



State of West Virginia
 Department of Administration
 Purchasing Division
 2019 Washington Street East
 Post Office Box 50130
 Charleston, WV 25305-0130

Solicitation

NUMBER
HOP14082

PAGE
1

ADDRESS CORRESPONDENCE TO ATTENTION OF
ROBERTA WAGNER 304-558-0067

RFQ COPY

TYPE NAME/ADDRESS HERE

VENDOR

SHIP TO

HEALTH AND HUMAN RESOURCES
 HOPEMONT HOSPITAL
 CENTRAL RECEIVING
 150 HOPEMONT DRIVE
 TERRA ALTA, WV
 26764-7728 304-789-2411

DATE PRINTED
11/26/2013

BID OPENING DATE: 12/11/2013

BID OPENING TIME 1:30PM

LINE	QUANTITY	UOP	CAT. NO.	ITEM NUMBER	UNIT PRICE	AMOUNT
ADDENDUM NO. 1						
ADDENDUM IS ISSUED:						
1. TO PROVIDE A COPY OF THE PRE-BID MEETING SIGN-IN SHEET FOR THE ABOVE SOLICITATION.						
2. TO PROVIDE RESPONSES TO VENDORS' QUESTIONS REGARDING THE ABOVE SOLICITATION. QUESTION AND ANSWER PAGES ARE ATTACHED.						
3. TO PROVIDE THE ASBESTOS REPORT. ASBESTOS REPORT IS ATTACHED.						
4. TO PROVIDE ADDENDUM ACKNOWLEDGMENT. THIS DOCUMENT SHOULD BE SIGNED AND RETURNED WITH YOUR BID. FAILURE TO SIGN AND RETURN MAY RESULT IN THE DISQUALIFICATION OF YOUR BID.						
***** END OF ADDENDUM NO. 1 *****						

SIGNATURE		TELEPHONE	DATE
TITLE	FEIN	ADDRESS CHANGES TO BE NOTED ABOVE	

WHEN RESPONDING TO SOLICITATION, INSERT NAME AND ADDRESS IN SPACE ABOVE LABELED 'VENDOR'

SOLICITATION NUMBER: HOP14082

Addendum Number: 1

The purpose of this addendum is to modify the solicitation identified as ("Solicitation") to reflect the change(s) identified and described below.

Applicable Addendum Category:

- Modify bid opening date and time
- Modify specifications of product or service being sought
- Attachment of vendor questions and responses
- Attachment of pre-bid sign-in sheet
- Correction of error
- Other

Description of Modification to Solicitation:

1. To provide copy of the pre-bid meeting sign-in sheet.
2. To provide copy of vendor questions and responses.
3. To provide copy of the asbestos report.
4. To provide Addendum Acknowledgement form.

Additional Documentation: Documentation related to this Addendum (if any) has been included herewith as Attachment A and is specifically incorporated herein by reference.

Terms and Conditions:

1. All provisions of the Solicitation and other addenda not modified herein shall remain in full force and effect.
2. Vendor should acknowledge receipt of all addenda issued for this Solicitation by completing an Addendum Acknowledgment, a copy of which is included herewith. Failure to acknowledge addenda may result in bid disqualification. The addendum acknowledgement should be submitted with the bid to expedite document processing.

ATTACHMENT A

SIGN IN SHEET

Page 1 of 2

Request for Proposal No. HOP14082

PLEASE PRINT

Date: 11/13/13

* PLEASE BE SURE TO PRINT LEGIBLY - IF POSSIBLE, LEAVE A BUSINESS CARD

FIRM & REPRESENTATIVE NAME	MAILING ADDRESS	TELEPHONE & FAX NUMBERS
Company: <u>Danhill Const. Co.</u>	<u>P.O. Box 685</u>	PHONE <u>304-632-1600</u>
Rep: <u>Dan Hill</u>	<u>Gauley Bridge WV</u>	TOLL FREE
Email Address: <u>rdanhill@hotmail.com</u>	<u>25085</u>	FAX <u>304-632-1501</u>
Company: <u>QUESTMARK</u>	<u>401 TECHNOLOGY DR.</u>	PHONE <u>724-444-4585</u>
Rep: <u>MARK HARRISON</u>	<u>CANONSBURG PA</u>	TOLL FREE
Email Address: <u>MARK.HARRISON@CENT.MARK.COM</u>	<u>15317</u>	FAX <u>724-444-8016</u>
Company: <u>Delanos Inc</u>	<u>31658 Veterans Mem Hwy</u>	PHONE <u>304-789-6966</u>
Rep: <u>Chuck Fultz</u>	<u>Terra Alta WV 26764</u>	TOLL FREE
Email Address: <u>cfultz4@gmail.com</u>		FAX <u>304-789-3166</u>
Company: <u>STONHARD FLOORING</u>	<u>1000 EAST PARK AVE.</u>	PHONE <u>412 716-1420</u>
Rep: <u>JOE DISAIA</u>	<u>MAPLE SHADE, NJ</u>	TOLL FREE
Email Address: <u>JDISAIA@STONHARD.COM</u>	<u>08052</u>	FAX <u>856 321-7631</u>
		PHONE
		TOLL
		FREE
		FAX

1000 EAST PARK AVENUE
MAPLE SHADE, NJ 08052
800.854.0310
FAX 856.321.7631
MOBILE 412.716.1420
jdisaia@stonhard.com

JOE DISAIA
TERRITORY MANAGER
PITTSBURGH SOUTH

STONHARD
Floors • Walls • Linings

0004

SIGN IN SHEET

Request for Proposal No. H0P14082

PLEASE PRINT

Page 2 of 2

Date: 11/13/13

* PLEASE BE SURE TO PRINT LEGIBLY - IF POSSIBLE, LEAVE A BUSINESS CARD

FIRM & REPRESENTATIVE NAME	MAILING ADDRESS	TELEPHONE & FAX NUMBERS
Company: _____	_____	PHONE
Rep: _____	_____	TOLL
Email Address: _____	_____	FREE
Company: _____	_____	FAX
Company: _____	_____	PHONE
Rep: _____	_____	TOLL
Email Address: _____	_____	FREE
Company: _____	_____	FAX
Company: _____	_____	PHONE
Rep: _____	_____	TOLL
Email Address: _____	_____	FREE
Company: _____	_____	FAX
Company: _____	_____	PHONE
Rep: _____	_____	TOLL
Email Address: _____	_____	FREE
Company: _____	_____	FAX

HOP14082-ADDENDUM#1
Resurfacing of Dietary Department Flooring

Question #1: Will the kitchen floor take the shot blasting without giving? If not what is the recourse?

Answer: Have a third party (Hopemont Maintenance Department) do a sound test to determine the cubic square footage that will need to be repaired by the contractor with a QuestMark Deco-pour or equal fast drying (4hour) concrete. Asbestos testing results show no asbestos present. The sound test results are approximately 3600 cubic feet that have the potential to give when shot blasted.

Question #2: Warranty Clarification, because of the sub structure potential for heaving will the warranty cover the resurfacing damaged by the heaving or will it be on the resurfacing products and installation alone?

Answer: Warranty must cover 2 years on the resurfacing failing from defect or faulty installation.

Question #3: How far are the contractors to go under stationary equipment?

Answer: Vendor must apply the resurfacing under stationary equipment four inches from the front of the equipment (not the front of the door but the unit itself).

Question #4: What size are the sections to be in the kitchen when resurfacing?

Answer: In specifications 3.1.1. Refers to the sections, Vendor must resurface in sections to ensure continuous operation of kitchen at all times. The following is the breakdown of the kitchen area: The storage area is one section; the kitchen will be split down the center to create 2 more sections, leaving access at the 2 doorways.

Question #5: The drains and clean outs will be ¼" higher than the new resurfaced floor do you want them to be lower?

Answer: In Specifications 3.1.1, this will be added in to the specifications to clarify what is to be done in detail how the drains and clean outs must be prepared. Vendor must prepare one and half foot (1 1/2') radius of 14 drains and 11 clean outs with fast cure grout, and then resurface the floor.

Question #6: Is there asbestos in or under the existing floor in the kitchen?

Answer: Kitchen tile was tested for asbestos and the no asbestos is present in the cafeteria or the kitchen.

Question#7: I would like to know if there's a cost estimate for the Kitchen & Cafeteria Floor Preparation/Resurfacing Project (Bid No. HOP14082) or can you give me a ball park this project would fall under?

Answer: No, we can't divulge the budget amount for this project, nor can we give a ball park figure.



ASBESTOS REPORT

Report Date:
11/25/2013

Project Number:
13-657

Asbestos Present:

Property Owner:
Hopemont Hospital
150 Hopemont Drive
Terra Alta, WV 26764

Property Address:
Hopemont Hospital
150 Hopemont Drive
Terra Alta, WV 26764
Kitchen and Cafeteria floors

- Yes
- No
- Friable
- Non-Friable
- Presumed

SYNOPSIS

Ms. Shelby Hauser requested a limited scope asbestos inspection on kitchen and cafeteria floors only at Hopemont Hospital 150 Hopemont Drive Terra Alta, WV. There were no asbestos containing materials detected in areas tested.

IMPORTANT: This document is intended only for the individual or entity to which it is directed. This document contains competition sensitive information that is privileged, confidential, and/or proprietary. Dissemination, distribution, or reproduction of this document by anyone other than the intended recipient, or a duly designated employee or agent of such recipient, is prohibited. This document, or any portions thereof, may not be divulged to third parties without expressed written consent.

Date of Inspection: **11/21/2013**
Year Constructed: **80+**
Approx. SF of Building: **30,000**
Current Use: **Hospital**
County: **Preston**

Renovation/Demolition: **Renovation**
Number of Floors: **Unknown**
Basement/Crawlspace: **Basement**
Prior Use: **Unknown**

Asbestos Inspector _____
Date: 11-25-13
Print Name: **Jeff Bailey**
License #: WV AI007437

Peer Review _____
Date: 11-25-2013



Table of Contents

Section	Title	Page
Section 1	Executive Summary.....	3
Section 2	Scope.....	4
Section 3	Definitions of Terms, Abbreviations, and Symbols.....	5
Section 4	Sample Collection and Analysis.....	6-7
Section 5	Photographs/Drawings.....	8

Appendices

Appendix	Title
Appendix 1	Laboratory Results
Appendix 2	Certification/License
Appendix 3	Summary of ACM Materials



Section 1 – Executive Summary

Below is a summary of the data and analysis presented in this document. Additional details are provided in the following sections.

Bulk Sample Concentrations

Astar Abatement, Inc. (Astar) collected bulk samples of suspect materials. Seven (7) sample(s) of suspect materials were collected from the structure as described in Section 4 Data Collection and Analysis.

The collected samples were forwarded to Pinnacle Environmental, located in Winfield, WV, for analysis. Table 1 in APPENDIX 3 presents a synopsis of the laboratory data. The results that indicate regulated asbestos containing materials are in highlighted in red.

Conclusions

The analytical results indicate that all of the materials identified in this report are not asbestos containing. Current laws and regulations require the removal of asbestos-containing materials (ACM) prior to any renovation or demolition activities which may disturb these materials. If removal of ACM is necessary, a West Virginia Bureau for Public Health (WVBPH) licensed asbestos abatement contractor should be contracted to perform the removal work and submit necessary regulatory notifications. If the property is a single family dwelling and the occupant is also the owner, he/she must contact the West Virginia Bureau for Public Health to get a waiver in order to perform the removal themselves. The WVBPH, Office of Radiation, Toxins and Indoor Air may be reached at 304-558-2981.

Caution should be exercised during the renovation/demolition activities in the event materials not identified in this report, known, assumed, or suspected to contain asbestos are exposed during these activities. In the event additional suspect material is discovered during this activity, work with the potential for disturbance should be stopped until sampling and analysis has been performed.



Section 2 – Scope of Work

In response to a request from Ms. Shelby Hauser, Astar conducted a limited scope asbestos inspection of the property on Hopemont Hospital 150 Hopemont Drive Terra Alta, WV (kitchen and cafeteria floors only).

The purpose of the inspection was to determine if asbestos containing materials were present prior to renovation. This report represents the results from a limited inspection performed in accordance with directions agreed upon by the owner and Astar.

This report or any statements or information contained herein shall not be interpreted to imply any conclusions or opinions related in any manner as to whether any potential health risks to individuals exposed to the building environments were or were not present at the time of our inspection or may or may not develop at some time in the future.

This report is not a guarantee or warranty of any kind and was prepared for the exclusive use of the owner and Astar Abatement, Inc. and may be provided to others for disclosure purposes only. Prospective purchasers or any other interested parties are advised that this report is not intended for their use or benefit nor is to be relied upon to ascertain the condition of the property. Astar Abatement, Inc., their employees, agents and subcontractors do not assume any liability for hidden/latent defects or conditions of any kind.

Indemnification:

Astar Abatement, Inc., its employees or subcontractors, shall not be legally responsible for any direct, indirect, incidental, special, consequential or exemplary damages, including (but not restricted to) damages for loss of investment, value, use, expenditure, or other intangible losses (even if Astar has been advised of the possibility of such damages), resulting from: 1) the use or the incapability to use this document or previously related documentation issued by Astar; 2) statements or behavior of any third party; or 3) any other matter relating to our efforts regarding the referenced property. On no occasion shall total legal responsibility to any concerned party for all damages, losses, and causes of action go beyond the amount paid to Astar for the preparation and publication of this specific document.

Every attempt was made to gain access to each and every area or to access representative materials entering or leaving such areas. Astar Abatement, Inc. accepts no liability nor makes any claims regarding asbestos or suspect materials that were not accessible during the inspection process. Especially if such material was located behind or within walls, concrete decks, sub-floors, chases, or was otherwise generally inaccessible without destructive sampling.

The information in the report or portions thereof may be required to be included in the notifications to contractors or other visitors to the building(s). This report is not intended to be used as a specification or work plan for any of the work suggested or recommended in this report.

This report is based upon conditions and practices observed at the property and information made available to the surveyor. This report does not intend to identify all hazards or unsafe practices, or to indicate that other hazards or unsafe practices do not exist at the premises.



Section 3
Definitions of Terms, Abbreviations, and Symbols:

PLM: Polarized Light Microscopy. Standard methodology for analyzing suspect materials for asbestos content.

Limited Scope: Only certain area(s) of the structure was inspected as per the owner's request. Any suspect material in the remaining area must be considered to be asbestos containing until proven otherwise.

Complete Inspection: Inspection of all areas of the structure including interior and exterior materials and all other areas generally accessible.

ND: None Detected – the level of asbestos was below the detection limit of the analytical method.

<(Left Pointer): Less than...

EPA: United States Environmental Protection Agency

RACM: Regulated Asbestos Containing Material – Any material containing greater than 1% of asbestos.

Friable: Any material, when dry, that can be crushed, crumbled or reduced to powder by hand pressure.

Category I Non-Friable: Resilient floor covering, roofing, gaskets or packings.

Category II Non-Friable: All other non-friable asbestos containing materials.

WVBPH: West Virginia Bureau for Public Health - Radiation, Toxics and Indoor Air Division

Sq. Ft. (sf): Square feet

Ln. Ft.(lf): Linear feet

TSI: Thermal System Insulation

Ftgs: Fittings



Section 4 – Sample Collection and Analysis

This section presents a summary of the sample collection and analysis tasks.

Laboratory Requirements

A laboratory experienced in the analysis of building materials and maintaining traceable quality control documentation is necessary to establish a reliable chain of evidence. The laboratory shall successfully participate in the American Industrial Hygiene Association (AIHA) bulk asbestos quality assurance program or the National Voluntary Laboratory Accreditation Program (NVLAP). NVLAP accreditation is required for the analysis of public or private school samples (K-12).

Summary of Data Collection and Analysis

Astar collects samples of suspect materials that may contain asbestos fibers according to the table below:

Est. Quantity of Surfacing Materials	# Samples
<1,000 sq. ft.	3
1,001 sq. ft. – 5,000 sq. ft.	5
>5,000 sq. ft.	7
Thermal System Insulation	
Per Homogeneous area	3
Per 6 ln. ft. patch	1
Miscellaneous & Non-friable	
Per Homogeneous area	1*
*The inspector shall insure that the number of samples taken were “sufficient to determine” whether the material contains asbestos.	

The sample(s) were collected and placed in a clean, sealable container and labeled with a unique identifying number. This sample number was then recorded on the Sample Chain of Custody (COC) and when conditions permit on the sample location to permit identification of the material in the future. To avoid the potential release of asbestos fibers, Astar performs bulk sampling of suspect material in accordance with generally accepted procedures outlined in the Asbestos Hazard Emergency Response Act (AHERA). Additional information may have also been recorded including the date of the inspection, inspector’s name, building name or number, description and location of the material being sampled and quantity of material. The location of the sample may also be recorded on a drawing.

Analysis of Samples

Bulk samples were submitted to the laboratory for analysis by PLM with dispersion staining (EPA-600/R-93/116). The EPA currently recommends this method for the determination of asbestos in bulk samples of suspect materials, can be used for the qualitative identification of the six (6) different types of asbestos fibers: Chrysotile, Amosite, Crocidolite, Anthophyllite, Tremolite and Actinolite. This method specifies that the asbestos content will be estimated and reported as a finite percentage (rounded to the nearest percent) within the range of zero to one hundred percent (0%-100%).

The results of the bulk sample analysis are reported in the laboratory report located in the Appendix of this report. The report includes the sample number, laboratory assigned number along with the asbestos



content of each sample. If a bulk sample contained more than one distinct layer of material, each layer was analyzed separately. This separation resulted in a total number of Seven (7) samples being analyzed.

The EPA recommends for bulk samples containing less than ten percent (<10%) of asbestos, the sample be analyzed by the point count method reference PLM, EPA 600/R-93/116. This analytical method is a more accurate way of determining the actual asbestos content percentage. For this particular project, 0 sample(s) was/were analyzed using the point count methods. A copy the laboratory results and the chain of custody are located in the Appendix.

ASTAR ABATEMENT, INC
Quality Safety Reliability

Section 5 - Photograph/Drawings



ASTAR ABATEMENT, INC
Quality Safety Reliability

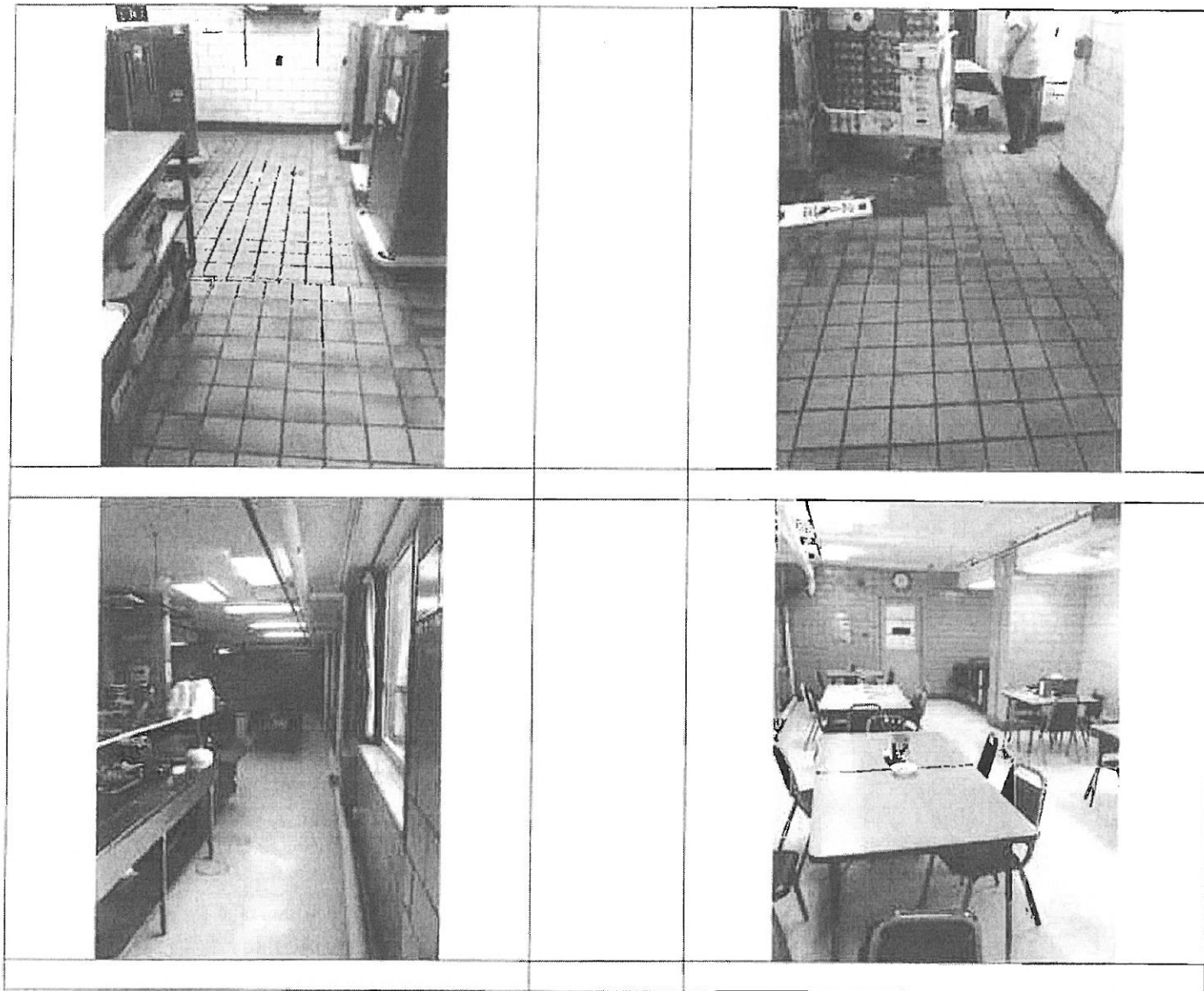

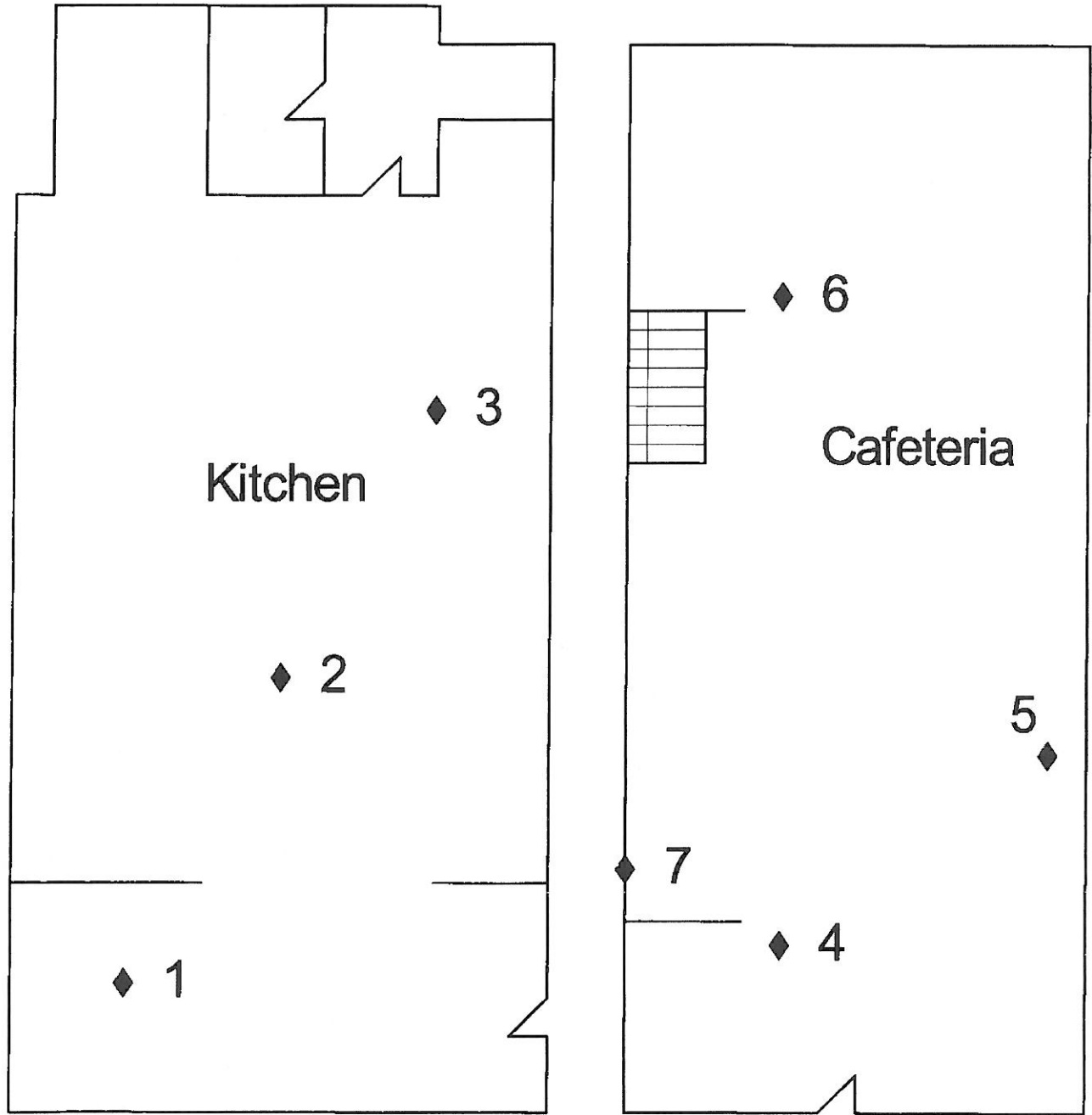

Approx. Sample Locations

Asbestos Inspection

Date 11/25/2013	Project 13-657 Drawn By JGB	Hopemont Hospital Terra Alta, WV	Page 1
--------------------	--------------------------------------	-------------------------------------	--------



Appendix 1

Laboratory Results



Client Kitchen / Cafeteria
 Inspector Jeff

Job # 13-657
 Date 11-21-13

Turn-Around Time
 4 Hours 24 Hours 48 Hours 3 Days 5 Days

Sample ID	Material Description	Lab ID
01	FLOOR GROUT KITCHEN	1308-32839
02	" "	↑
03	" "	
04	12x12 FRT CAFETERIA	
05	" "	
06	" "	
07	CONCRETE BASE	
8		
9		
10		
11		
12		
13		
14		
15		
16		
17		
18		
19		
20		
21		
22		
23		
24		
25		
26		
27		
28		
29		
30		
31		
32		
33		
34		
35		
36		

Check Back For Additional Samples

Relinquished By: <u>[Signature]</u>	Date/Time: <u>11-22-13</u>	Relinquished By:	Date/Time:
Relinquished By: <u>[Signature]</u>	Date/Time: <u>11-22-13 1:37 PM</u>	Relinquished By:	Date/Time:

PO. Box 13533
 Sissonville, WV 25360

Corporate E-mail
 astarinc@verizon.net

304-984-4030 Voice
 304-984-4031 Fax

Asbestos Identification by Polarized Light Microscopy

Analysis Report



PECLAB LAB CODE: 200712-0

Attn: Jeff Bailey
 Astar Abatement
 P.O. Box 13533
 Sissonville, WV 25360

400-L Prestige Park
 Hurricane, West
 Virginia 25526
 Phone: 304-757-5204
 Fax: 304-757-5205

Received Date: 11/22/2013
 Analysis Date: 11/22/2013
 RE: Kitchen/Cafeteria

PEC Project #:
 Client Project/PO #: 13-657

PECLAB #	CLIENT ID #	LOCATION	COLOR
13WB-32839	01	Kitchen	Grey
Texture/Description: Solid/Floor Grout			
TOTAL ASBESTOS: 0 %			
Cellulose: 3% Fiber Glass: 0%			
Chrysotile:	0%	Tremolite:	0%
Amosite:	0%	Actinolite:	0%
Others:	0%	Anthophyllite:	0%
		Crocidolite:	0%
		Filler/Binder:	97 %

PECLAB #	CLIENT ID #	LOCATION	COLOR
13WB-32840	02	Kitchen	Grey
Texture/Description: Solid/Floor Grout			
TOTAL ASBESTOS: 0 %			
Cellulose: 2% Fiber Glass: 0%			
Chrysotile:	0%	Tremolite:	0%
Amosite:	0%	Actinolite:	0%
Others:	0%	Anthophyllite:	0%
		Crocidolite:	0%
		Filler/Binder:	98 %

PECLAB #	CLIENT ID #	LOCATION	COLOR
13WB-32841	03	Kitchen	Grey
Texture/Description: Solid/Floor Grout			
TOTAL ASBESTOS: 0 %			
Cellulose: 2% Fiber Glass: 0%			
Chrysotile:	0%	Tremolite:	0%
Amosite:	0%	Actinolite:	0%
Others:	0%	Anthophyllite:	0%
		Crocidolite:	0%
		Filler/Binder:	98 %

PECLAB #	CLIENT ID #	LOCATION	COLOR
13WB-32842	04	Cafeteria	White
Texture/Description: Solid/12 x 12 Floor Tile			
TOTAL ASBESTOS: 0 %			
Cellulose: 0% Fiber Glass: 0%			
Chrysotile:	0%	Tremolite:	0%
Amosite:	0%	Actinolite:	0%
Others:	0%	Anthophyllite:	0%
		Crocidolite:	0%
		Filler/Binder:	100%

PECLAB #	CLIENT ID #	LOCATION	COLOR
13WB-32843	05	Cafeteria	White
Texture/Description: Solid/12 x 12 Floor Tile			
TOTAL ASBESTOS: 0 %			
Cellulose: 0% Fiber Glass: 0%			
Chrysotile:	0%	Tremolite:	0%
Amosite:	0%	Actinolite:	0%
Others:	0%	Anthophyllite:	0%
		Crocidolite:	0%
		Filler/Binder:	100%

RE: Kitchen/Cafeteria

REC LAB #	CLIENT ID #	LOCATION	COLOR
13WB-32844	06	Cafeteria	White
Texture/Description: Solid/12 x 12 Floor Tile			
TOTAL ASBESTOS: 0 %			
Cellulose: 0% Fiber Glass: 0% Others: 0% Filler/Binder: 100%			
Chrysotile: 0% Tremolite: 0% Anthophyllite: 0%			
Amosite: 0% Actinolite: 0% Crocidolite: 0%			

REC LAB #	CLIENT ID #	LOCATION	COLOR
13WB-32845a	07	Cafeteria	Brown
Texture/Description: Solid/Cove Base			
TOTAL ASBESTOS: 0 %			
Cellulose: 0% Fiber Glass: 0% Others: 0% Filler/Binder: 100%			
Chrysotile: 0% Tremolite: 0% Anthophyllite: 0%			
Amosite: 0% Actinolite: 0% Crocidolite: 0%			

REC LAB #	CLIENT ID #	LOCATION	COLOR
13WB-32845b	07	Cafeteria	Yellow
Texture/Description: Solid/Mastic			
TOTAL ASBESTOS: 0 %			
Cellulose: 2% Fiber Glass: 0% Others: 0% Filler/Binder: 98 %			
Chrysotile: 0% Tremolite: 0% Anthophyllite: 0%			
Amosite: 0% Actinolite: 0% Crocidolite: 0%			

Analytical Method: Polarized light microscopy using dispersion staining (EPA-600/M4-82-020). PLM should not be used to demonstrate the absence of asbestos in floor tiles. All samples will be held for sixty (60) days unless otherwise requested. This report relates only to items tested and makes no statement as to the contents of surrounding materials. Multi-layered material which have distinct and separable layers shall be reported separately. This report shall not be reproduced, except in full, without written permission. The results of this report should not be used as an endorsement for NVLAP or any other government agency.

Analyzed by: _____

Littia C. Mann

Littia Mann



Appendix 2 Certification/License



WEST VIRGINIA

Asbestos Program

Jeff Bailey

IS LICENSED AS AN
ASBESTOS INSPECTOR

License #: AI007437

Issued: 9/4/2013

Expires: 9/30/2014

Anthony Turner Assistant Director
WV RTIA DIV

This Certificate is Awarded to

Jeff Bailey

Who has successfully completed the below course with a score of 70% or better. This course is West Virginia and EPA approved and meets the requirements set forth in 40 CFR Part 763 (AHERA) for purposes of accreditation required under TSCA Title II. This Course was conducted by Astar Abatement, Incorporated.

Asbestos Building Inspector Refresher

Course Start Date
8/30/2013 Thru 8/30/2013

Exam Date
8/30/2013
Expiration Date
8/30/2014

Total Hours
4

Certificate Number
AC13107-789

Leiton E. Miller III
Instructors Name

Leiton E. Miller III
Instructors Signature

There is a printed watermark below the Instructors signature on the original



Post Office Box 13533
Sissonville, WV 25360
Phone: (304) 343-5950
Fax: (304) 343-5961



Appendix 3

SUMMARY OF ACM MATERIALS



ASTAR ABATEMENT, INC
Quality Safety Reliability

Material Description	Sample #	Quantity	Result	Room #
Floor grout	1-2-3	-----	NAD	Kitchen
12" x 12" Floor tile	4-5-6	-----	NAD	Cafeteria
Cove base	7	-----	NAD	Cafeteria

SF-Square Feet LF - Linear Feet JT - Joints NAD - No Asbestos Detected

ADDENDUM ACKNOWLEDGEMENT FORM
SOLICITATION NO.: HOP14082

Instructions: Please acknowledge receipt of all addenda issued with this solicitation by completing this addendum acknowledgment form. Check the box next to each addendum received and sign below. Failure to acknowledge addenda may result in bid disqualification.

Acknowledgment: I hereby acknowledge receipt of the following addenda and have made the necessary revisions to my proposal, plans and/or specification, etc.

Addendum Numbers Received:

(Check the box next to each addendum received)

- | | |
|---|--|
| <input type="checkbox"/> Addendum No. 1 | <input type="checkbox"/> Addendum No. 6 |
| <input type="checkbox"/> Addendum No. 2 | <input type="checkbox"/> Addendum No. 7 |
| <input type="checkbox"/> Addendum No. 3 | <input type="checkbox"/> Addendum No. 8 |
| <input type="checkbox"/> Addendum No. 4 | <input type="checkbox"/> Addendum No. 9 |
| <input type="checkbox"/> Addendum No. 5 | <input type="checkbox"/> Addendum No. 10 |

I understand that failure to confirm the receipt of addenda may be cause for rejection of this bid. I further understand that any verbal representation made or assumed to be made during any oral discussion held between Vendor's representatives and any state personnel is not binding. Only the information issued in writing and added to the specifications by an official addendum is binding.

Company

Authorized Signature

Date

NOTE: This addendum acknowledgement should be submitted with the bid to expedite document processing.
 Revised 6/8/2012