

Existing  
Conduit  
180'



Sat  
Dish

Existing Telecom Pole  
Lines go underground here

Approximate Total Length DS3: 194'  
Approximate Total Length Ethernet: 318'

Cable Tray is 9'3" from floor

Note1: DS3 drop  
Note2: Ethernet Drop

Distance from pole  
to building  
108'

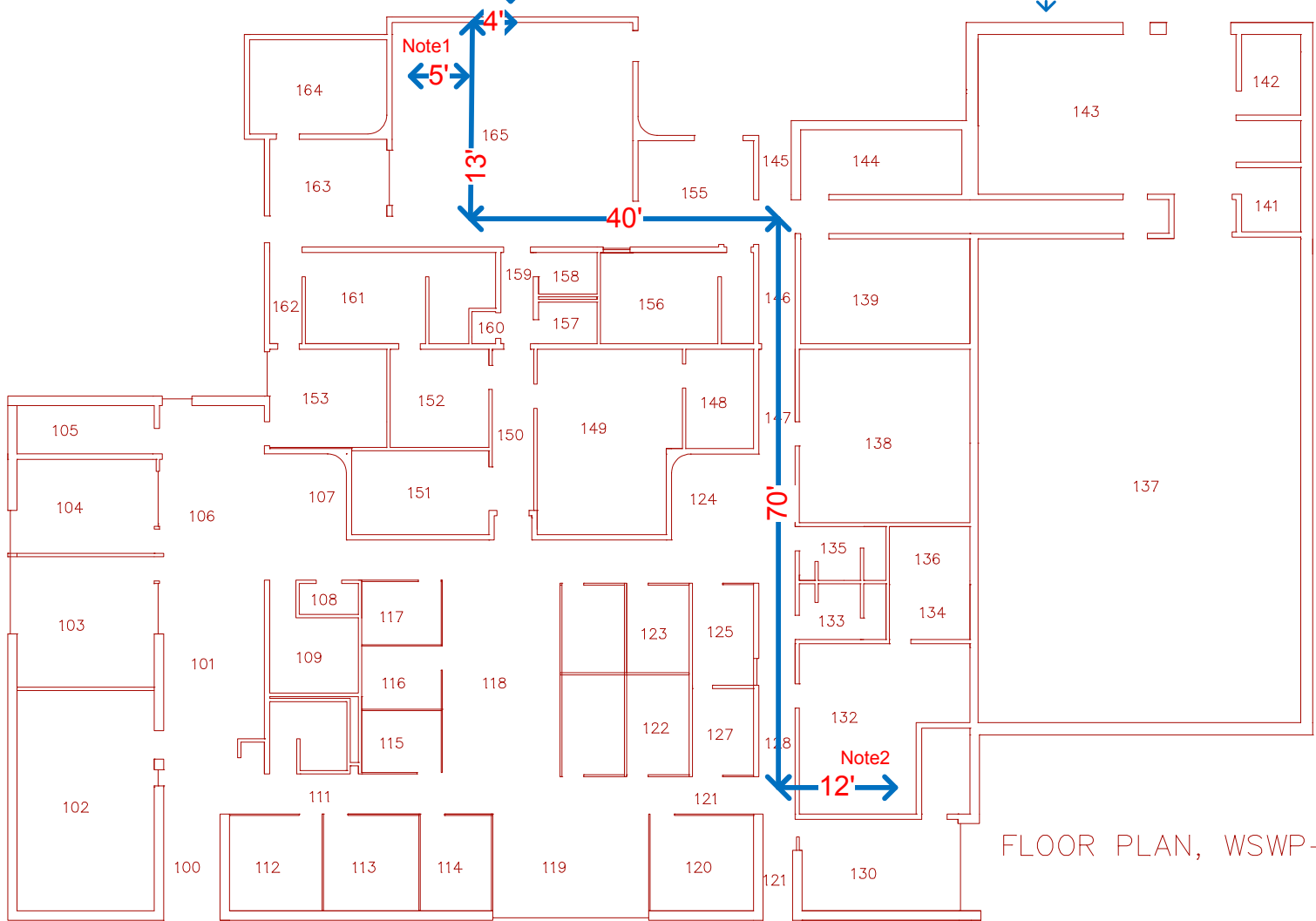

FLOOR PLAN, WSWP-TV