

WSWP-TV
124 Industrial Pk Rd
Beaver, WV 25813

Approximate Total Length DS3: 194'
Approximate Total Length Ethernet: 318'

Cable Tray is 9'3" from floor

Note1: DS3 drop
Note2: Ethernet Drop

Existing Path
180'



Sat Dish

Existing Telecom Pole
Lines go underground here



Distance from pole to building
108'

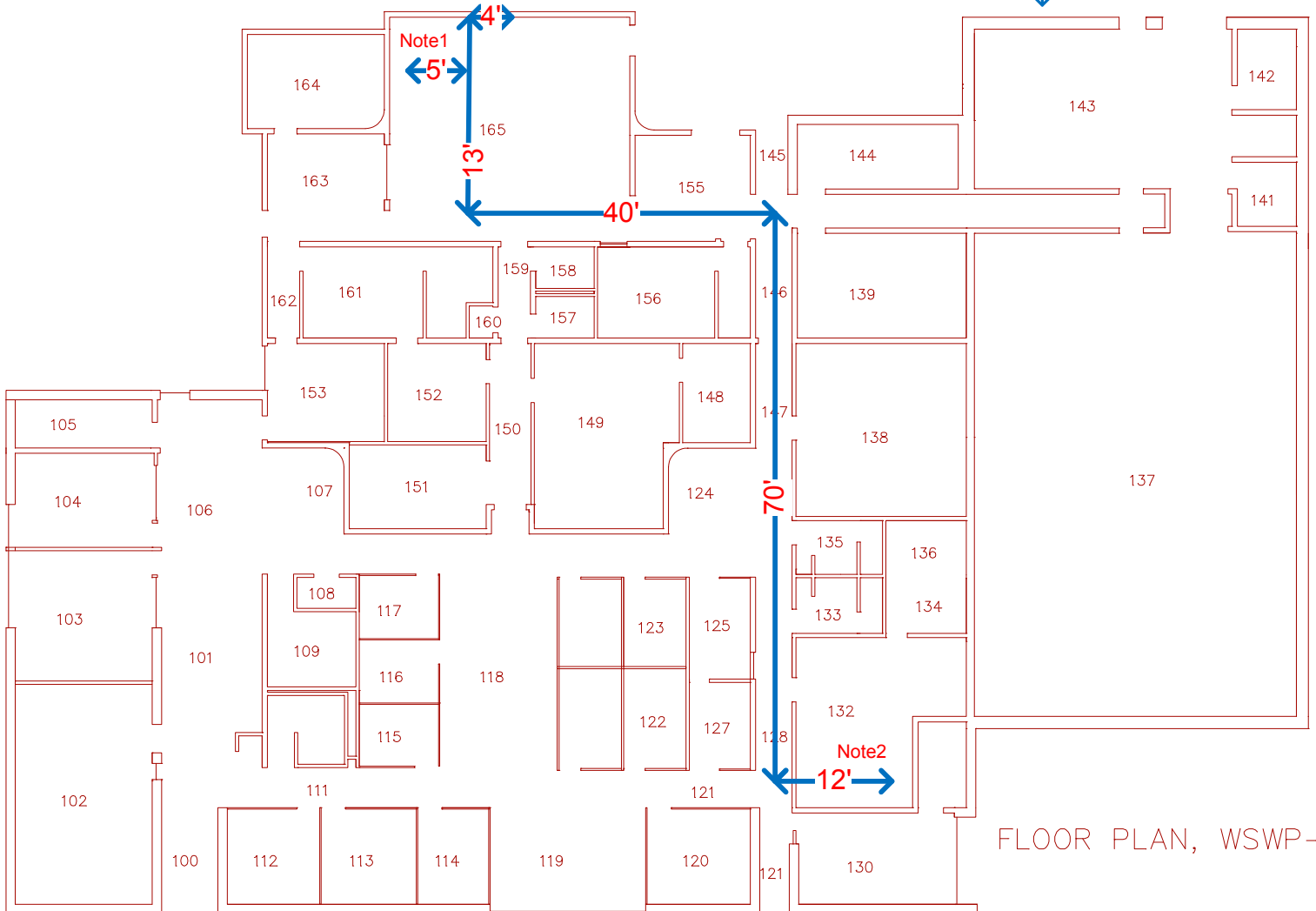

FLOOR PLAN, WSWP-TV