

LAYOUT Tab: PLOT
 CAD FILE: R:\060-0459 Palatine Park Phase I - Marion County\EDA\Survey\boat Ramp_Topop.dwg
 PLOT DATE/TIME: 8/23/2013 2:29 PM
 USER: chris Irvine

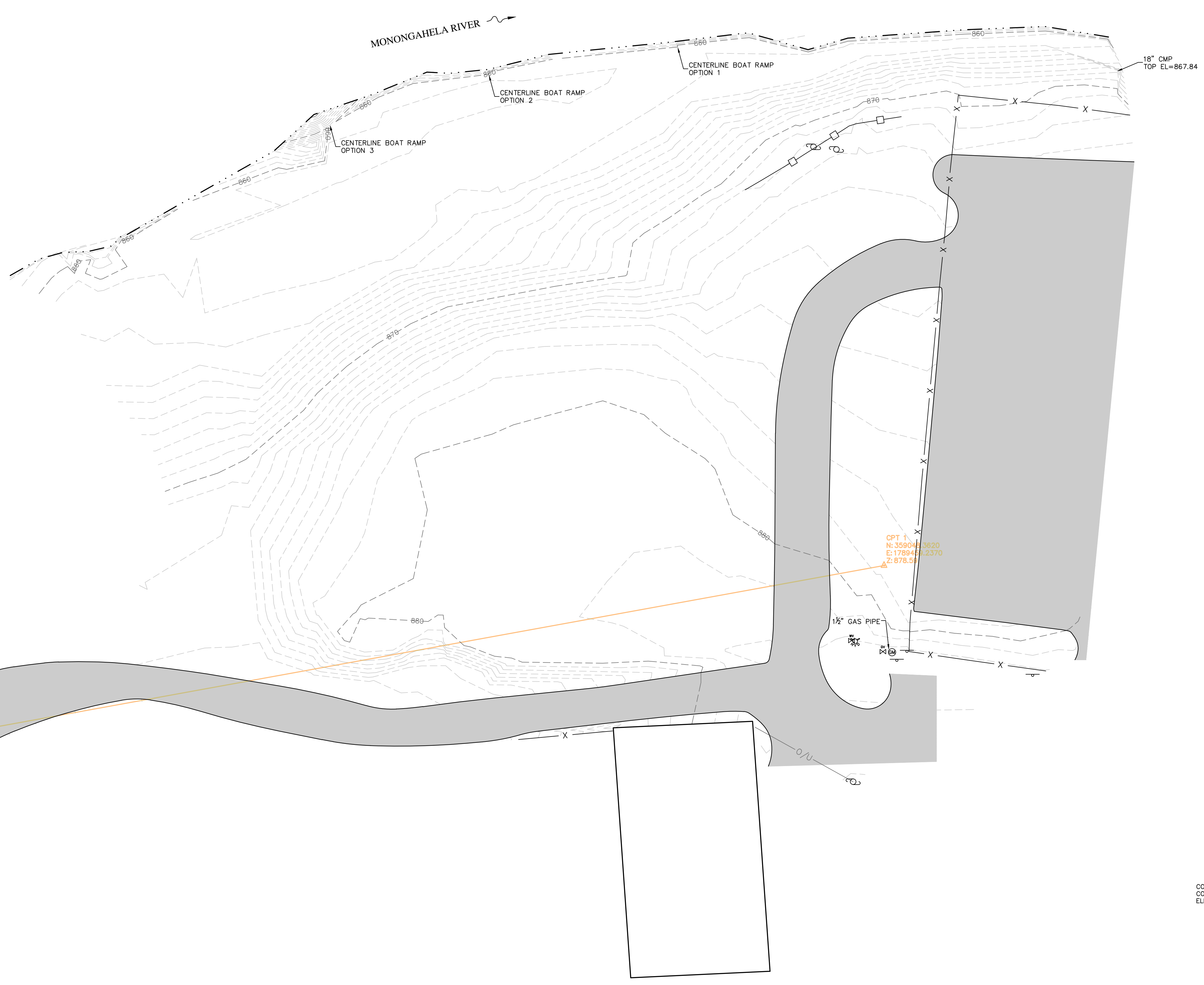

LEGEND/ABBREVIATIONS

- = EXISTING WOODEN FENCE
- x— = EXISTING FENCE
- ⊕ = HYDRANT
- ⊕ = GAS VALVE
- ⊕ = GAS METER
- ⊕ = UTILITY POLE
- /○— = OVERHEAD UTILITY LINE
- = HOT MIXED ASPHALT

CONTOUR INTERVAL = 1 FOOT
 COORDINATES ARE WEST VIRGINIA STATE PLAN NORTH ZONE NAD 83
 ELEVATIONS ARE NAVD 88

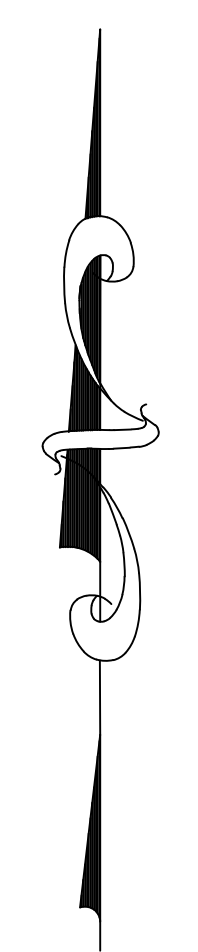
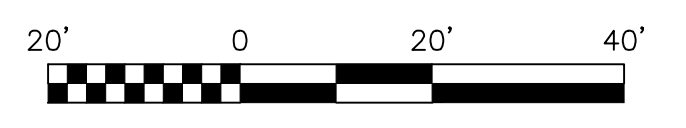

THE INFORMATION CONTAINED HEREIN IS THE SOLE PROPERTY OF THE THRASHER GROUP INC. REPRODUCTION OF THESE DOCUMENTS IN WHOLE OR IN PART, FOR ANY REASON WITHOUT PRIOR WRITTEN PERMISSION, IS STRICTLY PROHIBITED. COPYRIGHT © 2013 THE THRASHER GROUP INC.			
NO.	BY	DATE	DESCRIPTION

SCALE: 1"=20'	DATE: 8/2013
DRAWN: CI	DATE:
CHECKED:	DATE:
APPROVED:	DATE:
SURVEY DATE:	
SURVEY BY:	
FIELD BOOK No.:	



PHASE No.	
CONTRACT No.	
PROJECT No.	060-0459

**TOPOGRAPHIC SURVEY
 PALATINE PARK
 MARION COUNTY, WEST VIRGINIA**

SHEET No.
1