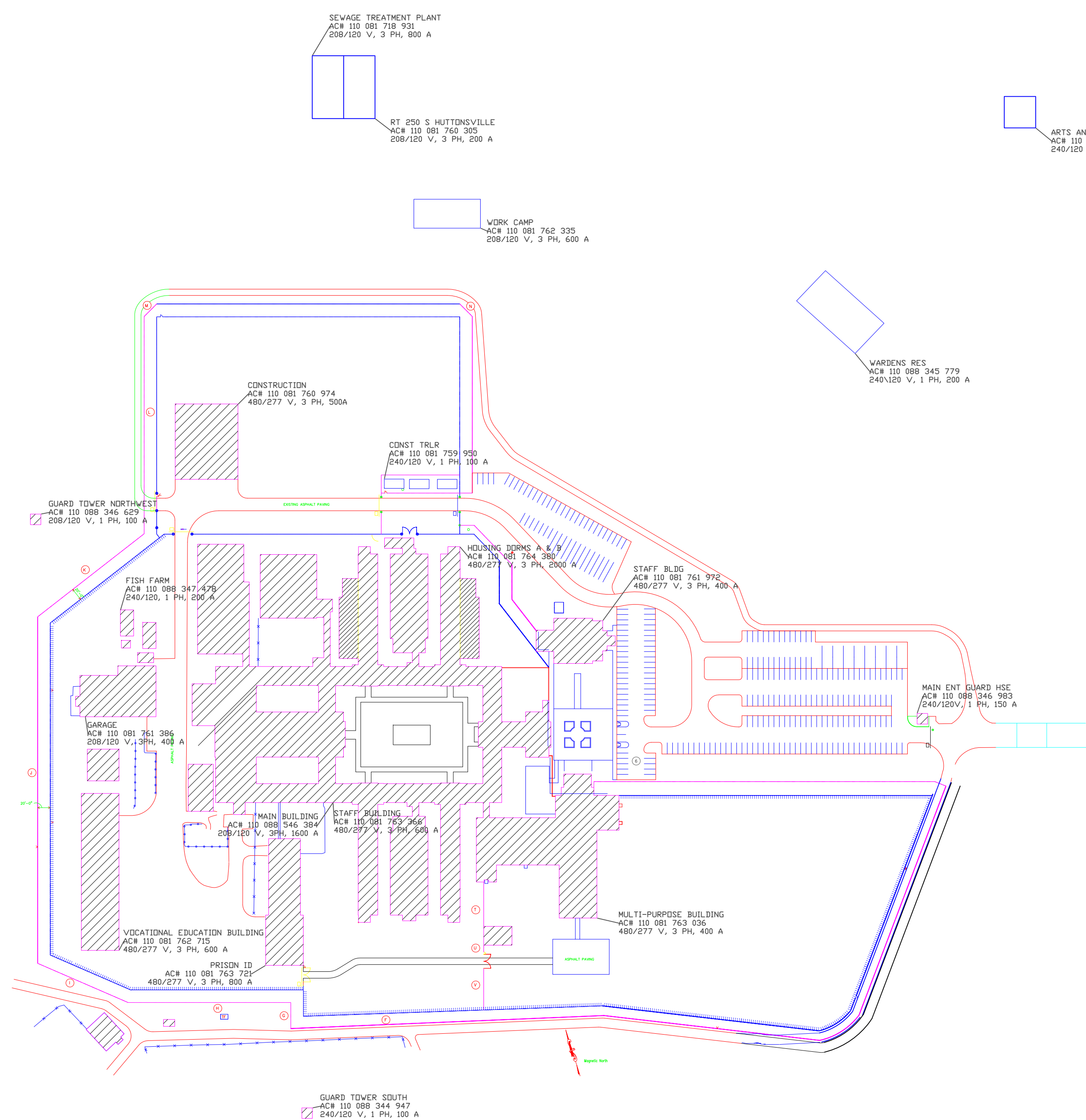

Exhibit #4

Drawing of Commercial Power Meter Locations and Size of Voltage, Phase, Amperage



US ROUTE 250

COMMERCIAL POWER COMPANY METER LOCATIONS DRAWING
1/128" = 1'

General Notes

KEY NOTES

1. THE BUILDINGS THAT DO NOT HAVE HATCH MARKS ON WERE JUST PLACED ON THE DRAWING. THE SIZE OF THE BUILDINGS AND THE LOCATIONS ARE NOT CORRECT. THEY ARE JUST SHOWN IN AN ESTIMATED LOCATION.
2. THE FOLLOWING LIST OF FOUR COMMERCIAL POWER SERVICES WILL NOT NEED TO BE INCLUDED IF THERE IS A SUBSTATION BUILT:
 - A. FIRING RANGE
 - B. FORMER VDC BLD
 - C. ARTS AND CRAFTS BLG
 - D. RECORDS STOR/FARM OFFICE

FIRING RANGE
AC# 110 089 042 925
240/120 V, 1 PH, 200 A

ARTS AND CRAFTS BLDG
AC# 110 081 761 709
240/120 V, 1 PH, 200 A

FORMER VDC BLDG
AC# 110 089 046 199
240/120 V, 1 PH, 400 A

RECORDS STOR/FARM OFFICE
AC# 110 081 760 630
240/120 V, 1 PH, 150 A

No.	Revision/Issue	Date

Firm Name and Address
West Virginia Division of Corrections
1409 Greenbrier Street
Charleston, WV 25311

Project Name and Address
Emergency Power Systems and Issues
Project
Huttnoville Correctional Center
Route 219/250 South
Huttnoville, WV 26273

Project	COR61694	Sheet	EXHIBIT #4
Date	MAY 23, 2014		
Scale	1/128" = 1'		