

6 Roof Plan - Stair
A101 1/4" = 1'-0"

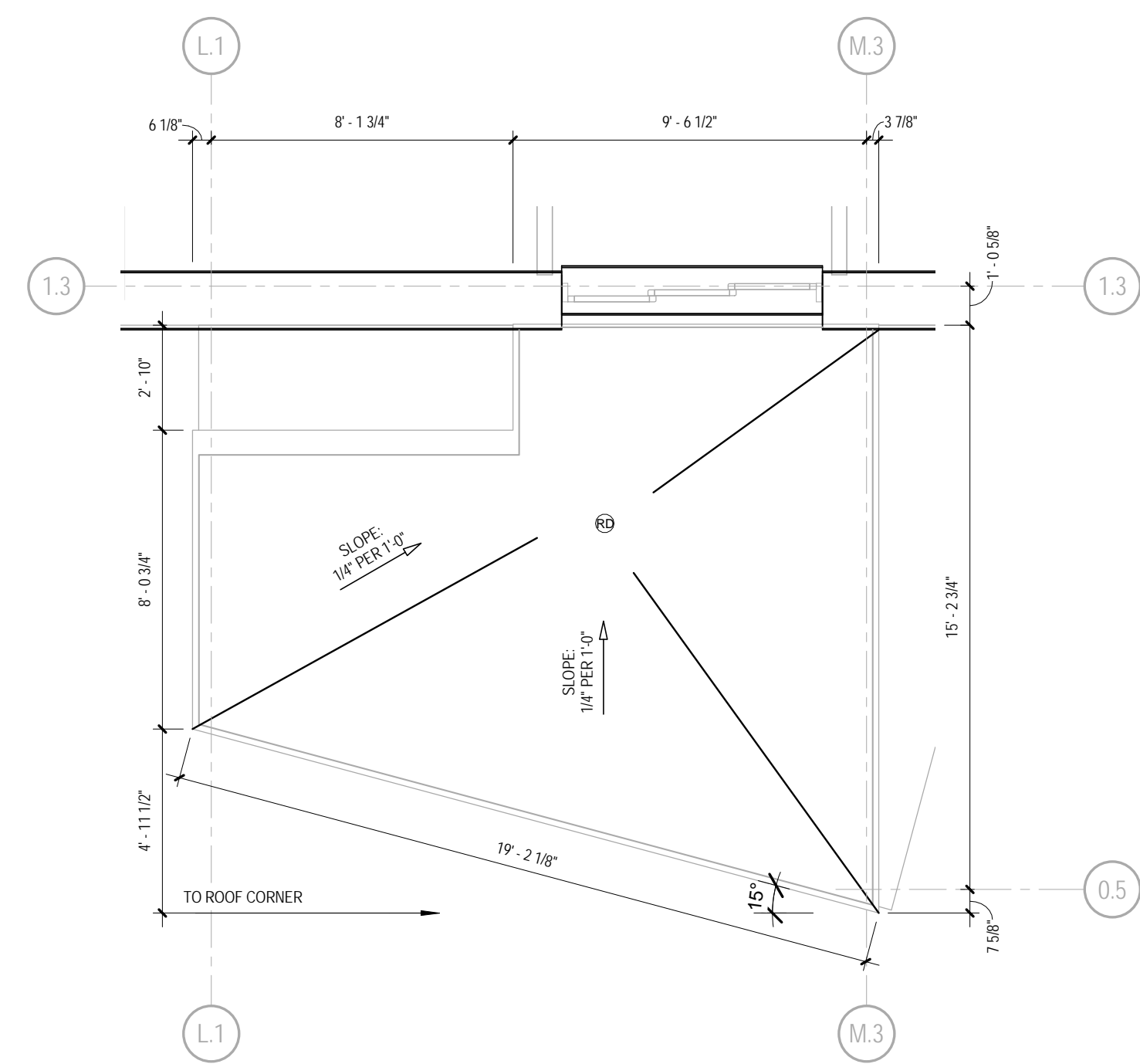

3 Entrance Canopy Roof Plan
A101 1/4" = 1'-0"

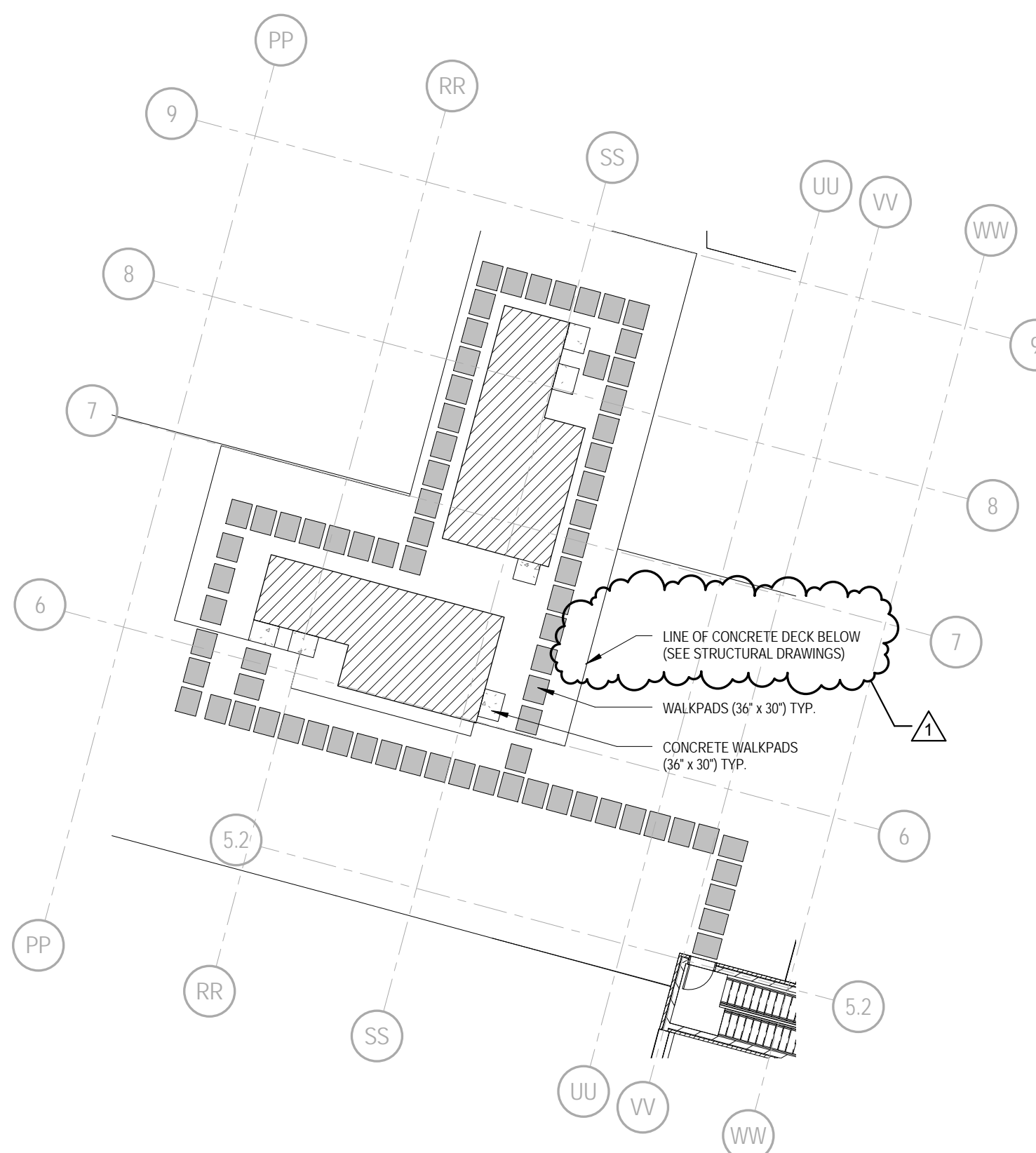

2 Roof Paver Plan
A101 1/16" = 1'-0"

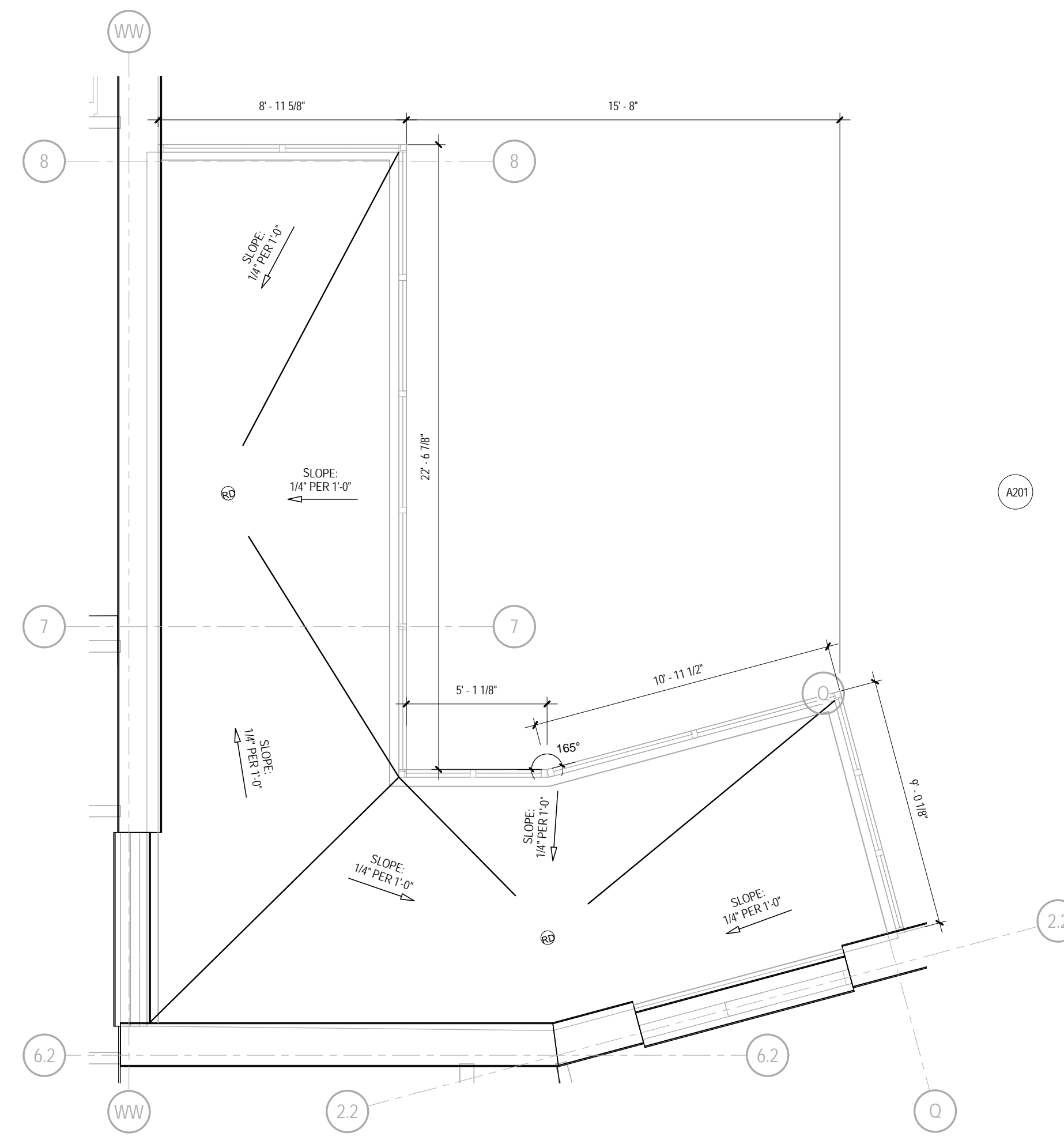

4 Shared Courtyard Canopy Roof Plan
A101 1/4" = 1'-0"

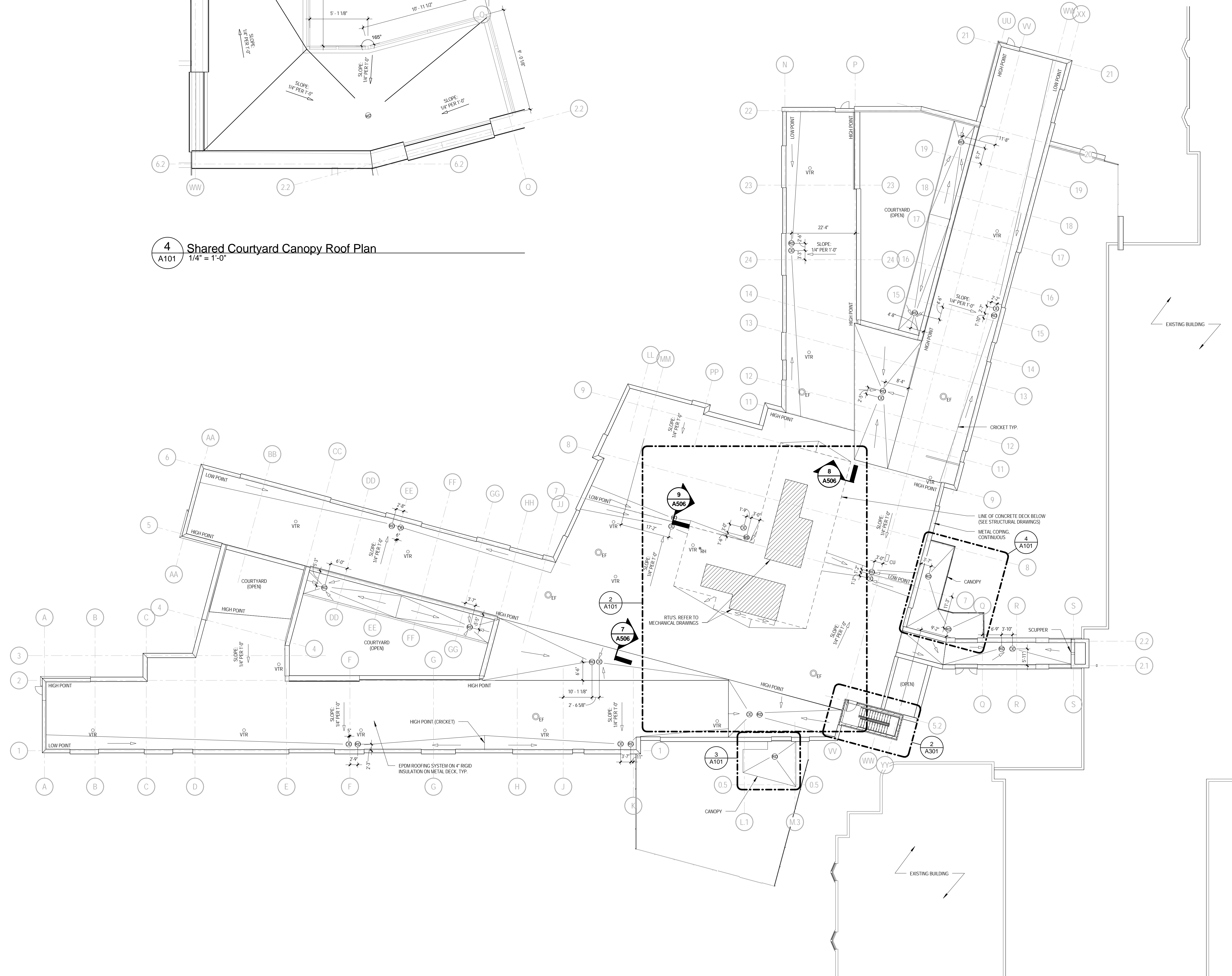

1 Roof Plan
A101 1/16" = 1'-0"

Legend	
	OVERFLOW DRAIN
	ROOF DRAIN
	VENT THROUGH ROOF
	VTR
	EF EXHAUST FAN

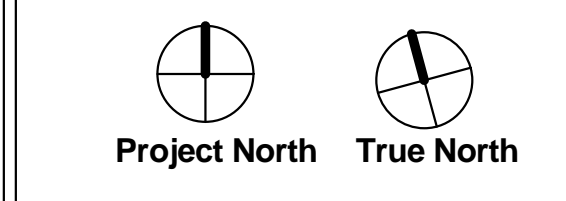
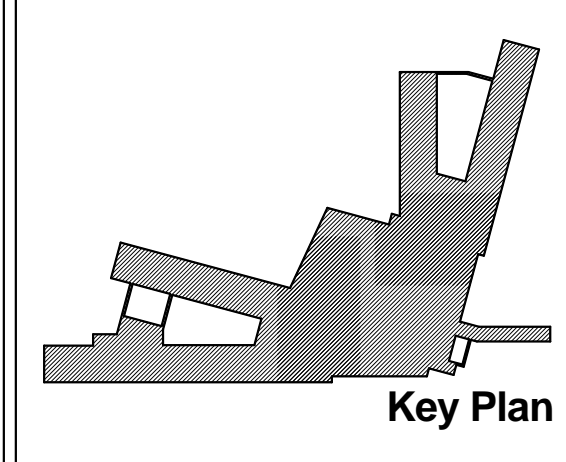

Bid Set

No.	Date	Description
1	01-30-2013	Addendum 4

Revisions	
Date	14 November 2012
Project Title	William R. Sharpe Hospital
50 Bed Addition	

936 Sharpe Hospital Road
Weston, WV 26452-8550

Drawing Title
Roof Plan

Project Number
11-170

Drawing Number
A101