

**Bid Set**

No.	Date	Description
1	01-30-2013	Addendum 4

**Revisions**

**Date**  
 14 November 2012

**Project Title**  
 William R. Sharpe  
 Hospital  
 50 Bed Addition

**Drawing Title**  
 Partial Plan - Nursing  
 Unit 1

**Project Number**  
 11-170  
**Drawing Number**  
 A100a

**Floor Plan Key**

	PROJECT AREA
	PARTITION TO BE PROVIDED - PROVIDE P1 UNLESS INDICATED OTHERWISE
	EXISTING PARTITION TO REMAIN
	DOOR - KEYED TO DOOR SCHEDULE
	EXISTING DOOR TO REMAIN

**NOTES:**  
 1. ALL PARTITIONS "P1" UNLESS NOTED OTHERWISE  
 2. SEE ENLARGED PLANS FOR ADDITIONAL INFORMATION  
 3. ALL NO-CRIMP FENCES ARE TO BE GROUNDED AND BONDED

**Courtyard Material Key**

1	EXTERIOR RESILIENT SURFACING - COLOR 1
2	EXTERIOR RESILIENT SURFACING - COLOR 2
3	EXTERIOR RESILIENT SURFACING - COLOR 3
4	SYNTHETIC TURF
5	CONCRETE BENCHES ADJACENT MATERIAL TO RUN UNDERNEATH BASIS OF DESIGN: RESILION OUTDOORS AURORA, ILL. CONCRETE GARDEN BENCH MODEL S860

**Markerboard / Tackboard Key**

KEY	DESCRIPTION	SIZE
TB1	TACKBOARD (ENCLOSED)	36 x 48
TR2	TACKBOARD	24 x 36
MB1	MARKERBOARD	24 x 36
MB2	MARKERBOARD	48 x 72
MB3	MARKERBOARD	36 x 48
TBAMB	TACKBOARD/MARKERBOARD	48 x 96

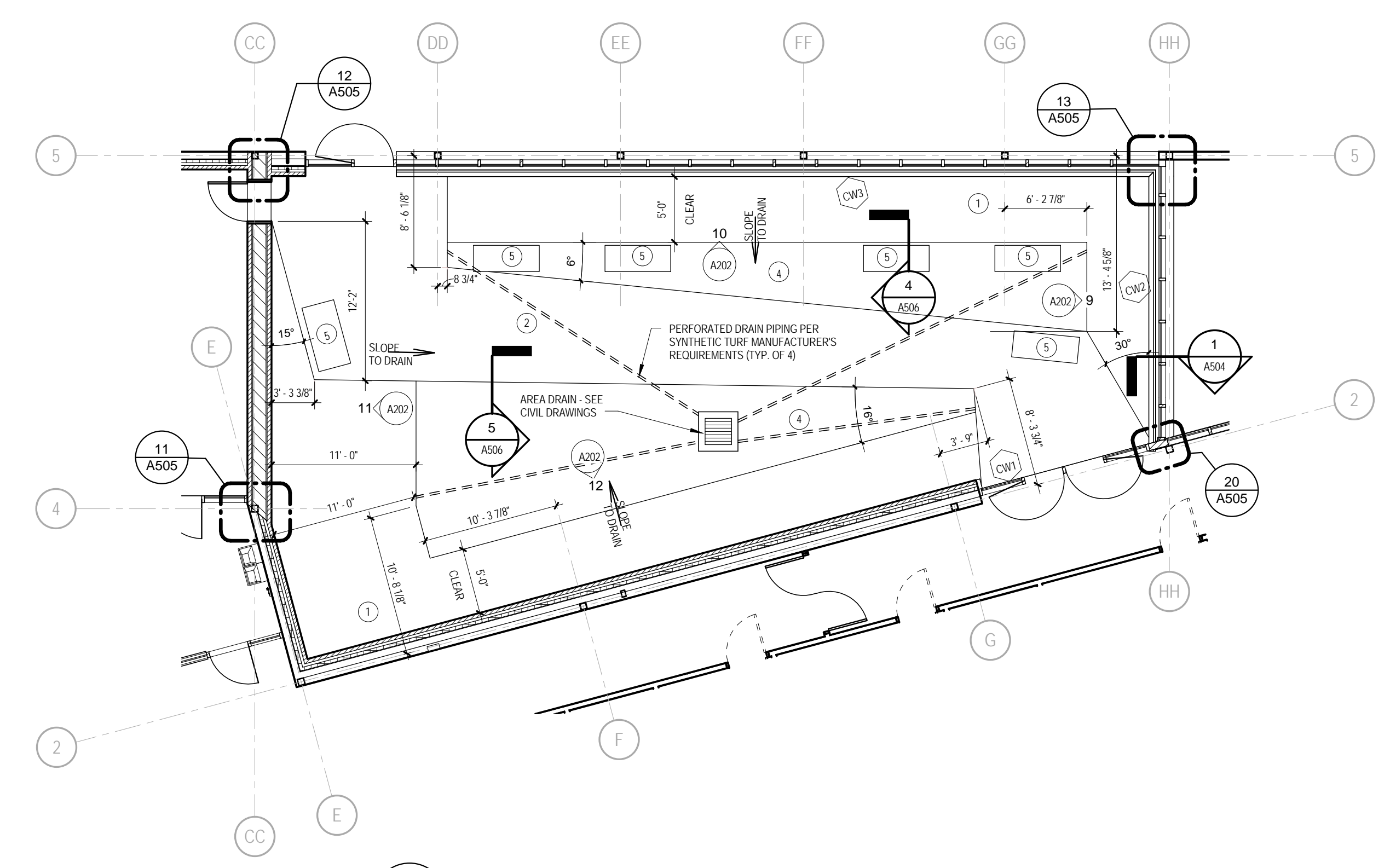

**2**  
 A100a Floor Plan - Level 1 - Courtyard 1139  
 1/8" = 1'-0"

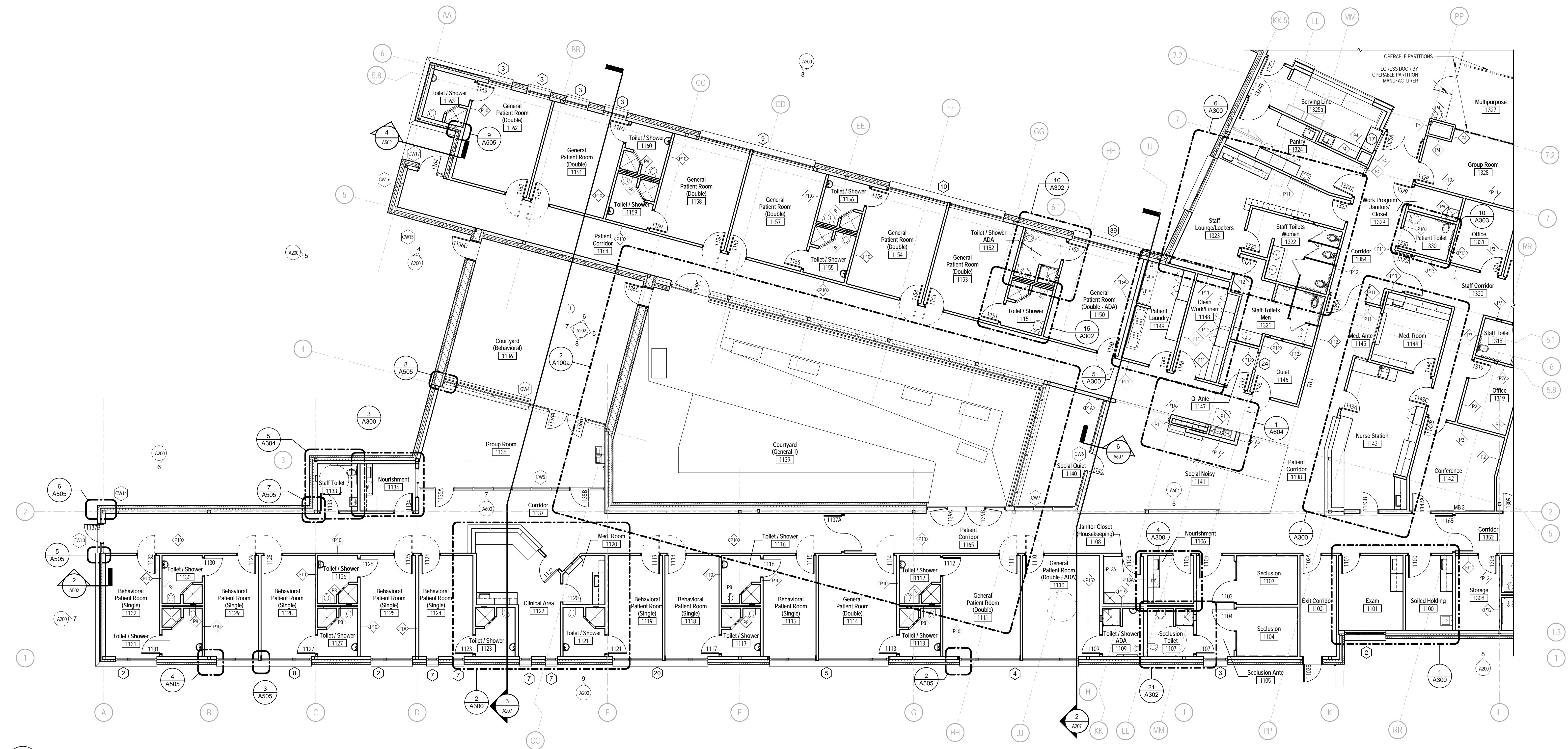

**1**  
 A100a Floor Plan - Level 1 - Nursing Unit 1  
 1/8" = 1'-0"