

FAIRMONT-ADAMS  
BANK INVESTORS, LLC  
TAX MAP 1-01 PARCEL 100

①

**STATE OFFICE BUILDING**  
**TAX MAP 1-01**  
**PARCELS 96, 97, 98, 99, & 106**

⑤

HALLWOOD  
LIMITED LIABILITY COMPANY  
TAX MAP 1-01 PARCEL 94

①

HALLWOOD  
LIMITED LIABILITY COMPANY  
TAX MAP 1-01 PARCEL 95

①

**NOTES**

- ① PROTECT ADJOINING PROPERTY OWNERS BUILDING (HUNTINGTON BANK - PARCEL 100) & GROUNDS FROM DAMAGES. CLEAN AND REPAIR ANY DAMAGES TO ADJOINER AT NO COST TO ADJOINER.
- ② UTILITY LOCATIONS ARE APPROXIMATE. CONTACT THE WV ONE CALL CENTER PRIOR TO DIGGING AT (800) 245-4848. ALSO CONTACT ANY LOCAL UTILITY PROVIDERS NOT SUBSCRIBING TO THE ONE CALL SYSTEM. DO NOT BEGIN DEMOLITION WITHOUT FIRST KNOWING THE UTILITIES ARE DISCONNECTED. OVERHEAD UTILITIES TO BE DISCONNECTED AT NEAREST OFF-SITE POLE. SECURELY PLUG OR CAP NATURAL GAS, WATER, & SEWER WITHIN 5 FEET OUTSIDE OF FOOTPRINT OF BUILDING
- ③ PROTECT ALL CITY/STATE ACCESS AND RIGHT-OF-WAYS DURING DEMOLITION. MAINTAIN NORMAL TRAFFIC EITHER VEHICULAR OR PEDESTRIAN DURING WORK PERIODS. PROVIDE TEMPORARY SHELTERING OR DIVERSION AS NECESSARY.
- ④ BASEMENT AREAS BENEATH SIDEWALK AND ALLEY WILL BE FILLED WITH 67 STONE WITH ALL VOIDS BELOW THE ALLEY/SIDEWALK FILLED.
- ⑤ REMOVE FOUNDATIONS/INTERIOR BASEMENT WALLS TO A MINIMUM OF 24 INCHES BELOW SURFACE GRADE, COBBLE ALL BASEMENT FLOOR SLABS INTO PIECES NO LARGER THAN 2 FOOT SQUARE. COMPLETELY FILL BELOW GRADE AREAS WITH CLEAN BROKEN CONCRETE AND OR MASONRY MATERIALS PLACED IN MAXIMUM 24 INCH THICK COMPACTED LIFTS. EACH LAYER TO BE CHOKED WITH 67 STONE. FINAL SURFACE WILL BE 8 INCH THICK 2 INCH CRUSHER RUN STONE COMPACTED AND GRADED TO INSURE POSITIVE DRAINAGE FOR SITE.

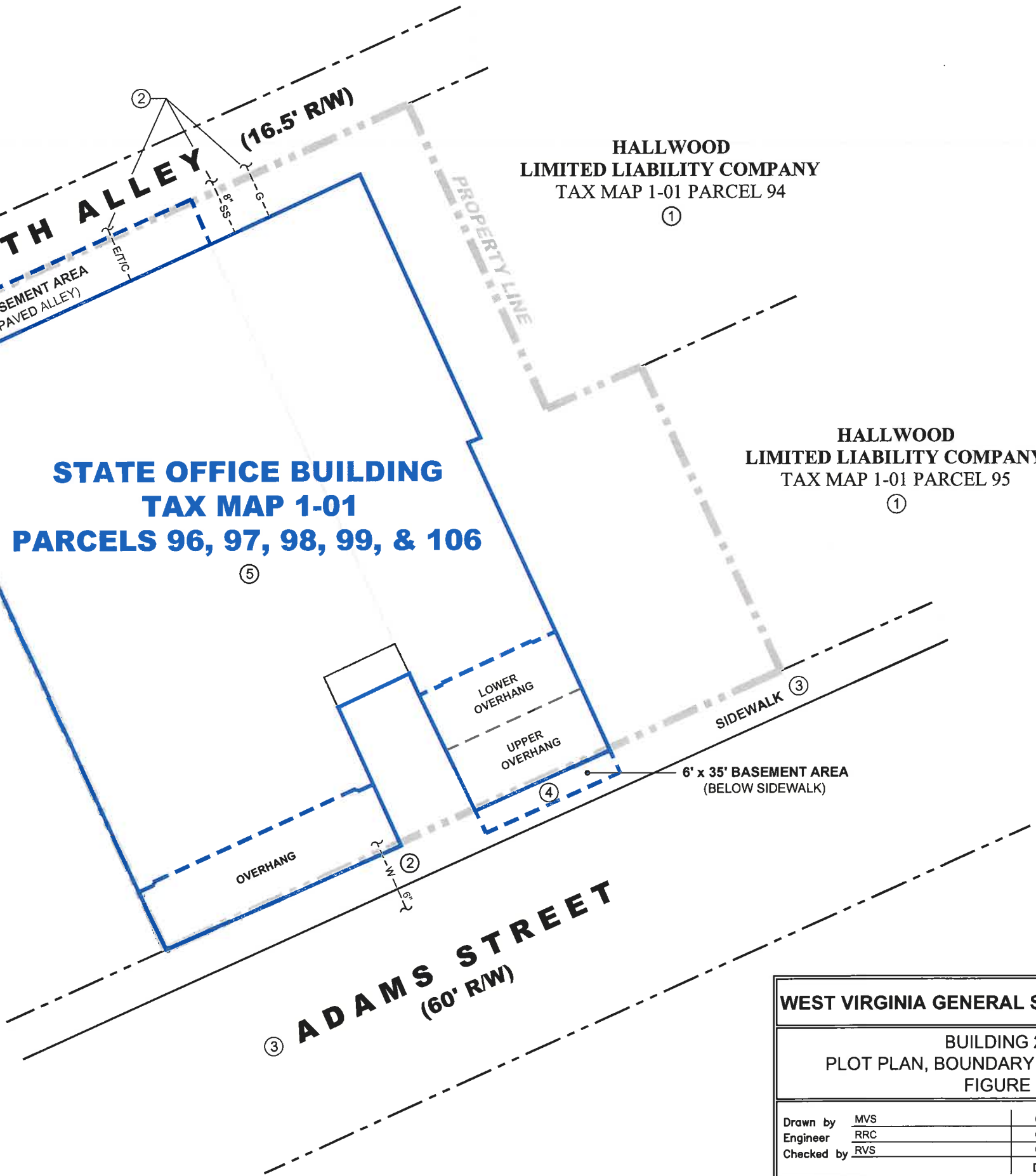

**WEST VIRGINIA GENERAL SERVICES DIVISION**

**BUILDING 21**  
**PLOT PLAN, BOUNDARY, & DEMOLITION**  
**FIGURE**

Drawn by	MVS	6/11
Engineer	RRC	6/11
Checked by	RVS	6/11
		Date

Scale: AS SHOWN

Dwg. No.

1 OF 1

Prepared by **MSES consultants, inc.**