

**FIRST FLOOR PLAN**  
SCALE: 1/8" = 1'-0"

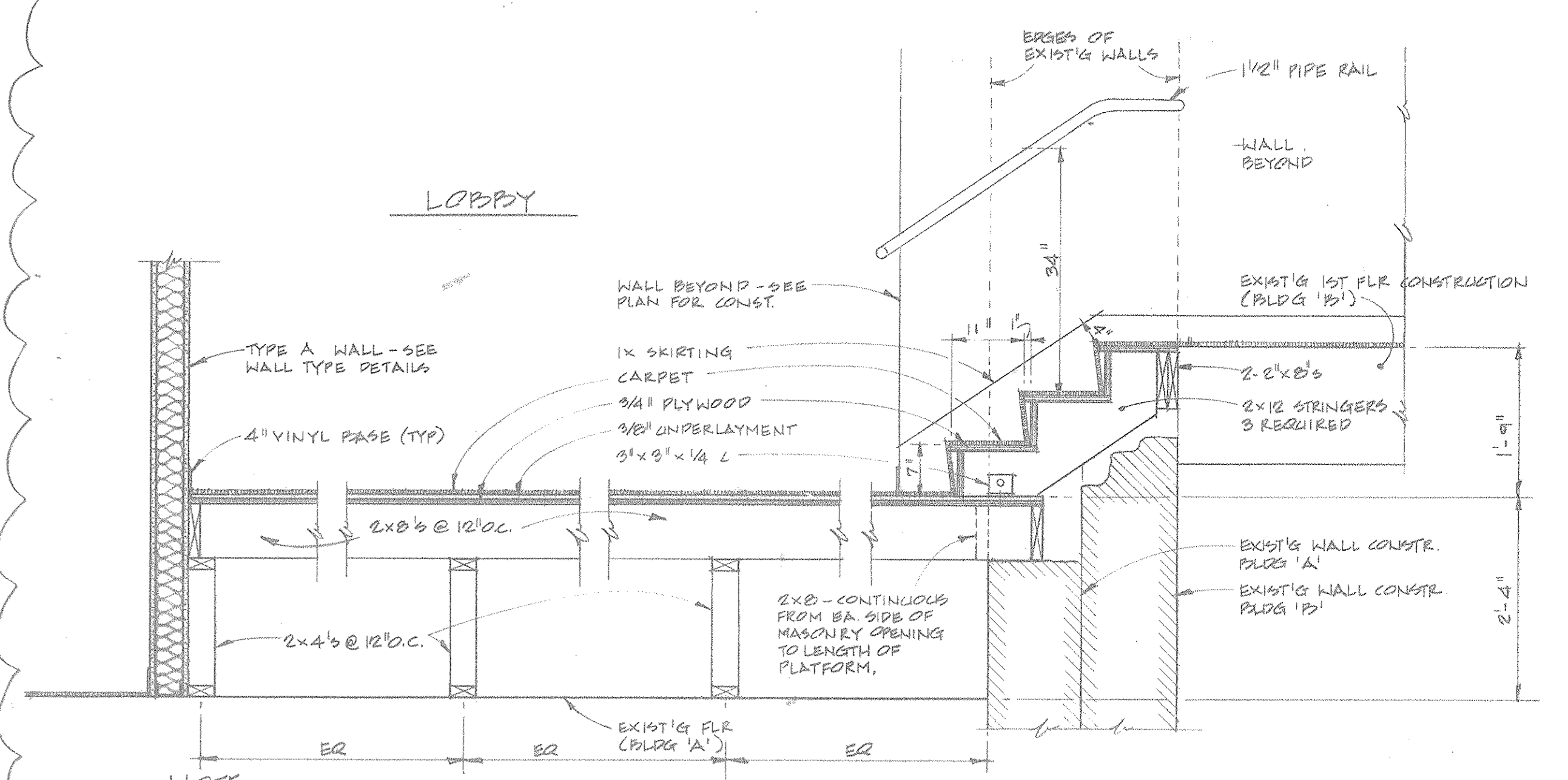

**NOTE**  
ALL LID USED FOR CONST. OF PLATFORM,  
STAIRS, ETC. WILL BE FIRE RETARDANT.

**LOBBY FLOOR DETAIL**  
SCALE: 3/4" = 1'-0"

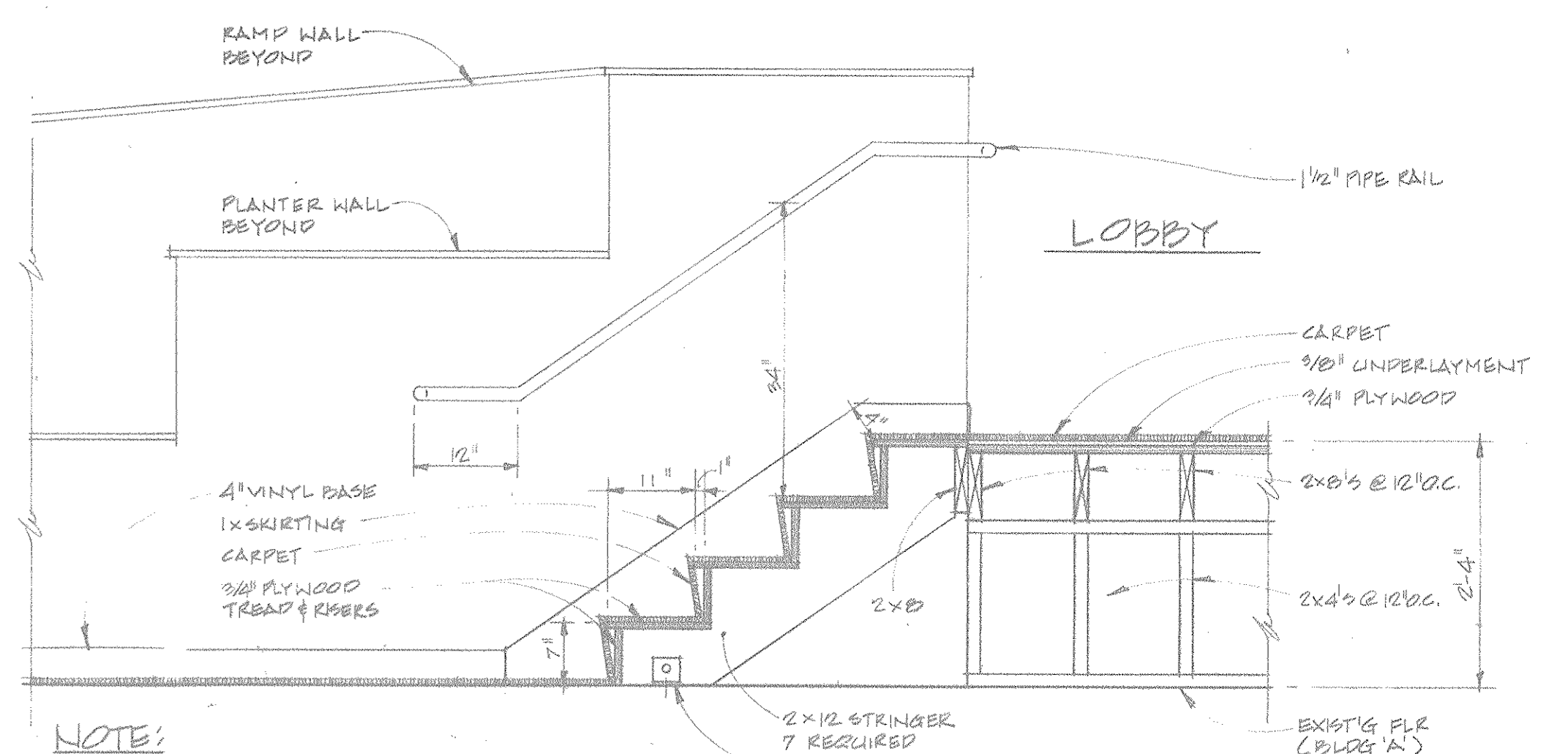

**NOTE**  
ALL LID USED FOR CONST. OF STAIRS,  
PLATFORM, ETC. WILL BE FIRE RETARDANT.

**LOBBY STAIR DETAIL**  
SCALE: 3/4" = 1'-0"

**GENERAL CONSTRUCTION NOTES**

1. CONTRACTOR WILL FIELD VERIFY ALL DIMENSIONS AND IMMEDIATELY NOTIFY ARCHITECT OF ANY DISCREPANCIES PRIOR TO CONTINUING CONSTRUCTION.
2. ALL LUMBER USED WILL BE PRESSURE TREATED-FIRE RETARDANT.
3. ANY STRUCTURAL STEEL EXPOSED BY SMALL OPENINGS DURING CONSTRUCTION WILL BE RE-FIREPROOFED BY PATCHING PLASTER TO MATCH EXISTING. LARGER OPENINGS OR WHERE STEEL STRUCTURE IS COMPLETELY EXPOSED, STRUCTURE WILL BE PROTECTED WITH TWO (2) LAYERS OF 5/8" DRYWALL (FIRE RATED).
4. ALL DIMENSIONS TAKEN TO EXISTING WALLS ARE DIMENSIONS PRIOR TO APPLYING ANY NEW FINISHES TO THE EXISTING WALLS.
5. EXISTING WALLS - ALL EXISTING PLASTER WALLS THAT ARE EXPOSED WILL BE FINISHED. PLASTER, GYPSUM SHEARS, OR OTHER PROJECTION FROM WALLS WILL HAVE 5/8" DRYWALL SCREENED AND GIRD DIRECTLY TO EXISTING SMOOTH SURFACE. OTHERWISE, THE EXISTING SURFACE WILL BE FURRED OUT AND THE DRYWALL APPLIED. ALL EXISTING WALLS SHOWN ON DRAWINGS TO BE FURRED WILL BE FURRED LEVEL BEFORE DRYWALL IS APPLIED.
6. UNLESS OTHERWISE INDICATED, ALL STUD WALLS WILL USE 5/8" DRYWALL AND STUDS WILL BE @ 16" O.C.
7. COORDINATE ARCHITECTURAL DRAWINGS WITH MECHANICAL AND ELECTRICAL DRAWINGS FOR ANY WALL PENETRATION.

**NOTES**

1. WORK ON THIS FLOOR TO INCLUDE...
2. TOLERANCE # 103 & #104 VERTICAL WALLS & VERTICAL OPENINGS...
3. SEE GENERAL NOTES SHEET A-17

**FOR PURPOSES OF CONTRACTOR EVALUATION. CONDITIONS DEPICTED IN DRAWING HAVE NOT BEEN VERIFIED.**

FIRST FLOOR PLAN