



State of West Virginia  
 Department of Administration  
 Purchasing Division  
 2019 Washington Street East  
 Post Office Box 50130  
 Charleston, WV 25305-0130

# Request for Quotation

RFQ NUMBER  
 DEP15737

PAGE  
 1

ADDRESS CORRESPONDENCE TO ATTENTION OF:  
 GUY NISBET  
 304-558-8802

RFQ COPY  
 TYPE NAME/ADDRESS HERE

VENDOR

SHIP TO

ENVIRONMENTAL PROTECTION  
 DEPT. OF  
 OFFICE OF SPECIAL RECLAMATION  
 601 57TH STREET SE  
 CHARLESTON, WV  
 25304 304-926-0499

DATE PRINTED	TERMS OF SALE	SHIP VIA	F.O.B.	FREIGHT TERMS
04/04/2012				

BID OPENING DATE: 04/17/2012 BID OPENING TIME 01:30PM

LINE	QUANTITY	UOP	CAT. NO.	ITEM NUMBER	UNIT PRICE	AMOUNT
				ADDENDUM NO.1		
				ADDENDUM ISSUED TO DISTRIBUTE THE FOLLOWING INFORMATION FROM PRE-BID MEETING HELD:3/20/2012.		
				1. Q & A'S FROM PRE-BID MEETING		
				2. BID SCHEDULE (REVISED)		
				3. BID TECHNICAL SPECIFICATIONS (REVISED)		
				BID OPENING DATE CHANGED FROM: 04/10/2012		
				TO: 04/17/2012		
				NO OTHER CHANGES.		
				END OF ADDENDUM NO.1		
0001	1	JB		962-73		
				RECLAMATION: RESTORATION OF WATER AND LAND		
				***** THIS IS THE END OF RFQ DEP15737 ***** TOTAL:		

SEE REVERSE SIDE FOR TERMS AND CONDITIONS

SIGNATURE	TELEPHONE	DATE
TITLE	FEIN	ADDRESS CHANGES TO BE NOTED ABOVE

WHEN RESPONDING TO RFQ, INSERT NAME AND ADDRESS IN SPACE ABOVE LABELED 'VENDOR'

**GENERAL TERMS & CONDITIONS**  
**REQUEST FOR QUOTATION (RFQ) AND REQUEST FOR PROPOSAL (RFP)**

1. Awards will be made in the best interest of the State of West Virginia.
  2. The State may accept or reject in part, or in whole, any bid.
  3. Prior to any award, the apparent successful vendor must be properly registered with the Purchasing Division and have paid the required \$125 fee.
  4. All services performed or goods delivered under State Purchase Order/Contracts are to be continued for the term of the Purchase Order/Contracts, contingent upon funds being appropriated by the Legislature or otherwise being made available. In the event funds are not appropriated or otherwise available for these services or goods this Purchase Order/Contract becomes void and of no effect after June 30.
  5. Payment may only be made after the delivery and acceptance of goods or services.
  6. Interest may be paid for late payment in accordance with the *West Virginia Code*.
  7. Vendor preference will be granted upon written request in accordance with the *West Virginia Code*.
  8. The State of West Virginia is exempt from federal and state taxes and will not pay or reimburse such taxes.
  9. The Director of Purchasing may cancel any Purchase Order/Contract upon 30 days written notice to the seller.
  10. The laws of the State of West Virginia and the *Legislative Rules* of the Purchasing Division shall govern the purchasing process.
  11. Any reference to automatic renewal is hereby deleted. The Contract may be renewed only upon mutual written agreement of the parties.
  12. **BANKRUPTCY:** In the event the vendor/contractor files for bankruptcy protection, the State may deem this contract null and void, and terminate such contract without further order.
  13. **HIPAA BUSINESS ASSOCIATE ADDENDUM:** The West Virginia State Government HIPAA Business Associate Addendum (BAA), approved by the Attorney General, is available online at [www.state.wv.us/admin/purchase/vrc/hipaa.html](http://www.state.wv.us/admin/purchase/vrc/hipaa.html) and is hereby made part of the agreement provided that the Agency meets the definition of a Cover Entity (45 CFR §160.103) and will be disclosing Protected Health Information (45 CFR §160.103) to the vendor.
  14. **CONFIDENTIALITY:** The vendor agrees that he or she will not disclose to anyone, directly or indirectly, any such personally identifiable information or other confidential information gained from the agency, unless the individual who is the subject of the information consents to the disclosure in writing or the disclosure is made pursuant to the agency's policies, procedures, and rules. Vendor further agrees to comply with the Confidentiality Policies and Information Security Accountability Requirements, set forth in <http://www.state.wv.us/admin/purchase/privacy/noticeConfidentiality.pdf>.
  15. **LICENSING:** Vendors must be licensed and in good standing in accordance with any and all state and local laws and requirements by any state or local agency of West Virginia, including, but not limited to, the West Virginia Secretary of State's Office, the West Virginia Tax Department, and the West Virginia Insurance Commission. The vendor must provide all necessary releases to obtain information to enable the director or spending unit to verify that the vendor is licensed and in good standing with the above entities.
  16. **ANTITRUST:** In submitting a bid to any agency for the State of West Virginia, the bidder offers and agrees that if the bid is accepted the bidder will convey, sell, assign or transfer to the State of West Virginia all rights, title and interest in and to all causes of action it may now or hereafter acquire under the antitrust laws of the United States and the State of West Virginia for price fixing and/or unreasonable restraints of trade relating to the particular commodities or services purchased or acquired by the State of West Virginia. Such assignment shall be made and become effective at the time the purchasing agency tenders the initial payment to the bidder.
- I certify that this bid is made without prior understanding, agreement, or connection with any corporation, firm, limited liability company, partnership, or person or entity submitting a bid for the same material, supplies, equipment or services and is in all respects fair and without collusion or fraud. I further certify that I am authorized to sign the certification on behalf of the bidder or this bid.

**INSTRUCTIONS TO BIDDERS**

1. Use the quotation forms provided by the Purchasing Division. Complete all sections of the quotation form.
2. Items offered must be in compliance with the specifications. Any deviation from the specifications must be clearly indicated by the bidder. Alternates offered by the bidder as **EQUAL** to the specifications must be clearly defined. A bidder offering an alternate should attach complete specifications and literature to the bid. The Purchasing Division may waive minor deviations to specifications.
3. Unit prices shall prevail in case of discrepancy. All quotations are considered F.O.B. destination unless alternate shipping terms are clearly identified in the quotation.
4. All quotations must be delivered by the bidder to the office listed below prior to the date and time of the bid opening. Failure of the bidder to deliver the quotations on time will result in bid disqualifications: Department of Administration, Purchasing Division, 2019 Washington Street East, P.O. Box 50130, Charleston, WV 25305-0130
5. Communication during the solicitation, bid, evaluation or award periods, except through the Purchasing Division, is strictly prohibited (W.Va. C.S.R. §148-1-6.6).

**Addendum #1 - Questions During Pre-Bid Conference  
For DEP15737  
Landmark Corporation  
Permit # S-34-82**

---

The following questions were identified at the Pre-Bid Conference (PBC). The answers and clarifications provided herein take precedence over verbal answers at the PBC should there be any conflicts between the two.

- 1.) The following questions are verbatim from the pre-bid conference concerning the construction requirements for Channel #2:

Q. You have lining Channel #2 with rip-rap. Is that your intention? Page 75 says you'll make up any difference in limestone rip-rip.

Q. Are you going to make up the difference because it says two different things and that's a big number? It says in one place you're going to choke it down with (1) inch to 3 inch stuff and the other place says you're going to make up any difference anywhere in that ditch with 18" rip-rap, and that size ditch...And it also says you go to the original size. That's what page 75 says and that's a big number. If you want to put limestone rip-rap in there, I need to know that.

Q. But you are going to replace, I mean there are some places that there's no rip-rap at all, if you look at it visible and there's places that are 30 feet wide.

Question summary: There was confusion in the specification as to whether Channel #2 is to be lined with rip-rap or 1-½ inch crusher run material. Also, it was not clear which areas of the channel are being required to be lined with rip-rap and with crusher run. Since the entire Channel #2 did not have existing rip-rap, this confusion prevented any estimation of quantities for either lining. The following clarification to this item is provided.

**CLARIFICATION:** The total length of the existing fresh water diversion ditch earmarked for work under this project, designated as Channel #2, is 1,250 LF. Of this length, the lower 375 LF has existing sandstone rip-rap. The upper 875 LF is shaped into the fill material with no existing rip-rap or other liner (except for natural vegetation) in place. Per the revised specification, the entire channel, as delineated on the plan, shall be cleared of all obstructions (such as trees, pipes, boulders, washed in sediments, etc.) and be free-flowing. All obstructions shall be removed such that the final cross-sectional shape of the cleaned section conforms to the cross-sections of the channel immediately upstream and downstream of the cleaned section. The entire channel length of 1,250 LF shall then be lined with 3-inches of 1-1/2" limestone crusher run for the full channel cross-section. No new rip-rap placement work will be required except where the existing rip-rap is displaced or damaged by the cleaning activities. Such rip-rap repair work will be incidental to this bid item. Revised specifications for Item 12.2 are attached, deleting all reference to new rip-rap placement work (except for rip-rap repair work associated with and due to Channel #2 cleaning).

Drawings #3 and #4 (pp. 23 and 24) are revised to show the lining of the lower 375 LF of Channel #2 as existing rip-rap.

Drawing #5 (pg. 35) is revised to list the proposed proper lining for Channel #2.

**Addendum #1 - Questions During Pre-Bid Conference  
For DEP15737  
Landmark Corporation  
Permit # S-34-82**

---

- 2.) Q. Are there sizes given in the plans for the alkalinity cells?  
A. Yes, the plans have specific dimensions on the length, width and depth (see drawings #17 and #18, pages 37 and 38).
- 3.) Q. Are sediment ditches E, F and G to be cleaned out and liners installed?  
A. Yes. All three will need to be cleaned and lined.
- 4.) Q. Are there any measurements for sediment ditches E and F?  
A. There's a length in lineal feet listed in the bid items. There's not a width given, and they'll only be lined on the bottom and one side. The side against the hill will not be lined, there's where all of the seepage is coming in.

**CLARIFICATION:** Sediment Ditches E and F are estimated at 420 LF and 350 LF, respectively. The final sediment ditch width will be the same as that which currently exists. The ditches will be cleaned and lined to their current width with liner covering the entire bottom and lower side as shown on the typical section (Drawing #20). It will be the responsibility of the bidder to determine the exact amount of materials required to complete the work under this bid item.

Drawing #20 (Page 40) of typical Section C-C is revised to describe the bottom width for the ditches as ranging from 20' to 35' wide.

- 5.) Q. Will the area including the 4-wheeler road and sediment ditch D be re-graded?  
A. Yes, and during regrading, the water currently in Sediment Ditch D may be discharged down through Sediment Ditch E. The discharge pipe in Sediment Ditch D will also need to be removed and disposed.
- 6.) Q. Is V-ditch #7 a grass lined ditch?  
A. No, it's limestone rip-rap (see page 71).
- 7.) Q. Is V-ditch #7 to be lined, beginning from the dike between sediment ditches D and E?  
A. Yes, for the full distance, beginning at the upper end of Sediment Ditch E.
- 8.) Q. What is to be done with sediments cleaned out of the cells?  
A. We'll designate a stockpile area. That's something we'll have to look at.

**Addendum #1 - Questions During Pre-Bid Conference  
For DEP15737  
Landmark Corporation  
Permit # S-34-82**

---

**CLARIFICATION:** A pond cleanings storage area is now provided for temporary disposal and drying of all materials excavated from sediment ditches, ponds and any other excessively wet soil materials. Note that a berm is also constructed around the area. After drying, the material will be spread to conform to the surrounding terrain and revegetated. The revegetation item #23 has been increased to 22.0 acres to account for this additional area.

9.) **ITEM CHANGE** – Bid Item 12.3 – Construct Grouted Limestone Rip-Rap Channel #3.

Due to adjacent construction activities by Alpha Natural Resources along the northern side of the main access road, Channel #3 has been relocated to the opposite side of the road. The discharge of Channel #3 will now be into the lower end of Channel #2, just upstream of the existing concrete wing wall. The proposed length of Channel #3 is unchanged at 680 LF.

Drawings #3 and #5 (pp. 23 and 25) are revised to show the new location of Channel #3. Drawing #15 (pg. 35) is revised to add a drive-thru for Channel #3 across the main access road.

BUYER GN-23	PAGE	REQ. OR PO NO. DEP15737
SPENDING UNIT WEST VIRGINIA DEPARTMENT OF ENVIRONMENTAL PROTECTION/SPECIAL RECLAMATION		

WV-36a STATE OF WEST VIRGINIA  
REV. 5-26-09 PURCHASING CONTINUATION SHEET  
VENDOR:

ITEM NO.	QUANTITY	DESCRIPTION	UNIT PRICE	AMOUNT
<b>BID SCHEDULE - REVISED</b>				
<b>PERMIT NAME: <u>Landmark Corp.</u></b>				
<b>PERMIT NUMBER(S): <u>S-34-82</u></b>				
<b>The DEP reserves the right to request additional information and supporting documentation regarding unit prices when the unit price appears to be unreasonable.</b>				
1.0	LUMP SUM	<b><u>MOBILIZATION/DEMobilIZATION/PROJECT SIGN</u></b> (5% Total Bid Maximum for this permit)	LUMP SUM	\$ _____
2.0	LUMP SUM	<b><u>SPILL CONTAINMENT AREA (S.C.A.)</u></b> (\$1,000.00 Maximum Bid for this permit)	LUMP SUM	\$ _____
3.0	LUMP SUM	<b><u>MAIN ACCESS ROAD</u></b> (5% Total Bid Maximum for this permit)	LUMP SUM	\$ _____
4.0	<u>100</u> LF	<b><u>MAIN ACCESS ROAD FENCING</u></b>	\$ _____ PER LF	\$ _____
4.1	<u>1</u> EA	<b><u>MAIN ACCESS ROAD GATE AND GUARDRAIL</u></b>	\$ _____ PER EA	\$ _____
5.0	<u>3,500</u> LF	<b><u>STORMWATER MANAGEMENT</u></b> (Max. bid of \$5.00/LF of silt fence/hay bale material used on site)	\$ _____ PER LF	\$ _____
6.0	NO BID ITEM	<b><u>UTILITIES</u></b>	NO BID ITEM	
7.0	<u>200</u> LF	<b><u>ELIMINATE SEDIMENT DITCH 'A'</u></b>	\$ _____ PER LF	\$ _____
8.0	<u>1</u> EA	<b><u>POND #1 CLEANING &amp; CULVERT INSTALLATION</u></b>	\$ _____ PER EA	\$ _____
9.0	<u>1200</u> LF	<b><u>INSTALL SANDSTONE UNDERDRAIN, ELIMINATE SEDIMENT DITCH 'B'</u></b>	\$ _____ PER LF	\$ _____
10.0	<u>1100</u> LF	<b><u>ELIMINATE EXISTING BENCH</u></b>	\$ _____ PER LF	\$ _____
11.0		<b><u>DITCHES (GROUTED LIMESTONE RIP-RAP)</u></b>		
11.1	<u>400</u> LF	<b><u>CONSTRUCT V-DITCH #1</u></b>	\$ _____ PER LF	\$ _____
11.2	<u>500</u> LF	<b><u>CONSTRUCT V-DITCH #2</u></b>	\$ _____ PER LF	\$ _____

BUYER GN-23	PAGE	REQ. OR PO NO. DEP15737
SPENDING UNIT WEST VIRGINIA DEPARTMENT OF ENVIRONMENTAL PROTECTION/SPECIAL RECLAMATION		

WV-36a STATE OF WEST VIRGINIA  
REV. 5-26-09 PURCHASING CONTINUATION SHEET  
VENDOR:

ITEM NO.	QUANTITY	DESCRIPTION	UNIT PRICE	AMOUNT
11.3	<u>100</u> LF	<u>CONSTRUCT V-DITCH #3</u>	\$ _____ PER LF	\$ _____
11.4	<u>320</u> LF	<u>CONSTRUCT V-DITCH #4</u>	\$ _____ PER LF	\$ _____
11.5	<u>260</u> LF	<u>CONSTRUCT V-DITCH #5</u>	\$ _____ PER LF	\$ _____
11.6	<u>200</u> LF	<u>CONSTRUCT TRAPEZOIDAL DITCH #6</u>	\$ _____ PER LF	\$ _____
11.7	<u>800</u> LF	<u>CONSTRUCT V-DITCH #7</u>	\$ _____ PER LF	\$ _____
11.8	<u>420</u> LF	<u>CONSTRUCT V-DITCH #8</u>	\$ _____ PER LF	\$ _____
12.0		<u>CHANNELS</u>		
12.1	<u>400</u> LF	<u>CONSTRUCT GROUTED LIMESTONE RIP-RAP CHANNEL #1</u>	\$ _____ PER LF	\$ _____
12.2	<u>1250</u> LF	<u>CLEAN AND LINE EXISTING CHANNEL #2 WITH LIMESTONE</u>	\$ _____ PER LF	\$ _____
12.3	<u>680</u> LF	<u>CONSTRUCT GROUTED LIMESTONE RIP-RAP CHANNEL #3</u>	\$ _____ PER LF	\$ _____
13.0	<u>5</u> EA	<u>CONSTRUCT ALKALINITY CELLS #1, #2, #3, #4, #5</u>	\$ _____ PER EA	\$ _____
14.0	<u>1</u> EA	<u>POND #2 CONSTRUCTION</u>	\$ _____ PER EA	\$ _____
15.0	LUMP SUM	<u>BACK FILL AND REGRADE 'HILL CLIMB' AREA</u>	LUMP SUM	\$ _____
16.0	<u>950</u> LF	<u>ELIMINATE 'HILL-CLIMB' ACCESS ROAD</u>	\$ _____ PER LF	\$ _____
17.0	<u>200</u> LF	<u>INSTALL SANDSTONE UNDERDRAIN, ELIMINATE SEDIMENT DITCH 'C'</u>	\$ _____ PER LF	\$ _____
18.0	<u>1000</u> LF	<u>ELIMINATE BENCH ACCESS ROAD, EAST SIDE</u>	\$ _____ PER LF	\$ _____

BUYER GN-23	PAGE	REQ. OR PO NO. DEP15737
SPENDING UNIT WEST VIRGINIA DEPARTMENT OF ENVIRONMENTAL PROTECTION/SPECIAL RECLAMATION		

WV-36a STATE OF WEST VIRGINIA  
REV. 5-26-09 PURCHASING CONTINUATION SHEET  
VENDOR: \_\_\_\_\_

19.0	<u>320</u> LF	<u>ELIMINATE SEDIMENT DITCH 'D'</u>	\$ _____	\$ _____
			PER LF	
20.0		<u>SEDIMENT DITCH RECONSTRUCTION</u>		
20.1	<u>420</u> LF	<u>CLEAN AND RE-LINE EXISTING SEDIMENT DITCH 'E' WITH CLAY &amp; LIMESTONE, RECONSTRUCT DIKE</u>	\$ _____	\$ _____
			PER LF	
20.2	<u>350</u> LF	<u>CLEAN AND RE-LINE EXISTING SEDIMENT DITCH 'F' WITH CLAY &amp; LIMESTONE, RECONSTRUCT DIKE</u>	\$ _____	\$ _____
			PER LF	
20.3	<u>1</u> EA	<u>CLEAN AND RE-LINE EXISTING SEDIMENT DITCH 'G' W/LINER, RECONSTRUCT DIKE, REPLACE CULVERT</u>	\$ _____	\$ _____
			PER EA	
21.0	<u>950</u> LF	<u>INTERNAL SITE FENCING</u>	\$ _____	\$ _____
			PER LF	
22.0	<u>850</u> LF	<u>CONSTRUCT NEW ACCESS ROAD</u>	\$ _____	\$ _____
			PER LF	
23.0		<u>REVEGETATION</u>		
23.1	<u>22.0</u> AC	<u>AGRICULTURAL LIME</u>	\$ _____	\$ _____
			PER AC	
23.2	<u>22.0</u> AC	<u>FERTILIZER</u>	\$ _____	\$ _____
			PER AC	
23.3	<u>22.0</u> AC	<u>MULCH</u>	\$ _____	\$ _____
			PER AC	
23.4	<u>22.0</u> AC	<u>VEGETATIVE SPECIES</u>	\$ _____	\$ _____
			PER AC	
24.0	LUMP SUM	<u>STRUCTURE AND DEBRIS REMOVAL</u>	LUMP SUM	\$ _____
25.0	<u>2500</u> TN	<u>INCIDENTAL STONE</u>	\$ _____	\$ _____
			PER TN	
		<u>TOTAL PERMIT</u>		\$ _____



BUYER GN-23	PAGE	REQ. OR PO NO. DEP15737
SPENDING UNIT WEST VIRGINIA DEPARTMENT OF ENVIRONMENTAL PROTECTION/SPECIAL RECLAMATION		

WV-36a STATE OF WEST VIRGINIA  
REV. 5-26-09 PURCHASING CONTINUATION SHEET  
VENDOR:

## **BID ITEM TECHNICAL SPECIFICATIONS – REVISED**

### **12.0 CHANNELS**

#### **12.2 CLEAN AND LINE EXISTING CHANNEL #2 WITH LIMESTONE**

The existing fresh water diversion channel was previously by others and partially rip-rapped at the lower 375 LF section. Work under this item includes cleaning the channel of all vegetative, sediment, backfill, culvert materials, etc. The channel shall then be restored to the existing originally constructed cross-section and be free-flowing. Damage to the existing rip-rap by channel cleaning activities shall be repaired at the contractor's expense.

All vegetative materials shall be disposed of separately by windrowing or burning as directed by the DEP on-site representative. All excavated soil materials shall be utilized as regrade material on finished hill-climb areas and pond cleaning disposal area. All removed pipe materials shall be disposed according to Item 24.0.

A final layer of three-inches (3") of one and one-half inch (1-1/2") limestone crusher run shall be added to the full length of the final channel surface to the top of the ditch, including the existing 375 LF riprap portion.

### **20.0 SEDIMENT DITCH RECONSTRUCTION**

#### **20.1 CLEAN AND RE-LINE EXISTING SEDIMENT DITCH 'E' WITH CLAY AND LIMESTONE, RECONSTRUCT DIKE**

#### **20.2 CLEAN AND RE-LINE EXISTING SEDIMENT DITCH 'F' WITH CLAY AND LIMESTONE, RECONSTRUCT DIKE**

Provide all materials, excavate and construct sediment ditches as indicated on the attached plans and cross-section, and as discussed at the Pre-Bid Showing. Length of ditch may be adjusted to meet on site conditions upon approval of the WVDEP agent onsite.

Sediment ditches will be graded to positively flow to V-Ditch #8. The completed ditches must be demonstrated to the onsite WVDEP representative to be capable of free draining and not leaking prior to invoicing and payment. The contractor shall provide all services, materials, construction layout, equipment, or other materials necessary to execute the work.

#### **EXCAVATION**

The existing sediment ditches will be cleaned throughout to a five (5) vertical feet depth below the discharge elevation of the spillway, or to existing depth, whichever is greater. All existing liners materials, sediments and vegetative materials including (but not limited to) cattails, trees, tree stumps and root balls will be removed by excavation. Rocks, boulders or other materials which protrude and interfere with liner and liner bedding installation will also be removed. Sidewalls of the finished ditches will be no steeper than 2H:1V. Sediment ditch cleanings shall be stockpiled, dried and disposed at the location shown on the plans. The existing embankment will not be disturbed. Damage or leakage to the embankment will be repaired at the

BUYER GN-23	PAGE	REQ. OR PO NO. DEP15737
SPENDING UNIT WEST VIRGINIA DEPARTMENT OF ENVIRONMENTAL PROTECTION/SPECIAL RECLAMATION		

WV-36a            STATE OF WEST VIRGINIA  
REV. 5-26-09    PURCHASING CONTINUATION SHEET  
VENDOR:

---

Contractor's expense.

#### LINING

A six-inch layer of fine sand will be placed throughout the pond bottom for the final liner bedding. A 60-mil textured HDPE liner will be installed per manufacturer's recommendations and keyed into all sides and inlet / discharge spillways. Sediment ditch bottom and sides will be lined with a six-inch (6") layer of 1-1/2" limestone crusher run topped with a final eighteen-inch (18") layer of 3"-6" limestone on bottom and sides, both layers constructed to the elevation of the discharge spillway.

Landmark Corporation  
Permit No. S-34-82

BUYER GN-23	PAGE	REQ. or P.O. No. DEP15737
SHEET 2 OF 5		

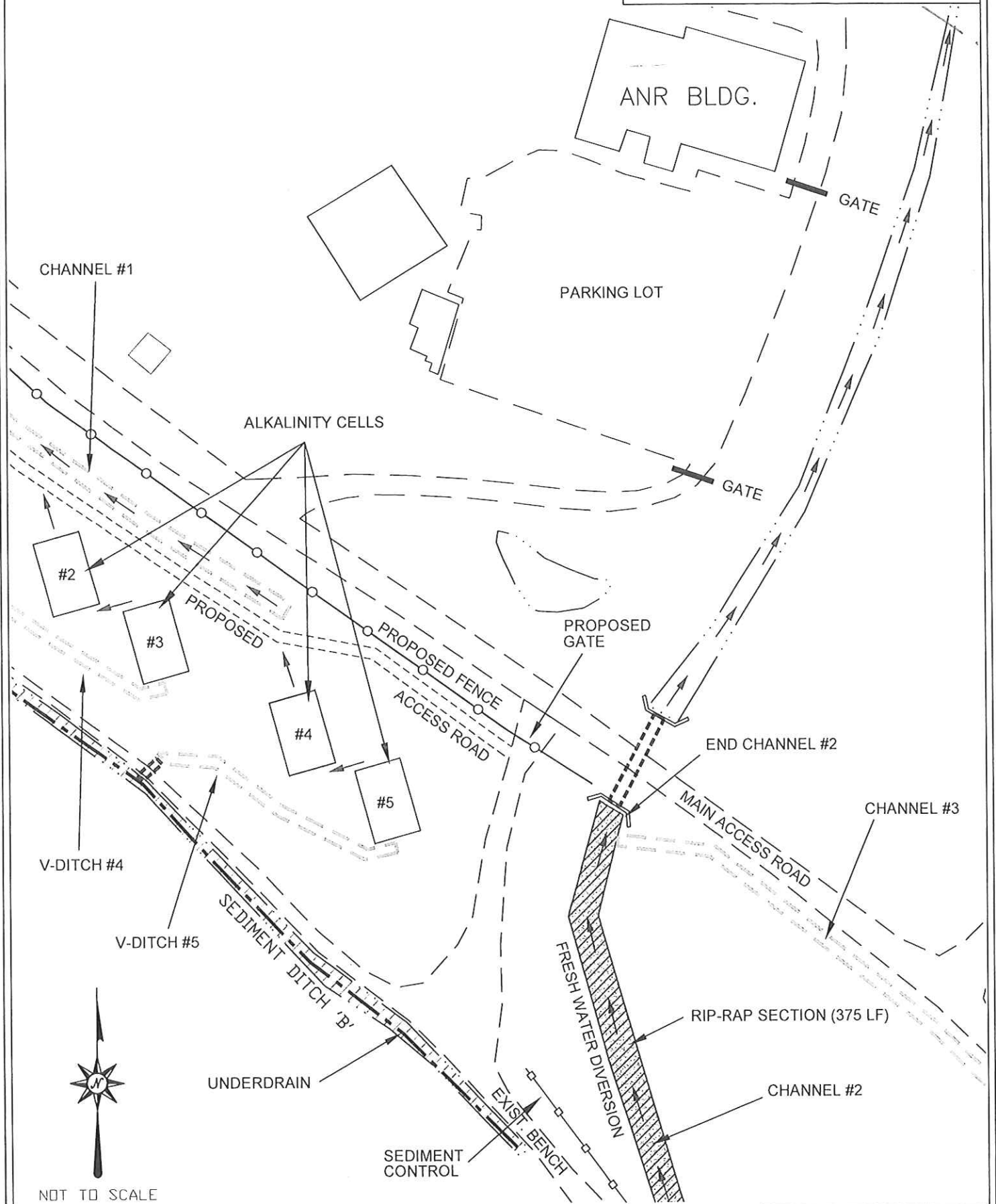

Landmark Corporation  
Permit No. S-34-82

BUYER GN-23	PAGE	REQ. or P.O. No. DEP15737
----------------	------	------------------------------

SHEET 3 OF 5

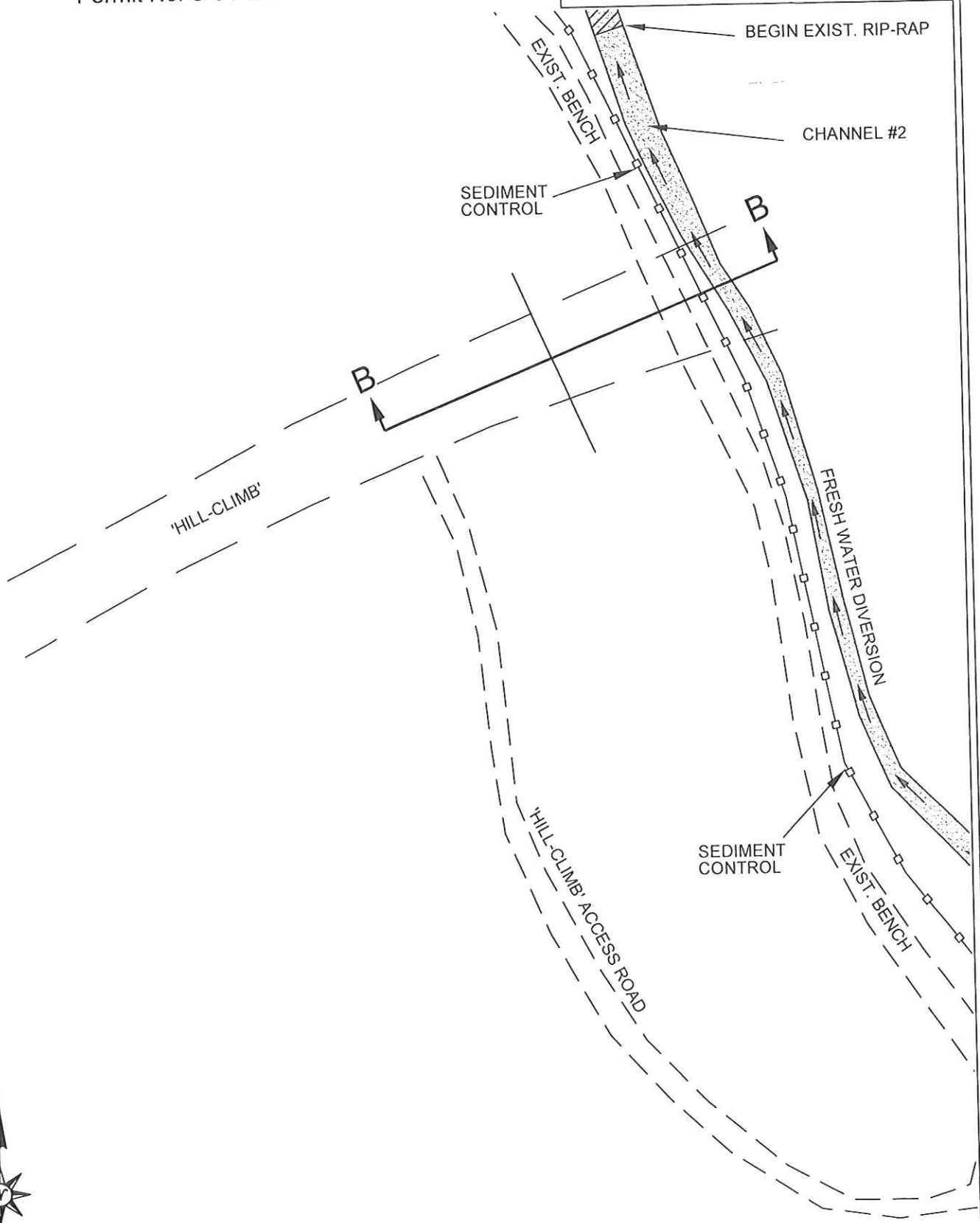

NOT TO SCALE

DRAWING NO.:	4
--------------	---

# Landmark Corporation

Permit No. S-34-82

BUYER GN-23	PAGE	REQ. or P.O. No. DEP15737
SHEET 4 OF 5		



NOT TO SCALE

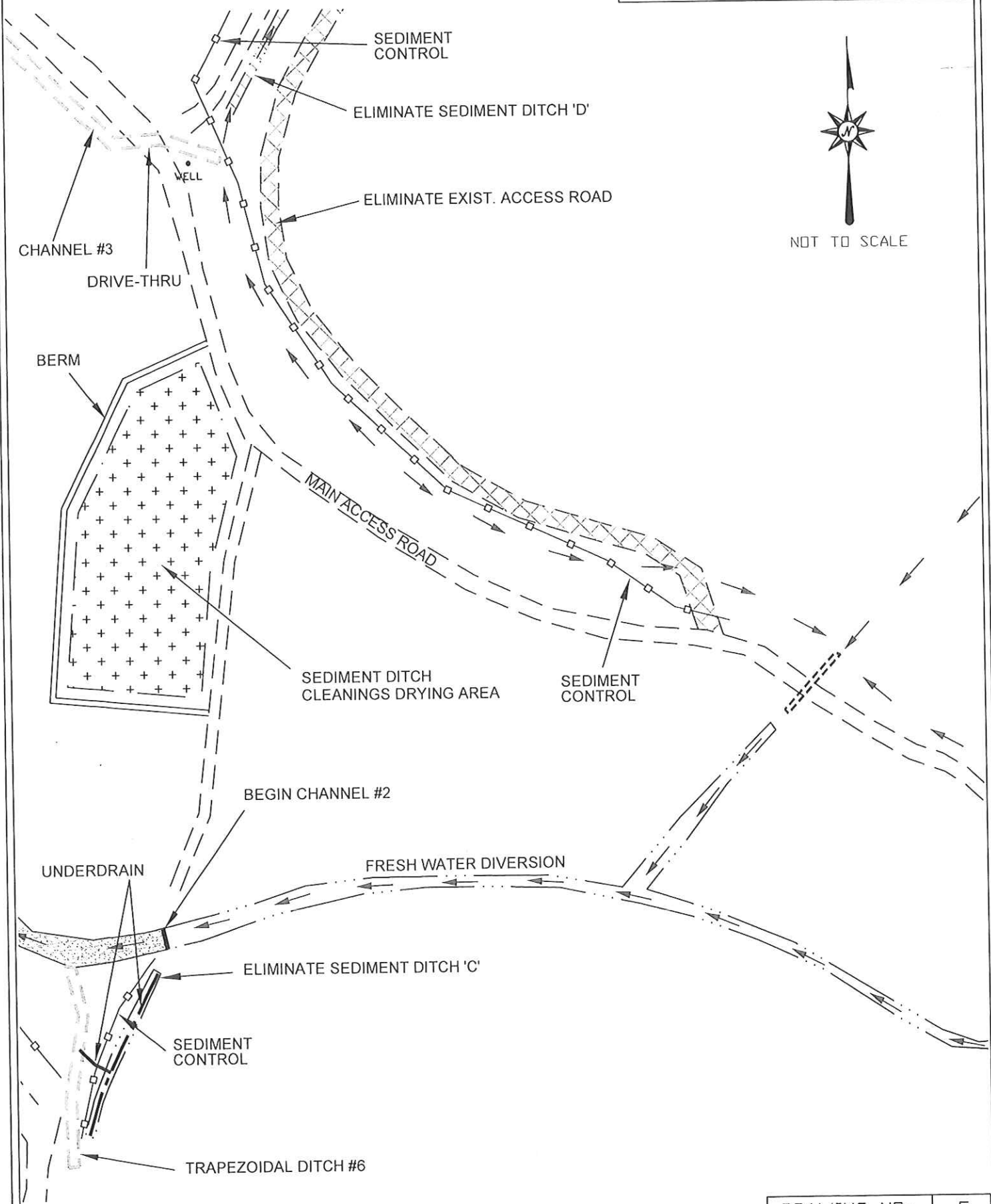

## Landmark Corporation

Permit No. S-34-82

BUYER  
GN-23

PAGE

REQ. or P.O. No.  
DEP15737

DIVERSION CHANNELS - DESIGN

DITCH / CHANNEL	TOP WIDTH -TW- (FT)	BOT. WIDTH -BW- (FT)	TOTAL DEPTH* -D- (FT)	SIDE SLOPE (H/V)	BOTTOM SLOPE (%)	LINING**	LINING THICKNESS -T- (FT)
DITCH #1	8.0	0	2.0	2/1	1.0	2	1.5
DITCH #2	8.0	0	2.0	2/1	10.0	2	1.5
DITCH #3	8.0	0	2.0	2/1	20.0	2	1.5
DITCH #4	8.0	0	2.0	2/1	10.0	2	1.5
DITCH #5	8.0	0	2.0	2/1	10.0	2	1.5
DITCH #6	14.0	4.0	2.5	2/1	10.0	2	1.5
DITCH #7	12.0	0	3.0	2/1	1.0	2	1.5
DITCH #8	8.0	0	2.0	2/1	1.0	2	1.5
CHANNEL #1	14.0	4.0	2.5	2/1	5.0	2	1.5
CHANNEL #2	EXIST. CHANNEL - CLEAN & LINE ONLY - DO NOT RESIZE					1	3.0
CHANNEL #3	10.0	0	2.5	2/1	2.0	2	1.5
CHANNEL #3 DRIVE-THRU	25.0	5	2.0	5/1	0.0	2	1.5

\* Includes 1.0 ft. freeboard (F)

## \*\* LINING

- 1-1/2" Limestone Crusher Run
- Limestone Rip-Rap, Grouted

## RIPRAP GRADATION CHART

D <sub>50</sub> MEDIAN STONE SIZE (IN.)	% OF MATERIAL SMALLER THAN TYPICAL STONE	TYPICAL STONE EQUIVALENT DIAMETER (IN.)	ALTERNATE SIZE DESIGNATION	STONE SIZE RANGE (IN.)
9	70 - 100	15	R-4	4 X 12
	50 - 70	12		
	35 - 50	9		
	2 - 10	3		

## NOTES:

1. ALL CHANNELS WILL HAVE 2H to 1V SIDE SLOPES AND ONE (1) FOOT OF FREEBOARD (F).
2. ROCK BLANKET SHALL BE A MINIMUM OF ONE AND A HALF FEET (1-1/2') THICK (T) THROUGHOUT.
3. ALL GROUTED RIP RAP CHANNELS SHALL HAVE 100% GROUT PENETRATION IN ALL VOIDS.

DRAWING NO.:

15

Landmark Corporation  
Permit No. S-34-82

BUYER GN-23	PAGE	REQ. or P.D. No. DEP15737
SED. DITCHES 'E' & 'F' TYP. SECT. C-C		

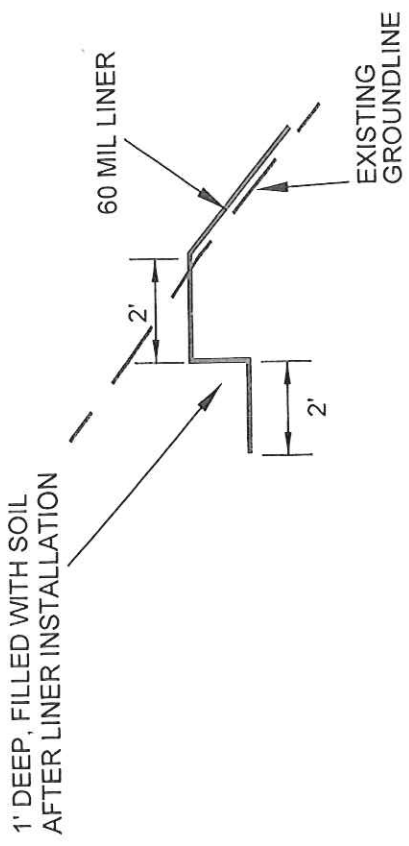

LINER KEY DETAIL

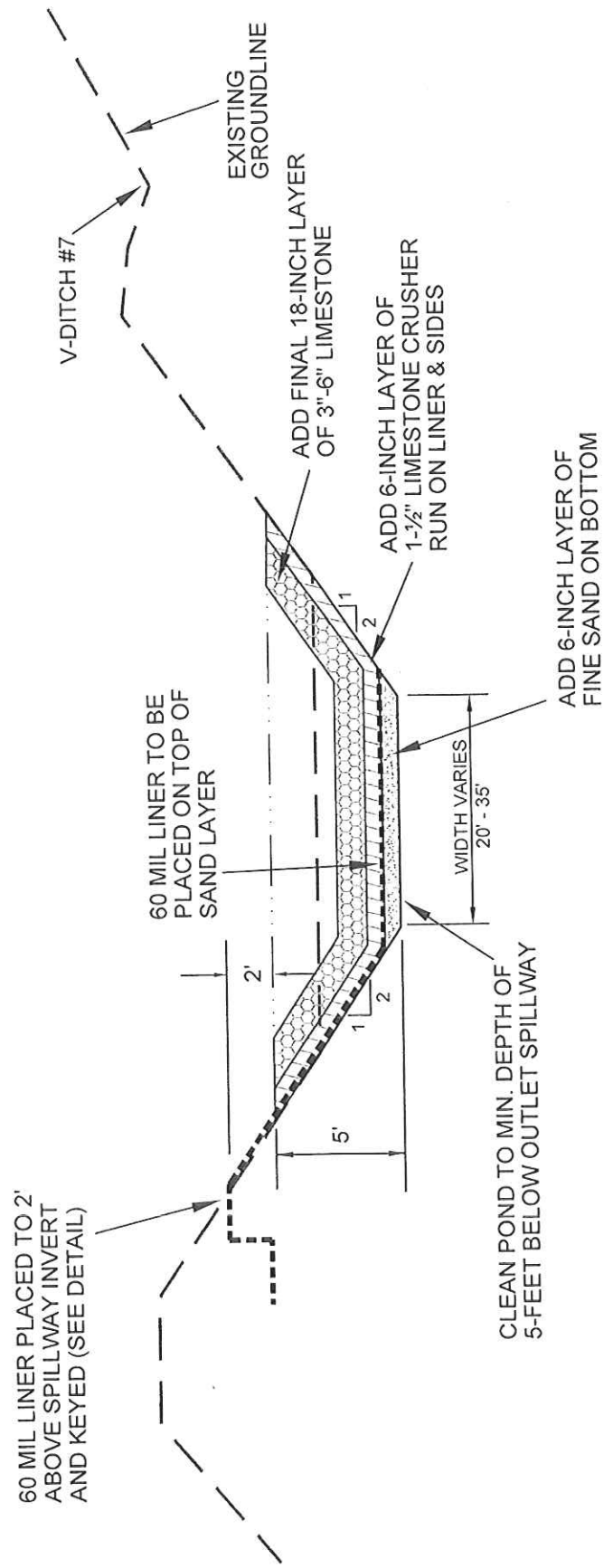

SECTION C-C

MANDATORY PRE-BID SIGN-IN ATTENDANCE SHEET

SHEET 1 of 2

RFQ # : DEP15737  
 Project: Landmark Corporation  
S-34-82

Bid Date: 4/10/12  
 Pre-Bid Date: 3/20/12

<p>Name : <u>Mike Stiltner</u>                      Company: <u>Carey Concrete</u>                      Address: <u>P.O. Box 803</u>  <u>Wayne, WV 25570</u>                      Phone #: <u>304-300-6338</u>                      Fax # : _____                      Email : <u>Steve F. Carey @ yahoo.com</u></p>	<p>Name : <u>Joe Wiseman</u>                      Company: <u>Wiseman Excavating</u>                      Address: <u>Pt. 1 Box 190</u>  <u>Liberty, WV 25124</u>                      Phone#: <u>304-586-3736</u>                      Fax # : <u>304-586-3789</u>                      Email : <u>juwpoa12@aol.com</u></p>
<p>Name : <u>Mike Jarrett</u>                      Company: <u>Mountain Haus Properties Inc</u>                      Address: <u>1805 Smith Rd</u>  <u>Charleston WV 25314</u>                      Phone #: <u>304-545-0408</u>                      Fax # : _____                      Email : <u>mikejarrett1865@yahoo.com</u></p>	<p>Name : <u>DAVID H. BOWMAN</u>                      Company: <u>GREEN MOUNTAIN COMPANY</u>                      Address: <u>511 50<sup>th</sup> STREET</u>  <u>CHAS WV</u>  <u>25304</u>                      Phone#: <u>304-925-0253</u>                      Fax # : _____                      Email : <u>DHB722@yahoo.com</u></p>
<p>Name : <u>Doug Vincent</u>                      Company: <u>BREAKAWAY INC</u>                      Address: <u>1075 Old Turnpike</u>  <u>Sutton WV 26601</u>                      Phone #: <u>765-5317</u>                      Fax # : <u>765-5389</u>                      Email : <u>doug@breakawaywv.com</u></p>	<p>Name : <u>DERRICK SEARS</u>                      Company: <u>FOSTER SUPPLY</u>                      Address: <u>PO Box 488</u>  <u>SCOTT DEPT WV 25500</u>                      Phone#: <u>304-553-6565</u>                      Fax # : <u>304-755-8280</u>                      Email : <u>dsears@fostersupply.com</u></p>
<p>Name : <u>Clyde R. Raynes</u>                      Company: <u>Raynes + Co</u>                      Address: <u>P.O. Box 438</u>  <u>Eleanor WV. 25070</u>                      Phone #: <u>304-586-2535</u>                      Fax # : <u>304-586-2707</u>                      Email : <u>We go Extreme at Yahoo</u></p>	<p>Name : <u>GEORGE FRESHOUR</u>                      Company: <u>EAGLE EXCAVATION INC.</u>                      Address: <u>P.O. BOX 218</u>  <u>KENNA WV</u>  <u>25140</u>                      Phone#: <u>(304) 372-4378</u>                      Fax # : <u>304-372-4378</u>                      Email : _____</p>



MANDATORY PRE-BID SIGN-IN ATTENDANCE SHEET

SHEET 2 of 2

RFQ # : DEP15737  
Project: Landmark Corporation  
5-34-82

Bid Date: 4/10/12  
Pre-Bid Date: 3/26/12

Name : Mike Jones  
Company: Bermont Const.  
Address: PO box 1460  
Queen Rd  
Phone #: 304-548-7004  
Fax #: 304-548-7133  
Email : bermontconst@earthlink.net

Name : \_\_\_\_\_  
Company: \_\_\_\_\_  
Address: \_\_\_\_\_  
Phone# : \_\_\_\_\_  
Fax # : \_\_\_\_\_  
Email : \_\_\_\_\_

Name : Robert L. Barnes  
Company: Barnes EXC. INC.  
Address: P.O. Box 13384  
Sissonville  
WV 25360  
Phone #: 304-984-1725  
Fax #: 304-984-0074  
Email : Barnes EXC (A) AOL.COM

Name : \_\_\_\_\_  
Company: \_\_\_\_\_  
Address: \_\_\_\_\_  
Phone# : \_\_\_\_\_  
Fax # : \_\_\_\_\_  
Email : \_\_\_\_\_

Name : ROY MCKINNEY  
Company: EASTERN ARROW CORP  
Address: PO BOX 4108  
CHARLESTON WV.  
25364  
Phone #: 304-414-0255  
Fax #: 304-414-0256  
Email : EASTERN ARROW @ HOTMAIL.COM

Name : \_\_\_\_\_  
Company: \_\_\_\_\_  
Address: \_\_\_\_\_  
Phone# : \_\_\_\_\_  
Fax # : \_\_\_\_\_  
Email : \_\_\_\_\_

Name : \_\_\_\_\_  
Company: \_\_\_\_\_  
Address: \_\_\_\_\_  
Phone #: \_\_\_\_\_  
Fax #: \_\_\_\_\_  
Email : \_\_\_\_\_

Name : \_\_\_\_\_  
Company: \_\_\_\_\_  
Address: \_\_\_\_\_  
Phone# : \_\_\_\_\_  
Fax # : \_\_\_\_\_  
Email : \_\_\_\_\_