

NOTE: Areas of Archeological Intrest.
Keep disturbance of soil to a minimum.
Cut posts flush with concrete base
and fill with concrete. DO NOT remove concrete base.

NOTE: Areas of Archeological Intrest.
Keep disturbance of soil to minimum.
Cut posts flush with concrete base and fill with concrete.
DO NOT remove concrete base.

WEST SIDE PLAN VIEW, DEMOLITION

SCALE: 1" = 20'

GENERAL NOTES:

1. THESE DRAWINGS ARE BASED ON HISTORICAL DRAWINGS OF THE SITE. FENCING CONTRACTOR SHALL VERIFY ALL CONDITIONS PRIOR TO BEGINNING THE WORK.
2. GRAVE CREEK MOUND ARCHEOLOGICAL COMPLEX IS AN ARCHEOLOGICAL SITE OF NATIONAL SIGNIFICANCE; FENCING CONTRACTOR SHALL CONDUCT WORK WITH CARE. IN AREAS IDENTIFIED AS "ARCHEOLOGICALLY SIGNIFICANT" WORK MUST BE CONDUCTED IN THE PRESENCE OF AN ARCHAEOLOGIST. IF DURING THE WORK EVIDENCE OF HISTORICAL ARTIFACTS ARE UNCOVERED WORK IS TO STOP IN THE AREA OF DISCOVERY AND THE SITE MANAGER IS TO BE IMMEDIATELY NOTIFIED.
3. FENCING CONTRACTOR IS TO REMOVE EXISTING FENCE FOOTINGS AND PROPERLY DISPOSE OF SAME. HOLES ARE TO BE FILLED AND PROPERLY COMPACTED. (REFER TO PROJECT MANUAL)

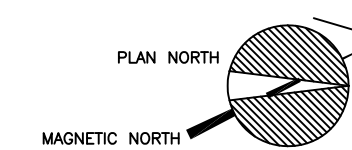

COMPLEX SECURITY FENCE REPLACEMENT
 GRAVE CREEK ARCHAEOLOGICAL COMPLEX
 WEST SITE PLAN VIEW, DEMOLITION
 MOUNDSVILLE, WEST VIRGINIA

FACILITY OPERATIONS UNIT
 1900 KANAWHA BOULEVARD EAST
 CHARLESTON, WV 25305
 PHONE: 304-556-0220
 FAX: 304-556-2779
 WWW.WVCULTURE.ORG

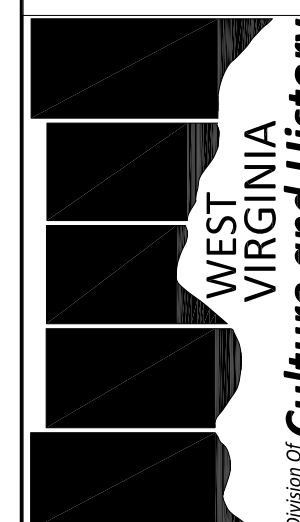

DATE: MARCH 21, 2011
 SCALE: 1"=20'
 DR. BY: MARK LYNCH

D-1

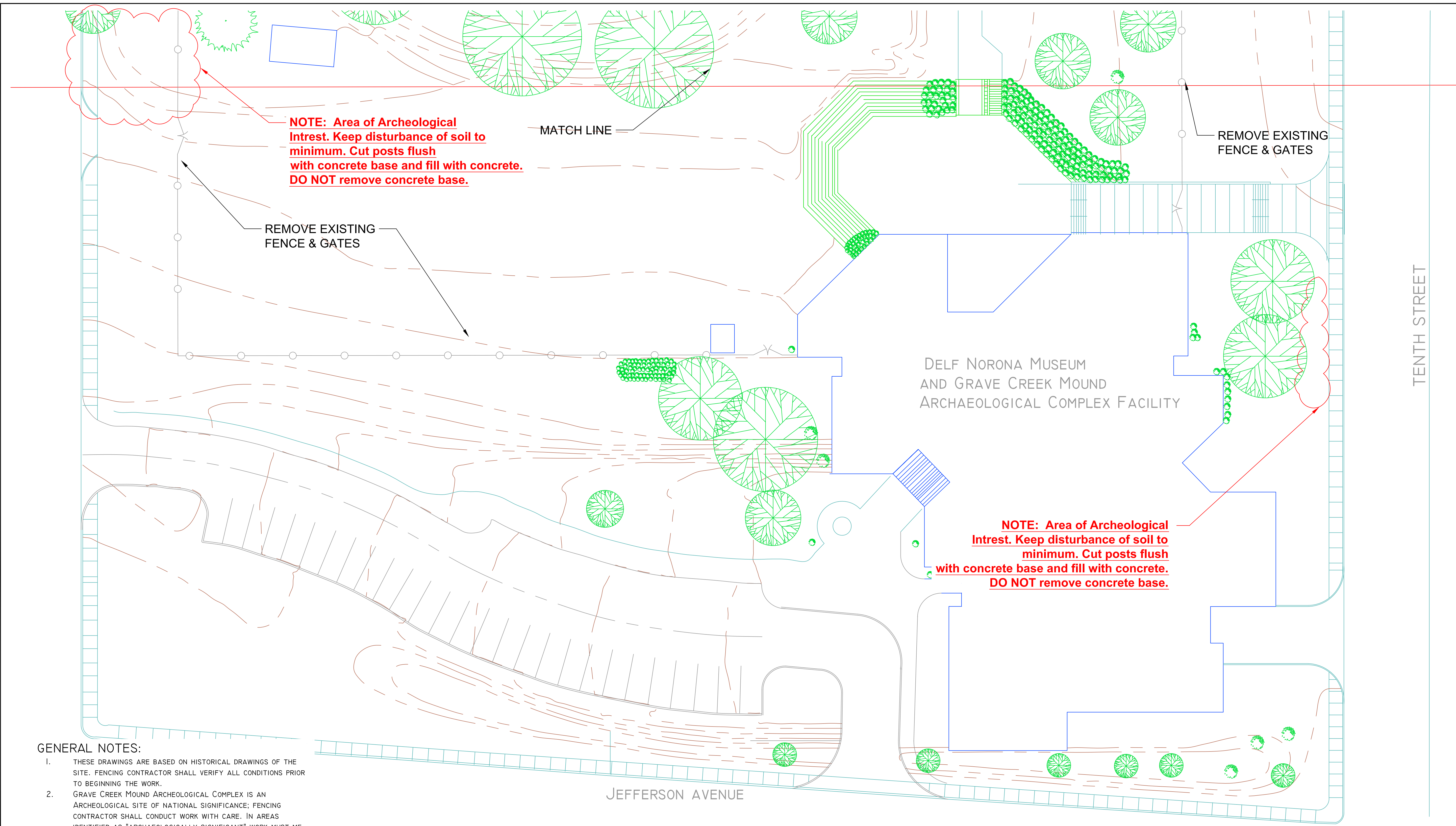

GENERAL NOTES:

1. THESE DRAWINGS ARE BASED ON HISTORICAL DRAWINGS OF THE SITE. FENCING CONTRACTOR SHALL VERIFY ALL CONDITIONS PRIOR TO BEGINNING THE WORK.
2. GRAVE CREEK MOUND ARCHAEOLOGICAL COMPLEX IS AN ARCHAEOLOGICAL SITE OF NATIONAL SIGNIFICANCE; FENCING CONTRACTOR SHALL CONDUCT WORK WITH CARE. IN AREAS IDENTIFIED AS "ARCHAEOLOGICALLY SIGNIFICANT" WORK MUST BE CONDUCTED IN THE PRESENCE OF AN ARCHAEOLOGIST. IF DURING THE WORK EVIDENCE OF HISTORICAL ARTIFACTS ARE UNCOVERED WORK IS TO STOP IN THE AREA OF DISCOVERY AND THE SITE MANAGER IS TO BE IMMEDIATELY NOTIFIED.
3. FENCING CONTRACTOR IS TO REMOVE EXISTING FENCE FOOTINGS AND PROPERLY DISPOSE OF SAME. HOLES ARE TO BE FILLED AND PROPERLY COMPACTED. (REFER TO PROJECT MANUAL)

EAST SIDE PLAN VIEW, DEMOLITION

SCALE: 1" = 20'

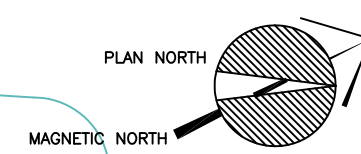

COMPLEX SECURITY FENCE REPLACEMENT
GRAVE CREEK ARCHAEOLOGICAL COMPLEX
EAST SITE PLAN VIEW, DEMOLITION
MOUNDSVILLE, WEST VIRGINIA

FACILITY OPERATIONS UNIT
1900 KANAWHA BOULEVARD EAST
CHARLESTON, WV 25305
PHONE: 304-558-0220
FAX: 304-558-2779
WWW.WVCULTURE.ORG

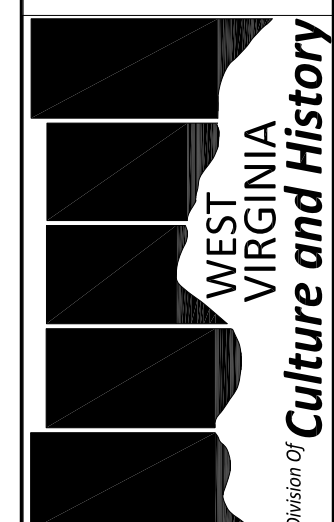

DATE: MARCH 21, 2011
SCALE: 1"=20'
DR. BY: MARK LYNCH

D-2

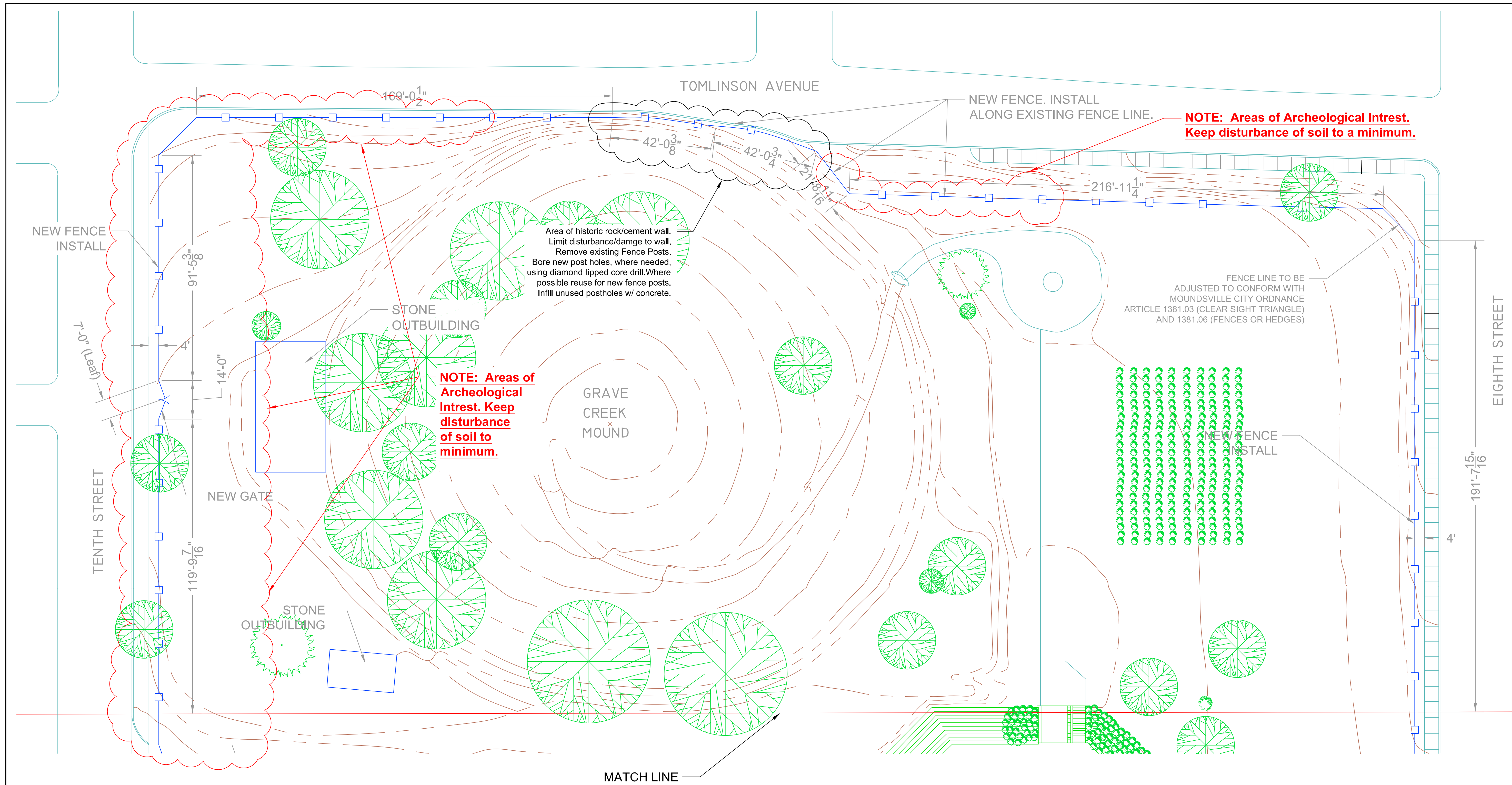

GENERAL NOTES:

1. THESE DRAWINGS ARE BASED ON HISTORICAL DRAWINGS OF THE SITE. FENCING CONTRACTOR SHALL VERIFY ALL CONDITIONS PRIOR TO BEGINNING THE WORK.
2. GRAVE CREEK MOUND ARCHEOLOGICAL COMPLEX IS AN ARCHEOLOGICAL SITE OF NATIONAL SIGNIFICANCE; FENCING CONTRACTOR SHALL CONDUCT WORK WITH CARE. IN AREAS IDENTIFIED AS "ARCHEOLOGICALLY SIGNIFICANT" WORK MUST BE CONDUCTED IN THE PRESENCE OF AN ARCHAEOLOGIST. IF DURING THE WORK EVIDENCE OF HISTORICAL ARTIFACTS ARE UNCOVERED WORK IS TO STOP IN THE AREA OF DISCOVERY AND THE SITE MANAGER IS TO BE IMMEDIATELY NOTIFIED.
3. FENCING CONTRACTOR IS TO REMOVE EXISTING FENCE FOOTINGS AND PROPERLY DISPOSE OF SAME. HOLES ARE TO BE FILLED AND PROPERLY COMPACTED. (REFER TO PROJECT MANUAL)

WEST SIDE PLAN VIEW

SCALE: 1" = 20'

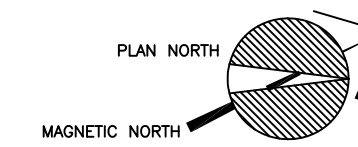

COMPLEX SECURITY FENCE REPLACEMENT
GRAVE CREEK ARCHEOLOGICAL COMPLEX
WEST SIDE PLAN VIEW
MOUNDSVILLE, WEST VIRGINIA

FACILITY OPERATIONS UNIT
1900 KANAWHA BOULEVARD EAST
CHARLESTON, WV 25305
PHONE: 304-556-0220
FAX: 304-556-2779
WWW.WVCULTURE.ORG

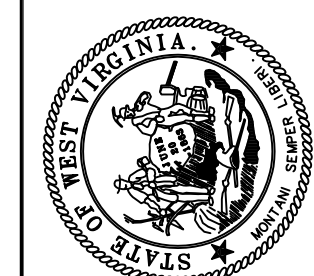
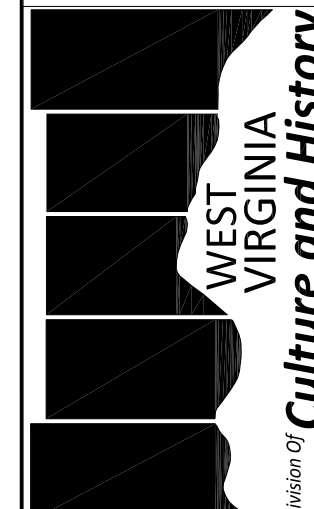

DATE: MARCH 21, 2011
SCALE: 1"=20'
DR. BY: MARK LYNCH

C-1

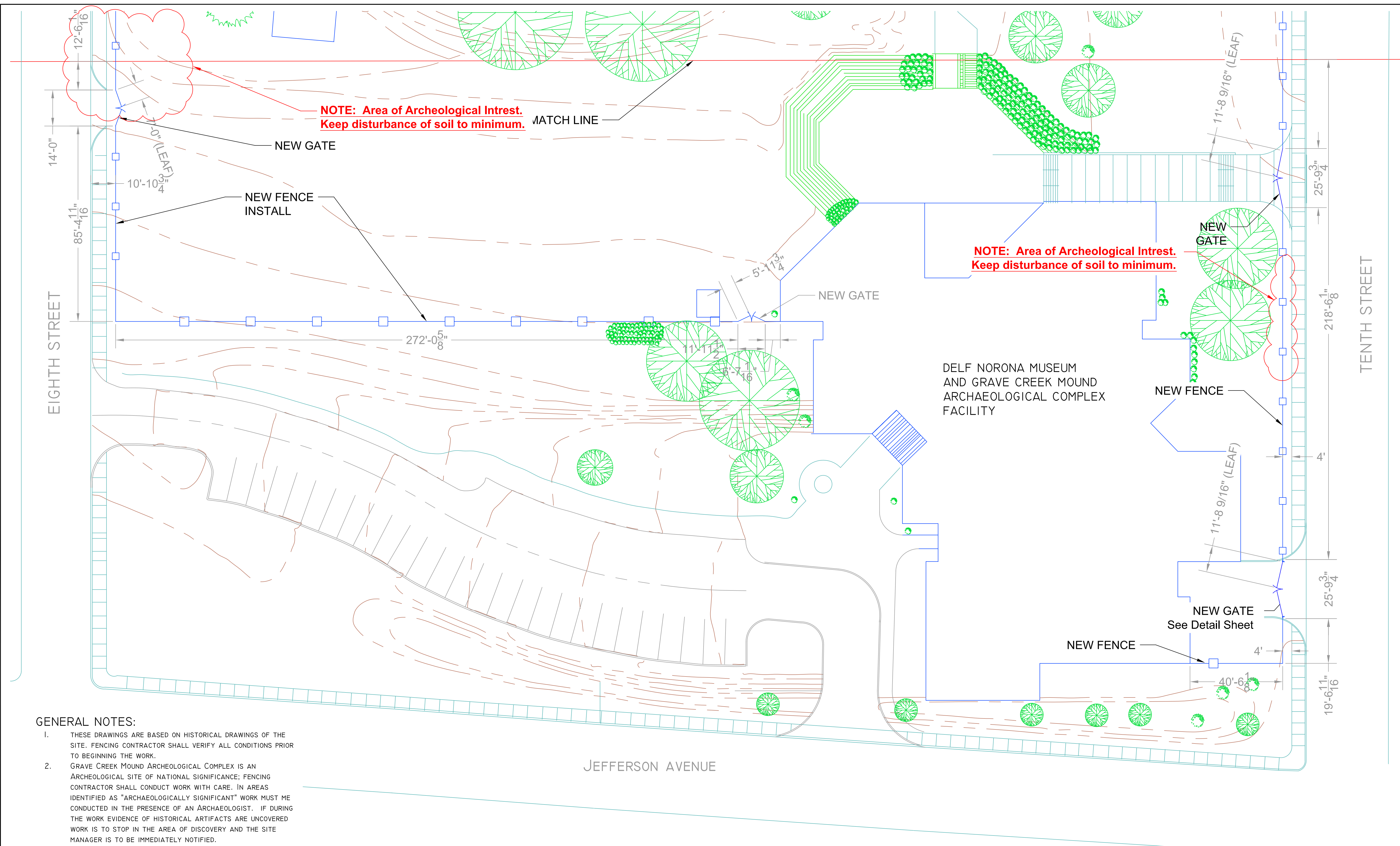

NOTE: Area of Archeological Intrest.
Keep disturbance of soil to minimum.

NOTE: Area of Archeological Intrest.
Keep disturbance of soil to minimum.

- GENERAL NOTES:**
1. THESE DRAWINGS ARE BASED ON HISTORICAL DRAWINGS OF THE SITE. FENCING CONTRACTOR SHALL VERIFY ALL CONDITIONS PRIOR TO BEGINNING THE WORK.
 2. GRAVE CREEK MOUND ARCHEOLOGICAL COMPLEX IS AN ARCHEOLOGICAL SITE OF NATIONAL SIGNIFICANCE; FENCING CONTRACTOR SHALL CONDUCT WORK WITH CARE. IN AREAS IDENTIFIED AS "ARCHEAOLOGICALLY SIGNIFICANT" WORK MUST BE CONDUCTED IN THE PRESENCE OF AN ARCHAEOLOGIST. IF DURING THE WORK EVIDENCE OF HISTORICAL ARTIFACTS ARE UNCOVERED WORK IS TO STOP IN THE AREA OF DISCOVERY AND THE SITE MANAGER IS TO BE IMMEDIATELY NOTIFIED.
 3. FENCING CONTRACTOR IS TO REMOVE EXISTING FENCE FOOTINGS AND PROPERLY DISPOSE OF SAME. HOLES ARE TO BE FILLED AND PROPERLY COMPACTED. (REFER TO PROJECT MANUAL)

EAST SIDE PLAN VIEW
 SCALE: 1" = 20'

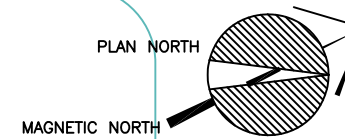

COMPLEX SECURITY FENCE REPLACEMENT
 GRAVE CREEK ARCHEOLOGICAL COMPLEX
 EAST SITE PLAN VIEW
 MOUNDSVILLE, WEST VIRGINIA

FACILITY OPERATIONS UNIT
 1900 KANAWHA BOULEVARD EAST
 CHARLESTON, WV 25305
 PHONE: 304-556-0220
 FAX: 304-556-2779
 WWW.WVCULTURE.ORG

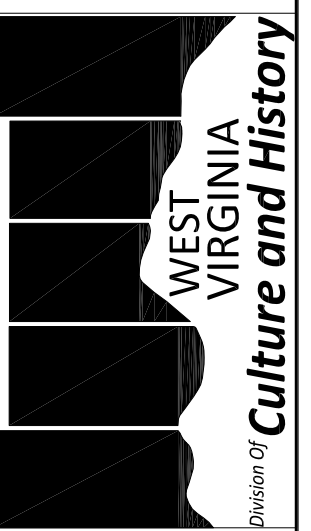

DATE: MARCH 21, 2011
 SCALE: 1"=20'
 DR. BY: MARK LYNCH

C-2

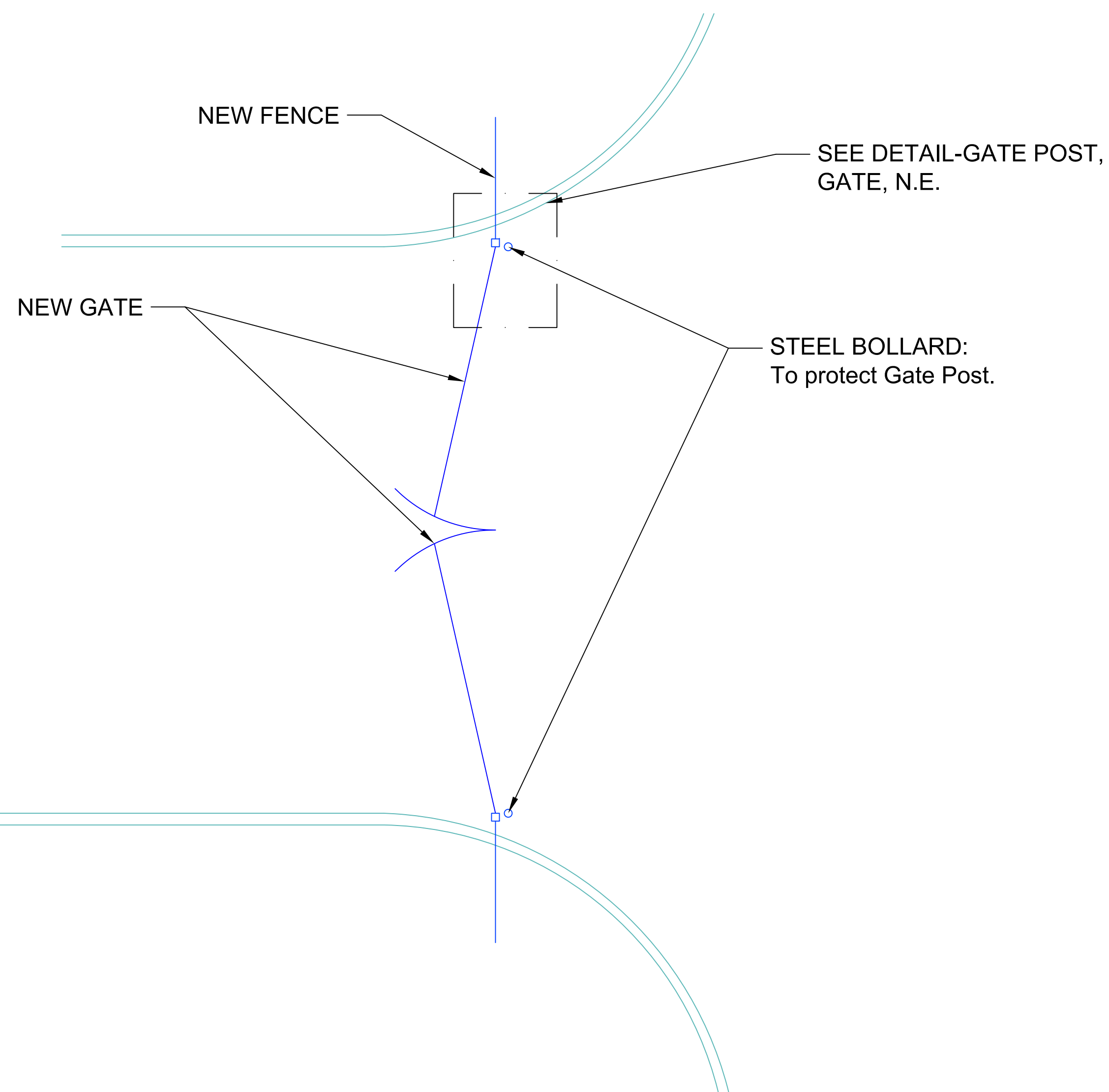

DETAIL: GATE, NORTH EAST
SCALE: 1/4" = 1'-0"

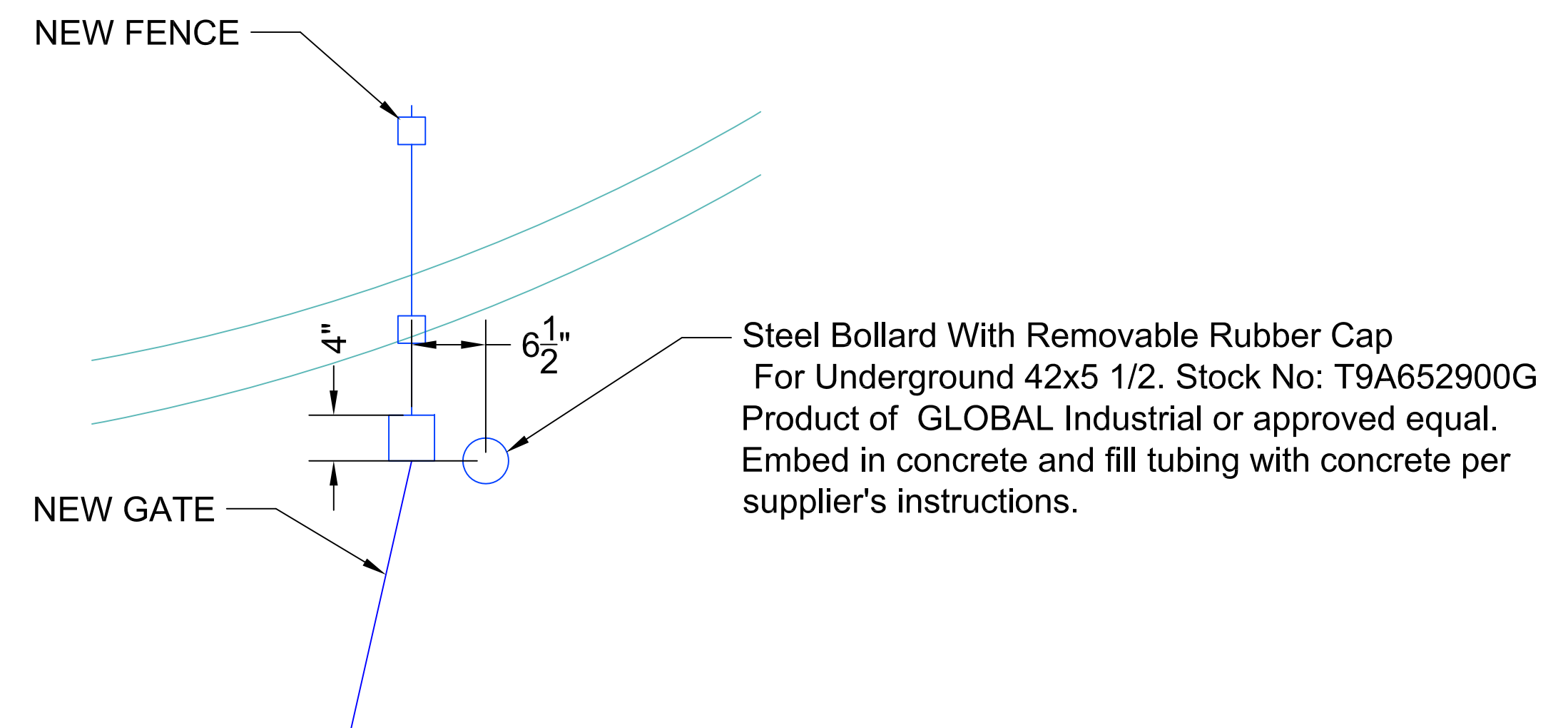

DETAIL- GATE Post, GATE,N.E.
SCALE: 1" = 1'-0"

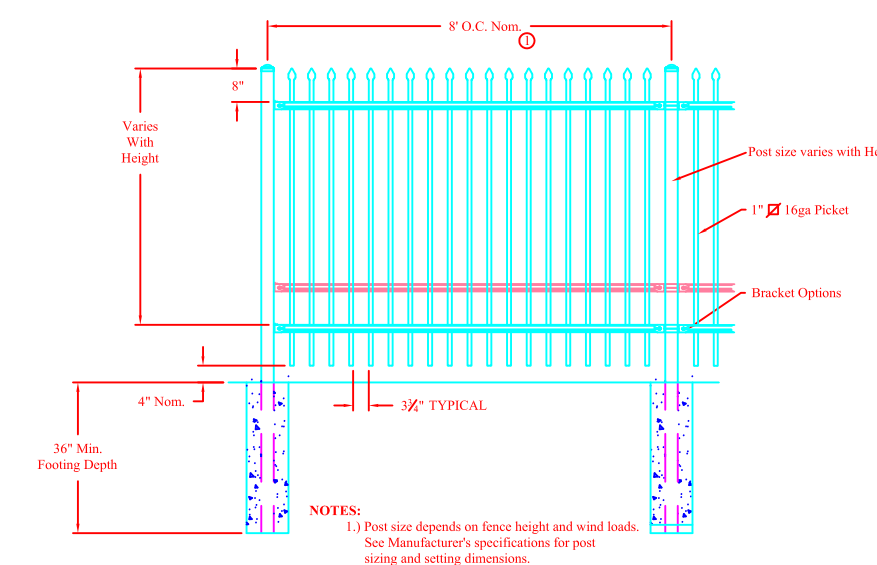

FENCE PANEL (TYP.)
DO NOT SCALE

GENERAL NOTES:

1. THESE DRAWINGS ARE BASED ON HISTORICAL DRAWINGS OF THE SITE. FENCING CONTRACTOR SHALL VERIFY ALL CONDITIONS PRIOR TO BEGINNING THE WORK.
2. GRAVE CREEK MOUND ARCHEOLOGICAL COMPLEX IS AN ARCHEOLOGICAL SITE OF NATIONAL SIGNIFICANCE; FENCING CONTRACTOR SHALL CONDUCT WORK WITH CARE. IN AREAS IDENTIFIED AS "ARCHEOLOGICALLY SIGNIFICANT" WORK MUST BE CONDUCTED IN THE PRESENCE OF AN ARCHAEOLOGIST. IF DURING THE WORK EVIDENCE OF HISTORICAL ARTIFACTS ARE UNCOVERED WORK IS TO STOP IN THE AREA OF DISCOVERY AND THE SITE MANAGER IS TO BE IMMEDIATELY NOTIFIED.
3. FENCING CONTRACTOR IS TO REMOVE EXISTING FENCE FOOTINGS AND PROPERLY DISPOSE OF SAME. HOLES ARE TO BE FILLED AND PROPERLY COMPACTED. (REFER TO PROJECT MANUAL)

DETAIL SHEET
SCALE: AS INDICATED

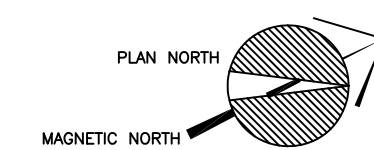

COMPLEX SECURITY FENCE REPLACEMENT GRAVE CREEK ARCHAEOLOGICAL COMPLEX DETAIL SHEET MOUNDSVILLE, WEST VIRGINIA	
FACILITY OPERATIONS UNIT 1900 KANAWHA BOULEVARD EAST CHARLESTON, WV 25305 PHONE: 304-556-0220 FAX: 304-556-2779 WWW.WVCULTURE.ORG	
DATE: MARCH 21, 2011 SCALE: 1"=20' DR. BY: MARK LYNCH	
C-3	