



State of West Virginia  
 Department of Administration  
 Purchasing Division  
 2019 Washington Street East  
 Post Office Box 50130  
 Charleston, WV 25305-0130

# Request for Quotation

RFQ NUMBER  
**DEP15136**

PAGE  
**1**

ADDRESS CORRESPONDENCE TO ATTENTION OF  
**CHUCK BOWMAN  
 304-558-2157**

RFQ COPY  
 TYPE NAME/ADDRESS HERE

VENDOR

SHIP TO

**ENVIRONMENTAL PROTECTION  
 DEPARTMENT OF  
 OFFICE OF AML&R  
 601 57TH STREET SE  
 CHARLESTON, WV  
 25304 304-926-0499**

DATE PRINTED	TERMS OF SALE	SHIP VIA	F.O.B.	FREIGHT TERMS
08/25/2010				

BID OPENING DATE: **09/09/2010** BID OPENING TIME **01:30PM**

LINE	QUANTITY	UOP	CAT. NO.	ITEM NUMBER	UNIT PRICE	AMOUNT
0001	1	JB		962-73		
<p>***** ADDENDUM NO. 1 *****</p> <p>ADDENDUM ISSUED FOR THE SARAH ANN (VANCE) DRAINAGE PROJECT TO DISTRIBUTE THE PRE-BID SIGN-IN SHEETS, THE Q/A, AND THE REVISED SPECIFICATIONS &amp; DRAWINGS RESULTING FROM THE MANDATORY PRE-BID MEETING OF 08/11/2010.</p> <p>BID OPENING DATE &amp; TIME REMAIN UNCHANGED AS 09/09/10 AT 1:30 PM.</p> <p>***** NO OTHER CHANGES *****</p> <p>RECLAMATION: RESTORATION OF LAND &amp; OTHER PROPERTIES</p> <p>***** THIS IS THE END OF RFQ DEP15136 ***** TOTAL: _____</p>						

SEE REVERSE SIDE FOR TERMS AND CONDITIONS

SIGNATURE	TELEPHONE	DATE
-----------	-----------	------

TITLE	FEIN	ADDRESS CHANGES TO BE NOTED ABOVE
-------	------	-----------------------------------

WHEN RESPONDING TO RFQ, INSERT NAME AND ADDRESS IN SPACE ABOVE LABELED 'VENDOR'

## GENERAL TERMS & CONDITIONS REQUEST FOR QUOTATION (RFQ) AND REQUEST FOR PROPOSAL (RFP)

1. Awards will be made in the best interest of the State of West Virginia.
2. The State may accept or reject in part, or in whole, any bid.
3. Prior to any award, the apparent successful vendor must be properly registered with the Purchasing Division and have paid the required \$125 fee.
4. All services performed or goods delivered under State Purchase Order/Contracts are to be continued for the term of the Purchase Order/Contracts, contingent upon funds being appropriated by the Legislature or otherwise being made available. In the event funds are not appropriated or otherwise available for these services or goods this Purchase Order/Contract becomes void and of no effect after June 30.
5. Payment may only be made after the delivery and acceptance of goods or services.
6. Interest may be paid for late payment in accordance with the *West Virginia Code*.
7. Vendor preference will be granted upon written request in accordance with the *West Virginia Code*.
8. The State of West Virginia is exempt from federal and state taxes and will not pay or reimburse such taxes.
9. The Director of Purchasing may cancel any Purchase Order/Contract upon 30 days written notice to the seller.
10. The laws of the State of West Virginia and the *Legislative Rules* of the Purchasing Division shall govern the purchasing process.
11. Any reference to automatic renewal is hereby deleted. The Contract may be renewed only upon mutual written agreement of the parties.
12. **BANKRUPTCY:** In the event the vendor/contractor files for bankruptcy protection, the State may deem this contract null and void, and terminate such contract without further order.
13. **HIPAA BUSINESS ASSOCIATE ADDENDUM:** The West Virginia State Government HIPAA Business Associate Addendum (BAA), approved by the Attorney General, is available online at [www.state.wv.us/admin/purchase/vrc/hipaa.htm](http://www.state.wv.us/admin/purchase/vrc/hipaa.htm) and is hereby made part of the agreement. Provided that the Agency meets the definition of a Cover Entity (45 CFR §160.103) and will be disclosing Protected Health Information (45 CFR §160.103) to the vendor.
14. **CONFIDENTIALITY:** The vendor agrees that he or she will not disclose to anyone, directly or indirectly, any such personally identifiable information or other confidential information gained from the agency, unless the individual who is the subject of the information consents to the disclosure in writing or the disclosure is made pursuant to the agency's policies, procedures, and rules. Vendor further agrees to comply with the Confidentiality Policies and Information Security Accountability Requirements, set forth in <http://www.state.wv.us/admin/purchase/privacy/noticeConfidentiality.pdf>.
15. **LICENSING:** Vendors must be licensed and in good standing in accordance with any and all state and local laws and requirements by any state or local agency of West Virginia, including, but not limited to, the West Virginia Secretary of State's Office, the West Virginia Tax Department, and the West Virginia Insurance Commission. The vendor must provide all necessary releases to obtain information to enable the director or spending unit to verify that the vendor is licensed and in good standing with the above entities.
16. **ANTITRUST:** In submitting a bid to any agency for the State of West Virginia, the bidder offers and agrees that if the bid is accepted the bidder will convey, sell, assign or transfer to the State of West Virginia all rights, title and interest in and to all causes of action it may now or hereafter acquire under the antitrust laws of the United States and the State of West Virginia for price fixing and/or unreasonable restraints of trade relating to the particular commodities or services purchased or acquired by the State of West Virginia. Such assignment shall be made and become effective at the time the purchasing agency tenders the initial payment to the bidder.

I certify that this bid is made without prior understanding, agreement, or connection with any corporation, firm, limited liability company, partnership, or person or entity submitting a bid for the same material, supplies, equipment or services and is in all respects fair and without collusion or fraud. I further certify that I am authorized to sign the certification on behalf of the bidder or this bid.

### INSTRUCTIONS TO BIDDERS

1. Use the quotation forms provided by the Purchasing Division. Complete all sections of the quotation form.
2. Items offered must be in compliance with the specifications. Any deviation from the specifications must be clearly indicated by the bidder. Alternates offered by the bidder as **EQUAL** to the specifications must be clearly defined. A bidder offering an alternate should attach complete specifications and literature to the bid. The Purchasing Division may waive minor deviations to specifications.
3. Unit prices shall prevail in case of discrepancy. All quotations are considered F.O.B. destination unless alternate shipping terms are clearly identified in the quotation.
4. All quotations must be delivered by the bidder to the office listed below prior to the date and time of the bid opening. Failure of the bidder to deliver the quotations on time will result in bid disqualifications: Department of Administration, Purchasing Division, 2019 Washington Street East, P.O. Box 50130, Charleston, WV 25305-0130
5. Communication during the solicitation, bid, evaluation or award periods, except through the Purchasing Division, is strictly prohibited (W.Va. C.S.R. §148-1-6.6).

RFQ 15136  
Sarah Ann (Vance) Drainage  
Addendum #1

- Item 1: Q) What is the time period for this project and will it affect the mob/demob, etc, for the project.
- A) The time period for the project is 120 days. It is anticipated that all work with the exception of the installation of the bat gates will be completed within the 120 day time period. A change order will be used to cater for the installation of the bat gates. The time period for the change order and installation of the bat gates will be thirty (30) days (i.e. from May 1 through May 31). Any additional costs (i.e. mob/demob, revegetation, etc) that you estimate to be incurred as a result of this schedule should be included in your bid.
- Item 2: C) Section 5.0 "Sediment Control" in the specifications is to be omitted. (pg 23-25) . They will be replaced with a new section "5.0 Sediment Control" which are included with this addendum.
- Item 3: C) Four of the construction drawings have been revised. These include Sh 6, 9, 11, & 14. The straw bales were replaced with straw wattles. The four revised sheets are included with this addendum.
- Item 4: Q) Where will the material from the slide area be wasted?  
A) The disposal area for the slide material is identified on the plans. It is adjacent to the slide located along the road.
- Item 5: Q) Will limestone be required for grouted ditches?  
A) No
- Item 6: Q) Will chiseling into the existing rock face on Channel D, profile station 0+50 to 0+60 be required?  
A) No

# MANDATORY PRE-BID SIGN-IN ATTENDANCE SHEET

## PRINT LEGIBLY

RFQ # : 15136  
 Project: SARAH ANN (VANCE) DRAINAGE

Bid Date: 9/9/2010  
 Pre-Bid Date: 8/11/2010

Name : LES BOLEN  
 Company: ASPEN CORP.  
 Address: 2400 RITTER DR.  
DANIELS WV 25832  
 Phone #: 304-763-4573  
 Fax #: 304-763-4591  
 Email : lboLEN@aspEN-gOLF.com

Name : DAVID H. BOWMAN  
 Company: GREEN MOUNTAIN CO.  
 Address: 511 50th STREET  
Chas. WV 25304  
 Phone#: 304 925 0253  
 Fax #: 925 9230  
 Email : Jody Maye@AOL.COM

Name : Robert Barnes  
 Company: BARNES EXC. INC.  
 Address: P.O. Box 13384  
Sissonville  
WV 25360  
 Phone #: 304-984-1725  
 Fax #: 304-984-0074  
 Email : BARNES EXC. @AOL.COM

Name : Chris Harman  
 Company: CLECO CORP.  
 Address: DRAWER A  
ROSEDALE VA 24208  
 Phone#: 276-880-1034  
 Fax #: \_\_\_\_\_  
 Email : WWW.CLECO CORP.COM

Name : Brian Hoard  
 Company: BREAKAWAY INC.  
 Address: 1075 Old Turnpike Rd  
Sutton WV 26601  
 Phone #: 304-765-5587  
 Fax #: 304-765-5587  
 Email : \_\_\_\_\_

Name : Tanner Taylor  
 Company: SELCO CONSTRUCTION SERVICE  
 Address: P.O. Box 190  
Swords Creek, VA 24664  
 Phone#: 276-880-2300  
 Fax #: 276-880-2390  
 Email : ttaylor@selcoconstruction.com

Name : DENNIS C. ELBOW  
 Company: COWGIRL UP INC  
 Address: P O Box 243  
SIMPSON, WV 26435  
 Phone #: 304-739-4397  
 Fax #: 304-739-4401  
 Email : DCE.COWGIRLUP@EARTHINK.NC9

Name : LEE PRESCOTT  
 Company: T. P. C.  
 Address: RT 1 Box 30  
Frametown WV 26623  
 Phone#: 304 765-2842  
 Fax #: \_\_\_\_\_  
 Email : lpresco@gmail.com

# MANDATORY PRE-BID SIGN-IN ATTENDANCE SHEET

PRINT LEGIBLY

RFO # : 15136  
Project: Sarah Ann (Vance) Drainage

Bid Date: 9/9/2010  
Pre-Bid Date: 8/11/2010

Name : GARY Long  
Company: McCourt & Son Const.  
Address: 2790 Centralia Rd  
Sutton WV 26601  
Phone #: 304 765-5288  
Fax #: 304 765-5293  
Email : \_\_\_\_\_

Name : Randy Carpenter  
Company: Carpenter Reclamation  
Address: PO Box 13015  
Sissonville, WV  
25360  
Phone #: 304-984-1115  
Fax #: 984-2770  
Email : RCarpenter103@aol.com

Name : Robert Pantelony  
Company: B&B Transit  
Address: ~~720 Bx~~  
Bowling WV 25001  
Phone #: 304-673-9388  
Fax #: 304-253-4133  
Email : B.B. Pantelony@Email.com

Name : BRAD WISEMAN  
Company: WISEMAN EXCAVATING  
Address: RT1 Box 190 Liberty  
WV 25124  
Phone #: 304-586-3736  
Fax #: 304-586-3789  
Email : \_\_\_\_\_

Name : DARRE FOSTER  
Company: EAGLE CONTRACTORS LLC  
Address: 1721 WINFIELD ROAD  
WINFIELD WV 25213  
Phone #: 304-352-7781  
Fax #: 304-755-3150  
Email : \_\_\_\_\_

Name : \_\_\_\_\_  
Company: \_\_\_\_\_  
Address: \_\_\_\_\_  
Phone #: \_\_\_\_\_  
Fax #: \_\_\_\_\_  
Email : \_\_\_\_\_

Name : GEORGE FRESHOUR  
Company: EAGLE EXCAVATION INC  
Address: P.O. Box 218  
KENNA WV  
25248  
Phone #: (304) 372-4270  
Fax #: (304) 372-4278  
Email : \_\_\_\_\_

Name : \_\_\_\_\_  
Company: \_\_\_\_\_  
Address: \_\_\_\_\_  
Phone #: \_\_\_\_\_  
Fax #: \_\_\_\_\_  
Email : \_\_\_\_\_

## 5.0 SEDIMENT CONTROL

### 5.1 Description

This item shall consist of furnishing all materials, equipment, labor and incidentals necessary for the installation of sediment control structures as designated in the Drawings. Sediment control shall be placed on regraded outslope areas concurrent with construction and prior to revegetation. Additional quantities may be added at the discretion of the WVDEP. This item will also include permanent erosion control matting for slope protection on the corrected slide.

The CONTRACTOR shall submit an erosion and sediment control plan to the WVDEP at the pre-construction meeting for approval. This plan shall include measures to be utilized for temporary and permanent erosion and sediment control. This plan shall also include the measures as outlined herein. The WVDEP's approval of this plan does not relieve the CONTRACTOR of his responsibility to be in compliance with any and all permits. All costs associated with meeting the Federal and/or State Regulations shall be the sole responsibility of the Contractor.

### 5.2 Materials

**5.2.1** Straw Wattles: The Straw Wattles shall consist of cylinders of recycled, compressed, 100% agricultural straw, and are wrapped in photodegradable black synthetic netting. Twelve (12) inch diameter wattles, 25-feet in length shall be utilized and shall be North American Green (NAG) WS1210, or approved equal.

**5.2.2** Stakes: The stakes shall consist of 1" X 1" stakes, 24 inches in length made from suitable hardwoods. Stakes shall be spaced 4-feet minimum on each straw wattle. Other methods of anchoring may be used if specifically approved by the WVDEP.

**5.2.3** Alternate: Silt fencing materials and installation shall meet all applicable requirements of Section 715.11.5 and 642.6 of the West Virginia Division of Highways Standard Specifications for Roads and Bridges, Adopted 2000.

Even with the specific prior approval of the WVDEP, the use of silt fence shall be limited to relatively flat areas and the toe of selected slopes. Straw wattles shall be used on slopes.

**5.2.4** Erosion Control Matting: Matting shall be NAG SC250 or equal for use on the permanent erosion control matting for slope protection on the bench at the corrected slide.

**5.2.5** Diversion berms shall be constructed as shown on the plans. The location of the diversion berms are at the Contractor's access.

5.2.6 Riprap for the rock check dams shall be  $D_{max}$  18-inches and meet the requirements of Section 7.2.1, "Riprap."

### 5.3 Maintenance

During the course of the project, sediment control structures shall be maintained in sound condition and accumulations of silt which may threaten their effectiveness shall be removed. Silt removed from the sediment control structures shall be taken to an approved disposal area.

### 5.4 Installation

The Straw Wattles shall be installed end to end at locations shown on the plans, per the detail. Straw Wattles shall be set in a 2"-3" deep trench by 12" wide. Stakes shall be placed every 3 to 4-feet, driven thru the middle of the wattle, with 2"-3" of the top of the stake exposed.

The rock check dams shall be installed at locations as shown on the plans. The dams shall be cleaned when half or more full and shall be removed from the channels once vegetation has been established. All rock check dams shall be removed from the site at the end of construction.

### 5.5 Method of Measurement

5.5.1 The method of measurement for sediment and/or erosion control installation and maintenance in conformance with the specifications and accepted by the WVDEP shall be on a per lineal foot basis to include fencing, straw wattles, stakes, all necessary materials, supplies, labor and equipment for installation and maintenance including sediment removal and disposal.

5.5.2 The method of measurement for diversion berms shall be based on a per lineal foot basis to include all necessary materials, supplies, labor and equipment for installation and maintenance including sediment removal and disposal.

5.5.3 The method of measurement for rock check dams shall be based on a per each basis to include all necessary materials, supplies, labor and equipment for installation and maintenance including sediment removal and disposal.

### 5.6 Basis of Payment

5.6.1 The quantity of work completed will be paid at the contract unit price bid for the following items, which price and payment shall be full compensation for all materials, labor, equipment and incidentals necessary to perform the work. Additionally, payments shall constitute full compensation for any required maintenance, sediment removal and disposal.

5.6.2 The Permanent Erosion Control Matting will be paid at the contract unit bid price for item, and shall be for all materials, labor, equipment and incidentals necessary to perform the work.

5.6.3 Diversion berms will be paid at the contract unit bid price for item, and shall be for all materials, labor, equipment and incidentals necessary to perform the work.

5.6.4 Rock check dams will be paid at the contract unit bid price for item, and shall be for all materials, labor, equipment and incidentals necessary to perform the work.

5.7 Pay Item

Item 5.1, "Sediment Control", per linear foot.

Item 5.2, "Permanent Erosion Control Matting", per square yard.

Item 5.3, "Diversion Berms", per linear foot.

Item 5.4, "Rock Check Dams", per each.



LEGEND	
SYMBOL	DESCRIPTION
[Symbol]	EXISTING PAVED ROAD
[Symbol]	EXISTING UNPAVED ROAD
[Symbol]	EXISTING RAILROAD
[Symbol]	EXISTING GAS MAIN
[Symbol]	EXISTING BUILDING
[Symbol]	EXISTING WALL
[Symbol]	EXISTING STREAM OR LAKE
[Symbol]	EXISTING CATCH BASIN
[Symbol]	EXISTING CULVERT
[Symbol]	EXISTING HEADWALL
[Symbol]	EXISTING MISCELLANEOUS STRUCTURE
[Symbol]	EXISTING FENCE LINE
[Symbol]	EXISTING UTILITY POLE
[Symbol]	EXISTING LIGHT POLE
[Symbol]	EXISTING GAS LINE
[Symbol]	EXISTING FIRE HYDRANT
[Symbol]	EXISTING MANHOLE
[Symbol]	EXISTING WATER METER
[Symbol]	EXISTING LOCATED OBJECT
SYMBOL	DESCRIPTION
[Symbol]	EXISTING SCATTERED TRASH/DEBRIS
[Symbol]	EXISTING WIRE PORTAL
[Symbol]	EXISTING GAS WELL
[Symbol]	EXISTING TREE LINE
[Symbol]	EXISTING BRUSH LINE
[Symbol]	EXISTING SPOT ELEVATION
[Symbol]	EXISTING CONTROL
[Symbol]	TERRADON BASELINE
[Symbol]	PROPOSED MATERIAL WASTE AREA
[Symbol]	PROPOSED RIPRAP
[Symbol]	PROPOSED GROUDED RIPRAP
[Symbol]	PROPOSED TEMP. CONST. ENTRANCE
[Symbol]	PROPOSED DRAINAGE CHANNEL
[Symbol]	PROPOSED STRAW BALES
[Symbol]	PROPOSED SILT FENCE
[Symbol]	PROPOSED UNDERDRAIN
[Symbol]	PROPOSED LIMIT OF CONSTRUCTION
[Symbol]	BOREHOLE LOCATION

- NOTES:**
- IT IS THE RESPONSIBILITY OF THE CONTRACTOR TO LOCATE ALL UNDERGROUND UTILITIES PRIOR TO CONSTRUCTION.
  - CONTOUR INTERVAL IS TWO FEET.
  - ALL DISTURBED AREAS WITHIN THE LIMIT OF CONSTRUCTION SHALL RECEIVE PERMANENT SEEDING UPON COMPLETION OF ALL WORK.
  - CONTRACTOR TO CUT AND MOVE ANY EXISTING PRIVATE WATERLINES WITHIN THE LIMIT OF CONSTRUCTION THAT WOULD PROHIBIT WORK. THESE WATERLINES SHALL BE ABANDONED IN PLACE. THESE ARE NOT PUBLIC WATER LINES.
  - CONTRACTOR IS TO UTILIZE EXISTING PIPES WHEN POSSIBLE FOR DIVERTING WATER BEFORE FINAL CHANNEL IS COMPLETE. TEMPORARY PIPES MAY BE USED WHEN EXISTING PIPES ARE NOT ABLE TO BE USED.

**NOTE:**  
CONTRACTOR SHALL CONSTRUCT A GROUDED RIPRAP HEADWALL FOR CHANNEL 'A', CONSISTING OF THE TYPE ROCK SPECIFIED IN THE CHANNEL 'A' ISLAND CREEK TIE IN DETAIL L-11. THE HEADWALL WILL INCLUDE THE EXISTING 18" CMP AND REPLACE EXISTING WOOD RETAINING WALL STRUCTURE AND EXTENDING AND CONNECT WITH THE EXISTING CONCRETE RETAINING WALL. THE TOP OF THE GROUDED RIPRAP HEADWALL WILL BE CONSTRUCTED TO THE ELEVATION OF THE EXISTING CONCRETE RETAINING WALL.

**NOTE:**  
NO SOIL BORROW AREAS ARE DESIGNATED ON THIS SITE. IF ADDITIONAL MATERIAL IS REQUIRED FOR THE BACKFILLING OF MINE SEALS, MATERIAL FROM THE EXCAVATION OF THE SLIDE AREA MAY BE USED.

- UTILITY COMPANIES AND CONTACTS**
- A. ASP PHONE: 1-800-982-4237
  - B. CSX CORPORATION PHONE: 1-904-339-3200
  - C. LOGAN COUNTY PSD PHONE: 1-304-946-2641
  - D. SOUTHERN PSD PHONE: 1-304-752-2757
  - E. VERIZON PHONE: 1-800-837-4866
  - F. WDOH-DISTRICT 2 PHONE: 1-304-528-5825

**NOTE:**  
CONTRACTOR TO SAVE AND PLACE TOPSOIL ON TOP OF ALL FILL MATERIAL. SOIL COVER FOR THE SLIDE DISPOSAL AREA WILL BE REQUIRED IF THE DISPOSAL MATERIAL CONTAINS LARGE AMOUNTS OF REDDUG OR REFUSE.

**SLIDE AND EXCESS MATERIAL WASTE AREA:** SLOPES SHALL BE NO STEEPER THAN 3:1 AND SHALL BE SEEDED.

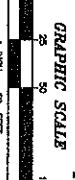
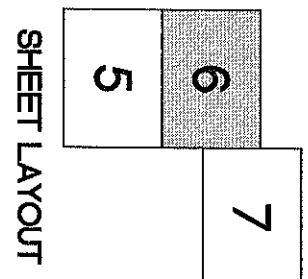
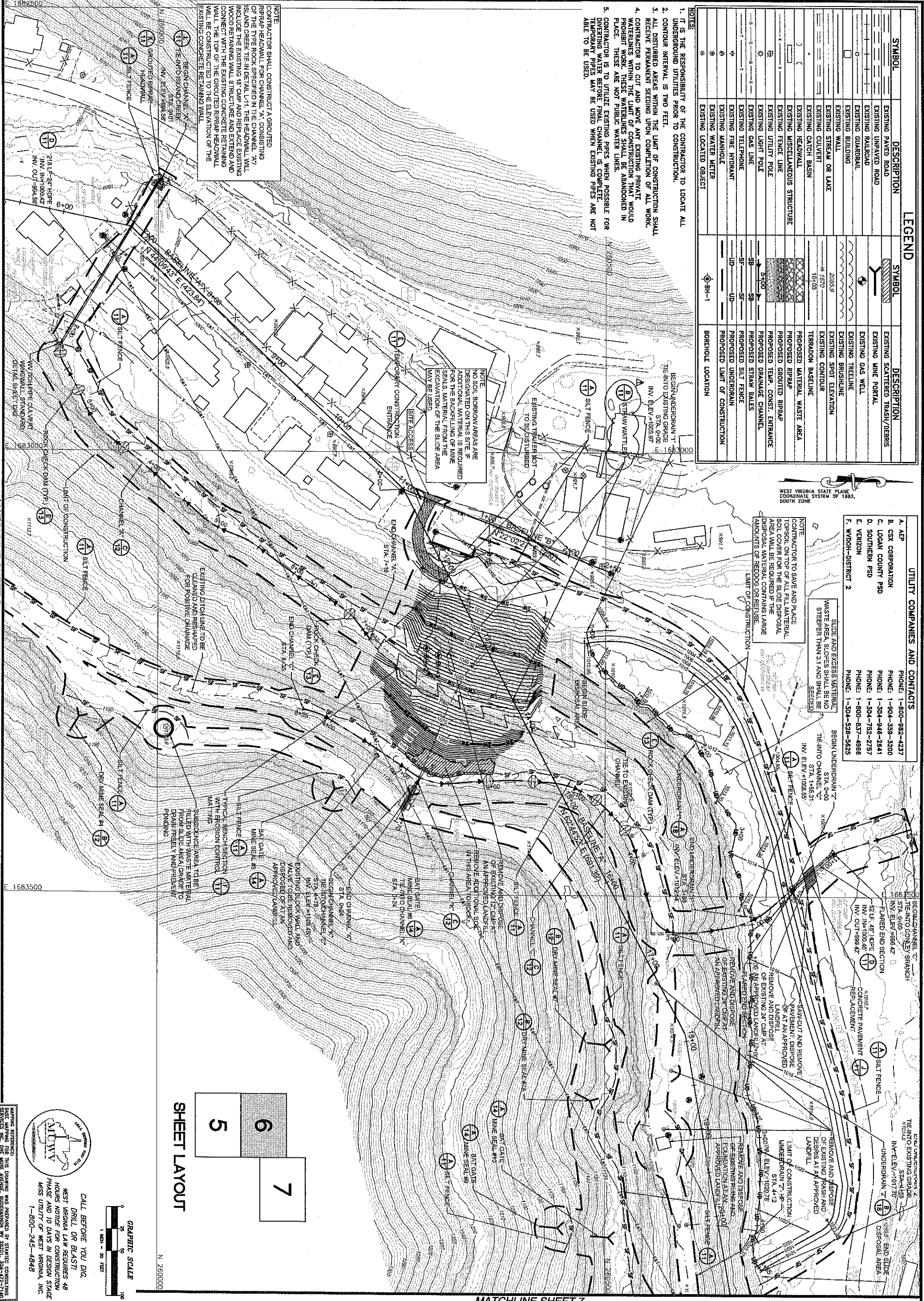

CALL BEFORE YOU DIG.  
DRILL OR BLAST!  
WEST VIRGINIA LAW REQUIRES 48 HOURS NOTICE FOR CONSTRUCTION PHASE AND 10 DAYS IN DESIGN STAGE. MISS UTILITY OF WEST VIRGINIA, INC. 1-800-245-4848

<p>WEST VIRGINIA DEPARTMENT OF ENVIRONMENTAL PROTECTION OFFICE OF ABANDONED MINE LANDS AND RECLAMATION</p> <p>RECLAMATION PLAN SARAH ANN (VANCE) DRAINAGE LOGAN COUNTY, WEST VIRGINIA</p>	<p><b>TERRADON</b> CORPORATION Engineering • Surveying • Landscape Architecture P.O. Box 519 Nitro, West Virginia 25143 (304) 755-8291 FAX 755-2836 www.terradon.com</p>	<p>NO. DATE REVISION</p> <p>8/6/10 REPLACE STRAW BALES WITH STRAW WATTLES</p>
		<p>Project No. 08056-0038</p> <p>Drawn: KLS</p> <p>Checked: TWJ</p> <p>Approved: JWI</p> <p>Scale: 1"=50'</p> <p>Date: 5-14-10</p> <p>Drawn by: JWI</p>

SYMBOL	DESCRIPTION	SYMBOL	DESCRIPTION
(Symbol)	EXISTING PAVED ROAD	(Symbol)	EXISTING CONTOUR
(Symbol)	EXISTING UNPAVED ROAD	(Symbol)	EXISTING MINE PORTAL
(Symbol)	EXISTING RAILROAD	(Symbol)	EXISTING GAS WELL
(Symbol)	EXISTING GUARDRAIL	(Symbol)	TERRADON BASELINE
(Symbol)	EXISTING BUILDING	(Symbol)	PROPOSED MATERIAL WASTE AREA
(Symbol)	EXISTING WALL	(Symbol)	PROPOSED RIPRAP
(Symbol)	EXISTING STREAM OR LAKE	(Symbol)	PROPOSED GROUDED RIPRAP
(Symbol)	EXISTING FENCE LINE	(Symbol)	PROPOSED TEMP. CONST. ENTRANCE
(Symbol)	EXISTING UTILITY POLE	(Symbol)	PROPOSED DRAINAGE CHANNEL
(Symbol)	EXISTING LIGHT POLE	(Symbol)	PROPOSED STRAW BALES
(Symbol)	EXISTING GAS LINE	(Symbol)	PROPOSED SILT FENCE
(Symbol)	EXISTING TELEPHONE	(Symbol)	PROPOSED UNDERDRAIN
(Symbol)	EXISTING SCATTERED TRASH/DEBRIS	(Symbol)	PROPOSED LIMIT OF CONSTRUCTION
(Symbol)	EXISTING TREE LINE	(Symbol)	BOREHOLE LOCATION
(Symbol)	EXISTING BRUSHLINE	(Symbol)	EXISTING PROPERTY/ROW LINE
(Symbol)	EXISTING SPOT ELEVATION	(Symbol)	TAX MAP NUMBER

- NOTES:**
- IT IS THE RESPONSIBILITY OF THE CONTRACTOR TO LOCATE ALL UNDERGROUND UTILITIES PRIOR TO CONSTRUCTION.
  - CONTOUR INTERVAL IS TWO FEET.
  - ALL DISTURBED AREAS WITHIN THE LIMIT OF CONSTRUCTION SHALL RECEIVE PERMANENT SEEDING UPON COMPLETION OF ALL WORK.
  - CONTRACTOR TO CUT AND MOVE ANY EXISTING PRIVATE WATERLINES WITHIN THE LIMIT OF CONSTRUCTION THAT WOULD PROHIBIT WORK. THESE WATERLINES SHALL BE ABANDONED IN PLACE. THESE ARE NOT PUBLIC WATER LINES.
  - CONTRACTOR IS TO UTILIZE EXISTING PIPES WHEN POSSIBLE FOR TEMPORARY PIPES MAY BE USED WHEN EXISTING PIPES ARE NOT ABLE TO BE USED.
- UTILITY COMPANIES AND CONTACTS**
- A. AEP PHONE: 1-800-982-4237
  - B. CSX CORPORATION PHONE: 1-804-359-3200
  - C. LOGAN COUNTY PSD PHONE: 1-304-948-2841
  - D. SOUTHERN PSD PHONE: 1-304-752-2757
  - E. VERIZON PHONE: 1-800-837-4866
  - F. WYDOH-DISTRICT 2 PHONE: 1-304-528-5825

**NOTE:**  
PROPERTY LINES SHOWN ON THIS MAP WERE TAKEN FROM TAX MAPS AND PAID ROAD VAL MAPS ONLY. NO FIELD SURVEY WAS PERFORMED TO VERIFY ACTUAL PROPERTY LINE LOCATIONS.

**NOTE:**  
CONTRACTOR SHALL CONSTRUCT A GROUDED RIPRAP HEADWALL FOR CHANNEL 'A', CONSISTING OF THE TYPE ROCK SPECIFIED IN THE CHANNEL 'A' ISLAND CREEK TIE-IN DETAIL L-11. THE HEADWALL WILL INCLUDE THE EXISTING 18" CMP AND REPLACE EXISTING WOOD RETAINING WALL STRUCTURE AND EXTEND AND CONNECT WITH THE EXISTING CONCRETE RETAINING WALL. THE TOP OF THE GROUDED RIPRAP HEADWALL WILL BE CONSTRUCTED TO THE ELEVATION OF THE EXISTING CONCRETE RETAINING WALL.

**NOTE:**  
NO SOIL BORROW AREAS ARE DESIGNATED ON THIS SITE. ADDITIONAL MATERIAL IS REQUIRED FOR THE BACKFILL OF MINE SEALS WATERPILL TM 67. EXCAVATION OF THE SEALS MAY BE USED.

**NOTE:**  
CONTRACTOR TO SAVE AND PLACE TOPSOIL ON TOP OF ALL FILL MATERIAL. SOIL COVER FOR THE SLIDE DISPOSAL AREA WILL BE REQUIRED IF THE DISPOSAL MATERIAL CONTAINS LARGE AMOUNTS OF REDDUG OR REUSE. LIMIT OF CONSTRUCTION

**NOTE:**  
SLIDE AND EXCESS MATERIAL WASTE AREA. SLOPES SHALL BE NO STEEPER THAN 2:1 AND SHALL BE SEEDDED.

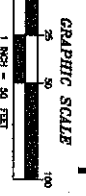
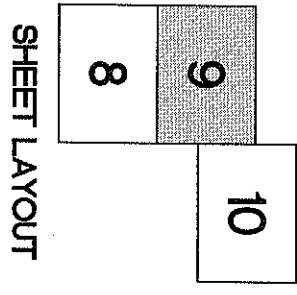
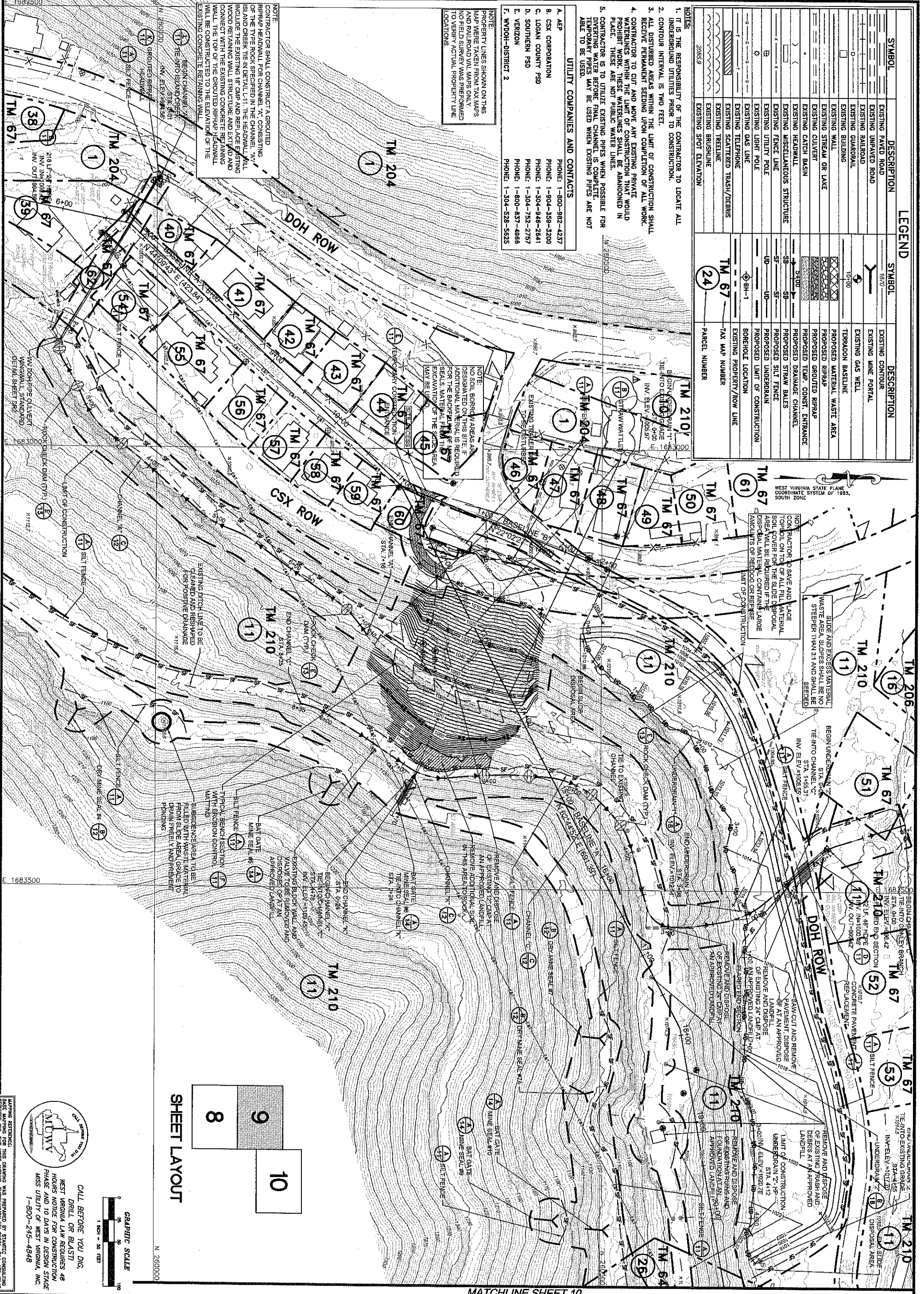

**CALL BEFORE YOU DIG,  
DRILL OR BLAST!**  
WEST VIRGINIA LAW REQUIRES 48 HOURS NOTICE FOR CONSTRUCTION PHASE AND 10 DAYS IN DESIGN STAGE MISS UTILITY OF WEST VIRGINIA, INC. 1-800-245-4848

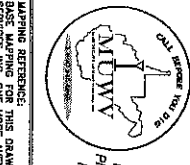

Mapping reference: THIS DRAWING WAS PREPARED BY STATISTICAL CONSULTING SERVICES INC. ONE MORE AVENUE, ROCKWELL, WV 26001. 304-477-7740. FOR A LIST OF THE STATE'S LICENSED SURVEYORS, VISIT WWW.SURVEYORS.WV.GOV.

<b>WEST VIRGINIA DEPARTMENT OF ENVIRONMENTAL PROTECTION</b> OFFICE OF ABANDONED MINE LANDS AND RECLAMATION	<b>TERRADON CORPORATION</b> Engineering • Surveying • Landscape Architecture P.O. Box 519 Nitro, West Virginia 25143 (304) 755-8291 FAX 755-2636 www.terradon.com	NO. DATE REVISION 8/6/10 REPLACE STRAW BALES WITH STRAW WATTLES
		<b>TAX MAP OVERLAY</b> SARAH ANN (VANCE) DRAINAGE LOGAN COUNTY, WEST VIRGINIA

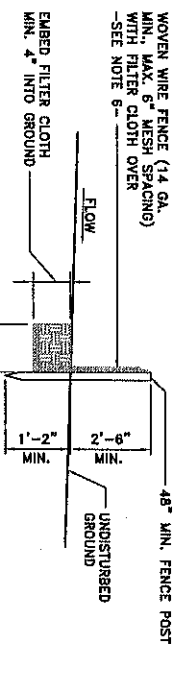
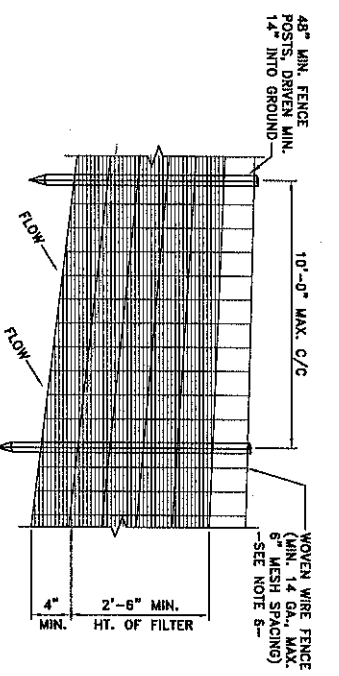

- NOTES:**
1. WOVEN WIRE FENCE TO BE FASTENED SECURELY TO FENCE POSTS WITH WIRE OR STAPLES.
  2. FILTER CLOTH TO BE FASTENED SECURELY TO WOVEN WIRE FENCE WITH TIES SPACED AT TOP AND MID SECTION.
  3. WHEN TWO SECTIONS OF FILTER CLOTH ADJOIN EACH OTHER THEY SHALL BE OVERLAPPED BY SIX INCHES AND FOLDED.
  4. MAINTENANCE SHALL BE PERFORMED AS NEEDED AND MATERIAL SHOULD BE CHECKED AFTER EACH STORAGE EVENT. SILT FENCE SHALL BE CHECKED AFTER EACH STORAGE EVENT.
  5. POSTS SHALL BE CONSTRUCTED OF STEEL, EITHER "I" OR "U" TYPE, OR 2" HARDWOOD.
  6. FENCE SHALL BE WOVEN WIRE, 14 GAUGE, 6" MAX. MESH OPENING.
  7. FILTER CLOTH SHALL BE "FILTER X", "MIRAFI 100X", "LINKA 1140N", "EXXON GF 180" OR APPROVED EQUAL.

**A SILT FENCE DETAIL**  
11 NO SCALE

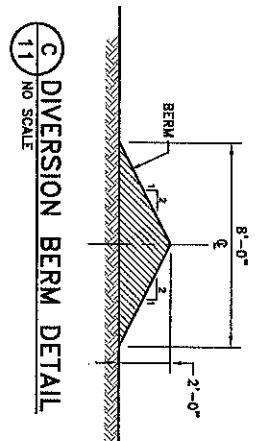

**C DIVERSION BERM DETAIL**  
11 NO SCALE

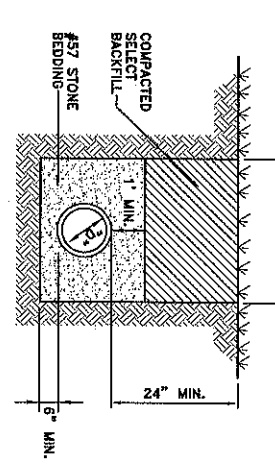

**D PIPE BEDDING DETAIL**  
11 NO SCALE

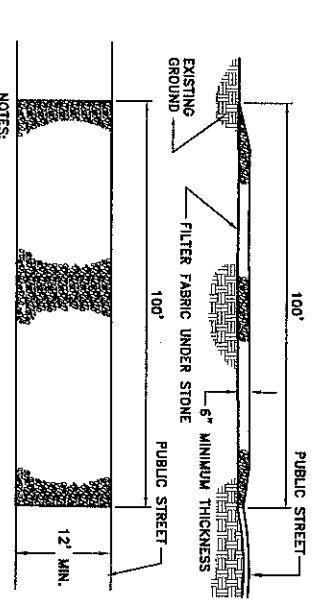

**E TEMPORARY CONSTRUCTION ENTRANCE DETAIL**  
11 NO SCALE

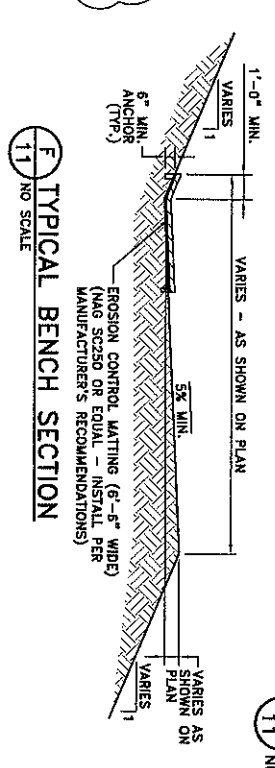

**F TYPICAL BENCH SECTION**  
11 NO SCALE

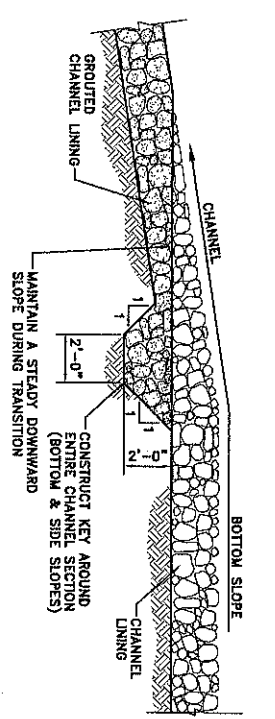

**G GROUED CHANNEL TRANSITION DETAILS**  
11 NO SCALE

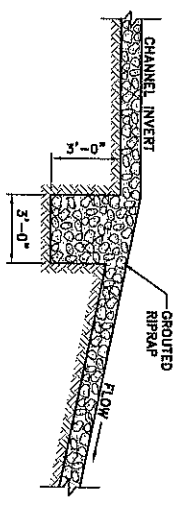

**H GROUED RIPRAP ANCHOR DETAIL**  
11 NO SCALE

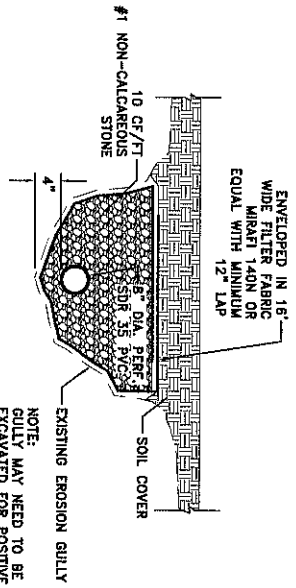

**I UNDERDRAIN DETAIL**  
11 NO SCALE

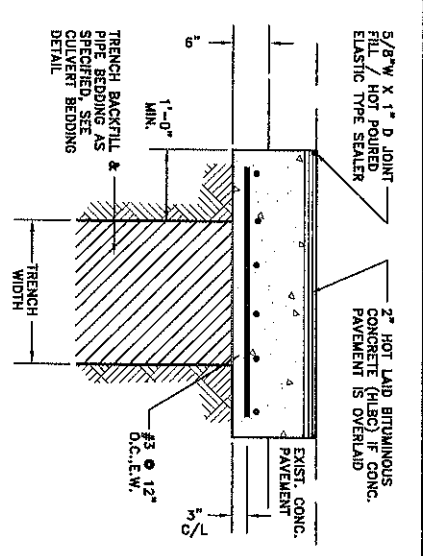

**J CONCRETE PAVEMENT REPLACEMENT DETAIL**  
11 NO SCALE

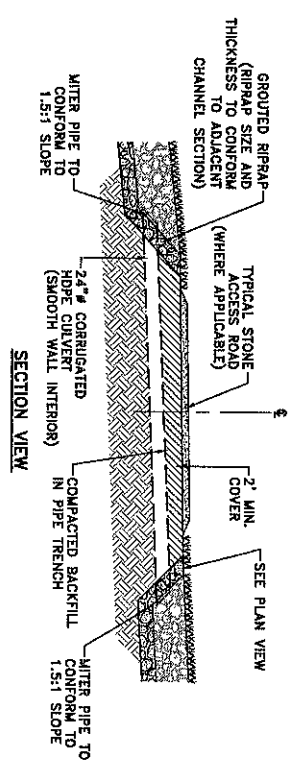

**K GROUED RIPRAP HEADWALL DETAIL**  
11 NO SCALE

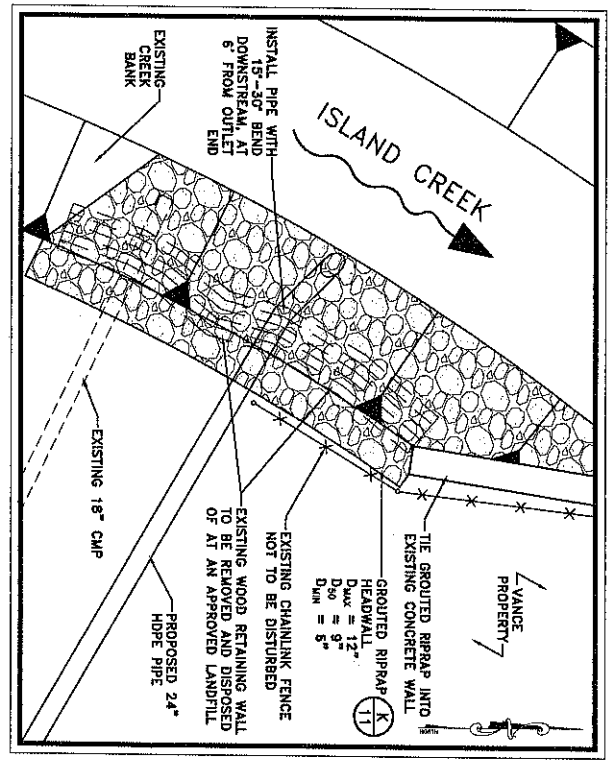

**L CHANNEL "A" ISLAND CREEK TIE-IN DETAIL**  
11 NO SCALE

WEST VIRGINIA DEPARTMENT OF ENVIRONMENTAL PROTECTION  
OFFICE OF ABANDONED MINE LANDS AND RECLAMATION

MISCELLANEOUS DETAILS  
SARAH ANN (VANCE) DRAINAGE  
LOGAN COUNTY, WEST VIRGINIA

**TERRADON CORPORATION**  
Engineering • Surveying • Landscape Architecture  
P.O. Box 519  
Nitro, West Virginia 25143  
(304) 755-8291 FAX 755-2636  
www.terradon.com

NO.	DATE	REVISION
Δ	8/8/10	REPLACE STRAW BALES WITH STRAW WATTLES

Project No. 09056-0038  
Drawn: KLS  
Checked: TTV  
Appr'd: JMJ  
Scale: AS NOTED  
Date: 5-14-10  
CAD File # 09056-0038-05

**BACKFILL NOTES:**  
 ENTRY STABILIZATION SHALL BE ACCOMPLISHED BY BACKFILLING WITH 1"-4" NON-CALCAREOUS STONE. BACKFILLING SHALL OCCUR AFTER INSTALLATION OF DRAIN IS ACCEPTED BY THE ENGINEER.  
 THE ENTRY SHALL BE FILLED WITH 1"-4" STONE TO A DEPTH ALLOWING A MINIMUM OF 6 LINEAR FEET OF CONTACT WITH THE MINE ROOF OR TOP OF COAL SEAM.  
 AFTER ACCEPTANCE OF BACKFILLING BY THE ENGINEER, THE MINE SHALL BE INSTALLED AND THE ENTIRE AREA BACKFILLED, GRADED, SEEDED AND MULCHED.

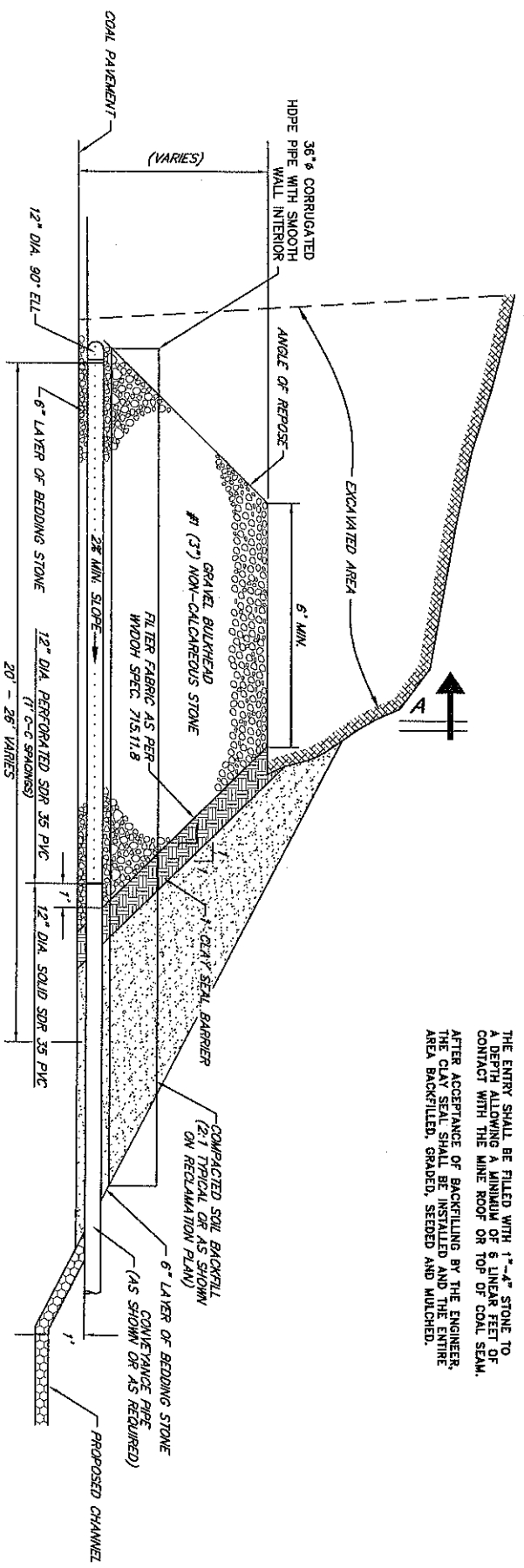

TYPICAL SECTION

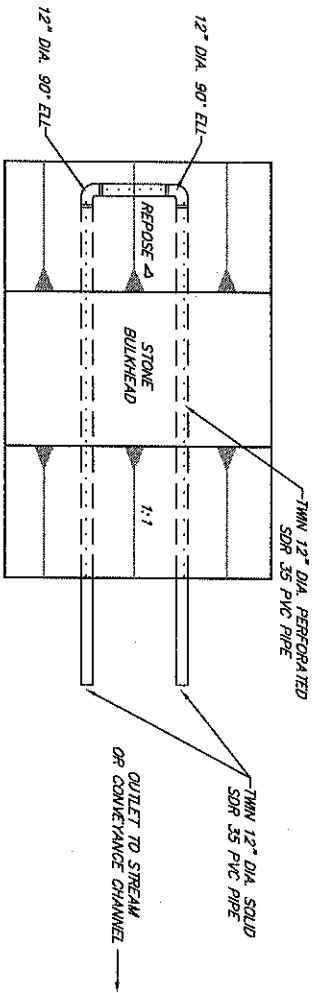

PLAN

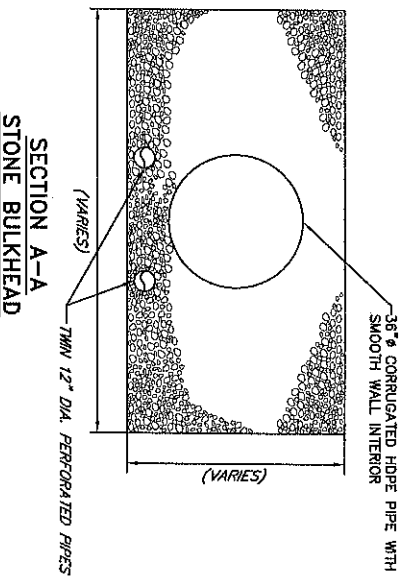

SECTION A-A  
STONE BULKHEAD

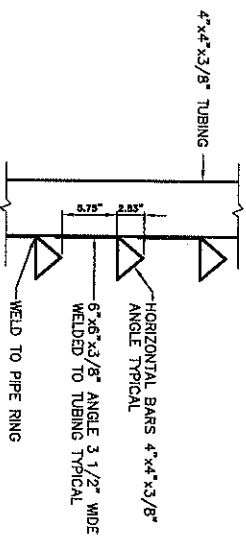

SECTION VIEW

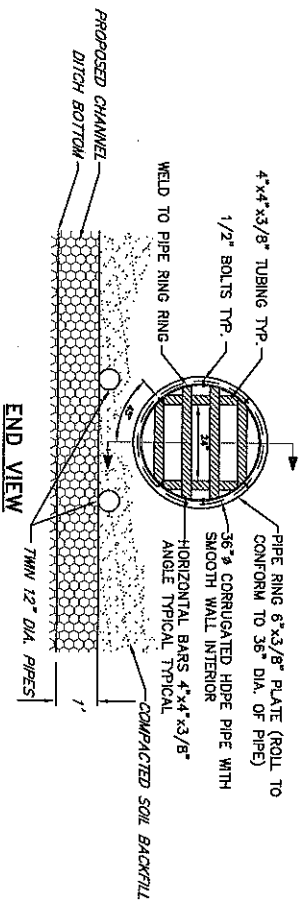

END VIEW

**A** BAT GATE MINE SEAL DETAIL  
 1/4" NO SCALE

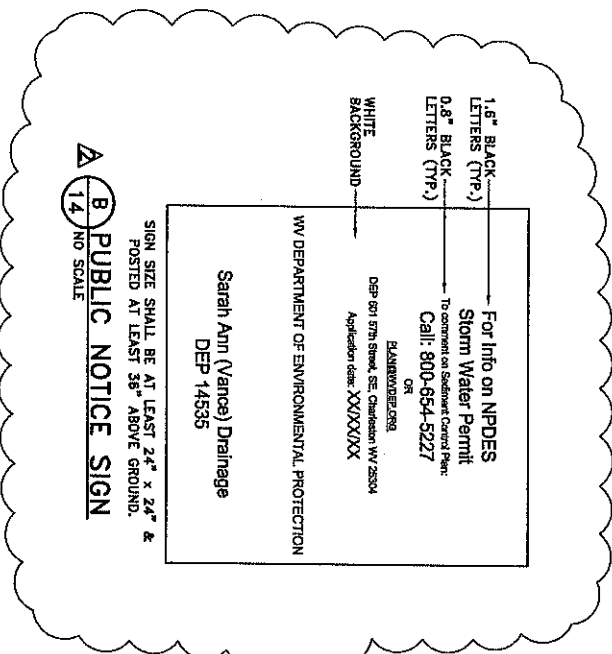

**B** PUBLIC NOTICE SIGN  
 1/4" NO SCALE

WEST VIRGINIA DEPARTMENT OF ENVIRONMENTAL PROTECTION OFFICE OF ABANDONED MINE LANDS AND RECLAMATION	
MISCELLANEOUS DETAILS SARAH ANN (VANCE) DRAINAGE LOGAN COUNTY, WEST VIRGINIA	

**TERRADON CORPORATION**  
 Engineering • Surveying • Landscape Architecture  
 P.O. Box 519  
 Nitro, West Virginia 25143  
 (304) 755-8291 FAX 755-2636  
 www.terradon.com

NO.	DATE	REVISION
1	8/6/10	ADDED PUBLIC NOTICE SIGN

Product No.	09056-0036
Client	KLS
Checked	TTW
Approved	JWI
Scale	AS NOTED
Date	5-14-10
CAD File #	09056-0036-05