



State of West Virginia
Department of Administration
Purchasing Division
2019 Washington Street East
Post Office Box 50130
Charleston, WV 25305-0130

Request for Quotation

RFQ NUMBER
COR61418

PAGE
1

ADDRESS CORRESPONDENCE TO ATTENTION OF
JOHN ABBOTT 304-558-2544

RFQ COPY
TYPE NAME/ADDRESS HERE

V
E
N
D
O
R

SHIP
T
O

ANTHONY CORRECTIONAL CENTER
BOX N-1, HC 70
ROUTE 92 (NEOLA)
WHITE SULPHUR SPRINGS, WV
24986 304-536-4151

DATE PRINTED	TERMS OF SALE	SHIP VIA	F.O.B.	FREIGHT TERMS
07/06/2009				

BID OPENING DATE: 07/16/2009 BID OPENING TIME 01:30PM

LINE	QUANTITY	UOP	CAT NO	ITEM NUMBER	UNIT PRICE	AMOUNT
ADDENDUM #02						
THIS ADDENDUM IS ISSUED TO MODIFY, CLARIFY, AND ADD TO THE ORIGINAL REQUEST FOR QUOTATION SPECIFICATIONS, PER THE ATTACHED DOCUMENTATION; AND TO EXTEND THE BID OPENING DATE TO 7/16/2009.						
REVISED BID OPENING DATE: 7/16/2009; 1:30 PM						
001	1	LS	890-15	WATER TREATMENT SYSTEMS, COMPLETE (CHEMICAL)		
***** THIS IS THE END OF RFQ COR61418 ***** TOTAL:						

SEE REVERSE SIDE FOR TERMS AND CONDITIONS

SIGNATURE	TELEPHONE	DATE
TITLE	FEIN	ADDRESS CHANGES TO BE NOTED ABOVE

WHEN RESPONDING TO RFQ, INSERT NAME AND ADDRESS IN SPACE ABOVE LABELED 'VENDOR'

GENERAL TERMS & CONDITIONS
REQUEST FOR QUOTATION (RFQ) AND REQUEST FOR PROPOSAL (RFP)

1. Awards will be made in the best interest of the State of West Virginia.
2. The State may accept or reject in part, or in whole, any bid.
3. All quotations are governed by the *West Virginia Code* and the *Legislative Rules* of the Purchasing Division.
4. Prior to any award, the apparent successful vendor must be properly registered with the Purchasing Division and have paid the required \$125 fee.
5. All services performed or goods delivered under State Purchase Order/Contracts are to be continued for the term of the Purchase Order/Contracts, contingent upon funds being appropriated by the Legislature or otherwise being made available. In the event funds are not appropriated or otherwise available for these services or goods, this Purchase Order/Contract becomes void and of no effect after June 30.
6. Payment may only be made after the delivery and acceptance of goods or services.
7. Interest may be paid for late payment in accordance with the *West Virginia Code*.
8. Vendor preference will be granted upon written request in accordance with the *West Virginia Code*.
9. The State of West Virginia is exempt from federal and state taxes and will not pay or reimburse such taxes.
10. The Director of Purchasing may cancel any Purchase Order/Contract upon 30 days written notice to the seller.
11. The laws of the State of West Virginia and the *Legislative Rules* of the Purchasing Division shall govern all rights and duties under the Contract, including without limitation the validity of this Purchase Order/Contract.
12. Any reference to automatic renewal is hereby deleted. The Contract may be renewed only upon mutual written agreement of the parties.
13. **BANKRUPTCY:** In the event the vendor/contractor files for bankruptcy protection, the State may deem this contract null and void, and terminate such contract without further order.
14. **HIPAA BUSINESS ASSOCIATE ADDENDUM:** The West Virginia State Government HIPAA Business Associate Addendum (BAA), approved by the Attorney General, and available online at the Purchasing Division's web site (<http://www.state.wv.us/admin/purchase/vrc/hipaa.htm>) is hereby made part of the agreement. Provided that, the Agency meets the definition of a Cover Entity (45 CFR §160.103) and will be disclosing Protected Health Information (45 CFR §160.103) to the vendor.
15. **WEST VIRGINIA ALCOHOL & DRUG-FREE WORKPLACE ACT:** If this Contract constitutes a public improvement construction contract as set forth in Article 1D, Chapter 21 of the West Virginia Code ("The West Virginia Alcohol and Drug-Free Workplace Act"), then the following language shall hereby become part of this Contract: "The contractor and its subcontractors shall implement and maintain a written drug-free workplace policy in compliance with the West Virginia Alcohol and Drug-Free Workplace Act, as set forth in Article 1D, Chapter 21 of the West Virginia Code. The contractor and its subcontractors shall provide a sworn statement in writing, under the penalties of perjury, that they maintain a valid drug-free work place policy in compliance with the West Virginia and Drug-Free Workplace Act. It is understood and agreed that this Contract shall be cancelled by the awarding authority if the Contractor: 1) Fails to implement its drug-free workplace policy; 2) Fails to provide information regarding implementation of the contractor's drug-free workplace policy at the request of the public authority; or 3) Provides to the public authority false information regarding the contractor's drug-free workplace policy."

INSTRUCTIONS TO BIDDERS

1. Use the quotation forms provided by the Purchasing Division.
2. **SPECIFICATIONS:** Items offered must be in compliance with the specifications. Any deviation from the specifications must be clearly indicated by the bidder. Alternates offered by the bidder as **EQUAL** to the specifications must be clearly defined. A bidder offering an alternate should attach complete specifications and literature to the bid. The Purchasing Division may waive minor deviations to specifications.
3. Complete all sections of the quotation form.
4. Unit prices shall prevail in case of discrepancy.
5. All quotations are considered F.O.B. destination unless alternate shipping terms are clearly identified in the quotation.
6. **BID SUBMISSION:** All quotations must be delivered by the bidder to the office listed below prior to the date and time of the bid opening. Failure of the bidder to deliver the quotations on time will result in bid disqualifications: Department of Administration, Purchasing Division, 2019 Washington Street East, P.O. Box 50130, Charleston, WV 25305-0130



ADDENDUM NO. 2 COR61418

Date: June 29, 2009

Project: ANTHONY CORRECTIONAL CENTER
POTABLE WATER TREATMENT PLANT

Architect: Silling Associates, Inc.
405 Capitol Street, Upper Atrium
Charleston, WV 25301

Engineer: GAI Consultants, Inc.
500 Summers Street, 3rd floor
Charleston, WV 25301

Owner: WV Division of Corrections

The following amendments, addenda, additions and deletions shall be made to the contract documents titled as above. Insofar as the contract documents are at variance with Addendum Number One, this Addendum shall govern. Bidders shall acknowledge receipt of the Addendum on the Bid Form included in the Project Manual.

QUESTIONS & CLARIFICATIONS

- Q1: In spec section 1010, the summary speaks of a "42 GPM treatment plant influent pump station"; there are no drawings or specs for this. Can these be provided?
- A1: This is called out in the drawings as "Influent Booster Pump" on sheet C-8. It is not a pump station.

Q2: Can the engineer provide any additional building drawings and/or specs for footers and elevation, etc...The same is also needed for the tank foundation?

A2: **Building:**

Additional drawings supplied by Carr Concrete for the building and building footers are attached. This building or an approved equivalent shall be utilized. Specification 03010 Pre-Cast Concrete Building is attached.

Tank:

The tank foundation shall be designed by the tank manufacturer and submitted to the owner for review. The tank foundation shall be designed for an allowable bearing capacity of at least 2000 psf or recommended bearing capacity from the tank manufacturer. The potable water tank is to meet all AWWA standards governing tank design and erection. Specification 02515 Water Storage Tank.

Note No. 1:

Any trees that must be removed during construction shall be stacked in a location designated by owner's representative. Trees shall not leave the site.

Note No. 2

All building materials and debris shall be sent to a landfill offsite. No materials shall be buried or burned onsite.

Note No. 3

There shall be no soils hauled on or off the site

Note No. 4

See Attachment No. 1 Two (2) 6-inch steel pipes for drainage crossing the tank service road and the water plant entrance drive. The pipe is to have a minimum 0.25-inch wall thickness and is to be backfilled with AASTO #8 Stone or Sand.

Note No. 5

On the Index Sheet of the Project Manual section 02660 is Water Treatment Plant not "Waste Water Treatment Plant"

Note No. 6

All Equipment that is pertinent to the operation of the current potable water system is to be relocated to the new building and located where shown on drawings or as designated by owner's representative.

Note No. 7

A conduit for the Electronic Float Sensor in the Water Storage Tank will need to be ran along the 2-inch outflow line from the tank to the plant and connected to the Telemetry Control Panel to control the Existing Well Pumps.

SECTION 03010 – PRE-CAST CONCRETE BUILDING

PART 1 – GENERAL

1.1 RELATED DOCUMENTS

- A Drawings and general provisions of the Contract, including General and Supplementary Conditions and Division 1 Specification Sections, apply to this Section.
- B Section 02300 – Earthwork for subgrade preparation
- C Section 03300 – Cast In Place Concrete

1.2 SUMMARY

- A This Section includes general guidelines for the precast concrete building:
 - 1 Layout
 - 2 Loading Considerations
 - 3 Amenities
 - 4 Warranty

1.3 SUBMITTALS

- A Product Data: For the following:
 - 1 HVAC System
 - 2 Water Heater
 - 3 Electrical and Panels
 - 4 Rollup Door
 - 5 Other Miscellaneous Building Products
- B Shop Drawings & Cut Sheets: For the following:
 - 1 Pre-Cast Building Drawings and Details stamped by a licensed WV Structural Engineer.
- C Field Quality-Control Test Reports: From Contractor
- D Operation and Maintenance Data:
 - 1. Building Products

1.4 QUALITY ASSURANCE

- A. Regulatory Requirements:
 - 1 Comply with requirements of the Architect for (Anthony Correctional Facility)

2 Comply with standards of authorities having jurisdiction for West Virginia building codes.

B Materials shall bear label, stamp, or other markings of specified testing agency as needed.

1.5 DELIVERY, STORAGE, AND HANDLING

1. Mobilization, delivery and erection of the building shall be the responsibility of the contractor
- 2 All permits needed for the building transporting the building shall be the responsibility of the contractor

1.6 PROJECT CONDITIONS

A Existing Utilities: The Contractor shall not interrupt access or utilities serving existing facilities occupied by Owner or others unless permitted under the following conditions and then only after arranging to provide temporary utility services according to requirements indicated:

- 1 Notify Owner Huttonsville Correctional Facility not less than two weeks in advance of proposed utility interruptions
- 2 Do not proceed with utility interruptions without owner's written permission

1.7 COORDINATION

A Coordinate with owner's representative and onsite personnel for unloading and storage are

PART 2 – PRODUCTS

2.1 Building shall be precast construction as designed by CARR CONCRETE CORPORATION or approved equal

2.2 All Electrical components to meet specification 16051.

2.3 All lighting fixtures interior and exterior shall be approved by the owner prior to installation See drawings for lighting description

PART 3 – EXECUTION

3.1 SITE CONSTRUCTION

- A All site grades shall be verified by the contractor prior to construction and after construction
- B Site clearing and subgrade preparation are the responsibility of the contractor.
- C Building Erection shall be in a manner that is directed by the building manufacturer
- D The building shall be weatherproofed by the contractor by caulking or other approved methods

- E Exterior of the building shall be treated by a sealant to prevent water absorption and freeze-thaw damage
- F All drainage shall be directed away from the building

3.8 FIELD QUALITY CONTROL

- A All panels will be inspected by the owner's representative prior to placement
- C Prepare reports of any testing activities.

PART 4 - WARRANTY

The Building warranty shall be at least five (5) years and shall cover against defects in the concrete building material or workmanship. Any defective construction shall be repaired or replaced at the cost of the contractor.

All non-building components shall be to have a one (1) year warranty. Defective components shall be repaired or replaced at the cost of the contractor.

END OF SECTION 03010



CARR CONCRETE Subsidiary of R. W. Sidley, Inc.

CARR CONCRETE CORPORATION
P.O. Box 265, Waverly, WV 26184-0265
Phone: 800-837-8918 or 304-464-4441 Fax: 304-464-4013
www.carrconcrete.com

SPECIFICATIONS

Revised June 2004

NAME: DOUBLE OPEN FLOOR UTILITIES ENCLOSURE
MODEL: CCC-UES-116206 (2 each)
SIZE: 23'-0" X 20'-6" X 10'-10" (together)

Anthony Correctional Center, Neola, WV

STRUCTURAL CONSTRUCTION DETAILS

- 1 **Panel Type Construction:** Each building is fabricated of Four (4) solid, one-piece concrete panels, one (1) floor panel (see Detail #4) and one open wall. Panels are bolted together and joints caulked inside and out to make the building weatherproof.
- 2 **Wall Panels:** The three (3) walls are 3" thick solid panels of concrete with primary structural reinforcement of steel bar and welded wire fabric.
- 3 **Roof Panel:** The roof is a 4" thick concrete panel which extends 2" over the walls to act as a drip edge. The roof has primary reinforcement of steel bar and welded wire fabric as well as secondary reinforcement of polypropylene fibers. In addition, the roof is post-tensioned through the use of an internal tensioning cable for additional protection against cracking and checking. No additional roof coatings are required to make the building weatherproof.
- 4 **Floor Panel:** The floor panel is a 6" thick perimeter floor, 1'-0" wide with steel channel inside and outside with concrete between two channels to form perimeter floor. Primary reinforcing is structural reinforcing bar.
- 5 **Panel Connections:** The panels are bolted together with 1/4" thick steel brackets and 2" coil thread bolts. The steel brackets are cold galvanized to resist rusting.
- 6 **Structural Loadings:** The standard roof loading is 30 psf. The standard wind load is 27 psf (103 mph). Higher loadings for roof and wind are optional.
- 7 **Preassembly:** Standard procedures are for the completely assembled building to arrive at the jobsite on a tractor trailer. The building is then lifted from the trailer and set in place with a crane. Carr Concrete can economically make arrangements for freight and crane unloading or the customer can provide these services.
- 8 **Warranty of structural integrity:** Carr Concrete shall provide a warranty against defects in material or workmanship for a period of five (5) years on all concrete components manufactured at our Waverly, WV location. The warranty is valid only when concrete is used within the specified loadings. Furthermore, said warranty includes only the related material necessary for the construction and fabrication of said concrete components. If found defective, Carr Concrete Corporation will, at its option, repair or replace any concrete component of the building. Upon receipt and approval of the delivered building – troubleshooting, installation, repair and shipping are the responsibility of the end user, unless otherwise agreed upon in writing between Carr Concrete and end user.

Non-concrete components are defined as any item not manufactured by Carr Concrete and include, but are not limited to, the following categories: electrical equipment, interior finishing, flooring, air circulation, security or entry. Any non-concrete component found to be defective shall be covered by the

manufacturer's standard warranty of said non-concrete component. All troubleshooting, installation, repair and shipping of non-concrete components are the responsibility of the end user.

ARCHITECTURAL DETAILS

- 1 **Dimensions:** Outside dimensions are 10'-10" high, 23'-0" wide and 20'-6" long except for the roof which extends over the walls 2" on all sides. The inside dimensions (without optional interiors) are 10'-0" high, 22'-6" wide and 20'-0" long.
- 2 **Doors, Frames and Hardware:** This building comes standard with a single door, consisting of one (1) 3'-0" wide x 6'-8" x 1-3/4" 18 gauge, grade II heavy-duty metal door with polyurethane foam core. For ease in maintenance and replacement, the door frame is bolted and caulked to the wall panel. Doors are primed and painted one coat of gray enamel. Standard door hardware includes a deadbolt lock, a stainless steel pull plate, a door sweep, a 2" drip cap, a door bumper and a lockback. The door is hung with three heavy-duty, vandal-proof hinges. (A variety of doors and door options are available to meet your specific needs).
- 3 **Vents:** Passive ventilation consists of two (2) 15-5/8" x 5-1/8" fixed aluminum vents with insect screens. One vent is placed 6" from the floor and the other 6" from the ceiling.
- 4 **Caulking:** All wall-to-wall, wall-to-roof and wall-to-floor joints are caulked on both the interior and exterior surfaces for double weatherproof protection. The limestone-colored caulking is a high quality, polyurethane-based, elastomeric sealant.
- 5 **Sealer:** All exterior surfaces of the building are treated with a clear penetrating silane sealer to prevent water absorption and freeze-thaw damage.
- 6 **Lifting Points:** The building is equipped with cast-in-place lifting inserts located in the exterior edge of the floor. These remain as part of the building and can be used later to lift or relocate the building.
- 7 **Weight:** The building weight (each) without options is approximately 45,000 pounds.
- 8 **Finishes:** An exposed aggregate finish of light Indiana limestone is standard.
- 9 **Drawings:** Carr will furnish CAD drawings for your approval. The customer must approve drawings before manufacturing will begin. Prices do not include any documentation other than standard drawings, packing lists and invoices. Special documentation, reports or submittals can be supplied at an additional cost. If additional engineering, engineer seals, state approvals, drawings or insignias are required by local authorities or others for permitting or other purposes, an additional cost is required pending availability of the particular item.
- 10 **Site preparation:** To minimize the cost of site preparation, Carr buildings are designed to be installed on a pad of crushed stone. The buildings can also be set on level footer foundations or slab type foundations if needed.

Note: We may be able to leave the floors intact and leave holes for the pipe penetrations if the client desires. This may be dependent on engineering and our ability to get the buildings to location without cracking the floors.

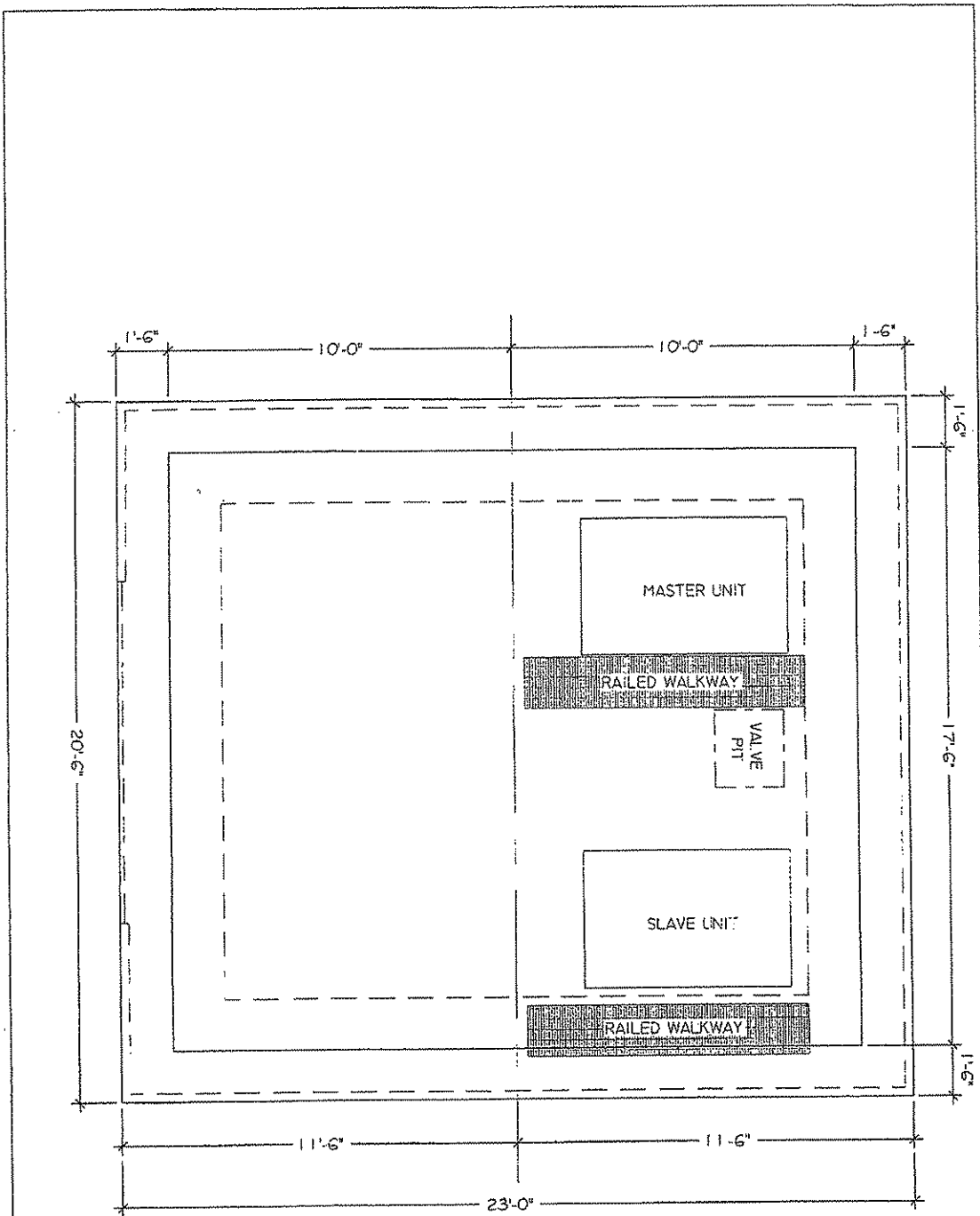

<div> <div>1 of 3</div> <div> <div>FOUNDER</div> <div>DATE</div> <div>BY</div> <div>CHK</div> <div>APP</div> </div> </div>	<div> <div>WEST VIRGINIA DEPARTMENT OF CORRECTIONS</div> <div>ANTHONY WATERPLANT</div> <div>NEOLA, WEST VIRGINIA</div> <div>PERIMETER FOUNDATION DETAIL</div> <div>20'-6" X 10'-9"</div> </div>	<div> <div>  <div> <div>CARR CONCRETE</div> <div>SUBSIDIARY OF R.W. SIDLEY, INC.</div> </div> </div> </div>	<div> <div>CARR CONCRETE CORPORATION</div> <div>P.O. BOX 265</div> <div>WAVELEY WV 26164-0265</div> <div>PHONE (800) 637-8916</div> <div>FAX (304) 464-4013</div> </div>
--	---	--	--

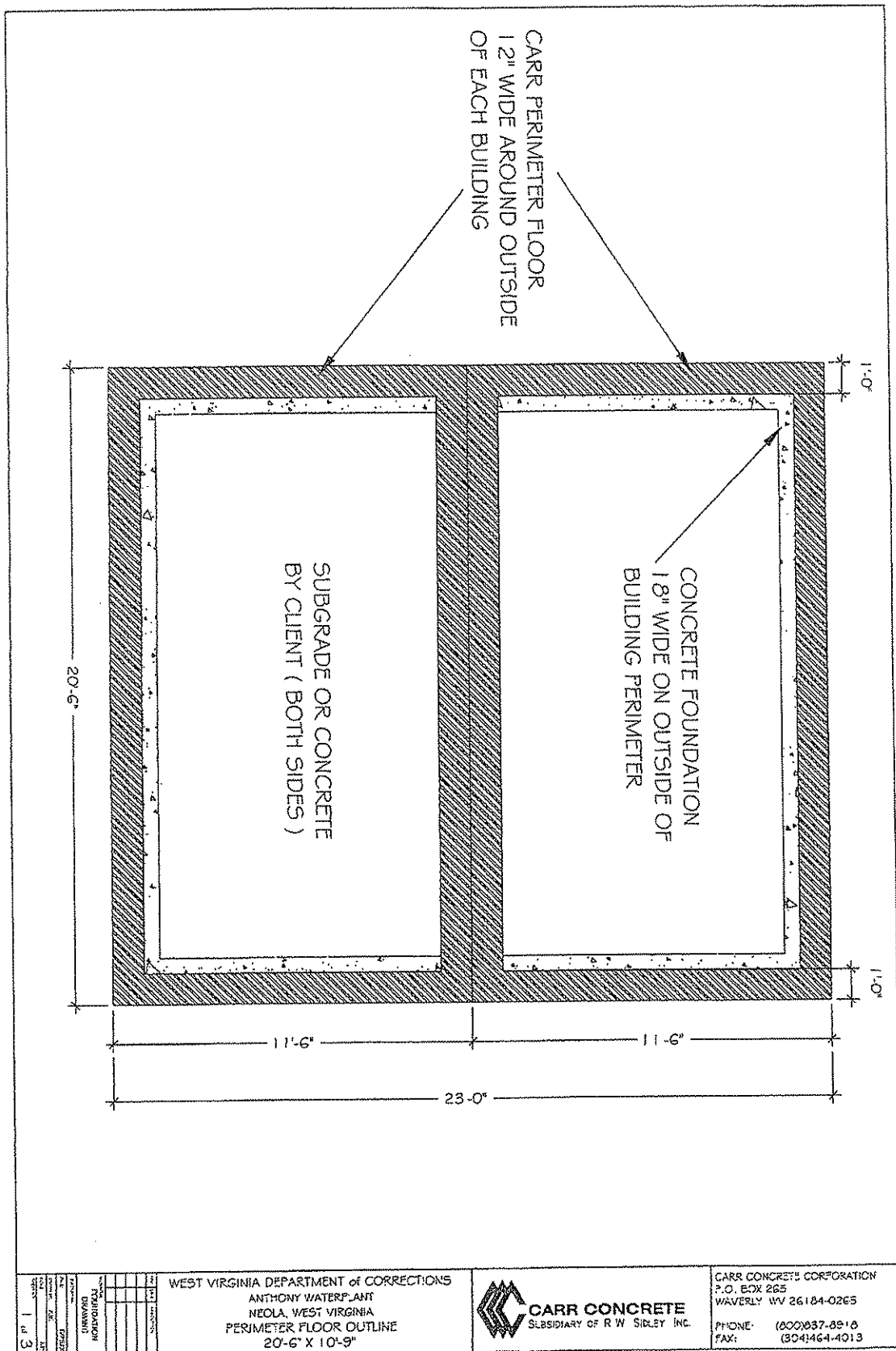

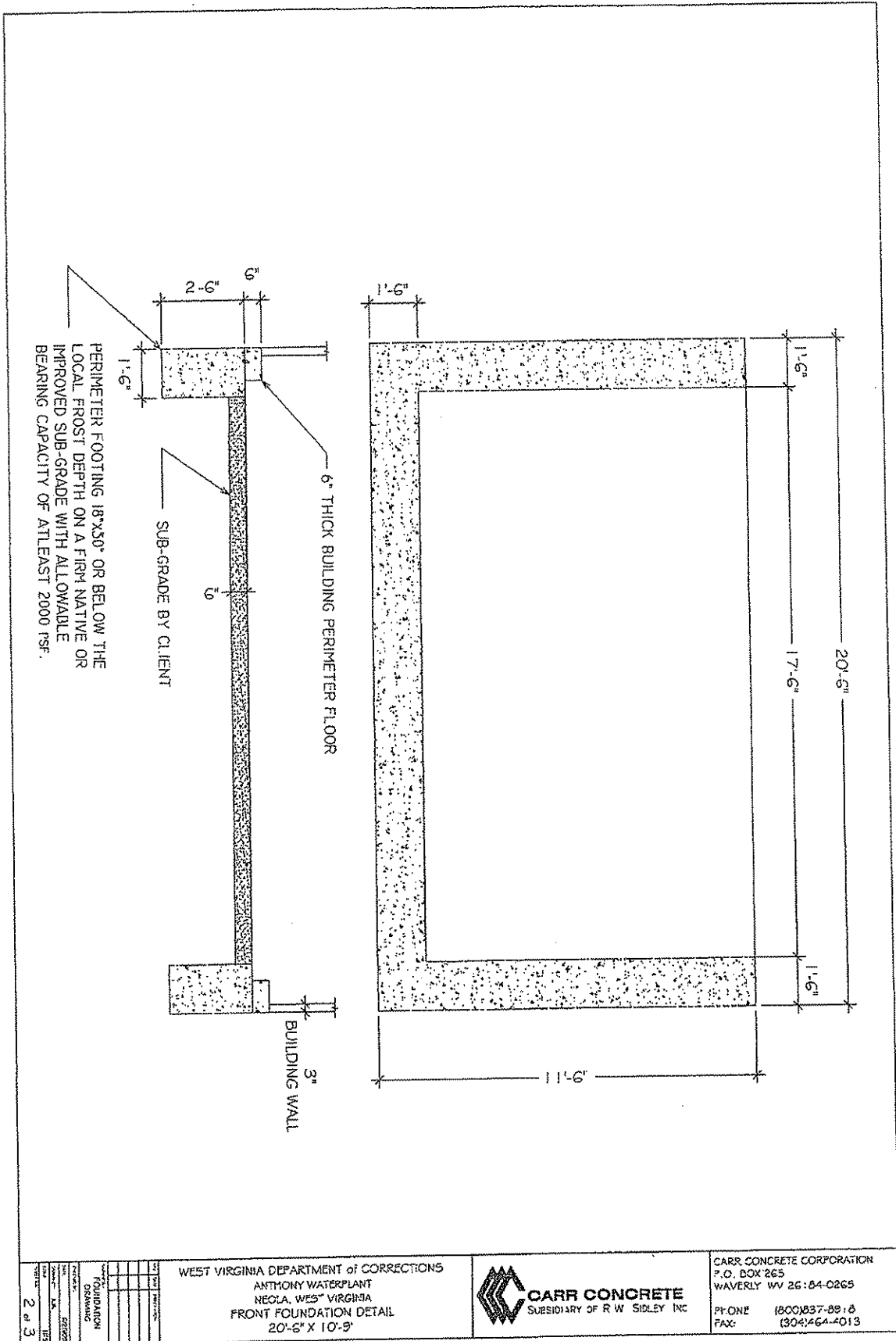

BUILDING CROSS SECTION
WHERE THEY ATTACH

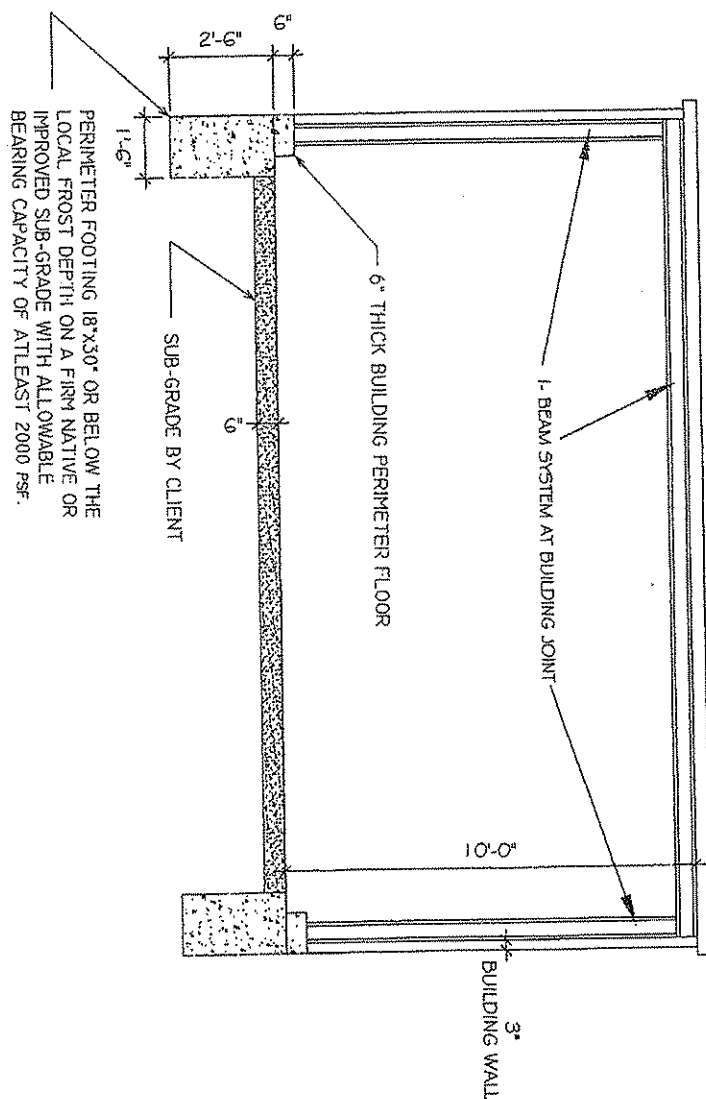

NAME	FOUNDAATION
DATE	DRAWING
BY	
CHECKED	
DATE	
BY	
CHECKED	
DATE	

2 of 3

WEST VIRGINIA DEPARTMENT of CORRECTIONS
ANTHONY WATERPIANT
NEOLA, WEST VIRGINIA
FRONT FOUNDATION DETAIL
20'-6" X 10'-9"



CARR CONCRETE
SUBSIDIARY OF R W SOLEY INC

CARR CONCRETE CORPORATION
P.O. BOX 265
WAVERLY WV 26184-0265
PHONE: (800)837-8918
FAX: (304)464-4013

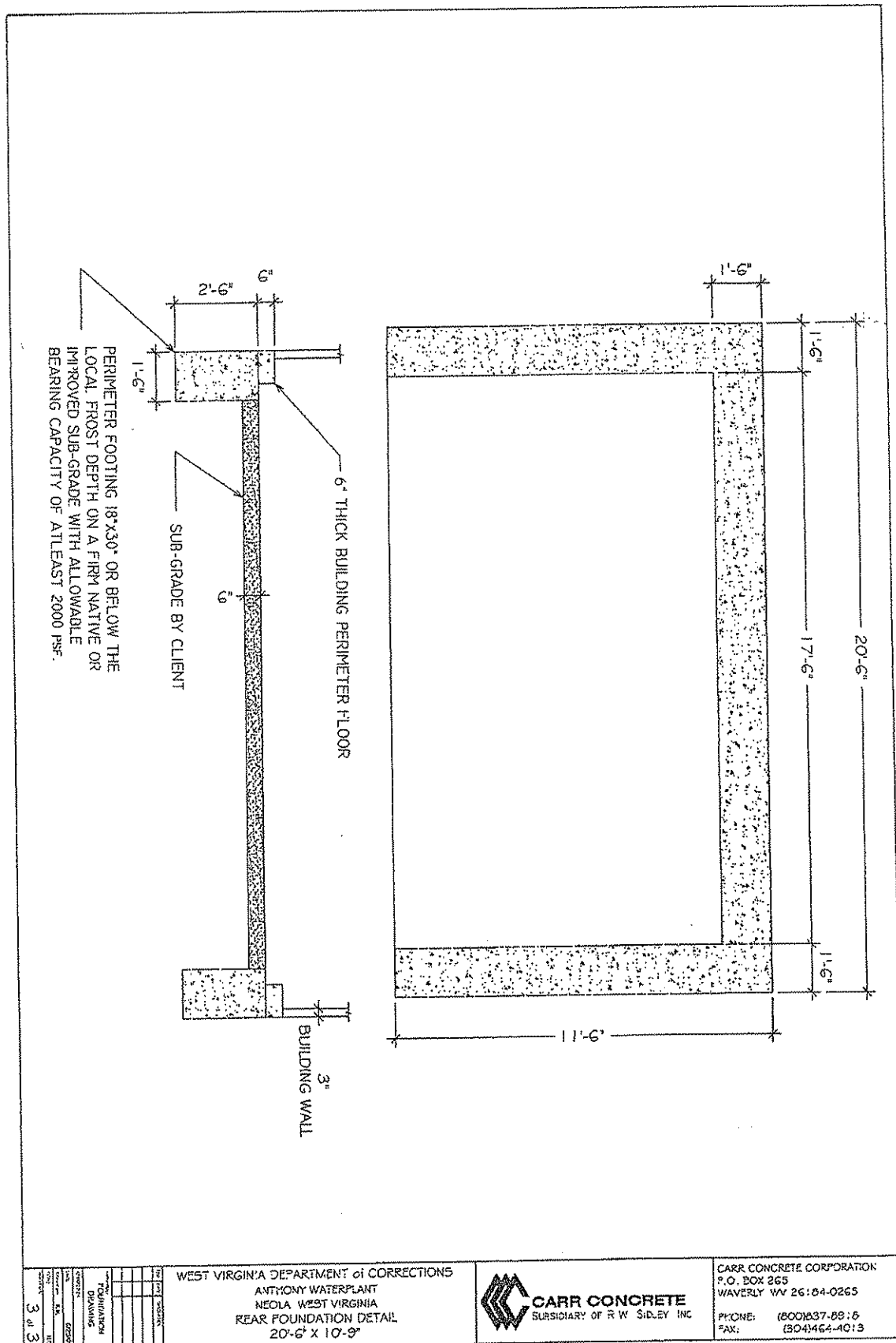

SECTION 02515 – WATER STORAGE TANK

PART 1 – GENERAL

1.1 RELATED DOCUMENTS

- A Drawings and general provisions of the Contract, including General and Supplementary Conditions and Division 1 Specification Sections, apply to this Section

1.2 SCOPE OF WORK

- A Furnish and erect bolted steel tank for potable water storage. Scope to include tank structure, foundation and tank appurtenances as shown on the contract drawings and described herein.
- B All required labor, materials and equipment shall be included.
- C Tank Manufacturer is to provide a foundation design for tank to be approved by the Owners representative.

1.3 QUALIFICATIONS

- A The contractor shall have the experience and knowledge necessary to furnish and erect the highest quality tank possible. Under no circumstances shall an inexperienced contractor be awarded the project. The contractor shall be fully responsible for the entire installation including appurtenances and the final product.
- B Strict adherence to the standards of design, fabrication, erection, product, quality, and long-term performance, established in this Specification will be required by the Owner and Owners representative.
- C The bidder shall offer a new tank structure as supplied from a manufacturer specializing in the design, fabrication and erection of bolt together tank systems. The manufacturer shall fabricate and coat the tank in the same facility which it owns and operates.

1.4 SUBMITTALS

- A The Contractor shall furnish certified copies of reports of tests or analyses of any of the materials used in the work and in accordance with applicable specifications for the material as provided in these specifications. All certificates shall be furnished and all tests and analyses required in connection therewith shall be made at the expense of the Contractor.
- B Each bidder shall furnish with his bid a drawing which shows the tank configuration which he proposes to erect, including tank diameter and height, and roof type. Prior to any construction, the Contractor shall furnish plans of the tank foundation for construction, and all fabrication drawings of the tank and appurtenances, and all equipment data, for approval by the Owners representative. Design and calculations stamped by a licensed WV Structural Engineer for the tank foundation, the tank, tank overflow, and tank vent shall also be submitted for approval. The tank overflow shall be two (2) times the diameter of the inflow pipe or as required by the Owners representative to accommodate the tank inlet line capacity.

1.5 QUALITY ASSURANCE

- A. Materials. All materials and articles furnished by the Contractor and used for installation in the work shall conform to the respective specifications or brands herein designated and in the event the materials are not specified in detail in these specifications, the materials shall conform to the best standard construction practice as determined by the Owners representative. All materials furnished shall be subject to rigid inspection and no material shall be used in the work until it has been inspected and accepted by the Owners Onsite Representative.
- B. Lines, Grades and Measures. All lines and grades will be established by the Owners representative and the Contractor shall provide him with such assistance and materials as may be required. The Contractor shall carefully preserve all survey stakes and reference points as possible. Should any stakes or points be removed or destroyed unnecessarily by any act of the Contractor or his employees, they may be reset at the Contractor's expense.
- C. The Contractor shall inform the Owners representative a reasonable length of time in advance of the times and places at which he intends to work in order that lines and grades may be furnished, that inspection may be provided, and that necessary measurements for records and payments may be made with minimum inconvenience.

1.6 DELIVERY, STORAGE, AND HANDLING

- A. All approved panels shall be protected from damage prior to packing for shipment. Heavy paper or plastic foam shall be placed between each panel to eliminate sheet-to-sheet abrasion during shipment. Individual stacks of panels will be wrapped in heavy mil black plastic and steel banded to special wood pallets built to the roll-radius of the tank panels. This procedure eliminates contact or movement of finished panels during shipment. Shipment from the factory to the site will be by truck, hauling the tank components exclusively.
- B. Handling: Use proper lifting techniques so that no panels are damaged.
- C. Protect stored materials from moisture and dirt. Elevate above grade.

1.7 PROJECT CONDITIONS

- A. Existing Utilities: Do not interrupt utilities serving facilities occupied by Owner or others unless permitted under the following conditions and then only after arranging to provide temporary utility services according to requirements indicated:
 - 1. Notify Owner Anthony Correctional Facility not less than two weeks in advance of proposed utility interruptions.
 - 2. Do not proceed with utility interruptions without owner's written permission.

1.8 COORDINATION

- A. Coordinate connection to existing water main with owner's representative and onsite personnel.

PART 2 – PRODUCTS

2.1 TANK

- A. The materials, design, fabrication and erection of bolted steel tanks shall be in accordance with the requirements of the latest revision of API (Std. 12B) Specification for Bolted Production Tanks. The tank roof shall be of steel plate supported by steel beams, and column(s) of steel pipe. All gaskets shall be made from new material, approved by the Owners representative,

suitable for use with storage of potable water. No vents will be permitted in the tank shell or roof except as required in these detailed specifications. Testing of the tank after erection shall be done in accordance with the requirements of these specifications.

- B It is the intention to use the Contractor's standard size tanks for the capacities as shown on the Bidding Sheet. The capacity of each tank shall be the rated capacity at the top of the overflow.

2.2 ACCESSORIES

- A The following items shall be furnished with the tank and fabrication in accordance with the applicable sections of the latest revision of the specifications stated herein, to be oriented as shown on the Contract Drawings or oriented in the field by the Owners representative.

- 1 Outside Tank Ladder. As per AWWA Specification D100, extending from top of tank to eight (8) feet above ground, with safety cage per District drawings.
- 2 Mechanical Float Gauge with visual level indicator mounted on the outside of the Tank.
- 3 Electronic Float Gauge with Telemetry (The three (3) existing well pumps are to be connected into Telemetry).
4. Pipe connections and penetrations are to be installed as shown.
- 5 Tank Roof System
- 6 Roof Hatch minimum 24" Square
- 7 Vent (per AWWA D100)
- 8 Tank Roof Guard Rail
- 9 Tank Access Manway

PART 3 – EXECUTION

3.1 TANK ERECTION

- A. Field erection of bolted-steel storage tank shall be in strict accordance with the procedures outlined in the manufacturer's erection manual, and performed by an authorized dealer of the tank manufacturer.
- B. Specialized erection jacks and building equipment developed and manufactured by the tank manufacturer shall be used to erect the tanks.
- C. Particular care shall be taken in handling and bolting the tank panels and members to avoid abrasion of the coating system. Prior to liquid test, all surface areas shall be visually inspected by the owner's representative.
- ~~D. An electrical leak test shall be performed during each erection using a 9-volt leak detection device. All electrical leak points found on the inside surface shall be repaired in accordance with manufacturer's published touch up procedure.~~
- E. The placement of sealant on each panel may be inspected prior to placement of adjacent panels. However, the owner's representative inspection shall not relieve the Contractor from his responsibility for liquid tightness.

3.2 HYDROSTATIC FIELD TESTING

- A After the sealant is fully cured and following the completion of erection, tank shall be tested for liquid tightness by filling the tank with water to its overflow elevation. Any leaks disclosed by this test (24 hour minimum duration) shall be corrected by the erector in accordance with the manufacturer's recommendations. Water required for testing shall be furnished by the Contractor at the time of tank erection completion and at no charge to the owner.

3.3 INSPECTION

- A All coated sheets shall be inspected for mil thickness. An electrical leak detection test shall be performed on the inside surface after fabrication of the sheet. Sheets with excessive electrical leaks shall be rejected so as to minimize field touch up. All test results shall be submitted to the owner's representative.
- B On or near the one-year anniversary date of initial tank use (but not more than 14 months from the date of delivery of tank materials to job site) and upon the request of the owner should any potential defects be discovered, the manufacturer's authorized dealer shall make a visual inspection of each tank interior coating and appurtenances; tank exterior coating and appurtenances; and the immediate area surrounding the tank. A written summary of this inspection will be filed with the owner and the tank manufacturer.

3.4 WARRANTY

- A Should the tank or any parts of the tank prove to be defective in material or workmanship upon examination by the manufacturer within a period of one year from date of completion (but not more than 14 months from date of delivery of the product to the construction site) the manufacturer will supply an identical or substantially similar replacement part or at the manufacturer's option will repair such part. The tank erector shall be responsible to replace all parts covered by this warranty at no cost to the owner.
- B If within a period of five years from date of completion of the tanks (but no more than 62 months from date of delivery of the product to the erection site) the coating on the tank chips, cracks, spalls, or under-cuts during normal service, the manufacturer shall after examination supply an identical or substantially similar replacement part, or at the manufacturer's option will repair such part. The tank erector shall be responsible to replace all parts covered by this warranty at no cost to the owner.

END OF SECTION 02515

SIGN IN SHEET

Page ____ of ____

Request for Proposal No. COR61418

PLEASE PRINT

Date: 6-16-09

* PLEASE BE SURE TO PRINT LEGIBLY - IF POSSIBLE, LEAVE A BUSINESS CARD

FIRM & REPRESENTATIVE NAME	MAILING ADDRESS	TELEPHONE & FAX NUMBERS
Company: <u>BISS MUSS INC</u>	<u>57E310</u>	PHONE <u>304-346-7531</u>
Rep: <u>TIM CANTERBURY</u>	<u>723 RAVENHAW BLVD. E.</u>	<u>TOLL FREE</u>
Email Address: <u>J.CANTERBURY@BISSMUSSINC.COM</u>	<u>CHARLESTON, W.VA 25301</u>	PHONE <u>412-405-4720</u>
Company: <u>Fenn Contracting Co Inc</u>	<u>614 Robinson Lane</u>	PHONE <u>724 222 2297</u>
Rep: <u>Clem Fenni</u>	<u>Mc Murray Pa 15317</u>	TOLL FREE
Email Address: <u>Clem@FenniCont.com</u>		FAX <u>724 222 2617</u>
Company: <u>JR Contrachy LLC</u>	<u>810 Rt 519</u>	PHONE <u>724 222 3429</u>
Rep: <u>Clem Fenni</u>	<u>Esley Pa Pa 15330</u>	TOLL FREE
Email Address: <u>Clem@FenniCont.com</u>		FAX <u>724 222 2617</u>
Company: <u>TIMS WELLS PUMP</u>	<u>RR 2 BOX 47 W</u>	PHONE <u>304-799-4884</u>
Rep: <u>TIMOTHY SPARKS</u>	<u>BUCKEYE, W.V</u>	TOLL FREE
Email Address: <u>TIMS WELLS PUMP FRONTIER.NET</u>		FAX
Company: <u>CHISLER INCORPORATED</u>		PHONE <u>304-798-3201</u>
Rep: <u>TIM SPARKS</u>	<u>DAY BROOK, W.V.</u>	TOLL FREE
Email Address: <u>MMAN@CHISLERINC.COM</u>		FAX <u>304-798-3206</u>

SIGN IN SHEET

Page _____ of _____

Request for Proposal No. CR61418Date: 6-16-07

PLEASE PRINT

* PLEASE BE SURE TO PRINT LEGIBLY - IF POSSIBLE, LEAVE A BUSINESS CARD

FIRM & REPRESENTATIVE NAME		MAILING ADDRESS	TELEPHONE & FAX NUMBERS
Company:	<u>ORDERS Construction Co., Inc.</u>		PHONE <u>304-722-4237</u>
Rep:	<u>JASON NORTON</u>		TOLL FREE
Email Address:	<u>jasonn@ordersconstruction.com</u>		FAX <u>304-201-2405</u>
Company:	<u>Hayslett Const.</u>		PHONE <u>304-757-9348</u>
Rep:	<u>David Martin</u>		TOLL FREE
Email Address:	<u>W.Hayslett@Aol.com</u>		FAX <u>304-757-9561</u>
Company:	<u>SHAMPOOK ENVIRONMENTAL</u>		PHONE <u>(336) 207-4034</u>
Rep:	<u>RAY RICE</u>		TOLL FREE
Email Address:	<u>RRICE@SHAMPOOKENV.COM</u>		FAX
Company:	<u>Multiplex</u>	<u>PO Box 505</u>	PHONE <u>304-872-6648</u>
Rep:	<u>Mary Ann Kiser</u>	<u>Summersville, WV 26651</u>	TOLL FREE
Email Address:	<u>multiplerap@yahoo.com</u>		FAX <u>304-872-1445</u>
Company:			PHONE
Rep:			TOLL FREE
Email Address:			FAX

SIGN IN SHEET

Page _____ of _____

Request for Proposal No. COR 61418

PLEASE PRINT

Date: 6-16-09

* PLEASE BE SURE TO PRINT LEGIBLY - IF POSSIBLE, LEAVE A BUSINESS CARD

FIRM & REPRESENTATIVE NAME		MAILING ADDRESS	TELEPHONE & FAX NUMBERS
Company:	<u>SNYDER ENVIRONMENTAL</u>	<u>270 INDUSTRIAL BLVD</u>	PHONE <u>304-725-9190</u>
Rep:	<u>B. LEB SNYDER</u>	<u>KERNERSVILLE WV</u>	TOLL FREE
Email Address:	<u>LEBSNYDER@CSW.NET</u>	<u>25430</u>	FAX <u>304-728-7326</u>
Company:	<u>MICHAEL MERCER SWYDER ENV</u>	<u>270 INDUSTRIAL BLVD</u>	PHONE <u>304-728-9140</u>
Rep:	<u>MICHAEL MERCER</u>	<u>KERNERSVILLE WV</u>	TOLL FREE
Email Address:	<u>mmercer@seswater.net</u>	<u>25430</u>	FAX <u>304-728-7326</u>
Company:			PHONE
Rep:			TOLL FREE
Email Address:			FAX
Company:			PHONE
Rep:			TOLL FREE
Email Address:			FAX
Company:			PHONE
Rep:			TOLL FREE
Email Address:			FAX