

NOTES:

- EXTERNAL PTZ CAMERAS AT THE FRONT OF THE MALL SHALL BE WALL-MOUNTED UNDER THE FABRIC CANOPIES.
- ALL OTHER EXTERNAL CAMERAS SHALL BE WALL-MOUNTED AS HIGH AS IS PRACTICAL.
- INTERNAL CAMERAS SHALL BE CEILING MOUNTED AT ACOUSTICAL TILE CEILINGS AND WALL-MOUNTED AT EXPOSED CEILINGS.
- INTERNAL PTZ CAMERAS SHALL BE PLENUM RATED FLUSH-MOUNTED MODELS AT ACOUSTICAL TILE CEILINGS.
- COORDINATE DURESS BUTTONS WITH "OSBORNE- HOFFMAN" SOFTWARE AND FACILITY COMMANDER ACCESS CONTROL PACKAGE AT THE WV STATE CAPITOL BUILDING.

●	CARD READER
■	MAG-LOCK
E	PUSH-TO-EXIT BUTTON OR OCCUPANCY SENSOR TO RELEASE MAG-LOCKS
HC	AUTOMATIC DOOR OPENER BUTTON
D	DURESS BUTTON
I	EBELCO BP-121 BEL DOOR PHONE/INTERCOM
PTZ	INTERIOR PAN-TILT-ZOOM CAMERA (GE LEGEND DOME OR EQUAL)
EPTZ	EXTERIOR PAN-TILT-ZOOM CAMERA (GE LEGEND DOME W/ HEATER/FAN OR EQUAL)
F	INTERIOR FIXED CAMERA (GE ULTRAVIEW OR EQUAL)
EF	EXT./INT. FIXED CAMERA (GE ULTRAVIEW FLUGGED DOME W/DR OR EQUAL)
R	DIGITAL MULTIPLEXER/RECORDER (GE DVM/Pr Triplex 4-HDD)

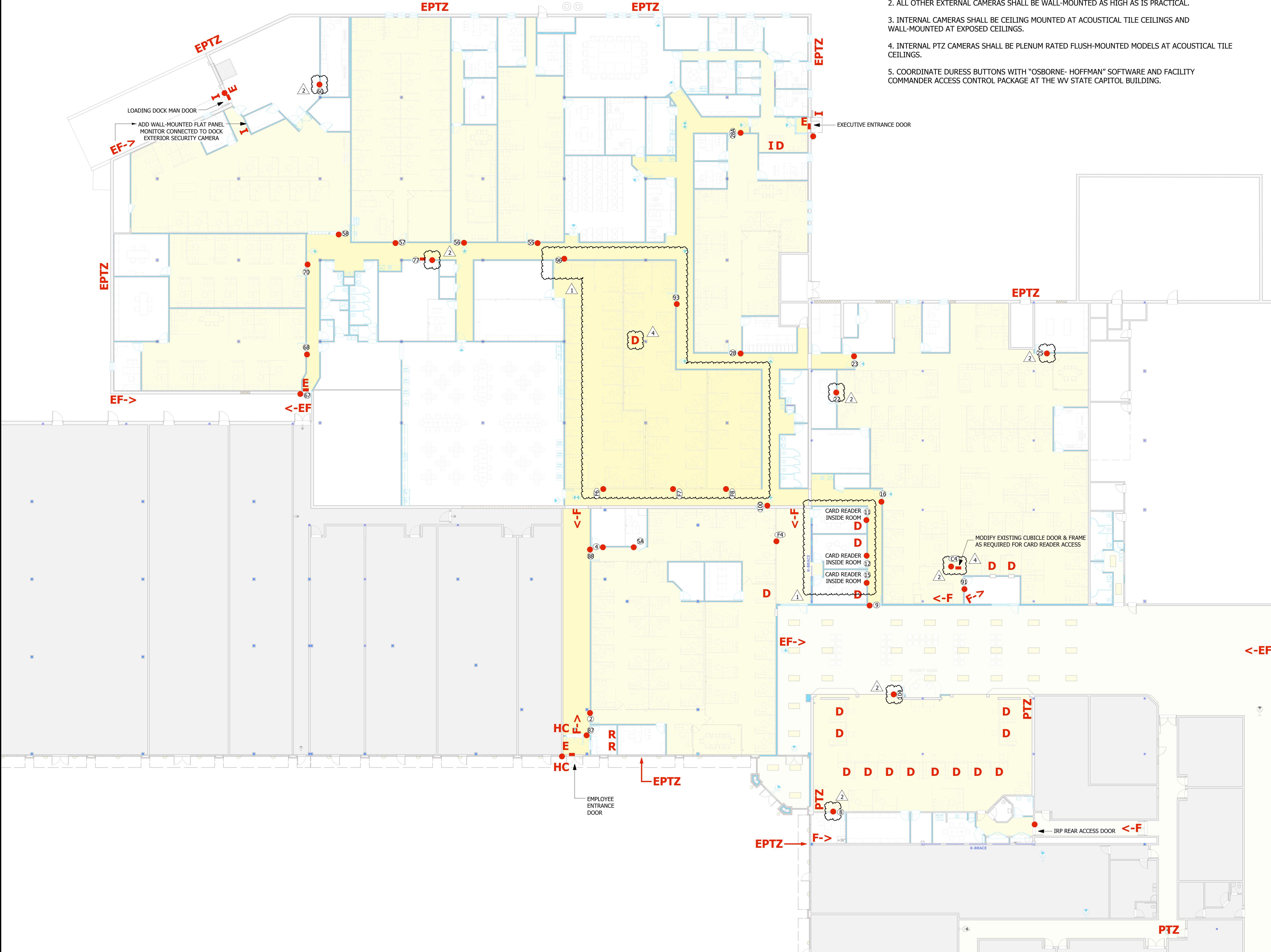

IMPORTANT
CONTRACTORS, MATERIAL SUPPLIERS AND INSTALLERS TO VERIFY ALL DIMENSIONS AND CONDITIONS BEFORE EXECUTING ANY WORK

Issue Date	Description
3/25/09	for Reference only
10/28/09	for Bidding
Revision	Description
1. 5/13/09	Added 5 card readers at Information Services section, Clarified location of card readers in Hearing Rooms
2. 10/16/09	Added 7 card readers
3. 10/28/09	Added other security equipment
4. 11/4/09	Added mag-lock at cubicle door C4 and Duress button

SEAL:

TITLE:
DMV SECURITY PLAN

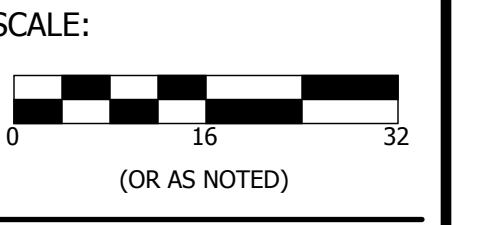

DRAWING:
T15.8

