



State of West Virginia  
 Department of Administration  
 Purchasing Division  
 2019 Washington Street East  
 Post Office Box 50130  
 Charleston, WV 25305-0130

# Request for Quotation

RFQ NUMBER
DEFK9020

PAGE
1

ADDRESS: CORRESPONDENCE TO ATTENTION OF:
JOHN ABBOTT 304-558-2544

VENDOR

RFQ COPY  
 TYPE NAME/ADDRESS HERE

SHIP TO

DIV ENGINEERING & FACILITIES  
 CAMP DAWSON ARMY TRAINING SITE  
 240 ARMY ROAD  
  
 KINGWOOD, WV  
 26537-1077      304-329-4417

DATE PRINTED	TERMS OF SALE	SHIP VIA	F.O.B.	FREIGHT TERMS
04/13/2009				

BID OPENING DATE: 04/22/2009      BID OPENING TIME: 01:30PM

LINE	QUANTITY	UOP	CAT. NO.	ITEM NUMBER	UNIT PRICE	AMOUNT
				ADDENDUM #02		
				THIS ADDENDUM IS ISSUED TO ANSWER VENDOR QUESTIONS, ADD TO, AND MODIFY THE ORIGINAL REQUIREMENTS OF THE SPECIFICATIONS, PER THE ATTACHED DOCUMENTATION; AND EXTEND THE BID OPENING TO 4/22/2009; 1:30 PM		
				REVISED BID OPENING: 4/22/2009; 1:30 PM		
0001	1	LS		962-73		
				RECLAMATION: RESTORATION OF LAND & OTHER PROPERTIES		
				***** THIS IS THE END OF RFQ DEFK9020 ***** TOTAL:		

SEE REVERSE SIDE FOR TERMS AND CONDITIONS

SIGNATURE	TELEPHONE	DATE
TITLE	FEIN	ADDRESS CHANGES TO BE NOTED ABOVE

WHEN RESPONDING TO RFQ, INSERT NAME AND ADDRESS IN SPACE ABOVE LABELED 'VENDOR'

**GENERAL TERMS & CONDITIONS  
REQUEST FOR QUOTATION (RFQ) AND REQUEST FOR PROPOSAL (RFP)**

1. Awards will be made in the best interest of the State of West Virginia.
2. The State may accept or reject in part, or in whole, any bid.
3. All quotations are governed by the *West Virginia Code* and the *Legislative Rules* of the Purchasing Division.
4. Prior to any award, the apparent successful vendor must be properly registered with the Purchasing Division and have paid the required \$125 fee.
5. All services performed or goods delivered under State Purchase Order/Contracts are to be continued for the term of the Purchase Order/Contracts, contingent upon funds being appropriated by the Legislature or otherwise being made available. In the event funds are not appropriated or otherwise available for these services or goods, this Purchase Order/Contract becomes void and of no effect after June 30.
6. Payment may only be made after the delivery and acceptance of goods or services.
7. Interest may be paid for late payment in accordance with the *West Virginia Code*.
8. Vendor preference will be granted upon written request in accordance with the *West Virginia Code*.
9. The State of West Virginia is exempt from federal and state taxes and will not pay or reimburse such taxes.
10. The Director of Purchasing may cancel any Purchase Order/Contract upon 30 days written notice to the seller.
11. The laws of the State of West Virginia and the *Legislative Rules* of the Purchasing Division shall govern all rights and duties under the Contract, including without limitation the validity of this Purchase Order/Contract.
12. Any reference to automatic renewal is hereby deleted. The Contract may be renewed only upon mutual written agreement of the parties.
13. **BANKRUPTCY:** In the event the vendor/contractor files for bankruptcy protection, this Contract may be deemed null and void, and terminated without further order.
14. **HIPAA BUSINESS ASSOCIATE ADDENDUM:** The West Virginia State Government HIPAA Business Associate Addendum (BAA), approved by the Attorney General, and available online at the Purchasing Division's web site (<http://www.state.wv.us/admin/purchase/vrc/hipaa.htm>) is hereby made part of the agreement. Provided that, the Agency meets the definition of a Cover Entity (45 CFR §160.103) and will be disclosing Protected Health Information (45 CFR §160.103) to the vendor.
15. **WEST VIRGINIA ALCOHOL & DRUG-FREE WORKPLACE ACT:** If this Contract constitutes a public improvement construction contract as set forth in Article 1D, Chapter 21 of the West Virginia Code ("The West Virginia Alcohol and Drug-Free Workplace Act"), then the following language shall hereby become part of this Contract: "The contractor and its subcontractors shall implement and maintain a written drug-free workplace policy in compliance with the West Virginia Alcohol and Drug-Free Workplace Act, as set forth in Article 1D, Chapter 21 of the West Virginia Code. The contractor and its subcontractors shall provide a sworn statement in writing, under the penalties of perjury, that they maintain a valid drug-free work place policy in compliance with the West Virginia and Drug-Free Workplace Act. It is understood and agreed that this Contract shall be cancelled by the awarding authority if the Contractor: 1) Fails to implement its drug-free workplace policy; 2) Fails to provide information regarding implementation of the contractor's drug-free workplace policy at the request of the public authority; or 3) Provides to the public authority false information regarding the contractor's drug-free workplace policy."

---

**INSTRUCTIONS TO BIDDERS**

1. Use the quotation forms provided by the Purchasing Division.
2. **SPECIFICATIONS:** Items offered must be in compliance with the specifications. Any deviation from the specifications must be clearly indicated by the bidder. Alternates offered by the bidder as **EQUAL** to the specifications must be clearly defined. A bidder offering an alternate should attach complete specifications and literature to the bid. The Purchasing Division may waive minor deviations to specifications.
3. Complete all sections of the quotation form.
4. Unit prices shall prevail in case of discrepancy.
5. All quotations are considered F.O.B. destination unless alternate shipping terms are clearly identified in the quotation.
6. **BID SUBMISSION:** All quotations must be delivered by the bidder to the office listed below prior to the date and time of the bid opening. Failure of the bidder to deliver the quotations on time will result in bid disqualifications: Department of Administration, Purchasing Division, 2019 Washington Street East, P.O. Box 50130, Charleston, WV 25305-0130

*Contractor Questions*

Q: Within addendum #1 Clarification from the pre-bid meetings, #2, it is stated that the onsite rubble can be hauled to an area that is shown on an attached aerial. The attached aerial cannot be found.

A: Please refer to the narrative describing this area included in Addendum #1 and repeated herein.

Q: Should we not have a detail of just what the engineer is wanting for the cable guard rail system?

A: Please refer to the attached five sheet set of drawing number SS-740 of the CASS TL-4 Cable Guardrail system produced by Trinity Highway Products. Provide this system or equivalent. Assume installation will require post option #1.

Q: In the pre-bid meeting we had a discussion of allowing the successful bidder to perform an additional core hole at the upper end of the wall prior to ordering material at the expense of the owner. I see no mention of this in the Addendum #1.

A: A Line Item was added to the bid form for a 40' deep soil boring in Addendum #1.

*Bid Form Update*

The bid form has been updated to include a Lump Sum line item for Construction Layout & Staking. The Owner will provide control points and benchmarks, from which the Contractor will provide all necessary surveying required to complete the Work.

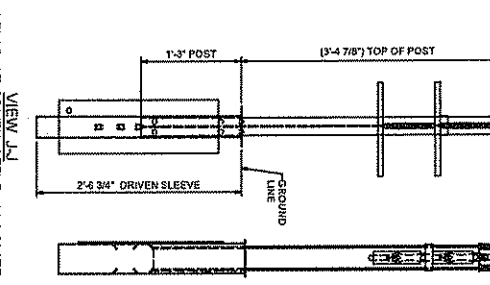
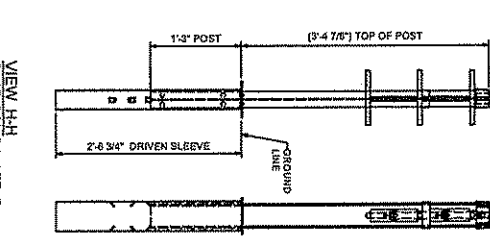
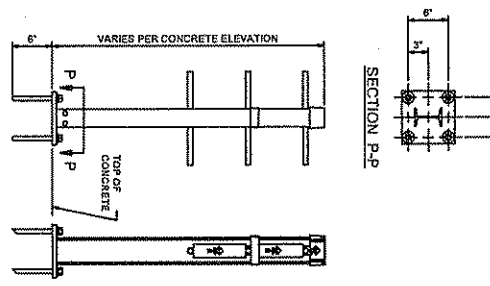
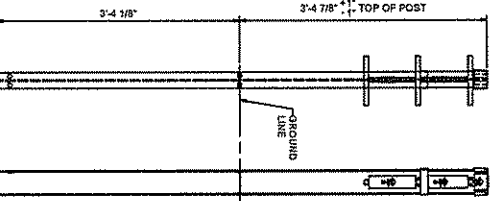
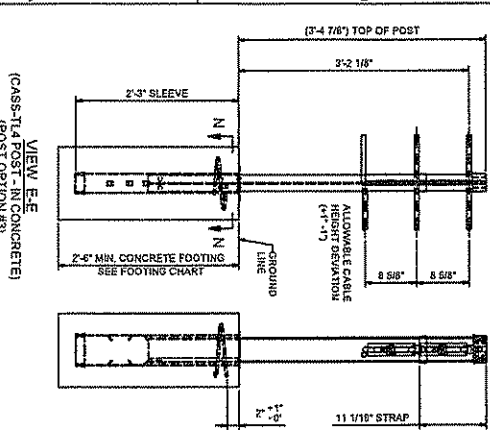
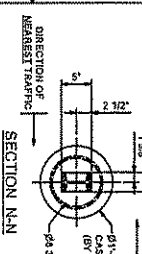
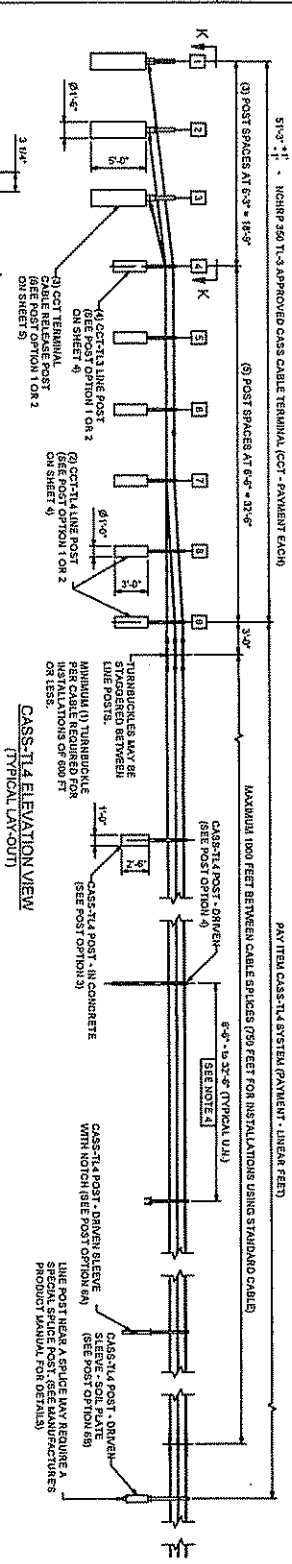
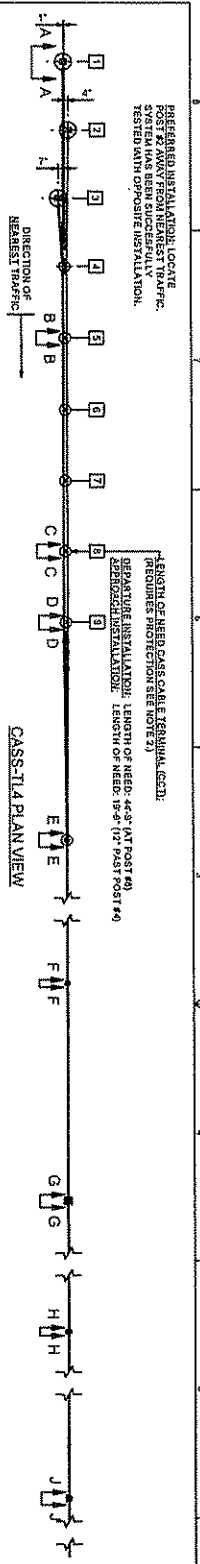

**NOTES:**

- CASS-TL4 HAS BEEN SUCCESSFULLY TESTED TO NATIONAL COOPERATIVE HIGHWAY RESEARCH PROGRAM REPORT 350 TEST LEVEL 4 (NCHRP 350 TL 4) AND ACCEPTED BY FHWA FOR VANDERBILT UNIVERSITY'S ROADWAY SAFETY SYSTEM (RSS) FOR BEST PRACTICES FOR TESTING AND APPROVED TO NCHRP 350 TL 4.
- AN NCHRP 350 TL 4 APPROVED TERMINAL (COT) OR CASS-TL4 TERMINATION SHALL BE USED TO TERMINATE CABLES. THE TERMINATION POINT SHALL BE LOCATED OUTSIDE THE CLEAR ZONE AND/OR PROTECTED BY OTHER MEANS. CONFORMANCE WITH THE NATIONAL HIGHWAY SYSTEM (NHS) WHICH CASS-TL4 IS INSTALLED ON THE NATIONAL HIGHWAY SYSTEM (NHS). IF THE TERMINATION POINT IS LOCATED OUTSIDE THE CLEAR ZONE AND/OR PROTECTED BY OTHER MEANS, THE TERMINATION POINT SHALL BE LOCATED AT A DEPARTURE TERMINATION. (SEE NOTE 3 FOR DEPARTURE TERMINATION AND DEPARTURE TERMINATIONS.)
- CASS-TL4 SHALL BE INSTALLED ON SPACERS OR LEGS WITH SPACES OF 6" OR FLATTER WITHOUT OBSTRUCTIONS, DEPRESSIONS, ETC. THAT MAY SIGNIFICANTLY AFFECT THE STABILITY OF AN EQUAL VEHICLE. GROUND OF THE TERMINATION POINT SHALL BE REINFORCED WITH 2" X 2" X 12" REBAR. THE TERMINATION POINT IS LOCATED OUTSIDE THE CLEAR ZONE AND/OR PROTECTED BY OTHER MEANS, THE TERMINATION POINT SHALL BE LOCATED AT A DEPARTURE TERMINATION. (SEE NOTE 3 FOR DEPARTURE TERMINATION AND DEPARTURE TERMINATIONS.)
- CASS-TL4 SHALL BE INSTALLED ON SPACERS OR LEGS WITH SPACES OF 6" OR FLATTER WITHOUT OBSTRUCTIONS, DEPRESSIONS, ETC. THAT MAY SIGNIFICANTLY AFFECT THE STABILITY OF AN EQUAL VEHICLE. GROUND OF THE TERMINATION POINT SHALL BE REINFORCED WITH 2" X 2" X 12" REBAR. THE TERMINATION POINT IS LOCATED OUTSIDE THE CLEAR ZONE AND/OR PROTECTED BY OTHER MEANS, THE TERMINATION POINT SHALL BE LOCATED AT A DEPARTURE TERMINATION. (SEE NOTE 3 FOR DEPARTURE TERMINATION AND DEPARTURE TERMINATIONS.)
- CASS-TL4 POST SPACING MAY BE REDUCED TO 4" TO 5" TO ACCOMMODATE SPACING ALLOWED BY PROJECT ENGINEER - HOWEVER, 18" IS LESS REDUCING OR INCREASING SPACING BEYOND 18" IS NOT TO EXCEED 32".
- POST FOUNDATIONS MAY BE DRILLED THROUGH EXISTING PAVEMENT. PAVEMENT SHALL BE REINFORCED WITH 2" X 2" X 12" REBAR. THE TERMINATION POINT IS LOCATED OUTSIDE THE CLEAR ZONE AND/OR PROTECTED BY OTHER MEANS, THE TERMINATION POINT SHALL BE LOCATED AT A DEPARTURE TERMINATION. (SEE NOTE 3 FOR DEPARTURE TERMINATION AND DEPARTURE TERMINATIONS.)
- ALL CONCRETE SHALL HAVE A MINIMUM COMPRESSIVE STRENGTH OF 3,000 P.S.I. PRIOR TO TENSIONING THE SYSTEM. TRINITY RECOMMENDS THE CONCRETE TO BE TENSIONED IN ACCORDANCE WITH THE LATEST APPLICABLE AASHTO SPECIFICATION.
- CASS-TL4 SHALL BE INSTALLED IN WELL-COMPAKED, COMPACTED, NCHRP 350 TL 4 APPROVED TERMINAL (COT) OR CASS-TL4 TERMINATION. IF SOLID CONCRETE IS INCORPORATED BELOW GRADE OR IF SOLID IS ACCEPTABLE TO SEVERE FREEZE/THAW CYCLES, PLEASE CONTACT TRINITY ABOUT ALTERNATE FOOTING DESIGN. TRINITY SUGGESTS THE USE OF "KNOX" CONCRETE. (SEE NOTE 3 FOR DEPARTURE TERMINATION AND DEPARTURE TERMINATIONS.)
- PLEASE SEE SPECIFICATIONS (OR SURVEY) FOR PROPER BARBER DENOTATION.
- PLEASE CONTACT TRINITY OR CONSULT THE DESIGN, INSTALLATION, OR REPAIR MANUAL(S) FOR ADDITIONAL INFORMATION.

TRINITY HIGHWAY PRODUCTS, LLC. EMAIL: 2535 STEWARTS FREEWAY PRODUCT INFO@TRINITY DALLAS, TX 75227 PHONE: (800) 644-7578

NO.	DESCRIPTION	CONCRETE TENSILE STRENGTH	MINIMUM DEPTH	MINIMUM WIDTH	MINIMUM LENGTH	MINIMUM AREA	MINIMUM PERIMETER
1	COT TERMINAL POST 1.8" IN CONCRETE	3,000 P.S.I.	6" MIN.	3" MIN.	24" MIN.	18" MIN.	NO
2	CASS-TL4 POST 1.8" IN CONCRETE	3,000 P.S.I.	6" MIN.	3" MIN.	24" MIN.	18" MIN.	NO
3	CASS-TL4 POST - DRIVER	3,000 P.S.I.	6" MIN.	3" MIN.	24" MIN.	18" MIN.	NO
4	CASS-TL4 POST - IN CONCRETE	3,000 P.S.I.	6" MIN.	3" MIN.	24" MIN.	18" MIN.	NO
5	CASS-TL4 POST - BASE-PLATED	3,000 P.S.I.	6" MIN.	3" MIN.	24" MIN.	18" MIN.	NO
6	CASS-TL4 POST - IN CONCRETE	3,000 P.S.I.	6" MIN.	3" MIN.	24" MIN.	18" MIN.	NO
7	CASS-TL4 POST - WITH SOIL PLATE	3,000 P.S.I.	6" MIN.	3" MIN.	24" MIN.	18" MIN.	NO

**CASS-TL4**  
CABLE GUARDRAIL SAFETY SYSTEM

TRINITY HIGHWAY PRODUCTS, LLC

DATE: 08/20/2018  
REV: 04/10/2018  
REV: 03/10/2018  
REV: 02/10/2018  
REV: 01/10/2018  
REV: 12/10/2017  
REV: 11/10/2017  
REV: 10/10/2017  
REV: 09/10/2017  
REV: 08/10/2017  
REV: 07/10/2017  
REV: 06/10/2017  
REV: 05/10/2017  
REV: 04/10/2017  
REV: 03/10/2017  
REV: 02/10/2017  
REV: 01/10/2017  
REV: 12/10/2016  
REV: 11/10/2016  
REV: 10/10/2016  
REV: 09/10/2016  
REV: 08/10/2016  
REV: 07/10/2016  
REV: 06/10/2016  
REV: 05/10/2016  
REV: 04/10/2016  
REV: 03/10/2016  
REV: 02/10/2016  
REV: 01/10/2016  
REV: 12/10/2015  
REV: 11/10/2015  
REV: 10/10/2015  
REV: 09/10/2015  
REV: 08/10/2015  
REV: 07/10/2015  
REV: 06/10/2015  
REV: 05/10/2015  
REV: 04/10/2015  
REV: 03/10/2015  
REV: 02/10/2015  
REV: 01/10/2015  
REV: 12/10/2014  
REV: 11/10/2014  
REV: 10/10/2014  
REV: 09/10/2014  
REV: 08/10/2014  
REV: 07/10/2014  
REV: 06/10/2014  
REV: 05/10/2014  
REV: 04/10/2014  
REV: 03/10/2014  
REV: 02/10/2014  
REV: 01/10/2014  
REV: 12/10/2013  
REV: 11/10/2013  
REV: 10/10/2013  
REV: 09/10/2013  
REV: 08/10/2013  
REV: 07/10/2013  
REV: 06/10/2013  
REV: 05/10/2013  
REV: 04/10/2013  
REV: 03/10/2013  
REV: 02/10/2013  
REV: 01/10/2013  
REV: 12/10/2012  
REV: 11/10/2012  
REV: 10/10/2012  
REV: 09/10/2012  
REV: 08/10/2012  
REV: 07/10/2012  
REV: 06/10/2012  
REV: 05/10/2012  
REV: 04/10/2012  
REV: 03/10/2012  
REV: 02/10/2012  
REV: 01/10/2012  
REV: 12/10/2011  
REV: 11/10/2011  
REV: 10/10/2011  
REV: 09/10/2011  
REV: 08/10/2011  
REV: 07/10/2011  
REV: 06/10/2011  
REV: 05/10/2011  
REV: 04/10/2011  
REV: 03/10/2011  
REV: 02/10/2011  
REV: 01/10/2011  
REV: 12/10/2010  
REV: 11/10/2010  
REV: 10/10/2010  
REV: 09/10/2010  
REV: 08/10/2010  
REV: 07/10/2010  
REV: 06/10/2010  
REV: 05/10/2010  
REV: 04/10/2010  
REV: 03/10/2010  
REV: 02/10/2010  
REV: 01/10/2010  
REV: 12/10/2009  
REV: 11/10/2009  
REV: 10/10/2009  
REV: 09/10/2009  
REV: 08/10/2009  
REV: 07/10/2009  
REV: 06/10/2009  
REV: 05/10/2009  
REV: 04/10/2009  
REV: 03/10/2009  
REV: 02/10/2009  
REV: 01/10/2009  
REV: 12/10/2008  
REV: 11/10/2008  
REV: 10/10/2008  
REV: 09/10/2008  
REV: 08/10/2008  
REV: 07/10/2008  
REV: 06/10/2008  
REV: 05/10/2008  
REV: 04/10/2008  
REV: 03/10/2008  
REV: 02/10/2008  
REV: 01/10/2008  
REV: 12/10/2007  
REV: 11/10/2007  
REV: 10/10/2007  
REV: 09/10/2007  
REV: 08/10/2007  
REV: 07/10/2007  
REV: 06/10/2007  
REV: 05/10/2007  
REV: 04/10/2007  
REV: 03/10/2007  
REV: 02/10/2007  
REV: 01/10/2007  
REV: 12/10/2006  
REV: 11/10/2006  
REV: 10/10/2006  
REV: 09/10/2006  
REV: 08/10/2006  
REV: 07/10/2006  
REV: 06/10/2006  
REV: 05/10/2006  
REV: 04/10/2006  
REV: 03/10/2006  
REV: 02/10/2006  
REV: 01/10/2006  
REV: 12/10/2005  
REV: 11/10/2005  
REV: 10/10/2005  
REV: 09/10/2005  
REV: 08/10/2005  
REV: 07/10/2005  
REV: 06/10/2005  
REV: 05/10/2005  
REV: 04/10/2005  
REV: 03/10/2005  
REV: 02/10/2005  
REV: 01/10/2005  
REV: 12/10/2004  
REV: 11/10/2004  
REV: 10/10/2004  
REV: 09/10/2004  
REV: 08/10/2004  
REV: 07/10/2004  
REV: 06/10/2004  
REV: 05/10/2004  
REV: 04/10/2004  
REV: 03/10/2004  
REV: 02/10/2004  
REV: 01/10/2004  
REV: 12/10/2003  
REV: 11/10/2003  
REV: 10/10/2003  
REV: 09/10/2003  
REV: 08/10/2003  
REV: 07/10/2003  
REV: 06/10/2003  
REV: 05/10/2003  
REV: 04/10/2003  
REV: 03/10/2003  
REV: 02/10/2003  
REV: 01/10/2003  
REV: 12/10/2002  
REV: 11/10/2002  
REV: 10/10/2002  
REV: 09/10/2002  
REV: 08/10/2002  
REV: 07/10/2002  
REV: 06/10/2002  
REV: 05/10/2002  
REV: 04/10/2002  
REV: 03/10/2002  
REV: 02/10/2002  
REV: 01/10/2002  
REV: 12/10/2001  
REV: 11/10/2001  
REV: 10/10/2001  
REV: 09/10/2001  
REV: 08/10/2001  
REV: 07/10/2001  
REV: 06/10/2001  
REV: 05/10/2001  
REV: 04/10/2001  
REV: 03/10/2001  
REV: 02/10/2001  
REV: 01/10/2001  
REV: 12/10/2000  
REV: 11/10/2000  
REV: 10/10/2000  
REV: 09/10/2000  
REV: 08/10/2000  
REV: 07/10/2000  
REV: 06/10/2000  
REV: 05/10/2000  
REV: 04/10/2000  
REV: 03/10/2000  
REV: 02/10/2000  
REV: 01/10/2000  
REV: 12/10/1999  
REV: 11/10/1999  
REV: 10/10/1999  
REV: 09/10/1999  
REV: 08/10/1999  
REV: 07/10/1999  
REV: 06/10/1999  
REV: 05/10/1999  
REV: 04/10/1999  
REV: 03/10/1999  
REV: 02/10/1999  
REV: 01/10/1999  
REV: 12/10/1998  
REV: 11/10/1998  
REV: 10/10/1998  
REV: 09/10/1998  
REV: 08/10/1998  
REV: 07/10/1998  
REV: 06/10/1998  
REV: 05/10/1998  
REV: 04/10/1998  
REV: 03/10/1998  
REV: 02/10/1998  
REV: 01/10/1998  
REV: 12/10/1997  
REV: 11/10/1997  
REV: 10/10/1997  
REV: 09/10/1997  
REV: 08/10/1997  
REV: 07/10/1997  
REV: 06/10/1997  
REV: 05/10/1997  
REV: 04/10/1997  
REV: 03/10/1997  
REV: 02/10/1997  
REV: 01/10/1997  
REV: 12/10/1996  
REV: 11/10/1996  
REV: 10/10/1996  
REV: 09/10/1996  
REV: 08/10/1996  
REV: 07/10/1996  
REV: 06/10/1996  
REV: 05/10/1996  
REV: 04/10/1996  
REV: 03/10/1996  
REV: 02/10/1996  
REV: 01/10/1996  
REV: 12/10/1995  
REV: 11/10/1995  
REV: 10/10/1995  
REV: 09/10/1995  
REV: 08/10/1995  
REV: 07/10/1995  
REV: 06/10/1995  
REV: 05/10/1995  
REV: 04/10/1995  
REV: 03/10/1995  
REV: 02/10/1995  
REV: 01/10/1995  
REV: 12/10/1994  
REV: 11/10/1994  
REV: 10/10/1994  
REV: 09/10/1994  
REV: 08/10/1994  
REV: 07/10/1994  
REV: 06/10/1994  
REV: 05/10/1994  
REV: 04/10/1994  
REV: 03/10/1994  
REV: 02/10/1994  
REV: 01/10/1994  
REV: 12/10/1993  
REV: 11/10/1993  
REV: 10/10/1993  
REV: 09/10/1993  
REV: 08/10/1993  
REV: 07/10/1993  
REV: 06/10/1993  
REV: 05/10/1993  
REV: 04/10/1993  
REV: 03/10/1993  
REV: 02/10/1993  
REV: 01/10/1993  
REV: 12/10/1992  
REV: 11/10/1992  
REV: 10/10/1992  
REV: 09/10/1992  
REV: 08/10/1992  
REV: 07/10/1992  
REV: 06/10/1992  
REV: 05/10/1992  
REV: 04/10/1992  
REV: 03/10/1992  
REV: 02/10/1992  
REV: 01/10/1992  
REV: 12/10/1991  
REV: 11/10/1991  
REV: 10/10/1991  
REV: 09/10/1991  
REV: 08/10/1991  
REV: 07/10/1991  
REV: 06/10/1991  
REV: 05/10/1991  
REV: 04/10/1991  
REV: 03/10/1991  
REV: 02/10/1991  
REV: 01/10/1991  
REV: 12/10/1990  
REV: 11/10/1990  
REV: 10/10/1990  
REV: 09/10/1990  
REV: 08/10/1990  
REV: 07/10/1990  
REV: 06/10/1990  
REV: 05/10/1990  
REV: 04/10/1990  
REV: 03/10/1990  
REV: 02/10/1990  
REV: 01/10/1990  
REV: 12/10/1989  
REV: 11/10/1989  
REV: 10/10/1989  
REV: 09/10/1989  
REV: 08/10/1989  
REV: 07/10/1989  
REV: 06/10/1989  
REV: 05/10/1989  
REV: 04/10/1989  
REV: 03/10/1989  
REV: 02/10/1989  
REV: 01/10/1989  
REV: 12/10/1988  
REV: 11/10/1988  
REV: 10/10/1988  
REV: 09/10/1988  
REV: 08/10/1988  
REV: 07/10/1988  
REV: 06/10/1988  
REV: 05/10/1988  
REV: 04/10/1988  
REV: 03/10/1988  
REV: 02/10/1988  
REV: 01/10/1988  
REV: 12/10/1987  
REV: 11/10/1987  
REV: 10/10/1987  
REV: 09/10/1987  
REV: 08/10/1987  
REV: 07/10/1987  
REV: 06/10/1987  
REV: 05/10/1987  
REV: 04/10/1987  
REV: 03/10/1987  
REV: 02/10/1987  
REV: 01/10/1987  
REV: 12/10/1986  
REV: 11/10/1986  
REV: 10/10/1986  
REV: 09/10/1986  
REV: 08/10/1986  
REV: 07/10/1986  
REV: 06/10/1986  
REV: 05/10/1986  
REV: 04/10/1986  
REV: 03/10/1986  
REV: 02/10/1986  
REV: 01/10/1986  
REV: 12/10/1985  
REV: 11/10/1985  
REV: 10/10/1985  
REV: 09/10/1985  
REV: 08/10/1985  
REV: 07/10/1985  
REV: 06/10/1985  
REV: 05/10/1985  
REV: 04/10/1985  
REV: 03/10/1985  
REV: 02/10/1985  
REV: 01/10/1985  
REV: 12/10/1984  
REV: 11/10/1984  
REV: 10/10/1984  
REV: 09/10/1984  
REV: 08/10/1984  
REV: 07/10/1984  
REV: 06/10/1984  
REV: 05/10/1984  
REV: 04/10/1984  
REV: 03/10/1984  
REV: 02/10/1984  
REV: 01/10/1984  
REV: 12/10/1983  
REV: 11/10/1983  
REV: 10/10/1983  
REV: 09/10/1983  
REV: 08/10/1983  
REV: 07/10/1983  
REV: 06/10/1983  
REV: 05/10/1983  
REV: 04/10/1983  
REV: 03/10/1983  
REV: 02/10/1983  
REV: 01/10/1983  
REV: 12/10/1982  
REV: 11/10/1982  
REV: 10/10/1982  
REV: 09/10/1982  
REV: 08/10/1982  
REV: 07/10/1982  
REV: 06/10/1982  
REV: 05/10/1982  
REV: 04/10/1982  
REV: 03/10/1982  
REV: 02/10/1982  
REV: 01/10/1982  
REV: 12/10/1981  
REV: 11/10/1981  
REV: 10/10/1981  
REV: 09/10/1981  
REV: 08/10/1981  
REV: 07/10/1981  
REV: 06/10/1981  
REV: 05/10/1981  
REV: 04/10/1981  
REV: 03/10/1981  
REV: 02/10/1981  
REV: 01/10/1981  
REV: 12/10/1980  
REV: 11/10/1980  
REV: 10/10/1980  
REV: 09/10/1980  
REV: 08/10/1980  
REV: 07/10/1980  
REV: 06/10/1980  
REV: 05/10/1980  
REV: 04/10/1980  
REV: 03/10/1980  
REV: 02/10/1980  
REV: 01/10/1980  
REV: 12/10/1979  
REV: 11/10/1979  
REV: 10/10/1979  
REV: 09/10/1979  
REV: 08/10/1979  
REV: 07/10/1979  
REV: 06/10/1979  
REV: 05/10/1979  
REV: 04/10/1979  
REV: 03/10/1979  
REV: 02/10/1979  
REV: 01/10/1979  
REV: 12/10/1978  
REV: 11/10/1978  
REV: 10/10/1978  
REV: 09/10/1978  
REV: 08/10/1978  
REV: 07/10/1978  
REV: 06/10/1978  
REV: 05/10/1978  
REV: 04/10/1978  
REV: 03/10/1978  
REV: 02/10/1978  
REV: 01/10/1978  
REV: 12/10/1977  
REV: 11/10/1977  
REV: 10/10/1977  
REV: 09/10/1977  
REV: 08/10/1977  
REV: 07/10/1977  
REV: 06/10/1977  
REV: 05/10/1977  
REV: 04/10/1977  
REV: 03/10/1977  
REV: 02/10/1977  
REV: 01/10/1977  
REV: 12/10/1976  
REV: 11/10/1976  
REV: 10/10/1976  
REV: 09/10/1976  
REV: 08/10/1976  
REV: 07/10/1976  
REV: 06/10/1976  
REV: 05/10/1976  
REV: 04/10/1976  
REV: 03/10/1976  
REV: 02/10/1976  
REV: 01/10/1976  
REV: 12/10/1975  
REV: 11/10/1975  
REV: 10/10/1975  
REV: 09/10/1975  
REV: 08/10/1975  
REV: 07/10/1975  
REV: 06/10/1975  
REV: 05/10/1975  
REV: 04/10/1975  
REV: 03/10/1975  
REV: 02/10/1975  
REV: 01/10/1975  
REV: 12/10/1974  
REV: 11/10/1974  
REV: 10/10/1974  
REV: 09/10/1974  
REV: 08/10/1974  
REV: 07/10/1974  
REV: 06/10/1974  
REV: 05/10/1974  
REV: 04/10/1974  
REV: 03/10/1974  
REV: 02/10/1974  
REV: 01/10/1974  
REV: 12/10/1973  
REV: 11/10/1973  
REV: 10/10/1973  
REV: 09/10/1973  
REV: 08/10/1973  
REV: 07/10/1973  
REV: 06/10/1973  
REV: 05/10/1973  
REV: 04/10/1973  
REV: 03/10/1973  
REV: 02/10/1973  
REV: 01/10/1973  
REV: 12/10/1972  
REV: 11/10/1972  
REV: 10/10/1972  
REV: 09/10/1972  
REV: 08/10/1972  
REV: 07/10/1972  
REV: 06/10/1972  
REV: 05/10/1972  
REV: 04/10/1972  
REV: 03/10/1972  
REV: 02/10/1972  
REV: 01/10/1972  
REV: 12/10/1971  
REV: 11/10/1971  
REV: 10/10/1971  
REV: 09/10/1971  
REV: 08/10/1971  
REV: 07/10/1971  
REV: 06/10/1971  
REV: 05/10/1971  
REV: 04/10/1971  
REV: 03/10/1971  
REV: 02/10/1971  
REV: 01/10/1971  
REV: 12/10/1970  
REV: 11/10/1970  
REV: 10/10/1970  
REV: 09/10/1970  
REV: 08/10/1970  
REV: 07/10/1970  
REV: 06/10/1970  
REV: 05/10/1970  
REV: 04/10/1970  
REV: 03/10/1970  
REV: 02/10/1970  
REV: 01/10/1970  
REV: 12/10/1969  
REV: 11/10/1969  
REV: 10/10/1969  
REV: 09/10/1969  
REV: 08/10/1969  
REV: 07/10/1969  
REV: 06/10/1969  
REV: 05/10/1969  
REV: 04/10/1969  
REV: 03/10/1969  
REV: 02/10/1969  
REV: 01/10/1969  
REV: 12/10/1968  
REV: 11/10/1968  
REV: 10/10/1968  
REV: 09/10/1968  
REV: 08/10/1968  
REV: 07/10/1968  
REV: 06/10/1968  
REV: 05/10/1968  
REV: 04/10/1968  
REV: 03/10/1968  
REV: 02/10/1968  
REV: 01/10/1968  
REV: 12/10/1967  
REV: 11/10/1967  
REV: 10/10/1967  
REV: 09/10/1967  
REV: 08/10/1967  
REV: 07/10/1967  
REV: 06/10/1967  
REV: 05/10/1967  
REV: 04/10/1967  
REV: 03/10/1967  
REV: 02/10/1967  
REV: 01/10/1967  
REV: 12/10/1966  
REV: 11/10/1966  
REV: 10/10/1966  
REV: 09/10/1966  
REV: 08/10/1966  
REV: 07/10/1966  
REV: 06/10/1966  
REV: 05/10/1966  
REV: 04/10/1966  
REV: 03/10/1966  
REV: 02/10/1966  
REV: 01/10/1966  
REV: 12/10/1965  
REV: 11/10/1965  
REV: 10/10/1965  
REV: 09/10/1965  
REV: 08/10/1965  
REV: 07/10/1965  
REV: 06/10/1965  
REV: 05/10/1965  
REV: 04/10/1965  
REV: 03/10/1965  
REV: 02/10/1965  
REV: 01/10/1965  
REV: 12/10/1964  
REV: 11/10/1964  
REV: 10/10/1964  
REV: 09/10/1964  
REV: 08/10/1964  
REV: 07/10/1964  
REV: 06/10/1964  
REV: 05/10/1964  
REV: 04/10/1964  
REV: 03/10/1964  
REV: 02/10/1964  
REV: 01/10/1964  
REV: 12/10/19



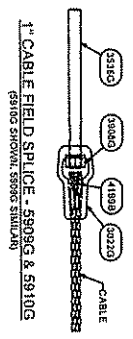

**1" CABLE FIELD SPLICE - 5909G & 5910G**  
(5910G SHOWN, 5909G SIMILAR)

QTY	PART No.	TITLE	U.S. / Each
1	4032G	CABLE END CASTING	0.58
1	5350G	1" STUD FLATWRENCH - L.H.T.	2.28
1	3500G	1" HEAVY HEX NUT (ASB DIN)	0.47
1	4199G	3/4" CABLE WEDGE (3 X 7)	0.28

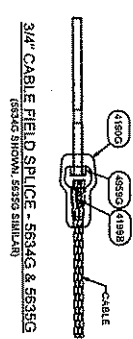

**3/4" CABLE FIELD SPLICE - 5634G & 5635G**  
(5635G SHOWN, 5634G SIMILAR)

QTY	PART No.	TITLE	U.S. / Each
1	4190G	3/4" STUD FLATWRENCH - L.H.T.	1.22
1	4190G	3/4" CABLE END CASTING	3.76
1	4198G	3/4" CABLE WEDGE (3 X 7)	0.28
1	4950G	3/4" HEAVY SQUARE NUT (ASB)	0.28

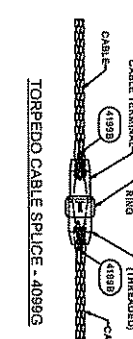

**TORPEDO CABLE SPLICE - 4099G**

QTY	PART No.	TITLE	U.S. / Each
1	4198G	CABLE TERMINAL - THREADED	1.78
1	4198G	CABLE TERMINAL - THREADED	4.12
2	4198G	3/4" CABLE WEDGE (3 X 7)	0.28

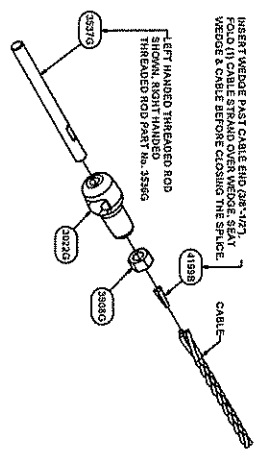

**ASSEMBLY Y - 1" CABLE FIELD SPLICE - 5909G**  
(5909G SHOWN, 5910G SIMILAR)

QTY	PART No.	TITLE	U.S. / Each
1	5310G	1" HEAVY HEX NUT (ASB DIN)	0.47
1	5310G	1" STUD ASSEMBLY R.H.T.	3.89
1	4198G	3/4" CABLE WEDGE (3 X 7)	0.28

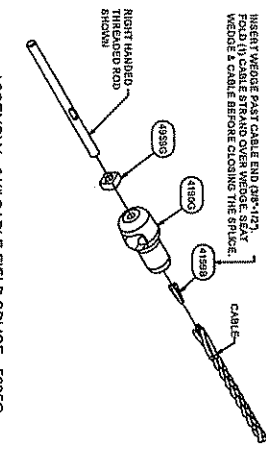

**ASSEMBLY Y - 3/4" CABLE FIELD SPLICE - 5635G**  
(5635G SHOWN, 5634G SIMILAR)

QTY	PART No.	TITLE	U.S. / Each
1	4198G	3/4" CABLE WEDGE (3 X 7)	0.28
1	4198G	3/4" HEAVY SQUARE NUT (ASB)	0.28

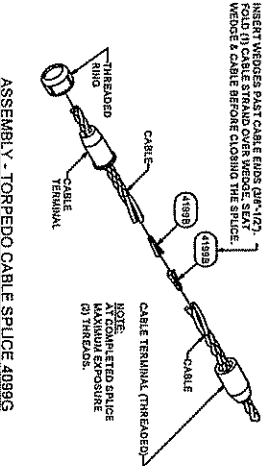

**ASSEMBLY Y - TORPEDO CABLE SPLICE 4099G**

QTY	PART No.	TITLE	U.S. / Each
1	4198G	CABLE TERMINAL - THREADED	1.78
1	4198G	CABLE TERMINAL - THREADED	4.12
2	4198G	3/4" CABLE WEDGE (3 X 7)	0.28

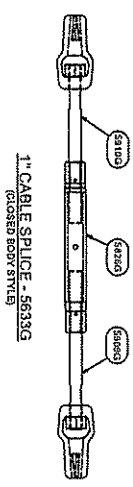

**1" CABLE SPLICE - 5633G**  
(CLOSED BODY STYLE)

QTY	PART No.	TITLE	U.S. / Each
1	5633G	1" CASS TURNBUCKLE CLOSED BODY STYLE	4.81
1	5633G	1" STUD ASSEMBLY R.H.T.	3.89
1	5310G	1" STUD ASSEMBLY R.H.T.	3.89

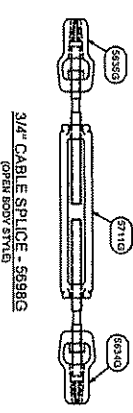

**3/4" CABLE SPLICE - 5698G**  
(OPEN BODY STYLE)

QTY	PART No.	TITLE	U.S. / Each
1	5698G	3/4" STUD ASSEMBLY L.H.T.	5.72
1	5698G	3/4" STUD ASSEMBLY R.H.T.	5.72
1	5710G	3/4" TURNBUCKLE OPEN BODY STYLE	10.29

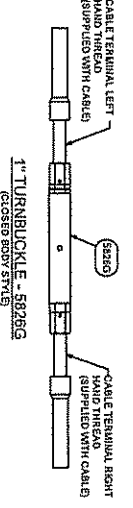

**1" TURNBUCKLE - 5826G**  
(CLOSED BODY STYLE)

QTY	PART No.	TITLE	U.S. / Each
1	5826G	1" CASS TURNBUCKLE CLOSED BODY STYLE	4.81

**CASS TEMPERATURE & TENSION CHART (NEAREST 10 LB)**

FAHRENHEIT	STD. CABLE TENSILE STRENGTH	PRE-STRETCHED TENSILE STRENGTH
< 15	8000	7500
15	8000	7500
30	8000	7500
45	8000	7500
60	8000	7500
75	8000	7500
90	8000	7500
105	8000	7500
120	8000	7500
135	8000	7500
150	8000	7500
165	8000	7500
180	8000	7500
195	8000	7500
210	8000	7500
225	8000	7500
240	8000	7500
255	8000	7500
270	8000	7500
285	8000	7500
300	8000	7500
315	8000	7500
330	8000	7500
345	8000	7500
360	8000	7500
375	8000	7500
390	8000	7500
405	8000	7500
420	8000	7500
435	8000	7500
450	8000	7500
465	8000	7500
480	8000	7500
495	8000	7500
510	8000	7500
525	8000	7500
540	8000	7500
555	8000	7500
570	8000	7500
585	8000	7500
600	8000	7500
615	8000	7500
630	8000	7500
645	8000	7500
660	8000	7500
675	8000	7500
690	8000	7500
705	8000	7500
720	8000	7500
735	8000	7500
750	8000	7500
765	8000	7500
780	8000	7500
795	8000	7500
810	8000	7500
825	8000	7500
840	8000	7500
855	8000	7500
870	8000	7500
885	8000	7500
900	8000	7500
915	8000	7500
930	8000	7500
945	8000	7500
960	8000	7500
975	8000	7500
990	8000	7500
1005	8000	7500
1020	8000	7500
1035	8000	7500
1050	8000	7500
1065	8000	7500
1080	8000	7500
1095	8000	7500
1110	8000	7500
1125	8000	7500
1140	8000	7500
1155	8000	7500
1170	8000	7500
1185	8000	7500
1200	8000	7500
1215	8000	7500
1230	8000	7500
1245	8000	7500
1260	8000	7500
1275	8000	7500
1290	8000	7500
1305	8000	7500
1320	8000	7500
1335	8000	7500
1350	8000	7500
1365	8000	7500
1380	8000	7500
1395	8000	7500
1410	8000	7500
1425	8000	7500
1440	8000	7500
1455	8000	7500
1470	8000	7500
1485	8000	7500
1500	8000	7500
1515	8000	7500
1530	8000	7500
1545	8000	7500
1560	8000	7500
1575	8000	7500
1590	8000	7500
1605	8000	7500
1620	8000	7500
1635	8000	7500
1650	8000	7500
1665	8000	7500
1680	8000	7500
1695	8000	7500
1710	8000	7500
1725	8000	7500
1740	8000	7500
1755	8000	7500
1770	8000	7500
1785	8000	7500
1800	8000	7500
1815	8000	7500
1830	8000	7500
1845	8000	7500
1860	8000	7500
1875	8000	7500
1890	8000	7500
1905	8000	7500
1920	8000	7500
1935	8000	7500
1950	8000	7500
1965	8000	7500
1980	8000	7500
1995	8000	7500
2010	8000	7500
2025	8000	7500
2040	8000	7500
2055	8000	7500
2070	8000	7500
2085	8000	7500
2100	8000	7500

**NOTE:**

- TURNBUCKLES SHALL BE INSTALLED WITH A MINIMUM OF 1/2" THREAD ENGAGEMENT TO ALLOW FOR MAINTENANCE/REPAIR ADJUSTMENTS AT A LATER DATE. TIGHTENING INSTRUCTIONS ON THE TURNBUCKLE SHALL BE FOLLOWED. CONSULT THE MANUFACTURER'S INSTRUCTIONS FOR MORE THAN 4" THREAD ENGAGEMENT.
- WHEN CUTTING CABLE LENGTHS IN THE FIELD FROM CABLE REELS, IT IS RECOMMENDED THAT THE TURNBUCKLES BE INSTALLED WITH A MINIMUM OF 1/2" THREAD ENGAGEMENT. DO NOT USE FOR CABLE LENGTH SHORTER THAN 10'. PLEASE CONTACT TRINITY CONSULTING FOR THE MANUAL OF SPECIFICATIONS TO DETERMINE IF APPROPRIATE FOR SPECIFIC APPLICATION.

**CASS-TL4**  
**3-CABLE GUARDRAIL SAFETY SYSTEM**

TRINITY HIGHWAY PRODUCTS, LLC

SS-740

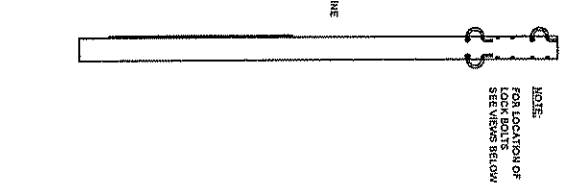
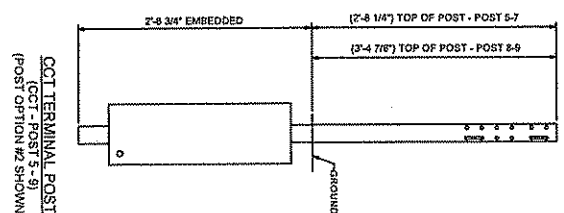
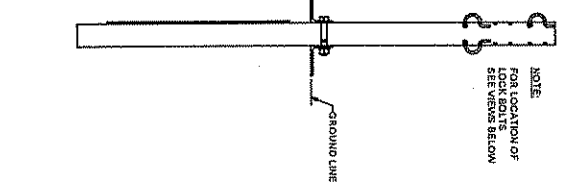
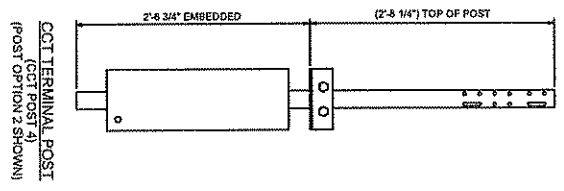
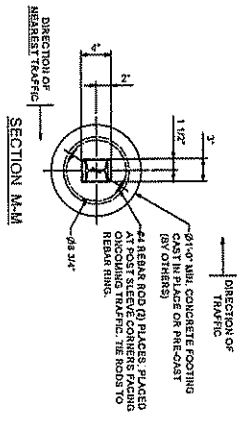
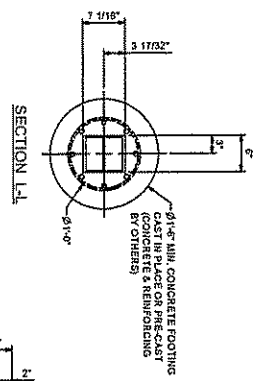
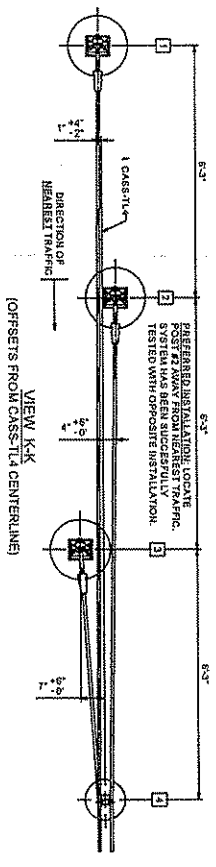

NOTE:  
FOR LOCATION OF  
LOCK BOLTS  
SEE VIEWS BELOW

NOTE:  
FOR LOCATION OF  
LOCK BOLTS  
SEE VIEWS BELOW

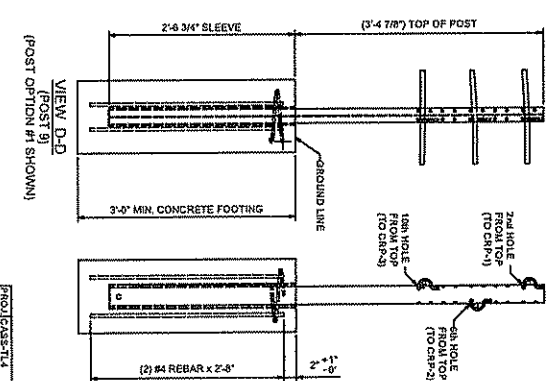
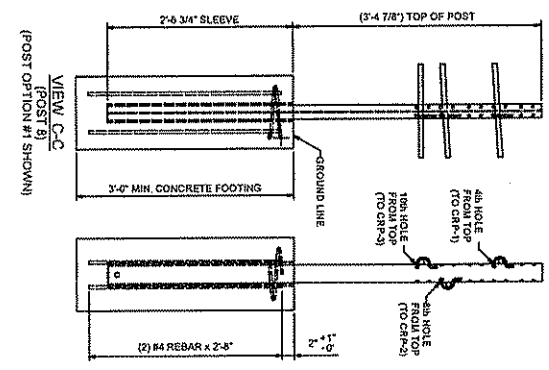
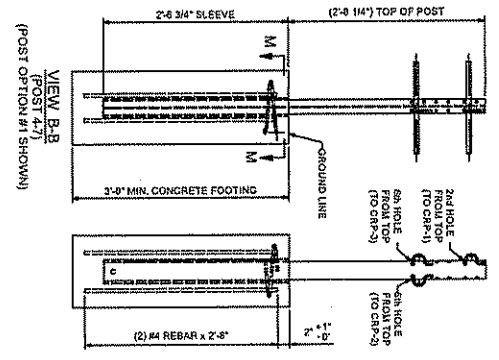
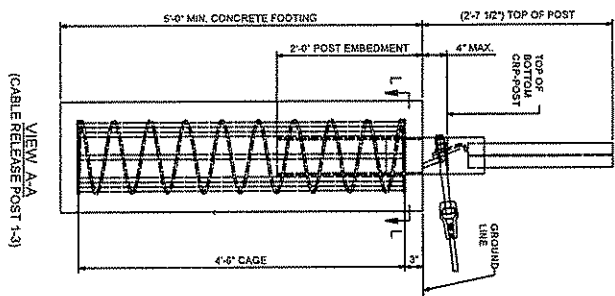

CASS-TLA		DATE:	1/20/20
3-CABLE GUARDRAIL		DESIGNER:	EAL/ET/2020
SAFETY SYSTEM		CHECKER:	CON/2/2020
TRINITY HIGHWAY PRODUCTS, LLC		SCALE:	1" = 1'-0"
		PROJECT:	SS-740
		REVISION:	
		DATE:	
		BY:	
		APPROVED:	
		DATE:	





Bid Item Number	Description	Quantity	Unit	Unit Price	Amount
1	Mobilization and Demobilization	1.00	LS		\$ -
2	Clear & Grub	0.25	ACRE		\$ -
3	Excavation and Embankment	1.00	LS		\$ -
4	Erosion & Sediment Control	1.00	LS		\$ -
5	Construction Layout & Staking	1.00	LS		\$ -
6	Roadway Grading	136.00	CY		\$ -
7	Stone Base for Road	272.00	TON		\$ -
8	Soil Boring	40.00	LFT		\$ -
9	30" Diameter Drilled Shafts, Above Bedrock	481.57	LFT		\$ -
10	30" Diameter Drilled Shafts, Into Bedrock	360.00	LFT		\$ -
11	Steel Piles, W18x106	680.00	LFT		\$ -
12	Steel Piles, W21x111	200.00	LFT		\$ -
13	Precast Concrete Lagging, 8" Thick	2,070.00	SFT		\$ -
14	Free Draining Backfill	150.00	TON		\$ -
15	6" Perforated Pipe	230.00	LFT		\$ -
16	Cable Guardrail	280.00	LFT		\$ -
17	Seed	0.50	ACRE		\$ -
<b>TOTAL BID</b>					\$ -

Contractor Name: \_\_\_\_\_  
 Address: \_\_\_\_\_  
 Date: \_\_\_\_\_  
 Signed: \_\_\_\_\_  
 Print Name: \_\_\_\_\_  
 Title: \_\_\_\_\_