

REVISION	DESCRIPTION	REVISED BY	DATE
1	LEASING		

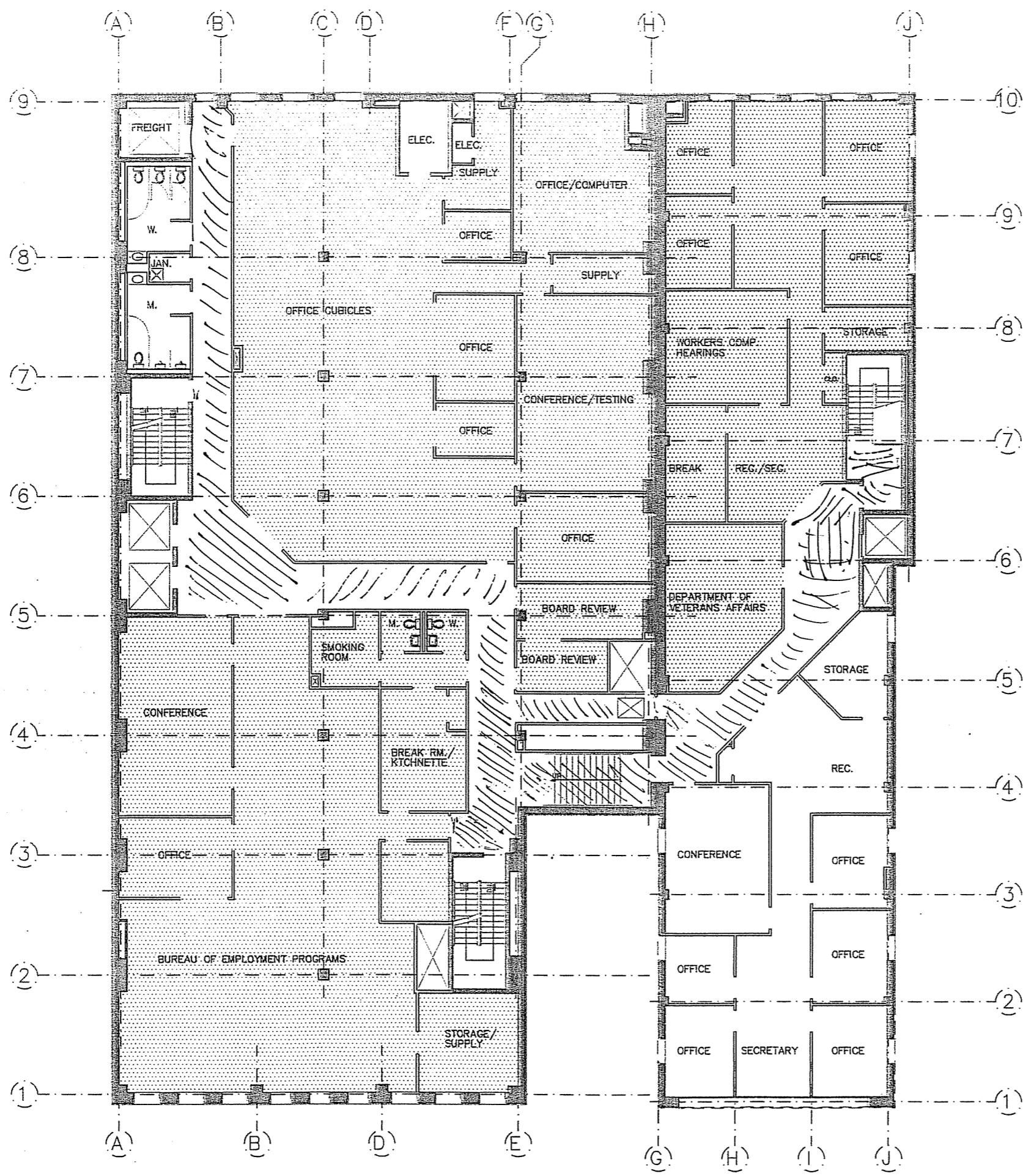

LEASING SPACE ALLOCATION

8315 S.F.	BEP
2070 S.F.	WORKERS COMP.
2070 S.F.	VW REHAB SERVICES
435 S.F.	VETERANS AFFAIRS

GROSS AREA	17610 SQ. FT.
RENTABLE AREA	15305 SQ. FT.
USABLE AREA	12890 SQ. FT.
RENTABLE / USABLE RATIO	1.19

THE ABOVE WERE QUANTIFIED USING BUILDING OWNERS AND MANAGERS ASSOCIATION'S STANDARD FOR MEASURING FLOOR AREA IN OFFICE BUILDINGS(1993), AMERICAN NATIONAL STANDARD(ANSI Z65.1-1989).

NOTE

THIS PLAN SCALED FROM EXISTING FLOOR PLANS. VERIFY ALL DIMENSIONS SCALED FROM PLAN.

**STATE OF WEST VIRGINIA**  
 DEPARTMENT OF ADMINISTRATION Xref CAD/ADMIN SUPPORT BLOCKS  
 DIVISION OF GENERAL SERVICES  
 CHARLESTON, WEST VIRGINIA

LOCATION: FAIRMONT, WEST VIRGINIA  
 BUILDING: BUILDING 21  
 PROJECT: AS-BUILT

DRAWING TITLE: THIRD FLOOR PLAN  
 DRAWN BY: FDU  
 SCALE: [REDACTED]  
 DATE: [REDACTED]

DRAWING NO: A5