



State of West Virginia
 Department of Administration
 Purchasing Division
 2019 Washington Street East
 Post Office Box 50130
 Charleston, WV 25305-0130

Request for Quotation

RFQ NUMBER:
DNR80010

PAGE:
1

ADDRESS CORRESPONDENCE TO ATTENTION OF:
BUYER 32
304-558-0492

VENDOR	RFQ COPY TYPE NAME/ADDRESS HERE
--------	------------------------------------

SHIP TO	DIVISION OF NATURAL RESOURCES PROCUREMENT OFFICE CAPITOL COMPLEX BUILDING 3, ROOM 630 CHARLESTON, WV 25305 304-558-3397
---------	-------------------------------------------------------------------------------------------------------------------------------------------------------------

DATE PRINTED	TERMS OF SALE	SHIP VIA	F.O.B.	FREIGHT TERMS
08/29/2006				

BID OPENING DATE: **09/19/2006** **BID OPENING TIME 01:30PM**

LINE	QUANTITY	UOP	CAT. NO.	ITEM NUMBER	UNIT PRICE	AMOUNT
ADDENDUM 01						
THIS ADDENDUM IS ISSUED TO CHANGE AND/OR ADD TO THE SCOPE OF WORK PER THE ATTACHED; AND TO CHANGE THE DATE OF THE BID OPENING.						
ATTACHMENTS:						
1. DNR ADDITION AND ALTERATION SPECIFICATIONS FROM ALPHA ASSOCIATES						
2. ADDENDUM ACKNOWLEDGEMENT						
REVISED BID OPENING DATE: SEPTEMBER 19, 2006, 1:30 PM						
***** END OF ADDENDUM 01 *****						

SEE REVERSE SIDE FOR TERMS AND CONDITIONS			
SIGNATURE	TELEPHONE	DATE	
TITLE	FEIN	ADDRESS CHANGES TO BE NOTED ABOVE	

WHEN RESPONDING TO RFQ, INSERT NAME AND ADDRESS IN SPACE ABOVE LABELED 'VENDOR'

**GENERAL TERMS & CONDITIONS
REQUEST FOR QUOTATION (RFQ) AND REQUEST FOR PROPOSAL (RFP)**

1. Awards will be made in the best interest of the State of West Virginia.
2. The State may accept or reject in part, or in whole, any bid.
3. All quotations are governed by the *West Virginia Code* and the *Legislative Rules* of the Purchasing Division.
4. Prior to any award, the apparent successful vendor must be properly registered with the Purchasing Division and have paid the required \$125.00 registration fee.
5. All services performed or goods delivered under State Purchase Orders/Contracts are to be continued for the term of the Purchase Order/Contract, contingent upon funds being appropriated by the Legislature or otherwise being made available. In the event funds are not appropriated or otherwise available for these services or goods, this Purchase Order/Contract becomes void and of no effect after June 30.
6. Payment may only be made after the delivery and acceptance of goods or services.
7. Interest may be paid for late payment in accordance with the *West Virginia Code*.
8. Vendor preference will be granted upon written request in accordance with the *West Virginia Code*.
9. The State of West Virginia is exempt from federal and state taxes and will not pay or reimburse such taxes.
10. The Director of Purchasing may cancel any Purchase Order/Contract upon 30 days written notice to the seller.
11. The laws of the State of West Virginia and the *Legislative Rules* of the Purchasing Division shall govern all rights and duties under the Contract, including without limitation the validity of this Purchase Order/Contract.
12. Any reference to automatic renewal is hereby deleted. The Contract may be renewed only upon mutual written agreement of the parties.
13. **BANKRUPTCY:** In the event the vendor/contractor files for bankruptcy protection, this contract is automatically null and void, and is terminated without further order.
14. **HIPAA Business Associate Addendum** - The West Virginia State Government HIPAA Business Associate Addendum (BAA), approved by the Attorney General, and available online at the Purchasing Division's web site (<http://www.state.wv.us/admin/purchase/vrc/hipaa.htm>) is hereby made part of the agreement. Provided that, the Agency meets the definition of a Covered Entity (45 CFR §160.103) and will be disclosing Protected Health Information (45 CFR §160.103) to the vendor.

INSTRUCTIONS TO BIDDERS

1. Use the quotation forms provided by the Purchasing Division.
2. **SPECIFICATIONS:** Items offered must be in compliance with the specifications. Any deviation from the specifications must be clearly indicated by the bidder. Alternates offered by the bidder as **EQUAL** to the specifications must be clearly defined. A bidder offering an alternate should attach complete specifications and literature to the bid. The Purchasing Division may waive minor deviations to specifications.
3. Complete all sections of the quotation form.
4. Unit prices shall prevail in cases of discrepancy.
5. All quotations are considered F.O.B. destination unless alternate shipping terms are clearly identified in the quotation.
6. **BID SUBMISSION:** All quotations must be delivered by the bidder to the office listed below prior to the date and time of the bid opening. Failure of the bidder to deliver the quotations on time will result in bid disqualifications.

SIGNED BID TO:

Department of Administration
Purchasing Division
2019 Washington Street East
Post Office Box 50130
Charleston, WV 25305-0130



Berkeley Springs Bath House
Addendum Bulletin No. 1

DEPT. of Natural Resources
Additions and Alterations to
Berkeley Springs Bath House

AAI PROJECT NO.: 0408097.00
DNR-80010
August 28, 2006

TO ALL BIDDERS:

1.0 GENERAL NOTES:

- .01 This Addendum is part of the Contract Documents for the Project.
- .02 Acknowledge receipt of this Addendum on the Form of Proposal in the space provided. Failure to do so may be cause for rejection of bid.
- .03 A Mandatory Pre-Bid Conference was held on August 23, 2006. Copies of the Pre-Bid Conference Minutes and Attendance List are appended to this Addendum.

2.0 CORRECTIONS/ADDITIONS TO THE PROJECT MANUAL:

- .01 **Bid Invitation:** Page 2:
OMIT: " The bidder, ... agrees that all work is to be completed within 180 consecutive calendar days...."
ADD: " The bidder, ... agrees that all work is to be completed within 240 consecutive calendar days...."
- .02 **ADD:** Attached information regarding quantity of suspected Asbestos containing material to be removed by General Contractor. See Fax Transmission dated 7/5/06 attached. This is not a laboratory report.
- .03 **DIVISION 08710-Door Hardware**
OMIT: Division 08710-Door Hardware as bound in the Project Manual.
ADD: Division 08710- Door Hardware as attached.



- .04 **DIVISION 015411- Roman Tub Bath**
ADD: Add attached Section 015411 to Project Manual

3.0 CORRECTIONS/ADDITIONS TO THE PROJECT DRAWINGS:

- .01 **Sheet A-6.1**
ADD: Hardware Set No. as shown on attached AD-001
ADD: 1 Hr. Fire rated door to Door-111
ADD: Note 5.: Provide Fire rated door frame.
- .02 **Sheet E-1.1**
ADD: AD-002 as attached, showing correct location of existing flagpole.

4.0 CORRECTIONS/ADDITIONS TO THE PROJECT:

- .01 **ADD:** "Contractor to provide three (3) modular workplace units similar or approved equal to Whitley Manufacturing Co., P.O. Box 496, South Whitney, IN 46787 (Tel. 260-723-5131) Models MO-4757-3 (74' x 13'-9"), MO-4495-2 (40' x 9'-9") and SLTF-5839-6 (36' x 9'-9"). Location of modular units shall be as set forth on attached drawing. Price shall include all temporary set-up costs, including delivery, leveling, blocking, anchoring and steps, nine month rental fee, and all removal costs. Utility connections will be by Owner. Modular units must be in place and operational prior to demolition of existing bath house." See attached sketch "Location of Modular work place building". Modulares are to be part of the Base Bid.
- .02 **CLARIFICATION:** After conversation with the sewer authority, the Owner states that the sewer tap fee will be waived.
- .03 **CLARIFICATION:** Referencing the demolition drawing note for re-use of equipment: some of the equipment and piping will be tagged by the Owner prior to the start of demolition for re-use. Tagged equipment and piping will be carefully removed and saved on site. The owner will remove these items from the site and transport them to the Owner's storage.

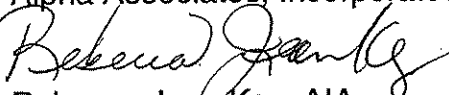

-
- .04 **CLARIFICATION:** Demo all existing electric heaters as part of electrical demolition.
 - .05 **CLARIFICATION:** All MEP demolition is included in the Project Work.

Issued: August 28, 2006
Alpha Associates, Incorporated

Rebecca Jean Key, AIA



FAX TRANSMISSION

WVDNR Parks & Recreation
 Elkins Planning, Engineering & Maintenance
 1200 Harrison Ave., Suite 222
 Elkins, WV 26241
 Telephone 304-637-0300
 Fax 304-637-0303

TO: Rebecca Key

DATE: 7/5/06

FAX#:

Pages (incl. this page): 1

FROM: Dore Smith

SUBJECT: Berkeley Springs S.A. Bathhouse
 Asbestos Totals

COMMENTS:

Pipe Insulation Total - 499.5 L.F. (90% is 3" pipe, 10% is 1 1/2" pipe)

VAT Total -

Electric Room	63.0	sq. ft
Wash Room	37.5	sq. ft.
Small Office	91.0	sq. ft.
Room to Roof (1)	96.0	sq. ft
Steps to Roof (2 sets)	113.1	sq. ft
Closets (2) beneath steps	88.1	sq. ft
Roman Bath Room (1)	120.0	sq. ft
Supply Room - Women	41.6	sq. ft.
Stock Room	78.9	sq. ft
Chemical Room	112.0	sq. ft
	<u>841.2</u>	sq. ft

SECTION 08710 - DOOR HARDWARE

PART 1 - GENERAL

1.1 RELATED DOCUMENTS

- A. Drawings and general provisions of the Contract, including General and Supplementary Conditions and Division 01 Specification Sections, apply to this Section.

1.2 SUMMARY

- A. This Section includes the following:
 - 1. Commercial door hardware for the following:
 - a. Swinging doors, fire rated and non fire rated
 - b. Other doors to the extent indicated.
 - c. Cylinders for doors.
- B. Related Sections include the following:
 - 1. Division 08 Section "Hollow Metal Doors and Frames"
 - 2. Division 08 Section "Stile and Rail Wood Doors"

1.3 SUBMITTALS

- A. Product Data: Include construction and installation details, material descriptions, dimensions of individual components and profiles, and finishes.
- B. Samples for Initial Selection: For each finish, color, and texture required for each type of door hardware indicated.
 - 1. Samples will be returned to Contractor. Units that are acceptable and remain undamaged through submittal, review, and field comparison process may, after final check of operation, be incorporated into the Work, within limitations of keying requirements.
- C. Qualification Data: For Architectural Hardware Consultant.
- D. Maintenance Data: For each type of door hardware to include in maintenance manuals. Include final keying schedule.
- E. Warranty: Special warranty specified in this Section.

**ALTERATIONS AND ADDITIONS TO BATH HOUSE
BERKELEY SPRINGS, WEST VIRGINIA**

**08710-2
DIVISION 8**

F. Other Action Submittals:

1. Door Hardware Sets: Prepared by or under the supervision of Architectural Hardware Consultant, detailing fabrication and assembly of door hardware, as well as procedures and diagrams. Coordinate the final door hardware sets with doors, frames, and related work to ensure proper size, thickness, hand, function, and finish of door hardware.
 - a. Format: Comply with scheduling sequence and vertical format in DHI's "Sequence and Format for the Hardware Schedule." Double space entries, and number and date each page.
 - b. Content: Include the following information:
 - 1) Identification number, location, hand, fire rating, and material of each door and frame.
 - 2) Type, style, function, size, quantity, and finish of each door hardware item.
 - 3) Complete designations of every item required for each door or opening including name and manufacturer.
 - 4) Fastenings and other pertinent information.
 - 5) Location of each door hardware set, cross-referenced to Drawings, both on floor plans and in door and frame schedule.
 - 6) Explanation of abbreviations, symbols, and codes contained in schedule.
 - 7) Mounting locations for door hardware.
 - 8) Door and frame sizes and materials.
 - 9) Description of each electrified door hardware function, including location, sequence of operation, and interface with other building control systems.
 - a) Sequence of Operation: Include description of component functions that occur in the following situations: authorized person wants to enter; authorized person wants to exit; unauthorized person wants to enter; unauthorized person wants to exit.
 - 10) List of related door devices specified in other Sections for each door and frame.
 - c. Submittal Sequence: Submit the final door hardware sets at earliest possible date, particularly where approval of the door hardware sets must precede fabrication of other work that is critical in Project construction schedule. Include Product Data, Samples, Shop Drawings of other work affected by door hardware, and other information essential to the coordinated review of the door hardware sets.

**ALTERATIONS AND ADDITIONS TO BATH HOUSE
BERKELEY SPRINGS, WEST VIRGINIA**

**08710-3
DIVISION 8**

2. Keying Schedule: Prepared by or under the supervision of Architectural Hardware Consultant, detailing Owner's final keying instructions for locks. Include schematic keying diagram and index each key set to unique door designations.

1.4 QUALITY ASSURANCE

- A. Architectural Hardware Consultant Qualifications: A person who is currently certified by DHI as an Architectural Hardware Consultant and who is experienced in providing consulting services for door hardware installations that are comparable in material, design, and extent to that indicated for this Project.
- B. Source Limitations: Obtain each type and variety of door hardware from a single manufacturer, unless otherwise indicated.
- C. Fire-Rated Door Assemblies: Assemblies complying with NFPA 80 that are listed and labeled by a testing and inspecting agency acceptable to authorities having jurisdiction, for fire ratings indicated, based on testing according to NFPA 252.
- D. Keying Conference: Obtain keying instructions from Architect and/or Owner.

1.5 DELIVERY, STORAGE, AND HANDLING

- A. Inventory door hardware on receipt and provide secure lock-up for door hardware delivered to Project site.
- B. Tag each item or package separately with identification related to the final door hardware sets, and include basic installation instructions, templates, and necessary fasteners with each item or package.
- C. Deliver permanent keys to Owner by registered mail or overnight package service.

1.6 COORDINATION

- A. Templates: Distribute door hardware templates for doors, frames, and other work specified to be factory prepared for installing door hardware. Check Shop Drawings of other work to confirm that adequate provisions are made for locating and installing door hardware to comply with indicated requirements.
- B. Electrical System Roughing-in: Coordinate layout and installation of electrified door hardware with connections to power supplies and fire alarm system.

**ALTERATIONS AND ADDITIONS TO BATH HOUSE
BERKELEY SPRINGS, WEST VIRGINIA**

**08710-4
DIVISION 8**

- C. Existing Openings: Where new hardware components are scheduled for application to existing construction or where modifications to existing door hardware are required, field verify existing conditions and coordinate installation of door hardware to suit opening conditions and to provide for proper operation.

1.7 WARRANTY

- A. Special Warranty: Manufacturer's standard form in which manufacturer agrees to repair or replace components of door hardware that fail in materials or workmanship within specified warranty period.
1. Failures include, but are not limited to, the following:
 - a. Structural failures including excessive deflection, cracking, or breakage.
 - b. Faulty operation of operators and door hardware.
 - c. Deterioration of metals, metal finishes, and other materials beyond normal weathering and use.
 2. Warranty Period: Manufacturer's standard warranties.

1.8 MAINTENANCE SERVICE

- A. Maintenance Tools and Instructions: Furnish a complete set of specialized tools and maintenance instructions as needed for Owner's continued adjustment, maintenance, and removal and replacement of door hardware.

PART 2 - PRODUCTS

2.1 SCHEDULED DOOR HARDWARE

- A. General: Provide door hardware for each door to comply with requirements in this Section.
1. Door Hardware Sets: Provide quantity, item, size, finish or color indicated, using named manufacturers listed in the following paragraphs of this section and hardware sets.
- B. Designations: Requirements for design, grade, function, finish, size, and other distinctive qualities of each type of door hardware are indicated in Part 3 "Door Hardware Sets" Article. Products are identified by using door hardware designations, as follows:

**ALTERATIONS AND ADDITIONS TO BATH HOUSE
BERKELEY SPRINGS, WEST VIRGINIA****08710-5
DIVISION 8**

1. In other Part 2 articles where titles below introduce lists, the following requirements apply to product selection:
2. Manufacturers: Subject to compliance with requirements, provide products by the manufacturers specified.

2.2 HINGES

- A. Quantity: Provide the following, unless otherwise indicated:
 1. Two Hinges: For doors with heights up to 60 inches (1524 mm).
 2. Three Hinges: For doors with heights 61 to 90 inches (1549 to 2286 mm).
 3. Four Hinges: For doors with heights 91 to 120 inches (2311 to 3048 mm).
 4. For doors with heights more than 120 inches (3048 mm), provide 4 hinges, plus 1 hinge for every 30 inches (750 mm) of door height greater than 120 inches (3048 mm).
- B. Template Requirements: Except for hinges and pivots to be installed entirely (both leaves) into wood doors and frames, provide only template-produced units.
- C. Hinge Weight: Unless otherwise indicated, provide the following:
 1. Entrance Doors: Heavy-weight hinges.
 2. Doors with Closers: Antifriction-bearing hinges.
 3. Interior Doors: Standard-weight hinges.
- D. Hinge Base Metal: Unless otherwise indicated, provide the following:
 1. Exterior Hinges – Front Entrance Door: Brass, with stainless-steel pin body and brass decorative protruding heads.
 2. Exterior Hinges – All other exterior doors: Stainless steel, with stainless-steel pin.
 3. Interior Hinges: Brass, with stainless-steel pin body and brass protruding heads or stainless steel – see Section 3 - Hardware Sets
 4. Hinges for Fire-Rated Assemblies: Stainless steel, with stainless-steel pin.
 5. Decorator Tips: Steeple.
 6. Corners: Square
- E. Fasteners: Comply with the following:
 1. Machine Screws: For metal doors and frames. Install into drilled and tapped holes.
 2. Wood Screws: For wood doors and frames.
 3. Threaded-to-the-Head Wood Screws: For fire-rated wood doors.

**ALTERATIONS AND ADDITIONS TO BATH HOUSE
BERKELEY SPRINGS, WEST VIRGINIA****08710-6
DIVISION 8**

4. Screws: Phillips flat-head; machine screws (drilled and tapped holes) for metal doors wood screws for wood doors and frames. Finish screw heads to match surface of hinges.

2.3 HINGES

- A. Butts and Hinges: BHMA A156.1.
- B. Template Hinge Dimensions: BHMA A156.7.
- C. Available Manufacturers:
 1. Ives.
 2. Hager Companies (HAG):
 3. McKinney Products Company; an ASSA ABLOY Group company (MCK).
 4. PBB, Inc. (PBB).
 5. Stanley Commercial Hardware; Div. of The Stanley Works (STH).

2.4 LOCKS AND LATCHES, GENERAL

- A. Accessibility Requirements: Where indicated to comply with accessibility requirements, comply with the U.S. Architectural & Transportation Barriers Compliance Board's "Americans with Disabilities Act (ADA), Accessibility Guidelines for Buildings and Facilities (ADAAG)
 1. Provide operating devices that do not require tight grasping, pinching, or twisting of the wrist and that operate with a force of not more than 5 lbf (22 N).
- B. Latches and Locks for Means of Egress Doors: Comply with NFPA 101. Latches shall not require more than 15 lbf (67 N) to release the latch. Locks shall not require use of a key, tool, or special knowledge for operation.
- C. Lock Trim:
 1. Levers: Cast.
 2. Escutcheons (Roses): Wrought
 3. Dummy Trim: Match lever lock trim and escutcheons.
 4. Lockset Designs: Provide design indicated in Section 3 below or, if sets are provided by another manufacturer, provide designs that match those designated.
- D. Lock Throw: Comply with testing requirements for length of bolts required for labeled fire doors, and as follows:
 1. Bored Locks: Minimum 1/2-inch (13-mm) latchbolt throw.

**ALTERATIONS AND ADDITIONS TO BATH HOUSE
BERKELEY SPRINGS, WEST VIRGINIA****08710-7
DIVISION 8**

2. Mortise Locks: Minimum 3/4-inch (19-mm) latchbolt throw.
 3. Deadbolts: Minimum 1-inch (25-mm) bolt throw.
- E. Backset: 2-3/4 inches (70 mm), unless otherwise indicated.
- F. Strikes: Manufacturer's standard strike with strike box for each latchbolt or lock bolt, with curved lip extended to protect frame, finished to match door hardware set, and as follows:
1. Strikes for Bored Locks and Latches: BHMA A156.2.
 2. Strikes for Mortise Locks and Latches: BHMA A156.13.
 3. Strikes for Interconnected Locks and Latches: BHMA A156.12.
 4. Strikes for Auxiliary Deadlocks: BHMA A156.5.
 5. Flat-Lip Strikes: For locks with three-piece antifriction latchbolts, as recommended by manufacturer.
 6. Extra-Long-Lip Strikes: For locks used on frames with applied wood casing trim.
 7. Aluminum-Frame Strike Box: Manufacturer's special strike box fabricated for aluminum framing.

2.5 MECHANICAL LOCKS AND LATCHES

- A. Lock Functions: Function numbers and descriptions indicated in door hardware sets comply with the following:
1. Bored Locks: BHMA A156.2.
 2. Mortise Locks: BHMA A156.13.
 3. Interconnected Locks: BHMA A156.12.
- B. Bored Locks: BHMA A156.2, Series 4000.
1. Available Manufacturers:
 - a. Best Access Systems; Div. of The Stanley Works (BAS).
 - b. SARGENT Manufacturing Company; an ASSA ABLOY Group company (SGT).
 - c. Schlage Commercial Lock Division; an Ingersoll-Rand Company (SCH).
 - d. Weiser Lock; a Masco Company (WEI).
- C. Mortise Locks: Stamped steel case with steel or brass parts; BHMA A156.13 Series 1000.
1. Available Manufacturers:
 - a. Best Access Systems; Div. of The Stanley Works (BAS).
 - b. SARGENT Manufacturing Company; an ASSA ABLOY Group company (SGT).

**ALTERATIONS AND ADDITIONS TO BATH HOUSE
BERKELEY SPRINGS, WEST VIRGINIA**

**08710-8
DIVISION 8**

- c. Schlage Commercial Lock Division; an Ingersoll-Rand Company (SCH).

2.6 DOOR BOLTS

- A. Bolt Throw: Comply with testing requirements for length of bolts required for labeled fire doors, and as follows:
 - 1. Mortise Flush Bolts: Minimum 3/4-inch (19-mm) throw.
- B. Manual Flush Bolts: BHMA A156.16, Grade 1 unless Grade 2 is indicated designed for mortising into floor and frame at top of door.
 - 1. Available Manufacturers:
 - a. McKinney
 - b. Burns Manufacturing Incorporated (BM).
 - c. Hager Companies (HAG).
 - d. IVES Hardware; an Ingersoll-Rand Company (IVS).
 - e. Stanley Commercial Hardware; Div. of The Stanley Works (STH).

2.7 EXIT DEVICES

- A. Exit Devices: BHMA A156.3.
- B. Accessibility Requirements: Where handles, pulls, latches, locks, and other operating devices are indicated to comply with accessibility requirements, comply with the U.S. Architectural & Transportation Barriers Compliance Board's "Americans with Disabilities Act (ADA), Accessibility Guidelines for Buildings and Facilities (ADAAG)." FED-STD-795, "Uniform Federal Accessibility Standards."
 - 1. Provide operating devices that do not require tight grasping, pinching, or twisting of the wrist and that operate with a force of not more than 5 lbf (22 N).
- C. Exit Devices for Means of Egress Doors: Comply with NFPA 101. Exit devices shall not require more than 15 lbf (67 N) to release the latch. Locks shall not require use of a key, tool, or special knowledge for operation.

2.8 LOCK CYLINDERS

- A. Standard Lock Cylinders: BHMA A156.5, Grade 1 unless Grade 1A is indicated

- B. Cylinders: Manufacturer's standard tumbler type, constructed from brass or bronze, stainless steel, or nickel silver, and complying with the following:
 - 1. Number of Pins: Six
 - 2. Mortise Type: Threaded cylinders with rings and straight- or clover-type cam.
 - 3. Bored-Lock Type: Cylinders with tailpieces to suit locks.
- C. Permanent Cores: Manufacturer's standard; finish face to match lockset; complying with the following:
 - 1. Removable Cores: Core insert, removable by use of a special key; for use only with core manufacturer's cylinder and door hardware.
- D. Construction Keying: Comply with the following:
 - 1. Construction Master Keys: Provide cylinders with feature that permits voiding of construction keys without cylinder removal. Provide 10 construction master keys.
 - 2. Construction Cores: Provide construction cores that are replaceable by permanent cores. Provide 10 construction master keys.
 - a. Replace construction cores with permanent cores as indicated in keying schedule and as directed by Owner.
- E. Manufacturer: Same manufacturer as for locks and latches.
- F. Available Manufacturers:
 - 1. ASSA, Inc.; an ASSA ABLOY Group company (ASA).
 - 2. Best Access Systems; Div. of The Stanley Works (BAS).
 - 3. SARGENT Manufacturing Company; an ASSA ABLOY Group company (SGT).
 - 4. Schlage Commercial Lock Division; an Ingersoll-Rand Company (SCH).

2.9 KEYING

- A. Keying System: Factory registered. Incorporate decisions made in keying conference.
 - 1. Master Key System: Cylinders are operated by a change key and a master key.
 - 2. Provide construction Master Keyed Cylinders.

2.10 OPERATING TRIM

- A. Standard: BHMA A156.6

- B. Materials: Fabricate from aluminum brass or stainless steel, unless otherwise indicated.
- C. Available Manufacturers:
 - 1. Burns Manufacturing Incorporated (BM).
 - 2. Hager Companies (HAG).
 - 3. IVES Hardware; an Ingersoll-Rand Company (IVS).
 - 4. Rockwood Manufacturing Company (RM).

2.11 CLOSERS

- A. Size of Units: Unless otherwise indicated, comply with manufacturer's written recommendations for size of door closers depending on size of door, exposure to weather, and anticipated frequency of use. Provide factory-sized closers, adjustable to meet field conditions and requirements for opening force.
- B. Surface Closers: As specified in hardware sets.
 - 1. Manufacturers:
 - a. Corbin Russwin Architectural Hardware; an ASSA ABLOY Group company (CR).
 - b. **Norton Door Controls; an ASSA ABLOY Group company (NO).**
 - c. SARGENT Manufacturing Company; an ASSA ABLOY Group company (SGT).
 - d. Yale Commercial Locks and Hardware; an ASSA ABLOY Group company (YAL).
 - e. LCN Closers; an Ingersoll-Rand Company (LCN)

2.12 STOPS AND HOLDERS

- A. Stops and Bumpers: As specified in hardware sets.
 - 1. Provide floor stops for doors unless wall or other type stops are scheduled or indicated. Do not mount floor stops where they will impede traffic.
- B. Silencers for Wood Door Frames: Neoprene or rubber, minimum 5/8 by 3/4 inch; fabricated for drilled-in application to frame. As specified in hardware sets.
- C. Silencers for Metal Door Frames: Neoprene or rubber, minimum diameter 1/2 inch; fabricated for drilled-in application to frame.
- D. Manufacturers:
 - 1. Hager Companies (HAG).

2. IVES Hardware; an Ingersoll-Rand Company (IVS).
3. **Rockwood Manufacturing Company (RO).**
4. SARGENT Manufacturing Company; an ASSA ABLOY Group company (SGT).
5. Stanley Commercial Hardware; Div. of The Stanley Works (STH).
6. Trimco (TBM).

2.13 THRESHOLDS

- A. Standard: BHMA A156.21. Listed under Category J in BHMA's "Certified Product Directory."
- B. Accessibility Requirements: Where thresholds are indicated to comply with accessibility requirements, comply with the U.S. Architectural & Transportation Barriers Compliance Board's "Americans with Disabilities Act (ADA), Accessibility Guidelines for Buildings and Facilities (ADAAG)."
 1. Bevel raised thresholds with a slope of not more than 1:2. Provide thresholds not more than 1/2 inch (13 mm) high
- C. Thresholds for Means of Egress Doors: Comply with NFPA 101. Maximum 1/2 inch (13 mm) high.
- D. Available Manufacturers – Metal Thresholds:
 1. Hager Companies (HAG).
 2. National Guard Products (NGP).
 3. Pemko Manufacturing Co. (PEM).

2.14 FOLDING DOOR HARDWARE

- A. General: BHMA A156.14; consisting of complete sets including overhead rails, hangers, supports, bumpers, floor guides, and accessories indicated.
 1. Interior Doors: Provide door hardware for interior bifolding doors when not furnished as part of door package.
- B. Bi-folding Door Hardware: Rated for door panels weighing up to [125 lb (57 kg)] [50 lb (23 kg)].
- C. Available Manufacturers:
 1. Cox, Arthur & Sons, Inc. (ACS).
 2. Hager Companies (HAG).
 3. Henderson, P. C. Inc.; Div. of Hepworth PLC (PCH).
 4. Johnson, L. E. Products, Inc. (LEJ).

5. Lawrence Brothers, Inc. (LB).
6. Stanley Commercial Hardware; Div. of The Stanley Works (STH).

2.15 FABRICATION

- A. Manufacturer's Nameplate: Do not provide products that have manufacturer's name or trade name displayed in a visible location except in conjunction with required fire-rated labels and as otherwise approved by Architect.
 1. Manufacturer's identification is permitted on rim of lock cylinders only.
- B. Base Metals: Produce door hardware units of base metal, fabricated by forming method indicated, using manufacturer's standard metal alloy, composition, temper, and hardness. Furnish metals of a quality equal to or greater than that of specified door hardware units and BHMA A156.18. Do not furnish manufacturer's standard materials or forming methods if different from specified standard.
- C. Fasteners: Provide door hardware manufactured to comply with published templates generally prepared for machine, wood, and sheet metal screws. Provide screws according to commercially recognized industry standards for application intended, except aluminum fasteners are not permitted. Provide Phillips flat-head screws with finished heads to match surface of door hardware, unless otherwise indicated.
 1. Concealed Fasteners: For door hardware units that are exposed when door is closed, except for units already specified with concealed fasteners. Do not use through bolts for installation where bolt head or nut on opposite face is exposed unless it is the only means of securely attaching the door hardware. Where through bolts are used on hollow door and frame construction, provide sleeves for each through bolt.
 2. Steel Machine or Wood Screws: For the following fire-rated applications:
 - a. Mortise hinges to doors.
 - b. Strike plates to frames.
 - c. Closers to doors and frames.
 3. Fasteners for Wood Doors: Comply with requirements in DHI WDHS.2, "Recommended Fasteners for Wood Doors."

2.16 FINISHES

- A. Standard: BHMA A156.18, as indicated in door hardware sets.
- B. Protect mechanical finishes on exposed surfaces from damage by applying a strippable, temporary protective covering before shipping.

- C. Appearance of Finished Work: Variations in appearance of abutting or adjacent pieces are acceptable if they are within one-half of the range of approved Samples. Noticeable variations in the same piece are not acceptable. Variations in appearance of other components are acceptable if they are within the range of approved Samples and are assembled or installed to minimize contrast.

PART 3 - EXECUTION

3.1 EXAMINATION

- A. Proceed with installation only after unsatisfactory conditions have been corrected.

3.2 PREPARATION

- A. Steel Doors and Frames: Comply with DHI A115 Series.
 - 1. Surface-Applied Door Hardware: Drill and tap doors and frames according to ANSI A250.6.
- B. Wood Doors: Comply with DHI A115-W Series.

3.3 INSTALLATION

- A. Mounting Heights: Mount door hardware units at heights indicated on drawings or required to comply with governing regulations.
 - 1. Standard Steel Doors and Frames: DHI's "Recommended Locations for Architectural Hardware for Standard Steel Doors and Frames."
 - 2. Wood Doors: DHI WDHS.3, "Recommended Locations for Architectural Hardware for Wood Flush Doors."
- B. Install each door hardware item to comply with manufacturer's written instructions. Where cutting and fitting are required to install door hardware onto or into surfaces that are later to be painted or finished in another way, coordinate removal, storage, and reinstallation of surface protective trim units with finishing work specified in Division 09 Sections. Do not install surface-mounted items until finishes have been completed on substrates involved.
 - 1. Set units level, plumb, and true to line and location. Adjust and reinforce attachment substrates as necessary for proper installation and operation.
 - 2. Drill and countersink units that are not factory prepared for anchorage fasteners. Space fasteners and anchors according to industry standards.

- C. Boxed Power Supplies: Locate power supplies as indicated. Verify location with Architect.
 - 1. Configuration: Provide the least number of power supplies required to adequately serve doors with electrified door hardware.

3.4 ADJUSTING

- A. Initial Adjustment: Adjust and check each operating item of door hardware and each door to ensure proper operation or function of every unit. Replace units that cannot be adjusted to operate as intended. Adjust door control devices to compensate for final operation of heating and ventilating equipment and to comply with referenced accessibility requirements.
 - 1. Spring Hinges: Adjust to achieve positive latching when door is allowed to close freely from an open position of 30 degrees.
 - 2. Door Closers: Unless otherwise required by authorities having jurisdiction, adjust sweep period so that, from an open position of 70 degrees, the door will take at least 3 seconds to move to a point 3 inches from the latch, measured to the leading edge of the door.

3.5 CLEANING AND PROTECTION

- A. Clean adjacent surfaces soiled by door hardware installation.
- B. Clean operating items as necessary to restore proper function and finish.
- C. Provide final protection and maintain conditions that ensure that door hardware is without damage or deterioration at time of Substantial Completion.

3.6 DOOR HARDWARE SETS

A. Door Hardware Set No. 01

Doors: D-100

Function: Entrance, double locking with separate deadbolt. ANSI 97

Hinges: 1-1/2 pair 4" ball bearing 5 knuckle butt type with decorative steeple tips. Fin Bright Brass

Handles/Knobs: Schlage lever style Flair, S-200 Series or Equal. Fin Brass
605

Locks: Deadbolt with interchangeable core.

Closer(s): LCN surface mount model #1460. Finish – Bright Brass

B. Door Hardware Set No. 02

Doors: D-101

Function: Entry Lock, keyed outside, thumb turn inside.

Hinges: 1 ½ pair 3 ½" ball bearing 5 knuckle butt type with decorative steeple tips. Fin Bright Brass, provide 180° hinges for center pair.

Handles/Knobs: Schlage lever style Flair, S- Series or Equal. Fin Brass 605

Locks: Inter Changeable Core.

Bolts: Top/bottom flush mount bolts. Fin Bright Brass

Accessories: Bright Brass Kick plates – 9x24. Both sides interior leafs, one side exterior leafs – provide 6.

C. Door Hardware Set No. 03

Doors: D-135A, D-135B, D-102, D-117, D-165A, D-165B

Function: Passage Latch

Hinges: 1 ½ pair 3 ½" ball bearing 5 knuckle butt type with ball decorative tips. Finish - Bright Brass

Handles/Knobs: Schlage lever style, Flair, S- Series or Equal. Finish – Bright Brass 605

Locks: Latch Only.

Closer(s): LCN surface mount model #1460. Finish Brass with delayed closer

D. Door Hardware Set No. 04

Doors: D-119, D-120, D-122, D-149, D-150, D-160.

- Function: ANSI F76 Bed/Bath Privacy Lock. Push button locking. Turning inside lever releases push button. Can open from outside in case of emergency.
- Hinges: 1 ½ pair, 3 ½" ball bearing 5 knuckles butt type. Finish – 626 Satin Chromium Plated
- Handles/Knobs: Schlage lever style Jupiter S-Series or Equal. Finish – 626 Satin Chromium Plated.
- Locks: Latch
- Closer(s): LCN surface mount model #1460 – Finish – Aluminum

E. Door Hardware Set No. 05

- Doors: D-103, D-115
- Function: ANSI F90 – Classroom Lock. Outside lever locked / unlocked by key, push button locking from inside.
- Hinges: 1 ½ pair, 3 ½" ball bearing butt type. Finish Satin Chromium or Brushed Stainless Steel.
- Handles/Knobs: Schlage lever style Jupiter S-Series or equal. Finish – 626 Satin Chromium.
- Locks: Bored

F. Door Hardware Set No. 06

- Doors: D-105, D-111, D-162, D-163
- Function: Storeroom Lock, outside lever fixed, entrance by key only. Inside lever always unlocked.
- Hinges: 1 ½ pair, 3 ½" ball bearing butt type. Finish Satin Chromium or Brushed Stainless Steel.
- Handles/Knobs: Schlage Lever Style Jupiter S Series or Equal. Finish 626 Satin Chromium.
- Locks: Bored

Closer: LCN Surface Mount Model #1460 – Finish Aluminum.

G. Door Hardware Set No. 07

Doors: D-109B, D-113, D-159

Function: Exit Lock. Blank plate outside, inside lever always unlocked.
Match to door thickness.

Hinges: 1 ½ pair 4" ball bearing butt type. Finish – Brushed Stainless
Steel or Satin Chromium Plated

Handles/Knobs: Schlage lever style Jupiter AL Series or equal. Finish – 626
Satin Chromium Plated.

Locks: Bored

Thresholds: Metal Exterior ½" Threshold

H. Door Hardware Set No. 08

Doors: D-108, D-109A, D-154

Function: Push Pull

Hinges: 1 ½ pair 3" ball bearing butt type. Finish – Brushed Stainless
Steel or Satin Chrome.

Handles/Knobs: Schlage Lever Style Jupiter S Series or Equal

Closers: LCN #1460 Surface Aluminum

Locks: None

I. Door Hardware Set No. 09

Doors: D-104, D-106

Function: Passage

Hinges: 1 ½ pair 3" ball bearing butt type. Finish – Brushed Stainless Steel or Satin Chrome.

Handles/Knobs: Schlage Lever Style Jupiter S Series or Equal

Locks: None – Latch Only

J. Door Hardware Set No. 10

Doors: D-121

Function: Bi-fold wood doors at Closet 121

Hinges: Part of set – see below

Handles/Knobs Part of set-see below

Notes: Basis of Hardware Design: Johnson Hardware Bi-Fold door hardware set #100FD484

END OF SECTION 08710

SECTION 15411 – ROMAN BATHS

PART 1 GENERAL

1.1 SECTION INCLUDES

- A. Fiberglass Roman Bath Units.

1.2 RELATED SECTIONS

- A. Section 15410 – Plumbing Fixtures: Plumbing fixtures, valves and fittings not furnished with units.

1.3 REFERENCES

- A. ATBCB ADAAG – Americans with Disabilities Act Accessibility Guidelines.
- B. ANSI Z124.1 – American National Standard for Plastic Bathtub Units.
- C. ANSI Z124.2 – American National Standard for Plastic Shower Units.
- D. ASTM E 84 – Standard Test Method for Surface Burning Characteristics of Building Materials.
- E. ASTM F 446 – Standard Consumer Safety Specification for Grab Bars and Accessories Installed in the Bathing Area.
- F. HUD Use of Materials Bulletin 73A – Building Product Standards and Certification Program for Plastic Bathroom Fixtures.

1.4 SUBMITTALS

- A. Submit under provisions of Section 01330.
- B. Product Data: Manufacturer's data sheets on each product to be used, including:
 - 1. Preparation instructions and recommendations.
 - 2. Storage and handling requirements and recommendations.
 - 3. Installation methods.
- C. Verification Samples: For each finish product specified, two samples, minimum size 6 inches (150 mm) square, representing actual product, color, and patterns.

1.5 DELIVERY, STORAGE, AND HANDLING

- A. Store products in manufacturer's unopened packaging inside a building until ready for installation.

1.6 WARRANTY

- A. Provide manufacturer's 3-year limited warranty.

PART 2 PRODUCTS

2.1 AVAILABLE MANUFACTURERS

- A. Bowling United Industries, Inc.
P.O. Box 2250
Danville, VA 24541
1-800-446-7400 Phone
1-434-822-2210 Fax
www.buichurch.com
- B. Viking Pools
Jane Lew, WV
304-884-6954
- C. Custom Plastics Group Ltd.
www.custom-plastics.com
604-857-0080 ext. 512
Shannon Wall
- C. Other Manufacturer's that can meet performance specification.

2.2 MATERIALS

- A. The fiberglass Roman Tub shall be manufactured with molded one-piece construction & shall be constructed with layers of top quality fiberglass & polyester resins, be sufficiently re-reinforced with molded-in exterior lateral supports to permit the fiberglass baptistry to be filled while free standing. The compression strength shall be a minimum of 38,000 PSI (Edgewise) & tensile strength shall be 32,000 PSI (Average). The thickness shall be a minimum of 3/16". The interior shall have a smooth, high gloss, porcelain like finish. All corners shall be gently rounded, steps, and bottom of tub shall have a non-skid surface for safety.
- B. Molded Fiberglass Units: Minimum 15 percent fiberglass content, cellular inner core, reinforced polyester outer coating; complying with ANSI Z124.1 or Z124.2, as applicable.
 - 1. Certified by NAHB to meet the requirements of HUD Use of Materials Bulletin 73A.
 - 2. Surface Burning Characteristics: Flame spread index less than 200; smoke developed index less than 450; when tested in accordance with ASTM E 84 or NFPA 255 (Class C).
 - 3. Gelcoated Finish: Sanitary grade polyester gelcoat, high gloss..
 - 4. Reinforcement for Future Grab Bars: Provide continuous 1/2 inch (13 mm) thick plywood fiberglassed into all three sides, complying with ASTM F 446, Uniform Federal Accessibility Standards, and HUD requirements.
 - 5. Wood base supporting bottom of unit, attached with fiberglass coating.
 - 6. Self-caulking chrome-plated brass drain.
- C. Grab Bars: Type 304 stainless steel; configuration complying with ANSI A117.1, ADAAG, and ASTM F 446.
 - 1. Size: 1-1/2 inches (37 mm) diameter tube, 18 gage wall thickness.

2. Mounting: Concealed stainless steel bolts and nuts, with escutcheon of same finish as bar.
3. Height: As shown on drawings.

PART 3 EXECUTION

3.1 EXAMINATION

- A. Do not begin installation until substrates have been properly prepared.
- B. If substrate preparation is the responsibility of another installer, notify Architect of unsatisfactory preparation before proceeding.

3.2 PREPARATION

- A. Clean surfaces using the methods recommended by the manufacturer for achieving the best result for the substrate under the project conditions.
- B. Prepare surfaces using the methods recommended by the manufacturer for achieving the best result for the substrate under the project conditions.

3.3 INSTALLATION

- A. Install in accordance with manufacturer's instructions.

3.4 PROTECTION

- A. Protect installed products until completion of project.
- B. Touch-up, repair or replace damaged products after Substantial Completion.

END OF SECTION 15411

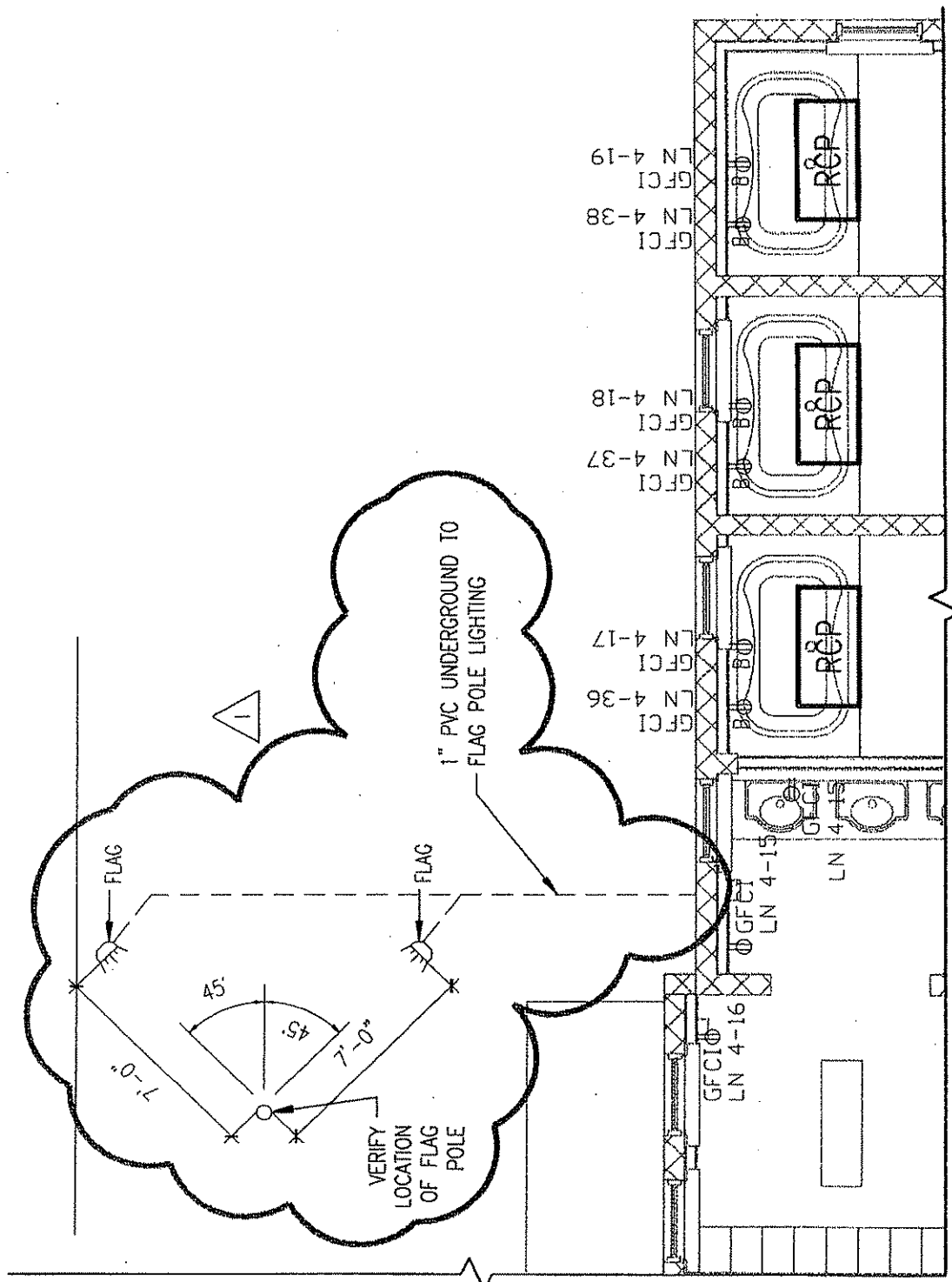

PARTIAL POWER PLAN
SCALE: 3/16" = 1'-0"

ADDENDUM DRAWING

REV. BY: CBM	DWG. DESCRIPTION: CORRECT LOCATION OF EXISTING FLAGPOLE; MODIFY FLAGPOLE ILLUMINATION.	DWG. NO: AD-002
DWG. BY: AEW		PRI NO: --
DATE: 08-25-06		SHEET REF: E-1.1
PROJECT NAME: ALTERATIONS AND UPGRADES TO THE BERKELEY SPRINGS BATH HOUSE		PROJECT NO: 0408097.00

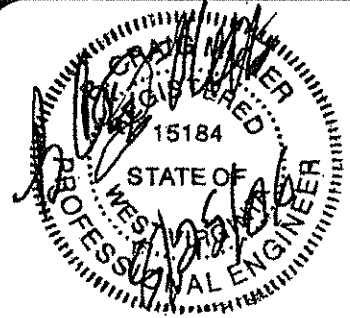

ALPHA
 ASSOCIATES, INCORPORATED
 ARCHITECTS • ENGINEERS • SURVEYORS

209 PRAIRIE AVENUE
 MORGANTOWN, WV 26501
 PHONE/FAX: 304-296-8216
 TOLL FREE: 800-640-8216
 EMAIL: alpha@alphaaec.com
 HTTP: www.alphaaec.com

DOOR & CASSED OPENING SCHEDULE

DOOR NO.	CASED OPENING NO.	SIZE	LABEL	DOOR		FRAME		HDWR SET NO.	JAMB TYPE	NOTES	DOOR NO.
				TYPE	MAT'L	TYPE	MAT'L				
D-100		EXISTING	--	--	--	--	--	01	--	1	D-100
D-101		2'-4"x6"-10" 4 Ø	--	D-7	WD	F-4	HM	02	J-6	--	D-101
D-102		2'-8"x6"-10"	--	D-1	HM	F-1	HM	03	J-1	--	D-102
D-103		EXISTING	--	--	--	--	--	05	--	2	D-103
D-104		EXISTING	--	--	--	--	--	09	--	2	D-104
D-105		EXISTING	--	--	--	--	--	06	--	2	D-105
D-106		EXISTING	--	--	--	--	--	09	--	2	D-106
D-108		EXISTING	--	--	--	--	--	08	--	2	D-108
--	C-108	EXISTING	--	--	--	F-1	HM	--	J-4	--	--
D-109A		3'-6"x6"-10"	1 HR	D-2	HM	F-2	HM	08	J-1	--	D-109A
D-109B		3'-6"x6"-10"	--	D-2	HM	F-1	HM	07	J-1	--	D-109B
D-111		3'-0"x6"-10"	1 HR	D-2	HM	F-1	HM	06	J-5	5	D-111
D-113		EXISTING	--	--	--	--	--	07	--	2	D-113
D-115		EXISTING	--	--	--	--	--	05	--	2	D-115
D-116		3'-0"x (BY MFR)	--	(BY MFR)	WD (BY MFR)	(BY MFR)	(BY MFR)	(BY MFR)	(BY MFR)	3	D-116
D-117		3'-0"x6"-10"	--	D-1	HM	F-1	HM	03	J-5	--	D-117
--	C-118	EXISTING	--	--	--	F-1	HM	--	J-2	--	--
D-119		2'-8"x6"-10"	--	D-1	HM	F-1	HM	04	J-4	--	D-119
D-120		2'-8"x6"-10"	--	D-1	HM	F-1	HM	04	J-4	--	D-120
D-121		1'-0"x6"-8" 4 Ø	--	D-8	WD	(BY MFR)	WD	10	(BY MFR)	4	D-121
D-122		2'-8"x6"-10"	--	D-1	HM	F-1	HM	04	J-5	--	D-122
--	C-125	3'-0"x6"-10"	--	--	--	F-1	HM	--	J-1	--	--
--	C-126	3'-0"x6"-10"	--	--	--	F-1	HM	--	J-1	--	--
D-135A		2'-8"x6"-10"	--	D-1	HM	F-1	HM	03	J-1	--	D-135A
D-135B		2'-8"x6"-10"	--	D-1	HM	F-1	HM	03	J-1	--	D-135B
--	C-146	3'-0"x6"-10"	--	--	--	F-1	HM	--	J-1	--	--
D-147		3'-0"x (BY MFR)	--	(BY MFR)	WD (BY MFR)	(BY MFR)	(BY MFR)	(BY MFR)	(BY MFR)	3	D-147
--	C-148	EXISTING	--	--	--	F-1	HM	--	J-2	--	--
D-149		2'-8"x6"-10"	--	D-1	HM	F-1	HM	04	J-4	--	D-149
D-150		2'-8"x6"-10"	--	D-1	HM	F-1	HM	04	J-4	--	D-150
D-154		3'-0"x6"-10"	--	D-1	HM	F-1	HM	08	J-5	--	D-154
D-159		EXISTING	--	--	--	--	--	07	--	2	D-159
D-160		2'-8"x6"-10"	--	D-1	HM	F-1	HM	04	J-5	--	D-160
D-162		3'-0"x6"-10"	--	D-1	HM	F-1	HM	06	J-5	--	D-162
D-163		3'-0"x6"-10"	1 HR	D-2	HM	F-1	HM	06	J-5	5	D-163
D-165A		2'-8"x6"-10"	--	D-1	HM	F-1	HM	03	J-1	--	D-165A
D-165B		2'-8"x6"-10"	--	D-1	HM	F-1	HM	03	J-1	--	D-165B

NOTES:

- 1) REPAIR & REFINISH EXISTING DOOR & FRAME.
- 2) REPAIR & REPAINT EXISTING DOOR & FRAME.
- 3) DOOR BY SALINA MFR.
- 4) FRAME BY DOOR MFR, TRIM TO MATCH EXISTING.

5) PROVIDE FIRE-RATED FRAME.

ADDENDUM DRAWING



209 PRAIRIE AVENUE
MORGANTOWN, WV 26501
PHONE/FAX: 304-296-8216
TOLL FREE: 800-640-8216
EMAIL: alpha@alphaaec.com
HTTP: www.alphaaec.com

REV. BY: RJK	DWG. DESCRIPTION: REVISE DOOR SCHEDULE TO INCLUDE HARDWARE SET NO.'s	DWG. NO: AD-001
DWG. BY: AEW		PBI NO: --
DATE: 08-21-06		SHEET REF: A-6.1
PROJECT NAME: ALTERATIONS AND UPGRADES TO THE BERKELEY SPRINGS BATH HOUSE		PROJECT NO: 0408097.00

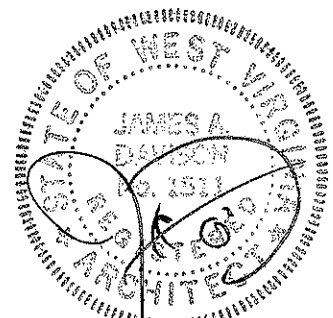

MAIN BATHHOUSE

MODULAR WORKPLACE UNITS

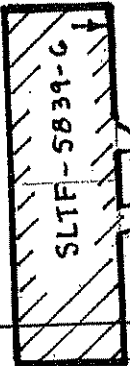
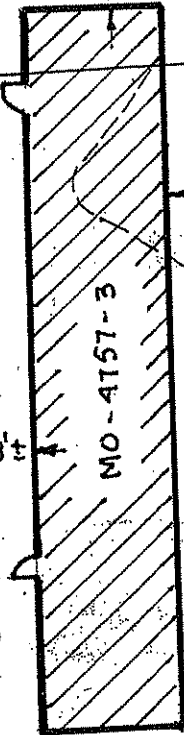
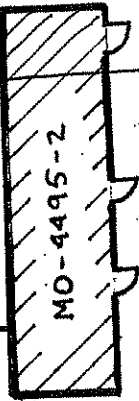

34" SYC. 8'±

SWIMMING POOL BATHHOUSE

PARK OFFICE

36" SYC

20" ELM

BERKELEY SPRINGS S.P.
BATHHOUSE RENOVATION

LOCATION OF MODULAR
WORKPLACE BUILDINGS

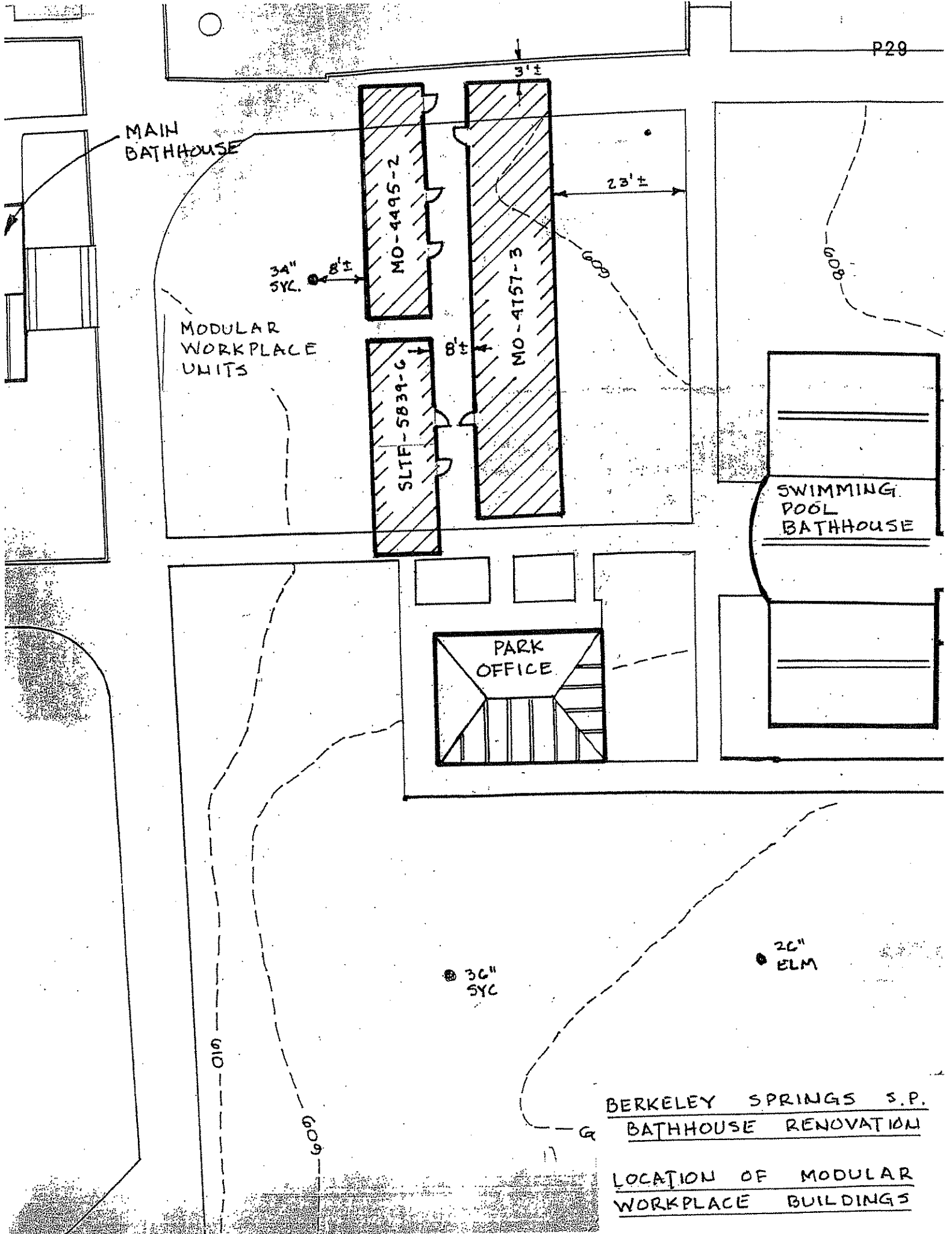

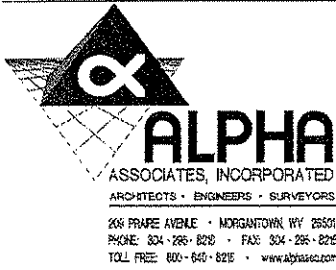

Pre-Bid Meeting Minutes

DEPT. of Natural Resources
Additions and Alterations to
Berkeley Springs Bath House

AAI PROJECT NO.: 0408097.00
DNR-80010

MANDATORY PRE-BID MEETING

Minutes
August 23, 2006

DATE: August 25, 2006
FROM: Rebecca Key *R Key*
LOCATION: Berkeley Springs State Park
August 23, 2006 Approximately 11AM

ATTENDEES: (See sign-in sheet attached)

DISTRIBUTION: To all plan holders of record.
MacDonald Smith, DNR
Deborah Damyan, DNR
Craig Miller, MEI
Rick Colebank, Alpha Associates, Inc.
Alex Hail, Alpha Associates, Inc.
Construction Employers Association
F.W. Dodge Division
Associated Builders and Contractors



- NB-01:** A Mandatory pre-bid meeting was held at Berkeley Springs State Park, at 11 Am on August 23, 2006.
- NB-02:** Deborah Demyan introduced all parties associated with the project. Don Smith, DNR; PM, Deborah Demyan, DNR, Contract Specialist, Craig Miller, MEI; Alex Haill, Construction Project Manager, Alpha Associates; Rebecca Key, Project Architect, Alpha Associates.
- NB-03:** Deborah Demyan reviewed State Purchasing Requirements.
- NB-04:** R. Key gave summary of project: Renovation of aprox. 7000 sq. ft. of 1920 and 1949 public bath/spa. Historic renovation and replacement of Mechanical, Plumbing and Electrical Systems.
- NB-05:** Bid Date: Thursday, September 7th, 2006 @ 1:30 PM.
- NB-06:** Bid Location: WV State Purchasing Division, 2019 Washington Street East, Capitol Complex, Charleston, WV 25305.
- NB-07:** Last day for Questions: Submit in Writing, Wednesday, August 30th, 3PM
Fax: 304-296-8245.
- NB-08:** Prevailing Wage: Use 2006 Prevailing Wage.
- NB-09:** Contract completion: All work must be completed in the space within 180 consecutive calendar days, following receipt of owner's written Notice to Proceed.
- NB-10:** Substitution Requests: Substitution Requests must be in by Wednesday August 30th 2006, 3 PM, if not, no substitutions will be reviewed during construction.
- NB-11:** Temporary Facilities: Water and Power on site is available for Contractor's use without metering or separate charge. Review Division Section 01500 for complete information.
- NB-12:** Permits: Yes, Obtain from the Police Dept. 304-258-1198 Ask for Barb, works until Noon. To obtain a permit, there must be two readings at City Council prior to approval.



-
- NB-13:** Sewer Dept.: 304-258-4118 Bath Town Hall, 271 Wilkes Street, 304-258-1102
- NB-14:** Morgan County Planning Office, 210 Fairfax Street, 304-258-8540 No Requirements
- NB-15:** B & O Tax: No Not required.
- NB-16:** Craig Miller gave summary of Mechanical, electrical and plumbing work.
- NB-17:** Questions from the floor:
- Q.: How to obtain a tour of facility after Pre-Bid.
A.: Contact James Steiner at the Park: 304-258-4012. He will be available for tours from 7:00 AM to 9:30 AM and then again from 12:30 PM to 1:30 PM. You must call in advance.
- Q.: What about soils inspection for the burying of the LP tank?
A.: No soils report has been done.
- Q.: Who removes the oil tanks?
A.: Both existing oil tanks will be removed prior to construction start by owner.
- Q.: There are rocks in the driveway, who removes them?
A.: The Park will remove those rocks prior to the start of construction.
- Q.: Schedule for modulars?
A.: Modular units must be in place and operational prior to any demolition work being performed on the existing Bath House.
- NB-18:** Tour of Existing Facility was conducted for those contractors who wanted to view the interior of the facility from 12:30 to 1 PM.

The above is considered to be an accurate account of my understanding of the discussions and/or events that took place at the Meeting. Participants are requested to advise this office, in writing, within ten (10) days of the issued date of these Minutes, of any errors or omissions. Otherwise, these Minutes are understood to be accepted by all parties receiving a copy of these Minutes and shall be considered as the Official Minutes of the Meeting.

The Formal Meeting adjourned at approx. 11:45 AM.