



The following documentation is an electronically-submitted vendor response to an advertised solicitation from the *West Virginia Purchasing Bulletin* within the Vendor Self-Service portal at wvOASIS.gov. As part of the State of West Virginia's procurement process, and to maintain the transparency of the bid-opening process, this documentation submitted online is publicly posted by the West Virginia Purchasing Division at WVPurchasing.gov with any other vendor responses to this solicitation submitted to the Purchasing Division in hard copy format.

Header @ 2

List View

- General Information
- Contact
- Default Values
- Discount
- Document Information
- Clarification Request

Procurement Folder: 1258007

Procurement Type: Central Purchase Order

Vendor ID: VS0000002427

Legal Name: Technology International Inc

Alias/DBA:

Total Bid: \$1,068,530.00

Response Date: 08/09/2023

Response Time: 10:50

Responded By User ID: tii123

First Name: Shaji

Last Name: Habib

Email: tii@tii-usa.com

Phone: 4073592373

SO Doc Code: CRFQ

SO Dept: 0803

SO Doc ID: DOT2400000011

Published Date: 7/31/23

Close Date: 8/9/23

Close Time: 13:30

Status: Closed

Solicitation Description: HP Steel Piling Beams 02230134

Total of Header Attachments: 2

Total of All Attachments: 2



Department of Administration
Purchasing Division
2019 Washington Street East
Post Office Box 50130
Charleston, WV 25305-0130

**State of West Virginia
Solicitation Response**

Proc Folder: 1258007
Solicitation Description: HP Steel Piling Beams 02230134
Proc Type: Central Purchase Order

| Solicitation Closes | Solicitation Response | Version |
|---------------------|------------------------------|---------|
| 2023-08-09 13:30 | SR 0803 ESR08092300000000494 | 1 |

VENDOR
VS0000002427
Technology International Inc

Solicitation Number: CRFQ 0803 DOT2400000011
Total Bid: 1068530
Response Date: 2023-08-09
Response Time: 10:50:51
Comments:

FOR INFORMATION CONTACT THE BUYER
John W Estep
304-558-2566
john.w.estep@wv.gov

Vendor Signature X **FEIN#** **DATE**

All offers subject to all terms and conditions contained in this solicitation

| Line | Comm Ln Desc | Qty | Unit Issue | Unit Price | Ln Total Or Contract Amount |
|------|--------------------------|-----------|------------|------------|-----------------------------|
| 1 | 12"x53#x40' H Pile Beams | 636000.00 | LB | 0.800000 | 508800.00 |

| Comm Code | Manufacturer | Specification | Model # |
|-----------|--------------|---------------|---------|
| 30101700 | | | |

Commodity Line Comments:

Extended Description:

12"x53#x40' H Pile Beams

| Line | Comm Ln Desc | Qty | Unit Issue | Unit Price | Ln Total Or Contract Amount |
|------|--------------------------|-----------|------------|------------|-----------------------------|
| 2 | 12"x53#x35' H Pile Beams | 371000.00 | LB | 0.790000 | 293090.00 |

| Comm Code | Manufacturer | Specification | Model # |
|-----------|--------------|---------------|---------|
| 30101700 | | | |

Commodity Line Comments:

Extended Description:

12"x53#x35' H Pile Beams

| Line | Comm Ln Desc | Qty | Unit Issue | Unit Price | Ln Total Or Contract Amount |
|------|--------------------------|-----------|------------|------------|-----------------------------|
| 3 | 12"x53#x30' H Pile Beams | 318000.00 | LB | 0.800000 | 254400.00 |

| Comm Code | Manufacturer | Specification | Model # |
|-----------|--------------|---------------|---------|
| 30101700 | | | |

Commodity Line Comments:

Extended Description:

12"x53#x30' H Pile Beams

| Line | Comm Ln Desc | Qty | Unit Issue | Unit Price | Ln Total Or Contract Amount |
|------|------------------------------|-----------|------------|------------|-----------------------------|
| 4 | 8Wx18#x40' Wide Flange Beams | 14400.000 | LB | 0.850000 | 12240.00 |

| Comm Code | Manufacturer | Specification | Model # |
|-----------|--------------|---------------|---------|
| 30101700 | | | |

Commodity Line Comments:

Extended Description:

8Wx18#x40' Wide Flange Beams



Department of Administration
 Purchasing Division
 2019 Washington Street East
 Post Office Box 50130
 Charleston, WV 25305-0130

State of West Virginia
 Centralized Request for Quote
 Miscellaneous

| Proc Folder: 1258007 | | | Reason for Modification: |
|--|---------------------|-------------------------|---------------------------------|
| Doc Description: HP Steel Piling Beams 02230134 | | | |
| Proc Type: Central Purchase Order | | | |
| Date Issued | Solicitation Closes | Solicitation No | Version |
| 2023-07-31 | 2023-08-09 13:30 | CRFQ 0803 DOT2400000011 | 1 |

BID RECEIVING LOCATION

BID CLERK
 DEPARTMENT OF ADMINISTRATION
 PURCHASING DIVISION
 2019 WASHINGTON ST E
 CHARLESTON WV 25305
 US

VENDOR

Vendor Customer Code:

Vendor Name : Technology International, Inc.

Address : 1331 South International Parkway,
Street : Suite 2251,
City : Lake Mary
State : Florida **Country :** USA **Zip :** 32746

Principal Contact : SHAJI HABIB

Vendor Contact Phone: 407-359-2373 **Extension:**

FOR INFORMATION CONTACT THE BUYER

John W Estep
 304-558-2566
 john.w.estep@wv.gov

Vendor
 Signature X

Rifat Habib

FEIN# 650342335

DATE 08/09/2023

All offers subject to all terms and conditions contained in this solicitation

ADDITIONAL INFORMATION**REQUEST FOR QUOTATION:**

The West Virginia Purchasing Division is soliciting bids on behalf of West Virginia Division of Highways to establish a contract for the onetime purchase of Structural Steel H Piles for WVDOH District 2. Per the Bid Requirements, Specifications, Terms and Conditions attached to this solicitation.

| INVOICE TO | | | SHIP TO | | |
|--|--|--|--|--|--|
| DIVISION OF HIGHWAYS DISTRICT TWO 801 MADISON AVE HUNTINGTON WV US | | | DIVISION OF HIGHWAYS DISTRICT TWO - STORAGE LOT 6200 RT 60 EAST BARBOURSVILLE WV US | | |

| Line | Comm Ln Desc | Qty | Unit Issue | Unit Price | Total Price |
|------|--------------------------|--------------|------------|------------|-------------|
| 1 | 12"x53#x40' H Pile Beams | 636000.00000 | LB | .80 | 508,800.00 |

| Comm Code | Manufacturer | Specification | Model # |
|-----------|--------------|---------------|---------|
| 30101700 | | | |

Extended Description:
12"x53#x40' H Pile Beams

| INVOICE TO | | | SHIP TO | | |
|--|--|--|--|--|--|
| DIVISION OF HIGHWAYS DISTRICT TWO 801 MADISON AVE HUNTINGTON WV US | | | DIVISION OF HIGHWAYS DISTRICT TWO - STORAGE LOT 6200 RT 60 EAST BARBOURSVILLE WV US | | |

| Line | Comm Ln Desc | Qty | Unit Issue | Unit Price | Total Price |
|------|--------------------------|--------------|------------|------------|-------------|
| 2 | 12"x53#x35' H Pile Beams | 371000.00000 | LB | .79 | 293,090.00 |

| Comm Code | Manufacturer | Specification | Model # |
|-----------|--------------|---------------|---------|
| 30101700 | | | |

Extended Description:
12"x53#x35' H Pile Beams

***Please see our Equipment Proposal TII/WV/0823/30454 attached.

| INVOICE TO | | | SHIP TO | | |
|--|--|--|--|--|--|
| DIVISION OF HIGHWAYS DISTRICT TWO 801 MADISON AVE HUNTINGTON WV US | | | DIVISION OF HIGHWAYS DISTRICT TWO - STORAGE LOT 6200 RT 60 EAST BARBOURSVILLE WV US | | |

| Line | Comm Ln Desc | Qty | Unit Issue | Unit Price | Total Price |
|------|--------------------------|--------------|------------|------------|-------------|
| 3 | 12"x53#x30' H Pile Beams | 318000.00000 | LB | .80 | 254,400.00 |

| Comm Code | Manufacturer | Specification | Model # |
|-----------|--------------|---------------|---------|
| 30101700 | | | |

Extended Description:
12"x53#x30' H Pile Beams

| INVOICE TO | | | SHIP TO | | |
|--|--|--|--|--|--|
| DIVISION OF HIGHWAYS DISTRICT TWO 801 MADISON AVE HUNTINGTON WV US | | | DIVISION OF HIGHWAYS DISTRICT TWO - STORAGE LOT 6200 RT 60 EAST BARBOURSVILLE WV US | | |

| Line | Comm Ln Desc | Qty | Unit Issue | Unit Price | Total Price |
|------|------------------------------|-------------|------------|------------|-------------|
| 4 | 8Wx18#x40' Wide Flange Beams | 14400.00000 | LB | .85 | 12,240.00 |

| Comm Code | Manufacturer | Specification | Model # |
|-----------|--------------|---------------|---------|
| 30101700 | | | |

Extended Description:
8Wx18#x40' Wide Flange Beams

SCHEDULE OF EVENTS

| Line | Event | Event Date |
|------|-------------------------------|------------|
| 1 | Tech Questions due by 10:00am | 2023-08-04 |

***Please see our Equipment Proposal TII/WV/0823/30454 attached.

| | Document Phase | Document Description | Page |
|--------------|----------------|--------------------------------|------|
| DOT240000011 | Final | HP Steel Piling Beams 02230134 | 4 |

ADDITIONAL TERMS AND CONDITIONS

See attached document(s) for additional Terms and Conditions

GENERAL TERMS AND CONDITIONS:

1. CONTRACTUAL AGREEMENT: Issuance of an Award Document signed by the Purchasing Division Director, or his designee, and approved as to form by the Attorney General's office constitutes acceptance by the State of this Contract made by and between the State of West Virginia and the Vendor. Vendor's signature on its bid, or on the Contract if the Contract is not the result of a bid solicitation, signifies Vendor's agreement to be bound by and accept the terms and conditions contained in this Contract.

2. DEFINITIONS: As used in this Solicitation/Contract, the following terms shall have the meanings attributed to them below. Additional definitions may be found in the specifications included with this Solicitation/Contract.

2.1. "Agency" or "Agencies" means the agency, board, commission, or other entity of the State of West Virginia that is identified on the first page of the Solicitation or any other public entity seeking to procure goods or services under this Contract.

2.2. "Bid" or "Proposal" means the vendors submitted response to this solicitation.

2.3. "Contract" means the binding agreement that is entered into between the State and the Vendor to provide the goods or services requested in the Solicitation.

2.4. "Director" means the Director of the West Virginia Department of Administration, Purchasing Division.

2.5. "Purchasing Division" means the West Virginia Department of Administration, Purchasing Division.

2.6. "Award Document" means the document signed by the Agency and the Purchasing Division, and approved as to form by the Attorney General, that identifies the Vendor as the contract holder.

2.7. "Solicitation" means the official notice of an opportunity to supply the State with goods or services that is published by the Purchasing Division.

2.8. "State" means the State of West Virginia and/or any of its agencies, commissions, boards, etc. as context requires.

2.9. "Vendor" or "Vendors" means any entity submitting a bid in response to the Solicitation, the entity that has been selected as the lowest responsible bidder, or the entity that has been awarded the Contract as context requires.

3. CONTRACT TERM; RENEWAL; EXTENSION: The term of this Contract shall be determined in accordance with the category that has been identified as applicable to this Contract below:

Term Contract

Initial Contract Term: The Initial Contract Term will be for a period of _____
_____. The Initial Contract Term becomes effective on the effective start date listed on the first page of this Contract, identified as the State of West Virginia contract cover page containing the signatures of the Purchasing Division, Attorney General, and Encumbrance clerk (or another page identified as _____), and the Initial Contract Term ends on the effective end date also shown on the first page of this Contract.

Renewal Term: This Contract may be renewed upon the mutual written consent of the Agency, and the Vendor, with approval of the Purchasing Division and the Attorney General's office (Attorney General approval is as to form only). Any request for renewal should be delivered to the Agency and then submitted to the Purchasing Division thirty (30) days prior to the expiration date of the initial contract term or appropriate renewal term. A Contract renewal shall be in accordance with the terms and conditions of the original contract. Unless otherwise specified below, renewal of this Contract is limited to _____ successive one (1) year periods or multiple renewal periods of less than one year, provided that the multiple renewal periods do not exceed the total number of months available in all renewal years combined. Automatic renewal of this Contract is prohibited. Renewals must be approved by the Vendor, Agency, Purchasing Division and Attorney General's office (Attorney General approval is as to form only)

Alternate Renewal Term – This contract may be renewed for _____ successive _____ year periods or shorter periods provided that they do not exceed the total number of months contained in all available renewals. Automatic renewal of this Contract is prohibited. Renewals must be approved by the Vendor, Agency, Purchasing Division and Attorney General's office (Attorney General approval is as to form only)

Delivery Order Limitations: In the event that this contract permits delivery orders, a delivery order may only be issued during the time this Contract is in effect. Any delivery order issued within one year of the expiration of this Contract shall be effective for one year from the date the delivery order is issued. No delivery order may be extended beyond one year after this Contract has expired.

Fixed Period Contract: This Contract becomes effective upon Vendor's receipt of the notice to proceed and must be completed within _____ days.

Fixed Period Contract with Renewals: This Contract becomes effective upon Vendor's receipt of the notice to proceed and part of the Contract more fully described in the attached specifications must be completed within _____ days. Upon completion of the work covered by the preceding sentence, the vendor agrees that:

the contract will continue for _____ years;

the contract may be renewed for _____ successive _____ year periods or shorter periods provided that they do not exceed the total number of months contained in all available renewals. Automatic renewal of this Contract is prohibited. Renewals must be approved by the Vendor, Agency, Purchasing Division and Attorney General's Office (Attorney General approval is as to form only).

One-Time Purchase: The term of this Contract shall run from the issuance of the Award Document until all of the goods contracted for have been delivered, but in no event will this Contract extend for more than one fiscal year.

Construction/Project Oversight: This Contract becomes effective on the effective start date listed on the first page of this Contract, identified as the State of West Virginia contract cover page containing the signatures of the Purchasing Division, Attorney General, and Encumbrance clerk (or another page identified as _____), and continues until the project for which the vendor is providing oversight is complete.

Other: Contract Term specified in _____

4. AUTHORITY TO PROCEED: Vendor is authorized to begin performance of this contract on the date of encumbrance listed on the front page of the Award Document unless either the box for "Fixed Period Contract" or "Fixed Period Contract with Renewals" has been checked in Section 3 above. If either "Fixed Period Contract" or "Fixed Period Contract with Renewals" has been checked, Vendor must not begin work until it receives a separate notice to proceed from the State. The notice to proceed will then be incorporated into the Contract via change order to memorialize the official date that work commenced.

5. QUANTITIES: The quantities required under this Contract shall be determined in accordance with the category that has been identified as applicable to this Contract below.

Open End Contract: Quantities listed in this Solicitation/Award Document are approximations only, based on estimates supplied by the Agency. It is understood and agreed that the Contract shall cover the quantities actually ordered for delivery during the term of the Contract, whether more or less than the quantities shown.

Service: The scope of the service to be provided will be more clearly defined in the specifications included herewith.

Combined Service and Goods: The scope of the service and deliverable goods to be provided will be more clearly defined in the specifications included herewith.

One-Time Purchase: This Contract is for the purchase of a set quantity of goods that are identified in the specifications included herewith. Once those items have been delivered, no additional goods may be procured under this Contract without an appropriate change order approved by the Vendor, Agency, Purchasing Division, and Attorney General's office.

Construction: This Contract is for construction activity more fully defined in the specifications.

6. EMERGENCY PURCHASES: The Purchasing Division Director may authorize the Agency to purchase goods or services in the open market that Vendor would otherwise provide under this Contract if those goods or services are for immediate or expedited delivery in an emergency. Emergencies shall include, but are not limited to, delays in transportation or an unanticipated increase in the volume of work. An emergency purchase in the open market, approved by the Purchasing Division Director, shall not constitute of breach of this Contract and shall not entitle the Vendor to any form of compensation or damages. This provision does not excuse the State from fulfilling its obligations under a One-Time Purchase contract.

7. REQUIRED DOCUMENTS: All of the items checked in this section must be provided to the Purchasing Division by the Vendor as specified:

LICENSE(S) / CERTIFICATIONS / PERMITS: In addition to anything required under the Section of the General Terms and Conditions entitled Licensing, the apparent successful Vendor shall furnish proof of the following licenses, certifications, and/or permits upon request and in a form acceptable to the State. The request may be prior to or after contract award at the State's sole discretion.

The apparent successful Vendor shall also furnish proof of any additional licenses or certifications contained in the specifications regardless of whether or not that requirement is listed above.

8. INSURANCE: The apparent successful Vendor shall furnish proof of the insurance identified by a checkmark below prior to Contract award. The insurance coverages identified below must be maintained throughout the life of this contract. Thirty (30) days prior to the expiration of the insurance policies, Vendor shall provide the Agency with proof that the insurance mandated herein has been continued. Vendor must also provide Agency with immediate notice of any changes in its insurance policies, including but not limited to, policy cancelation, policy reduction, or change in insurers. The apparent successful Vendor shall also furnish proof of any additional insurance requirements contained in the specifications prior to Contract award regardless of whether that insurance requirement is listed in this section.

Vendor must maintain:

Commercial General Liability Insurance in at least an amount of: \$1,000,000.00 per occurrence.

Automobile Liability Insurance in at least an amount of: \$1,000,000.00 per occurrence.

Professional/Malpractice/Errors and Omission Insurance in at least an amount of: _____ per occurrence. Notwithstanding the forgoing, Vendor's are not required to list the State as an additional insured for this type of policy.

Commercial Crime and Third Party Fidelity Insurance in an amount of: _____ per occurrence.

Cyber Liability Insurance in an amount of: _____ per occurrence.

Builders Risk Insurance in an amount equal to 100% of the amount of the Contract.

Pollution Insurance in an amount of: _____ per occurrence.

Aircraft Liability in an amount of: _____ per occurrence.

9. WORKERS' COMPENSATION INSURANCE: Vendor shall comply with laws relating to workers compensation, shall maintain workers' compensation insurance when required, and shall furnish proof of workers' compensation insurance upon request.

10. VENUE: All legal actions for damages brought by Vendor against the State shall be brought in the West Virginia Claims Commission. Other causes of action must be brought in the West Virginia court authorized by statute to exercise jurisdiction over it.

11. LIQUIDATED DAMAGES: This clause shall in no way be considered exclusive and shall not limit the State or Agency's right to pursue any other available remedy. Vendor shall pay liquidated damages in the amount specified below or as described in the specifications:

_____ for _____.

Liquidated Damages Contained in the Specifications.

Liquidated Damages Are Not Included in this Contract.

12. ACCEPTANCE: Vendor's signature on its bid, or on the certification and signature page, constitutes an offer to the State that cannot be unilaterally withdrawn, signifies that the product or service proposed by vendor meets the mandatory requirements contained in the Solicitation for that product or service, unless otherwise indicated, and signifies acceptance of the terms and conditions contained in the Solicitation unless otherwise indicated.

13. PRICING: The pricing set forth herein is firm for the life of the Contract, unless specified elsewhere within this Solicitation/Contract by the State. A Vendor's inclusion of price adjustment provisions in its bid, without an express authorization from the State in the Solicitation to do so, may result in bid disqualification. Notwithstanding the foregoing, Vendor must extend any publicly advertised sale price to the State and invoice at the lower of the contract price or the publicly advertised sale price.

14. PAYMENT IN ARREARS: Payments for goods/services will be made in arrears only upon receipt of a proper invoice, detailing the goods/services provided or receipt of the goods/services, whichever is later. Notwithstanding the foregoing, payments for software maintenance, licenses, or subscriptions may be paid annually in advance.

15. PAYMENT METHODS: Vendor must accept payment by electronic funds transfer and P-Card. (The State of West Virginia's Purchasing Card program, administered under contract by a banking institution, processes payment for goods and services through state designated credit cards.)

16. TAXES: The Vendor shall pay any applicable sales, use, personal property or any other taxes arising out of this Contract and the transactions contemplated thereby. The State of West Virginia is exempt from federal and state taxes and will not pay or reimburse such taxes.

17. ADDITIONAL FEES: Vendor is not permitted to charge additional fees or assess additional charges that were not either expressly provided for in the solicitation published by the State of West Virginia, included in the Contract, or included in the unit price or lump sum bid amount that Vendor is required by the solicitation to provide. Including such fees or charges as notes to the solicitation may result in rejection of vendor's bid. Requesting such fees or charges be paid after the contract has been awarded may result in cancellation of the contract.

18. FUNDING: This Contract shall continue for the term stated herein, contingent upon funds being appropriated by the Legislature or otherwise being made available. In the event funds are not appropriated or otherwise made available, this Contract becomes void and of no effect beginning on July 1 of the fiscal year for which funding has not been appropriated or otherwise made available. If that occurs, the State may notify the Vendor that an alternative source of funding has been obtained and thereby avoid the automatic termination. Non-appropriation or non-funding shall not be considered an event of default.

19. CANCELLATION: The Purchasing Division Director reserves the right to cancel this Contract immediately upon written notice to the vendor if the materials or workmanship supplied do not conform to the specifications contained in the Contract. The Purchasing Division Director may also cancel any purchase or Contract upon 30 days written notice to the Vendor in accordance with West Virginia Code of State Rules § 148-1-5.2.b.

20. TIME: Time is of the essence regarding all matters of time and performance in this Contract.

21. APPLICABLE LAW: This Contract is governed by and interpreted under West Virginia law without giving effect to its choice of law principles. Any information provided in specification manuals, or any other source, verbal or written, which contradicts or violates the West Virginia Constitution, West Virginia Code, or West Virginia Code of State Rules is void and of no effect.

22. COMPLIANCE WITH LAWS: Vendor shall comply with all applicable federal, state, and local laws, regulations and ordinances. By submitting a bid, Vendor acknowledges that it has reviewed, understands, and will comply with all applicable laws, regulations, and ordinances.

SUBCONTRACTOR COMPLIANCE: Vendor shall notify all subcontractors providing commodities or services related to this Contract that as subcontractors, they too are required to comply with all applicable laws, regulations, and ordinances. Notification under this provision must occur prior to the performance of any work under the contract by the subcontractor.

23. ARBITRATION: Any references made to arbitration contained in this Contract, Vendor's bid, or in any American Institute of Architects documents pertaining to this Contract are hereby deleted, void, and of no effect.

24. MODIFICATIONS: This writing is the parties' final expression of intent. Notwithstanding anything contained in this Contract to the contrary no modification of this Contract shall be binding without mutual written consent of the Agency, and the Vendor, with approval of the Purchasing Division and the Attorney General's office (Attorney General approval is as to form only). Any change to existing contracts that adds work or changes contract cost, and were not included in the original contract, must be approved by the Purchasing Division and the Attorney General's Office (as to form) prior to the implementation of the change or commencement of work affected by the change.

25. WAIVER: The failure of either party to insist upon a strict performance of any of the terms or provision of this Contract, or to exercise any option, right, or remedy herein contained, shall not be construed as a waiver or a relinquishment for the future of such term, provision, option, right, or remedy, but the same shall continue in full force and effect. Any waiver must be expressly stated in writing and signed by the waiving party.

26. SUBSEQUENT FORMS: The terms and conditions contained in this Contract shall supersede any and all subsequent terms and conditions which may appear on any form documents submitted by Vendor to the Agency or Purchasing Division such as price lists, order forms, invoices, sales agreements, or maintenance agreements, and includes internet websites or other electronic documents. Acceptance or use of Vendor's forms does not constitute acceptance of the terms and conditions contained thereon.

27. ASSIGNMENT: Neither this Contract nor any monies due, or to become due hereunder, may be assigned by the Vendor without the express written consent of the Agency, the Purchasing Division, the Attorney General's office (as to form only), and any other government agency or office that may be required to approve such assignments.

28. WARRANTY: The Vendor expressly warrants that the goods and/or services covered by this Contract will: (a) conform to the specifications, drawings, samples, or other description furnished or specified by the Agency; (b) be merchantable and fit for the purpose intended; and (c) be free from defect in material and workmanship.

29. STATE EMPLOYEES: State employees are not permitted to utilize this Contract for personal use and the Vendor is prohibited from permitting or facilitating the same.

30. PRIVACY, SECURITY, AND CONFIDENTIALITY: The Vendor agrees that it will not disclose to anyone, directly or indirectly, any such personally identifiable information or other confidential information gained from the Agency, unless the individual who is the subject of the information consents to the disclosure in writing or the disclosure is made pursuant to the Agency's policies, procedures, and rules. Vendor further agrees to comply with the Confidentiality Policies and Information Security Accountability Requirements, set forth in <http://www.state.wv.us/admin/purchase/privacy/default.html>.

31. YOUR SUBMISSION IS A PUBLIC DOCUMENT: Vendor's entire response to the Solicitation and the resulting Contract are public documents. As public documents, they will be disclosed to the public following the bid/proposal opening or award of the contract, as required by the competitive bidding laws of West Virginia Code §§ 5A-3-1 et seq., 5-22-1 et seq., and 5G-1-1 et seq. and the Freedom of Information Act West Virginia Code §§ 29B-1-1 et seq.

DO NOT SUBMIT MATERIAL YOU CONSIDER TO BE CONFIDENTIAL, A TRADE SECRET, OR OTHERWISE NOT SUBJECT TO PUBLIC DISCLOSURE.

Submission of any bid, proposal, or other document to the Purchasing Division constitutes your explicit consent to the subsequent public disclosure of the bid, proposal, or document. The Purchasing Division will disclose any document labeled "confidential," "proprietary," "trade secret," "private," or labeled with any other claim against public disclosure of the documents, to include any "trade secrets" as defined by West Virginia Code § 47-22-1 et seq. All submissions are subject to public disclosure without notice.

32. LICENSING: In accordance with West Virginia Code of State Rules § 148-1-6.1.e, Vendor must be licensed and in good standing in accordance with any and all state and local laws and requirements by any state or local agency of West Virginia, including, but not limited to, the West Virginia Secretary of State's Office, the West Virginia Tax Department, West Virginia Insurance Commission, or any other state agency or political subdivision. Obligations related to political subdivisions may include, but are not limited to, business licensing, business and occupation taxes, inspection compliance, permitting, etc. Upon request, the Vendor must provide all necessary releases to obtain information to enable the Purchasing Division Director or the Agency to verify that the Vendor is licensed and in good standing with the above entities.

SUBCONTRACTOR COMPLIANCE: Vendor shall notify all subcontractors providing commodities or services related to this Contract that as subcontractors, they too are required to be licensed, in good standing, and up-to-date on all state and local obligations as described in this section. Obligations related to political subdivisions may include, but are not limited to, business licensing, business and occupation taxes, inspection compliance, permitting, etc. Notification under this provision must occur prior to the performance of any work under the contract by the subcontractor.

33. ANTITRUST: In submitting a bid to, signing a contract with, or accepting a Award Document from any agency of the State of West Virginia, the Vendor agrees to convey, sell, assign, or transfer to the State of West Virginia all rights, title, and interest in and to all causes of action it may now or hereafter acquire under the antitrust laws of the United States and the State of West Virginia for price fixing and/or unreasonable restraints of trade relating to the particular commodities or services purchased or acquired by the State of West Virginia. Such assignment shall be made and become effective at the time the purchasing agency tenders the initial payment to Vendor.

34. VENDOR NON-CONFLICT: Neither Vendor nor its representatives are permitted to have any interest, nor shall they acquire any interest, direct or indirect, which would compromise the performance of its services hereunder. Any such interests shall be promptly presented in detail to the Agency.

Revised 11/1/2022

35. VENDOR RELATIONSHIP: The relationship of the Vendor to the State shall be that of an independent contractor and no principal-agent relationship or employer-employee relationship is contemplated or created by this Contract. The Vendor as an independent contractor is solely liable for the acts and omissions of its employees and agents. Vendor shall be responsible for selecting, supervising, and compensating any and all individuals employed pursuant to the terms of this Solicitation and resulting contract. Neither the Vendor, nor any employees or subcontractors of the Vendor, shall be deemed to be employees of the State for any purpose whatsoever. Vendor shall be exclusively responsible for payment of employees and contractors for all wages and salaries, taxes, withholding payments, penalties, fees, fringe benefits, professional liability insurance premiums, contributions to insurance and pension, or other deferred compensation plans, including but not limited to, Workers' Compensation and Social Security obligations, licensing fees, etc. and the filing of all necessary documents, forms, and returns pertinent to all of the foregoing.

Vendor shall hold harmless the State, and shall provide the State and Agency with a defense against any and all claims including, but not limited to, the foregoing payments, withholdings, contributions, taxes, Social Security taxes, and employer income tax returns.

36. INDEMNIFICATION: The Vendor agrees to indemnify, defend, and hold harmless the State and the Agency, their officers, and employees from and against: (1) Any claims or losses for services rendered by any subcontractor, person, or firm performing or supplying services, materials, or supplies in connection with the performance of the Contract; (2) Any claims or losses resulting to any person or entity injured or damaged by the Vendor, its officers, employees, or subcontractors by the publication, translation, reproduction, delivery, performance, use, or disposition of any data used under the Contract in a manner not authorized by the Contract, or by Federal or State statutes or regulations; and (3) Any failure of the Vendor, its officers, employees, or subcontractors to observe State and Federal laws including, but not limited to, labor and wage and hour laws.

37. NO DEBT CERTIFICATION: In accordance with West Virginia Code §§ 5A-3-10a and 5-22-1(i), the State is prohibited from awarding a contract to any bidder that owes a debt to the State or a political subdivision of the State. By submitting a bid, or entering into a contract with the State, Vendor is affirming that (1) for construction contracts, the Vendor is not in default on any monetary obligation owed to the state or a political subdivision of the state, and (2) for all other contracts, neither the Vendor nor any related party owe a debt as defined above, and neither the Vendor nor any related party are in employer default as defined in the statute cited above unless the debt or employer default is permitted under the statute.

38. CONFLICT OF INTEREST: Vendor, its officers or members or employees, shall not presently have or acquire an interest, direct or indirect, which would conflict with or compromise the performance of its obligations hereunder. Vendor shall periodically inquire of its officers, members and employees to ensure that a conflict of interest does not arise. Any conflict of interest discovered shall be promptly presented in detail to the Agency.

39. REPORTS: Vendor shall provide the Agency and/or the Purchasing Division with the following reports identified by a checked box below:

Such reports as the Agency and/or the Purchasing Division may request. Requested reports may include, but are not limited to, quantities purchased, agencies utilizing the contract, total contract expenditures by agency, etc.

Quarterly reports detailing the total quantity of purchases in units and dollars, along with a listing of purchases by agency. Quarterly reports should be delivered to the Purchasing Division via email at purchasing.division@wv.gov.

40. BACKGROUND CHECK: In accordance with W. Va. Code § 15-2D-3, the State reserves the right to prohibit a service provider's employees from accessing sensitive or critical information or to be present at the Capitol complex based upon results addressed from a criminal background check. Service providers should contact the West Virginia Division of Protective Services by phone at (304) 558-9911 for more information.

41. PREFERENCE FOR USE OF DOMESTIC STEEL PRODUCTS: Except when authorized by the Director of the Purchasing Division pursuant to W. Va. Code § 5A-3-56, no contractor may use or supply steel products for a State Contract Project other than those steel products made in the United States. A contractor who uses steel products in violation of this section may be subject to civil penalties pursuant to W. Va. Code § 5A-3-56. As used in this section:

- a. "State Contract Project" means any erection or construction of, or any addition to, alteration of or other improvement to any building or structure, including, but not limited to, roads or highways, or the installation of any heating or cooling or ventilating plants or other equipment, or the supply of and materials for such projects, pursuant to a contract with the State of West Virginia for which bids were solicited on or after June 6, 2001.
- b. "Steel Products" means products rolled, formed, shaped, drawn, extruded, forged, cast, fabricated or otherwise similarly processed, or processed by a combination of two or more or such operations, from steel made by the open heath, basic oxygen, electric furnace, Bessemer or other steel making process.
- c. The Purchasing Division Director may, in writing, authorize the use of foreign steel products if:
 1. The cost for each contract item used does not exceed one tenth of one percent (.1%) of the total contract cost or two thousand five hundred dollars (\$2,500.00), whichever is greater. For the purposes of this section, the cost is the value of the steel product as delivered to the project; or
 2. The Director of the Purchasing Division determines that specified steel materials are not produced in the United States in sufficient quantity or otherwise are not reasonably available to meet contract requirements.

42. PREFERENCE FOR USE OF DOMESTIC ALUMINUM, GLASS, AND STEEL: In Accordance with W. Va. Code § 5-19-1 et seq., and W. Va. CSR § 148-10-1 et seq., for every contract or subcontract, subject to the limitations contained herein, for the construction, reconstruction, alteration, repair, improvement or maintenance of public works or for the purchase of any item of machinery or equipment to be used at sites of public works, only domestic aluminum, glass or steel products shall be supplied unless the spending officer determines, in writing, after the receipt of offers or bids, (1) that the cost of domestic aluminum, glass or steel products is unreasonable or inconsistent with the public interest of the State of West Virginia, (2) that domestic aluminum, glass or steel products are not produced in sufficient quantities to meet the contract requirements, or (3) the available domestic aluminum, glass, or steel do not meet the contract specifications. This provision only applies to public works contracts awarded in an amount more than fifty thousand dollars (\$50,000) or public works contracts that require more than ten thousand pounds of steel products.

The cost of domestic aluminum, glass, or steel products may be unreasonable if the cost is more than twenty percent (20%) of the bid or offered price for foreign made aluminum, glass, or steel products. If the domestic aluminum, glass or steel products to be supplied or produced in a “substantial labor surplus area”, as defined by the United States Department of Labor, the cost of domestic aluminum, glass, or steel products may be unreasonable if the cost is more than thirty percent (30%) of the bid or offered price for foreign made aluminum, glass, or steel products. This preference shall be applied to an item of machinery or equipment, as indicated above, when the item is a single unit of equipment or machinery manufactured primarily of aluminum, glass or steel, is part of a public works contract and has the sole purpose or of being a permanent part of a single public works project. This provision does not apply to equipment or machinery purchased by a spending unit for use by that spending unit and not as part of a single public works project.

All bids and offers including domestic aluminum, glass or steel products that exceed bid or offer prices including foreign aluminum, glass or steel products after application of the preferences provided in this provision may be reduced to a price equal to or lower than the lowest bid or offer price for foreign aluminum, glass or steel products plus the applicable preference. If the reduced bid or offer prices are made in writing and supersede the prior bid or offer prices, all bids or offers, including the reduced bid or offer prices, will be reevaluated in accordance with this rule.

43. INTERESTED PARTY SUPPLEMENTAL DISCLOSURE: W. Va. Code § 6D-1-2 requires that for contracts with an actual or estimated value of at least \$1 million, the Vendor must submit to the Agency a disclosure of interested parties prior to beginning work under this Contract. Additionally, the Vendor must submit a supplemental disclosure of interested parties reflecting any new or differing interested parties to the contract, which were not included in the original pre-work interested party disclosure, within 30 days following the completion or termination of the contract. A copy of that form is included with this solicitation or can be obtained from the WV Ethics Commission. This requirement does not apply to publicly traded companies listed on a national or international stock exchange. A more detailed definition of interested parties can be obtained from the form referenced above.

44. PROHIBITION AGAINST USED OR REFURBISHED: Unless expressly permitted in the solicitation published by the State, Vendor must provide new, unused commodities, and is prohibited from supplying used or refurbished commodities, in fulfilling its responsibilities under this Contract.

45. VOID CONTRACT CLAUSES: This Contract is subject to the provisions of West Virginia Code § 5A-3-62, which automatically voids certain contract clauses that violate State law.

46. ISRAEL BOYCOTT: Bidder understands and agrees that, pursuant to W. Va. Code § 5A-3-63, it is prohibited from engaging in a boycott of Israel during the term of this contract.

DESIGNATED CONTACT: Vendor appoints the individual identified in this Section as the Contract Administrator and the initial point of contact for matters relating to this Contract.

(Printed Name and Title) SHAJI HABIB SALES MANAGER

(Address) 1331 South International Parkway, Suite 2251, Lake Mary, Florida 32746

(Phone Number) / (Fax Number) 407-359-2373 / 407-359-2372

(Email address) tii@tii-usa.com

CERTIFICATION AND SIGNATURE: By signing below, or submitting documentation through wvOASIS, I certify that: I have reviewed this Solicitation/Contract in its entirety; that I understand the requirements, terms and conditions, and other information contained herein; that this bid, offer or proposal constitutes an offer to the State that cannot be unilaterally withdrawn; that the product or service proposed meets the mandatory requirements contained in the Solicitation/Contract for that product or service, unless otherwise stated herein; that the Vendor accepts the terms and conditions contained in the Solicitation, unless otherwise stated herein; that I am submitting this bid, offer or proposal for review and consideration; that this bid or offer was made without prior understanding, agreement, or connection with any entity submitting a bid or offer for the same material, supplies, equipment or services; that this bid or offer is in all respects fair and without collusion or fraud; that this Contract is accepted or entered into without any prior understanding, agreement, or connection to any other entity that could be considered a violation of law; that I am authorized by the Vendor to execute and submit this bid, offer, or proposal, or any documents related thereto on Vendor's behalf; that I am authorized to bind the vendor in a contractual relationship; and that to the best of my knowledge, the vendor has properly registered with any State agency that may require registration.

By signing below, I further certify that I understand this Contract is subject to the provisions of West Virginia Code § 5A-3-62, which automatically voids certain contract clauses that violate State law; and that pursuant to W. Va. Code 5A-3-63, the entity entering into this contract is prohibited from engaging in a boycott against Israel.

Technology International, Inc.

(Company) Rifat Habib

(Signature of Authorized Representative)

RIFAT HABIB BUSINESS DEVELOPMENT EXECUTIVE

(Printed Name and Title of Authorized Representative) (Date)

407-359-2373 / 407-359-2372

(Phone Number) (Fax Number)

tii@tii-usa.com

(Email Address)

| EXHIBIT A-Pricing Page | | | | | |
|---------------------------------------|----------|-----------------|--|-----------|----------------------|
| District Two-HP Steel Piling 02230134 | | | | | |
| Item Number | Quantity | Unit of Measure | Description | Unit Cost | Total |
| 1 | 636,000 | LBS | 12" HP Steel Piling Beams, 40' (12"x53#x40') | .80 | 50,880.00 \$0.00 |
| 2 | 371,000 | LBS | 12" HP Steel Piling Beams, 35' (12"x53#x35') | .79 | 293,090.00 \$0.00 |
| 3 | 318,000 | LBS | 12"HP Steel Piling Beams, 30' (12"x53#x30') | .80 | 254,400.00 \$0.00 |
| 4 | 14400 | LBS | 8Wx40' Wide Flange Beams (8Wx18#x40') | .85 | 12,240.00 \$0.00 |
| Grand Total | | | | | \$0.00 610,610.00 |

***Please see our Equipment Proposal TII/WV/0823/30454 attached.



Technology International, Inc.
1331 South International Pkwy, Suite 2251
Lake Mary, FL 32746
Tel: (407) 359-2373
Fax: (407) 359-2372
E-mail: tii@tii-usa.com
Website: www.tii-usa.com

Equipment Proposal

Description: HP Steel Piling Beams 02230134

Solicitation #: CRFQ 0803 DOT2400000011

Agency: State of West Virginia

TII Ref: TII/WV/0823/30454

Date: 08/09/2023

In response to your quote request for HP Steel Piling Beams 02230134, Technology International, Inc. is pleased to submit the following for consideration:

| ITEM NO. | QTY | DESCRIPTION/ MODEL NO. | UNIT PRICE | EXTD. PRICE |
|----------|--------|--|------------|-------------|
| 1 | 636000 | HP 12X53 Steel Piling Beams; ASTM A572 GR 5 Quantity: 30 pcs Length Range: 40.0 ft Average Length: 40.0 ft Total Length / Wall Length: 1200.0 lf Unit Weight: 53.00 lbs Total Weight: 31.80 tons | \$.80 | 508,880.00 |
| 2 | 371000 | HP 12X53 Steel Piling Beams; ASTM A572 GR 50 Quantity: 200 pcs Length Range: 35.0 ft Average Length: 35.0 ft Total Length / Wall Length: 7000.0 lf Unit Weight: 53.00 lbs Total Weight: 185.5 tons | \$.79 | 293,090.00 |
| 3 | 318000 | HP 12X53 Steel Piling Beams; ASTM A572 GR 50 Quantity: 200 pcs Length Range: 30.0 ft Average Length: 30.0 lf Total Length / Wall Length: 6000.0 lf Unit Weight: 53.0 lbs Total Weight: 159.00 tons | \$.80 | 254,400.00 |

| | | | | |
|--|-------|---|-------|-----------|
| 4 | 14400 | W8X18 Steel Beam; ASTM A992 GR 50 Quantity: 20 pcs Length Range: 40.0 ft Average Length: 40.0 ft Total Length / Wall Length: 800.0 lf Unit Weight: 18.0 lbs Total Weight: 7.20 tons | \$.85 | 12,240.00 |
| See attached data sheets | | | | |
| <u>Total.....\$1,068,530.00</u> | | | | |

Warranty: Manufacturer's standard warranty applies.

Delivery:

- Estimated delivery is **40-52 Weeks** after receipt of order and approved submittal.
- Please note, due to COVID-19 there may be unanticipated disruptions and delays in the supply chains globally, for parts, components, equipment and internal manufacturing services such as engineering, production allocation, and logistics. This may result in manufacturing & delivery delays out of our control. We will do our best to communicate all such impacts and reduce the effects of any such delays.
- All delivery dates quoted are subject to manufacturer's confirmation at time of order.
- Submittal data will be provided for approval after receipt of order (if applicable)
- Customer to provide equipment and personnel to unload
- TII will provide MSO at time of payment confirmation. Customer is responsible for all titling and registration of trailer (If Applicable)

Freight: Included to Barboursville, WV 25504.

Payment Terms: NET 30

Prompt Payment discount: 1/4 % 10 days

Quote Validity: 90 days.

***** Notes:**

- Quoted price is not available on a line item basis. This is an offer for a lump sum contract.

Technology International, Inc. Corporate data:

We are a small business and our Tax Payer Identification Number (TIN): 650342335. The price quoted does not include any sales, excise or similar taxes.

We trust that this proposal will meet your requirements and we look forward to hearing from you.

If you have any questions or need more information, please contact us by phone at 407-359-2373, fax at 407-359-2372 or email us at tii@tii-usa.com

Respectfully submitted,

A handwritten signature in blue ink that reads "Rifat Habib". The signature is written in a cursive style with a blue color.

Rifat Habib
Business Development Exec.
Technology International, Inc.



MEEVER USA

PILING PRODUCTS





**RELY
ON US**

**NEW AND
USED MATERIALS
FOR SALE OR RENT
AND BUY BACK
OPTIONS**





Meever USA is your specialist in delivering made-to-order steel that complies to your exact wishes and requirements. We thereby provide you of all fabricating operations such as welding, sawing, cutting, blasting, coating and watertight seals.

This is also shown in the mission statement of Meever USA: delivering advice and high-quality steel products to support construction and engineering companies, governments and contractors in order to enable them to successfully implement groundwork, road constructions, railways and civil engineering projects.

With our highly qualified employees we can provide you with fast and dependable support for all your questions and orders.

Meever USA delivers all its steel from stock or production with a very short lead time. We can fulfill your delivery requests because of our various stock locations across the US. We also have a large stock of used steel in which we can provide you directly.

In conjunction with several welding and construction engineering specialists, we can deliver special structures and construction such as guard walls, box sections and 'combi piles' for combined sheet piling walls. At your request we can also apply coating to the sections you require to delay the corrosion process and/or for aesthetic reasons.

Our continuous focus on our customers has made Meever USA a major international steel supplier. This customer focus is demonstrated in various ways:

- Questions and orders are handled quickly and efficiently.
- We look at issues from our costumers' perspectives to find optimum solutions.
- Flexibility in all aspects of our service provision.
- Fabricating options to deliver custom designs.
- Flexible delivery times.

Furthermore, we have established an excellent reputation for delivering high-quality new and used steel.



| Subject | Page |
|---|------|
| Contact Us | 3 |
| About Meever USA | 4 |
| Table Of Contents | 5 |
| Hot Rolled Z-Profiles | 6 |
| Flat Sections, Walers and Tie Rods | 11 |
| Hot Rolled U-Profiles | 12 |
| IBO® The Tailor-Made Suit In The Sheet Pile World | 14 |
| Cold Formed VKZ Profiles | 18 |
| Cold Formed IBO® Profiles | 19 |
| Cold Formed Profiles | 20 |
| Cold Formed Z-Profiles | 22 |
| Connectors and Corner Solutions | 23 |
| Steel Tubes | 26 |
| Thick-Walled Tubes From Our Own Production | 29 |
| Combined Walls | 30 |
| Steal Beams | 32 |
| Bollards | 34 |
| Anchoring | 35 |
| Service | 36 |
| Intra Expanding Seal | 37 |
| New Unique Patented Mechanical Modular Bracing System | 38 |
| Terms Of Delivery | 40 |



The data and commentary contained within this steel sheet piling document is for general information purposes only. It is provided without warranty of any kind. Meever USA shall not be held responsible for any errors, omissions or misuse of any of the enclosed information and hereby disclaims any and all liability resulting from the ability or inability to use the information contained within.



Hot Rolled U-Profiles

U Sections:

U shaped sheet piles were first produced in the early 1900s and are the basis for all sheet pile sections we know today. U sections are used globally for permanent and temporary use and can be used in all types of soil because of its shape. U sections perform especially well in heavy soil types and temporary uses where the pile is driven multiple times. In the last 60 years, US mills promoted Z shaped pile which caused the U shape to fall out of favor with contractors. We strongly believe U shaped sheet pile can be the right solution for your job!



Do you want to save up to 40% on these profiles?

"Then look at the tailor-made suit in the sheet pile world on page 14."



| Section | Wy | ly | Width | Height | Thickness | | Weight | | Coating Area* |
|------------|---------------------|---------------------|-------|--------|-----------|--------|-------------------|--------------------|---------------------|
| | in ³ /ft | in ⁴ /ft | inch | inch | inch | inch | lb/ft | lb/ft ² | ft ² /ft |
| | cm ³ /m | cm ⁴ /m | mm | mm | t (mm) | s (mm) | kg/m ³ | kg/m ² | E |
| VL 601 | 13.8 | 84.4 | 23.62 | 12.2 | 0.295 | 0.252 | 31.1 | 15.81 | 5.24 |
| | 744 | 11.530 | 600 | 310 | 7.5 | 6.4 | 46.3 | 77.2 | 1.6 |
| VL 601FP | 13.9 | 84.6 | 23.6 | 12.2 | 0.283 | 0.276 | 31.9 | 16.18 | 5.24 |
| | 745 | 11.547 | 600 | 310 | 7.2 | 7 | 47.4 | 79 | 1.6 |
| VL 601K | 14.4 | 88 | 23.62 | 12.2 | 0.307 | 0.268 | 32.6 | 16.56 | 5.24 |
| | 775 | 12.019 | 600 | 310 | 7.8 | 6.8 | 48.5 | 80.8 | 1.6 |
| VL 602A | 15 | 91.5 | 23.62 | 12.2 | 0.315 | 0.287 | 34.5 | 17.51 | 5.24 |
| | 806 | 12.499 | 600 | 310 | 8 | 7.3 | 51.3 | 85.5 | 1.6 |
| VL 602 | 15.7 | 95.5 | 23.62 | 12.2 | 0.331 | 0.299 | 35.9 | 18.23 | 5.24 |
| | 842 | 13.046 | 600 | 310 | 8.4 | 7.6 | 53.4 | 89 | 1.6 |
| VL 602K | 16.3 | 99.5 | 23.62 | 12.2 | 0.346 | 0.311 | 37.2 | 18.91 | 5.24 |
| | 877 | 13.590 | 600 | 310 | 8.8 | 7.9 | 55.4 | 92.3 | 1.6 |
| VL 603A | 21.2 | 133.3 | 23.62 | 12.6 | 0.354 | 0.315 | 41.3 | 21 | 5.53 |
| | 1.138 | 18.205 | 600 | 320 | 9 | 8 | 61.5 | 102.5 | 1.72 |
| VL 603 | 22.3 | 140.6 | 23.62 | 12.6 | 0.378 | 0.323 | 43.1 | 21.92 | 5.53 |
| | 1.200 | 19.199 | 600 | 320 | 9.6 | 8.2 | 64.2 | 107 | 1.73 |
| VL 603N | 23.8 | 197.9 | 23.6 | 16.6 | 0.358 | 0.287 | 40.1 | 20.4 | 5.7 |
| | 1.279 | 27.020 | 600 | 422.6 | 9.1 | 7.3 | 59.7 | 99.6 | 1.73 |
| VL 603KN | 22.9 | 144.1 | 23.6 | 12.6 | 0.386 | 0.339 | 45.0 | 22.8 | 5.7 |
| | 1.230 | 19.682 | 600 | 320 | 9.8 | 8.6 | 66.9 | 111.5 | 1.73 |
| VL 604Z | 24.2 | 153.3 | 23.62 | 12.68 | 0.394 | 0.394 | 48.5 | 24.61 | 5.53 |
| | 1.300 | 20.930 | 600 | 322 | 10 | 10 | 72.1 | 120.2 | 1.73 |
| VL 604AN | 26.2 | 201.2 | 23.62 | 15.35 | 0.343 | 0.303 | 43.2 | 21.95 | 6.05 |
| | 1.409 | 27.478 | 600 | 390 | 8.7 | 7.7 | 64.3 | 107.1 | 1.85 |
| VL 604A | 29.1 | 223.3 | 23.62 | 15.35 | 0.378 | 0.346 | 47.7 | 24.24 | 5.96 |
| | 1.564 | 30.495 | 600 | 390 | 9.6 | 8.8 | 71 | 118.3 | 1.85 |
| VL 604 | 30.1 | 231 | 23.62 | 15.35 | 0.394 | 0.354 | 49.1 | 24.96 | 5.96 |
| | 1.618 | 31.548 | 600 | 390 | 10 | 9 | 73.1 | 121.8 | 1.85 |
| VL 604K | 31.1 | 238.7 | 23.62 | 15.35 | 0.409 | 0.362 | 50.5 | 25.67 | 5.96 |
| | 1.672 | 32.600 | 600 | 390 | 10.4 | 9.2 | 75.2 | 125.3 | 1.85 |
| VL 605A | 33.9 | 280 | 23.62 | 16.54 | 0.421 | 0.354 | 51.4 | 26.12 | 6.02 |
| | 1.821 | 38.243 | 600 | 420 | 10.7 | 9 | 76.5 | 127.5 | 1.89 |
| VL 605N | 37.6 | 312.4 | 23.62 | 16.64 | 0.472 | 0.374 | 55.2 | 28.03 | 6.15 |
| | 2.019 | 42.664 | 600 | 422.6 | 12 | 9.5 | 82.1 | 136.9 | 1.88 |
| VL 605KN | 39.4 | 328.7 | 23.62 | 16.69 | 0.496 | 0.394 | 57.5 | 29.22 | 6.15 |
| | 2.117 | 44.886 | 600 | 424 | 12.6 | 10 | 85.6 | 142.7 | 1.88 |
| VL 606A | 41 | 347.1 | 23.62 | 16.93 | 0.528 | 0.354 | 57.4 | 29.16 | 6.18 |
| | 2.205 | 47.402 | 600 | 430 | 13.4 | 9 | 85.4 | 142.3 | 1.9 |
| VL 606AN | 43.8 | 372.6 | 23.62 | 17.01 | 0.567 | 0.370 | 60.3 | 30.66 | 6.18 |
| | 2.355 | 50.878 | 600 | 432 | 14.4 | 9.4 | 89.8 | 149.6 | 1.89 |
| VL 606AN10 | 44.7 | 380.2 | 23.62 | 17.02 | 0.571 | 0.394 | 61.8 | 31.41 | 6.18 |
| | 2.402 | 51.913 | 600 | 432.2 | 14.5 | 10 | 92 | 153.4 | 1.89 |
| VL 606N | 46.6 | 398.3 | 23.62 | 17.09 | 0.606 | 0.386 | 63.2 | 32.13 | 6.18 |
| | 2.506 | 54.389 | 600 | 434 | 15.4 | 9.8 | 94.1 | 156.8 | 1.89 |
| VL 606K | 47.5 | 402.1 | 23.62 | 16.93 | 0.63 | 0.394 | 65.4 | 33.22 | 6.18 |
| | 2.602 | 56.116 | 600 | 431 | 16.5 | 9.5 | 96.6 | 161 | 1.89 |
| VL 628 | 52.8 | 473.4 | 23.62 | 17.92 | 0.64 | 0.40 | 68.4 | 34.76 | 6.38 |
| | 2.841 | 64.640 | 600 | 455.1 | 16.3 | 10.1 | 101.8 | 169.6 | 1.95 |
| VL 607A | 55.9 | 499.7 | 23.62 | 17.87 | 0.697 | 0.394 | 71.4 | 36.26 | 6.38 |
| | 3.006 | 68.232 | 600 | 453.9 | 17.7 | 10 | 106.2 | 177.1 | 1.95 |
| VL 607 | 59.7 | 536.8 | 23.62 | 17.97 | 0.748 | 0.417 | 75.5 | 38.37 | 6.38 |
| | 3.211 | 73.300 | 600 | 456.5 | 19 | 10.6 | 112.4 | 187.3 | 1.95 |
| VL 607K | 62.6 | 565.0 | 23.62 | 18.05 | 0.787 | 0.433 | 78.5 | 39.88 | 6.38 |
| | 3.365 | 77.153 | 600 | 458.5 | 20 | 11 | 116.8 | 194.7 | 1.95 |

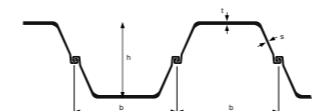

* Excluding the interlock interior – coating on both sides.

Manufactured in accordance with: Technical delivery conditions in accordance with EN 10248-1. Tolerances in accordance with EN 10248-2. Steel qualities: S 270GP, S355GP, S 390GP, S 430GP with 3.1 certificate in accordance with EN 10204. Standard availability: Lengths up to 80 ft, longer lengths on request.



Sheet Pile Caps in any desired shape from our own production.





IBO® The Tailor-Made Suit In The Sheet Pile World



IBO® VKZ:

The first sheet pile sections produced were narrow, thick, and heavy but with smart engineering and improved production facilities, we are now capable of producing wider and thinner sections. This results in more economic sections with less Lbs/Ft2 and less interlocks per wall feet which means less leakage risk and less interlocks to seal.

Meever USA invented the "Precision pile" to reduce costs and increase the capacity of a design.

When designing a sheet pile wall, come to Meever USA with your design parameters (S, I, thickness etc.) and we can provide a section unique to your job! This Unique concept allows you to save up to 20-40% of costs compared to current options on the market.

How does it work:

Meever USA creates a design which meets the required Section modulus/Moment of Inertia with multiple options determined by, Installation Technique, Tiebacks, Soil Conditions and Design Life.

Another option is to send your already approved design to Meever USA.

Its trained Engineers will prepare an Alternative Design for you to compare.

What makes the Precision Pile unique:

- In House Designing and Production.
- Custom shapes and measurements. Think about installing with a radius and any corner solution.
- The unique interlocks have less friction during installation and are more water-tight.
- Lighter per ft2/wall has compounding savings, less material costs, less transport, less handling and installation time.
- Available in small tonnages with no minimum order quantity
- Larger effective width = fewer interlocks, which in turn would require less interlock sealant on water tight jobs.
- Lower emission values. We must highlight this in a way. Because less steel (20-40%) and transport(20-40%) and on top of that also the production is proven in a report that it saves 7% emission.
- Welding on anchor plates is easier and faster because an IBO® has no middle lock. Please see the picture from regular Z piles below.
- Customizable to any layout.
- Increased pile driving efficiency.

Z Sheet Pile



IBO® Sheet Pile



Sheet piling that in terms of dimensions, weight and technical specifications exactly match the strength and stiffness required in the specifications.

The Benefits:

- IBO® sheet piles are lighter than regular hot-rolled sheet piles.
- Well-nigh no lock friction in the sheet piles during installation.
- Many options in shapes and measurements.
- Create an angle without using loose corner sections.
- The locks are ideal for water-inhibiting products.
- Larger effective width = fewer interlocks.
- Less material = lower weight per ft² and less CO2 emission.
- Suitable for smaller series.
- Fast delivery.

Meever USA optimizes the standard

Our IBO® profiles are developed by certified engineers whereby your requirements are the basis. We will develop the most advantageously profile with the required Moment of Inertia and Section Modulus. Your requirements regarding steel grade, thickness, width and height will be considered in this development.

On demand you will receive a made-to-order profile which is especially developed for your project.

In the table you will find a number of examples of possible savings.

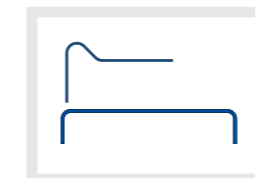

On request we can make the required Sheet Pile Cap.

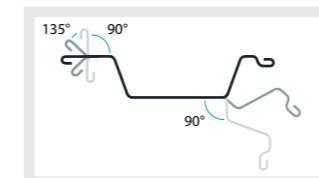

Meever USA can produce almost any specified angle corner piles from 40 - 300°.

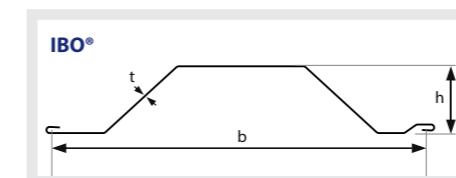

IBO® is a double VKZ without the lock.

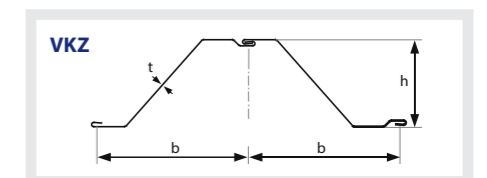

| Section | Wy in/ft cm ² /m | Ly in/ft cm/m | Flange inch mm | Weight lbs/ft ² kgs/m ² | Weight advantage | |
|--------------|-----------------------------------|---------------------|----------------------|---|------------------|--|
| PZ 22 | 18.1 | 84.38 | 0.375 | 22.0 | | |
| | 973 | 11.500 | 9.5 | 107.4 | | |
| VKZ 1033-7 | 19.2 | 122.9 | 0.276 | 16.3 | 26% | |
| | 1.033 | 16.783 | 7.0 | 79.5 | | |
| VKZ 1045-8 | 19.4 | 103.4 | 0.315 | 18.4 | 16% | |
| | 1.045 | 14.115 | 8.0 | 89.7 | | |
| VKZ 986-9 | 18.3 | 90.3 | 0.354 | 20.3 | 8% | |
| | 986 | 12.331 | 9.0 | 98.9 | | |
| VKZ 1318-10 | 24.5 | 149.7 | 0.394 | 21.7 | 2% | |
| | 1.318 | 20.438 | 10.0 | 105.7 | | |
| IBO® 1093-7 | 20.3 | 144.1 | 0.276 | 15.6 | 29% | |
| | 1.093 | 19.678 | 7.0 | 76.1 | | |
| IBO® 999-8 | 18.6 | 104.5 | 0.315 | 17.1 | 22% | |
| | 999 | 14.270 | 8.0 | 83.7 | | |
| IBO® 1029-9 | 19.1 | 127.4 | 0.354 | 17.9 | 19% | |
| | 1.029 | 17.404 | 9.0 | 87.5 | | |
| IBO® 990-10 | 18.4 | 85.8 | 0.394 | 20.8 | 5% | |
| | 990 | 11.450 | 10.0 | 101.7 | | |
| IBO® 1295-10 | 24.1 | 144.8 | 0.394 | 21.3 | 3% | |
| | 1.295 | 19.777 | 10.0 | 104.1 | | |

"The IBO® sheet piles are a new and improved type of sheet piles.

With which weight advantages of up to 40% are possible, something I have never seen before in my old days as a sheet pile specialist!"

NEW AND USED MATERIALS FOR SALE OR RENT AND BUY BACK OPTIONS



IBO® The Tailor-Made Suit In The Sheet Pile World



| Section | Wy in ³ /ft cm ³ /m | Ly in/ /ft cm /m | Flange inch mm | Weight lbs/ft ² kgs/m ² | Weight advantage | |
|--------------|---|------------------------|----------------------|---|---------------------|--|
| PZ 27 | 18.1 | 84.38 | 0.375 | 22.0 | | |
| | 973 | 11.500 | 9.5 | 107.4 | | |
| PZC 17 | 31.0 | 236.1 | 0.335 | 22.3 | 17% | |
| | 1.670 | 32.235 | 8.5 | 108.8 | | |
| VKZ 1808-7 | 33.6 | 331.1 | 0.276 | 17.8 | 34% | |
| | 1.808 | 45.210 | 7.0 | 87.1 | | |
| VKZ 1704-8 | 31.7 | 256.0 | 0.315 | 19.5 | 13% | |
| | 1.704 | 34.954 | 8.0 | 95.1 | | |
| VKZ 1771-9 | 32.9 | 291.9 | 0.354 | 20.9 | 23% | |
| | 1.771 | 39.857 | 9.0 | 102.0 | | |
| VKZ 1793-10 | 33.4 | 262.6 | 0.394 | 23.1 | 14% | |
| | 1.793 | 35.864 | 10.0 | 112.7 | | |
| IBO® 1805-6 | 33.6 | 298.6 | 0.315 | 20.5 | 24% | |
| | 1.805 | 40.771 | 8.0 | 100.2 | | |
| IBO® 1639-8 | 32.4 | 255.7 | 0.315 | 19.4 | 28% | |
| | 1.743 | 34.916 | 8.0 | 94.8 | | |
| IBO® 1661-9 | 30.9 | 247.0 | 0.354 | 21.1 | 22% | |
| | 1.661 | 33.734 | 9.0 | 102.9 | | |
| IBO® 1652-10 | 30.7 | 237.2 | 0.394 | 22.5 | 17% | |
| | 1.652 | 32.398 | 10.0 | 110.0 | | |

| Section | Wy in ³ /ft cm ³ /m | Ly in/ /ft cm /m | Flange inch mm | Weight lbs/ft ² kgs/m ² | Weight advantage | |
|--------------|---|------------------------|----------------------|---|---------------------|--|
| PZ 35 | 48.5 | 361.22 | 0.600 | 35.0 | | |
| | 2.608 | 49.300 | 15.2 | 170.9 | | |
| PZC 26 | 48.4 | 428.1 | 0.600 | 31.8 | 9% | |
| | 2.600 | 58.460 | 15.2 | 155.4 | | |
| AZ 26-700 | 48.4 | 437.3 | 0.480 | 30.1 | 14% | |
| | 2.600 | 59.720 | 12.2 | 146.9 | | |
| ESZ 26-700 | 48.4 | 438.0 | 0.512 | 28.3 | 19% | |
| | 2.600 | 59.810 | 13.0 | 138.1 | | |
| VKZ 2628-10 | 48.9 | 514.7 | 0.394 | 26.4 | 25% | |
| | 2.628 | 70.289 | 10.0 | 128.9 | | |
| VKZ 2886-10 | 53.7 | 581.3 | 0.394 | 27.7 | 21% | |
| | 2.886 | 79.377 | 10.0 | 135.2 | | |
| VKZ 3082-10 | 57.3 | 648.8 | 0.394 | 28.6 | 18% | |
| | 3.082 | 88.594 | 10.0 | 139.8 | | |
| VKZ 4665-10 | 86.8 | 1332.3 | 0.394 | 32.2 | 9% | |
| | 4.665 | 181.942 | 10.0 | 157.0 | | |
| IBO® 2625-10 | 48.8 | 501.5 | 0.394 | 28.2 | 10% | |
| | 2.625 | 68.487 | 10.0 | 137.5 | | |
| IBO® 3030-10 | 56.4 | 610.9 | 0.394 | 30.9 | 12% | |
| | 3.030 | 83.417 | 10.0 | 150.9 | | |

| Section | Wy in ³ /ft cm ³ /m | Ly in/ /ft cm /m | Flange inch mm | Weight lbs/ft ² kgs/m ² | Weight advantage | |
|--------------|---|------------------------|----------------------|---|---------------------|--|
| PZ 40 | 60.7 | 490.85 | 0.600 | 40.0 | | |
| | 3.263 | 67.000 | 15.2 | 195.3 | | |
| VKZ 3359-10 | 62.5 | 781.0 | 0.394 | 26.6 | 33% | |
| | 3.359 | 106.651 | 10.0 | 130.1 | | |
| VKZ 3658-10 | 68.0 | 870.6 | 0.394 | 28.1 | 30% | |
| | 3.658 | 118.893 | 10.0 | 137.1 | | |
| VKZ 4665-10 | 86.8 | 1332.3 | 0.394 | 32.2 | 20% | |
| | 4.665 | 181.942 | 10.0 | 157.0 | | |
| IBO® 3030-10 | 56.4 | 610.9 | 0.394 | 30.9 | 23% | |
| | 3.030 | 83.417 | 10.0 | 150.9 | | |

| Section | Wy in ³ /ft cm ³ /m | Ly in/ /ft cm /m | Flange inch mm | Weight lbs/ft ² kgs/m ² | Weight advantage | |
|---------------|---|------------------------|----------------------|---|---------------------|--|
| PZC 13 | 24.2 | 152.0 | 0.375 | 21.7 | | |
| | 1.300 | 20.760 | 9.5 | 106.0 | | |
| VKZ 1453-7 | 27.0 | 207.5 | 0.276 | 18.6 | 14% | |
| | 1.453 | 28.331 | 7.0 | 90.8 | | |
| VKZ 1342-9 | 25.0 | 162.2 | 0.354 | 21.6 | 1% | |
| | 1.342 | 22.151 | 9.0 | 105.3 | | |
| VKZ 1481-8 | 27.5 | 205.1 | 0.315 | 20.5 | 6% | |
| | 1.481 | 28.008 | 8.0 | 100.1 | | |
| IBO® 1310-8 | 24.4 | 173.0 | 0.315 | 17.8 | 18% | |
| | 1.310 | 23.620 | 8.0 | 87.1 | | |
| IBO® 1443-9 | 26.8 | 208.0 | 0.354 | 20.7 | 4% | |
| | 1.443 | 28.410 | 9.0 | 101.3 | | |
| IBO® 1372-10 | 25.5 | 168.5 | 0.394 | 21.3 | 2% | |
| | 1.372 | 23.008 | 10.0 | 104.2 | | |

| Section | Wy in ³ /ft cm ³ /m | Ly in/ /ft cm /m | Flange inch mm | Weight lbs/ft ² kgs/m ² | Weight advantage | |
|---------------|---|------------------------|----------------------|---|---------------------|--|
| PZC 18 | 33.5 | 255.5 | 0.375 | 24.2 | | |
| | 1.800 | 34.890 | 9.5 | 118.2 | | |
| VKZ 1808-7 | 33.6 | 331.1 | 0.276 | 17.8 | 26% | |
| | 1.808 | 45.210 | 7.0 | 87.1 | | |
| VKZ 1850-8 | 34.4 | 328.4 | 0.315 | 19.2 | 21% | |
| | 1.850 | 44.850 | 8.0 | 93.7 | | |
| VKZ 1832-9 | 34.1 | 301.9 | 0.354 | 21.2 | 13% | |
| | 1.832 | 41.228 | 9.0 | 103.3 | | |
| IBO® 1805-8 | 33.6 | 298.6 | 0.315 | 20.5 | 15% | |
| | 1.805 | 40.771 | 8.0 | 100.2 | | |
| IBO® 1963-8 | 36.5 | 338.3 | 0.315 | 21.5 | 11% | |
| | 1.963 | 46.196 | 8.0 | 105.2 | | |
| IBO® 1922-9 | 35.7 | 302.7 | 0.354 | 22.6 | 7% | |
| | 1.922 | 41.339 | 9.0 | 110.5 | | |

"Less material means less CO2 emissions and this makes the IBO® sheet piles a perfect solution for an environmentally friendly approach."

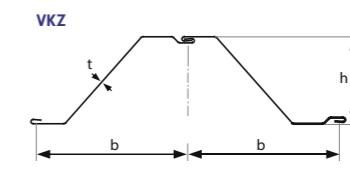
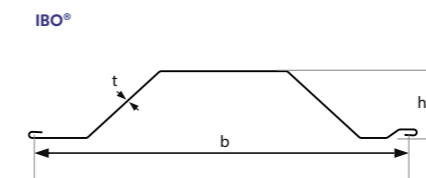



Cold Formed VKZ Profiles

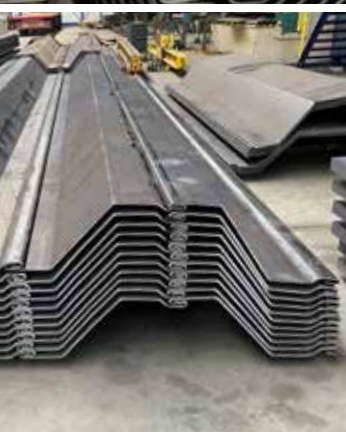

| Meever USA | Section | Wy | ly | Width inch mm | Height inch mm | Thickness | | Weight | | Coating 2 sides ft ² /ft ² m ² /m ² |
|--------------|---------|---------------------|---------------------|---------------------|----------------------|-----------|-------|--------|---------------------|--|
| | | in ³ /ft | in ⁴ /ft | | | flange | web | single | wall | |
| | | cm ³ /m | cm ⁴ /m | | | inch | inch | lbs/ft | lbs/ft ² | |
| VKZ 784-5 | 784 | 14.6 | 96.2 | 28.43 | 13.98 | 0.197 | 0.197 | 26.9 | 11.3 | 8.17 |
| | 784 | 13.136 | 722 | 355 | 5.0 | 5.0 | 40.0 | 55.4 | 2.49 | |
| VKZ 965-5 | 965 | 17.9 | 150.2 | 26.61 | 16.73 | 0.197 | 0.197 | 26.9 | 12.1 | 8.72 |
| | 965 | 20.516 | 676 | 425 | 5.0 | 5.0 | 40.0 | 59.2 | 2.66 | |
| VKZ 783-6 | 783 | 14.6 | 87.4 | 29.45 | 12.01 | 0.236 | 0.236 | 32.3 | 13.1 | 7.90 |
| | 783 | 11.939 | 748 | 305 | 6.0 | 6.0 | 48.0 | 64.1 | 2.41 | |
| VKZ 1153-6 | 1153 | 21.4 | 159.2 | 25.79 | 14.84 | 0.236 | 0.236 | 32.3 | 15.0 | 9.02 |
| | 1153 | 21.741 | 655 | 377 | 6.0 | 6.0 | 48.0 | 73.2 | 2.75 | |
| VKZ 1246-6 | 1246 | 23.2 | 214.4 | 35.55 | 18.50 | 0.236 | 0.236 | 40.3 | 13.6 | 8.36 |
| | 1246 | 29.280 | 903 | 470 | 6.0 | 6.0 | 60.0 | 66.4 | 2.55 | |
| VKZ 846-7 | 846 | 15.7 | 85.2 | 29.02 | 10.83 | 0.276 | 0.276 | 37.6 | 15.5 | 8.00 |
| | 846 | 11.628 | 737 | 275 | 7.0 | 7.0 | 56.0 | 75.9 | 2.44 | |
| VKZ 1033-7 | 1033 | 19.2 | 122.9 | 27.72 | 12.80 | 0.276 | 0.276 | 37.6 | 16.3 | 8.53 |
| | 1033 | 16.783 | 704 | 325 | 7.0 | 7.0 | 56.0 | 79.5 | 2.60 | |
| VKZ 1078-7 | 1078 | 20.1 | 130.3 | 27.32 | 12.99 | 0.276 | 0.276 | 37.6 | 16.5 | 8.50 |
| | 1078 | 17.790 | 694 | 330 | 7.0 | 7.0 | 56.0 | 80.6 | 2.59 | |
| VKZ 1330-7 | 1330 | 24.7 | 184.0 | 25.35 | 14.88 | 0.276 | 0.276 | 37.6 | 17.8 | 9.18 |
| | 1330 | 25.130 | 644 | 378 | 7.0 | 7.0 | 56.0 | 86.9 | 2.80 | |
| VKZ 1453-7 | 1453 | 27.0 | 207.5 | 24.29 | 15.35 | 0.276 | 0.276 | 37.6 | 18.6 | 9.54 |
| | 1453 | 28.331 | 617 | 390 | 7.0 | 7.0 | 56.0 | 90.8 | 2.91 | |
| VKZ 1808-7 | 1808 | 33.6 | 331.1 | 31.65 | 19.69 | 0.276 | 0.276 | 47.0 | 17.8 | 9.18 |
| | 1808 | 45.210 | 804 | 500 | 7.0 | 7.0 | 70.0 | 87.1 | 2.80 | |
| VKZ 812-8 | 812 | 15.1 | 72.9 | 30.91 | 9.65 | 0.315 | 0.315 | 44.2 | 17.1 | 8.23 |
| | 812 | 9.955 | 785 | 245 | 8.0 | 8.0 | 65.7 | 83.7 | 2.51 | |
| VKZ 1006-8 | 1006 | 18.7 | 106.9 | 28.25 | 11.42 | 0.315 | 0.315 | 43.0 | 18.3 | 8.36 |
| | 1006 | 14.596 | 718 | 290 | 8.0 | 8.0 | 64.0 | 89.2 | 2.55 | |
| VKZ 1045-8 | 1045 | 19.4 | 103.4 | 27.56 | 10.63 | 0.315 | 0.315 | 43.0 | 18.4 | 8.43 |
| | 1045 | 14.115 | 700 | 270 | 8.0 | 8.0 | 64.0 | 89.7 | 2.57 | |
| VKZ 1481-8 | 1481 | 27.5 | 205.1 | 25.20 | 14.88 | 0.315 | 0.315 | 43.0 | 20.5 | 9.22 |
| | 1481 | 28.008 | 640 | 378 | 8.0 | 8.0 | 64.0 | 100.1 | 2.81 | |
| VKZ 1704-8 | 1704 | 31.7 | 256.0 | 33.11 | 16.14 | 0.315 | 0.315 | 53.8 | 19.5 | 8.79 |
| | 1704 | 34.954 | 841 | 410 | 8.0 | 8.0 | 80.0 | 95.1 | 2.68 | |
| VKZ 1850-8 | 1850 | 34.4 | 328.4 | 32.91 | 19.09 | 0.315 | 0.315 | 53.8 | 19.2 | 8.82 |
| | 1850 | 44.850 | 836 | 485 | 8.0 | 8.0 | 80.0 | 93.7 | 2.69 | |
| VKZ 986-9 | 986 | 18.3 | 90.3 | 28.66 | 9.84 | 0.354 | 0.354 | 48.4 | 20.3 | 8.10 |
| | 986 | 12.331 | 728 | 250 | 9.0 | 9.0 | 72.0 | 98.9 | 2.47 | |
| VKZ 1342-9 | 1342 | 25.0 | 162.2 | 26.93 | 12.99 | 0.354 | 0.354 | 48.4 | 21.6 | 8.63 |
| | 1342 | 22.151 | 684 | 330 | 9.0 | 9.0 | 72.0 | 105.3 | 2.63 | |
| VKZ 1832-9 | 1832 | 34.1 | 301.9 | 34.29 | 17.72 | 0.354 | 0.354 | 60.5 | 21.2 | 8.46 |
| | 1832 | 41.228 | 871 | 450 | 9.0 | 9.0 | 90.0 | 103.3 | 2.58 | |
| VKZ 1379-9.5 | 1379 | 25.6 | 175.2 | 30.31 | 13.66 | 0.375 | 0.375 | 55.8 | 21.7 | 8.30 |
| | 1379 | 23.929 | 770 | 347 | 9.5 | 9.5 | 83.1 | 106.0 | 2.53 | |
| VKZ 1392-9.5 | 1392 | 25.9 | 186.1 | 29.92 | 14.37 | 0.375 | 0.375 | 51.1 | 20.1 | 7.77 |
| | 1392 | 25.419 | 760 | 365 | 9.5 | 9.5 | 76.0 | 98.2 | 2.37 | |
| VKZ 1454-9.5 | 1454 | 27.0 | 189.1 | 36.18 | 13.98 | 0.375 | 0.375 | 63.8 | 20.8 | 8.04 |
| | 1454 | 25.820 | 919 | 355 | 9.5 | 9.5 | 95.0 | 101.4 | 2.45 | |
| VKZ 1318-10 | 1318 | 24.5 | 149.7 | 37.24 | 12.20 | 0.394 | 0.394 | 67.2 | 21.7 | 7.81 |
| | 1318 | 20.438 | 946 | 310 | 10.0 | 10.0 | 100.0 | 105.7 | 2.38 | |
| VKZ 1771-9 | 1771 | 32.9 | 291.9 | 34.72 | 17.72 | 0.354 | 0.354 | 60.5 | 20.9 | 8.36 |
| | 1771 | 39.857 | 882 | 450 | 9.0 | 9.0 | 90.0 | 102.0 | 2.55 | |
| VKZ 1375-10 | 1375 | 25.6 | 138.5 | 26.08 | 10.83 | 0.394 | 0.394 | 53.8 | 24.7 | 9.02 |
| | 1375 | 18.908 | 663 | 275 | 10.0 | 10.0 | 80.0 | 120.8 | 2.75 | |
| VKZ 1793-10 | 1793 | 33.4 | 262.6 | 34.92 | 15.75 | 0.394 | 0.394 | 67.2 | 23.1 | 8.33 |
| | 1793 | 35.864 | 887 | 400 | 10.0 | 10.0 | 100.0 | 112.7 | 2.54 | |
| VKZ 2628-10 | 2628 | 48.9 | 514.7 | 30.55 | 21.06 | 0.394 | 0.394 | 67.2 | 26.4 | 9.77 |
| | 2628 | 70.289 | 776 | 535 | 10.0 | 10.0 | 100.0 | 128.9 | 2.98 | |
| VKZ 2886-10 | 2886 | 53.7 | 581.3 | 30.55 | 21.65 | 0.394 | 0.394 | 67.2 | 27.7 | 9.77 |
| | 2886 | 79.377 | 776 | 550 | 10.0 | 10.0 | 100.0 | 135.2 | 2.98 | |
| VKZ 3082-10 | 3082 | 57.3 | 648.8 | 28.15 | 22.64 | 0.394 | 0.394 | 67.2 | 28.6 | 10.59 |
| | 3082 | 88.594 | 715 | 575 | 10.0 | 10.0 | 100.0 | 139.8 | 3.23 | |
| VKZ 4665-10 | 4665 | 86.8 | 1332.3 | 30.10 | 30.71 | 0.394 | 0.394 | 80.6 | 32.2 | 11.91 |
| | 4665 | 181.942 | 765 | 780 | 10.0 | 10.0 | 120.0 | 157.0 | 3.63 | |

Cold Formed IBO® Profiles

| Meever USA | Section | Wy | ly | Width inch mm | Height inch mm | Thickness | | Weight | | Coating 2 sides ft ² /ft ² m ² /m ² |
|--------------|---------|---------------------|---------------------|---------------------|----------------------|-----------|-------|--------|---------------------|--|
| | | in ³ /ft | in ⁴ /ft | | | flange | web | single | wall | |
| | | cm ³ /m | cm ⁴ /m | | | inch | inch | lbs/ft | lbs/ft ² | |
| IBO® 154-4 | 154 | 2.9 | 5.0 | 32.17 | 3.54 | 0.157 | 0.157 | 21.5 | 8.0 | 6.56 |
| | 154 | 683 | 817 | 90 | 4.0 | 4.0 | 32.0 | 39.2 | 2.00 | |
| IBO® 272-4 | 272 | 5.1 | 13.0 | 27.56 | 5.12 | 0.157 | 0.157 | 21.5 | 9.9 | 6.56 |
| | 272 | 1.780 | 700 | 130 | 4.0 | 4.0 | 32.0 | 48.5 | 2.00 | |
| IBO® 265-5 | 265 | 4.9 | 12.3 | 30.24 | 4.92 | 0.197 | 0.197 | 26.9 | 10.7 | 6.56 |
| | 265 | 1.679 | 768 | 125 | 5.0 | 5.0 | 40.0 | 52.1 | 2.00 | |
| IBO® 781-5 | 781 | 14.5 | 103.4 | 52.48 | 14.17 | 0.197 | 0.197 | 48.4 | 11.1 | 7.90 |
| | 781 | 14.118 | 1.333 | 360 | 5.0 | 5.0 | 72.0 | 54.1 | 2.41 | |
| IBO® 949-5 | 949 | 17.7 | 157.5 | 56.30 | 17.72 | 0.197 | 0.197 | 53.8 | 11.5 | 8.27 |
| | 949 | 21.511 | 1.430 | 450 | 5.0 | 5.0 | 80.0 | 55.9 | 2.52 | |
| IBO® 361-6 | 361 | 6.7 | 19.9 | 49.88 | 5.91 | 0.236 | 0.236 | 48.4 | 11.6 | 6.72 |
| | 361 | 2.724 | 1.267 | 150 | 6.0 | 6.0 | 72.0 | 56.8 | 2.05 | |
| IBO® 537-6 | 537 | 10.0 | 45.0 | 67.68 | 8.90 | 0.236 | 0.236 | 64.5 | 11.4 | 6.86 |
| | 537 | 6.142 | 1.719 | 226 | 6.0 | 6.0 | 96.0 | 55.8 | 2.09 | |
| IBO® 744-6 | 744 | 13.8 | 81.6 | 64.13 | 11.81 | 0.236 | 0.236 | 58.1 | 12.8 | 7.61 |
| | 744 | 11.138 | 1.629 | 300 | 6.0 | 6.0 | 86.4 | 62.6 | 2.32 | |
| IBO® 895-6 | 895 | 16.6 | 106.8 | 60.20 | 12.80 | 0.236 | 0.236 | 64.5 | 12.9 | 7.71 |
| | 895 | 14.586 | 1.529 | 325 | 6.0 | 6.0 | 96.0 | 62.8 | 2.35 | |
| IBO® 1552-6 | 1552 | 28.9 | 284.6 | 47.44 | 19.69 | 0.236 | 0.236 | 64.5 | 16.3 | 9.81 |
| | 1552 | 38.867 | 1.205 | 500 | 6.0 | 6.0 | 96.0 | 79.7 | 2.99 | |
| IBO® 741-7 | 741 | 13.8 | 71.0 | 64.29 | 10.24 | 0.276 | 0.276 | 75.3 | 13.9 | 7.22 |
| | 741 | 9.692 | 1.633 | 260 | 7.0 | 7.0 | 112.0 | 67.9 | 2.20 | |
| IBO® 1093-7 | 1093 | 20.3 | 144.1 | 51.14 | 14.17 | 0.276 | 0.276 | 67.7 | 15.6 | 8.63 |
| | 1093 | 19.678 | 1.299 | 360 | 7.0 | 7.0 | 100.8 | 76.1 | 2.63 | |
| IBO® 1438-7 | 1438 | 26.7 | 226.5 | 53.19 | 16.93 | 0.276 | 0.276 | 75.3 | 17.0 | 8.72 |
| | 1438 | 30.932 | 1.351 | 430 | 7.0 | 7.0 | 112.0 | 82.9 | 2.66 | |
| IBO® 1770-7 | 1770 | 32.9 | 342.1 | 47.80 | 20.67 | 0.276 | 0.276 | 75.3 | 18.9 | 9.74 |
| | 1770 | 46.721 | 1.214 | 525 | 7.0 | 7.0 | 112.0 | 92.3 | 2.97 | |
| IBO® 999-8 | 999 | 18.6 | 104.5 | 54.17 | 11.22 | 0.315 | 0.315 | 77.4 | 17.1 | 8.17 |
| | 999 | 14.270 | 1.376 | 285 | 8.0 | 8.0 | 115.2 | 83.7 | 2.49 | |
| IBO® 1310-8 | 1310 | 24.4 | 173.0 | 57.87 | 14.17 | 0.315 | 0.315 | 86.0 | 17.8 | 8.50 |
| | 1310 | 23.620 | 1.470 | 360 | 8.0 | 8.0 | 128.0 | 87.1 | 2.59 | |
| IBO® 1639-8 | 1743 | 32.4 | 255.7 | 52.87 | 16.73 | 0.315 | 0.315 | 86.0 | 19.4 | 9.28 |
| | 1743 | 34.916 | 1.343 | 425 | 8.0 | 8.0 | 128.0 | 94.8 | 2.83 | |
| IBO® 1805-8 | 1805 | 33.6 | 298.6 | 50.31 | 17.72 | 0.315 | 0.315 | 86.0 | 20.5 | 9.74 |
| | 1805 | 40.771 | 1.278 | 450 | 8.0 | 8.0 | 128.0 | 100.2 | 2.97 | |
| IBO® 1963-8 | 1963 | 36.5 | 338.3 | 47.91 | 18.50 | 0.315 | 0.315 | 86.0 | 21.5 | 10.27 |
| | 1963 | 46.196 | 1.217 | 470 | 8.0 | 8.0 | 128.0 | 105.2 | 3.13 | |
| IBO® 1029-9 | 1029 | 19.1 | 127.4 | 54.45 | 12.40 | 0.354 | 0.354 | 96.8 | 17.9 | 8.13 |
| | 1029 | 17.404 | 1.383 | 315 | 9.0 | 9.0 | 144.0 | 87.5 | 2.48 | |
| IBO® 1443-9 | 1443 | 26.8 | 208.0 | 55.94 | 14.96 | 0.354 | 0.354 | 96.8 | 20.7 | 7.90 |
| | 1443 | 28.410 | 1.421 | 380 | 9.0 | 9.0 | 144.0 | 101.3 | 2.41 | |
| IBO® 1661-9 | 1661 | 30.9 | 247.0 | 55.12 | 15.98 | 0.354 | 0.354 | 96.8 | 21.1 | 8.04 |
| | 1661 | 33.734 | 1.400 | 406 | 9.0 | 9.0 | 144.0 | 102.9 | 2.45 | |
| IBO® 1922-9 | 1922 | 35.7 | 302.7 | 51.30 | 16.93 | 0.354 | 0.354 | 96.8 | 22.6 | 8.59 |
| | 1922 | 41.339 | 1.303 | 430 | 9.0 | 9.0 | 144.0 | 110.5 | 2.62 | |
| IBO® 2265-9 | 2265 | 42.1 | 427.9 | 47.56 | 20.28 | 0.354 | 0.354 | 96.8 | 24.4 | 9.77 |
| | 2265 | 58.431 | 1.208 | 515 | 9.0 | 9.0 | 144.0 | 119.2 | 2.98 | |
| IBO® 990-10 | 990 | 18.4 | 83.8 | 55.75 | 9.06 | 0.394 | 0.394 | 96.8 | 20.8 | 7.94 |
| | 990 | 11.450 | 1.416 | 230 | 10.0 | 10.0 | 144.0 | 101.7 | 2.42 | |
| IBO® 1295-10 | 1295 | 24.1 | 144.8 | 60.51 | 11.81 | 0.394 | | | | |



Cold Formed Profiles

Trench Sheets

| Meever USA | Section | Wy | ly | Width | Height | Thickness | Weight | |
|------------|---------|---------------------|---------------------|-------|--------|-----------|--------------------|--------------------|
| | | in ³ /ft | in ⁴ /ft | inch | inch | inch | lb/ft ¹ | lb/ft ² |
| | | cm ³ /m | cm ⁴ /m | mm | mm | mm | kg/m ¹ | kg/m ² |
| MKD VI/6 | | 3.4 | 5.3 | 23.62 | 3.07 | 0.236 | 25.2 | 12.80 |
| | | 182 | 726 | 600 | 78 | 6.0 | 37.5 | 62.5 |
| MKD VI/8 | | 4.5 | 7.1 | 23.62 | 3.15 | 0.315 | 33.6 | 17.07 |
| | | 242 | 968 | 600 | 80 | 8.0 | 50.0 | 83.3 |

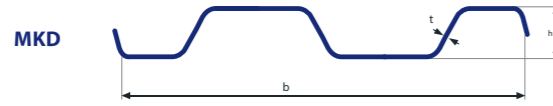

| Meever USA | Section | Wy | ly | Width | Height | Thickness | Weight | |
|------------|---------|---------------------|---------------------|-------|--------|-----------|--------------------|--------------------|
| | | in ³ /ft | in ⁴ /ft | inch | inch | inch | lb/ft ¹ | lb/ft ² |
| | | cm ³ /m | cm ⁴ /m | mm | mm | mm | kg/m ¹ | kg/m ² |
| MKD 1500 | | 7.1 | 15.4 | 53.15 | 4.33 | 0.394 | 80.6 | 18.2 |
| | | 382 | 2,108 | 1,350 | 110 | 10.0 | 120.0 | 88.9 |
| MKD 1800 | | 9.1 | 25.6 | 62.99 | 5.51 | 0.394 | 96.8 | 18.4 |
| | | 490 | 3,492 | 1,600 | 140 | 10.0 | 144.0 | 90.0 |
| MKD 2000 | | 10.0 | 29.9 | 70.24 | 5.91 | 0.394 | 107.5 | 18.4 |
| | | 540 | 4,081 | 1,784 | 150 | 10.0 | 160.0 | 89.7 |

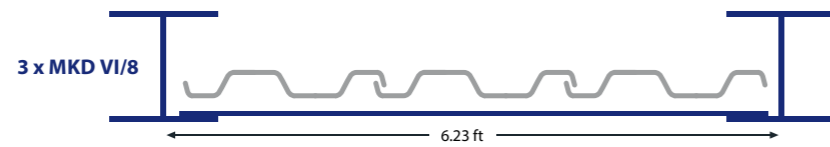
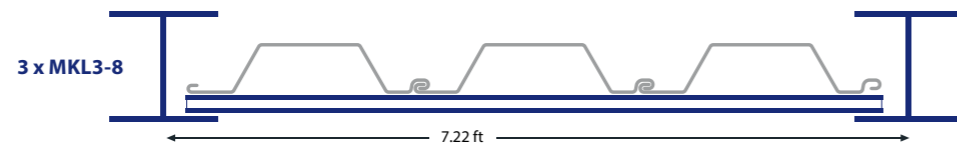
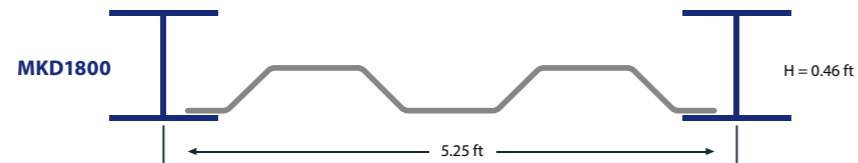

| Meever USA | Section | Wy | ly | Width | Height | Thickness | Weight pile | Weight area | Coating* | Coating* |
|------------|---------|---------------------|---------------------|-------|--------|-----------|-------------|--------------------|---------------------|----------------------------------|
| | | in ³ /ft | in ⁴ /ft | inch | inch | inch | lbs/ft | lb/ft ² | ft ² /ft | ft ² /ft ² |
| | | cm ³ /m | cm ⁴ /m | mm | mm | mm | kg/m | kg/m ² | m ² /m | m ² /m ² |
| MKL 3-4 | | 5.62 | 16.2 | 27.56 | 5.91 | 0.157 | 21.8 | 9.5 | 6.46 | 2.43 |
| | | 302 | 2,209 | 700 | 150 | 4.0 | 32.4 | 46.3 | 2.0 | 2.43 |
| MKL 3-5 | | 7.0 | 20.2 | 27.56 | 5.98 | 0.197 | 27.1 | 11.8 | 6.46 | 2.43 |
| | | 374 | 2,753 | 700 | 152 | 5.0 | 40.4 | 57.7 | 1.96 | 2.43 |
| MKL 3-6 | | 8.5 | 24.7 | 27.56 | 6.06 | 0.236 | 32.6 | 14.2 | 6.46 | 2.43 |
| | | 455 | 3,369 | 700 | 154 | 6.0 | 48.5 | 69.3 | 1.96 | 2.43 |
| MKL 3-7 | | 10.0 | 29.3 | 27.56 | 6.14 | 0.276 | 37.8 | 16.5 | 6.46 | 2.43 |
| | | 540 | 4,004 | 700 | 156 | 7.0 | 56.3 | 80.4 | 1.95 | 2.43 |
| MKL 3-8 | | 11.2 | 32.7 | 27.56 | 6.22 | 0.315 | 43.1 | 18.2 | 6.36 | 2.43 |
| | | 600 | 4,460 | 700 | 158 | 8.0 | 64.2 | 88.9 | 1.94 | 2.43 |
| MKL 3-9 | | 12.6 | 37.5 | 27.56 | 6.30 | 0.354 | 48.4 | 21.1 | 6.46 | 2.43 |
| | | 680 | 5,120 | 700 | 160 | 9.0 | 72 | 102.9 | 1.94 | 2.43 |

| Meever USA | Section | Wy | ly | Width | Height | Thickness | Weight pile | Weight area | Coating* | Coating* |
|------------|---------|---------------------|---------------------|-------|--------|-----------|-------------|--------------------|---------------------|----------------------------------|
| | | in ³ /ft | in ⁴ /ft | inch | inch | inch | lbs/ft | lb/ft ² | ft ² /ft | ft ² /ft ² |
| | | cm ³ /m | cm ⁴ /m | mm | mm | mm | kg/m | kg/m ² | m ² /m | m ² /m ² |
| MKL 4-5 | | 14.4 | 80.0 | 27.95 | 11.57 | 0.197 | 33.3 | 14.3 | 7.84 | 3.37 |
| | | 774 | 10,920 | 710 | 294 | 5.0 | 49.5 | 69.7 | 2.40 | 3.37 |
| MKL 4-6 | | 17.4 | 99.1 | 27.95 | 11.65 | 0.236 | 38.9 | 16.7 | 7.64 | 3.29 |
| | | 933 | 13,530 | 710 | 296 | 6.0 | 57.9 | 81.6 | 2.34 | 3.29 |
| MKL 4-7 | | 194.9 | 115.0 | 27.95 | 11.73 | 0.276 | 45.2 | 19.4 | 7.62 | 3.29 |
| | | 10480 | 15,701 | 710 | 298 | 7.0 | 67.3 | 94.8 | 2.34 | 3.29 |
| MKL 4-8 | | 22.9 | 131.1 | 27.95 | 11.81 | 0.315 | 51.5 | 22.1 | 7.59 | 3.27 |
| | | 1230 | 17,896 | 710 | 300 | 8.0 | 76.7 | 108.1 | 2.32 | 3.27 |
| MKL 4-9 | | 25.7 | 153.0 | 27.95 | 11.89 | 0.354 | 57.5 | 24.7 | 7.54 | 3.24 |
| | | 1380 | 20,896 | 710 | 302 | 9.0 | 85.6 | 120.6 | 2.30 | 3.24 |

| Meever USA | Section | Wy | ly | Width | Height | Thickness | Weight pile | Weight area | Coating* | Coating* |
|------------|---------|---------------------|---------------------|-------|--------|-----------|-------------|--------------------|---------------------|----------------------------------|
| | | in ³ /ft | in ⁴ /ft | inch | inch | inch | lbs/ft | lb/ft ² | ft ² /ft | ft ² /ft ² |
| | | cm ³ /m | cm ⁴ /m | mm | mm | mm | kg/m | kg/m ² | m ² /m | m ² /m ² |
| MKZ 785-5 | | 11.3 | 61.5 | 30.91 | 10.87 | 0.197 | 28.2 | 10.9 | 6.64 | 2.58 |
| | | 605 | 8,395 | 785 | 276 | 5.0 | 41.9 | 53.4 | 2.03 | 2.58 |
| MKZ 785-6 | | 13.5 | 73.6 | 30.91 | 10.91 | 0.236 | 33.9 | 13.2 | 6.65 | 2.59 |
| | | 724 | 10,053 | 785 | 277 | 6.0 | 50.4 | 64.2 | 2.03 | 2.59 |
| MKZ 785-7 | | 15.5 | 85.4 | 30.91 | 10.94 | 0.276 | 39.2 | 15.2 | 6.61 | 2.57 |
| | | 836 | 11,657 | 785 | 278 | 7.0 | 58.4 | 74.4 | 2.02 | 2.57 |
| MKZ 785-8 | | 17.7 | 97.4 | 30.91 | 10.98 | 0.315 | 44.8 | 17.3 | 6.59 | 2.57 |
| | | 951 | 13,302 | 785 | 279 | 8.0 | 66.6 | 84.4 | 2.02 | 2.57 |
| MKZ 785-9 | | 19.8 | 109.4 | 30.91 | 11.02 | 0.354 | 50.3 | 19.5 | 6.58 | 2.56 |
| | | 1,067 | 14,944 | 785 | 280 | 9.0 | 74.8 | 95.3 | 2.01 | 2.56 |

| Meever USA | Section | Wy | ly | Width | Height | Thickness | Weight pile | Weight area | Coating* | Coating* |
|------------|---------|---------------------|---------------------|-------|--------|-----------|-------------|--------------------|---------------------|----------------------------------|
| | | in ³ /ft | in ⁴ /ft | inch | inch | inch | lbs/ft | lb/ft ² | ft ² /ft | ft ² /ft ² |
| | | cm ³ /m | cm ⁴ /m | mm | mm | mm | kg/m | kg/m ² | m ² /m | m ² /m ² |
| MKZ 675-5 | | 18.1 | 135.5 | 26.57 | 14.80 | 0.197 | 28.2 | 12.7 | 6.64 | 3.01 |
| | | 972 | 18,500 | 675 | 376 | 5.0 | 41.9 | 62.1 | 2.03 | 3.01 |
| MKZ 675-6 | | 21.7 | 162.1 | 26.57 | 14.84 | 0.236 | 33.9 | 15.3 | 6.64 | 3.01 |
| | | 1,164 | 22,131 | 675 | 377 | 6.0 | 50.4 | 74.7 | 2.03 | 3.01 |
| MKZ 675-7 | | 25.1 | 188.2 | 26.57 | 14.88 | 0.276 | 39.2 | 17.7 | 6.61 | 2.99 |
| | | 1,350 | 25,698 | 675 | 378 | 7.0 | 58.4 | 86.5 | 2.02 | 2.99 |
| MKZ 675-8 | | 28.6 | 214.8 | 26.57 | 14.92 | 0.315 | 44.8 | 20.2 | 6.60 | 2.99 |
| | | 1,540 | 29,332 | 675 | 379 | 8.0 | 66.6 | 98.7 | 2.02 | 2.99 |
| MKZ 675-9 | | 32.1 | 241.0 | 26.57 | 14.96 | 0.354 | 50.3 | 22.7 | 6.58 | 2.99 |
| | | 1,728 | 32,914 | 675 | 380 | 9.0 | 74.8 | 110.8 | 2.01 | 2.99 |

* Excluding the interlock interior – coating on both sides.





Cold Formed Z-Profiles

| Section | Wy | ly | Width | Height | Thickness | | Weight | | Coating Area* |
|---------|---|---|------------|------------|----------------|----------------|----------------------------|---|--|
| | in ³ /ft cm ³ /m | in ⁴ /ft cm ⁴ /m | inch mm | inch mm | inch t (mm) | inch s (mm) | lb/ft kg/m ¹ | lb/ft ² kg/m ² | ft ² /ft ² m ² /m ² |
| SCZ 14 | 14.36 | 71.82 | 28.5 | 10 | 0.25 | 0.25 | 33.81 | 14.24 | 6.1 |
| | 772 | 9808 | 724 | 254 | 6.4 | 6.4 | 50.3 | 69.5 | 1.86 |
| SCZ 16 | 15.8 | 78.7 | 28.50 | 10.00 | 0.276 | 0.276 | 37.4 | 15.73 | 6.10 |
| | 847 | 10751 | 724 | 254 | 7.0 | 7.0 | 55.6 | 76.8 | 1.86 |
| SCZ 18N | 18.1 | 90.5 | 28.50 | 10.00 | 0.317 | 0.317 | 42.9 | 18.08 | 6.10 |
| | 973 | 12356 | 724 | 254 | 8.1 | 8.1 | 63.9 | 88.3 | 1.86 |
| SKZ 20 | 31.7 | 253.5 | 28.50 | 16.00 | 0.315 | 0.315 | 48.2 | 20.31 | 7.60 |
| | 1704 | 34619 | 724 | 406 | 8.0 | 8.0 | 71.8 | 99.2 | 2.31 |
| SKZ 22 | 33.4 | 267.4 | 28.50 | 16.00 | 0.335 | 0.335 | 51.3 | 21.60 | 7.60 |
| | 1797 | 36516 | 724 | 406 | 8.5 | 8.5 | 76.3 | 105.5 | 2.31 |
| SKZ 24 | 37.7 | 301.8 | 28.50 | 16.00 | 0.375 | 0.375 | 57.4 | 24.18 | 7.60 |
| | 2028 | 41213 | 724 | 406 | 9.5 | 9.5 | 85.5 | 118.1 | 2.31 |
| SKZ 31 | 51.6 | 464.1 | 28.50 | 18.00 | 0.450 | 0.450 | 73.8 | 31.08 | 8.06 |
| | 2772 | 63370 | 724 | 457 | 11.4 | 11.4 | 109.9 | 151.8 | 2.46 |
| SKZ 36 | 60.7 | 546.4 | 28.50 | 18.00 | 0.535 | 0.535 | 86.8 | 36.55 | 8.06 |
| | 3264 | 74619 | 724 | 457 | 13.6 | 13.6 | 129.2 | 178.5 | 2.46 |

| Section | Wy | ly | Width | Height | Thick-ness | Weight single | Weight | Coating 2 sides |
|--------------|---------------------|---------------------|-------|--------|------------|---------------|---------------------|----------------------------------|
| | in ³ /ft | in ⁴ /ft | inch | inch | inch | lbs/ft | lbs/ft ² | ft ² /ft ² |
| MSZ 13 - 312 | 14.13 | 67.86 | 36.38 | 9.58 | 0.312 | 49.72 | 16.40 | 7.51 |
| MSZ 13 - 340 | 15.32 | 73.79 | 36.38 | 9.58 | 0.340 | 54.10 | 17.85 | 7.52 |
| MSZ 13 - 350 | 15.74 | 75.93 | 36.38 | 9.58 | 0.350 | 55.69 | 18.37 | 7.53 |
| MSZ 13 - 375 | 16.81 | 81.34 | 36.38 | 9.58 | 0.375 | 59.67 | 19.68 | 7.54 |
| MSZ 13 - 406 | 18.18 | 88.27 | 36.38 | 9.58 | 0.406 | 64.60 | 21.31 | 7.54 |
| MSZ 14 - 312 | 19.62 | 120.97 | 34.56 | 12.24 | 0.312 | 49.72 | 17.27 | 7.51 |
| MSZ 14 - 340 | 21.29 | 131.28 | 34.56 | 12.24 | 0.340 | 54.10 | 18.79 | 7.52 |
| MSZ 14 - 350 | 21.91 | 135.5 | 34.56 | 12.24 | 0.350 | 55.69 | 19.34 | 7.53 |
| MSZ 14 - 375 | 23.38 | 144.93 | 34.56 | 12.24 | 0.375 | 59.67 | 20.72 | 7.54 |
| MSZ 14 - 406 | 25.29 | 157.25 | 34.56 | 12.24 | 0.406 | 64.60 | 22.43 | 7.54 |
| MSZ 15 - 312 | 24.24 | 172.66 | 32.79 | 14.11 | 0.312 | 49.72 | 18.20 | 7.51 |
| MSZ 15 - 340 | 26.27 | 187.52 | 32.79 | 14.11 | 0.340 | 54.10 | 19.80 | 7.52 |
| MSZ 15 - 350 | 27.06 | 193.26 | 32.79 | 14.11 | 0.350 | 55.69 | 20.38 | 7.53 |
| MSZ 15 - 375 | 28.91 | 207.03 | 32.79 | 14.11 | 0.375 | 59.67 | 21.84 | 7.54 |
| MSZ 15 - 406 | 31.27 | 224.46 | 32.79 | 14.11 | 0.406 | 64.60 | 23.64 | 7.54 |
| MSZ 16 - 312 | 28.45 | 223.36 | 31.05 | 15.54 | 0.312 | 49.72 | 19.22 | 7.51 |
| MSZ 16 - 340 | 30.88 | 242.98 | 31.05 | 15.54 | 0.340 | 54.10 | 20.91 | 7.52 |
| MSZ 16 - 350 | 31.74 | 249.85 | 31.05 | 15.54 | 0.350 | 55.69 | 21.53 | 7.53 |
| MSZ 16 - 375 | 33.95 | 267.87 | 31.05 | 15.54 | 0.375 | 59.67 | 23.06 | 7.54 |
| MSZ 16 - 406 | 36.75 | 290.74 | 31.05 | 15.54 | 0.406 | 64.60 | 24.97 | 7.54 |
| MSZ 17 - 312 | 31.60 | 262.34 | 29.71 | 16.43 | 0.312 | 49.72 | 20.09 | 7.51 |
| MSZ 17 - 340 | 34.27 | 285.1 | 29.71 | 16.43 | 0.340 | 54.10 | 21.86 | 7.52 |
| MSZ 17 - 350 | 35.25 | 293.36 | 29.71 | 16.43 | 0.350 | 55.69 | 22.50 | 7.53 |
| MSZ 17 - 375 | 37.71 | 314.57 | 29.71 | 16.43 | 0.375 | 59.67 | 24.11 | 7.54 |
| MSZ 17 - 406 | 40.80 | 341.03 | 29.71 | 16.43 | 0.406 | 64.60 | 26.10 | 7.54 |
| MSZ 18 - 312 | 34.57 | 300.16 | 28.38 | 17.2 | 0.312 | 49.72 | 21.03 | 7.51 |
| MSZ 18 - 340 | 37.54 | 326.53 | 28.38 | 17.2 | 0.340 | 54.10 | 22.88 | 7.52 |
| MSZ 18 - 350 | 38.60 | 336.07 | 28.38 | 17.2 | 0.350 | 55.69 | 23.56 | 7.53 |
| MSZ 18 - 375 | 41.30 | 360.01 | 28.38 | 17.2 | 0.375 | 59.67 | 25.23 | 7.54 |
| MSZ 18 - 406 | 44.70 | 390.78 | 28.38 | 17.2 | 0.406 | 64.60 | 27.33 | 7.54 |
| MSZ 19 - 340 | 41.32 | 373.81 | 26.88 | 17.9 | 0.340 | 54.10 | 24.15 | 7.52 |
| MSZ 19 - 350 | 42.44 | 384.52 | 26.88 | 17.9 | 0.350 | 55.69 | 24.86 | 7.53 |
| MSZ 19 - 375 | 45.41 | 411.98 | 26.88 | 17.9 | 0.375 | 59.67 | 26.64 | 7.54 |
| MSZ 19 - 406 | 49.20 | 446.95 | 26.88 | 17.9 | 0.406 | 64.60 | 28.84 | 7.54 |

Connectors and Corner Solutions

Meever USA has a solution in stock to fit every possible corner connection you might need. Meever USA is always happy to advise on tailor-made solutions and/or connections between different types of sheet piling sections.

If you don't have the time or possibility to weld the corner sections to your sheet piling yourself, why not leave that to us?

For **PZ-Corner Sections** we refer you to our website.

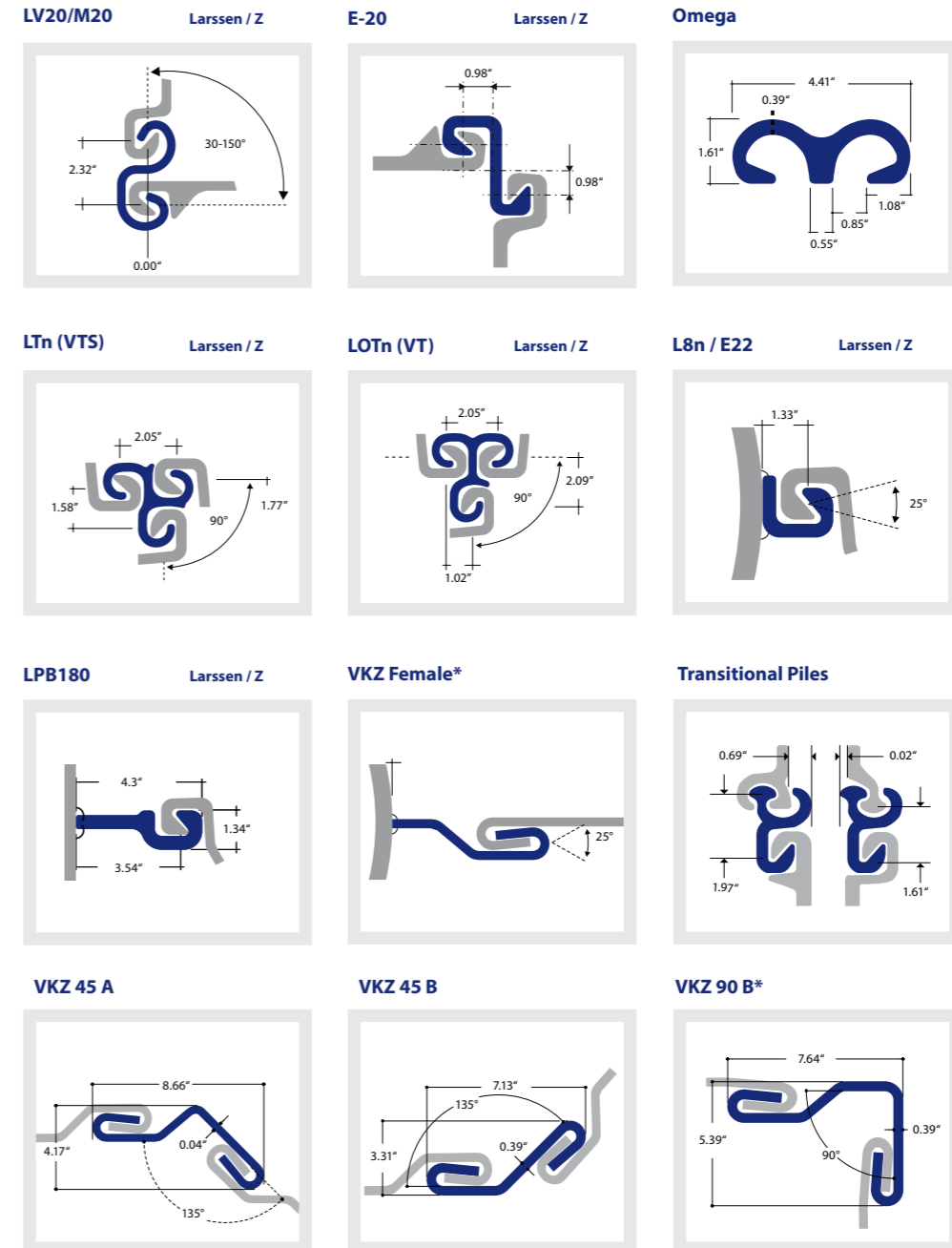

* More options available

"Meever USA can even supply the sheet pile sections with the required angle for you, so they can be immediately placed and connected upon arrival."





New Unique Patented Mechanical Modular Bracing System
See Page 38

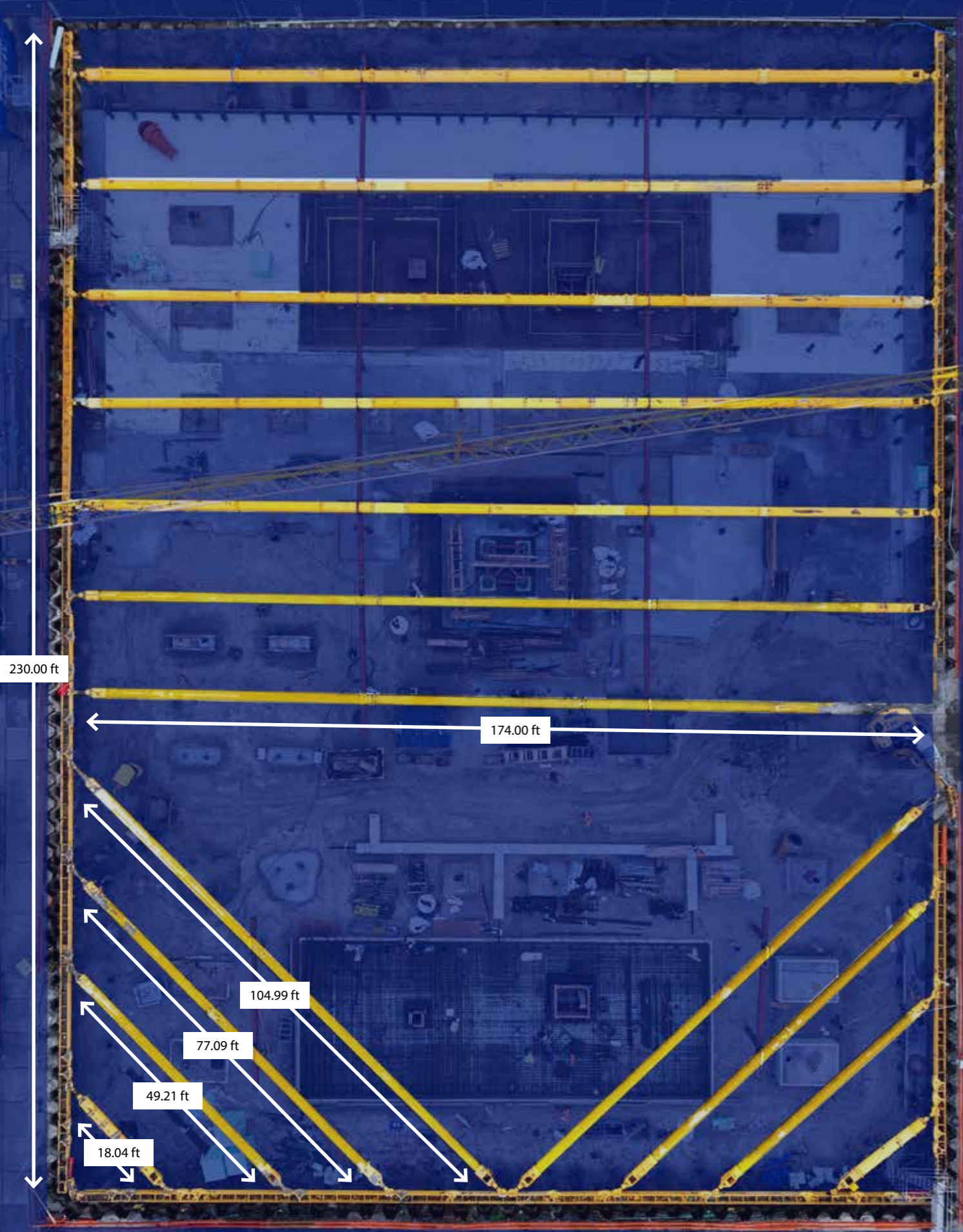

8.20 ft

BUT WE CAN DO MUCH BIGGER!
PLEASE TAKE A LOOK AT PAGE 26 FOR OUR FULL RANGE

RENT YOUR CRANE MATS AT MEEVER USA AND CREATE EXCELLENT MOBILE ACCESS ON SITE



Steel Tubes



Our steel tubular pipes are being used for countless ground, road and hydraulic engineering projects throughout the US and beyond. We have a wide range of diameters and wall thicknesses in stock (seamless, longitudinally welded and spirally welded), which enables us to meet the wishes and requirements of the customer and to deliver quickly from stock. For example, for outrigger constructions, pipelines, noise barriers or deeply founded flood defences.

Meever USA delivers steel pipes according to API, ASTM, DIN or NEN. On request we can deliver every quality from stock or production including CE-marking. Steel grades up to X80, S555 or L555. We deliver quickly and on your terms; with or without certificates. The pipes are usually provided with a 3.1/3.2 certificate or a material analysis 2.1 certificate. We have a wide range of pipes; new, second choice or used.

| Type | Diameter | | Thickness | |
|----------------------------|--------------------|-----------------|---------------|---------------|
| | mm | inch | mm | inch |
| Seamless Tube | 21.30 - 725.00 | 0.84 - 28.50 | 2.5 - 150.00 | 0.10 - 5.90 |
| Longitudinally Welded Tube | 42.40 - 5,600.00 * | 1.66 - 220.00 * | 2.0 - 60.00 * | 0.08 - 2.35 * |
| Spirally Welded Tube | 219.00 - 3,048.00 | 8.60 - 120.00 | 3.5 - 30.00 | 0.14 - 1.18 |

* Larger diameters and/or thicknesses on request.

Optional

- Non-destructive Testing (NDT)
 - o Ultrasonic testing
 - o Magnetic testing
 - o Radiographic examination (X-ray or gamma ray)
- Destructive testing (DO)
 - o Tensile test
 - o Chemical Analysis
 - o Impact test
- Drilling head; design Meever USA, also possible with a large injection lance
- Extruded ends
- Footplates
- Various welding options (e.g. mooring post attributes)
- Coating/galvanizing
- CE-marking

| ASTM | Yield Strength | | ASTM | Yield Strength | |
|---------------|----------------|-------|----------------------|----------------|---------|
| | (ksi) | (MPa) | | (ksi) | (MPa) |
| A 139 Grade A | 30 | 206 | A 252 Grade 1 | 30 | 205 |
| A 139 Grade B | 35 | 240 | A 252 Grade 2 | 35 | 240 |
| A 139 Grade C | 42 | 290 | A 252 Grade 3 | 45 | 310 |
| A 139 Grade D | 46 | 315 | A 252 Grade 3 (Mod)* | 50-80 | 345-555 |
| A 139 Grade E | 52 | 360 | | | |

| Available Steel Specifications |
|--------------------------------|
| ASTM |
| A 588 |
| A 690 |
| A 572 |
| A 1011 |
| A 1011 |
| Abrasion Resistant |

Seamless

Seamless pipes are, as the word says, pipes that are produced without a weld/seam. This makes seamless pipes ideal for high pressure projects, and are therefore perfect for projects where high demands are made.

A steel billet will be heated to high temperatures in an oven after which it is possible to create a cylindrical hollow. This hollow is produced using a rotary piercer and rollers.

Longitudinally Welded

Longitudinally welded pipes are welded along the length of the pipe and can be produced in two ways. Both forms of production provide their own advantages.

The first type of production is from a coil. The coil is rolled out and folded over the width into a round shape. Then the seam is welded and a "longitudinal seam" is created over the entire length. This is a continuous process until the coil is unwound and is common for standard diameters and thicknesses.

The second form of production is from a steel plate. This plate is rolled into a pipe shape whose specification exactly fits the customer's project. These pipes are also welded along the length of the pipe and for this reason also bear the name 'longitudinally welded'. The separately produced pipes have got a limited length and therefore the elements are usually welded together by means of a round seam. This method is not limited in diameters and/or thicknesses and is therefore very suitable for projects which contain specific sizes, for example with thick-walled pipes.

Spirally Welded

Spirally welded pipes are pipes where the weld runs across the pipe as a spiral. A coil is rolled out and formed into a pipe-shaped spiral. It is then completely spirally welded. This is a continuous welding process until the coil is unwound. This is the ideal production form for larger tons of steel/projects with long pipes and relatively thin wall thicknesses.

Spirally welded pipes are very suitable for combined wall constructions, outrigger pipes, pipes, mooring posts/fenders and guideways.

Combined Pipes

With a combined pipe, various pipes with different diameters and/or wall thicknesses are assembled into one pipe. Here, the demand for different strengths (Wx) and stiffnesses (Ix) can be met along the length of one pipe. This saves tons of steel where the Wx and Ix may be lower.





**EXCELLENCE
IN STEEL
SINCE 1898**

Thick-Walled Tubes From Our Own Production

The Highest Quality

These pipes are very suitable for heavy duty applications and are often seen in mooring posts or guideways, wind turbines, support structures/foundations in the offshore industry.



| Certifications | Welding Processes | Surface Treatment | Testing Equipment |
|--|-------------------|------------------------|------------------------|
| DIN EN 1090 EXC 4 | TIG | Sandblasting | Radiographic test |
| DIN EN 10219 | SMAW | Corrosion protection | Ultrasonic test |
| DIN EN ISO 9001 : 2008 | E | Coating | Magnetic particle test |
| DIN EN ISO 3834 | MIG / MAG | Rubber lining | Dye penetration test |
| DGRL | | CPL | Pressure test |
| AD HP 0 | | PE-, PP-, PVC - lining | |
| AD W | | | |
| WHG | | | |
| ASME Boiler & Pressure Vessel Code (U+S) | | | |



Wall thickness up to 6.3 inch

Length up to 262.5 ft.

Diameter up to 236.2 inch

Weight up to 220.46 St.

Other specifications available upon request.



"These tubes are made in our own production facility in Germany and can be made on request."





Combined Walls

A Combined Wall (also referred to as a "Combi-wall") is a structural design for a bulkhead wall using a combination of pipe, beams, and/or sheetpiling that are connected with interlocks in order to provide a very high strength alternative to typical sheetpiling designs.

As project requirements vary greatly, the component choices can be custom designed to meet almost all specifications. The choices includes: sheet piling with beams, sheet piling with pipe piling, beams only with interlocks, and pipe piling only with interlocks. With the many options for sheet piling, wide flange beams and pipe piling, the design options and properties are almost limitless.

The Meever Group has the capability to provide value-engineered designs, material procurement, fabrication, corrosion protection and shipping from multiple locations domestically and worldwide to meet any project requirements with delivery and budget concerns kept in mind.

Pipe-Z Sheetpiling System is composed of large diameter pipe, weld-on interlock connectors and Z sheetpiling between pipes. The sheetpiling transfers load to the pipe which carries the majority of the required strength. Pipe piling is available in multiple sizes and grades in order to meet the required properties.

Beam-Z Sheetpiling System is similar to the Pipe-Z System with wide-flange beams replacing the pipe. With the many beam sizes available, this system is also very versatile.

Pipe-to-Pipe (or Beam-to-Beam) Wall Systems with weld-on interlocks are available to provide the greatest design capacity alternatives.

If a design is specified on a project, the Meever Group can provide a value-engineered alternative that can potentially produce time and cost savings.

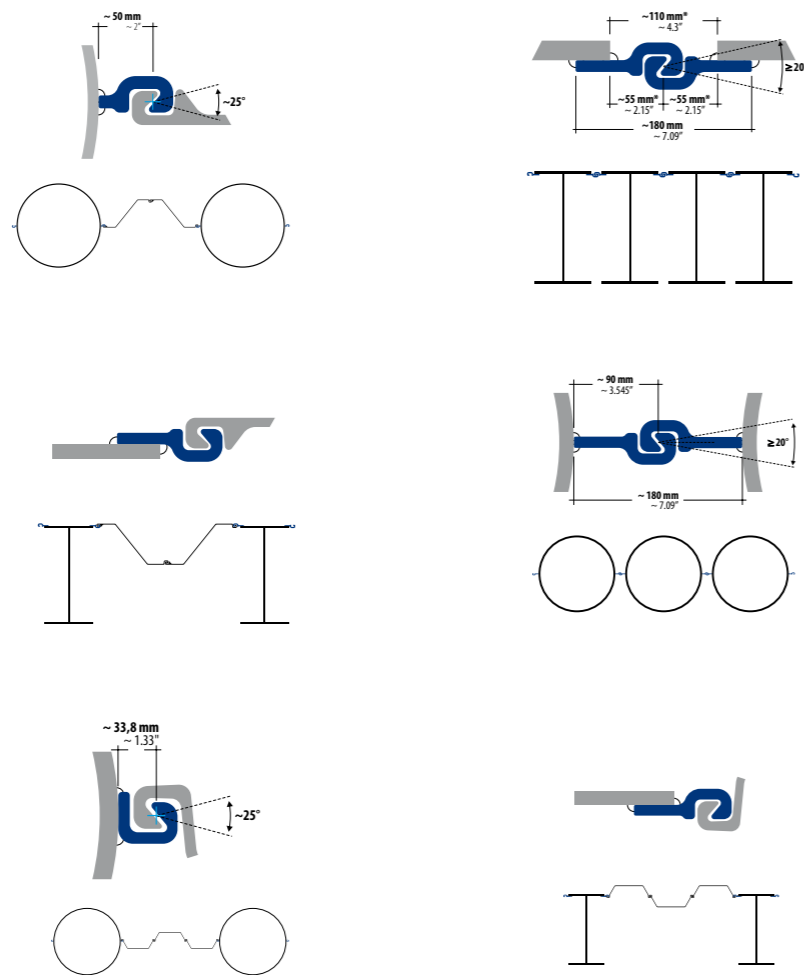

Example Designs

Example Design

| King Pile | Sheet pile | Section Modules | Moment of Inertia | System Width |
|------------|--------------------------|---------------------|---------------------|--------------|
| | | in ³ /ft | in ⁴ /ft | inch |
| W 36 x 160 | ESZ 19-700 A572 GR 50 | 112.9 | 2188.6 | 67.13 |

Example Design

| Section | Section Modules | Moment of Inertia | Width | Height | Thickness | Weight | Weight | Coating | Cross | |
|--------------------------------|---|---|------------------|---------------|----------------|----------------|--|--|------------------------------------|------------------|
| | in ³ /ft cm ³ /m | in ⁴ /ft cm ⁴ /m | inch mm | inch mm | inch mm | lbs/ft kg/m | lbs/ft ² kg/m ² | ft ² /ft m ² /m | in ² mm ² | |
| 42"x0.650 pipe with ESZ 19-700 | 107.87 5.700 | 2.484 339.211 | 99.72 2,532.8 | 42 1066.76 | 0.650 16.51 | 0.375 0.5 | 407.02 605.71 | 48.98 239.14 | 25.04 7.63 | 116.35 75.064 |





Steel Beams



| MUSA | Section Modulus | Moment of Inertia | Width | Height | Thickness Flange | Web | Weight | Coating |
|-----------|---------------------|---------------------|-------|--------|------------------|-------|--------|---------------------|
| | in ³ /ft | in ⁴ /ft | inch | inch | inch | inch | lbs/ft | ft ² /ft |
| | cm ³ /m | cm ⁴ /m | mm | mm | mm | mm | kg/m | m ² /m |
| HP8 x36 | 29.8 | 119.0 | 8.16 | 8.02 | 0.445 | 0.445 | 36.0 | 3.92 |
| | 1.602 | 16.250 | 207 | 204 | 11.3 | 11.3 | 53.6 | 1.19 |
| HP10 x42 | 43.4 | 210.0 | 10.10 | 9.70 | 0.420 | 0.415 | 42.0 | 4.83 |
| | 2.333 | 28.677 | 257 | 246 | 10.7 | 10.5 | 62.5 | 1.47 |
| HP10 x42 | 58.8 | 294.0 | 10.20 | 9.99 | 0.565 | 0.565 | 57.0 | 4.91 |
| | 3.161 | 40.148 | 259 | 254 | 14.4 | 14.4 | 84.8 | 1.50 |
| HP12 x53 | 66.7 | 393.0 | 12.00 | 11.80 | 0.435 | 0.435 | 53.0 | 5.82 |
| | 3.586 | 53.667 | 305 | 300 | 11.0 | 11.0 | 78.9 | 1.77 |
| HP12 x63 | 79.1 | 472.0 | 12.10 | 11.90 | 0.515 | 0.515 | 63.0 | 5.86 |
| | 4.253 | 64.455 | 307 | 302 | 13.1 | 13.1 | 93.8 | 1.78 |
| HP12 x74 | 93.8 | 569.0 | 12.20 | 12.10 | 0.610 | 0.605 | 74.0 | 5.91 |
| | 5.043 | 77.702 | 310 | 307 | 15.5 | 15.4 | 110.1 | 1.80 |
| HP12 x84 | 106.0 | 650.0 | 12.30 | 12.30 | 0.685 | 0.685 | 84.0 | 5.97 |
| | 5.699 | 88.763 | 312 | 312 | 17.4 | 17.4 | 125.0 | 1.82 |
| HP12 x89 | 111.6 | 689.0 | 12.32 | 12.36 | 0.720 | 0.720 | 89.0 | 6.04 |
| | 6.000 | 94.089 | 313 | 314 | 18.3 | 18.3 | 132.4 | 1.84 |
| HP12 x102 | 129.3 | 811.0 | 12.64 | 12.56 | 0.819 | 0.819 | 102.0 | 6.17 |
| | 6.952 | 110.749 | 321 | 319 | 20.8 | 20.8 | 151.8 | 1.88 |
| HP12 x117 | 148.2 | 946.0 | 12.87 | 12.76 | 0.929 | 0.929 | 117.0 | 6.26 |
| | 7.968 | 129.184 | 327 | 324 | 23.6 | 23.6 | 174.1 | 1.91 |
| HP14 x73 | 107.0 | 729.0 | 14.60 | 13.60 | 0.505 | 0.505 | 73.0 | 6.96 |
| | 5.753 | 99.551 | 371 | 345 | 12.8 | 12.8 | 108.6 | 2.12 |
| HP14 x89 | 131.0 | 904.0 | 14.70 | 13.80 | 0.615 | 0.615 | 89.0 | 7.02 |
| | 7.043 | 123.449 | 373 | 351 | 15.6 | 15.6 | 132.4 | 2.14 |
| HP14 x102 | 150.0 | 1,050.0 | 14.80 | 14.00 | 0.705 | 0.705 | 102.0 | 7.06 |
| | 8.064 | 143.386 | 376 | 356 | 17.9 | 17.9 | 151.8 | 2.15 |
| HP14 x117 | 172.0 | 1,220.0 | 14.90 | 14.20 | 0.805 | 0.805 | 117.0 | 7.12 |
| | 9.247 | 166.601 | 378 | 361 | 20.4 | 20.4 | 174.1 | 2.17 |
| HP16 x88 | 145.0 | 1,110.0 | 15.70 | 15.30 | 0.540 | 0.540 | 88.0 | 7.52 |
| | 7.796 | 151.580 | 399 | 389 | 13.7 | 13.7 | 131.0 | 2.29 |
| HP16 x101 | 168.0 | 1,300.0 | 15.80 | 15.50 | 0.625 | 0.625 | 101.0 | 7.56 |
| | 9.032 | 177.526 | 401 | 394 | 15.9 | 15.9 | 150.3 | 2.30 |
| HP16 x121 | 201.0 | 1,590.0 | 15.90 | 15.80 | 0.750 | 0.750 | 121.0 | 7.62 |
| | 10.806 | 217.128 | 404 | 401 | 19.1 | 19.1 | 180.1 | 2.32 |
| HP16 x141 | 234.0 | 1,870.0 | 16.00 | 16.00 | 0.875 | 0.875 | 141.0 | 7.69 |
| | 12.581 | 255.364 | 406 | 406 | 22.2 | 22.2 | 209.8 | 2.34 |
| HP16 x162 | 269.0 | 2,190.0 | 16.10 | 16.30 | 1.000 | 1.000 | 162.0 | 7.75 |
| | 14.462 | 299.062 | 409 | 414 | 25.4 | 25.4 | 241.1 | 2.36 |
| HP16 x183 | 304.0 | 2,510.0 | 16.30 | 16.50 | 1.130 | 1.130 | 183.0 | 7.81 |
| | 16.344 | 342.761 | 414 | 419 | 28.7 | 28.7 | 272.3 | 2.38 |
| HP18 x135 | 251.0 | 2,200.0 | 17.80 | 17.50 | 0.750 | 0.750 | 135.0 | 8.54 |
| | 13.495 | 300.428 | 452 | 445 | 19.1 | 19.1 | 200.9 | 2.60 |
| HP18 x157 | 290.0 | 2,570.0 | 17.90 | 17.70 | 0.870 | 0.870 | 157.0 | 8.60 |
| | 15.591 | 350.955 | 455 | 450 | 22.1 | 22.1 | 233.6 | 2.62 |
| HP18 x181 | 336.0 | 3,020.0 | 18.00 | 18.00 | 1.000 | 1.000 | 181.0 | 8.66 |
| | 18.064 | 412.406 | 457 | 457 | 25.4 | 25.4 | 269.4 | 2.64 |
| HP 18x204 | 380.0 | 3,480.0 | 18.10 | 18.30 | 1.130 | 1.130 | 204.0 | 8.73 |
| | 20.430 | 475.223 | 460 | 465 | 28.7 | 28.7 | 303.6 | 2.66 |

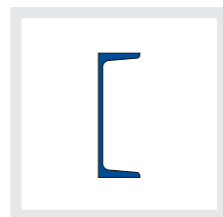

Meever USA offers steel beams and sections from stock or directly from production, delivered quickly and flexibly and with ample choice as to types and specifications. They can also be made to measure for your specific application if you so desire. We supply H-beams, U-sections and I-sections of several different lengths, grades and types.

Materials can be offered in accordance with ASTM standards and A572 or A690 steel grades. On request we also have the availability for special high yield strength steel grades. Aside from standard rolled shapes we also provide fabricated shapes. Cutting holes, welding attachments, coating or galvanizing and other value added services can be offered.

• HEA • HEB • HEM • UNP • IPE • Double-U

If you are interested in using lesser quality or used steel beams, we can email you some photos of examples in advance. And we are always happy to advise you on the best choice for your specific project.

In our material database you can find the section properties of all commonly used construction steel sections.

"We can supply a variety of W beams!"
Enquire with your Meever contact for our heavy pallet of beams."





Bollards

Tricorn Bollards

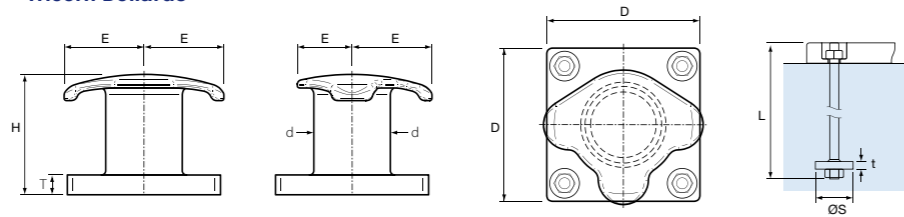

Square Head Bollards

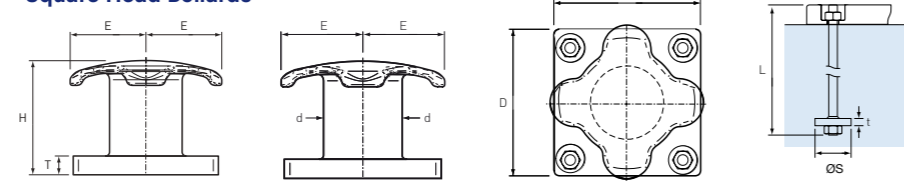

Standard

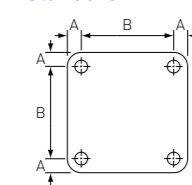

Optional Baseplates

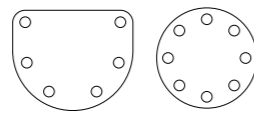

MEEVER Supplies different types of bollards. Here you can find our available bollard types. If there are any questions or you need more information, please contact us.

K-Head Bollards

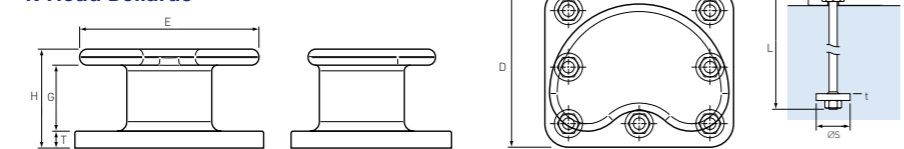

4 Bolts

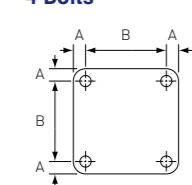

5 Bolts

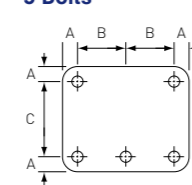

7 Bolts

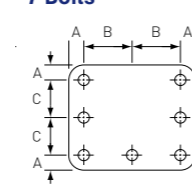

T-Head Bollards

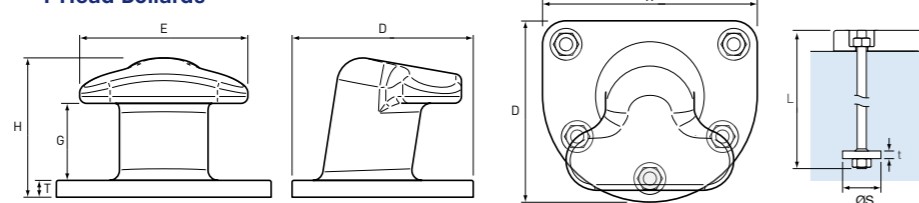

5 Bolts

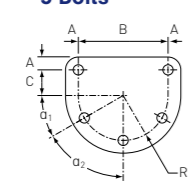

6 Bolts

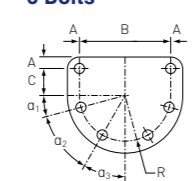

7 Bolts

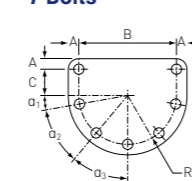

8 Bolts

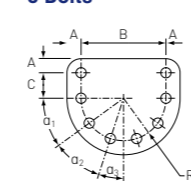

Anchoring

Meever USA offers several solutions for anchoring sheet piles, the right solution depends on the specifics of your project. Factors to consider here are the length and depth of the sheet pile wall, the soil situation, and whether the sheet pile wall is a temporary or permanent wall.

Grout Injection Anchors

A grout anchor is a hollow borehole tube in which grout is injected under high pressure. The anchor is connected to the sheet pile wall to enable damming constructions with major differences in height to be constructed.

GTB Anchors

GTB anchors are applied in the bottom as a grouted anchor. Installation is done by mean of a cased drilling technique. A temporary drill tube is inserted to a final depth and is flushed empty. The anchor rod is in the drill tube drained where after, with simultaneous injection of cement grout, the drilling pipes are drawn again.

Micro Piles

These are driven deep into the ground, into a sufficiently load-bearing layer; the micro pile that displaces the soil is constructed of tubular steel segments. These segments are interconnected by means of a threaded coupling sleeve to avoid having to be welded on the building site.

Screw Injection Piles

The seamless tubes have a threaded connection and are available with various dimensions. The thread guarantees an excellent connection which has been developed especially for heavy processing conditions. We can also supply the necessary drill bits and other accessories in accordance with your personal preferences.

Folding Anchors

Folding anchors are quick and easy to install. The anchor is first driven into the ground, at any angle required, using a vibro hammer. It is then tilted using a removable pull rod. When it is in this position (i.e. at a right angle), the folding anchor can immediately be subjected to a load. Our folding anchors are CE-certified.

Anchor Rods

Anchor Rods are high-quality steel solid bars that come in different versions. These rods are often installed horizontally and connected to the sheet pile wall and anchor wall by means of fasteners, anchor plates, an eye, hammer head and skullcap/flat nuts. Meever USA can offer all supplies from stock and production.

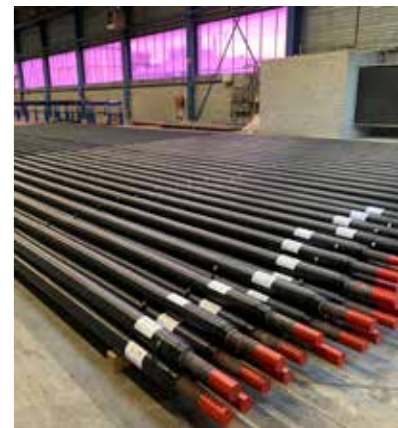



Interlock Sealing

Pile Lock

Pile Lock is the best option when the sealing needs to be completely waterproof. This product expands up to 20 times its original volume when it comes into contact with water, enabling a waterproof solution.

Intra Expanding Seal

Where soil is contaminated, an interlock seal based on polyurethane (PU) will often be the best solution. Read more about this on the right.



Pertex Bituminous Filling

This type of interlock sealing is very interesting from an economic point of view and significantly reduces leaking.



Surface Treatment

Blasting and Coating

We offer a full range of high quality coating systems from experienced, qualified coating facilities. Whether it's an anti-corrosion coating to increase the material lifetime or a paint for esthetic purposes, we can do it.

Galvanizing

We can deliver our products hot dipped galvanized.

Cathodic Protection (Anti Corrosion)

Especially in salt water environments steel gets affected quickly and marine coatings are almost a standard procedure to increase the lifetime. In addition to coating systems we provide zinc and aluminum anodes the have a huge effect on the material lifetime. Anodes and coating are often used in conjunction with each other to get the best result.

Product Modification

On request we can modify all products according to your specific requirements.

- Weld on interlocks
- Add slinging / handling holes
- Cut in lengths
- Corner sections
- Multiple sheet piles
- Loose / welded / punched

Project Design & Engineering

Our certified engineers can draw construction plans or calculate your complete project. We can help you with finding the best and most price efficient solution. Our experience has made us a reliable partner. We have seen that the best results are accomplished when working together with the contractor on a project starting from the tender phase until the end.

- Drawings and calculations
- Design building plans
- Developing alternative construction
- Cost efficient engineering

The Intra Expanding Seal is the product with watertight sheet pile joints as a result. This Hydrophilic swelling sealant on Polyurethane (PU) basis expands up to 350% of its original volume when it comes into contact with moisture and it can be applied to the sheet piling interlock structure on site.

Field of Application

- Sealing of the locks between sheet piles.
- Sealing of joints of in-situ cast concrete in moist conditions.
- Sealing joints between precast segments in wet or underwater applications (e.g. manholes, box culverts, cable ducts and pipes).

The Advantages of the Intra Expanding Seal:

- Due to its special formulation, Intra Expanding Seal can be applied in moist conditions.
- The Intra Expanding Seal is very sustainable: it will exceed the construction's lifespan.
- Solvent free.
- Intra Expanding Seal adheres to steel, concrete, PVC, HDPE, fibreglass, etc.
- In contact with moisture Intra Expanding Seal will expand to about 350% of its original volume.
- Flexible system, which adapts to the irregular surface of the substrate.
- Easy application with a standard caulking gun.
- Good chemical resistance: The ideal solution with contaminated soil.
- Environmentally friendly (find the explanation further on this page).

Environmentally Friendly

Intra Expanding Seal is an air moisture curing polyurethane sealant. The product does not contain any raw materials that are classified as dangerous to the environment.

Once cured, the expected life time is 100 years; during this life cycle Intra Expanding Seal will not release any substances that are harmful to the environment, ground water or soil.

Consumption

| Nozzle diameter | Length (sausage) |
|-----------------|---------------------|
| 0.12 inch | 131.00 - 164.00 ft. |
| 0.24 inch | 53.00 - 66.00 ft. |
| 0.31 inch | 26.00 - 33.00 ft. |
| 0.39 inch | Approx. 20.00 ft. |





New Unique Patented Mechanical Modular Bracing System

Meever Patented Bracing Systems

Meever Bracing Series is a modular system designed & engineered to maintain excavation integrity, it allows flexibility on site and saves time and money. Most importantly it provides a safe working environment. Meever Bracing Series is manufactured in house so we are able to offer custom solutions for varying excavations.

Meever Series is:

- The first of its kind, with removable hydraulic rams to create a static temporary support system
- Easy and quick to install
- Versatile on site
- Time and money saving
- Easy and fast assembly
- No welding on site

With 20 inch, 3 ft, 6 ft, 10 ft, 20 ft and 30 ft Modules, Meever Series fits together with a full shear capacity joint, secured with one pin. This simple, easy assembly requires minimal training, saving layout time on site.

What projects can the Meever Bracing System be used for?

- Meever Series can be used in conjunction with all Steel Sheet Piles U & Z Type and trench sheets.
- Meever Series is not restricted to size or shape it is versatile in every aspect.
- Meever Series offer a preliminary design outlining the sheets and the amount of bracing needed to secure your excavations.

There are three kinds of Bracing Series:

- The B300 bracing series is suitable for excavations with a section modulus of 102 in³ (grade 50) and it can be compared with a HP14 x 73 (Grade 50).
- The B400 bracing series is suitable for excavations with a section modulus of 199 in³ (grade 65) and it can be compared with a W24 x 104 (Grade 50).
- The B500 bracing series is suitable for excavations with a section modulus of 558 in³ (grade 65) and it can be compared with a W36 x 210 (Grade 50).

All series are compatible with each other.

Our engineering team can/will design the right bracing series for your project.

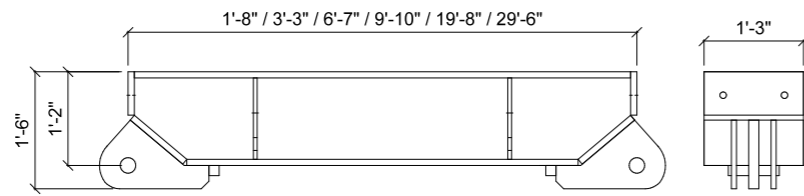

"Find out more information and a video about our Meever USA Bracing System."



Reduced Weight

The brace is lighter than conventional method of steel pipe strutting, therefore smaller machines can be used on site.

Over-dig Allowance

The Meever USA Series mechanical unit extends up to 20 inches and hydraulic unit extends up to 14 inches. This means that if over-digging occurs, the hydraulic unit can extend 14 inches to cover the gap between the modules, creating dig flexibility and convenience on site.

Safe Cross Bracing

Cross brace connection points have been designed into the modules. This allows a positive connection between the module and the cross brace.

STAGE 2
Install support at 3.00ft
Excavate to 15.00ft

| Maximum | d (ft) |
|-----------------|--------|
| 948.2 psf | 15.00 |
| 15875.3 ftlb/ft | 23.75 |

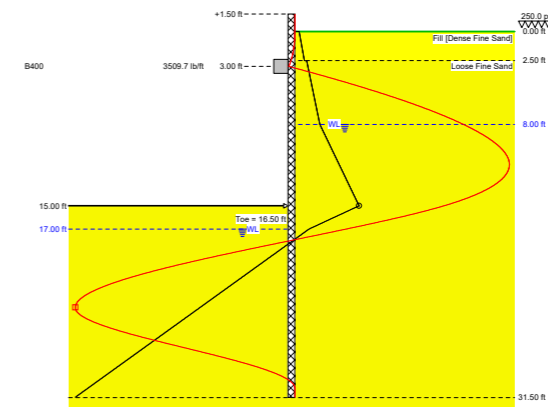

| | x (ft) | R (lb) | M (ftlb) |
|--------------------------------|--------|---------|----------|
| L = 87.50 ft | 0.00 | 26214.5 | 0.0 |
| E = 3.04E+07 psi | 20.00 | 85811.5 | 169986.5 |
| I = 1445.82 in ⁴ | 43.75 | 83051.0 | 163328.5 |
| M _v = 739653.3 ftlb | 67.50 | 85811.5 | 169986.5 |
| | 87.50 | 26214.5 | 0.0 |

| | Maximum | x (ft) |
|-----------------------|----------|--------|
| Bending Moment (ftlb) | 169986.5 | 19.91 |
| Shear Force (lb) | 44163.3 | 67.38 |
| Deflection (in) | 0.1 | 8.53 |

| | x (ft) | R (lb) | M (ftlb) |
|--------------------------------|--------|---------|----------|
| B = 51.00 ft | 0.00 | 23724.9 | 0.0 |
| E = 3.04E+07 psi | 17.00 | 65773.7 | 101301.2 |
| I = 1445.82 in ⁴ | 34.00 | 65773.7 | 101301.2 |
| M _v = 739653.3 ftlb | 51.00 | 23724.9 | 0.0 |

| | Maximum | x (ft) |
|-----------------------|----------|--------|
| Bending Moment (ftlb) | 101301.2 | 17.00 |
| Shear Force (lb) | 36090.0 | 33.91 |
| Deflection (in) | 0.1 | 7.56 |

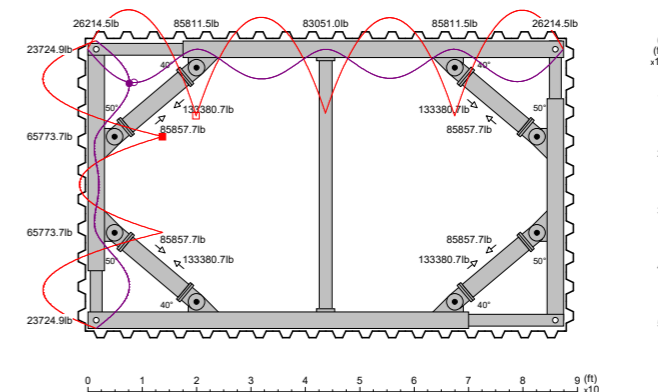



Sheet piling steel grades for hot-rolled sheet piles conforming to DIN EN 10 248-1

| American | | | Canadian | | | European | | | | |
|--------------|----------------|-----|--------------------|----------------|-----|-------------------|----------------|-----|------------------|--------------------|
| ASTM | Yield Strength | | CSA G40.21 | Yield Strength | | EN 10248 | Yield Strength | | Tensile strength | Minimum elongation |
| | ksi | MPa | | ksi | MPa | | ksi | MPa | MPa | % |
| A 328 | 39 | 270 | Grade 260 W | 38 | 260 | S 240 GP | 35 | 240 | 340 | 26 |
| A 572 Gr. 42 | 42 | 290 | Grade 300 W | 43 | 300 | S 270 GP | 39 | 270 | 410 | 24 |
| A 572 Gr. 50 | 50 | 345 | Grade 350 W | 51 | 355 | S 320 GP | 46 | 320 | 440 | 23 |
| A 572 Gr. 55 | 55 | 380 | Grade 400 W | 58 | 400 | S 355 GP | 51 | 355 | 480 | 22 |
| A 572 Gr. 60 | 60 | 415 | | | | S 390 GP* | 57 | 390 | 490 | 20 |
| A 572 Gr. 65 | 65 | 450 | | | | S 430 GP* | 62 | 430 | 510 | 19 |
| A 690 | 50 | 345 | | | | S 460 AP** | 67 | 460 | 550 | 17 |
| A 690* | 57 | 390 | | | | | | | | |

*) For the higher-strength sheet piling steels S 390 GP and S 430 GP, an approval certificate (Z-30.1-17) from the building supervisory authorities is available.

**) This is not within the 10248 but Arcelor Mittal mill specification.

Mechanical proportions according to EN 10025 - 2:2004. Other steel grades on request.

Deviation limits and dimensional tolerances for hot-rolled sheet piles made of unalloyed steels conforming to DIN EN 10 248-2.

| | |
|---|--|
| Pile width | Single piles ± 2%; double and triple piles ± 3% |
| Wall thicknesses of U-sections | t: up to 8.5 mm = ± 0.5 mm; over 8.5 mm = ± 6% t s: up to 8.5 mm = ± 0.5 mm; over 8.5 mm = ± 6% s* |
| Wall thicknesses of Z-sections and straight-web sections | t, s: up to 8.5 mm = ± 0.5 mm; over 8.5 mm = ± 6% s, t |
| Height of U-sections | h: up to 200 mm = ± 4 mm; over 200 mm = ± 5 mm |
| Height of Z-sections | h: up to 200 mm = ± 5 mm; from 200 up to 300 mm = ± 6 mm; over 300 mm = ± 7 mm |
| Deviation from straightness | The longitudinal deviation from straightness must not exceed 0.2% of pile length. |
| Pile length | Sheet pile lengths are permitted to deviate by + 5 in. and - 0 in. (± 200 mm) from the ordered lengths. |
| Cut | Cut at right angles to the longitudinal axis. The total deviation between the highest and lowest points in the cutting plane, measured on a single pile along the longitudinal axis, must not exceed 2% of pile width. |
| Weight | The tolerance between the arithmetic weight (according to section tables) and weighed weight of the total consignment must be within ± 2.5% (± 5%). |
| Section interlocks | The interlocks shall have adequate free play so that the piles can be fitted into each other and they must engage in such a manner that the in-service forces can be transmitted. The minimum interlock overlap on U and Z piles must not be less than 4 mm and on straight-web sections not less than 7 mm. |

*) Normally the positive tolerance shall be at the discretion of the manufacturer. At the time of the enquiry and order, a limitation on the positive tolerance can be agreed. In this case, the following values should be chosen: + 0,5 mm for s < 8,5 mm and + 6 % for > 8,5 mm.

Available Types

| U-profile | Single | Double S-shape standard | Double Z-shape (on request) | Triple piles standard |
|-----------|--------|-------------------------|-----------------------------|-----------------------|
| | | | | |

| Z-profile | Position A Single | Position B Single | Shape 1 standard | Shape 2 (on request) |
|-----------|---------------------|---------------------|------------------|----------------------|
| | | | | |

Sheet piling steel grades for cold-formed sheet piles conforming to EN 10 249-1

| American | | | | | | European | | | | |
|--------------------|----------------|-----|--------------------|----------------|-----|------------------|----------------|-----|------------------|--------------------|
| ASTM | Yield Strength | | ASTM | Yield Strength | | EN 10249 | Yield Strength | | Tensile strength | Minimum elongation |
| | ksi | MPa | | ksi | MPa | | ksi | MPa | MPa | % |
| A572 Gr. 50 | 50 | 345 | A588 | 50 | 345 | S 235 JRC | 34 | 235 | 360 | 26 |
| A572 Gr. 55 | 55 | 380 | A690 Gr. 50 | 50 | 345 | S 275 JRC | 40 | 275 | 410 | 23 |
| A572 Gr. 60 | 60 | 415 | A490 Gr. 60 | 60 | 415 | S 355 J0C | 51 | 355 | 470 | 22 |
| A572 Gr. 65 | 65 | 450 | | | | | | | | |

Mechanical proportions according to EN 10025 - 2:2004. Other steel grades on request.

Deviation limits and dimensional tolerances for cold-formed sheet piles made of unalloyed steels conforming to EN 10 249-2

| | |
|--------------------------------------|---|
| Pile width | Single piles ± 2 %; double piles ± 3 % |
| Wall thicknesses | The tickness is indicated in table 3 of the EN 10 051. |
| Height | h: up to 200 mm = ± 4 mm; over 200 up to 300 mm = ± 6 mm; over 300 up to 400 mm ± 8 mm; over 400 mm = ± 10 mm. |
| Deviation from straightness S | The longitudinal deviation from straightness S, must not exceed 0,25 % of the pile length. |
| Deviation from straightness C | The longitudinal deviation from straightness C, must not exceed 0,25 % of the pile length. |
| Torsion V | The Size V must not exceed ± 0,2 % of the pile length, with a maximum of 100 mm. |
| Pile length | Sheet pile lengths are permitted to deviate by + 5 in. and - 0 in. (± 50 mm) from the ordered lengths. |
| Cut | Cut at right angles to the longitudinal axis. The total deviation between the highest and lowest points in the cutting plane, measured on a single pile along the longitudinal axis, must not exceed 2 % of the pile width. |
| Weight | The tolerance between the arithmetic weight (according to section tables) and weighed weight of the total consignment must be within ± 2.5% (± 7 %). |

Available Types

| IBO | Shape 1 standard | Shape 2 (on request) | MKU | Shape 1 standard | Shape 2 (on request) |
|-----|---------------------|----------------------|------------------|----------------------|----------------------|
| | | | | | |
| VKZ | Position A Single | Position B Single | Shape 1 standard | Shape 2 (on request) | |
| | | | | | |

**NEW AND
USED MATERIALS
FOR SALE OR RENT
AND BUY BACK
OPTIONS**



www.meeverbracing.com
+31(0)18335 83 90
Modular Bracing Systems
Easier & Faster Installation Methods
Cost Effective Support Options
Sustainable & Reusable Products

EXHIBIT A-Pricing Page

District Two-HP Steel Piling 02230134

| Item Number | Quantity | Unit of Measure | Description | Unit Cost | Total |
|--------------------|-----------------|------------------------|--|------------------|-----------------------|
| 1 | 636,000 | LBS | 12" HP Steel Piling Beams, 40' (12"x53#x40') | \$0.80 | \$508,800.00 |
| 2 | 371,000 | LBS | 12" HP Steel Piling Beams, 35' (12"x53#x35') | \$0.79 | \$293,090.00 |
| 3 | 318,000 | LBS | 12"HP Steel Piling Beams, 30' (12"x53#x30') | \$0.80 | \$254,400.00 |
| 4 | 14400 | LBS | 8Wx40' Wide Flange Beams (8Wx18#x40') | \$0.85 | \$12,240.00 |
| Grand Total | | | | | \$1,068,530.00 |