

Ascent Consulting and Engineering, LLC
2361 Davisson Run Rd Suite 103
Clarksburg, WV 26301
304-933-3463
www.ascentconsultingengineers.com



December 2, 2019

Department of Administration
Purchasing Division
2019 Washington Street East
Post Office Box 50130
Charleston, WV 25305-0130

Attn: Brittany E. Ingraham

Re: Isaac's Creek (CR16*1)DS- EPAM16035

RECEIVED

2019 DEC -3 AM 11:10

WV PURCHASING
DIVISION

Ascent Consulting & Engineering (ACE) is pleased to submit this Statement of Qualifications for Engineering Services regarding The Camden (Wilson) Landslide Project. ACE is a "home town" firm comprised of "home town" individuals that simply strive to complete good work and help to improve our beloved state. Our firm was started out of desire to get back to our roots.

A son of a coal miner, I was told at a young age that I was not allowed to follow in my father's footsteps. However, I took an interest in construction, machinery, energy, and infrastructure. After completing a degree in civil engineering, I was fortunate enough to work for a growing company that allowed me to experience a variety of civil engineering projects. I worked my way up from a staff engineer to a major division lead, focusing on development projects, earthwork, stormwater/drainage, transportation, and Abandoned Mine Lands projects, among others. Through that career growth, I began to spend less and less time dealing with aspects of the designs, working with clients, and teaching the younger generation of engineers. The desire to do those things led me to start a new engineering firm, Ascent Consulting and Engineering....

We are now completing our second year in business and have been extremely lucky to have worked on a large variety of projects. The components of the designs we complete every day are very similar with those that are required for projects such as this and our staff has worked on numerous AML projects in their past. However, as a new company, we have not yet had the honor of working with your office on an Abandoned Mines related project. I would greatly appreciate the opportunity to do so and I believe very strongly that we will do an excellent job.

At ACE, we use a common sense approach to complete projects and provide a level of service and accessibility that is unmatched. Too often, engineering and consulting services are treated as tasks with little thought as to how the process affects the client or the public. At Ascent, we strive to appreciate and plan for all facets of the project such as operation during construction in addition to the final product.

The ACE team understands that these projects will benefit The State of West Virginia and its residents. The Selection of ACE will be beneficial for multiple reasons:

- Your project is IMORTANT to us!
- Experience, quality of work, knowledge and personal touch
- Priority and communication

This is an exciting opportunity for ACE and we greatly appreciate the opportunity to be considered for this work. Sincerely,

Ascent Consulting & Engineering, LLC

Michael R. Nestor

Michael R. Nestor, PE
Managing Member

QUALIFICATIONS

Founded in January 2018, Ascent Consulting and Engineering is a young and growing firm located in Clarksburg, West Virginia. Ascent has a total of 25 employees with knowledge and experience in Abandoned Mine Lands, Utilities, Land Development, Stormwater Management, Drainage, Environmental Services, Inspection, Materials Testing, and more. We have built this team of professionals so we can provide a full range of services to our clients. This allows us to be “hands on” and quick to respond to our clients’ needs.

We are committed to providing quality services, building long lasting relationships, and supporting/encouraging our employees. We aren’t the typical engineering firm.

KEY PERSONNEL

ACE employs a broad range of professionals to meet the needs of our clients. The main Ascent personnel involved with this project include:

Michael R. Nestor, PE-Civil Engineer QA/QC

Mr. Nestor is a Civil Engineer registered professionally in WV and serves as the Managing Member of Ascent Consulting and Engineering, LLC. He has over 15 years of consulting experience focusing on land development projects and utilities in WV, MD, and PA. His expertise allows him to guide projects from concept to completion by understanding the goals/vision of the project, effectively communicating with the project team, and paying careful attention to the details. Mr. Nestor will be responsible for client communication as well as QA/QC on this project.

Eric Short, Senior Project Engineer

Eric Short is a site/civil Project Engineer. In his 16 years, he has worked on a variety of projects which include commercial, residential, and industrial development, as well as downtown streetscapes and oil and gas sites and Abandoned Mine Lands remediation projects. His tasks involve the design and development of Demolition, Erosion and Sediment Control, Site, Grading, and Utility Plans along with creating details for site specific elements. Mr. Short is also an experienced highway designer with a background in the preparation of roadway construction, right-of-way, sign, and pavement marking plans. Other responsibilities include traffic studies, storm water and water/sanitary sewer design, and cost estimation.

Jeff Knepper, CPG, LRS-Sr. Environmental Manager

Jeff is a former Environmental Resource Program Manager for the West Virginia Department of Environmental Protection (WVDEP). He worked for the Division of Water and Waste Management reviewing and approving groundwater protection and remediation plans. He worked closely with the WV Voluntary

Remediation Program (VRP) and has spent significant time negotiating as a regulator and consultant for remedial activities for the WVDEP and the EPA.

As an LRS Jeff understands the importance of organization and technical prowess while completing documentation and regulatory requirements of the VRP and EPA programs. Mr. Knepper is an experienced AST inspector with over 1,000 completed inspections in various states including: WV, PA, OH, KY, WI, MI, VA and NY.

LOCATION/PERSONNEL

Ascent Consulting and Engineering:

2361 Davisson Run Rd Suite 103

Clarksburg, WV 26301

7 Engineers

11 Field Services

4 Environmental Services

1 Mechanical Engineer

2 Administrative

**WEST VIRGINIA DEPARTMENT OF ENVIRONMENTAL PROTECTION
AML CONSULTANT QUALIFICATION QUESTIONNAIRE**

Attachment "A"

PROJECT NAME Isaac's Creek (CR16*1)DS- EPAM16035		DATE (DAY, MONTH, YEAR) December 2, 2019	FEIN 82-4069240				
1. FIRM NAME Ascent Consulting and Engineering, LLC		2. HOME OFFICE BUSINESS ADDRESS 2361 Davisson Run Rd Suite 103 Clarksburg, WV 26301	3. FORMER FIRM NAME N/A				
4. HOME OFFICE TELEPHONE (304) 933-3463	5. ESTABLISHED (YEAR) 2018	6. TYPE OWNERSHIP Individual Corporation <input checked="" type="checkbox"/> Partnership Joint-Venture	6a. WV REGISTERED DBE (Disadvantaged Business Enterprise) YES <input type="checkbox"/> NO <input checked="" type="checkbox"/>				
7. PRIMARY AML DESIGN OFFICE: ADDRESS/ TELEPHONE/ PERSON IN CHARGE/ NO. AML DESIGN PERSONNEL EACH OFFICE 2361 Davisson Run Rd Suite 103 Clarksburg, WV 26301/ (304)933-3463/ Michael Nestor, PE / 7							
8. NAMES OF PRINCIPAL OFFICERS OR MEMBERS OF FIRM Michael R. Nestor, PE (Managing Member) Zachary L. Assaro (Member)		8a. NAME, TITLE, & TELEPHONE NUMBER - OTHER PRINCIPALS					
9. PERSONNEL BY DISCIPLINE							
<table style="width:100%; border:none;"> <tr> <td style="width:25%; vertical-align: top;"> <u>2</u> ADMINISTRATIVE — ARCHITECTS — BIOLOGIST <u>1</u> CADD OPERATORS — CHEMICAL ENGINEERS <u>5</u> CIVIL ENGINEERS <u>11</u> CONSTRUCTION INSPECTORS — DESIGNERS — DRAFTSMEN </td> <td style="width:25%; vertical-align: top;"> — ECOLOGISTS — ECONOMISTS — ELECTRICAL ENGINEERS <u>4</u> ENVIRONMENTALISTS — ESTIMATORS — GEOLOGISTS — HISTORIANS — HYDROLOGISTS </td> <td style="width:25%; vertical-align: top;"> — LANDSCAPE ARCHITECTS <u>1</u> MECHANICAL ENGINEERS — MINING ENGINEERS — PHOTOGRAMMETRISTS — PLANNERS: URBAN/REGIONAL — SANITARY ENGINEERS — SOILS ENGINEERS — SPECIFICATION WRITERS </td> <td style="width:25%; vertical-align: top;"> — STRUCTURAL ENGINEERS — SURVEYORS — TRAFFIC ENGINEERS — OTHER <u>24</u> TOTAL PERSONNEL </td> </tr> </table>				<u>2</u> ADMINISTRATIVE — ARCHITECTS — BIOLOGIST <u>1</u> CADD OPERATORS — CHEMICAL ENGINEERS <u>5</u> CIVIL ENGINEERS <u>11</u> CONSTRUCTION INSPECTORS — DESIGNERS — DRAFTSMEN	— ECOLOGISTS — ECONOMISTS — ELECTRICAL ENGINEERS <u>4</u> ENVIRONMENTALISTS — ESTIMATORS — GEOLOGISTS — HISTORIANS — HYDROLOGISTS	— LANDSCAPE ARCHITECTS <u>1</u> MECHANICAL ENGINEERS — MINING ENGINEERS — PHOTOGRAMMETRISTS — PLANNERS: URBAN/REGIONAL — SANITARY ENGINEERS — SOILS ENGINEERS — SPECIFICATION WRITERS	— STRUCTURAL ENGINEERS — SURVEYORS — TRAFFIC ENGINEERS — OTHER <u>24</u> TOTAL PERSONNEL
<u>2</u> ADMINISTRATIVE — ARCHITECTS — BIOLOGIST <u>1</u> CADD OPERATORS — CHEMICAL ENGINEERS <u>5</u> CIVIL ENGINEERS <u>11</u> CONSTRUCTION INSPECTORS — DESIGNERS — DRAFTSMEN	— ECOLOGISTS — ECONOMISTS — ELECTRICAL ENGINEERS <u>4</u> ENVIRONMENTALISTS — ESTIMATORS — GEOLOGISTS — HISTORIANS — HYDROLOGISTS	— LANDSCAPE ARCHITECTS <u>1</u> MECHANICAL ENGINEERS — MINING ENGINEERS — PHOTOGRAMMETRISTS — PLANNERS: URBAN/REGIONAL — SANITARY ENGINEERS — SOILS ENGINEERS — SPECIFICATION WRITERS	— STRUCTURAL ENGINEERS — SURVEYORS — TRAFFIC ENGINEERS — OTHER <u>24</u> TOTAL PERSONNEL				
TOTAL NUMBER OF WV REGISTERED PROFESSIONAL ENGINEERS IN PRIMARY OFFICE: <u>1</u> *RPEs other than Civil and Mining must provide supporting documentation that qualifies them to supervise and perform this type of work.							
10. HAS THIS JOINT-VENTURE WORKED TOGETHER BEFORE? N/A € YES € NO							

11. OUTSIDE KEY CONSULTANTS/SUB-CONSULTANTS ANTICIPATED TO BE USED. Attach "AML Consultant Qualification Questionnaire".

NAME AND ADDRESS: American Geotech 601 Ohio Ave Charleston, WV	SPECIALTY: Geotech	WORKED WITH BEFORE <input checked="" type="checkbox"/> Yes No
NAME AND ADDRESS: Brandon Rumbaugh Solutions 319 Paintersville Road Hunker, PA 15639	SPECIALTY: Survey	WORKED WITH BEFORE <input checked="" type="checkbox"/> Yes No
NAME AND ADDRESS:	SPECIALTY:	WORKED WITH BEFORE ___ Yes No
NAME AND ADDRESS:	SPECIALTY:	WORKED WITH BEFORE ___ Yes No
NAME AND ADDRESS:	SPECIALTY:	WORKED WITH BEFORE ___ Yes No
NAME AND ADDRESS:	SPECIALTY:	WORKED WITH BEFORE ___ Yes No
NAME AND ADDRESS:	SPECIALTY:	WORKED WITH BEFORE ___ Yes No
NAME AND ADDRESS:	SPECIALTY:	WORKED WITH BEFORE ___ Yes No
NAME AND ADDRESS:	SPECIALTY:	WORKED WITH BEFORE ___ Yes No

12. A. Is your firm's personnel experienced in Abandoned Mine Lands Remediation/Mine Reclamation Engineering?

YES Description and Number of Projects: Performed design for various projects dealing with mine seepage and ground instability. Coordinated drilling/monitoring activities, designed wet mine seals, drainage conveyances, E&S measures, and slip repairs, etc. Approximately 5 or 6 projects completed. Specifically, Mr. Nestor was heavily involved in the Anglins Run and Roaring Creek projects as well as several others.

NO

B. Is your firm experienced in Soil Analysis?

YES Description and Number of Projects: Ascent staff is experienced with identifying hydric soils applicable to wetlands and subsequent permitting needs. Ascent is also experienced with reading boring logs and coordinating with Geotechnical Engineers in order to apply information to practical designs. Ascent personnel has provided such services on dozens of projects.

NO

C. Is your firm experienced in hydrology and hydraulics?

YES Description and Number of Projects: Ascent personnel performs pre and post watershed analyses on a variety of projects. We have completed drainage studies for municipalities, private development projects, and AML projects. We have also performed stream analyses for bridge replacement projects and development in flood prone areas. This type of work is performed in nearly every project Ascent works on and has been completed in hundreds of projects.

NO

D. Does your firm produce its own Aerial Photography and Develop Contour Mapping?

YES Description and Number of Projects:

NO Ascent works with subconsultants to identify the most cost-effective way of producing design worthy mapping. We have purchased mapping that was already developed, produced mapping with drone flights, and utilized Brandon Rumbaugh Solutions in order to develop survey mapping from "boots on the ground" survey.

E. Is your firm experienced in domestic waterline design? (Include any experience your firm has in evaluation of aquifer degradation as a result of mining.)

YES Description and Number of Projects: Ascent is experienced with the design and layout of potable water systems for commercial and residential development projects. We have completed dozens of mainline extensions and/or replacement projects, however we do not have experience in aquifer degradation.

NO

F. Is your firm experienced in Acid Mine Drainage
Evaluation and Abatement Design?

YES Description and Number of Projects: Ascent Personnel has developed several projects dealing with
evaluation of Acid Mine Drainage and design of conveyance/treatment systems. Approximately 5 or 6 projects completed

NO

13. PERSONAL HISTORY STATEMENT OF PRINCIPALS AND ASSOCIATES RESPONSIBLE FOR AML PROJECT DESIGN (Furnish complete data but keep to essentials)

NAME & TITLE (Last, First, Middle Int.)	YEARS OF EXPERIENCE		
	YEARS OF AML DESIGN EXPERIENCE:	YEARS OF AML RELATED DESIGN EXPERIENCE:	YEARS OF DOMESTIC WATERLINE DESIGN EXPERIENCE:
Nestor, Michael, R.	5/6	15	15

Brief Explanation of Responsibilities

Mr. Nestor has served in various roles for AML projects as well as numerous projects with related design activities. Mr. Nestor worked as a staff engineer, project engineer, project manager, and then led an entire site development division for a large regional design firm before starting Ascent Consulting and Engineering in January of 2018. He now serves as the Managing Member for the firm. He is very heavily involved in all aspects of the firm's work including design and review for projects. Mr. Nestor has and continues to work with drainage, stormwater, land development, public utility, transportation/access roads, landslides, etc.

EDUCATION (Degree, Year, Specialization)
Bachelor of Science in Engineering Technology, 2003

MEMBERSHIP IN PROFESSIONAL ORGANIZATIONS
American Society of Civil Engineers
American Society of Highway Engineers (Past President of NCWV Region)

REGISTRATION (Type, Year, State)
Professional Engineer, 2009, WV

13. PERSONAL HISTORY STATEMENT OF PRINCIPALS AND ASSOCIATES RESPONSIBLE FOR AML PROJECT DESIGN (Furnish complete data but keep to essentials)

NAME & TITLE (Last, First, Middle Int.)	YEARS OF EXPERIENCE		
	YEARS OF AML DESIGN EXPERIENCE:	YEARS OF AML RELATED DESIGN EXPERIENCE:	YEARS OF DOMESTIC WATERLINE DESIGN EXPERIENCE:
Assaro, Zachary, L.	1/2	7	7

Brief Explanation of Responsibilities

Mr. Assaro served as a staff engineer, project engineer, and then project manager within a large regional design firm prior to joining Ascent Consulting and Engineering as a co-owner/member. Mr. Assaro has performed design and management work for a variety of project types including but not limited to access roads, drainage and stormwater management, land development, public utilities, slip repairs, etc.

EDUCATION (Degree, Year, Specialization)
Bachelor of Science in Engineering Technology, 2012

MEMBERSHIP IN PROFESSIONAL ORGANIZATIONS

REGISTRATION (Type, Year, State)
N/A

13. PERSONAL HISTORY STATEMENT OF PRINCIPALS AND ASSOCIATES RESPONSIBLE FOR AML PROJECT DESIGN (Furnish complete data but keep to essentials)

NAME & TITLE (Last, First, Middle Int.) Short, Eric, M.	YEARS OF EXPERIENCE		
	YEARS OF AML DESIGN EXPERIENCE: 5/6	YEARS OF AML RELATED DESIGN EXPERIENCE:16	YEARS OF DOMESTIC WATERLINE DESIGN EXPERIENCE:16

Brief Explanation of Responsibilities
 Mr. Short has been involved in nearly every facet of civil engineering design. He serves as the engineering manager for Ascent Consulting and Engineering. Mr. Short's experiences covers large land development projects, slip repair, access road design, E&S plans, drainage/stormwater management, etc.

EDUCATION (Degree, Year, Specialization)
 Bachelor of science in Engineering Technology, 2003

MEMBERSHIP IN PROFESSIONAL ORGANIZATIONS American Society of Civil Engineers American Society of Highway Engineers	REGISTRATION (Type, Year, State) N/A
--	---

13. PERSONAL HISTORY STATEMENT OF PRINCIPALS AND ASSOCIATES RESPONSIBLE FOR AML PROJECT DESIGN (Furnish complete data but keep to essentials)

NAME & TITLE (Last, First, Middle Int.)	YEARS OF EXPERIENCE		
	YEARS OF AML DESIGN EXPERIENCE:	YEARS OF AML RELATED DESIGN EXPERIENCE:	YEARS OF DOMESTIC WATERLINE DESIGN EXPERIENCE:

Brief Explanation of Responsibilities

EDUCATION (Degree, Year, Specialization)

MEMBERSHIP IN PROFESSIONAL ORGANIZATIONS	REGISTRATION (Type, Year, State)
--	----------------------------------

14. PROVIDE A LIST OF SOFTWARE AND EQUIPMENT AVAILABLE IN THE PRIMARY OFFICE WHICH WILL BE USED TO COMPLETE AML DESIGN SERVICES

Auto CAD Civil 3D (2020), Microsoft Suite, Vehicle Tracking, Hydraflow Add on from Auto Desk, HEC-RAS, Google Earth, GPS Pathfinder Office, Terrain Navigator Pro, Adobe Acrobat DC, Sage (Financial Software)

15. CURRENT ACTIVITIES ON WHICH YOUR FIRM IS THE DESIGNATED ENGINEER OF RECORD

PROJECT NAME, TYPE AND LOCATION	NAME AND ADDRESS OF OWNER	NATURE OF YOUR FIRM'S RESPONSIBILITY	ESTIMATED CONSTRUCTION COST	PERCENT COMPLETE
Fort Martin Road Improvements, Road and Drainage, Monongalia County WV	Longview Power 1375 Fort Martin Rd. Maidsville, WV 26541	Intersection Improvement Design, construction administration, inspection	\$600,000	90%
Sole/Morris Compressor Station, 12 acre compressor pad for natural gas operations, Tyler County, WV	Antero Resources White Oaks Blvd. Bridgeport, WV	Compressor Station design, construction administration, survey, inspection	\$1,000,000	100%
TL 255 Natural Gas replacement, 5 mile replacement, Wood County WV	Dominion Energy Transmission Southern Regional Headquarters, Weston, WV	Transmission Line Replacement design, permitting, construction administration, survey, inspection	\$9,900,000	80%
ND Paper Slip, repair of slip along Monongahela River, Marion County	ND Paper 702 AFR Drive Fairmont, WV 26554	Geotechnical Investigation, H-Pile slip repair, construction inspection and administration	\$500,000	50%
Tyler County 4H Camp Bridge Replacement Tyler County, WV	Tyler County Commission Middlebourne, WV	Geotechnical Evaluation, stream analysis, bridge design, construction administration	\$2,000,000	25%
Camden Slip Repair	Mountain V Oil and Gas Bridgeport, WV	Geotechnical Evaluation, wall and slip repair design, road improvements	\$500,000	95%
Gnats Run Road Slip	Antero Resources White Oaks Blvd. Bridgeport, WV	Geotechnical Evaluation, slip repair design	\$250,000	75%

TOTAL NUMBER OF PROJECTS: 8

TOTAL ESTIMATED CONSTRUCTION COSTS: \$15,000,000

16. CURRENT ACTIVITIES ON WHICH YOUR FIRM IS SERVING AS A SUB-CONSULTANT TO OTHERS

PROJECT NAME, TYPE AND LOCATION	NATURE OF FIRMS RESPONSIBILITY	NAME AND ADDRESS OF OWNER	ESTIMATED COMPLETION DATE	ESTIMATED CONSTRUCTION COST	
				ENTIRE PROJECT	YOUR FIRMS RESPONSIBILITY
WVU Hospitals Rehab Center	Civil Engineering	WVU Hospitals Morgantown, WV	December 2020	Unknown	\$400,000
Concrete Testing And Inspections	Testing and Inspections	Antero Resources, Bear Contracting, City of Buckhannon, Wolfe's Excavating	Ongoing	Varies	Varies
Clay Battelle Health Center	Civil Site Design	Unknown	Spring 2020	Unknown	\$150,00
Paving Projects Numerous	Testing and Inspections	Wolfe Excavating Bear Contracting	Ongoing	Varies	Varies

17. COMPLETED WORK WITHIN LAST 5 YEARS ON WHICH YOUR FIRM WAS THE DESIGNATED ENGINEER OF RECORD

PROJECT NAME, TYPE AND LOCATION	NAME AND ADDRESS OF OWNER	ESTIMATED CONSTRUCTION COST	YEAR	CONSTRUCTED (YES OR NO)
Fort Martin Road Maintenance Monongalia County, WV	Longview Power 1375 Fort Martin Rd Maidsville, WV 26541	\$125,00	2018	YES
Lowndes Hill Slip Repair Harrison County, WV	City of Clarksburg 222 West Main Street Clarksburg, WV 26301	\$200,000	2018	YES
The Vale, Residential Housing, Bridgeport, WV	Trailhead Investments, LLC. 721 Brightridge Drive Bridgeport, WV 26330	\$1,900,000	2018- 2019	YES
Jenkins Subaru, Commercial Site Development, Bridgeport, WV	Jenkins Subaru 750 Lodgeville Rd. Bridgeport, WV 26330	\$160,000	2019	YES
Suds Run Pad Improvement	GAL Land II Bridgeport, WV 26330	\$100,000	2019	YES

18. COMPLETED WORK WITHIN LAST 5 YEARS ON WHICH YOUR FIRM HAS BEEN A SUB-CONSULTANT TO OTHER FIRMS (INDICATE PHASE OF WORK FOR WHICH YOUR FIRM WAS RESPONSIBLE)

PROJECT NAME, TYPE AND LOCATION	NAME AND ADDRESS OF OWNER	ESTIMATED CONSTRUCTION COST OF YOUR FIRM'S PORTION	YEAR	CONSTRUCTED (YES OR NO)	FIRM ASSOCIATED WITH

19. Use this space to provide any additional information or description of resources supporting your firm's qualifications to perform work for the West Virginia Abandoned Mine Lands Program.

20. The foregoing is a statement of facts.

Signature: Michael R. Nestor

Title: Managing Member

Date: _____

Printed Name: Michael R. Nestor

West Virginia Ethics Commission
Disclosure of Interested Parties to Contracts

(Required by W. Va. Code § 6D-1-2)

Name of Contracting Business Entity: Ascent Consulting and Engineering, LLC Address: 2361 Davisson Run Rd Suite 103
Clarksburg, WV 26301

Name of Authorized Agent: Michael R. Nestor Address: _____

Contract Number: DEP2000000003 Contract Description: Isaacs Creek (CR1601)

Governmental agency awarding contract: State of West Virginia

Check here if this is a Supplemental Disclosure

List the Names of Interested Parties to the contract which are known or reasonably anticipated by the contracting business entity for each category below (attach additional pages if necessary):

1. Subcontractors or other entities performing work or service under the Contract

Check here if none, otherwise list entity/individual names below.

2. Any person or entity who owns 25% or more of contracting entity (not applicable to publicly traded entities)

Check here if none, otherwise list entity/individual names below.

3. Any person or entity that facilitated, or negotiated the terms of, the applicable contract (excluding legal services related to the negotiation or drafting of the applicable contract)

Check here if none, otherwise list entity/individual names below.

Signature: Michael R. Nestor

Date Signed: 12/02/2019

Notary Verification

State of West Virginia, County of Harrison:

I, Chelsea L. Coppola, the authorized agent of the contracting business entity listed above, being duly sworn, acknowledge that the Disclosure herein is being made under oath and under the penalty of perjury.

Taken, sworn to and subscribed before me this 2nd day of October, 2019.

Chelsea L. Coppola
Notary Public's Signature

To be completed by State Agency:

Date Received by State Agency: _____
Date submitted to Ethics Commission: _____
Governmental agency submitting Disclosure: _____

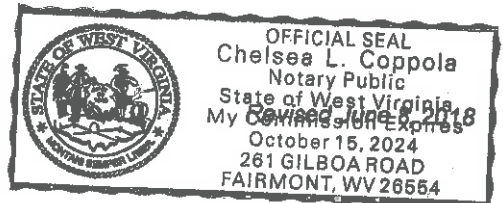

STATE OF WEST VIRGINIA
Purchasing Division

PURCHASING AFFIDAVIT

CONSTRUCTION CONTRACTS: Under W. Va. Code § 5-22-1(i), the contracting public entity shall not award a construction contract to any bidder that is known to be in default on any monetary obligation owed to the state or a political subdivision of the state, including, but not limited to, obligations related to payroll taxes, property taxes, sales and use taxes, fire service fees, or other fines or fees.

ALL CONTRACTS: Under W. Va. Code §5A-3-10a, no contract or renewal of any contract may be awarded by the state or any of its political subdivisions to any vendor or prospective vendor when the vendor or prospective vendor or a related party to the vendor or prospective vendor is a debtor and: (1) the debt owed is an amount greater than one thousand dollars in the aggregate; or (2) the debtor is in employer default.

EXCEPTION: The prohibition listed above does not apply where a vendor has contested any tax administered pursuant to chapter eleven of the W. Va. Code, workers' compensation premium, permit fee or environmental fee or assessment and the matter has not become final or where the vendor has entered into a payment plan or agreement and the vendor is not in default of any of the provisions of such plan or agreement.

DEFINITIONS:

"Debt" means any assessment, premium, penalty, fine, tax or other amount of money owed to the state or any of its political subdivisions because of a judgment, fine, permit violation, license assessment, defaulted workers' compensation premium, penalty or other assessment presently delinquent or due and required to be paid to the state or any of its political subdivisions, including any interest or additional penalties accrued thereon.

"Employer default" means having an outstanding balance or liability to the old fund or to the uninsured employers' fund or being in policy default, as defined in W. Va. Code § 23-2c-2, failure to maintain mandatory workers' compensation coverage, or failure to fully meet its obligations as a workers' compensation self-insured employer. An employer is not in employer default if it has entered into a repayment agreement with the Insurance Commissioner and remains in compliance with the obligations under the repayment agreement.

"Related party" means a party, whether an individual, corporation, partnership, association, limited liability company or any other form or business association or other entity whatsoever, related to any vendor by blood, marriage, ownership or contract through which the party has a relationship of ownership or other interest with the vendor so that the party will actually or by effect receive or control a portion of the benefit, profit or other consideration from performance of a vendor contract with the party receiving an amount that meets or exceeds five percent of the total contract amount.

AFFIRMATION: By signing this form, the vendor's authorized signer affirms and acknowledges under penalty of law for false swearing (W. Va. Code §61-5-3) that: (1) for construction contracts, the vendor is not in default on any monetary obligation owed to the state or a political subdivision of the state, and (2) for all other contracts, that neither vendor nor any related party owe a debt as defined above and that neither vendor nor any related party are in employer default as defined above, unless the debt or employer default is permitted under the exception above.

WITNESS THE FOLLOWING SIGNATURE:

Vendor's Name: Ascent Consulting and Engineering, LLC

Authorized Signature: *Michael D. Costa* Date: 12/02/2019

State of West Virginia

County of Harrison, to-wit:

Taken, subscribed, and sworn to before me this 2nd day of December, 2019.

My Commission expires October 15th 20, 2024

AFFIX SEAL HERE

NOTARY PUBLIC

Chelsea L. Coppola

Purchasing Affidavit (Revised 01/19/2018)

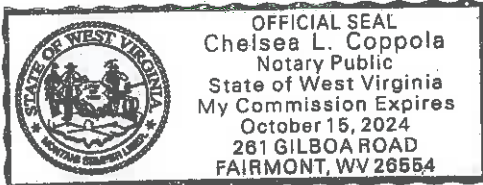

DESIGNATED CONTACT: Vendor appoints the individual identified in this Section as the Contract Administrator and the initial point of contact for matters relating to this Contract.

(Name, Title) Michael R. Nestor, Managing Member

(Printed Name and Title)
2361 Davisson Run Rd. Suite 103 Clarksburg, WV 26301

(Address)
(304) 933-3463

(Phone Number) / (Fax Number)
mike@ascentconsultingengineers.com

(email address)

CERTIFICATION AND SIGNATURE: By signing below, or submitting documentation through wvOASIS, I certify that I have reviewed this Solicitation in its entirety; that I understand the requirements, terms and conditions, and other information contained herein; that this bid, offer or proposal constitutes an offer to the State that cannot be unilaterally withdrawn; that the product or service proposed meets the mandatory requirements contained in the Solicitation for that product or service, unless otherwise stated herein; that the Vendor accepts the terms and conditions contained in the Solicitation, unless otherwise stated herein; that I am submitting this bid, offer or proposal for review and consideration; that I am authorized by the vendor to execute and submit this bid, offer, or proposal, or any documents related thereto on vendor's behalf; that I am authorized to bind the vendor in a contractual relationship; and that to the best of my knowledge, the vendor has properly registered with any State agency that may require registration.

Ascent Consulting and Engineering, LLC

(Company)

(Authorized Signature) (Representative Name, Title)

Michael R. Nestor, Managing Member

(Printed Name and Title of Authorized Representative)

11/25/2019

(Date)

(304)933-3463

(Phone Number) (Fax Number)

Client#: 1493628

ASCENCONS

ACORD™

CERTIFICATE OF LIABILITY INSURANCE

DATE (MM/DD/YYYY)
2/04/2019

THIS CERTIFICATE IS ISSUED AS A MATTER OF INFORMATION ONLY AND CONFERS NO RIGHTS UPON THE CERTIFICATE HOLDER. THIS CERTIFICATE DOES NOT AFFIRMATIVELY OR NEGATIVELY AMEND, EXTEND OR ALTER THE COVERAGE AFFORDED BY THE POLICIES BELOW. THIS CERTIFICATE OF INSURANCE DOES NOT CONSTITUTE A CONTRACT BETWEEN THE ISSUING INSURER(S), AUTHORIZED REPRESENTATIVE OR PRODUCER, AND THE CERTIFICATE HOLDER.

IMPORTANT: If the certificate holder is an ADDITIONAL INSURED, the policy(ies) must have ADDITIONAL INSURED provisions or be endorsed. If SUBROGATION IS WAIVED, subject to the terms and conditions of the policy, certain policies may require an endorsement. A statement on this certificate does not confer any rights to the certificate holder in lieu of such endorsement(s).

PRODUCER USI Insurance Svcs MVB CL 48 Donley Street, Suite 703 Morgantown, WV 26501 304 598-5678		CONTACT NAME: Denise A Deem	
		PHONE (A/C, No, Ext): 304-381-3426	FAX (A/C, No): 304-381-3430
		E-MAIL ADDRESS: denise.deem@usi.com	
		INSURER(S) AFFORDING COVERAGE	
		INSURER A: Cincinnati Insurance Company	NAIC # 10677
		INSURER B: BrickStreet Mutual Insurance Company	12372
		INSURER C: Remedy Insurance Company, Inc.	37540
		INSURER D:	
		INSURER E:	
		INSURER F:	

COVERAGES **CERTIFICATE NUMBER:** **REVISION NUMBER:**

THIS IS TO CERTIFY THAT THE POLICIES OF INSURANCE LISTED BELOW HAVE BEEN ISSUED TO THE INSURED NAMED ABOVE FOR THE POLICY PERIOD INDICATED. NOTWITHSTANDING ANY REQUIREMENT, TERM OR CONDITION OF ANY CONTRACT OR OTHER DOCUMENT WITH RESPECT TO WHICH THIS CERTIFICATE MAY BE ISSUED OR MAY PERTAIN, THE INSURANCE AFFORDED BY THE POLICIES DESCRIBED HEREIN IS SUBJECT TO ALL THE TERMS, EXCLUSIONS AND CONDITIONS OF SUCH POLICIES. LIMITS SHOWN MAY HAVE BEEN REDUCED BY PAID CLAIMS.

INSR LTR	TYPE OF INSURANCE	ADDL SUBR INSR HVWD	POLICY NUMBER	POLICY EFF (MM/DD/YYYY)	POLICY EXP (MM/DD/YYYY)	LIMITS
A	<input checked="" type="checkbox"/> COMMERCIAL GENERAL LIABILITY <input type="checkbox"/> CLAIMS-MADE <input checked="" type="checkbox"/> OCCUR GEN'L AGGREGATE LIMIT APPLIES PER: <input type="checkbox"/> POLICY <input type="checkbox"/> PROJECT <input type="checkbox"/> LOC OTHER:		ECP0475263	02/06/2019	02/06/2020	EACH OCCURRENCE \$1,000,000 DAMAGE TO RENTED PREMISES (Ea occurrence) \$1,000,000 MED EXP (Any one person) \$10,000 PERSONAL & ADV INJURY \$1,000,000 GENERAL AGGREGATE \$2,000,000 PRODUCTS - COM/POP AGG \$2,000,000 \$
A	AUTOMOBILE LIABILITY <input type="checkbox"/> ANY AUTO OWNED AUTOS ONLY <input checked="" type="checkbox"/> SCHEDULED AUTOS <input checked="" type="checkbox"/> HIRED AUTOS ONLY <input checked="" type="checkbox"/> NON-OWNED AUTOS ONLY		ECP0475263	02/06/2019	02/06/2020	COMBINED SINGLE LIMIT (Ea accident) \$1,000,000 BODILY INJURY (Per person) \$ BODILY INJURY (Per accident) \$ PROPERTY DAMAGE (Per accident) \$ \$
A	<input checked="" type="checkbox"/> UMBRELLA LIAB <input checked="" type="checkbox"/> OCCUR <input type="checkbox"/> EXCESS LIAB <input type="checkbox"/> CLAIMS-MADE DED RETENTION \$		ECP0475263	02/06/2019	02/06/2020	EACH OCCURRENCE \$10,000,000 AGGREGATE \$10,000,000 \$
B	WORKERS COMPENSATION AND EMPLOYERS' LIABILITY ANY PROPRIETOR/PARTNER/EXECUTIVE OFFICER/MEMBER EXCLUDED? <input type="checkbox"/> Y/N <input checked="" type="checkbox"/> N (Mandatory in NH) If yes, describe under DESCRIPTION OF OPERATIONS below	N/A	WCB1026291	03/08/2019	03/08/2020	<input checked="" type="checkbox"/> PER STATUTE <input type="checkbox"/> OTH-ER E.L. EACH ACCIDENT \$1,000,000 E.L. DISEASE - EA EMPLOYEE \$1,000,000 E.L. DISEASE - POLICY LIMIT \$1,000,000
C	Professional		V21C57190201	02/01/2019	02/01/2020	\$1,000,000 Occr/Aggr

DESCRIPTION OF OPERATIONS / LOCATIONS / VEHICLES (ACORD 101, Additional Remarks Schedule, may be attached if more space is required)

Verification of Coverage

CERTIFICATE HOLDER	CANCELLATION
SAMPLE	SHOULD ANY OF THE ABOVE DESCRIBED POLICIES BE CANCELLED BEFORE THE EXPIRATION DATE THEREOF, NOTICE WILL BE DELIVERED IN ACCORDANCE WITH THE POLICY PROVISIONS.
	AUTHORIZED REPRESENTATIVE

AML and RELATED PROJECT EXPERIENCE MATRIX

PROJECT	Exp. Basis C=Corp. P=Personnel	Additional Info Provided in Section (a) **	PROJECT EXPERIENCE REQUIREMENTS														PRIMARY STAFF PARTICIPATION/CAPACITY *** M=Management P=Professional						
			Abandoned Surface Mine Reclamation	Abandoned Deep Mine Reclamation	Portal/Shaft Closure	Hydrologic/Hydraulic Design/Eval.	Remining Evaluation	Mine/Refuse Fire Abatement	Subsidence Investigation Mitigation	Hazardous Waste Disposal	Project Specifications	Water Quality Evaluation/Nitigation/ Replacement	Construction Inspection/Managem ent	Water Treatment	Equipment/Structure Removal	Stream Restoration	Geotechnical/Stability	Michael Nestor	Eric Short	Jeff Knepper	Zachary Assaro	Devon Shrewsbury	Keith Axton
Anglins Run - AML	P			X		X										X	P						
Roaring Creek - AML	P			X		X			X							X	P						
Lowndes Hill Slip Repair	C/P								X						X	M/P	P		P				
ND Paper Slip Repair	C/P														X	M	P						P
Sole/Morris Compressor	C/P														X		M/P		P	P	P		
Gnats Run Slip Repair	C/P														X		P		M	P	P		
Fort Martin Road	C/P														X	M	P						
Tyler County 4H Bridge	C/P														X	M/P	P				P	P	
Leon Street Slip Repair	C/P								X						X	M	P						
Vesuvius Clay Mine	C/P			X		X		X		X	X	X	X	X				P	M				
White Oaks Phase II	P														X	X	M/P		P				

* List whether project experience is corporate or personnel based or both.
 ** Use this area to provide specific sections or pages if needed for reference.
 *** List Primary Design personnel and their functional capacity for the projects listed.

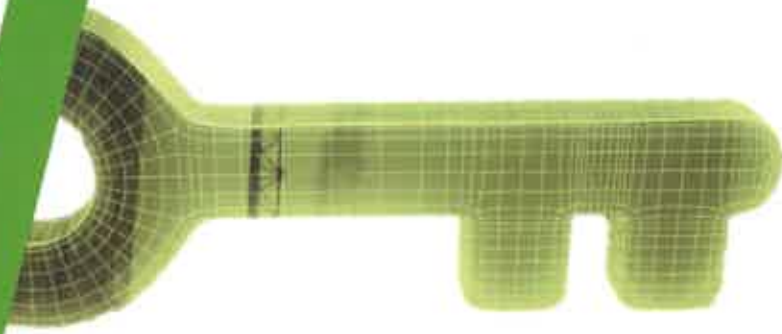

UNLOCKING ENGINEERING SOLUTIONS WITH **ASCENT CONSULTING & ENGINEERING**

Ascent Consulting and Engineering is a company of excellence and dedication providing the most incomparable and efficient services possible.

Founded in January 2018, Ascent Consulting and Engineering is a young company with big experience. Ascent employs a diverse staff, bringing expertise in nearly every facet of Civil Engineering. We are committed to providing quality services, building long lasting relationships, and supporting/encouraging our employees.

Ascents professional staff includes Project Managers, Project Engineers, Civil Designers, Construction Engineers, Environmental Specialists, Construction Managers, Project Inspectors, along with long lasting relationships with local GEO-Technical Engineers and Professional Surveyors

TELECOMMUNICATIONS



With experience in nearly every facet of the industry, Ascent Consulting & Engineering takes our expertise and experience, and our passion for precision to a level our customers appreciate. Our team can manage your telecommunications projects from start to finish.

TELECOMMUNICATION SERVICES

- | | |
|------------------------------|---------------------------------------|
| Site design | Typical Telecommunication Details |
| Site audit & inspection | Photo simulations |
| Site civil engineering | Aerial exhibits |
| Structural analysis & design | Alternative analysis & visual studies |
| Tower modification | FAA Certifications |
| Stealth site design | |
| Zoning | |



CONSTRUCTION SERVICES

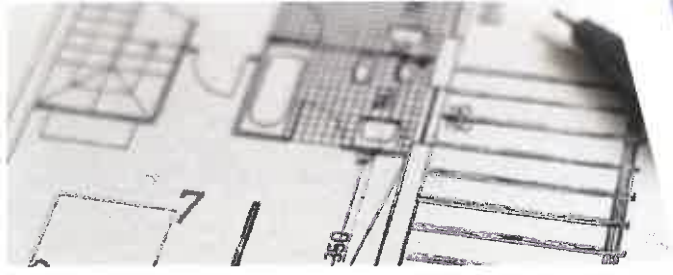

The Ascent team is dedicated to the successful completion of your project. Our staff values safety, quality, communication, and schedules.

CONSTRUCTION SERVICES

Roadway Construction Inspections

Pipeline Routing Inspection

Bridge Inspection

Transportation Management Plans

E&S Inspections and Corrective Actions

Turnkey Construction Projects

Construction Inspection

GIS Portal for Roadway
Monitoring and Asset Management

QA/QC Inspections

Right of Way and
Easement Plans and
Documentation

Utility Locations
and Coordination



MECHANICAL ENGINEERING



Ascent has a highly qualified Mechanical Engineering team who are able to create anything from a simple project to something as complex as designing a gas facility. Our mechanical engineers are able to review specifications and other data to develop mechanical layouts. We have the knowledge of mechanical parts as well as computer-aided design (CAD) software, such as AutoCAD.

MECHANICAL ENGINEERING SERVICES

Conduct research into the feasibility, design

Analyze piping systems

Develop maintenance standards, schedules, and programs and provide guidance to industrial maintenance crews

Investigating mechanical failures or unexpected maintenance problems

Selecting materials for product specifications in terms of durability, weight, cost, and safety

Piping

Boiler Services

Cryogenic Towers



SITE DEVELOPMENT



Ascent is a team of **experienced and licensed professionals** that can take any project from concept to completion.

Ascent offers advice in the planning process, helping clients determine the most cost effective route to a successful project. Our **site engineers** will be there every step of the way providing advice, solving technical issues, navigating permitting, and generally guiding your project.

SITE DEVELOPMENT SERVICES

Stormwater Management/Storm Drainage

Erosion and Sediment Control

Highway Design

Site Layout

Grading Plans

Utility Plans

Construction Management

Permitting

Residential Developments

Commercial Developments

Recreational Facilities

Water Supply & Distribution

Waste Water Collection



MATERIALS INSPECTION AND TESTING



Ascent Consulting and Engineering is a growing firm that will offer big solutions in Materials Testing and Field Inspection. Our lab technicians are highly experienced. We have a complete in-house laboratory. We are able to inspect and calibrate in accordance with the highest industry quality assurance standards.

MATERIALS INSPECTION AND TESTING SERVICES

Concrete Testing

Structural Steel

Soil Compaction and Classification

Asphalt Compaction

Field Services

American Association of State
Highway and Transportation Officials
(AASHTO)

AASHTO Materials Reference
Laboratory (AMRL) (AAP)

American Society of Civil Engineers

American Concrete Institute (ACI)



ENVIRONMENTAL



Ascent has over 12 years of experience in environmental capabilities and covers a wide range of services, including Phase I and Phase II Environmental Site Assessments, aquatic resource surveys/permitting, endangered species consultations, asbestos inspections, operating permit compliance, and general environmental consulting

ENVIRONMENTAL SERVICES

NPDES Permitting

Phase 1 & 2 Environmental Site Assessments

Stream/Wetland Delineations

Asbestos

USACE/Nationwide/
Individual Permit

WV DNR Right of Entry

County Flood Plan Coordination

M&A Due Diligence

Remediation & Feasibility
Studies/Alternatives

Hydrogeologic Investigations

Erosion & Sediment Control

Risk Assessments &
Characterizations

Monitoring Well Installations

Nature & Extent Studies

Corrective Action Plans

Hazardous & Solid Waste
Management

Brownfield Redevelopment

Asbestos Inspection and Sampling

ENVIRONMENTAL PERMITTING & COMPLIANCE

Consent Orders & Compliance
Schedules

Mining Discharge Permits

Underground Injection Control Wells

EHS Compliance

Water Sampling & Analysis Reports

NATURAL RESOURCE SERVICES

Stream/Wetland Delineations

Water Management Planning

County Flood Plan Coordination

Mitigation/Restoration

(FERC, NEPA, 404, 401, Individual)
Permitting

WV DNR Right of Entry



OIL AND GAS



Ascent provides you with knowledge that only comes from years of experience working in the industry. We have background in **compressor stations, well pads, impoundments, access roads, and permitting** for energy related projects.

Quick and Efficient Results: **Professionalism**
with a Sense of **Urgency**

OIL AND GAS SERVICES

- Grading
- Road Design
- Permitting
- Erosion & Sediment Control
- Stormwater Management
- Roadway Condition Inspections
- Pipeline Access Routing and Permitting
- Roadway Bonding
- Bridge Inspection, Analysis, and Design
- Transportation Management Plans
- Site Design and Permitting
- Environmental Assessments, Permits, and Mitigation
- E&S Inspections and Corrective Actions
- Turnkey Construction Projects
- Construction Inspection
- QA/QC Inspections
- GIS Portal for Roadway Monitoring and Asset Management
- Zoning and Municipal Permitting/ Approvals
- Agency, Municipal, and Public coordination/meetings
- Right of Way and Easement Plans and Documentation
- Utility Locations and Coordination
- Water Management Plans and Facilities

