



**DESIGNATED CONTACT:** Vendor appoints the individual identified in this Section as the Contract Administrator and the initial point of contact for matters relating to this Contract.

Todd Boggess, President  
 (Name, Title) Todd Boggess, President  
 (Printed Name and Title)  
PO Box 727, Princeton, WV 24740  
 (Address)  
(P) 304-425-4491 / (F) 304-425-2028  
 (Phone Number) / (Fax Number)  
etb@etbarchitects.com  
 (email address)

**CERTIFICATION AND SIGNATURE:** By signing below, or submitting documentation through wvOASIS, I certify that I have reviewed this Solicitation in its entirety; that I understand the requirements, terms and conditions, and other information contained herein; that this bid, offer or proposal constitutes an offer to the State that cannot be unilaterally withdrawn; that the product or service proposed meets the mandatory requirements contained in the Solicitation for that product or service, unless otherwise stated herein; that the Vendor accepts the terms and conditions contained in the Solicitation, unless otherwise stated herein; that I am submitting this bid, offer or proposal for review and consideration; that I am authorized by the vendor to execute and submit this bid, offer, or proposal, or any documents related thereto on vendor's behalf; that I am authorized to bind the vendor in a contractual relationship; and that to the best of my knowledge, the vendor has properly registered with any State agency that may require registration.

E.T. Boggess Architect, Inc.  
(Company)

Todd Boggess, President  
(Authorized Signature) (Representative Name, Title)

Todd Boggess, President  
(Printed Name and Title of Authorized Representative)

March 27, 2018  
(Date)

(P) 304-425-4491 / (F) 304-425-2028  
(Phone Number) (Fax Number)

West Virginia Ethics Commission  
**Disclosure of Interested Parties to Contracts**  
(Required by W. Va. Code § 6D-1-2)

Contracting Business Entity: E.T. Boggess Architect, Inc. Address: PO Box 727, 101 Rockledge Avenue  
Princeton, WV 24740

Authorized Agent: Todd Boggess Address: 101 Rockledge Ave., Princeton, WV

Contract Number: DNR1800000004 Contract Description: Facilities at Summersville Lake & Frozen Camp WMAs

Governmental agency awarding contract: WVDNR

Check here if this is a Supplemental Disclosure

List the Names of Interested Parties to the contract which are known or reasonably anticipated by the contracting business entity for each category below (attach additional pages if necessary):

1. **Subcontractors or other entities performing work or service under the Contract**

Check here if none, otherwise list entity/individual names below.

Harper Engineering (St. Albans) and EL Robinson (Charleston)

2. **Any person or entity who owns 25% or more of contracting entity (not applicable to publicly traded entities)**

Check here if none, otherwise list entity/individual names below.

Todd Boggess

3. **Any person or entity that facilitated, or negotiated the terms of, the applicable contract (excluding legal services related to the negotiation or drafting of the applicable contract)**

Check here if none, otherwise list entity/individual names below.

Signature: 

Date Signed: March 27, 2018

**Notary Verification**

State of West Virginia, County of Mercer

I, Todd Boggess (Todd Boggess), the authorized agent of the contracting business entity listed above, being duly sworn, acknowledge that the Disclosure herein is being made under oath and under the penalty of perjury.

Taken, sworn to and subscribed before me this 27th day of March, 2018

  
Notary Public's Signature

**To be completed by State Agency:**

Date Received by State Agency: \_\_\_\_\_

Date submitted to Ethics Commission: \_\_\_\_\_

Governmental agency submitting Disclosure: \_\_\_\_\_

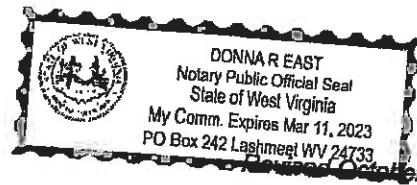

Received October 7, 2017

STATE OF WEST VIRGINIA  
Purchasing Division

**PURCHASING AFFIDAVIT**

**CONSTRUCTION CONTRACTS:** Under W. Va. Code § 5-22-1(i), the contracting public entity shall not award a construction contract to any bidder that is known to be in default on any monetary obligation owed to the state or a political subdivision of the state, including, but not limited to, obligations related to payroll taxes, property taxes, sales and use taxes, fire service fees, or other fines or fees.

**ALL CONTRACTS:** Under W. Va. Code §5A-3-10a, no contract or renewal of any contract may be awarded by the state or any of its political subdivisions to any vendor or prospective vendor when the vendor or prospective vendor or a related party to the vendor or prospective vendor is a debtor and: (1) the debt owed is an amount greater than one thousand dollars in the aggregate; or (2) the debtor is in employer default.

**EXCEPTION:** The prohibition listed above does not apply where a vendor has contested any tax administered pursuant to chapter eleven of the W. Va. Code, workers' compensation premium, permit fee or environmental fee or assessment and the matter has not become final or where the vendor has entered into a payment plan or agreement and the vendor is not in default of any of the provisions of such plan or agreement.

**DEFINITIONS:**

**"Debt"** means any assessment, premium, penalty, fine, tax or other amount of money owed to the state or any of its political subdivisions because of a judgment, fine, permit violation, license assessment, defaulted workers' compensation premium, penalty or other assessment presently delinquent or due and required to be paid to the state or any of its political subdivisions, including any interest or additional penalties accrued thereon.

**"Employer default"** means having an outstanding balance or liability to the old fund or to the uninsured employers' fund or being in policy default, as defined in W. Va. Code § 23-2c-2, failure to maintain mandatory workers' compensation coverage, or failure to fully meet its obligations as a workers' compensation self-insured employer. An employer is not in employer default if it has entered into a repayment agreement with the Insurance Commissioner and remains in compliance with the obligations under the repayment agreement.

**"Related party"** means a party, whether an individual, corporation, partnership, association, limited liability company or any other form or business association or other entity whatsoever, related to any vendor by blood, marriage, ownership or contract through which the party has a relationship of ownership or other interest with the vendor so that the party will actually or by effect receive or control a portion of the benefit, profit or other consideration from performance of a vendor contract with the party receiving an amount that meets or exceeds five percent of the total contract amount.

**AFFIRMATION:** By signing this form, the vendor's authorized signer affirms and acknowledges under penalty of law for false swearing (W. Va. Code §61-5-3) that: (1) for construction contracts, the vendor is not in default on any monetary obligation owed to the state or a political subdivision of the state, and (2) for all other contracts, that neither vendor nor any related party owe a debt as defined above and that neither vendor nor any related party are in employer default as defined above, unless the debt or employer default is permitted under the exception above.

**WITNESS THE FOLLOWING SIGNATURE:**

Vendor's Name: E. T. Boggess Architect, Inc.

Authorized Signature: *[Signature]*

Date: March 27, 2018

State of West Virginia

County of Mercer, to-wit:

Taken, subscribed, and sworn to before me this 27 day of March, 2018.

My Commission expires March 11, 2023.

AFFIX SEAL HERE

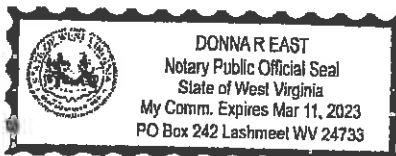

NOTARY PUBLIC

*[Signature]*

March 29, 2018

STATEMENT OF QUALIFICATIONS  
for Architectural / Engineering Services

Headquarters and  
Equipment Storage

Summersville Lake WMA  
& Frozen Camp WMA  
for the WVDNR  
DNR1800000004



E.T. BOGGESS ARCHITECT, INC.



■ Guy Nisbet  
Department of Administration, Purchasing Division  
2019 Washington Street East  
Charleston, WV 25305-0130

■ March 29, 2018

REF: DNR1800000004

Dear Mr. Nisbet:

In response to your qualifications request for the professional Architectural and Engineering Design services, the E.T. Boggess Architect, Inc. team is pleased to submit information regarding our experience. We will provide the services necessary to accomplish the new headquarters and equipment storage facilities for Summersville Lake WMA and Frozen Camp WMA. Our team will work with the State of West Virginia, WVDNR, and designated representatives from the wildlife management areas to ensure that everyone's vision for each of the projects is achieved.

ETB has designed government offices for smaller agencies (Hatfield-McCoy Regional Recreational Authority) to larger, military facilities (WV Army National Guard Readiness Center). We are currently working with several private entities to design ATV developments along the Hatfield-McCoy Trail as we all work to attract even more tourists to our state. Our design for an office building, maintenance building, and equipment shops have been repeated at several DOH district headquarters with modifications made to accommodate different sites. We are also working with the City of Princeton to renovate a former wood manufacturing facility to create a municipal complex. The city will relocate administrative offices, police department, fire department, public works, recreation department, and lots of equipment storage into a single location. Our diverse experiences, both past and present, will help ensure the successful completion of the new headquarters and equipment storage facilities.

ETB emphasizes a client-centered design approach. Through this focus, we can assure the State of West Virginia and the WVDNR that needs and project issues will be clearly identified and addressed through an engaged, interactive programming, design, and construction process. Our design process will be conducted with an attention to detail, creative problem solving and with a passion towards the project's success.

We value this opportunity to serve you and look forward to personally presenting our credentials.

Sincerely,

A handwritten signature in blue ink, appearing to read 'Todd Boggess', is written over a faint, larger version of the signature.

Todd Boggess, AIA, NCARB, Architect  
President

Cover Letter

Qualifications – 1

Approach & Methodology – 2

Firm Profiles – 3

Projects / Prior Experience – 4

Management & Staffing Capabilities – 5

References – 6

West Virginia Forms – 7

## INTRODUCTION

The E.T. Boggess Architect, Inc., team understands the challenges facing our state agencies as they strive to serve the needs of our citizens and continue to attract visitors to our state. The financial situation our state is enduring has affected all of us and requires us mountaineers to “get creative” in our approach. We must find ways to maximize our financial resources. We must also find the resources to create better working environments for our state employees. The new headquarters/office facilities at Summersville Lake and Frozen Camp can provide a more comfortable and productive facility, as well as promote a more positive image of both of the wildlife management areas. This will help attract more visitors to our state which, in turn, should help increase our financial resources.

ETB has a great deal of experience with government and recreational facilities of all sizes and scopes, including offices, visitor centers, maintenance and equipment shops. We have provided and continue to provide various state agencies, including the WVDOH, with a variety of design and construction administration services. Over the years, we have accomplished several projects for the WVDNR, including the following at Pipestem State Park:

- ✓ Conference Center Addition
- ✓ Kitchen Renovations
- ✓ Connecting Walkway/Bridgeway
- ✓ Picnic Shelters
- ✓ Clubhouse Deck
- ✓ Golf Course Toilets

We have worked on tourism and recreational public and private projects and were fortunate to design facilities for The Summit Bechtel Family National Scout Reserve. ETB has also worked with the Hatfield/McCoy Regional Trail Authority and private developers along the ATV trail on various projects that will help continue to attract users from across the country. We understand the impact tourism has on our state and the need to ensure visitors are able to experience and enjoy their favorite recreational activity, as well as provide new options for them to appreciate in The Mountain State.

Because in today's economic climate, every new project in every community is designed with full awareness of the economic challenges we face. Building Committees target improvements that a department or agency needs to operate safely and securely, at the best value for our state and their community. The design process helps ensure a cost effective solution. Space Planning is based on current and future needs consistent with operational and performance goals established by the user. Design layouts are models of efficiency. Materials and building systems are chosen for their cost effectiveness over the 50-100 year life of the building. These principles guide our new and renovation design services as we strive to help organizations, agencies and small governments ensure their citizens receive maximum benefit from their tax dollars.

One of the most recognizable projects that we have completed for a state agency is the West Virginia Tourist Information Center at the intersection of Interstate 77 and Route 460. We appreciate the work the state has given us and we look forward to helping the DNR address the goals and objectives of the two headquarters projects as well.

**Objective 1 – “Review existing plans and conditions as well as the operation of the park and evaluate while communicating effectively with the owner to determine a plan that can be implemented in a manner that will minimize disruption to concurrent operation of the facility and meet all objectives.”**



Our team will examine the proposed location for the new headquarters at each WMA to ensure it will meet the goals of the DNR. We will also examine the site/civil information that you may have already generated.

ETB will review any existing facilities that have been serving as the headquarters. We will then design offices, sleeping/living quarters, equipment storage and maintenance areas that will provide for the safety, comfort, and convenience of your on-site representatives. Since we are dealing with a large public area, there is little chance that the construction of the new headquarters will in any way disrupt the concurrent operations at either location.

We believe architectural design should be an *interactive process* and we will work closely with the DNR to keep the lines of communication open throughout the design and construction process. This interactive approach enables us to develop facilities that meet your requirements, as well as being aesthetically distinctive. Design cannot be mass produced or provided in a "cookie cutter" fashion, it must be developed from scratch with the unique attributes of each individual project in mind. Our approach is not only about our ideas . . . it is about *you and your ideas*. We **look** at any existing spaces, **listen** to what you need, and then provide a **design** to satisfy those needs.

**Objective 2 – “As a portion of this process outlined in Objective 1, provide all necessary services to design the facilities described in this EOI in a manner that is consistent with The Division of Natural Resources needs, objectives, current law, and the current code; while following the plan to design and execute the project within the project budget.”**

ETB has been developing architectural designs, plans, specifications, estimates and other construction/bidding documents for projects for over 50 years. Todd Boggess, President of ETB, serves on the WV Board of Architects and is active in verifying that all architects provide professional services within the state's laws and codes. He is, therefore, one of the first to be notified of any changes to any laws and codes that apply to the architectural profession. Todd will be **your architect** and point-of-contact in order to ensure the needs and objectives of the DNR are fully addressed to your satisfaction.

If we are selected for the projects, one of the first items will be to establish a realistic schedule and budget. After they have been established, we will re-examine, as necessary, throughout the design and construction documentation process. We will immediately notify the DNR of any problems we anticipate or issues that we become aware of that would adversely impact time, materials, or labor. One issue that will be examined is whether to bid each project separately or concurrently.

Our team of professionals will engage with the state and project stakeholders to collect data and correlate basis of design guidance to address facility functional and aesthetic criteria for the facility and develop detailed program requirements for each space. Team members include:

Structural and Civil/Site Engineering: **EL Robinson Engineering**

Mechanical, Electrical, Plumbing Engineering: **Harper Engineering**

**Objective 3 – “Provide Construction Contract Administration Services with competent professionals that ensures the project is constructed and functions as designed.”**

ETB provides professional A/E services, including construction contract administration, for all of our projects. Contract administration services are important in order to ensure construction conforms to the design intent of the construction documents; to lessen project risks; and to identify and resolve construction problems early in order to keep the project on schedule.

Chris Canterbury is our construction administration manager and has been involved with maintenance and equipment shops for multiple WV DOH projects. Chris provides efficient leadership in coordinating the team dynamics, budget, schedule, and the flow of information. He also assists the client with the management of services and consultants that may not be a part of this contract, but still may have an impact on workflow and infrastructure coordination.

**COMMUNICATION**

**Communication, collaboration, and consensus** are the three elements we feel are essential to the planning, design and building process. The architect is responsible for the finished product, but the design process must include guidance and review by the State of West Virginia and representatives from the Division of Natural Resources. Our goal is to develop a “partnership” with our clients – a relationship that includes a long-term commitment, trust, and shared vision.

Although there are more ways than ever to communicate these days, the art of listening continues to be a challenge. If your message is not being heard and understood, then communication has failed. Our cycle of communication is best depicted by the image below and this procedure is repeated throughout the design and construction process.

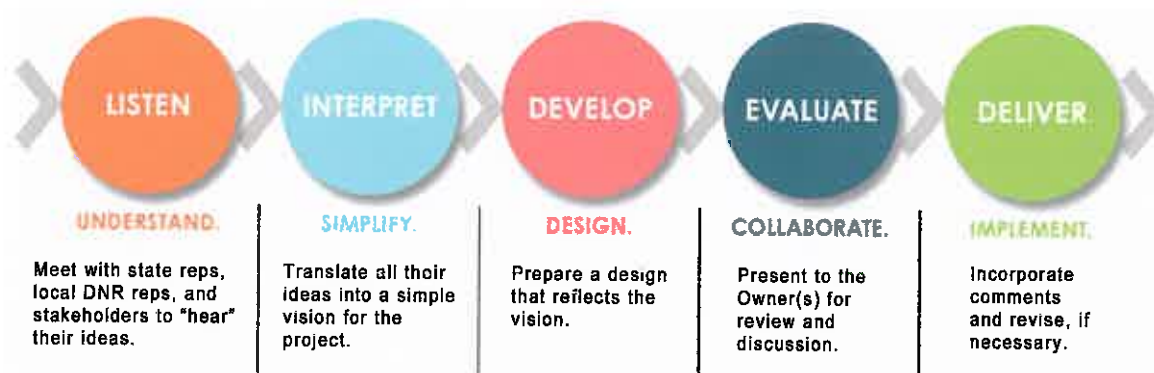

## PROJECT BUDGET and CONSTRUCTION

According to a study from KPMG, just 31% of all projects came within 10% of the budget in the past 3 years. This is a challenging situation that our entire country is facing, not just West Virginia. While it is the goal of the A/E design team to design a facility within the established budget by thoroughly investigating the cost of materials and labor and utilizing the costs of past projects, there are a number of items that are simply beyond our control. For example, a hurricane in the Gulf of Mexico can raise the cost of gasoline in West Virginia a great deal before it does any actual damage. That raises the cost of moving men and materials and can dramatically affect any project costs that are currently advertised for bids. Even though the project budget was examined within the past few months, the numbers may be skewed due to recent developments.

The first step in maintaining a project budget is to make sure the budget represents an achievable goal. This is where honest, open *communication* between the Owner and design team is important. Unfortunately, Owners are often told their budget is realistic in order for the project to proceed. We believe that the management of costs and/or risks begins with the development of fully vetted alternatives which enable you to make informed choices about the project. We search for simple and effective solutions. The evaluation of cost must extend beyond the costs of construction, and consider the costs of operations, human resources, energy and sustainability.



If the project we have designed for you bids over-budget, our preferred method to ensure the project moves forward is *value engineering*. We will work with the Owner and apparent low bidder to adjust and/or modify materials, quantities, and spaces, as necessary, in order for the facility to be constructed. We believe value engineering is a much more effective approach than re-design/re-bid. An excellent example of value engineering at its best was the New River Community & Technical College Headquarters (located near Beckley) which we designed for the C&TCS of WV. After the original bid exceeded the budget, value engineering enabled the project to proceed with construction and, ultimately, come in on-budget and on-schedule.

## CONSTRUCTION PERIOD

The first step in maintaining a project construction schedule is to, once again, make sure the schedule is realistic. Early in the process, *communication* between the Owner and Architect will establish both the anticipated time to accomplish the design as well as a realistic timeframe for construction to be completed. As always, there will be surprises along the way that may affect progress, but keeping open communication between all parties will led to a more successful project.

ETB currently has three projects under construction, WVDOH D7 Office Building, WVDOH D7 Equipment Shop, and Greenville Senior Living. All three are expected to be completed on-time. In the past five years, all but two of our projects were completed within a few weeks of the projected schedule.

There are options available to the Owner if you wish to incorporate liquidated damages into the contract for failure to meet a project deadline, and, if time is of the essence, a bonus could be included if construction is completed ahead of time. However, ETB believes it is in the best interest of the project to work together, especially during the construction phase, to ensure a project's successful completion. Maintaining a "team" approach is much more effective than an "us versus them" scenario.



Hatfield-McCoy Regional Recreational Authority Offices

## APPROACH

Our approach for the headquarters at Summersville and Frozen Camp will begin with an examination of the program and any preliminary site design documentation. Through careful and methodical planning, incorporating programmatic requirements established during the pre-design phase, the ETB team will develop conceptual design solutions for both of the new headquarters.

In order to successfully accomplish your objectives, we normally approach a project in the following manner:

- Establish/review goals and objectives
- List improvements to utilities, telecommunications, and infrastructure that may be necessary
- Identify best access, site circulation and parking – both pedestrian and automotive
- Identify any Code issues to ensure compliance
- Estimate the timing, phasing and projected costs

## METHOD for MEETING GOALS

**The Integrated Design Process** is our process of design in which the owners, users and the ETB team (architects and engineers) are all integral team members. This integrated process and the implementation of high performance design requires both efficiency and innovation. In our role with this team as the design leader and project organizer, ETB will be responsible for coordinating and orchestrating the work throughout the design, documentation, and administrative functions of the project.

ETB will emphasize the following throughout your project:

- **Understanding goals.** We review your established goals and provide input into areas as needed.
- **Brainstorming ideas.** We investigate opportunities for greater service through value engineering, strategic partnering, or an alternative delivery method.
- **Assuring timelines.** We generate a management plan to fulfill deliverables and meet milestones on schedule.
- **Maintaining client contact.** We are accessible, convenient, and committed to success from the beginning through the design process, and after completion.
- **Inviting performance feedback.** We welcome Owner input at closeout and review how well time, cost, and design goals were met.

## PHASES of WORK

The professional services outlined in this proposal will be accomplished in five sequential phases as outlined below.

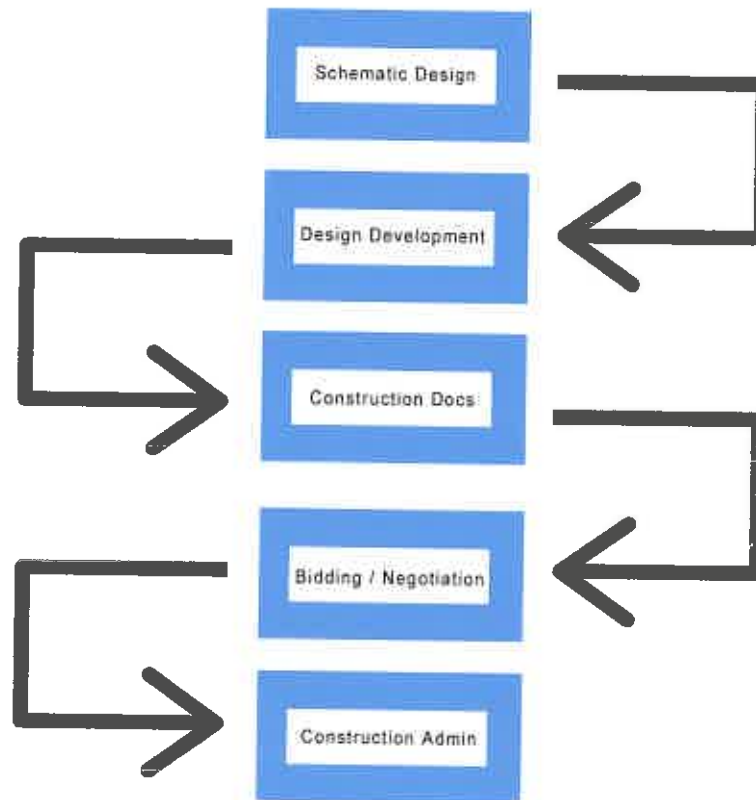

**Schematic Design Phase** - The schematic design documents will establish the general scope and conceptual design for your project, and the scale and relationships of the building components. The main goal of this phase is to arrive at a clearly defined, feasible concept and to present it in a form that will result in your understanding and acceptance.

**Design Development Phase** - Services in the design development phase are structured to achieve the refinement and coordination necessary for a polished work of architecture. During this phase, decisions made in schematic design are worked out at a more detailed level to minimize the possibility of major modifications being needed during the development of construction documents.

**Construction Document Phase** - Construction documentation is the bridge between building design and physical building form. A key element of documentation services, construction drawings provide the instructions for transforming the design solution into brick, mortar, landscapes, access, etc. The purpose of providing construction document drawings is to provide graphic documentation for bidding and execution of construction services.

**Bidding / Negotiation Phase** - Construction procurement activities assist the client in obtaining competent construction services. Our team will prepare bid packages or request for proposals/qualifications, and we will support the selection, negotiation, and contract award processes.

**Construction Phase / Contract Administration Services** - Contract administration services are important in order to ensure construction conforms to construction documents; to support the design intent; to lessen project risks; to identify and resolve construction problems early; and assist you in understanding the construction process. The architect, serving as a construction administrator, observes construction for conformity to construction drawings and specifications.

Once the doors open and you occupy the buildings, we will remain available to assist you with start-up questions, "fine tuning and balancing" of systems required to make sure the new headquarters work specifically for the WV DNR.

## QUALITY MEASURES

**Quality Assurance** - We feel quality assurance is the ability of an architect to provide the client with a set of documents that satisfies the client's needs and are as accurate as possible. ETB believes quality assurance is an ongoing process, not just a one-time occurrence. No project is perfect, however, we strive to achieve maximum client satisfaction. To that end, we have set the following goals for ourselves:

- Promote teamwork
- Quality management throughout entire project – *Website*
- Prompt response to client's requests – *Availability*
- Creation of quality construction documents – *Purpose Driven*
- Error prevention, not error catching – *Standard Practices*
- Personal pride in our work - *Motivation*
- Education and Training in-house (staff mentoring) – *Continuing Education*
- Go the extra mile whenever necessary – *Service Oriented*

**Quality Control** - Quality control starts with matching expectations about quality standards and life cycle costs with budget and scope during planning and design reviews. This continues through construction delivery with a program of inspections, tests, and certifications that are typically handled through a third-party agency. Quality control should flow seamlessly from one phase to another. The “partnership” we develop during the project assists us in maintaining a high level quality control standard with everyone working together in the project’s best interest. We strive to coordinate performance among the entire project team in order for a completed building program to fully satisfy your needs and expectations. The quality control plan we follow should help eliminate errors, reduce cost and improve overall building quality.

ETB normally follows the plan as outlined below:

- Keep the lines of communication open and consistent between all team members with regularly scheduled project meetings
- Share lessons learned from recent similar projects, include value engineering
- In-house reviews to address issues with constructability and budget restraints
- Utilize past experiences related to construction administration – Be Proactive
- Provide post construction administration services to be utilized on future projects - Every project or opportunity can be a learning experience for continued growth to better serve clients

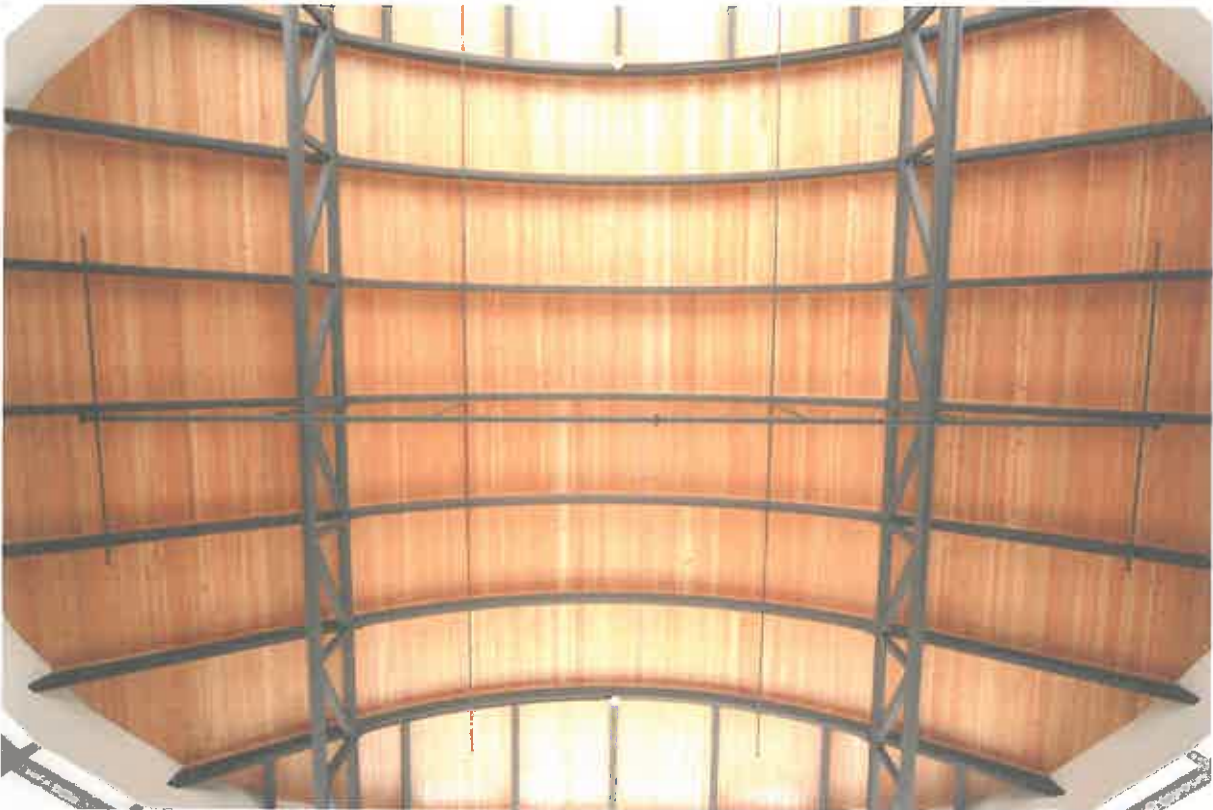

WVARNG Elkins Readiness Center – Entry Ceiling Detail



## HISTORY

E. T. Boggess Architect, Inc. was established in Princeton, West Virginia, by Ted Boggess in 1966. ETB has been a successful architectural firm primarily because of a team approach and partnership-type attitude with all involved in the design and construction process. Having grown up in the practice and with a life-long love of architecture, Todd became a full time presence with the firm in 1988 after receiving a Masters in Architecture from Clemson University. Their unique relationship as father/son/mentor/apprentice and, ultimately, partners has been both exciting and rewarding as the practice continues to flourish and evolve.



Experience

Integrity



Quality

Service



## REPUTATION

Our firm lives or dies by its reputation. We have cultivated a team that strives to deliver the highest level of project management, service, and design. Our approach is client and site specific, and questions conventional assumptions. The greatest testament to the success of ETB's work goes beyond the organizational, operation and business stewardship we provide; it is in our enduring client relationships.

The architects at ETB are well-respected for their high ethical standards, as well as professional and civic activities. They have been asked to serve as expert witnesses and arbitrators in legal disputes. They have also been selected to serve on various local, state and national committees. These committees cover areas from determining local zoning ordinances to reviewing and developing educational requirements for future architects, to preserving West Virginia's historic architecture. In 2014, Todd was appointed to the WV Board of Architects by Governor Tomblin. The Board of Architects protects the life, health, and property of the people of the State of West Virginia by ensuring that proper architecture practices are used in the state.

## SIZE

Bigger is not always better. ETB has purposely controlled size in order to maintain personal involvement and quality control. We feel that it is important to maintain close client contact so we can respond to your needs and questions, as well as address any situations that may arise in a timely manner. Our talented staff is ready to accommodate the needs of your project and ensure the successful completion of our current workload. The depth of our personnel is such that we can assign individuals to the appropriate task during each phase to ensure all your project's needs are satisfied.

## TEAMWORK

Our projects and design services are dependent on both our abilities as architects and our commitment to perform and implement a set of standards in order to create a design that responds to the needs of our client. In house, ETB actually functions as a team of consultants with individual strengths and abilities emphasized by each employee's role within the team. In addition to being a strong design oriented firm, we offer expertise in communication, construction documentation, construction administration, and quality control.

Throughout our state, we have developed relationships with government agencies, contractors and material suppliers which will be valuable as we address the challenges associated with this project. ETB has worked with many of the code officials, including the state fire marshal, and consider them an extension of our team, another member who is concerned about the final design. We review our designs with the Office of the State Fire Marshal in Charleston at regular intervals during the design process, as well as on-site inspections during construction.

## EXPERIENCE

Over the past 52 years, ETB has accomplished many different types of buildings in 12 different states and 1 foreign country. We have not limited ourselves by focusing on one particular type of project or a single location. Instead, we choose to maintain a diverse practice which allows us to begin each project with renewed enthusiasm. Our range of project types have helped us develop a broad knowledge base

ETB was one of the first architectural firms in the state to implement the use of computer-aided design and drafting into the everyday practice of architecture more than thirty-five years ago. Today we continue to implement current technology as we have become very efficient with photorealistic imagery through computer modeling and digital photography. The building 3-D model and associated imagery can be developed early in the design process for presentations. This helps everyone better understand design approaches and project contextual relationships within a setting.

Our firm has a great deal of experience creating graphic imagery as well as presenting the information to government agencies and the general public. Recent projects for the WV Higher Education and Policy Commission, the WV School Building Authority, as well as county school systems, have required us to generate imagery and create powerpoint presentations. This is just another step in the process of moving your projects forward and we are anxious to work with you to obtain the necessary approvals.

## SCHEDULES & BUDGETS

ETB understands the importance of ensuring that all schedules and budgets are met. Our strength is in the delivery of appropriate and analytical solutions for complex buildings in strict conformance with budget and time constraints. Some of our most recent projects, especially for state agencies, have presented us with very rigorous scheduling goals. Our projects for the West Virginia School Building Authority have penalties built in if schedules and established budgets are not adhered to as an added incentive to meet the deadlines.

Our team will do everything within our power to ensure the project stays within budget and on schedule. We will work with the general contractor to provide him with the information he needs as quickly as possible. As mentioned earlier, the key to addressing problems during construction will be **communication, collaboration, and consensus.**

## OVERVIEW



We come from humble beginnings and were founded and named after our president, Edward L. Robinson, P.E., P.S., in 1978. The company began as a small surveying firm with only four employees and has grown exponentially to what it is today – a highly diversified engineering and surveying firm with over 135 full time, experienced professionals and support personnel located in ten offices throughout West Virginia (Charleston, Beckley, Bridgeport, and Chapmanville), Kentucky, Ohio and North Carolina. Over the past four decades, E.L. Robinson has grown to be one of the most respected firms in the region, offering a diverse scope of services. E.L. Robinson provides a full range of quality engineering services, from planning and analysis to design and implementation.

We attribute much of our continued success to our commitment to complete customer service, unwavering quality, and innovative solutions. ELR prides itself on overcoming obstacles and adapting to changing times. The firm uses diligence and a dedicated work ethic to complete every project on time, on or under budget.

E.L. Robinson Engineering boasts of a highly skilled and professional staff. We know that in order to take care of our clients, we must also take care of our own employees. The firm maintains an unheard of employee retention rate. ELR pairs its past experience with the technology of the future to provide the most thorough and advanced engineering knowledge and skills.

The use of technology has allowed the firm to expand engineering capabilities and make use of new resources such as satellite imagery and digital mapping. In addition to the use of technology, E.L. Robinson also continues to strive to invent new and more effective ways to serve our clients. One of these ways is to provide a thorough pre-analysis of every project, saving the client time, money, and legal exposure. When the client is educated on every phase of the job and every challenge, the reputation of the firm grows stronger and attracts business from a larger marketplace.

### Our Services

- Utilities Engineering
- Land Planning
- Transportation Engineering
- Landscape Architecture
- Construction Management
- Site Development
- Geotechnical Engineering
- Oil and Natural Gas
- Surveying and Technology



## QUALIFICATIONS



E.L. Robinson has over 135 staff members including 69 degreed engineers, 48 of which are registered professional engineers; 20 construction inspectors and a support team of administrative and technical personnel. Our firm's office in Charleston will provide the identified scope of services. This team of professional engineers, funding specialists, surveyors and construction inspectors has been specifically assembled for this project because of their experience relating to your project and others like it.

ELR has an exceptional background and proven success in the fields required to complete this project including:

**Water System Planning, Funding and Design:** Our services include water service master plans, water treatment plant planning and design, pump station design, water tank design, waterline extension, water distribution modeling, water facilities security, leak investigations, permitting and capital investments funding.

**Wastewater Treatment and Collection:** Our services include wastewater treatment plant planning, sewage pump station design, sanitary sewer line extensions, collection systems capacity analysis, wastewater collection system modeling, combined sewer overflow planning, wastewater facilities security, infiltration and inflow investigations, permitting, and capital improvements funding.

**Structural and Facility Design:** Our areas of expertise include community and public facilities, business parks, recreational areas, residential neighborhoods, urban planning and streetscape design, planned unit and community development, park and recreation design, , and campus planning.

The following is a list of sample projects that showcase our depth and capabilities in professional engineering and design. A more detailed description of these sample projects can be found later in this statement of qualifications.

### Water:

- Greenbrier State Forest Water System Repairs
- North Bend State Park Campground Upgrades
- Forks of Coal State Natural Area/Claudia L. Workman Wildlife Education Center
- Beech Fork State Park Campground Utilities Upgrade
- Pipestem State Park Campground Utilities Upgrade
- Scott/Findley Road Waterline Extension
- Town of Rupert Backwash Water Disposal Facility
- WV 82 Anthony Creek Water Project
- Drews Creek Water Project

### Wastewater

- Watoga State Park Wastewater Treatment Plant Replacement Project
- Bergoo Wastewater Collection and Treatment System
- Frank Bartow Sewer Line Extension Project



# QUALIFICATIONS



- Blackwater Falls State Park Sewage Treatment Plant Replacement

## **Structural and Facility Design**

- Chief Logan State Park Recreational Facility
- Aldersgate United Methodist Church Recreation Facility
- Mingo County Memorial Building Handicap Accessibility
- Williamson Coal House
- Logan County Courthouse ADA Upgrades

## **Landscape Architecture & Land Planning**

- Ronceverte Comprehensive Plan
- Ronceverte Streetscape Enhancements
- Ronceverte Streetscape Phases 3 & 4
- Mt. Hope Streetscape Phase 3 & 4
- Bridgeport Pedestrian Walkway Feasibility Study
- Doddridge County Courthouse Campus Upgrade





## **Mechanical, Electrical, and Plumbing Engineering**

Harper Engineering, PLLC has the talent and resources to provide quality mechanical, electrical, and plumbing design. Our staff utilizes the latest building information modeling (BIM) software to provide the accurate system designs with minimal change orders during construction.

Our goal is to design optimized systems that meet all of our client's performance, energy use, and budgetary needs.

The staff at Harper Engineering, PLLC has over 100 years of experience working with clients in a variety of fields including, but not limited to, K-12 schools, hospitals, offices, airports, manufacturing, multi-family housing, and Design/Build.

The following is a partial listing of projects that demonstrate Harper Engineering's mechanical, electrical, and plumbing design experience:

- South Charleston Fire Station No. 1
- Chapmanville Intermediate School
- Franklin Elementary School - Design/Build Criteria Developer
- Additions to Holden Elementary School
- Williamson Coal House
- River Ridge Church- Hurricane
- Seneca Village Housing
- Beckley VA Parking Garage
- West Virginia Department of Highways
  - SRC Office Building Renovation
  - Weigh Stations
  - Highway Lighting
- Mason County Sheriff's Office Renovation
- Stonerise Nursing Homes (Multiple Projects)
- Boone County Courthouse Annex
- City of Charleston Fire Station No. 3
- A New Ronald McDonald House for Southern West Virginia
- North Central West Virginia Airport (Multiple Projects)
- Yeager Airport Security
- CAMC Hospitals (Multiple Projects)

# PIPESTEM STATE PARK CONFERENCE CENTER

Pipestem, WV



## PROJECT DETAILS

owner/district:  
WV DNR

year:  
1999

size:  
20,000 sf

The Pipestem Conference Center Project involved a two-story addition to the McKeever Lodge. The project centered around the addition of a multi-purpose conference area that can accommodate a single, large group or be divided with panels for multiple, smaller groups.

In order to allow for ADA compliant access, an enclosed, connecting bridge-way was designed to connect the new conference center to the existing lodge.

The existing kitchen area was also renovated during this project.



# PIPESTEM STATE PARK CONFERENCE CENTER

Pipestem, WV





# PIPESTEM STATE PARK CONFERENCE CENTER

Pipestem, WV



## PROJECT DETAILS

owner/district:  
WV DNR

year:  
1999

size:  
20,000 sf

The Pipestem Conference Center Project involved a two-story addition to the Mc-Keever Lodge. An enclosed bridgeway (interior & exterior shown here) was designed to provide ADA compliant access



# PIPESTEM STATE PARK PICNIC SHELTERS

Pipestem, WV



## PROJECT DETAILS

owner/district:  
WV DNR  
year:  
phased

ETB provided a picnic shelter design that appears to have been duplicated throughout Pipestem State Park.



# HATFIELD / MCCOY REGIONAL RECREATIONAL AUTHORITY

Lyburn, WV



## PROJECT DETAILS

owner/district:  
Hatfield/McCoy Regional Authority

year:  
2011

type:  
renovation

ETB designed the renovations to the former Western Sizzling Building to accommodate the main authority offices.

The renovations included a total interior re-design, new floor plan layouts, and material selections. The building spaces include offices, conference room, sales/display, restrooms and storage areas.



# HATFIELD / MCCOY TRAILHEAD FACILITY

Ashland, WV

## PROJECT DETAILS

owner/district:  
Hatfield/McCoy Regional Authority

year:  
2006

type:  
new construction

The trailhead facility designed by ETB provides a rest area for ATV rider along the trail. The trailhead includes:

- restrooms
- shelter
- water access
- power access
- equipment storage

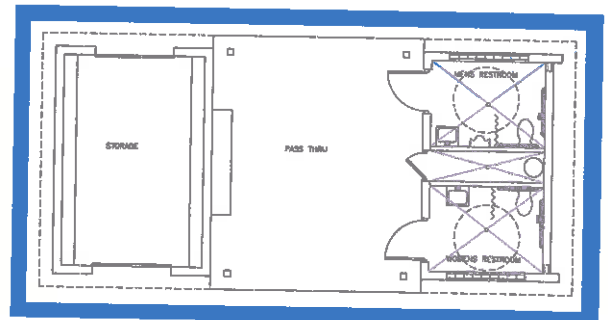

# BATHHOUSE DESIGN & CONSTRUCTION SUMMIT BECHTEL FAMILY NATIONAL SCOUT RESERVE

Mt. Hope, WV

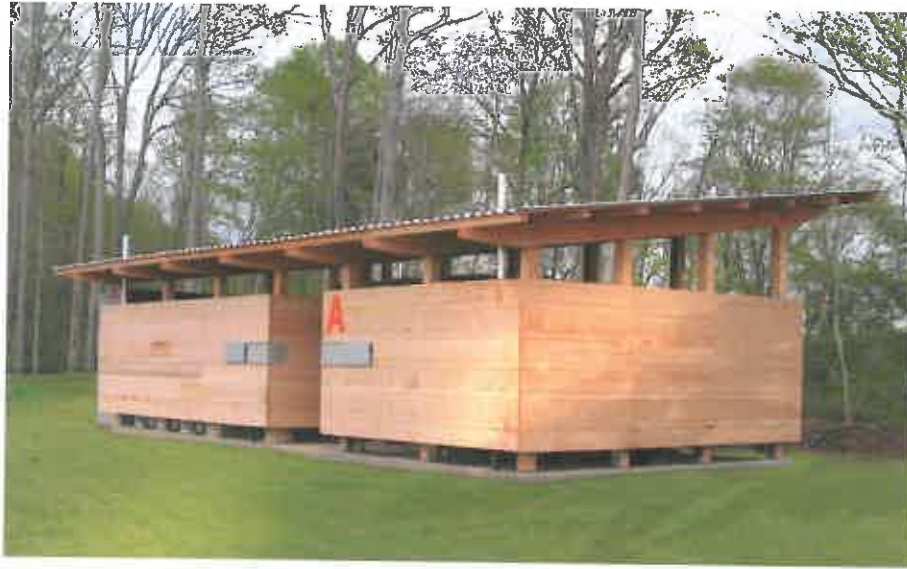

## PROJECT DETAILS

owner/district:  
Boy Scouts of America

year:  
2013

size:  
330 units

ETB provided design, graphic imagery construction documentation and administration for 330 bathhouses which were located throughout the national scout reserve. The bathhouses were spread throughout the six villages.

ETB worked in conjunction with Lake Flato Architects on this project.

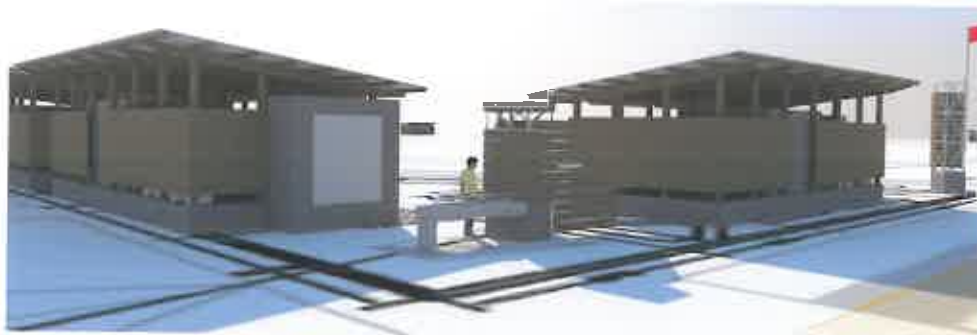

# OBSERVATION DECK SUMMIT BECHTEL FAMILY NATIONAL SCOUT RESERVE

Mt. Hope, WV

## PROJECT DETAILS

owner/district:  
Boy Scouts of America

year:  
2013

ETB designed a new ADA compliant observation deck overlooking the entire Boy Scout Reserve. The deck can accommodate over 100 sight-seers. In addition to providing a scenic view, the deck was used during construction to observe progress throughout the site.



VIEW FROM OBSERVATION DECK





# ASHLAND KOA CAMPGROUND

Ashland, WV



## PROJECT DETAILS

owner/district:  
Ashland KOA Campground

year:  
2005

type:  
new construction

ETB designed two different cabin layouts for the Ashland KOA Campground.

The cabins are equipped with a full-service kitchen, including a granite countertop, bathroom with shower, sitting area, loft and front porch.

Each cabin will sleep 6. The bedroom has bunk beds or a full-size bed. The main room has a queen-sized murphy bed.

Exterior features include picnic tables, a fire pit, and wonderful views from the front porch swing.





# ATV RESORT AND LODGE

West Virginia

## PROJECT DETAILS

owner/district:  
Private Developer

year:  
2019

size:  
40 acres w/ 36,000 sf Lodge

ETB provided master planning and architectural design for the resort that will cater to the ATV enthusiast. The Architectural design for the resort facilities features a timber and stone exterior with woodcraft details representative of the National Parks rustic style with an Appalachian Mountain craftsman theme.



LODGE ENTRANCE



STANDARD COTTAGE



DELUXE COTTAGE



LODGE - SOUTH FACADE

# ATV TRAILCAMP

Coaldale, WV

## PROJECT DETAILS

owner/district:  
Private Developer

year:  
2018

size:  
3.5 acres

ETB provided master planning and architectural design for the site, cottages and amenities that will cater to the ATV enthusiast. The preliminary concept imagery shown here has been used for grant and loan applications.



ONE BEDROOM UNIT

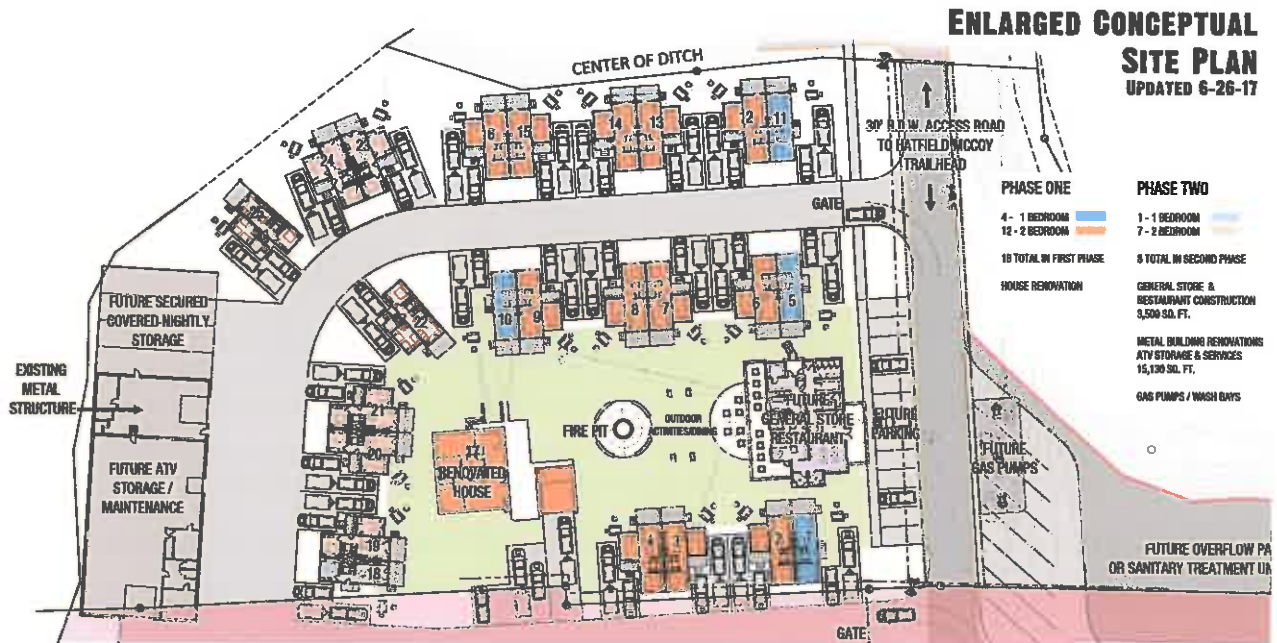

TWO BEDROOM UNIT

# WV DOH DISTRICT SEVEN OFFICE BUILDING & EQUIPMENT SHOP

Weston, WV



Office Building



Equipment Shop



## PROJECT DETAILS

owner/district:  
WV DOH

year:  
2018

size:  
Office Building - 29,915 sf  
Equipment Shop - 22,996 sf

The District Seven Office Building and Equipment Shop are both under construction. The office building is similar to the ones already located at Districts Six, Nine and Ten. The Equipment Shop, originally called the maintenance building, has also been built for Districts Ten and Six. Each building is modified as needed to better serve the needs of the district and in order to accommodate the specific site conditions.

ETB provided the original complex design for District Ten, which included an office building, maintenance building, bridge/sign shop, and a lab building. The new buildings are being phased-in throughout the state. At this time, the following projects have been completed:

District One  
Office Building

District Six  
Office, Maintenance, Bridge/Sign

District Eight  
Equipment Shop

District Nine  
Office Building

District Ten  
Entire Complex

# WV DOH DISTRICT EIGHT EQUIPMENT SHOP

Elkins, WV

## PROJECT DETAILS

owner/district:  
WV DOH

year:  
2015

size:  
21,675 sf



These photos were taken shortly before District Eight Equipment Shop was completed. This building, originally called the maintenance building, has also been built for District Ten and Six. Each building is modified to better serve the needs of the district and in order to accommodate the specific site conditions.

The equipment shop includes office space, maintenance/garage bays, storage areas, and roll-up doors.

ETB provided the original complex design for District Ten, which included an office building, maintenance building, bridge/sign shop, and a lab building. The new buildings are being phased-in throughout the state. At this time, the following projects have been completed:

District One  
Office Building

District Six  
Office, Maintenance, Bridge/Sign

District Nine  
Office Building

District Ten  
Entire Complex

District Seven  
Office Building  
Equipment Shop  
(under construction)



# WV ARMY NATIONAL GUARD READINESS CENTER

Elkins, WV



COMPUTER VISUALIZATION

## PROJECT DETAILS

owner/district:  
WV Army National Guard

year:  
2012

size:  
50,000 sf

The Readiness Center has two main entrances; the front into the lobby and the rear into the assembly hall. The circular central core of the entrance leads to the administrative wing (east) and classroom wing (west). The facility contains a learning center library, storage areas, locker rooms, kitchen, break-room, and Telcon spaces. Areas within the lobby will be used for recruiting, family support and distance learning.

The project also included the design and construction of a separate structure for secure storage maintenance/ workshop/ office structure.

# WV ARMY NATIONAL GUARD MAINTENANCE SHOP

Elkins, WV



## PROJECT DETAILS

owner/district:  
WV Army National Guard

year:  
2012

size:  
Maint & Workshop 3,102 sf  
Organized Storage 2,560 sf

Along with the Readiness Center, ETB designed a separate structure to serve as a maintenance building/workshop. A secure, organized storage area was also designed in conjunction with the new maintenance building / workshop.



MAINTENANCE BUILDING

# WV TOURIST INFORMATION CENTER

Princeton, WV



## PROJECT DETAILS

owner/district:  
WV Parkways Authority

year:  
1992

size:  
7,200 sf

The West Virginia Tourist Information Center is "composed" of three pyramid-shaped skylites (41' x 41', 33' x 33' and 29' x 29') that enclose a large main exhibit hall with the information desk, multi-use small exhibit hall with a mezzanine level, and restroom facilities. The seemingly "high-tech" design is complimented by incorporating a dry, stacked stone wall and split-rail fence into the landscape and by utilizing an exposed wood framing system.

West Virginia products were used throughout the project, including hardwood flooring, "Terne" roofing and native field stone. Local artisans also have their creations on display. Over 100,000 people per year visit the facility which is located ten miles from the border at the intersection of I-77/460.

1994 WVAIA Merit Award Winner



## Project Information

E.T. Boggess Architect, Inc.

Project	Type	Goals	Size	Cost	Comp.
---------	------	-------	------	------	-------

### Bathhouses for the Summit Bechtel Family National Scout Reserve

Location: Mt. Hope, WV	<b>New</b>	<i>Provide rustic design and construction admin for almost 50,000 scouts at the new home for the National Scout Jamboree.</i>	330 units	\$14 mil	2013
Project Manager for the Boy Scouts: Rob Ridgeway - 304-465-2800		<i>Completion on-schedule a MUST.</i> <i>Additional projects included observation deck.</i>			
<i>Goals were met by as a result of diligent research, planning/programming and coordination between team members and the Owner's rep.</i>					

### Bathhouse for the Ashland KOA Campground

Location: Ashland, WV	<b>New</b>	<i>Provide bathhouse design for KOA campground.</i>		Private	2014
Project Manager / Contact Tara Elder - 304-237-7567		<i>Design includes shower, restrooms and laundry facilities.</i> <i>Cabins were previously designed for Ashland KOA as a separate project.</i>		Information	
<i>Goals were met as a result of diligent research, planning/programming and coordination between team members and the Owner's rep.</i>					

### WVARNG Readiness Center

Location: Elkins	<b>New</b>	<i>Provide offices, classrooms, kitchens, showers for local armed forces to train &amp; prepare.</i>	56,000 sf	\$15.5 mil	2012
Project Manager for the WVARNG: Dan Clevenger - 304-380-7524		<i>Serve as base of operations in emergency.</i> <i>Additional projects have been completed including Maintenance Building at Elkins and exterior renovations to the headquarters at Coonskin.</i>			
<i>Goals were met by as a result of diligent research, planning/programming and coordination between team members and the Owner's rep.</i>					



## Greenbrier State Forest Water System Repairs

**Project Location:** Greenbrier County, West Virginia

**Client:** WVDNR

**Project Description:** The existing water system consists of multiple wells and block reservoirs that supply water to the park facilities via old service lines. ELR was contracted to evaluate the existing system and develop a more traditional pump-pressure system to serve the forest more efficiently. In addition, ELR evaluated the option of extending existing public water to the facility. That solution would eliminate the on-site treatment currently being performed by staff employees.

**Cost:** Planning Phase

## North Bend State Park Campground Upgrades

**Project Location:** Ritchie County, West Virginia

**Client:** WVDNR

**Project Description:** ELR prepared construction documents for mitigating the standing water present in many of the 26 sites due to years of added road pavement and lack of adequate cross slope and drainage swales throughout the campground. Also, provided an upgrade of the existing electrical service to the campsites by increasing the sites from 30 amp to 50 amp service which requires extending 3 phase service 1600' to the campground.

Additionally the park staff wanted to establish individual water hook ups at all 26 campsites. Only five (5) centralized faucets existed throughout the campground. To facilitate this, an aging 2" waterline to the campground required replacement with 1600 feet of new 4" waterline. Lastly staff expressed an interest in evaluating the cost of a prefabricated concrete restroom facility for the additional 22 campsites that have no facilities lessening the burden on the existing restroom /bathhouse in the original 26 site campsites.

**Cost:** \$250,000

## Forks of Coal State Natural Area/Claudia L. Workman Wildlife Education Center

**Project Location:** Kanawha County, West Virginia

**Client:** WVDNR

**Project Description:** This project involves the preparation of a master plan for a 100 plus acre site donated to the State of West Virginia for the development of the state's first natural area. The site is located at the forks of the Big Coal and Little Coal River, approximately twenty miles from downtown Charleston.

ELR's portion of the design include an access road off US 119 and car and bus parking area for the Claudia L. Workman Wildlife Education Center, site development for the Education Center including entry courtyard and outdoor classroom/amphitheater, an entry sign, trailhead parking, waterline extension from the Lincoln County PSD, an on-site sewage treatment facility for the education center and landscape plans for the center.

**Cost:** \$7,000,000

## Beech Fork State Park Campground Utilities Upgrade

**Project Location:** Wayne/Cabell County, West Virginia

**Client:** WVDNR

**Project Description:** ELR completed the preliminary design for electrical, water and sewer service for campsites 100-136. Our role included an extension of the electrical service by providing all of the sites with at least 50 amp service, individual water and sewer hook ups at all the referenced campsites by extending new pipes within each campground and/or utilizing existing infrastructure already in place, determining capacity of the existing sewage collection and treatment system to handle the increased flows, reviewing of the water distribution and pressures of the existing systems to determine capacity of the existing water infrastructure and assisted with successful LWCF grant application for construction.

**Cost:** \$595,000

## Pipestem State Park Campground Utilities Upgrade

**Project Location:** Summers County, West Virginia

**Client:** WVDNR

**Project Description:** ELR completed the preliminary design for electrical, water and sewer service for campsites 50-81. Our role included an extension of the electrical service by providing all of the sites with at least 50 amp service, individual water and sewer hook ups at all the referenced campsites by extending new pipes within each campground and/or utilizing existing infrastructure already in place, determining capacity of the existing sewage collection and treatment system to handle the increased flows, reviewing of the water distribution and pressures of the existing systems to determine capacity of the existing water infrastructure and assisted with successful LWCF grant application for construction.

**Cost:** \$692,000

## Scott Road-Findley Road Waterline Extension

**Project Location:** Randolph County, West Virginia

**Client:** Norton Harding Jimtown PSD

**Project Description:** This project consisted of the design and construction monitoring on a five mile waterline extension project in Randolph County. The six inch waterline extension provided service to areas determined to be affected by past coal mining activities.

**Cost:** \$1,300,000

## Town of Rupert Backwash Water Disposal Facility

**Project Location:** Greenbrier County, West Virginia

**Client:** Town of Rupert

**Project Description:** The Town of Rupert's backwash disposal facility was in very poor condition and in need of replacement. This project will provide the Town with a new backwash water disposal facility including dual decant basins and dual sludge drying beds.

**Cost:** \$825,000

## WV 82 Anthony Creek Water Project

**Project Location:** Nicholas County, West Virginia

**Client:** Birch River PSD

**Project Description:** This project involved the extension of the existing Birch River PSD Water System to the east along WV 82 and then south along Anthony Creek. The project included constructing approximately 32,000 lineal feet of eight-inch and smaller diameter water lines and the construction of a small constant pressure booster station to serve the last few homes on Anthony Creek.

**Cost:** \$1,800,000

## Drews Creek Water Project

**Project Location:** Raleigh County, West Virginia

**Client:** Raleigh County PSD

**Project Description:** This project consisted of the extension of its Arnett Water System to serve 140 new customers. The project involved constructing approximately 57,000 lineal feet of eight-inch and smaller diameter water lines, a booster station and a 105,000 gallon storage tank.

**Cost:** \$2,300,000

## Watoga State Park Wastewater Treatment Plant Replacement Project

**Project Location:** Pocahontas County, West Virginia

**Client:** WVDNR

**Project Description:** The project replaced an existing 10,000 gpd package treatment plant with a 3,750 gpd wastewater treatment plant provided by Orenco Systems, Inc. The new plant serves two cabins and River Run Campground which contains fifty RV sites, an office and restroom facility.

**Cost:** \$313,450

## Bergoo Wastewater Collection and Treatment System

**Project Location:** Webster County, West Virginia

**Client:** Webster Springs PSD

**Project Description:** This project includes providing sewage collection and treatment system for 51 residences in the community of Bergoo. The system will include 4,600 feet of gravity line, 4,300 linear feet of force main, five pump stations and a small treatment plant.

**Cost:** \$2,692,500

## Frank Bartow Sewer Line Extension Project

**Project Location:** Pocahontas County, West Virginia

**Client:** Pocahontas County PSD

**Project Description:** This project includes providing sewer line extension to approximately 104 residences in the communities of Frank and Bartow. The system will include approximately 15,150 linear feet of gravity sewer pipe, 16,400 linear feet of 2-inch force main, 58 manholes, 20 gravity line cleanouts, two (2) lift stations, thirteen (13) grinder stations, and all necessary appurtenances.

**Cost:** \$3,640,000

## Blackwater Falls State Park Sewage Treatment Plant Replacement

**Project Location:** Tucker County, West Virginia

**Client:** WVDNR

**Project Description:** The project consisted of a new concrete sewage treatment plant which eliminated the potential for rust and provides a sand filter prior to discharge into the Blackwater Canyon. Additionally, due to ELR's design, the existing plant was able to remain in service during construction.

## Chief Logan State Park Recreational Facility

**Project Location:** Logan County, West Virginia

**Client:** Logan County PSD

**Project Description:** ELR served as the prime consultant on this project and worked with our sub consultants, the project architect and the project mechanical engineer. The facility consists of a 37,050 SF first level that has a tennis facility surrounded by an elevated walking track, and a 25 meter indoor swimming facility. A second level consisting of 8563 square foot includes a weight lifting facility as well as several other exercise areas. The site was a former mine fill area with 70 -80 feet of rock over burden placed on site during mining operations. E. L. Robinson worked with the owner after performing a geotechnical investigation to develop a plan to remove soil at the site to a depth of 12 feet removing oversized materials and replacing the material with an engineered fill. Upon completion of the earthwork, plans and specifications for the structure and the foundation system were developed. In addition sewage and water infrastructure was designed to serve the facility.

**Cost:** \$5,200,000

## Aldersgate United Methodist Church Recreation Facility

**Project Location:** Kanawha County, West Virginia

**Client:** Aldersgate United Methodist Church

**Project Description:** E.L. Robinson was contracted by the Aldersgate United Methodist Church to prepare structural drawings for a 9,600 SF addition to the existing church building. The building consisted of a masonry and structural steel 5,640 SF gymnasium/fellowship hall and a two story 3,960 SF music/kitchen structure connected to the gymnasium/fellowship hall and existing church. The project architect for this structure was Associated Architects. The facility was used by the church during the summertime widespread power outage to house people who were without power and were susceptible to the high (100 degree +) heat.

**Cost:** \$1,000,000

## Mingo County Memorial Building Handicap Accessibility

**Project Location:** Mingo County, West Virginia

**Client:** Mingo County Commission

**Project Description:** The Mingo County Courthouse Annex (Memorial Building) was inaccessible to handicap persons. E.L. Robinson Engineering worked with the Mingo County Commission to develop plans and specifications to install a wheel chair lift elevator in an existing stairwell. The sidewalk and entrance at street level were modified to accommodate a ramp system in the existing sidewalk. The doorways leading to and from the elevator were provided with openers to assist handicap persons with opening of the door ways. The plans and specifications were put out to bid in the fall of 2011 and by early 2012 the elevator system was installed.

**Cost:** \$150,000

## Williamson Coal House

**Project Location:** Mingo County, West Virginia

**Client:** Mingo County Commission

**Project Description:** A fire gutted the historic coal house on October 11, 2010 and destroyed the wood framing supporting the roof system. E.L. Robinson Engineering worked with the Mingo County Commission to prepare plans and specifications so the building could be reconstructed. E.L. Robinson also worked with Associated Architects on this project to recreate the interior of the Coal House to its historical interior with the high ceilings and ornate interior. The building framing was designed restoring the building to its original configuration with plans and specifications submitted to the State Historical Preservation Office for their approval. The project was bid in the spring of 2011 with the project completed in the Fall of 2011. Plans and specifications were prepared in a short period of time to meet the county's aggressive schedule to have this historical structure restored since it has become such a focal point of the community.

**Cost:** \$200,000

## Logan County Courthouse ADA Upgrades

**Project Location:** Logan County, West Virginia

**Client:** Logan County Commission

**Project Description:** The Logan County Courthouse did not provide ADA compliant accessibility to handicap persons. ELR worked with the Logan County Commission to develop plans and specifications for a wheel chair ramp on the Stratton Street side of the courthouse. ELR assisted the Logan County Commission in obtaining bids from contractors and provided inspection oversight during construction.

The Logan County Commission purchased an existing two story building in downtown Logan. In order to make the second floor handicap accessible, the LCC needed an elevator installed in the building. ELR performed laser survey of the existing building and designed an elevator and elevator shaft to provide access to the second level. The plans and specifications were used to solicit bids from elevator companies. Logan County maintenance personnel constructed the elevator shaft as designed by E.L. Robinson. The elevator system was completed in 2013.

The Logan County Courthouse did not have any handicap accessible restrooms. The county commission worked with ELR concerning the ADA compliance issues. ELR made site visits and prepared plans of the existing facilities and developed a plan to convert one ground floor restroom to an ADA compliant restroom. ELR prepared plans and specifications for the modifications. The restroom currently serves the handicap visitors to the courthouse.

**Cost:** ??

## Ronceverte Comprehensive Plan

**Project Location:** Greenbrier County, West Virginia

**Client:** City of Ronceverte

**Project Description:** ELR assisted the planning team to develop the first comprehensive plan for the City and prepared the required maps and graphics to examine the following: existing land use, existing land constraints (slopes, floodplain and other relative constraints, future land use, potential development areas considering vacant land and/or parcels, brownfields, and other properties with limited constraints, future growth areas (annexation possibilities), greenway/trails/open space.

**Cost:** \$10,000

## Ronceverte Streetscape Enhancements

**Project Location:** Greenbrier County, West Virginia

**Client:** City of Ronceverte

**Project Description:** The City of Ronceverte engaged E.L. Robinson's landscape architects to prepare a Town Center master plan, building on other recent planning documents prepared in cooperation with West Virginia University for Ronceverte. The objective for the Town Center Plan was to prepare tourism and market analysis, planning & design recommendation for the Town Center, design recommendations for streetscape extensions on Main Street (US 219) and a building analysis of approximately 31 structures within the area of the Town Center. Previous to this plan the City had utilized E.L. Robinson's landscape architects in 1988 to design the initial phase of a streetscape which was constructed on Edgar Avenue.

This project was completed by E.L. Robinson's landscape architects prior to their affiliation with the firm.

**Cost:** N/A

## Ronceverte Streetscape Phases 3 & 4

**Project Location:** Greenbrier County, West Virginia

**Client:** WV Department of Highways

**Project Description:** E.L. Robinson was selected, by the West Virginia Department of Transportation, as one of seven firms to perform new non-traditional streetscape projects. ELR was selected by the City of Ronceverte from this short list of firms to perform the planning and design services required for this project. We completed the design for the upgrade of the streetscape throughout the downtown area of Ronceverte. The streetscape enhancements included upgraded sidewalk, brick banding, and lighting. In order to complete the electrical engineering portion of this project, Harper Engineering was utilized as a sub contractor.

**Cost:** \$398,166

## Mt. Hope Streetscape Phases 3 & 4

**Project Location:** Fayette County, West Virginia

**Client:** City of Mount Hope

**Project Description:** This project involved the development of the third phase of the sidewalk and curb replacement along with installation of new period street lighting established on the previous streetscape phases for Main Street. Accessibility for all citizens were improved and site furniture and a small plaza were designed at the clock next to old bank building near City Hall. The project entailed nearly 700 feet more of improvements adding to the 1100 feet already completed. Phase 4 of Mt. Hope Streetscape was completed with the replacement and addition of 600 feet of sidewalk on Main Street plus 9 new street lights and street furniture.

**Cost:** \$427,455

## Bridgeport Pedestrian Walkway Feasibility Study & Design

**Project Location:** Harrison County, West Virginia

**Client:** WV Department of Highways

**Project Description:** ELR prepared a feasibility study of four options for extending a pedestrian pathway from US 50 (Main Street) primarily along the west side of WV 58 for nearly a half mile to the existing pathway on the City Parks property. Storm drainage elements, asphalt pathways, retaining walls, railing, sidewalk and curb ramp upgrades, traffic signalization, crosswalk and traffic signage upgrades were all considered in the study. ELR completed survey, geotechnical, investigations, property easements, and design for this .5 mile trail with additional upgrades to sidewalks as part of the trail route.

**Cost:** \$900,000

## Doddridge County Courthouse Campus Upgrade

**Project Location:** Doddridge County, West Virginia

**Client:** Doddridge County Commission

**Project Description:** The County Courthouse is located on a promontory hill overlooking the Town of West Union. Pedestrian and vehicles access can be challenging on a busy day around the courthouse with aging sidewalks and limited parking for the public access to the courthouse. E.L. Robinson was retained to upgrade sidewalks with an accessible route to the courthouse for all citizens, including new curb ramps, crosswalks, and accessible parking spaces. Also, all the existing sidewalks and around the courthouse were replaced as where the front entry steps. Two parking areas were expanded, paved and appropriate stormwater detention facilities were installed with new retaining walls to better accommodate parking. All the adjoining parking lots and surrounding four streets were milled and paved.

**Cost:** \$500,000





## **Recent Public Works Buildings**

### **New Bus Garage**

HVAC, Plumbing, Sprinkler, Electrical and Fire Alarm design for a new 5,900 sq. ft. bus garage in West Union, WV.

### **Public Works Building**

HVAC, Plumbing, Sprinkler, Electrical and Fire Alarm design for a new 4,500 sq. ft. bus garage in Romney, WV.

### **Energy Corporation of America**

HVAC, Plumbing, Electrical, Fire Alarm and Sprinkler design for a 60,000 sq. ft. office located in Charleston, WV.

### **St. Albans Armory Storage Building**

HVAC, Plumbing, Electrical and Fire Alarm design for a 3,000 sq. ft. storage building.

### **WV Veterans Home Barboursville**

Electrical design for a new 1,000 sq. ft. storage building.

### **WV DOH Weigh Station**

HVAC, Plumbing and Electrical design for a new 885 sq. ft. weigh stations to replace existing weigh stations in Putnam County.

### **Dominion Gas Office Building**

HVAC, Plumbing, Electrical, Fire Alarm and Sprinkler design for a 20,000 sq. ft. office located in Clarksburg, WV.

### **Beckley VA Parking Garage**

HVAC, Plumbing, Electrical and Fire Alarm design for a new 4-story parking garage.

### **W. Kent Carper Justice and Public Safety Complex**

HVAC, Plumbing, Electrical, Fire Alarm and Sprinkler design for a renovations to a 62,400 sq. ft. Justice and Public Safety Complex.

### **WV Department of Highways SRC Office Building**

HVAC, Plumbing, Electrical, Fire Alarm and Sprinkler design for a renovations to a 39,400 sq. ft. addition and renovation to existing office building in Charleston, WV.



### **Recent Public Works Buildings (continued)**

#### **Office Addition to Boone County Courthouse Annex**

HVAC, Plumbing, Electrical, Fire Alarm and Sprinkler design for a 20,400 sq. ft. addition and renovation to Boone County Courthouse Annex.

#### **Fayette County 911 Emergency Communication Center**

Provided mechanical, electrical, and plumbing services for the new 911 Emergency and Communications Center. Project utilized energy efficient water heating system, strategic lightings to reduce screen glare, diesel emergency generator and automatic transfer switch, and a dual action sprinkler system.

#### **Wayne County 911 Emergency Communication Center**

Mechanical, Electrical and Plumbing services for the new 911 Emergency and Communications Center. Project utilized energy efficient water heating system, strategic lighting to reduce screen glare, diesel emergency generator and automatic transfer switch, and dual action sprinkler system.

#### **South Charleston Fire Station #1**

Mechanical, Electrical, and Plumbing services for the new 10,000 sq. ft. Fire Station located in downtown South Charleston, WV.

#### **Charleston Fire Station #3**

Mechanical, Electrical, and Plumbing services for the new 6,400 sq. ft. Fire Station located in Oakwood Road in Charleston, WV.

## Management & Staffing Capabilities

**Todd Boggess** is President of E.T. Boggess, Architect, Inc., and will serve as the design team leader. He will be assisted by **Stephen Mackey**, who is responsible for planning and design for the project.

**Nathan Turner** will be the project manager responsible for coordinating all project information amongst the team.

**Dale East** will be managing the construction documentation and, along with Mr. Mackey, they will be generating the design and construction approach to realize the project.

**Chris Canterbury** is ETB's construction contract administration manager. With over 18 years of CA experience, Chris' knowledge and background of all building systems has been an invaluable asset to our team. Nathan Turner, as project manager, and Todd Boggess also remain very active during the CA phase to help ensure the design intent is realized.

A component of our management approach is the development of an individual strategy for each project, focused on the specific problems to be solved. This strategy considers the staff members assigned to the project, the scheduling and duration of work phases, the use of special consultants or specialized studies. Our Project Management Plan (PMP) will document key management and oversight tasks and is updated throughout the project as changes occur. The plan will include a definition of your program goals, technical requirements, schedules, resources, budgets, and management programs.

Once we gain a better understanding of your scheduling targets, we will be able to determine exactly what resources we will need to dedicate to the project. Regardless of the schedule, we are confident that our manpower and skill level will remain more than adequate, even in the early, labor intensive phases. Our projected workloads and the depth of personnel available are such that staffing projects of this size and complexity will have no adverse impact on any current or future projects in our office.

Resumes for our design team, including EL Robinson and Harper Engineering, can be found on the following pages.

Todd Boggess, AIA, NCARB, Architect  
*President*



## EDUCATION

- Master of Architecture, Clemson University School of Architecture
- International Studies, Clemson University Daniel Center for Urban Design & Building Studies, Genoa, Italy
- Bachelor of Arts Degree in Design, Clemson University School of Architecture

## RESPONSIBILITIES

Todd joined ETB as a project architect and office manager in 1988 after graduating from Clemson University. In January, 2001, he assumed the office of President.

Todd is responsible for . . .

- architectural design and development
- project management and coordination
- computer aided design and visualization
- interior design
- site planning

Your project will receive his complete attention, from the interview and project meetings, through the construction process. As the president of the firm, you are putting your trust in him and he takes that commitment very seriously. He wants to make sure you are satisfied with our service, performance, and design.

## COMMITTEES

West Virginia Board of Architects (2014) – Governor Tomblin recently appointed Todd to this board which is responsible for protecting the life, health and property of the people of the State of WV by ensuring that proper architecture practices are used in the state.

Princeton Zoning Board of Appeals (since 2000) – Todd has been asked to serve on this local committee for the past 15 years. He currently serves as vice-chair. The board is responsible for reviewing and ruling on appeals to the existing Princeton Zoning Laws.

## PROJECTS

- WVDNR Pipestem Conference Center (*Addition*), Pipestem State Park, WV
- The Summit Bechtel Family National Scout Reserve - Bathhouse Design & Construction, Observation Deck, & Pavilion Design Options, Mt. Hope, WV
- Hatfield-McCoy Regional Recreational Authority Offices, Lyburn, WV
- ATV Resort and Lodge, Mingo County, WV
- ATV Resort and Lodge, Logan County, WV
- Spearhead Trail Lodging/Parking, Tazewell County, VA
- WVARNG Readiness Center, Elkins, WV
- WVARNG Coonskin Joint Facilities Exterior Renovation, Charleston, WV
- WVDON District 10 Headquarters Complex, Gardner, WV
- WVDON District 6 Headquarters Complex, Moundsville, WV
- WVDON District 9 Headquarters Complex - Office Building, Lewisburg, WV
- WVDON District 1 Headquarters Complex - Office Building, Charleston, WV
- WVDON District 8 Equipment Shop, Elkins, WV
- WVDON District 7 Office Building, Weston, WV
- WVDON District 7 Equipment Shop, Weston, WV
- WV Parkways Authority Tourist Information Center, Princeton, WV

## AWARDS

- WVAIA "Honor Award" for Renovation Design of the Princeton Public Library – April 2012
- Princeton/Mercer County Chamber of Commerce "Excel Award" – January, 2011
- *West Virginia Executive Magazine's* "Young Guns" - Fall, 2003
- Princeton/Mercer County Chamber of Commerce "Citizen of the Year - 2000"
- Princeton Elks Club "Citizen of the Year - 2000"

**Stephen Mackey**  
*Planning & Design*



## EDUCATION

- Bachelor of Arts Degree in Design, Clemson University School of Architecture
- Master of Architecture, Clemson University School of Architecture

## RESPONSIBILITIES

With over 30 years of experience in all phases of design and construction, Mr. Mackey brought strong design, management and leadership skills to the firm. His significant experience has enabled him to successfully oversee the design and construction of a number of large educational projects. Specific project responsibilities include:

- code review and analysis
- program development
- conceptual design
- design visualization
- project coordination
- construction specifications

## PROJECTS

Mr. Mackey rejoined ETB Architects in 2009 after serving as Executive Vice President for two architectural firms in Florida. During his absence, Mr. Mackey also served as project manager on several large school projects in the state of Florida and has been focused on education projects since his return to ETB.

- The Summit Bechtel Family National Scout Reserve - Bathhouse Design & Construction, Observation Deck, & Pavilion Design Options, Mt. Hope, WV
- ATV Resort and Lodge, Mingo County, WV
- ATV Resort and Lodge, Logan County, WV
- Advantage Valley Advanced Technology Center for the WVC&TCS, So. Charleston, WV
- North Central Advanced Technology Center for the WVC&TCS and Allied Health, Fairmont, WV
- WVARNG Readiness Center, Elkins, WV

Nathan Turner, LEED G.A.  
*Project Manager*



## EDUCATION

- Bachelor of Science, Engineering – Architecture, Fairmont State University
- Master of Architecture (May, 2009), Boston Architectural College

## RESPONSIBILITIES

Mr. Turner joined ETB in 2009 and brought with him a wealth of experience in architectural design, as well as construction methods and practices. His prior experience with educational facilities has already proven extremely valuable as we have several elementary, middle, and high school projects at various stages of completion. Nathan has obtained LEED certification and will assist in our efforts to provide a “green” approach to as many projects as possible.

Specific project responsibilities include:

- architectural programming
- construction documentation
- project management
- project coordination
- construction specifications
- construction administration

## PROJECTS

- The Summit Bechtel Family National Scout Reserve - Bathhouse Design & Construction, Observation Deck, & Pavilion Design Options, Mt. Hope, WV
- Advantage Valley Advanced Technology Center for the WWC&TCS, So. Charleston, WV
- North Central Advanced Technology Center for the WWC&TCS and Allied Health, Fairmont, WV
- New River Community and Technical College Headquarters and Allied Health Building, Beaver, WV
- WVARNG Readiness Center, Elkins, WV

Dale East  
*Production Management*



## EDUCATION

- Bachelor of Science - Architectural Engineering  
Bluefield State College

## RESPONSIBILITIES

Mr. East is an architectural intern with 10 years of experience who joined ETB in November of 2013. Prior to returning to Princeton, his work at architectural firms in Tennessee allowed him to manage projects from New Jersey to Atlanta, ranging from educational facilities to zoological exhibits. Dale is involved in all phases of design documentation and production and is eager to handle any task needed to ensure a smooth project flow from start to finish.

Specific project responsibilities include:

- 3D modeling
- graphics/imagery
- construction documentation
- project coordination

## PROJECTS

- WVARNG Coonskin Joint Facilities Exterior Renovation, Charleston, WV
- WVDOT D7 Office Building, Weston, WV
- WVDOT D7 Equipment Shop, Weston, WV
- Cabins and Bathhouse for the Ashland KOA, Ashland, WV
- ATV Resort and Lodge, Mingo County, WV
- ATV Resort and Lodge, Logan County, WV
- Spearhead Trail Lodging/Parking, Tazewell County, VA
- Creekside Villas (Exterior Renovations), Snowshoe, WV



**Chris Canterbury**, Associate AIA  
*Construction Administration Manager*



## EDUCATION

- Bachelor of Science Engineering Technology/Architecture, Fairmont State University

## RESPONSIBILITIES

Chris joined ETB in 2000 as a CADD Technician. His focus in recent years has been project administration and his current position of Construction Administration Manager reflects that area of expertise. Your project will benefit from his superb organizational skills. He attends meetings and keeps track of your needs and wishes through notes and minutes. His timely response to submittals will ensure that your project stays on its construction schedule.

Chris is responsible for . . .

- construction administration
- organizing and attending meetings
- distribution of minutes and progress reports
- contacting material suppliers
- responding to contractor's requests for information
- reviewing submittals and shop drawings
- site visits/observations

## PROJECTS

During the construction process, Chris attends the regular progress meetings, as well as special meetings with material suppliers and sub-contractors. He works closely with the contractor in maintaining the budget, adhering to the schedule, and ensuring quality control.

- Pipestem Conference Center (*Addition*), Pipestem State Park
- Hatfield-McCoy Regional Recreational Authority Offices, Lyburn, WV
- WVDOH District 6 Headquarters Complex - Maintenance Building, Bridge & Sign Shop
- WVDOH District 9 Headquarters Complex - Office Building
- WVDOH District 1 Headquarters Complex - Office Building
- WVDOH District 8 Equipment Shop
- WVDOH District 7 Office Building and Equipment Shop

**Mr. Eric Coberly, P.E.**, will serve as Project Manager. Mr. Coberly has over 30 years of experience in the field of engineering. He has managed an array of projects with ELR including site development, infrastructure planning, water, sewer, geotechnical analysis, abandoned mine reclamation projects, building construction, active surface mining projects, insurance investigations, and various post mining land use projects. Additionally, he served as the Chief for the West Virginia Department of Environmental Protection Abandoned Mine Lands Division for more than 4 years. He has spent his career bettering the State of West Virginia in both the private and public sectors.

**Mr. Ed Robinson, P.E., P.S.**, will serve as Quality Control and Quality Assurance representative for the project team. Mr. Robinson has over 40 years experience in the engineering and construction field, where he has been a member of many associations and boards within the design field.

**Mr. Randall Lewis** will serve as Assistant Project Manager. Mr. Lewis has over 30 years experience in the development of infrastructure in the State of West Virginia. Mr. Lewis has immeasurable knowledge of state and federal funding programs and interacts with various funding agencies on a regular basis.

**Mr. Tim Cart, P.E.**, will serve as Structural Engineer. Mr. Cart has over 35 years of experience in providing consulting engineering services including structural and roadway projects. He has served as project engineer and project manager on numerous geotechnical investigations including highways, bridges, industrial sites, buildings and various developments.

**Mr. Jack Ramsey, P.E.**, will serve as Project Engineer. Mr. Ramsey has more than 20 years of experience in the planning, design and construction management of water and wastewater systems, including preliminary engineering reports, feasibility studies, line layout, hydraulic design, lift and booster station design, water storage tank design, water and wastewater treatment plant design and rehabilitations, preparation of construction documents and specifications, preparation of permit applications and coordination with regulatory and funding agencies.

**Mr. Rick Roberts, P.E.**, will serve as Project Engineer. Mr. Roberts has more than 30 years of experience as a water/wastewater designer, regulator and utility manager. He has extensive experience in project planning, design and construction of water and wastewater extensions. During his time as a utility manager he oversaw the acquisition and upgrade/replacement of over 30 public water systems.

**Mr. Bob Hazelwood, P.E.**, will serve as Project Engineer. Mr. Hazelwood has more than 40 years of experience as a civil engineer with specific experience in a multitude of engineering subfields. His extensive background includes water source distribution and treatment facilities, wastewater collection systems, storm water management, industrial and business parks, access roads, bridges, airports, various land development and structure renovations.

**Mr. Jeff Nelsen, PLA**, will serve as Landscape Architect. Mr. Nelsen has a strong background in park and recreation planning and facilities design. Mr. Nelsen has completed boat ramp projects for WVDNR and USNRCS in the past and numerous other park and recreation projects for WVDNR, US Forest Service and numerous communities in West Virginia, Ohio, Kentucky, and Indiana. He is currently Project Manager on several other WVDNR projects.



**Mr. Tim Scott, PLA**, will serve as Landscape Architect. Mr. Scott has experience in all phases of the design process in projects including: parks and recreation; streetscapes; commercial and residential design; civic and institutional design; botanic gardens; and trail design.

**Mr. Todd Garnes**, will serve as a Project Designer. He has more than 15 years of experience as a civil draftsman and designer. He is proficient in numerous drafting and mapping software platforms. His proficiency spans multiple areas such as Civil 3D, GIS, construction inspection, waterline planning and design, sanitary sewer planning and design, site development, cathodic protection planning, county-wide planning, infrastructure cataloging, and document preparation.

**Mr. Shawn Fore**, will serve as a Project Designer. He has over 15 years of experience as a CAD Designer in numerous areas of civil engineering. His representative experience includes civil site development, water and wastewater line treatment plants, abandoned mine lands reclamation, highway design, bridge inspection, utility location and mapping, hydrographic surveying, land surveying, environmental, wind energy and water sampling.

**Mr. J. Tom Rayburn, P.S.**, will be assigned as the Surveying Manager. By using GIS based mapping and high-tech instrumentation, the ELR survey team can evaluate any type of surface including lakes and river bottoms.

**Mr. Ronald Williams and Mr. Jeff Casto** will be assigned to oversee construction inspection activities. ELR maintains a permanent and highly qualified construction inspection staff with outstanding experience and knowledge to very capably oversee the construction of your project.

### **Education**

M.S. Engineering of Mines, West Virginia University, 1990

B.S. Engineering of Mines, West Virginia University, 1983

### **Registrations**

Registered Professional Engineer in West Virginia, Ohio, and Maryland

### **Professional Experience**

Mr. Coberly has more than 30 years of experience as an infrastructure and mining engineer. He has extensive experience in project planning, funding coordination and design. Mr. Coberly has managed projects with ELR which have involved site development, infrastructure planning, water, sewer, geotechnical analysis, abandoned mine reclamation projects, building construction, active surface mining projects, insurance investigations, providing expert witness services and various post mining land use projects.

Additionally, Mr. Coberly served as the Chief for the West Virginia Department of Environmental Protection Abandoned Mine Lands Division for more than 4 years. In this position he was responsible for managing and directing all operations. He has spent his career working to better the State of West Virginia in both the private and public sectors.

### **Representative Projects**

The following is a sample list of recent projects on which Mr. Coberly has served as Project Manager

- City of Bluefield Commercialization Center - \$2.55 Million
- Greenfield Cabinetry Building Expansion - \$3.64 Million
- Scott Findley Road Waterline Extension Project - \$1.2 Million
- Exchange Road Phase I Waterline Extension - \$3.1 Million
- Putnam Business Park Utility Extension Phase II - \$1 Million
- Kenova Downtown Water System Upgrade - \$1.9 Million
- Kenova Prichard Waterline Replacement and Upgrade Project - \$4.7 Million
- Route 18 South-Snowbird Road Waterline Extension Project - \$969,000
- Big Flint Waterline Extension Project - \$7.8 Million
- Poca Belt Press - \$1.6 Million



ERIC COBERLY, P.E.  
(CONTINUED)



- Blue Knob Waterline Extension Project - \$2.3 Million
- Town of Burnsville Sewer Study - \$2.7 Million
- Bergoo Wastewater Collection and Treatment System Project - \$2.7 Million
- Cow Creek Waterline Extension Project - \$815,000
- WVDEP OSR Viking Preston Mining Project - \$2.3 Million
- Over 100 West Virginia Department of Environmental Protection Abandoned Mine Lands reclamation projects



EDWARD L. ROBINSON, P.E., P.S.  
PRESIDENT



### **Education**

M.S. Civil Engineering, University of West Virginia College of Graduate Studies, 1981

B.S. Civil Engineering, West Virginia Institute of Technology, 1969

### **Registrations**

Registered Professional Engineer in West Virginia, Kentucky, Ohio, Florida, Virginia, and North Carolina

Registered Professional Surveyor in West Virginia

### **Professional Experience**

Mr. Robinson founded E. L. Robinson Engineering in 1978 with four employees. Initially the firm provided land surveying and land development services. Over the course of the next 20 years, the firm added water and wastewater engineering as well as structural inspection services simultaneously growing to 14 employees.

Under his leadership, E. L. Robinson enters the new millennium as a multi-disciplined professional services firm that utilizes the latest technology in the design of added infrastructure, highways, bridges, structures, environmental, civil, and geotechnical projects as well as global position satellite surveying, right-of-way, construction inspection and architectural services.

The firm now employs more than 135 engineers, architects, surveyors and support personnel and has been converted to an employee owned company through an Employee Stock Ownership Plan (ESOP).

### **Professional Memberships**

National Society of Professional Engineers

American Society of Civil Engineers

Water Environmental Federation

### **Offices Held**

Chairman of WVUIT Advisory Board

President of West Virginia Council of Consulting Engineers

Chairman Transportation Committee - WV Association of Consulting Engineers

State Director of West Virginia Society of Professional Engineers

President of West Virginia Society of Professional Engineers



EDWARD L. ROBINSON, P.E., P.S.  
(CONTINUED)



Assistant Treasurer of the American Society of Civil Engineers  
National Director of the ASCE representing WV, NC, SC and VA  
President of West Virginia Section of ASCE

**Honors Awarded**

Alumnus of the Year – West Virginia University Institute of Technology, 1992  
Engineer of the Year – West Virginia Society of Professional Engineers, 1997  
Engineer of the Year – American Society of Civil Engineers, 1998  
National Entrepreneur of the Year Finalist – Ernst & Young, 2001  
Engineering Entrepreneur of the Year – Ernst & Young, 2001  
Honorary PhD, Doctor of Science – West Virginia Institute of Technology 2002



### **Education**

B.S. Business Administration, Marshall University, 1985  
University of Kentucky Basic Economic Development Institute  
University of Oklahoma – Graduate Economic Development Institute

### **Professionals Memberships**

American Planning Association  
Board of Directors for State Planning Association (past)

### **Professional Experience**

E. L. Robinson Engineering: Vice-President-Responsible for marketing of services to clients. Services include the development of infrastructure, transportation design, community planning and development.

West Virginia Rural Water Association: Executive Director of the West Virginia Rural Water Association. Under his leadership at WVRWA, membership and budget growth skyrocketed to an all-time high. In the capacity of director of this association, legislative actions were influenced which positively affected the utility industry in West Virginia.

Region II Planning and Development Council: Deputy Director-While serving in this capacity, a diversity of experience was gained in dealing with the management of loan and grant programs. He gained a broad knowledge base through the development and management of infrastructure and economic development projects within cities, counties, and economic development authorities.

His expertise is planning and assisting governmental agencies to facilitate the development of infrastructure, while linking it to economic development.

He has a vast knowledge of regulations concerning the Economic Grant Committee; Small Cities Block Grant Program; West Virginia Infrastructure and Jobs Development Council Program; Rural Economic and Community Development Program; U.S. Department of Commerce-Economic Development Administration; West Virginia Division of Environmental Protection Programs; Appalachian Regional Commission Programs and Army Corps of Engineers Programs.

Mr. Lewis has devoted his career to serve the citizens of West Virginia in the development of infrastructure and promotion of economic development. With over 30 years of experience, Mr. Lewis has immeasurable knowledge of state and federal funding programs and interacts with funding agencies, water and wastewater system personnel, and elected officials on a regular basis. He has extensive experience communicating and networking with funding agencies, elected officials, and a myriad of private citizens.





His broad experience helps take projects that may otherwise be financially infeasible and develop practical and cost-effective solutions that allow them to be funded and constructed in a reasonable amount of time – satisfying the needs of our clients quickly. By partnering with different funding agencies, E.L. Robinson can develop projects in a manner that is consistent with available funding as opposed to developing a project that may never meet the requirements for state and/or federal funding assistance.

Mr. Lewis served as the first chairman of Wayne County Infrastructure and Planning Team for new highway construction. He has served on the Abandoned Mine Lands Water Resource Committee; WV Infrastructure and Jobs Development Council Consolidation Committee (Advisory Member); Miss Utility Board of Directors; West Virginia Rural Development Council Board of Directors.

#### **Recent Funding Experience**

Lavalette PSD Nestlow Phase I & II	Mingo County PSD Lick Creek Waterline Extension
Lavalette PSD Route 37	Mingo County PSD Dingess Phase I
Lavalette PSD Right Fork of Wilson/Newcomb Creek	Mingo County PSD Dingess Phase II
Crum PSD Mill Creek	Mingo County PSD Jennies Creek
Crum PSD Phase I	Mingo County PSD Upper Marrowbone
Crum PSD Route 52 North Water Project	Mingo County PSD Ben Creek Phase I
Town of Gilbert Horsepen Water	Mingo County PSD Ben Creek Phase II
Town of Gilbert Browning Fork	Mingo County Redevelopment Authority King Coal Highway Phase I
Town of Gilbert Horsepen Gilbert Creek	Mingo County Redevelopment Authority King Coal Highway Phase II
Post Mine Land Use Planning: Ten Counties	
West Hamlin Waterline	
West Hamlin Sewer Improvements	



### **Education**

B.S. Civil Engineering, West Virginia University, 1981, Magna Cum Laude

### **Registrations**

Registered Professional Engineer West Virginia (1986) and Ohio (2000)

Registered Professional Surveyor in West Virginia (1995)

### **Professional Memberships**

American Society of Civil Engineers (ASCE)

### **Professional Experience**

Mr. Cart has over 32 years of experience in providing consulting engineering services. Clients served have included Industrial, Public and Private Institutions and State and Federal Agencies.

Mr. Cart has served as Project Engineer on numerous geotechnical investigations over the years. These projects have included highways, bridges, industrial sites and private development.

He has designed numerous waterline extensions and sewer collection systems. These extensions have included providing service to many residential as well as industrial customers. The sewer collection systems have included design of systems to collect sewage from residential and industrial sites. Mr. Cart served as a project engineer on several major waste water treatment plant upgrades for industrial clients in the Kanawha Valley.

Mr. Cart has performed over 100 Abandoned Mine Land Reclamations projects throughout Appalachia. These projects have been mainly in Ohio, West Virginia and Eastern Kentucky. These projects have involved draining flooded mine workings, support of ground experiencing or subject to Mine subsidence and the stabilization of landslides. He has also designed numerous reclamation plans for refuse sites and stream restoration project.

Mr. Cart has designed numerous retention and retaining ponds for sites. These designs have involved the determination of storm runoff and design of structures to safely retain and pass the required storm peak flows.

His experience includes permitting activities for projects which have included:

Railroad Occupancy Permits for Utilities

NPDES Permits for Industrial and Public Wastewater Facilities

Highway Permits for Utility Occupancy and Access Road Tie Ins

Health Department Permits for Water and Sewer Projects



### Representative Projects

Mr. Cart has served as senior project engineer for several large industrial parks (20-100 acres) in southern West Virginia. These include several sites for Mingo County Redevelopment Authority and Putnam County Development Authority. He has also designed numerous sites for commercial retail including drug store sites, hotels, restaurants, 911 centers, regional bus garages, public service district maintenance facilities, gas station commercial sites, banks, etc. Such projects include the following:

- Buckwheat Express Bus Garage
- Mason County 911 Center and Garage
- Putnam County 911 Center and Maintenance Garage
- Mingo County 911 Center
- Wetzel County 911 Center
- Mingo County Wood Park Industrial Park
- Upshur County Industrial Park
- Earl Ray Tomblin Industrial Park
- Putnam County Industrial Park
- Walgreens - Cross Lanes, WV
- TGI Fridays - Cross Lanes, WV
- Saturn - Hurricane, WV
- Hurricane Chevrolet - Hurricane, WV
- 7-11 Shell Gas Station - South Charleston, WV
- Hatfield McCoy Trail Head Office - Lincoln County, WV
- Bank of Mingo - Belo, WV



### **Education**

B.S. Civil Engineering Technology, West Virginia Institute of Technology, 1994

### **Registrations**

Registered Professional Engineer in West Virginia, Ohio, Pennsylvania, and Virginia

### **Professional Experience**

Mr. Ramsey has more than 20 years of experience in the planning, design and construction management of water and wastewater systems, including preliminary engineering reports, feasibility studies, line layout, hydraulic design, lift and booster station design, water storage tank design, water and wastewater treatment plant design and rehabilitations, preparation of construction documents and specifications, preparation of permit applications and coordination with regulatory and funding agencies.

Mr. Ramsey has worked on projects ranging in size from \$10,000 to over \$40 million. They include everything from single water line extensions to large-scale advanced technology wastewater treatment plants.

Mr. Ramsey has been recognized by the American Registry of Outstanding Professionals as well as Cambridge Who's Who in the field of water and wastewater engineering. He has also written several articles that have been published in the WV Rural Water Association's Quarterly. Mr. Ramsey also served as the Planning Director for the Town of Winfield Planning Commission from 2003 to 2007.

### **Representative Projects**

#### **Wastewater:**

**Town of New Haven:** Provided the design and construction administration of the wastewater treatment plant upgrade and collection system improvements project that included installation and automatic bar screen, a UV unit, replacement and/or rehabilitation of the motor control center, the sludge holding tank, the chlorine contact chamber and the existing WWTP pump station. Project also included replacing over 6,300 LF of existing 10-inch and 8-inch sewer line, 24 manholes and 1 pump station.

**City of Glenville:** Wrote the facilities planning report for a wastewater treatment plant upgrade, which included a sequencing batch reactor (SBR), belt filter press, additional clarification, and headworks as well as the collection system extension to various areas of the City and to the proposed \$100 million Federal Prison. Total estimated project cost \$7,500,000.

**City of Paden City:** Performed a Sanitary Sewer Evaluation Study (SSES) on the entire wastewater treatment and collection system. Study included system mapping, Closed Circuit Television (CCTV) of over 15 miles of collection line, evaluation of problem areas and corrective measures, cost estimates, and report preparation.

**Moorefield / Hardy County Wastewater Authority:** Performed the design and permitting of the regional wastewater collection system project that includes installation of approximately 4,000 LF of 24-inch gravity sewer pipe and over 20,000 LF of 14-inch and 18-inch force main. This system will convey wastewater from all of



Moorefield, the Pilgrim's Pride industrial facility and portions of Hardy County to the new Regional WWTP.

Performed value engineering and partial redesign of the 4.1 MGD advanced wastewater treatment facility.

Performed construction administration on all three (3) contracts worth over \$40 million and was under construction for approximately 18 months.

Nitro Regional Wastewater Utility: Design and construction management of a wastewater treatment plant upgrade. The project consisted of a 0.65 MGD packaged treatment unit, a 1.2 meter belt filter press with building, a 150,000 gallon aerobic digester and headworks upgrade. Total project cost \$2,700,000.

Syracuse-Racine Regional Sewer District: Design of the Wastewater Treatment Plant Upgrade and Pump Station Rehabilitation project that consisted of rehabilitating the existing oxidation ditches and secondary clarifiers, replacing the existing sewage grinder, splitter box, return and waste sludge pump and controls, and sludge meter. Installing a new belt filter press building and SCADA system as well as rehabilitating three (3) existing collection system pump stations and replacing two (2) others.

Design of the Tackerville sewer system extension project. Project included over 10,000 LF of gravity sewer line and one (1) pump station. The project served 55 previously unsewered customers.

Town of Belle Sanitary Board: Performed a Sanitary Sewer Evaluation Study (SSES) on the entire wastewater treatment and collection system. Study included system mapping, Closed Circuit Television (CCTV) of over 15 miles of collection line, smoke testing, manhole inspections, evaluation of problem areas and corrective measures, cost estimates, and report preparation.

Performed the design of a wastewater collection system improvements project that included relining over 13,000 LF of existing sewer line, replacement and/or rehabilitation of approximately 80 manholes, and rehabilitation of the 13th Street pump station.

Performed the Design and Construction Administration for a 1.0-meter Belt Filter Press and new Building, including all ancillary equipment.

Planning and design for a 0.35 MGD wastewater packaged plant to replace the existing treatment process. Project includes combination bar screen / grit removal system, 0.35 MGD package treatment unit with aeration basin, clarifier, sludge digester and chlorine contact tank. Project also includes an external clarifier, conversion of the existing aeration basin to an EQ basin, construction of a new garage / blower building, onsite generator, upgrade to the main lift station and other miscellaneous improvements.

Town of Hartford: Design and construction of the wastewater collection system improvements which included rehabilitation of the majority of the manholes and rehabilitation of all five (5) existing lift stations.

Town of New Haven: Performed the design of a wastewater treatment plant upgrade and collection system improvements project that included installation an automatic bar screen, a UV unit, replacing and/or rehabilitating the motor control center, the sludge holding tank, the chlorine contact chamber, and the existing WWTP pump station. Project also includes replacing over 6,300 LF of existing 10-inch and 8-inch sewer line, 24 manholes, and one (1) pump station.

### Education

B.S. Civil Engineering, West Virginia Institute of Technology, 1982

### Registrations

Registered Professional Engineer in West Virginia  
Former West Virginia Class II Water Operator  
West Virginia Class I – S Wastewater Operator

### Professional Experience

Mr. Roberts has more than 30 years of experience as a water/wastewater designer, regulator and utility manager. He has extensive experience in project planning, specifically in water and wastewater extensions and the establishment and implementation of maintenance and preventative maintenance programs.

Mr. Roberts worked as a Utility Engineer with the Public Service Commission in the late 1980s. His primary responsibilities included gathering data and approving county plans as authorized by Senate Bill 191.

Mr. Roberts was the Managing Engineer for the Logan County PSD for more than 20 years. In this position, he was responsible for all aspects of the District's operations including financial planning, budgeting, operation maintenance, environmental compliance and testing, project planning and implementation, and regulatory oversight and compliance.

### Specific Accomplishments

- Oversaw the completion of the construction of twenty-three major water and wastewater projects totaling over \$73,000,000.
- Responsible for the construction of a 2,800 GPM surface water treatment plant that was constructed so that it may be affordably upgraded to 5,600 GPM should the need arise. The plant went online in October 2002 and is exceeding all state and federal treatment requirements.
- Oversaw the construction of a regional 1.0 MGD Wastewater Treatment Plant capable of treating wastewater for over 2,000 customers. Further, the plant is upgradable to 3.0 MGD.
- Managed the purchase and upgrade of 23 privately owned water systems in Logan County. At the time of purchase, each was in poor condition and under "boil water advisories." All of these systems have, or soon will be replaced or upgraded.
- Assisted in flood recovery in the 1996 Logan County and 2001 Wyoming County floods. Mr. Roberts responsibilities included damage assessment, coordination with state and federal officials including FEMA and the actual repair and disinfection of the affected systems.



- Oversaw the extension of water and/or wastewater service to various economic development sites including the Logan County Airport, Southwestern Regional Jail, Earl Ray Tomblin Industrial Park, Wood Products Industrial Park, Chief Logan State Park Convention Center, Fountain Place Mall/Complex, Hatfield and McCoy Trail Facilities as well as eight exits of U.S. 119. All were completed on time and at or under budget.
- Precipitated a phenomenal growth and expansion at Logan County PSD. This growth can be attributed to several key factors: increased number of customers served; increased annual operating revenues; increased Utility Plant in service; increased amount of water mains in service; installed additional fire hydrants; and constructed additional storage tanks.

**Representative Projects**

Client	Project	Cost
Logan County PSD	Big Harts Phase I Water	\$7,288,000
Logan County PSD	Big Harts Phase II Water	\$4,952,000
Logan County PSD	Big Harts Phase III Water	\$2,732,000
Logan County PSD	Phase IIIA Sewer	\$11,740,600
Logan County PSD	Phase IIIB-1 Sewer	\$5,832,276
Town of Chapmanville	Phase I Water	\$3,005,000
Town of Chapmanville	Phase II Water	\$2,529,000
Town of Gilbert	Horsepen Water	\$4,843,000
Town of Gilbert	Browning Fork Water	\$1,486,000
Town of Gilbert	River Bend Water	\$2,229,000
Town of Delbarton	WWTP Upgrade	\$10,693,420
Lubeck PSD	Lake Washington Sewer	\$3,400,000
Marshall Co Sewerage Dis	Mozart Sewer	\$8,318,507
Town of Matewan	Red Jacket Sewer	\$5,240,000
Eastern Wyoming PSD	Covel Water	\$5,719,000
Eastern Wyoming PSD	Barkers Ridge Phase I Water	\$6,655,000
Eastern Wyoming PSD	Barkers Ridge Phase II Water	\$3,020,615
Eastern Wyoming PSD	Beartown Water	\$9,410,000
Buffalo Creek PSD	WWTP Upgrade	\$14,867,700
Lincoln PSD	Lower Mud River Phase I	\$4,289,135
Lincoln PSD	Lower Mud River Phase II	\$2,337,000
Lincoln PSD	Alum Creek Sewer	\$20,000,000

### **Education**

M.S. Sanitary Engineering, VPI and State University (Virginia Tech), 1976

B.S. Civil Engineering, West Virginia Institute of Technology, 1975

### **Registrations**

Registered Professional Engineer in West Virginia

Registered Professional Surveyor in West Virginia

### **Professional Experience**

Mr. Hazelwood has more than 40 years of experience as a civil engineer with specific experience in a multitude of engineering fields. His extensive background includes water source distribution and treatment facilities, wastewater collection systems, storm water management, industrial and business parks, access roads, bridges, airports, various land development and structure renovations.

Mr. Hazelwood served as senior design engineer for 30 years vice president for 14 years for the Pentree/Thrasher Company. In the latter position, he was responsible for project design and management, quality control and construction administration.

### **Representative Projects**

Town of Union - Water System Upgrade Project (\$2 million) - Consisted of water distribution system extensions along Route 3 to Gap Mills in Monroe County, Raw spring water development, water treatment plant, and two water storage tanks.

Gap Mills PSD - Water System Upgrade and Extensions Project (\$1.7 million) - Consisted of water distribution system extensions along Moncove Lake Road, water distribution system upgrades, upgrade of raw spring water facilities, water plant building and one water storage tank.

Red Sulphur PSD - Water System Upgrade and Extensions Project Phase 1 (\$2.8 million) - Consisted of upgrading water treatment plant settling basin, raw water intake and pumping station, one water storage tank, and water distribution system extensions in the Pine Grove and Dry Pond areas.

Red Sulphur PSD - Water System Upgrade and Extensions Project Phase 2 (\$5 million) - Consisted of water distribution system extensions in the Bozoo, Cashmere, Rock Camp and Back Valley Road areas and one water storage tank.

Red Sulphur PSD - Ballard Water Project (\$0.6 million) - Consisted of water distribution system facilities to take in the Ballard Water Works system and water distribution system extensions in the Ballard area.

Red Sulphur PSD - Lindside Valley Water Project (\$2.5 million) - Consisted of water distribution system extensions to the Lindside area, 700 gpm water treatment plant, 100 gpm water treatment plant, and three water storage tanks.





Town of Union - Wastewater System Upgrade and Extensions Project (\$2 million) - Consisted of upgrades to pumping stations and generators, wastewater collection system extensions, wastewater collection and pumping system and upgrading existing 90,000 gpd wastewater treatment plant.

Town of Union - Main Street Sidewalk Streetscape Project (\$260,000) - Consisting of brick accented sidewalks, streetscaping, lighting and plantings on Main Street.

Town of Union - North Street Sidewalk Streetscape Project Phase I (\$150,000) - Consisted of brick accented sidewalks, streetscaping, lighting and plantings on North Street.

Town of Union - North Street Sidewalk Streetscape Project Phase II (\$150,000) - Consisted of brick accented sidewalks, streetscaping, lighting and plantings on North Street.

Town of Union - North Street Sidewalk Streetscape Project Phase III (\$100,000) - Consisted of brick accented sidewalks, streetscaping, lighting and plantings on North Street.

Town of Union - Fitness Trail Park Project (\$100,000) - Consisted of paved waling and biking trails, fitness stations and a parking lot near Union Health Center.

Town of Union - Log Home Relocation and Restoration Project (\$100,000) - Consisting of relocating an existing log home to the Town of Union and restoring the log home.



### **Education**

Bachelor of Science in Landscape Architecture, West Virginia University, 1976

### **Registrations**

Professional Landscape Architect in West Virginia, Kentucky, Ohio, Maryland, and Virginia

### **Professional Experience**

Mr. Nelsen has practiced landscape architecture for over 39 years principally in West Virginia but also has completed projects in Ohio, Indiana and Pennsylvania. His professional experience has afforded him opportunities to assist clients with park and recreation planning and design, community and urban planning, streetscape design, campus planning for elementary, secondary and higher education facilities and site planning and design for residential, commercial and public places. He has been involved in environmental planning and restoration especially lands degraded from past mining practices. He has managed site development on significant projects such as the Stonewall Jackson Resort and the Tamarack Art Center yet enjoys working with clients and communities assisting them visualize the improvements for their parcels and neighborhoods.

### **Representative Projects**

Clay Center for the Arts and Sciences, Charleston, WV: Prepared construction and bidding documents and provided construction administration for a new public plaza space at the corner of Leon Sullivan Way and Washington Street for Charleston's premier performing arts and science center. The site's design called creating a cool green zone for people to gather informally and as an entertainment venue for special events. The relative flat site consisted of a circular plaza and fountain surrounded by a concentric ring of granite seat walls at the edge of the pavement radiating outward into the lawn area. Large 4" and 6" caliper Linden and Honeylocust trees were planted to create a shaded canopy for the space in front of the center.

Washington Street Streetscape, Charleston's East End, WV: Prepared master plan, construction and bidding documents and provided construction administration services for the remaining segment of the Washington Street streetscape from the state Capitol grounds to Charleston Area Medical Center which entailed a ½ mile of sidewalk replacement, new street lighting, brick accent pavements, street trees, landscaping, utility line relocation and burial and new underground electrical service for 30 structures. Total budget for the project was approximately two million dollars.

Completed streetscape and sidewalk projects over the last 5 years include Mt. Hope, Ronceverte, Chapmanville, Romney, Ceredo, Kenova, Gilbert, Harrisville, Weirton, Charleston, Huntington, Parsons, and many West Virginia for approximately \$2.6 million of improvements

Rich Mountain, Laurel Hill and Corrick's Ford Civil War Battlefields, Randolph, Barbour and Tucker Counties, WV: These are three distinct battlefields but are all related to each other because they are a progression of the first major conflict in northwestern Virginia in July, 1861 between approximately 9000 Union soldiers led by General George McClellan and 5000 Confederate troops led by General Robert Garnett. The armies engaged each other at

these three locations over a week's time resulting in the defeat of the Confederate forces. This early Union victory allowed Union sympathizers in the western counties of Virginia to organize a secessionist movement to form the new state of West Virginia. Services included providing master planning, interpretation recommendations, signage and trail development for each of these sites with archeological and historical consultants on the team. The planning and design efforts of these new public lands were focused on preservation and interpretation of each site's story about West Virginia's role in the Civil War.

Tamarack Art Center, Beckley, WV: Working with the architect for the project prepared the site master plan and managed design for all exterior improvements including access road, bus and car parking, earthwork, stormwater management, utility design, pedestrian walkways and plaza spaces, fountain design, landscaping, and irrigation design. This \$20 million facility is widely recognized in West Virginia and surrounding states as one of the finest venues for West Virginia artisans.

Stonewall Jackson Resort, Roanoke, WV: In the most recent major expansion of a West Virginia State Park, assisted the developer in an unique public private partnership to build new facilities at the park which included master planning for a lodge, golf course, expanded campgrounds, cabins, expanded day use facilities, trails and other site features. Prepared documents for regulatory review by the USACOE, WVDEP, and WVDNR. Managed the development of site preparation construction documents for the lodge, golf clubhouse, cabin area, and future campground areas. Assisted the golf course design team with storm water management and permitting issues. After the completion of new facilities have continued to assist the developer on future proposed amenities for the resort.

West Side Community Renewal Plan, Charleston, WV: Working with the Charleston Urban Renewal Authority, Charleston Planning Department and community leaders on the West Side developed the largest urban renewal plan within the city encompassing 228 acres and almost 900 buildings. With assistance of a public facilitation consultant held a series of meetings with residents and business owners to gain input into their vision for the plan. The adopted recommendations identified significant public and private recommendations with the strongest focus on a new home ownership zone around the new elementary school planned on Florida Street.

Beech Fork State Park Lodge Development, Lavalette, WV: Provided feasibility studies of three different sites for new lodge for the state park beginning in 2008 through 2011. Working with WVDNR and the architectural firm ZMM of Charleston to develop a conceptual plan for the lodge and site improvements for a 75 room lodge near the lake's beach area with a total construction cost of approximately \$29 million.

### **Education**

B.S. Landscape Architecture Minor in Geography: GIS and Regional Planning and Development  
West Virginia University, 2010

### **Registrations**

Professional Landscape Architect in Ohio

### **Professional Experience**

Mr. Scott joined E.L. Robinson in August of 2016 and has since become an integral part of the design team. Prior to joining E.L. Robinson, Mr. Scott worked for a small landscape architecture firm in eastern Ohio where he was the project manager for residential projects while also working on various other projects that spanned into northern West Virginia and south-eastern Pennsylvania. Mr. Scott has experience in all phases of the design process in projects including: parks and recreation; streetscapes; commercial and residential design; civic and institutional design; botanic gardens; and trail design. Aside from working at E.L. Robinson, Mr. Scott has over twenty years of military experience and currently flies UH-60 Blackhawk helicopters for the West Virginia Army National Guard.

### **Representative Projects**

The Health Plan Corporate Headquarters - Wheeling, WV: Provided conceptual and final site designs; and prepared construction documents and bidding documents for the new corporate headquarters building in downtown Wheeling. The project consisted of a complete site design which included off-street parking, an outdoor pocket park, a sandstone and grass amphitheater and open space for outdoor exhibits. The project also included a new streetscape design which incorporated the use of bioswales which parallel between the sidewalks and on-street parking to help reduce the load on the city's storm system. The intent of the new streetscape design is to serve as the City of Wheeling's new standard for future streetscape designs.

Market Street Plaza Redesign - Wheeling, WV: Prepared construction documents and provided construction administration for the redesign of Market Street Plaza in downtown Wheeling. The redesign consisted of improving both vehicular and pedestrian traffic all while maintaining ADA standards; preserving and promoting a portion of the city of Wheeling's history and culture; and providing the area with a safe place for local businesses and their patrons to gather. The elements of the redesign consisted of new concrete sidewalks and brick paving; on-street and off-street parking; gated access for tenants; new tables and benches; historic interpretation and signage; and new planters and planting material.

Belmont County Senior Services Center - St. Clairsville, OH: Worked on all phases of the design process from conceptual design through preparing construction and bidding documents. The project consisted of a complete site design to include building location and orientation; visitor and employee parking design; vehicular and pedestrian circulation; and on-site storm water retention. The elements of the design included concrete sidewalks, bioswales, traffic signage, and planting material.



**Military Road Park - Zanesville, OH:** Worked on all phases of the design process from conceptual design, to preparing construction and bidding documents, through providing construction administration and project close-out. The design of the project was to create an accessible trail which connected to an art museum through a newly established meadow and woods; removing invasive species while reestablishing native tree species to provide a wooded area over time. The initial design elements consisted of an accessible parking space, an asphalt trail, a wood chip path, a custom-designed stream crossing, deer fencing, and new planting.

**McIntire Wildlife Park - Zanesville, OH:** Worked on all phases of the design process from conceptual design through preparing construction and bidding documents. The design consisted of a reuse of the former site of McIntire Elementary School in Zanesville to create a pocket wildlife park for the local community as well as provide outdoor classrooms and educational spaces for the local schools. The enclosed park created new off-street parking; asphalt and compacted gravel trails through the site; an outdoor amphitheater/classroom; educational gardens; a water feature to attract wildlife; and bird houses, bird baths, and bat boxes. The planting scheme for the park was designed to create a succession of landscapes which mimic the natural landscapes of central and eastern Ohio: forests, successional shrub zones, and natural meadows; all while promoting wildlife habitation.

**Seven Springs Mountain Resort Parking Plan - Seven Springs, PA:** Assisted with conceptual redesign of the main parking lot for the main lodge of Seven Springs Mountain Resort in Pennsylvania. The redesign improved vehicular and pedestrian circulation while incorporating bioswales and bioretention for storm water control.

**Romney Streetscape - Romney WV:** Prepared construction documents for a sidewalk replacement project for the town of Romney. The design improved accessibility and addressed storm water issues while remaining sensitive to some of the town's historic structures. The elements of the design consist of: concrete sidewalks, accessible curb ramps, and curbing; yard drains with underdrain; and new catch basins.

**Charleston East End Safe Routes to School - Charleston, WV:** Prepared construction documents for a sidewalk replacement project for the city of Charleston as part of the Safe Routes to School program. The elements of the design consist of: concrete sidewalks, accessible curb ramps, curbing, and new catch basins.

**Forks of Coal State Natural Area - Alum Creek, WV:** Worked on final design and prepared construction documents for a new state natural area and education center at the confluence of the Big Coal and Little Coal Rivers. The project's final design encompassed a complete site design to include: a new access road; building placement and orientation; an entry plaza and gathering space; parking lot design with bioswales and a detention basin; vehicular and pedestrian circulation; an outdoor amphitheater/classroom with accessible seating and an accessible trail with retaining walls for access; and a new entry sign.

### **Education**

A.A.S. Architectural Drafting Technology, West Virginia State College, 1999

A.A.S. Computer Aided Drafting and Design, West Virginia State College, 1999

### **Computer Skills**

ArcView 10.1, AutoCAD, AutoCAD Map, MicroStation, Microsoft Office, Civil 3-D, ESRI, GIS

### **Professional Experience**

Mr. Garnes has more than 15 years of experience as a civil draftsman and designer. He is proficient in numerous drafting and mapping software platforms. His proficiency spans multiple areas such as Civil 3D, GIS, construction inspection, waterline planning and design, sanitary sewer planning and design, site development, cathodic protection planning, county-wide planning, infrastructure cataloging, and document preparation.

### **Representative Projects**

Kermit Bypass – Core Drilling Inspector

Robinson Creek Bridge – Core Drilling Inspector

Rahall Transportation Institute Land Use Master Plans – Boone, Clay, Fayette, Lincoln, Logan, McDowell, Mercer, Wayne, Wyoming, Raleigh, Upshur, Webster, and Marshall Counties

GIS – Marshall County 10 Year Comprehensive Water and Sewer Study

GIS – Brooke County Land Use Inventory

B&H Towing Project

Town of Gilbert

- Slabtown, Tamcliff and Paynter Bottom Waterline Extension Project
- Horsepen, Gilbert Creek and Browning Fork Waterline Extension
- River Bend Road Waterline Extension
- Upper Gilbert Creek Waterline Extension

Logan County PSD

- Upper Little Harts Creek Waterline Extension
- Big Harts Creek Waterline Extension
- Marsh Fork Waterline Extension
- Hidden Valley/Airport Road Waterline Extension
- Ridgeview Sewer – Railroad Permits

Lincoln PSD

McCorkle Railroad Crossing

Lincoln EDA

Lower Mud River Waterline Extension

Queen Shoals PSD Waterline Extension

Town of Chapmanville Water Upgrade Project

West Virginia American Water

Sanderson/Dutch Ridge Waterline Extension

Miller Mountain Waterline Extension

Upper Winifrede Waterline Extension

Mingo County Redevelopment Authority

King Coal Highway Water and Sewer Project

Mingo Central High School Water and Sewer Project

Mingo County Airport Water and Sewer Project

Putnam County Development Authority

Putnam County Business Park Utilities Extension Project

Norton Harding Jimtown PSD

Scott Run/Findley Road Waterline Extension Project

Town of Matewan

Red Jacket Sanitary Sewer Upgrade Project

South Charleston Sanitary Board

Corridor G Sanitary Sewer Study

Enervest

Ravencliff Operations System Inventory and Monitoring

Chester Engineers

Bluescape Pipeline Cathodic Protection System

Crestwood Midstream Partners, LLC



Doddridge and Harrison County Pipeline Close Interval Survey GIS Mapping

### **Education**

Drafting CADD Certificate (Microstation), Ben Franklin Career and Technical Center, 2000

CADD Certificate (Autocad), Carver Career and Technical Center, 1999

### **Professional Experience**

Mr. Fore has over 15 years of experience as a CAD Designer in numerous areas of civil engineering. His representative experience includes civil site development, water and wastewater line treatment plants, abandoned mine lands reclamation, highway design, bridge inspection, utility location and mapping, hydrographic surveying, land surveying, environmental, wind energy and water sampling.

He is adept in AutoCad Civil 3D (Version 2006 thru 2015). Further proficiency includes Autocad Land Desktop, Microstation, Inroads, Autodesk Vault Explorer, Eagle Point, TGO, Pathfinder Office, Hydro-Pro, Microsoft Access, Excel and Word. He provides training/support and workstation configuration, as well as data management of CAD and GIS related material.

### **Representative Projects**

The Village at Coolfront, Morgan County, WV

Green Valley Glenwood PSD Raw Water System Upgrade, Mercer County, WV

Mason Wastewater Treatment System Improvements, Mason County, WV

Buffalo Wild Wings, Nitro, WV

Village of Cadiz North Trunk Line Wastewater Improvements, Harrison County, OH

East Bank Water System Improvements, Kanawha County, WV

The Summit at Cheat Lake, Monongalia County, WV

William Fitzpatrick Subdivision, Lawrence County, OH

East Bank Water System Improvements, Kanawha County, WV

HSB 13th and 19th Street Sanitary Sewer Line Replacement, Huntington, WV

Cabell Huntington Hospital Slide, Huntington, WV

Merritt's Creek Landslide Abatement Project, Cabell County, WV

Lick Creek Waterline Extension Phase 2, Boone County, WV

Six Mile Creek Waterline Extension, Boone County, WV

WVDEP AML Rachel Refuse, Marion County, WV





### **Education**

A.S. Mechanical Engineering, West Virginia Institute of Technology, 1970

### **Registrations**

Registered Professional Surveyor in West Virginia

### **Professional Experience**

Mr. Rayburn currently serves as Manager of Surveying for E.L. Robinson Engineering (ELR) and has more than 30 years of Design Surveying and Construction Surveying experience. The responsibilities include management of surveying and control for various design projects, including highways, buildings, and bridges. In addition, Mr. Rayburn manages and performs work consisting of courthouse research for property ownership resolution for the above mentioned project types. This includes preparation of property resolution maps, deed descriptions for property acquisitions required for project plan preparation. Mr. Rayburn has experience in Geodetic Control Surveys, 3D Laser Scanning, Photogrammetric Control, Topographic Surveys, Cemetery Surveys, Boundary Surveys, Construction Stakeout, Subdivision Surveys, along with Hydrographic surveys of river and lake bottoms. A few of the more notable surveying projects performed by ELR under the supervision of Mr. Rayburn, has been the Blennerhassett Bridge Project, 11 continuous miles of Corridor H design surveys, GPS Control for the West Virginia Statewide Mapping and Addressing PSD Project, 3D Laser Scan and mapping of the CAMC Parking Garage partial collapse, and 3D Laser Scanning of I64/I77 Retaining Wall for Monitoring.

### **Representative Projects**

#### Design Surveys:

Corridor H (WVDOT) Hardy County, WV: Lead Surveyor for Design Surveys, Right of Way Staking, etc. for approximately 11 miles of Corridor H in Hardy County, WV. This was for Sections 6 & 7 of Corridor H, both Sections of which are now under construction. Estimated construction cost of \$150 million dollars.

WV Route 10 (WVDOT) Logan to Man WV, Logan County, WV: Lead Surveyor for Design Surveys for a section approximately five miles in length from Man, WV, to Rita, WV, including the Man Bridge. Also provided control surveying for the entire project length of approximately 12 miles. The approximate five miles section of roadway is now under construction at an estimated cost of \$51 million dollars.

Blennerhassett Bridge, Corridor D (WVDOT), Wood County, WV: Lead Surveyor for Design Surveys for this landmark Bridge Project which is now under construction at an estimated cost of \$120 million dollars.

James Ramsey Bridge (WVDOT) Potomac River, Shepardstown, WV: Lead Surveyor for Design Surveys for this Bridge Project which is now completed at an estimated cost \$15.5 million dollars. This project involved working in an environmentally historic area, which adjoined a National Park.



US Route 35 (WVDOT) Mason County, WV: Lead Surveyor for Design Surveys for two Design Sections each approximately 2.5 miles in length from Lower Five Mile Road to Upper Nine Mile Road. Also provided control surveying for the entire US 35 design project length of approximately 22 miles.

I64/US 35 (WVDOT) I64 to US 34 Crooked Creek, Putnam County, WV: Lead Surveyor for Design Surveys, Right of Way Staking, etc. for approximately four miles of US 35 including Interstate 64 Ramps and Flyovers in Putnam County, WV. This included the I64 Bridges and Flyovers, which is now under construction.

ATB-Parrish Road (ODOT) Ashtabula County, Ohio: Project Design Surveyor for rail grade separation project. Project involved roadway realignment, 900' new bridge, new waterline, storm and sanitary sewers. Project is currently under construction. Estimated construction cost: \$8.6 million.

PIC-23-3.21 and Various (ODOT) Pickaway County, Ohio: Project Design Surveyor for ODOT Project PIC-23-3.21 and Various. Project involves deck replacements along 11 miles of US 23 in Pickaway County. Project includes large diameter culvert liner, interchange upgrade that includes mainline profile correction, ramp reconstruction, and addition of barrier wall and storm drainage. Project is currently under design (90%). Project scheduled for construction in 2007. Estimated construction cost: \$12 million.

ATB-90-22.06 (ODOT) Ashtabula County, Ohio: Project Design Surveyor for Interstate Reconstruction Project. Project includes total pavement replacement, bridge widening, and contra - crossover maintenance of traffic, culvert replacements and storm sewer rehabilitation and sign replacements. Project is currently under design (50%) and scheduled for construction in 2011. Estimated construction cost: \$36 million.

#### Construction Surveys:

Corridor D (WVDOT) Wood County, WV: Lead Surveyor for Highway/Bridge Construction Monitoring surveys for the following segments of Corridor D and related relocation projects:

Godbey Athletic Field Relocation Construction

Godbey Colt Field and Soccer Field Construction

West WV 47-East WV 47 Highway/Bridge Construction

East Buckeye-West Little Kanawha River Highway/Bridge Construction

Interstate I-79 Widening and Median Barrier (WVDOT) Harrison County, WV: Lead Surveyor for construction layout surveys for the widening of I-79 from the Meadowbrook Exit, north to the Jerry Dove Exit approximately three miles in length, as a subcontractor to the prime contractor.

CAMC 33rd Street Relocation and Building Expansion, Charleston, WV: Lead Surveyor for construction layout surveys for 33rd Street relocation along with ancillary items including sidewalks, drainage and utilities. Also layout surveys for building expansion project.



J. TOM RAYBURN, P.S.  
(CONTINUED)



Saturn Dealership, Hurricane, WV: Lead Surveyor for Saturn Dealership site development and access roads at Hurricane Interchange of Interstate 64.

Arch Coal WV Mining Operations: Lead Surveyor as a subcontractor to Arch Coal operations for Valley Fill Construction (Up to 27 million cubic yard fills), mine haul road layout, drill line staking, and dragline pit layout.

**Professional Memberships**

American Congress on Surveying and Mapping

The American Association for Geodetic Surveying (AAGS)

Member Organization of ACSM.

Cartography and Geographic Information Society (CaGIS)

Geographic and Land Information Society (GLIS)

National Society of Professional Surveyors (NSPS)

West Virginia Association of Land Surveyors, Inc.



### **Education**

High School Diploma, Sissonville High School, 1978

### **Professional Experience**

Mr. Williams has been employed at ELR since 1978. Mr. Williams has had primary responsibility for the inspection of water, wastewater, and gas line construction and drilling projects.

Waterline projects he has inspected include: Cooper's Creek, Oak Hill, Uneda/Quinland, Town of Danville, Southern PSC, South Putnam PSD, Kanawha Orchard PSD, Webster County Commission, Kanawha County's 1997 Water Extension projects and most recently RDA 1999 water extension projects.

He has also inspected the construction of sanitary sewer installation for the City of Charleston, Greater St. Albans PSD and South Putnam PSD.

Mr. Williams has inspected the construction of storm sewers for the City of Charleston and the City of Parkersburg. He has also inspected the relocation of gas lines for the Southern PSC and Consumer's Gas.

Mr. Williams has been involved both as a surveyor and inspector on all major projects performed by ELR. Mr. Williams has performed extensive courthouse research on numerous survey projects and is responsible for the field work associated with the AML projects.

### **Representative Projects**

Sewer Installation for the Town of Debarton

Sewer Installation for the City of Gilbert

Sewer Installation for the City of Weston

Highway Construction Inspection on Corridor D in Parkersburg, WV

Construction of water and sewer lines for South Putnam PSD on Teays Valley RD+1 and 34 Widening in Scott Depot

Inspected replacement of sewage treatment plant at Holly River State Park

Inspected construction of a storm sewers in Charleston and Parkersburg

Inspected relocations of gas and waterlines for Southern PSD for the construction of U.S. 119 in Holden

Inspected relocation of gas lines for Consumers Gas on Docks Creek, Whites Creek and Harrisville



### **Education**

Carver Career Center, 1975

### **Professional Experience**

Mr. Casto spent 14 years of his 30 year career with the WVDOT District I office before joining ELR in 2000. He has vast experience in many areas of inspection with an emphasis in both infrastructure and roadway projects. He has inspected numerous water, wastewater, roadway, and site development projects throughout the State of West Virginia.

### **Representative Projects**

Mr. Casto has worked as Lead Field Inspector for the following projects:

Corridor D- 5 separate projects which included 9 bridges with construction of all phases.

Earl Ray Tomblin Industrial Park – Installation of storm and sanitary sewer, water line and construction of roadway, curbs, gutters and lighting.

Charleston Area Medical Center Memorial Division, Charleston, WV – Two construction projects that required roadway construction, storm sewer, sanitary sewer and water line relocation work of 33rd Street replacement.

Chief Logan State Park, Logan, WV – Inspected excavation and compaction of materials in preparation of building pad for recreational center.

Charles Pointe – North Land Bay Phase I & II – Installation of storm and sanitary sewer, water line construction, curbs, lighting and roadway construction.

Charles Pointe – South Land Bay – Installation of storm and sanitary sewer, water line construction, curbs, lighting and roadway construction.

Jolo Phases 3 and 4 Water Project - Inspected construction of extension of water system to serve various areas around the community of Jolo.

West Hamlin Sewer Line Replacement and Sludge Removal Project - Cleaning and removal at the waste pond , replacement of sewer lines and manholes.

Hammond PSD - Project consisted of inspection of all phases of extending waterline to WV Route 2 in Brooke County.

Mingo County PSD Dingess Phase I & II - Project consisted of inspection of all phases waterline extension

Eastern Wyoming PSD Otsego Water Project- Project consisted of inspection of all phases waterline extension

Eastern Wyoming PSD Bud/Alpaca Water Project - Project consisted of inspection of all phases waterline extension





## Experience

Mr. Harper brings 16 years of design experience to the firm. He has expertise with HVAC, electrical, plumbing, sprinkler and fire alarm system designs. His projects include educational facilities (including colleges and universities), health care facilities, office buildings, banks, emergency services facilities, postal facilities, and government buildings.

Mr. Harper's role with the firm includes, but is not limited to, office manager, project manager, draftsman, and Building Information Modeling coordinator. He oversees projects from the early design phase through construction administration to post construction. He assists the project architect and design team with valuable mechanical, electrical, and plumbing information early in the project to ensure it is adequately designed to handle the client's needs.



## Projects

HVAC Additions to Taylor County Middle School  
Poca High School Elevator Addition  
Chapmanville Intermediate School  
Burch PK-8 School  
Lewis County Transportation Facility  
HVAC Renovations to Tucker County High School  
South Preston PK8 School  
Arnoldsburg Elementary School  
Additions and Renovation to Geary School  
Tunnelton Denver Elementary School  
HVAC Systems Renovations to  
Upshur County Elementary Schools  
Additions and Renovations to Flinn Elementary

## Registration/Professional Affiliations

Professional Engineer WV - [REDACTED]  
American Society of Heating, Refrigeration and Air-  
Conditioning Engineers [REDACTED]  
National Fire Protection Association - [REDACTED]

## Education

West Virginia University Institute of Technology  
Bachelor of Science - Mechanical Engineering



## Experience

Mr. King brings 14 years of electrical design experience and over 11 years of electrical construction/maintenance experience to the firm. His projects include educational facilities (including colleges and universities), health care facilities, office buildings, banks, emergency services facilities, government buildings, and industrial projects.

Mr. King's role with the firm includes, but is not limited to, project manager, draftsman, specification writer and construction administration. He oversees projects from the early design phase to post construction. He assists the project architect and design team with valuable electrical information early in the project to ensure it is adequately designed to handle the client's needs.



## Registration/Professional Affiliations

Professional Engineer WV - [REDACTED]

Professional Engineer KY - [REDACTED]

Professional Engineer PA - [REDACTED]

Professional Engineer OH - [REDACTED]

Professional Engineer VA - [REDACTED]

Professional Engineer MI - [REDACTED]

Professional Engineer SC - [REDACTED]

Professional Engineer IN - [REDACTED]

West Virginia Master Electrician - [REDACTED]

American Society of Heating, Refrigeration and

Air-Conditioning Engineers - [REDACTED]

National Fire Protection Association - [REDACTED]

## Projects

FedEx Freight - 32 Bay Expansion

Arnoldsburg Elementary School

Chapmanville Intermediate School

South Charleston Fire Station

Geary Elementary School

Holden Elementary School

Hurricane High School Batting Facility

Marshfork Elementary School

Tudor's/Gino's Restaurants (Various Location)

Additions and Renovations to Flinn Elementary

## Education

West Virginia University Institute of Technology

Bachelor of Science - Electrical Engineering

Bluefield State College

Bachelors of Science - Computer Science

**Hatfield McCoy Offices  
Ashland Trailhead**

- Renovations  
- New

**Mr. Jeffery Lusk**, Executive Director  
Hatfield McCoy Trail Regional Authority  
PO Box 146  
Man, WV 25635  
304-752-3255

**Ashland Cabins & Bathhouse**

- New

**Ms. Tara Elder**  
The Ashland Group  
12 Maddy's Lane  
Elkview, WV 25071  
304-237-7567

**The Summit Bechtel Family National Scout Reserve**

- New

**Mr. Rob Ridgeway**, Project Manager  
Boy Scout National Scout Reserve  
2550 Jack Furst Drive  
Glen Jean, WV 25846  
304-465-2800



## REFERENCES



**Mr. Jimmy Nichols**

Town of Rupert  
Drawer B  
Rupert, WV 25984  
(304) 392-5682  
townofrupert@suddenlinkmail.com

**Mr. J.B. Heflin**

Mingo County Public Service District  
1 Riverside Drive  
Naugatuck, WV 25685  
(304) 235-2244  
jhbheflin@suddenlinkmail.com

**Mr. Mike McNulty**

Putnam Public Service District  
107 South Poplar Fork Road  
Scott Depot, WV 25560  
(304) 757-6551  
mikemcnulty@putnampsd.com

**Mr. William Baisden**

Logan County Public Service District  
P.O. Box 506  
Logan, WV 25601  
(304) 946-2641  
wb@lcpd.com

**Mr. Rodney Pritt**

Flatwoods Canoe Run PSD  
406 Main Street  
Sutton, WV 26601  
(304) 765-2300  
fcrpsd@yahoo.com

**Mr. Lloyd Coleman**

Pocahontas County PSD  
14066 Back Mountain Road  
Bartow, WV 24920  
(304) 572-2566  
lcoleman@pcpsd.org

**Ms. Mavis Brewster**

McDowell County Public Service District  
21901 Rocket Boys Drive  
Welch, WV 24801  
(304) 297-2622  
mcdpsd@frontiernet.net

**Mr. Jim Boggs**

Wayne County Commission  
700 Hendricks Street  
Wayne, WV 25570  
(304) 272-6350  
jimmyboggs@waynecountywv.org

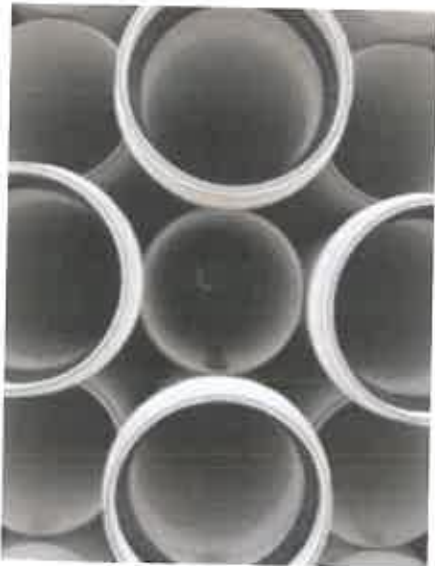



Purchasing Division  
 2019 Washington Street East  
 Post Office Box 50130  
 Charleston, WV 25305-0130

State of West Virginia  
 Centralized Expression of Interest  
 02 - Architect/Engr

Proc Folder: 426022

Doc Description: A&E SVC for facilities Summersville Lake & Frozen Camp WMA

Proc Type: Central Contract - Fixed Amt

Date Issued	Solicitation Closes	Solicitation No	Version
2018-02-23	2018-03-29 13:30:00	CEOI 0310 DNR1800000004	1

**BID RECEIVING LOCATION**

BID CLERK  
 DEPARTMENT OF ADMINISTRATION  
 PURCHASING DIVISION  
 2019 WASHINGTON ST E  
 CHARLESTON WV 25305  
 US

**VENDOR**

Vendor Name, Address and Telephone Number:

**E.T. Boggess Architect, Inc.**  
 PO Box 727 101 Rockledge Avenue  
 Princeton, WV 24740 304-425-4491

**FOR INFORMATION CONTACT THE BUYER**

Guy Nisbet  
 (304) 558-2596  
 guy.l.nisbet@wv.gov

Signature X

FEIN #

55-0515917

DATE

March 27, 2018

All offers subject to all terms and conditions contained in this solicitation

**DESIGNATED CONTACT:** Vendor appoints the individual identified in this Section as the Contract Administrator and the initial point of contact for matters relating to this Contract.

Todd Boggess, President  
 (Name, Title) Todd Boggess, President  
 (Printed Name and Title)  
PO Box 727, Princeton, WV 24740  
 (Address)  
(P) 304-425-4491 / (F) 304-425-2028  
 (Phone Number) / (Fax Number)  
etb@etbarchitects.com  
 (email address)

**CERTIFICATION AND SIGNATURE:** By signing below, or submitting documentation through wvOASIS, I certify that I have reviewed this Solicitation in its entirety; that I understand the requirements, terms and conditions, and other information contained herein; that this bid, offer or proposal constitutes an offer to the State that cannot be unilaterally withdrawn; that the product or service proposed meets the mandatory requirements contained in the Solicitation for that product or service, unless otherwise stated herein; that the Vendor accepts the terms and conditions contained in the Solicitation, unless otherwise stated herein; that I am submitting this bid, offer or proposal for review and consideration; that I am authorized by the vendor to execute and submit this bid, offer, or proposal, or any documents related thereto on vendor's behalf; that I am authorized to bind the vendor in a contractual relationship; and that to the best of my knowledge, the vendor has properly registered with any State agency that may require registration.

E.T. Boggess Architect, Inc.  
(Company)

  
Todd Boggess, President  
(Authorized Signature) (Representative Name, Title)

Todd Boggess, President  
(Printed Name and Title of Authorized Representative)

March 27, 2018  
(Date)

(P) 304-425-4491 / (F) 304-425-2028  
(Phone Number) (Fax Number)

West Virginia Ethics Commission  
**Disclosure of Interested Parties to Contracts**

(Required by W. Va. Code § 6D-1-2)

Contracting Business Entity: E.T. Boggess Architect, Inc. Address: PO Box 727, 101 Rockledge Avenue  
Princeton, WV 24740  
Authorized Agent: Todd Boggess Address: 101 Rockledge Ave., Princeton, WV  
Contract Number: DNR1800000004 Contract Description: Facilities at Summersville Lake & Frozen Camp WMAs  
Governmental agency awarding contract: WVDNR

Check here if this is a Supplemental Disclosure

List the Names of Interested Parties to the contract which are known or reasonably anticipated by the contracting business entity for each category below (attach additional pages if necessary):

1. Subcontractors or other entities performing work or service under the Contract

Check here if none, otherwise list entity/individual names below.

Harper Engineering (St. Albans) and EL Robinson (Charleston)

2. Any person or entity who owns 25% or more of contracting entity (not applicable to publicly traded entities)

Check here if none, otherwise list entity/individual names below.

Todd Boggess

3. Any person or entity that facilitated, or negotiated the terms of, the applicable contract (excluding legal services related to the negotiation or drafting of the applicable contract)

Check here if none, otherwise list entity/individual names below.

Signature:  Date Signed: March 27, 2018

**Notary Verification**

State of West Virginia, County of Mercer:

I, Todd Boggess (Todd Boggess), the authorized agent of the contracting business entity listed above, being duly sworn, acknowledge that the Disclosure herein is being made under oath and under the penalty of perjury.

Taken, sworn to and subscribed before me this 27th day of March, 2018

  
Notary Public's Signature

**To be completed by State Agency:**

Date Received by State Agency: \_\_\_\_\_

Date submitted to Ethics Commission: \_\_\_\_\_

Governmental agency submitting Disclosure: \_\_\_\_\_

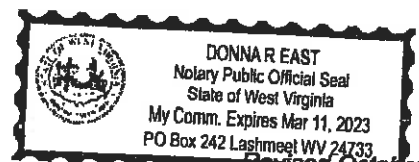

STATE OF WEST VIRGINIA  
Purchasing Division

**PURCHASING AFFIDAVIT**

**CONSTRUCTION CONTRACTS:** Under W. Va. Code § 5-22-1(i), the contracting public entity shall not award a construction contract to any bidder that is known to be in default on any monetary obligation owed to the state or a political subdivision of the state, including, but not limited to, obligations related to payroll taxes, property taxes, sales and use taxes, fire service fees, or other fines or fees.

**ALL CONTRACTS:** Under W. Va. Code §5A-3-10a, no contract or renewal of any contract may be awarded by the state or any of its political subdivisions to any vendor or prospective vendor when the vendor or prospective vendor or a related party to the vendor or prospective vendor is a debtor and: (1) the debt owed is an amount greater than one thousand dollars in the aggregate; or (2) the debtor is in employer default.

**EXCEPTION:** The prohibition listed above does not apply where a vendor has contested any tax administered pursuant to chapter eleven of the W. Va. Code, workers' compensation premium, permit fee or environmental fee or assessment and the matter has not become final or where the vendor has entered into a payment plan or agreement and the vendor is not in default of any of the provisions of such plan or agreement.

**DEFINITIONS:**

"Debt" means any assessment, premium, penalty, fine, tax or other amount of money owed to the state or any of its political subdivisions because of a judgment, fine, permit violation, license assessment, defaulted workers' compensation premium, penalty or other assessment presently delinquent or due and required to be paid to the state or any of its political subdivisions, including any interest or additional penalties accrued thereon.

"Employer default" means having an outstanding balance or liability to the old fund or to the uninsured employers' fund or being in policy default, as defined in W. Va. Code § 23-2c-2, failure to maintain mandatory workers' compensation coverage, or failure to fully meet its obligations as a workers' compensation self-insured employer. An employer is not in employer default if it has entered into a repayment agreement with the Insurance Commissioner and remains in compliance with the obligations under the repayment agreement.

"Related party" means a party, whether an individual, corporation, partnership, association, limited liability company or any other form or business association or other entity whatsoever, related to any vendor by blood, marriage, ownership or contract through which the party has a relationship of ownership or other interest with the vendor so that the party will actually or by effect receive or control a portion of the benefit, profit or other consideration from performance of a vendor contract with the party receiving an amount that meets or exceeds five percent of the total contract amount.

**AFFIRMATION:** By signing this form, the vendor's authorized signer affirms and acknowledges under penalty of law for false swearing (W. Va. Code §61-5-3) that: (1) for construction contracts, the vendor is not in default on any monetary obligation owed to the state or a political subdivision of the state, and (2) for all other contracts, that neither vendor nor any related party owe a debt as defined above and that neither vendor nor any related party are in employer default as defined above, unless the debt or employer default is permitted under the exception above.

**WITNESS THE FOLLOWING SIGNATURE:**

Vendor's Name: E. T. Boggess Architect, Inc.

Authorized Signature: *[Handwritten Signature]*

Date: March 27, 2018

State of West Virginia

County of Mercer, to-wit:

Taken, subscribed, and sworn to before me this 27 day of March, 2018.

My Commission expires March 11, 2023.

AFFIX SEAL HERE

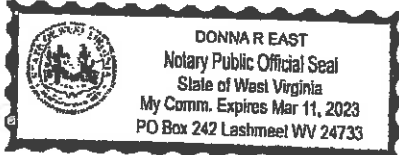

NOTARY PUBLIC

*[Handwritten Signature]*