

EOI  
WEST VIRGINIA  
DIVISION OF NATURAL RESOURCES  
STATE PARK MODEL CABIN  
RENOVATION PROJECT  
DNR 1600000009



12/01/15 10:43:16  
WV Purchasing Division



602 Virginia St. E. Suite 102  
Charleston, WV 25301  
Phone: 304.343.9080  
Email: Aric@MargolisArch.com

November 30, 2015

Department of Administration, Purchasing Division  
2019 Washington Street East  
Charleston, WV 25305-0130

Dear Review Committee:

Aric Margolis Architecture and its selected design team is pleased to have the opportunity to submit this proposal for providing architectural / engineering services for the State Park Model Cabin Renovation Project at Watoga State Park and Cass, WV. We feel confident our design team is uniquely qualified to provide design services for the project and feel a team approach between WV DNR and its architects / engineers is the key to the successful completion of your project.

Aric Margolis Architecture is pleased to present a proposal outlining technical expertise, management, staff capabilities and experience for providing high quality architectural services. Our approach will offer advantages in methodology and delivery that will guarantee the success of your project both now and for years to come. My firm is capable of providing full architectural design services and has a long list of sub-consultants that provide civil, mechanical and electrical engineering services to complete the design package. I have provided full architectural design services to multiple State Agencies. During that time, I have had the opportunity to complete many building designs as represented in the enclosed profiles.

As with many architectural firms in West Virginia, Aric Margolis Architecture has teamed with consultants for the required various trades to provide the owner with a complete turnkey project. These consultants have been selected based on past performance, design expertise and familiarity with the region to provide a cost affective, efficient and reliable team. The team consists of Terradon Corporation for Civil / Site design services. Moment Engineers for Structural Engineering. Harper Engineering will provide Plumbing, Mechanical and Electrical Engineering services. Their profiles are included in this package.

The following shall serve as an outline to the project specifications:

#### Qualifications and Experience:

A team has been assembled to provide A/E services based on the expected scope of work. Attached to this document are the individual firm profiles for each discipline outlining their capabilities and project experience. Aric Margolis Architecture will be the architect on the project and the prime contact with the client. Terradon Corporation will provide Civil Engineering services. Moment Engineers will provide structural Engineering Services. Harper Engineering will provide Plumbing, Mechanical and Electrical engineering services.

3.1.a Communication on the project will begin between the DNR representative assigned to the project and the architect. As the project leader, the architect will disseminate the correspondence to the other team members. If any information is passed on directly to the other team members either during design or construction, the procedure set up will be to pass that information along to the team leader so that all information can be tracked. It will be up to the team leader to track all of the information so that it is properly organized and distributed as needed. This information will then be further passed along to the owner (if not originated by owner) so that the owner is kept up to date.

3.1.b Within the attached project profiles you will find an array of projects both in size and scope that have been built per the owner's budget. Furthermore, I would propose that we hire an independent professional estimator that has experience in this region. This independent estimator will help insure that the project bids come within budget. I have used this method before and it is very successful.

3.1.c In order to assure that the construction time is met, the team shall put together a plan that combines a realistic time schedule as well as liquidated damages. Unlike the private sector, the State cannot always pick who the contractor will be. That is why a realistic time schedule based on the size of the project, expected trades on the job, and location of the project must be considered. The estimator hired for the project will also be asked to timeline the project.

3.1.d See attached firm profiles showing the range of projects for the design team.

Teamwork is the spirit and foundation of a successful project. We acknowledge the importance of a quick turnaround and excellent quality of services which our administrative procedures, overall organization and depth of experience provides you. As you will see from our resumes and company experience, we are uniquely qualified to offer the professional services required and to ensure that your project becomes a success. We want to emphasize that your project is very important to our design team and look forward to personally discussing our qualifications to complete this project to the very highest standards, on time and within budget. Should you have any questions regarding this proposal, please do not hesitate to contact us.

Sincerely,



Aric L. Margolis, AIA



"We shape our buildings, thereafter they shape us." Winston Churchill



#### about

Aric Margolis Architecture, PLLC was founded in the Fall of 2012. Aric has worked in the field of architecture for over 18 years and has a tremendous amount of experience in a variety of areas and in different capacities. A native Charlestonian, Aric's office is conveniently located in the historic Woodrums Building in downtown Charleston. Aric is licensed to practice in West Virginia, Kentucky and is NCARB certified, allowing licensure in other states. Aric has worked on projects throughout the State of West Virginia. He is dedicated to enhancing the beauty of our state through his craft, and he loves what he does for a living. Aric earned a Bachelor of Environmental Design in Architecture from the University of Colorado. While at Colorado, he entered the Denmark International Study program and spent 6 months studying in Europe. Aric also earned a Bachelor of Architecture from North Carolina State University and returned to West Virginia in 1996. Aric has served on the City of Charleston Municipal Planning Commission since 2002. He is also past members of the Friends of Clay Center Board, Big Brothers Big Sister Myrtle Beach Dinner Dance, and Museum in the Community.

#### design approach

Aric Margolis Architecture, PLLC believes in client-centered representation. Flexible and accessible, Aric will work tirelessly to ensure client satisfaction. Aric feels design is not a one size fits all. Every project brings unique situations. It is important to listen and understand the problems before coming to the solution. All projects must begin with a development of a compilation of the needs and wants of the client. Through dialogue, the owner and architect create an understanding of the important parameters within a project. Within those parameters, the Architect is charged with developing aesthetically pleasing, cost-conscious solutions.

#### collaboration

Like most architectural firms, Aric has developed strong relationships with several engineering firms. He considers all talented firms and tailors firm selections based on the specific project.

**COMMERCIAL • MEDICAL • EDUCATIONAL • RETAIL • RELIGIOUS • MULTIFAMILY • RESIDENTIAL**

ARIC MARGOLIS ARCHITECTURE, PLLC 602 VIRGINIA ST. E SUITE 102 CHARLESTON, WV 25301

p. 304.343.9080 email: Aric@MargolisArch.com



## PROJECT PROFILES

602 VIRGINIA ST. E SUITE 102  
CHARLESTON, WV 25301  
p. 304.343.9080  
email: Aric@MargolisArch.com  
www.MargolisArch.com



### **Buckskin Council Service Center**

Addition and Renovation to current Service Center

8,000 Square Feet of New + 6,000 Square Feet of Renovated Construction

The Boy Scout service center is a 1978 building that no longer meets the needs of the user. The existing building is to be completely renovated, both inside and out and addition will provide much needed meeting space.

This building is set to break ground in October 2015

Aric Margolis Architecture, PLLC is the Project Architect



### **St. Johns United Methodist Church**

New Multi-Purpose Building & Entrance

13,200 Square Feet of New + 26,800 Square Feet of Renovated Construction

The church was in need of expanded facilities. This project re-purposed existing space in order to save cost so that a new Multi-purpose building could be constructed. Project was completed in 2014

Aric Margolis Architecture, PLLC was the Project Architect

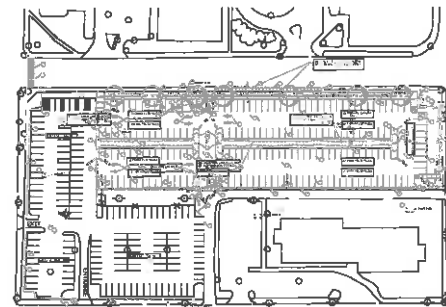

### **CAMC: Parking lot Expansion**

New 185 Car Parking lot

Aric Margolis Architecture oversaw the Coordination, Bidding & Construction of the much needed parking lot expansion for CAMC. Project also used rain garden principals to minimize effects of run-off

Aric Margolis Architecture, PLLC was the Project Architect



### **Glenville State College: Goodwin Hall**

New 6 Story - 484 Bed Residence Hall

120,566 Square Feet

This project, built on a steep hill, was constructed of light gauge steel framing as well as load bearing concrete and steel framing. The project provided much needed, updated housing for the campus. Construction Cost over \$20 million

Aric Margolis was Project Architect while at Associated Architects.



### **Glenville State College: Pioneer Center**

2 Story, 120,000 Square Feet

3000 seat gymnasium and education building

This project was a new multi-purpose facility housing locker rooms, Athletic offices, weight room, indoor walking track, presidents suite and semi-attached 2 story education building.

Aric Margolis was Project Architect while at Associated Architects.



## PROJECT PROFILES

602 VIRGINIA ST. E SUITE 102  
CHARLESTON, WV 25301  
p. 304.343.9080  
email: Aric@MargolisArch.com  
www.MargolisArch.com



### University of Charleston: East Hall

New 4 Story - 49 Apartments & 524 car parking

This project provided new apartment style housing and much needed parking for the Campus. The design wrapped the apartment building around 3 sides of the parking structure while maintaining the campus aesthetics. Each floor of the garage aligns with the apartment floors, allowing for direct access.

Aric Margolis was Project Manager while at Associated Architects.

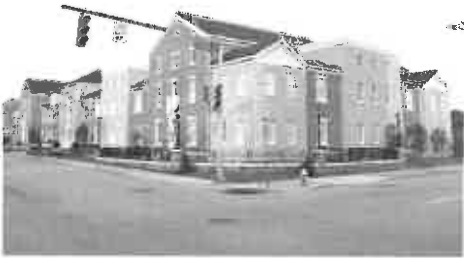

### Charleston Medical Center Housing Corporation

Jefferson Place

24 Unit Apartment Building .

This complex serves resident doctors for CAMC. Project incorporated materials from the surrounding neighborhood to give it a classic feel.

Aric Margolis was Project Manager while at Associated Architects.

#### Other notable projects while at Associated Architects:

##### As Project Architect:

- University of Charleston: Renovations for New Physicians Assistant program
- CAMC Orthopedic Trauma Group: 8000 Square Feet expansion of existing Office Space
- Dr. Grant Mason: Renovation to existing facility for Dental office
- Raleigh Regional Cancer Center: Renovations to existing building
- Crestview: New 3 Story, 48 - Unit Apartment Building, 49,473 Square Feet
- Willow Tree II: New 3 Story, 48 - Unit Apartment Building, 47,581 Square Feet
- Lowenstein Building: Renovations to historic building for Commercial & Residential use
- Kanawha Stone: New 2 Story Office Building
- Dollar General Washington St. E: New Retail Store
- Raleigh Mall: Demolition and Renovation to Existing Facility

##### As Project Manager:

- University of Charleston: Middle Hall - 5 Story - 240 bed residence hall, 62,715 Square Feet
- DEP: New 3 Story - 120,000 Square Feet Office Building, LEED Silver
- University of Charleston: Rattie Hall - 4 Story - 180 bed residence hall, 47,352 Square Feet
- B'nai Jacob Synagogue: - 1 Story addition used for Meeting & Dining Space
- Marshall University Parking Garage: 5 Story - 1009 car parking
- Joe Holland Service Center: 1 Story 44,000 square foot service center
- Northgate Business Park: Sports Medicine, Ticketmaster, Thrasher Engineering, Forbes Building

#### References:

Tom Ratliff - Glenville State College - Director of Facilities - 304.462.6241  
Cleta Harless - University of Charleston - VP Admin. & Finance - 304.357.4736  
Karen Seim - CAMC - Property Management - 304.388.9660

# RESUME

**Aric L. Margolis**

AIA, NCARB  
Principal, Owner



## Professional Experience

Aric Margolis Architecture, PLLC  
Principal, Owner (August 2012 - Present)

Associated Architects, Inc.  
Project Architect (1996 - 2012)

## Education

Bachelor of Architecture  
North Carolina State University - 1996

Bachelor of Environmental Design in Architecture  
University of Colorado - 1994

Denmark's International Study Program in Architecture - 1993

## Organizations

Licensed Architect - West Virginia, Kentucky  
American Institute of Architects  
National Council Architecture Registration Board

## Community Service

City of Charleston - Municipal Planning Commission: 2002 - Present  
Past Member:

Friends of Clay Center Board;  
Museum in the Community Board;

## Significant Projects:

Aric Margolis Architecture, PLLC:

- SJUMC: 13,200 SF New Multipurpose Bldg & Entry, 26,800 SF of renovation
- CAMC: Enlarged 185 Car parking lot

As Project Architect at Associated Architects:

- Glenville State College: New 6 Story - 484 bed residence hall, 120,566 SF
- Glenville State College: New Performance Gym & Education Building, 130,704 SF
- CAMC Northgate: Office building for Information Services and other dept, 69,000 SF
- University of Charleston: Renovations for New Physicians Assistant program
- Lowenstein Building: Commercial & Residential renovations to historic building.
- Smith Motors: Renovation and Additions for Mercedes and Land Rover Dealerships

As Project Manager at Associated Architects:

- University of Charleston: East Hall & Parking garage - 49 Apartments, 524 cars
- Equity House: Renovations to 5 story historic building downtown for office use
- Jefferson Place: 24 Unit Apartment Building for CMCHC
- University of Charleston: Middle Hall - 5 Story - 240 bed residence hall, 62,715 SF
- DEP: New 3 Story - 120,000 Square Feet Office Building, LEED Silver
- Marshall University Parking Garage: 5 Story - 1009 car parking
- Northgate Business Park Multiple Projects:  
Sports Medicine, Ticketmaster, Thrasher Engineering, Forbes Building



## CORPORATE OVERVIEW

TERRADON Corporation offers a multi-faceted approach to design engineering and consulting services. For more than 25 years TERRADON staff has provided a wealth of engineering solutions blanketing the Ohio Valley and the Appalachian Region with successful projects. The company built its reputation on expert personnel and quality, time-sensitive service. Those same founding principles hold true today.

Staff includes engineers, landscape architects, surveyors, planners, environmental scientists, designers, technicians and LEED Accredited Professionals.

The company maintains approximately 50 leading-edge staff in four locations: Nitro/Poca, WV; Lewisburg, WV; Charlton Heights, WV; and Ripley, WV. TERRADON'S departments work cohesively to provide turn-key solutions that strive to exceed client expectations.

## ABOUT TERRADON

The family-owned business has built a strong reputation by providing flexible, cost effective design solutions and maintaining the highest level of customer service. TERRADON is particularly suited to design engineering within the mountainous areas of the Ohio Valley and Appalachian Regions. The firm has been recognized through numerous awards from professional organizations and agencies including the several State Divisions of Highways, Departments of Environmental Protection and the American Institute of Architects state chapters.

TERRADON's corporate culture promotes innovation and progressive thinking. Project leaders strive to sustain customers through a wide-range of engineering offerings. TERRADON employees understand the purpose behind their services and work to cultivate lasting relationships with clients through honest, hard work.

## SERVICE OFFERINGS

- Land Planning and Site Design
- Civil Engineering
- Environmental
- Geotechnical Engineering
- Surveying and Mapping
- Water/Wastewater
- Transportation Engineering
- Structural Engineering





## TERRADON Land Development Services Overview



Land Development covers a broad swath of TERRADON's service offerings and sees a large percentage of its annual revenue from repeat clients or referrals. The group is composed mainly of Landscape Architects and CAD designers who frequently team with every other department within the company.

TERRADON's Land Development department collaborates with public and private entities and has a strong presence in the recreation, public/civil, educational and commercial development sectors. TERRADON is recognized as a leader in providing site design and land planning services. The firm's professional engineers work closely with the client from the project's initial phase through a schematic design, construction documents and project delivery. TERRADON's Landscape Development Group remains on the forefront of sustainable design, providing LEED Accredited Professionals to clients. Projects utilizing sustainable design best practices aid clients in significantly reducing energy costs on projects.

TERRADON's Land Development Group works in a variety of markets including: Parks/Recreation, Commercial/Industrial, Civic/Public, K-12 Education, Higher Education and Medical.

Projects include: Master planning, recreational planning, funding agencies assistance, economic development planning, surveying, engineering, architecture, historical preservation construction administration and inspection.

## LAND DEVELOPMENT SERVICES

- Master Planning
- Presentation Drawings/Renderings
- Site Feasibility Studies
- Schematic Design
- Layout Plans
- Grading Plans
- Stormwater Management Plans
- Erosion Control Plans
- Planting Plans
- Construction Observation

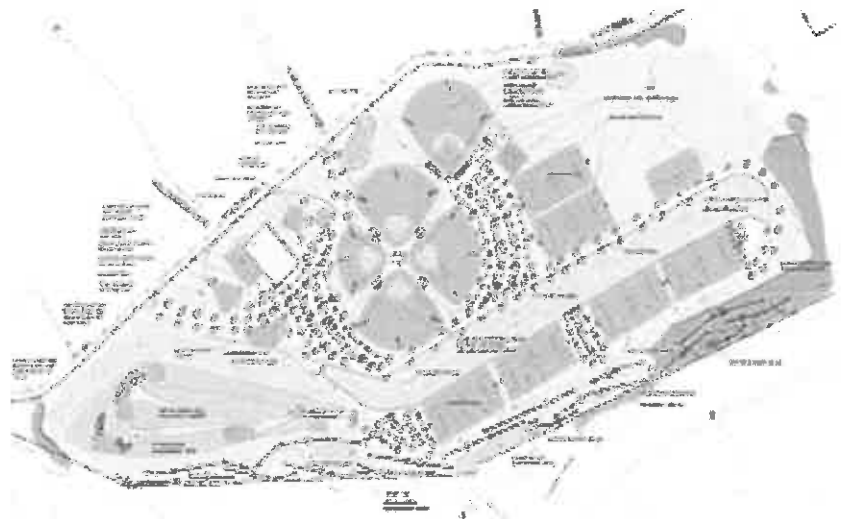

## RESUMES OF PROJECT TEAM MEMBERS - TERRADON

### **Greg Fox, ASLA, LEED AP      VP Land Development**

Greg Fox has overseen TERRADON's Land Development Department since its inception in 2000. He offers more than 25 years of industry experience, providing design services to a variety of markets. During his tenure, the Land Development Group has completed more than one hundred K-12 Educational projects and dozens of Higher Education projects.

Under his guidance, the group has been the recipient of Engineering Excellence awards from the West Virginia Association of Consulting Engineers, and the Gold Award for Engineering Excellence from the American Council of Engineering Companies. Additionally, the Land Development Group has been recognized numerous times for Merit Awards by the West Virginia Chapter of American Society of Landscape Architects. Fox is a registered Landscape Architect in West Virginia, Ohio, North Carolina, South Carolina, Pennsylvania and Virginia. He is an active member of the American Society of Landscape Architects. Fox received degrees in Landscape Architecture and Planning from West Virginia University.

### **Peter J. Williams, ASLA      Landscape Architect**

"Pete" Williams is a graduate of West Virginia University with a Bachelor of Science in Landscape Architecture. His responsibilities include landscape architectural design, grading and storm water drainage design, the design of pedestrian circulation systems and related amenities, roadway design, site planning, and quality control. Mr. Williams is registered as a professional Landscape Architect in West Virginia with more than 13 years of experience at TERRADON and more than 22 years of overall experience.

### **Jim Nagy, PE      Utility Infrastructure**

Nagy performs Civil Engineering related to water and waste water projects at TERRADON. He specializes in the design of water treatment and distribution systems. He has more than 25 years of on-hand experience providing engineering for the largest private water company in West Virginia. He earned a B.S. in Civil Engineering from West Virginia University. His primary focus is on management of water and wastewater projects. He also performs design work related to water distribution systems and sewage collection systems.

### **Robert Thaw, PS      VP Survey and Mapping**

Robert Thaw, Vice President of Survey and Mapping, oversees all TERRADON Survey services. TERRADON's survey group serves a diverse range of projects in support of TERRADON's service groups in addition to managing survey-specific clients. Thaw manages a staff of Professional Surveyors and Computer Aided Drafting (CAD) designers who provide mapping, construction layout, ALTA survey, topographic survey and boundary survey services. Thaw's leadership has been instrumental in TERRADON's prioritization of the use of modern technology, ensuring clients the most efficient and accurate results. Additionally, he is responsible for in-house design of commercial property sites, parking and utility easements, and review of project plans and base mapping creation. Thaw's group also provides as-built surveys, utility identification surveys and deformation monitoring of design features such as retaining walls and dams.

### **Bill Hunt, PG, LRS      VP Geo-Environmental, Materials Testing and Inspection**

Bill Hunt serves as Vice President of Geo-Environmental at TERRADON Corporation. He will oversee any environmental needs, permitting and direct work for geotechnical tasks and testing and inspection required of the project. Hunt offers relevant experience in environmental documentation, investigations, and coordination with federal, state, and local agencies. He prepares Environmental Impact Statements, Environmental Assessments, Section 4(f) Evaluations, and other environmental technical documents. He supervises and participates in work plan development, field surveys, on-site monitoring, data collection, impact analysis, subconsultant management, public meeting organization and group presentations.

### **John James, PE      Geotechnical Engineer**

James is a Senior Geotechnical Engineer for civil engineering projects. Mr. James specializes in innovative and cost-saving concepts for his projects. James' project experience includes: roads; highways and bridges; earth and rockfill dams; numerous foundation investigations; studies and designs for landfills and environmental facilities; surface and ground water studies and remediation; foundation investigations and designs ranging in size from houses to major industrial complexes; storm drainage facilities; airport facilities; landslide analysis and correction; and forensic engineering.

## RESUMES OF PROJECT TEAM MEMBERS

**Greg Fox, ASLA, LEED AP**  
 Vice President of Land Development

Greg Fox oversees TERRADON's Land Development Sector. Fox has been responsible for hundreds of notable commercial, educational and recreational site development projects during his 25-year career. During his time as Land Development Department Head, TERRADON has earned Engineering Excellence Awards from the West Virginia Association of Consulting Engineers, numerous Merit Awards from the American Society of Landscape Architects, and the Gold Award from the American Council of Engineering Companies.

### Relevant Project Experience

- **The Bechtel Summit National Scouting Reserve**  
 Provide Site Design for the 12,000+ acre site in Fayette County, WV. Responsible for site grading, construction drawings, NPDES design and coordination for all project subconsultants for NPDES permitting with WVDEP.
- **Greater Greenbrier Sports Complex**  
 Provided Master Planning and Grading Design Services for the Greater Greenbrier Sports Complex located north of Lewisburg, WV. Five phases include: Master Planning, Grading Study, Full Construction Documents, Utility Layout, Road Design, Erosion and Sediment Control.
- **Glade Run/ Zelianople, PA**  
 Conducted a master facility plan for a 300+ acre development for Glade Run Lutheran Services This project involved a mixed use development which included an equestrian trail, senior housing, single family residential, office, and retail.
- **Palatine Park Master Planning**  
 Provided master Planning Services for the City of Fairmont for the redevelopment of Palatine Park on the east side of the Monongahela River adjacent to downtown Fairmont, WV. The Master Plan featured new parking areas, walking trails, a vista overlook, a picnic gazebo and retail space.
- **Putnam County Parks Master Planning**  
 TERRADON Corporation provided Master Planning and site civil design services for the expanding Valley Park in Hurricane, Putnam County, WV. This work is part of a nearly \$2 million expansion, which was completed in 2013 and adds an additional 6 acres to the park. The project included planning for athletic fields, multiple parking lots, access roads and greenspace, but also incorporated a walking trail that ties into existing park trails. The plan was produced in coordination with the WVDOT to determine roadway/walkway ingress/egress and designed in accordance with local, state and federal regulations.
- **Fairmont Riverfront Park Master Plan**  
 The City of Fairmont and the Fairmont Renaissance Corporation intend to develop new recreation opportunities and at the same time enhance economic development opportunities for the community. The main goal of the planning process was to develop a plan that will allow for the comprehensive development and implementation of new elements to the riverfront. The elements planned will include rehabilitation of an existing park and new recreation, commercial, and residential opportunities.



### Education

B.S. Landscape Architecture  
 West Virginia University  
 B.A. Geography & Planning  
 West Virginia University

### Work Experience

2000-Present  
 TERRADON Corporation

1996-2000  
 Martin Boal Anthony &  
 Johnson Architects

1993-1996  
 Site Design

1989-1993  
 EG&G Inc

1988-1989  
 PSC Engineers

## RESUMES OF PROJECT TEAM MEMBERS

Peter J. Williams, ASLA  
Landscape Architect

"Pete" Williams is a graduate of West Virginia University with a Bachelor of Science in Landscape Architecture. His responsibilities include landscape architectural design, grading and storm water drainage design, the design of pedestrian circulation systems and related amenities, roadway design, site planning, and quality control. Mr. Williams is registered as a professional Landscape Architect in West Virginia with more than 13 years of experience at TERRADON and more than 22 years of overall experience.

### Relevant Project Experience

- **The Bechtel Summit National Scouting Reserve**  
Provide Site Design for the 12,000+ acre site in Fayette County, WV. Responsible for site grading, construction drawings, NPDES design and coordination for all project subconsultants for NPDES permitting with WVDEP.
- **Greater Greenbrier Sports Complex**  
Provided Master Planning and Grading Design Services for the Greater Greenbrier Sports Complex located north of Lewisburg, WV. Five phases include: Master Planning, Grading Study, Full Construction Documents, Utility Layout, Road Design, Erosion and Sediment Control.
- **Glade Run/ Zelenople, PA**  
Conducted a master facility plan for a 300+ acre development for Glade Run Lutheran Services This project involved a mixed use development which included an equestrian trail, senior housing, single family residential, office, and retail.
- **Palatine Park Master Planning**  
Provided master Planning Services for the City of Fairmont for the redevelopment of Palatine Park on the east side of the Monongahela River adjacent to downtown Fairmont, WV. The Master Plan featured new parking areas, walking trails, a vista overlook, a picnic gazebo and retail space.
- **Putnam County Parks Master Planning**  
TERRADON Corporation provided Master Planning and site civil design services for the expanding Valley Park in Hurricane, Putnam County, WV. This work is part of a nearly \$2 million expansion, which was completed in 2013 and adds an additional 6 acres to the park. The project included planning for athletic fields, multiple parking lots, access roads and greenspace, but also incorporated a walking trail that ties into existing park trails. The plan was produced in coordination with the WVDOT to determine roadway/walkway ingress/egress and designed in accordance with local, state and federal regulations.
- **Hospitality**  
Twin Falls State Park Lodge Expansion  
Snowshoe Camp 4 Condominiums  
Snowshoe Sawmill Village Luxury Homes  
Huntington Towne Place Suites Hotel  
Huntington Hampton Inn Hotel



### Education

B.S. Landscape  
Architecture  
West Virginia University

### Work Experience

2000 – Present  
TERRADON Corporation

### 1992-2000

Chapman Technical Group  
Registration

### Affiliations

American Society of Landscape  
Architects

West Virginia Chapter of  
American Society of Landscape  
Architects

## RESUMES OF PROJECT TEAM MEMBERS

**Bill Hunt, PG, LRS**  
 Vice President of Geo-Environmental, Testing & Inspection

Bill Hunt is a Licensed Remediation Specialist and serves as Vice President of Geo-Environmental and Testing & Inspection services at TERRADON Corporation. Hunt offers relevant experience in environmental documentation, investigations, and coordination with federal, state, and local agencies. He prepares Environmental Impact Statements, Environmental Assessments, Section 4(f) Evaluations, and other environmental technical documents. He supervises and participates in work plan development, field surveys, on-site monitoring, data collection, impact analysis, subconsultant management, public meeting organization and group presentations.

### Relevant Project Experience

Hunt has provided environmental management services on a wide variety of projects. His experience includes:

- Phase I and II Environmental Site Assessments
- Section 401/404 Permitting
- Wetland Assessments and Delineations
- Environmental and Industrial Hygiene Sampling
- Environmental Audits and NEPA Assessments
- Risk Assessments
- Remediation Design
- Statistical Analysis of Soil and Groundwater data
- Spill Prevention and Best Management Practices Plan Preparation

### Key Projects

- 40 Phase I Environmental Site Assessments (ESAs) for fast food franchise at locations in WV, OH, IN, MO, KS, MI and WI. 25 of these Phase I ESAs led to Phase II ESAs
- Phase I and II ESA of coal loading terminal along the Ohio River. Phase II delineated Soil & groundwater diesel impact which was remediated using free product recovery, pump and treat and vacuum extraction—Kenova, WV
- Phase I ESA of more than 1800 acres of timber land which included Phase II soil sampling for mercury at natural gas wellhead sites – Various Locations, WV
- Phase I ESA of city block slated for demolition. Phase II activities included soil and groundwater sampling, asbestos sampling, lead based paint sampling and wipe sampling of surfaces within pesticide storage areas – Fairmont, WV
- Phase I ESA and wetland assessment and delineation at 900-acre undeveloped property Kingwood, WV
- Risk assessment for site closure at LUST site in Ohio, conducted in accordance with Ohio BUSTR guidelines.
- Risk assessment for RCRA closure at Barge Manufacturing Facility, Burlington, Ohio.
- NEPA Environmental Study, West Virginia Regional Airport, Randolph County Airport, Mason County Airport, Upshur County Airport, Mingo County Airport
- Exposure Assessment at pigment manufacturing facility as part of RCRA closure Cincinnati, Ohio



### Education

B.S. Environmental Science,  
 Morehead State University

M.A. Geography,  
 Ohio University

### Work Experience

2010—Present  
 TERRADON Corporation  
 Geo-Environmental Department  
 Head

2008—2010  
 NGE, LLC  
 Environmental Services Manager

2001—2008  
 Superior Marine Ways  
 Director, Environmental Health  
 & Safety

1991-2001  
 H.C. Nutting Company  
 Environmental Group Leader

1989—1991  
 PSARA Technologies  
 Environmental Services Division  
 Manager

1986—1989  
 Westinghouse  
 Environmental Scientist

## RESUMES OF PROJECT TEAM MEMBERS

### Jim Nagy, PE Senior Engineer

As a Senior Engineer at TERRADON, Jim Nagy's primary focus is on designing civil engineering projects for public and private development projects throughout West Virginia. Nagy specializes in the design of water distribution systems as well as sewage collection systems. Nagy offers decades of hands-on experience and has previously provided design engineering services for schools, commercial developments, residential developments, public utilities and more. He earned a B.S. in Civil Engineering from West Virginia University and is a Professional Engineer in the State of West Virginia.

#### Relevant Project Experience

- **School Projects**

Responsible for layout, design, and permitting of water and sewer lines for numerous school projects in WV. Projects entailed coordination with PSDs, municipal water and sewer departments, State and Federal regulatory agencies for design of facilities. Schools include: Blue Ridge Community and Technical College, Blue Ridge K-12, Burnsville Elementary, Flatwoods Elementary, Davis Elementary, Sutton Elementary, Little Birch Elementary, Frametown Elementary, Buffalo High School, Clay-Battelle High School, Confidence Elementary, Jefferson Elementary, East Hardy High School, Eastwood Elementary, Flinn Elementary, Geary Elementary, Gilbert High School, Greenbrier West high School, Hampshire High School, Harpers Ferry High School and 19 additional schools.

- **Commercial Developments**

Responsible for layout, design, and permitting of water and sewer lines for numerous commercial developments in WV. Projects entailed coordination with PSDs, municipal water and sewer departments, State and Federal regulatory agencies for design of facilities. Developments include: Fairmont Federal Credit Union, Allegheny Energy Union (Fairmont), First Ward (Clendenin) Apartments, Milton Crossing, Tri-State Hotel and multiple convenience store sites throughout WV.

- **Charleston Replacement Housing**

Utility design, primarily water, sewer and stormwater, and coordination of overall site activities with the project developer for multi-unit housing development. Each phase entailed the design and layout of several hundred feet of water, sewer and stormwater line, including multiple connections with the utility providers, i.e., the Charleston Sanitary Board and West Virginia American Water, and applicable permit applications. Also responsible for construction monitoring and provision of as-built drawings as required by the respective utility providers.

- **Cathcart – Devonshire Development, Scott Depot, WV**

Designed sanitary sewer and water distribution system to serve more than 900 housing units in this private development.

- **Washington Woods Subdivision, Ravenswood, WV**

Designed more than 9,000 feet of water and sewer line and a 500 gpm fire pump water booster station to serve a 150 lot subdivision.

- **Sawmill Village, Snowshoe, WV**

Designed approximately 2,800 feet of 8" water line and sanitary facilities to serve the Sawmill Village development project in Snowshoe, WV.

- **Cabell County Water Main Extension Project**

Worked on design and layout of approximately 46,000 feet of water main for the Salt Rock PSD/WVAW. Responsible for bidding, contract award, and project management.

- **Putnam County Water Main Extensions**

Worked on design and layout of approximately 63,000 feet of water main and a booster pumping station for the Putnam County Commission/WVAW. Responsible for bidding, contract award, and project management.

- **Manila Ridge Water Main Extension Project**

Worked on design and layout of approximately 38,000 feet of water main for the Putnam County Commission/WVAW. Project has not received funding yet. However, will be responsible for bidding, contract award, and project management.



#### Education

B.S. Civil Engineering  
West Virginia University

#### Work Experience

TERRADON Corporation  
2007-Present

WV American Water  
1991-2007

AWW SC  
1984-1991

WV DNR  
1982-1984

VTN, Inc. Consulting  
Engineers  
1978-1982

J.H. Milam Consulting  
Engineers  
1977-1978

WV DNR  
1976-1977

WV Department of  
Highways  
1975-1976

#### Registration

Professional Engineer: WV

## RESUMES OF PROJECT TEAM MEMBERS

### John James, PE Senior Geotechnical Engineer

John James is a Senior Geotechnical Engineer for various transportation, environmental, and mining projects. James specializes in innovative and cost-saving concepts for his projects. James' project experience includes: studies and designs for landfills and environmental facilities; surface and groundwater studies and remediation; design of liners for landfills and various impoundments; earth and rockfill dams; roads; highways and bridges; foundation investigations and designs ranging in size from small projects to major industrial complexes; storm drainage facilities; airport facilities; landslide analysis and remediation; and forensic engineering.

#### Relevant Project Experience

- **Geotechnical investigations and reporting on highway/roadway projects including:** open-ended statewide geotechnical contract, Route 35 Design/Build, Sedalia Arch Bridge, and Sleeth's Run Bridge.
- **LCAP Experience**  
Provided design and permitting for the following under the WVDEP LCAP Program:
  - Pine Creek/Omar Landfill, 12 Acres HDPE Liner, Pine Creek, Logan County, WV.
- **Dam Experience**  
James has been Engineer of Record for numerous earth and rock fill dams in West Virginia. Recent projects include: Mallard Dam (presently in design), 8 acres; Upper Glade Creek Water Supply Dam upgrade (from 95 to 112 acres+/-; Dawson Dam, 30 acres+/-; Lake Chaweva Reconstruction, 24 acres+/-; and Chatham Dam, 65 acres+/-). Also provided consultation and construction design for the United States Army Corps of Engineers for Bluestone Dam.
- **Site Selection Experience**  
James specializes in site evaluation from geologic and topographic perspectives, including literature research and site reconnaissance, for specific project needs.
- **Landslide Experience**  
Worked on numerous landslides of various sizes and complexity in West Virginia.
- **Foundation Investigation and Design**  
Performed foundation investigation services for more than 1,000 projects in West Virginia, from small residential sites to major industrial projects (valued at up to \$2 B) including complicated foundation designs.
- **Retaining Walls**  
Designed numerous retaining structures including simple gravity concrete and MSU walls, cantilever walls and complicated sheet piling or H pile and lagging walls.
- **Geotechnical investigation and design of numerous water and wastewater treatment plants, including:**  
Charleston Wastewater Treatment Plant, North Beckley Wastewater Treatment Plant, and Buckhannon Water & Wastewater Treatment Plant.
- **WVDOT City Beer Bridge, Wood County, WV**  
TERRADON conducted a field exploration for the proposed overpass replacement on I-77 located in Wood County, West Virginia. A total of thirteen (13) structure borings at the proposed bridge and one pavement boring were required by the WVDOT, and TERRADON performed drilling for the fourteen borings, delivered samples to MCS&T and provided GINT logs.
- **WVDOT Corridor H- Slope Stability Design of Waste Pit Areas and Cut/Fill Slope Value Engineering**

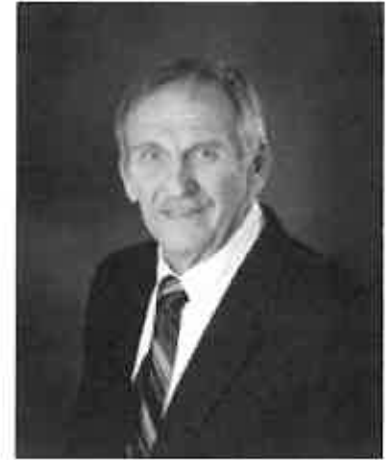

#### Education

B.S., Civil Engineering,  
West Virginia University Institute  
of Technology

#### Work Experience

TERRADON Corporation  
2004-Present

James Engineering  
1983-2004

Triad Engineering  
1978-1983

James Engineering  
1973-1978

Ackenherl & Associates  
1968-1973

US Geological Survey  
(Part-time College Intern)

## RESUMES OF PROJECT TEAM MEMBERS

### Robert Thaw, PS VP - Survey and Mapping

With more than 22 years of experience in a wide range of surveying projects, Robert Thaw serves as head of TERRADON's Survey and Mapping department. He organizes and supervises survey crews, reviews project plans and creates base mapping for various projects including noise barriers, interchanges, connectors, bypasses, sidewalks, bike paths and bridges. Thaw oversees all TERRADON survey activities, including: preparation of Right-Of-Way plans; the development of GPS static networks for aerial mapping in the design of roadways; identification of existing utilities and property lines; base image development and control placement for construction projects; and drafting of legal descriptions for ROW parcels.

Thaw has been directly responsible for survey and mapping services on a number of notable projects including:

- **Laurel Fork Campground Bridge**  
TERRADON provided surveying and design engineering on a USDA Forest Service project in Randolph County, West Virginia. Surveyors led by Thaw provided Right-Of-Way services, including courthouse research, construction easements, and location of alignments. Additionally, provided topographic mapping, project control for construction, hydraulic cross sections, and stream profiles.
- **Sedalia Arch Bridge**  
Thaw oversaw survey services for the replacement of an existing concrete arch bridge with a 72' single span bridge. The bridge consisted of adjacent concrete prestressed box beams with a cast-in-place concrete deck. Survey services consisted of a topographic survey, ROW plans, construction control, and legal description creation. Roadway design consisted of new bridge approaches and a designed detour. Drainage, maintenance of traffic, and right-of-way plans were included in the scope of work.
- **Sleeth's Run Bridge**  
Thaw provided Right-Of-Way services during the design for the replacement of an existing truss bridge in Lewis County, WV. The project included the design of a new 200' structure and approaches. Survey services consisted of a topographic survey, ROW plans, construction control, and legal description creation.
- **Grade Road**  
Thaw oversaw Right-Of-Way services for the new construction of two lanes adjacent to an existing two-lane roadway. Right-Of-Way services included Right-Of-Way Plans, legal descriptions, and questionnaires for take parcels.
- **St. Mary's Bypass**  
Working for the WVDOT, Thaw led transportation survey services for the relocation of WV 16 in Pleasants County, from Pleasants County Route 18 to WV 2 in Saint Mary's, West Virginia for approximately two miles of highway. The project included topographic mapping, survey control mapping, right-of-way and utility cost estimates, and inventories.
- **Nitro Land Fill-2007 Topo**  
Surveyed the boundary of the former Landfill for future cap and development. Performed topographic survey of the site, prepared maps used for design of a municipal boat ramp.
- **Tucker Co Landfill**  
Established survey control for the landfill. Created topographic surveys quarterly to be used for quarterly volume reports.



#### Education

A.S., Survey Technology, 1981,  
West Virginia Institute of  
Technology

B.S., Surveying, 1985, West  
Virginia Institute of Technology

#### Work Experience

TERRADON Corporation  
1994-Present

Bowman Land Surveying  
1992-1994

Dunn Engineers  
1990-1992

Kelley Gidley Blair and Wolf  
1988-1990

Pierson & Whitman  
Architects and Engineers  
1984-1986

#### Registration

Professional Surveyor,  
West Virginia



## RELEVANT EXPERIENCE

# Palatine Park Master Planning

From June to August 2013, TERRADON Provided master Planning Services for the City of Fairmont for the redevelopment of Palatine Park on the east side of the Monongahela River adjacent to downtown Fairmont, WV. The Master Plan featured new parking areas, walking trails, a vista overlook, a picnic gazebo and retail space.

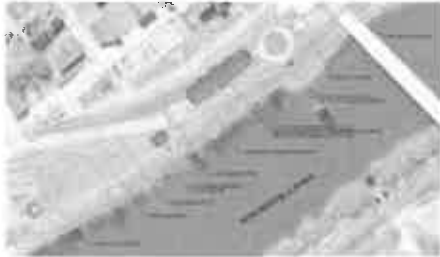

*Palatine Park*  
Master Plan Fairmont, West Virginia

August 27, 2013



# Fairmont Riverfront Master Plan

The City of Fairmont and the Fairmont Renaissance Corporation intend to develop new recreation opportunities and at the same time enhance economic development opportunities for the community. The main goal of the planning process was to develop a plan that will allow for the comprehensive development and implementation of new elements to the riverfront. The elements planned will include rehabilitation of an existing park and new recreation, commercial, and residential opportunities. This plan was designed so that the core elements of the plan will entertain people of all age groups, help with the revitalization of the surrounding neighborhood, and stimulate the entire downtown area of Fairmont.



## RELEVANT EXPERIENCE

# Putnam County Commission - Master Planning & Valley Park Expansion



TERRADON Corporation provided Master Planning and site civil design services for the expanding Valley Park in Hurricane, Putnam County, WV. This work is part of a nearly \$2 million expansion, which was completed in 2013 and adds an additional 6 acres to the park.

The project included planning for athletic fields, multiple parking lots, access roads and greenspace, but also incorporated a walking trail that ties into existing park trails. The plan was produced in coordination with the WVDOT to determine roadway/walkway ingress/egress and designed in accordance with local, state and federal regulations.



## RELEVANT EXPERIENCE

# Summit Bechtel National Scout Reserve Master Plan

From 2008 to July 2013, TERRADON provided a variety of services for the development of the Summit Bechtel National Scout Reserve near Mt. Hope, Fayette County, WV. In fact, TERRADON worked with the NRGRDA on the initial site selection and presentations to the Boy Scouts of America, which landed this massive project in Mt. Hope.

The Summit is a 10,600+ acre outdoor adventure center near Mt. Hope, WV next to the New River Gorge National Park. The world-class facility serves as a venue for the Boy Scouts of America's fourth High Adventure Base, the permanent home to the National Jamboree, a summer camp and National Center for Scouting Excellence leadership center - all on the same contiguous property.

Services for the 10,600+ Acre site included:

- Initial Site Selection/Conceptual Designs
- Site Planning/Grading
- Erosion and Sediment Control
- AML
- Survey/Mapping
- All Environmental Permitting
- Geotechnical Engineering
- Materials Testing and Construction Monitoring
- Utility Design
- 60+ miles of underground utilities
- 550,000 tons of aggregate produced by on-site rock crushing 600 acres of clearing, grubbing and rough grade operations
- 3 million cubic yards of excavation
- 600 acres of fine grading and revegetation
- 28 miles of drainage swales, including erosion and sediment control
- 14 miles of new roads (grade and drain)
- 4 earthen dams
- 80,000 seat lawn amphitheater
- On site sanitary sewer system



## RELEVANT EXPERIENCE

# Greater Greenbrier Sports Complex Master Plan

TERRADON provided Master Planning and Grading Design Services beginning in June 2013 for the Greater Greenbrier Sports Complex located north of Lewisburg, WV.

The work was divided into five phases, and includes:

- Master Planning
- Grading Study
- Full Construction Documents
- Utility Layout
- Road Design
- Erosion and Sediment Control.

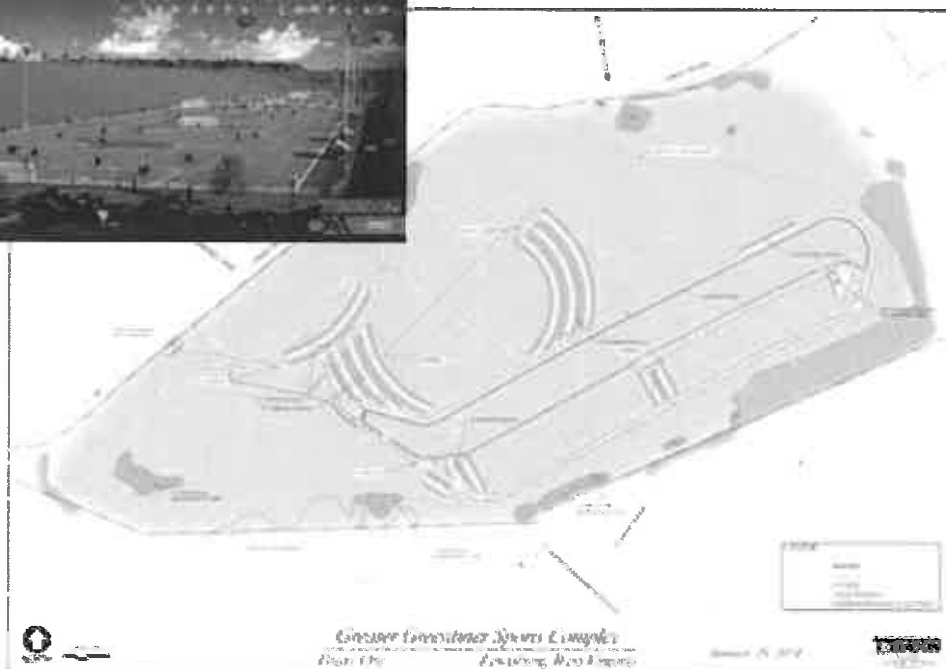

RELEVANT EXPERIENCE

# Putnam County Parks and Recreation Board - Valley Park Trails Map

TERRADON Corporation developed a detailed trail map and additional graphics for a walking trail system in Valley Park.

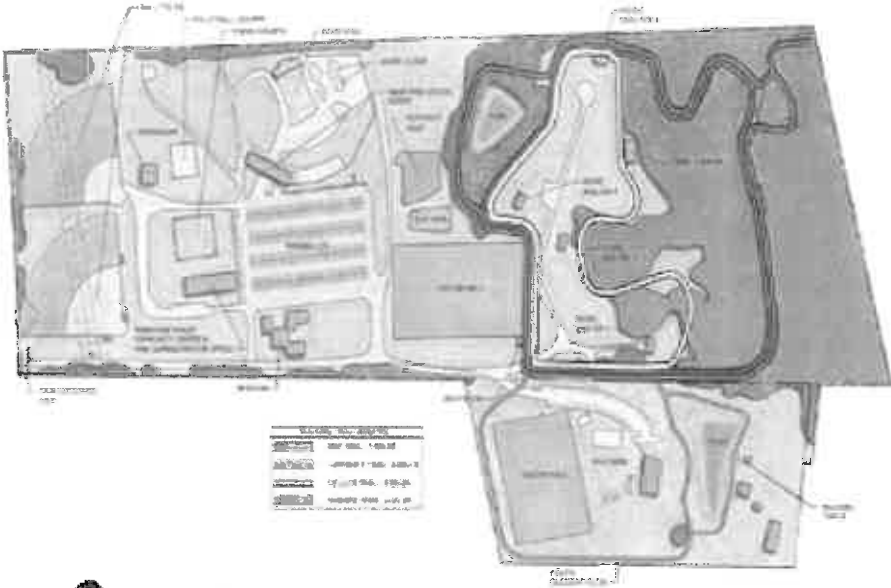

# Jonathan Larck Reservoir Park Master Plan

TERRADON Corporation was responsible for creating a Master Plan for the Jonathan Larck Reservoir Park for the Putnam County Parks and Recreation Commission. Elements included an access drive to the park area, picnic shelters, playground areas, restroom facilities, trail systems and fishing and boating opportunities.

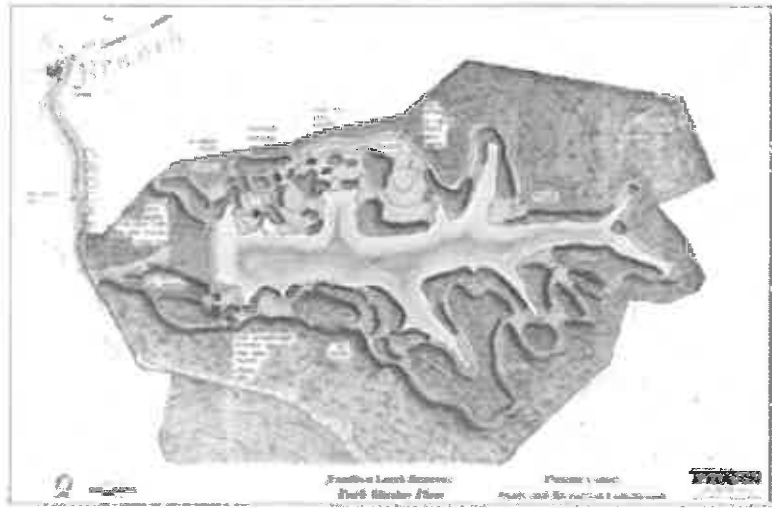

## RELEVANT EXPERIENCE

### Glade Run Lutheran Services

TERRADON conducted a master facility plan for a 300+ acre development for Glade Run Lutheran Services. This project involved a mixed use development which included an equestrian trail, senior housing, single family residential, office, and retail.

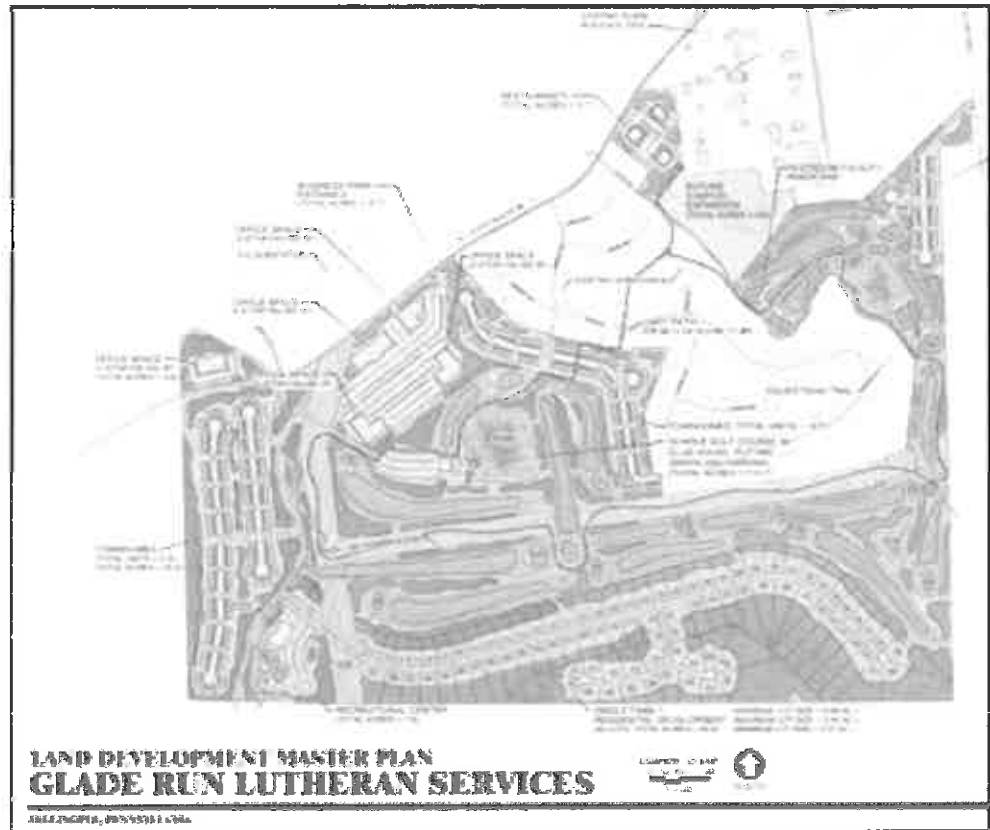

### Barbour County Park - Master Planning

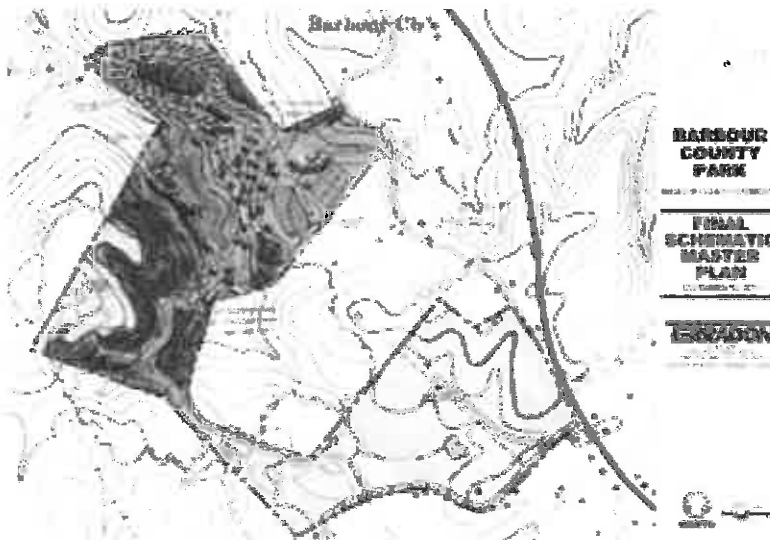

As a subconsultant, TERRADON created a Final Schematic Master Plan for Barbour County Park.

**Relevant Project Tasks Included:**

- Survey and Mapping
- Land Planning
- Utility Design
- Grading and Drainage Design
- Access Road Design
- Construction Drawings

## RELEVANT EXPERIENCE

### Toyota Wetland Education Center

TERRADON Corporation provided Master Planning and site civil design services, followed by construction drawings, for the Toyota Wetland Education Center near Buffalo, WV.

Notable elements incorporated parking spaces, information kiosks, crushed gravel trails, elevated boardwalks and observation decks into this unique environmental habitat and wildlife refuge.

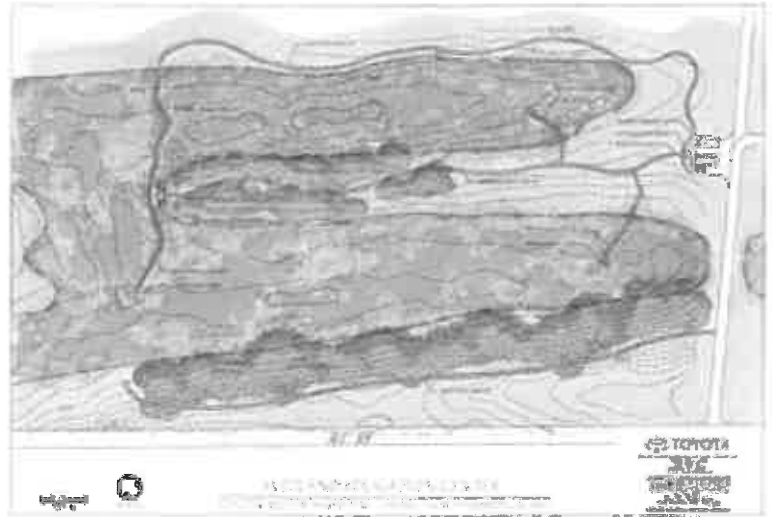

### Harveytown Park & Connector Master Planning

TERRADON Corporation was responsible for trail design of a connector from Harveytown Park to Ritter Park in Huntington, WV. TERRADON provided a 3-Phase Master Planning approach for a section of trail that is predicted to be heavily used by the Huntington Community.

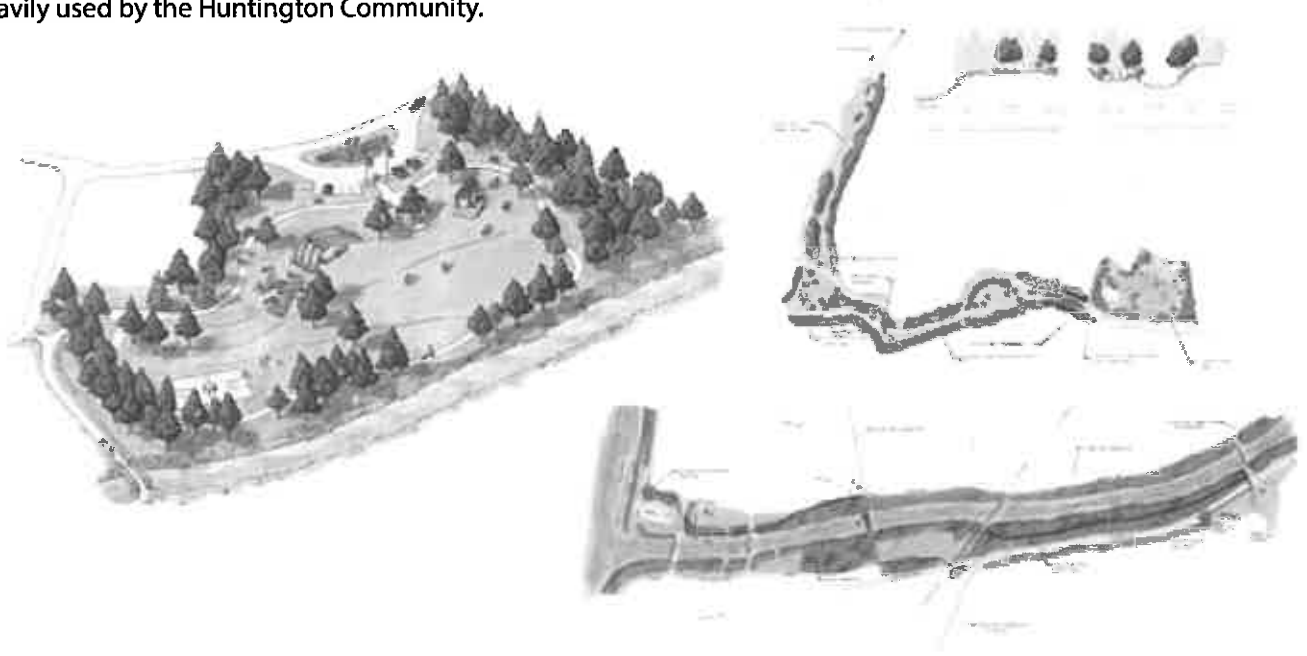

## RELEVANT EXPERIENCE

# Westmoreland Trail System Master Planning

TERRADON Corporation was responsible for the Master Planning of a unique trail system for the Greater Huntington Parks and Recreation District. The project design called for the connection of the Ceredo-Kenova area to Huntington. The trail system was designed to use the top of an earthen flood levy to move through urban areas. Design included alignments, typical sections and E&S Control.



# Kennedy Center Athletic Complex Master Planning

TERRADON Corporation was responsible for the Master Planning of the Kennedy Center Athletic Complex, an outdoor recreational facility located north of Huntington, WV, that provides 80 acres of outdoor opportunities as part of the Huntington YMCA. Improvements or additions were made to various athletic fields, including upgrading a soccer field to tournament-level requirements.





## RELEVANT EXPERIENCE

# Volcano Island & Water Park Master Planning

TERRADON Corporation has provided a variety of engineering services for a growing community on the East Side of Fairmont, WV to help spur economic development. The former Coke Works Site in Fairmont, WV consisted of approximate 100 acres of land. Previously listed on the EPA priority list of superfund sites, the site concluded remediation efforts in 2008. TERRADON Corporation then began providing land planning and design services to the City.

Combined with surrounding areas totaling approximately 350 acres, TERRADON provided land planning and design engineering, utility location and mapping services for the properties. The master planning provided vision for Volcano Island Water Park, allowing the City of Fairmont efficient and value-based use of the former environmentally concerned site.

### Relevant Project Tasks Included:

- Survey and Mapping
- Land Planning
- Utility Design
- Grading and Drainage Design
- Access Road Design
- Construction Drawings

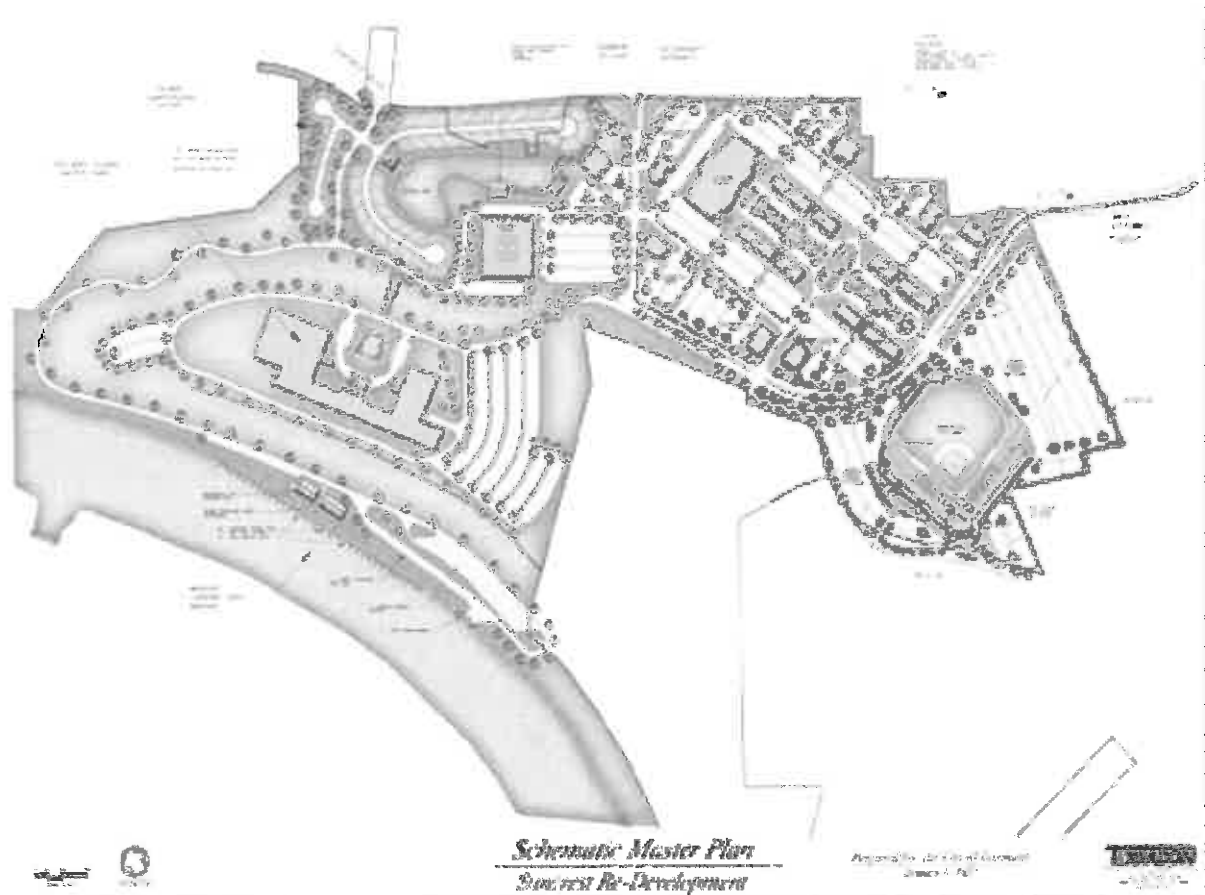

## RELEVANT EXPERIENCE

### Bluestone State Park Master Planning

TERRADON was responsible for the development of a swimming pool replacement for existing pools at Bluestone State Park. The existing pool was located within the 100-year flood plain and subject to flooding.

TERRADON proposed a new pool located above the 100-year flood plain while incorporating many unique and creative design features for Bluestone State Park guests and the surrounding community.



### Little Beaver State Park Design

TERRADON was responsible for the design of a campground expansion that doubled the number of existing full-service RV spaces, a new bathhouse and a trail system to the bathhouse. TERRADON was also responsible for preparation of plans and specifications for a septic tank effluent gravity (STEG) system at the park. DNR Parks and Recreation had started the project using force account method of construction, but was unable to complete the project. Terradon designed the project to utilize materials already purchased and delivered to the site. The project consisted of septic tanks, one (1) grinder sewage pumping station, and small diameter gravity sewer (SDGS) with connection to the local PSD for treatment.

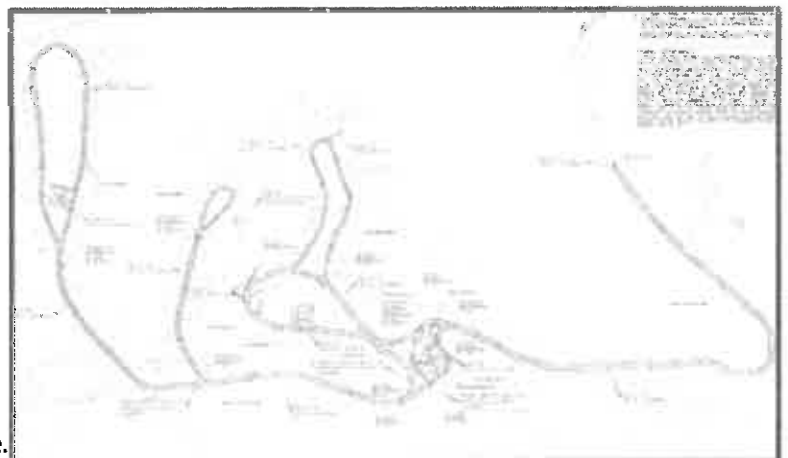

## RELEVANT EXPERIENCE

# West Virginia University Institute of Technology Marina Study Master Plan

TERRADON Corporation was responsible for the design of a Tech Marina Study as part of a recreational master plan study for the West Virginia University Institute of Technology Extreme Sport Committee. The study contained plans for renovation of an existing dock, fuel slips, boat rental slip expansion, a boat trailer parking lot, vehicle parking, camping sites and overflow parking on a bicycle trail along the Kanawha River.

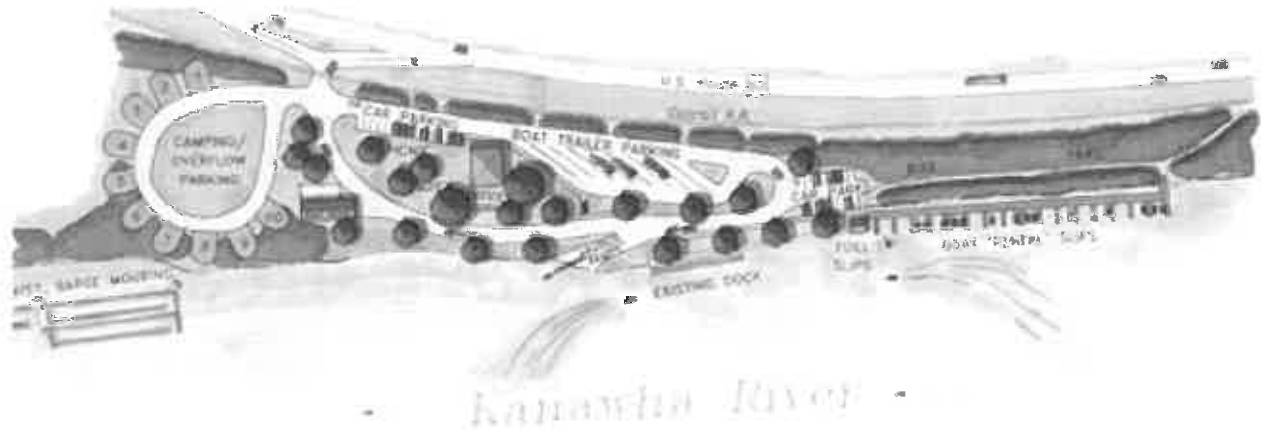

## Nitro Boat Launch Master Plan

TERRADON Corporation was responsible for the design of schematic plans for the Nitro Boat Launch in Nitro, WV. The master plan contained boat docks, an access road and parking lot to provide the local community with a recreational outlet to the Kanawha River.

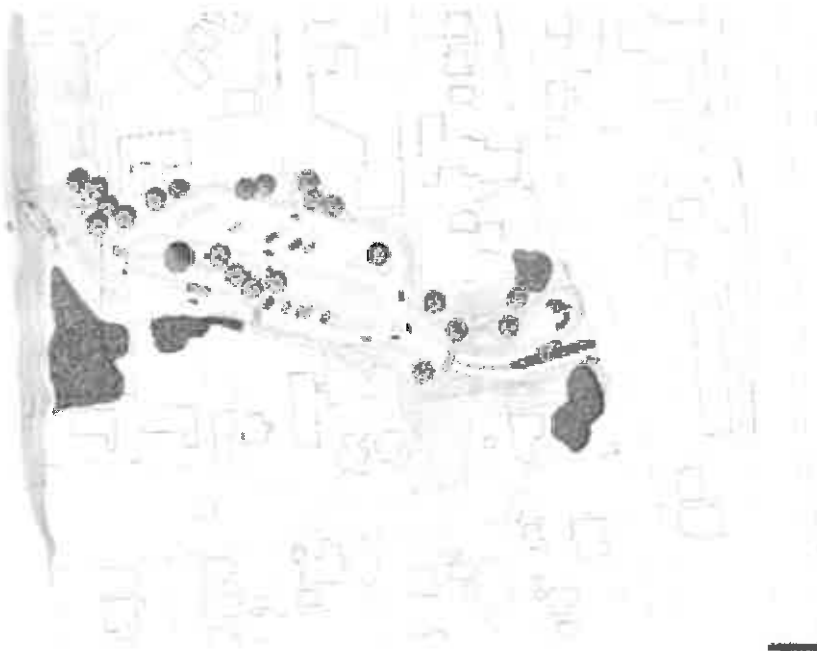

## RELEVANT EXPERIENCE

### Dorsey's Knob Master Plan - BOPARK

TERRADON provided Master Planning services to the Morgantown Board of Park and Recreation Commissioners for the development of Dorsey's Knob in Morgantown, WV.

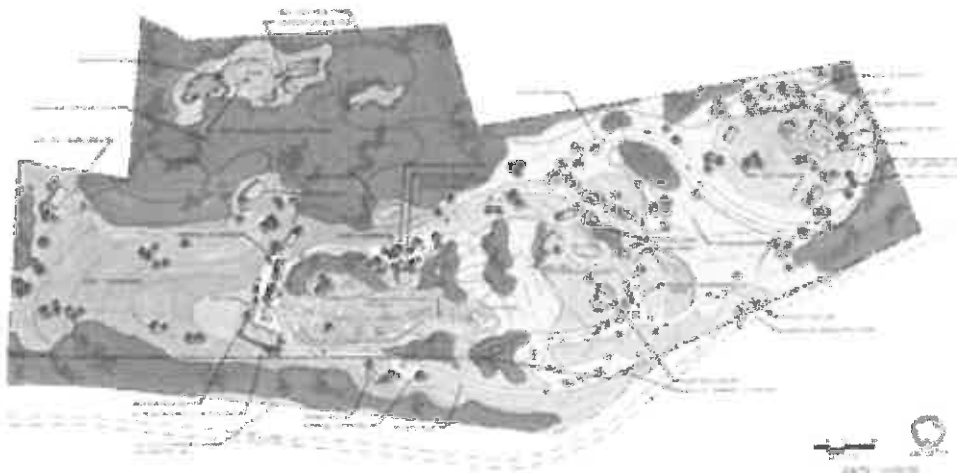

**DORSEY'S KNOB**  
MORGANTOWN, WEST VIRGINIA  
**MASTER PLAN**  
**BOARD OF PARK & RECREATION COMMISSIONERS**

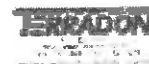

### Roane County Parks Master Planning

TERRADON Corporation, provided site master planning and site civil engineering services for Roane County Parks.



## RELEVANT EXPERIENCE

# Upshur County Park Master Planning - Curry Park

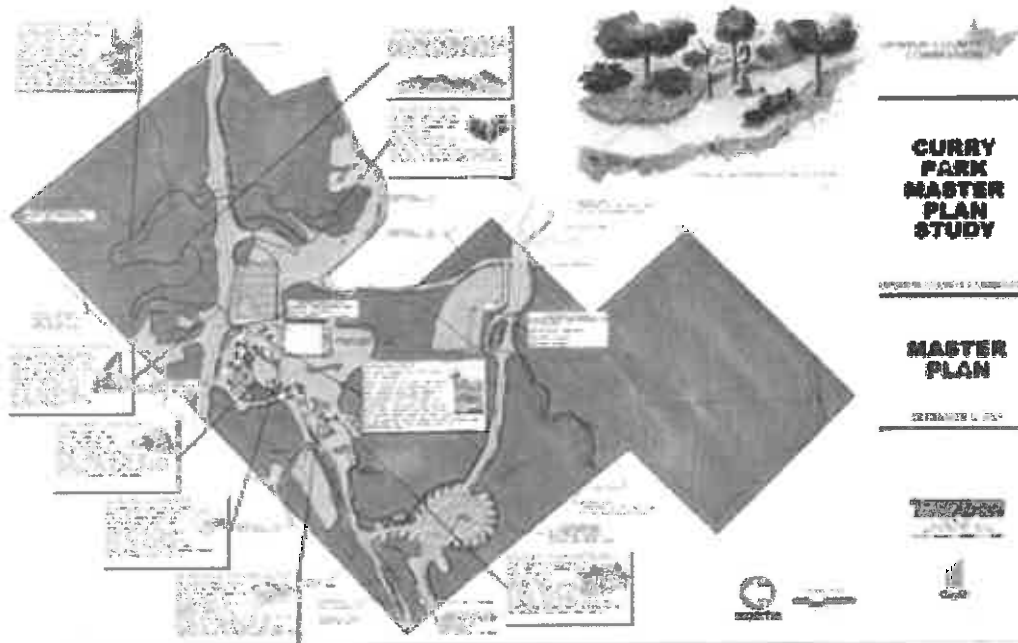

As a subconsultant, TERRADON completed the Curry Park Master Plan Study for the Upshur County Commission.

Relevant Project Tasks Included:

- Survey and Mapping
- Land Planning
- Utility Design
- Grading and Drainage Design
- Access Road Design
- Construction Drawings

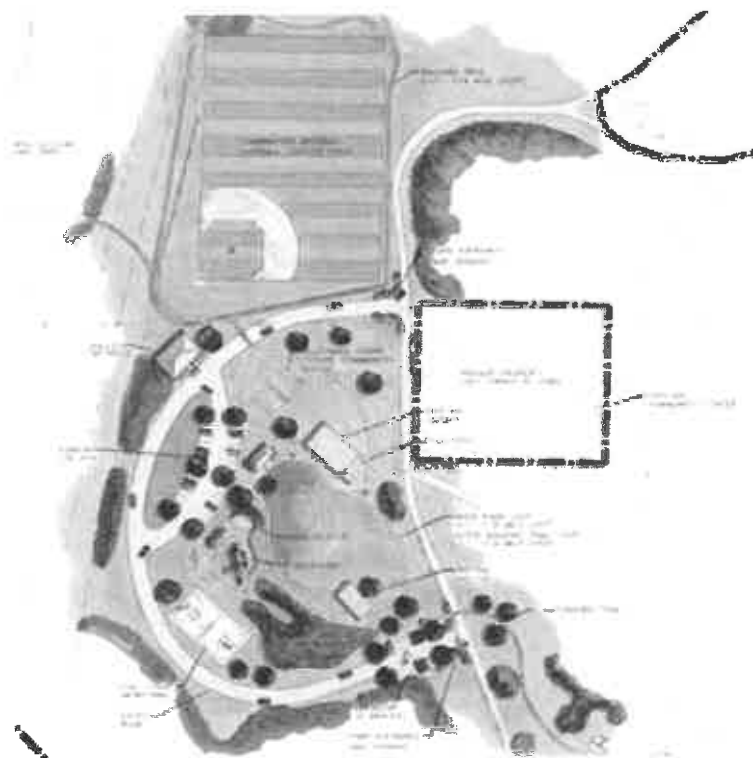

RELEVANT EXPERIENCE

Grand Vue Park



TERRADON is currently in the developing Master Plans and Schematic Planning for Grand Vue Park near Moundsville, WV. Services include: inventory and analysis of existing features, identifying project opportunities, land planning, master planning and team coordination with subconsultants.

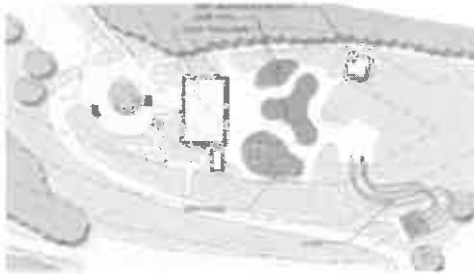

*Sports Center*



*Band Pavilion*



*North Center*



*Lodge*



*9 Hole Golf Course*



*Park Entrance*



*Scenic Overlook*

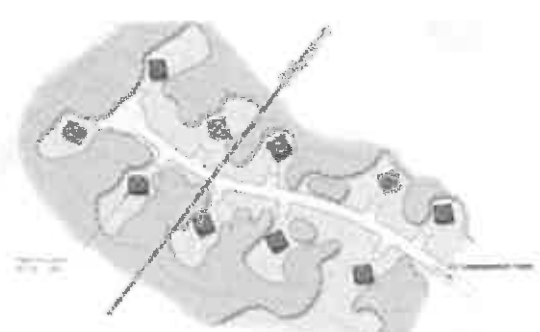

*Treehouse Rentals*

## REFERENCES

**PROJECT 1:** Palatine Park Master Planning  
**OWNER'S NAME:** City of Fairmont, WV  
**ADDRESS:** 200 Jackson St., Fairmont, WV 26554  
**CONTACT NAME AND PHONE NUMBER:** Jay Rogers, City Manager 304-366-6212  
**EMAIL ADDRESS:** jrogers@fairmontwv.gov

**PROJECT 2:** Valley Park Expansion  
**OWNER'S NAME:** Putnam County Commission  
**ADDRESS:** 1 Valley Park Rd, Hurricane, WV 25526  
**CONTACT NAME AND PHONE NUMBER:** Scott Williams 304- 562-0518  
**EMAIL ADDRESS:** jamie@putnamcountyparks.com

**PROJECT 3:** Greater Greenbrier Sports Complex  
**OWNER'S NAME:** Greater Greenbrier Sports Complex Foundation  
**ADDRESS:** 200 N Court, Lewisburg, WV 24901  
**CONTACT NAME AND PHONE NUMBER:** Jerry Via 304-645-3961  
**EMAIL ADDRESS:** jerryosull@aol.com

**PROJECT 4:** The Summit Bechtel Family National Scout Reserve  
**OWNER'S NAME:** Boy Scouts of America, Summit Group  
**ADDRESS:** 68 Crossroads Mall, Mount Hope, WV 25880  
**CONTACT NAME AND PHONE NUMBER:** Rob Ridgeway, Facilities Director 304-469-1089  
**EMAIL ADDRESS:** Rob.Ridgeway@scouting.org

# Resume



Douglas R. Richardson, PE, LEED AP  
Principal Engineer

## Education

North Carolina State University, (8/87-5/89).

Masters of Science in Civil Engineering, major in structures and minor in construction.

GPA 4.0/4.0.

West Virginia University, (8/83-8/87)

Bachelors of Science in Civil Engineering.

Ranking: 1st out of approximately 450 College of Engineering graduates. GPA 3.98/4.0.

## Professional Registration

Professional Engineer - WV, VA and KY

Maintains active record with NCEES to facilitate prompt registration in additional states as required.

LEED Accredited Professional

## Professional Affiliations

American Society of Civil Engineers

American Concrete Institute

American Institute of Architects, Professional Affiliate

Structural Engineering Institute

Timber Framers Guild

US Green Building Council

Engineers Without Borders-USA

## Awards

Eagle Scout - Buckskin Council (1983)





# Background



Moment Engineers, Inc. is a professional consulting firm specializing in structural engineering. We serve the architectural and building construction communities throughout West Virginia. Based in Charleston, West Virginia at 179 Summers Street, Moment Engineers was founded by Douglas Richardson in early 2005.

During his more than 25 years of experience, Mr. Richardson has had sole responsibility for the structural engineering design of more than 6 million square feet of built space. The construction costs of these projects exceeded a half billion dollars. His experience, which ranges from small to very large multi-phase projects, is invaluable in providing the technical expertise and creative flexibility to deliver results in a prompt and reliable manner.

Our staff's experience encompasses a wide variety of building types and sectors, and our expertise includes design analysis for steel, concrete, masonry, and wooden structures.



# Approach

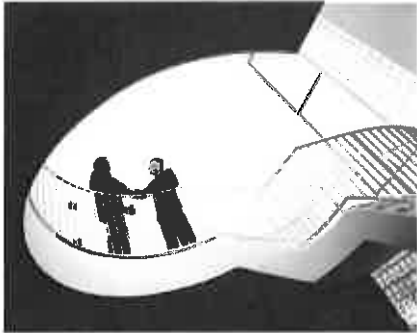

At Moment Engineers, we recognize that the contractor and architect are the primary contact for the building owner. Our role is to strengthen those relationships by producing high quality designs in a prompt and cost effective manner. To that end, we emphasize incorporating traditional and technical means of communication and data transfer to ensure a seamless integration of structural integrity and architectural creativity.

We believe that the practice of engineering is the point at which science and society meet. We also believe that the architects and builders we serve are essential in the development of the fundamental dignity of the community. Moment Engineers is strongly committed to developing structural solutions which bring permanence and strength to the expression of architectural thought.





## Sample Project Experience

Moment Engineers staff experience includes a wide variety of new building design and existing structure evaluation and renovation. The list below is a small sample of the projects for which our staff has had responsible charge of the structural engineering, design and contract document production. All projects listed were or are being constructed in West Virginia. A more extensive list is available upon request.

<u>Project</u>	<u>Sq. Ft.</u>
Logan State Office Building	53,200
Blackwater Falls State Park Addition	9,350
Cacapon State Park Addition	9,840
Summit Bechtel Reserve Bathhouses (358 units)	646 ea.
Mountaineer Challenge Academy	47,790
Kappa Alpha Fraternity House, WVU	14,000
Greenbrier East H.S. Renovations & Additions	205,060
Lincoln Co. High School	216,500
Wayne Co. Spring Valley High School	175,000
Cabell West Elementary School	55,790
Judge Donald F. Black Courthouse Annex	37,000
WV Hospital Association Office Building	29,710
Glen Jean - AFRC	107,090
Elkins - AFRC	60,570
Robert C. Byrd Regional Training Institute	143,000
Alderson Federal Prison Dormitory	60,620
Western Juvenile Detention Center	29,020
Lewisburg United Methodist Church	12,800
West Liberty University Health Sciences Bldg	70,500
Goodwill Industries Renovation and Addition	15,460
NGK-NTK Production Facility	78,000
Advantage Valley Advance Technology Center	55,040



# Harper Engineering, PLLC

52 B Street  
St. Albans, WV 25177  
Office: 304.722.3602 Fax: 304.722.3603

Wayne Co 911 Center: HVAC, Plumbing, Electrical, Fire Alarm, and Sprinkler design for a new 5,800 sq ft 911 Center.

Fayette County 911: HVAC, Plumbing, Sprinkler, Electrical and Fire Alarm design for the new 7,500 sq ft 911 Call Center located in Fayette Co. WV.

KIA Dealership: HVAC, Plumbing, Sprinkler, Electrical and Fire Alarm design for the new 9,000 sq ft showroom and maintenance bay located in Raleigh Co. WV. Included Vehicle Exhaust System for Maintenance bay.

New Bus Garage: HVAC, Plumbing, Sprinkler, Electrical and Fire Alarm design for the new 5,900 sq ft bus garage in West Union, WV.

Public Works Building: HVAC, Plumbing, Sprinkler, Electrical and Fire Alarm design for new 4,500 sq ft bus garage in Romney, WV.

Norfolk Southern Bath House: HVAC, Plumbing and Electrical design for a 1,400 sq ft renovation to an existing bath house.

Cliffs Logan Bath House: HVAC, Plumbing, Electrical and Fire Alarm design for new 6,200 sq ft bath house/office building for Cliffs Logan Coal Company.

WV Department of Highways SRC Office Building: HVAC, Plumbing, Electrical, Fire Alarm, and Sprinkler design for renovations to the 39,400 sq ft addition and renovations to existing office building in Charleston, WV.

Cabwaylingo State Park Dining Hall: HVAC, Plumbing and Electrical Design for a new 3800 sq ft facility.

# **HE Harper Engineering,pllc**

---

52 B Street  
St. Albans, WV 25177  
Office: 304.722.3602 Fax: 304.722.3603



Jason E. Harper, PE  
(304)-541-1390  
jason@harperengwv.com

## **Education**

West Virginia University Institute of Technology  
Montgomery, WV  
Bachelor of Science-Mechanical Engineering

## **Registrations/Professional Affiliations**

Licensed Professional Engineer – WV  
ASHRAE  
NFPA

## **Experience**

Jason E. Harper, PE brings 11 years design experience to our firm. He has experience with HVAC, Electrical, plumbing, and fire alarm system design. His projects include educational facilities (including colleges and universities), health care facilities, office buildings, banks, emergency services facilities, postal facilities, and government buildings.

## **Projects**

Addition and Renovation to Geary School  
Baileysville Elem. HVAC Renovations  
W. Kent Carper Justice and Public Safety Complex  
Dominion Gas Office Building  
Renovations to Glenville ES  
Addition to Shady Spring Middle School  
Addition and Renovations to Flinn Elementary  
Renovations to Park Middle School

# **HE Harper Engineering,pllc**

---

52 B Street  
St. Albans, WV 25177  
Office: 304.722.3602 Fax: 304.722.3603



Kevin Mark King, PE  
[mark@harperengwv.com](mailto:mark@harperengwv.com)

## **Education**

West Virginia University Institute of  
Technology Montgomery, WV  
Bachelor of Science-Electrical Engineering

Bluefield State College  
Bluefield, WV  
Bachelor of Science-Computer Science

## **Registrations/Professional Affiliations**

Licensed Professional Engineer – WV, KY, PA, OH, VA  
WV licensed Master Electrician  
NFPA

## **Experience**

Kevin Mark King, PE brings 10 years of electrical design experience and over 11 years of electrical construction/maintenance experience to our firm. His projects include educational facilities (including colleges and universities), health care facilities, office buildings, emergency services facilities, government buildings and industrial projects.

## **Projects**

Fayette Co. 911 Center  
Wayne County 911 Center  
Pulmonary Associates

Huff PK-8 School  
Oakvale Elementary School  
Pineville Elementary School

# **HE** Harper Engineering

---

P O B o x 8 7 4  
S t. A l b a n s , W V 2 5 1 7 7  
O f f i c e : 3 0 4 . 7 2 2 . 3 6 0 2 F a x : 3 0 4 . 7 2 2 . 3 6 0 3



Richard M. Standish  
(304)-722-3206  
Rick@harperengwv.com

## **Registrations/Professional Affiliations**

ASHRAE

## **Experience**

Richard M. Standish brings 36 years design experience to our firm. He has experience with HVAC, plumbing, and electrical design. His specialty is the electrical design of water treatment and wastewater treatment plants. Rick's projects include treatment plants, educational facilities (including colleges and universities), health care facilities, office buildings, banks, emergency services facilities, postal facilities, and government buildings.

## **Projects**

Brooke County High School  
University of Charleston Dorm  
Tri-State Gaming Center  
Mylan Pharmaceuticals Expansion  
Mason Co. 911 Center  
Oak Hill Police Station  
Kenova WTP  
Boone County WWTP  
Salt Rock PSD  
Eleanor Maintenance Facility

Wyoming West High School  
WVU- Boreman Hall  
Greenbank Observatory  
Robert Byrd Health Science Center  
WV DEP Consolidated Offices  
Flatwoods-Canoe Run PSD  
Union PSD  
City of St Mary's WWTP  
St. Albans WTP  
Dominion Gas Office Building

# **HE Harper Engineering,pllc**

52 B Street  
St. Albans, WV 25177  
Office: 304.722.3602 Fax: 304.722.3603



Scott D. Phillips  
(304)-722-3602  
Scott@harperengwv.com

## **Registrations/Professional Affiliations**

American Society of Plumbing Engineers

## **Experience**

Scott D. Phillips brings 30 years design experience to our firm. He has experience with mechanical, electrical, plumbing and fire suppression system design. His projects include educational facilities (including colleges and universities), health care facilities, office buildings, banks, emergency services facilities, postal facilities, and government buildings.

## **Projects**

W. Kent Carper Justice and Public Safety Complex  
Renovations to Burnsville Elementary School  
Pioneer Community Bank  
Bible Center Recreation and Ministry Building  
Pulmonary Associates Office Building  
Additions and Renovations to Little Birch Elementary School  
Moses Factory Outlet- Teays Valley  
Dominion Gas Office Building  
Fairmount State University WV Folk Life Center  
South Preston Pre K-8 School  
Rahall Technology and Business Center Community Based Outpatient Clinic  
Renovations to Davis Elementary School