



# West Virginia Purchasing Division

2019 Washington Street, East  
Charleston, WV 25305  
Telephone: 304-558-2306  
General Fax: 304-558-6026  
Bid Fax: 304-558-3970

The following documentation is an electronically-submitted vendor response to an advertised solicitation from the *West Virginia Purchasing Bulletin* within the Vendor Self-Service portal at ***wvOASIS.gov***. As part of the State of West Virginia's procurement process, and to maintain the transparency of the bid-opening process, this documentation submitted online is publicly posted by the West Virginia Purchasing Division at ***WVPurchasing.gov*** with any other vendor responses to this solicitation submitted to the Purchasing Division in hard copy format.

## Header

List View

### General Information

Contact

Default Values

Discount

Document Information

Procurement Folder: 116514

Procurement Type: Central Purchase Order

Vendor ID: VS0000006215 

Legal Name: PRINOTH LLC

Alias/DBA:

Total Bid: \$143,000.00

Response Date: 08/04/2015 

Response Time: 23:02

SO Doc Code: CRFQ

SO Dept: 0310

SO Doc ID: DNR1600000002

Published Date: 7/16/15

Close Date: 8/5/15

Close Time: 13:30

Status: Closed

Solicitation Description: One-time purchase of a used snow groomer with attachments

Total of Header Attachments: 0

Total of All Attachments: 0



Purchasing Division  
 2019 Washington Street East  
 Post Office Box 50130  
 Charleston, WV 25305-0130

**State of West Virginia  
 Solicitation Response**

**Proc Folder :** 116514

**Solicitation Description :** One-time purchase of a used snow groomer with attachments

**Proc Type :** Central Purchase Order

Date issued	Solicitation Closes	Solicitation No	Version
	2015-08-05 13:30:00	SR 0310 ESR07301500000000337	1

VENDOR
VS0000006215 PRINOTH LLC

**FOR INFORMATION CONTACT THE BUYER**  
 Guy Nisbet  
 (304) 558-2596  
 guy.l.nisbet@wv.gov

Signature X FEIN # DATE

All offers subject to all terms and conditions contained in this solicitation

Line	Comm Ln Desc	Qty	Unit Issue	Unit Price	Ln Total Or Contract Amount
1	Used Two Tracked Snow Groomer- Pistenbully 100, or equal	1.00000	EA	\$143,000.00	\$143,000.00

Comm Code	Manufacturer	Specification	Model #
22101538			

**Extended Description :** Includes all attachments specified in Section 3 of the mandatory requirements.

REQUEST FOR QUOTATION  
Blackwater Falls State Park  
Used Two-Track Snow Groomer and Attachments

22

---

REQUEST FOR QUOTATION  
Blackwater Falls State Park  
Used Two-Track Snow Groomer and Attachments

---

21

SPECIFICATIONS

1. **PURPOSE AND SCOPE:** The West Virginia Purchasing Division is soliciting bids on behalf of the West Virginia Division of Natural Resources, Blackwater Falls State Park to establish a contract for the "One-Time" purchase of one (1) used Two-Track Snow Groomer and Tiller with attachments.
2. **DEFINITIONS:** The terms listed below shall have the meanings assigned to them below. Additional definitions can be found in section 2 of the General Terms and Conditions.
  - 2.1 "Contract Item" Used Two-Track Snow Groomer and attachments as more fully described by these specifications.
  - 2.2 "Pricing Page" means the pages, contained in wvOASIS or attached as Exhibit "A", upon which Vendor should list its proposed price for the Contract Items.
  - 2.3 "Solicitation" means the official notice of an opportunity to supply the State with goods or services that is published by the Purchasing Division.
  - 2.4 "ROPS" means Rollover Protective Structure.
3. **GENERAL REQUIREMENTS:**
  - 3.1 **Mandatory Contract Item Requirements:** Contract Item must meet or exceed the mandatory requirements listed below.
    - 3.1.1 Used Two Tracked Snow Groomer- Pistenbully 100, or equal  
Primary Bid 2012 husky XC 197 HP \$143,000  
Alternative Bid 2015 Husky XC 228 HP Tier 4 \$218,000
      - 3.1.1.1 Groomer and tiller must be a 2002 model or newer  
2012 Meets requirement approximately 625 hours  
2015 Meets requirements approximately 150 hours
      - 3.1.1.2 Must have less than 4,000 hours of operation on equipment.  
Meet requirements
      - 3.1.1.3 Groomer engine must include a fully inclined 4 cylinder diesel,

REQUEST FOR QUOTATION  
Blackwater Falls State Park  
Used Two-Track Snow Groomer and Attachments

---

turbocharged and after cooled, electronically controlled fuel injection.

Meet requirements

3.1.1.4 Groomer speed must be continuously variable and must have a maximum speed of at least 24 kilometers per hour.

Meet requirements

3.1.1.5 Fuel tank must be a minimum of 140 liter.

2012 does not meet requirement, 110 L tank. Optional axillary tank available.

2015 exceeds requirement, 150 l tank

3.1.1.6 Groomer width, with tracks, must be a minimum of 2,500 mm wide and no more than 3,100 mm wide. Meet requirements

3.1.1.7 Must have digital electronics, programmable without external computer. Meet requirements

3.1.1.8 Must include an electronically controlled steering wheel. Meet requirements

3.1.1.9 Direction of travel control via steering wheel mounted switch, and foot throttle. Meet requirements

3.1.1.10 Drive pumps must be equipped with pressure override protection. Meet requirements

3.1.1.11 Must have a three speed transfer box with variable displacement pump for tiller operation. Meet requirements

3.1.1.12 Must have closed center hydraulic system. Meet requirements

3.1.1.13 Must have a Hydraulic track tensioning system. 2012 does not, mechanical track tensioning, 2015 meets requirements

3.1.1.14 Must have steel closed profile tracks with overlapping belt lacings. Exception hinge closing system

3.1.1.15 Each carrier wheel must be mounted to a cranking arm for

REQUEST FOR QUOTATION  
Blackwater Falls State Park  
Used Two-Track Snow Groomer and Attachments

---

independent suspension. **Meet requirements**

3.1.1.16 Must have heated front and rear windows. **Meet requirements**

3.1.1.17 Must have heated rear view mirrors. **Meet requirements**

3.1.1.18 Must have a grid heater for cold-starting. **Meet requirements**

3.1.1.19 Must have a two passenger cabin.  
**Meet requirements.**

REQUEST FOR QUOTATION  
Blackwater Falls State Park  
Used Two-Track Snow Groomer and Attachments

---

3.1.1.20 Must have a ROPS certified driver's cab with steel safety frames. **Meet requirements**

3.1.1.21 Must have a 24 volt electrical system. **Meet requirements**

3.1.1.22 Braking must be done utilizing the hydrostatic transmission and must have two multi-disc parking brakes. **Meet requirements**

3.1.1.23 Service and technical support must be available within the United States. **Meet requirements**

3.1.2 Front attached clearing blade

3.1.2.1 Blade must be capable of 12 directions of movement. **Meet Requirements**

3.1.2.2 Must have a quick mount system for attaching front mounted attachments. **Meet requirements**

3.1.2.3 Blade must be no more than 3.1m wide. **Meet requirements**

3.1.3 Front attached snow cutter **Do not meet min requirements for this implement. Exception / Operator can perform task with Prinoth 12-way blade**

3.1.3.1 Snow cutter must work with the 12-way blade and quick mount system.

3.1.3.2 Snow cutter will consist of a toothed bar that is lowered hydraulically, to break up ice before it is tilled.

3.1.3.3 Toothed bar must swing back automatically if it runs into solid ground.

3.1.3.4 Cutter must be no more than 3.1m wide.

3.1.4 Rear attached tiller **Meet Requirements**

3.1.4.1 Must be auto raising when groomer is put into reverse.

3.1.4.2 Must have contact pressure and tiller depth adjustment.



REQUEST FOR QUOTATION  
Blackwater Falls State Park  
Used Two-Track Snow Groomer and Attachments

---

3.1.4.3 Tiller must automatically shut of when raised.

REQUEST FOR QUOTATION  
Blackwater Falls State Park  
Used Two-Track Snow Groomer and Attachments

---

### 3.1.5 Warranty And Inspection Meet Requirements

3.1.5.1 Snow Groomer must include a minimum of a 12 month and first 500 operating hour warranty on all parts, which will cover the cost of removal, fitting, and travel cost associated with the repair.

3.1.5.2 Before delivery all parts of the groomer, attachments, and tracks must be inspected. All worn parts and defective components must be replaced with serviced components. All components and attachments must be inspected, functionally tested, and approved by a certified technician. Written documentation of the inspection is required.

## 4. CONTRACT AWARD:

4.1 Contract Award: The Contract is intended to provide Agencies with a purchase price for the Contract Items. The Contract shall be awarded to the Vendor that provides the Contract Items meeting the required specifications for the lowest overall total cost as shown on the Pricing Pages.

4.2 Pricing Page: Vender should complete the Pricing Page by filling in the total price for the contract item plus attachments listed in Section 3 of the specifications. Vendor should complete the Pricing Page in full as failure to complete the Pricing Page in its entirety may result in Vendor's bid being disqualified.

Vendor should type or electronically enter the information into the Pricing Page to prevent errors in the evaluation.

Vendor should provide Brand and Model of Equipment being Bid as well as any supporting documentation of the specifications of this equipment with their submitted bid response.

This documentation may be required before award of contract.

Vendor's who wish to respond to a Centralized Request for Quotation online may submit information through the State's wvOASIS, Vendor Self Services (VSS). Vendors should download the "Bid Form" that is attached separately to the CRFQ and published to the VSS.

Vendors must complete the Bid Form with their price information and any other information that is being submitted and include it as an attachment to their online response.

REQUEST FOR QUOTATION  
Blackwater Falls State Park  
Used TwoTrack Snow Groomer and Attachments

---

If unable to respond online you must submit the Bid Form with your bid prior to the bid opening date.

5. PAYMENT:

5.1 Payment: Vendor shall accept payment in accordance with the payment procedures of the State of West Virginia.

6. DELIVERY AND RETURN:

6.1 Shipment and Delivery: Vendor shall ship the Contract Items immediately after being awarded this Contract and receiving a purchase order or notice to proceed. Vendor shall deliver the Contract Items within 60 calendar days after receiving a purchase order. Contract Items must be delivered to Agency at:

Blackwater Falls State Park  
1584 Blackwater Lodge Rd.  
Davis, WV 26260

6.2 Late Delivery: The Agency placing the order under this Contract must be notified in writing if the shipment of the Contract Items will be delayed for any reason. Any delay in delivery that could cause harm to an Agency will be grounds for cancellation of the Contract, and/or obtaining the Contract Items from a third party.

Any Agency seeking to obtain the Contract Items from a third party under this provision must first obtain approval of the Purchasing Division.

6.3 Delivery Payment/Risk of Loss: Vendor shall deliver the Contract Items F.O.B. destination to the Agency's location.

6.4 Return of Unacceptable Items: If the Agency deems the Contract Items to be unacceptable, the Contract Items shall be returned to Vendor at Vendor's expense and with no restocking charge. Vendor shall either make arrangements for the return within five (5) days of being notified that items are unacceptable, or permit the Agency to arrange for the return and reimburse Agency for delivery expenses. If the original packaging cannot be utilized for the return, Vendor will supply the Agency with appropriate return packaging upon request. All returns of unacceptable items shall be F.O.B. the Agency's location. The returned product shall either be replaced, or the Agency shall receive a full credit or refund for the purchase price, at the Agency's discretion.

6.5 Return Due to Agency Error: Items ordered in error by the Agency will be returned for credit within 30 days of receipt, F.O.B. Vendor's location. Vendor shall not

REQUEST FOR QUOTATION  
Blackwater Falls State Park  
Used Two-Track Snow Groomer and Attachments

---

charge a restocking fee if returned products are in a resalable condition. Items shall be deemed to be in a resalable condition if they are unused and in the original packaging. Any restocking fee for items not in a resalable condition shall be the lower of the Vendor's customary restocking fee or 5% of the total invoiced value of the returned items.

7 VENDOR DEFAULT:

7.1 The following shall be considered a vendor default under this Contract.

- 7.1.1 Failure to provide Contract Items in accordance with the requirements contained herein.
- 7.1.2 Failure to comply with other specifications and requirements contained herein.
- 7.1.3 Failure to comply with any laws, rules, and ordinances applicable to the Contract Services provided under this Contract.
- 7.1.4 Failure to remedy deficient performance upon request.

7.2 The following remedies shall be available to Agency upon default.

- 7.2.1 Immediate cancellation of the Contract.
- 7.2.2 Immediate cancellation of one or more release orders issued under this Contract.
- 7.2.3 Any other remedies available in law or equity.



Purchasing Division  
2019 Washington Street East  
Post Office Box 50130  
Charleston, WV 25305-0130

State of West Virginia  
Request for Quotation  
13 – Equipment

Proc Folder: 116514

Doc Description: One-time purchase of a used snow groomer with attachments

Proc Type: Central Purchase Order

Date Issued	Solicitation Closes	Solicitation No	Version
2015-07-16	2015-08-05 13:30:00	CRFQ 0310 DNR1600000002	1

**BID RECEIVING LOCATION**

BID CLERK  
DEPARTMENT OF ADMINISTRATION  
PURCHASING DIVISION  
2019 WASHINGTON ST E  
CHARLESTON WV 25305  
US

Prinoth, LLC  
264 NH Route 106  
Gilmanton, NH 03237

VENDOR





# Vehicle specifications

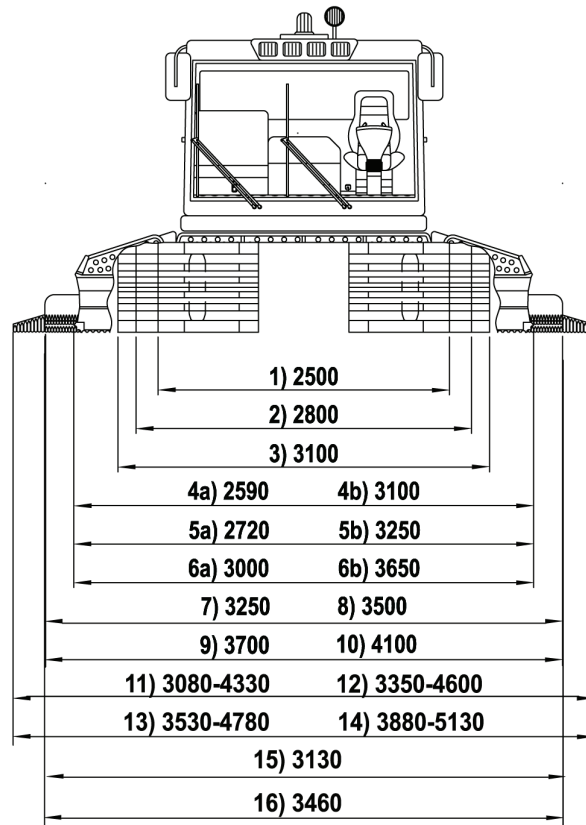
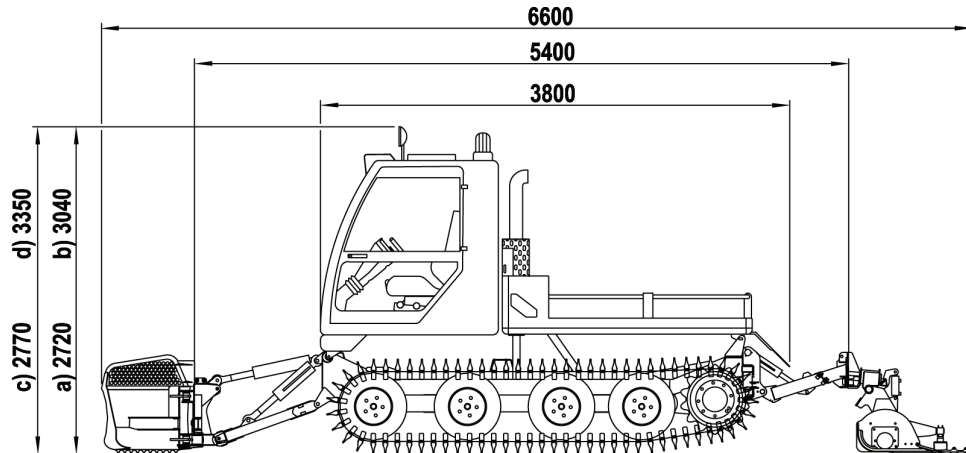

Specification

## Husky dimensions in mm

- |    |  |    |  |
|----|--|----|--|
| a  | Max. Height of vehicle, driver's cab               | 6b | Max. Dozer blade working width 3.1                 |
| b  | Max. Vehicle height with driver's cab tilted       | 7  | Rear tiller working width with fixed side wing 2.3 |
| c  | Max. Vehicle height, transport cabin               | 8  | Rear tiller working width with fixed side wing 2.5 |
| d  | Max. Height of vehicle with transport cabin tilted | 9  | Rear tiller working width with fixed side wing 2.8 |
| 1  | Track width, version 2.5                           | 10 | Rear tiller working width with fixed side wing 3.1 |
| 2  | Track width, version 2.8                           | 11 | Rear tiller working width side wings up/down 2.3   |
| 3  | Track width, version 3.1                           | 12 | Rear tiller working width side wings up/down 2.5   |
| 4a | Min. Dozer blade working width 2.5                 | 13 | Rear tiller working width side wings up/down 2.8   |
| 4b | Max. Dozer blade working width 2.5                 | 14 | Rear tiller working width side wings up/down 3.1   |
| 5a | Min. Dozer blade working width 2.8                 | 15 | Smoothing board 2.3                                |
| 5b | Max. Dozer blade working width 2.8                 | 16 | Smoothing board 3.1                                |
| 6a | Min. Dozer blade working width 3.1                 |    |  |



# Vehicle specifications

Husky		
<b>Dimensions</b>		
Vehicle length	mm	3 800
Vehicle length without attachments	mm	5 400
Vehicle length with attachments	mm	6 600
Vehicle width without tracks Driver's cab/transport cabin version	mm	2 000/2 100
Vehicle width with tracks Version 2.5 m/2.8 m/3.1 m/All-Season	mm	2 500/2 800/3 100/2 570
Rear tiller max. working width with fixed side wing Version 2.3 m/2.5 m/2.8 m/3.1 m	mm	3 250/3 520/3 700/4 100
Smoothing board version 2.3 m/3.1 m		3 130/3 460
Rear tiller max. working width with movable side wing Version 2.3 m/2.5 m/2.8 m/3.1 m	mm	4 230/4 500/4 680/5 030
Max. working width of the dozer blade with opened wings Version 2.5 m/2.8 m/3.1 m	mm	3 100/3 250/3 650
Max. vehicle height	mm	2 720
Max. vehicle height with driver's cab tilted	mm	3 040
Track width Version 2.5 m/2.8 m/3.1 m/All-Season	mm	840/1 020/1 170/800
Distance between tracks	mm	750
Min. clearance above ground (ground clearance)	mm	350
Loading platform length	mm	1 650
Loading platform width	mm	1 900
Loading platform height above ground	mm	1 100
<b>Recommended garage dimensions for maintenance work</b>		
Length	mm	8 000
Width	mm	6 000
Height	mm	3 600
<b>Weights</b>		
Empty weight	kg	3 160
Intrinsic weight with transport cabin	kg	3 570
Permissible gross vehicle weight	kg	5 800
<b>Vehicle speed</b>		
Continuous vehicle speed range	km/h	0...25
<b>Noise emission values</b>		
Sound power level (2000/14/EC)	dB (A)	105
Sound pressure level at operator's position (ISO 6394: 2008)	dB (A)	76
<b>Vibration emission values (2002/44/EC)</b>		
Hand-arm vibration	m/s <sup>2</sup>	<2.5
Whole-body vibration*	m/s <sup>2</sup>	<0.5

Specification

\* The vibration emission values indicated are derived from testing production vehicles under typical operating conditions according to intended use.





# Vehicle specifications

Husky			
<b>Diesel engine</b>			
Manufacturer		DaimlerChrysler AG	DaimlerChrysler AG
Model		Mercedes OM 904 LA	Mercedes OM 924 LA
Type		Turbo diesel with direct injection and charge air cooling High-pressure injection system with individual injection pump and fully electronic engine management, cylinder arrangement 4 in-line	Turbo diesel with direct injection and charge air cooling High-pressure injection system with individual injection pump and fully electronic engine management, cylinder arrangement 4 in-line
Total displacement	cm <sup>3</sup>	4 250	4 800
Engine power according to 80/1269/EC	kW/PS at rpm	129/176 2 200	145/197 2 200
Max. torque	Nm at rpm	675 1 200	705 1 200
Fuel consumption	l/h	min. 8.5	min. 8.5
Fuel tank capacity	l	110	110
<b>Brakes</b>			
Operating pressure	bar	min. 15	min. 15
Maximum permitted operating pressure of the brakes	bar	50	50
<b>Tyres</b>			
Tyre pressure	bar	6.5	6.5
<b>Electrical system</b>			
Operating voltage, 2 batteries in series	V	24	24
Rated voltage of the individual batteries	V	12	12
Capacity	Ah	74	74
Cold start capacity	A	680	680
Negative terminal		connected to earth	connected to earth
Current generator, Bosch	V/A	28/100	28/100
Starter motor rated output	kW	4.0	4.0





**Technical comparison between NEW HUSKY AND NEW PB100 TIER 4F**

With this fact sheet we want to illustrate some differences of the NEW HUSKY and the PB100 SCR Tier 4f, in terms of technical concept. On the next slides you will find their sales arguments and our counter arguments.

	<b>NEW HUSKY</b>	<b>PB 100 T4f</b>
Engine model	OM 934 LA	Cummins QSL 6.7
Cylinders	4	6
Displacement	5.1L	6.7L
Power output	231HP	234HP
Torque	900 Nm	949 Nm
Speed	24km/h	25km/h
Exhaust level	Tier 4F	Tier 4F
Exhaust system type	SCR	SCR+ AGR
Chassis	Single suspension with springs	Single suspension with tensioning bar
Lenght	8.500mm	8.893mm
Height Std	2.770 mm	2.620mm
Weight Std (vehicle + track)	4.890kg	Rough estimation 5.100kg (assumption: 120 kg weight increase on Powertrain (6 cylinder + SCR system), cooler not calculated)

Pistenbully promotes the PB100 SCR Tier 4F by using the following arguments.  
We complete the picture by adding some information.

*Pistenbully claims...*

**“Most powerful engine in its class”**

Cummins QSL 6.7L engine with 234HP and 949NM

PRINOTH counter arguments:

- ✓ Weight increase due to bigger engine (cooling system and more cylinders)
- ✓ More fuel consumption due to the bigger engine
- ✓ Heavier main frame because of the weight and power increase of the engine



NEW HUSKY engine

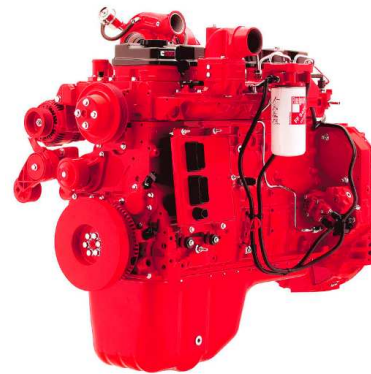

PB100 SCR T4f

*Pistenbully claims...*

### “Solid base”

A great deal of optimization work has also been performed **on the chassis and frame**: the new axle technology is more stable and delivers 60 % higher load capacity. Four axles ensure greater ride comfort and the best gradability.

PRINOTH counter arguments:

- ✓ PRINOTH machine frame was recalculated by using the finite element method, finding the perfect balance between lowest weight and structure reliability
- ✓ Optimal center of gravity → Low impact on suspension and less intermittent stress on the tracks
- ✓ Optimal maneuverability thanks to less area of support → smaller turning radius possible
- ✓ Low impact on the ground when turning, less ground damage

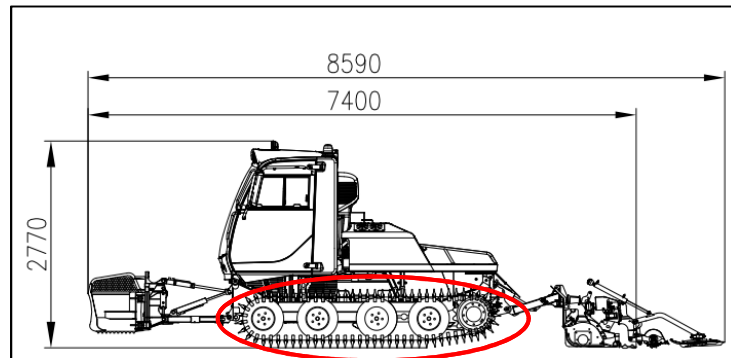

PRINOTH- Husky

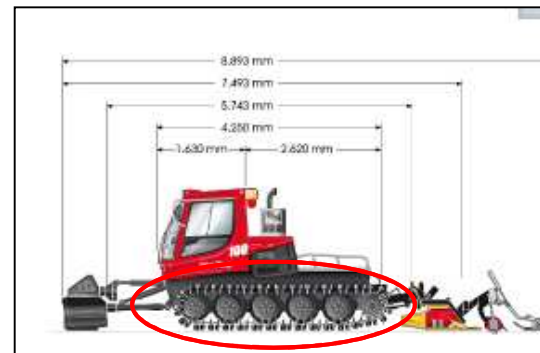

Pistenbully-PB100

*Pistenbully claims...*

## “Comfortable cab”

Standardised operating concept in all new-generation vehicles and new intuitive control concept.

### PRINOTH counter arguments

- ✓ The PB joystick is new on the market → No real customer feedback yet, no proven solution
- ✓ The cabin at the fair is a Prototype vehicle and market acceptance is not given yet
- ✓ Confirmed feedback from our customers about the PRINOTH universal operating concept
- ✓ Most spacious and comfortable cabin on the market (same cabin structure as on the bigger snowgroomer)
- ✓ Better overview thanks to great window areas
- ✓ Very silent cabin thanks to high level insulation



*Pistenbully claims...*

### “New hydraulics”

Increased drive output and performance, as well as higher tensile force, lower revs at the same speed and, thus, fuel savings and reduced noise, plus simultaneous control of front and rear attachments.

PRINOTH counter arguments:

- ✓ The hydraulic concept of the “NEW HUSKY” was completely new developed for better power transmission
- ✓ Customer feedback is really good
- ✓ Perfect steering behavior with levers or wheel
- ✓ Improved blade and tiller movements
- ✓ Powerful vehicle with a lot’s of pushing performance so that it even is used as a small grooming vehicle



*Pistenbully claims...*

### “New tiller generation”

Individual and independent setting of the tiller and track setters in terms of tiller depth is now possible for the first time. Likewise, the contact pressure of the tiller and the track setters can also be set independently of each other.

PRINOTH counter arguments:

- ✓ PB had problems when using a tracksetting equipment. No nice finish was achieved and operators left uneven slope. We never had this issue.



*Pistenbully claims...*

### “Track setter in perfection”

The track setters can be removed quickly and easily without tools when not required, saving weight and fuel. The redesign has also achieved improved terrain adaptation and a clearer view of the tiller.

PRINOTH counter arguments:

- ✓ PRINOTH benefits from a great following behavior in curves Better following behavior as PB because of a better fixation concept which guarantees always a perfect finish especially in tight curves.
- ✓ Improved stabilization ensure a clean track line
- ✓ Operator oriented operation concept: Add on of the joystick simplifies at maximum the operation of a tracksetting equipment





*Pistenbully claims...*

### “Power – blade”

Even more snow can now be moved thanks to a higher snow guard. Additional functions make work easier.

PRINOTH counter arguments:

- ✓ PRINOTH offers a MASTER BLADE also for its smallest vehicle, the NEW HUSKY, permitting an additional blade for the customer:
  - ✓ More aggressive blade teeth
  - ✓ Perfect geometry for a better snow rolling inside the blade
  - ✓ Higher pushing performance with less power



*Pistenbully claims...*

### “New combined tracks”

The new PistenBully 100 is equipped with completely new combined tracks. This new development also leads to several advantages: the reduced number of parts decreases storage volumes and costs for customers, while a new drive wheel increases drive comfort thanks to fewer vibrations, and automatic chain tensioning ensures lower wear and tear.

PRINOTH counter arguments:

- ✓ Customer can choose between three different tracks in 3 different widths, in order to find the ideal solution for his application:
  - ✓ Alu track (improved quality of track guides)
  - ✓ Steel track (improved quality of crosslinks and track guides)
  - ✓ All season track
- ✓ Hydraulic track tension as standard

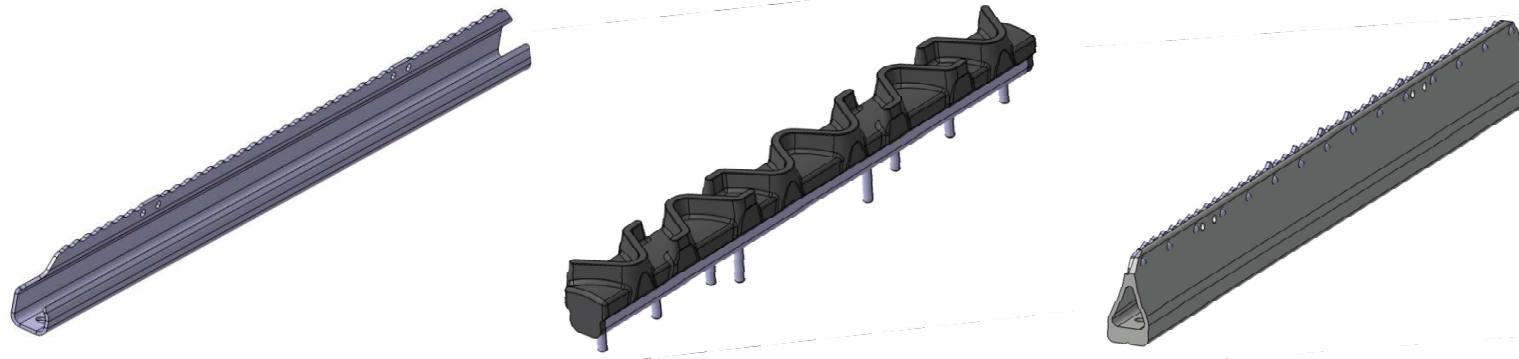

*Pinotti*<sup>®</sup>



Purchasing Division  
 2019 Washington Street East  
 Post Office Box 50130  
 Charleston, WV 25305-0130

State of West Virginia  
 Request for Quotation  
 13 — Equipment

Proc Folder: 116514

Doc Description: One-time purchase of a used snow groomer with attachments

Proc Type: Central Purchase Order

Date Issued	Solicitation Closes	Solicitation No	Version
2015-07-16	2015-08-05 13:30:00	CRFQ 0310 DNR1600000002	1

**BID RECEIVING LOCATION**

BID CLERK  
 DEPARTMENT OF ADMINISTRATION  
 PURCHASING DIVISION  
 2019 WASHINGTON ST E  
 CHARLESTON WV 25305  
 US

**VENDOR**

**Vendor Name, Address and Telephone Number:**

Bill Cox  
 PRINOTH LLC  
 264 NH ROUTE 106  
 GILMANTON, NH 03237  
 603-267-7840

**FOR INFORMATION CONTACT THE BUYER**

Guy Nisbet  
 (304) 558-2596  
 guy.l.nisbet@wv.gov

Signature X	<i>Bill Cox</i>	FEIN #	33-1099093	DATE	8/4/2015
-------------	-----------------	--------	------------	------	----------

All offers subject to all terms and conditions contained in this solicitation

INVOICE TO		SHIP TO	
SUPERINTENDENT DIVISION OF NATURAL RESOURCES BLACKWATER FALLS STATE PARK PO BOX 490		SUPERINTENDENT DIVISION OF NATURAL RESOURCES BLACKWATER FALLS STATE PARK 1584 BLACKWATER LODGE RD	
DAVIS	WV26260-0490	DAVIS	WV 26260-0490
US		US	

Line	Comm Ln Desc	Qty	Unit Issue	Unit Price	Total Price
1	Used Two Tracked Snow Groomer- Pistenbully 100, or equal	1.00000	EA		

Comm Code	Manufacturer	Specification	Model #
22101538			

**Extended Description :**

Includes all attachments specified in Section 3 of the mandatory requirements.

<b>DNR160000002</b>	<b>Document Phase</b> <b>Final</b>	<b>Document Description</b> One-time purchase of a used snow groomer with attachments	<b>Page 3</b> <b>of 3</b>
---------------------	---------------------------------------	---	------------------------------

**ADDITIONAL TERMS AND CONDITIONS**

See attached document(s) for additional Terms and Conditions

# THE AMERICAN INSTITUTE OF ARCHITECTS

## AIA Document A310 Bid Bond

KNOW ALL MEN BY THESE PRESENTS, THAT WE Prinoth LLC

as Principal, hereinafter called the Principal, and Fidelity and Deposit Company of Maryland

a corporation duly organized under the laws of the State of Maryland

as Surety, hereinafter called the Surety, are held and firmly bound unto State of West Virginia

as Obligee, hereinafter called the Obligee, in the sum of Five Percent of Bid Amount

----- Dollars (\$ 5% of Bid Amount ),  
for the payment of which sum well and truly to be made, the said Principal and the said Surety, bind ourselves, our heirs, executors, administrators, successors and assigns, jointly and severally, firmly by these presents.

WHEREAS, the Principal has submitted a bid for Solicitation No CRFQ 0310 DNR160000002

Proc Folder: 116514; Doc Description: One-time purchase of a used snow groomer with attachments; Proc Type: Central Purchase Order

NOW, THEREFORE, if the Obligee shall accept the bid of the Principal and the Principal shall enter into a Contract with the Obligee in accordance with the terms of such bid, and give such bond or bonds as may be specified in the bidding or Contract Documents with good and sufficient surety for the faithful performance of such Contract and for the prompt payment of labor and materials furnished in the prosecution thereof, or in the event of the failure of the Principal to enter such Contract and give such bond or bonds, if the Principal shall pay to the Obligee the difference not to exceed the penalty hereof between the amount specified in said bid and such larger amount for which the Obligee may in good faith contract with another party to perform the Work covered by said bid, then this obligation shall be null and void, otherwise to remain in full force and effect.

Signed and sealed this 3rd day of August, 2015

Prinoth LLC

(Principal)

(Seal)

(Witness)

By:

SECRETARY

(Title)

Fidelity and Deposit Company of Maryland

(Surety)

(Seal)

Please see attached Loose Notary Acknowledgment

(Witness)

By:

Attorney-in-Fact Jessica L. Nowlin

(Title)

**CALIFORNIA ALL-PURPOSE ACKNOWLEDGMENT**

**CIVIL CODE § 1189**

A notary public or other officer completing this certificate verifies only the identity of the individual who signed the document to which this certificate is attached, and not the truthfulness, accuracy, or validity of that document.

State of California )  
County of San Francisco )  
On August 3, 2015 before me, Teri L. Koehler, Notary Public,  
*Date Here Insert Name and Title of the Officer*  
personally appeared Jessica L. Nowlin  
*Name(s) of Signer(s)*

who proved to me on the basis of satisfactory evidence to be the person~~(s)~~ whose name~~(s)~~ is/~~are~~ subscribed to the within instrument and acknowledged to me that ~~he~~/she/~~they~~ executed the same in ~~his~~/her/~~their~~ authorized capacity~~(ies)~~, and that by ~~his~~/her/~~their~~ signature~~(s)~~ on the instrument the person~~(s)~~, or the entity upon behalf of which the person~~(s)~~ acted, executed the instrument.

I certify under PENALTY OF PERJURY under the laws of the State of California that the foregoing paragraph is true and correct.

WITNESS my hand and official seal.



Signature Teri L. Koehler  
*Signature of Notary Public*

*Place Notary Seal Above*

**OPTIONAL**

*Though this section is optional, completing this information can deter alteration of the document or fraudulent reattachment of this form to an unintended document.*

**Description of Attached Document**

Title or Type of Document: \_\_\_\_\_ Document Date: \_\_\_\_\_  
Number of Pages: \_\_\_\_\_ Signer(s) Other Than Named Above: \_\_\_\_\_

**Capacity(ies) Claimed by Signer(s)**

Signer's Name: \_\_\_\_\_  
 Corporate Officer — Title(s): \_\_\_\_\_  
 Partner —  Limited  General  
 Individual  Attorney in Fact  
 Trustee  Guardian or Conservator  
 Other: \_\_\_\_\_  
Signer Is Representing: \_\_\_\_\_

Signer's Name: \_\_\_\_\_  
 Corporate Officer — Title(s): \_\_\_\_\_  
 Partner —  Limited  General  
 Individual  Attorney in Fact  
 Trustee  Guardian or Conservator  
 Other: \_\_\_\_\_  
Signer Is Representing: \_\_\_\_\_



**ZURICH AMERICAN INSURANCE COMPANY  
COLONIAL AMERICAN CASUALTY AND SURETY COMPANY  
FIDELITY AND DEPOSIT COMPANY OF MARYLAND  
POWER OF ATTORNEY**

KNOW ALL MEN BY THESE PRESENTS: That the ZURICH AMERICAN INSURANCE COMPANY, a corporation of the State of New York, the COLONIAL AMERICAN CASUALTY AND SURETY COMPANY, a corporation of the State of Maryland, and the FIDELITY AND DEPOSIT COMPANY OF MARYLAND a corporation of the State of Maryland (herein collectively called the "Companies"), by **THOMAS O. MCCLELLAN, Vice President**, in pursuance of authority granted by Article V, Section 8, of the By-Laws of said Companies, which are set forth on the reverse side hereof and are hereby certified to be in full force and effect on the date hereof, do hereby nominate, constitute, and appoint **David ALVARADO, Scott GADDY, Jeff PARKHURST, Jessica L. NOWLIN, Teri L. KOEHLER, Shaina E. GLISCHINSKI and Sofia OCEGUEDA, all of San Francisco, California, EACH** its true and lawful agent and Attorney-in-Fact, to make, execute, seal and deliver, for, and on its behalf as surety, and as its act and deed: **any and all bonds and undertakings**, and the execution of such bonds or undertakings in pursuance of these presents, shall be as binding upon said Companies, as fully and amply, to all intents and purposes, as if they had been duly executed and acknowledged by the regularly elected officers of the ZURICH AMERICAN INSURANCE COMPANY at its office in New York, New York., the regularly elected officers of the COLONIAL AMERICAN CASUALTY AND SURETY COMPANY at its office in Owings Mills, Maryland., and the regularly elected officers of the FIDELITY AND DEPOSIT COMPANY OF MARYLAND at its office in Owings Mills, Maryland., in their own proper persons.

The said Vice President does hereby certify that the extract set forth on the reverse side hereof is a true copy of Article V, Section 8, of the By-Laws of said Companies, and is now in force.

IN WITNESS WHEREOF, the said Vice-President has hereunto subscribed his/her names and affixed the Corporate Seals of the said ZURICH AMERICAN INSURANCE COMPANY, COLONIAL AMERICAN CASUALTY AND SURETY COMPANY, and FIDELITY AND DEPOSIT COMPANY OF MARYLAND, this 29th day of June, A.D. 2015.

ATTEST:

**ZURICH AMERICAN INSURANCE COMPANY  
COLONIAL AMERICAN CASUALTY AND SURETY COMPANY  
FIDELITY AND DEPOSIT COMPANY OF MARYLAND**



By: *Eric D. Barnes*  
*Secretary*  
*Eric D. Barnes*

*Thomas O. McClellan*  
*Vice President*  
*Thomas O. McClellan*

State of Maryland  
County of Baltimore

On this 29th day of June, A.D. 2015, before the subscriber, a Notary Public of the State of Maryland, duly commissioned and qualified, **THOMAS O. MCCLELLAN, Vice President, and ERIC D. BARNES, Secretary**, of the Companies, to me personally known to be the individuals and officers described in and who executed the preceding instrument, and acknowledged the execution of same, and being by me duly sworn, deposed and saith, that he/she is the said officer of the Company aforesaid, and that the seals affixed to the preceding instrument are the Corporate Seals of said Companies, and that the said Corporate Seals and the signature as such officer were duly affixed and subscribed to the said instrument by the authority and direction of the said Corporations.

IN TESTIMONY WHEREOF, I have hereunto set my hand and affixed my Official Seal the day and year first above written.

*Constance A. Dunn*



Constance A. Dunn, Notary Public  
My Commission Expires: July 14, 2019

**EXTRACT FROM BY-LAWS OF THE COMPANIES**

"Article V, Section 8, Attorneys-in-Fact. The Chief Executive Officer, the President, or any Executive Vice President or Vice President may, by written instrument under the attested corporate seal, appoint attorneys-in-fact with authority to execute bonds, policies, recognizances, stipulations, undertakings, or other like instruments on behalf of the Company, and may authorize any officer or any such attorney-in-fact to affix the corporate seal thereto; and may with or without cause modify or revoke any such appointment or authority at any time."

**CERTIFICATE**

I, the undersigned, Vice President of the ZURICH AMERICAN INSURANCE COMPANY, the COLONIAL AMERICAN CASUALTY AND SURETY COMPANY, and the FIDELITY AND DEPOSIT COMPANY OF MARYLAND, do hereby certify that the foregoing Power of Attorney is still in full force and effect on the date of this certificate; and I do further certify that Article V, Section 8, of the By-Laws of the Companies is still in force.

This Power of Attorney and Certificate may be signed by facsimile under and by authority of the following resolution of the Board of Directors of the ZURICH AMERICAN INSURANCE COMPANY at a meeting duly called and held on the 15th day of December 1998.

RESOLVED: "That the signature of the President or a Vice President and the attesting signature of a Secretary or an Assistant Secretary and the Seal of the Company may be affixed by facsimile on any Power of Attorney...Any such Power or any certificate thereof bearing such facsimile signature and seal shall be valid and binding on the Company."

This Power of Attorney and Certificate may be signed by facsimile under and by authority of the following resolution of the Board of Directors of the COLONIAL AMERICAN CASUALTY AND SURETY COMPANY at a meeting duly called and held on the 5th day of May, 1994, and the following resolution of the Board of Directors of the FIDELITY AND DEPOSIT COMPANY OF MARYLAND at a meeting duly called and held on the 10th day of May, 1990.

RESOLVED: "That the facsimile or mechanically reproduced seal of the company and facsimile or mechanically reproduced signature of any Vice-President, Secretary, or Assistant Secretary of the Company, whether made heretofore or hereafter, wherever appearing upon a certified copy of any power of attorney issued by the Company, shall be valid and binding upon the Company with the same force and effect as though manually affixed.

IN TESTIMONY WHEREOF, I have hereunto subscribed my name and affixed the corporate seals of the said Companies, this 3rd day of August, 20 15



Michael Bond, Vice President



**NEW  
HUSKY**

THE FRONT RUNNER

***Pinotti***<sup>®</sup>

# NEW HUSKY

## A Front Runner is on its Way.



### CLEAN MOTION – SUSTAINABILITY

**Your contribution to a clean environment.** The world's first snow groomer to be fitted with a pioneering engine, which meets the current cleanest exhaust emission standard, Stage IV/Tier 4 final for mobile machinery.

### COMFORTABLE CABIN

**Spacious, ergonomic and comfortable.** All steering and driving controls are arranged in a user-friendly way, to ensure that the driver has a comfortable workplace and easy drive. The improved ergonomics and modernized control system optimizes workflows and reduces the number of operating hours. Reduced acoustic levels, perfect view and the sophisticated light system enable drivers to pay full attention to the slopes.

### INNOVATIVE TECHNOLOGY

**Compact design, excellent climbing ability & high level of maneuverability.** Through the larger hydraulic pump which enhances the efficiency of the drivetrain, leading to improved power transmission, the higher torque significantly boosts the vehicle's pushing performance and increases the quality of the snow grooming results. Snow groomer easy to drive and maintain.

**4F**  
– emission  
+ efficiency

# TECHNICAL DATA

## DIMENSIONS AND WEIGHT

Overall vehicle length	4,065 mm (160 in)
Overall vehicle length with attachments	7,400 mm (291 in)
Overall vehicle length with attachments including Nordic Liner	8,590 mm (338 in)
Overall height	2,770 mm (109 in)
Versions of working width	2.5/2.8/3.1 m
Shipping dimensions (length-width-height)	5,110 mm - 2,445 mm - 2,655 mm (201 in - 96 in - 104 in)
Vehicle weight with aluminum tracks and attachments (blade, tiller) from	5,565 kg (12,269 lb)
Permitted gross weight	7,500 kg (16,534 lb)

## PERFORMANCE

Max. speed	24 km/h (14.9 mph)
Turning radius	0°
Payload	500 kg (1,102 lb)

## DRIVE

Drive pump	90 cm <sup>3</sup> (9 l)
Final drive	63 cm <sup>3</sup> (6,3 l)

## INCLUDED FUNCTIONS IN STANDARD CONFIGURATION

Adjustable down pressure, cruise control, on board diagnostic, multiple driver profiles, hydraulic track tensioning

## CABIN

Left hand drive, mechanical suspension, adjustable  
 Seat bench for 1,5 persons  
 7" in color display  
 Steering wheel  
 PRINOTH UNIVERSAL joystick  
 Tinted sunroof  
 Heated windows  
 Heated mirrors  
 Hydraulically tiltable cabin  
 Radio FM/AM, CD, MP3, WMA; input for USB, iPod/iPad direct control via USB, AUX in  
 ROPS certified according to EN 15059

## ENGINE

Model	MTU OM 934
Power output (ECE)	170 kW/231 PS (170 kW/228 bhp)
Max. torque	900 Nm @ 1,200-1,600 min <sup>-1</sup>
Displacement	5.1 l
Layout	In line 4 cylinder, direct injection, Common Rail
Exhaust emission standard	Stufe IV/ EPA Tier 4
Emission regulation type	SCR
Tank capacity fuel	150 l (39.6 gal)
Tank capacity AdBlue®	40 l (10.5 gal)

## OPTIONS

Comfort seat  
 Steering levers  
 Air conditioning  
 Heated wipers  
 Full-LED equipment (with 4 working lights on the mirror supports)  
 Brushguard  
 Rear view camera  
 RESOURCE MANAGEMENT  
 SNOW DEPTH MEASUREMENT  
 Radio with DAB Plus and Bluetooth®  
 Additional fuel tank (125 l)  
 Floating position blade  
 Side wings for tiller  
 Preparation for front hydraulics  
 Steel tracks  
 All season tracks

## ELECTRICAL SYSTEM

Operating voltage	24 VDC
Starter	24 VDC
Generator	28 VDC/150 A
Battery	2 x 12 VDC/74 Ah
Starting capacity	680 A (EN)

## ILLUMINATION

4 halogen working lights  
 2 high/low beam lights  
 Direction and position lights  
 2 turning lights  
 4 halogen working lights at the back

## ADDITIONAL EQUIPMENT

Nordic Liner basic (with/ without track tiller)  
 Nordic Liner move (with/ without track tiller)

## 12-WAY BLADE

### STANDARD

### MASTER

Open	3,250 mm (127 in)	3,650 mm (143 in)	3,875 mm (152 in)
Closed	2,720 mm (107 in)	3,000 mm (118 in)	3,220 mm (126 in)

## TILLER

### 2.3 m

### 2.5 m

### 2.8 m

### 3.1 m

Tiller without hydraulic side wings	3,255 mm (128 in)	3,530 mm (138 in)	3,700 mm (145 in)	4,060 mm (160 in)
Tiller with hydraulic side wings up	3,075 mm (121 in)	3,345 mm (131 in)	3,530 mm (139 in)	3,880 mm (152 in)
Tiller with hydraulic side wings down	4,095 mm (161 in)	4,365 mm (171 in)	4,550 mm (179 in)	4,900 mm (192 in)

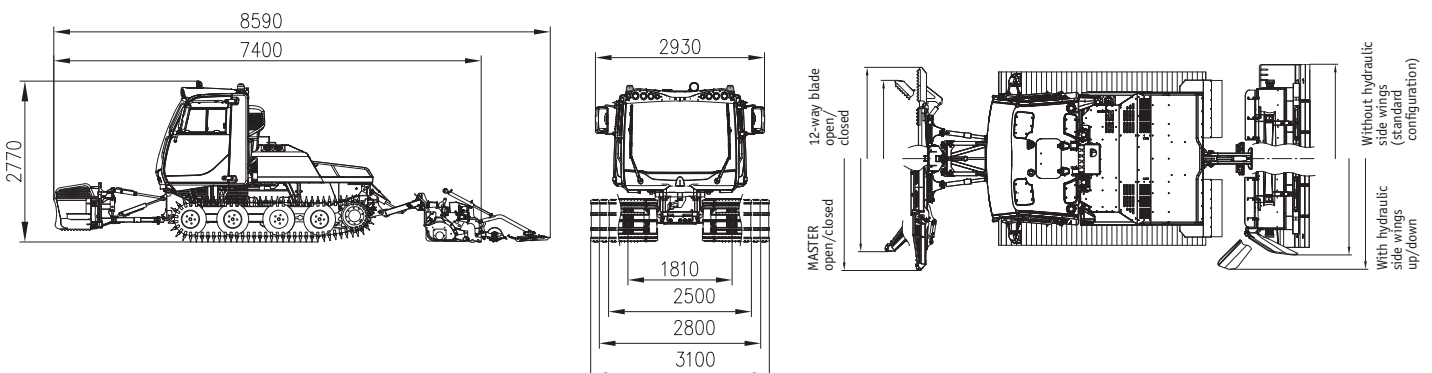

[www.prinoth.com](http://www.prinoth.com)

***Prinoth***<sup>®</sup>

PRINOTH AG  
Brennerstraße 34  
39049 Sterzing (BZ)  
ITALY  
Tel. +39 0472 72 26 22  
Fax +39 0472 72 26 18  
[prinoth@prinoth.com](mailto:prinoth@prinoth.com)

PRINOTH S.A.S.  
5, Rue Galilée Alpespace B.P. 62  
73802 Montmelian, Cedex  
FRANCE  
Tel. +33 479 84 76 76  
Fax +33 479 84 76 77  
[prinoth.france@prinoth.com](mailto:prinoth.france@prinoth.com)

PRINOTH AG  
Gemmistrasse 45  
3970 Salgesch  
SWITZERLAND  
Tel. +41 27 456 26 56  
Fax +41 27 456 47 00  
[info@prinoth.ch](mailto:info@prinoth.ch)

PRINOTH LLC  
2746 Seeber Drive Bldg B  
Grand Junction, co 81506  
USA  
Tel. +1 970 242 7150  
Fax +1 970 241 6722  
[prinoth.us@prinoth.com](mailto:prinoth.us@prinoth.com)

PRINOTH GmbH  
Michael-Seeber-Straße 1  
6410 Telfs  
AUSTRIA  
Tel. +43 526 262 121  
Fax +43 526 262 123 160  
[prinoth.austria@prinoth.com](mailto:prinoth.austria@prinoth.com)

PRINOTH Eastern Canada  
1001, J.-A. Bombardier Street  
Granby Qc J2J 1E9  
CANADA  
Tel. +1 450 776 3663  
Fax +1 450 776 3685  
[prinoth.canada@prinoth.com](mailto:prinoth.canada@prinoth.com)



Exhibit "A"  
DNR Blackwater Falls State Park  
Used Groomer - Pricing Page

Item	Description	Manufacturer and Model for "or equal" bids	Qty.	Unit Price	Extended Price
1	Used Two Tracked Snow Groomer- Pistenbully 100, or equal.  Includes all attachments specified in Section 3 of the mandatory requirements.	Prinoth Husky Snowgroomer Serial # HU11328	1	\$143,000	\$143,000.00
TOTAL BID AMOUNT (Includes Shipping Costs)					\$143,000.00

\*If bidding "or equal" brands, vendor should include manufacturer 's literature documenting it meets the mandatory requirements stated in the specifications. This information may be required before award of contract.

Vendors should note the areas of the provided manufacturer's literature that adheres to the mandatory requirements outlined in the CRFQ.

Exhibit "A"  
DNR Blackwater Falls State Park  
Used Groomer - Pricing Page

Item	Description	Manufacturer and Model for "or equal" bids	Qty.	Unit Price	Extended Price
1	Used Two Tracked Snow Groomer- Pistenbully 100, or equal.  Includes all attachments specified in Section 3 of the mandatory requirements.	Prinoth Husky Snowgroomer Serial # HS10144	1	\$212,000	\$212,000.00
TOTAL BID AMOUNT (Includes Shipping Costs)					\$212,000.00

\*If bidding "or equal" brands, vendor should include manufacturer 's literature documenting it meets the mandatory requirements stated in the specifications. This information may be required before award of contract.

Vendors should note the areas of the provided manufacturer's literature that adheres to the mandatory requirements outlined in the CRFQ.