

EXPRESSION OF INTEREST  
for  
MAURIN MINE FIRE & PORTALS  
MONONGALIA COUNTY, WEST VIRGINIA

DEP 16436  
APRIL 10, 2014

04/09/14 09:42:59AM  
West Virginia Purchasing Division

Project Location - County Highway Map  
Maurin Mine Fire and Portals: WV-4150

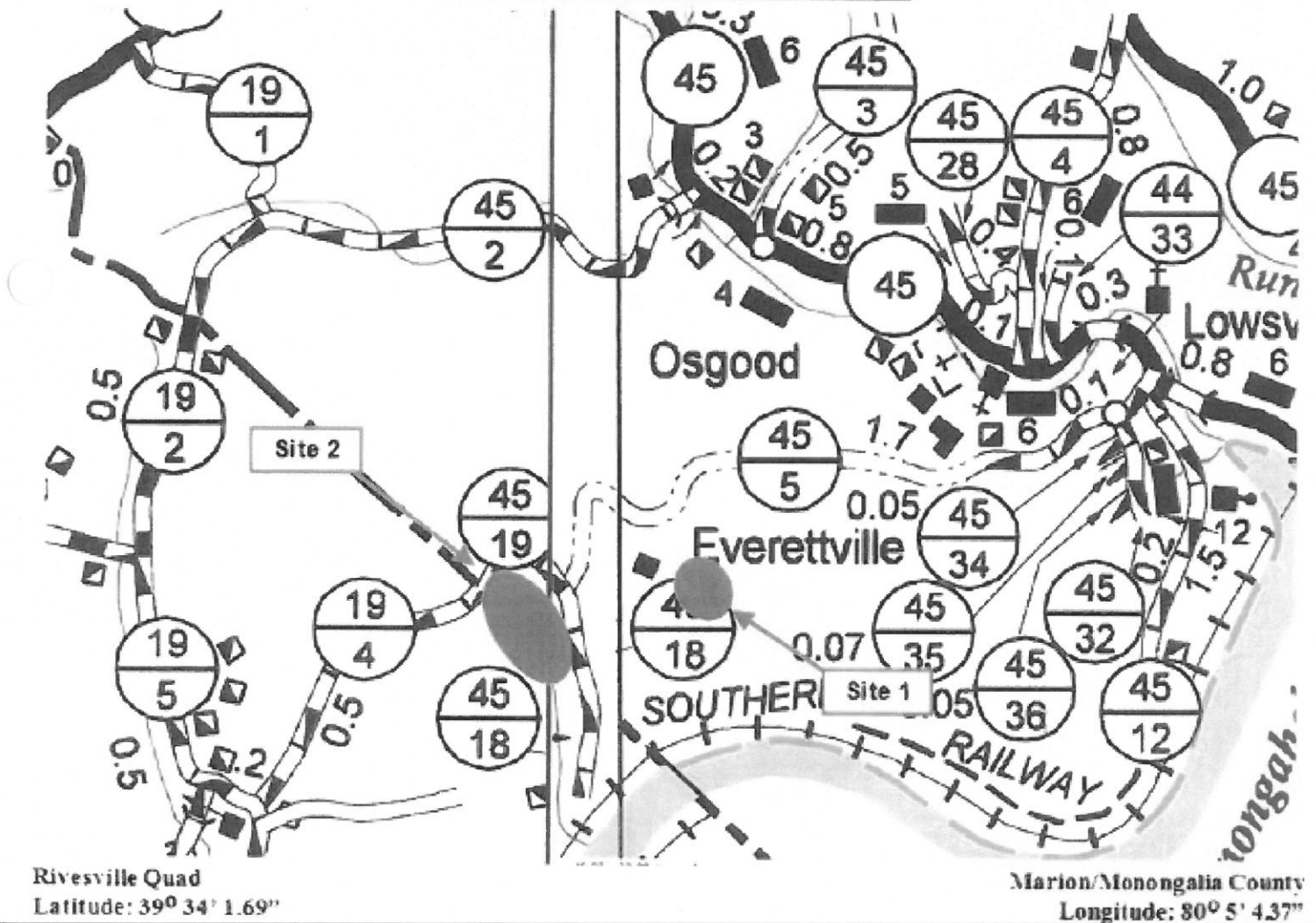

Rivesville Quad  
Latitude: 39° 34' 1.69"

Marion/Monongalia County  
Longitude: 80° 5' 43.7"

**THRASHER**

600 WHITE OAKS BLVD.  
BRIDGEPORT, WV 26330  
www.thrashereng.com



State of West Virginia  
 Department of Administration  
 Purchasing Division  
 2019 Washington Street East  
 Post Office Box 50130  
 Charleston, WV 25305-0130

**Solicitation**

NUMBER
DEP16436

PAGE
1

ADDRESS CORRESPONDENCE TO ATTENTION OF:
FRANK WHITTAKER
304-558-2316

RFQ COPY

TYPE NAME/ADDRESS HERE

V  
E  
N  
D  
O  
R

S  
H  
I  
P  
T  
O

ENVIRONMENTAL PROTECTION  
 DEPARTMENT OF  
 OFFICE OF AML&R  
 601 57TH STREET SE  
 CHARLESTON, WV  
 25304 304-926-0499

DATE PRINTED
03/20/2014

BID OPENING DATE: 04/10/2014 BID OPENING TIME 1:30PM

LINE	QUANTITY	UOP	CAT. NO.	ITEM NUMBER	UNIT PRICE	AMOUNT
0001	1	JB		906-29		
MAURIN MINE FIRE & PORTALS DESIGN						
EXPRESSION OF INTEREST						
THE WEST VIRGINIA PURCHASING DIVISION, FOR THE AGENCY, THE WEST VIRGINIA DEPARTMENT OF ENVIRONMENTAL PROTECTION, IS SOLICITING EXPRESSIONS OF INTEREST FOR PROFESSIONAL ENGINEERING DESIGN SERVICES AND CONSTRUCTION MONITORING SERVICES AT THE MAURIN MINE FIRE AND PORTALS, MONONGALIA COUNTY, WEST VIRGINIA PER THE FOLLOWING BID REQUIREMENTS AND ATTACHED SPECIFICATIONS.						
***** THIS IS THE END OF RFQ DEP16436 ***** TOTAL:						

SIGNATURE <i>Chad Beller</i>	TELEPHONE 304-624-4108	DATE April 10, 2014
TITLE Principal In Charge	FEIN 55-0633596-6	ADDRESS CHANGES TO BE NOTED ABOVE

WHEN RESPONDING TO SOLICITATION, INSERT NAME AND ADDRESS IN SPACE ABOVE LABELED 'VENDOR'

April 10, 2014  
Department of Administration, Purchasing Division  
2019 Washington Street East  
Charleston, WV 25305-0130

RE: DEP 16436, Maurin Mine Fire and Portals

Dear Members of the Selection Committee:

Thrasher is no stranger to DEP AML projects. Our attention to detail and project execution speak for itself. Like most projects we undertake, Thrasher has visited the Maurin Mine project site. We understand the depth and breath of this project and believe we will provide timely, cost effective improvements. Our experience in mine portal design projects assures project success.

As the Principal-In-Charge, I have assembled a team of professionals who will deliver based on the following competencies:

- ***detailed review of the existing conditions of the project area,***
- ***ability to provide recommendations and options for the improvements,***
- ***preparation of itemized cost estimates,***
- ***review of estimate and design concepts,***
- ***development of drawings, showing all required work, and***
- ***construction administration.***

Thrasher has built a business reputation that stands on integrity, experience, efficiency and judgment. In taking this approach, we have carefully and concisely responded to your request. We have assembled an experienced group of professionals to meet the various needs of this project. Our knowledge of the area and proximity to the site will prove to be advantageous to the successful completion of this project.

Sincerely,



Partner, Principal-in-Charge

# SELECTION CRITERIA

**A. WV Professional Engineers in the Primary Office:** Thrasher employs 14 registered PE's at our company headquarters located in Bridgeport, WV.

- H. Wood "Woody" Thrasher, PE
- Chad Biller, PE
- Mike Nestor, PE
- Daniel Ferrell, PE
- Ken Moran, PE
- Clay Riley, PE
- Matt Fluharty, PE
- Tom Urquhart, PE, BCEE
- Chad Riley, PE
- Jeff Gola, PE
- Doug Forni, PE
- Rob Milne, PE
- Richard Hovatter, PE
- Brad Messenger, PE
- Garrett Grubb, PE

**B. Our reclamation engineering design experience as it relates to the specific project:**

- Chad Biller, PE, Principal-in-Charge. Chad has more than 19 years of civil engineering experience with specific emphasis in mine reclamation, site development, highways, roads, bridges, and airports. Mr. Biller has managed the design and construction administration for a number of large grading and drainage projects in West Virginia. These projects have included design for mine reclamation, industrial and business parks, highways, and airports. Mr. Biller is also familiar with reclamation of mine portals, using either wet or dry seals.
- April Rohrbaugh, Staff Engineer has completed the design of four AML projects, under the direction of Chad Biller.
- Richard "RJ" Hovatter, PE has extensive experience in grouting projects for the WVDEP.

**C. Available AML Design Team:**

**Civil PE's:** Chad Biller, Richard Hovatter, Mike Nestor, Dan Ferrell, Ken Moran, Clay Riley, Matt Fluharty, Tom Urquhart, Chad Riley, Jeff Gola and Doug Forni

**CAD:** Cliff Cleavenger, Brandon Hinkle, John Pitman, Jason Heflin, Joe Lowther, Phil Lantz, John Sirianni, Robert Hebb, Mike Oldaker, Zack Gain and Tudy Heil

# BACKGROUND

Thrasher is a privately owned engineering firm that specializes in multidisciplinary engineering services. Established in 1983, Thrasher is built on stable leadership, financial strength and reputation. Our dedication to creative design solutions, well-managed projects and customer service has made Thrasher West Virginia's largest privately owned engineering firm and an industry leader in the Mid-Atlantic region.

Since our formation, the company has grown to a firm of more than 250 employees. Our diverse staff has the resources to handle many projects, both large and small, simultaneously. Our client base is diverse and includes municipalities, state and federal government agencies, secondary and higher education, public and private entities, etc.

## Principals:

H. Wood "Woody" Thrasher, PE  
 Kenneth P. Moran, PE, PS  
 Chad M. Riley, PE  
 Daniel E. Ferrell, PE  
 Wm. Randy Watson, PE  
 Clay P. Riley, PE  
 Jonathan Carpenter, PE  
 Chadwick D. Biller, PE  
 Craig Baker, Associate AIA  
 Robert R. Milne, PE  
 Ron Stanley, CPA  
 Jenelle Armstrong, PE  
 Matt Fluharty, PE

## Our Locations:

Bridgeport, West Virginia  
 Charleston, West Virginia  
 Beckley, West Virginia  
 Princeton, West Virginia  
 Oakland, Maryland  
 Canton, Ohio  
 Fredericksburg, Virginia

## Multi-Disciplinary Services:

Civil Engineering  
 Utility Services  
 Land and Site Development  
 Roadways  
 Bridges  
 Streetscapes  
 Airports  
 Storm Water Systems  
 Environmental Services  
 Architecture  
 Land Planning  
 Landscape Architecture  
 Construction Monitoring  
 Materials Testing  
 Pipeline Inspection  
 GIS Mapping

# OUR APPROACH TO AML

Thrasher has, or is in the process of, completing eight Abandoned Mine Lands (AML) projects for the West Virginia Department of Environmental Protection (WVDEP). While the scope of the projects varies, Thrasher has the experience and resources to apply the following design aspects:

**Reclaim Refuse Piles:** refuse piles were incorporated into the backfill of re-graded highwalls. These areas are then covered with soil and re-seeded.

**Highwall Re-Grading:** miles of highwalls have been backfilled and re-graded utilizing plans developed by Thrasher. Balancing the amount of cut and fill and keeping the amount of disturbance to a minimum is a challenge on any AML project. Thrasher has successfully met these challenges on other projects.

**Sealing of Portals:** Thrasher has developed plans for dozens of wet and modified mine seals for AML projects, including bat gate mine seals.

**Sink Hole Repair:** shallow mine voids cause sink holes that divert natural streams underground. Thrasher evaluates each site and develops a plan to backfill the voids, thereby reestablishing the original property.

**Landslide Repair:** two different landslide repair projects have been completed by Thrasher. Each repair required extensive geo-technical design for soldier pile and concrete lagging and concrete segmental gravity block walls. Both projects were in close proximity to residential areas that required special care during construction.

**Drainage Design:** all of the AML projects completed by Thrasher have required design of drainage structures. These have included vegetated, grouted, riprap, as well as culverts and storm sewers. Drainage calculations were completed to properly size all conveyences.

**Permitting:** the permitting process can delay projects if they are not submitted correctly or in a timely manner. Thrasher takes pride in on our ability to quickly obtain permits for our clients. We are able to utilize our excellent relationship with the WVDEP for NPDES permits as well as our relationship with the West Virginia Division of Highways for entrance and drainage permits. We are also experienced in obtaining ACE permits for stream bank restoration.

# MAURIN MINE FIRE & PORTALS

Thrasher has taken steps to adequately respond to the WVDEP's expression of interest by visiting the job site. Our assessment of the site reveals this project will require the following steps:

**Step 1.** Adequate Mapping

**Step 2.** Project Development and Design

**Step 3.** Environmental and Permitting

**Step 4.** Bidding

**Step 5.** Construction Management



# ADDITIONAL RELATED SERVICES

## SITE DEVELOPMENT

Projects ranging from sites for residential housing to business and industrial parks to multi-purpose “live, work and play” communities are included in our range of site development projects.

Services Include:

- ***Planning and Conceptual Design***
- ***Grading Plans***
- ***Utility Layout and Mapping***

## STORM WATER, SEDIMENT AND EROSION

Our experience includes development of Sediment and Erosion Control measures on all types of construction sites as required by the WV Division of Environmental Protection, design of drainage facilities including piping, intake structures, etc. for site stabilization and flood control.

Capabilities Include:

- ***Hydrology Studies / Hydrographic Mapping***
- ***Storm Water Collection Systems***
- ***Detention Ponds***
- ***Injection Wells***
- ***Underground Storage***
- ***Combined Sewer Overload (CSO) separation***

## SURVEY

In addition to a full service professional engineering staff, we maintains a surveying department which includes 10 licensed professional land surveyors, twenty full-time survey crews, CADD technicians, and office support staff.

## ENVIRONMENTAL REPORTING SERVICES

Thrasher provides full environmental assessment and clearance services. We have more than 20 years of experience conducting environmental and natural resource compliance consultation with both state and federal agencies.

Experience includes:

- ***Permitting Related Activities (401 and 404)***
- ***NEPA document preparation***
- ***Wetland Delineation and Mitigation***
- ***Rare, threatened and endangered species Section 7 Informal Consultation***
- ***Rare, threatened and endangered species Section 10 Habitat Conservation Plans***
- ***Water Use and Water Quality***
- ***Air and Noise Impacts, Assessments, and Controls***
- ***Soils and Geological Resources***
- ***Cultural Resources***
- ***Hazardous Materials***
- ***Sediment and Erosion Control***
- ***Consent Orders***
- ***Compliance Schedules***
- ***Site investigations***
- ***SPCC Plans, Contingency Plans, Ground Water***
- ***Protection Plans and Storm Water Pollution***
- ***Prevention Plans***
- ***Waste Treatment and Site Remediation***
- ***Waste Disposal***
- ***Channel Restoration***
- ***Stream Bank Stabilization***
- ***Enforcement Actions***



# ADDITIONAL RELATED SERVICES

## CONSTRUCTION MANAGEMENT AND INSPECTION

Thrasher knows how projects should be built. We provide the knowledge and experience necessary to manage the construction of your project. Our project managers and inspectors are experienced in all types of construction activities. Many of our construction managers and inspectors have years of experience, and our are certified by the West Virginia Department of Transportation, Division of Highways for roadwork and materials testing.

## MATERIALS TESTING

Thrasher's Materials Testing Department is capable of performing a wide range of field and laboratory tests. Our laboratory at our Bridgeport, WV office is one of only three nationally certified facilities in the State of West Virginia. Additionally, our engineers and technicians who perform tests both in the field and in the lab are certified by the State of WV.

## EQUIPMENT AND SOFTWARE

Thrasher provides one of the largest networks of computer aided design (CAD) equipment, software and trained personnel in the State of West Virginia. Civil 3D, Carlson and Microstation V8 software is utilized at 70 CAD stations within the Group. Additionally, equipment includes 10 large format (size E) plotters and 5 large format plotter / scanners. CAD plans are prepared by both dedicated CAD employees and by staff engineers and engineering technicians in each of the firm's offices. This equipment allows our design department to perform accurate work quickly and efficiently.



*April Rohrbaugh, Project Manager reviews project designs and answers questions with a group of contractors on a recent site visit to Roger Camp Hill.*



# PROJECT TEAM



## Chad Biller, PE Principal-In-Charge

### Education:

- BS, Civil Engineering, West Virginia University

### Registrations:

- Registered Professional Engineer (PE) - State of West Virginia
- Registered Professional Engineer (PE) - State of Pennsylvania
- Registered Professional Engineer (PE) - State of Ohio
- American Society of Civil Engineers
- American Society of Highway Engineers
- Society of American Military Engineers
- National Society of Professional Engineers

### **ANGLINS RUN and ROARING CREEK:**

**Anglins Run:** Thrasher provided preliminary plans and final design for two WVDEP AML projects. Anglins Run included a total of eight collapsed mine portals with at least five of them having discharges ranging from one to ten gpm. Total flows were estimated to be between 25 and 30 gpm. Thrasher's plan for this project included construction of an access road, excavation and wet seal of at least eight deep mine portals and the re-grade and fill of subsidence sinkholes. To carry water safely off site, drainage control channels, conveyance pipe and under drain was constructed.

**Roaring Creek:** This project involved the elimination of subsidence depressions, the closure of open portals and the treatment of AMD. The Roaring Creek Watershed was heavily deep mined and surfaced mined prior to 1977. The project area consisted of three open and three closed portals discharging AMD, AMD seeps along the unnamed tributary and an area of subsidence, which drains surface water into the mine workings. AMD flow from the deep mine portals ranges from 10gpm to 100 gpm with PH ranging from 3.1 to 5.0. Preliminary plans included re-grading the subsidence area to prevent surface water from entering the mine workings, and installing an emergency spillway on the existing pond to handle the additional flow.

**OVERFIELD AND SQUIRES CREEK:** These projects consisted of engineering design for portal sealing, drainage and retaining walls for the Overfield - Lafferty Site and engineering design for portal sealing, drainage and backfilling of the highwall with refuse for the Squires Creek Site.

**RALEIGH COUNTY AIRPORT INDUSTRIAL PARK:** This multi-phased project consisted of all preliminary design, permitting, final design and construction management for the development of a 300+ acre business and industrial park adjacent to the Raleigh County airport. Engineering design consisted of mass grading, E&S plans, stormwater, public utilities, roadways, sidewalks and building pads.

# PROJECT TEAM



## April Rohrbaugh Project Manager

### Education:

- BS, Civil Engineering Technology, West Virginia University

### Project Manager on the following:

- Squires Creek: Reclaim Refuse Piles; Highwall Re-grading
- Anglin's Run: Seal Portals
- Roaring Creek: Sink Hole Repair
- Overfield (Lafferty): Landslide Repair
- Laurel Run: Bat Gates
- Clarksburg Lyons Landslide: Retaining Wall
- Pleasant Valley : Highwall
- Roger Camp Hill: Access Road; Drainage and Culverts

### ANGLINS RUN and ROARING CREEK:

**Anglins Run:** Thrasher provided preliminary plans and final design for two WVDEP AML projects. Anglins Run included a total of eight collapsed mine portals with at least five of them having discharges ranging from one to ten gpm. Total flows were estimated to be between 25 and 30 gpm. Thrasher's plan for this project included construction of an access road, excavation and wet seal of at least eight deep mine portals and the re-grade and fill of subsidence sinkholes. To carry water safely off site, drainage control channels, conveyance pipe and under drain was constructed.

**Roaring Creek:** This project involved the elimination of subsidence depressions, the closure of open portals and the treatment of AMD. The Roaring Creek Watershed was heavily deep mined and surfaced mined prior to 1977. The project area consisted of three open and three closed portals discharging AMD, AMD seeps along the unnamed tributary and an area of subsidence, which drains surface water into the mine workings. AMD flow from the deep mine portals ranges from 10gpm to 100 gpm with PH ranging from 3.1 to 5.0. Preliminary plans included re-grading the subsidence area to prevent surface water from entering the mine workings, and installing an emergency spillway on the existing pond to handle the additional flow.

**OVERFIELD AND SQUIRES CREEK:** These projects consisted of engineering design for portal sealing, drainage and retaining walls for the Overfield - Lafferty Site and engineering design for portal sealing, drainage and backfilling of the highwall with refuse for the Squires Creek Site.

**WV DEP Shinns Run Portals:** Mr. Hovatter served as Project Engineer and was responsible for the design, drawings along with the construction documents on an AML project outside of Shinnston on Shinns Run Road. The project consisted of a total seven open mine portals that needed to be sealed. Three of the portals were required to have bat gates installed and the others were to be piped for drainage. During the subsurface investigation it was determined that the section of Shinns Run that passed over three of the portals was constructed over significant mine voids. This resulted in a grout stabilization design to be added to the project scope.



11. OUTSIDE KEY CONSULTANTS/SUB-CONSULTANTS ANTICIPATED TO BE USED. Attach "AML Consultant Confidential Qualification Questionnaire".

<p>NAME AND ADDRESS:  <b>NOVEL GEO-ENVIRONMENTAL</b>  <b>650 MACCORKLE AVENUE WEST</b>  <b>ST. ALBANS, WV 25177</b></p>	<p>SPECIALTY:  <b>GEO-TECHNICAL SERVICES</b></p>	<p>WORKED WITH BEFORE  <input checked="" type="checkbox"/> Yes  <input type="checkbox"/> No</p>
<p>NAME AND ADDRESS:  <b>RELIANCE LABORATORIES, INC</b>  <b>2044 MEADOWBROOK ROAD</b>  <b>BRIDGEPORT, WV 26330</b></p>	<p>SPECIALTY:  <b>WATER SAMPLE ANALYZATION</b></p>	<p>WORKED WITH BEFORE  <input checked="" type="checkbox"/> Yes  <input type="checkbox"/> No</p>
<p>NAME AND ADDRESS:</p>	<p>SPECIALTY:</p>	<p>WORKED WITH BEFORE  <input type="checkbox"/> Yes  <input type="checkbox"/> No</p>
<p>NAME AND ADDRESS:</p>	<p>SPECIALTY:</p>	<p>WORKED WITH BEFORE  <input type="checkbox"/> Yes  <input type="checkbox"/> No</p>
<p>NAME AND ADDRESS:</p>	<p>SPECIALTY:</p>	<p>WORKED WITH BEFORE  <input type="checkbox"/> Yes  <input type="checkbox"/> No</p>
<p>NAME AND ADDRESS:</p>	<p>SPECIALTY:</p>	<p>WORKED WITH BEFORE  <input type="checkbox"/> Yes  <input type="checkbox"/> No</p>
<p>NAME AND ADDRESS:</p>	<p>SPECIALTY:</p>	<p>WORKED WITH BEFORE  <input type="checkbox"/> Yes  <input type="checkbox"/> No</p>
<p>NAME AND ADDRESS:</p>	<p>SPECIALTY:</p>	<p>WORKED WITH BEFORE  <input type="checkbox"/> Yes  <input type="checkbox"/> No</p>
<p>NAME AND ADDRESS:</p>	<p>SPECIALTY:</p>	<p>WORKED WITH BEFORE  <input type="checkbox"/> Yes  <input type="checkbox"/> No</p>

12. A. Is your firm experienced in Abandoned Mine Lands Remediation/Mine Reclamation Engineering?

**X YES** Description and Number of Project: THRASHER PERFORMS ENGINEERING DESIGN SERVICES TO THE WV DEP FOR DRAINAGE, PORTAL, HIGHWALL AND OTHER REMEDIATION PROJECTS, AS WELL AS FOR WATER LINE AND WATER TREATMENT PLANT PROJECTS RELATED TO AML. NUMEROUS PROJECTS INVOLVING LAND REMEDIATION, STORM WATER DRAINAGE, SLIP REPAIR, MASS GRADING IN RELATION TO SITE DEVELOPMENT AND HIGHWAY PROJECTS ARE ENGINEERED BY THE FIRM ON A REGULAR BASIS.

B. Is your firm experienced in Soil Analysis?

**X YES** Description and Number of Projects: THRASHER MAINTAINS AN AASHTO CERTIFIED MATERIALS TESTING AND ANALYSIS LAB AT BOTH THE CLARKSBURG AND BECKLEY OFFICES. SOIL ANALYSIS EXPERIENCE IS SPECIFICALLY IN GRADATIONS AND CLASSIFICATION.

C. Is your firm experienced in hydrology and hydraulics?

**X YES** Description and Number of Projects: THROUGH OUR WORK IN THE PLANNING AND DESIGN OF BRIDGES FOR THE WEST VIRGINIA DEPARTMENT OF HIGHWAYS AND WATER LINE EXTENSION PROJECTS THROUGHOUT THE STATE, THRASHER HAS EXTENSIVE EXPERIENCE IN HYDROLOGY. WE ALSO HAVE EXTENSION EXPERIENCE IN HYDRAULIC MODELING FOR WATER AND WASTEWATER PROJECTS THROUGHOUT WEST VIRGINIA.

D. Does your firm produce its own Aerial Photography and Develop Contour Mapping?

**YES** Description and Number of Projects: THRASHER SURVEY ONLY SUBCONTRACTS THE ACQUISITION OF AERIAL PHOTOGRAPHY. ALL OTHER SERVICES ASSOCIATED WITH MAPPING ARE PERFORMED IN-HOUSE INCLUDING AERO-TRIANGULATION, PLANIMETRIC COMPILATION, SURFACE MODELING, CONTOURING AND DIGITAL ORTHO-RECTIFIED IMAGERY. THRASHER MAPPING AND CONTROL SERVICES INCLUDE NGS "BLUE-BOOKING", PERMANENT MONUMENT POSITIONING AND INSTALLATION, GPS BASE STATION INSTALLATION, PRECISE LEVELING, CONTROL NETWORKS, AERIAL PHOTO CONTROL, VERTICAL SCALE MAPPING, STEREO PHOTOGRAMMETRY, ORTHO-RECTIFIED IMAGES, TRIANGULATED SURFACE MODELS, 3D MODELING AND ANIMATION. THRASHER PROVIDES THESE SERVICES FROM BOTH MANNED AND UNMANNED PLATFORMS. THRASHER LIDAR/REMOTE SENSING IS PERFORMED FROM TERRESTRIAL AND AIRBORNE PLATFORMS BOTH MANNED AND REMOTE CONTROLLED. THRASHER'S MODEL WHEN IT COMES TO ADVANCED TECHNOLOGIES IS TO EMPLOY TECHNICAL EXPERTISE, OWN SOFTWARE AND RENT/LEASE HARDWARE AS NEEDED SINCE TECHNOLOGY CHANGES ARE CONSTANT.

E. Is your firm experienced in domestic waterline design? (Include any experience your firm has in evaluation of aquifer degradation as a result of mining.)

**YES** Description and Number of Projects: THRASHER HAS DESIGNED MORE WATER LINE SYSTEMS THAN ANY OTHER WEST VIRGINIA FIRM. PROJECTS INCLUDE NEW SYSTEMS, EXTENSIONS AND REPLACEMENTS OF WATER LINE DISTRIBUTION SYSTEMS, MANY OF WHICH HAVE BEEN AFFECTED BY ABANDONED MINE LANDS. DESIGN OF THE PROJECTS INCLUDES INCLUDE LINES, BOOSTER STATIONS, WATER TREATMENT PLANTS, AND STORAGE FACILITIES. THRASHER'S ANALYSIS AND DESIGN ALSO INCLUDES IMPROVEMENTS AND ALTERNATIVES FOR WATER SOURCES DEEMED GROUND WATER UNDER THE DIRECT EFFECT OF SURFACE WATER.

F. Is your firm experienced in Acid Mine Drainage Evaluation and Abatement Design?

**YES** Description and Number of Projects THRASHER HAS BEEN AWARDED AND HAS SUCCESSFULLY COMPLETED NUMEROUS RECLAMATION PROJECTS FOR WVDEP RELATED SPECIFICALLY TO ACID MINE DRAINAGE AND ABATEMENT . THE CHARLESTON WV BRANCH OF OUR COMPANY DESIGNED AN AWARD WINNING WATER TREATMENT PLANT FOR MARTINKA MINES IN MARION COUNTY, WEST VIRGINIA TO TREAT MINE DRAINAGE.

13. PERSONAL HISTORY STATEMENT OF PRINCIPALS AND ASSOCIATES **RESPONSIBLE FOR AML PROJECT DESIGN** (Furnish complete data but keep to essentials)

NAME & TITLE (Last, First, Middle Int.)	YEARS OF EXPERIENCE		
	YEARS OF AML DESIGN EXPERIENCE:	YEARS OF AML RELATED DESIGN EXPERIENCE:	YEARS OF DOMESTIC WATERLINE DESIGN EXPERIENCE:
<b>BILLER, CHADWICK D. P.E.</b>	<b>5</b>	<b>19</b>	<b>19</b>

Brief Explanation of Responsibilities: *Mr. Biller has experience in all aspects of engineering with specific emphasis on site development, highways, roads, bridges, and airports. Mr. Biller joined Thrasher Engineering in 1999 and is a partner of Thrasher Engineering. For Thrasher Engineering, Mr. Biller is responsible for WV DEP AML project and public and private site development projects, specializing in airports, highways, roads and bridges. As Project Manager for all of the firm's WVDOT/DOH projects, he has extensive knowledge of state and federal building standards .*

EDUCATION (Degree, Year, Specialization:  
 **B.S., Civil Engineering, 1992 – West Virginia University**

MEMBERSHIP IN PROFESSIONAL ORGANIZATIONS

- American Society of Civil Engineers*
- Society of American Military Engineers*
- National Society of Professional Engineers*

REGISTRATION (Type, Year, State)

- Registered Professional Engineer(PE),State of West Virginia #13620*
- Registered Professional Engineer (PE),State of Pennsylvania #PE056012E*
- Registered Professional Engineer (PE),State of Ohio #64594*

13. PERSONAL HISTORY STATEMENT OF PRINCIPALS AND ASSOCIATES **RESPONSIBLE FOR AML PROJECT DESIGN** (Furnish complete data but keep to essentials)

NAME & TITLE (Last, First, Middle Int.)	YEARS OF EXPERIENCE		
	YEARS OF AML DESIGN EXPERIENCE:	YEARS OF AML RELATED DESIGN EXPERIENCE:	YEARS OF DOMESTIC WATERLINE DESIGN EXPERIENCE:
<b>NESTOR, MICHAEL – PROJECT ENGINEER</b>	<b>3</b>	<b>9</b>	<b>9</b>

Brief Explanation of Responsibilities *Mr. Nestor joined Thrasher Engineering in 2005 and serves as Project Manager and Engineer. Mr. Nestor has a wide range of experience in residential and commercial site development projects, utilizing all aspects of infrastructure design including street and lot layout, street profiles, extensions of public sewer and water systems, storm water drainage, storm water management, erosion and sediment control plans, and NPDES permitting. In addition, Mr. Nestor oversees all general operations within The Berkeley Associates, directing administrative staff, CAD technicians, and staff engineers to ensure successful completion of projects covering site development, surveying, material testing, and environmental services.*

EDUCATION (Degree, Year, Specialization)  
**B.S. Civil Engineering Technology – Fairmont State University, 2003**

MEMBERSHIP IN PROFESSIONAL ORGANIZATIONS

- American Society of Civil Engineers*
- Eastern Panhandle Home Builders Association*

REGISTRATION (Type, Year, State)

- Professional Engineer (P.E.), 2009, State of West Virginia*

13. PERSONAL HISTORY STATEMENT OF PRINCIPALS AND ASSOCIATES **RESPONSIBLE FOR AML PROJECT DESIGN** (Furnish complete data but keep to essentials)

NAME & TITLE (Last, First, Middle Int.)	YEARS OF EXPERIENCE		
	YEARS OF AML DESIGN EXPERIENCE:	YEARS OF AML RELATED DESIGN EXPERIENCE:	YEARS OF DOMESTIC WATERLINE DESIGN EXPERIENCE:
<b>ROHRBAUGH, APRIL</b>	<b>3</b>	<b>8</b>	-

Brief Explanation of Responsibilities  
*Ms. Rohrbaugh joined Thrasher Engineering in January of 2006 and serves as Staff Engineer in the site development department of Thrasher, with a concentration on AML reclamation and sediment/erosion control project. Ms. Rohrbaugh has experience in all aspects of site engineering, taking projects from survey to concept to construction. Her responsibilities with AML projects include: Design of wet and modified mine seals, grading associated with reclaiming, storm water management, and erosion and sediment control. Ms. Rohrbaugh's other responsibilities include: design surveying consisting of both field traversing and survey locations and aerial mapping. Conceptual planning for residential, commercial, and recreational developments. Site/Land Development engineering: geometric layout of sites, subdivisions, and roads, grading, drainage, storm water management, erosion and sediment control, and various regulatory permitting requirements.*

EDUCATION (Degree, Year, Specialization) **B.S. Civil Engineering – West Virginia University, 2005, Civil Engineering**

MEMBERSHIP IN PROFESSIONAL ORGANIZATIONS

REGISTRATION (Type, Year, State)

13. PERSONAL HISTORY STATEMENT OF PRINCIPALS AND ASSOCIATES **RESPONSIBLE FOR AML PROJECT DESIGN** (Furnish complete data but keep to essentials)

NAME & TITLE (Last, First, Middle Int.)	YEARS OF EXPERIENCE		
	YEARS OF AML DESIGN EXPERIENCE:	YEARS OF AML RELATED DESIGN EXPERIENCE:	YEARS OF DOMESTIC WATERLINE DESIGN EXPERIENCE:
<b>HOVATTER, RICHARD (RJ) – PROJECT MANAGER</b>	<b>9</b>	<b>9</b>	<b>9</b>

Brief Explanation of Responsibilities: *Richard Hovatter Jr. joined Thrasher Engineering, Inc. in 2011 and serves as Project Manager from TEI's Clarksburg Office. As a graduate of Fairmont State University and previous experience Mr. Hovatter has extensive knowledge of abandoned mine land and emergency situations such as landslides and mine subsidence of abandoned mine land. Mr. Hovatter is responsible for the designs, scheduling, collection and reporting of mine surface, sediment erosion control plans and waterline feasibility studies.*

EDUCATION (Degree, Year, Specialization)

**Bachelor of Science, 2002, Civil Engineering Technology – Fairmont State University**

MEMBERSHIP IN PROFESSIONAL ORGANIZATIONS

REGISTRATION (Type, Year, State)

- Professional Engineer (P.E.), 2009, State of West Virginia**
- Professional Engineer (P.E.), 2010, State of Pennsylvania**



14. PROVIDE A LIST OF SOFTWARE AND EQUIPMENT AVAILABLE IN THE PRIMARY OFFICE WHICH WILL BE USED TO COMPLETE AML DESIGN SERVICES

THRASHER ENGINEERING, INC. WILL DESIGN WORK FOR AML UTILIZING ONE OF THE LARGEST NETWORKS OF COMPUTER AIDED DESIGN (CAD) EQUIPMENT, SOFTWARE AND TRAINED PERSONNEL IN THE STATE OF WEST VIRGINIA.

CONNECTED THROUGH A VIRTUAL PRIVATE NETWORK, OUR CAD STAFF HAS THE ABILITY TO SHARE NECESSARY PLANS AMONG OUR LOCATIONS. THIS WILL ALLOW WORK DESIGNED FOR AML TO BE PREPARED AND UPDATED AT THE OFFICE LOCATION THAT BEST MEETS THE NEEDS OF THE SCOPE OF SERVICES.

CIVIL 3D, CARLSON AND MICROSTATION V8 SOFTWARE IS UTILIZED AT 70 CAD STATIONS THROUGHOUT OUR LOCATIONS. ADDITIONALLY, EQUIPMENT INCLUDES 10 LARGE FORMAT (SIZE E) PLOTTERS AND 5 LARGE FORMAT PLOTTER / SCANNERS. CAD PLANS ARE PREPARED BY BOTH DEDICATED CAD EMPLOYEES AND BY STAFF ENGINEERS AND ENGINEERING TECHNICIANS IN EACH OF THE FIRM'S OFFICES.

THRASHER ENGINEERING, INC. ALSO UTILIZES TOP-OF-THE LINE SURVEY EQUIPMENT. OUR SURVEY WORK IS ACCOMPLISHED WITH GLOBAL POSITIONING SYSTEMS (GPS) AND ELECTRONIC DISTANCE MEASURING (EDM) SURVEY STATIONS WITH DATA GATHERING CAPABILITIES. THE SURVEY CREWS AND OFFICE SUPPORT STAFF GENERATE MAPPING DELIVERABLES IN VIRTUALLY ANY DIGITAL FORMAT REFERENCED TO SPECIFIED PROJECTION SYSTEMS.

ADDITIONAL SURVEY SERVICES INCLUDE: HIGH ACCURACY MONUMENTATION, ASTRONOMIC OBSERVATIONS / ORIENTATION, NGS BLUE BOOKING, HYDROGRAPHIC, TERRESTRIAL SCANNING, 3D AS-BUILTS, 3D MONITORING, SUB-SURFACE UTILITY LOCATION / DESIGNATION. THE FIELD CREWS ARE ALL EQUIPPED WITH LATE MODEL

FOUR

WHEEL DRIVE VEHICLES STOCKED WITH THE MOST MODERN EQUIPMENT AVAILABLE TO PERFORM PROFESSIONAL LAND SURVEYING SERVICES.

63 TRIMBLE GNSS UNITS

6 TRIMBLE ROBOTS

2 PRECISE DIGITAL FIRST ORDER LEVELS WITH INVAR RODS

25 LEICA, NIKON OR TOPCON TOTAL STATIONS ALL MANAGED BY

TRIMBLE TSC3 FIELD COMPUTERS

REMOTE CONTROLLED/UNMANNED MAPPING AERIAL PLATFORM

HYDROGRAPHIC SURVEY VESSEL

3D SUB-SURFACE UTILITY LOCATORS

CIVIL 3D

CARLSON AND MICROSTATION V8 SOFTWARE

70 CAD STATIONS

10 LARGE FORMAT (SIZE E) PLOTTERS AND

5 LARGE FORMAT PLOTTER / SCANNERS.

**CURRENT ACTIVITIES – WVDOH PROJECTS- DESIGNATED ENGINEER OF RECORD**

15. CURRENT ACTIVITIES ON WHICH YOUR FIRM IS THE DESIGNATED ENGINEER OF RECORD:				
PROJECT NAME, TYPE AND LOCATION	NAME AND ADDRESS OF OWNER	NATURE OF YOUR FIRM'S RESPONSIBILITY	ESTIMATED CONSTRUCTION COST	PERCENT COMPLETE
MINERAL WELLS ROUTE 2 WOOD COUNTY	WVDOT / DOH BLDG. 5, ROOM A-109 1900 KANAWHA BLVD., EAST CHARLESTON, WV 25305	CIVIL ENGINEERING DESIGN, SURVEY, CONSTRUCTION DOCUMENTS	\$6,000,000.00	DESIGN STUDY 100% ENGINEERING DESIGN – 0%
BASNETTVILLE BRIDGE MARION COUNTY	WVDOT / DOH BLDG. 5, ROOM A-109 1900 KANAWHA BLVD., EAST CHARLESTON, WV 25305	CIVIL ENGINEERING DESIGN, SURVEY, CONSTRUCTION DOCUMENTS	\$1,800,000.00	15%
US ROUTE 119 BRIDGES ROANE COUNTY	WVDOT / DOH BLDG. 5, ROOM A-109 1900 KANAWHA BLVD., EAST CHARLESTON, WV 25305	CIVIL ENGINEERING DESIGN, SURVEY, CONSTRUCTION DOCUMENTS	\$1,500,000.00	10%
TOTAL NUMBER OF PROJECTS: 3			TOTAL ESTIMATED CONSTRUCTION COSTS: 3 PROJECTS = \$9.3 MILLION	

15. CURRENT ACTIVITIES ON WHICH YOUR FIRM IS THE DESIGNATED ENGINEER OF RECORD:

**PRESENT ACTIVITIES – WATER AND WASTEWATER PROJECTS- DESIGNATED ENGINEER OF RECORD**

THRASHER IS CURRENTLY THE DESIGNATED "ENGINEER OF RECORD" ON MORE THAN 200 ON-GOING PROJECTS. THESE PROJECTS RANGE FROM SIMPLE BOUNDARY SURVEYS WHICH ARE COMPLETED WITHIN A FEW DAYS' TIME TO COMPLETE MUNICIPAL PROJECTS WHICH ARE COMPLETED OVER AN EXTENDED AMOUNT OF TIME. THE FOLLOWING LIST OF SELECTED CURRENT PROJECTS REPRESENTS THOSE WHICH HAVE BEEN AWARDED TO THRASHER WITHIN THE PAST THREE (3) YEARS AND DEMONSTRATES THE RANGE OF SERVICES PROVIDED BY THRASHER.

PROJECT NAME, TYPE AND LOCATION	NAME AND ADDRESS OF OWNER	NATURE OF YOUR FIRM'S RESPONSIBILITY	ESTIMATED CONSTRUCTION COST	PERCENT COMPLETE
MALDEN PUBLIC SERVICE DISTRICT WASTEWATER TREATMENT PLANT KANAWHA COUNTY, WV	MALDEN PUBLIC SERVICE DISTRICT P.O. BOX 350 TAD, WV 25201-0350	FEASIBILITY STUDY, DESIGN, FUNDING AND PERMIT APPLICATIONS, CONTRACT DOCUMENTS, FIELD SERVICES OF SURVEY AND INSPECTION	\$13,600,000.00	50%
CITY OF RIPLEY, WV WASTEWATER TREATMENT PLANT & SYSTEM IMPROVEMENTS JACKSON COUNTY, WV	CITY OF RIPLEY, WV 203 SOUTH CHURCH STREET RIPLEY, WV 25271	FEASIBILITY STUDY, DESIGN, FUNDING AND PERMIT APPLICATIONS, CONTRACT DOCUMENTS, FIELD SERVICES OF SURVEY AND INSPECTION	\$13,000,000.00	50%
FOUNTAIN PUBLIC SERVICE DISTRICT WATER SYSTEM PROJECT MINERAL COUNTY, WV	FOUNTAIN PUBLIC SERVICE DISTRICT PO BOX 146 / ROUTE 46 EAST KEYSER, WV 26726	FEASIBILITY STUDY, DESIGN, FUNDING AND PERMIT APPLICATIONS, CONTRACT DOCUMENTS, FIELD SERVICES OF SURVEY AND INSPECTION	\$10,500,000.00	45%
CITY OF ROMNEY WASTEWATER TREATMENT PLANT, ROMNEY, WV	CITY OF ROMNEY 340 E MAIN STREET ROMNEY, WV 26757	FEASIBILITY STUDY, DESIGN, FUNDING AND PERMIT APPLICATIONS, CONTRACT DOCUMENTS, FIELD SERVICES OF SURVEY AND INSPECTION	\$9,000,000.00	60 %
TOWN OF FLEMINGTON SANITARY SEWER EXTENSION FLEMINGTON, WV	TOWN OF FLEMINGTON PO BOX 443 FLEMINGTON, WV 26347	FEASIBILITY STUDY, DESIGN, FUNDING AND PERMIT APPLICATIONS, CONTRACT DOCUMENTS, FIELD SERVICES OF SURVEY AND INSPECTION		
CITY OF CLARKSBURG WASTEWATER TREATMENT PLANT UPGRADES FOR LTCP	CITY OF CLARKSBURG 222 WEST MAIN STREET CLARKSBURG, WV 26301	FEASIBILITY STUDY, DESIGN, FUNDING AND PERMIT APPLICATIONS, CONTRACT DOCUMENTS, FIELD SERVICES OF SURVEY AND INSPECTION		
PRESTON COUNTY SEWER PUBLIC SERVICE DISTRICT WASTEWATER TREATMENT PLANT AND COLLECTION SYSTEM	PRESTON COUNTY SEWER PUBLIC SERVICE DISTRICT PO BOX 89 BRUCETON MILLS, WV 26525	FEASIBILITY STUDY, DESIGN, FUNDING AND PERMIT APPLICATIONS, CONTRACT DOCUMENTS, FIELD SERVICES OF SURVEY AND INSPECTION		

TOTAL NUMBER OF PROJECTS:  
7 SHOWN – 200+ COMPANY-WIDE

TOTAL ESTIMATED CONSTRUCTION COSTS:  
TOTAL ESTIMATED CONSTRUCTION COSTS: \$60,350,000.00 SHOWN – TOTAL PROJECTS APPROXIMATELY \$750,000,000.00

15. CURRENT ACTIVITIES ON WHICH YOUR FIRM IS THE DESIGNATED ENGINEER OF RECORD:

**PRESENT ACTIVITIES – WATER AND WASTEWATER PROJECTS- DESIGNATED ENGINEER OF RECORD**

PROJECT NAME, TYPE AND LOCATION	NAME AND ADDRESS OF OWNER	NATURE OF YOUR FIRM'S RESPONSIBILITY	ESTIMATED CONSTRUCTION COST	PERCENT COMPLETE
CHESTNUT RIDGE PSD BARBOUR/PRESTON EXTENSION BARBOUR COUNTY, WV	CHESTNUT RIDGE PSD 209 S MAIN STREET P.O. BOX 386 PHILIPPI, WV 26416	FEASIBILITY STUDY, DESIGN, FUNDING AND PERMIT APPLICATIONS, CONTRACT DOCUMENTS, FIELD SERVICES OF SURVEY AND INSPECTION.	\$4,500,000	90%
GILMER COUNTY PSD WATER LINE EXTENSION	GILMER COUNTY PSD PO BOX 729 GLENVILLE, WV 26351	FEASIBILITY STUDY, DESIGN, FUNDING AND PERMIT APPLICATIONS, CONTRACT DOCUMENTS, FIELD SERVICES OF SURVEY AND INSPECTION	\$3,200,000.00	85%
MINGO COUNTY PSD WATER LINE EXTENSION	MINGO COUNTY PSD PO BOX 98 NAUGATUCK, WV 25685	FEASIBILITY STUDY, DESIGN, FUNDING AND PERMIT APPLICATIONS, CONTRACT DOCUMENTS, FIELD SERVICES OF SURVEY AND INSPECTION	\$1,075,000.00	60%
HAMRICK PSD MOORE/PORTERWOOD EXTENSION TUCKER COUNTY, WV	HAMRICK PSD PO BOX 228 HENDRICKS, WV 26271	FEASIBILITY STUDY, DESIGN, FUNDING AND PERMIT APPLICATIONS, CONTRACT DOCUMENTS, FIELD SERVICES OF SURVEY AND INSPECTION	\$1,100,000.	35%
LINCOLN COUNTY PSD WATER LINE EXTENSION PROJECTS	LINCOLN PSD P.O. BOX 38 240 LITTLE COAL RIVER RD. ALUM CREEK, WV 25003	FEASIBILITY STUDY, DESIGN, FUNDING AND PERMIT APPLICATIONS, CONTRACT DOCUMENTS, FIELD SERVICES OF SURVEY AND INSPECTION	\$6,920,000.	25%
TOWN OF CAPON BRIDGE WATERLINE AND PUMP STATION REPLACEMENT	TOWN OF CAPON BRIDGE PO BOX 183 FRANK, WV 24920	FEASIBILITY STUDY, DESIGN, FUNDING AND PERMIT APPLICATIONS, CONTRACT DOCUMENTS, FIELD SERVICES OF SURVEY AND INSPECTION	\$1,925,000.00	50%
CITY OF SALEM, WEST VIRGINIA WATER LINE REPLACEMENT	SALEM, CITY OF P.O. BOX 352 229 W. MAIN SALEM, WV 26426	FEASIBILITY STUDY, DESIGN, FUNDING AND PERMIT APPLICATIONS, CONTRACT DOCUMENTS, FIELD SERVICES OF SURVEY AND INSPECTION	\$1,500,000.	80%
TOTAL NUMBER OF PROJECTS: 7 REPRESENTED (APPROXIMATELY 20 ADDITIONAL CURRENTLY IN PRELIMINARY / DESIGN OR CONSTRUCTION PHASES)			TOTAL ESTIMATED CONSTRUCTION COSTS: \$18,220,000.00 REPRESENTED ESTIMATED COST OF ALL JOBS APPROXIMATELY \$150,000,000.00	

15. CURRENT ACTIVITIES ON WHICH YOUR FIRM IS THE DESIGNATED ENGINEER OF RECORD: **SANITARY SEWER PROJECTS**  
 THRASHER ENGINEERING IS CURRENTLY THE DESIGNATED "ENGINEER OF RECORD" ON MORE THAN 200 ON-GOING PROJECTS. THESE PROJECTS RANGE FROM SIMPLE BOUNDARY SURVEYS WHICH ARE COMPLETED WITHIN A FEW DAYS' TIME TO COMPLETE MUNICIPAL PROJECTS WHICH ARE COMPLETED OVER AN EXTENDED AMOUNT OF TIME. A PARTIAL LISTING OF CURRENT PROJECTS FOLLOWS WHICH DEMONSTRATES THE RANGE OF SERVICES PROVIDED BY THRASHER ENGINEERING.

PROJECT NAME, TYPE AND LOCATION	NAME AND ADDRESS OF OWNER	NATURE OF YOUR FIRM'S RESPONSIBILITY	ESTIMATED CONSTRUCTION COST	PERCENT COMPLETE
KINGWOOD SEWER REPLACEMENT AND SERVICE EXTENSIONS KINGWOOD, WV	CITY OF KINGWOOD 313 TUNNELTON STREET KINGWOOD, WV 26537	FEASIBILITY STUDY, DESIGN, FUNDING AND PERMIT APPLICATIONS, CONTRACT DOCUMENTS, FIELD SERVICES OF SURVEY AND INSPECTION	\$10,000,000.00	50%
GREATER HARRISON COUNTY PSD PHASE II-B HARRISON COUNTY, WV	GREATER HARRISON COUNTY PSD P.O. BOX 190 WEST MILFORD, WV 26451	FEASIBILITY STUDY, DESIGN, FUNDING AND PERMIT APPLICATIONS, CONTRACT DOCUMENTS, FIELD SERVICES OF SURVEY AND INSPECTION	\$6,000,000.00	65%
TENNERTON PSD PHASE III SANITARY SEWER EXTENSION UPSHUR COUNTY, WV	TENNERTON PSD 188 FAYETTE ST. BUCKHANNON, WV 26201	FEASIBILITY STUDY, DESIGN, FUNDING AND PERMIT APPLICATIONS, CONTRACT DOCUMENTS, FIELD SERVICES OF SURVEY AND INSPECTION	\$6,800,000.00	5%
ENLARGED HEPZIBAH PSD SANITARY SEWER EXTENSION HARRISON COUNTY, WV	ENLARGED HEPZIBAH PSD DRAWER H HEPZIBAH, WV 26369	FEASIBILITY STUDY, DESIGN, FUNDING AND PERMIT APPLICATIONS, CONTRACT DOCUMENTS, FIELD SERVICES OF SURVEY AND INSPECTION	\$2,666,000.00	50%
CITY OF WEIRTON, WV PHASE II SEWER PROJECT	CITY OF WEIRTON 3031 BIRCH DRIVE WEIRTON, WV 26062	FEASIBILITY STUDY, DESIGN, FUNDING AND PERMIT APPLICATIONS, CONTRACT DOCUMENTS, FIELD SERVICES OF SURVEY AND INSPECTION	\$5,728,000.00	40%
TOWN OF JUNIOR WASTEWATER TREATMENT PLANT JUNIOR, WV	TOWN OF JUNIOR PO BOX 247 JUNIOR, WV 26275	FEASIBILITY STUDY, DESIGN, FUNDING AND PERMIT APPLICATIONS, CONTRACT DOCUMENTS, FIELD SERVICES OF SURVEY AND INSPECTION	\$2,332,000.00	45%
TOTAL NUMBER OF PROJECTS: 7 REPRESENTED TOTAL ACTIVE SANITARY SEWER PROJECTS APPROXIMATELY 38			TOTAL ESTIMATED CONSTRUCTION COSTS: \$46,000,000.00 TOTAL FOR ALL PROJECTS APPROXIMATELY \$150,000,000	



**COMPLETED WORK – WVDEP OFFICE OF AML&R - PROJECTS DESIGNATED ENGINEER OF RECORD**

17. COMPLETED WORK WITHIN LAST 5 YEARS ON WHICH YOU WERE THE DESIGNATED ENGINEER OF RECORD THRASHER HAS DESIGNED, BID AND PROVIDED CONSTRUCTION SERVICES FOR MORE THAN 200 PUBLICLY FUNDED PROJECTS WITHIN THE PAST 10 YEARS. THE FOLLOWING LIST IS COMPRISED OF PROJECTS COMPLETED WITHIN THE LAST THREE (3) YEARS THAT DEMONSTRATE THE RANGE OF DISCIPLINES PROVIDED BY THRASHER

PROJECT NAME, TYPE AND LOCATION	NAME AND ADDRESS OF OWNER	ESTIMATED CONSTRUCTION COST	YEAR	CONSTRUCTED (YES OR NO)
PLEASANT VALLEY AML RECLAMATION MARION COUNTY, WV	WV DEP, OFFICE OF AML&R 601 57 <sup>TH</sup> STREET, SE CHARLESTON, WV 25304	\$764,000.00	2013	YES
ROGER (CAMP HILL) AML RECLAMATION TUCKER COUNTY, WV	WV DEP, OFFICE OF AML&R 601 57 <sup>TH</sup> STREET, SE CHARLESTON, WV 25304	\$210,000.00	2013	YES
ANGLINS RUN PORTALS AML RECLAMATION BARBOUR COUNTY, WV	WV DEP, OFFICE OF AML&R 601 57 <sup>TH</sup> STREET, SE CHARLESTON, WV 25304	\$321,000.00	2010	YES
ROARING CREEK SUBSIDENCE AML RECLAMATION RANDOLPH COUNTY, WV	WV DEP, OFFICE OF AML&R 601 57 <sup>TH</sup> STREET, SE CHARLESTON, WV 25304	\$353,000.00	2010	YES
SQUIRES CREEK PORTALS REFUSE AML RECLAMATION	WV DEP, OFFICE OF AML&R 601 57 <sup>TH</sup> STREET, SE CHARLESTON, WV 25304	\$260,000.00	2011	YES
OVERFIELD (LAFFERTY) CS&P AML RECLAMATION	WV DEP, OFFICE OF AML&R 601 57 <sup>TH</sup> STREET, SE CHARLESTON, WV 25304	\$492,000.00	2011	YES
LAUREL RUN #1 REFUSE / HIGHWALL AML RECLAMATION MONONGALIA COUNTY, WV	WV DEP, OFFICE OF AML&R 601 57 <sup>TH</sup> STREET, SE CHARLESTON, WV 25304	\$1,558,000.00	2012	YES
CLARKSBURG (LYONS) LANDSLIDE AML RECLAMATION HARRISON COUNTY, WV	WV DEP, OFFICE OF AML&R 601 57 <sup>TH</sup> STREET, SE CHARLESTON, WV 25304	\$1,492,000.00	2012	YES

17. COMPLETED WORK WITHIN LAST 5 YEARS ON WHICH YOUR FIRM WAS THE DESIGNATED ENGINEER OF RECORD				
PROJECT NAME, TYPE AND LOCATION	NAME AND ADDRESS OF OWNER	ESTIMATED CONSTRUCTION COST	YEAR	CONSTRUCTED (YES OR NO)
McHENRY BUSINESS PARK SITE DEVELOPMENT AND UTILITIES GARRETT COUNTY, MD	GARRETT COUNTY EDA 203 SOUTH 4TH STREET COURTHOUSE ROOM 208 OAKLAND, MD 21550	\$3,500,000.00	2011	YES
WHITE OAKS BUSINESS PARK SITE DEVELOPMENT AND UTILITIES HARRISON COUNTY, WV	HIGH TECH CORRIDOR DEVELOPMENT,LLC MR. JACK KEELEY PO BOX 1532 CLARKSBURG, WV 26302	\$12,100,000.00	2010	YES
CANYON PUBLIC SERVICE DISTRICT SANITARY SEWER UPGRADE AND EXT MONONGALIA COUNTY, WV	CANYON PSD 12 WICHITA STREET MORGANTOWN, WV 26508	\$6,500,000.	2009	YES
HEPZIBAH PSD SANITARY SEWER EXTENSION HARRISON COUNTY, WV	ENLARGED HEPZIBAH DRAWER H HEPZIBAH, WV 26369	\$3,400,000	2010	YES
SUN VALLEY WATER AND SEWER SYSTEM IMPROVEMENTS REYNOLDSVILLE, WV	SUN VALLEY PSD PO BOX 95 REYNOLDSVILLE, WV 26422	\$12,500,000	2010	YES
BROOKE COUNTY PSD REPLACEMENT AND EXTENSION BROOKE COUNTY, WV	BROOKE CO. PSD 711 CHARLES ST. P. O. BOX 150 WELLSBURG, WV 26070	\$10,000,000	2009	YES
HUTTONSVILLE PSD PHASE II RANDOLPH COUNTY, WV	HUTTONSVILLE PSD P.O. BOX 277 MILL CREEK, WV 26280	\$4,300,000	2009	YES
POCAHONTAS COUNTY PSD WWTP AND COLLECTION SYSTEM POCAHONTAS COUNTY, WV	POCAHONTAS COUNTY PSD HC 63 BOX 122 FRANK, WV 24920	\$11,600,000	2009	YES
HARDY COUNTY WATER SYSTEM IMPROVEMENTS HARDY COUNTY, WV	HARDY COUNTY PSD 223 N. MAIN STREET MOOREFIELD, WV 26836	\$8,000,000	2010	YES



17. COMPLETED WORK WITHIN LAST 5 YEARS ON WHICH YOU WERE THE DESIGNATED ENGINEER OF RECORD				
PROJECT NAME, TYPE AND LOCATION	NAME AND ADDRESS OF OWNER	ESTIMATED CONSTRUCTION COST	YEAR	CONSTRUCTED (YES OR NO)
LEWIS COUNTY ECONOMIC DEVELOPMENT AUTHORITY BLOODY RUN WATER LINE EXTENSION	LEWIS COUNTY EDA 16 GARTON PLAZA WESTON, WV 26452	\$167,165.00	2013	YES
HEPZIBAH PSD SANITARY SEWER EXTENSION HARRISON COUNTY, WV	ENLARGED HEPZIBAH DRAWER H HEPZIBAH, WV 26369	\$3,400,000	2010	YES
SOUTHWESTERN PSD WATER LINE EXTENSION / REPLACEMENT	SOUTHWESTERN WATER PUBLIC SERVICE DISTRICT P. O. BOX 98 FLEMINGTON, WV 26347	\$10,430,000	2012.	YES
CITY OF SALEM WATER LINE REPLACEMENT AND DAM IMPROVEMENTS HARRISON COUNTY, WV	CITY OF SALEM 229 WEST MAIN STREET SALEM, WV 26426	\$981,595.00	2013	YES
TOWN OF ROWLESBURG WATER TREATMENT PLANT/ EXT. PRESTON COUNTY, WV	TOWN OF ROWLESBURG PO BOX 458 42 POPLAR STREET ROWLESBURG, WV 26425	\$4,500,000.	2010	YES
COUNTY LINE BRIDGE MARSHALL COUNTY, WV	WVDOT / DOH BLDG. 5, ROOM A-109 1900 KANAWHA BLVD., EAST CHARLESTON, WV 25305	\$1,800,000.00	2013	YES
WVDOH DISTRICT 7 HEADQUARTERS LEWIS COUNTY, WV	WVDOT / DOH BLDG. 5, ROOM A-109 1900 KANAWHA BLVD., EAST CHARLESTON, WV 25305	\$2,300,000.00	2013	YES
I-64 WEIGH STATION PUTNAM COUNTY, WV	WVDOT / DOH BLDG. 5, ROOM A-109 1900 KANAWHA BLVD., EAST CHARLESTON, WV 25305	\$800,000.00	2013	YES

18. COMPLETED WORK WITHIN LAST 5 YEARS ON WHICH YOU WERE ASSOCIATED WITH OTHER FIRMS (INDICATE PHASE OF WORK FOR WHICH YOUR FIRM WAS RESPONSIBLE)

PROJECT NAME, TYPE AND LOCATION	NAME AND ADDRESS OF OWNER	ESTIMATED CONSTRUCTION COST OF YOUR FIRM'S PORTION	YEAR	CONSTRUCTED (YES OR NO)	FIRM ASSOCIATED WITH
MC DOWELL COUNTY FEDERAL PRISON WELCH, WV SITE DEVELOPMENT	US DEPARTMENT OF JUSTICE FEDERAL BUREAU OF PRISONS 500 FIRST STREET NW WASHINGTON, DC 20534	\$25,000,000.00	2010	YES	BELL JUSTICE FACILITIES
CITY OF BECKLEY INTERMODAL GATEWAY	CITY OF BECKLEY 409 S. KANAWHA STREET BECKLEY, WV 25801	\$250,000.00	2012	YES	PARSONS BRINCKERHOFF

19. USE THIS SPACE TO PROVIDE ANY ADDITIONAL INFORMATION OR DESCRIPTION OF RESOURCES SUPPORTING YOUR FIRM'S QUALIFICATIONS TO PERFORM WORK FOR THE WV ABANDONED MINE LANDS PROGRAM

SEE ATTACHMENT – STATEMENT OF QUALIFICATIONS

20. THE FOREGOING IS A STATEMENT OF FACTS.

SIGNATURE: Chad Biller TITLE: PARTNER / PRINCIPAL-IN-CHARGE

DATE: 4/10/2014

PRINTED NAME: CHADWICK D. BILLER, P.E.

**CERTIFICATION AND SIGNATURE PAGE**

By signing below, I certify that I have reviewed this Solicitation in its entirety, understand the requirements, terms and conditions, and other information contained herein; that I am submitting this bid or proposal for review and consideration; that I am authorized by the bidder to execute this bid or any documents related thereto on bidder's behalf; that I am authorized to bind the bidder in a contractual relationship; and that to the best of my knowledge, the bidder has properly registered with any State agency that may require registration.

Thrasher  
(Company)

Chad Biller  
(Authorized Signature)

Principal In Charge, Chad Biller  
(Representative Name, Title)

304-624-4108      304-624-7831  
(Phone Number)      (Fax Number)

April 10, 2014  
(Date)

**ADDITIONAL TERMS AND CONDITIONS (Architectural and Engineering Contracts Only)**

1. **PLAN AND DRAWING DISTRIBUTION:** All plans and drawings must be completed and available for distribution at least five business days prior to a scheduled pre-bid meeting for the construction or other work related to the plans and drawings.
2. **PROJECT ADDENDA REQUIREMENTS:** The Architect/Engineer and/or Agency shall be required to abide by the following schedule in issuing construction project addenda:
  - a. The Architect/Engineer shall prepare any addendum materials for which it is responsible, and a list of all vendors that have obtained drawings and specifications for the project. The Architect/Engineer shall then send a copy of the addendum materials and the list of vendors to the State Agency for which the contract is issued to allow the Agency to make any necessary modifications. The addendum and list shall then be forwarded to the Purchasing Division buyer by the Agency. The Purchasing Division buyer shall send the addendum to all interested vendors and, if necessary, extend the bid opening date. Any addendum should be received by the Purchasing Division at least fourteen (14) days prior to the bid opening date.
3. **PRE-BID MEETING RESPONSIBILITIES:** The Architect/Engineer shall be available to attend any pre-bid meeting for the construction or other work resulting from the plans, drawings, or specifications prepared by the Architect/Engineer.
4. **AIA DOCUMENTS:** Contracts for architectural and engineering services will be governed by the AIA document B101-2007, as amended by the Supplementary Conditions for the State of West Virginia, in addition to the terms and conditions contained herein when procured under Chapter 5G of the West Virginia Code.
5. **GREEN BUILDINGS MINIMUM ENERGY STANDARDS:** In accordance with West Virginia Code § 22-29-4, all new building construction projects of public agencies that have not entered the schematic design phase prior to July 1, 2012, or any building construction project receiving state grant funds and appropriations, including public schools, that have not entered the schematic design phase prior to July 1, 2012, shall be designed and constructed complying with the ICC International Energy Conservation Code, adopted by the State Fire Commission, and the ANSI/ASHRAE/IESNA Standard 90.1-2007: *Provided*, That if any construction project has a commitment of federal funds to pay for a portion of such project, this provision shall only apply to the extent such standards are consistent with the federal standards.

RFQ No. DEP16436

STATE OF WEST VIRGINIA  
Purchasing Division

**PURCHASING AFFIDAVIT**

**MANDATE:** Under W. Va. Code §5A-3-10a, no contract or renewal of any contract may be awarded by the state or any of its political subdivisions to any vendor or prospective vendor when the vendor or prospective vendor or a related party to the vendor or prospective vendor is a debtor and: (1) the debt owed is an amount greater than one thousand dollars in the aggregate; or (2) the debtor is in employer default.

**EXCEPTION:** The prohibition listed above does not apply where a vendor has contested any tax administered pursuant to chapter eleven of the W. Va. Code, workers' compensation premium, permit fee or environmental fee or assessment and the matter has not become final or where the vendor has entered into a payment plan or agreement and the vendor is not in default of any of the provisions of such plan or agreement.

**DEFINITIONS:**

"Debt" means any assessment, premium, penalty, fine, tax or other amount of money owed to the state or any of its political subdivisions because of a judgment, fine, permit violation, license assessment, defaulted workers' compensation premium, penalty or other assessment presently delinquent or due and required to be paid to the state or any of its political subdivisions, including any interest or additional penalties accrued thereon.

"Employer default" means having an outstanding balance or liability to the old fund or to the uninsured employers' fund or being in policy default, as defined in W. Va. Code § 23-2c-2, failure to maintain mandatory workers' compensation coverage, or failure to fully meet its obligations as a workers' compensation self-insured employer. An employer is not in employer default if it has entered into a repayment agreement with the Insurance Commissioner and remains in compliance with the obligations under the repayment agreement.

"Related party" means a party, whether an individual, corporation, partnership, association, limited liability company or any other form or business association or other entity whatsoever, related to any vendor by blood, marriage, ownership or contract through which the party has a relationship of ownership or other interest with the vendor so that the party will actually or by effect receive or control a portion of the benefit, profit or other consideration from performance of a vendor contract with the party receiving an amount that meets or exceeds five percent of the total contract amount.

**AFFIRMATION:** By signing this form, the vendor's authorized signer affirms and acknowledges under penalty of law for false swearing (W. Va. Code §61-5-3) that neither vendor nor any related party owe a debt as defined above and that neither vendor nor any related party are in employer default as defined above, unless the debt or employer default is permitted under the exception above.

**WITNESS THE FOLLOWING SIGNATURE:**

Vendor's Name: The Thrasher Group, Inc. (Thrasher)

Authorized Signature: Chad Belter Date: 4-10-2014

State of West Virginia

County of Harrison, to-wit:

Taken, subscribed, and sworn to before me this 10<sup>th</sup> day of April, 2014.

My Commission expires April 28, 2019.

AFFIX SEAL HERE

NOTARY PUBLIC Neve Lee Kerns  
Purchasing Affidavit (Revised 07/01/2012)

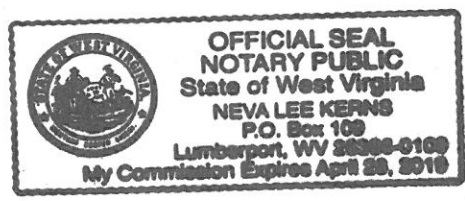

**ADDENDUM ACKNOWLEDGEMENT FORM**  
**SOLICITATION NO.: DEP16436**

**Instructions:** Please acknowledge receipt of all addenda issued with this solicitation by completing this addendum acknowledgment form. Check the box next to each addendum received and sign below. Failure to acknowledge addenda may result in bid disqualification.

**Acknowledgment:** I hereby acknowledge receipt of the following addenda and have made the necessary revisions to my proposal, plans and/or specification, etc.

**Addendum Numbers Received:**

(Check the box next to each addendum received)

- |   |  |
|---|--|
| <input type="checkbox"/> Addendum No. 1 | <input type="checkbox"/> Addendum No. 6  |
| <input type="checkbox"/> Addendum No. 2 | <input type="checkbox"/> Addendum No. 7  |
| <input type="checkbox"/> Addendum No. 3 | <input type="checkbox"/> Addendum No. 8  |
| <input type="checkbox"/> Addendum No. 4 | <input type="checkbox"/> Addendum No. 9  |
| <input type="checkbox"/> Addendum No. 5 | <input type="checkbox"/> Addendum No. 10 |

I understand that failure to confirm the receipt of addenda may be cause for rejection of this bid. I further understand that any verbal representation made or assumed to be made during any oral discussion held between Vendor's representatives and any state personnel is not binding. Only the information issued in writing and added to the specifications by an official addendum is binding.

\_\_\_\_\_  
Company

\_\_\_\_\_  
Authorized Signature

\_\_\_\_\_  
Date

NOTE: This addendum acknowledgement should be submitted with the bid to the office of the document processing.

