

CAPITOL CAMPUS SECURITY DESIGN

CHARLESTON, WV

RFQ Number: GSD 126428

February 9, 2012

RECEIVED

2012 FEB -9 AM 9:38

WV PURCHASING
DIVISION

RTKL

AN ARCADIS COMPANY

February 8, 2012

Krista Ferrell
Purchasing Division
2019 Washington Street, East
Charleston, WV 25305

The logo for RTKL Associates Inc. consists of the letters "RTKL" in a bold, white, sans-serif font, centered within a solid red rectangular background.

RE: State of West Virginia – Capitol Campus Security Design

Dear Ms. Ferrell,

Please accept our response to your Request for Qualifications for the Capitol Campus Security Design. RTKL has worked extensively with projects of this type as demonstrated throughout our proposal. We are an organization with extensive experience in the design of high profile public facilities that must balance public accessibility with security requirements while respecting the needs of the workplace and the projects context. This experience ensures you that we have the expertise to effectively partner with your team members who will influence our project approach and recommended solutions.

RTKL is nationally recognized as a global design leader and our portfolio of work for clients such as the Architect of the Capitol, Intelligence Community, General Services Administration and Department of Defense indicates our success balancing significant new and historic architecture with today's need for heightened security. We believe that we are providing you with the absolute best team for this project.

RTKL has a staff of qualified architects, engineers, landscape architects, and security professionals, augmented by specialist consultants that specialize in securing public sector facilities both locally and internationally. We work with our clients to develop balanced solutions that are unique to each facility that reflect aesthetic, operational and functional requirements, best practices and regulatory guidance.

It is our sincere hope that we will have the opportunity to share these skills with you and contribute to a successful project for the entire team. We look forward to working with you to secure another Cass Gilbert design as we did for the U.S. Supreme Court. Please do not hesitate to contact us with any questions you might have after you've reviewed the enclosed proposal. We look forward to offering any further information you might find necessary. Thank you for your consideration.

Sincerely,

A handwritten signature in black ink, reading "David Vere Thompson", is written over a horizontal line.

RTKL Associates Inc.
David Vere Thompson FAIA, BSCP, LEED AP
Senior Vice President

RTKL Associates Inc.
901 South Bond Street
Baltimore, MD 21231

T. 410 537 6000
F. 410 276 2136

RTKL.COM

CONTENTS

CONCEPT	[1]
FIRM/TEAM QUALIFICATIONS	[2]
PROJECT ORGANIZATION	[3]
RELEVANT EXPERIENCE	[4]
ATTACHMENTS	[5]

CONCEPT

RTKL'S DESIGN PROCESS IS NOT BASED ON PRECONCEIVED NOTIONS OR AN INSULATED DESIRE TO MAKE AN ARCHITECTURAL STATEMENT. RATHER, IT IS BASED ON UNDERSTANDING WHO OUR CLIENTS ARE AND WHAT THEY SEEK TO ACHIEVE. WE START BY DIGGING DEEP TO UNEARTH THE STRATEGIC OBJECTIVES OF THE ENVIRONMENTS WE CREATE—WE IMMERSE OURSELVES IN OUR CLIENTS' WORLDS.

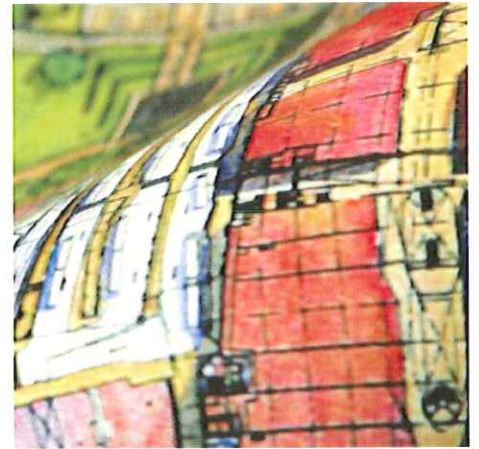

SECURITY DESIGN

PROTECTIVE PLANNING AGAINST CRIMINAL AND TERRORIST THREATS HAS BECOME AN INTEGRAL ASPECT OF THE DESIGN PROCESS - SECURITY IS SHAPING THE BUILT ENVIRONMENT. THE PUBLIC AND PRIVATE SECTORS ARE INCREASINGLY CONCERNED WITH THE SAFETY OF THEIR EMPLOYEES AND THE SECURITY OF THEIR BUILDINGS. FINANCIAL IMPACTS ARE REAL AND VARY WITH RESPECT TO THE LEVEL OF THREAT, THE ACCEPTED RISKS, AND THE LEVEL OF DESIRED PROTECTION.

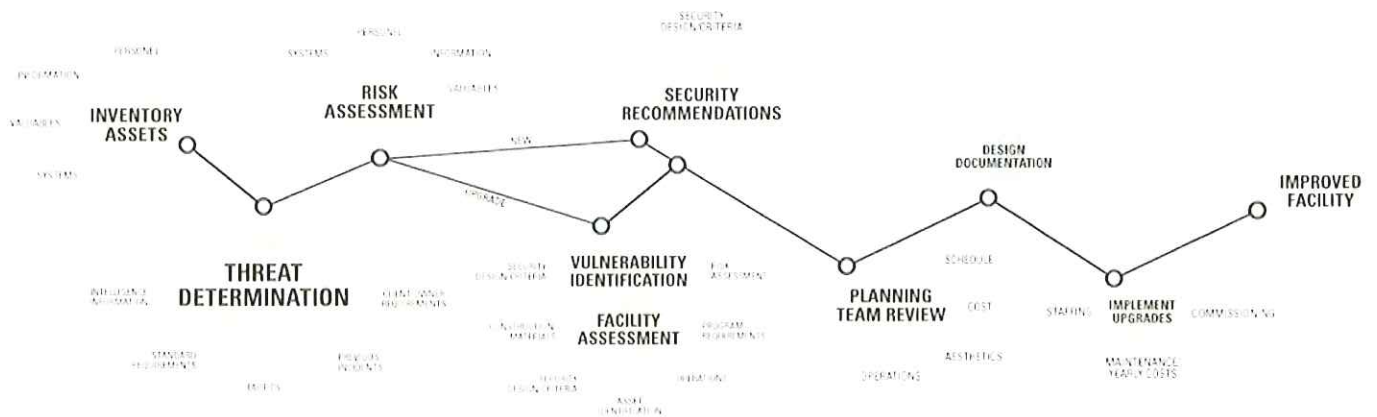

RTKL takes a holistic approach to protective planning. We are a team of specialized professionals that brings extensive planning and design expertise. We work collaboratively with experts in operational security, life safety, structural blast effects, and traffic engineering. This group, has over time, developed a comprehensive approach to facilities protective planning. We address security as a tiered defensive system within a framework which respects planning, architectural design and engineering excellence. By coordinating and balancing security goals against threats and vulnerabilities, we can apply an integrated set of technical measures within the facilities framework and operational considerations to provide an effective, coordinated, security response. We have no preconceived solutions nor are we affiliated with any security manufacturer or product.

The primary goal of an ideal security design is to save lives, prevent injuries, and protect property. Our primary concerns have been loss of life and loss of operations. Ideal criteria encompass components that provide the means and methods to detect, delay, deter, and assess intrusions or attempted intrusions. These components provide a range of design options depending upon the threat to the facility. The criticality of the protected resource also contributes to the degree of protection that should be provided. Previous assessments have included as threats: vehicle bombs, package bombs, surreptitious entry, forged identification, and weapons of mass destruction.

Defense Threat Reduction Agency



FORCE PROTECTION

Beginning in the early 1990s, an increased focus on domestic terrorism led the GSA to establish new security guidelines governing the construction and renovation of all federal buildings. Now, after the events of September 11th, both the public and private sectors are intensely concerned with the safety of their employees and the security of their buildings.

In our work on the Pentagon reconstruction, the U.S. Capitol Visitors Center and the U.S. Army's Defense Threat Reduction Center, RTKL has employed a team approach to protective planning, coordinating the extensive facilities planning and design expertise of our specialized professionals with that of consultants representing operational security, life safety, structural blast effects, and traffic engineering.

RTKL's portfolio of significant, secure workplaces includes headquarters office compounds, embassies, ambassadors' residences, command and operations

centers, courts, corporate data centers, research laboratories, medical centers, and Department of Defense and Intelligence Community facilities, such as the National Maritime Intelligence Center, the award-winning National Ground Intelligence Center, the Defense Threat Reduction Center and just completed Defense Information Systems Agency Headquarters and the National Geospatial-Intelligence Agency's Campus East. We have prepared master plans, final designs and design criteria/standards against both criminal and terrorist threats including blast mitigation and CBRN protection.

SECURITY MASTER PLANNING

RTKL's security master planners take a holistic approach to security for the built environment and focus on the symbiotic relationship of spaces and systems. We approach every project from the outside in, making sure to identify significant threats and vulnerabilities before honing in on specific design challenges.

Whether in the public or private sector, or at the global, national or local level, we deliver targeted solutions that improve the safety and security of our clients' most valuable assets.

Recent events throughout the world have made one thing very clear: security matters. People must be protected and information must remain secure and uncorrupted.

Facilities built to contain essential personnel and essential data face unique challenges when it comes to protective planning. Complicating matters is the fact that these threats change. Staying on top of the changes means approaching security from differing perspectives while being mindful of cost, functionality, flexibility and aesthetics. From building perimeters to interior spaces, and from simple card access to highly complex surveillance systems, today's secure environments require multi-disciplinary, enlightened solutions.

RTKL has, over time, developed a comprehensive approach to security master planning and design. We bring a wide-ranging, coordinated team of professionals together to address security as a tiered defensive system, regardless of a project's size, scope or type. This approach begins with a holistic look at a project's largescale protection needs. From who the client is, to where the project is located, to how a building is used, we develop a framework of requirements that help balance project goals against identified threats. We evaluate concerns such as perimeter protection, access control and building adjacencies to develop effective security responses that respect architectural design and engineering excellence.

Our protective planning services offer coordinated architectural and engineering solutions for the physical needs of a building, including structure, materials, HVAC systems, power supply, access and interior design. Our technical protective planning provides high-performance, scalable security solutions that are highly interoperable for cost savings and operational efficiency. We offer complete security capability of virtually unlimited size to meet any spatial and integration challenge.

FACILITY DESIGN AND CONSTRUCTION

An example of our perimeter security master planning and design is our work on Capitol Hill for the Architect of the Capitol. We developed design-build RFP's or full construction documents for its implementation protecting the U.S. Capitol, House and Senate Office buildings, Library of Congress and Supreme Court (like the West Virginia Capitol, a Cass Gilbert design) . We have conducted over 50 threat, vulnerability and security upgrade master plans for federal agencies and have developed security standards and criteria for intelligence community members. Currently we are engaged by GSA for perimeter security solutions for the Herbert C. Hoover Building and the Federal Triangle including Department of Justice, Internal Revenue Service and Environmental Protection Agency. As with the Capitol hill projects, all of these buildings are national historic landmarks and sensitivity to the landscape, architecture, historic settings, pedestrian access, service and lighting have been important considerations.

Perimeter Security projects for public buildings are challenging in terms of providing freedom of access to the public while maintaining control of vehicles in a manner that respects the site context, especially in historic settings. Depending on threats and protective level required, placement of perimeter devices can require extensive foundations, and power and communications lines all of which require survey and evaluation of existing subsurface conditions for soil condition as well as buried utilities. We include a traffic planner on our team because failure to understand the effects of queuing at vehicle control points can result in traffic backups affecting surrounding road networks. Placement of sensors and cameras must consider sight lines, lighting levels and existing elements such as trees, light posts, utility poles, flag poles and surrounding architecture to successfully integrate these elements.

RTKL has extensive experience in the design of Sensitive Compartmented Information Facilities (SCIF) and other secure environments including the new NGA New Campus East, Defense Information Systems Agency Headquarters, Defense Threat Reduction Center, National Ground Intelligence Center, National

Maritime Intelligence Center, the House and Senate Intelligence Committee SCIF's in the new U.S. Capitol Visitor Center. In total RTKL has been involved in the planning of over 14 million square feet of SCIF space.

Our projects incorporate IDS and protective measures against specific or full spectrum threats including: blast, ballistics, and CBRNE; our projects also include access control systems, sensors, and CCTV systems. We have designed remote inspection facilities, visitor control centers, security control centers, polygraph suites and command and control centers. We are knowledgeable and experienced in applying federal and other organizations design criteria.

PROTECTIVE PLANNING PROCESS

We can provide a comprehensive set of security to services working with our clients or to provide a balanced, flexible, and cost effective layered solution to their security needs. This process includes some or all of the items listed below and can be applied to both new and existing facilities. Our greatest impact is in dealing with entire campuses where holistic solutions can reduce overall cost when compared to individual buildings.

- Asset Analysis
- Threat Assessment
- Facility Evaluation
- Vulnerability Assessment
- Risk Assessment and Prioritization
- Mitigation Strategies
- Development of standards and Criteria
- Final Design
- Construction Phase Services
- Commissioning and Testing
- Operations

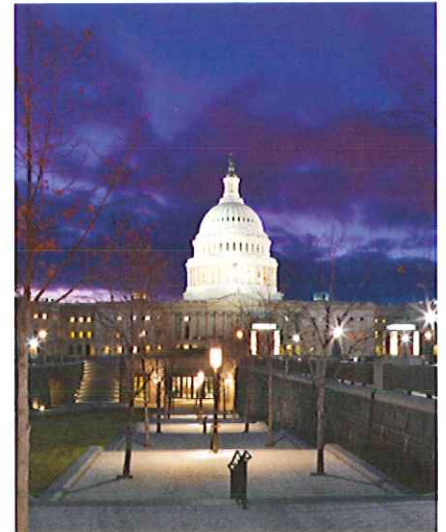

U.S. Capitol Visitor Center,
Washington, DC

RTKL SECURE FACILITIES EXPERIENCE

902nd Military Intelligence Group Headquarters
Architect of the Capitol Perimeter Security Projects
Booz Allen Hamilton, Aberdeen, MD
Booz Allen Hamilton, Annapolis Junction, MD
Booz Allen Hamilton, One Preserve Parkway, MD
Classified Agency Decision Support Center
Classified Agency External Buildings Security Study
Classified Agency IDIQ (15 years; over 1000 tasks)
Classified Agency Main Headquarters Compound
Classified Agency Special Sites Security Study
Defense Information Systems Agency Headquarters
Defense Threat Reduction Center
Federal Bureau of Investigation IDIQ
Federal Executive Institute
Food and Drug Administration Headquarters
Fortress Development Security Upgrade
Fort Stewart Secure Command and Control Center
Founder's Square Secure Office Complex
Maryland Procurement Office
Naval Facilities Engineering Command Washington IDIQ
INSCOM Metro Park
The Johns Hopkins Applied Physics Laboratory, Security Master Plan and Perimeter Security
The Johns Hopkins Applied Physics Laboratory, Buildings 17 & 21
Joint Use Intelligence Analysis Facility
Joint Personnel Recovery Agency, Command and Control Center
Marine Corps Network Operations Security Center
National Drug Intelligence Center Security Master Plan
National Geospatial-Intelligence Agency, New Campus East
National Ground Intelligence Center and Security Upgrade
National Maritime Intelligence Center (1991) and Expansion (2011)
Naval Research Laboratory Computational Research Center
New York State Emergency Management Office
PCAS Network Operations Center, USMC Quantico
Pentagon Reconstruction ("The Phoenix Project")
Satellite Earth Terminal Station, Ft Detrick, MD

Pentagon Reconstruction ("The Phoenix Project")

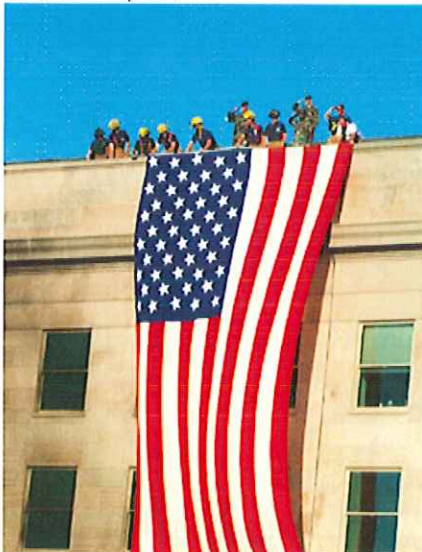

Sun Microsystems National Business Park
TEMPEST Shielded Operations Center (Classified)
U.S. Army Laboratory Center, Adelphi, MD
U.S. Army Judge Advocate General School Security Master Plan and
Perimeter Security
U.S. Capitol Visitor Center
U.S. Department of State Overseas Building Operations IDIQ
U.S. Department of State (Main State) IDIQ
U.S. Embassy Compound, Kampala, Uganda
U.S. Embassy Compound, Kuwait City, Kuwait
U.S. Embassies and Ambassadors' Residences, multiple locations
U.S. Secret Service Training Facility
U.S. Senate Recording Studios
Vice President's Residence (NOBSY)
White House Press Briefing Room

FIRM/TEAM QUALIFICATIONS

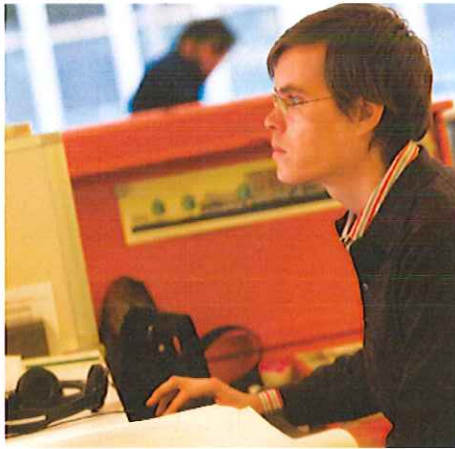



OUR FIRM

SINCE OUR FOUNDING AS A TWO-PERSON OFFICE MORE THAN 65 YEARS AGO, RTKL HAS BECOME ONE OF THE NATION'S LEADERS IN THE FIELD OF ARCHITECTURE AND ENGINEERING. WE STRIVE TO ACHIEVE DESIGN EXCELLENCE ON EVERY ASPECT OF A PROJECT, AND IT SHOWS.

RTKL is an idea-based creative firm that offers the most comprehensive integrated end-to-end planning and design services available in the market today. Founded in 1946, RTKL carved out a niche in master planning and design for private and government clients. Over the succeeding decades, RTKL evolved into a full-service firm, adding the disciplines of engineering, interior architecture, landscape architecture, and environmental graphic design, as well as new project specialties, including residential, offices, retail centers, hotels, and health sciences projects. The past two decades have brought further expansion, with mixed-use, federal government, entertainment, and branding and identity assignments.

Ranked by World Architecture as the sixth largest architecture and engineering firm in North America, RTKL's philosophy is currently practiced by nearly 800 architects, engineers, planners and urban designers, landscape architects, interior designers, and graphic designers working in offices around the world, including Baltimore, Washington, DC, Chicago, Miami, Dallas, Los Angeles, London, Abu Dhabi, Dubai, Beijing, and Shanghai.

While our domestic and international offices afford us geographic diversity and flexibility, we pride ourselves on providing collaborative services to our clients, regardless of a project's physical location, drawing input and resources from all of our offices to meet our clients' specific needs. The firm's orientation by practice group, rather than by geographic location, is key to providing clients with seamless, responsive design services.

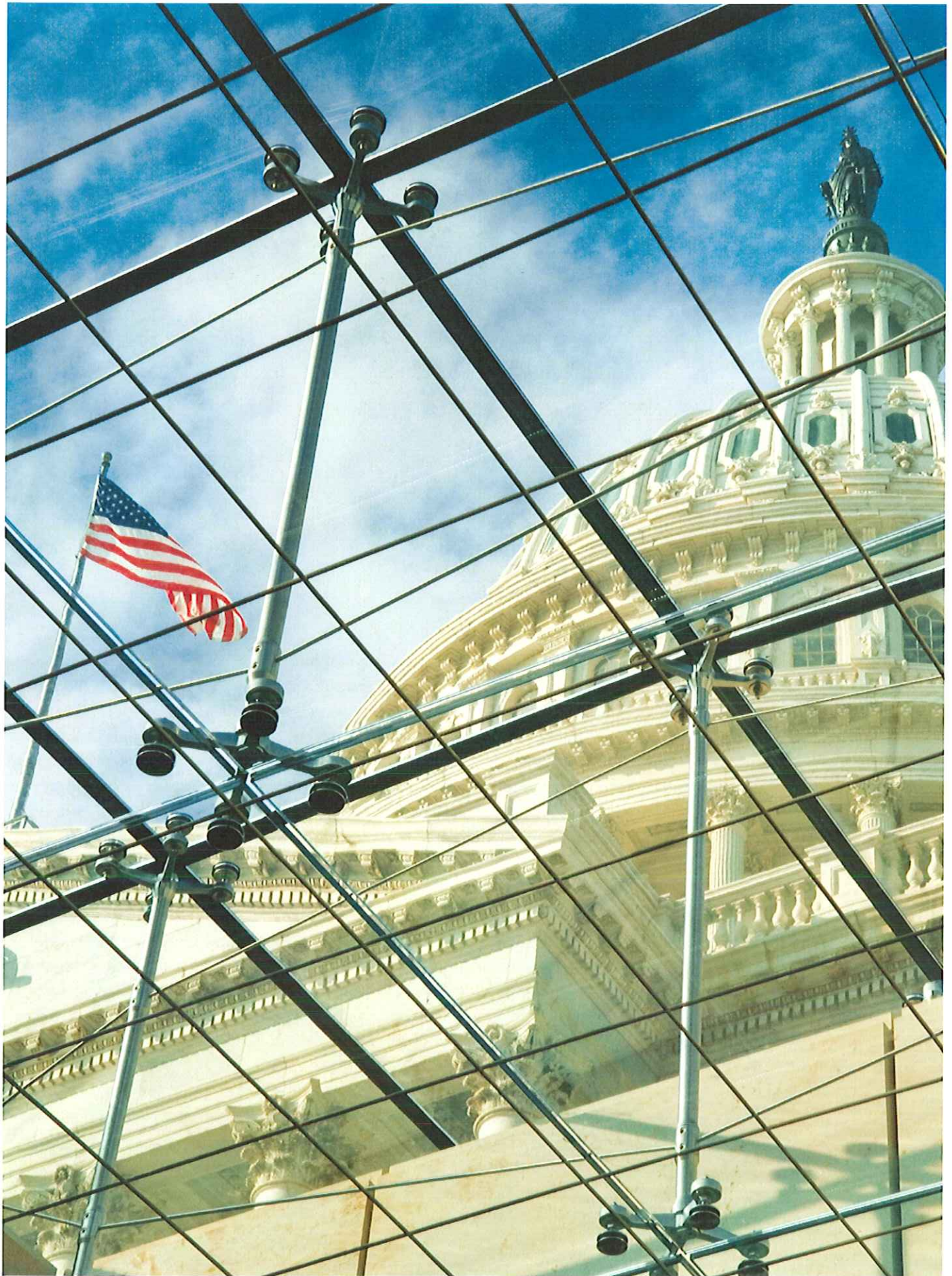

[OUR FIRM CONT.]

Guided by a design philosophy that emphasizes cooperative client relations, respect for excellence, and dedication to enhancing the human environment, RTKL has played a leading role in the shaping of skylines around the world. Characterized by a sensitivity to scale and context, the firm's early award-winning work set the tone for RTKL's growing portfolio of architecture projects, while its involvement with the famed revitalization of Baltimore's Inner Harbor led to planning and urban design commissions for dozens of cities around the world.

RTKL's project scope, as well as geographic focus, broadened with the design of retail centers, hotels, and large-scale commercial commissions, often as components of its urban plans. Today, RTKL is at work on projects in Asia, Europe, North and South America, Australia, and the United Kingdom.

Widely published in the design and trade press, and the recipient of hundreds of awards of excellence, RTKL enjoys an impressive history of creating buildings and projects that make a strong and lasting statement of quality. Having been commissioned by some of the world's most prestigious public and private clients—such as the Smithsonian Institution, Marriott, the Federal Government, and a multiple national developers—we have developed an international portfolio of mixed-use, retail, hotel, planning, public sector, government, health sciences, and interiors projects.



PROTECTIVE PLANNING

In today's uncertain times, the need for careful security planning is critical to ensure the safekeeping of people, systems and data. Providing a rich array of protective services, RTKL coordinates the extensive facilities planning and design expertise of our specialized professionals with that of consultants representing technical and operational security.

SECURITY

Facilities built to contain essential personnel and essential data face unique challenges when it comes to protective planning. Complicating matters is the fact that these threats change. Staying on top of the changes means approaching security from differing perspectives while being mindful of cost, functionality, flexibility and aesthetics.

ARCHITECTURE

With experience in nearly all project types, RTKL's architecture studios combine outstanding design skills with superior project management capabilities. Guided by a design philosophy that emphasizes respect for excellence, cooperative client relations, and enhancing the human environment, the firm's architects have helped shape the physical expression of communities and organizations across the globe.

INTERIOR ARCHITECTURE

From the initial client meeting through occupancy, RTKL's specialists in programming, space planning and interior design work with you to identify your design goals, schedule requirements and budgetary parameters, and develop a design that is sensitive to the individual considerations and requirements of the project.

MEP ENGINEERING

RTKL's mechanical, electrical, and plumbing engineers work closely with their architectural colleagues to provide seamless service. At the core of each project is the firm's promotion of "intelligent buildings," an approach that endows each design with contemporary strategies for energy efficiency, safety, and long-term savings.

WHAT WE CAN DO FOR YOU

BECAUSE OUR PROCESS IS BASED ON A HOLISTIC APPROACH, WE OFFER OUR CLIENTS A WIDE ARRAY OF SERVICES THAT COMPLEMENT OUR TRADITIONAL DESIGN DISCIPLINES. THESE RANGE FROM THE FRONT-END STRATEGIC SERVICES THAT HELP CLIENTS ASSESS A PROPERTY'S VALUE, DEFINE AND SHAPE BUSINESS GOALS AND CUSTOMER TOUCHPOINTS, TO THE MORE TECHNICAL ASPECTS OF THE BUILT ENVIRONMENT. OUR CORE SERVICES INCLUDE:

SUSTAINABILITY

At the core of every RTKL project lies a commitment to preserving and ensuring the needs of future generations and the capacity of our resources. RTKL implements sustainable design practices ranging from the use of environmentally-friendly products to LEED certification, aspiring to meet our clients' demands and expectations while paving the way for a sustainable future.

THE ENVIRONMENTS STUDIO

Our Environments Studio celebrates creativity through the implementation of ideas in three broad categories: the built environment, the visitor experience, and project identity. This approach combines architecture with a range of complementary design services to enhance architectural design, convey a memorable image, and establish inviting, easily navigated spaces.

PLANNING & URBAN DESIGN

Whether revitalizing downtown districts or developing large-scale land plans, our RTKL creates visually exciting and economically viable settings in which people live, work and shop. Drawing on decades of experience, our planners and urbanists create projects that establish logical frameworks, foster heightened cooperation between public and private interests, and spark a sense of civic and community pride.

STRUCTURAL ENGINEERING

The work of RTKL's structural engineering studio is marked by innovation directed toward overcoming the physical limitations of sites and meeting the particular requirements of each project. The studio works with our peers in architecture, as well as with clients directly, to develop cost-effective solutions to the full range of structural needs.

AUDIO/VISUAL

RTKL's Audio/Visual group provides high technology solutions to many federal and private clients. Working with large conference rooms, auditoriums, and college lecture rooms, the A/V group has extensive experience accommodating client needs. Their collaboration with the Special Systems group provides the best breeding ground for efficiency and innovation.

TECHNOLOGY DESIGN GROUP

Our Technology Design group works with both internal and external resources to provide data, telecommunications, security, and audio/visual technology, including telecommunications and data distribution systems, network architecture design and build, network implementation, project management and construction administration.

TIMOTHY J. HUTCHESON AIA, LEED AP [PRINCIPAL-IN-CHARGE]



Tim Hutcheson has extensive experience in the management of large, complex projects with responsibility for technical detailing, specifications, production, and construction administration. Tim has consistently demonstrated a strong capacity to solve complex challenges under pressure. His portfolio includes contracts with the federal government and major commercial developers on office, laboratory, retail, and education projects.

SELECT EXPERIENCE

United States Capitol Visitor

Center project manager and on-site construction administrator, 580,000-SF underground visitor reception facility, designed to strengthen the building's security, includes exhibition, reception, food service, office, theater and gift shop areas, Washington DC

National Geospatial-Intelligence

Agency New Campus East 2.4 million SF headquarters, consolidation of six NGA locations into a state-of-the-art intelligence facility, Ft. Belvoir, VA

Herbert C. Hoover Building Perimeter

Security 1,800,000-SF federal building, eight-phase renovation, construction administration services, Washington, DC

Brickell Financial Center

Design Technical Advisor, 920,000-SF, 35-story tower, includes retail and office components, Miami, FL

Social Security Administration Metro

West Complex Project Manager, 1.3 million-SF office building, alteration and repairs, Baltimore, MD

Bond Street Wharf Project Manager, 215,000-SF office building, includes first floor retail, Baltimore, MD

U.S. Naval Academy, Bancroft Hall

1.4 million-SF historic building, 10-year phased renovation master plan to upgrade dorm rooms, administrative

offices, galley, large-scale dining facility and support space, Annapolis, MD

T. Rowe Price Financial Center Phase 1 585,000-SF, 32-acre corporate headquarters, includes four buildings, Owings Mills, MD

Baltimore City Juvenile Justice

Center 240,000-SF juvenile detention center, includes court and office space, Baltimore, MD

National Cancer Institute 12,000-SF research laboratory, includes a 1,000 SF bio-safety level 3 animal holding suite, Frederick, MD

Lafayette College Residential Facilities

Masterplan residential master plan, includes comprehensive review of 15 separate residential facilities, Easton, PA

Kiev Business Center

160,000 SM mixed-use development including local headquarters of Daewoo Corporation, five-star hotel, retail, and high-end residential units, Kiev, Ukraine

Inner Harbor Center 155,000-SF, 11-story office tower, Baltimore, MD

Eastern Shore Hospital Center 80-bed freestanding replacement psychiatric hospital, Cambridge, MD

Warsaw Trade Tower

765,000-SF, 41-story mixed use tower, includes office, retail, restaurants, health club, showroom and parking, Warsaw, Poland

TITLE

Vice President

INDUSTRY EXPERIENCE

21 Years

EDUCATION

University of Cincinnati,
Bachelor of Architecture

LICENSES AND CERTIFICATIONS

Registered Architect: DC, MD, OH
LEED AP

Certified Construction Contract
Administrator

Construction Documents
Technologist

National Council Architectural
Registration Boards

AWARDS AND HONORS

Vernon Moorer Award for Technical
Quality, RTKL Legacy Awards, 2007

PROFESSIONAL AFFILIATIONS

American Institute of Architects
Construction Specification Institute

RICHARD J. STORCK AIA, LEED AP [PROJECT MANAGER]



Richard has extensive experience as a project manager and is a project architect with more than 28 years of diverse project experience involving renovation and new construction. His past experience in the design and management of public space projects including visitor centers, embassies and ambassador residences makes for the necessary skills to successfully complete this project. Richard was the project manager for a five-year IDIQ contract with the Office of Overseas Buildings Operations (OBO) in which he managed multiple and concurrent Task Orders ranging in value from \$35,000 to \$1.1 million. As a project manager, Richard facilitates communication between disciplines such as Architecture, MEP, Civil, and Structural. He also serves as the primary point of contact with the Contracting Officer's Representative.

TITLE

Principal

INDUSTRY EXPERIENCE

28 Years

EDUCATION

Kansas State University
Bachelor of Architecture
Loyola College
Bachelor, Liberal Arts

LICENSES AND CERTIFICATIONS

Registered Architect: Maryland
LEED AP

PROFESSIONAL AFFILIATIONS

American Institute of Architects

SELECT RTKL EXPERIENCE

U.S. Capitol Visitor Center Project Manager, Three story 580,000 SF subterranean visitor center below the east plaza of the U.S. Capitol, Washington, DC

Design-Build RFP's for NAVFAC Project Manager to develop two Design-Build Requests for Proposal for NAVFAC, Marine Corps Base, Quantico, VA and Naval Air Station, Patuxent River, MD

FDA Child Care Center Project Manager for 21,000 SF one-story LEED Gold child care center for GSA, White Oak, MD

Manhattan Courts Master Plan Project Manager for Pre-scoping Study for the City of New York to assess four large court buildings and develop strategies to resolve building deficiencies and to re-organize the court spaces within the buildings, New York, NY

Embassy of Poland Master Plan Project Manager to develop a Master Plan to consolidate the diverse operations of the Polish Mission in

Washington, DC on to a single site, Washington, DC

U.S. Embassy (Future) Project Manager, Initial Planning Study for the future ten acre New Embassy Compound for Overseas Buildings Operations (OBO), U.S. Department of State, Tripoli, Libya

U.S. Embassy Project Manager, ten year master plan for the ten acre embassy compound for Overseas Buildings Operations (OBO), U.S. Department of State, Canberra, Australia

U.S. Embassy Compound Project Architect, 40,000 SF U.S. Embassy building and 40,000 USAID building in East Africa for the U.S. Department of State using the most current security standards, Kampala, Uganda

Ariel Rios Federal Building (Phase II) modernization Project Architect, renovation, and tenant fit-out of 500,000 SF 1930's office building listed on the National Register of Historic Places, new headquarters for the United States Environmental Protection Agency, Washington, DC

D. ROD HENDERER FAIA, LEED AP [LEAD ARCHITECTURAL DESIGNER]

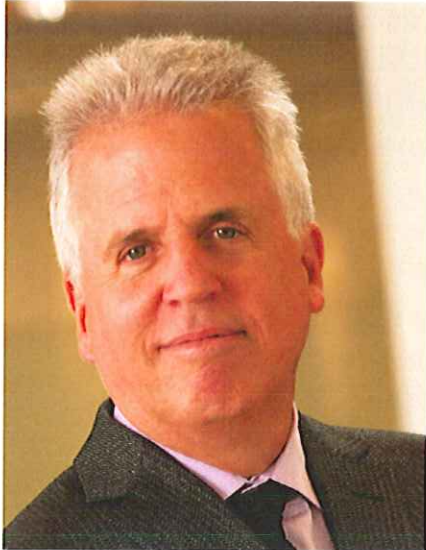

TITLE

Sr. Vice President

INDUSTRY EXPERIENCE

37 Years

EDUCATION

Syracuse University, Bachelor of Architecture

Architectural Association School of Architecture

LICENSES AND CERTIFICATIONS

Registered Architect: DC, DE, MD, VA
LEED Accredited Professional

As a Senior Vice President and senior designer, Rod has been responsible for leading the designs of many of the firm's prominent projects. He is experienced in all phases of project development, from design through construction administration. With nearly 40 years of experience, he brings a passion for design and a portfolio of international and domestic assignments that encompasses major civic and public facilities, offices and embassies that has helped guide RTKL to the upper echelons of the industry.

SELECT EXPERIENCE

Food and Drug Administration Headquarters principal-in-charge of design, 2.2 million-SF federal government agency headquarters consolidation, White Oak, MD

National Geospatial-Intelligence Agency, New Campus East lead designer, state-of-the-art headquarters facility, new construction, Fort Belvoir, VA

U.S. Capitol Visitor Center principal-in-charge of design, 574,000 SF underground facility

Saudi Food and Drug Authority principal-in-charge of 1 million-SF government complex, Riyadh, Saudi Arabia

U.S. Embassy, The Netherlands principal-in-charge of design for a chancery, marine barracks, utility and maintenance buildings on a ten-acre site. Concept centered on creating a park-like setting with canals reminiscent of the Dutch landscape, The Netherlands

U.S. Embassy, Kampala principal-in-charge, design-build competition, 28,000 SF office building, Kampala, Uganda

U.S. Consulate, Milan principal-in-charge of design for a consulate, marine barracks, utility and maintenance buildings, Milan, Italy

U.S. Ambassador's Residence lead designer, 15,000-SF residence, Bangkok, Thailand

U.S. Embassy Compound, Monrovia principal-in-charge of design for an embassy, marine barracks, utility and maintenance buildings, Monrovia, Liberia

U.S. Embassy Compound, Baku principal-in-charge of design for an embassy, marine barracks, utility and maintenance buildings, Baku, Azerbaijan

U.S. Embassy, Kuwait lead designer, 96,000-SF embassy complex, Bayan, Kuwait

U.S. Ambassador's Residence lead designer, 10,000-SF residence, Bayan, Kuwait

Richard Sheppard Arnold United States Courthouse Annex principal-in-charge of design, alterations of 260,000 SF existing building and 140,000 SF addition, Little Rock, AR

New NATO HQ Competition principal-in-charge for one of only five finalist submissions selected in a competition to design the new NATO headquarters in Brussels. RTKL created a design that met NATO's challenge: to reflect the complex structure of the organization and its evolving role in the field of international security while adhering to a NATO's detailed program including

strict security, functional and program requirements, 2.7 million SF, Brussels, Belgium

NOAA Competition principal-in-charge for 300,000-SF building for National Center for Weather and Climate Prediction. Facility includes office, mission critical and laboratory spaces, auditorium, conference center and library, College Park, MD

National Capital Planning

Commission lead designer, revisions to the "monumental core" plan for the year 2050, Washington, DC

Nassif Building

Redevelopment principal-in-charge, one of three finalists selected for a competition to redevelop a one million-SF building to suit a cabinet level federal agency. The design included truss system for progressive collapse, under-floor air distribution system, large-scale covered courtyard, unmatched loft-like space on top floor and was designed to meet certification requirements for Core & Shell Gold LEED rating, Washington, DC

Broad Run Building E principal-in-charge for architectural design of single-story speculative 130,000-GSF office building, Loudoun County, VA

Towers Crescent principal-in-charge of master plan and architecture to develop 900,000-SF office and mixed-use site, Tysons Corner, VA

National Association of Securities Dealers principal-in-charge, 450,000-SF corporate operations center, Rockville, MD

Brickell Financial Center principal-in-charge for a 40-story, Class A multi-use tower with retail and office components, Miami, FL

Senayan Square lead designer for mixed-use center with 325 residential units, 500-room hotel, 1.8 million SF

of office, 840,000 SF of retail, Jakarta, Indonesia

Towson Commons lead designer for 900,000-SF mixed-use project with office, retail and theaters, Towson, MD

Milton Keynes lead designer, international urban design competition for final and third phase of central business exchange of planned community outside of London, London, England

Coastline Hotel Expansion vice president-in-charge of design for 100,000-SF new hotel with 140 rooms, rooftop bar and swimming pool. Includes 36,000-SF renovation/restoration of a historic warehouse into lobby, bar/lounge and three large meeting rooms and a restaurant, Wilmington, North Carolina.

Montgomery County Conference Center and Hotel Complex principal-in-charge of design for 225-room hotel and conference facilities, Montgomery County, MD

Fan Pier Hyatt principal-in-charge of design, concept studies for a 400-room Grand Hyatt and 200-room Park Hyatt, Boston, MA

Hyatt Regency Orlando Convention Center principal-in-charge of design, 1,500-room convention hotel with 150,000 SF of meeting space, Orange County, FL

Blackwell Inn and Conference Center, Fisher College of Business, Ohio State University vice president-in-charge of a 123,000-SF hotel and conference center created to enhance and support the Executive Education Programs, Columbus, OH

Hyatt Regency Chesapeake Resort and Conference Center principal-in-charge of design for 350-acre complex with 400-room hotel, conference facilities, spa, 18-hole golf course, marina, and 300-400 residential units, Cambridge, MD

AWARDS AND HONORS

Northern Virginia NAIOP, Best of NAIOP Awards, Best Buildings Speculative Single-Story Office, 2001

1998 Lisbon World's Fair, competition design, Outstanding Submission

The Manhattan, Grand Award, Hotel Category, Gold Nugget Awards Competition (Pacific Coast Builders Conference and Sun/Coast Architect/Builder magazine), 1992

Reston Town Center, AIA Urban Design Award of Excellence, 1992

Reston Town Center, Citation, Maryland Society of Architects, 1991

Reston Town Center, Award of Excellence, Commercial Projects over \$40 million, DC Metropolitan and VA Chapters/Associated Builders and Contractors, 1991

Reston Town Center, Building of Excellence, Iron Workers Employers Association/DC, 1991

PUBLICATIONS AND PRESENTATIONS

Architecture, Facilities Design and Management, Hotels, McGraw-Hill Encyclopedia of Architecture, Nikkei Architecture, Specifying Engineer, Urban Land, Contract Design, The Washington Post, The Baltimore Sun

Juror, AIA National Awards, Spring 2002

PROFESSIONAL AFFILIATIONS

The American Institute of Architects

DAVID VERE THOMPSON FAIA, BSCP, LEED AP [SECURITY PLANNER]

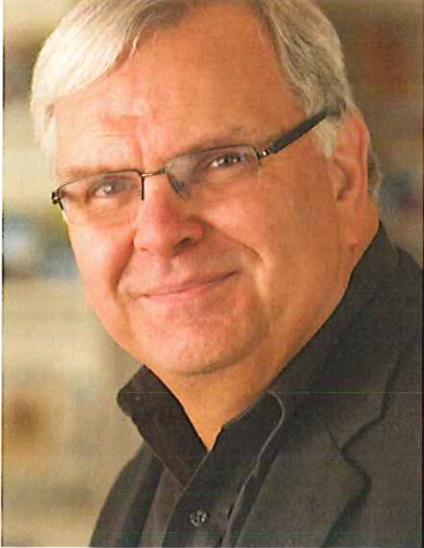

TITLE

Architect, Security Planner

INDUSTRY EXPERIENCE

36 Years

EDUCATION

Texas A&M University, Master of Architecture

Texas A&M University, Bachelors, Environmental Design

LICENSES AND CERTIFICATIONS

Registered Architect: MD, NC, PA, VA, NY, TX, VA, WV, DC

NCARB Certificate

LEED Accredited Professional

Building Security Certified

Professional (one of first 13)

Dave leads RTKL's Federal Practice studio. He has experience on a wide range of architectural and facility planning projects, with an emphasis on large-scale, advanced technology facilities, masterplanning, design, and project management. His personal focus has been in the design of facilities with significant technology and/or security requirements. Dave was selected by GSA as Principal Designer for the National Ground Intelligence Center awarded the Army Chief of Engineers Design Award for 2002. He was the 2002 recipient of the Max O. Urbahn Medal from the Society of American Military Engineers for Contributions to Architecture.

SELECT RTKL EXPERIENCE

National Geospatial-Intelligence Agency, New Campus East Director of the Joint Venture, 2.4 million-SF state-of-the-art intelligence community headquarters facility, new construction, Ft. Belvoir, VA

U.S. Capitol Visitor Center Principal-in-Charge, 580,000 SF underground facility addition, includes exhibition, reception, food service, office, theater and gift shop areas, Washington, DC

Herbert C. Hoover Building Perimeter Security 1,800,000-SF federal building, eight-phase renovation, construction administration services, Washington, DC

U.S. Army Judge Advocate General (JAG) School multi-building campus at University of Virginia, includes classrooms, auditorium and billeting, Charlottesville, VA

Perimeter Security Master Plan and Final Design, Capitol Square, Senate and House Office Buildings, Supreme Court and Library of Congress Washington, DC for the Architect of the Capitol

The Pentagon "The Phoenix Project" Executive Architect, 400,000-

SF Post 9/11 Reconstruction, RTKL was Coordinating Architect and Architect for the interior core and shell elements and roofs, Washington, DC

Threat & Vulnerability Assessment & Force Protection Master Plans and Security Standards classified government agency at over 30 locations: Agency facility security standards and criteria; Security master plan for a U.S. government classified agency; Security master plan for the Federal Executive Institute

National Ground Intelligence Center Principal-in-Charge, 258,000-SF headquarters and high technology laboratory facility, including office and support spaces, teleconference, conference and training facilities, and data center space, Charlottesville, VA (GSA Design Excellence Principal Designer) Winner of the 2002 Chief of Engineers Design Award.

National Ground Intelligence Center Expansion Principal-in-Charge, 64,000-SF Expansion and garage, Design-Build RFP documents and parametric study, Charlottesville, VA

Defense Threat Reduction Center Principal-in-Charge, 317,000-SF mission critical headquarters facility,

includes data center, SCIF areas and operations center, Fort Belvoir, VA.

Johns Hopkins University Applied Physics Laboratory Building

21 Principal-in-Charge, 263,000-SF, 5-story multi-purpose office and laboratory building, Laurel, MD

Johns Hopkins University Applied Physics Laboratory Building

17 Principal-in-Charge, 242,000-SF multipurpose office and laboratory facility, part of the development of a 360-acre quasi government research complex, Laurel, MD

Fort Stewart Secure Command & Control Center

Principal-in charge, 105,000-SF headquarters facility, includes SCIF, 100% raised access floor and redundant systems to meet mission critical requirements, Ft. Stewart, GA

Satellite Earth Terminal Station/ SATCOM Facility

Principal-in-Charge, 37,000 SF state-of-the-art satellite earth terminal communications facility, Ft. Detrick, MD

Joint Use Intelligence Analysis Facility

Principal-in-Charge, 170,400 SF Secure DOD Intelligence Center, includes a data center, auditorium, food service and analytical work space all within a SCIF environment, programming, design and preparation of Design-Build RFP documents, Charlottesville, VA

Joint Personnel Recovery Agency

Principal-in-Charge, 88,000-SF architectural feasibility study, includes administrative office space, SCIF, operations, training and support facilities in both new and renovated construction, Ft. Belvoir, VA

National Maritime Intelligence Center

Joint Venture Senior Designer, 600,000-SF high technology headquarters, Suitland, MD

National Maritime Intelligence Center

Principal-in-Charge, 200,000-SF multi-use office and command center expansion, Design-Build RFP documents, Suitland, MD

902nd Military Intelligence Group Headquarters

Principal-in-Charge, 419,000-SF facility, includes controlled access, SCIF, laboratories, staging facilities, and polygraph suites, Ft. Meade, MD

NAVFAC IDIQ

Vice President-in-Charge, task orders including planning programming, concept design, funding documentation, design review, construction period oversight, and documentation for RFPs, NAVFAC Washington District

PCAS Network Operations Center,

USMC Quantico Vice President-in-Charge, 40 KSF network command center, Quantico, VA

U.S. Army Corps of Engineers

Baltimore District IDIQ Vice President-in-Charge, 3 year, \$ 1 million per year contract, 9 tasks completed ranging from feasibility studies for new construction and renovation to design of a 67,000-SF archival facility, USACE Baltimore District

MASINT Data Center Studies

Principal-in-Charge, studies for a new generation of intelligence data mining repositories

AWARDS AND HONORS

Max O. Urbahn Award for contributions to architecture, Society of American Military Engineers, 2002

Outstanding Contributions to Architecture Award, Society of American Military Engineers, Washington Post, January 2003

PRESENTATIONS/ PUBLICATIONS

Author, 'Security Master Planning' Chapter 2 of "Building Security - Handbook for Architectural Planning and Design", Nadel, McGraw Hill, 2004

Speaker, "Architects Tools – An Architect Odyssey," The National Building Museum, 2005

Speaker, "Site Planning Considerations," AEI Building Security Symposium, 2005

Speaker, "A Mighty Fortress – Protective Planning & Design," AIA Design DC, 2005

Speaker, "National Ground Intelligence Center – A Case Study," AIA National Convention, 2003

Speaker, "Freedom to Shop," International Council of Shopping Center/ Center-Build Conference, 2002

Speaker, "Fundamentals of Force Protection Planning," Southern Gas Association National Conference, 2002

Speaker, "Making Secure Our Homeland," Construction Specifications Institute, 2002

Speaker, "Preparing for Threats to the Commercial Real Estate Industry," Panelist JHU/CREW Seminar, 2002

Speaker, "The US Capitol Visitor Center," D.C. Post Society of American Military Engineers, 2002

Panelist, "Freedom without Fortresses? – Shaping the New Secure Environment," National Building Museum, 2001

PROFESSIONAL AFFILIATIONS

American Institute of Architects
Society of American Military Engineers

MAXWELL A. STEVENS CPP, CSI CDT [TECHNICAL SECURITY]



Maxwell Stevens has 16 years of expertise in developing and integrating physical security system solutions and a strong background in systems design and electrical test engineering. He has proven leadership throughout the development spectrum, from initial system analysis and assessment, through testing and evaluation, to design, installation and integration of highly-effective security systems and superior customer support. Max's has extensive experience with CCTV video storage and transmission, smart card systems, door locking, electronic gates, barriers and bollards, duress systems, intercom systems, visitor management systems, wireless and hardwire systems design, site surveys, electrical testing, documentation and LAN/WAN protocols.

TITLE

Associate

INDUSTRY EXPERIENCE

16 Years

EDUCATION

Rensselaer Polytechnic Institute (RPI), Masters of Science, Systems Engineering

Northeastern University, Bachelor of Science, Electrical Engineering

LICENSES AND CERTIFICATIONS

Certified Protection Professional
Construction Document Technologist
DCJS Registered and Certified:
Virginia

Andover Controls, Certified System Designer

Lenel Systems, Certified systems designer

Notifier Certified Fire Alarm System Designer

Medeco Systems, Factory Trained
CT Class II Low Voltage Electrical
Contractors License: Connecticut

SELECT EXPERIENCE

U.S. Capitol Visitor Center 580,000 SF underground facility addition with exhibition, reception, food service, office, theater and gift shop areas, Washington, DC

National Geospatial-Intelligence Agency Programmer and Security Planner for the new construction of a 2.4 million SF \$1.2 billion headquarters that will allow the NGA to perform their critical functions in a state-of-the-art facility, designed to enable their technical, organizational and cultural transformations. Also responsible for the Design/Documentation of all of the Operation Centers, Ft. Belvoir, VA

Harriman State Office Building Campus designed IP-based CCTV, card and physical access system for highly secure site. System designed on the principle of the "concentric rings" which involves perimeter security, building exterior and interior space security. Systems are fully integrated with IP-based control and administration from any secure remote site, Albany, NY

Herbert C. Hoover Building Perimeter Security 1,800,000-SF federal building, eight-phase renovation, construction administration services, Washington, DC

Department of State: New Hires Program, Micro Program of Requirements for Bureau ECA and II 200,000 SF, Washington, DC
Department Of State, developed Program Of Requirements for CCTV surveillance, card access, vehicle access, visitor management, perimeter and intrusion and detection systems, Washington, DC

Department of Veterans Affairs – Las Vegas Medical Center 750,000 SF health care facility, systems include voice and data communications, broadband video distribution, security systems, and various patient monitoring systems, Las Vegas, NV

Ft Stewart Secure Command and Control Center Lead Designer - 105,000 GSF headquarters facility for the 3rd Infantry and the Garrison Command at Ft. Stewart, Hinesville, GA

Defense Threat Reduction Agency Lead Designer for a 330,000

GSF headquarters facility with 1,100-space parking structure, Fort Belvoir, VA

Highmark Data Center designed proprietary CCTV and access control system for data center utilizing local and remote system control and administration via network, Harrisburg, PA

Highmark Disaster Recovery Center Project Manager for a 30,000 GSF Disaster Recovery Center in an existing Office Facility, Camp Hill, PA

MPO Security Systems Design 260,000 SF office building modernization, Ft. Meade, MD

NAVFAC Washington A 5 year IDIQ contract to provide a full range of professional services ranging from planning studies and design reviews to complete planning and design services

NAVFAC Patuxent River Assessment / RFP site surveys and data collection in order to produce engineering assessments and renovation concepts for a 467500 SF facility, Patuxent River, MD

New York State Emergency Management Office 80,000SF mission critical office, microwave connectivity emergency operations center, 155 Mbps, OC3, high speed microwave backbone system, Albany, NY

Northwest Community Hospital security systems, in an eight-story, 78-bed patient care addition with Emergency Department expansion, Arlington Heights, IL

U.S. Naval Academy Preble Hall 48,000 SF interior renovation of historic 1939 museum building, Annapolis, MD

Singapore Embassy provided analysis and system design criteria for the complete security system at the Singaporean Embassy. New design incorporated biometric

readers and smart cards, hardening of facility with electronic barricades, integrating intrusion detection, CCTV and card access into a single security network that is scalable with remote administration, control and diagnostic capabilities, Washington, DC
St. Agnes Hospital Campus Revitalization campus revitalization project including 169,000 SF new bed tower addition, 74,000 SF renovation of a 3-level existing bed tower with 29,000 SF renovation/addition to cancer center and central plant, a 600 car parking garage, and various site improvements. Town & Country

The National Ground Intelligence Center – Nicholson Building Security Master Plan / Facility Upgrades, Security Planner for the security upgrades for an existing facility, Charlottesville, VA

U.S. Secret Service Indoor Firing Range and Training Facility Project Manager and senior telecommunications designer for the renovation of the facility. Design consisted of voice, data, and video for classrooms and conference rooms as well as office facilities, Beltsville, MD

University of Maryland University College designed CCTV and card access system for the data center including the secure Network Operation Center (NOC) utilizing dual technology card format, to be remotely controlled and administered remotely by the campus security department, Adelphi, MD

Veterans Benefits Administration (VBA), 1 Master plan and consolidation of 120,000 SF regional office, Los Angeles, CA; 2) New 42,000 SF build to suit regional office building, Des Moines, IA

PUBLICATIONS AND PRESENTATIONS

BICSI Electronic Safety and Security Manual Ver 2.0, 2009, Co-Authored

PROFESSIONAL AFFILIATIONS

American Society of Industrial Security
Construction Specification Institute

MATTHEW D. LOEFFLER PE

[STRUCTURAL ENGINEERING]



TITLE

Principal

INDUSTRY EXPERIENCE

25 Years

EDUCATION

The University of Texas, Master of Science in Architectural Engineering
Princeton University, Bachelor of Arts in Architecture and Design

LICENSES AND CERTIFICATIONS

Professional Engineer: DC, MD, NV, PA, SC, VA, UT
National Council of Examiners for Engineering and Surveying

Matt is Director of the Structural Engineering Group in RTKL's Washington office. He serves as a Project Manager, responsible for the performance and supervision of structural design and coordination for varying types of projects. Matt's experience encompasses the design of structural steel, conventionally reinforced and pre-stressed concrete buildings; and renovation of steel, concrete, timber and masonry structures.

SELECT EXPERIENCE

Capitol Hill Perimeter Security Project Manager, Washington, DC

United States Capitol Perimeter Security Project Manager, Washington, DC

United States Library of Congress Perimeter Security Project Manager, Washington, DC

United States Supreme Court Perimeter Security Project Manager, Washington, DC

Thurgood Marshall Building Perimeter Security Project Manager, Washington, DC

U.S. Embassy Project Engineer, Tokyo, Japan, Perimeter Access Control Study

U.S. Capitol Visitor Center Project Manager, Structural Design for 580,000 SF Underground Three Story Visitor Center, Washington, DC

Food and Drug Administration Southeast Parking Garage Project Manager, White Oak, MD

Food and Drug Administration Southeast Quadrant Office Buildings Project Manager, White Oak, MD

Food and Drug Administration North Parking Garage Project Manager, White Oak, MD

Food and Drug Administration CDRH Office Building Project Manager, White Oak, MD

Food and Drug Administration OC/ORA Office Building Complex, Project Manager, White Oak, MD

Food and Drug Administration Childcare Center Project Manager, White Oak, MD

Department of Veterans Affairs Hospital Parking Garage Design-Build Advisor to the DVA, Pittsburgh, PA

National Institutes of Health Central Core Infill and Renovation, Project Manager, Bethesda, MD

Army Training Center Renovation Project Manager, Location Confidential

Embassy of Brunei Structural Project Manager, 31,000-SF new embassy complex, Washington, DC

Embassy of Singapore Structural Project Manager, 55,000-SF embassy, security upgrade and interior renovation, Washington, DC

U.S. Embassy, Brunei Structural Project Manager, 11,200-SF new embassy compound, initial planning surveys and identification of impact to potential building sites Bandar Seri Begawan, Brunei

U.S. Embassy, The Netherlands Structural Engineer, 113,021-SF embassy, includes design for a chancery, marine barracks, and utility and maintenance buildings, The Hague, Netherlands

U.S. Consulate, Milan Structural Project Manager, 107,500-SF consulate complex, located on historic site, Milan, Italy

U. S. Embassy, Kampala structural project manager, 40,000-SF embassy, designed to meet stringent security standards, Kampala, Uganda

U.S. Embassy, Monrovia Structural Project Manager, 170,000-SF embassy, highly sustainable facility that generates its own electricity and water, Monrovia, Liberia

U.S. Embassy, Guayaquil Structural Project Manager, physical security upgrades for embassy complex, Guayaquil, Ecuador

U.S. Embassy, Casablanca Structural Project Manager, physical security upgrades for existing embassy, Casablanca, Morocco

U.S. Embassy, Kuwait Project Engineer, design for 10,000 SF residence, Bayan, Kuwait

U.S. Ambassador's Residence, Bangkok Staff Engineer, design for 15,000 SF residence, Bangkok, Thailand

U.S. Embassy, Tokyo Project Engineer, Tokyo, Japan, PAC Study

Fairfax County Government Center Staff Engineer, Fairfax County, VA

Department of Veterans Affairs Medical Center Staff Engineer, Baltimore, MD

Health Care Financing Administration Headquarters Staff Engineer, Structural Design for 900,000 SF Office Building Campus, Woodlawn, MD

Federal Government Lease Consolidation Study and Master Plan Project Engineer, metropolitan area, Washington, DC

Federal Government Task Order Contract Project Engineer, Washington, DC

U.S. Naval Academy- Bancroft Hall Renovation Senior Staff Engineer, Annapolis, MD

Social Security Administration Metro West Complex Project Engineer, Structural Design for the renovation of two-building, 1.3 million SF complex, including virtually total exterior skin replacement, Baltimore, MD

Department of Agriculture IDQ Contract Peer Review Services for USVL Greenhouse, Charleston, SC

Department of Veterans Affairs Cemetery Project Manager, Ft. Bliss, TX

Department of Veterans Affairs Cemetery Project Manager, Ft. Gibson, OK

Veterans Benefits Administration: RFP Development for Iowa and South Carolina facilities

PROFESSIONAL AFFILIATIONS

PROFESSIONAL AFFILIATIONS

American Concrete Institute

American Institute of Steel Construction

American Society of Civil Engineers

Council on Tall Buildings and Urban Habitat

Society of American Military Engineers

PUBLICATIONS AND PRESENTATIONS

"A Mighty Fortress: Protective Planning & Design", AIA DesignDC, Washington, DC 2005

"Warsaw Trade Tower", Modern Steel Construction, August 2001

"ASCE 7 Revised: New Emphasis on the Effect of the Building Form on Envelope Design for Wind Resistance", Felt Tips, April 1996

DENNIS PELTZ PE, LEED AP [MECHANICAL ENGINEERING & CBR]



TITLE

Vice President

INDUSTRY EXPERIENCE

30 Years

EDUCATION

Engineering Coursework, Johns Hopkins University

LICENSES AND CERTIFICATIONS

Professional Engineer: Maryland
LEED AP

Dennis Peltz is a Vice President and Co-Director for MEP Engineering and systems' commissioning. He offers a wealth of experience in mechanical engineering for a wide range of building types including educational, government, corporate, healthcare, retail, hospitality, high-tech data centers and mission critical projects. Dennis's experience, both at home and abroad, covers many project types that include adaptive renovations, as well as new facilities and range in size and complexity from multiple task orders to multi-million square foot facilities. He is accomplished in the design and evaluation of HVAC systems and controls as well as in CBR Mitigation. As a LEED accredited engineer, his enthusiasm for sustainable energy efficiency has piloted his work and has long influenced his advocacy for commissioning. These attributes strengthen his existing facilities evaluations and facilitate success in achieving today's enhanced energy performance goals.

SELECT EXPERIENCE

National Geospatial-Intelligence

Agency, New Campus East Vice President of MEP, 2.4 million SF state-of-the-art headquarters facility, new construction, Fort Belvoir, VA

Defense Threat Reduction Center Lead Engineer, 317,000 SF mission critical data center, includes SCIF areas and operations center, Fort Belvoir, VA

National Ground Intelligence

Center Lead Engineer, 258,000 SF new multi-use headquarters facility and high technology laboratory facility, Charlottesville, VA (GSA Design Excellence Principal Designer) Winner of the 2002 Chief of Engineers Design Award.

U.S. Capitol Visitor Center Lead Engineer, 580,000 SF visitor center designed to enhance visitor reception facilities and strengthen the building's security, Washington, DC

Fort Stewart Secure Command and

Control Center Lead Engineer, 105,000 SF new headquarters facility, includes SCIF, 100% raised access floor and redundant systems to meet mission critical requirements, Ft. Stewart, GA

Food and Drug Administration

Headquarters Lead Engineer, 2.3 million SF government agency headquarters consolidation, White Oak, MD

U.S. Ambassador's Residence Vice President of MEP and Lead Engineer, 10,000 SF residence, Bayan, Kuwait

U.S. Ambassador's Residence Vice President of MEP and Lead Engineer, 15,000 SF residence, Bangkok, Thailand

U.S. Ambassador's Residence Vice President of MEP and Lead Engineer, Tokyo, Japan

American Red Cross Vice President of MEP and Lead Engineer, 130,000 SF three-building headquarters complex, programming and master plan, Washington, DC

National Ground Intelligence Center Vice President of MEP and Lead Engineer, 258,000 SF new multi-use headquarters facility and high technology laboratory facility, Charlottesville, VA

Federal Bureau of Investigation, J Edgar Hoover Building Vice President of MEP and Lead Engineer, MEP engineering design for computer center, Washington, DC

Federal Bureau of Investigation, Quantico, Building 10 Vice President of MEP and Lead Engineer, MEP engineering design, Quantico, VA

Federal Bureau of Investigation, Quantico, HRT Facility Vice President of MEP and Lead Engineer, MEP engineering design, Quantico, VA

Embassy of the Republic of Singapore Vice President of MEP and Lead Engineer, 25,000 SF systems renovation design, Washington, DC

Adelphi Army Research Laboratory Center Vice President of MEP and Lead Engineer, 1 million SF, engineered the Central Plan and Distribution Systems required for expansion of 3,000 tons to the existing 4,200-ton. New chillers and boilers and primary/secondary pumping arrangements have been engineered, Adelphi, MD

General Services Administration Vice President of MEP and Lead Engineer, Post Occupancy Evaluations: Federal Courthouse, Baton Rouge, LA; Border Station Complex, Otay Mesa, CA; and Border Station, International Falls, MN

Classified Agency Vice President of MEP and Lead Engineer, Due Diligence Reports, Tech Center Facility, Plaza A & B Facility and The Page Facility, Classified

Classified Agency Vice President of MEP and Lead Engineer, Facility Survey, Classified location

Institute For Defense Analysis Vice President of MEP and Lead Engineer, existing facilities evaluation, Alexandria VA

U.S. Environmental Protection Agency Headquarters Vice President of MEP and Lead Engineer, 1.2 million SF federal office complex renovation, Washington, DC

Federal Correctional Institution Vice President of MEP and Lead Engineer, MEP engineering design for medium and minimum security prison, Cumberland, MD

Social Security Administration, Metro West Complex Vice President of MEP, 1.3 million SF, two-building campus renovation, Baltimore, MD

AWARDS AND HONORS

Outstanding Contributions to Technology or to the Engineering Profession, Society of Military Engineers, 2010

National Ground Intelligence Center, Chief of Engineers Award of Excellence – Design, US Army Corps of Engineers, 2002

PUBLICATIONS AND PRESENTATIONS

“Design Excellence in HVAC Design for Federal Buildings,” General Services Administration, Denver, CO and Washington, DC, September and October 1998

“Systems Commissioning – What Is It? And Why Do We Need It?” University of Virginia, Charlottesville, VA, January 1997

PROFESSIONAL AFFILIATIONS

Society of American Military Engineers
DC Building Industry Association

DAVID P. LABUSKES RCDD, NTS, OSP, CTS, CPHIMS [TELECOMMUNICATIONS]



David is a seasoned professional with over 20 years of experience in information technology, systems analysis, Information Technology (IT) project management and consultation, structured cable and network development design. David applies his varied background as an IT and business executive and design professional on public and private sector projects that require the elegant and economically rational integration of technology. David participates as Chairman of the BICSI TI&M Committee, which is responsible for the authorship of all of BICSI's reference documentation. These manuals and reference material serve as the fundamental tool used by all low-voltage designers both in the United States and abroad.

TITLE

Vice President

INDUSTRY EXPERIENCE

22 Years

EDUCATION

Pennsylvania State University,
Bachelor, International Politics

LICENSES AND CERTIFICATIONS

Certified Technology Specialist –
Design

Cisco Certified Network Associate
Outside Plant Specialist

Certified Professional in Healthcare
Information and Management
Systems

SELECT EXPERIENCE

National Geospatial-Intelligence Agency Vice President Technology Design, 2.4 million-SF state-of-the-art intelligence community headquarters facility, new construction, Ft. Belvoir, VA

U.S. Capitol Visitor Center Vice President Technology Design and Lead Designer, 588,000-SF visitor center designed to enhance visitor reception facilities and strengthen the building's security, Washington, DC

U.S. Capitol Building Vice President Technology Design and Lead Designer, information technology and interface design, Washington, DC

U.S. Embassy Kampala Vice President Technology Design, 40,000-SF government office building designed to meet stringent security standards, Kampala, Uganda

National Ground Intelligence Center Security Improvements Lead Telecommunications Designer, 363,000-SF facility, includes the construction of a Sensitive Compartmented Information Facility (SCIF) addition,

multi-level parking structure and temporary parking, information processing facility, specialized operations space, training rooms, conference building service and support spaces, Charlottesville, VA

Defense Threat Reduction Center Vice President Technology Design and Lead Designer, mission critical headquarters facility, includes data center, SCIF areas and operations center e, Fort Belvoir, VA

National Ground Intelligence Center Lead Telecommunications Designer, 258,000-SF headquarters and high technology laboratory facility, including office and support spaces, teleconference, conference and training facilities, and data center space, Charlottesville, VA

PUBLICATIONS AND PRESENTATIONS

Author, Wireless Design Reference Manual, 1st Edition, January 2004

Author, Network Design Reference Manual, 5th Edition, January 2002

Author, BICSI Telecommunications Dictionary, 2nd Edition, January 2001

AIMEE WOODALL AIA, LEED AP [HISTORIC PRESERVATION]



Aimee's knowledge of historic preservation and sustainable design has proven useful on many public sector projects in the Washington, DC area. She is active in the historic preservation and sustainable design communities of Washington, DC, including the local chapters of both APT & USGBC, and has spoken at local and national conferences on the topics. Aimee joined RTKL's historic preservation studio on July of 2000, after graduating with a Master of Architecture and Certificate in Historic Preservation from Texas A&M University. Prior to her professional career, Aimee gained three years of experience in historic documentation projects, as well as teaching experience at the second-, third-, and fourth-year levels of undergraduate design studios.

TITLE

Associate

INDUSTRY EXPERIENCE

11 Years

EDUCATION

Texas A&M University, Master of Architecture

Texas A&M University, Bachelor of Environmental Design, Magna Cum Laude

LICENSES AND CERTIFICATIONS

Registered Architect: MD

LEED AP

Construction Documents Technologist (CSI)

PROFESSIONAL AFFILIATIONS

American Institute of Architects, Member, July 2000

Professional Fellow, Historic Resources Imaging Laboratory, Texas A&M University

Association for Preservation Technology, DC Chapter

National Trust for Historic Preservation

SELECT EXPERIENCE

U.S. Capitol Visitor Center Staff Architect, 580,000-SF underground visitor center facility. Tasks included Olmsted preservation at East Plaza & interface design at East front of United States Capitol, Washington, DC

Herbert C. Hoover Building Perimeter Security 1,800,000-SF federal building, eight-phase renovation, construction administration services, Washington, DC

U.S. Naval Academy Preble Hall Architect, 50,000 SF museum, modernization and restoration, Annapolis, MD

U.S. Naval Academy King Hall Restoration Architect, 63,000-SF dining hall, seats 4,300 midshipmen that sits in the heart of the United States Naval Academy, Annapolis, MD

U.S. Naval Academy (Phase 9) Bancroft Hall Architect, 1.4 million-SF naval facility modernization and restoration, includes dormitories, administrative offices, retail, and historic Memorial Hall, Annapolis, MD

Naval Observatory Project Architect and historic preservationist, 10-year master plan to establish program and goals for the Vice President's residence, Washington, DC

Webster School Preservation Architect, 28,000-SF historic school, building preservation plan, includes re-use recommendations for the century-old school building, Washington, DC

U.S. Secret Service Wilkie Building Architect, 41,000-SF training facility, includes space for weapons distribution, weapons library, armory, indoor firing ranges, training rooms, and staff offices, Beltsville, MD

National Security Administration Architect, renovation and tenant fit out, Ft. Meade, MD

Army Navy Country Club Project Architect for clubhouse master plan, Arlington, VA

Ariel Rios Federal Building (Phase II) Architect, 500,000-SF federal office building, modernization, preservation, conservation, and tenant fit-out of 1930's building, Washington, DC

BRIAN E. CORNELL LEED AP, ASSOCIATE AIA, ASLA, CSI [LANDSCAPE ARCHITECT]



TITLE

Associate

INDUSTRY EXPERIENCE

17 Years

EDUCATION

Pennsylvania State University,
Bachelor, Landscape Architecture

LICENSES AND CERTIFICATIONS

Registered Landscape Architect: DE,
MD, VA
LEED AP

Brian Cornell is a licensed landscape architect with over twenty-years of experience in landscape design and construction. His background in landscape design includes program development, site analysis and selection, schematic and design development, construction documentation and construction administration. Brian has extensive experience in green roof design and implementation, tree preservation, large tree transplanting, and construction practices. In addition, he also has expertise in the implementation of urban streetscapes and plazas and physical perimeter security systems.

SELECT EXPERIENCE

Capitol Hill Perimeter Security Master Plan Landscape Architect, perimeter security evaluation, includes the design of several structures and the re-design of the East Plaza to accommodate visitors, Washington, DC

Herbert C. Hoover Building Perimeter Security 1,800,000-SF federal building, eight-phase renovation, construction administration services, Washington, DC

Capitol Square Planting Project Manager, physical security improvements on the Capitol Building Grounds, includes landscape architectural concept, schematic, and construction documents and construction administration, Washington, DC, United States

Department of State Overseas Buildings Operations - Milan, Italy Landscape Architect, 107,500-SF consulate complex, located on historic site, Milan, Italy

Department of State, Overseas Buildings Operations - Baku, Azerbaijan Landscape Architect, embassy, initial planning surveys and local infrastructure study, Baku, Azerbaijan

Department of State, Overseas Buildings Operations - Bandar Seri Begawan, Brunei Darussalam Landscape Architect, 11,200-SF new embassy compound, initial planning surveys and identification of impact to potential building sites, Bandar Seri Begawan, Brunei Darussalam

Department of State, Overseas Buildings Operations - Casablanca, Morocco Landscape Architect, 10,000-SF consulate, engineering survey and security evaluation, Casablanca, Morocco

Department of State, Overseas Buildings Operations - Dakar, Senegal Landscape Architect, new embassy compound, due diligence assessments and site plan development, Dakar, Senegal

Department of State, Overseas Buildings Operations - Guayaquil, Ecuador Landscape Architect, 50,000-SF US Consulate compound, office and security building renovations, Guayaquil, Ecuador

Department of State, Overseas Buildings Operations - Kampala, Uganda Landscape Architect, 40,000-SF embassy, designed to meet stringent security standards, Kampala, Uganda

Department of State, Overseas Buildings Operations - Monrovia, Liberia Landscape Architect, 170,000-SF embassy compound, highly sustainable facility that generates its own electricity and water, includes 100,000 SF of security and support buildings, Monrovia, Liberia

Embassy of Ethiopia Landscape Architect, 28,000-SF embassy, includes offices, parking, and ceremonial space for diplomatic functions, Washington, DC

Food and Drug

Administration Headquarters

Consolidation Landscape Architect, 2,300,000-SF headquarters campus, includes over a dozen new buildings comprised of office, laboratory, training and conference space, Silver Spring, MD

Food and Drug Administration Office of Commissioner Office of Regulatory Affairs Landscape Architect, 420,000-SF office building, includes FDA campus' main cafeteria, multi-use conference rooms and 24-7 command center, designed to LEED Gold standards, Silver Spring, MD

Food and Drug Administration, Center for Devices and Radiological Health Landscape Architect, 387,655-SF office building, designed to LEED Gold standards, Silver Spring, MD

Food and Drug Administration, Center for Drug Evaluation and Research I Landscape Architect, 550,000-SF office, designed to LEED standards, Silver Spring, MD

Food and Drug Administration, Center for Drug Evaluation and Research II Landscape Architect, 300,000-SF office building, includes conference facilities, Silver Spring, MD

Fort Stewart Secure Command and Control Center Landscape Architect, 105,000-SF headquarters, includes

SCIF, 100% raised access floor and redundant systems to meet mission critical requirements, Fort Stewart, GA

Lincoln Memorial Reflecting Pool Project Manager, 70.0-AC historic renovation and preservation, includes repair of the structural damage, replacement of water source and discharge infrastructure, integration of new and handicap accessible pedestrian walkways, integration of perimeter security system, and refurbishment and relocation of site furnishings, Washington, DC

National Ground Intelligence

Center Landscape Architect, 258,000-SF headquarters and high technology laboratory facility, includes office and support spaces, teleconference, conference and training facilities, and data center space, Charlottesville, VA

National Ground Intelligence Center Expansion Landscape Architect, 64,000-SF facility, includes the construction of SCIF addition, multi-level parking structure, specialized operations space, training rooms, conference and support space, Charlottesville, VA

Repair and Alteration of the Social Security Administration Metro West Complex Landscape Architect, 1,300,000-SF campus renovations, two-buildings, includes extensive office and training space, daycare, cafeteria and computer room facilities, Baltimore, MD

U.S. Capitol Visitor Center Landscape Architect, 580,000-SF underground visitor reception facility, designed to strengthen the building's security, includes exhibition, reception, food service, office, theater and gift shop areas, Washington, DC

U.S. Department of State Overseas Buildings Operations IDIQ, Landscape Architect, 5-year IDIQ contract for various DOS facilities, including Long

Range Facility Plans, Super Small Embassy Prototypes and design of embassies worldwide, Arlington, VA

PROFESSIONAL AFFILIATIONS

American Institute of Architects - Associate Member
American Society of Landscape Architects

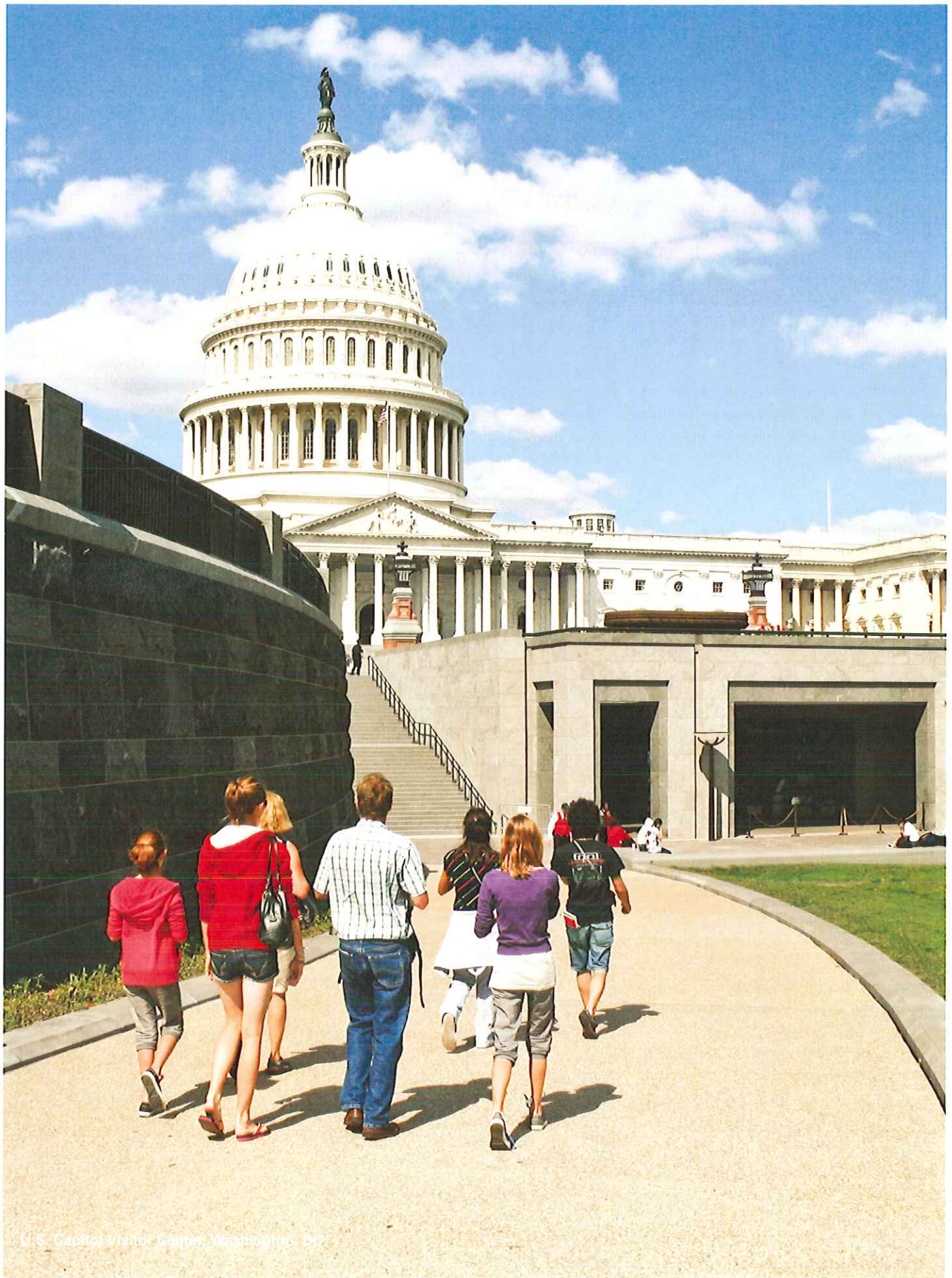

U.S. Capitol Visitor Center, Washington, DC

[FIRM/TEAM QUALIFICATIONS]

HISTORY OF LITIGATION

Provide a description of any litigation or arbitration proceedings, including vendor complaints files with the State's Purchasing Division, disputes with other Agencies of the State of West Virginia that involved legal representation by either party relating to the firm's delivery of design services, if applicable. Also, any disputes with other Agencies of the State of West Virginia that involved legal representation by either party.

RTKL Associates Inc. does not have and has not had any litigation or arbitration proceedings, including vendor complaints files with the State's Purchasing Division, disputes with other Agencies of the State of West Virginia that involved legal representation relating to the firm's delivery of design services. Also, RTKL Associates Inc. does not have and has not had any disputes with other Agencies of the State of West Virginia that involved legal representation by either party.

FIRM'S ABILITY

RTKL is currently operating under a moderate and manageable workload with a number of major projects in various stages of development and completion. Managing the firm's capacity is one of the most important responsibilities of senior leadership, ensuring that the firm's formidable resources are allocated appropriately and quality is never compromised.

We know that the future of our organization is solely dependent on the satisfaction of our clients. RTKL cannot afford to provide anything short of excellent service to State of West Virginia - Department of Administration. You have our total commitment.

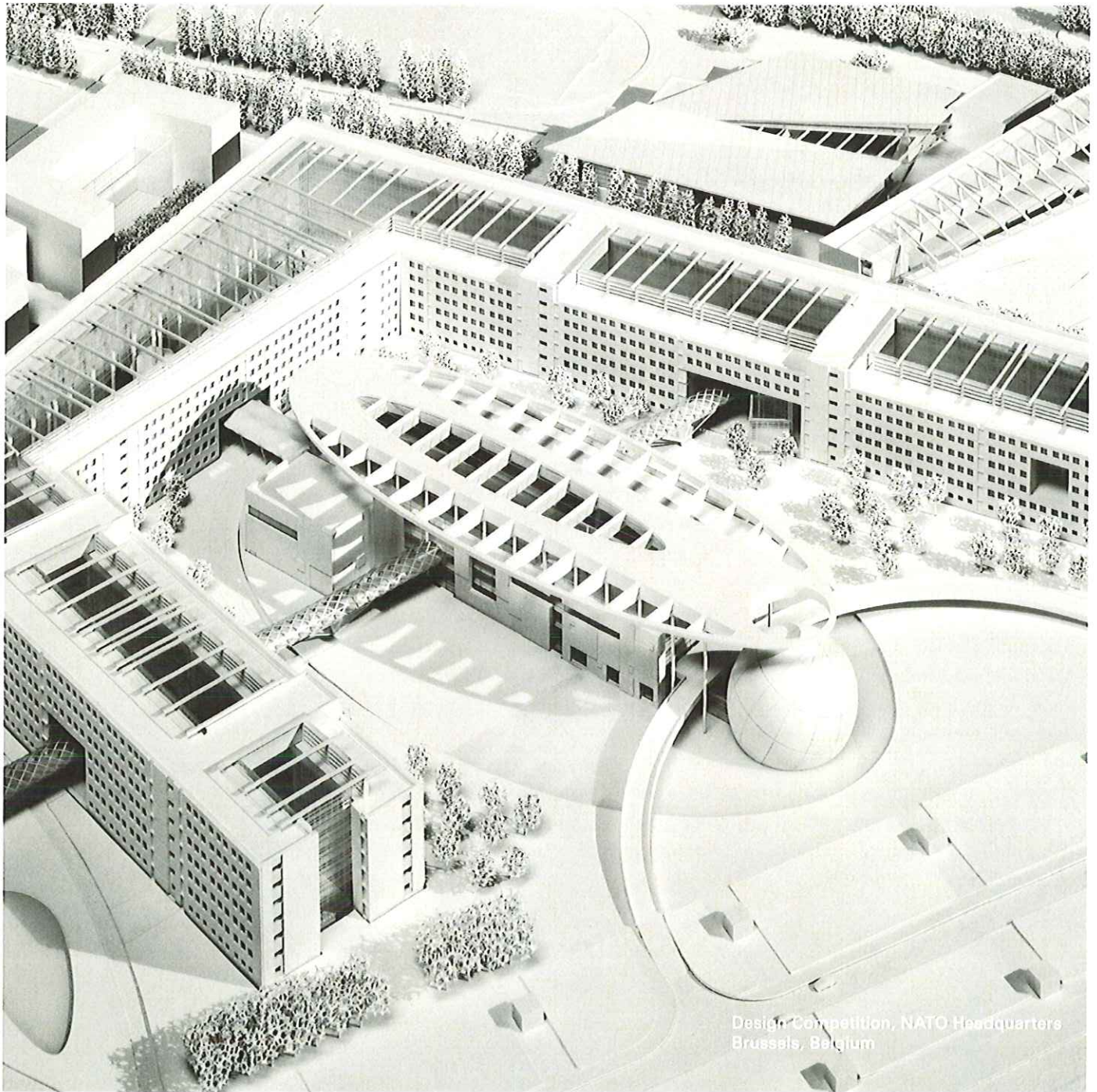

Design Competition, NATO Headquarters
Brussels, Belgium

CONSULTANTS

RTKL has extensive experience with many of the best consultants in the industry and therefore, we know the consultants that can deliver. We know that past working relationships are important to our clients and seek to assemble teams that enjoy working together to deliver exceptional projects.

COST ESTIMATOR - PAUL WADDELOVE ASSOCIATES

Paul Waddelove has worked as an owner's representative and cost consultant in the Washington metropolitan area since 1973. He received a professional registration from the Royal Institution of Chartered Surveyors, London, England, and he is a member of the American Association of Cost Engineers. Over the course of his career, Mr. Waddelove has worked on over 15 million square feet of office buildings, government office buildings and facilities. Paul Waddelove and RTKL have worked together on several projects including the National Ground Intelligence Center and the Defense Threat Reduction Center.

TRAFFIC PLANNING - STREET TRAFFIC STUDIES LTD.

Street Traffic Studies Ltd. provides the transportation planning and traffic engineering input required for the preparation and evaluation of land use proposals. Street Traffic Studies and RTKL have worked together on several projects including Capitol Hill Perimeter Security Projects, Food and Drug Administration Perimeter Security and the Johns Hopkins University Applied Physics Laboratory Site Development Master Plan.

CIVIL - GREENHORNE & O'MARA

Greenhorne & O'Mara (G&O) provides a full range of consulting and design services for both public and private sector clients. Our principal services include planning, engineering, landscape architecture, and geospatial services. Our experienced project teams provide services for every stage of a project from concept through construction. We are committed to our clients and communities and have a long history of providing innovative approaches for sustainable and responsible growth. Greenhorne & O'Mara and RTKL have worked together on several projects including the U.S. Capitol Visitor Center.

BLAST & AT/FP - WEIDLINGER ASSOCIATES

Weidlinger Associates is a renowned civil/structural engineering firm specializing in buildings, bridges, infrastructure, applied science, security, and investigations. With a staff of more than 295, the firm has seven U.S. offices and an office in the United Kingdom. An American Institute of Architects Honor Award cited Weidlinger for being at the "leading edge of structural design for more than thirty years." Weidlinger Associates and RTKL have worked together on several projects including Capitol Hill Perimeter Security Projects.

PROJECT ORGANIZATION



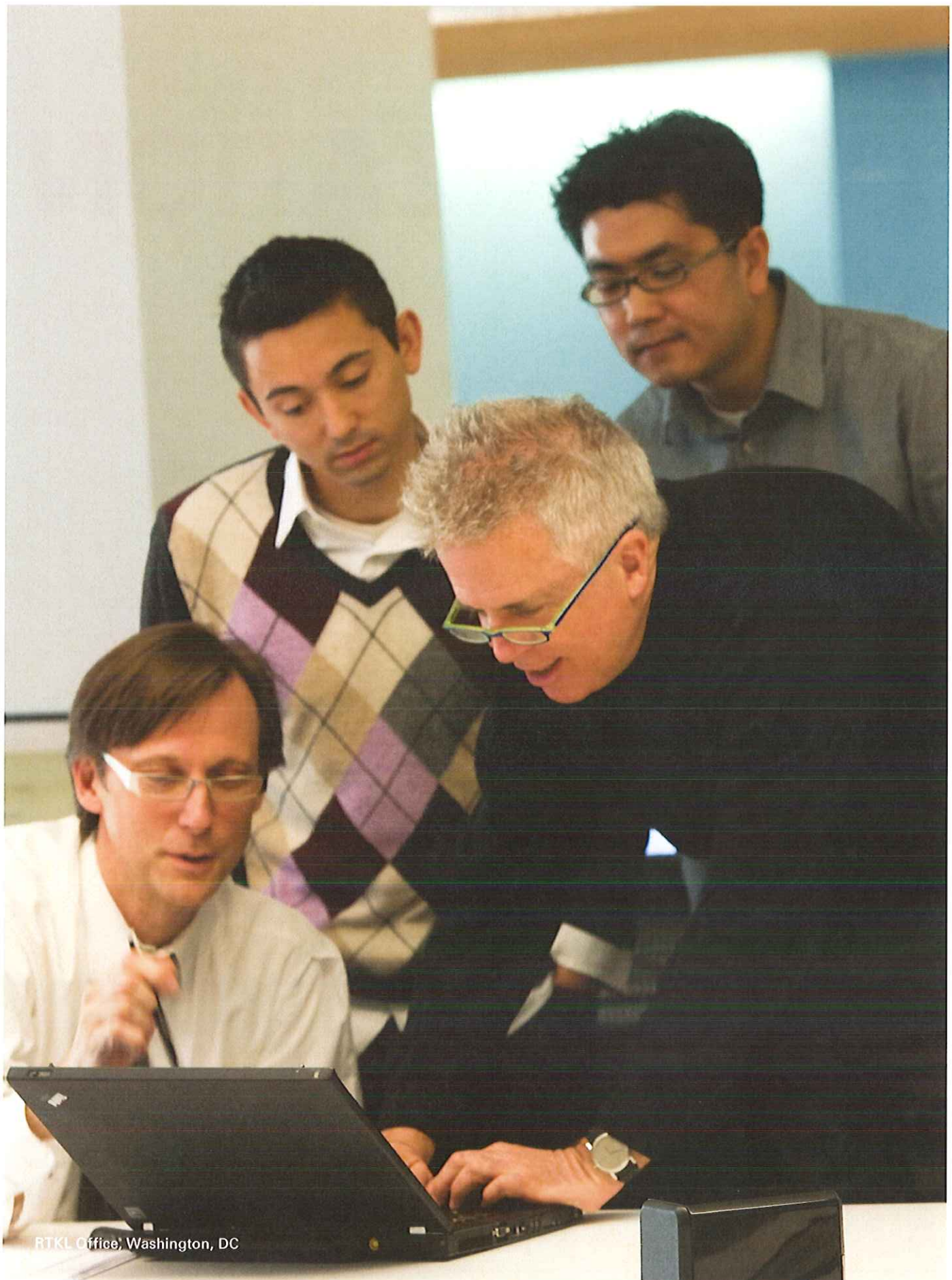

RTKL Office, Washington, DC

ORGANIZATIONAL CHART

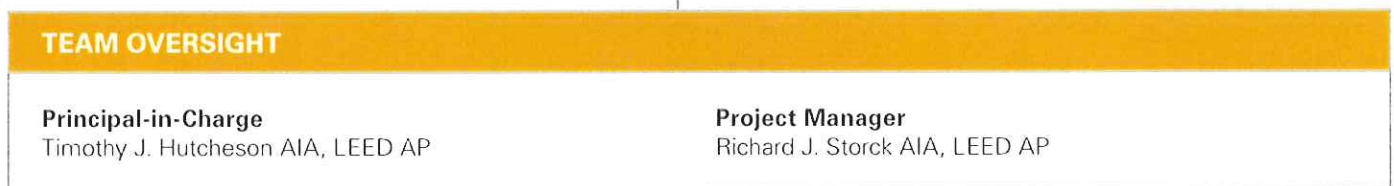

RELEVANT EXPERIENCE



ARCHITECT OF THE CAPITOL PERIMETER SECURITY PROJECTS

[WASHINGTON, DC]

RTKL PREPARED A MASTER PLAN FOR PERIMETER SECURITY ENHANCEMENTS FOR FACILITIES ON CAPITOL HILL UNDER THE JURISDICTION OF THE ARCHITECT OF THE CAPITOL RESULTING IN TEMPORARY ENHANCEMENTS IN THE 1990-95 TIMEFRAME.

Beginning in 1998 RTKL designed permanent perimeter solutions for Capitol Square, the House and Senate Office Buildings, Library of Congress buildings and the Supreme Court as individual projects either designed through full plans and specs or as design-build request for proposal packages. All have been completed.



Client
Architect of the Capitol

Size
Varies by location

Services
Architecture, Security Planning

U.S. CAPITOL VISITOR CENTER [WASHINGTON, DC]

ACCOMMODATING 4,500 VISITORS AWAITING ENTRY TO THE U.S. CAPITOL, THE CVC FUNCTIONS EFFECTIVELY FOR SECURITY PURPOSES AND PROVIDES EDUCATIONAL RESOURCES FOR VISITORS IN A SETTING BEFITTING ONE OF WORLD'S MOST MEMORABLE STRUCTURES.

In addition, the facility provides office and hearing space for the House and Senate and facilities for the U.S. Capitol Police.

With knowledge garnered from a dozen years of work with the Architect of the Capitol, RTKL designed a facility that enhances the visitor reception experience and strengthens building security while preserving an atmosphere of free public access for the more than three million visitors who tour the Capitol annually.

Working with the U.S. Capitol Police and House and Senate Sergeants at Arms, RTKL conducted a full spectrum threat and vulnerability assessment and developed a security master plan for both the Visitor Center and the perimeter of Capitol Square and other surrounding facilities under the purview of the AoC.

Client

Architect of the Capitol

Size

580,000 SF

Services

Architecture, Interior Design, Structural Engineering, MEP Engineering, Electronic Security, Telecommunications, Audiovisual Design, Environmental Graphic Design, Landscape Architecture, Historic Preservation

Reference

Stephen Ayers, Acting Architect of the Capitol & Deputy Architect
Office of the Architect of the Capitol
Washington, DC 20515
T 202.224.3536
E sayers@aoc.gov





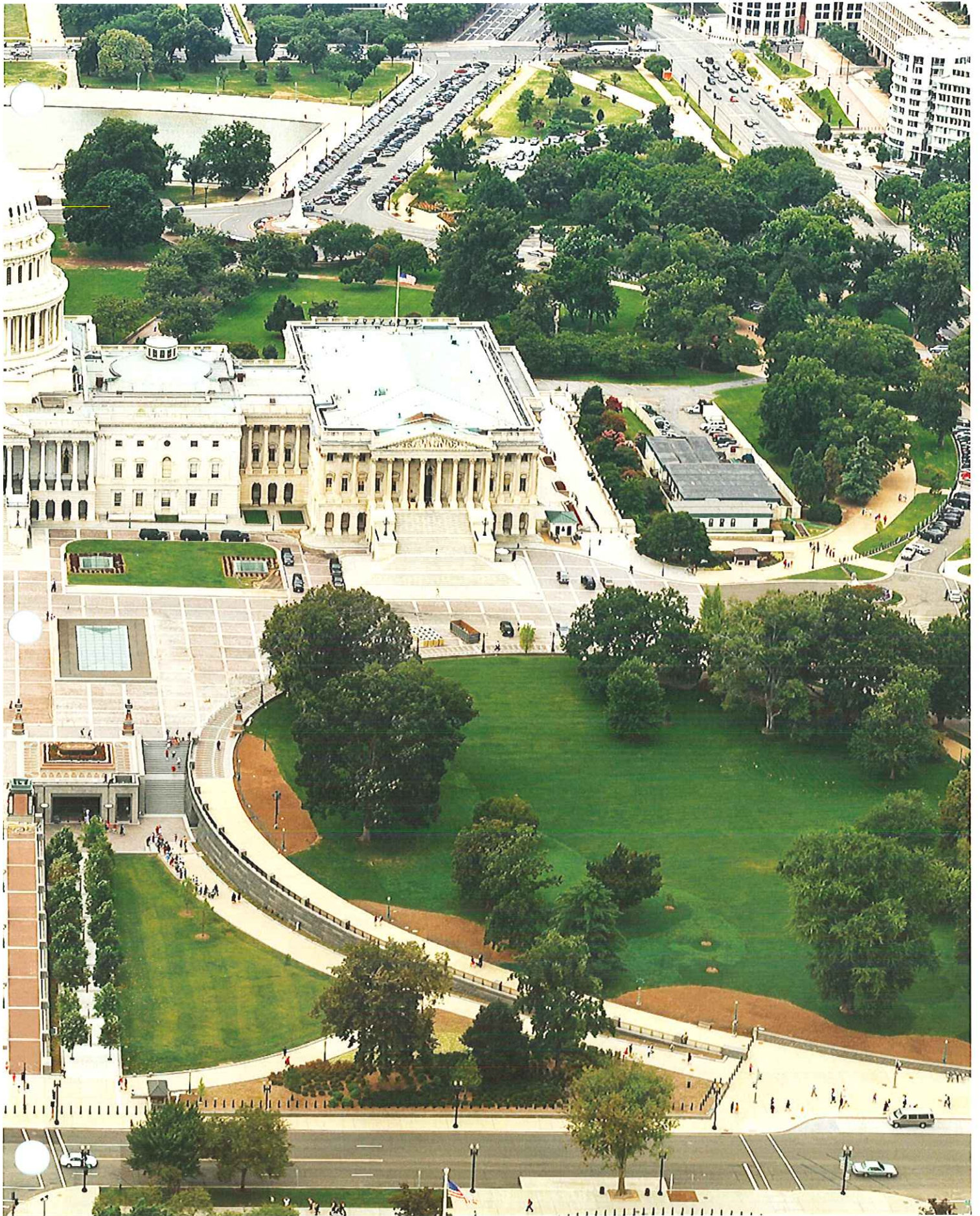



FOOD AND DRUG ADMINISTRATION [SILVER SPRING, MARYLAND]

UNTIL RECENTLY, THE U.S. FOOD AND DRUG ADMINISTRATION OPERATED FROM 40 BUILDINGS IN 18 LOCATIONS THROUGHOUT THE WASHINGTON DC METROPOLITAN AREA.

In 1996 as part of GSA's Design Excellence program, RTKL was selected in collaboration with KlingStubbins to design the agency's new headquarters, consolidating its 9,000 employees on a 130-acre campus on the historic site of the Naval Surface Warfare Center. The resulting 2 million-SF development is being completed in phases, with final completion anticipated for 2014.

Challenged to improve overall space utilization and encourage more interaction among the FDA's core divisions, the design team created a master plan that follows the tenets of great university campuses, where buildings define a series of public courtyards and pedestrian spaces. The master plan is organized around a central lawn, with the placement and

design of the buildings reinforcing FDA's mission of enhancing cross-disciplinary collaboration while also respecting the private and confidential nature of the organization's work. The campus is more than 66% complete and features several LEED certified buildings.

Client

General Services Administration

Size

2.3 million SF

Services

Masterplanning, Architecture, MEP Engineering, Structural Engineering, Interior Architecture and Design, Environmental Graphics, Pre-Design Services

Reference

Shapour Ebadi
Deputy Regional Commissioner
General Services Administration
10903 New Hampshire Ave.
Silver Spring, MD 20903
T 202.302.4672
E shapour.ebadi@gsa.gov

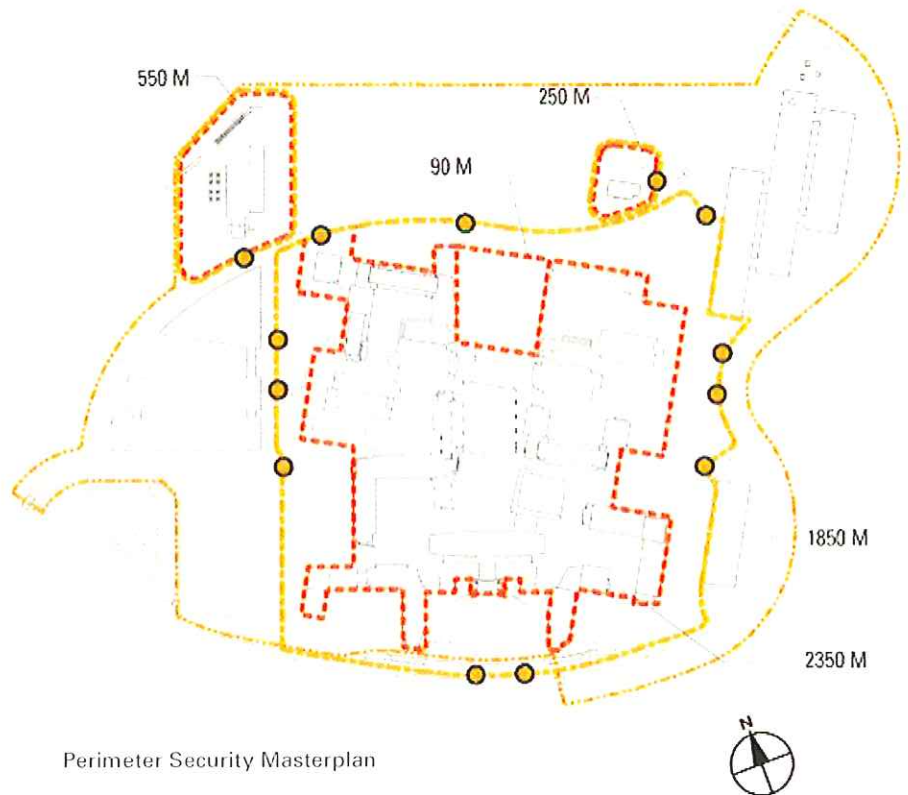

Perimeter Security Masterplan

THURGOOD MARSHALL PERIMETER SECURITY [WASHINGTON, DC]

FOLLOWING OUR WORK ON CAPITOL HILL, RTKL WAS COMMISSIONED BY THE FEDERAL JUDICIARY TO PREPARE A PERIMETER SECURITY SOLUTION FOR THE THURGOOD MARSHALL FEDERAL JUDICIARY BUILDING ADJACENT TO UNION STATION IN WASHINGTON.

This project involved subsurface investigation, vehicular control, phased implementation and coordination with the District of Columbia and the National Capitol Planning Commission (NCPC).

CLASSIFIED AGENCY EXTERNAL BUILDING SECURITY STUDY [MULTIPLE CLASSIFIED LOCATIONS]

RTKL INVESTIGATED EXTERNAL SITES TO DETERMINE THEIR EXISTING SECURITY STATUS AND THEIR FUTURE SECURITY POTENTIAL.

The individual sites were a variety of sizes, populations and functions; the interrelation of several posed unique circumstances.

This study additionally incorporated various levels of facility evaluations to determine additional usefulness and condition related to the building systems, and overall architectural condition. Infrastructures were analyzed to best understand points of failure and redundancy concerns. The result of this study was to develop a comprehensive Master Plan strategy for the facilities in sum which included leasing criteria, new facilities and phasing out deficient facilities.

RTKL initiated a site survey and conducted interviews with client representatives, security personnel and facility managers at each of the sites. RTKL utilized the various facility based threat requirement and generated a Vulnerability Assessment. The study identified points of potential conflict and outlined site development solutions which projected structured and surface parking, infrastructure enhancements, and new buildings which would become necessary to meet the determined threat requirements.

Traffic analyses were performed for the internal circulation, loading docks, and vehicular entries. Security operations

and vetting procedures were discussed to determine response capabilities and the effect that vehicle vetting would have on the surrounding road networks. The perimeters were analyzed to best determine the hardening, fencing, alarming, and camera requirements.

Weidlinger Associates performed blast analyses and integrated the results to determine stand-off requirements and building upgrades which would apply to structural systems and building exteriors. Cost estimates and construction schedules were developed along with logistical concerns and assimilated in a comprehensive final master plan.

Client

Confidential

Size

Multiple Confidential Locations

Services

Security Planning



NATIONAL GEOSPATIAL- INTELLIGENCE AGENCY, NEW CAMPUS EAST [FORT BELVOIR, VIRGINIA]

A JOINT VENTURE OF RTKL AND KLING STUBBINS HAS COMPLETED THE MASTER PLANNING AND DESIGN FOR THE NEW EAST COAST HEADQUARTERS OF THE NATIONAL GEOSPATIAL-INTELLIGENCE AGENCY.

The project allows the NGA to perform their critical functions in a state-of-the-art facility designed to enable their technical, organizational and cultural transformations. The consolidation of the six NGA locations is a stipulation of the 2005 Base Realignment and Closure (BRAC) process, and also a reflection of changes in the NGA's mission, which has become more centralized with changing systems technology and security needs. The new facility includes 24/7 operations centers and a data center. It also houses administrative space; a technology center; support and storage space; an auditorium and conference center; NGA college; a central utility plant and a parking structure for 5,100 vehicles.

This project is designed to meet specific threats across the multi-threat environment. Approximately 85% of the facility is designed to be accredited as SCIF. The site has a fenced outer installation perimeter and a fenced hardened inner perimeter a minimum of 476 feet from occupied facilities. A remote inspection facility (RIF) will inspect all oversized vehicles while all visitors will be screened in the visitor control center (VCC) outside the fence, 3 multi-lane vehicular access control points screen all badged vehicles at the fence line and include active K12 barriers, sensors and over-watch positions. Visitor parking is provided in a surface lot outside the fence line. An employee parking structure and all

roads/drop-off areas are a minimum of 82 feet from the buildings. All buildings have been designed to meet specific high threat requirements against explosive devices. Portions of the complex are ballistically hardened. TEMPEST hardening is included. A primary and secondary security command center (SCC) are provided including armory. Access control, CCTV, and various sensor technologies are employed throughout the site and buildings.

Client

National Geospatial-Intelligence Agency

Size

2,418,000 SF, 130 Acres

Cost

\$1.7 Billion

Services

Architecture, Interior Architecture and Design, MEP Engineering, Telecommunications, Acoustics, Audio-Visual, Structural Engineering

Reference

Thomas Bukoski, Deputy Director, Facilities Programs

National Geospatial-Intelligence Agency
Fort Belvoir, VA 22060

T 571.557.1803

E Thomas.J.Bukoski@nga.mil



CLASSIFIED AGENCY MAIN HEADQUARTERS COMPOUND [CLASSIFIED LOCATION]

AFTER A THOROUGH INVESTIGATION, INCLUDING CLIENT INTERVIEWS, VULNERABILITY ASSESSMENTS AND SITE SURVEYS, RTKL DEVELOPED CRITERIA TO BEST REPRESENT THE THREATS AND MINIMUMS REQUIREMENTS APPLIED TO THE AGENCY.

RTKL investigated existing campus master plans to identify points of potential conflict and outlined site development solutions which projected future structured and surface parking, infrastructure enhancements, and new buildings which would become necessary to meet the determined threat requirements.

Campus infrastructure was analyzed to understand points of failure and redundancy concerns. Traffic analyses

were performed for the internal circulation, loading docks, and vehicular entries. Security operations and vetting procedures were discussed to determine response capabilities and the effect that vehicle vetting would have on the surrounding road networks. The Perimeter was analyzed to best determine the hardening, fencing, alarming, and camera requirements. Blast analyses were performed by Weidlinger Associates and were integrated to determine stand-off

requirements and building upgrades which would apply to structural systems and building exterior. Cost estimates and construction schedules were developed along with logistical concerns and assimilated in a comprehensive final master plan.

Client

Classified Government Agency

Size

Varies by location

Services

Development of Security Criteria, Site Survey, Threat Assessment, Vulnerability Assessment, Blast Analysis, Force Protection Master Plan, Cost Estimate, Construction Schedule

U.S. ARMY JUDGE ADVOCATE GENERAL (JAG) SCHOOL [CHARLOTTESVILLE, VA]

RTKL PREPARED A COMPREHENSIVE SECURITY MASTER PLAN FOR THE ARMY'S JUDGE ADVOCATE GENERALS SCHOOL AT THE UNIVERSITY OF VIRGINIA AND PREPARED IMPLEMENTATION DESIGN DOCUMENTS FOR THE PERIMETER SECURITY ELEMENTS WHICH HAVE BEEN COMPLETED.

RTKL used various standards (including COE, GSA and DoJ) to determine appropriate threat levels and required protection levels.

RTKL developed a vulnerability assessment to ensure the Force Protection Master Plan includes all areas of concern. The Master Plan is expected to address all security items that require improvement, including but not limited to requirements for human resources (security officers), technical equipment, interior renovations, hardened construction and adjustments in common facility operations. In some cases, various options for each item will be provided. The future addition to the JAG school will likewise be considered as to location and required functions.

Entry points were investigated and analyzed for traffic flow and access requirements to meet the various

security procedures for the different Force Protection Condition Levels. This will require the coordination of vetting procedures, vehicle barrier requirements, and technical security devices. Civil engineering and landscaping will be coordinated with revised design. Perimeter was assessed to determine fencing requirements and to identify its prospective location and supporting infrastructure. This will include fence construction criteria, landscaping/civil coordination, clear-zone requirements, camera locations and sensor requirements. Differing levels of aesthetic criteria will be identified to address particular site concerns.

As an option, blast analyses were performed by Weidlinger Associates and were integrated to determine stand-off requirements and building upgrades to both structural systems and building exterior.

Client

U.S. Army Judge Advocate General School

Services

Site Survey, Threat Assessment, Vulnerability Assessment, Blast Analysis, Force Protection Master Plan, Cost Estimate, Construction Schedule

JOHNS HOPKINS UNIVERSITY APPLIED PHYSICS LABORATORY SITE DEVELOPMENT MASTER PLAN [LAUREL, MD]

RTKL HAS COMPLETED A COMPREHENSIVE UPDATE OF THE CAMPUS MASTER PLAN FOR THE JOHNS HOPKINS UNIVERSITY APPLIED PHYSICS LABORATORY (APL), LOCATED IN LAUREL, MARYLAND.

APL is a division of the Johns Hopkins University (JHU) and a University Affiliated Research Center. The Laboratory is engaged in applied research, involving both the development and application of technology, for multiple sponsors.

The Laboratory is located about 18 miles from the JHU Homewood campus, the Baltimore site of the research and teaching university.

RTKL analyzed APL's space metrics, buildings and site infrastructure and its ability to support projected staff growth. Building placement, construction criteria and security infrastructure in relation to identified security threats were defined. The proposed master plan provides a framework for future development options, flexible site usage and implementation strategies.

Client

Johns Hopkins University

Size

1,500,000 SF

Services

Master Planning, Site Planning, Electronic Security, Physical Security / Force Protection, Strategic Planning, Telecommunications, Building Evaluation, Landscape Architecture, MEP Engineering, Architecture, Design Guidelines, Programming, Signage, Facade and Entry Graphics, Environmental Graphic Design, Laboratory Design

Reference

Glenn Carey, Facilities Projects Manager,
Technical Services
The Johns Hopkins University, Applied
Physics Laboratory
T 443.778.5118
E glenn.carey@jhuapl.edu



DEPARTMENT OF STATE, OVERSEAS BUILDINGS OPERATIONS [KAMPALA, UGANDA]

RESPONDING TO THE COMPLEXITIES OF CREATING BOTH A SECURE AND PHYSICALLY APPEALING BUILDING, RTKL DESIGNED THE U.S. EMBASSY COMPOUND IN KAMPALA TO BOTH REPRESENT THE UNITED STATES AND EMBRACE THE CULTURE AND CHARACTER OF UGANDA.

Divided into main areas for both offices and the future location of USAID, the interior spaces distinguish between public and private functions, providing security without sacrificing elegance. Outside, Uganda's traditional agricultural hill plantings influence the site design. A series of low walls run parallel to the building and

perpendicular to the slope of the site. A canopy of trees and plantings at the embassy's arrival court greets visitors. Inside, loggia evoke the strong and memorable form of the East African savanna, with Acacia trees providing shelter for animals that live in the harsh habitat. Other materials that reflect the local context include wrought iron

as a part of the central atrium and is repeated throughout the compound and rubble wall extends through the building while large glazed walls and gardens anchor the building at either end.

Client

U.S. Department of State

Services

MEP Engineering, Structural Engineering, Interior Architecture and Design, Architecture, Programming, Landscape Architecture

Size

40,000 SF

Reference

Patrick Collins, Architecture Branch Chief
U.S. Department of State Office of Foreign
Building Operations
Rosslyn, VA 22209
T 703.875.6189
E collinspw@state.gov



DEFENSE INFORMATION SYSTEMS AGENCY HEADQUARTERS [FT. MEADE, MARYLAND]

THE DEFENSE INFORMATION SYSTEMS AGENCY'S RELOCATION IS DESIGNED TO PROVIDE IMMEDIATE ENHANCEMENT OF FORCE PROTECTION FOR A MILITARY INSTALLATION. RTKL'S LEED SILVER PROJECTS DELIVERS THAT GOAL.

The resulting project is located on a 95 acre site at the center of Fort Meade. The site's previous life was that of the Installation's Golf Course and was being coordinated with numerous other construction projects. The secure campus will accommodate 4,272+ personnel. An overarching goal for DISA was to create a world-class facility to counter potential employee losses due to relocation.

The complex consists of group of multi-story buildings connected by the internal Main Concourse. 700,000 GSF is located in 3 robust office buildings (comprised of 4 and 5 stories) which surround the Central Courtyard.

These buildings accommodate general administrative office space, but also Command and Operation centers, Unclassified and Classified Communication and Computer Equipment Rooms, robust VTC Conference Rooms (including JWICS) and Computer Analysis Centers. The facility is "Open Storage Secret" and also accommodates approximately 50% SCIF administration space.

In addition, the project includes an 80,000-SF two-story Computer Laboratory Building, a Common Building that houses corporate amenities, a 30,000 Warehouse, a Central Plant, a two-level, 650-space

Parking Structure and a 400,000 gallon Water Tank. The amenities include a full service food service facility, dining room, fitness and wellness center, health unit, conference center and academic training facility, computer demonstration center and a reproduction center.

To meet the intense IT demand and to enhance quality of life issues, the entire facility utilizes raised access floor with underfloor air distribution. The facility incorporates redundant power, cooling and water to support the Mission Critical program elements.

Client

U.S. Army Corps of Engineers, Baltimore

Size

1.07 million SF

Services

Master Planning, Architecture, Interior Design, Lighting, Electrical Engineering, Acoustics, Sustainable Design, Commissioning, Construction Contract Administration

Reference

David Bullock, DISA BRAC Executive
Defense Information Systems Agency
T 301.225.1247
E david.bullock@disa.mil



NATIONAL GROUND INTELLIGENCE CENTER [CHARLOTTESVILLE, VIRGINIA]

REPLACING AN OBSOLETE 40-YEAR-OLD BUILDING, NGIC SOUGHT A NEW HEADQUARTERS TO MEET DEMANDS FOR SECURE AND FLEXIBLE OPERATIONS AND TO ADDRESS THE CHANGING ROLE OF TECHNOLOGY AND THE CHANGING WORKFORCE IN THE ANALYTICAL COMMUNITY.

The five-level structure consists of offices and support services including a cafeteria, fitness center and daycare center to create a comfortable environment for employees.

Sophisticated teleconferencing centers, special access rooms, conference and training facilities, and data center space are positioned at the building's core, thereby maximizing panoramic views from the open office plan.

Following 9/11 RTKL was commissioned to develop a perimeter security upgrade for the 30 acre site which had not been fenced or hardened in the original design.

Carefully accommodating secure and non-secure areas, the structure is designed to meet accreditation as a sensitive compartmented information

facility (SCIF) and boasts both a flexible work environment and a sophisticated telecommunications and mechanical and electrical infrastructure.

Photographic and electronic laboratories for data gathering are carefully fitted to control vibration and protect against changes in temperature and humidity. Every laboratory contains flexible and expandable modules to accommodate changing research and development work.

Client

National Ground Intelligence Center

Size

258,000 SF

Services

Architecture, Interior Design, MEP Engineering, Structural Engineering, Telecommunications Design, Acoustic Design, Audiovisual Design, Anti-terrorist/ Force Protection

Reference

Joseph Miller

U.S. Army Engineer District, Norfolk
Norfolk, VA 23510-1096

T 757.201.7117

E joseph.a.miller@nao02.usace.army.mil





State of West Virginia
 Department of Administration
 Purchasing Division
 2019 Washington Street East
 Post Office Box 50130
 Charleston, WV 25305-0130

Request for Quotation

RFO NUMBER
GSD126428

PAGE
2

ADDRESS CORRESPONDENCE TO ATTENTION OF
**KRISTA FERRELL
 304-558-2596**

VENDOR

RFQ COPY
 TYPE NAME/ADDRESS HERE

SHIP TO

DEPARTMENT OF ADMINISTRATION
 GENERAL SERVICES
 BUILDING 1 ROOM MB60
 1900 KANAWHA BOULEVARD, EAST
 CHARLESTON, WV
 25305-0123 304-558-2317

DATE PRINTED 01/09/2012	TERMS OF SALE	SHIP VIA	F.O.B.	FREIGHT TERMS
-----------------------------------	---------------	----------	--------	---------------

BID OPENING DATE **02/09/2012** BID OPENING TIME **01:30PM**

LINE	QUANTITY	UOP	CAT NO.	ITEM NUMBER	UNIT PRICE	AMOUNT
<p>NO CONTACT BETWEEN THE VENDOR AND THE AGENCY IS PERMITTED WITHOUT THE EXPRESS WRITTEN CONSENT OF THE STATE BUYER. VIOLATION MAY RESULT IN THE REJECTION OF THE BID. THE STATE BUYER NAMED ABOVE IS THE SOLE CONTACT FOR ANY AND ALL INQUIRIES AFTER THIS EOI HAS BEEN RELEASED.</p> <p>EXHIBIT 10</p> <p>REQUISITION NO.:</p> <p>ADDENDUM ACKNOWLEDGEMENT</p> <p>I HEREBY ACKNOWLEDGE RECEIPT OF THE FOLLOWING CHECKED ADDENDUM(S) AND HAVE MADE THE NECESSARY REVISIONS TO MY PROPOSAL, PLANS AND/OR SPECIFICATION, ETC.</p> <p>ADDENDUM NO.'S:</p> <p>NO. 1 <input checked="" type="checkbox"/></p> <p>NO. 2 <input checked="" type="checkbox"/></p> <p>NO. 3</p> <p>NO. 4</p> <p>NO. 5</p> <p>I UNDERSTAND THAT FAILURE TO CONFIRM THE RECEIPT OF THE ADDENDUM(S) MAY BE CAUSE FOR REJECTION OF BIDS.</p> <p>VENDOR MUST CLEARLY UNDERSTAND THAT ANY VERBAL REPRESENTATION MADE OR ASSUMED TO BE MADE DURING ANY ORAL DISCUSSION HELD BETWEEN VENDOR'S REPRESENTATIVES AND ANY STATE PERSONNEL IS NOT BINDING. ONLY THE</p>						

SEE REVERSE SIDE FOR TERMS AND CONDITIONS

SIGNATURE <i>Krista Ferrell</i>	TELEPHONE 202.833.4400	DATE February 14, 2012
TITLE Senior Vice President	FEIN 52-0884069	ADDRESS CHANGES TO BE NOTED ABOVE

WHEN RESPONDING TO REQ. INSERT NAME AND ADDRESS IN SPACE ABOVE LABELED VENDOR



State of West Virginia
 Department of Administration
 Purchasing Division
 2019 Washington Street East
 Post Office Box 50130
 Charleston, WV 25305-0130

Request for Quotation

RFQ NUMBER
GSD126428

PAGE
3

ADDRESS CORRESPONDENCE TO ATTENTION OF
KRISTA FERRELL 304-558-2596

VENDOR	RFQ COPY
	TYPE NAME/ADDRESS HERE

SHIP TO	DEPARTMENT OF ADMINISTRATION
	GENERAL SERVICES
	BUILDING 1 ROOM MB60
	1900 KANAWHA BOULEVARD, EAST
	CHARLESTON, WV
	25305-0123 304-558-2317

DATE PRINTED	TERMS OF SALE	SHIP VIA	F.O.B.	FREIGHT TERMS
01/09/2012				

BID OPENING DATE	02/09/2012	BID OPENING TIME	01:30PM
------------------	------------	------------------	---------

LINE	QUANTITY	UOP	CAT. NO.	ITEM NUMBER	UNIT PRICE	AMOUNT
<p>INFORMATION ISSUED IN WRITING AND ADDED TO THE SPECIFICATIONS BY AN OFFICIAL ADDENDUM IS BINDING.</p> <p style="text-align: center;">..... SIGNATURE RTKL Associates Inc. COMPANY February 8, 2012 DATE</p> <p>NOTE: THIS ADDENDUM ACKNOWLEDGEMENT SHOULD BE SUBMITTED WITH THE EOI.</p> <p>REV. 09/21/2009</p> <p>BANKRUPTCY: IN THE EVENT THE VENDOR/CONTRACTOR FILES FOR BANKRUPTCY PROTECTION, THE STATE MAY DEEM THE CONTRACT NULL AND VOID, AND TERMINATE SUCH CONTRACT WITHOUT FURTHER ORDER.</p> <p>ANY INDIVIDUAL SIGNING THIS BID IS CERTIFYING THAT: (1) HE OR SHE IS AUTHORIZED BY THE BIDDER TO EXECUTE THE BID OR ANY DOCUMENTS RELATED THERETO ON BEHALF OF THE BIDDER, (2) THAT HE OR SHE IS AUTHORIZED TO BIND THE BIDDER IN A CONTRACTUAL RELATIONSHIP, AND (3) THAT THE BIDDER HAS PROPERLY REGISTERED WITH ANY STATE AGENCIES THAT MAY REQUIRE REGISTRATION.</p> <p style="text-align: center;">NOTICE</p> <p>A SIGNED EOI MUST BE SUBMITTED TO:</p>						

SEE REVERSE SIDE FOR TERMS AND CONDITIONS			
SIGNATURE	<i>David Van Thompson</i>	TELEPHONE	202.833.4400
TITLE	Senior Vice President	DATE	February 14, 2012
FEIN	52-0884069	ADDRESS CHANGES TO BE NOTED ABOVE	

WHEN RESPONDING TO RFQ, INSERT NAME AND ADDRESS IN SPACE ABOVE LABELLED 'VENDOR'

Transmittal



PROJECT: State of West Virginia – Capitol Campus Security Design DATE: February 8, 2012
 PROJECT #: 9032100.01 FILE:
 TO: **Krista Ferrell**
 COMPANY: Purchasing Division
 ADDRESS (1): 2019 Washington Street, East
 ADDRESS (2):
 CITY / ST / ZIP: Charleston, WV 25305-0130
 COUNTRY / OTHER: USA
 PHONE # (required): 304.558.2306
 FROM: RTKL
 VIA: FedEx Overnight

COPIES	DATE	DESCRIPTION	AS REQUESTED	PYI	FOR YOUR ACTION	APPROVED	APPROVED AS NOTED	DISAPPROVED/ RESUBMIT	INCOMPLETE/ RESUBMIT	NOT SUBJECT TO REVIEW
6	02/08/12	1 Original / 5 Copies	<input checked="" type="checkbox"/>	<input type="checkbox"/>	<input type="checkbox"/>	<input type="checkbox"/>	<input type="checkbox"/>	<input type="checkbox"/>	<input type="checkbox"/>	<input type="checkbox"/>
			<input type="checkbox"/>	<input type="checkbox"/>	<input type="checkbox"/>	<input type="checkbox"/>	<input type="checkbox"/>	<input type="checkbox"/>	<input type="checkbox"/>	<input type="checkbox"/>
			<input type="checkbox"/>	<input type="checkbox"/>	<input type="checkbox"/>	<input type="checkbox"/>	<input type="checkbox"/>	<input type="checkbox"/>	<input type="checkbox"/>	<input type="checkbox"/>
			<input type="checkbox"/>	<input type="checkbox"/>	<input type="checkbox"/>	<input type="checkbox"/>	<input type="checkbox"/>	<input type="checkbox"/>	<input type="checkbox"/>	<input type="checkbox"/>
			<input type="checkbox"/>	<input type="checkbox"/>	<input type="checkbox"/>	<input type="checkbox"/>	<input type="checkbox"/>	<input type="checkbox"/>	<input type="checkbox"/>	<input type="checkbox"/>
			<input type="checkbox"/>	<input type="checkbox"/>	<input type="checkbox"/>	<input type="checkbox"/>	<input type="checkbox"/>	<input type="checkbox"/>	<input type="checkbox"/>	<input type="checkbox"/>
			<input type="checkbox"/>	<input type="checkbox"/>	<input type="checkbox"/>	<input type="checkbox"/>	<input type="checkbox"/>	<input type="checkbox"/>	<input type="checkbox"/>	<input type="checkbox"/>

RTKL Associates Inc.
 2101 L Street, NW
 Suite 200
 Washington, DC 20037
 T. 202 833 4400
 F. 202 887 5168
 RTKL.COM