

TRIPLES ENGINEERING



Expression of Interest

Prepared for
**West Virginia
Purchasing Division**



To provide
*Architectural & Engineering
Services for Renovations of
Office Space of the WV State
Police*

RFQ # DPS1203

September 13, 2011



30 Columbia Boulevard
Clarksburg, West Virginia 26301

304-624-4108

304-624-7831-Fax

CLARKSBURG, WV

CHARLESTON, WV

BECKLEY, WV

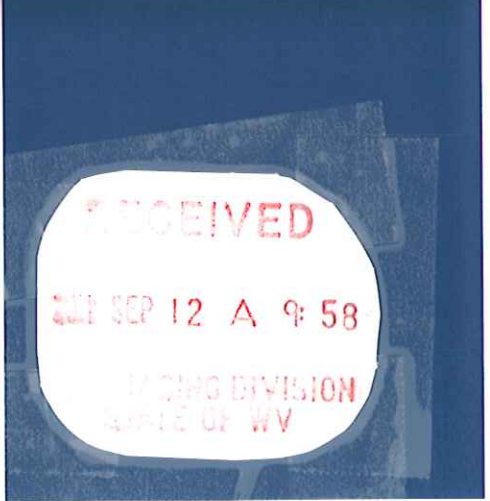

September 13, 2011

West Virginia Purchasing Division
2019 Washington Street, East
P. O. Box 50130
Charleston, WV 25305-0130

RE: *Expression of Interest for Architectural and Engineering Services*
For the WV State Police Renovations of the Old Medical Examiner Office

To the Members of the Selection Committee:

Thrasher Engineering, Inc. (TEI) is pleased to have the opportunity to submit this expression of interest and qualifications to provide engineering and architectural services for the design of renovations to the old medical examiner office to new office space for the West Virginia State Police Department. Our qualifications as West Virginia's leading civil engineering and architectural firm will provide the staff and studies of the State Police Department with quality service in a timely and cost efficient manner.

As demonstrated in this submittal, TEI is highly experienced in the planning, design and construction monitoring for building renovations. We greatly appreciate the opportunity to present our qualifications for consideration.

Our qualifications meet and exceed the criteria for selection of the architectural firm for the renovation project. In summary, we offer the following reasons why TEI is the right firm for this project:

- ❑ **Depth and Variety of Staff Disciplines:** Thrasher Engineering provides a work force of over 200 employees, with disciplines including engineering, architecture, environmental assessment, hazardous materials inspection and abatement, survey, construction monitoring and materials testing. Only Mechanical –Electrical – Plumbing engineering is sub-contracted for our architectural projects.
- ❑ **Accurate Project Estimating:** Our approach to architecture is different from that of most architecture firms: we take an engineering methodology to your project management. Our designs are aesthetically pleasing, but we focus on maintainability and functionality and most importantly we focus on design that meets the budgetary requirements of our clients. Our track record of accurately estimating construction costs is one of the strongest reasons we have repeat customers and long-term relationships with our clients. Through good design and careful estimating, we save our clients time and money.
- ❑ **Priority:** The architectural division of Thrasher Engineering, Inc. is a young and growing one. Our current work load will allow us to place your project as a priority and meet the deadlines required.

Per the requirements of the Notice for Expressions of Interest, enclosed please find three (3) originals of our submittal along with a version on CD.

We look forward to the opportunity of meeting with representatives of West Virginia Purchasing and State Police members to discuss your needs and how TEI can provide the services necessary.

Sincerely,

THRASHER ENGINEERING, INC.

A handwritten signature in blue ink, appearing to read 'CBA', with a long horizontal flourish extending to the right.

CRAIG BAKER, ASSOCIATE AIA
Project Manager

/enc.

EXECUTIVE SUMMARY

In response to the Request for Expressions of Interest to provide services for the design of all renovations aspects to the former old medical examiner office, Thrasher Engineering, Inc. (TEI) presents the following summary addressing our qualifications. Additional detailed information is included in subsequent sections.

PROJECT UNDERSTANDING

The West Virginia Purchasing Division is requesting letters of interest from qualified firms for the development of all design renovations aspects to the former old medical examiner office in South Charleston, West Virginia which will serve as a new West Virginia State Police office building.

The scope of services include developing initial design, construction and contract documents for bidding along with the oversight necessary to renovate the building into new office space.

Included in the Related Prior Experience section of this Statement of Qualifications (SOQ) are examples of projects similar in scope to the needs of State Police building renovations.



TEI, through this submittal of our qualifications, is confident that we can provide the engineering and architectural services required for this project.

LOCATIONS

TEI is based in **Clarksburg, West Virginia** with branch offices in **Charleston** and **Beckley, West Virginia** along with **Oakland, Maryland**. The Oakland office was opened in early 2004 to serve customers in the eastern portion of West Virginia and the western portion of Maryland, while our Charleston and Beckley offices are able to effectively meet the needs of our southern West Virginia clients, well into Virginia. **Architectural and engineering work for the project will be managed by and performed in the Clarksburg office.** TEI has successfully completed numerous projects in the Charleston area of West Virginia that were managed out of the Clarksburg office.

MANAGEMENT AND STAFFING

The expertise of the TEI staff is a combination of education and experience; it is reflected in all aspects of our services. The firm is led by a talented group of principals and partners who are dedicated to the success of our projects and the satisfaction of our clients.

The principals and project team members from Thrasher Engineering who will be involved with the project include:

Chad M. Riley P.E. is a partner in Thrasher Engineering. His primary responsibilities include overseeing both site development and architecture projects as Principal-In-Charge. Mr. Riley is a graduate engineer from Fairmont State University. He will serve as **Principal-In-Charge** for the project, coordinating architectural and engineering services along with overseeing all contractual obligations of the project.

Craig Baker, Associate AIA will serve as **Architectural Project Manager**. He joined Thrasher Engineering in 2006, following six years of experience with other firms. Mr. Baker received his Bachelor of Science Degree in Architecture Engineering, in 2001 from Fairmont State University. His specific related experience includes numerous renovations and new structures. Medical facilities, office buildings, city government buildings, residences, and restaurants are among his expertise. Mr. Baker has expertise in all CADD design programs relative to architecture.

For thirty years, **Lee O. Gustafson, AIA** has provided architectural design and engineering services in numerous areas including commercial, education, government, and residential development. Following twelve years of practice with other architectural firms, he formed his own firm, a sole proprietorship, in March of 1985. A graduate of the University of Cincinnati, Mr. Gustafson brings over thirty years of experience to the team, with over twenty-five of those years designing and managing projects throughout the State of West Virginia. Lee will serve as **Lead Design Architect**.

Structural engineering aspects of your project will be the responsibility of **Jeff Gola, P.E.** as **Project Engineer**. Mr. Gola is based in Thrasher Engineering's Clarksburg office, which will allow for communication with the architectural team. He joined Thrasher Engineering in 1998 and is responsible for the structural aspects of engineering design, as well as airport, road, sidewalk, storm water management and demolition projects. Mr. Gola is a Summa Cum Laude graduate of West Virginia University's College of Engineering and Mineral Resources. He is a Registered Professional Engineer in the State of West Virginia.

The Thrasher Engineering, Inc. team also offers the field services necessary to meet the entire scope of your project. Survey, construction monitoring and materials testing will also be provided by our team. Thrasher employs more construction project representatives and survey crews than any other West Virginia firm, assuring that we will be able to provide full-time representation on the project.

Any necessary **Mechanical-Electrical-Plumbing** aspects of the design will be under the direction of **Jason Harper, P.E., owner and principal of Harper Engineering, Inc.** Mr. Harper is a graduate of West Virginia Institute of Technology with a Bachelor of Science degree in Mechanical Engineering. He is a Registered Professional Engineer in the State of West Virginia. Additional members of the Harper MEP team include Kevin Mark King, PE and Scott Phillips. Mr. King brings 6 years of electrical design experience and over 10 years of electrical construction/maintenance experience to our team, while Mr. Phillips will apply 26 years of plumbing design to the projects. Their projects include educational facilities (including colleges and universities), healthcare facilities, commercial buildings, office buildings, emergency services facilities, government buildings and industrial projects.

Detailed resumes of these team members are included later in this EOI.

DESIGN AESTHETIC AND PROJECT MANAGEMENT APPROACH

TEI's Architectural team brings specific experience in providing quality planning, design and construction contract administration services for both new and renovated structures.

New building projects are a large part of the design work of the TEI architectural team, ranging from a simple 1,200 square foot building to 100,000 square foot multi-purpose structures. Renovations have been designed and managed by the team for numerous projects as well as is considered one of our specialties.

We meet project budgets and deadlines before delivering accurate plans.

TEI was formed in 1983 and since that time, the focus of the firm's work has been on publicly funded projects, ranging from public utilities to economic development to higher education facilities. We know the importance of project deadlines and have earned a reputation for accurate, on-time design and construction documents.

TEI's design team knows that accurately estimating construction costs is vitally important, especially in cases of publicly funded projects. In order to develop estimates that meet or are below our clients' budgets, we focus on preliminary assessment, to ensure no details are overlooked. Our positive track record in accurate estimates has been demonstrated throughout our new structure and renovation projects. This ability will bring cost efficiencies to your project.

We take an "engineering approach" to project management.

The State Police renovation project is one that will require solid engineering along with architectural design. TEI is unique as we consistently meet that balance by utilizing an "engineering approach to project management" which is seen in our construction and contract administration. How is our approach different? We focus on the details of monitoring the project by having our architects visit the project site on a more frequent basis than other firms. In doing so, we ensure an on-going dialogue with the owner, our project representative and construction crew and are able to ensure the quality of materials specified are being used and that design details are followed. As a result, the TEI team can reduce or eliminate changes and project delays.

The corporate philosophy of Thrasher Engineering – "Successful Projects...Repeat Clientele" is one we want to apply to the West Virginia Purchasing Division by providing engineering and architectural services for the new State Police office building.



Lecture Hall at WVU Eye Institute

STATEMENT OF QUALIFICATIONS

Founded in 1983, Thrasher Engineering, Inc., a West Virginia owned and operated full-service company has provided engineering design and construction services for infrastructure throughout the State of West Virginia.

Throughout our history, TEI has provided site development, planning and engineering design services for many successful building projects, working with numerous architectural firms and contractors. Based on that success, in 2004, we added architectural design to the scope of services we provide in-house.



Thrasher's corporate headquarters and architectural staff are located in Clarksburg, West Virginia

ARCHITECTURAL / ENGINEERING QUALIFICATIONS

Exceptional customer service, versatility, quality and experience are the benefits realized by the selection of TEI for West Virginia Purchasing Division project.

Our architects bring over 40 years of experience to the project; a balance of aesthetics, functional design and maintainability is the base of their design. The civil engineering team, working with the architects, offers the structural, utilities, and landscape architecture segments. These abilities have been demonstrated in projects shown as examples in this proposal.

In addition to our ability to provide the necessary services for architecture, Thrasher Engineering, Inc.'s selection brings the following benefits to the project:

- We offer an approach to architectural projects different from that of other firms. Our engineering emphasis on the details of construction bidding documents for our design, in addition to the design itself, results in **more accurate bids and fewer change orders - bringing cost savings to our clients.**
- We offer a solid track record of architectural design and site development engineering for state and federally funded projects, requiring integrated communication among design and construction teams.
- We offer **a teamwork process.** Whether we are serving as the civil engineer for architecture within our own company, as a sub-contractor to other architectural firms or, in a design-build team, we communicate with the project owner to provide design and construction services **on-time and within budget.**



Progress Centre at White Oaks

TEI has provided feasibility studies, design, bidding and construction phase services for **over \$500 Million** in construction for infrastructure and building projects **within the State of West Virginia**.

Simply stated, there is no other West Virginia firm that can surpass TEI in the quality of service and technical ability necessary to meet your needs in the plans for renovations to your current facility.

CONSTRUCTION DOCUMENTATION AND BIDDING SERVICES

TEI's architects thoroughly review preliminary plans to ensure accuracy and flexibility for modifications, as they are needed. Based upon that review, we prepare the necessary bidding and contracting documents. A well-designed project has more bidders with a closer spread in bids than a poorly designed project.

TEI has earned a reputation for well-designed projects resulting in more bidders and costs that meet funding allocations. During the past two years, TEI's projects have averaged six (6) bidders per contract; more recent projects have experienced up to 18 bidders which is a very price competitive arena with positive results for our clients. To promote your projects to potential bidders, Thrasher Engineering includes project information in the "Out to Bid" section of its Web site (www.thrashereng.com). The site is updated with new plan-holders daily.

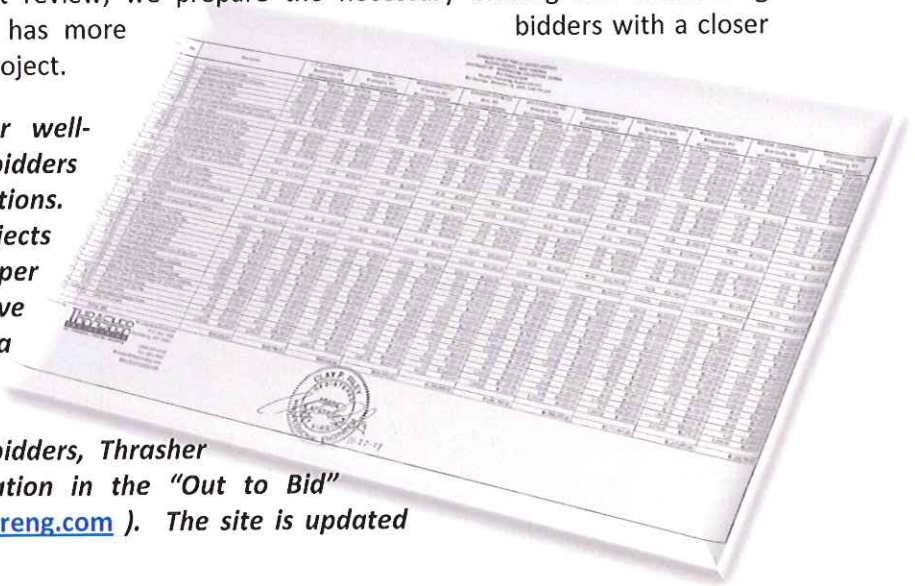

MECHANICAL-ELECTRICAL-PLUMBING DESIGN

The only engineering service that Thrasher Engineering, Inc. sub-contracts for our building projects is for Mechanical, Electrical and Plumbing design. However, we consider these designers as a part of our team and represent them under our **single contact management method**. For your project, we will utilize the services of **Harper Engineering** based in St. Albans, West Virginia.

Harper Engineering is an innovative, new engineering firm serving architects, owners, and contractors throughout the state. They offer full service commercial and industrial engineering with over 60 years of combined experience striving to offer the best service at the most competitive rates.

M-E-P services that Harper Engineering will provide for the project include design of HVAC, electrical, lighting, fire alarm, security and communications, plumbing and fire suppression. Harper Engineering's staff are also LEED certified which provides the opportunity for complete designs that are recognized by the U.S. Green Building Council as energy efficient structures.

WV Purchasing Division

**CRAIG BAKER, ASSOCIATE AIA
PROJECT MANAGER**

**CHAD M. RILEY, P.E.
PARTNER /
PRINCIPAL – IN - CHARGE**

**LEE GUSTAFSON, AIA
SENIOR ARCHITECT**

**JEFF GOLA, P.E.
STRUCTURAL ENGINEER**

**TEI's In-House
Construction Monitoring and Inspection
Team**

HARPER ENGINEERING
Mechanical–Electrical–Plumbing
**JASON HARPER, P.E., LEED
Prncpal-In-Charge HVAC Design**
**KEVIN MARK KING, P.E., LEED
Electrical,
Telecommunications and
Fire Alarm Design**
**SCOTT PHILLIPS
Plumbing and Sprinkler System Design**

CHAD MITCHELL RILEY, P.E. – PARTNER / PRINCIPAL-IN-CHARGE

Mr. Riley joined Thrasher Engineering in 1996 and became a partner in the firm in 2004. His past experience with the firm has included survey and construction management / inspection responsibilities; he now holds the responsibility of Site Development Manager and lead engineer for site development projects. The focus of these projects is for the development of industrial and business parks, multi-use developments and long-term, multi-phase infrastructure improvement and building projects. He has extensive experience in working with both Federal and State funding agencies, including the US Department of Commerce, Economic Development Council and the State of West Virginia Development Office.

Mr. Riley is currently, or has served, as Project Manager for numerous economic development projects throughout the State of West Virginia. In this capacity, he holds ultimate responsibility for client communication, engineering design, funding issues, construction document preparation, bidding, and construction management.

SITE DEVELOPMENT PROJECTS

- WHITE OAKS BUSINESS PARK**
- FAIRMONT STATE UNIVERSITY: 10-YEAR INFRASTRUCTURE IMPROVEMENTS PROJECT:**
 - Utilities, Roadways, Sidewalks, Storm Drainage, Utility Relocation*
 - Parking Garage*
 - Falcon Center (Student Activity Center)*
 - Bryant Place Dormitory*
- RALEIGH COUNTY MEMORIAL AIRPORT INDUSTRIAL PARK**
- McDOWELL COUNTY PRISON**
- PINECREST BUSINESS AND TECHNOLOGY PARK –RALEIGH COUNTY, WV**
- WOLF CREEK PARK “LIVE, WORK AND PLAY” COMMUNITY – FAYETTE COUNTY, WV**
- CHARLES POINTE DEVELOPMENT – BRIDGEPORT, WV**
 - Mass Grading, Roadways, Sidewalks, Utilities*
 - Conference Center*
- WOOD PRODUCTS INDUSTRIAL PARK – MINGO COUNTY, WV**
- PUTNAM COUNTY INDUSTRIAL PARK**
- BELINGTON INDUSTRIAL PARK – BARBOUR COUNTY, WV**
- FEDERAL BUREAU OF PRISONS**
 - Glenville Correctional Institute – Gilmer County, WV*
 - Canaan U.S. Penitentiary / Federal Prison Camp*
- U.S. DEPARTMENT OF VETERANS AFFAIRS – WEST VIRGINIA NATIONAL CEMETERY EXPANSION**

EDUCATION

- Fairmont State University – Bachelor Of Science – Civil Engineering Technology**

REGISTRATIONS

- Registered Professional Engineer, State of West Virginia**
- Registered Professional Engineer, State of Maryland**
- WVDOH Certified Concrete Technician / Certified Compaction Technician**

AFFILIATIONS

- Fairmont State University Technology Advisory Committee**

CRAIG BAKER – ASSOCIATE AIA – PROJECT MANAGER

Mr. Baker joined Thrasher Engineering, Inc. in 2005, following six years of experience with other firms. He received his Bachelor of Science Degree in Architectural Engineering in 2001 from Fairmont State University. Office buildings, city government buildings, medical facilities and restaurants are among his expertise. Mr. Baker has expertise in all CADD design programs relative to architecture. As Project Manager for numerous public and private architectural projects throughout the State of West Virginia, Mr. Baker holds responsibility for client communication, scheduling, construction document preparation, bidding, construction management and contract administration.

EDUCATION

- Bachelor of Science—Architectural Engineering, Fairmont State University

AFFILIATIONS

- American Institute of Architects - Associate, West Virginia

REPRESENTATIVE PROJECT EXPERIENCE

- Progress Centre at White Oaks – 23,000 SF, 2-story, class-A office building. All masonry construction complete with elevator and a finished common area finished with slate tile and wood crown and chair molding. Modernly secure facility equipped with card reader systems at all entrance points. Cost = \$2,600,000.00, Completed 1/2010
- Dominion Gas Building – 19,000 SF, 1 story office building equipped with offices, large scale conference rooms and training facilities. Split faced block construction with asphalt architectural shingle roof. Cost = \$2,750,000.00, Completed 10/2008
- City of Oak Hill Police Station – 6,300 SF police station facility with offices, family court room, training room and holding cell area. Equipped with a two stall sally port. Cost \$1,400,000.00 Completed 6/2009
- Glenville State Convocation Center – Schematic designs completed for the new facility which will house a 5,000 seat basketball arena, hall of fame museum, locker rooms, study facilities, film rooms, classrooms and a medical center. A separate intramural practice facility was also included. Estimated cost \$25,000,000.00
- Cambridge Office Park Buildings – 7 single story building with square footages ranging from 4,000 SF to 12,000 SF. Each is designed with entrances that will accommodate multiple tenants. Each building is constructed out of an all brick façade and each highlighted by their distinct roof top cupola. Cost = Varies from \$200,000.00-\$800,000.00 Completed 11/2009
- Horizons Church Phase 2 – SF addition to the Church building. Building to include a multi-purpose gymnasium, kitchen, food pantry as well as a two story section to house classrooms and youth facilities. Cost = , Scheduled completion 6/2010
- Harrison County School Board, Liberty High School Football Stadium – Complete football stadium, practice facility and field house. Project consists of bleacher seating for approximately 2,500, a 6500 SF field house, new lighting, a new 8 lane rubberized running track and a new practice/soccer field. Cost = \$2,500,000.00, Scheduled Completion 10/2010
- Mason County Board of Education, High School Football Stadium - Complete football stadium consisting of bleacher seating for approximately 3,500, new lighting, a new 8 lane rubberized running track and a new artificial turf playing field. Cost = \$3,200,000.00, Completed 8/2009
- Morgantown AES Federal Credit Union – A 5,500 SF banking facility consisting of private offices, board rooms, meeting rooms, etc. A 3 lane drive thru as well as a separate ATM lane was also included. Cost = \$1,300,000.00, Completed 6/2009
- Rahall Center at the Woodlands = 10,000 SF office building. Designed with capturing the sites panoramic views at mind. The building perimeter walls are 90% glass with the building's main feature being the front and rear walls being composed of an approximately 110' span of continuous curved glass curtain wall.

Building materials were brick and cut stone with limestone accents and a standing seam metal roof. Cost = 1,700,000.00, Completed 10/2007

- MVB Bank and office building – 20,000 SF, 2 story office building with MVB bank occupying 75% of first floor. All brick façade with a standing seam metal roof. Cost = \$3,250,000.00, Completed 6/2007*
- Mon Valley Bank, Bridgeport– 10,000 SF, 2 story building complete with 3 lane drive thru. Cost \$1,200,000.00, Complete 5/2005*
- Northern and Southern High School athletic Facilities – Locker room, press box and concession stand renovations at each school. Estimated Cost = \$250,000.00, Scheduled Completion 2/2010*
- Elkins Hospice Care – Renovation of an existing 5,000 SF nursing facility into a 12 bed Hospice Care Center. Each room was designed to be a private suite with furnishings reminiscent of home. A group kitchen and dining area as well as a chapel were also included. The project also included a 2 story 10,000 SF administrative addition. Cost = \$2,000,000.00, Completed 10/2008*
- WVU Natatorium - Complete renovation of the men's and women's swim team locker rooms as well as the swim coaches' offices. Cost \$60,000.00, Completed 1/2010*
- Exxon on the Run Station @ White Oaks – 5,400 Sf retail service station which will include walk in coolers, a private office, donut shop & store room. All Brick façade with standing seam metal roof. Cost \$700,000.00, Scheduled Completion 6/2010*
- NCWV KCI/V-1 services renovations – Complete renovation of the V-1 services space. Renovations consisted of modernizing the space to accommodate a pilot's lounge, private offices, first class waiting area and more. A covered canopy was added to the exterior to provide a formal entrance into the space. Cost = \$300,000.00, Completed 10/2009*

LEE O. GUSTAFSON – AIA / LEAD ARCHITECT

Prior to joining Thrasher Engineering in 2005, Mr. Gustafson owned and operated a sole-proprietorship firm specializing in health care, business, and educational facilities. Additionally, he provides architectural services for government & community facilities, apartment complexes, religious buildings, industrial facilities and office buildings and structures associated with Thrasher Engineering's site development projects. A graduate of the University of Cincinnati, Mr. Gustafson brings over thirty years of experience to the team, with more than twenty-five of those years designing and managing projects throughout the State of West Virginia.

EDUCATION

- Bachelor of Science-Architecture, University of Cincinnati, 1975

CERTIFICATIONS

- American Institute of Architects (AIA), State of West Virginia
- American Institute of Architects (AIA), State of Maryland
- Certification, National Council of Architectural Registration

AFFILIATIONS

- West Virginia Society of Architects
- A.I.A. Committee on Architecture for Education
- A.I.A. Committee on Architecture for Health Care
- A.I.A. Committee on Architecture for Justice
- SHPO Listed and Approved for Historic Preservation Work
- Past Member of Clarksburg Municipal Building Commission
- Past Member of Harrison County Housing Council
- Genesis Youth Center Board Member
- Clarksburg Rotary
- Past Member of Allohak Council Boy Scouts of America

REPRESENTATIVE PROJECT EXPERIENCE

- Clarksburg Baptist Church, "Nannie Monroe" 2 Story Classroom and Office Addition with Connecting Atrium and 5 Stop Elevator connection the Historic Church and New Addition. This addition was designed with brick detailing to complement the existing historic structure which is a prominent Church in the Downtown Clarksburg Historic District.
- Shenandoah Office Park - 2 Multi-Story Office Buildings, Martinsburg, WV, 2 story, 20,000 sf MVB Bank Building Completed 2007, 3 story, 30,000 sf Office Building in schematic design phase. The buildings are designed in a white brick and green roof and window theme to distinguish the park from the traditional red brick used in the historic areas. The site design and landscaping have been recognized for trend setting concepts in storm water management.
- MVB Bank and office building – 20,000 SF, 2 story office building with MVB bank occupying 75% of first floor. All brick façade with a standing seam metal roof. The MVB/Shenandoah Building also required a high level of security for the government offices housed on the Second Floor. .Cost = \$3,250,000.00, Completed 6/2007
- Mon Valley Bank, Bridgeport– 10,000 SF, 2 story building with Basement Vaults and Elevator, and 3-lane drive thru. Cost \$1,200,000.00, Complete 5/2005
- Heritage Square Office Complex, Clarksburg, WV, including Heritage Bank (now Wesbanco) 3 stories, 21,000 sf, cost \$\$1,260,000, plus the CWV Tel Federal Credit Union & Dr. DeMarino Optometry Building. All buildings are designed with a split faced block exterior, aluminum windows and storefronts, and standing seam metal roofing to maintain the design theme.

- ❑ *Morgantown AES Federal Credit Union – A 5,500 SF banking facility consisting of private offices, board rooms, meeting rooms, etc. A 3 lane drive thru as well as a separate ATM lane was also included. Cost = \$1,300,000.00, Completed 6/2009*
- ❑ *GVEDC VA Community Based out-patient clinic, Clarksburg, WV – 8,536 sf build-out in an existing space. Construction consisted of 8 exam rooms, a pharmacy, a medical lab with all necessary support offices for doctors, nurses, health care providers, etc. Cost = \$950,000, Completed 12/2010*
- ❑ *Elkins Hospice Care – Renovation of an existing 5,000 SF nursing facility into a 12 bed Hospice Care Center. Each room was designed to be a private suite with furnishings reminiscent of home. A group kitchen and dining area as well as a chapel were also included. The project also included a 2 story 10,000 SF administrative addition. Cost = \$2,000,000.00, Completed 10/2008*
- ❑ *Grant County Nursing Home; 15,000 of Additions and Renovations for a 45 Bed Addition to the existing 60 Bed Long Term Care Facility, Cost \$1,250,000, plus several follow up additions and renovations for the Alzheimer Wing, Dining Room, Kitchen, Physical Therapy and Administrative Offices.*
- ❑ *Cortland Acres Nursing Home, Thomas WV, Alzheimer Wing, 3,120 sf, \$283,000, Laundry Wing, 950 sf, \$69,650, Physical Therapy and Pool Addition, 3,460, \$461,925, Administrative Offices and Dining Room Additions & Renovations*
- ❑ *Tucker County Senior Center, 7,980 sf, \$430,000, Hardy County Senior Center, 5,000 sf, Cost \$350,000, and Newburg Senior Center, 3,700 sf, Cost \$296,000. These projects were each constructed with funding from Small Cities Block Grants. All included Community dining and Recreation, Commercial Kitchens, Health Department Facilities, and Senior Center Administrative Facilities.*
- ❑ *Rahall Center at the Woodlands - 10,000 SF office building. Designed with capturing the sites panoramic views at mind. The building perimeter walls are 90% glass with the building's main feature being the front and rear walls being composed of an approximately 110' span of continuous curved glass curtain wall. Building materials were brick and cut stone with limestone accents and a standing seam metal roof. Cost = \$1,700,000.00, Completed 10/2007*
- ❑ *Lumberport Volunteer Fire Department – A one story, 6,260 sf split faced block and wood framed roof Fire Station including 2,800 sf Apparatus Bay, Community/Recreation Room, Bunk/Locker/Shower Room, Cascade Tank Room, Kitchen, Restrooms and Offices, Cost \$310,000*
- ❑ *Newpointe Medical Center, Clarksburg, WV – 2 One Story Buildings totaling 21875 sf, \$1,750,000, including Medpointe Urgent Care Clinic, Newpointe Pharmacy, Franz Dermatology, Mountain State Physical Therapy, and Dr. Sivakumaren Pediatrics. The buildings are wood frame, fully sprinklered, with synthetic stucco exterior wall finish and architectural shingle roofing.*
- ❑ *Cambridge Place Office Park, Bridgeport, WV; 7 Mixed Use Executive Office Buildings totaling 47,000 square feet at a total cost of approximately \$6,650,000, constructed in phases over a 6 year schedule.. Floor plans are varied, but each building is designed with trademark portico and roof top cupolas, molded brick, divided light windows, and architectural shingles to maintain the park's distinctive design theme. Completed 11/2009*
- ❑ *Horizons Church Phase 2 – SF addition to the Church building. Building to include a multi-purpose gymnasium, kitchen, food pantry as well as a two story section to house classrooms and youth facilities. Completed 6/2010*

JEFF GOLA, P.E. – PROJECT ENGINEER

Mr. Gola joined Thrasher Engineering in 1998 and serves as Project Manager/Engineer on Highway Projects, Community Improvement Projects, and Commercial Site Development Projects and provides structural engineering services for architectural projects. He is experienced in all aspects of the project control, from design and drafting to the bidding process to the over site of the construction inspection. Specialties include:

- ❑ *Highway Engineering: planning and design of roadways and sidewalks.*
- ❑ *Structural Engineering: design of buildings, bridges, retaining walls, and utility plant structures.*
- ❑ *Site/Land Development: design of roads, drainage, storm water manager, erosion and sediment control and numerous regulatory permitting activities.*
- ❑ *Hydrology and Hydraulic Engineering: stream modeling and dam break analysis.*

REPRESENTATIVE PROJECTS

- ❑ *Buffalo Wild Wings, Site Preparation: Performed the design of site preparation for a developer in Charleston, WV for construction of the franchise restaurant. The work included grading, drainage, parking layout, landscaping, and utilities.*
- ❑ *Baywood Hotel, Site Preparation: Provided design for the site of future motel. The site preparation plans involve demo, grading, storm water management, entrance permitting, landscaping, utilities, and parking layout.*
- ❑ *Fairmont State University, Locust Avenue Demolition: This project was broken down into two phases, which included the demolition of nine (9) residential structures. Once the structures were demolished, a parking lot was installed in the vacant area.*
- ❑ *City of Mannington, Buffalo Street Demolitions: The goal of the project was to demolish four structures, ranging from three to four story buildings. Once the structures were removed, Thrasher Engineering was able to restore and stabilize an adjacent stream bank and provide off-street parking.*
- ❑ *Fairmont State University, Engineering Technology Building: For this project we were working with the architect who was renovating the existing technology building on campus. Our portion of the job was to provide grading and utility plans for the renovation. As the plans progressed, the owner decided to include a retaining wall. The wall was designed as a segmental block wall which had grating that spanned between the wall and the proposed building.*
- ❑ *Harrison County Commission, Handicap Ramp and Sidewalk: The goal of the design was to improve the handicap entrance to the county courthouse by making a wider ramp and gentler slope. The sidewalk that makes up Court Street, adjacent to the courthouse was designed to remove all existing uneven pavers, slate and concrete and replace with a concrete sidewalk with a brick paver border.*

EDUCATION

- ❑ *Bachelor Of Science-Civil Engineering, West Virginia University, 1998 Summa cum Laud*

CERTIFICATIONS

- ❑ *Registered Professional Engineer (PE), State of West Virginia*
- ❑ *Registered Professional Engineer (PE), State of Maryland*
- ❑ *American Society of Civil Engineers*
- ❑ *American Society of Highway Engineers*
- ❑ *City of Mannington Code Enforcement Appeal Board*
- ❑ *Licensed Lead Inspector and Risk Assessor*

JASON E. HARPER, PE, LEED
President



(304)-541-1390
jason@harperengwv.com

Jason E. Harper, PE, LEED brings 5 years design experience to our team. He has experience with HVAC and piping design. His projects include educational facilities (including colleges and universities), health care facilities, office buildings, banks, emergency services facilities, postal facilities, and government buildings.

EDUCATION

- West Virginia University Institute of Technology Montgomery, WV
Bachelor of Science-Mechanical Engineering*

REGISTRATIONS/PROFESSIONAL AFFILIATIONS

- WV Licensed Professional Engineer*
- LEED Green Associate*
- ASHRAE*

EXPERIENCE - REPRESENTATIVE PROJECTS

Summersville Readiness Center

Independence High School HVAC

Lewisburg Readiness Center

Liberty High School HVAC

WVARNG Fire Station

Grafton High School Addition

Mylan Pharmaceuticals Expansion

Robert Byrd Health Science Center

Raleigh Co. 911 Center

TMH MRI Addition- Ashton Place

Kevin Mark King, PE, LEED brings 6 years of electrical design experience and over 10 years of electrical construction/maintenance experience to our firm. His projects include educational facilities (including colleges and universities), healthcare facilities, office buildings, emergency services facilities, government buildings and industrial projects.

EDUCATION

West Virginia University Institute of Technology *Montgomery, WV*
Bachelor of Science-Electrical Engineering

Bluefield State College *Bluefield, WV*
Bachelor of Science-Computer Science

Wytheville Community College *Wytheville, VA*
Associate Applied Science – Computer Information Systems

REGISTRATIONS/PROFESSIONAL AFFILIATIONS

WV licensed Professional Engineer
WV licensed Master Electrician
LEED Green Associate

REPRESENTATIVE PROJECT EXPERIENCE

Raleigh Co. 911 Center *Independence High School HVAC*

Mason County 911Center *WVU Tech Printing Innovation Center*

WVARNG Fire Station *Talcott Elementary School*

Sissonville Middle School *Greenbrier West High School Renov.*

SCOTT D. PHILLIPS



Scott D. Phillips brings 26 years design experience to our firm. He has experience with plumbing and fire suppression system design. His projects include educational facilities (including colleges and universities), health care facilities, office buildings, banks, emergency services facilities, postal facilities, and government buildings.

REGISTRATIONS/PROFESSIONAL AFFILIATIONS

American Society of Plumbing Engineers

REPRESENTATIVE PROJECT EXPERIENCE

*Renovations to Glenville ES
301 Virginia Street Alpha and Bravo
Terra Alta ES Fire Alarm
Oak Hill Police Station
Berkeley Testing Lab
Dominion Gas Office Building
Raleigh Co. BOE Credit Union*

*City of St Marys WWTP
Renovations to Burnsville ES
Timber's Lodge
Thrasher Engineering Office Addition
Moses Factory Outlet- Teays Valley
WVU Housing Sanitary Replacement
Renovations to Davis ES*

RELATED PRIOR EXPERIENCE

Thrasher Engineering, Inc.'s team offers a portfolio of engineering and architectural projects featuring a variety of project types of various sizes and costs. For these projects, we have provided project planning, design, bid document preparation, construction documentation and in many cases the site development and field services aspects of the projects.

Over the past five years, our portfolio of business has included renovations, new structures and additions in the areas of education, commercial / office buildings, light industrial, healthcare and government facilities.



Representative Project Experience includes:

- ❑ **Rahall Technology Center – Lewisburg, WV**
- ❑ **Elkins Hospice Center – Elkins, WV**
- ❑ **KCI V1 Facility – NCWV Airport, Bridgeport, WV**
- ❑ **Valley Community Mental Health Centers – Various Locations throughout WV**
- ❑ **Fairmont State University Hunt Haught Hall – Fairmont, WV**
- ❑ **Abraham Linc. – Bridgeport, WV**
- ❑ **Horizons Church and Learning Center – Lost Creek, WV**



RAHALL TECHNOLOGY CENTER BUILDOUT FOR VA OUTPATIENT CLINIC SERVICES

The project scope consisted of project management, architectural and interior design and construction management for renovations to the Rahall Technology and Business Center complex in Lewisburg, WV. The space, which includes 8,900 sf of finished interior, is designed for the Veteran's Administration for use as a community outpatient clinic. Exterior design included canopies at exterior door entrances, sidewalks, precast retaining walls, hand railing, outdoor lighting, parking lot paving and markings, landscaping, and other related work.

Final Project Cost: Approximately \$950,000.00



Contact:

Greenbrier Economic Development Authority
PO Box 33
804 Industrial Park Road
Maxwellton, WV 24957
304-497-4300
Stephen Weir, CEDP

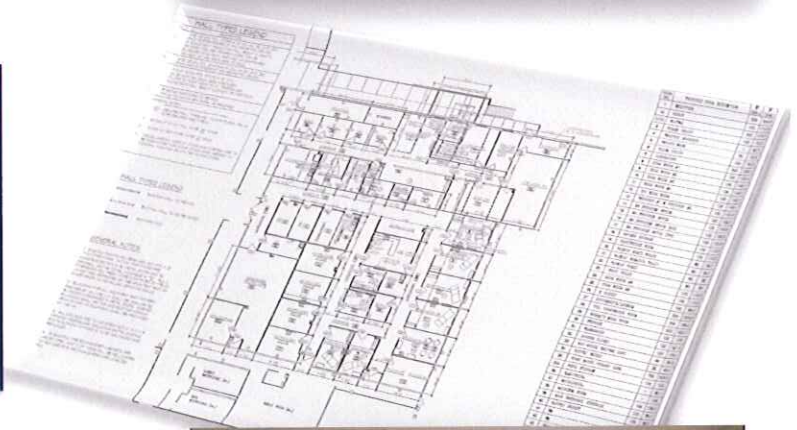

ELKINS HOSPICE CENTER – ELKINS, WV

Thrasher's role in the project included project management, architectural and interior design and construction management. The project consisted of the complete interior stripping and remodel of an existing 5800 sf nursing home facility to create a state of the art hospice facility. The renovation created a 12-bed facility to meet the owners' goal of a hospice which was "as comforting and home-like as possible". This was achieved with the use of deep, warm earth tones, natural hardwood trim and accents, patient and family lounge facilities with oversized sofas and residential style lighting. Each patient room is furnished with a private desk, wide screen flat panel TV and sitting area. Additionally, each room contains its own thermostat to allow individual comfort levels.

Special care was taken to conceal all healthcare amenities to maintain the family/home feel of the hospice. A 1200 square foot addition was included in this aspect of the project to contain all laundry facilities as well as necessary support staff amenities. The full sprinkler, fire alarm, nurse call and oxygen system makes this facility to meet all state and federal codes for health care structures.

In addition to the remodel, a 2-story, 7600 sf administration addition was constructed and connected to the patient care area. This houses 8 private offices, 18 cubicles, 3 large conference rooms; staffs break rooms, elevator and full basement. The exterior brick was specifically matched to the existing structure to obtain a more cohesive structure.

Building size:

Patient care – 6,900 square feet (12 beds) Administration- 7,600 square feet (2-story)



Owner's Name: Hospice Care of WV
Contact: Ms. Malene Davis, President
Address: P.O. Box 760
Highway 92 South
City/ State: Arthurdale, WV 26520
Phone: 304-864-0884 ext. 815
Fax: 304- 864-3373
E-mail: mdavis@hospicecarecorp.org

Total Project Cost: Cost: \$2,410,880.00.
Project Status: Complete/ Occupied
Funding Sources: Private

NCWV REGIONAL AIRPORT – KCI VI FACILITY RENOVATIONS

The North Central West Virginia Airport hired Thrasher Engineering to provide architectural and engineering services to renovate the space occupied by KCI (charter plane service) and / V-1 Aviation Services (aircraft fuel provider.) The scope of the project encompassed all services necessary to complete renovation of the V-1 services space, consisting of 1,730 net square feet of existing office area, and construction of approximately 670 sf of canopy area covering entrance doors.

Renovations consisted of modernizing the space to accommodate a pilot's lounge, private offices, first class waiting area and more. A covered canopy was added to the exterior to provide a formal entrance into the space. Cost = \$300,000.00, completed 10/2009



Owner's Name: North Central WV Regional Airport / Benedum Airport Authority

Contact: Mr. Rick Rock, Acting General Manager

Address: 2000 Aviation Way

City/State: Bridgeport, WV 26330

Phone: 304.842.3400 |

E-mail: info@flyckb.com



VALLEY COMMUNITY MENTAL HEALTH CENTERS

These projects were the result of providing a quick response to an initial small renovation at the corporate headquarters located in Morgantown, West Virginia. Future projects expanded to include a new clinic in Grafton, the ACT (Alcohol and Chemical Abuse Treatment) unit in Fairmont and the plans for the STRU (Short Term Residential Crisis Center) and MRDD Facilities in Morgantown. These facilities cover both day patient and residential uses.

Each of these facilities is a one story walk-in with easily maintainable interiors. The exteriors are partially brick and partially cedar siding.

GRAFTON CLINIC - GRAFTON, WV

The Valley Community Mental Health Centers Grafton Clinic involved constructing an addition and the renovation of a former lawn equipment store for use as a new office building.

Office Renovation

- Removal of Interior Partitions and Fixtures
- New Partition Framing
- Roof Framing Additions and Modifications
- New Exterior Windows and Doors
- Cutting and Patching of Existing Slab for New Sanitary Sewer Lines and Leveling Repairs
- Sealing of Existing Foundation Cracks
- New Exterior Siding
- Brick Work
- New Shingles to Match Addition

Office Addition

- Fiberglass Wall & Ceiling Insulation
- Shingled Roof
- Drywall on Wood Stud Partitions
- Plastic Laminate Counterwork
- Attic Access
- Client & Staff Restrooms
- Attic Access
- Entry Skylights
- Interior Sound Batt Insulation
- Two HVAC Systems with Air Handlers
- Interior and Exterior Wiring and Lighting
- Grading for New Parking and Lawn Areas
- All Site Utilities

*Owner's Name: Valley Community
Mental Health Centers
Contact: Gerry Schmidt, COO
Address: 301 Scott Avenue
City/ State: Morgantown, WV 26508*

*Phone: (304) 296- 1731
FAX: 225-2288*

Project Status: Complete/ Occupied

Funding Sources: Private



ACT UNIT (ALPHA CHEMICAL DEPENDENCY TREATMENT) RESIDENTIAL CENTER - FAIRMONT, WEST VIRGINIA

This 5,750 square foot structure is designed to house 12 residents for treatment, and is a one story wood frame with brick veneer structure, with a concrete slab grade floor.

- Fiberglass Wall & Ceiling Insulation
- Shingled Roof
- Drywall on Wood Stud Partitions
- Plastic Laminate Counterwork
- Shower Rooms With Floor and Wall Tile
- Kitchenette Unit
- Client & Staff Restrooms
- Roof Windows
- Interior Sound Batt Insulation
- Laundry Room
- Sanitary Sewer Grinder Pump Station
- Parking and Lawn Areas
- Concrete Walks and Curbs
- Utility Connections

FAIRMONT STATE UNIVERSITY -HUNT HAUGHT HALL RENOVATIONS

TEI is providing all professional services to plan design and provide construction administration for the renovations to Hunt-Haught Hall, a 30+ year-old structure. Renovations include revisions to the glass wall stair tower along with numerous HVAC upgrades. Revisions to the stair tower were required due to age related leaking windows resulting in the deterioration of the steel structure. Additionally, the existing window glass required replacement to meet the more energy efficiency guidelines of FSU. HVAC upgrades included the removal and replacement of existing hot water boilers with new high efficiency systems.

TEI's architects identified the challenges to the project and proposed solutions to those challenges immediately upon being hired for the project. The first challenge identified was the avoidance of disruptions to everyday use of the building during construction, specifically regarding ingress and egress and safety and noise concerns as classes will be in session. To avoid disruptions, the TEI team met with campus officials, faculty and staff in a logistical planning session to develop a full understanding of classroom and building use schedules. In doing so, specific guidelines were developed and included in the bid documentation to allow a clear understanding to prospective contractors.

Also identified as a challenge was minimalizing modifications to the existing structure, specifically the client's preference to utilize the existing steel structure. TEI designed an individual aluminum store front style window system that meets the budget and preserves the current aesthetic of Hunt Haught Hall.

Owner's Name: Fairmont State University
Contact: Jim Decker, Asst. VP of Facilities
Address: 1201 Locust Avenue
City/ State: Fairmont, WV 26554
Phone: 304-367-4861
Project Status: Complete/ Occupied

CONSTRUCTION COST: Estimate:
Contract 1- Window Replacement
\$250,000.00
Contract 2- HVAC Improvements
\$500,000.00

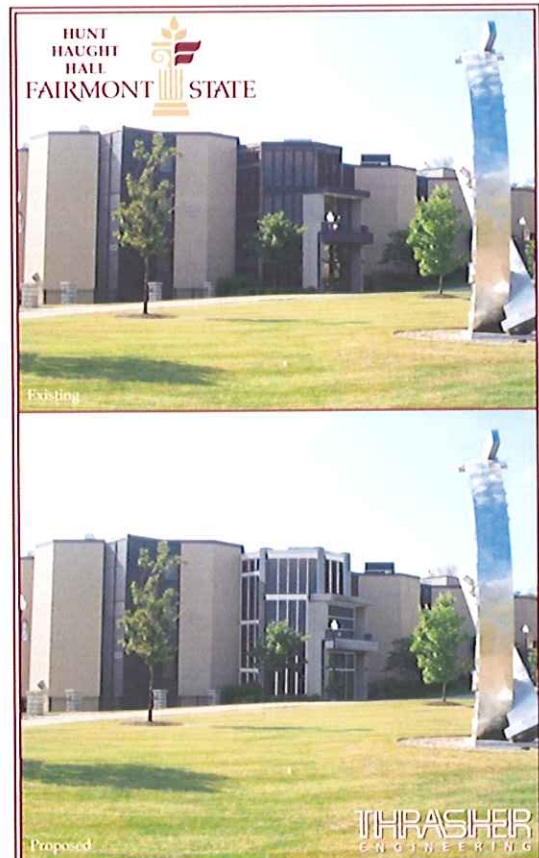

ABRAHAM LINC CORPORATION-BRIDGEPORT, WV

Scope of Services:

This project included the design and construction management services for the renovation of existing Abraham Linc offices and warehouse, and the addition of new offices. Demolition and disposal work was also included within this scope of services.

The building addition was wood framed with full span low slope wood roof trusses and plywood decking. The roofing system was an adhered PVC system over rigid insulation sheathing. Exterior finishes included commercial aluminum entrance systems, clad wood windows with interior wood trim and brick veneer to match the existing building.

Interior finishes included vinyl floor coverings, stained wood base and trim, finished drywall and a two-foot by two-foot lay-in ceiling system.

This project also included mechanical and electrical work, plumbing for roof and storm drains, rooftop heating and air conditioning, lighting and a fire alarm extension.

*Owner's Name: Abraham Linc
Address: 519 West Main Street
City/ State: Bridgeport, WV 26330*

*Phone: (304) 842-6474
FAX: 842-8703*

Project Status: Complete/ Occupied

*Funding Sources: Private
Building Size: 10,900 Square Feet*

Cost: \$1,200,000



HORIZONS CHURCH AND EDUCATIONAL COMPLEX ANNEX



BRIEF PROJECT DESCRIPTION: This project encompassed a total building area of more than 42,000 square feet. The latest addition consists of the design of a new 13,750 square foot Family Life Center. A 2,430 square foot office building and a 14,000 square foot Educational and Fellowship annex was also completed. This portion includes classrooms, the Youth Recreation Center, a kitchen, a dining/café area, meeting rooms, a nursery, rest rooms, and the Youth Worship Center. The sanctuary and stage are fully equipped for a wide variety of multi-media productions. The facility included 900 square feet for the food pantry expansion.



Horizons Church
CONTACT: Scott Burns
Lost Creek, West Virginia 26301
304-598-4125
PROJECT LOCATION:
Harrison County, West Virginia
Three Buildings Size:
52,000 square feet
Total Project Cost:
\$3,500,000.00

REFERENCES

Dr. Larry Parsons (304) 329-0580
Preston County Schools
Kingwood, WV

Mr. Jim Decker, Assistant VP of Facilities (304) 367-4861
Fairmont State University
Fairmont, WV

Mr. Bill Hannabas, City Manager (304) 469-9541
City of Oak Hill
Oak Hill, WV

City of Oak Hill (304) 465-0591
Police Chief Michael Whisman
Oak Hill, WV

High Tech Corridor Development, LLC (304) 622-2400
Mr. Jack Keeley
Clarksburg, WV

Pinecrest Development Corporation (304) 929-2010
Mr. Bill Baker
Beckley, WV

EXHIBIT 10

REQUISITION NO.: DPS 1203

ADDENDUM ACKNOWLEDGEMENT

I HEREBY ACKNOWLEDGE RECEIPT OF THE FOLLOWING CHECKED ADDENDUM(S) AND HAVE MADE THE NECESSARY REVISIONS TO MY PROPOSAL, PLANS AND/OR SPECIFICATION, ETC.

ADDENDUM NO.'S:

NO. 1

NO. 2

NO. 3

NO. 4

NO. 5

I UNDERSTAND THAT FAILURE TO CONFIRM THE RECEIPT OF THE ADDENDUM(S) MAY BE CAUSE FOR REJECTION OF BIDS. VENDOR MUST CLEARLY UNDERSTAND THAT ANY VERBAL REPRESENTATION MADE OR ASSUMED TO BE MADE DURING ANY ORAL DISCUSSION HELD BETWEEN VENDOR'S REPRESENTATIVES AND ANY STATE PERSONNEL IS NOT BINDING. ONLY THE INFORMATION ISSUED IN WRITING AND ADDED TO THE SPECIFICATIONS BY AN OFFICIAL ADDENDUM IS BINDING.

SIGNATURE

Thrasher Engineering, Inc.
COMPANY

9/9/11
DATE



State of West Virginia
 Department of Administration
 Purchasing Division
 2019 Washington Street East
 Post Office Box 50130
 Charleston, WV 25305-0130

Request for Quotation

RFQ NUMBER
DPS1203

PAGE
1

ADDRESS CORRESPONDENCE TO ATTENTION OF
TARA LYLE
304-558-2544

RFQ COPY

TYPE NAME/ADDRESS HERE
 Thrasher Engineering, Inc.
 30 Columbia Boulevard
 P. O. Box 1532
 Clarksburg, WV 26301

SHIP TO

WEST VIRGINIA STATE POLICE
 4124 KANAWHA TURNPIKE
 SOUTH CHARLESTON, WV
 25309 304-746-2141

DATE PRINTED	TERMS OF SALE	SHIP VIA	F.O.B.	FREIGHT TERMS
08/10/2011				

BID OPENING DATE: **09/13/2011** BID OPENING TIME **01:30PM**

LINE	QUANTITY	UOP	CAT. NO.	ITEM NUMBER	UNIT PRICE	AMOUNT
0001	1	JB		906-00-00-001		
<p>ARCHITECT/ENGINEERING SERVICES, PROFESSIONAL</p> <p>EXPRESSION OF INTEREST (EOI)</p> <p>THE WEST VIRGINIA PURCHASING DIVISION FOR THE AGENCY, WV STATE POLICE, IS SOLICITING EXPRESSIONS OF INTEREST FOR PROFESSIONAL ARCHITECTURAL ENGINEERING DESIGN SERVICES TO RENOVATE THE OLD MEDICAL EXAMINER BUILDING AT THE WV STATE POLICE HEADQUARTERS LOCATED AT 725 JEFFERSON ROAD SOUTH CHARLESTON, WV 25309, PER THE ATTACHED BID REQUIREMENTS AND SPECIFICATIONS.</p> <p>TECHNICAL QUESTIONS MUST BE SUBMITTED IN WRITING TO TARA LYLE VIA MAIL AT THE ADDRESS SHOWN IN THE BODY OF THIS EOI, VIA FAX AT 304-558-4115, OR VIA EMAIL AT TARA.L.LYLE@WV.GOV.</p> <p>DEADLINE FOR ALL TECHNICAL QUESTIONS IS 8/26/2011 AT THE CLOSE OF BUSINESS. ANY TECHNICAL QUESTIONS RECEIVED WILL BE ANSWERED BY FORMAL ADDENDUM ISSUED BY THE PURCHASING DIVISION AFTER THE DEADLINE HAS LAPSED.</p> <p>CANCELLATION: THE DIRECTOR OF PURCHASING RESERVES THE RIGHT TO CANCEL THIS CONTRACT IMMEDIATELY UPON WRITTEN NOTICE TO THE VENDOR IF THE COMMODITIES AND/OR SERVICES SUPPLIED ARE OF AN INFERIOR QUALITY OR DO NOT CONFORM TO THE SPECIFICATIONS OF THE BID AND CONTRACT HEREIN.</p>						

SEE REVERSE SIDE FOR TERMS AND CONDITIONS

SIGNATURE 	TELEPHONE 1-304-624-4108	DATE September 9, 2011
TITLE Principal-In-Charge	FEIN 5506335966	ADDRESS CHANGES TO BE NOTED ABOVE

WHEN RESPONDING TO RFQ, INSERT NAME AND ADDRESS IN SPACE ABOVE LABELED 'VENDOR'



State of West Virginia
 Department of Administration
 Purchasing Division
 2019 Washington Street East
 Post Office Box 50130
 Charleston, WV 25305-0130

Request for Quotation

RFQ NUMBER
DPS1203

PAGE
2

ADDRESS CORRESPONDENCE TO ATTENTION OF:
**TARA LYLE
 304-558-2544**

VENDOR
 RFQ COPY
 TYPE NAME/ADDRESS HERE
**Thrasher Engineering, Inc.
 30 Columbia Boulevard
 P. O. Box 1532
 Clarksburg, WV 26301**

SHIP TO
**WEST VIRGINIA STATE POLICE
 4124 KANAWHA TURNPIKE
 SOUTH CHARLESTON, WV
 25309 304-746-2141**

DATE PRINTED	TERMS OF SALE	SHIP VIA	F.O.B.	FREIGHT TERMS
08/10/2011				

BID OPENING DATE: **09/13/2011** BID OPENING TIME **01:30PM**

LINE	QUANTITY	UOP	CAT. NO.	ITEM NUMBER	UNIT PRICE	AMOUNT
<p>BANKRUPTCY: IN THE EVENT THE VENDOR/CONTRACTOR FILES FOR BANKRUPTCY PROTECTION, THE STATE MAY DEEM THE CONTRACT NULL AND VOID, AND TERMINATE SUCH CONTRACT WITHOUT FURTHER ORDER.</p> <p>NOTICE</p> <p>A SIGNED BID MUST BE SUBMITTED TO:</p> <p>DEPARTMENT OF ADMINISTRATION PURCHASING DIVISION BUILDING 15 2019 WASHINGTON STREET, EAST CHARLESTON, WV 25305-0130</p> <p>THE BID SHOULD CONTAIN THIS INFORMATION ON THE FACE OF THE ENVELOPE OR THE BID MAY NOT BE CONSIDERED:</p> <p>SEALED BID</p> <p>BUYER:-----TL/32-----</p> <p>RFQ. NO.:-----DPS1203-----</p> <p>BID OPENING DATE:-----09/13/2011-----</p> <p>BID OPENING TIME:-----1:30 PM-----</p> <p>PLEASE PROVIDE A FAX NUMBER IN CASE IT IS NECESSARY TO CONTACT YOU REGARDING YOUR BID;</p>						

SEE REVERSE SIDE FOR TERMS AND CONDITIONS

SIGNATURE	TELEPHONE 1-304-624-4108	DATE September 9, 2011
TITLE Principal-In-Charge	FEIN 5506335966	ADDRESS CHANGES TO BE NOTED ABOVE

WHEN RESPONDING TO RFQ, INSERT NAME AND ADDRESS IN SPACE ABOVE LABELED 'VENDOR'



State of West Virginia
 Department of Administration
 Purchasing Division
 2019 Washington Street East
 Post Office Box 50130
 Charleston, WV 25305-0130

Request for Quotation

RFQ NUMBER
DPS1203

PAGE
3

ADDRESS CORRESPONDENCE TO ATTENTION OF:
TARA LYLE
304-558-2544

VENDOR

RFQ COPY
 TYPE NAME/ADDRESS HERE
Thrasher Engineering, Inc.
30 Columbia Boulevard
P. O. Box 1532
Clarksburg, WV 26301

SHIP TO

WEST VIRGINIA STATE POLICE
4124 KANAWHA TURNPIKE
SOUTH CHARLESTON, WV
25309 304-746-2141

DATE PRINTED	TERMS OF SALE	SHIP VIA	F.O.B.	FREIGHT TERMS
08/10/2011				

BID OPENING DATE: **09/13/2011** BID OPENING TIME **01:30PM**

LINE	QUANTITY	UOP	CAT. NO.	ITEM NUMBER	UNIT PRICE	AMOUNT

CONTACT PERSON (PLEASE PRINT CLEARLY):						

***** THIS IS THE END OF RFQ DPS1203 ***** TOTAL:						N/A
Craig Baker, Associate AIA, Project Manager 30 Columbia Boulevard Clarksburg, WV 26301 Phone: 304-624-4108 Direct Line: 304-326-6388 E-mail: cbaker@thrashereng.com						

SEE REVERSE SIDE FOR TERMS AND CONDITIONS

SIGNATURE 	TELEPHONE 1-304-624-4108	DATE September 9, 2011
TITLE Principal-In-Charge	FEIN 5506335966	ADDRESS CHANGES TO BE NOTED ABOVE

WHEN RESPONDING TO RFQ, INSERT NAME AND ADDRESS IN SPACE ABOVE LABELED 'VENDOR'

RFQ No. DPS1203

STATE OF WEST VIRGINIA
Purchasing Division

PURCHASING AFFIDAVIT

West Virginia Code §5A-3-10a states: No contract or renewal of any contract may be awarded by the state or any of its political subdivisions to any vendor or prospective vendor when the vendor or prospective vendor or a related party to the vendor or prospective vendor is a debtor and the debt owed is an amount greater than one thousand dollars in the aggregate.

DEFINITIONS:

"Debt" means any assessment, premium, penalty, fine, tax or other amount of money owed to the state or any of its political subdivisions because of a judgment, fine, permit violation, license assessment, defaulted workers' compensation premium, penalty or other assessment presently delinquent or due and required to be paid to the state or any of its political subdivisions, including any interest or additional penalties accrued thereon.

"Debtor" means any individual, corporation, partnership, association, limited liability company or any other form or business association owing a debt to the state or any of its political subdivisions. "Political subdivision" means any county commission; municipality; county board of education; any instrumentality established by a county or municipality; any separate corporation or instrumentality established by one or more counties or municipalities, as permitted by law; or any public body charged by law with the performance of a government function or whose jurisdiction is coextensive with one or more counties or municipalities. "Related party" means a party, whether an individual, corporation, partnership, association, limited liability company or any other form or business association or other entity whatsoever, related to any vendor by blood, marriage, ownership or contract through which the party has a relationship of ownership or other interest with the vendor so that the party will actually or by effect receive or control a portion of the benefit, profit or other consideration from performance of a vendor contract with the party receiving an amount that meets or exceeds five percent of the total contract amount.

EXCEPTION: The prohibition of this section does not apply where a vendor has contested any tax administered pursuant to chapter eleven of this code, workers' compensation premium, permit fee or environmental fee or assessment and the matter has not become final or where the vendor has entered into a payment plan or agreement and the vendor is not in default of any of the provisions of such plan or agreement.

Under penalty of law for false swearing (*West Virginia Code §61-5-3*), it is hereby certified that the vendor affirms and acknowledges the information in this affidavit and is in compliance with the requirements as stated.

WITNESS THE FOLLOWING SIGNATURE

Vendor's Name: Thrasher Engineering, Inc.

Authorized Signature: *CW M Byrd* Date: 9-9-11

State of West Virginia

County of Harrison, to-wit:

Taken, subscribed, and sworn to before me this 9th day of September, 2011.

My Commission expires October 26, 2019, 20 .

AFFIX SEAL HERE

NOTARY PUBLIC *J. Sue Schmidt*

