

Expression of Interest
Architectural/Engineering Services
For
55 County Courthouses
Facility Needs Assessment
RFQ # CFA100611



West Virginia Purchasing Division
Frank Whittaker Buyer

J. Dan Snead & Associates
ARCHITECTS
Beckley, West Virginia

RECEIVED
2011 NOV 15 A 11: 32
PURCHASING DIVISION
STATE OF WV



J. DAN SNEAD AND ASSOCIATES, INC.

ARCHITECTS

PLANNERS

November 14, 2011

State of West Virginia
Department of Administration
Purchasing Division
Mr. Frank Whittaker, Buyer
2019 Washington Street, East
PO Box 50130
Charleston, WV 25305-0130

Re: Architectural/Engineering Services
Facility Needs Assessment – 55 County Courthouses
CFA100611

Dear Mr. Whittaker:

It is with enthusiasm that I submit this letter of interest and qualifications for Architectural/Engineering design services for facility needs assessment for each of the 55 county courthouses throughout the state of West Virginia.

Our relevant experience includes courthouse related projects in Webster, Nicholas, Fayette, Summers and Raleigh counties.

Related experience includes the Judicial Annex Building for Fayette County and the adaptive re-use of an existing building to develop a new Judicial facility in Summers County. These projects involved close coordination between the County Commission, Building Commission, State Supreme Court and the various agencies occupying these facilities. Additionally, we provided schematic design and planning services for a Judicial Annex in Mercer County.

Relevant work includes several improvement projects with Fayette County and Summers County as the result of grants from the Courthouse Improvement Authority.

As part of our team, we have included Harper Engineering for plumbing, mechanical and electrical issues. Harper Engineering is currently working with us on courthouse improvement projects and is very familiar with this type work.

101 NORTH KANAWHA STREET
SUITE 203
BECKLEY, WEST VIRGINIA 25801

PHONE: (304) 252-6630
FAX: (304) 252-4856

Our court facility related work has sensitized us to the historic significance of the unique architectural resource of our state courthouses and to the need to preserve and protect these iconic facilities. Additionally, we have worked closely with the administrative office of the West Virginia Supreme Court of Appeals to understand the operational standards of the various agencies occupying court facility buildings. We are also aware of the inherent danger potential in court proceedings which necessitates careful planning and a technical understanding of security systems.

We are comfortable with working with county commissions, the judiciary, historic preservation groups, the State of West Virginia Department of Culture and History and the West Virginia Courthouse Improvement Authority.

Letters of reference contained within this submittal will attest to our understanding of client's needs, budgets and time schedules, and perhaps more importantly, our unwavering commitment to project management and to our client's best interest.

We appreciate the opportunity to submit our expression of interest and look forward to hearing from you in the near future.

Sincerely,

A handwritten signature in blue ink, appearing to read "J. Dan Snead". The signature is stylized with large, looping letters.

J. Dan Snead, AIA

JDS:pcf

TABLE OF CONTENTS

Corporate Background

Evaluative Criteria

Resumes

References

Projects

Consultants:

Harper Engineering PLLC

**Architects
Planners**

CORPORATE
BACKGROUND



CORPORATE BACKGROUND

J. Dan Snead & Associates, Inc. is an Architectural firm founded on February 2, 1998, with the formation of a partnership including J. Dan Snead, AIA, Raymond E. Fink, Jr. and Steven D. Stone.

Dan Snead has thirty-five years of experience in architectural practice and was a principal and partner in a previous practice for ten years prior to organizing the firm.

Mr. Snead has a broad background in architectural design experience including educational and healthcare facilities, public housing, judicial, residential and general commercial design.

Dan is currently a licensed architect in West Virginia and in response to the growing practice is seeking certification in other states. He is a member of the AIA and the West Virginia Society of Architects and is certified by the National Council of Architectural Registration Boards. Dan has become recognized as one of the leading architects in the state of West Virginia.

J. Dan Snead & Associates, Inc. has vast experience with a variety of projects and fully believes that each project requires a completely coordinated development from concept through design and construction. We focus our expertise on designing projects that are sensitive to our client's needs and projects that utilize the client's investment dollars to the greatest advantage. Our entire organization is dedicated to the achievement of project designs that are aesthetically pleasing, functional, and consistent with available funds.

The strengths of our firm lie in our talented staff, experience, and the ability to perform architectural services efficiently from inception to completion. We have but one simple goal - provide each client with the project they envisioned in an attentive, professional manner and to bring each project to a positive and successful conclusion.

**Architects
Planners**

EVALUATIVE CRITERIA



EVALUATIVE CRITERIA

J. Dan Snead & Associates, Inc. has extensive experience in the design of educational, commercial and governmental facilities. Our staff has designed new educational facilities in Nicholas, Raleigh, Summers and Hardy counties. Some of our other projects involve renovations to existing educational institutions including: Southern West Virginia Community College, Concord College, Bluefield State College, West Virginia Schools for the Deaf and Blind, and various facilities in Wyoming, Marion and Raleigh counties. Our designs were also incorporated in the Valley One Office Building and the West Virginia State Office Building. Locally, some of our recent projects include the design of the new Shady Spring Junior High, a new administrative office complex for the Raleigh County Solid Waste Authority and the new Pioneer Community Bank, Sophia Branch, a new EOC/911 facility in Raleigh County, a new Health Sciences Building for Mountain State University in Beckley and miscellaneous public facilities in Fayette County, West Virginia.

The firm's principals, J. Dan Snead, AIA, and Raymond E. Fink, Jr. actively participate and supervise all aspects of design and construction administration employing a wealth of knowledge amassed through many dedicated years of experience.

Our firm is committed to the team concept of design and production. We recognize the value of establishing quality communications with the design committee as a means of thoroughly understanding the design objectives, program requirements and project budget. Through utilization of this concept, project owners are valued as a member of our team from the schematic phase through the completion of the project.

Dan Snead, AIA, has a history of providing aesthetically pleasing designs within budget limitations by avoiding trendy design issues and by steadfastly adhering to the "elegance of simplicity." His projects are applauded for their design and for their high value/cost ratio.

Through many years of experience, the firm's principals have refined the ability to evaluate the probable construction costs in the project programming stage to allow us to assess the appropriateness of the proposed budget related to the proposed scope of work.

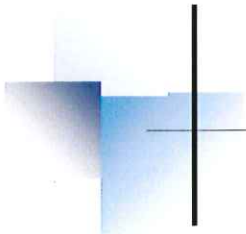

J. Dan Snead & Associates uses the latest computer and software technology, ARRIS Version 9.0 and AutoCAD 2007, to produce all of our design documents. Combined with the gifted architectural designers in our firm, our computers provide precise, accurate drawings, which translate into lower bid costs from contractors and fewer change orders. Our record regarding change orders is one of the industry's best and our goal is to have few, if any, change orders on all projects.

J. Dan Snead & Associates is enthusiastic about the prospect of working with you. We pledge sensitivity to your needs, attention to detail, and the relentless pursuit of excellence.

**Architects
Planners**

RESUMES

J. DAN SNEAD, AIA

EDUCATIONAL BACKGROUND

West Virginia Institute of Technology, 1965

REGISTRATIONS & MEMBERSHIPS

National Council of Architectural Registration Boards
The Board of Architects, State of West Virginia, 1608
American Institute of Architects
West Virginia Society of Architects

PROFESSIONAL EXPERIENCE

J. Dan Snead & Associates, Inc., Beckley, West Virginia
1998 - Present

Computects, Inc. - Beckley, West Virginia
1988 - 1998

Donald H. Stark Architects, Inc.
1973 - 1988

SUMMARY

Mr. Snead is a licensed architect in West Virginia and a member of the American Institute of Architects; the West Virginia Society of Architects; and is certified by the National Council of Architectural Registration Boards.

With over thirty-four years of experience in Architectural design and construction administration, Dan has developed a well known, excellent reputation within West Virginia for providing functional, aesthetically pleasing designs within budget limitations. His innovative designs and understanding of design objectives have rewarded him with a long list of satisfied, repeat clients.

His experience is extensive and varied and includes primary, secondary and higher education facilities; municipal and government facilities; administrative offices; industrial and commercial projects; as well as numerous renovation, rehabilitation and adaptive reuse projects. Many of the designs Dan has developed require significant sensitivity to historic issues, local codes, life safety and current ADA thinking.

Dan is dedicated to maintaining the highest levels of both professional and ethical standards and to the coordination of teamwork both with the Owner and construction professionals to bring to each project a positive and successful conclusion.



RAYMOND E. FINK, JR.

EDUCATIONAL BACKGROUND

Bluefield State College - A.S. Civil Engineering Technology, 1972 - 1974

Mercer County Vocational Technical School - Civil Engineering Technology, 1971 - 1972

REGISTRATIONS

Licensed Land Surveyor, West Virginia, 1989
Certified Surface Mine Foreman, West Virginia, 1977

PROFESSIONAL EXPERIENCE

J. Dan Snead & Associates, Inc., Beckley, West Virginia
1998 - Present

Almes & Associates, Inc., Beaver, West Virginia
1997 - 1998

Computects, Inc., Beckley, West Virginia
1984 - 1997

Oscar Vecellio, Inc., Beckley, West Virginia
1976 - 1983

SUMMARY

Raymond has more than thirty-three years of experience in the fields of Civil Engineering and Architecture. He has worked as Party Chief and Chief of Surveys directing boundary and topographic field surveys as well as construction layout. He has also served as foreman and cost estimator for various site construction projects spanning a period of nine years.

For more than twenty years, Raymond has worked in construction administration for various architectural projects including site inspections and review of submittals. He has been responsible for the preparation of all architectural drawings for residential, educational and commercial facilities.

As well as his unique surveying, engineering and architectural background, Raymond commands a wealth of computer knowledge. He has served as the Systems Administrator for computer operations and is proficient in the use of AutoCAD 2007 and ARRIS Version 9.0.



DONALD H. NORMAN, II

EDUCATIONAL BACKGROUND

Bluefield State College - B.S. Mining Engineering
Technology, 1986

PROFESSIONAL EXPERIENCE

J. Dan Snead & Associates, Inc., Beckley, West Virginia
2001 - Present

Pentree, Inc., Princeton, West Virginia
1994 - 2001

Computects, Inc., Beckley, West Virginia
1987 - 1993

SUMMARY

Don has more than nineteen years of experience in the fields of Architecture and Civil Engineering. This experience is primarily in the design and detailing of bidding documents and project administration with some civil engineering experience in the field as well.

Don has served as an architectural designer for various construction projects during the last six years and has served as an engineering technician for construction projects spanning a period of seven years.

He has been responsible for the preparation of architectural drawings for residential, educational and commercial facilities. He has also been responsible for the preparation of engineering drawings for water and sanitary sewer projects as well as West Virginia Department of Transportation projects.

**Architects
Planners**

REFERENCES

J. Dan Snead & Associates, Inc.

References

Debbie Berry, County Administrator
Fayette County Commission
(304) 574-4290

Matthew D. Wender, President
Fayette County Commission
(304) 574-4290

Jerry E. Berry, President
Summers County Commission
(304) 466-7100

David Neal, E-911 Coordinator/Deputy OES Director
Fayette County OES/E-911 Center
(304) 574-3590

Vicki Hinerman, Superintendent
Summers County Schools
(304) 466-6000

Jeff Brewer, Supervisor of Buildings and Grounds
Wyoming County Board of Education
(304) 732-6262

David Quisenberry, Director of Services
Summers County Board of Education
(304) 466-6007

Mr. Phillip Jarrell, Director of Purchasing
Raleigh County Board of Education
(304) 256-4651

Kenny Thompson, Owner
Country Roads Pharmacy
(304) 934-5327

Dan Bickey, Owner
Mine Power Systems
(304) 252-2509



**Architects
Planners**

PROJECTS

FAYETTE COUNTY COURTHOUSE



A schematic study was prepared for the Fayette County Courthouse to resolve ADA issues and security circulation.

Since no original drawings for the Courthouse could be located, measurements had to be taken for the entire facility. The existing conditions were drawn and then modified to reflect proposed changes.

Design considerations included sensitive historical matters, traditional courthouse public traffic routes, courtroom security, accessibility and project cost.

*Fayetteville, WV
Fayette County*

Projected cost \$300,000

J. Dan Snead & Associates, Inc.

SUMMERS COUNTY COURTHOUSE and MEMORIAL BUILDING



The Summers County Courthouse and adjacent Memorial Building have been studied for the purpose of finding ways to join them together to solve accessibility and courtroom security problems.

A unique solution was found allowing one elevator to be built which would serve both buildings. Design considerations included: historic sensitivity, existing structure and office layout, five different floor levels within the two buildings and two completely different architectural styles.

*Hinton, WV
Summers County*

Projected cost \$406,000

J. Dan Snead & Associates, Inc.

BARBOUR COUNTY COURTHOUSE



The Barbour County Courthouse, built between 1903 and 1905, is a monumental public building which was added to the National Register of Historic Places in 1980. Restoration efforts have been undertaken and in 1999 the Courtroom restoration work was awarded "Best Interior Rehabilitation Project."

The structure is a classic example of the Richardsonian Romanesque Architectural Style. It is an imposing building in Philippi and is clearly an icon in the community.

A study was made to determine the condition of the existing original windows. A report with recommendations has been submitted to the Barbour County Commission which will be used to justify a grant request to replace the windows in this historic building.

Careful and sensitive consideration of the historic integrity of the Courthouse will be required for any remedial work.

The estimated cost of window replacement including hazardous waste removal is approximately \$300,000.00.

***Philippi, WV
Barbour County***

Estimated Cost \$300,000

J. Dan Snead & Associates, Inc.

WEBSTER COUNTY COURTHOUSE



A schematic study was performed for the 100 year old Webster County Courthouse for the purpose of upgrading ADA and security issues to current standards.

Significant interior renovations are required to accommodate Courthouse accessibility and the items in the State Supreme Court Security Audit.

The schematic design focused on isolating jurors and provided security corridors for the judiciary. Additionally, courtroom access was controlled by structural modifications and security devices.

The completion of the project is pending funding.

*Webster Springs, WV
Webster County*

Projected cost \$300,000

J. Dan Snead & Associates, Inc.

RALEIGH COUNTY COURTHOUSE



*Courtroom Renovations
Beckley, WV*

Total Project Cost: \$150,000

Courtroom renovations to the Raleigh County Courthouse involved converting one large Circuit Courtroom into two smaller facilities. The design employed a unique circular litigation area surrounded by attorneys, litigants, officers of the court, jurors, and spectators. Design problems included the complete acoustical separation of the two courtrooms and the production of a high-quality facility within a restrictive budget. The project was a complete success and has been applauded by all who use it.



J. Dan Snead & Associates, Inc.

NICHOLAS COUNTY COURTHOUSE



Summersville, WV

Renovations

Total Project Cost: \$300,000

The Nicholas County Courthouse Courtroom Renovation Project was jointly sponsored by the West Virginia State Supreme Court and the Nicholas County Commission.

This project was primarily focused on upgrading courtroom security and the need to completely refurbish the aging courtroom.

Work included a new security corridor with security devices, a new jury room, judges chamber, holding rooms, witness rooms, library and renovated courtroom.

Owing to the historic nature of the courthouse, design concepts were sensitive to the traditional nature of the building.



J. Dan Snead & Associates, Inc.

WV STATE OFFICE BUILDING



Beckley, WV

Total Project Cost: \$3.2 Million

The State Office Building, located in Beckley, West Virginia, was developed as a downtown revitalization project.

The original building was abandoned and previously housed a J.C. Penney retail store. The five story facility was completely renovated to contain various state agencies.

A five story addition containing 20,000 square feet was added to the back of the building bringing the total developed space to 46,000 square feet.

Design challenges included giving the original building a totally new look, while maintaining existing openings and structural elements. Additionally, it was important to provide a design that was in harmony with the existing downtown environment.

This project was completed on time, within budget, and with no change orders.

J. Dan Snead & Associates, Inc.

Raleigh Playhouse Theater



Beckley, West Virginia Raleigh County

Estimated Project Budget: \$1,000,000

The Raleigh Playhouse Theater project is an adaptive reuse of an existing downtown Beckley building.

The original building contained a retail store and doctor's office. The renovated building will contain a small, intimate theater with a projection stage and fly gallery, offices, rehearsal room and dressing rooms. Additionally, an upscale lounge will be located on the lower floor below the theater.

The new facility is expected to support small theater stage productions, musical groups, classic cinema, art films and perhaps film festivals.

The estimated cost of development is anticipated to be approximately \$1,000,000.00.

J. Dan Snead & Associates, Inc.

Mountain State University Health Science Building



The recently completed Health Science Building on the campus of Mountain State University was constructed with a grant from the U.S. Government

The building contains five science laboratories, a nursing education center, two elevated lecture rooms, a large testing center, administrative offices and various support facilities. Total building area is 26,000 sf.

The budget of \$4,300,000 included construction costs and A/E fees, produced a unit cost of \$165.00 per square foot.

A unique feature of construction includes a three story tinted glass entry with concentric brick arches.

The new science facility includes the latest information technology.



*Beckley,
West Virginia*

Total Project Budget: \$4,300,000

J. Dan Snead & Associates, Inc.

RALEIGH COUNTY EOC/911 CENTER



Beaver, West Virginia
Projected cost \$2.4 million
14000 Square Feet
\$172 per sq. ft.

The new Raleigh County EOC/911 Center is located on a wooded four-acre site in an industrial park near Beckley, West Virginia. The new facility is designed to accommodate normal 911 activity and is intended to act as a regional command center for emergency services during times of need. The new center features a secure, internal dispatch area, state-of-the-art communication and data systems, a large command center/board room, administrative wing, 3,000 square feet of emergency equipment storage and overnight accommodations for emergency staff. Additional features include masonry structure and a standing seam metal roof for low maintenance.

J. Dan Snead & Associates, Inc.

Pioneer Community Bank



Iaeger, West Virginia

Total Project Budget: \$1,600,000

The Pioneer Community main bank at Iaeger is modeled after a smaller branch bank that was designed by J. Dan Snead & Associates, Inc. in 1999.

The new bank contains 8,500 square feet and was constructed for \$188.00 per square foot.

The structure is steel frame with concrete floor slabs and metal stud partitions. The exterior is finished with brick and stucco and the roof is standing seam metal.

Interior finishes include ceramic tile lobby floor, cut pile plush carpet, dark stained wood wainscot, doors and trim and solid vinyl tile in utility areas.

J. Dan Snead & Associates, Inc.

SHADY SPRING MIDDLE SCHOOL



The recently completed Shady Spring Middle School project is part of a \$20,000,000 construction program undertaken by Raleigh County.

The new Shady Spring Middle School had a budget of over nine million dollars and was partially funded by a School Building Authority grant.

The new facility houses 600 students in three academic pods. It contains 78,000 square feet and features a unique design facilitating the middle school concept. Incorporated into the design is a centrally located administrative suite, media center, and commons area.

Additional features include three computer labs and an isolated, but easily accessible gymnasium.

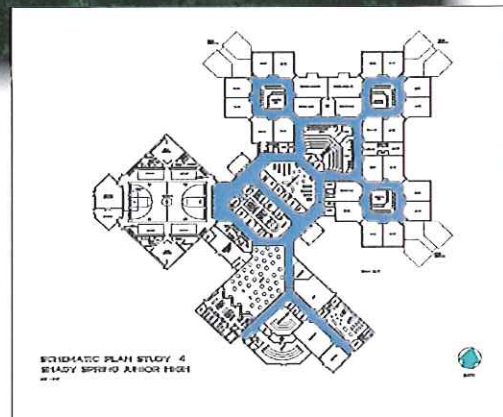

*Shady Spring, WV
Raleigh County*

Total Project Budget: \$9,500,000

J. Dan Snead & Associates, Inc.

Fairdale Elementary School



The currently under construction Fairdale Elementary School is funded in part by a School Building Authority Grant.

The school population is approximately 500 and the building footprint contains 52,000 square feet.

The budget of \$8,422,000 which includes construction costs and A/E fees, produces a unit cost of \$162.00 per square foot.

Unique features of construction include a gymnasium, sloping roof, ceramic tile in all corridors and a media center with a two tier computer lab.

The new Fairdale Elementary includes the latest technology in classroom security.



*Fairdale, WV
Raleigh County*

Total Project Budget: \$8,422,000

J. Dan Snead & Associates, Inc.

Talcott Elementary School



The currently under construction Talcott Elementary School completes the construction programs of Summers County Schools by replacing the 72 year old existing building.

The new elementary school had a five million, three hundred thirty thousand dollar budget and was funded by a School Building Authority Grant. The student population is approximately 200 and the building area is 26,000 square feet.

The plan features a central Administration Area, Media Center, Multipurpose Room and Dining Hall flanked on both sides by classroom wings.

Additional features include an isolated bus loop and the latest technology in school security.

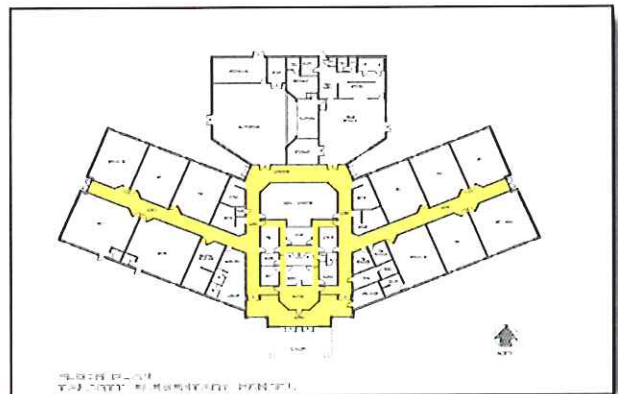

*Talcott, WV
Summers County*

Total Project Budget: \$5,330,000

J. Dan Snead & Associates, Inc.

INDEPENDENCE JUNIOR HIGH



Sophia, WV

New Construction

Total Project Cost: \$6 Million

Independence Junior High School was designed to provide the Owners a functional and attractive facility on a predetermined budget and area. The school was designed for the inclusion of the Creative Learning Systems, Inc., "Lab 2000". With this system, students can integrate today's technology with the classroom. Computers provide the students the opportunity to study manufacturing, communication, transportation, and construction technologies in their own environment. Innovative gymnasium design provided an additional 3,000 square feet at little, if any, cost to the Owner and produced a gymnasium that complemented the layout of the school. The combination of all the special ingredients in Independence Junior High School has provided Raleigh County with a unique educational facility to be utilized by students and faculty for many generations.

J. Dan Snead & Associates, Inc.

MOOREFIELD MIDDLE SCHOOL



Moorefield, WV

New Construction

Total Project Cost: \$6.4 Million

The Moorefield Middle School design concept was based on the desire of Hardy County Administrators to create a true middle school. The facility drew fifth and sixth grade students from Moorefield Elementary and seventh and eighth grade students from Moorefield High.

The new school is located on gently sloping farm land with vistas of the nearby mountains of the Potomac Highlands.

Innovations included separate bus and public circulation routes providing maximum student safety, a spacious library equally accessible from both education pods, a computer lab with all monitors visible from a central location, and a unique gymnasium which is fully air conditioned.

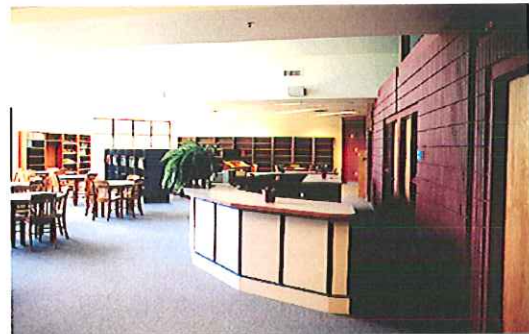

J. Dan Snead & Associates, Inc.

SUMMERS COUNTY HIGH SCHOOL



Hinton, WV

New Construction

Total Project Cost: \$6 Million

Summers County High School is a comprehensive facility which includes the Summers County Career Center.

Unusual design considerations involved an extremely linear site bounded by a river, a railroad, a stadium and a recreation park. Additional site considerations included the three existing buildings of the Career Center and circulation access to the county football stadium. Additionally, there was a desire to limit the new construction to a single story.

The school includes a competition gymnasium, a centrally located library and an auditorium.

J. Dan Snead & Associates, Inc.

SUMMERSVILLE JUNIOR HIGH SCHOOL



Summersville, WV

New Construction

Total Project Cost: \$5.2 Million

The Summersville Junior High School was constructed as part of a \$9,000,000.00 bond program supported by the residents of Nicholas county.

The total project cost of 5.2 million dollars constructed a school of 92,000 square feet and includes a unique gymnasium, band music suite, kitchen, cafeteria, high-tech science facilities and a library.

The school, which is the result of a sensitive design approach coupled with the dedicated efforts of an involved administration, has produced an exemplary facility representing a high value to cost ratio.

J. Dan Snead & Associates, Inc.

PIONEER COMMUNITY BANK



The Pioneer Community Bank is a new branch facility located at the Lester Square Shopping Center. The facility is constructed with wood frame, EIFS exterior, metal roof, aluminum entry and clad windows providing a maintenance free exterior.

The exterior design is somewhat monumental and employs fluted, oversized columns to produce a sense of solidity and tradition.

Interior finishes are of high quality and were selected for durability and quiet elegance.

Design features include a vaulted entry canopy, which extends from the exterior through the lobby and terminates at the teller stations. A partial second floor allows a Board Room with dormer windows and a large storage space.



Sophia, WV

Total Project Cost: \$420,400

J. Dan Snead & Associates, Inc.

RALEIGH REGIONAL CANCER TREATMENT CENTER



Chemotherapy Outpatient Addition

The new addition was designed to harmonize with the original building design and to significantly increase patient capacity.

The 2,600 square feet addition includes a large treatment room with vaulted ceiling and clerestory, doctor's offices, exam rooms, nurse's station and laboratory.

Design and construction problems included matching original building materials and maintaining patient caseload during normal construction activities.

The project was completed on time and under budget



Beckley, WV

Total Project Cost: \$360,000

J. Dan Snead & Associates, Inc.

RALEIGH COUNTY SOLID WASTE AUTHORITY



Lanark, WV

New Construction

Total Project Cost: \$357,525

The Raleigh County Solid Waste Authority requested that their new administrative office be designed to reflect the progressive and highly professional philosophies of the Authority and its staff.

The design accommodates anticipated future space needs of the Authority as well as a technology infrastructure which insures the efficient operation of the facility.

Exterior and interior materials were selected for durability and to be low maintenance over an extended period of time.

The location of the building on the site considered ease of public access and a very attractive view from the Board Room overlooking active and completed landfill cells.

Building features include a hexagonal vaulted center section divided into a Board Room and Entry Lobby. The vaulted ceiling is formed by laminated wood beams and decking. Large windows with curved overpanels provide abundant visual access to the view beyond.



J. Dan Snead & Associates, Inc.

J. DAN SNEAD & ASSOCIATES

**Architects
Planners**

Harper Engineering, PLLC



H a r p e r E n g i n e e r i n g , p l l c

5 2 B S t r e e t
S t . A l b a n s , W V 2 5 1 7 7
O f f i c e : 3 0 4 . 7 2 2 . 3 6 0 2 F a x : 3 0 4 . 7 2 2 . 3 6 0 3

Harper Engineering,pllc was founded in 2008 to provide innovative engineering design services to architects, owners and contractors throughout the state. We are a unique combination of eager young talent and proven experience fused together to serve all of your building systems design needs including HVAC, plumbing, lighting, electrical, and Fire Alarm.

Our goal is to design optimized systems that meet all of our client's performance, energy use, and budgetary needs. The staff at Harper Engineering has a combined 85 years of experience working with clients in a variety of fields including but not limited to K-12 Schools, hospitals, offices, airports, manufacturing, and water treatment plants.

Services:

HVAC Design

- Heating and Cooling load calculations
- Ductwork sizing
- Hydronic pipe sizing
- Equipment selection

Electrical Design

- Electrical load calculations
- Panel and switch gear selection
- Lighting
- Fire alarm
- Site Utilities
- Emergency Generators
- Security and communications

Plumbing Design

- Pipe Sizing
- Fixture Selection
- Sprinkler design
- Site Utilities

Drafting

- Specifications
- Project Management
- Construction Documents

H a r p e r E n g i n e e r i n g , p l l c

5 2 B S t r e e t
S t . A l b a n s , W V 2 5 1 7 7
O f f i c e : 3 0 4 . 7 2 2 . 3 6 0 2 F a x : 3 0 4 . 7 2 2 . 3 6 0 3



Jason E. Harper, PE
(304)-541-1390
jason@harperengwv.com

Education

West Virginia University Institute of Technology
Montgomery, WV
Bachelor of Science-Mechanical Engineering

Registrations/Professional Affiliations

Licensed Professional Engineer – WV, KY, MD
ASHRAE
NFPA

Experience

Jason E. Harper, PE brings 9 years design experience to our firm. He has experience with HVAC, Electrical, plumbing, and fire alarm system design. His projects include educational facilities (including colleges and universities), health care facilities, office buildings, banks, emergency services facilities, postal facilities, and government buildings.

Projects

W. Kent Carper Justice and Public Safety Complex
Oak Hill Police Station
Addition to Boone Co Courthouse Annex
Raleigh Co 911 Center
Addition and Renovation to Geary School
Baileysville Elem. HVAC Renovations
Dominion Gas Office Building
Renovations to Glenville ES
Addition to Shady Spring Middle School
Addition and Renovations to Flinn Elementary
Renovations to Park Middle School



52 B Street
St. Albans, WV 25177
Office: 304.722.3602 Fax: 304.722.3603

Kevin Mark King, PE
mark@harperengwv.com

Education

West Virginia University Institute of
Technology Montgomery, WV
Bachelor of Science-Electrical Engineering

Bluefield State College
Bluefield, WV
Bachelor of Science-Computer Science

Wytheville Community College
Wytheville, VA
Associate Applied Science – Computer Information Systems

Registrations/Professional Affiliations

WV licensed Professional Engineer
WV licensed Master Electrician

Experience

Kevin Mark King, PE brings 6 years of electrical design experience and over 10 years of electrical construction/maintenance experience to our firm. His projects include educational facilities (including colleges and universities), health care facilities, office buildings, emergency services facilities, government buildings and industrial projects.

Projects

Raleigh Co. 911 Center
Mason County 911 Center
WVARNG Fire Station
Sissonville Middle School
Greenbrier West High School Renovation
WVU Tech Printing Innovation Center
Talcott Elementary School



Scott D. Phillips
(304)-722-3602
Scott@harperengwv.com

Registrations/Professional Affiliations

American Society of Plumbing Engineers

Experience

Scott D. Phillips brings 26 years design experience to our firm. He has experience with mechanical, electrical, plumbing and fire suppression system design. His projects include educational facilities (including colleges and universities), health care facilities, office buildings, banks, emergency services facilities, postal facilities, and government buildings.

Projects

W. Kent Carper Justice and Public Safety Complex
Oak Hill Police Station
Addition to Boone Co. Courthouse Annex
Renovations to Glenville ES
Renovations to Burnsville ES
Terra Alta ES Fire Alarm
Timber's Lodge
Additions and Renovations to Little Birch Elementary
Moses Factory Outlet- Teays Valley
Dominion Gas Office Building
Fairmount State University WV Folk Life Center
Raleigh Co. BOE Credit Union
Rahall Technology and Business Center Community Based Outpatient Clinic
Renovations to Davis ES



52 B Street
St. Albans, WV 25177
Office: 304.722.3602 Fax: 304.722.3603

Barbour County Court House: Complete HVAC renovation for 12,000 sq ft historic building.

Fayette County Court House: HVAC Boiler replacement and Electrical upgrades for Court House building.

Summers County Court House: HVAC Boiler replacement and HVAC control improvements for Court House building.

Fairmont State College WV Folklife Center: HVAC, Plumbing, Electrical, Fire Alarm, and Sprinkler design for a renovation to a 6,100 sq ft historic building.

Baileysville Elementary School HVAC Renovations: HVAC and Electrical design for new HVAC, Lighting, and electrical Service.

Wyoming County CEFP: County wide review of all Schools in the county to provide assessment of current building condition and outline future improvements for each of the 14 Schools.

Upshur County CEFP: County wide review of all Schools in the county to provide assessment of current building condition and outline future improvements for each of the 9 Schools.

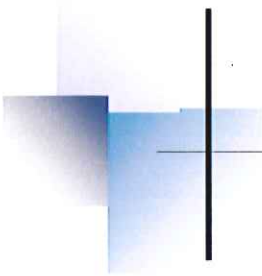

What is the recipe for successful achievement? To my mind there are just four essential ingredients: Choose a career you love, give it the best there is in you, seize your opportunities, and be a member of the team.

Benjamin F. Fairless

J. DAN SNEAD AND ASSOCIATES, INC.

J. Dan Snead, AIA
Email: dsnead8@frontier.com

Raymond E. Fink
Email: rfink5@frontier.com

Donald Norman, II
Email: dhnorman1@frontier.com

101 NORTH KANAWHA STREET
SUITE 203
BECKLEY, WEST VIRGINIA 25801

PHONE: (304) 252-6630
FAX: (304) 252-4856