



State of West Virginia
Department of Administration
Purchasing Division
2019 Washington Street East
Post Office Box 50130
Charleston, WV 25305-0130

WV PURCHASING ACA SECT Fax 304-558-4115

May 25 2012 03:40pm P001/003

Request for Quotation

RFP NUMBER
AGR1235

PAGE
1

ADDRESS CORRESPONDENCE TO ATTENTION OF
FRANK WHITTAKER
304-558-2316

RFQ COPY

TYPE NAME/ADDRESS HERE

Schwan's Food Service, Inc.
115 West College Drive
Marshall, MN 56258

DEPARTMENT OF AGRICULTURE

FOOD DISTRIBUTION PROGRAM
1 CEDAR LAKES DRIVE
RIPLEY, WV
25271 304-558-2221

DATE PRINTED	TERMS OF SALE	SHIP VIA	FOB	FREIGHT TERMS
05/25/2012				
BID OPENING DATE:	06/07/2012	BID OPENING TIME	01:30PM	

LINE	QUANTITY	UOP	CAT NO	ITEM NUMBER	UNIT PRICE	AMOUNT
***** ADDENDUM NO. 1 *****						
THIS ADDENDUM IS ISSUED TO:						
1) PROVIDE THE ATTACHED CHANGES TO THE SPECIFICATIONS.						
2) EXTEND THE BID OPENING DATE AND TIME TO: 06/07/2012 AT 1:30 PM.						
***** END ADDENDUM NO. 1 *****						
0001	1	LS		385-42		
PROCESSING USDA COMMODITY MOZZARELLA CHEESE						
***** THIS IS THE END OF RFQ AGR1235 ***** TOTAL:						

RECEIVED

2012 MAY 31 AM 9:52

WV PURCHASING
DIVISION

SEE REVERSE SIDE FOR TERMS AND CONDITIONS

SIGNATURE <i>Jim Peep</i>	TELEPHONE 800-533-5290 ext. 77759	DATE 5/29/2012
TITLE Division Controller	FEIN 58-1972868	ADDRESS CHANGES TO BE NOTED ABOVE

WHEN RESPONDING TO RFQ, INSERT NAME AND ADDRESS IN SPACE ABOVE LABELED 'VENDOR'

GENERAL TERMS & CONDITIONS REQUEST FOR QUOTATION (RFQ) AND REQUEST FOR PROPOSAL (RFP)

1. Awards will be made in the best interest of the State of West Virginia.
 2. The State may accept or reject in part, or in whole, any bid.
 3. Prior to any award, the apparent successful vendor must be properly registered with the Purchasing Division and have paid the required \$125 fee.
 4. All services performed or goods delivered under State Purchase Order/Contracts are to be continued for the term of the Purchase Order/Contracts, contingent upon funds being appropriated by the Legislature or otherwise being made available. In the event funds are not appropriated or otherwise available for these services or goods this Purchase Order/Contract becomes void and of no effect after June 30.
 5. Payment may only be made after the delivery and acceptance of goods or services.
 6. Interest may be paid for late payment in accordance with the *West Virginia Code*.
 7. Vendor preference will be granted upon written request in accordance with the *West Virginia Code*.
 8. The State of West Virginia is exempt from federal and state taxes and will not pay or reimburse such taxes.
 9. The Director of Purchasing may cancel any Purchase Order/Contract upon 30 days written notice to the seller.
 10. The laws of the State of West Virginia and the *Legislative Rules* of the Purchasing Division shall govern the purchasing process.
 11. Any reference to automatic renewal is hereby deleted. The Contract may be renewed only upon mutual written agreement of the parties.
 12. **BANKRUPTCY:** In the event the vendor/contractor files for bankruptcy protection, the State may deem this contract null and void, and terminate such contract without further order.
 13. **HIPAA BUSINESS ASSOCIATE ADDENDUM:** The West Virginia State Government HIPAA Business Associate Addendum (BAA), approved by the Attorney General, is available online at www.state.wv.us/admin/purchase/vro/hipaa.html and is hereby made part of the agreement provided that the Agency meets the definition of a Cover Entity (45 CFR §160.103) and will be disclosing Protected Health Information (45 CFR §160.103) to the vendor.
 14. **CONFIDENTIALITY:** The vendor agrees that he or she will not disclose to anyone, directly or indirectly, any such personally identifiable information or other confidential information gained from the agency, unless the individual who is the subject of the information consents to the disclosure in writing or the disclosure is made pursuant to the agency's policies, procedures, and rules. Vendor further agrees to comply with the Confidentiality Policies and Information Security Accountability Requirements, set forth in <http://www.state.wv.us/admin/purchase/privacy/noticeConfidentiality.pdf>.
 15. **LICENSING:** Vendors must be licensed and in good standing in accordance with any and all state and local laws and requirements by any state or local agency of West Virginia, including, but not limited to, the West Virginia Secretary of State's Office, the West Virginia Tax Department, and the West Virginia Insurance Commission. The vendor must provide all necessary releases to obtain information to enable the director or spending unit to verify that the vendor is licensed and in good standing with the above entities.
 16. **ANTITRUST:** In submitting a bid to any agency for the State of West Virginia, the bidder offers and agrees that if the bid is accepted the bidder will convey, sell, assign or transfer to the State of West Virginia all rights, title and interest in and to all causes of action it may now or hereafter acquire under the antitrust laws of the United States and the State of West Virginia for price fixing and/or unreasonable restraints of trade relating to the particular commodities or services purchased or acquired by the State of West Virginia. Such assignment shall be made and become effective at the time the purchasing agency tenders the initial payment to the bidder.
- I certify that this bid is made without prior understanding, agreement, or connection with any corporation, firm, limited liability company, partnership, or person or entity submitting a bid for the same material, supplies, equipment or services and is in all respects fair and without collusion or fraud. I further certify that I am authorized to sign the certification on behalf of the bidder or this bid.

INSTRUCTIONS TO BIDDERS

1. Use the quotation forms provided by the Purchasing Division. Complete all sections of the quotation form.
2. Items offered must be in compliance with the specifications. Any deviation from the specifications must be clearly indicated by the bidder. Alternates offered by the bidder as **EQUAL** to the specifications must be clearly defined. A bidder offering an alternate should attach complete specifications and literature to the bid. The Purchasing Division may waive minor deviations to specifications.
3. Unit prices shall prevail in case of discrepancy. All quotations are considered F.O.B. destination unless alternate shipping terms are clearly identified in the quotation.
4. All quotations must be delivered by the bidder to the office listed below prior to the date and time of the bid opening. Failure of the bidder to deliver the quotations on time will result in bid disqualifications: Department of Administration, Purchasing Division, 2019 Washington Street East, P.O. Box 50130, Charleston, WV 25305-0130
5. Communication during the solicitation, bid, evaluation or award periods, except through the Purchasing Division, is strictly prohibited (W.Va. C.S.R. §148-1-6.6).

AGR1235

Section 4 of the specifications is changed to read as follows:

4. END PRODUCT DATA SCHEDULE (EPDS):

End Product Data Schedule (EPDS) forms and/or a Summary End Product Data Schedule (SEPDS) form with all applicable columns completed must be submitted for each end product and returned as part of the completed bid package.

ALL PRICING SUBMITTED ON EPDSs and/or SEPDSs and/or OTHERWISE SUBMITTED AS PART OF THE BID PACKAGE MUST BE THE ACTUAL MAXIMUM PRICE YOU WILL CHARGE WEST VIRGINIA FOR THE DURATION OF THIS AGREEMENT, NOT NATIONAL PRICES. ADDITIONALLY, ALL PRICES MUST BE BASED ON 100% YIELD ON A FEE-FOR-SERVICE BASIS. ALL EPDSs AND SEPDSs SHOULD BE ASCRIBED WITH ORIGINAL SIGNATURES IN BLUE INK. NEITHER ELECTRONIC NOR STAMPED SIGNATURES CAN BE ACCEPTED.

SEPDS A

SUMMARY END PRODUCT DATA SCHEDULE

VALUE PASS THROUGH SYSTEMS APPROVED:

☒ National Summary

(EPDS approved by USDA)

THIS IS AN ORIGINAL SUMMARY SCHEDULE UNLESS CHECKED BELOW:

☐ State Summary

(EPDS approved by state agency)

☒ Reflects Change in Formulation (Italic)☐ Additional Products Listed

Direct Sale



Refund to Recipient Agency



Net Price Through Distributor



Fee for Service (billed by Processor)



Fee for Service (billed by Distributor)

Information Certified as Accurate from Approved EPDS (requires signature from agency that approved EPDS)

Certified by State Agency

End Product Code & Description	Net Weight Per Case	Servings Per Case	Net Weight per Serving	Donated Food (Use commodity code and short title)		DF Inventory Drawdown per case	By Products Produced* (none unless box is checked)	Value per pound of DF (contract value)	Value of DF per case (F x H)	Effective Date	State Agency Acceptance/A approval
A	B	C	D		E	F	G	H	I	J	K
63912 - Sausage Breakfast Pizza	<input type="checkbox"/> 26.57	<input type="checkbox"/> 128	<input type="checkbox"/> 3.32	<input type="checkbox"/> B286	100418 FLOUR BAKER <input type="checkbox"/> HARD WHT UNBLCH BUL	6.57	<input type="checkbox"/>	\$0.2544	\$1.67		<input type="checkbox"/>
				A048	100332 TOMATO PASTE FOR BULK <input type="checkbox"/> PROCESSING	1.38		\$0.3786	\$0.52		
				B077	100042 CHEESE MOZZ LM PART SKIM <input type="checkbox"/> UNFZ PRO	2.56		\$1.5407	\$3.94		
68765 - SFS Big Daddy's WG Chese Fill Brdstek Blk	20.25	108	3.00	B286	100418 FLOUR BAKER <input type="checkbox"/> HARD WHT UNBLCH BUL	7.64		\$0.2544	\$1.94		
				A048	100332 TOMATO PASTE FOR BULK <input type="checkbox"/> PROCESSING			\$0.3786	\$0.00		
				B077	100042 CHEESE MOZZ LM PART SKIM <input type="checkbox"/> UNFZ PRO	6.75		\$1.5407	\$10.40		
73158 - Tony's Smart Whole Grain Cheese 50/50	27.60	96	4.60	B286	100418 FLOUR BAKER <input type="checkbox"/> HARD WHT UNBLCH BUL	6.30		\$0.2544	\$1.60		
<i>submit to USDA with mz changing on the approved</i>				A048	100332 TOMATO PASTE FOR BULK <input type="checkbox"/> PROCESSING	1.53		\$0.3786	\$0.58		
				B077	100042 CHEESE MOZZ LM PART SKIM <input type="checkbox"/> UNFZ PRO	4.50		\$1.5407	\$6.93		
73159 - Tony's Smart Whole Grain Pepp 50/50	26.88	96	4.48	B286	100418 FLOUR BAKER <input type="checkbox"/> HARD WHT UNBLCH BUL	6.30		\$0.2544	\$1.60		
<i>set up BOM</i>				A048	100332 TOMATO PASTE FOR BULK <input type="checkbox"/> PROCESSING	1.53		\$0.3786	\$0.58		
				B077	100042 CHEESE MOZZ LM PART SKIM <input type="checkbox"/> UNFZ PRO	3.33		\$1.5407	\$5.13		
78356 - 6" Cheese 51% Whole Grain	18.41	60	4.91	B286	100418 FLOUR BAKER <input type="checkbox"/> HARD WHT UNBLCH BUL	2.13		\$0.2544	\$0.54		
				A048	100332 TOMATO PASTE FOR BULK <input type="checkbox"/> PROCESSING	0.00		\$0.3786	\$0.00		
				B077	100042 CHEESE MOZZ LM PART SKIM <input type="checkbox"/> UNFZ PRO	4.02		\$1.5407	\$6.19		
78357 - 6" Pepperoni 51% Whole Grain	18.38	60	4.90	B286	100418 FLOUR BAKER <input type="checkbox"/> HARD WHT UNBLCH BUL	2.13		\$0.2544	\$0.54		
				A048	100332 TOMATO PASTE FOR BULK <input type="checkbox"/> PROCESSING	0.00		\$0.3786	\$0.00		
				B077	100042 CHEESE MOZZ LM PART SKIM <input type="checkbox"/> UNFZ PRO	4.27		\$1.5407	\$6.58		
78362 - Turkey Sausage Bagel (Red Sauce)	15.90	96	2.65	B286	100418 FLOUR BAKER <input type="checkbox"/> HARD WHT UNBLCH BUL	3.00		\$0.2544	\$0.76		
				A048	100332 TOMATO PASTE FOR BULK <input type="checkbox"/> PROCESSING	0.65		\$0.3786	\$0.25		
				B077	100042 CHEESE MOZZ LM PART SKIM <input type="checkbox"/> UNFZ PRO	3.96		\$1.5407	\$6.10		
78697 - 4x6 Pizza with Whole Grain Cheese 100% Mozz	27.00	96	4.50	B286	100418 FLOUR BAKER <input type="checkbox"/> HARD WHT UNBLCH BUL	6.30		\$0.2544	\$1.60		
				A048	100332 TOMATO PASTE FOR BULK <input type="checkbox"/> PROCESSING	1.51		\$0.3786	\$0.57		
				B077	100042 CHEESE MOZZ LM PART SKIM <input type="checkbox"/> UNFZ PRO	8.40		\$1.5407	\$12.94		
78698 - 4x6 with Whole Grain Pepp 100% Mozz	26.88	96	4.48	B286	100418 FLOUR BAKER <input type="checkbox"/> HARD WHT UNBLCH BUL	6.30		\$0.2544	\$1.60		
				A048	100332 TOMATO PASTE FOR BULK <input type="checkbox"/> PROCESSING	1.51		\$0.3786	\$0.57		
				B077	100042 CHEESE MOZZ LM PART SKIM <input type="checkbox"/> UNFZ PRO	6.66		\$1.5407	\$10.26		

PROCESSOR:

USDA APPROVAL:
School Year 2012-2013

STATE AGENCY APPROVAL:

Schwan's Food Service, Inc.	
Name of Company	
Marsha Rose, Director of Market Strategies	
Name and Title of Authorized Representative	
	5/29/2012
Signature	Date Signed

(not applicable for state summary)

FNS FDD HQ	
Name of Approving Agency	
Raymond Magee - Program Analyst	
Name and Title of Authorized Representative	
Signature	Date Signed

Name of Approving Agency	
Name and Title of Authorized Representative	
Signature	Date Signed

*If by products are produced, provide value and method credit will be given
 Value of NDM reduced from \$0.80 per pound to \$0.74 per pound for subcontractor's handling fee.



State of West Virginia
Department of Administration
Purchasing Division
2019 Washington Street East
Post Office Box 50130
Charleston, WV 25305-0130

Request for Quotation

RFQ NUMBER

AGR1235

PAGE

1

ADDRESS CORRESPONDENCE TO ATTENTION OF:

FRANK WHITTAKER
304-558-2316

*C29132658 800-533-5290
SCHWANS FOOD SERVICE INC
115 WEST COLLEGE DR

MARSHALL MN 56258

DEPARTMENT OF AGRICULTURE

FOOD DISTRIBUTION PROGRAM
1 CEDAR LAKES DRIVE
RIPLEY, WV
25271 304-558-2221

DATE PRINTED	TERMS OF SALE	SHIP VIA	F.O.B.	FREIGHT TERMS
05/02/2012				

BID OPENING DATE: 05/29/2012 BID OPENING TIME 01:30PM

LINE	QUANTITY	UOP	CAT NO	ITEM NUMBER	UNIT PRICE	AMOUNT
0001	1	LS		385-42		
PROCESSING USDA COMMODITY MOZZARELLA CHEESE						
THE WEST VIRGINIA PURCHASING DIVISON FOR THE AGENCY THE DEPARTMENT OF AGRICULTURE IS SOLICITING BIDS FOR AN OPEN-END CONTRACT FOR PROCESSING USDA MOZZARELLA CHEESE INTO MOZZARELLA CHEESE PRODUCTS PER THE ATTACHED SPECIFICATIONS.						
ALL TECHNICAL QUESTIONS MUST BE SUBMITTED IN WRITING TO FRANK WHITTAKER IN THE WV PURCHASING DIVISON VIA EMAIL AT FRANK.M.WHITTAKER@WV.GOV OR VIA FAX AT 304-558-4115. DEADLINE FOR TECHNICAL QUESTIONS IS 04/15/2012 AT 4:00 PM. ALL TECHNICAL QUESTIONS WILL BE ADDRESSED BY ADDENDUM AFTER THE DEADLINE.						
EXHIBIT 3						
LIFE OF CONTRACT: THIS CONTRACT BECOMES EFFECTIVE ON AND EXTENDS FOR A PERIOD OF ONE (1) YEAR OR UNTIL SUCH "REASONABLE TIME" THEREAFTER AS IS NECESSARY TO OBTAIN A NEW CONTRACT OR RENEW THE ORIGINAL CONTRACT. THE "REASONABLE TIME" PERIOD SHALL NOT EXCEED TWELVE (12) MONTHS. DURING THIS "REASONABLE TIME" THE VENDOR MAY TERMINATE THIS CONTRACT FOR ANY REASON UPON GIVING THE DIRECTOR OF PURCHASING 30 DAYS WRITTEN NOTICE.						
UNLESS SPECIFIC PROVISIONS ARE STIPULATED ELSEWHERE IN THIS CONTRACT DOCUMENT BY THE STATE OF WEST VIRGINIA, ITS AGENCIES, OR POLITICAL SUBDIVISIONS, THE						

SEE REVERSE SIDE FOR TERMS AND CONDITIONS

SIGNATURE <i>B. R. R.</i>	TELEPHONE 800-533-5290 ext.77759	DATE 5/24/2012
TITLE Vice President of Finance	FEIN 58-1972868	ADDRESS CHANGES TO BE NOTED ABOVE

WHEN RESPONDING TO RFQ, INSERT NAME AND ADDRESS IN SPACE ABOVE LABELED 'VENDOR'

RECEIVED

2012 MAY 25 AM 9:53

WV PURCHASING
DIVISION



State of West Virginia
Department of Administration
Purchasing Division
2019 Washington Street East
Post Office Box 50130
Charleston, WV 25305-0130

Request for Quotation

RFQ NUMBER

AGR1235

PAGE

2

ADDRESS CORRESPONDENCE TO ATTENTION OF:

FRANK WHITTAKER
304-558-2316

*C29132658 800-533-5290
SCHWANS FOOD SERVICE INC
115 WEST COLLEGE DR

MARSHALL MN 56258

DEPARTMENT OF AGRICULTURE

FOOD DISTRIBUTION PROGRAM
1 CEDAR LAKES DRIVE
RIPLEY, WV
25271 304-558-2221

DATE PRINTED	TERMS OF SALE	SHIP VIA	F.O.B.	FREIGHT TERMS
05/02/2012				
BID OPENING DATE: 05/29/2012		BID OPENING TIME 01:30PM		

LINE	QUANTITY	UOP	CAT NO	ITEM NUMBER	UNIT PRICE	AMOUNT
TERMS, CONDITIONS, AND PRICING SET FORTH HEREIN ARE FIRM FOR THE LIFE OF THE CONTRACT.						
RENEWAL: THIS CONTRACT MAY BE RENEWED UPON THE MUTUAL WRITTEN CONSENT OF THE SPENDING UNIT AND VENDOR, SUBMITTED TO THE DIRECTOR OF PURCHASING THIRTY (30) DAYS PRIOR TO THE EXPIRATION DATE. SUCH RENEWAL SHALL BE IN ACCORDANCE WITH THE TERMS AND CONDITIONS OF THE ORIGINAL CONTRACT AND SHALL BE LIMITED TO TWO (2) ONE (1) YEAR PERIODS.						
CANCELLATION: THE DIRECTOR OF PURCHASING RESERVES THE RIGHT TO CANCEL THIS CONTRACT IMMEDIATELY UPON WRITTEN NOTICE TO THE VENDOR IF THE COMMODITIES AND/OR SERVICES SUPPLIED ARE OF AN INFERIOR QUALITY OR DO NOT CONFORM TO THE SPECIFICATIONS OF THE BID AND CONTRACT HEREIN.						
OPEN MARKET CLAUSE: THE DIRECTOR OF PURCHASING MAY AUTHORIZE A SPENDING UNIT TO PURCHASE ON THE OPEN MARKET, WITHOUT THE FILING OF A REQUISITION OR COST ESTIMATE, ITEMS SPECIFIED ON THIS CONTRACT FOR IMMEDIATE DELIVERY IN EMERGENCIES DUE TO UNFORESEEN CAUSES (INCLUDING BUT NOT LIMITED TO DELAYS IN TRANSPORTATION OR AN UNANTICIPATED INCREASE IN THE VOLUME OF WORK.)						
QUANTITIES: QUANTITIES LISTED IN THE REQUISITION ARE APPROXIMATIONS ONLY, BASED ON ESTIMATES SUPPLIED BY THE STATE SPENDING UNIT. IT IS UNDERSTOOD AND AGREED THAT THE CONTRACT SHALL COVER THE QUANTITIES ACTUALLY ORDERED FOR DELIVERY DURING THE TERM OF THE CONTRACT, WHETHER MORE OR LESS THAN THE QUANTITIES SHOWN.						
BANKRUPTCY: IN THE EVENT THE VENDOR/CONTRACTOR FILES FOR BANKRUPTCY PROTECTION, THE STATE MAY DEEM THE						

SEE REVERSE SIDE FOR TERMS AND CONDITIONS

SIGNATURE <i>Ben Redman</i>	TELEPHONE 800-533-5290 ext.77759	DATE 5/24/2012
TITLE Vice President of Finance	FEIN 58-1972868	ADDRESS CHANGES TO BE NOTED ABOVE

WHEN RESPONDING TO RFQ, INSERT NAME AND ADDRESS IN SPACE ABOVE LABELED 'VENDOR'



State of West Virginia
Department of Administration
Purchasing Division
2019 Washington Street East
Post Office Box 50130
Charleston, WV 25305-0130

Request for Quotation

RFQ NUMBER

AGR1235

PAGE

3

ADDRESS CORRESPONDENCE TO ATTENTION OF

FRANK WHITTAKER
304-558-2316

*C29132658 800-533-5290
SCHWANS FOOD SERVICE INC
115 WEST COLLEGE DR

MARSHALL MN 56258

DEPARTMENT OF AGRICULTURE

FOOD DISTRIBUTION PROGRAM
1 CEDAR LAKES DRIVE
RIPLEY, WV
25271 304-558-2221

DATE PRINTED	TERMS OF SALE	SHIP VIA	F.O.B.	FREIGHT TERMS
05/02/2012				

BID OPENING DATE: 05/29/2012 BID OPENING TIME 01:30PM

LINE	QUANTITY	UOP	CAT NO	ITEM NUMBER	UNIT PRICE	AMOUNT
CONTRACT NULL AND VOID, AND TERMINATE SUCH CONTRACT WITHOUT FURTHER ORDER.						
THE TERMS AND CONDITIONS CONTAINED IN THIS CONTRACT SHALL SUPERSEDE ANY AND ALL SUBSEQUENT TERMS AND CONDITIONS WHICH MAY APPEAR ON ANY ATTACHED PRINTED DOCUMENTS SUCH AS PRICE LISTS, ORDER FORMS, SALES AGREEMENTS OR MAINTENANCE AGREEMENTS, INCLUDING ANY ELECTRONIC MEDIUM SUCH AS CD-ROM.						
REV. 01/17/2012						
NOTICE						
A SIGNED BID MUST BE SUBMITTED TO:						
DEPARTMENT OF ADMINISTRATION PURCHASING DIVISION BUILDING 15 2019 WASHINGTON STREET, EAST CHARLESTON, WV 25305-0130						
THE BID SHOULD CONTAIN THIS INFORMATION ON THE FACE OF THE ENVELOPE OR THE BID MAY NOT BE CONSIDERED:						
SEALED BID						
BUYER: 44						
RFQ. NO.: AGR1235						
BID OPENING DATE: 05/29/2012						

SEE REVERSE SIDE FOR TERMS AND CONDITIONS

SIGNATURE <i>B. Redman</i>	TELEPHONE 800-533-5290 ext.77759	DATE 5/24/2012
TITLE Vice President of Finance	FEIN 58-1972868	ADDRESS CHANGES TO BE NOTED ABOVE

WHEN RESPONDING TO RFQ, INSERT NAME AND ADDRESS IN SPACE ABOVE LABELED 'VENDOR'



State of West Virginia
Department of Administration
Purchasing Division
2019 Washington Street East
Post Office Box 50130
Charleston, WV 25305-0130

Request for Quotation

RFQ NUMBER

AGR1235

PAGE

4

ADDRESS CORRESPONDENCE TO ATTENTION OF:

FRANK WHITTAKER
304-558-2316

*C29132658 800-533-5290

SCHWANS FOOD SERVICE INC
115 WEST COLLEGE DR

MARSHALL MN 56258

DEPARTMENT OF AGRICULTURE

FOOD DISTRIBUTION PROGRAM
1 CEDAR LAKES DRIVE
RIPLEY, WV
25271 304-558-2221

DATE PRINTED	TERMS OF SALE	SHIP VIA	F.O.B.	FREIGHT TERMS
05/02/2012				
BID OPENING DATE: 05/29/2012		BID OPENING TIME 01:30PM		

LINE	QUANTITY	UOP	CAT NO	ITEM NUMBER	UNIT PRICE	AMOUNT
BID OPENING TIME: 1:30 PM						
PLEASE PROVIDE A FAX NUMBER IN CASE IT IS NECESSARY TO CONTACT YOU REGARDING YOUR BID:						
----- 507-537-5272 -----						
CONTACT PERSON (PLEASE PRINT CLEARLY):						
----- Michael Ovitt -----						
***** THIS IS THE END OF RFQ AGR1235 ***** TOTAL: _____						

SEE REVERSE SIDE FOR TERMS AND CONDITIONS

SIGNATURE

B. Raden

TELEPHONE

800-533-5290 ext.77759

DATE

5/24/2012

TITLE

Vice President of Finance

FEIN

58-1972868

ADDRESS CHANGES TO BE NOTED ABOVE

WHEN RESPONDING TO RFQ, INSERT NAME AND ADDRESS IN SPACE ABOVE LABELED 'VENDOR'

INVITATION TO BID

To establish an agreement between the West Virginia Department of Agriculture Food Distribution Program and a processing firm to produce pizza products using USDA Commodity **MOZZARELLA CHEESE**.

SPECIAL PROVISIONS FOR THE PROCESSING OF MOZZARELLA CHEESE:

1. CONTRACT/AGREEMENT REQUIREMENTS

The processor must comply with and abide by all specifications, qualifiers, terms, and conditions as set forth in this Invitation to Bid, including all attachments (hereinafter referred to collectively as "The Bid Package").

The Bid Package will provide the framework for the processing of mozzarella cheese into processed pizza products for use and consumption by West Virginia Schools and other authorized recipient agencies in the State of West Virginia.

Any processing company submitting a completed Bid Package under this Invitation must have an approved National Processing Agreement in place with USDA for the time period covered by this Invitation and any subsequent agreement(s) with the State of West Virginia. The contractual obligations under which a Processor may utilize USDA Commodities to manufacture and deliver specified end product(s) to the WV Department of Agriculture Food Distribution Program to ensure the return of quantity, quality, and value of such commodities is set forth in the National Processing Agreement and also in the State Participation Agreement, Bid Specifications and all other attachments included in this Bid Package.

1a. CONTRACT PERIOD:

The State Participation Agreement shall be valid for a one (1) year period from July 01, 2012, through June 30, 2013.

2. PRODUCT FORMULA:

Processor is to include the raw batch formula for all processed end products under this Agreement, listing the name and quantity of each ingredient contained in the batch recipe. Flavorings and seasonings may be given as an aggregate quantity.

A NUTRITIONAL ANALYSIS OF FINISHED PRODUCTS WILL BE PROVIDED WITH THIS BID PACKAGE. THE ANALYSIS IS TO INCLUDE THE AMOUNTS OF SODIUM, THE AMOUNTS OF SATURATED FAT, MONOSATURATED FAT, POLYSATURATED FAT; AND THE AMOUNT OF THEIR PERCENT OF CALORIES, TOTAL FAT GRAMS AND TOTAL CALORIES PER SERVING. ALSO, INFORMATION REGARDING COOKING/PREPARATION, HANDLING AND STORAGE WILL BE SUBMITTED. ANY BID PACKAGE SUBMITTED WITHOUT AN ADEQUATE AND COMPLETE NUTRITIONAL ANALYSIS AND THE OTHER OUTLINED INFORMATION MAY BE CONSIDERED DISQUALIFIED AND INVALID AND, THEREFORE, NOT AWARDED AN AGREEMENT.

3. SAMPLES:

The WV Department of Agriculture Food Distribution Program requests bidding processors submit samples of each item PRIOR TO THE DAY OF THE BID OPENING.

SAMPLES SUBMITTED SHOULD BE IN SUFFICIENT QUANTITY TO PERMIT EVALUATION BY A MINIMUM OF TWENTY (20) PEOPLE. SAMPLES SHOULD BE CLEARLY MARKED WITH APPROPRIATE PRODUCT NAMES AND CODES IDENTICAL TO THOSE ON SUBMITTED END PRODUCT DATA SCHEDULES.

Samples shall be submitted without charge PRIOR TO the BID OPENING DATE to:

WV Department of Agriculture
Food Distribution Program
4496 Cedar Lakes Road
Ripley, WV 25271

4. END PRODUCT DATA SCHEDULE (EPDS):

End Product Data Schedule (EPDS) forms and/or a Summary End Product Data Schedule (SEPDS) form with all applicable columns completed must be submitted for each end product and returned as part of the completed bid package.

ALL PRICING SUBMITTED ON EPDSs and/or SEPDSs and/or OTHERWISE SUBMITTED AS PART OF THE BID PACKAGE MUST BE THE ACTUAL MAXIMUM PRICE YOU WILL CHARGE WEST VIRGINIA FOR THE DURATION OF THIS AGREEMENT, NOT NATIONAL PRICES. ADDITIONALLY, ALL PRICES MUST BE BASED ON GUARANTEED MINIMUM RETURN ON A FEE-FOR-SERVICE BASIS. ALL EPDSs AND SEPDSs SHOULD BE ASCRIBED WITH ORIGINAL SIGNATURES IN BLUE INK. NEITHER ELECTRONIC NOR STAMPED SIGNATURES CAN BE ACCEPTED.

5. PRICE:

In addition to the pricing requirements outlined above in Number 4, prices quoted shall be firm for the duration of the Agreement. Prices must be based on "Guaranteed Minimum Return" and shall be calculated on a "Fee-for-Service" basis.

6. SPECIFICATIONS:

The commodities processed in conjunction with this Agreement shall adhere to the specifications marked as ATTACHMENT A.

7. PACKAGING AND LABELING:

The finished end products are to be packaged and shipped under the proper conditions recognized by the industry to ensure the return of a quality finished product free from damage and deformity upon delivery and as may otherwise be set forth in Attachment A - Specifications.

Packaging descriptions submitted and therefore agreed to by Processor (i.e. stated case sizes) shall be firm for the duration of this Agreement.

7a. CONTAINER AND MARKING SPECIFICATIONS:

Packaged end-products shall be packed in good commercial fiberboard shipping containers which are acceptable by common or other carrier for safe transportation to point of destination specified in shipping instructions and shall be of a size to accommodate the products without slack filling or bulging. The container shall be securely sealed by gluing, or closed by use of a filament reinforced freezer-type tape, or Scotch Brand No. 3523 Cold Temperature Polyester Film Packaging Tape or its equal, or nonmetallic strapping having a heat-sealed or comparable friction weld joint. Staples and/or steel or wire straps shall not be used as closure for the container.

ALL PRODUCTS MUST BE PACKED IN CONTAINERS CAPABLE OF BEING STACKED FOR PALLETIZING AND/OR WAREHOUSING.

ALL CASES SHOULD BE CLEARLY MARKED ON AT LEAST TWO SIDES WITH PRODUCT INFORMATION INCLUDING THE PRODUCT NAME AND NUMBER.

All packing and packing materials shall be new, clean, sanitary, and shall not impart objectionable odors or flavors to the product and shall be approved for use in contact with food products. Marking material shall be water fast, non-smearing, and of a color contrasting with the color of the container.

Each shipping container shall be legibly initialed, stamped, or labeled to show:

- A. The net weight.
- B. USDA inspection marks and plant number and name, and location of processor. Each container shall bear required labeling, USDA contract compliance stamp and certificate number.
- C. Date of Manufacture-Processing.
- E. Ingredient statement by order of predominance.
- F. The appropriate CN LABEL is to be affixed to each case and a copy of same CN LABEL attached to the EPDS/SEPDS. The CN LABEL identification number assigned by FNS is to be clearly shown.
- G. The proper recommended storage instructions.

8. DELIVERY:

The Processor agrees to process, produce and deliver the end products in truckload lots to a warehouse located in West Virginia; so specified upon the order of the West Virginia Department of Agriculture.

Delivery quantities will be determined by the WV Department of Agriculture Food Distribution Program. The processor will be responsible for the delivery of the end product, undamaged, unspoiled, and fit for human consumption.

9. SHIPPING TERMS:

All freight charges must be included in the bid price and all product must be shipped F.O.B. destination.

10. QUANTITY:

The quantity of mozzarella cheese made available to West Virginia will vary according to commodity availability and USDA policy. The WV Department of Agriculture Food Distribution Program shall be the final authority with regard to the total quantity of USDA commodities allocated for processing under this agreement.

11. PICK-UP:

From time to time commodities may have to be picked up for processing. In an instance of that unlikely event; the pick up point will be designated by the WV Department of Agriculture Food Distribution Program and will most usually be the Food Distribution warehouse located in WV. The cost of transportation to the processing plant may be added to the price of the finished end product (on a \$ per lb. processed product basis). Written approval from the WV Department of Agriculture Food Distribution Program is required prior to any backhauling of USDA commodity items from Recipient Agencies.

12. ACCOUNTABILITY AND RECORDS:

The successful bidding processor shall be required to establish and maintain perpetual inventories and control of all commodities received for processing, performance and production records and other reporting systems as may be required by state and federal regulations, to include provision to the USDA of the required Monthly Performance Reports.

13. PROCESSING AGREEMENT:

In addition to an approved National Processing Agreement with USDA, the successful bidding processor shall be required to execute a standard State Participation Agreement with the West Virginia Department of Agriculture, Food Distribution Program. The attached State Participation Agreement (ATTACHMENT B) must be fully executed in BLUE INK by bidding processor and returned as part of the completed bid package. Upon award, the State Participation Agreement executed by the successful bidding processor will be further executed in full by the appropriate Food Distribution Program personnel and become, at that time, in full force and effect. A copy of the fully executed State Participation Agreement will be sent to the successful bidding processor for processor's records.

13a. BASIS OF AWARD:

The West Virginia Purchasing Division shall award the contract to the lowest responsible bidder(s) who meets the requirements of the INVITATION TO BID, and who is considered best able to serve the interests of the State of West Virginia.

14. LIFE OF CONTRACT:

This contract is to become effective on July 01, 2012 and extend for a period of one year. The vendor may terminate this contract for any reason upon giving the Director of the WV Department of Agriculture Food Distribution Program and the Director of the Purchasing Division thirty (30) days written notice.

This contract may be declared immediately terminated at the option of the Director of the WV Department of Agriculture Food Distribution Program and/or the Director of the Purchasing Division if this contract and/or any of its terms, conditions, or covenants are not complied with by the Processor, or if any right thereunder in favor of the WV Department of Agriculture Food Distribution Program is threatened or jeopardized by processor or his agent.

This contract may be terminated by the vendor only upon the return delivery of unencumbered and/or unobligated food and/or funds to the WV Department of Agriculture Food Distribution Program. In the event of termination due to non-compliance with the terms of this contract, or at the request of the vendor, transportation costs for the return of USDA commodities shall be borne by vendor.

Vendor shall not assign and/or delegate any of the duties and/or responsibilities to process food products under this Agreement to any party, either by way of a subcontract or any other arrangement, without first having received the prior written consent of the WV Department of Agriculture Food Distribution Program.

Unless specific provisions are stipulated elsewhere in this contract-agreement document, the terms, conditions, and pricing set herein are firm for the life of the contract.

15. RENEWAL:

June 30, 2013 is to be the expiration date of the contract-agreement. The contract may be extended for two 1-year periods. Any changes to date must be updated before any contract extension is granted including, but not limited to, pricing, yield, and the signature page.

16. LETTERS OF REFERENCE:

Bidding processors should provide **three (3) business references** with the completed bid package. These references will consist of current or previous customers and should include: the name of the company/agency, the most current mailing address and telephone number, and the name of at least one contact person.

17. BILLING:

The successful bidding processor is required to "Bill as Shipped" to the ordering agency.

18. PAYMENT:

The West Virginia Department of Agriculture Food Distribution Program will authorize and process for payment each invoice within thirty (30) days after the date of receipt.

ATTACHMENT A

BID SPECIFICATIONS

**BID SPECIFICATIONS
FOR MOZZARELLA CHEESE PIZZA PRODUCTS**

1. END PRODUCT INFORMATION

Pizza products may contain no more than 8 g of fat per 1 oz, no more than 850 mg of sodium per serving, and 0 trans fats.

2. GENERAL REQUIREMENTS

- CN Labels are required
- No MSG, artificial flavorings, colorings and/or preservatives
- Each individual item is to be packaged in such a way that will prevent sticking together when frozen
- All frozen products are to be delivered at 0° F to -10° F and must show no signs of refreezing, thawing or freezer burn.
- All cases should be marked on at least 2 sides with product information including product name and number.

3. PRODUCT STANDARDS

- All products covered under this Agreement shall be formulated, manufactured, handled, stored, packaged, and shipped in compliance with the regulations and guidelines of the State of West Virginia, the United States Department of Agriculture, the Federal Food, Drug and Cosmetic Act, and all pertinent sections of the Code of Federal Regulations which govern Food Distribution and the National School Lunch Program, as well as Industry standards related to products for Food Distribution and the National School Lunch Program.
- Any end product not meeting the fabrication, formulation, and/or packaging requirements will be rejected by the WV Food Distribution Program and returned to Processor at Processor's expense.

ATTACHMENT B

STATE PARTICIPATION AGREEMENT

NATIONAL PROCESSING AGREEMENT
STATE PARTICIPATION AGREEMENT

This Agreement is subject to the terms and conditions set forth in the National Processing Agreement made by and between the U.S. Department of Agriculture, Food and Nutrition Service and Schwans Food Service, Inc. (Processor).

State Distributing Agency
WV Department of Agriculture, Food Distribution Program

Processor Schwans Food Service, Inc.

Name Darrell Carter

Name Marsha Rose

Title Program Director

Title Director of Market Strategies

Address 4496 Cedar Lakes Road

Address 115 West College Drive

City, State, Zip Ripley, WV 25271

City, State, Zip Marshall, MN 56258

Contact Darrell Carter

Contact Nancy Coleman

Phone 304-558-0573

Phone 800-533-5290

Fax 304-372-3322

Fax 507-537-5499

E-mail dcarter@ag.state.wv.us

E-mail nancy.coleman@schwans.com

Web Address www.state.wv.us/admin/purchase/vrc

Web Address www.schwansfoodservice.com

Signature _____

Signature 

Date _____

Date 5/24/2012

Period of Agreement: This Agreement shall become effective on JULY 1, 2012 and will terminate on JUNE 30, 2013.

1. **Value Pass Through Systems.** State Agency will indicate which value pass through systems are acceptable in their State. Processor will indicate which value pass through systems they desire to use in the State and have been approved by USDA in the NPA (National Processing Agreement).

Permitted By State	Value Pass Through System	Selected by Processor
	Direct Discount	
	Refund	
	Indirect Discount (net off invoice)*	
	Alternate Value Pass Thru System* (requires FNS approval)	
THIS IS THE ONLY VPT ALLOWED IN WV	Fee for Service – billed by processor	
	Fee for Service – billed by distributor	

*Sales Verification Required

If sales verification is required, check one:

☐ State delegates sales verification to the processor

[According to 250.19 (2)(vi) (C) states must review the processor's findings and select a random sub-sample of at least 10% of all sales verified by the processor and reverify the sales by re-contacting the RA]

Processor should submit their Sales Verification Plan to the State Agency.

☐ State will conduct sales verification

2. **Summary End Product Data Schedules (SEPDS).** Processor will submit SEPDS to State with the completed State Participation Agreement. The SEPDS contains summary information from approved EPDS and a master SEPDS approved by USDA. Processor may select specific EPDS for processing in a given state. The state also has the option to accept or reject individual products listed on the SEPDS, and in the case of multiple commodities available for processing, may accept or reject certain commodities for processing. Note: the case weight listed on the SEPDS **MUST** match the label on the finished case.

SUMMARY END PRODUCT DATA SCHEDULES SUBMITTED WITH THIS BID PACKAGE MUST INCLUDE MAXIMUM PRICES WHICH WILL BE CHARGED TO WEST VIRGINIA FOR THE DURATION OF THE AGREEMENT (IF AN AGREEMENT IS AWARDED)

Do you use a subcontractor for the production of any items covered in this agreement?

☒ Yes ☐ No

If yes, please identify in an attachment the subcontractor by name, address, USDA plant number, and each item produced.

Processor must provide written notification to the State Agency of any change(s) to the SEPDS including the nature of the change(s); notification may be made electronically.

3. **CN Labeling.** Products, which contribute toward the school meal pattern requirements, may qualify for CN labeling. State should check those that apply.

☐ CN Labeling is optional. Recipient agencies may request CN labeled products.

☒ CN Labeling is required, if applicable for the processed product.

☒ Submit CN labels with SEPDS.

4. **Nutritional Information.** Recipient agencies need nutritional information to comply with USDA regulations. Please check those that apply:

- ☐ Processor must provide nutrition information to RA upon request.
- ☐ Processor's nutrition information has been submitted to USDA Database
- ☐ Processor's nutrition information is available on their web site.

_____ (Provide the web address)

- ☒ Processor must submit nutrition information with the SEPDS

5. **Grading.** Red Meat grading will be performed under (check one)

- ☐ Full Certification per AMS Instruction MGC 640
- ☐ PCCP per AMS Instruction MGC 638

6. **By products.** If by products are produced, describe method of valuation and credit.

N/A

7. **Backhauling of DF.** If backhauling is permitted, processor must notify the State before backhauling products. Please check those that apply.

State permits backhauling ☐ Yes ☒ No

Backhauling permitted from State Warehouse ☐ School District ☐

State requires attached form for requesting approval to backhaul ☐ Yes ☐ No

8. ~~List of Eligible Recipient Agencies. State will provide a list of eligible recipient agencies to the processor upon State approval of the State Participation Agreement.~~

COMMODITIES IN WEST VIRGINIA ARE PURCHASED AND DISTRIBUTED DIRECTLY BY THE STATE DISTRIBUTING AGENCY.

9. Special Instructions for Delivery of End Product to Designated Delivery Locations:

ALL INSTRUCTIONS AND PROVISIONS OF THE INVITATION TO BID AND ATTACHMENT A – SPECIFICATIONS ARE BY REFERENCE INCORPORATED HEREIN

10. Additional State Requirements.

AS OUTLINED UNDER NUMBER 1 ABOVE, THE ONLY VALUE-PASS-THROUGH SYSTEM CURRENTLY ALLOWED BY WV IS FEE-FOR-SERVICE BILLED BY PROCESSOR

AS OUTLINED UNDER NUMBER 2 ABOVE, SUMMARY END PRODUCT DATA SCHEDULES SUBMITTED WITH THIS BID PACKAGE MUST INCLUDE MAXIMUM PRICES WHICH WILL BE CHARGED TO WEST VIRGINIA FOR THE DURATION OF THE AGREEMENT (IF AN AGREEMENT IS AWARDED)

ALL PROVISIONS OF THE INVITATION TO BID AND ATTACHMENT A – SPECIFICATIONS ARE BY REFERENCE INCORPORATED HEREIN



The SCHWAN FOOD COMPANY™

SCHWAN'S FOOD SERVICE, INC.

Commodity Department

PO Box 600

Marshall, MN 56258

Phone: 800-533-5290

Fax: 507-537-8411

Good Heart

11122 Nacogdoches Road

San Antonio, TX 78217

Plant Number: 5003859

List of Subcontractors and Product Codes

Better Baked Foods

Smedley & Grahmanville St,

North East PA 16428

Plant Number: M8848-P8848

KT's Kitchen

1065 E Walnut

Carson CA 90746

Plant Number: 17237

Item Description

78356 SMPL SFS TNY 6 LS FB CHS
78357 SMPL SFS TNY 6 LS FB PEPP
78358 SFS TNY 6 LS FB SAUS
78359 SFS TNY 6 LS FB MULTI CHS
78360 SFS TNY 6 LS FB PEPP IW
78361 SFS TNY 6 LS FB MULTI CHS IW
78504 SFS RB FB 6 BULK CHEESE MOZZ 100 CN
78505 SFS RB FB 6 PEPP 100 MOZZ CN
78511 SFS RB FB 6 CHEESE 50/50 CN
78516 SFS 6 MULTI CHS FRENCH BREAD IW PZA CN
78518 SFS RB FB 8 PEPP CN
78525 SFS RB FB 8 CHEESE 50/50 CN
78622 SFS TNY SMART 6 FB CHS
78623 SFS TNY SMART 6 FB PEPP
78624 SFS TNY SMART 6 FB CHEESY GARLIC
78626 SFS RB FB 6 PEPP 100 MZ/CHD CN
78822 SFS TNY FB 6 WGRAIN SMART SAUS CN
78894 SFS EGG SAUSAGE CHEESE FLTBRD 24 CT
78911 SFS 6 FRESCH 3 CHS FLTBRD SAND
78913 SFS 6 FRESCH 3 MEAT ITAL FLTBRD SAND
78914 SFS 6 FRESCH BUFFALO CHIC FLTBRD SAND

Item Description

63266 SFS TNY 3.2X5 PEPP 100 MZ/CH
63276 SFS TNY 3.2X5 CHS 100 MZ
63999 SFS TNY 3.2X5 CHS 50/50 MZ
68505 SFS TN SAUS & COUNTRY GRAVY BAGEL
68533 SFS GLUTEN FREE 5 CHEESE PIZZA
74793 SFS TNY 4X6 CHS IW LAUSD 2010SY
74794 SFS TNY 4X6 CHS BULK LAUSD
78391 SFS TNY WHOLE GRAIN BGL PZA CHS CN
78519 SFS GF 6.5 CHS ORIG CRUST PZA
78571 SFS TNY VEND 4X6 PEPP 50/50
78598 SFS RB 11 SLICE PEPPERONI CN
78600 SFS RB 14 RND CHEESE CN
78668 SFS TNY 3.2X5 WGRAIN IQF CHS CN
78669 SFS TNY 3.2X5 WGRAIN IQF PEPP CN
78700 SFS TNY SAUS BKFT BAGEL
78706 SFS TNY PEPP BGL PKA 100 MZ
78710 SFS TNY SAUS BKFT PZA BAGEL IW CN
78712 SFS TNY 6 WG CHS PZA
78713 SFS TNY 6 WG PEPP PZA
78714 SFS TNY 4X6 CHS LAUSD
78817 SFS TNY 4X6 CHS 100 MZ IW

Item Description

69063 Sweet & Sour Chicken Stir Fry
69064 Teriyaki Chicken Stir Fry
69065 General TSO Chicken Stir Fry
69066 Orange Chicken Stir Fry

KT's Kitchen Continued

Item Description

78818 SFS TNY 4X6 PEPP 100 MZ IW
78862 SFS TNY WDG PEPP 100 MOZZ
78863 SFS TNY FB CHS 100 MOZZ
78867 SFS TNY 6 PEPP 100 MOZZ
78868 SFS TNY BAGEL CHS PZA
78869 SFS TNY BKFT SAUS 3.2X5 100 MOZZ
78870 SFS TNY WDG PEPP 100 MOZZ

State of West Virginia

VENDOR PREFERENCE CERTIFICATE

Certification and application* is hereby made for Preference in accordance with **West Virginia Code, §5A-3-37**. (Does not apply to construction contracts). **West Virginia Code, §5A-3-37**, provides an opportunity for qualifying vendors to request (at the time of bid) preference for their residency status. Such preference is an evaluation method only and will be applied only to the cost bid in accordance with the **West Virginia Code**. This certificate for application is to be used to request such preference. The Purchasing Division will make the determination of the Resident Vendor Preference, if applicable.

1. Application is made for 2.5% resident vendor preference for the reason checked:

____ Bidder is an individual resident vendor and has resided continuously in West Virginia for four (4) years immediately preceding the date of this certification; or,

____ Bidder is a partnership, association or corporation resident vendor and has maintained its headquarters or principal place of business continuously in West Virginia for four (4) years immediately preceding the date of this certification; or 80% of the ownership interest of Bidder is held by another individual, partnership, association or corporation resident vendor who has maintained its headquarters or principal place of business continuously in West Virginia for four (4) years immediately preceding the date of this certification; or,

____ Bidder is a nonresident vendor which has an affiliate or subsidiary which employs a minimum of one hundred state residents and which has maintained its headquarters or principal place of business within West Virginia continuously for the four (4) years immediately preceding the date of this certification; or,

2. Application is made for 2.5% resident vendor preference for the reason checked:

____ Bidder is a resident vendor who certifies that, during the life of the contract, on average at least 75% of the employees working on the project being bid are residents of West Virginia who have resided in the state continuously for the two years immediately preceding submission of this bid; or,

3. Application is made for 2.5% resident vendor preference for the reason checked:

____ Bidder is a nonresident vendor employing a minimum of one hundred state residents or is a nonresident vendor with an affiliate or subsidiary which maintains its headquarters or principal place of business within West Virginia employing a minimum of one hundred state residents who certifies that, during the life of the contract, on average at least 75% of the employees or Bidder's affiliate's or subsidiary's employees are residents of West Virginia who have resided in the state continuously for the two years immediately preceding submission of this bid; or,

4. Application is made for 5% resident vendor preference for the reason checked:

____ Bidder meets either the requirement of both subdivisions (1) and (2) or subdivision (1) and (3) as stated above; or,

5. Application is made for 3.5% resident vendor preference who is a veteran for the reason checked:

____ Bidder is an individual resident vendor who is a veteran of the United States armed forces, the reserves or the National Guard and has resided in West Virginia continuously for the four years immediately preceding the date on which the bid is submitted; or,

6. Application is made for 3.5% resident vendor preference who is a veteran for the reason checked:

____ Bidder is a resident vendor who is a veteran of the United States armed forces, the reserves or the National Guard, if, for purposes of producing or distributing the commodities or completing the project which is the subject of the vendor's bid and continuously over the entire term of the project, on average at least seventy-five percent of the vendor's employees are residents of West Virginia who have resided in the state continuously for the two immediately preceding years.

Bidder understands if the Secretary of Revenue determines that a Bidder receiving preference has failed to continue to meet the requirements for such preference, the Secretary may order the Director of Purchasing to: (a) reject the bid; or (b) assess a penalty against such Bidder in an amount not to exceed 5% of the bid amount and that such penalty will be paid to the contracting agency or deducted from any unpaid balance on the contract or purchase order.

By submission of this certificate, Bidder agrees to disclose any reasonably requested information to the Purchasing Division and authorizes the Department of Revenue to disclose to the Director of Purchasing appropriate information verifying that Bidder has paid the required business taxes, provided that such information does not contain the amounts of taxes paid nor any other information deemed by the Tax Commissioner to be confidential.

Under penalty of law for false swearing (**West Virginia Code, §61-5-3**), Bidder hereby certifies that this certificate is true and accurate in all respects; and that if a contract is issued to Bidder and if anything contained within this certificate changes during the term of the contract, Bidder will notify the Purchasing Division in writing immediately.

Bidder: Schwan's Food Service, Inc.

Signed: B. Radwin

Date: 5/24/2012

Title: Vice President of Finance

*Check any combination of preference consideration(s) indicated above, which you are entitled to receive.

RFQ No. AGR1235STATE OF WEST VIRGINIA
Purchasing Division**PURCHASING AFFIDAVIT**

West Virginia Code §5A-3-10a states: No contract or renewal of any contract may be awarded by the state or any of its political subdivisions to any vendor or prospective vendor when the vendor or prospective vendor or a related party to the vendor or prospective vendor is a debtor and the debt owned is an amount greater than one thousand dollars in the aggregate

DEFINITIONS:

"Debt" means any assessment, premium, penalty, fine, tax or other amount of money owed to the state or any of its political subdivisions because of a judgment, fine, permit violation, license assessment, defaulted workers' compensation premium, penalty or other assessment presently delinquent or due and required to be paid to the state or any of its political subdivisions, including any interest or additional penalties accrued thereon.

"Debtor" means any individual, corporation, partnership, association, Limited Liability Company or any other form or business association owing a debt to the state or any of its political subdivisions. "Political subdivision" means any county commission; municipality; county board of education; any instrumentality established by a county or municipality; any separate corporation or instrumentality established by one or more counties or municipalities, as permitted by law; or any public body charged by law with the performance of a government function or whose jurisdiction is coextensive with one or more counties or municipalities. "Related party" means a party, whether an individual, corporation, partnership, association, limited liability company or any other form or business association or other entity whatsoever, related to any vendor by blood, marriage, ownership or contract through which the party has a relationship of ownership or other interest with the vendor so that the party will actually or by effect receive or control a portion of the benefit, profit or other consideration from performance of a vendor contract with the party receiving an amount that meets or exceeds five percent of the total contract amount.

EXCEPTION: The prohibition of this section does not apply where a vendor has contested any tax administered pursuant to chapter eleven of this code, workers' compensation premium, permit fee or environmental fee or assessment and the matter has not become final or where the vendor has entered into a payment plan or agreement and the vendor is not in default of any of the provisions of such plan or agreement.

Under penalty of law for false swearing (*West Virginia Code §61-5-3*), it is hereby certified that the vendor affirms and acknowledges the information in this affidavit and is in compliance with the requirements as stated.

WITNESS THE FOLLOWING SIGNATUREVendor's Name: Schwan's Food Service, Inc.Authorized Signature: *Ben Radtke* Date: 5/24/2012State of MinnesotaCounty of Lyon, to-wit:Taken, subscribed, and sworn to before me this 24th day of May, 2012.My Commission expires 1-31-2015, 2015.

AFFIX SEAL HERE

NOTARY PUBLIC

Lori A Matthys



The **SCHWAN**
FOOD COMPANY

SCHWAN'S FOOD SERVICE, INC.

State of West Virginia
Department of Administration
Purchasing Division
Building 15
2019 Washington Street, East
Charleston, WV 25305-0130

Attn: Purchasing

Re: AGR1235

Schwan's Food Service, Inc. pricing for the 2012-2013 school year is as follows:

Code	Description	Gross Price	USDA Commodity Cheese Value	Net Price
63912	SFS TNY WG TKY SAUS BKFST SQRS	\$ 35.77	\$ 3.94	\$ 31.83
78362	SFS TNY TKY SAUS BAGEL (RED SAUCE)	\$ 34.89	\$ 6.10	\$ 28.79
68765	SFS BD WG CHS FILLED BREADSTICK	\$ 38.16	\$ 10.40	\$ 27.76
78697	SFS TNY SMART WGRAIN 4X6 CHS CN	\$ 37.29	\$ 12.94	\$ 24.35
78698	SFS TNY SMART WGRAIN 4X6 PEPP CN	\$ 37.89	\$ 10.26	\$ 27.63
73158	SFS TNY SEW WGRAIN SMART CHS 50/50	\$ 32.29	\$ 6.93	\$ 25.36
73159	SFS TNY SEW WGRAIN SMART PEPP 50/50	\$ 33.68	\$ 5.13	\$ 28.55
78356	SFS TNY FB 6" 51% WG CHS	\$ 33.81	\$ 6.19	\$ 27.62
78357	SFS TNY FB 6" 51% WG PEP	\$ 37.38	\$ 6.58	\$ 30.80

Sincerely,

Brian Rademacher
Vice President of Finance
Schwan's Food Service, Inc.

Enriching the quality of lives through our food solutions.



The **SCHWAN**
FOOD COMPANY

SCHWAN'S FOOD SERVICE, INC.

References

Marshall County School System
Debbie Schrader 304-843-4448
2700 4th Street
Moundsville, WV 26041

Raleigh County
Rosie Cook 304-256-4643
105 Adair Street
Beckley, WV 25801-3791

Cabell County
Rhonda McCoy 304-528-5048
2850 Fifth Avenue
Huntington, WV 25709

Enriching the quality of lives through our food solutions.



IMPORTANT: If the certificate holder is an **ADDITIONAL INSURED**, the policy(ies) must be endorsed. If **SUBROGATION IS WAIVED**, subject to the terms and conditions of the policy, certain policies may require an endorsement. A statement on this certificate does not confer rights to the certificate holder in lieu of such endorsement(s).

PRODUCER	Willis of Minnesota, Inc. 1600 Utica Avenue South Suite 600 Minneapolis, MN 55416	CONTACT NAME:		
		PHONE (A/C, NO, EXT):	877-945-7378	FAX (A/C, NO): 888-467-2378
		E-MAIL ADDRESS:	certificates@willis.com	
		INSURER(S) AFFORDING COVERAGE	NAIC #	
		INSURER A:	Hartford Fire Insurance Company	19682-076
INSURED	EVIDENCE OF COVERAGE FOR Schwan's Food Service, Inc. Attn: Insurance Services 115 West College Drive Marshall, MN 56258	INSURER B:	Twin City Fire Insurance Company	29459-000
		INSURER C:	Hartford Insurance Company of the Midwest	37478-001
		INSURER D:		
		INSURER E:		
		INSURER F:		

REVISION NUMBER:

INSR LTR	TYPE OF INSURANCE	ADD'L INSRD	SUBR WVD	POLICY NUMBER	POLICY EFF (MM/DD/YYYY)	POLICY EXP (MM/DD/YYYY)	LIMITS
A	GENERAL LIABILITY X COMMERCIAL GENERAL LIABILITY <input type="checkbox"/> CLAIMS-MADE <input checked="" type="checkbox"/> OCCUR GEN'L AGGREGATE LIMIT APPLIES PER: <input type="checkbox"/> POLICY <input type="checkbox"/> PRO-JECT <input checked="" type="checkbox"/> LOC			41CSES12603	1/1/2012	1/1/2013	EACH OCCURRENCE \$ 2,000,000 DAMAGE TO RENTED PREMISES (Ea occurrence) \$ 2,000,000 MED EXP (Any one person) \$ 10,000 PERSONAL & ADV INJURY \$ 2,000,000 GENERAL AGGREGATE \$ 4,000,000 PRODUCTS - COMP/OP AGG \$ 4,000,000 \$
A	AUTOMOBILE LIABILITY X ANY AUTO <input type="checkbox"/> ALL OWNED AUTOS <input type="checkbox"/> SCHEDULED AUTOS <input type="checkbox"/> HIRED AUTOS <input type="checkbox"/> NON-OWNED AUTOS			41CSES12604	1/1/2012	1/1/2013	COMBINED SINGLE LIMIT (Ea accident) \$ 5,000,000 BODILY INJURY(Per person) \$ BODILY INJURY(Per accident) \$ PROPERTY DAMAGE (Per accident) \$ \$
	UMBRELLA LIAB <input type="checkbox"/> OCCUR EXCESS LIAB <input type="checkbox"/> CLAIMS-MADE DED <input type="checkbox"/> RETENTION \$						EACH OCCURRENCE \$ AGGREGATE \$ \$
B	WORKERS COMPENSATION AND EMPLOYERS' LIABILITY Y/N N/A			WI 41WBR12601	1/1/2012	1/1/2013	X WC STATU-TORY LIMITS <input type="checkbox"/> OTH-ER <input type="checkbox"/>
C	ANY PROPRIETOR/PARTNER/EXECUTIVE OFFICER/MEMBER EXCLUDED? (Mandatory in NH) If yes, describes under DESCRIPTION OF OPERATIONS below	N/A		AOS 41WNS12600	1/1/2012	1/1/2013	E.L. EACH ACCIDENT \$ 1,000,000 E.L. DISEASE - EA EMPLOYEE \$ 1,000,000 E.L. DISEASE - POLICY LIMIT \$ 1,000,000

Evidence of Coverage

CANCELLATION

		CANCELLATION
	Evidence of Coverage :	SHOULD ANY OF THE ABOVE DESCRIBED POLICIES BE CANCELLED BEFORE THE EXPIRATION DATE THEREOF, NOTICE WILL BE DELIVERED IN ACCORDANCE WITH THE POLICY PROVISIONS.
		AUTHORIZED REPRESENTATIVE

SEPDS A

SUMMARY END PRODUCT DATA SCHEDULE

VALUE PASS THROUGH SYSTEMS APPROVED:

☒ **National Summary**
(EPDS approved by USDA)

THIS IS AN ORIGINAL SUMMARY SCHEDULE UNLESS CHECKED BELOW:

☐ **State Summary**
(EPDS approved by state agency)

☒ Reflects Change in Formulation (Italic)

☐ Additional Products Listed



- ☒ Direct Sale
☒ Refund to Recipient Agency
☒ Net Price Through Distributor
☐ Fee for Service (billed by Processor)
☐ Fee for Service (billed by Distributor)

Information Certified as Accurate from Approved EPDS (requires signature from agency that approved EPDS)

Certified by State Agency

End Product Code & Description	Net Weight Per Case	Servings Per Case	Net Weight per Serving	Donated Food (Use commodity code and short title)		DF Inventory Drawdown per case	By Products Produced* (none unless box is checked)	Value per pound of DF (contract value)	Value of DF per case (F x H)	Effective Date	State Agency Acceptance/Approval
A	B	C	D			F	G	H	I	J	K
63912 - Sausage Breakfast Pizza	<input type="checkbox"/> 26.57	<input type="checkbox"/> 128	<input type="checkbox"/> 3.32	<input type="checkbox"/> B286	<input type="checkbox"/> 100418	<input type="checkbox"/> FLOUR BAKER <input type="checkbox"/> HARD WHT UNBLCH BUL	<input type="checkbox"/>	\$0.2544	\$1.67		<input type="checkbox"/>
				A048	100332	TOMATO PASTE FOR BULK <input type="checkbox"/> PROCESSING	1.38	\$0.3786	\$0.52		
				B077	100042	CHEESE MOZZ LM PART SKIM <input type="checkbox"/> UNFZ PRO	2.56	\$1.5407	\$3.94		
68765 - SFS Big Daddy's WG Chese Fill Brdstck Blk	20.25	108	3.00	B286	100418	FLOUR BAKER <input type="checkbox"/> HARD WHT UNBLCH BUL	7.64	\$0.2544	\$1.94		
				A048	100332	TOMATO PASTE FOR BULK <input type="checkbox"/> PROCESSING		\$0.3786	\$0.00		
				B077	100042	CHEESE MOZZ LM PART SKIM <input type="checkbox"/> UNFZ PRO	6.75	\$1.5407	\$10.40		
73158 - Tony's Smart Whole Grain Cheese 50/50	27.60	96	4.60	B286	100418	FLOUR BAKER <input type="checkbox"/> HARD WHT UNBLCH BUL	6.30	\$0.2544	\$1.60		
<i>submit to USDA with m2 changing on the approved</i>				A048	100332	TOMATO PASTE FOR BULK <input type="checkbox"/> PROCESSING	1.53	\$0.3786	\$0.58		
				B077	100042	CHEESE MOZZ LM PART SKIM <input type="checkbox"/> UNFZ PRO	4.50	\$1.5407	\$6.93		
73159 - Tony's Smart Whole Grain Pepp 50/50	26.88	96	4.48	B286	100418	FLOUR BAKER <input type="checkbox"/> HARD WHT UNBLCH BUL	6.30	\$0.2544	\$1.60		
<i>set up BOM</i>				A048	100332	TOMATO PASTE FOR BULK <input type="checkbox"/> PROCESSING	1.53	\$0.3786	\$0.58		
				B077	100042	CHEESE MOZZ LM PART SKIM <input type="checkbox"/> UNFZ PRO	3.33	\$1.5407	\$5.13		
78356 - 6" Cheese 51% Whole Grain	18.41	60	4.91	B286	100418	FLOUR BAKER <input type="checkbox"/> HARD WHT UNBLCH BUL	2.13	\$0.2544	\$0.54		
				A048	100332	TOMATO PASTE FOR BULK <input type="checkbox"/> PROCESSING	0.00	\$0.3786	\$0.00		
				B077	100042	CHEESE MOZZ LM PART SKIM <input type="checkbox"/> UNFZ PRO	4.02	\$1.5407	\$6.19		
78357 - 6" Pepperoni 51% Whole Grain	18.38	60	4.90	B286	100418	FLOUR BAKER <input type="checkbox"/> HARD WHT UNBLCH BUL	2.13	\$0.2544	\$0.54		
				A048	100332	TOMATO PASTE FOR BULK <input type="checkbox"/> PROCESSING	0.00	\$0.3786	\$0.00		
				B077	100042	CHEESE MOZZ LM PART SKIM <input type="checkbox"/> UNFZ PRO	4.27	\$1.5407	\$6.58		
78362 - Turkey Sausage Bagel (Red Sauce)	15.90	96	2.65	B286	100418	FLOUR BAKER <input type="checkbox"/> HARD WHT UNBLCH BUL	3.00	\$0.2544	\$0.76		
				A048	100332	TOMATO PASTE FOR BULK <input type="checkbox"/> PROCESSING	0.65	\$0.3786	\$0.25		
				B077	100042	CHEESE MOZZ LM PART SKIM <input type="checkbox"/> UNFZ PRO	3.96	\$1.5407	\$6.10		
78697 - 4x6 Pizza with Whole Grain Cheese 100% Mozz	27.00	96	4.50	B286	100418	FLOUR BAKER <input type="checkbox"/> HARD WHT UNBLCH BUL	6.30	\$0.2544	\$1.60		
				A048	100332	TOMATO PASTE FOR BULK <input type="checkbox"/> PROCESSING	1.51	\$0.3786	\$0.57		
				B077	100042	CHEESE MOZZ LM PART SKIM <input type="checkbox"/> UNFZ PRO	8.40	\$1.5407	\$12.94		
78698 - 4x6 with Whole Grain Pepp 100% Mozz	26.88	96	4.48	B286	100418	FLOUR BAKER <input type="checkbox"/> HARD WHT UNBLCH BUL	6.30	\$0.2544	\$1.60		
				A048	100332	TOMATO PASTE FOR BULK <input type="checkbox"/> PROCESSING	1.51	\$0.3786	\$0.57		
				B077	100042	CHEESE MOZZ LM PART SKIM <input type="checkbox"/> UNFZ PRO	6.66	\$1.5407	\$10.26		

PROCESSOR:

USDA APPROVAL:
School Year 2012-2013

STATE AGENCY APPROVAL:

Schwan's Food Service, Inc.	
Name of Company	
Marsha Rose, Director of Market Strategies	
Name and Title of Authorized Representative	
	5/14/2012
Signature	Date Signed

(not applicable for state summary)

FNS FDD HQ	
Name of Approving Agency	
Raymond Magee - Program Analyst	
Name and Title of Authorized Representative	
Signature	Date Signed

Name of Approving Agency	
Name and Title of Authorized Representative	
Signature	Date Signed

*If by products are produced, provide value and method credit will be given
Value of NDM reduced from \$0.80 per pound to \$0.74 per pound for subcontractor's handling fee.



The SCHWAN FOOD COMPANY™

SCHWAN'S FOOD SERVICE, INC.



Tony's® Turkey Sausage Breakfast Pizza

Product Code: 63912

Last Update Date: 04/19/2012

Please continue to check our website for the most current nutrition information.

Printed on 5/24/2012

Nutrition Information		
	1	
Serving Size:	Piece(94g/3.31	oz)
Eaches/Case:	128	
Inner Packs/Case:	8	
Servings/Case:	128	
Calories:	220	
Calories from Fat:	70	
Total Fat:	8 g(s)	
Saturated Fat:	2 g(s)	
Trans Fat:	0 g(s)	
Cholesterol:	15 mg(s)	
Sodium:	480 mg(s)	
Potassium:	230 mg(s)	
Total Carbohydrate:	27 g(s)	
Total Dietary Fiber:	3 g(s)	
Sugars:	8 g(s)	
Protein:	10 g(s)	
Vitamins & Minerals		
	Amt/Srv	% DV
Vitamin A:	300 IU	6%
Vitamin C:	0 mg(s)	0%
Calcium:	150 mg(s)	15%
Iron:	1.8 mg(s)	10%
* Percent Daily Values are based on		
2,000 calorie diet.		
Whole Grain		
	Amt/Srv	% Flour
Whole Grain:	12 g(s)	52%

Savory turkey sausage & mozzarella cheese on top of whole grain crust. A delicious new menu option that is sure to get kids up and going!

Master Case Product Name: SFS TNY WG SAUSAGE BREAKFAST PIZZA CN

Child Nutrition Identification

080468

1-½ servings of bread alternate for the Child Nutrition Meal Pattern Requirements. (Use of this logo and statement authorized by the Food and Nutrition Service, USDA 04-11).

Preparation Instructions

COOKING INSTRUCTIONS. COOK BEFORE SERVING. Cook product until internal temperature reaches 165°F or above. Place frozen pizzas in 18"x26"x1/2" lightly greased bun pans. CONVECTION OVEN: 350°F for 15 to 17 minutes. CONVENTIONAL OVEN: 400°F for 16 to 19 minutes. Refrigerate or discard any unused portion. NOTE: Due to variances in oven regulators, cooking time and temperature may require adjustments.

Ingredients

(WHEAT FLOUR, MALTED BARLEY FLOUR, NIACIN, REDUCED IRON, THIAMINE MONONITRATE, RIBOFLAVIN, FOLIC ACID), SUGAR, YEAST, VEGETABLE OIL (SOYBEAN, COTTONSEED, CORN, AND/OR CANOLA OIL), CONTAINS 2% OR LESS OF: WHEAT GLUTEN, SALT, SEA SALT, DOUGH CONDITIONER (WHEY, AMMONIUM SULFATE, L-CYSTEINE), RELECITHINATED SOY FLOUR (SOY FLOUR, SOYBEAN OIL, SOY LECITHIN), DOUGH CONDITIONER (WHEAT FLOUR, WHEAT STARCH, SALT, ENZYME CONCENTRATES, MALTODEXTRIN, SUNFLOWER OIL). TOPPINGS: TOPPING BLEND (LOW MOISTURE PART SKIM MOZZARELLA CHEESE [CULTURED PASTEURIZED PART SKIM MILK, SALT, ENZYMES], SUBSTITUTE MOZZARELLA CHEESE [WATER, CORN OIL AND/OR SOY OIL, CASEIN, MODIFIED FOOD STARCH, WHEY, NONFAT DRY MILK, NATURAL FLAVOR, SODIUM ALUMINUM PHOSPHATE, SALT, LACTIC ACID, SODIUM PHOSPHATE, POTASSIUM CHLORIDE, CITRIC ACID, TRICALCIUM PHOSPHATE, SORBIC ACID [AS A PRESERVATIVE], XANTHAN GUM, VITAMIN AND MINERAL SUPPLEMENT (MAGNESIUM OXIDE, DICALCIUM PHOSPHATE, ZINC OXIDE, RIBOFLAVIN [VITAMIN B2], ELECTROLYTIC IRON, FOLIC ACID, PYRIDOXINE HYDROCHLORIDE [VITAMIN B6], NIACINAMIDE, THIAMINE MONONITRATE [VITAMIN B1], CYANOCOBALAMIN [VITAMIN B12], VITAMIN A PALMITATE), ARTIFICIAL COLOR)), COOKED TURKEY PIZZA TOPPING (TURKEY BREAKFAST SAUSAGE [MECHANICALLY SEPARATED TURKEY, SEASONING {SALT, NATURAL FLAVOR, DEXTROSE, SUGAR, CITRIC ACID, BHA, BHT}, WATER], TEXTURED VEGETABLE PROTEIN [SOY FLOUR, CARAMEL COLOR, ZINC OXIDE, NIACINAMIDE, FERROUS SULFATE, COPPER GLUCONATE, VITAMIN A PALMITATE, CALCIUM PANTOTHENATE, THIAMINE MONONITRATE, PYRIDOXINE HYDROCHLORIDE, RIBOFLAVIN, CYANOCOBALAMIN], WATER). SAUCE: TOMATOES (WATER, TOMATO PASTE [NOT LESS THAN 28% SOLUBLE SOLIDS]), MALTODEXTRIN, MODIFIED FOOD STARCH, CONTAINS 2% OR LESS OF: SALT, SPICE, SUGAR, HYDROLYZED SOY AND CORN PROTEIN, PAPRIKA, GARLIC POWDER, POWDERED CELLULOSE.

Allergens

Contains Milk, Wheat, and Soy.

Hard Bid Specifications

Tony's® Turkey Sausage Breakfast Pizza must provide 1 oz(s) equivalent meat/meat alternate and 1 1/2 servings of bread/bread alternate. Portion to provide a minimum of 190 calories with no more than 10 fat grams. Must contain a minimum of 2 grams of fiber and less than 580 milligrams sodium. Case pack of 128 per case. CN Label required. Acceptable Brand: Tony's® 63912 .

Shipping Info		
GTIN (UPC):	n/a	
SCC-14:	10072180639124	
Gross Weight:	28.17 lbs.	
Net Weight:	26.57 lbs.	
Each Weight:	3.31 Oz(s)/serving.	
Cube:	1.353	
Dimensions	17.5 x 12.875 x	
(LxWxH):	10.375	
Cases/Pallet:	56	
Tie:	8	
High:	7	
Shelf Life:	300 days	



The **SCHWAN**
FOOD COMPANY
SCHWAN'S FOOD SERVICE, INC.



Schwan's Food Service, Inc.

115 West College Drive

Marshall, MN 56258

1-877-302-7426

info@SchwansFoodService.com

8.43" x 7"

CN 080468
Cut each 53.06 oz. Breakfast Square into 16 - 3.31 oz. portions. Each 3.31 oz. portion provides 1.00 oz. equivalent meat/meat alternate, and 1 1/2 servings of bread alternate, for the Child Nutrition Meal Pattern Requirements. (Use of this logo and statement authorized by the Food and Nutrition Service, USDA 04-11.)

**FOR INSTITUTIONAL USE
COOK BEFORE SERVING
KEEP FROZEN**

COOKING INSTRUCTIONS. COOK BEFORE SERVING.
Cook product until internal temperature reaches 165°F or above.
Place frozen pizzas in 18"x26"x1/2" lightly greased bun pans.

Oven Type	OVEN TEMPERATURE	COOKING TIME
CONVECTION	350°F	15 TO 17 MINUTES
CONVENTIONAL	400°F	16 TO 19 MINUTES

Refrigerate or discard any unused portion.
NOTE: Due to variances in oven regulators, cooking time and temperature may require adjustments.

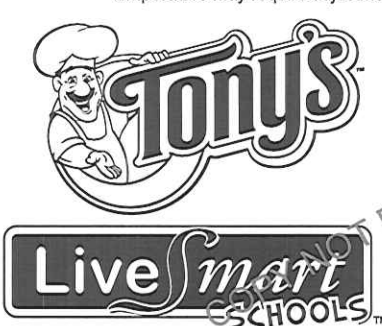

BREAKFAST SQUARES
MOZZARELLA CHEESE AND SUBSTITUTE CHEESE,
TURKEY BREAKFAST SAUSAGE
WITH TEXTURED VEGETABLE PROTEIN
AND RED SAUCE ON A CRUST

NET WT. 26.52 LBS.
(12.03 Kg)

Nutrition Facts

Serving Size 1 Piece (94g)
Servings Per Container 128

Amount Per Serving

Calories 220 Calories from Fat 70

	% Daily Value*
Total Fat 8g	12%
Saturated Fat 2g	10%
Trans Fat 0g	
Cholesterol 15mg	5%
Sodium 480mg	20%
Potassium 230mg	7%
Total Carbohydrate 27g	9%
Dietary Fiber 3g	12%
Sugars 8g	
Protein 10g	

Vitamin A 6%	Vitamin C 0%
Calcium 15%	Iron 10%

*Percent Daily Values are based on a 2,000 calorie diet. Your daily values may be higher or lower depending on your calorie needs:

	Calories:	2,000	2,500
Total Fat	Less than	65g	80g
Saturated Fat	Less than	20g	25g
Cholesterol	Less than	300mg	300mg
Sodium	Less than	2,400mg	2,400mg
Potassium		3,500mg	3,500mg
Total Carbohydrate		300g	375g
Dietary Fiber		25g	30g

Calories per gram:
Fat 9 • Carbohydrate 4 • Protein 4

INGREDIENTS: CRUST: WHITE WHOLE WHEAT FLOUR, WATER, ENRICHED FLOUR (WHEAT FLOUR, Malted BARLEY FLOUR, NIACIN, REDUCED IRON, THIAMINE MONONITRATE, RIBOFLAVIN, FOLIC ACID), SUGAR, YEAST, VEGETABLE OIL (SOYBEAN, COTTONSEED, CORN, AND/OR CANOLA OIL). CONTAINS 2% OR LESS OF: WHEAT GLUTEN, SALT, SEA SALT, DOUGH CONDITIONER (WHEY, AMMONIUM SULFATE, L-CYSTEINE), RELECITHINATED SOY FLOUR (SOY FLOUR, SOYBEAN OIL, SOY LECITHIN), DOUGH CONDITIONER (WHEAT FLOUR, WHEAT STARCH, SALT, ENZYME CONCENTRATES, MALTODEXTRIN, SUNFLOWER OIL). **TOPPINGS:** TOPPING BLEND (LOW MOISTURE PART SKIM MOZZARELLA CHEESE [CULTURED PASTEURIZED PART SKIM MILK, SALT, ENZYMES], SUBSTITUTE MOZZARELLA CHEESE [WATER, CORN OIL AND/OR SOY OIL, CASEIN, MODIFIED FOOD STARCH, WHEY, NONFAT DRY MILK, NATURAL FLAVOR, SODIUM ALUMINUM PHOSPHATE, SALT, LACTIC ACID, SODIUM PHOSPHATE, POTASSIUM CHLORIDE, CITRIC ACID, TRICALCIUM PHOSPHATE, SORBIC ACID [AS A PRESERVATIVE], XANTHAN GUM, VITAMIN A AND MINERAL SUPPLEMENT (MAGNESIUM OXIDE, DICALCIUM PHOSPHATE, ZINC OXIDE, RIBOFLAVIN [VITAMIN B2], ELECTROLYTIC IRON, FOLIC ACID, PYRIDOXINE HYDROCHLORIDE [VITAMIN B6], NIACINAMIDE, THIAMINE MONONITRATE [VITAMIN B1], CYANOCOBALAMIN [VITAMIN B12], VITAMIN A PALMITATE), ARTIFICIAL COLOR)), COOKED TURKEY PIZZA TOPPING (TURKEY BREAKFAST SAUSAGE [MECHANICALLY SEPARATED TURKEY, SEASONING (SALT, NATURAL FLAVOR, DEXTROSE, SUGAR, CITRIC ACID, BHA, BHT), WATER], TEXTURED VEGETABLE PROTEIN [SOY FLOUR, CARAMEL COLOR, ZINC OXIDE, NIACINAMIDE, FERROUS SULFATE, COPPER GLUCONATE, VITAMIN A PALMITATE, CALCIUM PANTOTHENATE, THIAMINE MONONITRATE, PYRIDOXINE HYDROCHLORIDE, RIBOFLAVIN, CYANOCOBALAMIN], WATER), SAUCE: TOMATOES (WATER, TOMATO PASTE [NOT LESS THAN 28% SOLUBLE SOLIDS]), MALTODEXTRIN, MODIFIED FOOD STARCH, CONTAINS 2% OR LESS OF: SALT, SPICE, SUGAR, HYDROLYZED SOY AND CORN PROTEIN, PAPRIKA, GARLIC POWDER, POWDERED CELLULOSE. CONTAINS: WHEAT, SOY, AND MILK.



Schwan's Food Service, Inc.
is a subsidiary of

**The SCHWAN
FOOD COMPANY**

DISTRIBUTED BY: **SCHWAN'S FOOD SERVICE, INC.,**
MARSHALL, MN 56258

COPYRIGHT © 2011, SCHWAN'S FOOD SERVICE, INC.,
ALL RIGHTS RESERVED. Conn. Lic. No: 9643

QUESTIONS OR COMMENTS?
PLEASE CONTACT US AT 1-877-302-7426,
OR VISIT OUR WEBSITE AT www.schwansfoodservice.com

Item No. **63912**
Item # 63912 11-18-11

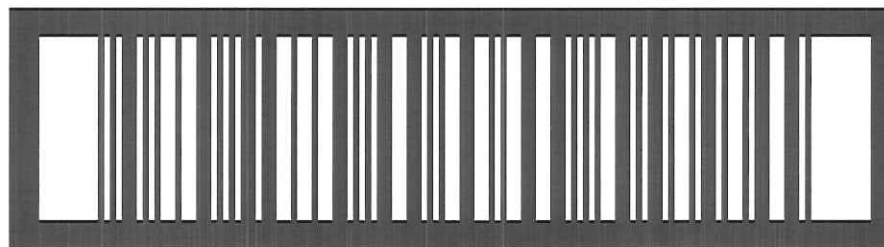

1 00 72180 63912 4



The SCHWAN FOOD COMPANY™

SCHWAN'S FOOD SERVICE, INC.



Tony's® LiveSmart(TM) Schools Sausage Breakfast Bagel (Red Sauce) IW

Product Code: 78362

Last Update Date: 03/01/2012

Please continue to check our website for the most current nutrition information.

Printed on 5/24/2012

Nutrition Information		
Serving Size:	1 Bagel (75g)	
Eaches/Case:	96	
Inner Packs/Case:	96	
Servings/Case:	9	
Calories:	160	
Calories from Fat:	35	
Total Fat:	4 g(s)	
Saturated Fat:	1.5 g(s)	
Trans Fat:	0 g(s)	
Cholesterol:	10 mg(s)	
Sodium:	430 mg(s)	
Potassium:	105 mg(s)	
Total Carbohydrate:	21 g(s)	
Total Dietary Fiber:	2 g(s)	
Sugars:	4 g(s)	
Protein:	10 g(s)	
Vitamins & Minerals		
	Amt/Srv	% DV
Vitamin A:	200 IU	4%
Vitamin C:	0 mg(s)	0%
Calcium:	150 mg(s)	15%
Iron:	1.08 mg(s)	6%
* Percent Daily Values are based on 2,000 calorie diet.		
Whole Grain		
	Amt/Srv	% Flour
Whole Grain:	12 g(s)	51%

Bring the great taste of pizza to your Breakfast Bagel. Topped with Tony's® special red sauce. Cooks right in the bake-able wrap. Easy to prepare with virtually no clean up. Great for classroom or hallway breakfast programs.

Master Case Product Name: SFS TNY LS SAUS BKFT BGL RED SCE IW CN

Child Nutrition Identification

081519

Each 2.65 oz. Breakfast Bagel provides 1.00 oz. equivalent meat/meat alternate and 1 1/4 servings of bread alternate for the Child Nutrition Meal Pattern Requirements. (Use of this logo and Statement authorized by the Food and Nutrition Service, USDA 08-11).

Preparation Instructions

COOKING INSTRUCTIONS. COOK BEFORE SERVING. Preheat the convection oven to 375°F (or a conventional oven to 400°F). Product must be cooked from a frozen state for best results. Place frozen pizzas in 18" x 26" x 1/2" bun pan. CONVECTION OVEN: 375°F for 8 to 10 minutes. CONVENTIONAL OVEN: 400°F for 10 to 12 minutes. NOTE: Oven temperature and times may vary due to oven load and/or product temperature. Refrigerate or discard any unused portion.

Ingredients

BAGEL: WATER, WHOLE WHEAT FLOUR, ENRICHED WHEAT FLOUR (WHEAT FLOUR, MALTED BARLEY FLOUR, NIACIN, IRON, ASCORBIC ACID, THIAMINE MONONITRATE, RIBOFLAVIN, FOLIC ACID, ASCORBIC ACID ADDED AS A DOUGH CONDITIONER), CONTAINS 2% OR LESS OF: YEAST, SUGAR, DRY MALT (MALTED BARLEY, WHEAT FLOUR, DEXTROSE), SALT, CALCIUM PROPIONATE, AND DOUGH CONDITIONERS (MONO & DIGLYCERIDES, POLYSORBATE 60, SODIUM STEAROYL LACTYLATE, PROPIONIC ACID, GUAR GUM, ENZYMES). TOPPINGS: REDUCED FAT MOZZARELLA CHEESE (PASTEURIZED PART SKIM MILK, CHEESE CULTURES, SALT, ENZYMES, VITAMIN A PALMITATE), COOKED TURKEY PIZZA TOPPING (TURKEY BREAKFAST SAUSAGE [MECHANICALLY SEPARATED TURKEY, SEASONING {SALT, NATURAL FLAVOR, DEXTROSE, SUGAR, CITRIC ACID, BHA, BHT}, WATER], TEXTURED VEGETABLE PROTEIN [SOY FLOUR, CARAMEL COLOR, ZINC OXIDE, NIACINAMIDE, FERROUS SULFATE, COPPER GLUCONATE, VITAMIN A PALMITATE, CALCIUM PANTOTHENATE, THIAMINE MONONITRATE, PYRIDOXINE HYDROCHLORIDE, RIBOFLAVIN, CYANOCOBALAMIN], WATER). SAUCE: TOMATOES (WATER, TOMATO PASTE [NOT LESS THAN 28% SOLUBLE SOLIDS]), MODIFIED FOOD STARCH, SUGAR, CONTAINS 2% OR LESS OF: DEXTROSE, SALT, SPICE, DEHYDRATED ONIONS, DEHYDRATED ROMANO CHEESE (PASTEURIZED CULTURED COW'S MILK, SALT, ENZYMES), GARLIC POWDER, PAPRIKA, CITRIC ACID, BEET POWDER.

Allergens

Contains Milk, Wheat, and Soy.

Hard Bid Specifications

Tony's® LiveSmart(TM) Schools Sausage Breakfast Bagel (Red Sauce) IW must provide 1 oz(s) equivalent meat/meat alternate and 1 1/4 servings of bread/bread alternate. Portion to provide a minimum of 130 calories with no more than 6 fat grams. Must contain a minimum of 1 grams of fiber and less than 530 milligrams sodium. Case pack of 96 per case. CN Label required. Acceptable Brand: Tony's® 78362 .

Shipping Info		
GTIN (UPC):	n/a	
SCC-14:	10072180783629	
Gross Weight:	17 lbs.	
Net Weight:	15.9 lbs.	
Each Weight:	2.65 Oz(s)/serving.	
Cube:	1.489	
Dimensions (LxWxH):	17.625 x 13.125 x 11.125	
Cases/Pallet:	56	
Tie:	8	
High:	7	
Shelf Life:	300 days	



Schwan's Food Service, Inc.
115 West College Drive
Marshall, MN 56258
1-877-302-7426
info@SchwansFoodService.com

CN

081519

CN

Each 2.65 oz. Breakfast Bagel provides 1.00 oz. equivalent meal/meat alternate and 1 1/4 servings of bread alternate for the Child Nutrition Meal Pattern Requirements. (Use of this logo and Statement authorized by the Food and Nutrition Service, USDA 08-11).

CN



78362

KEEP FROZEN

COOK BEFORE SERVING



**CONTAINS: 96 - 2.65 OZ BAGELS
FOR INSTITUTIONAL USE**



BREAKFAST BAGEL

**Bagel Topped with Reduced Fat Mozzarella Cheese,
Turkey Breakfast Sausage and Pizza Sauce**

Nutrition Facts

Serving Size 1 Bagel (75g)
Servings Per Container 96

Amount Per Serving

Calories 160 **Calories from Fat 35**

% Daily Value*

Total Fat 4g **6%**

Saturated Fat 1.5g **8%**

Trans Fat 0g

Cholesterol 10mg **3%**

Sodium 430mg **18%**

Potassium 105mg **3%**

Total Carbohydrate 21g **7%**

Dietary Fiber 2g **8%**

Sugars 4g

Protein 10g

Vitamin A 4% • **Vitamin C 0%**

Calcium 15% • **Iron 6%**

*Percent Daily Values are based on a 2,000 calorie diet. Your daily values may be higher or lower depending on your calorie needs:

	Calories:	2,000	2,500
Total Fat	Less than	65g	80g
Saturated Fat	Less than	20g	25g
Cholesterol	Less than	300mg	300mg
Sodium	Less than	2,400mg	2,400mg
Potassium		3,500 mg	3,500 mg
Total Carbohydrate		300g	375g
Dietary Fiber		25g	30g

Calories per gram:
Fat 9 • Carbohydrate 4 • Protein 4

INGREDIENTS: BAGEL: WATER, WHOLE WHEAT FLOUR, ENRICHED WHEAT FLOUR (WHEAT FLOUR, MALTED BARLEY FLOUR, NIACIN, IRON, ASCORBIC ACID, THIAMINE MONONITRATE, RIBOFLAVIN, FOLIC ACID, CONTAINS 2% OR LESS OF: YEAST, SUGAR, DRY MALT (MALTED BARLEY, WHEAT FLOUR, DEXTROSE), SALT, CALCIUM PROPIONATE, AND DOUGH CONDITIONERS (MONO & DIGLYCERIDES, POLYSORBATE 60, SODIUM STEAROYL LACTYLATE, PROPIONIC ACID, GUAR GUM, ENZYMES). TOPPINGS: REDUCED FAT MOZZARELLA CHEESE (PASTEURIZED PART SKIM MILK, CHEESE CULTURES, SALT, ENZYMES, VITAMIN A PALMITATE), COOKED TURKEY PIZZA TOPPING (TURKEY BREAKFAST SAUSAGE [MECHANICALLY SEPARATED TURKEY, SEASONING (SALT, NATURAL FLAVOR, DEXTROSE, SUGAR, CITRIC ACID, BHA, BHT), WATER], TEXTURED VEGETABLE PROTEIN [SOY FLOUR, CARAMEL COLOR, ZINC OXIDE, NIACINAMIDE, FERROUS SULFATE, COPPER GLUCONATE, VITAMIN A PALMITATE, CALCIUM PANTOTHENATE, THIAMINE MONONITRATE, PYRIDOXINE HYDROCHLORIDE, RIBOFLAVIN, CYANOCOBALAMIN, WATER), SAUCE: TOMATOES (WATER, TOMATO PASTE [NOT LESS THAN 28% SOLUBLE SOLIDS], MODIFIED FOOD STARCH, SUGAR, CONTAINS 2% OR LESS OF: DEXTROSE, SALT, SPICE, DEHYDRATED ONIONS, DEHYDRATED ROMANO CHEESE (PASTEURIZED CULTURED COW'S MILK, SALT, ENZYMES), GARLIC POWDER, PAPRIKA, CITRIC ACID, BEET POWDER.

CONTAINS: WHEAT, MILK, AND SOY

COOKING INSTRUCTIONS: COOK BEFORE SERVING. Preheat the convection oven to 375 Degrees F (or a conventional oven to 400 Degrees F). Product must be cooked from a frozen state for best results. Place frozen pizzas in 18" x 26" x 1/2" bun pan. **CONVECTION OVEN:** 375 Degrees F for 8 to 10 minutes. **CONVENTIONAL OVEN:** 400 Degrees F for 10 to 12 minutes. NOTE: Oven temperature and times may vary due to oven load and/or product temperature. Refrigerate or discard any unused portion.

NET WT. 15.90 LBS (7.21 Kg)

Distributed By: SCHWAN'S FOOD SERVICE, INC., MARSHALL, MN 56258

Copyright© 2011 SCHWAN'S FOOD SERVICE, INC. ALL RIGHTS RESERVED

Questions or comments? Please contact us at 1-877-302-7426 or visit

our website at: www.schwansfoodservice.com



10072180783629

78362 8-11-11



The SCHWAN FOOD COMPANY™

SCHWAN'S FOOD SERVICE, INC.



Big Daddy's® Cheese Filled Whole Grain Breadsticks

Product Code: 68765

Last Update Date: 03/23/2012

Please continue to check our website for the most current nutrition information.

Printed on 5/24/2012

Nutrition Information		
Serving Size:	1 Breadstick (3 oz/85g)	
Eaches/Case:	108	
Inner Packs/Case:	108	
Servings/Case:	108	
Calories:	210	
Calories from Fat:	50	
Total Fat:	6 g(s)	
Saturated Fat:	2 g(s)	
Trans Fat:	0 g(s)	
Cholesterol:	5 mg(s)	
Sodium:	290 mg(s)	
Total Carbohydrate:	30 g(s)	
Total Dietary Fiber:	2 g(s)	
Sugars:	4 g(s)	
Protein:	11 g(s)	
Vitamins & Minerals		
	Amt/Srv	% DV
Vitamin A:	200 IU	4%
Vitamin C:	0 mg(s)	0%
Calcium:	200 mg(s)	20%
Iron:	1.44 mg(s)	8%
* Percent Daily Values are based on 2,000 calorie diet.		
Whole Grain		
	Amt/Srv	% Flour
Whole Grain:	19 g(s)	55%

Deliciously gooey mozzarella cheese filled sticks. Serve two cheese sticks as a main dish with flavor-packed dips such as marinara, BBQ, Buffalo and Ranch. Each two-stick serving provides 2 oz of M/MA and 4.5 servings of bread alternate.

Master Case Product Name: SFS BD WG CHS FILLED BRDSTX BULK CN

Child Nutrition Identification

082794

Each 3.00 oz. cheesestick provides 1.00 oz. equivalent meat alternate and 2 1/4 servings of bread alternate for the Child Nutrition Meal Pattern Requirements. (Use of this logo and statement authorized by the Food and Nutrition Service, USDA 01-12)

Preparation Instructions

COOKING INSTRUCTIONS Convection Oven: Preheat oven to 375°F, High Fan 1. Place Frozen Breadstick on Paper Liner, Using a Full Sheet Pan 2. Bake at 375°F Low Fan, For 10 to 12 Minutes, Until Internal Temperature Reaches 160°F 3. For Even Cooking, Rotate Pans Partway Through Baking Time. NOTE: Due to Variances in Oven Regulators, Cooking Times and Temperatures May Require Adjustments

Ingredients

{WHEAT FLOUR, NIACIN, REDUCED IRON, THIAMINE MONONITRATE, RIBOFLAVIN, ENZYME, FOLIC ACID}, WATER, CORN OIL, SUGAR, CONTAINS 2% OR LESS OF: DRIED EXTRACT OF MALTED BARLEY & CORN, SALT, YEAST, ASCORBIC ACID ADDED AS A DOUGH CONDITIONER, SORBITAN MONOSTEARATE, CALCIUM SULFATE, ENZYMES), REDUCED FAT LOW MOISTURE PART SKIM MOZZARELLA CHEESE (PASTEURIZED PART SKIM MILK, CHEESE CULTURES, SALT, ENZYMES, VITAMIN A PALMITATE).

Allergens

Contains Milk and Wheat.

Hard Bid Specifications

Big Daddy's® Cheese Filled Whole Grain Breadsticks must provide 1 oz(s) equivalent meat/meat alternate and 2 1/4 servings of bread/bread alternate. Portion to provide a minimum of 180 calories with no more than 8 fat grams. Must contain a minimum of 1 grams of fiber and less than 390 milligrams sodium. Case pack of 108 per case. CN Label required. Acceptable Brand: Big Daddy's® 68765 .

Shipping Info		
GTIN (UPC):	n/a	
SCC-14:	10072180687651	
Gross Weight:	22.11 lbs.	
Net Weight:	20.25 lbs.	
Each Weight:	3 Oz(s)/serving.	
Cube:	1.266	
Dimensions (LxWxH):	19.813 x 13.188 x 8.375	
Cases/Pallet:	56	
Tie:	7	
High:	8	
Shelf Life:	365 days	



Schwan's Food Service, Inc.

115 West College Drive

Marshall, MN 56258

1-877-302-7426

info@SchwansFoodService.com

CN

082794

Each 3.00 oz. cheesestick provides 1.00 oz. equivalent meat alternate and 2 1/4 servings of bread alternate for the Child Nutrition Meal Pattern Requirements. (Use of this logo and statement authorized by the Food and Nutrition Service, USDA 01-12.)

CN



CHEESE FILLED WHOLE GRAIN BREADSTICKS

Nutrition Facts

Serving Size 1 Piece (85g / 3oz)
Servings Per Container 108

Amount Per Serving		
Calories 210	Calories from Fat 50	
		% Daily Value*
Total Fat 6g		8%
Saturated Fat 2g		10%
Trans Fat 0g		
Cholesterol 5mg		2%
Sodium 290mg		12%
Total Carbohydrate 30g		10%
Dietary Fiber 2g		10%
Sugars 0g		
Protein 11g		

Vitamin A 4% • Vitamin C 0%

Calcium 20% • Iron 8%

*Percent Daily Values are based on a diet of other people's misdeeds.
Your daily values may be higher or lower depending on your calorie needs.

	Calories	2,000	2,500
Total Fat	Less than	65g	80g
Saturated Fat	Less than	20g	25g
Cholesterol	Less than	300mg	300mg
Sodium	Less than	2,400mg	2,400mg
Total Carbohydrate	Less than	300g	375g
Dietary Fiber	Less than	25g	30g

Calories per gram:
Fat 9 • Carbohydrate 4 • Protein 4

ITEM NO.

68765

COOK
BEFORE SERVINGFOR
INSTITUTIONAL USE

INSPECTED BY THE
U.S. DEPT. OF AGRICULTURE
IN ACCORDANCE WITH
FNS REQUIREMENTS

INGREDIENTS: DOUGH (FLOUR BLEND [WHOLE WHEAT FLOUR, ENRICHED FLOUR (WHEAT FLOUR, NIACIN, REDUCED IRON, THIAMINE MONONITRATE, RIBOFLAVIN, ENZYME, FOLIC ACID)], WATER, CORN OIL, SUGAR, CONTAINS 2% OR LESS OF: DRIED EXTRACT OF MALTED BARLEY & CORN, SALT, YEAST, ASCORBIC ACID ADDED AS A DOUGH CONDITIONER, SORBITAN MONOSTEARATE, CALCIUM SULFATE, ENZYMES), REDUCED FAT LOW MOISTURE PART SKIM MOZZARELLA CHEESE (PASTEURIZED PART SKIM MILK, CHEESE CULTURES, SALT, ENZYMES, VITAMIN A PALMITATE).
CONTAINS: WHEAT AND MILK.

**KEEP
FROZEN**

Schwan's Food Service, Inc.
is a subsidiary of

**The SCHWAN
FOOD COMPANY**

DISTRIBUTED BY: SCHWAN'S FOOD SERVICE, INC., MARSHALL, MN 56258

© 2012 SCHWAN'S FOOD SERVICE INC., ALL RIGHTS RESERVED.

QUESTIONS OR COMMENTS? PLEASE CONTACT US AT 1-877-382-7426, OR VISIT OUR WEBSITE AT www.schwansfoodservice.com

Product of U.S.A.

CONTAINS: 108 - 3 OZ CHEESE FILLED
WHOLE GRAIN BREADSTICKS

NET WT. 20.25 LBS (9.18 Kg)

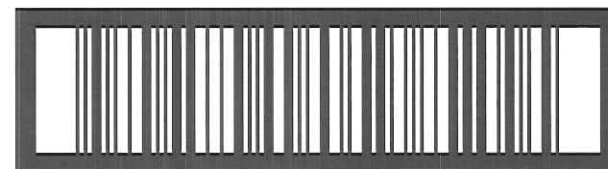

1 00 72180 68765 1



The SCHWAN FOOD COMPANY™

SCHWAN'S FOOD SERVICE, INC.



Tony's® SmartPizza(TM) Whole Grain Cheese Pizza 100% Mozz

Product Code: 78697

Last Update Date: 03/05/2012

Please continue to check our website for the most current nutrition information.

Printed on 5/24/2012

Nutrition Information		
Serving Size:	1 Piece(128g/4.50oz)	
Eaches/Case:	96	
Inner Packs/Case:	12	
Servings/Case:	96	
Calories:	300	
Calories from Fat:	100	
Total Fat:	11 g(s)	
Saturated Fat:	5 g(s)	
Trans Fat:	0 g(s)	
Cholesterol:	25 mg(s)	
Sodium:	560 mg(s)	
Potassium:	220 mg(s)	
Total Carbohydrate:	34 g(s)	
Total Dietary Fiber:	4 g(s)	
Sugars:	12 g(s)	
Protein:	18 g(s)	
Vitamins & Minerals		
	Amt/Srv	% DV
Vitamin A:	400 IU	8%
Vitamin C:	0 mg(s)	0%
Calcium:	300 mg(s)	30%
Iron:	1.8 mg(s)	10%
* Percent Daily Values are based on 2,000 calorie diet.		
Whole Grain		
	Amt/Srv	% Flour
Whole Grain:	18 g(s)	52%

Tony's® 4x6 with whole grain goodness, part of the delicious SmartPizza(TM) line. Your kids will love the great taste and authentic appearance and you'll feel great serving it. Whole Grain item 78697 includes 51% whole grains, over one CN bread serving from whole grains. We use white whole wheat flour for a texture and appearance similar to traditional white crust. CN approved.

Master Case Product Name: SFS TNY SMART WGRAIN 4X6 CHS CN

Child Nutrition Identification

080908

Each 4.50 oz Cheese Pizza provides 2.0 oz. equivalent meat alternate, 2 1/4 servings of bread alternate, and 1/8 cup vegetable for the Child Nutrition Meal Pattern Requirements. (Use of this logo and statement authorized by the Food and Nutrition Service, USDA 07-11.)

Preparation Instructions

COOKING GUIDELINES. COOK BEFORE SERVING. Place 16 frozen pizzas in 18" x 26" x 1/2" parchment lined sheet pans. CONVECTION OVEN: Low fan, 350°F for 13 to 16 minutes. CONVENTIONAL OVEN: 400°F for 17 to 20 minutes. Rotate pans one half turn to prevent cheese from burning. NOTE: Cook until internal temperature of pizza reaches 160°F. Due to variances in oven regulators and number of pizzas in an oven, cooking time and temperature may require adjustments. Refrigerate or discard any unused portion.

Ingredients

INGREDIENTS: CRUST: FLOUR BLEND (WHITE WHOLE WHEAT FLOUR, ENRICHED FLOUR [WHEAT FLOUR, Malted BARLEY FLOUR, NIACIN, REDUCED IRON, THIAMINE MONONITRATE, RIBOFLAVIN, FOLIC ACID]), WATER, DEFATTED SOY FLOUR, YEAST, SOY PROTEIN CONCENTRATE, CONTAINS 2% OR LESS OF: VEGETABLE OIL (SOYBEAN, COTTONSEED, CORN, AND/OR CANOLA OIL), SUGAR, GLUCONO-DELTA-LACTONE, DATEM, LEAVENING (SODIUM ACID PYROPHOSPHATE, SODIUM BICARBONATE, MONOCALCIUM PHOSPHATE, CALCIUM LACTATE), SALT, MODIFIED FOOD STARCH, DOUGH CONDITIONER (WHEAT STARCH, L-CYSTEINE HYDROCHLORIDE, AMMONIUM SULFATE). LOW MOISTURE PART SKIM MOZZARELLA CHEESE: (CULTURED PASTEURIZED PART SKIM MILK, SALT, ENZYMES). SAUCE: TOMATOES (WATER, TOMATO PASTE [NOT LESS THAN 28% SOLUBLE SOLIDS]), MODIFIED FOOD STARCH, SUGAR, CONTAINS 2% OR LESS OF: DEXTROSE, SALT, SPICE, ONION, DEHYDRATED ROMANO CHEESE (SHEEP'S AND COW'S MILK, CHEESE CULTURES, SALT, ENZYMES), GARLIC POWDER, PAPRIKA, CITRIC ACID, BEET POWDER.

Allergens

Contains Milk, Wheat, and Soy.

Hard Bid Specifications

Tony's® SmartPizza(TM) Whole Grain Cheese Pizza 100% Mozz must provide 2 oz(s) equivalent meat/meat alternate, 2 1/4 servings of bread/bread alternate, and 1/8 cup vegetable. Portion to provide a minimum of 270 calories with no more than 13 fat grams. Must contain a minimum of 3 grams of fiber and less than 660 milligrams sodium. Case pack of 96 per case. CN Label required. Acceptable Brand: Tony's® 78697 .

Shipping Info	
GTIN (UPC):	72180786975
SCC-14:	n/a
Gross Weight:	28.6 lbs.
Net Weight:	27 lbs.
Each Weight:	4.5 Oz(s)/serving.
Cube:	1.219
Dimensions (LxWxH):	16.875 x 13.313 x 9.375
Cases/Pallet:	64
Tie:	8
High:	8
Shelf Life:	300 days



Schwan's Food Service, Inc.
115 West College Drive
Marshall, MN 56258
1-877-302-7426
info@SchwansFoodService.com

46.705"

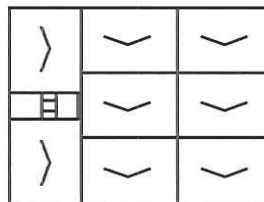

33.865"

Cases per layer - 8
Layers/stacked - 8
Interlock Layers - 5, 6, 7, 8

Cooking Guidelines: Cook Before Serving.

Place 16 frozen pizzas in 18" x 26" x 1/2" parchment lined sheet pans.

Cook until internal temperature reaches 160°F.

Rotate pans one half turn to prevent cheese from burning.

Oven Type	Preheated Oven Temperature	Cooking Time
Convection	Low fan, 350°F	13 to 16 minutes
Conventional	400°F	17 to 20 minutes

NOTE: Due to variances in oven regulators and number of pizzas in an oven, cooking times and temperatures may require adjustments. Refrigerate or discard any unused portion.

- Easy lift out and place on the pans.
- No parchment paper needed.
- Easy to peel flavor seal for full freshness.
- Touchless Handling System: Freezer to oven with food safety assurance.



Pizza. . .
you can't beat
the system.

CN

080908

Each 4.50 oz. Cheese Pizza provides 2.00 oz. equivalent meat alternate, 2 1/4 servings of bread alternate, and 1/8 cup vegetable for the Child Nutrition Meal Pattern Requirements. (Use of this logo and statement authorized by the Food and Nutrition Service, USDA 07-11.)

CN



SmartPizza

CHEESE
PIZZA

ITEM NO. **78697**

FOR
INSTITUTIONAL
USE

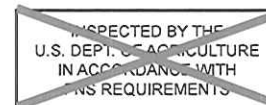

INGREDIENTS: CRUST: FLOUR BLEND (WHITE WHOLE WHEAT FLOUR, ENRICHED FLOUR [WHEAT FLOUR, MALTED BARLEY FLOUR, NIACIN, REDUCED IRON, THIAMINE MONONITRATE, RIBOFLAVIN, FOLIC ACID]), WATER, DEFATTED SOY FLOUR, YEAST, SOY PROTEIN CONCENTRATE, CONTAINS 2% OR LESS OF: VEGETABLE OIL (SOYBEAN, COTTONSEED, CORN, AND/OR CANOLA OIL), SUGAR, GLUCONO-DELTA-LACTONE, DATEM, LEAVENING (SODIUM ACID PYROPHOSPHATE, SODIUM BICARBONATE, MONOCALCIUM PHOSPHATE, CALCIUM LACTATE), SALT, MODIFIED FOOD STARCH, DOUGH CONDITIONER (WHEAT STARCH, L-CYSTEINE HYDROCHLORIDE, AMMONIUM SULFATE). LOW MOISTURE PART SKIM MOZZARELLA CHEESE: (CULTURED PASTEURIZED PART SKIM MILK, SALT, ENZYMES). SAUCE: TOMATOES (WATER, TOMATO PASTE [NOT LESS THAN 28% SOLUBLE SOLIDS]), MODIFIED FOOD STARCH, SUGAR, CONTAINS 2% OR LESS OF: DEXTROSE, SALT, SPICE, ONION, DEHYDRATED ROMANO CHEESE (SHEEP'S AND COW'S MILK, CHEESE CULTURES, SALT, ENZYMES), GARLIC POWDER, PAPRIKA, CITRIC ACID, BEET POWDER.
CONTAINS: WHEAT, MILK, AND SOY.

KEEP FROZEN

COOK BEFORE
SERVING



Schwan's Food Service, Inc.
is a subsidiary of

The SCHWAN
FOOD COMPANY

DISTRIBUTED BY: SCHWAN'S FOOD SERVICE, INC., MARSHALL, MINNESOTA 56258

©2011, SCHWAN'S FOOD SERVICE, INC. ALL RIGHTS RESERVED. Conn. Lic. No. 4196

QUESTIONS OR COMMENTS? PLEASE CONTACT US AT 877-302-7426 OR VISIT OUR WEBSITE AT: WWW.SCHWANSFOODSERVICE.COM

CONTAINS: 96 - 4.50 OZ PIZZAS

NET WT. 432 OZ (27 LBS)
12.24 Kg

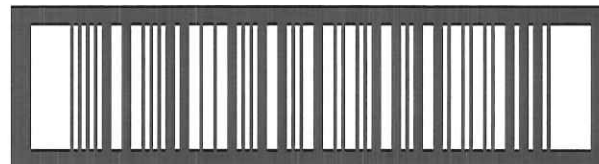

0 00 72180 78697 5



The SCHWAN FOOD COMPANY™

SCHWAN'S FOOD SERVICE, INC.



Tony's® SmartPizza(TM) Whole Grain 4x6 Pepperoni Pizza 100%

Product Code: 78698

Last Update Date: 05/21/2012

Please continue to check our website for the most current nutrition information.

Printed on 5/24/2012

Nutrition Information		
Serving Size:	1 Piece	
	(127g)	
Eaches/Case:	96	
Inner Packs/Case:	12	
Servings/Case:	96	
Calories:	300	
Calories from Fat:	100	
Total Fat:	12 g(s)	
Saturated Fat:	5 g(s)	
Trans Fat:	0 g(s)	
Cholesterol:	25 mg(s)	
Sodium:	630 mg(s)	
Potassium:	230 mg(s)	
Total Carbohydrate:	34 g(s)	
Total Dietary Fiber:	4 g(s)	
Sugars:	12 g(s)	
Protein:	18 g(s)	
Vitamins & Minerals		
	Amt/Srv	% DV
Vitamin A:	300 IU	6%
Vitamin C:	0 mg(s)	0%
Calcium:	250 mg(s)	25%
Iron:	2.7 mg(s)	15%
* Percent Daily Values are based on		
2,000 calorie diet.		
Whole Grain		
	Amt/Srv	% Flour
Whole Grain:	18 g(s)	52%

Shipping Info	
GTIN (UPC):	72180786982
SCC-14:	n/a
Gross Weight:	28.49 lbs.
Net Weight:	26.88 lbs.
Each Weight:	4.47 Oz(s)/serving.
Cube:	1,219
Dimensions	16.875 x 13.313 x
(LxWxH):	9,375
Cases/Pallet:	64
Tie:	8
High:	8
Shelf Life:	300 days

New Whole Grain 100% Mozzarella cheese, 4x6 Pizza, a product with 51% whole grains, over one CN bread serving from whole grains. We use white whole wheat flour for a texture and appearance similar to traditional white crust. Consumer benefits a nutritionally enhanced pizza that offers health benefits to consumers. Better Nutrition, lower in fat, and sodium while delivering higher fiber. Commodity Friendly 78698 is available for commodity processing.

Master Case Product Name: SFS TNY SMART WGRAIN 4X6 PEPP CN

Child Nutrition Identification

080972

Each 4.48 oz portion of pizza with fat reduced pepperoni provides 2.0 oz. equivalent meat/meat alternate, 2 1/4 servings of bread alternate, and 1/8 cup vegetable for the Child Nutrition Meal Pattern Requirements. (Use of this logo and statement authorized by the Food and Nutrition Service, USDA 07-11.)

Preparation Instructions

COOKING GUIDELINES. COOK BEFORE SERVING. Place 16 frozen pizzas in 18" x 26" x 1/2" parchment lined sheets pans. CONVECTION OVEN: Low fan, 350°F for 13 to 16 minutes. CONVENTIONAL OVEN: 400°F for 17 to 20 minutes. Rotate pans one half turn to prevent cheese from burning. NOTE: Cook until internal temperature of pizza reaches 160°F. Due to variances in oven regulators and number of pizzas in an oven, cooking time and temperature may require adjustment.

Ingredients

INGREDIENTS: CRUST: FLOUR BLEND (WHITE WHOLE WHEAT FLOUR, ENRICHED FLOUR [WHEAT FLOUR, MALTED BARLEY FLOUR, NIACIN, REDUCED IRON, THIAMINE MONONITRATE, RIBOFLAVIN, FOLIC ACID]), WATER, DEFATTED SOY FLOUR, YEAST, SOY PROTEIN CONCENTRATE, CONTAINS 2% OR LESS OF: VEGETABLE OIL (SOYBEAN, COTTONSEED, CORN, AND/OR CANOLA OIL), SUGAR, GLUCONO-DELTA-LACTONE, DATEM, LEAVENING (SODIUM ACID PYROPHOSPHATE, SODIUM BICARBONATE, MONOCALCIUM PHOSPHATE, CALCIUM LACTATE), SALT, MODIFIED FOOD STARCH, DOUGH CONDITIONER (WHEAT STARCH, L-CYSTEINE HYDROCHLORIDE, AMMONIUM SULFATE). LOW MOISTURE PART SKIM MOZZARELLA CHEESE (CULTURED PASTEURIZED PART SKIM MILK, SALT, ENZYMES). SAUCE: TOMATOES (WATER, TOMATO PASTE [NOT LESS THAN 28% SOLUBLE SOLIDS]), MODIFIED FOOD STARCH, SUGAR, CONTAINS 2% OR LESS OF: DEXTROSE, SALT, SPICE, ONION, DEHYDRATED ROMANO CHEESE (SHEEP'S AND COW'S MILK, CHEESE CULTURES, SALT, ENZYMES), GARLIC POWDER, PAPRIKA, CITRIC ACID, BEET POWDER. FAT REDUCED PEPPERONI (PORK, BEEF, WATER, TEXTURED VEGETABLE PROTEIN PRODUCT* (SOY PROTEIN CONCENTRATE, ZINC OXIDE, NIACINAMIDE, FERROUS SULFATE, COPPER GLUCONATE, VITAMIN A PALMITATE, CALCIUM PANTOTHENATE, THIAMINE MONONITRATE [B1], PYRIDOXINE HYDROCHLORIDE [B6], RIBOFLAVIN [B2], AND CYANOCOBALAMIN [B12]), SALT, CONTAINS 2% OR LESS OF SPICES, DEXTROSE, LACTIC ACID STARTER CULTURE, OLEORESIN OF PAPRIKA, FLAVORING, SODIUM NITRITE, BHA, BHT, CITRIC ACID. *INGREDIENT NOT IN REGULAR PEPPERONI).

Allergens

Contains Milk, Wheat, and Soy.

NA

Hard Bid Specifications

Tony's® SmartPizza(TM) Whole Grain 4x6 Pepperoni Pizza 100% must provide 2 oz(s) equivalent meat/meat alternate, 2 1/4 servings of bread/bread alternate, and 1/8 cup vegetable. Portion to provide a minimum of 270 calories with no more than 14 fat grams. Must contain a minimum of 3 grams of fiber and less than 730 milligrams sodium. Case pack of 96 per case. CN Label required. Acceptable Brand: Tony's® 78698 .



Schwan's Food Service, Inc.
115 West College Drive
Marshall, MN 56258
1-877-302-7426
info@SchwansFoodService.com

CN 080972

Each 4.48 oz. Pizza with Fat Reduced Pepperoni provides 2.00 oz. equivalent meat/meat alternate, 2 1/4 servings of bread alternate, and 1/8 cup vegetable for the Child Nutrition Meal Pattern Requirements. (Use of this logo and statement authorized by the Food and Nutrition Service, USDA 07-11).

CN



SmartPizza.

ITEM NO.

78698

PIZZA WITH
FAT REDUCED
PEPPERONI

FOR INSTITUTIONAL
USE



INGREDIENTS: CRUST: FLOUR BLEND (WHITE WHOLE WHEAT FLOUR, ENRICHED FLOUR [WHEAT FLOUR, MATED BARLEY FLOUR, NIACIN, REDUCED IRON, THIAMINE MONONITRATE, RIBOFLAVIN, FOLIC ACID]), WATER, DEFATTED SOY FLOUR, YEAST, SOY PROTEIN CONCENTRATE, CONTAINS 2% OR LESS OF: VEGETABLE OIL (SOYBEAN, COTTONSEED, CORN, AND/OR CANOLA OIL), SUGAR, GLUCONO-DELTA-LACTONE, DATEM, LEAVENING (SODIUM ACID PYROPHOSPHATE, SODIUM BICARBONATE, MONOCALCIUM PHOSPHATE, CALCIUM LACTATE), SALT, MODIFIED FOOD STARCH, DOUGH CONDITIONER (WHEAT STARCH, L-CYSTEINE HYDROCHLORIDE, AMMONIUM SULFATE). **LOW MOISTURE PART SKIM MOZZARELLA CHEESE:** (CULTURED PASTEURIZED PART SKIM MILK, SALT, ENZYMES). **SAUCE:** TOMATOES (WATER, TOMATO PASTE [NOT LESS THAN 28% SOLUBLE SOLIDS]), MODIFIED FOOD STARCH, SUGAR, CONTAINS 2% OR LESS OF: DEXTROSE, SALT, SPICE, ONION, DEHYDRATED ROMANO CHEESE (SHEEP'S AND COW'S MILK, CHEESE CULTURES, SALT, ENZYMES), GARLIC POWDER, PAPRIKA, CITRIC ACID, BEET POWDER. **FAT REDUCED PEPPERONI:** (PORK, BEEF, WATER, TEXTURED VEGETABLE PROTEIN PRODUCT* (SOY PROTEIN CONCENTRATE, ZINC OXIDE, NIACINAMIDE, FERROUS SULFATE, COPPER GLUCONATE, VITAMIN A-PALMITATE, CALCIUM PANTOTHENATE, THIAMINE MONONITRATE [B1], PYRIDOXINE HYDROCHLORIDE [B6], RIBOFLAVIN [B2], AND CYANOCOBALAMIN [B12]), SALT, CONTAINS 2% OR LESS OF SPICES, DEXTROSE, LACTIC ACID STARTER CULTURE, OLEORESIN OF PAPRIKA, FLAVORING, SODIUM NITRITE, BHA, BHT, CITRIC ACID. *INGREDIENT NOT IN REGULAR PEPPERONI).

CONTAINS: WHEAT, MILK AND SOY.

KEEP FROZEN
COOK BEFORE
SERVING



CONTAINS: 96 - 4.48 OZ PIZZAS

NET WT. 430.08 OZ.
(26 LBS 14.08 OZ) 12.19 Kg

DISTRIBUTED BY: SCHWAN'S FOOD SERVICE, INC., MARSHALL, MINNESOTA 56258
©2011, SCHWAN'S FOOD SERVICE, INC. ALL RIGHTS RESERVED. Conn. Lic. No. 4196
QUESTIONS OR COMMENTS? PLEASE CONTACT US AT 877-302-7426 OR VISIT OUR WEBSITE AT: WWW.SCHWANSFOODSERVICE.COM



Schwan's Food Service, Inc.
is a subsidiary of

The SCHWAN
FOOD COMPANY



0 00 72180 78698 2

ITEM



The SCHWAN FOOD COMPANY™
SCHWAN'S GLOBAL SUPPLY CHAIN, INC.

SAP Item # 73158

LABEL SET UP SHEET

1. HS 3 Digit Code	
2. Brand	Tony's®
3. Brand Family	
4. Product "Fanciful" Name	
5. True Product Name	WHOLE GRAIN CLASSIC WEDGE CHEESE PIZZA
6. Flavor/Variety Descriptor	
7. USDA Inspection Legend	Inspected by the U.S. Dept. of Agriculture in accordance with FNS requirements
8. Establishment Numbers	
9. CN Number	082815
10. CN Box	Each 4.60 oz. Whole Grain Cheese Pizza provides 2.00 oz. equivalent meat alternate, 2 1/4 servings of bread alternate, and 1/8 cup vegetable for the Child Nutrition Meal Pattern Requirements. (Use of this logo and statement authorized by the Food and Nutrition Service, USDA 02-12.)
11. Statement of Piece Count/Item Weight	CONTAINS 96 - 4.60 OZ PIZZAS
12. Net Contents:	441.60 OZ (27 LBS 9.6 OZ) 12.51kg
13. Certifications	
14. For Institutional Use Only	Yes
15. Serving Suggestion	No
16. Real SEAL Logo	No Logo
17. Handling Statement	KEEP FROZEN, Cook Before Serving
18. Flags/Banners	N/A
19. Required Statements	N/A
20. Validated Nutrient Content/Health Claims (including disclaimers)	NA
21. Ingredient Statement	INGREDIENTS: CRUST: FLOUR BLEND (WHITE WHOLE WHEAT FLOUR, ENRICHED FLOUR [WHEAT FLOUR, MALTED BARLEY FLOUR, NIACIN, REDUCED IRON, THIAMINE MONONITRATE, RIBOFLAVIN, FOLIC ACID]), WATER, DEFATTED SOY FLOUR, YEAST, SOY PROTEIN CONCENTRATE, CONTAINS 2% OR LESS OF: VEGETABLE OIL (SOYBEAN, COTTONSEED, CORN, AND/OR CANOLA OIL), SUGAR, GLUCONO-DELTA-LACTONE, DATEM, LEAVENING (SODIUM ACID PYROPHOSPHATE, SODIUM BICARBONATE, MONOCALCIUM PHOSPHATE, CALCIUM LACTATE), SALT, MODIFIED FOOD STARCH, DOUGH CONDITIONER (WHEAT STARCH, L-CYSTEINE HYDROCHLORIDE, AMMONIUM SULFATE). CHEESE BLEND (LOW MOISTURE PART SKIM MOZZARELLA CHEESE [PASTEURIZED MILK, CULTURES, SALT, ENZYMES], MOZZARELLA CHEESE SUBSTITUTE [WATER, VEGETABLE OIL (CORN OIL AND/OR SOY OIL), CHEESE SOLIDS, MODIFIED FOOD STARCH, NONFAT DRY MILK, SWEET WHEY, SALT, MAGNESIUM OXIDE, FERRIC ORTHOPHOSPHATE, VITAMIN A PALMITATE, NIACINAMIDE, ZINC OXIDE, PYRIDOXINE HYDROCHLORIDE (VITAMIN B6), CYANOCOBALAMIN]). SAUCE: TOMATOES (WATER, TOMATO PASTE [NOT LESS THAN 28% SOLUBLE SOLIDS]),



The SCHWAN FOOD COMPANY™
SCHWAN'S GLOBAL SUPPLY CHAIN, INC.

SAP Item # 73158

	MODIFIED FOOD STARCH, SUGAR, CONTAINS 2% OR LESS OF: DEXTROSE, SALT, SPICE, ONION, DEHYDRATED ROMANO CHEESE (SHEEP'S AND COW'S MILK, CHEESE CULTURES, SALT, ENZYMES), GARLIC POWDER, PAPRIKA, CITRIC ACID, BEET POWDER.
22. Allergens	Contains: Milk or its Derivatives
	Wheat or its Derivatives
	Soy or its Derivatives
23. Advisory/Species Labeling	NA
24. Distribution Line	Distributed by Schwan's Food Service, Inc., Marshall, MN 56258
25. Copyright Statement	© 2012, Schwan's Food Service, Inc. All Rights Reserved.
26. Product Origin	N/A
27. Conn. Lic. No.	4196
28. Contact Information for Pkg	1-877-302-7426, www.schwansfoodservice.com
29. Quality Guarantee	N/A
30. Reference Code	Package Item #
31. Customer Product Number	
32. (a) SCC-14 (Master Case)	10072180731583
32. (b) UPC-12 (Pack/Sell Unit)	
32. (c) UPC-12 (Piece/IW Sell Unit)	
33. Cook vs. Prepare	COOKING INSTRUCTIONS
34. Steps	COOKING GUIDELINES. COOK BEFORE SERVING. Place 16 frozen pizzas in a 18" x 26" x 1/2" parchment lined sheet pan. CONVECTION OVEN: Low fan, 350°F for 13 to 16 minutes. CONVENTIONAL OVEN: 400°F for 17 to 20 minutes. Rotate pans one half turn to prevent cheese from burning. Note: Cook until internal temperature of pizza reaches 160°F. Due to variances in oven regulators and number of pizzas in an oven, cooking time and temperature may require adjustments. Refrigerate or discard any unused portion.



The SCHWAN FOOD COMPANY™

SCHWAN'S GLOBAL SUPPLY CHAIN, INC.

SAP Item # 73158

35. [Nutritional Fact Panel]

Nutrition Facts

Serving Size 1 pizza (130g)

Servings Per Container 96

Amount Per Serving

Calories 300 Calories from Fat 100

% Daily Value*

Total Fat 11g 17%

Saturated Fat 4g 21%

Trans Fat 0g

Cholesterol 15mg 5%

Sodium 580mg 24%

Potassium 240mg 7%

Total Carbohydrate 37g 12%

Dietary Fiber 4g 17%

Sugars 15g

Protein 15g

Vitamin A 10% • Vitamin C 0%

Calcium 30% • Iron 15%

*Percent Daily Values are based on a 2,000 calorie diet. Your daily values may be higher or lower depending on your calorie needs:

		Calories:	2,000	2,500
Total Fat	Less than	65g	80g	
Saturated Fat	Less than	20g	25g	
Cholesterol	Less than	300mg	300mg	
Sodium	Less than	2,400mg	2,400mg	
Potassium		3,500 mg	3,500 mg	
Total Carbohydrate		300g	375g	
Dietary Fiber		25g	30g	

Calories per gram:

Fat 9 • Carbohydrate 4 • Protein 4

This information is provided for copy purposes only and does not indicate color, type size, type face, or any other design element and should not be taken as such. All design elements must be in compliance with all federal labeling regulations, directives, or other guidance as provided by applicable federal authorities. Any questions regarding the applicable federal labeling regulations should be directed to the Scientific and Regulatory Affairs department of Schwan's Shared Services, LLC, a subsidiary of The Schwan Food Company.

CN 083322

Each 4.60 oz. Whole Grain Cheese Pizza provides 2.00 oz. equivalent meat alternate, 2.00 oz. equivalent grains, and 1/8 cup red/orange vegetable for the Child Nutrition Meal Pattern Requirements. (Use of this logo and statement authorized by the Food and Nutrition Service, USDA 04-12.)

CN



WHOLE GRAIN CLASSIC WEDGE CHEESE PIZZA

73158

**KEEP
FROZEN**

INSPECTED BY THE
U.S. DEPT. OF AGRICULTURE
IN ACCORDANCE WITH
FNS REQUIREMENTS

COOK BEFORE SERVING FOR INSTITUTIONAL USE

Nutrition Facts

Serving Size 1 Pizza (130g)
Servings Per Container 96

Amount Per Serving

Calories 260 Calories from Fat 100

% Daily Value*

Total Fat 1g 17%

Saturated Fat 4g 21%

Trans Fat 0g

Cholesterol 15mg 5%

Sodium 580mg 24%

Potassium 240mg 7%

Total Carbohydrate 37g 12%

Dietary Fiber 4g 17%

Sugars 15g

Protein 15g

Vitamin A 10% Vitamin C 0%

Calcium 30% Iron 15%

* Percent Daily Values are based on a 2,000 calorie diet. Your daily values may be higher or lower depending on your calorie needs:

Calories: 2,000 2,500

Total Fat Less than 65g 60g

Saturated Fat Less than 20g 25g

Cholesterol Less than 300mg 300mg

Sodium Less than 2,400mg 2,400mg

Potassium 3,500mg 3,500mg

Total Carbohydrate 300g 375g

Dietary Fiber 25g 30g

Calories per gram:

Fat 9 • Carbohydrate 4 • Protein 4

INGREDIENTS: CRUST: FLOUR BLEND (WHITE WHOLE WHEAT FLOUR, ENRICHED FLOUR [WHEAT FLOUR, MALTED BARLEY FLOUR, NIACIN, REDUCED IRON, THIAMINE MONONITRATE, RIBOFLAVIN, FOLIC ACID]), WATER, DEFATTED SOY FLOUR, YEAST, SOY PROTEIN CONCENTRATE, CONTAINS 2% OR LESS OF: VEGETABLE OIL (SOYBEAN, COTTONSEED, CORN, AND/OR CANOLA OIL), SUGAR, GLUCONO-DELTA-LACTONE, DATEM, LEAVENING (SODIUM ACID PYROPHOSPHATE, SODIUM BICARBONATE, MONOCALCIUM PHOSPHATE, CALCIUM LACTATE), SALT, MODIFIED FOOD STARCH, DOUGH CONDITIONER (WHEAT STARCH, L-CYSTEINE HYDROCHLORIDE, AMMONIUM SULFATE). CHEESE BLEND (LOW MOISTURE PART SKIM MOZZARELLA CHEESE [PASTEURIZED MILK, CULTURES, SALT, ENZYMES], MOZZARELLA CHEESE SUBSTITUTE [WATER, VEGETABLE OIL (CORN OIL AND/OR SOY OIL), CHEESE SOLIDS, MODIFIED FOOD STARCH, NONFAT DRY MILK, SWEET WHEY, SALT, MAGNESIUM OXIDE, FERRIC ORTHOPHOSPHATE, VITAMIN A PALMITATE, NIACINAMIDE, ZINC OXIDE, PYRIDOXINE HYDROCHLORIDE (VITAMIN B6), CYANOCOBALAMIN]). SAUCE: TOMATOES (WATER, TOMATO PASTE [NOT LESS THAN 28% SOLUBLE SOLIDS]), MODIFIED FOOD STARCH, SUGAR, CONTAINS 2% OR LESS OF: DEXTROSE, SALT, SPICE, ONION, DEHYDRATED ROMANO CHEESE (SHEEP'S AND COW'S MILK, CHEESE CULTURES, SALT, ENZYMES), GARLIC POWDER, PAPRIKA, CITRIC ACID, BEET POWDER.

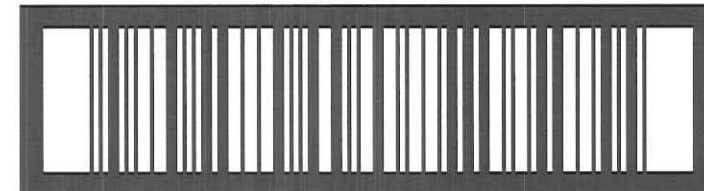

1 00 72180 73158 3

CONTAINS: 96 - 4.60 OZ PIZZAS

**NET WT. 441.60 OZ
(27 LBS 9.60 OZ) 12.51 Kg**



DISTRIBUTED BY SCHWAN'S FOOD SERVICE, INC., MARSHALL, MN 56258
© 2012, SCHWAN'S FOOD SERVICE, INC., ALL RIGHTS RESERVED. Conn. Lic. No: 4196
QUESTIONS OR COMMENTS? PLEASE CONTACT US AT 877-302-7426 OR VISIT OUR WEBSITE AT: WWW.SCHWANSFOODSERVICE.COM



The SCHWAN FOOD COMPANY™
SCHWAN'S GLOBAL SUPPLY CHAIN, INC.

SAP Item # 73159

LABEL SET UP SHEET

1. HS 3 Digit Code	
2. Brand	Tony's®
3. Brand Family	
4. Product "Fanciful" Name	NA
5. True Product Name	WHOLE GRAIN CLASSIC WEDGE PIZZA WITH FAT REDUCED PEPPERONI
6. Flavor/Variety Descriptor	NA
7. USDA Inspection Legend	U.S. Inspected and Passed by Department of Agriculture
8. Establishment Numbers	1999
9. CN Number	082816
10. CN Box	Each 4.48 oz. Whole Grain Pizza with Fat Reduced Pepperoni provides 2.00 oz. equivalent meat/meat alternate, 2 1/4 servings of bread alternate, and 1/8 cup vegetable for the Child Nutrition Meal Pattern Requirements. (Use of this logo and statement authorized by the Food and Nutrition Service, USDA 02-12.)
11. Statement of Piece Count/Item Weight	CONTAINS 96 - 4.48 OZ PIZZAS
12. Net Contents:	430.08 OZ (26 LBS 14.08 OZ) 12.19kg
13. Certifications	
14. For Institutional Use Only	Yes
15. Serving Suggestion	No
16. Real SEAL Logo	No Logo
17. Handling Statement	KEEP FROZEN, Cook Before Serving
18. Flags/Banners	N/A
19. Required Statements	N/A
20. Validated Nutrient Content/Health Claims (including disclaimers)	NA
21. Ingredient Statement	INGREDIENTS: CRUST: FLOUR BLEND (WHITE WHOLE WHEAT FLOUR, ENRICHED FLOUR [WHEAT FLOUR, MALTED BARLEY FLOUR, NIACIN, REDUCED IRON, THIAMINE MONONITRATE, RIBOFLAVIN, FOLIC ACID]), WATER, DEFATTED SOY FLOUR, YEAST, SOY PROTEIN CONCENTRATE, CONTAINS 2% OR LESS OF: VEGETABLE OIL (SOYBEAN, COTTONSEED, CORN, AND/OR CANOLA OIL), SUGAR, GLUCONO-DELTA-LACTONE, DATEM, LEAVENING (SODIUM ACID PYROPHOSPHATE, SODIUM BICARBONATE, MONOCALCIUM PHOSPHATE, CALCIUM LACTATE), SALT, MODIFIED FOOD STARCH, DOUGH CONDITIONER (WHEAT STARCH, L-CYSTEINE HYDROCHLORIDE, AMMONIUM SULFATE). CHEESE BLEND (LOW MOISTURE PART SKIM MOZZARELLA CHEESE [PASTEURIZED MILK, CULTURES, SALT, ENZYMES], MOZZARELLA CHEESE SUBSTITUTE [WATER, VEGETABLE OIL (CORN OIL AND/OR SOY OIL), CHEESE SOLIDS, MODIFIED FOOD STARCH, NONFAT DRY MILK, SWEET WHEY, SALT, MAGNESIUM OXIDE, FERRIC ORTHOPHOSPHATE, VITAMIN A PALMITATE, NIACINAMIDE, ZINC OXIDE, PYRIDOXINE HYDROCHLORIDE (VITAMIN B6), CYANOCOBALAMIN]). SAUCE: TOMATOES (WATER, TOMATO PASTE [NOT LESS THAN 28% SOLUBLE SOLIDS]), MODIFIED FOOD STARCH, SUGAR, CONTAINS 2% OR LESS OF: DEXTROSE, SALT,



	SPICE, ONION, DEHYDRATED ROMANO CHEESE (SHEEP'S AND COW'S MILK, CHEESE CULTURES, SALT, ENZYMES), GARLIC POWDER, PAPRIKA, CITRIC ACID, BEET POWDER. FAT REDUCED PEPPERONI (PORK, BEEF, WATER, TEXTURED VEGETABLE PROTEIN PRODUCT* [SOY PROTEIN CONCENTRATE, ZINC OXIDE, NIACINAMIDE, FERROUS SULFATE, COPPER GLUCONATE, VITAMIN A PALMITATE, CALCIUM PANTOTHENATE, THIAMINE MONONITRATE (B1), PYRIDOXINE HYDROCHLORIDE (B6), RIBOFLAVIN (B2), AND CYANOCOBALAMIN (B12)], SALT, LESS THAN 2% OF SPICES, DEXTROSE, LACTIC ACID STARTER CULTURE, OLEORESIN OF PAPRIKA, FLAVORING, SODIUM NITRITE, BHA, BHT, CITRIC ACID. *INGREDIENT NOT IN REGULAR PEPPERONI).
22. Allergens	Contains: Soy or its Derivatives
	Wheat or its Derivatives
	Milk or its Derivatives
23. Advisory/Species Labeling	NA
24. Distribution Line	Distributed by Schwan's Food Service, Inc., Marshall, MN 56258
25. Copyright Statement	© 2012, Schwan's Food Service, Inc. All Rights Reserved.
26. Product Origin	
27. Conn. Lic. No.	4196
28. Contact Information for Pkg	1-877-302-7426, www.schwansfoodservice.com
29. Quality Guarantee	N/A
31. Customer Product Number	
32. (a) SCC-14 (Master Case)	10072180731590
32. (b) UPC-12 (Pack/Sell Unit)	
32. (c) UPC-12 (Piece/IW Sell Unit)	
33. Cook vs. Prepare	COOKING INSTRUCTIONS
34. Steps	COOKING GUIDELINES. COOK BEFORE SERVING. Place 16 frozen pizzas in a 18" x 26" x 1/2" parchment lined sheet pan. CONVECTION OVEN: Low fan, 350°F for 13 to 16 minutes. CONVENTIONAL OVEN: 400°F for 17 to 20 minutes. Rotate pans one half turn to prevent cheese from burning. Note: Cook until internal temperature of pizza reaches 160°F. Due to variances in oven regulators and number of pizzas in an oven, cooking time and temperature may require adjustments. Refrigerate or discard any unused portion.



The SCHWAN FOOD COMPANY™
SCHWAN'S GLOBAL SUPPLY CHAIN, INC.

SAP Item # 73159

35. [Nutritional Fact
Panel]

Nutrition Facts

Serving Size 1 pizza (127g)
Servings Per Container 96

Amount Per Serving

Calories 300 Calories from Fat 100

% Daily Value*

Total Fat 11g 17%

Saturated Fat 4.5g 22%

Trans Fat 0g

Cholesterol 15mg 5%

Sodium 640mg 27%

Potassium 230mg 6%

Total Carbohydrate 36g 12%

Dietary Fiber 4g 17%

Sugars 14g

Protein 15g

Vitamin A 8% • Vitamin C 0%

Calcium 20% • Iron 15%

*Percent Daily Values are based on a 2,000 calorie diet. Your daily values may be higher or lower depending on your calorie needs:

	Calories:	2,000	2,500
Total Fat	Less than	65g	80g
Saturated Fat	Less than	20g	25g
Cholesterol	Less than	300mg	300mg
Sodium	Less than	2,400mg	2,400mg
Potassium		3,500 mg	3,500 mg
Total Carbohydrate		300g	375g
Dietary Fiber		25g	30g

Calories per gram:

Fat 9 • Carbohydrate 4 • Protein 4

This information is provided for copy purposes only and does not indicate color, type size, type face, or any other design element and should not be taken as such. All design elements must be in compliance with all federal labeling regulations, directives, or other guidance as provided by applicable federal authorities. Any questions regarding the applicable federal labeling regulations should be directed to the Scientific and Regulatory Affairs department of Schwan's Shared Services, LLC, a subsidiary of The Schwan Food Company.

CN 083323
Each 4.48 oz. Whole Grain Pizza with Fat Reduced Pepperoni provides 2.00 oz. equivalent meat/meat alternate, 2.00 oz. equivalent grains, and 1/8 cup red/orange vegetable for the Child Nutrition Meal Pattern Requirements. (Use of this logo and statement authorized by the Food and Nutrition Service, USDA 04-12.)
CN



WHOLE GRAIN CLASSIC WEDGE PIZZA WITH FAT REDUCED PEPPERONI

73159

**KEEP
FROZEN**



COOK BEFORE SERVING FOR INSTITUTIONAL USE

Nutrition Facts	
Serving Size 1 Pizza (127g)	
Servings Per Container 96	
Amount Per Serving	
Calories 300	Calories from Fat 100
% Daily Value*	
Total Fat 11g	17%
Saturated Fat 4.5g	22%
Trans Fat 0g	
Cholesterol 15mg	5%
Sodium 640mg	27%
Potassium 230mg	6%
Total Carbohydrate 36g	12%
Dietary Fiber 4g	17%
Sugars 14g	
Protein 15g	
Vitamin A 8%	Vitamin C 0%
Calcium 20%	Iron 15%
* Percent Daily Values are based on a 2,000 calorie diet. Your daily values may be higher or lower depending on your calorie needs:	
Calories: 2,000 2,500	
Total Fat	Less than 65g 80g
Saturated Fat	Less than 20g 25g
Cholesterol	Less than 300mg 300mg
Sodium	Less than 2,400mg 2,400mg
Potassium	3,500mg 3,500mg
Total Carbohydrate	300g 375g
Dietary Fiber	25g 30g
Calories per gram:	
Fat 9	Carbohydrate 4 Protein 4

INGREDIENTS: CRUST: FLOUR BLEND (WHITE WHOLE WHEAT FLOUR, ENRICHED FLOUR (WHEAT FLOUR, MALTED BARLEY FLOUR, NIACIN, REDUCED IRON, THIAMINE MONONITRATE, RIBOFLAVIN, FOLIC ACID)), WATER, DEFATTED SOY FLOUR, YEAST, SOY PROTEIN CONCENTRATE, CONTAINS 2% OR LESS OF: VEGETABLE OIL (SOYBEAN, COTTONSEED, CORN, AND/OR CANOLA OIL), SUGAR, GLUCONO-DELTA-LACTONE, DATEM, LEAVENING (SODIUM ACID PYROPHOSPHATE, SODIUM BICARBONATE, MONOCALCIUM PHOSPHATE, CALCIUM LACTATE), SALT, MODIFIED FOOD STARCH, DOUGH CONDITIONER (WHEAT STARCH, L-CYSTEINE HYDROCHLORIDE, AMMONIUM SULFATE). **CHEESE BLEND** (LOW MOISTURE PART SKIM MOZZARELLA CHEESE [PASTEURIZED MILK, CULTURES, SALT, ENZYMES], MOZZARELLA CHEESE SUBSTITUTE [WATER, VEGETABLE OIL (CORN OIL AND/OR SOY OIL), CHEESE SOLIDS, MODIFIED FOOD STARCH, NONFAT DRY MILK, SWEET WHEY, SALT, MAGNESIUM OXIDE, FERRIC ORTHOPHOSPHATE, VITAMIN A PALMITATE, NIACINAMIDE, ZINC OXIDE, PYRIDOXINE HYDROCHLORIDE (VITAMIN B6), CYANOCOBALAMIN]), SAUCE: TOMATOES (WATER, TOMATO PASTE [NOT LESS THAN 28% SOLUBLE SOLIDS]), MODIFIED FOOD STARCH, SUGAR, CONTAINS 2% OR LESS OF: DEXTROSE, SALT, SPICE, ONION, DEHYDRATED ROMANO CHEESE (SHEEP'S AND COW'S MILK, CHEESE CULTURES, SALT, ENZYMES), GARLIC POWDER, PAPRIKA, CITRIC ACID, BEET POWDER, **FAT REDUCED PEPPERONI** (PORK, BEEF, WATER, TEXTURED VEGETABLE PROTEIN PRODUCT* [SOY PROTEIN CONCENTRATE, ZINC OXIDE, NIACINAMIDE, FERROUS SULFATE, COPPER GLUCONATE, VITAMIN A PALMITATE, CALCIUM PANTOTHENATE, THIAMINE MONONITRATE (B1), PYRIDOXINE HYDROCHLORIDE (B6), RIBOFLAVIN (B2), AND CYANOCOBALAMIN (B12)], SALT, LESS THAN 2% OF SPICES, DEXTROSE, LACTIC ACID STARTER CULTURE, OLEORESIN OF PAPRIKA, FLAVORING, SODIUM NITRITE, BHA, BHT, CITRIC ACID. *INGREDIENT NOT IN REGULAR PEPPERONI).

CONTAINS: WHEAT, MILK, AND SOY.

CONTAINS: 96 - 4.48 OZ PIZZAS

**NET WT. 430.08 OZ
(26 LBS 14.08 OZ) 12.19 Kg**



DISTRIBUTED BY: SCHWAN'S FOOD SERVICE, INC., MARSHALL, MN 56258
© 2012, SCHWAN'S FOOD SERVICE, INC., ALL RIGHTS RESERVED. Conn. Lic. No: 4196
QUESTIONS OR COMMENTS? PLEASE CONTACT US AT 877-302-7426 OR VISIT OUR WEBSITE AT: WWW.SCHWANSFOODSERVICE.COM

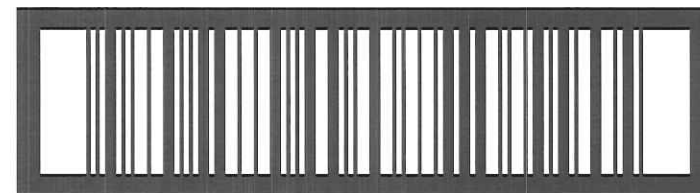

1 00 72180 73159 0



The SCHWAN FOOD COMPANY™

SCHWAN'S FOOD SERVICE, INC.

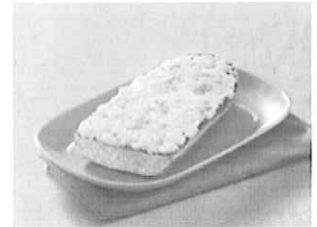

Tony's® LiveSmart(TM) Schools 6" French Bread Cheese Pizza

Product Code: 78356

Last Update Date: 02/29/2012

Please continue to check our website for the most current nutrition information.

Printed on 5/24/2012

Nutrition Information 78356		
Serving Size:	1 portion (147g/5.2oz)	
Eaches/Case:	60	
Inner Packs/Case:	1	
Servings/Case:	60	
Calories:	300	
Calories from Fat:	80	
Total Fat:	9 g(s)	
Saturated Fat:	3.5 g(s)	
Trans Fat:	0 g(s)	
Cholesterol:	15 mg(s)	
Sodium:	540 mg(s)	
Total Carbohydrate:	36 g(s)	
Total Dietary Fiber:	4 g(s)	
Sugars:	4 g(s)	
Protein:	19 g(s)	
Vitamins & Minerals		
	Amt/Srv	% DV
Vitamin A:	500 IU	10%
Vitamin C:	6 mg(s)	10%
Calcium:	350 mg(s)	35%
Iron:	2.7 mg(s)	15%
* Percent Daily Values are based on 2,000 calorie diet.		
Whole Grain		
	Amt/Srv	% Flour
Whole Grain:	18 g(s)	51%

An appealing half-loaf shape with a crispy crust, covered in zesty sauce, finished with tastefully blended mozzarella cheese.

Master Case Product Name: SFS TNY 6" LS FB CHS CN

Child Nutrition Identification

080984

Each 5.20 oz. French Bread Pizza with Cheese / Cheese Substitute provides 2.0 oz. equivalent meat alternate, 2 1/2 servings of bread and 1/8 cup vegetable for the Child Nutrition Meal Pattern Requirements. (Use of this logo and statement authorized by the Food and Nutrition Service, USDA 06-11). Each 5.20 oz. French Bread Pizza with Cheese / Cheese Substitute provides 2.0 oz. equivalent meat alternate, 2 1/2 servings of bread and 1/8 cup vegetable for the Child Nutrition Meal Pattern Requirements. (Use of this logo and statement authorized by the Food and Nutrition Service, USDA 06-11).

Preparation Instructions

COOKING INSTRUCTIONS. COOK BEFORE SERVING. Preheat oven to 375°F (or a conventional oven to 400°F). Product must be cooked from a frozen state for best results. Place frozen pizzas on a bun pan. CONVECTION OVEN: Bake for 10-13 minutes. CONVENTIONAL OVEN: Bake for 18-20 minutes. NOTE: Oven temperatures and times may vary due to oven load and/or product temperature. Refrigerate or discard unused portion.

Ingredients

FRENCH BREAD (WATER, WHOLE WHEAT FLOUR, ENRICHED UNBLEACHED WHEAT FLOUR (FLOUR, MALTED BARLEY FLOUR, NIACIN, REDUCED IRON, THIAMINE MONONITRATE (VITAMIN B1), RIBOFLAVIN (VITAMIN B2), FOLIC ACID), VITAL WHEAT GLUTEN, PEA PROTEIN, CONTAINS 2% OR LESS OF EACH OF THE FOLLOWING: SUGAR, SALT, SOYBEAN OIL, YEAST, DOUGH CONDITIONER (ENZYME, HYDRATED MONOGLYCERIDES, WHEAT FLOUR, DATES, DEXTROSE, SOYBEAN OIL, ASCORBIC ACID, L-CYSTEINE, AZODICARBONAMIDE (ADA)), CHEESE BLEND (LOW MOISTURE PART SKIM MOZZARELLA CHEESE AND MOZZARELLA CHEESE SUBSTITUTE BLEND (LOW MOISTURE PART SKIM MOZZARELLA CHEESE (PASTEURIZED MILK, CULTURES, SALT, ENZYMES), MOZZARELLA CHEESE SUBSTITUTE (WATER, VEGETABLE OIL (CORN OIL AND/OR SOY OIL), CHEESE SOLIDS, MODIFIED CORN STARCH, NONFAT DRY MILK, SWEET WHEY, SALT, MAGNESIUM OXIDE, FERRIC ORTHOPHOSPHATE, VITAMIN A PALMITATE, NIACINAMIDE, ZINC OXIDE, PYRIDOXINE HYDROCHLORIDE (VITAMIN B6), CYANOCOBALAMIN)), REDUCED FAT MOZZARELLA (PASTEURIZED PART SKIM MILK, CULTURES, SALT AND ENZYMES), SAUCE (WATER, TOMATO PASTE, SEASONING BLEND (SUGAR, MALTODEXTRIN, PAPRIKA, SPICES, CITRIC ACID, ONION, GARLIC, BEET POWDER, CARRAGEENAN, POTASSIUM CHLORIDE, XANTHAN GUM), MODIFIED CORN STARCH, CONTAINS 2% OR LESS OF EACH OF THE FOLLOWING: SALT, DEHYDRATED PARMESAN CHEESE (PART SKIM MILK, CULTURES, SALT, ENZYMES), DISODIUM PHOSPHATE).

Allergens

Contains Milk, Wheat, and Soy.

Hard Bid Specifications

Tony's® LiveSmart(TM) Schools 6" French Bread Cheese Pizza must provide 2 oz(s) equivalent meat/meat alternate, 2 1/2 servings of bread/bread alternate, and 1/8 cup vegetable. Portion to provide a minimum of 270 calories with no more than 11 fat grams. Must contain a minimum of 3 grams of fiber and less than 640 milligrams sodium. Case pack of 60 per case. CN Label required. Acceptable Brand: Tony's® 78356 .

Shipping Info	
GTIN (UPC):	n/a
SCC-14:	10072180783568
Gross Weight:	22.613 lbs.
Net Weight:	19.5 lbs.
Each Weight:	5.2 Oz(s)/serving.
Cube:	1.329
Dimensions (LxWxH):	19.125 x 14.125 x 8.5
Cases/Pallet:	70
Tie:	7
High:	10
Shelf Life:	300 days



The **SCHWAN**
FOOD COMPANY
SCHWAN'S FOOD SERVICE, INC.



Schwan's Food Service, Inc.

115 West College Drive

Marshall, MN 56258

1-877-302-7426

info@SchwansFoodService.com

Each 5.20 oz. French Bread Pizza with Cheese / Cheese Substitute provides 2.00 oz. equivalent meat alternate, 2 1/4 servings of bread and 1/8 cup vegetable for the Child Nutrition Meal Pattern Requirements. (Use of this logo and statement authorized by the Food and Nutrition Service, USDA 06-11)



Schwans Food Service, Inc.
The SCHWAN
FOOD COMPANY



78356

Distributed By: Schwan's Food Service, Inc.
General Office, Marshall, MN 56258 U.S.A.
Copyright © 2011, Schwan's Food Service, Inc.
All Rights Reserved.
Customer Service Call 1 (877) 302-7426
Visit us at www.SchwansFoodService.com

French Bread Pizza with Cheese/Cheese Substitute

#129018-1

INGREDIENTS: FRENCH BREAD (WATER, WHOLE WHEAT FLOUR, ENRICHED UNBLEACHED WHEAT FLOUR (FLOUR), MALTED BARLEY FLOUR, NIACIN, REDUCED IRON, THIAMINE MONONITRATE (VITAMIN B1), RIBOFLAVIN (VITAMIN B2), FOLIC ACID), VITAL WHEAT GLUTEN, PEA PROTEIN, CONTAINS 2% OR LESS OF EACH OF THE FOLLOWING: SUGAR, SALT, SOYBEAN OIL, YEAST, DOUGH CONDITIONER (ENZYME, HYDRATED MONOGLYCERIDES, WHEAT FLOUR DEXEM, DEXTROSE, SOYBEAN OIL, ASCORBIC ACID, L-CYSTEINE, AZODICARBONAMIDE (ADA)), CHEESE BLEND (LOW MOISTURE PART SKIM MOZZARELLA CHEESE AND MOZZARELLA CHEESE SUBSTITUTE BLEND (LOW MOISTURE PART SKIM MOZZARELLA CHEESE (PASTEURIZED MILK, CULTURES, SALT, ENZYMES), MOZZARELLA CHEESE SUBSTITUTE (WATER, VEGETABLE OIL (CORN OIL AND/OR SOY OIL), CHEESE SOLIDS, MODIFIED CORN STARCH, NONFAT DRY MILK, SWEET WHEY, SALT, MAGNESIUM OXIDE, FERRIC ORTHOPHOSPHATE, VITAMIN A PALMITATE, N'ACINAMIDE, ZINC OXIDE, PYRIDOXINE HYDROCHLORIDE (VITAMIN B6), CYANOCOBALAMIN)), REDUCED FAT MOZZARELLA (PASTEURIZED PART SKIM MILK, CULTURES, SALT AND ENZYMES), SAUCE (WATER, TOMATO PASTE, SEASONING BLEND (SUGAR, MALTODEXTRIN, PAPRIKA, SPICES, CITRIC ACID, ONION, GARLIC, BEET POWDER, CARRAGEENAN, POTASSIUM CHLORIDE, XANTHAN GUM), MODIFIED CORN STARCH, CONTAINS 2% OR LESS OF EACH OF THE FOLLOWING: SALT, DEHYDRATED PARMESAN CHEESE (PART SKIM MILK, CULTURES, SALT, ENZYMES), DISODIUM PHOSPHATE).
Contains: MILK, SOY, WHEAT

COOKING INSTRUCTIONS / INSTRUCCIONES:

PREHEAT THE CONVECTION OVEN TO 375°F (OR A CONVENTIONAL OVEN TO 400°F). PRODUCT MUST BE COOKED FROM A FROZEN STATE FOR BEST RESULTS. PLACE FROZEN PIZZAS ON AN 18" x 26" x 1 1/2" BUN PAN. PRECALIENTE EL HORNO DE CONVECCION HASTA ALCANZAR LOS 375°F (O UN HORNO COMUN HASTA ALCANZAR LOS 400°F). EL PRODUCTO DEBE CONFINARSE SIN DESCONGELAR PARA OBTENER LOS MEJORES RESULTADOS. PONGA LAS PIZZAS CONGELADAS EN UNA FUENTE DE 18" x 26" x 1 1/2".

OVEN TYPE / TIPO DE HORNO
CONVECTION / CONVECCION
CONVENTIONAL / COMUN

TEMPERATURE / TEMPERATURA
375°F
400°F

COOKING TIME / TIEMPO DE COCCIÓN
10-13 MINUTES / 10 A 13 MINUTOS
18-20 MINUTES / 18 A 20 MINUTOS

INSPECT THE
U.S. DEPT. OF AGRICULTURE
IN ACCORDANCE WITH
FNS REGULATIONS

NOTE: OVEN TEMPERATURE AND TIMES MAY VARY DUE TO OVEN LOAD AND/OR PRODUCT TEMPERATURE. REFRIGERATE OR DISCARD ANY UNUSED PORTION. NOTA: LA TEMPERATURA DEL HORNO Y EL PERÍODO DE TIEMPO PUEDEN VARIAR DEBIDO A LA CARGA DEL HORNO Y/O LA TEMPERATURA DEL PRODUCTO. REFRIGERE O DESECHE LA PARTE NO USADA.

NOT READY TO EAT. COOK THOROUGHLY. FOR FOOD SAFETY AND QUALITY, COOK BEFORE EATING TO AN INTERNAL TEMPERATURE OF 160°F.

FOR INSTITUTIONAL USE

COOK BEFORE SERVING

KEEP FROZEN

L.B.N. (Licensed Connecticut 3900)



10072180783568

CONTAINS: 60 - 5.20 OZ. PORTIONS
NET WT.: 19 LBS. 8.00 OZ.



The SCHWAN FOOD COMPANY™

SCHWAN'S FOOD SERVICE, INC.



Tony's® LiveSmart(TM) Schools 6" French Bread Pepperoni Pizza

Product Code: 78357

Last Update Date: 02/29/2012

Please continue to check our website for the most current nutrition information.

Printed on 5/24/2012

Nutrition Information 78357		
Serving Size:	1 portion (147g/5.19oz)	
Eaches/Case:	60	
Inner Packs/Case:	1	
Servings/Case:	60	
Calories:	300	
Calories from Fat:	70	
Total Fat:	8 g(s)	
Saturated Fat:	3.5 g(s)	
Trans Fat:	0 g(s)	
Cholesterol:	15 mg(s)	
Sodium:	420 mg(s)	
Total Carbohydrate:	34 g(s)	
Total Dietary Fiber:	4 g(s)	
Sugars:	3 g(s)	
Protein:	22 g(s)	
Vitamins & Minerals		
	Amt/Srv	% DV
Vitamin A:	400 IU	8%
Vitamin C:	4.8 mg(s)	8%
Calcium:	350 mg(s)	35%
Iron:	2.7 mg(s)	15%
* Percent Daily Values are based on 2,000 calorie diet.		
Whole Grain		
	Amt/Srv	% Flour
Whole Grain:	18 g(s)	51%

Shipping Info		
GTIN (UPC):	n/a	
SCC-14:	10072180783575	
Gross Weight:	22.4 lbs.	
Net Weight:	19.463 lbs.	
Each Weight:	5.19 Oz(s)/serving.	
Cube:	1.329	
Dimensions (LxWxH):	19.125 x 14.125 x 8.5	
Cases/Pallet:	70	
Tie:	7	
High:	10	
Shelf Life:	300 days	

An appealing half-loaf shape with a crispy crust, covered in zesty sauce, topped with diced pepperoni & tastefully blended mozzarella cheese.

Master Case Product Name: SFS TNY 6" LS FB PEPP CN

Child Nutrition Identification

081877

Each 5.19 oz. French Bread Pizza with Reduced Fat Pepperoni provides 2.0 oz. equivalent meat alternate, 2 1/2 servings of bread and 1/8 cup vegetable for the Child Nutrition Meal Pattern Requirements. (Use of this logo and statement authorized by the Food and Nutrition Service, USDA 06-11). Each 5.19 oz. French Bread Pizza with Reduced Fat Pepperoni provides 2.0 oz. equivalent meat alternate, 2 1/2 servings of bread and 1/8 cup vegetable for the Child Nutrition Meal Pattern Requirements. (Use of this logo and statement authorized by the Food and Nutrition Service, USDA 06-11).

Preparation Instructions

COOKING INSTRUCTIONS. COOK BEFORE SERVING. For food safety and quality cook before eating to an internal temperature of 160°F. Preheat oven to 375°F (or a conventional oven to 400°F). Product must be cooked from a frozen state for best results. Place frozen pizzas on an 18" x 26" x 1/2" bun pan. CONVECTION OVEN: Bake for 11-14 minutes. CONVENTIONAL OVEN: Bake for 20-22 minutes. NOTE: Oven temperatures and times may vary due to oven load and/or product temperature. Refrigerate or discard unused portion.

Ingredients

INGREDIENTS: FRENCH BREAD (WATER, WHOLE WHEAT FLOUR, ENRICHED UNBLEACHED WHEAT FLOUR (FLOUR, MALTED BARLEY FLOUR, NIACIN, REDUCED IRON, THIAMINE MONONITRATE (VITAMIN B1), RIBOFLAVIN (VITAMIN B2), FOLIC ACID), VITAL WHEAT GLUTEN, PEA PROTEIN, CONTAINS 2% OR LESS OF EACH OF THE FOLLOWING: SUGAR, SALT, SOYBEAN OIL, YEAST, DOUGH CONDITIONER (ENZYME, HYDRATED MONOGLYCERIDES, WHEAT FLOUR, DATEM, DEXTROSE, SOYBEAN OIL, ASCORBIC ACID, L-CYSTEINE, AZODICARBONAMIDE (ADA)), CHEESE BLEND (REDUCED FAT MOZZARELLA (PASTEURIZED PART SKIM MILK, CULTURES, SALT AND ENZYMES), LOW MOISTURE PART SKIM MOZZARELLA CHEESE AND MOZZARELLA CHEESE SUBSTITUTE BLEND (LOW MOISTURE PART SKIM MOZZARELLA CHEESE (PASTEURIZED MILK, CULTURES, SALT, ENZYMES), MOZZARELLA CHEESE SUBSTITUTE (WATER, VEGETABLE OIL (CORN OIL AND/OR SOYBEAN OIL), CHEESE SOLIDS, MODIFIED CORN STARCH, NONFAT DRY MILK, SWEET WHEY, SALT, MAGNESIUM OXIDE, FERRIC ORTHOPHOSPHATE, VITAMIN A PALMITATE, NIACINAMIDE, ZINC OXIDE, PYRIDOXINE HYDROCHLORIDE (VITAMIN B6), CYANOCOBALAMIN)), SAUCE (WATER, TOMATO PASTE (28% NTSS), SEASONING BLEND (SUGAR, MALTODEXTRIN, PAPRIKA, SPICES, CITRIC ACID, ONION, GARLIC, BEET POWDER, CARRAGEENAN, POTASSIUM CHLORIDE, XANTHAN GUM), MODIFIED CORN STARCH, CONTAINS 2% OR LESS OF EACH OF THE FOLLOWING: SALT, DEHYDRATED PARMESAN CHEESE (PART SKIM MILK, CULTURES, SALT, ENZYMES), DISODIUM PHOSPHATE), REDUCED FAT PEPPERONI (PORK, BEEF, WATER, TEXTURED VEGETABLE PROTEIN PRODUCT* (SOY PROTEIN CONCENTRATE, ZINC OXIDE, NIACINAMIDE, FERROUS SULFATE, COPPER GLUCONATE, VITAMIN A PALMITATE, CALCIUM PANTOTHENATE, THIAMINE MONONITRATE [B1], PYRIDOXINE HYDROCHLORIDE [B6], RIBOFLAVIN [B2], AND CYANOCOBALAMIN [B12]), SALT, LESS THAN 2% OF SPICES, DEXTROSE, LACTIC ACID STARTER CULTURE, OLEORESIN OF PAPRIKA, FLAVORING, SODIUM NITRITE, BHA, BHT, CITRIC ACID. *INGREDIENT NOT IN REGULAR PEPPERONI).

Allergens

Contains Milk, Wheat, and Soy.

Hard Bid Specifications

Tony's® LiveSmart(TM) Schools 6" French Bread Pepperoni Pizza must provide 2 oz(s) equivalent meat/meat alternate, 2 1/2 servings of bread/bread alternate, and 1/8 cup vegetable. Portion to provide a minimum of 270 calories with no more than 10 fat grams. Must contain a minimum of 3 grams of fiber and less than 520 milligrams sodium. Case pack of 60 per case. CN Label required. Acceptable Brand: Tony's® 78357 .



Schwan's Food Service, Inc.
115 West College Drive
Marshall, MN 56258
1-877-302-7426
info@SchwansFoodService.com

Each 5.19 oz. French Bread Pizza with Reduced Fat Pepperoni provides 2.00 oz. equivalent meat/meat alternate, 2 1/2 servings of bread and 1/8 cup vegetable for the Child Nutrition Meal Pattern Requirements. (Use of this logo and statement authorized by the Food and Nutrition Service, USDA 09-11).



78357

Distributed By: Schwan's Food Service, Inc.
General Office, Marshall, MN 56258 U.S.A.
Copyright © 2011 Schwan's Food Service, Inc.
All Rights Reserved.
Customer Service Call 1 (877) 302-7426
Visit us at www.SchwansFoodService.com

French Bread Pizza with Reduced Fat Pepperoni

#129020-1

INGREDIENTS: FRENCH BREAD (WATER, WHOLE WHEAT FLOUR, ENRICHED UNBLEACHED WHEAT FLOUR (FLOUR, MALTED BARLEY FLOUR, NIACIN, REDUCED IRON, THIAMINE MONONITRATE (VITAMIN B1), RIBOFLAVIN (VITAMIN B2), FOLIC ACID), VITAL WHEAT GLUTEN, PEA PROTEIN, CONTAINS 2% OR LESS OF EACH OF THE FOLLOWING: SUGAR, SALT, SOYBEAN OIL, YEAST, DOUGH CONDITIONER (ENZYME, HYDRATED MONOGLYCERIDES, WHEAT FLOUR, DATEM, DEXTROSE, SOYBEAN OIL, ASCORBIC ACID, L-CYSTEINE, AZODICARBONAMIDE (ADA)), CHEESE BLEND (REDUCED FAT MOZZARELLA (PASTEURIZED PART SKIM MILK, CULTURES, SALT AND ENZYMES), LOW MOISTURE PART SKIM MOZZARELLA CHEESE AND MOZZARELLA CHEESE SUBSTITUTE BLEND (LOW MOISTURE PART SKIM MOZZARELLA CHEESE (PASTEURIZED MILK, CULTURES, SALT, ENZYMES), MOZZARELLA CHEESE SUBSTITUTE (WATER, VEGETABLE OIL (CORN OIL AND/OR SOYBEAN OIL), CHEESE SOLIDS, MODIFIED CORN STARCH, NONFAT DRY MILK, SWEET WHEY, SALT, MAGNESIUM OXIDE, FERRIC ORTHOPHOSPHATE, VITAMIN A PALMITATE, NIACINAMIDE, ZINC OXIDE, PYRIDOXINE HYDROCHLORIDE (VITAMIN B6), CYANOCOBALAMIN)), SAUCE (WATER, TOMATO PASTE (28% NTSS), SEASONING BLEND (SUGAR, MALTODEXTRIN, PAPRIKA, SPICES, CITRIC ACID, ONION, GARLIC, BEET POWDER, CARRAGEENAN, POTASSIUM CHLORIDE, XANTHAN GUM), MODIFIED CORN STARCH, CONTAINS 2% OR LESS OF EACH OF THE FOLLOWING: SALT, DEHYDRATED PARMESAN CHEESE (PART SKIM MILK, CULTURES, SALT, ENZYMES), DISODIUM PHOSPHATE), REDUCED FAT PEPPERONI (PORK, BEEF, WATER, TEXTURED VEGETABLE PROTEIN PRODUCT* (SOY PROTEIN CONCENTRATE, ZINC OXIDE, NIACINAMIDE, FERROUS SULFATE, COPPER GLUCONATE, VITAMIN A PALMITATE, CALCIUM PANTOTHENATE, THIAMINE MONONITRATE (B1), PYRIDOXINE HYDROCHLORIDE (B6), RIBOFLAVIN (B2), AND CYANOCOBALAMIN (B12)), SALT, LESS THAN 2% OF SPICES, DEXTROSE, LACTIC ACID STARTER CULTURE, OLEORESIN OF PAPRIKA, FLAVORING, SODIUM NITRITE, BHA, BHT, CITRIC ACID. *INGREDIENT NOT IN REGULAR PEPPERONI).
CONTAINS: MILK, SOY, WHEAT

COOKING INSTRUCTIONS / INSTRUCCIONES:

PREHEAT THE CONVECTION OVEN TO 375°F (OR A CONVENTIONAL OVEN TO 400°F). PRODUCT MUST BE COOKED FROM A FROZEN STATE FOR BEST RESULTS. PLACE FROZEN PIZZAS ON AN 18" x 26" x 1/2" BUN PAN. PRECALIENTE EL HORNO DE CONVECCION HASTA ALCANZAR LOS 375°F (O EL HORNO COMÚN HASTA ALCANZAR LOS 400°F). EL PRODUCTO DEBE COCINARSE SIN DESCONGELAR PARA OBTENER LOS MEJORES RESULTADOS. PONGA LAS PIZZAS CONGELADAS EN UNA FUENTE DE 18" x 26" x 1/2".

OVEN TYPE / TIPO DE HORNO	TEMPERATURE / TEMPERATURA	COOKING TIME / TIEMPO DE COCCIÓN
CONVECTION / CONVECCION	375°F	11-14 MINUTES / 11 A 14 MINUTOS
CONVENTIONAL / COMÚN	400°F	20-22 MINUTES / 20 A 22 MINUTOS

NOTE: OVEN TEMPERATURE AND TIMES MAY VARY DUE TO OVEN LOAD AND/OR PRODUCT TEMPERATURE. REFRIGERATE OR DISCARD ANY UNUSED PORTION. NOTA: LA TEMPERATURA DEL HORNO Y EL PERÍODO DE TIEMPO PUEDEN VARIAR DEBIDO A LA CARGA DEL HORNO Y/O LA TEMPERATURA DEL PRODUCTO. REFRIGERE O DESECHE LA PARTE NO USADA.

NOT READY TO EAT. COOK THOROUGHLY. FOR FOOD SAFETY AND QUALITY, COOK BEFORE EATING TO AN INTERNAL TEMPERATURE OF 160°F.

FOR INSTITUTIONAL USE

COOK BEFORE SERVING

KEEP FROZEN

L.B.N. [Licensed Connecticut 3906]



10072180783575

CONTAINS: 60 - 5.19 OZ. PORTIONS
NET WT.: 19 LBS. 7.40 OZ.





New Tony'sTM Grilled Cheese

*The classic lunchtime
sandwich made better!*

Kids love grilled cheese sandwiches. Now the makers of the **Tony's**[®] brand make a lunchtime classic even better. Our CN labeled 51% whole grain grilled cheese sandwiches feature delicious cheese surrounded by two slices of lightly toasted bread.

Nobody but the makers of the **Tony's**[®] brand could bring you a kid-pleasing classic like this!

Tony's

The lunchtime classic kids love.

They'll love the great taste. And you'll love the fact that it's a healthier alternative to other traditional grilled cheese sandwiches.

Our lightly toasted bread delivers 51% whole grain goodness to kids. And between the slices they'll find great tasting, great melting cheese. No wonder everyone's smiling!

Each **Tony's™** Grilled Cheese Sandwich contains:

- 51% whole grain
- 2 oz. equivalent meat/meat alternate and 2 servings of bread
- 0g trans fat
- Excellent source of calcium
- Good source of protein (17g)

Plus, it's available for commodity processing!

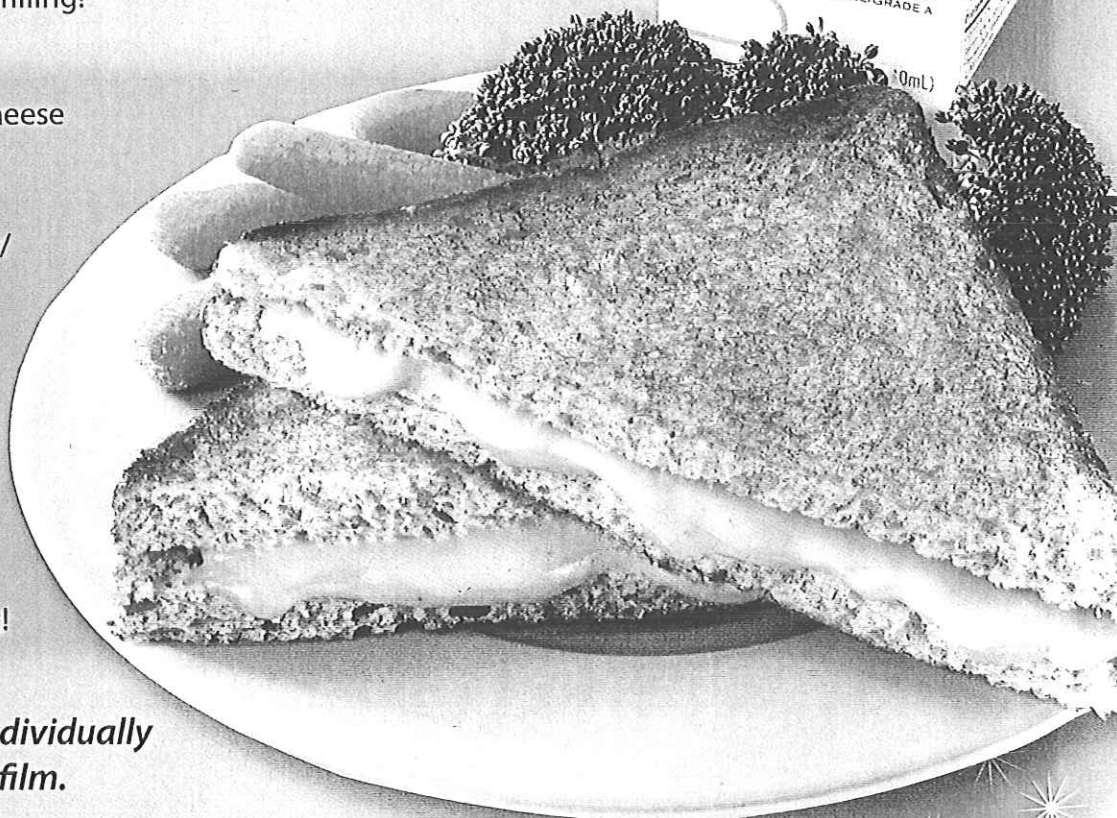

Available in bulk or individually wrapped in ovenable film.

PREP INSTRUCTIONS

Cooking Method	Temp	Time
Convection Oven	350°F	20 minutes

NOTE: Due to variances in oven regulators, cooking time and temperature may require adjustments.

CN INFORMATION

081547

Each 4.30 oz. Grilled Cheese Sandwich provides 2.00 oz. equivalent meat alternate and 2 servings of bread for the Child Nutrition Meal Pattern Requirements. (Use of this logo and statement authorized by the Food and Nutrition Service, USDA 08-11.)

NUTRITION

Product Description	Prod. Code	Serv./Case	Serv. Size (oz.)	M/MA (oz.)	Bread	Whole Grain (g)	Cal.	Total Fat (g)	% Cal. from Fat	Sat. Fat (g)	% Cal. from Sat. Fat	Trans Fat (g)	Chol. (g)	Sodium (mg)	Carbs. (g)	Fiber (g)	Sugar (g)	Protein (g)	Vit. A (IU)	Vit. C (mg)	Calcium (mg)	Iron (mg)
Grilled Cheese – Bulk	55224	48	4.30	2	2	30	320	15	42%	4	11%	0	5	860	34	3	6	17	100	0	450	1.44
Grilled Cheese – IW	55225	48	4.30	2	2	30	320	15	42%	4	11%	0	5	860	34	3	6	17	100	0	450	1.44

For more information or to order product samples, call 1-877-302-7426 or visit tonys.schwansfoodservice.com



THE SCHWAN FOOD COMPANY
SCHWAN'S FOOD SERVICE, INC.

Früchi[®]

Smoothies



Convenient and portable — enjoy ready-to-eat,
real fruit frozen smoothies anywhere!

Bring Your Customers the FRUCHI™ Smoothie Experience!

FRUCHI™ is the country's first and only ready-to-eat, real fruit frozen smoothie! FRUCHI™ Smoothies taste great, are made with the highest quality ingredients and give your customers a grab and go option they will love.



Customers love FRUCHI™ Smoothies because they provide:

- A full serving of fruit
- "All Natural"
- 100% RDA of Vitamin C
- Little or no Sodium, Fat or Cholesterol
- Antioxidants and other essential vitamins and nutrients
- Only 130-140 calories per large 8 ounce pouch

You will want them for your operation because they save time and money!

- No Prep required—Grab'n'go convenience for you and your customers
- Frozen shelf life of 12 months: little to no waste for your operation
- Eat right from the pouch—no messy and expensive cups, napkins, spoons or straws
- Packaged in environmentally-friendly, sustainable materials

CODE	PRODUCT DESCRIPTION	UNIT WEIGHT (OZ.)	UNIT COUNT PER CASE	CASE DIMENSIONS	GROSS CASE WEIGHT (LBS.)	NET CASE WEIGHT (LBS.)	T/H/I	CASE/ PALLET
53329	FRUCHI™ Strawberry Banana (12 CT)	8	12	10.938 x 7.875 x 6.250	7.23	5.94	22 x 12	264
53330	FRUCHI™ Berry Blast (12 CT)	8	12	10.938 x 7.875 x 6.250	7.23	5.94	22 x 12	264
53331	FRUCHI™ Island Splash (12 CT)	8	12	10.938 x 7.875 x 6.250	7.23	5.94	22 x 12	264
53332	FRUCHI™ Raspberry Rush (12 CT)	8	12	10.938 x 7.875 x 6.250	7.23	5.94	22 x 12	264
53333	FRUCHI™ Strawberry Banana (24 CT)	8	24	13.438 x 7.813 x 8.750	12.87	11.88	18 x 8	144
53334	FRUCHI™ Berry Blast (24 CT)	8	24	13.438 x 7.813 x 8.750	12.87	11.88	18 x 8	144
53335	FRUCHI™ Island Splash (24 CT)	8	24	13.438 x 7.813 x 8.750	12.87	11.88	18 x 8	144
53336	FRUCHI™ Raspberry Rush (24 CT)	8	24	13.438 x 7.813 x 8.750	12.87	11.88	18 x 8	144



FRUCHI™ Berry Blast

Flavor-Packed and Bold

Antioxidants abound and blueberries lead the way in this powerful dark berry blend.



FRUCHI™ Island Splash

A Tropical Delight

Escape to the Caribbean with this refreshing mix of oranges, peaches and mangos with our all-natural fruit juice blend.



FRUCHI™ Raspberry Rush

Rush Says it All

Zing your taste buds with this tangy blend of raspberry juice, strawberries, blackberries and other power-packed juices.



FRUCHI™ Strawberry Banana

A Timeless Favorite

Strawberries and bananas combine with our 100% all-natural fruit juice blend to make this one unforgettable smoothie.

Visit Fruchi.com for more information