



State of West Virginia
 Department of Administration
 Purchasing Division
 2019 Washington Street East
 Post Office Box 50130
 Charleston, WV 25305-0130

Request for Quotation

RFQ NUMBER
 DNR209122

PAGE
 1

ADDRESS CORRESPONDENCE TO ATTENTION OF
 FRANK WHITTAKER
 304-558-2316

VENDOR

*702142549 304-428-3000
 DAVIS ATHLETICS LLC
 2325 LIBERTY ST
 PARKERSBURG WV 26101

SHIP TO

DIVISION OF NATURAL RESOURCES
 CEDAR CREEK STATE PARK
 ATTN: PARK SUPERINTENDENT
 ROUTE 1, BOX 9
 GLENNVILLE, WV
 26351 462-7158

DATE PRINTED	TERMS OF SALE	SHIP VIA	F.O.B.	FREIGHT TERMS
03/18/2009				

BID OPENING DATE: 04/22/2009 BID OPENING TIME 01:30PM

LINE	QUANTITY	UOP	CAT NO.	ITEM NUMBER	UNIT PRICE	AMOUNT
0001	1	LS		650-38		
PLAYGROUND EQUIPMENT (NOT OTHERWISE CLASSIFIED)						
THE WEST VIRGINIA PURCHASING DIVISION, FOR THE AGENCY, THE WEST VIRGINIA DIVISION OF NATURAL RESOURCES IS SOLICITING BIDS FROM RESPONSIBLE VENDORS FOR NEW PLAYGROUND EQUIPMENT FOR CEDAR CREEK STATE PARK PER THE ATTACHED SPECIFICATIONS.						
TECHNICAL QUESTIONS MAY BE SUBMITTED IN WRITING TO FRANK WHITTAKER VIA FAX AT 304-558-4115 OR VIA EMAIL AT FRANK.M.WHITTAKER@WV.GOV. DEADLINE FOR TECHNICAL QUESTIONS IS 04/06/2009 AT 4:00 PM						
BANKRUPTCY: IN THE EVENT THE VENDOR/CONTRACTOR FILES FOR BANKRUPTCY PROTECTION, THIS CONTRACT MAY BE DEEMED NULL AND VOID, AND TERMINATED WITHOUT FURTHER ORDER.						
THE MODEL/BRAND/SPECIFICATIONS NAMED HEREIN ESTABLISH THE ACCEPTABLE LEVEL OF QUALITY ONLY AND ARE NOT INTENDED TO REFLECT A PREFERENCE OR FAVOR ANY PARTICULAR BRAND OR VENDOR. VENDORS WHO ARE BIDDING ALTERNATES SHOULD SO STATE AND INCLUDE PERTINENT LITERATURE AND SPECIFICATIONS. FAILURE TO PROVIDE INFORMATION FOR ANY ALTERNATES MAY BE GROUNDS FOR REJECTION OF THE BID. THE STATE RESERVES THE RIGHT TO WAIVE MINOR IRREGULARITIES IN BIDS OR SPECIFICATIONS IN ACCORDANCE WITH SECTION 148-1-4(F) OF THE WEST VIRGINIA LEGISLATIVE RULES AND REGULATIONS.						
NOTICE						

RECEIVED
 2009 APR 22 A 10:05
 PURCHASING DIVISION
 STATE OF WV

SEE REVERSE SIDE FOR TERMS AND CONDITIONS

SIGNATURE <i>J. L. R. D.</i>	TELEPHONE 304-428-3000	DATE 4-21-09
TITLE Purchase Manager	FEIN 91-2171922	ADDRESS CHANGES TO BE NOTED ABOVE

WHEN RESPONDING TO RFQ, INSERT NAME AND ADDRESS IN SPACE ABOVE LABELED 'VENDOR'



State of West Virginia
 Department of Administration
 Purchasing Division
 2019 Washington Street East
 Post Office Box 50130
 Charleston, WV 25305-0130

Request for Quotation

RFQ NUMBER
DNR209122

PAGE
2

ADDRESS CORRESPONDENCE TO ATTENTION OF
FRANK WHITTAKER 304-558-2316

VENDOR
*702142549 304-428-3000 DAVIS ATHLETICS LLC 2325 LIBERTY ST PARKERSBURG WV 26101

SHIP TO
DIVISION OF NATURAL RESOURCES CEDAR CREEK STATE PARK ATTN: PARK SUPERINTENDENT ROUTE 1, BOX 9 GLENNVILLE, WV 26351 462-7158

DATE PRINTED	TERMS OF SALE	SHIP VIA	F.O.B.	FREIGHT TERMS
03/18/2009				

BID OPENING DATE: 04/22/2009 BID OPENING TIME: 01:30PM

LINE	QUANTITY	UOP	CAT NO	ITEM NUMBER	UNIT PRICE	AMOUNT
<p>A SIGNED BID MUST BE SUBMITTED TO:</p> <p>DEPARTMENT OF ADMINISTRATION PURCHASING DIVISION BUILDING 15 2019 WASHINGTON STREET, EAST CHARLESTON, WV 25305-0130</p> <p>THE BID SHOULD CONTAIN THIS INFORMATION ON THE FACE OF THE ENVELOPE OR THE BID MAY NOT BE CONSIDERED:</p> <p>SEALED BID</p> <p>BUYER: 44</p> <p>RFQ. NO.: DNR209122</p> <p>BID OPENING DATE: 04/22/2009</p> <p>BID OPENING TIME: 1:30 PM</p> <p>PLEASE PROVIDE A FAX NUMBER IN CASE IT IS NECESSARY TO CONTACT YOU REGARDING YOUR BID: <u>304-428-3002</u></p> <p>CONTACT PERSON (PLEASE PRINT CLEARLY): <u>FRED DAVIS</u></p>						

SEE REVERSE SIDE FOR TERMS AND CONDITIONS

SIGNATURE <i>Fred Davis</i>	TELEPHONE 304.428.3000	DATE 4-21-09
TITLE <i>Manager</i>	FEIN 41.2171922	ADDRESS CHANGES TO BE NOTED ABOVE

WHEN RESPONDING TO RFQ, INSERT NAME AND ADDRESS IN SPACE ABOVE LABELED 'VENDOR'



State of West Virginia
 Department of Administration
 Purchasing Division
 2019 Washington Street East
 Post Office Box 50130
 Charleston, WV 25305-0130

Request for Quotation

RFQ NUMBER
 DNR209122

PAGE
 3

ADDRESS CORRESPONDENCE TO ATTENTION OF:
 FRANK WHITTAKER
 304-558-2316

VENDOR

*702142549 304-428-3000
 DAVIS ATHLETICS LLC
 2325 LIBERTY ST

 PARKERSBURG WV 26101

SHIP TO

DIVISION OF NATURAL RESOURCES
 CEDAR CREEK STATE PARK
 ATTN: PARK SUPERINTENDENT
 ROUTE 1, BOX 9
 GLENNVILLE, WV
 26351 462-7158

DATE PRINTED	TERMS OF SALE	SHIP VIA	F.O.B.	FREIGHT TERMS
03/18/2009				

BID OPENING DATE: 04/22/2009 BID OPENING TIME 01:30PM

LINE	QUANTITY	UOP	CAT NO.	ITEM NUMBER	UNIT PRICE	AMOUNT
***** THIS IS THE END OF RFQ DNR209122 ***** TOTAL:						<u>\$69,521</u>

SEE REVERSE SIDE FOR TERMS AND CONDITIONS

SIGNATURE <i>J. L. [Signature]</i>	TELEPHONE 304-428-3000	DATE 4.21.09
TITLE <i>Order Manager</i>	FEIN 41-2171922	ADDRESS CHANGES TO BE NOTED ABOVE

WHEN RESPONDING TO RFQ, INSERT NAME AND ADDRESS IN SPACE ABOVE LABELED 'VENDOR'

To supply playground equipment to offer play activities for children ages five (5) to twelve (12) at Cedar Creek State Park, Glenville, West Virginia. Playground equipment will be purchased for four separate areas in the park. Park personnel will install all playground equipment. The award may be split if it is in the best interest of the West Virginia Division of Natural Resources.

BATHHOUSE #1 AREA PLAYGROUND

Henderson custom play structure, Model #PF09679RO, or equal. F.O.B. Destination. Freight or delivery charges must be included in the price of the goods. Delivery must be made within ninety (90) days of purchase order award. Structure components must include all hardware necessary for assembly. Structure must include the following components:

- Ten (10) Henderson PF post caps or equal.
- Two (2) Henderson 101" PF post with aluminum cap or equal.
- Two (2) Henderson 126" P4 post with aluminum cap or equal.
- Two (2) Henderson 129" P4 post with aluminum cap or equal.
- Three (3) Henderson 132" P4 post with aluminum cap or equal.
- One (1) Henderson 147" P4 post with aluminum cap or equal.
- One (1) Henderson spacewalk or equal. Spacewalk must be a minimum of 4' in length.
- One (1) Henderson accessible step deck or equal. Step deck must be a minimum of 32" in height.
- One (1) Henderson grab bars (transfer point) or equal.
- One (1) Henderson 90° loop challenge or equal.
- One (1) Henderson jump! Panel or equal.
- One (1) Henderson accessible step up or equal. Step up must be a minimum of 12" in height.
- One (1) Henderson rock wall climber or equal. Climber must be a minimum of 4' in height.
- One (1) Henderson double scoop slide complete with hood or equal. Slide must be a minimum of 4' in height.

LAUNDRY/BATHHOUSE AREA PLAYGROUND

Henderson custom play structure, Model #PF09680R0, or equal. F.O.B. Destination. Freight or delivery charges must be included in the price of the goods. Delivery must be made within ninety (90) days of purchase order award. Structure components must include all hardware necessary for assembly. Structure must include the following components:

- One (1) Henderson PF post cap or equal.
- One (1) Henderson 78" P4 post with aluminum cap or equal.
- One (1) Henderson maze wheel or equal.
- Eleven (11) PF post caps or equal.
- Two (2) 126" P4 post with aluminum cap or equal.
- Two (2) 135" P4 post with aluminum cap or equal.
- One (1) 141" P4 post with aluminum cap or equal.
- Three (3) 150" P4 post with aluminum cap or equal.
- Two (2) 156" P4 post with aluminum cap or equal.
- One (1) 104" P4 post with aluminum cap or equal.
- One (1) Henderson rappel wall or equal. Wall must be a minimum of 6' in height.
- One (1) Henderson racecar panel or equal.
- One (1) Henderson accessible trapeze beam or equal.
- One (1) Henderson right transfer station or equal. Transfer station must be a minimum of 4' in length.
- One (1) Henderson tower climber or equal. Climber must be a minimum of 4' in height.
- One (1) Henderson accessible step deck or equal. Step deck must be a minimum of 24" in height.
- One (1) Henderson pipe ladder or equal. Ladder must be a minimum of 6' in height.
- One (1) Henderson right stargate slide veer complete with hood or equal. Slide veer must be a minimum of 6' in height.

BATHHOUSE #3 AREA PLAYGROUND

Henderson custom play structure, Model #PF09681R0, or equal. F.O.B. Destination. Freight or delivery charges must be included in the price of the goods. Delivery must be made within ninety (90) days of purchase order award. Structure components must include all hardware necessary for assembly. Structure must include the following components:

- Twenty-one (21) Henderson PF post cap or equal.
- Two (2) Henderson 48" P4 post with flat welded cap or equal.
- Three (3) Henderson 108" P4 post with aluminum cap or equal.
- One (1) Henderson 150" P4 post with aluminum cap or equal.
- Two (2) Henderson 141" P4 post with aluminum cap or equal.
- Two (2) Henderson 138" P4 post with aluminum cap or equal.
- Four (4) Henderson 132" P4 post with aluminum cap or equal.
- One (1) Henderson 126" P4 post with aluminum cap or equal.
- Three (3) Henderson 114" P4 post with aluminum cap or equal.
- One (1) Henderson 104" P4 post with aluminum cap or equal.
- Two (2) Henderson 90" P4 post with aluminum cap or equal.
- One (1) Henderson 78" P4 post with aluminum cap or equal.
- One (1) Henderson 120" P4 post with aluminum cap or equal.
- One (1) Henderson rappel wall or equal. Wall must be minimum of 5' in height.
- One (1) Henderson cobra climber 4' deck to deck or equal.
- One (1) Henderson maze wheel or equal.
- One (1) Henderson accessible trapeze beam or equal.
- One (1) Henderson jump! panel or equal.
- One (1) Henderson twin track ride or equal.
- One (1) Henderson 270° loop challenge or equal.
- One (1) Henderson tidal wave link or equal.
- One (1) Henderson deck ladder or equal. Ladder must be a minimum of 3' in height.
- One (1) Henderson spacewalk or equal. Spacewalk must be a minimum of 4' in length.
- One (1) Henderson bubble climber or equal.
- One (1) Henderson left transfer station or equal. Station must be a minimum of 3' in length.
- One (1) Henderson slide pole or equal. Pole must be a minimum of 4' in height.
- One (1) Henderson rock wall climber or equal. Climber must be a minimum of 5' in height.
- One (1) Henderson double dare slide complete with hood or equal. Slide must be a minimum of 5' in height.
- One (1) Henderson playseat or equal.

ONE ROOM SCHOOL AREA PLAYGROUND

Henderson custom play structure, Model #PF09682R0, or equal. F.O.B. Destination. Freight or delivery charges must be included in the price of the goods. Delivery must be made within ninety (90) days of purchase order award. Structure components must include all hardware necessary for assembly. Structure must include the following components:

- Thirty-five (35) Henderson PF post cap or equal.
- One (1) Henderson 104" P4 post with no cap or equal.
- Six (6) Henderson 48" P4 post with flat welded cap or equal.
- Four (4) Henderson 126" P4 post with aluminum cap or equal.
- Two (2) Henderson 168" P4 post with aluminum cap or equal.
- Two (2) Henderson 162" P4 post with aluminum cap or equal.
- Three (3) Henderson 153" P4 post with aluminum cap or equal.
- Four (4) Henderson 150" P4 post with aluminum cap or equal.
- Two (2) Henderson 135" P4 post with aluminum cap or equal.
- Two (2) Henderson 129" P4 post with aluminum cap or equal.
- Six (6) Henderson 120" P4 post with aluminum cap or equal.
- Two (2) Henderson 114" P4 post with aluminum cap or equal.
- Two (2) Henderson 104" P4 post with aluminum cap or equal.
- Three (3) Henderson 90" P4 post with aluminum cap or equal.
- Three (3) Henderson 132" P4 post with aluminum cap or equal.
- One (1) Henderson, single cliffhanger or equal. Cliffhanger must be a minimum of 6' in height.
- One (1) Henderson incline connector or equal. Connector must be a minimum of 1' in height.
- One (1) Henderson vertical rail or equal.
- One (1) Henderson playseat or equal.
- One (1) Henderson stargate left slide turn complete with hood or equal. Slide must be a minimum of 7' in height.
- One (1) Henderson vertical rail or equal.
- One (1) Henderson maze wheel or equal.
- One (1) Henderson playseat or equal.
- One (1) Henderson fredrock climber or equal. Climber must be a minimum of 4' in height.
- One (1) Henderson accessible trapeze beam or equal.
- One (1) Henderson twin track ride or equal.
- One (1) Henderson loop-to-loop or equal.
- One (1) Henderson jump! panel or equal.
- One (1) Henderson cobra link or equal.
- One (1) Henderson bubble climber or equal.
- One (1) Henderson pipe ladder or equal. Ladder must be a minimum of 3' in height.

ONE ROOM SCHOOL AREA PLAYGROUND CONTD.

- One (1) Henderson mineshaft link or equal. Link must be a minimum of 3' in length.
- One (1) Henderson spacewalk or equal. Spacewalk must be a minimum of 3' in length.
- One (1) Henderson accessible step deck or equal. Step deck must be a minimum of 12" in height.
- One (1) Henderson double scoop slide complete with hood or equal. Slide must be a minimum of 4' in height.
- One (1) Henderson tot arch bridge with protective barriers or equal.
- One (1) Henderson left transfer station or equal. Transfer station must be a minimum of 4' in length.
- One (1) Henderson accessible step deck or equal. Step deck must be a minimum of 24" in height.
- One (1) Henderson triple slide complete with hood or equal. Slide must be a minimum of 6' in height.
- One (1) Henderson rappel wall or equal. Wall must be a minimum of 6' in height.

Henderson 1-bay arch swing 8' complete with belt seats, Model #SW340, or equal.

Henderson arch swing 8' extend a half bay complete with baby seat, Model #SW342, or equal.

ITEMS FOR ALL FOUR PLAYGROUNDS

Childforms funtimber with spike, Model #FTB-00002, or equal. F.O.B. Destination. Freight or delivery charges must be included in the price of the goods.

Childforms filler ends, Model #ADJ-00008, or equal. F.O.B. Destination. Freight or delivery charges must be included in the price of the goods.

Geo-textile fabric or equal. F.O.B. Destination. Freight or delivery charges must be included in the price of the goods.

Engineered wood fiber @ 8" compacted depth. F.O.B. Destination. Freight or delivery charges must be included in the price of the goods.

All playground equipment and engineered wood fiber must meet the following requirements:

- Compliance with U.S. Consumer Product Safety Commission, Handbook for Public Playground Safety.
- Compliance with ASTM Standard F 1487.
- Compliance with Architectural and Transportation Barriers Compliance Board, Americans with Disabilities Act (ADA) Accessibility Guidelines for Buildings and Facilities; Play Areas.

Vendors must submit the following attachments:

- Complete manufacturer's parts specifications and warranties.
- Layout drawing to scale of the proposed play structure or equipment.
- ASTM and CPSC Statement of Compliance

Warranties:

- All equipment and engineered wood fiber must be guaranteed to be free of defects in workmanship and material for a minimum of one year from date of acceptance. However, if manufacturer warranty periods are longer than the required minimum one year warranty, those warranties shall apply.

All playground equipment must include tamper proof fasteners to prevent theft and destruction.

Color scheme of equipment must be coordinated with Cass Scenic Railroad State Park. Color of items will be selected from manufacturer's standard colors.

A mandatory pre-bid conference will be held on April 1, 2009, at Cedar Creek State Park at 1:00 pm. A failure to attend the mandatory pre-bid conference will result in bid disqualification. An individual may not represent more than one firm at the pre-bid conference.

Model # PF09679R0

Davis Athletics

Cedar Creek West Virginia State Park - Area 1

BATHHOUSE #1 AREA PLAYGROUND

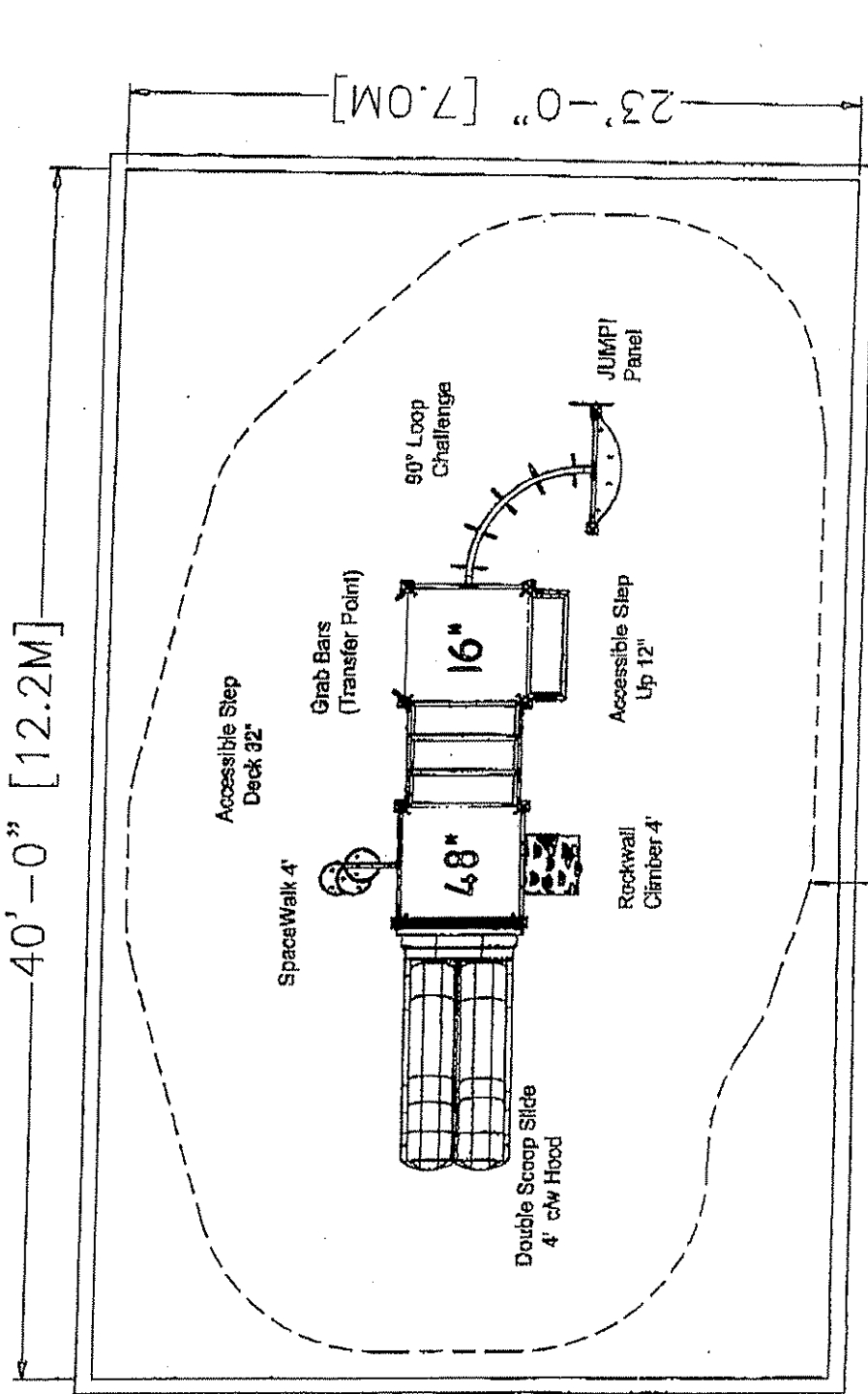
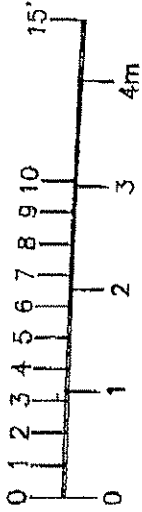

AWARNING
INFORMATION ON SAFETY AND PROPER USE OF THIS EQUIPMENT IS AVAILABLE IN THE USER MANUAL AND IN THE SAFETY MANUAL.

Best Year: Ages 5 to 12 yr.

Accessibility: Yes

Colors:

- Base: Brown
- Access: Green
- Slide: Yellow
- Transfer: Yellow
- Other: Yellow/Green

Surfacing Type: Wood Chips

Border Area: 820

Border Postmarker: 126

Installation Style:

Inground 36"

Footprint Dimensions: D

Compliance:

ASTM F 1487, CPSC

Safety: ROPS F.D.

Note: All border dimensions are inside border dimensions. All play structure dimensions are center-to-center of the posts unless otherwise specified. The location of all tiebacks, straps, cables, rollers, pins, and anchors must be clearly marked by the customer prior to the proposed installation. All equipment must be installed with dimensions to meet the required subsections of the latest EN1176-2014 (EN1176) or ASTM F 1487 (USA) reference. The playground installation site must be properly prepared to meet the requirements of the program prior to installation. The program installation dimensions have normal soil and sloping conditions. Please notify us of any unusual soil conditions. Henderson Recreation Equipment Limited has a commitment to continuous improvement and innovation to improve the quality of our products and specifications without notice.

Note: No-occupant areas that are adjacent to the outside of the safety surface area must be free of any obstacles and should include the required tieback hardware. No-occupant areas that are within the safety surface area must be free of all obstacles.

Drawn By: R.H.
Date Drawn: October 7, 2008

Reviewed By:
Revision Date:
Scale: See Key

Henderson
RECREATION EQUIPMENT LIMITED

Model # PF096880R0

Davis Athletics

Cedar Creek West Virginia State Park - Area 2
LAUNDRY/BATHHOUSE AREA PLAYGROUND

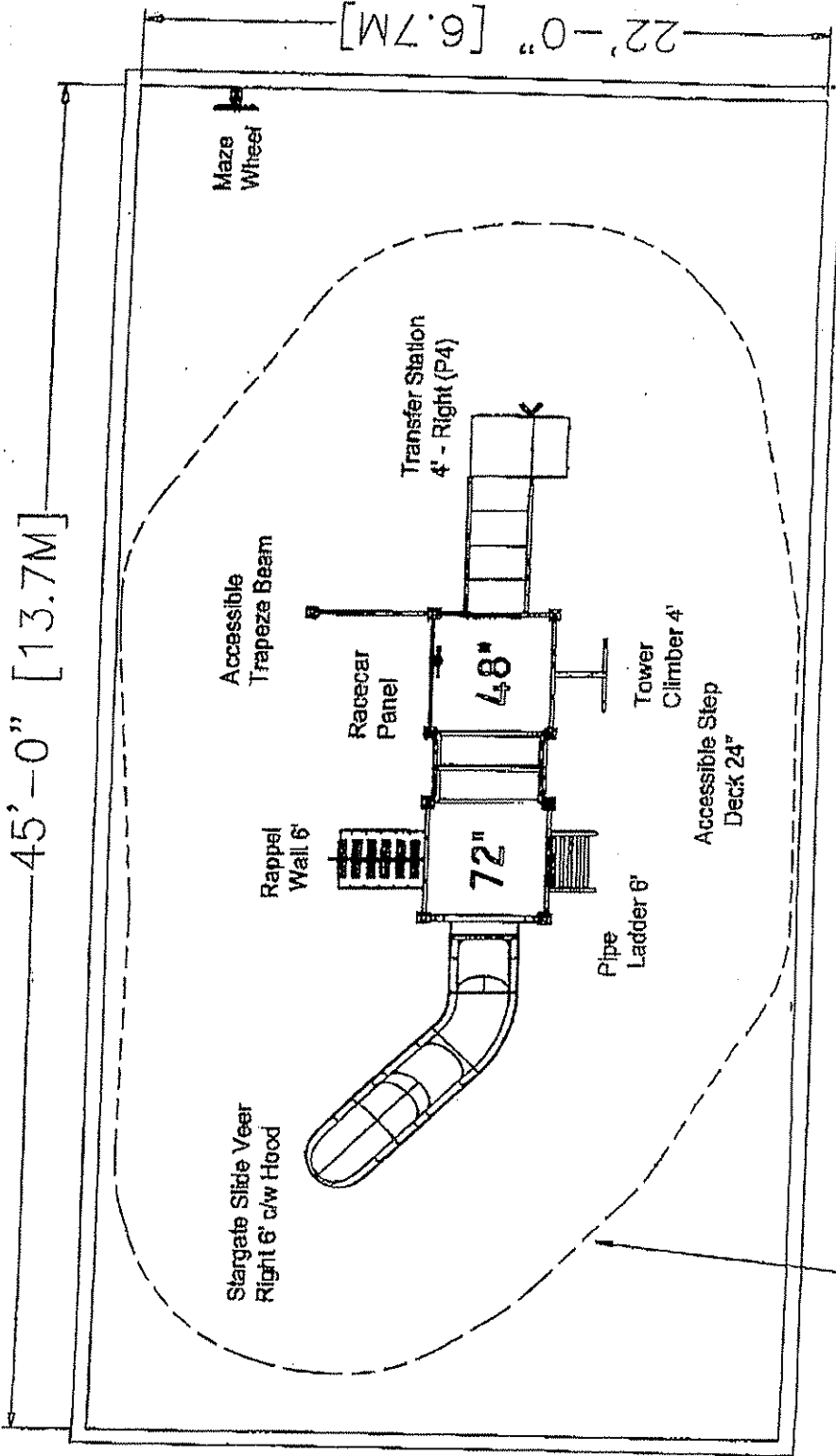
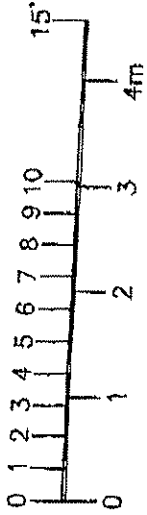

AWARNING
THIS PRODUCT IS NOT TO BE USED FOR
PLAY OR RECREATION PURPOSES.
IT IS NOT TO BE USED AS A
PART OF A STRUCTURE OR AS A
SURFACE FOR ANY OTHER PURPOSE.

Best User Age: 5 to 12
Accessibility: Yes
Color: Brown, Green, Red, Yellow, Orange, Blue, Grey, Black, White, Tan, Grey, Green, Other:
Surfacing: Loose Wood Chips
Bumper Area: 999
Bumper Perimeter: 134
Insulation: Sinks
Inground: 36"
Footing: Quantity: 0
Compliance: ASTM F 1487, CPSC
Safety: Risk F.D.

Note: All barrier dimensions are inside barrier measurements. All play structure dimensions are center-to-center of the posts. The distance of all dimensions, heights, clearances, and spacings must be verified by the manufacturer prior to the playground installation. All playgrounds must be installed with appropriate resistant surfacing and safety berms to meet the required guidelines of the latest CAN/CSA-2314 (CAN) or ASTM F 1487 (USA) releases. The playground installation site must be properly prepared to meet the manufacturer's specifications. Installation instructions for all equipment has normal set and storage conditions. Please verify all set and storage conditions. Equipment Installation Instructions must be read and understood prior to installation. Equipment is not to be used for any other purpose. The manufacturer is not responsible for any damage or loss of equipment or personal injury resulting from the use of this equipment. The manufacturer is not responsible for any damage or loss of equipment or personal injury resulting from the use of this equipment.

Attention: All equipment is not to be used for any other purpose. The manufacturer is not responsible for any damage or loss of equipment or personal injury resulting from the use of this equipment. The manufacturer is not responsible for any damage or loss of equipment or personal injury resulting from the use of this equipment.

Warning: All equipment is not to be used for any other purpose. The manufacturer is not responsible for any damage or loss of equipment or personal injury resulting from the use of this equipment. The manufacturer is not responsible for any damage or loss of equipment or personal injury resulting from the use of this equipment.

Drawn By: BAC
Date: March, October 7, 2008
Revised By:
Revised Date:
Scale: See Key

Henderson
RECOMMENDED EQUIPMENT LIMITED, P.O. BOX 88, 11 CHESTNUT DRIVE, SAUNDERS CREEK, CANADA, N1P 4A8, TEL: 519-238-1132, FAX: 519-238-1132. ALL RIGHTS RESERVED. THIS DRAWING IS NOT TO BE REPRODUCED IN ANY WAY WITHOUT PRIOR APPROVAL. REV. 2/2008

Model # PF09681R0

Davis Athletics

Cedar Creek West Virginia State Park - Area 3

BATHHOUSE #3 AREA PLAYGROUND

45'-0" [13.7M]

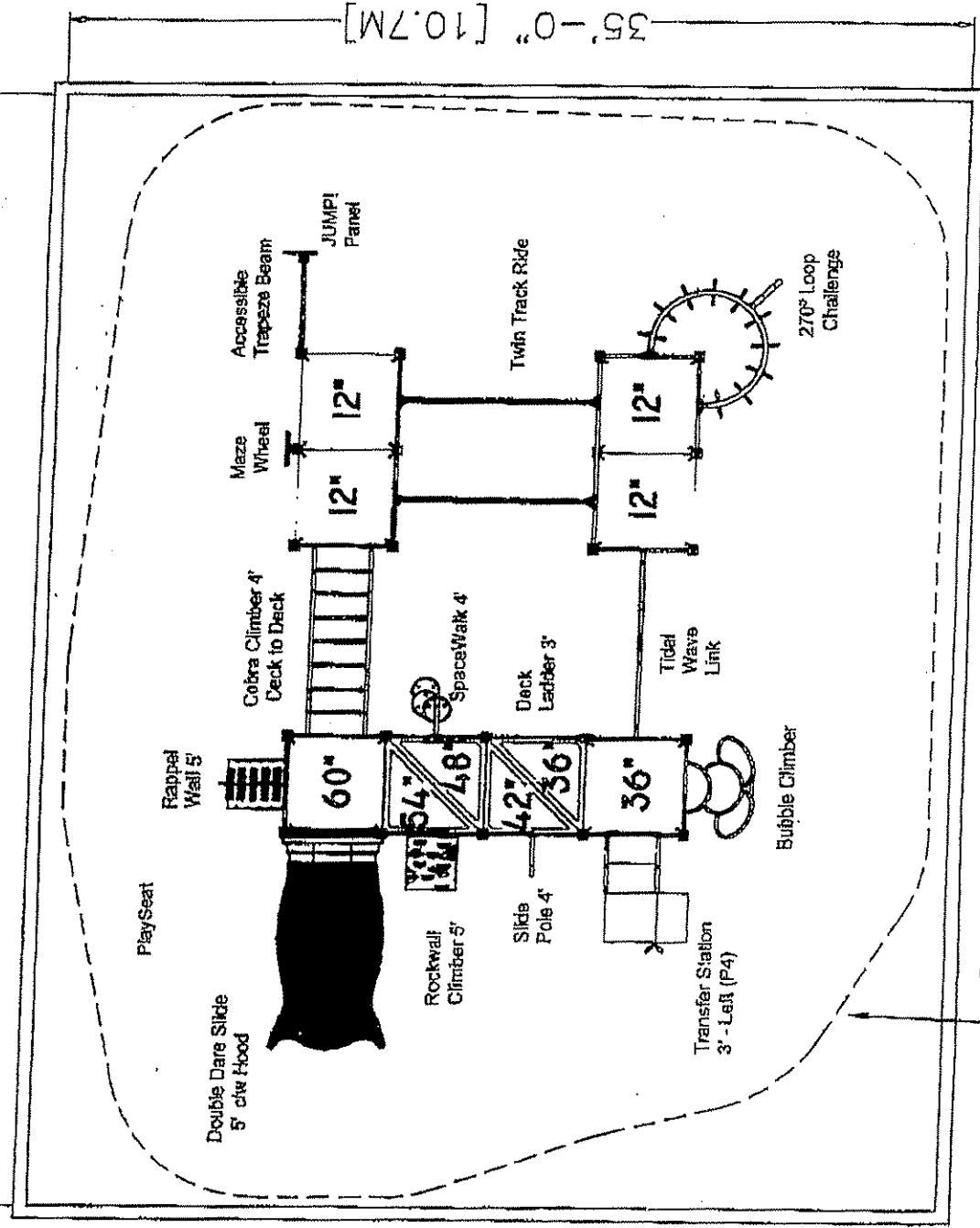
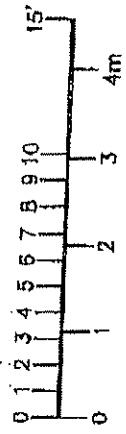

WARNING
 PLAYERS MUST BE SUPERVISED BY AN ADULT AT ALL TIMES.
 CHILDREN SHOULD NOT BE ALLOWED TO PLAY ON THIS EQUIPMENT IF THEY ARE WEARIN...

Best User Age: 5 to 12

Accessibility: Yes

Color(s):

- Frame: Brown
- Accent: Green
- Body: Plastic
- 3/4 Plastic: Tan
- Other: Tony/Gamma

Structuring Type: Wood Chips

Border Area: 1575

Border Perimeter: 160

Installation Style:

Inground 36"

Loading Quantity: 0

Compliance:

ASTM F 1487, CPSC

Scale: Feet: F.D.

Note:
 All border dimensions are inside border measurements. All play structure dimensions are outside - i.e. - safety of the points where the structure meets the ground. The manufacturer is not responsible for damage to the structure caused by water, rocks, and debris. The manufacturer is not responsible for damage to the structure caused by the playground prior to installation.
 All playgrounds must be installed with appropriate surfacing and safety zones to meet the required guidelines of the ASTM F1487-2012 (2016) or ASTM F 1487 (USA) release. The playground manufacturer must be referred to for installation and safety specifications prior to installation.
 Henderson Recreation reserves the right to improve, alter or discontinue products and specifications without notice.

Warning:
 No attachment areas that are exposed to the outside of the safety surface area must be free of any obstacles that could trap or hook into pedestrian traffic flow around the safety surface area. No attachment areas that are within the safety surface area must be free of 31 obstacles.

Drawn By: R.H.
 Date: December 7, 2006
 Reviewed By:
 Revision Date:
 Scale: See Key

Recommended Protective Surface Zone

Henderson

HENDERSON RECREATION EQUIPMENT LIMITED, P.O. BOX 88, 11 HENDERSON DRIVE, SUDBURY, ONTARIO, CANADA, M7Y 4S3, TEL: 905.882.4482 FAX: 905.882.4482

Model # PF09682R0

Davis Athletics

Cedar Creek West Virginia State Park - Area 4

ONE ROOM SCHOOL AREA PLAYGROUND

AWARNING
 ALL SURFACE MATERIALS MUST BE INSTALLED TO THE SPECIFIED DEPTH AND COMPACTED TO THE SPECIFIED DENSITY.
 SEE SPECIFICATIONS FOR FURTHER DETAILS.

Best User Age: 5 to 12
 Accessibility: Yes
 Colors: Brown, Green, Red, Plastic, Tan, 3/4" Plastic, Tan/Green
 Other:

Surfacing Type: Wood Chips
 Border Area: 3500
 Border Perimeter: 240
 Installation Site:
 Inground: 36"
 Fencing Quantity: 0
 Compliance:
 ASTM F 1487, CPSC
 Safety Bags: F.D.

Note:
 All border dimensions are for the border measurement. At play attractors dimensions are center-to-center of the posts unless otherwise noted. The installation of all equipment, including slides, rock, and drop-downs, must be clearly marked by the customer prior to the playground installation. All playgrounds must be installed with appropriate resilient surfacing and safety zones to meet the required parameters of the latest ASTM F1487 (2014) or ASTM F 1487 (USA) version. The playground manufacturer is not responsible for the installation of the equipment. The manufacturer is responsible for the product development and improvement and transfers the right to improve, after the manufacturer's products meet specifications without notice.

***Attention:**
 No-encroachment zones that are adjacent to the outside of the safety surface area must be free of any obstacles that would impede or block safe pedestrian traffic flow around the safety surface area. No-encroachment zones that are within the safety surface area must be free of 2' clearance.

Drawn By: R.H.
 Date Drawn: October 8, 2005
 Revised By:
 Revised Date:
 Scale: See Key

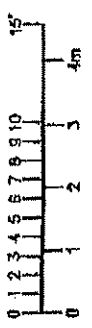

70'-0" [21.3M]

50'-0" [15.2M]

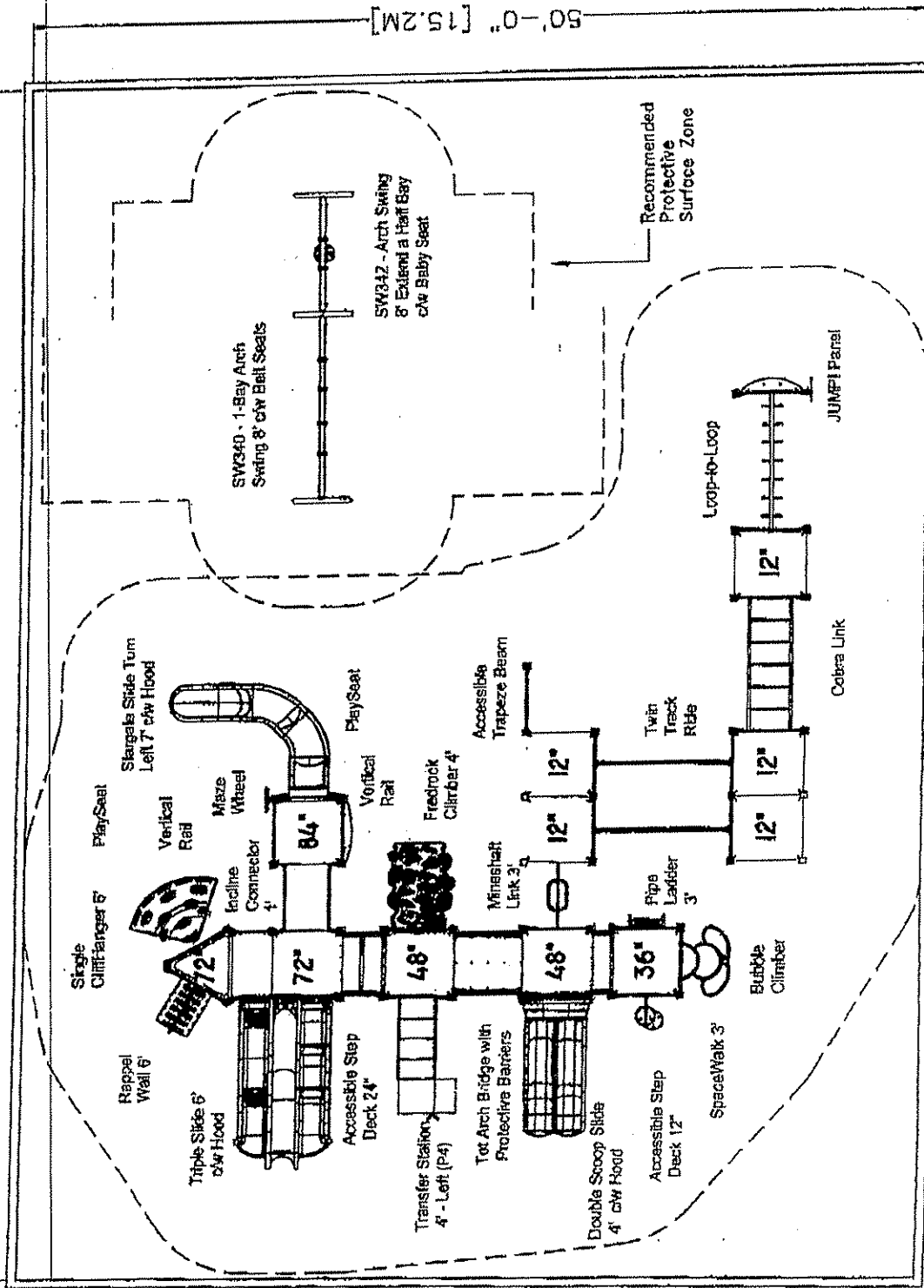

Henderson
 RECREATION EQUIPMENT MANUFACTURERS

HENDERSON RECREATION EQUIPMENT MANUFACTURERS, P.O. BOX 88, 11 HENDERSON DRIVE, SUITE 6000, GARDNER, CANADA, N0T 4B0. TOLL FREE: 1.800.363.5482. FAX: 519.426.1132. ALL RIGHTS RESERVED. THIS DRAWING IS NOT TO BE REPRODUCED IN ANY WAY WITHOUT PRIOR APPROVAL. H&E 2/2005

WVDNR209122
Cedar Creek State Park
PLAYGROUND EQUIPMENT SHEET

Please complete the below information concerning the brand(s) of equipment being bid in relation to this project. If bidding "or equal" brands, please attach manufacturer's literature documenting that it meets the mandatory requirements stated in the specifications. Vendors should note the areas of the provided manufacturer's literature that adheres to the mandatory requirements outlined in the Request For Proposal.

Item No.	Equipment	Manufacturer	Model
1	Bathhouse # 1 Area Playground Henderson custom play structure, Model #PF09679RO, or equal.		
2	Laundry/Bathhouse Area Playgrounds Henderson custom play structure, Model #PF09680RO, or equal.		
3	Bathhouse #3 Area Playground Henderson custom play structure, Model #PF09681RO, or equal.		
4	One Room School Area Playground Henderson custom play structure, Model #PF09682RO, or equal.		
5	One Room School Area Playground Area Henderson 1- bay arch wing 8' complete with belt seats, Model #SW340, or equal.		
6	One Room School Area Playground Area Henderson arch swing 8' extend a half bay complete with baby seat, Model #SW342, or equal.		
7	Playground, Laundry/Bathhouse Area Playground, Bathhouse #3 Area childforms funtimber with spike, Model #FTB-00002, or		

WVDNR209122
Cedar Creek State Park
PLAYGROUND EQUIPMENT SHEET

Item No.	Equipment	Manufacturer	Model
8	Bathhouse #1 Area Playground, Laundry/Bathhouse Area Playground, Bathhouse #3 Area childforms filter ends, Model #ADJ-00008, or equal.		
9	Playground, Laundry/Bathhouse Area Playground, Bathhouse #3 Area geo-textile fabric or		
10	Bathhouse #1 Area Playground, Laundry/Bathhouse Area Playground, Bathhouse #3 Area engineered wood fiber @ 8" compacted depth.		

All equipment bid is Henderson
As specified.

Cedar Creek State Park Playground Equipment
PRICING SHEET

Item No.	Quantity	Description	Unit Price	Amount
1	1	Bathhouse # 1 Area Playground Henderson custom play structure, Model #PF09679RO, or equal.		
2	1	Laundry/Bathhouse Area Playgrounds Henderson custom play structure, Model #PF09680RO, or equal.		
3	1	Bathhouse #3 Area Playground Henderson custom play structure, Model #PF09681RO, or equal.		
4	1	One Room School Area Playground Henderson custom play structure, Model #PF09682RO, or equal.		
5	1	One Room School Area Playground Area Henderson 1-bay arch wing 8' complete with belt seats, Model #SW340, or equal.		
6	1	One Room School Area Playground Area Henderson arch swing 8' extend a half bay complete with baby seat, Model #SW342, or equal.		
7	168	Bathhouse #1 Area Playground, Laundry/Bathhouse Area Playground, Bathhouse #3 Area childforms funtimber with spike, Model #FTB-00002, or equal.		
8	8	Bathhouse #1 Area Playground, Laundry/Bathhouse Area Playground, Bathhouse #3 Area childforms filter ends, Model #ADJ-00008, or equal.		
9	6,985 square feet	Bathhouse #1 Area Playground, Laundry/Bathhouse Area Playground, Bathhouse #3 Area geo-textile fabric or equal.		
10	6,985 square feet	Bathhouse #1 Area Playground, Laundry/Bathhouse Area Playground, Bathhouse #3 Area engineered wood fiber @ 8" compacted depth.		
			TOTAL	#69,521

State of West Virginia

VENDOR PREFERENCE CERTIFICATE

Certification and application* is hereby made for Preference in accordance with West Virginia Code, §5A-3-37. (Does not apply to construction contracts). West Virginia Code, §5A-3-37, provides an opportunity for qualifying vendors to request (at the time of bid) preference for their residency status. Such preference is an evaluation method only and will be applied only to the cost bid in accordance with the West Virginia Code. This certificate for application is to be used to request such preference. The Purchasing Division will make the determination of the Resident Vendor Preference, if applicable.

1. Application is made for 2.5% resident vendor preference for the reason checked:

- Bidder is an individual resident vendor and has resided continuously in West Virginia for four (4) years immediately preceding the date of this certification; or, Bidder is a partnership, association or corporation resident vendor and has maintained its headquarters or principal place of business continuously in West Virginia for four (4) years immediately preceding the date of this certification; or 80% of the ownership interest of Bidder is held by another individual, partnership, association or corporation resident vendor who has maintained its headquarters or principal place of business continuously in West Virginia for four (4) years immediately preceding the date of this certification; or, Bidder is a nonresident vendor which has an affiliate or subsidiary which employs a minimum of one hundred state residents and which has maintained its headquarters or principal place of business within West Virginia continuously for the four (4) years immediately preceding the date of this certification; or,

2. Application is made for 2.5% resident vendor preference for the reason checked:

Bidder is a resident vendor who certifies that, during the life of the contract, on average at least 75% of the employees working on the project being bid are residents of West Virginia who have resided in the state continuously for the two years immediately preceding submission of this bid; or,

3. Application is made for 2.5% resident vendor preference for the reason checked:

Bidder is a nonresident vendor employing a minimum of one hundred state residents or is a nonresident vendor with an affiliate or subsidiary which maintains its headquarters or principal place of business within West Virginia employing a minimum of one hundred state residents who certifies that, during the life of the contract, on average at least 75% of the employees or Bidder's affiliate's or subsidiary's employees are residents of West Virginia who have resided in the state continuously for the two years immediately preceding submission of this bid; or,

4. Application is made for 5% resident vendor preference for the reason checked:

Bidder meets either the requirement of both subdivisions (1) and (2) or subdivision (1) and (3) as stated above; or,

5. Application is made for 3.5% resident vendor preference who is a veteran for the reason checked:

Bidder is an individual resident vendor who is a veteran of the United States armed forces, the reserves or the National Guard and has resided in West Virginia continuously for the four years immediately preceding the date on which the bid is submitted; or,

6. Application is made for 3.5% resident vendor preference who is a veteran for the reason checked:

Bidder is a resident vendor who is a veteran of the United States armed forces, the reserves or the National Guard, if, for purposes of producing or distributing the commodities or completing the project which is the subject of the vendor's bid and continuously over the entire term of the project, on average at least seventy-five percent of the vendor's employees are residents of West Virginia who have resided in the state continuously for the two immediately preceding years.

Bidder understands if the Secretary of Revenue determines that a Bidder receiving preference has failed to continue to meet the requirements for such preference, the Secretary may order the Director of Purchasing to: (a) reject the bid; or (b) assess a penalty against such Bidder in an amount not to exceed 5% of the bid amount and that such penalty will be paid to the contracting agency or deducted from any unpaid balance on the contract or purchase order.

By submission of this certificate, Bidder agrees to disclose any reasonably requested information to the Purchasing Division and authorizes the Department of Revenue to disclose to the Director of Purchasing appropriate information verifying that Bidder has paid the required business taxes, provided that such information does not contain the amounts of taxes paid nor any other information deemed by the Tax Commissioner to be confidential.

Under penalty of law for false swearing (West Virginia Code, §61-5-3), Bidder hereby certifies that this certificate is true and accurate in all respects; and that if a contract is issued to Bidder and if anything contained within this certificate changes during the term of the contract, Bidder will notify the Purchasing Division in writing immediately.

Bidder: Davis Athletics, LLC Signed: Noel L Davis
Date: 4/21/09 Title: Owner

*Check any combination of preference consideration(s) indicated above, which you are entitled to receive.

RFQ No. DNR 209122STATE OF WEST VIRGINIA
Purchasing Division**PURCHASING AFFIDAVIT****VENDOR OWING A DEBT TO THE STATE:**

West Virginia Code §5A-3-10a provides that: No contract or renewal of any contract may be awarded by the state or any of its political subdivisions to any vendor or prospective vendor when the vendor or prospective vendor or a related party to the vendor or prospective vendor is a debtor and the debt owed is an amount greater than one thousand dollars in the aggregate.

PUBLIC IMPROVEMENT CONTRACTS & DRUG-FREE WORKPLACE ACT:

If this is a solicitation for a public improvement construction contract, the vendor, by its signature below, affirms that it has a written plan for a drug-free workplace policy in compliance with Article 1D, Chapter 21 of the **West Virginia Code**. The vendor **must** make said affirmation with its bid submission. Further, public improvement construction contract may not be awarded to a vendor who does not have a written plan for a drug-free workplace policy in compliance with Article 1D, Chapter 21 of the **West Virginia Code** and who has not submitted that plan to the appropriate contracting authority in timely fashion. For a vendor who is a subcontractor, compliance with Section 5, Article 1D, Chapter 21 of the **West Virginia Code** may take place before their work on the public improvement is begun.

ANTITRUST:

In submitting a bid to any agency for the state of West Virginia, the bidder offers and agrees that if the bid is accepted the bidder will convey, sell, assign or transfer to the state of West Virginia all rights, title and interest in and to all causes of action it may now or hereafter acquire under the antitrust laws of the United States and the state of West Virginia for price fixing and/or unreasonable restraints of trade relating to the particular commodities or services purchased or acquired by the state of West Virginia. Such assignment shall be made and become effective at the time the purchasing agency tenders the initial payment to the bidder.

I certify that this bid is made without prior understanding, agreement, or connection with any corporation, firm, limited liability company, partnership or person or entity submitting a bid for the same materials, supplies, equipment or services and is in all respects fair and without collusion or fraud. I further certify that I am authorized to sign the certification on behalf of the bidder or this bid.

LICENSING:

Vendors must be licensed and in good standing in accordance with any and all state and local laws and requirements by any state or local agency of West Virginia, including, but not limited to, the West Virginia Secretary of State's Office, the West Virginia Tax Department, West Virginia Insurance Commission, or any other state agencies or political subdivision. Furthermore, the vendor must provide all necessary releases to obtain information to enable the Director or spending unit to verify that the vendor is licensed and in good standing with the above entities.

CONFIDENTIALITY:

The vendor agrees that he or she will not disclose to anyone, directly or indirectly, any such personally identifiable information or other confidential information gained from the agency, unless the individual who is the subject of the information consents to the disclosure in writing or the disclosure is made pursuant to the agency's policies, procedures and rules. Vendor further agrees to comply with the Confidentiality Policies and Information Security Accountability Requirements, set forth in <http://www.state.wv.us/admin/purchase/privacy/noticeConfidentiality.pdf>.

Under penalty of law for false swearing (**West Virginia Code §61-5-3**), it is hereby certified that the vendor affirms and acknowledges the information in this affidavit and is in compliance with the requirements as stated.

Vendor's Name: Davis Athletics, LLC
Authorized Signature: Arnel J Davis Date: 4/21/09