



State of West Virginia
 Department of Administration
 Purchasing Division
 2019 Washington Street East
 Post Office Box 50130
 Charleston, WV 25305-0130

Request for Quotation

RFQ NUMBER:
BPH70354

PAGE:
1

ADDRESS CORRESPONDENCE TO ATTENTION OF:
ROBERTA WAGNER
304-558-0067

RFQ COPY

TYPE NAME/ADDRESS HERE

Western Shelter Systems
P.O. BOX 2729
Eugene, OR. 97402

SHIP TO

HEALTH AND HUMAN RESOURCES
BPH - THREAT PREPAREDNESS

505 CAPITOL STREET, SUITE 200
CHARLESTON, WV
25301 304-558-1218

DATE PRINTED	TERMS OF SALE	SHIP VIA	F.O.B.	FREIGHT TERMS		
05/01/2007	Net 30	Truck	Destination	Origin, Pre-Paid add.		
BID OPENING DATE: 05/31/2007		BID OPENING TIME 01:30PM				
LINE	QUANTITY	UOP	CAT. NO.	ITEM NUMBER	UNIT PRICE	AMOUNT
0001	1	EA		155-80	\$67,409.00	\$67,409.00
MEMBRANE SHELTER SYSTEM PER THE ATTACHED SPECS.						
SYSTEMS TO INCLUDE ALL ACCESSORIES AND ELECTRICAL POWER DISTRIBUTION AND HEATING, VENTILATION, AND AIR CONDITIONING (HVAC) EQUIPMENT, PER THE ATTACHED SPECIFICATIONS.						
CANCELLATION: THE DIRECTOR OF PURCHASING RESERVES THE RIGHT TO CANCEL THIS CONTRACT IMMEDIATELY UPON WRITTEN NOTICE TO THE VENDOR IF THE COMMODITIES AND/OR SERVICES SUPPLIED ARE OF AN INFERIOR QUALITY OR DO NOT CONFORM TO THE SPECIFICATIONS OF THE BID AND CONTRACT HEREIN.						
BANKRUPTCY: IN THE EVENT THE VENDOR/CONTRACTOR FILES FOR BANKRUPTCY PROTECTION, THIS CONTRACT IS AUTOMATICALLY NULL AND VOID, AND IS TERMINATED WITHOUT FURTHER ORDER.						
INQUIRIES WRITTEN QUESTIONS SHALL BE ACCEPTED THROUGH CLOSE OF BUSINESS ON MAY 16, 2007. QUESTIONS MAY BE SENT VIA USPS, FAX, COURIER, OR E-MAIL. IN ORDER TO ASSURE NO VENDOR RECEIVES AN UNFAIR ADVANTAGE, NO SUBSTANTIVE QUESTIONS WILL BE ANSWERED ORALLY. IF POSSIBLE, E-MAIL QUESTIONS ARE PREFERRED. ADDRESS INQUIRIES TO:						
ROBERTA WAGNER DEPARTMENT OF ADMINISTRATION PURCHASING DIVISION						

SEE REVERSE SIDE FOR TERMS AND CONDITIONS

SIGNATURE *Paul Selva* TELEPHONE *541.344.7267* DATE *5/29/07*
 TITLE *Shelter Div. MGR.* FEIN *930505268* ADDRESS CHANGES TO BE NOTED ABOVE

WHEN RESPONDING TO RFQ, INSERT NAME AND ADDRESS IN SPACE ABOVE LABELED 'VENDOR'



State of West Virginia
 Department of Administration
 Purchasing Division
 2019 Washington Street East
 Post Office Box 50130
 Charleston, WV 25305-0130

Request for Quotation

RFQ NUMBER
BPH70354

PAGE
2

ADDRESS CORRESPONDENCE TO ATTENTION OF
ROBERTA WAGNER 304-558-0067

VENDOR

RFQ COPY
 TYPE NAME/ADDRESS HERE
Western Shelter Systems
P.O. BOX 2729
Eugene, OR. 97402

SHIP TO

HEALTH AND HUMAN RESOURCES
 BPH - THREAT PREPAREDNESS
 505 CAPITOL STREET, SUITE 200
 CHARLESTON, WV 25301 304-558-1218

DATE PRINTED	TERMS OF SALE	SHIP VIA	F.O.B.	FREIGHT TERMS
05/01/2007	Net 30	Destination/Truck	Destination	Origin, Pre-paid & Add
BID OPENING DATE: 05/31/2007		BID OPENING TIME 01:30PM		

LINE	QUANTITY	UOP	CAT NO.	ITEM NUMBER	UNIT PRICE	AMOUNT
2019 WASHINGTON STREET, EAST CHARLESTON, WV 25311 FAX: 304-558-4115 E-MAIL: RWAGNER@WVADMIN.GOV						
THE MODEL/BRAND/SPECIFICATIONS NAMED HEREIN ESTABLISH THE ACCEPTABLE LEVEL OF QUALITY ONLY AND ARE NOT INTENDED TO REFLECT A PREFERENCE OR FAVOR ANY PARTICULAR BRAND OR VENDOR. VENDORS WHO ARE BIDDING ALTERNATES SHOULD SO STATE AND INCLUDE PERTINENT LITERATURE AND SPECIFICATIONS. FAILURE TO PROVIDE INFORMATION FOR ANY ALTERNATES MAY BE GROUNDS FOR REJECTION OF THE BID. THE STATE RESERVES THE RIGHT TO WAIVE MINOR IRREGULARITIES IN BIDS OR SPECIFICATIONS IN ACCORDANCE WITH SECTION 148-1-4(F) OF THE WEST VIRGINIA LEGISLATIVE RULES AND REGULATIONS.						
VENDOR PREFERENCE CERTIFICATE						
CERTIFICATION AND APPLICATION* IS HEREBY MADE FOR PREFERENCE IN ACCORDANCE WITH WEST VIRGINIA CODE, 5A-3-37 (DOES NOT APPLY TO CONSTRUCTION CONTRACTS).						
A. APPLICATION IS MADE FOR 2.5% PREFERENCE FOR THE REASON CHECKED:						
<input type="checkbox"/> BIDDER IS AN INDIVIDUAL RESIDENT VENDOR AND HAS RESIDED CONTINUOUSLY IN WEST VIRGINIA FOR FOUR (4) YEARS IMMEDIATELY PRECEDING THE DATE OF THIS CERTIFICATION; OR						
<input type="checkbox"/> BIDDER IS A PARTNERSHIP, ASSOCIATION OR CORPORA-						

SEE REVERSE SIDE FOR TERMS AND CONDITIONS

SIGNATURE <i>Paul Libs</i>	TELEPHONE 541.344.7267	DATE 5/29/07
TITLE <i>Shelter Div. MGR</i>	FEIN 930505268	ADDRESS CHANGES TO BE NOTED ABOVE

WHEN RESPONDING TO RFQ, INSERT NAME AND ADDRESS IN SPACE ABOVE LABELED 'VENDOR'



State of West Virginia
 Department of Administration
 Purchasing Division
 2019 Washington Street East
 Post Office Box 50130
 Charleston, WV 25305-0130

Request for Quotation

RFQ NUMBER
BPH70354

PAGE
3

ADDRESS CORRESPONDENCE TO ATTENTION OF:
ROBERTA WAGNER
304-558-0067

RFQ COPY

TYPE NAME/ADDRESS HERE

Western Shelter Systems
P.O. Box 2729
Eugene, OR. 97402

HEALTH AND HUMAN RESOURCES
 BPH - THREAT PREPAREDNESS

505 CAPITOL STREET, SUITE 200
 CHARLESTON, WV
 25301 304-558-1218

DATE PRINTED	TERMS OF SALE	SHIP VIA	F.O.B.	FREIGHT TERMS
05/01/2007	Net 30	Truck	Destination	Origin, Pre-land and Hold
BID OPENING DATE: 05/31/2007		BID OPENING TIME 01:30PM		

LINE	QUANTITY	UOP	CAT NO	ITEM NUMBER	UNIT PRICE	AMOUNT
<p>TION RESIDENT VENDOR AND HAS MAINTAINED ITS HEAD- QUARTERS OR PRINCIPAL PLACE OF BUSINESS CONTINUOUSLY IN WEST VIRGINIA FOR FOUR (4) YEARS IMMEDIATELY PRECEDING THE DATE OF THIS CERTIFICATION; OR 80% OF THE OWNERSHIP INTEREST OF BIDDER IS HELD BY ANOTHER INDIVIDUAL, PARTNERSHIP, ASSOCIATION OR CORPORATION VENDOR WHO HAS MAINTAINED ITS HEADQUARTERS OR PRINCIPAL PLACE OF BUSINESS CONTINUOUSLY IN WEST VIRGINIA FOR FOUR (4) YEARS IMMEDIATELY PRECEDING THE DATE OF THIS CERTIFICATION; OR</p> <p>() BIDDER IS A CORPORATION NONRESIDENT VENDOR WHICH HAS AN AFFILIATE OR SUBSIDIARY WHICH EMPLOYS A MINIMUM OF ONE HUNDRED STATE RESIDENTS AND WHICH HAS MAINTAINED ITS HEADQUARTERS OR PRINCIPAL PLACE OF BUSINESS WITHIN WEST VIRGINIA CONTINUOUSLY FOR THE FOUR (4) YEARS IMMEDIATELY PRECEDING THE DATE OF THIS CERTIFICATION.</p> <p>B. APPLICATION IS MADE FOR 2.5% PREFERENCE FOR THE REASON CHECKED:</p> <p>() BIDDER IS A RESIDENT VENDOR WHO CERTIFIES THAT, DURING THE LIFE OF THE CONTRACT, ON AVERAGE AT LEAST 75% OF THE EMPLOYEES WORKING ON THE PROJECT BEING BID ARE RESIDENTS OF WEST VIRGINIA WHO HAVE RESIDED IN THE STATE CONTINUOUSLY FOR THE TWO YEARS IMMEDIATELY PRECEDING SUBMISSION OF THIS BID; OR</p> <p>() BIDDER IS A NONRESIDENT VENDOR EMPLOYING A MINIMUM OF ONE HUNDRED STATE RESIDENTS OR IS A NONRESIDENT VENDOR WITH AN AFFILIATE OR SUBSIDIARY WHICH MAINTAINS ITS HEADQUARTERS OR PRINCIPAL PLACE OF BUSINESS WITHIN WEST VIRGINIA EMPLOYING A MINIMUM OF ONE HUNDRED STATE RESIDENTS WHO CERTIFIES THAT, DURING THE LIFE OF THE CONTRACT, ON AVERAGE AT LEAST</p>						

SEE REVERSE SIDE FOR TERMS AND CONDITIONS

SIGNATURE <i>Paul Lingo</i>	TELEPHONE 541.344.7267	DATE 5/29/07
TITLE <i>Shelter Div. MGR</i>	FEIN 930505268	ADDRESS CHANGES TO BE NOTED ABOVE

WHEN RESPONDING TO RFQ, INSERT NAME AND ADDRESS IN SPACE ABOVE LABELED 'VENDOR'



State of West Virginia
 Department of Administration
 Purchasing Division
 2019 Washington Street East
 Post Office Box 50130
 Charleston, WV 25305-0130

Request for Quotation.

RFQ NUMBER
BPH70354

PAGE
4

ADDRESS CORRESPONDENCE TO ATTENTION OF:
ROBERTA WAGNER
304-558-0067

VENDOR

RFQ COPY
 TYPE NAME/ADDRESS HERE
Western Shelter Systems
P.O. BOX 2729
Eugene, OR. 97402

SHIP TO

HEALTH AND HUMAN RESOURCES
BPH - THREAT PREPAREDNESS

505 CAPITOL STREET, SUITE 200
CHARLESTON, WV
25301 304-558-1218

DATE PRINTED 05/01/2007	TERMS OF SALE Net 30	SHIP VIA Truck	F.O.B. Destination	FREIGHT TERMS Origin, Pre-Paid & Held
-----------------------------------	--------------------------------	--------------------------	------------------------------	---

BID OPENING DATE: **05/31/2007** BID OPENING TIME: **01:30PM**

LINE	QUANTITY	UOP	CAT NO	ITEM NUMBER	UNIT PRICE	AMOUNT
<p>75% OF THE EMPLOYEES OR BIDDERS' AFFILIATE'S OR SUBSIDIARY'S EMPLOYEES ARE RESIDENTS OF WEST VIRGINIA WHO HAVE RESIDED IN THE STATE CONTINUOUSLY FOR THE TWO YEARS IMMEDIATELY PRECEDING SUBMISSION OF THIS BID.</p> <p>BIDDER UNDERSTANDS IF THE SECRETARY OF TAX & REVENUE DETERMINES THAT A BIDDER RECEIVING PREFERENCE HAS FAILED TO CONTINUE TO MEET THE REQUIREMENTS FOR SUCH PREFERENCE, THE SECRETARY MAY ORDER THE DIRECTOR OF PURCHASING TO: (A) RESCIND THE CONTRACT OR PURCHASE ORDER ISSUED; OR (B) ASSESS A PENALTY AGAINST SUCH BIDDER IN AN AMOUNT NOT TO EXCEED 5% OF THE BID AMOUNT AND THAT SUCH PENALTY WILL BE PAID TO THE CONTRACTING AGENCY OR DEDUCTED FROM ANY UNPAID BALANCE ON THE CONTRACT OR PURCHASE ORDER.</p> <p>BY SUBMISSION OF THIS CERTIFICATE, BIDDER AGREES TO DISCLOSE ANY REASONABLY REQUESTED INFORMATION TO THE PURCHASING DIVISION AND AUTHORIZES THE DEPARTMENT OF TAX AND REVENUE TO DISCLOSE TO THE DIRECTOR OF PURCHASING APPROPRIATE INFORMATION VERIFYING THAT BIDDER HAS PAID THE REQUIRED BUSINESS TAXES, PROVIDED THAT SUCH INFORMATION DOES NOT CONTAIN THE AMOUNTS OF TAXES PAID NOR ANY OTHER INFORMATION DEEMED BY THE TAX COMMISSIONER TO BE CONFIDENTIAL.</p> <p>UNDER PENALTY OF LAW FOR FALSE SWEARING (WEST VIRGINIA CODE 61-5-3), BIDDER HEREBY CERTIFIES THAT THIS CERTIFICATE IS TRUE AND ACCURATE IN ALL RESPECTS; AND THAT IF A CONTRACT IS ISSUED TO BIDDER AND IF ANYTHING CONTAINED WITHIN THIS CERTIFICATE CHANGES DURING THE TERM OF THE CONTRACT, BIDDER WILL NOTIFY THE PURCHASING DIVISION IN WRITING IMMEDIATELY.</p> <p style="text-align: right;">BIDDER: <i>Western Shelter Systems</i></p>						

SEE REVERSE SIDE FOR TERMS AND CONDITIONS			
SIGNATURE <i>Paul Selig</i>	TELEPHONE 541.344.7267	DATE 5/29/07	
TITLE <i>Shelter Div. MGR</i>	FEIN 930505268	ADDRESS CHANGES TO BE NOTED ABOVE	

WHEN RESPONDING TO RFQ, INSERT NAME AND ADDRESS IN SPACE ABOVE LABELED 'VENDOR'



State of West Virginia
 Department of Administration
 Purchasing Division
 2019 Washington Street East
 Post Office Box 50130
 Charleston, WV 25305-0130

Request for Quotation

RFQ NUMBER
BPH70354

PAGE
4

ADDRESS CORRESPONDENCE TO ATTENTION OF
**ROBERTA WAGNER
 304-558-0067**

RFQ COPY
 TYPE NAME/ADDRESS HERE
*Western Shelter Systems
 P.O. BOX 2729
 Eugene, OR. 97402*

HEALTH AND HUMAN RESOURCES
 BPH - THREAT PREPAREDNESS
 505 CAPITOL STREET, SUITE 200
 CHARLESTON, WV
 25301 304-558-1218

DATE PRINTED 05/01/2007	TERMS OF SALE Net 30	SHIP VIA Truck	F.O.B. Destination	FREIGHT TERMS Origin, Pre-Paid & Hold
BID OPENING DATE: 05/31/2007		BID OPENING TIME 01:30PM		

LINE	QUANTITY	UOP	CAT NO	ITEM NUMBER	UNIT PRICE	AMOUNT
<p>75% OF THE EMPLOYEES OR BIDDERS' AFFILIATE'S OR SUBSIDIARY'S EMPLOYEES ARE RESIDENTS OF WEST VIRGINIA WHO HAVE RESIDED IN THE STATE CONTINUOUSLY FOR THE TWO YEARS IMMEDIATELY PRECEDING SUBMISSION OF THIS BID.</p> <p>BIDDER UNDERSTANDS IF THE SECRETARY OF TAX & REVENUE DETERMINES THAT A BIDDER RECEIVING PREFERENCE HAS FAILED TO CONTINUE TO MEET THE REQUIREMENTS FOR SUCH PREFERENCE, THE SECRETARY MAY ORDER THE DIRECTOR OF PURCHASING TO: (A) RESCIND THE CONTRACT OR PURCHASE ORDER ISSUED; OR (B) ASSESS A PENALTY AGAINST SUCH BIDDER IN AN AMOUNT NOT TO EXCEED 5% OF THE BID AMOUNT AND THAT SUCH PENALTY WILL BE PAID TO THE CONTRACTING AGENCY OR DEDUCTED FROM ANY UNPAID BALANCE ON THE CONTRACT OR PURCHASE ORDER.</p> <p>BY SUBMISSION OF THIS CERTIFICATE, BIDDER AGREES TO DISCLOSE ANY REASONABLY REQUESTED INFORMATION TO THE PURCHASING DIVISION AND AUTHORIZES THE DEPARTMENT OF TAX AND REVENUE TO DISCLOSE TO THE DIRECTOR OF PURCHASING APPROPRIATE INFORMATION VERIFYING THAT BIDDER HAS PAID THE REQUIRED BUSINESS TAXES, PROVIDED THAT SUCH INFORMATION DOES NOT CONTAIN THE AMOUNTS OF TAXES PAID NOR ANY OTHER INFORMATION DEEMED BY THE TAX COMMISSIONER TO BE CONFIDENTIAL.</p> <p>UNDER PENALTY OF LAW FOR FALSE SWEARING (WEST VIRGINIA CODE 61-5-3), BIDDER HEREBY CERTIFIES THAT THIS CERTIFICATE IS TRUE AND ACCURATE IN ALL RESPECTS; AND THAT IF A CONTRACT IS ISSUED TO BIDDER AND IF ANYTHING CONTAINED WITHIN THIS CERTIFICATE CHANGES DURING THE TERM OF THE CONTRACT, BIDDER WILL NOTIFY THE PURCHASING DIVISION IN WRITING IMMEDIATELY.</p> <p>BIDDER: <i>Western Shelter Systems</i></p>						

SEE REVERSE SIDE FOR TERMS AND CONDITIONS

SIGNATURE <i>Paul Shins</i>	TELEPHONE 541.344.7267	DATE 5/29/07
TITLE <i>Shelter Div. MGR</i>	FEIN 930505268	ADDRESS CHANGES TO BE NOTED ABOVE

WHEN RESPONDING TO RFQ, INSERT NAME AND ADDRESS IN SPACE ABOVE LABELED 'VENDOR'



State of West Virginia
 Department of Administration
 Purchasing Division
 2019 Washington Street East
 Post Office Box 50130
 Charleston, WV 25305-0130

Request for Quotation

RFQ NUMBER
BPH70354

PAGE
6

ADDRESS CORRESPONDENCE TO ATTENTION OF
**ROBERTA WAGNER
 304-558-0067**

RFQ COPY
 TYPE NAME/ADDRESS HERE

V
E
N
D
O
R

S
H
I
P
T
O

**HEALTH AND HUMAN RESOURCES
 BPH - THREAT PREPAREDNESS
 505 CAPITOL STREET, SUITE 200
 CHARLESTON, WV
 25301 304-558-1218**

DATE PRINTED 05/01/2007	TERMS OF SALE Net 30	SHIP VIA Truck	F.O.B. Destination	FREIGHT TERMS Origin, Pre-Paid's Add
BID OPENING DATE: 05/31/2007		BID OPENING TIME 01:30PM		

LINE	QUANTITY	UOP	CAT NO	ITEM NUMBER	UNIT PRICE	AMOUNT
RFQ. NO.: --- BPH70354 ---						
BID OPENING DATE: --- MAY 31, 2007 ---						
BID OPENING TIME: --- 1:30 PM ---						
PLEASE PROVIDE A FAX NUMBER IN CASE IT IS NECESSARY TO CONTACT YOU REGARDING YOUR BID: 541.284.2820						
CONTACT PERSON (PLEASE PRINT CLEARLY): PAUL SILVA						
***** THIS IS THE END OF RFQ BPH70354 ***** TOTAL:						\$167,409.00

SEE REVERSE SIDE FOR TERMS AND CONDITIONS

SIGNATURE **Paul Silva** TELEPHONE **541.344.7267** DATE **5/29/07**

TITLE **Shelter Div. Mgr** FEIN **930505268** ADDRESS CHANGES TO BE NOTED ABOVE

WHEN RESPONDING TO RFQ, INSERT NAME AND ADDRESS IN SPACE ABOVE LABELED 'VENDOR'

“SPECIFICATIONS”

RFQ: BPH70354

The West Virginia Office of Emergency Medical Services, a Division of the West Virginia Department of Health and Human Resources, Bureau for Public Health, is soliciting bids for the purchase of **one (1) membrane shelter system** (with a width of no less than 18 feet and no greater than 20 feet and a length of no less than 32 feet and no greater than 40 feet) to include all accessories and electrical power distribution and heating, ventilation, and air conditioning (HVAC) equipment.

Requirements:

- **QUANTITIES:** The State will purchase one (1) shelter system as specified.
- **PRICE:** Bid price shall include all costs related to the purchase and delivery of the system, required components to the F.O.B. Destination, and required on-site training.
- **DELIVERY DATE:** Delivery at the final destination is requested within thirty (30) calendar days After Receipt of Order (ARO).
- **DAMAGE/SHIPPING CLAIMS:** Damage to items in transit is the sole responsibility of the Contractor. The Contractor is obligated to file any claims against carrier(s) for any damage incurred while in transit from point of origin to the ultimate destination.
- **GUARANTEE:** All items shall be guaranteed against faulty material and workmanship. All standard items shown in the manufacturer's published specifications for the units proposed is to be supplied as a result of this bid specification.
- **ACCEPTANCE:** Failure of the shelter systems to meet the required specifications or to operate properly in any way will require replacement or repair by Contractor at no expense to the State of West Virginia. Acceptance of the items by the State of West Virginia does not warrant that the items are in perfect working order. The terms of the stipulated Contractor warranty will continue to apply from the date of acceptance.
- **BRAND/MODEL SPECIFIED:** Western Shelter Gatekeeper I (GKI) or equal.
- **OR EQUAL:** When a specific brand/model and the words **or equal** is specified, the intention is to indicate and guarantee a quality level, but not to limit other brands/models. **If a bidder requests approval for an equivalent to the brand/model name specified, the bidder must**

describe their justification in writing and submit with their proposal. Bidders shall justify how the brand/model offered is equivalent to the quality level of the brand/model specified by the State of West Virginia. Failure of the bidder to describe their justification and quality level of the brand/model offered will be grounds to reject the bid as non-responsive. The State of West Virginia has the sole judgment to determine approval or non-approval of a request for an equivalent to the brand specified. A bid will be rejected if the requested equivalent is not equal to or better than the system specified.

- **MANUALS:** Contractor shall supply product manuals at time of delivery that describe setup, operation, and service instructions.
- **PARTS, ACCESSORIES, AND OPTIONAL EQUIPMENT:** As part of any response hereto, the successful bidder shall be required to supply a complete listing (i.e. catalog) of other parts, options, upgrades, replacement parts, and accessories with pricing. Discounts, if applicable, must also be clearly indicated.
- **TRAINING:** Bid price shall include Contractor-provided on-site training in Charleston, West Virginia to include product information, shelter erection and strike, power distribution and HVAC systems.
- **WARRANTY:** Product parts and labor shall be warranted for a **minimum** of one (1) year after delivery and acceptance by the State of West Virginia. Successful bidder shall be required to submit warranty information prior to award.
- **PARTS AVAILABILITY:** The manufacturer **must** guarantee parts availability for a **minimum** of five (5) years.
- **MULTIPLE USES:** Shelter system shall have the ability to be used in a wide variety of configurations as dictated by the situation. Anticipated uses for the shelter include but are not limited to: command post, triage center, staging check-in, medical surge capacity, point of distribution site, mass care, and DMAT/DMORT (Disaster Medical Assistance Teams/Disaster Mortuary Teams) activities.
- **SHELTER COMPONENTS:** One (1) single stand-alone shelter with a width of 18-20 feet and a length of 32-40 feet. Shelter shall have ability to be connected to other shelters, without modification, via vestibule to form larger shelters.
 - Shall include rigid light weight frame constructed of 6063-T5 and 6061-T6 alloys with clear industrial anodized support members.

"SPECIFICATIONS"

009

- The exterior shall be durable cover material of at least 14 oz. thermo-welded vinyl with ultraviolet ray and mildew inhibitors and shall meet NFPA-701 standards for fire resistance.
 - Roof trusses shall be of a telescoping nature to minimize packaging.
 - Eave bars and base bars shall lock and unlock into the mainframe with integral spring loaded buttons requiring no tools for assembly.
 - Eave bars and base bars shall have a clear anodized finish. Eave bars shall be of an extruded design to accommodate rigid hook and loop-type strips for the attachment of roof and sidewalls.
 - Upright legs shall lock either up or down with captive locking aluminum pins. Legs shall have a flat foot with provisions for securing to the ground or floor surface. Leg length shall be sufficient to ensure the shelter has a minimum of a full 6-foot vertical sidewall.
 - Shall include one (1) aluminum-framed, fabric covered double doors with a minimum 44-inch width.
 - Shall include one (1) aluminum vent cap system.
 - A minimum of eight (8) clear-view windows (32-38 inches x 32-38 inches) that are fully screened with privacy flaps shall be installed.
 - Shall be equipped with an integral self-sealing floor system using overlapping fabric with hook and loop fasteners.
 - Insulated roof panel shall be thermo-welded to ensure against leakage shall be included.
 - A minimum of two (2) 12" HVAC duct receivers with two (2) 12inch x 20ft duct boots shall be installed.
 - A minimum of six (6) fluorescent lights with dimmer sleeves, internal 110V electrical wiring harness and GFCI (ground-fault circuit interrupter)-protected modular daisy-chained together with outlet boxes (containing a minimum of two (2) outlets) every eight (8) feet shall be included.
 - One (1) high wind tie down bracket and stake kit with pouches shall be supplied.
 - Appropriate travel cases shall be included.
 - One (1) vinyl repair kit shall be supplied.
- **ELECTRICAL POWER AND DISTRUBUTION:** shall consist of:
 - One (1) generator of no less than 36kW (up to 480V) diesel-fueled, with a noise-signature of no more than 65dB(A) at 25 feet with a fuel tank of no less than twenty-five (25) gallons. The generator shall be equipped with one (1) high-amp breaker panel. The generator is to be trailer-mounted with an additional fuel tank of no less than fifty (50) gallons. The trailer shall be equipped with 2" ball hitch and electrical brakes.
 - One (1) 50 Amp power distribution box for use between high-amp power distribution panel and internal shelter wiring harness.

Distribution box must include a minimum of the following circuits:
six (6) 20-amp 120V GFCI-protected outlets, one (1) 20-amp 240V
GFCI-protected outlet, and one (1) 50 amp, 240 volt feed-through.

- One (1) 240V power cable of no less than 50 feet.
 - One (1) 110V power cable of no less than 50 feet.
 - One (1) storage case for power distribution system.
- **CLIMATE CONTROL:** A self-contained and portable HVAC system is to be included with the shelter. The system shall:
 - Be capable of providing a minimum of 3.5 tons of cooling and 42,000 BTU/hr. of heating and include a supplemental 27,000 BTU/hr heat strip.
 - Be UL listed for outdoor use and rated at 230V, single-phase power.
 - Include two (2) 20' ducts, one (1) intake boot, and one (1) discharge boot.
 - Include one (1) full-framed, wheeled transport cart with vinyl cover.
 - **EASE OF SETUP:** Shelter system must be able to be erected in remote areas without use of specialized equipment, ladders or tools, with no more than four (4) people in less than 90 minutes.
 - **COMPATIBILITY WITH FEMA EQUIPMENT:** Shelter system must include vestibules which will allow positive connections to FEMA (Federal Emergency Management) and the National Disaster Medical System's DMAT and DMORT shelters without compromising isolation capabilities.
 - **ALL WEATHER CAPABLE:** Shelter system must have proven record to withstand 50 mph sustained wind loads, 6" snow loads, heavy rain (2" per hour), and cold temperature extremes to -30F without compromising structure of effectiveness or primary mission.
 - **SELF-CONTAINED:** Shelter system must be self-contained in regards to electrical and HVAC.

COST EVALUATION SHEET FOR RFQ BPH70354

Description	Quantity	Unit Cost	Total Cost
Stand-alone membrane shelter system.	1	\$ 24,031.00	24,031.00
36KW (up to 480V) diesel-fueled	1	\$ 31,628.00	31,628.00
50 Amp power distribution box	1	\$ 820.00	820.00
50ft 240V power cable	1	\$ 746.00	746.00
50ft 110V power cable	1	\$ 38.00	38.00
storage case for power distribution system	1	\$ 846.00	846.00
self-contained and portable HVAC system	1	\$ 7330.00	7330.00
Freight		\$ 1970.00	1970.00
GRAND TOTAL:			\$ 67,409.00

STATE OF WEST VIRGINIA
Purchasing Division012**PURCHASING AFFIDAVIT**

West Virginia Code §5A-3-10a states: No contract or renewal of any contract may be awarded by the state or any of its political subdivisions to any vendor or prospective vendor when the vendor or prospective vendor or a related party to the vendor or prospective vendor is a debtor and the debt owned is an amount greater than one thousand dollars in the aggregate

DEFINITIONS:

"Debt" means any assessment, premium, penalty, fine, tax or other amount of money owed to the state or any of its political subdivisions because of a judgment, fine, permit violation, license assessment, defaulted workers' compensation premium, penalty or other assessment presently delinquent or due and required to be paid to the state or any of its political subdivisions, including any interest or additional penalties accrued thereon.

"Debtor" means any individual, corporation, partnership, association, limited liability company or any other form or business association owing a debt to the state or any of its political subdivisions. "Political subdivision" means any county commission; municipality; county board of education; any instrumentality established by a county or municipality; any separate corporation or instrumentality established by one or more counties or municipalities, as permitted by law; or any public body charged by law with the performance of a government function or whose jurisdiction is coextensive with one or more counties or municipalities. "Related party" means a party, whether an individual, corporation, partnership, association, limited liability company or any other form or business association or other entity whatsoever, related to any vendor by blood, marriage, ownership or contract through which the party has a relationship of ownership or other interest with the vendor so that the party will actually or by effect receive or control a portion of the benefit, profit or other consideration from performance of a vendor contract with the party receiving an amount that meets or exceed five percent of the total contract amount.

EXCEPTION: The prohibition of this section does not apply where a vendor has contested any tax administered pursuant to chapter eleven of this code, workers' compensation premium, permit fee or environmental fee or assessment and the matter has not become final or where the vendor has entered into a payment plan or agreement and the vendor is not in default of any of the provisions of such plan or agreement.

LICENSING: Vendors must be licensed and in good standing in accordance with any and all state and local laws and requirements by any state or local agency of West Virginia, including, but not limited to, the West Virginia Secretary of State's Office, the West Virginia Tax Department, West Virginia Insurance Commission, or any other state agencies or political subdivision. Furthermore, the vendor must provide all necessary releases to obtain information to enable the Director or spending unit to verify that the vendor is licensed and in good standing with the above entities.

CONFIDENTIALITY: The vendor agrees that he or she will not disclose to anyone, directly or indirectly, any such personally identifiable information or other confidential information gained from the agency, unless the individual who is the subject of the information consents to the disclosure in writing or the disclosure is made pursuant to the agency's policies, procedures and rules. Vendors should visit www.state.wv.us/admin/purchase/privacy for the Notice of Agency Confidentiality Policies.

Under penalty of law for false swearing (West Virginia Code, §61-5-3), it is hereby certified that the vendor acknowledges the information in this said affidavit and are in compliance with the requirements as stated.

Vendor's Name: Western Shelter Systems
 Authorized Signature: Paul Dilio Date: 5/29/07

	A	B	C	D	E	F	G	H
1	PART NUMBER	QNTY	DESCRIPTION	UNIT PRICE	GSA ITEM	EXTENDED PRICE	UNIT WEIGHT-lbs†	EXTENDED WEIGHT-lbs†
2	WESTERN SHELTER SYSTEMS			BID				
3	An ISO 9001 Registered Company. Visit at www.westernshelter.com			BID # T052207MO Date: 5/22/07				
4	Mailing Address: P.O. Box 2729			Quoted by: Mike Ottaway				
5	Shipping Address: 830 Wilson Street							
6	Eugene, Oregon 97402 USA							
7	Telephone: 1-541-344-7267 • Toll-Free: 1-800-971-7201 • Fax: 1-541-284-2820							
8								
9	QUOTATION FOR:			SHIP TO (for freight estimate):				
10	State of West Virginia			25301				
11	Department of Health and Human Resources / Threat Preparedness							
12	505 Capital St. Suite 200							
13	Charleston, WV 25301							
14	RFQ NUMBER: BPH70354							
15	CUSTOMER CONTACT: Roberta Wagner 304-558-0067							
16	CURRENT DELIVERY ESTIMATE ARO: 30 days							
17	TERMS: FOB Destination. Net Payment: 30 Days.							
18	Job Description: Brand Specific Western Shelter GateKeeper I - 1935 with self contained electrical power and HVAC. Purpose: Design a mobile Triage/Treatment center that can also be used as Command and Control, Staging, Point of Distribution, etc - needs to be interoperable with FEMA/DHHS Response Teams.							
19								
20	GATEKEEPER SHELTER SYSTEMS							
21	NOTE: All GateKeeper Shelters Systems are pre-packaged with the essential components required to support emergency medical field operations. If the pre-packaged GateKeeper system does not meet your needs, we recommend selecting your components from the Western Shelter product line.							
21	- All GateKeeper and Western Shelters are interoperable with FEMA USAR and NDMs DMAT shelters, as well as most state and local disaster response agency shelters. Western Shelter Systems has been the primary supplier of shelters for FEMA since 1992.							
21	- All GateKeeper systems come complete with rigid aluminum frame, insulated roof with vent cap, wall panels with fully-screened windows with privacy flaps, and Easy-Sealing floor. Double doors with threshold ramps and a Work Station desk set are standard.							
21	- Each GateKeeper is equipped with an interior 110V electrical wiring harness and in-line all-weather lights with Dimmer Sleeves™. Multiple shelter complexes also include electrical distribution kits.							
21	- Each GateKeeper includes it's own Vestibule Connector Kit to enable it to be connected to another GateKeeper or Western Shelter.							
21	- Storage/transport field bags for all pieces, high-wind tie-down stake kits, and vinyl repair kits are standard.							
21	- Optional equipment includes upgrade components for air pressure isolation, add-on 8'x8' entryways, hygiene centers, HVAC and heaters, generators, showers, personal hygiene, decontamination, storage and transport cases, and storage trailers with Command Centers.							
22	PART NUMBER	QNTY	DESCRIPTION	UNIT PRICE	GSA ITEM	EXTENDED PRICE	UNIT WEIGHT-lbs†	EXTENDED WEIGHT-lbs†
23	GK1-1935	1	GATEKEEPER I-1935 EMERGENCY MEDICAL FACILITY is a pre-packaged, portable medical facility consisting of one 19x35-foot diameter, octagonal shelter, which can be connected to other shelters by a Vestibule to form a larger facility. A "mud-room" entryway can also be added. Logistical support equipment to operate and support the facility is included in the package price. Optional equipment, including air pressure isolation, is recommended based on your specific location and application requirements.	\$ 17,456		\$ 17,456	793	793
24								
25	GK-1935	1	Stretched-Octagon Shelter - rigid-frame, 19'x35'x6' (wall height), 570 sq. ft. usable floor space, two aluminum roof vent caps. 36"x36" fully-screened windows with interior privacy flaps	Included				
26	HS1935-MFS	1	Main Frame Assembly - minus Eave Bars (EB20) & Base Bars (BB20)	Included				
27	EB20	12	Eave Bars - upper aluminum bars with black loop connection strip	Included				
28	BB20	12	Base Bars - lower aluminum bars	Included				
29	WC6	2	Vent Cap - standard non-closing	Included				
30	GK-DO	2	46" double doorways	Included				
31	K1935-LDS-2-B	2	Vinyl Wall Panel - Left of door	Included				
32	K1935-RDS-2-A	2	Vinyl Wall Panel - Right of door	Included				
33	HS1935-RP	1	Vinyl Roof Panel	Included				
34	FL-GK1935	1	Flooring system - Easy-Sealing	Included				
35	IN-GK1935RP	1	Roof insulation	Included				
36	WS-TR46GK	2	Threshold Ramp - 46", GateKeeper	Included				
37	WS-WRKGK20	4	Wiring Harnesses - 110V interior	Included				

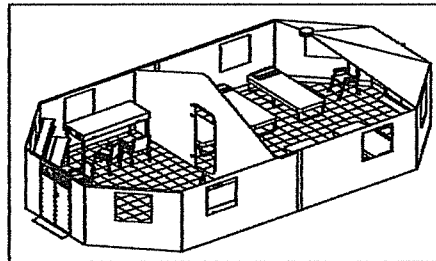

	A	B	C	D	E	F	G	H
	PART NUMBER	QNTY	DESCRIPTION	UNIT PRICE	GSA ITEM	EXTENDED PRICE	UNIT WEIGHT-lbs†	EXTENDED WEIGHT-lbs†
22								
84								
85	RECOMMENDED							
86	WS-20AP	1	Air Plenum - HO/GK20 shelter series	\$ 565		\$ 565	4	4
87								
88	IN-GK1935-WP	1	Insulation - GK1935, Wall Panels Only	\$ 1,014		\$ 1,014	76	76
89								
90				TOTAL		\$ 65,439	TOTAL	5,208
91			FREIGHT PRE-PAID AND ADD CHARGES TO INVOICE :			\$ 1,970		
92			TOTAL GATEKEEPER SYSTEM			\$ 67,409		
93	NOTES: Availability of parts for the system are guaranteed for 5 years.							
94	1. This is a quotation. Items added or deleted in final specification may result in re-quotation.							
95	2. Position in the production schedule is not reserved until acceptance of valid Purchase Order.							
96	3. Freight estimates and charges based on FOB Eugene, Oregon 97402 unless otherwise specified.							
97	4. Oregon has no sales tax.							
98	5. Prices quoted are effective for 60 days from date of quotation.							
99	6. Verbal Purchase Orders will not be accepted.							
100	7. Western Shelter Systems warrants all products against defects and workmanship for a period of one year from date of manufacture.							
101	†All weights are approximate.							
102	* GSA contract items available under GSA contract #GS-07F-8700C.							
103	Quotation by:	Mike Ottaway						
104		Western Shelter Systems						
105		513-349-9802						
106		Tel: 1-800-971-7201 Fax: 1-541-284-2820						
107		Email: mottaway@WesternShelter.com						



DCA45SSIU3 WhisperWatt Generator

WhisperWatt™ 45

Prime Rating: 36 kW (45 kVA)

Standby Rating: 37.8 kW (47.3 kVA)

60 Hertz

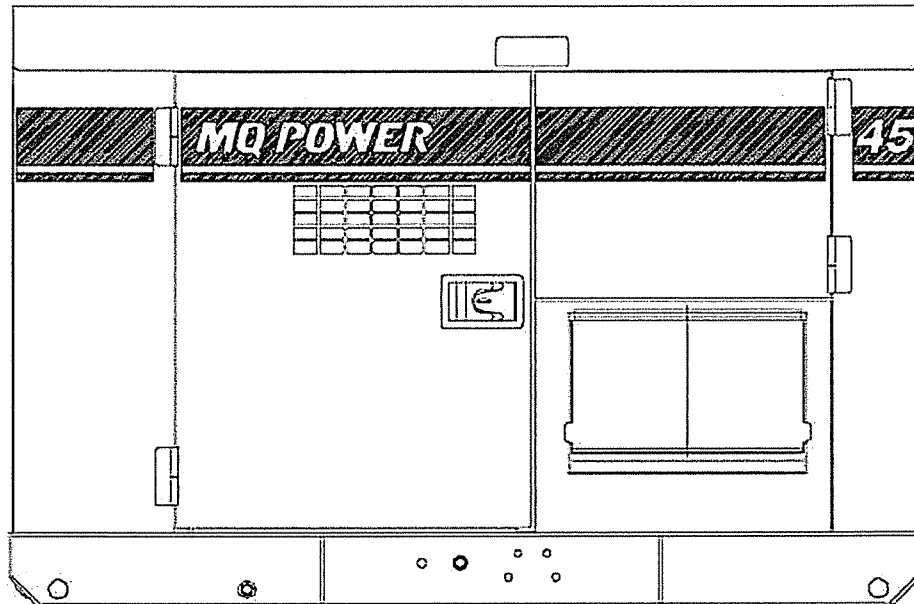

WhisperWatt™ Standard Features

- **Heavy duty, 4-cycle, diesel engine** provides maximum reliability.
- **Brushless alternator** reduces service and maintenance requirements and meets temperature rise standards for Class F insulation systems.
- **Open delta alternator design** provides virtually unlimited excitation for maximum motor starting capability.
- **Automatic voltage regulator (AVR)** provides precise regulation.
- **Full load acceptance** of standby nameplate rating in one step (NFPA 110, para 5-13.2.6).
- **Sound attenuated, weather resistant, steel housing** provides operation at 65 dB(A) at 23 feet. Fully lockable enclosure allows safe unattended operation.
- **Internal fuel tank** with direct reading fuel gauges are standard.
- **Seven-stage powder coat paint** provides durability and weather protection.
- **EPA-MOH emissions certified** - Tier 2 emissions compliant.
- **Complete engine analog instrumentation** includes DC ammeter, oil pressure gauge, water temp. gauge, fuel level gauge, tachometer/hour meter, preheat indicator, emergency shutdown monitors, and keyed start switch.
- **Complete generator analog instrumentation** includes voltage regulator control, ammeter phase selector switch, voltmeter phase selector switch, AC voltmeter, AC ammeter, frequency meter, panel light, and circuit breaker.
- **Automatic safety shutdown system** monitors the engine oil pressure and water temperature. Warning lights indicate abnormal conditions.
- **Complete power panel.** Fully covered; three-phase terminals and single phase receptacles allow fast and convenient hookup for most applications including temporary power boxes, tools and lighting equipment. All are NEMA standard.
- **Simultaneous single and three phase power.**
- **Voltage selector switch** allows easy to change voltages as your applications require.
- **Fuel / water separator** removes condensation from fuel for extended engine life. Panel mounted alarm light included.



DCA45SSIU3 WhisperWatt Generator

Specifications

Generator	
Design	Revolving field, self-ventilated drip-proof, single bearing
No. of Poles	4-pole
Excitation	Brushless with AVR
Standby Output	37.8 KW (47.3 KVA)
Prime Output	36 KW (45 KVA)
Generator RPM	1800
Voltage — 3Ø	208, 220, 240, 416, 440, 480V Switchable
Voltage — 1Ø	120, 127, 139, 240, 254, 277V Switchable
Armature Connection	Star with neutral / Zig Zag
Voltage Regulation (No load to full load)	±1.0%
Power Factor	0.8
Frequency	60 Hz
Frequency Regulation: No Load to Full Load	3-5% under varying loads from no load to 100% rated Load
Frequency Regulation: Steady State	±0.5% of mean value for constant loads from no load to full load
Insulation	Class F
Sound Level dB(A) Full load at 23 feet	65

Engine	
Make / Model	Isuzu / BB-4JG1T
Emissions	EPA Tier 2 Certified
Starting System	Electric
Design	4-cycle, water cooled, direct injection, turbocharged
Displacement	186.7 in ³ (3059 cc)
No. cylinders	4
Bore x Stroke (mm)	95.4 x 107
Gross Engine Power Output	64.8 hp (48.3 kW)
BMEP	134 psi (924 kPa)
Piston Speed	1264 ft./min. (6.42 m/s)
Compression Ratio	18 : 1
Engine Speed	1800 rpm
Overspeed Limit	2100 rpm
Oil Capacity	2.64 gallons (10.0 liters)
Battery	12V 72Ah x 1

Fuel		
Maximum Fuel Flow (per hour)	11.9 gallons (45.2 liters)	
Maximum Inlet Restriction (Hg)	2.39 in. (60.8 mm)	
Fuel Tank Capacity	26.4 gallons (100.0 liters)	
Fuel Consumption	gph	lph
At full load	2.98	11.30
At 3/4 load	2.25	8.52
At 1/2 load	1.65	6.24
At 1/4 load	1.09	4.12

Cooling	
Fan Load	0.94 HP (0.7 KW)
Coolant Capacity (with radiator)	2.88 gallons (10.9 liters)
Coolant Flow Rate (per minute)	21.1 gallons (80.0 liters)
Heat Rejection to Coolant (per minute)	1668 Btu (1.76 MJ)
Heat Rejection to Room (per minute)	246.4 Btu (0.26 MJ)
Maximum Coolant Friction Head	6.4 psi (44.1 kPa)
Maximum Coolant Static Head	6.56 feet (2.0 meters)
Ambient Temperature Rating	104 °F (40 °C)

Air	
Combustion Air	82.6 cfm (2.34 m ³ /min)
Maximum Air Cleaner Restriction	24.9 in. H ₂ O (6.2 kPa)
Alternator Cooling Air	565.0 cfm (16.0 m ³ /min)
Radiator Cooling Air	2330 cfm (66.0 m ³ /min)
Minimum Air Opening to Room	4.09 sq.ft (0.38 sq.m)
Minimum Discharge Opening	1.63 sq.ft (0.15 sq.m)

Exhaust	
Gas Flow (full load)	175.0 cfm (4.97 m ³ /min)
Gas Temperature	860 °F (460 °C)
Maximum Back Pressure	53.5 in. H ₂ O (13.3 kPa)

Size	
L x W x H inches (cm)	74.8 x 35.4 x 49.2 (190 x 90 x 125)
Approx. Net Dry Weight	2204.6 lbs. (1000.0 kg)

Maximum Amps	
Rated Voltage	Maximum Amps
1Ø 120 Volt	100 amps (4 wire)
1Ø 240 Volt	50 amps (4 wire)
3Ø 240 Volt	108 amps
3Ø 480 Volt	54 amps

Warranty*

Isuzu Engine

12 months from date of purchase with unlimited hours or 24 months from date of purchase with 2000 hours (whichever occurs first).

Generator

12 months from date of purchase or 1000 hours (whichever occurs first).

*Refer to the express written, one-year limited warranty sheet for additional information.

Backfeed to a utility system can cause electrocution and/or property damage. Do not connect to any building's electrical system except through an approved device.

Specifications are subject to change without notice.



DCA45SSIU3 WhisperWatt Generator

MQ POWER DECIBEL LEVELS

Our soundproof housing allows substantially lower operating noise levels than competitive designs. WhisperWatts are at home on construction sites, in residential neighborhoods, and at hospitals — just about anywhere.

- 90 — Subway / truck traffic
- 80 — Average city traffic
- 70 — Inside car at 60 mph
- 60 — Air conditioner at 20 feet
- 50 — Normal conversation

Ultra-Silent at 23 feet



Optional Generator Features

- Electronic Governor Control (Crystal Sync)** — maintains frequency to within $\pm 0.25\%$ from no load to full load.
- Battery Charger** — provides fully automatic and self-adjusting charging to the generator's battery system.
- Special Batteries** — long life batteries provide extra engine cranking power.
- Low Coolant Level Shutdown** — provides protection from critically low coolant levels. Includes control panel warning light.
- Jacket Water Heater** — for easy starting in cold weather climates.
- Spring Isolators** — provides extra vibration protection for standby applications.
- Trailer Mounted Package** — highway legal trailer with electric or surge brakes with tandem axle configuration.

Optional Control Features

- Emergency Stop Switch.**
- Audible Alarm** — alerts operator of abnormal conditions.
- Automatic Start / Stop Control** — automatically starts the generator set during a commercial power failure when used in conjunction with a transfer switch.

Optional Fuel Cell Features

- Trailer fuel tank** — a second fuel cell located in the trailer allows for extended run time.
- Sub-base fuel cells (double wall)** — Additional fuel cell for extended runtime operation. Contains a leak sensor, low fuel level switch, and a secondary containment tank. UL142 listed.
 - 12 hours of minimum run time.
 - 24 hours of minimum run time.

Optional Distribution Devices

- Cam-Lock connectors.**
- Pin & Sleeve Connectors.**
- AC Output Cable.**



DCA45SSIU3 WhisperWatt Generator

Dimensions

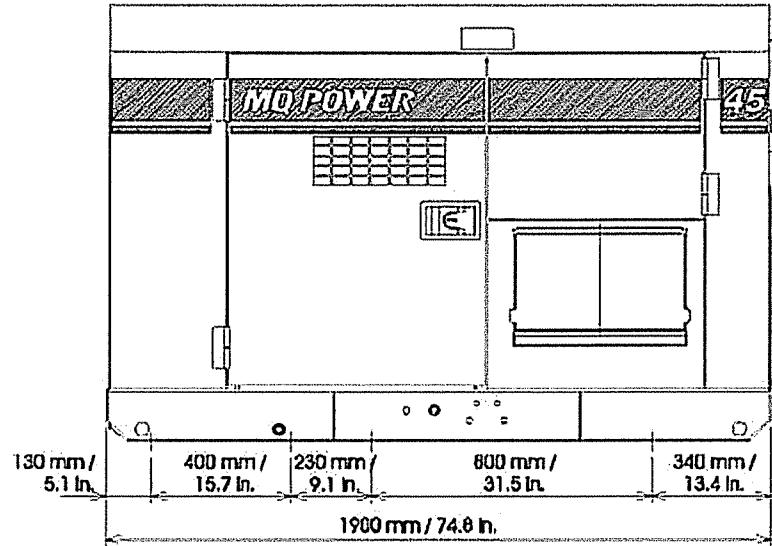
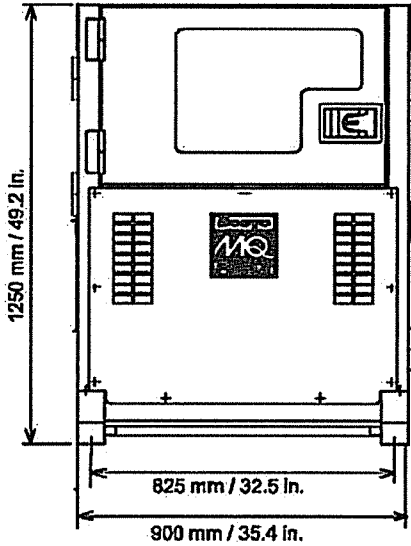

Weight	
Dry Weight	2204.6 lbs. (1000.0 kg)
Wet Weight	2434.5 lbs. (1104.3 kg)

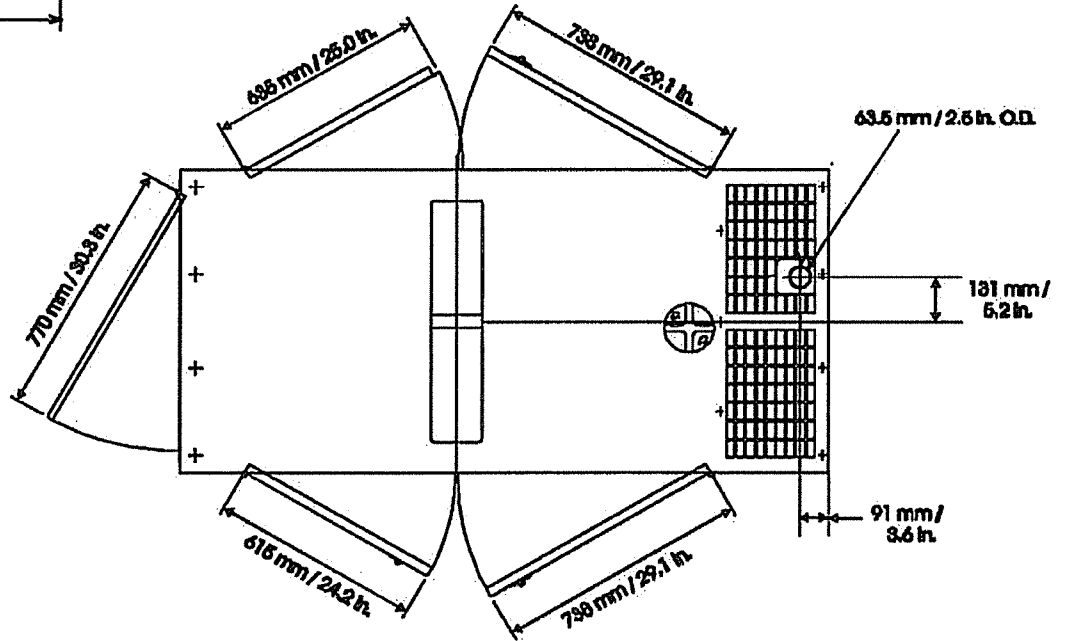

WESTERN SHELTER SYSTEMS

Mailing: PO Box 2729 • Shipping: 830 Wilson Street • Eugene, Oregon 97402 USA
Tel: 1-800-971-7201 • Fax: 1-541-284-2820 • Email: WSS@WesternShelter.com • Website: WesternShelter.com