



Purchasing Division
 2019 Washington Street East
 Post Office Box 50130
 Charleston, WV 25305-0130

State of West Virginia
 Centralized Expression of Interest
 02 — Architect/Engr

Proc Folder: 581555

Doc Description: East Campus Assessment and Metal Building Design

Proc Type: Central Contract - Fixed Amt

Date Issued	Solicitation Closes	Solicitation No	Version
2019-05-21	2019-06-12 13:30:00	CEOI 0211 GSD1900000011	1

BID RECEIVING LOCATION

BID CLERK
 DEPARTMENT OF ADMINISTRATION
 PURCHASING DIVISION
 2019 WASHINGTON ST E
 CHARLESTON WV 25305
 US

VENDOR

Vendor Name, Address and Telephone Number:

Alpha Associates, Inc
 209 Prairie Ave.
 Morgantown, WV 26501
 304-296-8216

RECEIVED

2019 JUN 11 AM 11:53

WV PURCHASING
 DIVISION

FOR INFORMATION CONTACT THE BUYER

Melissa Pettrey
 (304) 558-0094
 melissa.k.pettrey@wv.gov

Signature X

FEIN # 550516286

DATE 6/10/19

All offers subject to all terms and conditions contained in this solicitation

DESIGNATED CONTACT: Vendor appoints the individual identified in this Section as the Contract Administrator and the initial point of contact for matters relating to this Contract.

Richard A. Colebank, President & COO

(Name, Title)



(Printed Name and Title)

209 Prairie Ave, Morgantown, WV 26501

(Address)

304-296-8216/ 304-296-8245

(Phone Number) / (Fax Number)

rick.colebank@thinkalphafirst.com

(email address)

CERTIFICATION AND SIGNATURE: By signing below, or submitting documentation through wvOASIS, I certify that I have reviewed this Solicitation in its entirety; that I understand the requirements, terms and conditions, and other information contained herein; that this bid, offer or proposal constitutes an offer to the State that cannot be unilaterally withdrawn; that the product or service proposed meets the mandatory requirements contained in the Solicitation for that product or service, unless otherwise stated herein; that the Vendor accepts the terms and conditions contained in the Solicitation, unless otherwise stated herein; that I am submitting this bid, offer or proposal for review and consideration; that I am authorized by the vendor to execute and submit this bid, offer, or proposal, or any documents related thereto on vendor's behalf; that I am authorized to bind the vendor in a contractual relationship; and that to the best of my knowledge, the vendor has properly registered with any State agency that may require registration.

Alpha Associates, Inc

(Company)



(Authorized Signature) (Representative Name, Title)

Richard A. Colebank, President & COO

(Printed Name and Title of Authorized Representative)

6/10/19

(Date)

304-296-8216/ 304-296-8245

(Phone Number) (Fax Number)

**ADDENDUM ACKNOWLEDGEMENT FORM
SOLICITATION NO.:**

Instructions: Please acknowledge receipt of all addenda issued with this solicitation by completing this addendum acknowledgment form. Check the box next to each addendum received and sign below. Failure to acknowledge addenda may result in bid disqualification.

Acknowledgment: I hereby acknowledge receipt of the following addenda and have made the necessary revisions to my proposal, plans and/or specification, etc.

Addendum Numbers Received:

(Check the box next to each addendum received)

- | | |
|--|--|
| <input checked="" type="checkbox"/> Addendum No. 1 | <input type="checkbox"/> Addendum No. 6 |
| <input checked="" type="checkbox"/> Addendum No. 2 | <input type="checkbox"/> Addendum No. 7 |
| <input type="checkbox"/> Addendum No. 3 | <input type="checkbox"/> Addendum No. 8 |
| <input type="checkbox"/> Addendum No. 4 | <input type="checkbox"/> Addendum No. 9 |
| <input type="checkbox"/> Addendum No. 5 | <input type="checkbox"/> Addendum No. 10 |

I understand that failure to confirm the receipt of addenda may be cause for rejection of this bid. I further understand that any verbal representation made or assumed to be made during any oral discussion held between Vendor's representatives and any state personnel is not binding. Only the information issued in writing and added to the specifications by an official addendum is binding.

Alpha Associates, Inc

Company

Authorized Signature

6/10/19

Date

NOTE: This addendum acknowledgement should be submitted with the bid to expedite document processing.

West Virginia Ethics Commission
Disclosure of Interested Parties to Contracts

(Required by W. Va. Code § 6D-1-2)

Contracting Business Entity: Alpha Associates, Inc Address: 209 Prairie Ave, Morgantown, WV 26501

Authorized Agent: Richard A. Colebank Address: _____

Contract Number: CEOI 0211 GSD1900000011 Contract Description: East Campus Assessment &

Governmental agency awarding contract: West Virginia Purchasing Division Metal Building Design

Check here if this is a Supplemental Disclosure

List the Names of Interested Parties to the contract which are known or reasonably anticipated by the contracting business entity for each category below (attach additional pages if necessary):

1. Subcontractors or other entities performing work or service under the Contract

Check here if none, otherwise list entity/individual names below.

Miller Enginnering, Craig Miller

2. Any person or entity who owns 25% or more of contracting entity (not applicable to publicly traded entities)

Check here if none, otherwise list entity/individual names below.

Richard Colebank, President, COO
Richard Klein, Chairman, CEO

3. Any person or entity that facilitated, or negotiated the terms of, the applicable contract (excluding legal services related to the negotiation or drafting of the applicable contract)

Check here if none, otherwise list entity/individual names below.

Signature: [Handwritten Signature] Date Signed: 6/10/19

Notary Verification

State of West Virginia, County of Upshur:

I, Kayla Facemire, the authorized agent of the contracting business entity listed above, being duly sworn, acknowledge that the Disclosure herein is being made under oath and under the penalty of perjury.

Taken, sworn to and subscribed before me this 10th day of June, 2019.

[Handwritten Signature]
Notary Public's Signature

To be completed by State Agency:

Date Received by State Agency: _____

Date submitted to Ethics Commission: _____

Governmental agency submitting Disclosure: _____

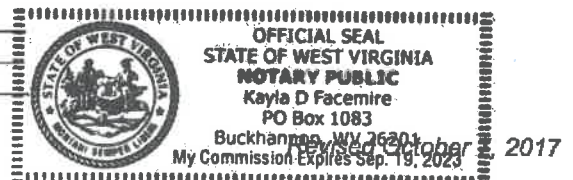

STATE OF WEST VIRGINIA
Purchasing Division
PURCHASING AFFIDAVIT

CONSTRUCTION CONTRACTS: Under W. Va. Code § 5-22-1(i), the contracting public entity shall not award a construction contract to any bidder that is known to be in default on any monetary obligation owed to the state or a political subdivision of the state, including, but not limited to, obligations related to payroll taxes, property taxes, sales and use taxes, fire service fees, or other fines or fees.

ALL CONTRACTS: Under W. Va. Code §5A-3-10a, no contract or renewal of any contract may be awarded by the state or any of its political subdivisions to any vendor or prospective vendor when the vendor or prospective vendor or a related party to the vendor or prospective vendor is a debtor and: (1) the debt owed is an amount greater than one thousand dollars in the aggregate; or (2) the debtor is in employer default.

EXCEPTION: The prohibition listed above does not apply where a vendor has contested any tax administered pursuant to chapter eleven of the W. Va. Code, workers' compensation premium, permit fee or environmental fee or assessment and the matter has not become final or where the vendor has entered into a payment plan or agreement and the vendor is not in default of any of the provisions of such plan or agreement.

DEFINITIONS:

"Debt" means any assessment, premium, penalty, fine, tax or other amount of money owed to the state or any of its political subdivisions because of a judgment, fine, permit violation, license assessment, defaulted workers' compensation premium, penalty or other assessment presently delinquent or due and required to be paid to the state or any of its political subdivisions, including any interest or additional penalties accrued thereon.

"Employer default" means having an outstanding balance or liability to the old fund or to the uninsured employers' fund or being in policy default, as defined in W. Va. Code § 23-2c-2, failure to maintain mandatory workers' compensation coverage, or failure to fully meet its obligations as a workers' compensation self-insured employer. An employer is not in employer default if it has entered into a repayment agreement with the Insurance Commissioner and remains in compliance with the obligations under the repayment agreement.

"Related party" means a party, whether an individual, corporation, partnership, association, limited liability company or any other form or business association or other entity whatsoever, related to any vendor by blood, marriage, ownership or contract through which the party has a relationship of ownership or other interest with the vendor so that the party will actually or by effect receive or control a portion of the benefit, profit or other consideration from performance of a vendor contract with the party receiving an amount that meets or exceeds five percent of the total contract amount.

AFFIRMATION: By signing this form, the vendor's authorized signer affirms and acknowledges under penalty of law for false swearing (W. Va. Code §61-5-3) that: (1) for construction contracts, the vendor is not in default on any monetary obligation owed to the state or a political subdivision of the state, and (2) for all other contracts, that neither vendor nor any related party owe a debt as defined above and that neither vendor nor any related party are in employer default as defined above, unless the debt or employer default is permitted under the exception above.

WITNESS THE FOLLOWING SIGNATURE:

Vendor's Name: Alpha Associates, Inc

Authorized Signature: [Signature] Date: 6/10/19

State of West Virginia

County of Upshur, to-wit:

Taken, subscribed, and sworn to before me this 10 day of June, 2019.

My Commission expires September 19, 2023.

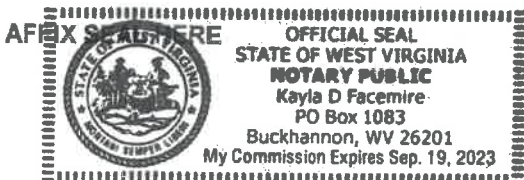

NOTARY PUBLIC [Signature]
Purchasing Affidavit (Revised 01/19/2018)

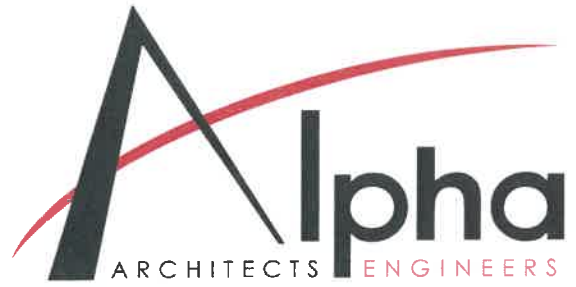

**Department of Administration
East Campus Assessment & Metal
Building Design**

June 12, 2019

1:30PM

CEOI 0211 GSD1900000011

EXPRESSION OF INTEREST





June 12, 2019

Department of Administration
Purchasing Division
2019 Washington St. E.
Charleston, WV 25305

Attn: Melissa Pettrey

RE: CEOI 0211 GSD19000011
A/E Services for East Campus Assessment and Metal Building Design

Dear Ms. Pettrey,

Alpha Associates, Incorporated is pleased to submit this expression of interest for the East Campus Assessment and Metal Building Design project on the Capitol Campus. The Alpha Team's experience, appreciation of presence in the community, and our existing relationship with the General Services Division make us the perfect design partner on this important project at the West Virginia State Capitol Complex in Charleston, WV.

Over the past 50 years Alpha has provided quality architectural, engineering and surveying services to various clients, both public and private, throughout the state. Our relevant project experience includes the evaluation, renovation, design and construction of a variety of office spaces including the Building 770 at the West Virginia Regional Technology Park in Charleston, West Virginia and the West Virginia State Office Building in Clarksburg, West Virginia. In addition to this, Alpha has provided professional services for several sites including the U.S. Coast Guard Operations Systems Center in Martinsburg, WV and Building 25 in Parkersburg, WV. Additionally, we have utilized Pre-engineered metal buildings in numerous applications including the WVU Equestrian Center in Reedsville, several automotive dealerships and numerous maintenance and Fire/Emergency Station buildings.

Project Team & Location

Alpha Associates, Incorporated is a West Virginia owned and operated small business that offers several services under one roof, including architecture, civil and structural engineering, surveying, interior design, and construction administrative services. The personnel that will be dedicated to your project are highly qualified professionals and support staff with the technical expertise to meet and exceed

expectations of this project. Miller Engineering will be the Mechanical, Electrical and Plumbing Engineers for this project. This project will be managed from Alpha's Corporate Office located in Morgantown, West Virginia.

Project Understanding

The General Services Division is looking to partner with a firm to provide design services for the property site that addresses the site issues, such as paving, site drainage, employee parking, inventory staging and storage, the demolition, construction and possible renovation of existing facilities on the site, as well as the design of an approximately 25,000 sq. ft. structural steel building (or buildings) that will house equipment storage, employee locker rooms, restrooms and showers as well as offices for general personnel. Also included will be the programming and producing schematic and preliminary designs and construction documents and construction administration services.

Summary

The Alpha Team is looking forward to continuing to build on an already successful relationship with the State of West Virginia by providing excellent services at affordable costs. Our dedicated team of professionals will make your project a priority. If you would like to further discuss this upcoming project, please contact me at (304) 296-8216 ext. 102.

Sincerely,

ALPHA ASSOCIATES, INCORPORATED



Richard Colebank, PE, PS
Richard A. Colebank, PE, PS
President and COO
rick.colebank@thinkALPHAfirst.com



FIRM PROFILE

Firm Profile

FIRM NAME

Alpha Associates, Incorporated

OFFICE LOCATIONS

209 Prairie Avenue
Morgantown, West Virginia 26501

535 West King Street
Martinsburg, West Virginia 25401

INCORPORATED

1969; Morgantown, WV

FIRM PRINCIPALS

Richard A. Colebank, PE, PS; President and COO
Richard W. Klein, PE, PS; Chairman and CEO
Charles B. Luttrell, PE; Principal
Charles B. Branch, PE; Principal

NUMBER OF EMPLOYEES

22 Employees

SERVICES

Architectural Design
Civil Engineering
Structural Engineering
Surveying
Interior Design
Landscape Architecture
Construction Administration

Alpha Associates, Incorporated was established in 1969 and since that time has completed hundreds of projects throughout Morgantown and the state of West Virginia. Alpha's Corporate Office is located in Morgantown with our Eastern Regional Office located in Martinsburg.



We provide Solutions. You can expect Excellence.

Firm Profile

Our engineered solutions involve a **detailed assessment process**: investigation, observation, communication with stakeholders, system analysis, building modeling, and engagement from our entire team. We approach each and every project with this process and the guiding principle that buildings are designed to be livable and function in their intended purpose.

Over the past (11) years Miller Engineering has engineered solutions for over \$17.2M in mechanical system upgrades, repairs, and renovations for projects of all scopes, with clients ranging from private owners to local and state governments.

Our team has engineered repairs and stabilized systems to assist an owner to plan for required upgrades, system repair or develop a maintenance plan to extend the life of a system.

Our team has unique skill-sets regarding engineered renovation solutions. Each member of the team has hands-on mechanical system installation, construction, design, and maintenance experience.

Miller Engineering takes pride in being **different by design**, and that difference shines through in all phases of our work and continued relationships with our clients.

Additional Benefits

- Experienced and Licensed Professional Engineers
- Quality, Value-Engineered Project Delivery
- Qualified Construction Representative on Staff
- LEED-AP Certified
- Below Industry Change Order Status
- Building Information Modeling
- Interactive Solutions Provider
- Emergency Facility Response

Engineering Design and Consultation

- Mechanical
- Electrical
- Plumbing
- HVAC Design
- Renovation
- New Construction

Aquatic Facility Design

- Public Pools & Areas
- ADA Compliance
- Indoor & Outdoor (air flow)
- Chlorination/Filtration

Construction Administration

- Maintenance/Facility Improvement Plans
- Contract Administration
- Code Observation

Communication System

- Intercomm & Public Address
- Voice/Data/CATV
- Urgent Response

Energy

- Power Supply (main & backup)
- Green & Renewable Consulting
- Systems Utilization & Upgrades
- Sustainable Solutions

Facility Utilization

- Systems Assessment & Solutions
- Adaptive Re-use
- Planning/Life-Cycle Control
- Engineered Replacement

Life Safety Inspection/Design

- Fire Protection & Alarm Systems
- Access Control
- Fire & Electrical Investigation

Industry Experience

- Education
- Local & State Government
- Commercial Development
- Healthcare
- Public Pools (indoor & outdoor)
- Department of Parks & Recreation





STATEMENT OF QUALIFICATIONS

Alpha Associates, Incorporated is an Architectural and Engineering design firm that provides services in the areas of Architectural Design, Civil Engineering, Structural Engineering, Landscape Design, Interior Design, Construction Administration, Project Management, and Surveying. Our clients benefit from our unique combination of extensive design and construction experience, advanced technical tools, dedicated principals and highly skilled staff members.

Since 1969, Alpha has provided architectural and engineering design services throughout the state of West Virginia. We have worked with many local, state, and federal government entities on numerous Building projects of varying sizes and types. In this proposal, you will find examples that showcase the Alpha Team's exceptional project experience on similar type facilities.

For this project, Alpha has partnered with Miller Engineering to perform the mechanical and electrical designs. Alpha has a successful partnership with Miller Engineering that's developed over a decade and has included numerous projects. This successful history allows us to provide the State with a cohesive team on this project. Both Alpha and Miller Engineering have the knowledge and understanding in design and construction to complete this project seamlessly from the initial project inspections to the development of plans. The Alpha team will be your expert for this project.

Everyone at Alpha, from the President to the administrative staff, works towards the goal of completing successful projects. Our principals are involved with projects from the earliest stages right through final completion and beyond. They will consistently update you on your project by using effective communication tools to manage the projects and all the involved parties. Our skilled staff of 24 architects, engineers, surveyors and administrative personnel works diligently towards producing the drawings and specifications that will deliver our clients successful projects, completed on time and within budget.

Alpha has thrived for 50 years because we are a professional organization dedicated to providing superior architectural and engineering design services to our clients. While our staff is large enough to handle any size project, we are also small enough to give each project the individual attention to detail that will make them successful projects for our clients.

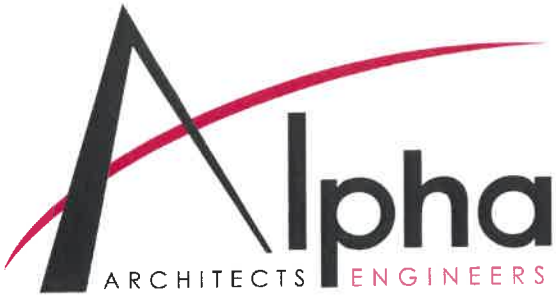

STAFFING PLAN

All work to be performed for this project will be managed out of Alpha's Morgantown office. In addition to your dedicated Project Team, Alpha's staff of 24 includes engineers, architects, architectural designers, interior designers, landscape designers, technicians, and support staff that are available to assist with any potential project need.



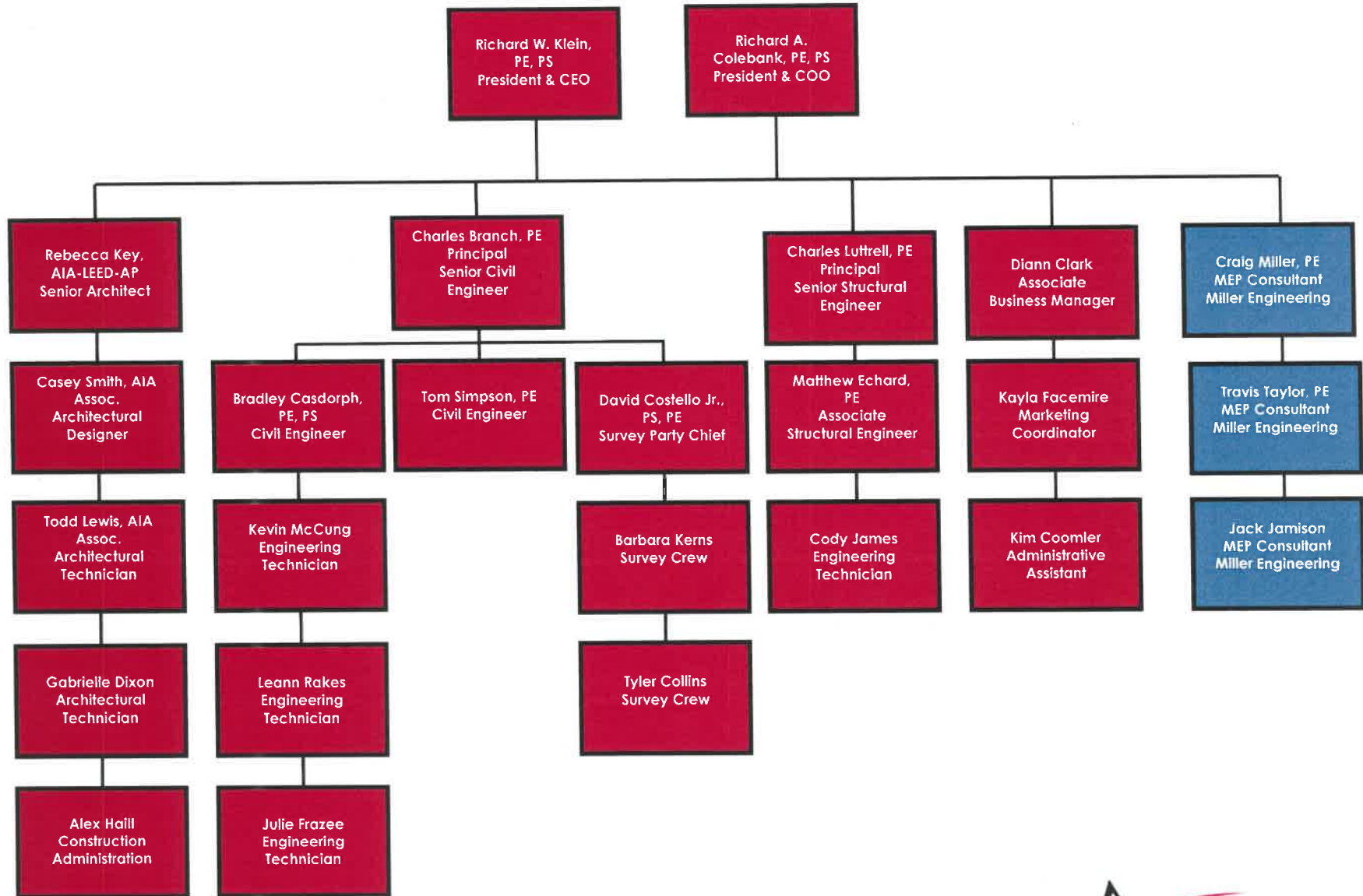



SCHEDULE CONTROL

Alpha Associates, Incorporated has an excellent track record of producing projects on time and within the Owner's budget. Many A/E firms can claim the same successes, but the determining factor is the tools the firms utilize to achieve the budgets, both in regard to funds and time. Alpha utilizes a number of tools, both traditional and modern to exceed our clients' expectations.

A project schedule is a dynamic, ever changing entity. Your project schedule depends on many factors including:

- Preferred construction method
- Changes to project scope
- Unique construction elements

The Alpha Team has an excellent track record of meeting project design deadlines. Most recently, Alpha completed construction on a project in Morgantown that went from design to completion in just over 12 months. This project was completed for a private developer and had a construction cost in excess of \$20 million.

Successful project management depends upon consensus regarding work efforts, milestones and goals. The team has found that the development of detailed work plans, which delineate tasks and deliverables for each project phase, in concert with the client and full project team, is the most effective means of establishing expectations about efforts required by the respective disciplines. In addition to guiding the efforts of the design team, the work plan sets forth specific time frames and decision points for Owner and user reviews, comments and approvals.

Developing an overall project schedule is a critical task that must take into account many factors: building type, owner's desire for occupancy, scope of work and level of documentation, whether contract(s) is bid or negotiated, available fee, and prior experiences on similar projects. Characteristic of the client, its organization, or the involvement of a construction manager and his responsibility for document review must also be considered.

This starts with a kick-off meeting which establishes ground rules, responsibilities,



and line of communication. We have found that a team visioning session is a great way to get everyone started off on the right track.

Determining a project schedule is a task that must be done with all parties involved in the process. Once the design process begins, a very detailed, realistic project schedule can be developed and communicated to all involved.



CAPACITY AND SOFTWARE

Capacity

Alpha Associates, Incorporated is prepared to commit staff resources to the East Campus and Metal Building Design Project. Alpha has the qualified and experienced personnel, administrative support, along with the production equipment and resources to ensure the successful completion of this project. We are confident in our ability to provide the State of West Virginia with a committed and dependable design team. Our multidisciplinary design team is prepared to meet and exceed the expectations of the State by committing any resources necessary to meet the project schedule.

Software

The project team incorporates the latest computer and software capabilities required to complete the working drawings and specifications for this project. Our cost accounting system is top-of-the-line and we have the ability to differentiate fees according to task. We have secure e-mail and internet capability to allow efficient transfer of information between Alpha and the client. We currently have the latest editions of the following software:

- AutoCAD 19
- REVIT (Editions up to 2019)
- Civil 3D
- RISA 3D
- RISA Floor
- RISA Foundation
- MathCAD
- Autodesk Suite
- Enercalc
- AutoTURN
- TopCon GR5 GPS System
- TopCon Total Station with Reflectorless Capabilities
- Carlson Surveyor & Data Collector



ALPHA RESUMES

Richard A. Colebank, PE, PS | President and COO

SUMMARY

Mr. Colebank is President and Chief Operating Officer of Alpha. He has been with Alpha Associates, Incorporated since 1985. He began his career with Alpha as a staff engineer and progressed through the ranks from Project Manager to his current position. Mr. Colebank has worked with diverse clients such as WVU, City of Morgantown, WVDOH, WVU Foundation, and the Morgantown Municipal Airport, as well as numerous other public and private clients. Since 1988, Mr. Colebank has been the Principal-In-Charge of the Civil Engineering projects developed at Alpha. In his current capacity, Mr. Colebank provides financial and administrative guidance for the day to day operations of the company while continuing to manage projects.



PROFILE

Broad-based responsibilities in the following areas:

- Project Management
- Business Operations and Financial Management
- Quality Assurance/Quality Control
- Civil Engineering Project Management and Design
- New Business Development
- Expert Testimony and Investigation

PROFESSIONAL HIGHLIGHTS

Project Manager:

- WVU Research Park; Morgantown, WV
- Federal Bureau of Prisons Hazelton Medium Security Prison
- WV Medal of Honor Recipients Plaza; Hazelton, WV
- North Fork Hughes River Recreation Facilities; Ritchie County, WV
- WVDOH I-77 Welcome Center; Williamstown, WV
- Ices Ferry Bridge; Morgantown, WV
- Monongalia General Hospital Expansion; Morgantown, WV
- Monongalia General Hospital Access Road; Morgantown, WV
- Morgantown Municipal Airport Access Road; Morgantown, WV
- West Virginia State Office Building; Clarksburg, WV
- WVU College of Physical Education and Sports Science/Student Health Center; Morgantown, WV

Indefinite Delivery/Indefinite Quantity Contracts:

- Morgantown Municipal Airport Open End Contract
- West Virginia Division of Highways Open End Contract
- National Energy Technology Laboratories Open End Contract
- West Virginia University Open End Contract
- United States Postal Service Open End Contract



ALPHA RESUMES

Richard A. Colebank, PE, PS | President and COO

EMPLOYMENT HISTORY

1985 – Current	Alpha Associates, Incorporated
1983-1985	Charles Townes and Associates, P.C.
1983	US Army Corps of Engineers

EDUCATION

West Virginia University
 Masters of Business Administration; 1999
 Bachelor - Civil Engineering; 1982

QUALIFICATIONS

- **License:** Professional Engineer: West Virginia, Maryland, Pennsylvania, Virginia
- Professional Surveyor: West Virginia
- Certified Private Pilot

AFFILIATIONS

- Former NSPE/PEPP Governor of WV
- American Red Cross - Regional Chairman
- University High School Foundation; Charter Member; President
- Morgantown Area Chamber of Commerce; Past Chairman
- WVU College of Civil and Environmental Engineering Visiting Committee
- WVU College of Business and Economics MBA Advisory Committee

Contact

Richard A. Colebank

304.296.8216

800.640.8216

rick.colebank@thinkalphafirst.com

think  **Alpha** first.com



ALPHA RESUMES

Charles Branch, PE | Principal, Civil Engineer

SUMMARY

As Chief Engineer for site development and planning projects, Mr. Branch is a vital part of the design process at Alpha. His involvement spans from strictly civil engineering projects, to the design of large scale educational projects and medical facilities. Mr. Branch acts as peer review for young engineers in the firm on issues ranging from storm water management to site design. Mr. Branch is also involved in commercial and residential development design, roadway and bridge design and utilities layout.



PROFILE

Broad-based responsibilities in the following areas:

- Highway Design
- Municipal Engineering
- Wastewater Collection
- Storm Sewer System Design
- Storm Water Management
- Site Engineering
- Project Management

PROFESSIONAL HIGHLIGHTS

Civil Engineer/Project Manager:

- Jane Lew Truck Stop; Jane Lew, WV
- Clarksburg State Office Building; Clarksburg, WV
- WVU Reedsville Farm Redevelopment; Morgantown, WV
- Freedom Automotive Group Dealerships; Morgantown, WV
- Freedom Kia; Clarksburg, WV
- WVU Parking Lot 81 Renovations; Morgantown, WV
- WVU Doll's Run Burn Room; Morgantown, WV
- WVU Alumni Center Parking Lot; Morgantown, WV
- WVU Alumni Center Storm Water Management; Morgantown, WV
- WVU Evansdale Redevelopment; Morgantown, WV
- WVU Health Sciences Center Eastern Division; Martinsburg, WV
- Blackshere Bridge; Mannington, WV
- WVDOH I-77 Welcome Center; Williamstown, WV
- WV Medal of Honor Recipients Plaza; Hazelton, WV
- Lewis County High School Bridge; Weston, WV
- Wyoming County Route 10 Relocation; Wyoming County, WV
- Fairmont Federal Credit Union; Bridgeport, WV

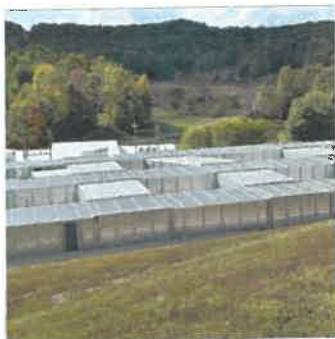

ALPHA RESUMES

Charles Branch, PE | Principal, Civil Engineer

EMPLOYMENT HISTORY

1992 – Current Alpha Associates, Incorporated
1988-1992 Reimer, Muegge, & Associates, Inc.

EDUCATION

West Virginia University
Bachelor - Civil Engineering; 2000
Fairmont State College
Bachelor Architectural Engineering Technology; 1988

QUALIFICATIONS

• **License:** Professional Engineer: West Virginia

AFFILIATIONS

- WV Society of Professional Engineers
- National Society of Professional Engineers

think  first.com

Contact

Charles B. Branch

304.296.8216

800.640.8216

chuck.branch@thinkalphafirst.com



ALPHA RESUMES

Charles B. Luttrell, PE | Principal, Structural Engineer

SUMMARY

Mr. Luttrell has worked with Alpha Associates, Inc. since 1996. He is the chief structural engineer on all projects at Alpha. Before coming to Alpha, Mr. Luttrell's graduate work resulted in several contributions to the cold-formed steel deck industry. His new method of analysis for non-uniform loads on composite concrete and cold formed steel decks has been made a permanent part of the Steel Deck Institute's design manual. Mr. Luttrell also worked on projects that involved pre-stressed timber bridge research with the WVU Constructed Facilities Center. Since coming to Alpha, Mr. Luttrell has had significant involvement in the effort to begin utilizing modern composite materials in practical bridge applications.

PROFILE

Broad-based responsibilities in the following areas:

- Bridge Structural Design and Analysis
- Innovative Bridge Materials Applications
- Building Structural Design and Analysis
- Historical Restoration and Evaluations

PROFESSIONAL HIGHLIGHTS

Structural Engineer:

- Freedom Automotive Group 3 Dealerships; Morgantown, WV
- Hazel Ruby McQuain Equine Education & Resource Center; WVU
- WVDOH Arnettsville Replacement Bridge; Morgantown, WV
- Clarksburg State Office Building; Morgantown, WV
- Grant County Bank Addition & Renovation; Petersburg, WV
- South Berkeley Fire Station; Inwood, WV
- Alumni Center Structural Framing and Foundation; WVU
- Engineering Science Building, East Wing Addition, WVU
- Hazel Ruby McQuain Amphitheater Roof; Morgantown, WV
- West Buckeye Bridge; Core, WV
- Washington High School; Charles Town, WV
- WVU Coliseum Structural Inspection; Morgantown, WV
- WVU Coliseum Scoreboard Hoist Project; Morgantown, WV
- Alderson Broaddus College, Rex Pyles Arena Deck; Philippi, WV
- Mountaineer Middle School Renovation; Morgantown, WV
- Salem International Building Inspections; Salem, WV
- Monongalia County Sheriff's Building; Morgantown, WV
- South High Street Bridge, Morgantown, WV
- Ices Ferry Bridge, Morgantown, WV



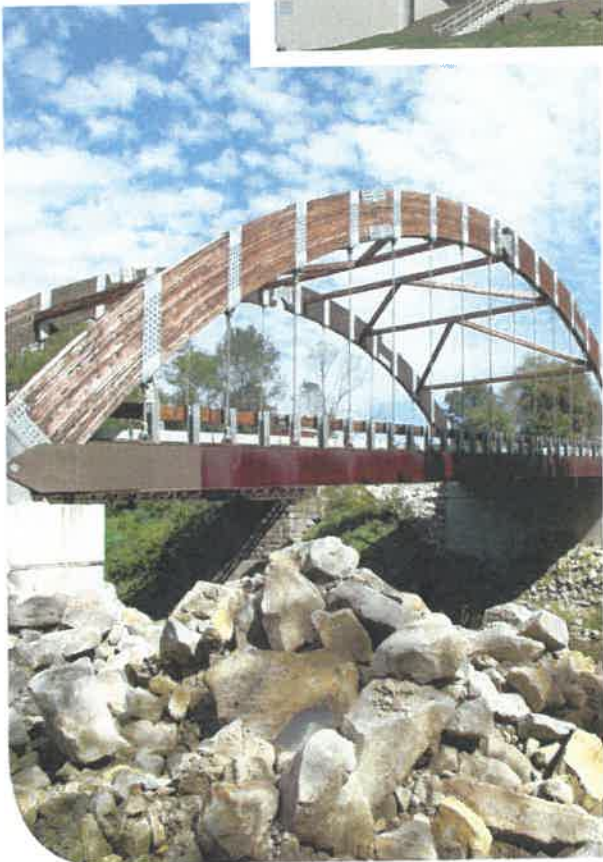

ALPHA RESUMES

Charles B. Luttrell, PE | Principal, Structural Engineer

EMPLOYMENT HISTORY

1996 – Current Alpha Associates, Incorporated
1995-1996 Larry D. Luttrell, PE, Ph D
1991-1994 West Virginia University
1990-1991 WVU Constructed Facilities Center

EDUCATION

West Virginia University
Masters - Structural Engineering; 1995
Bachelor - Civil Engineering; 1993

QUALIFICATIONS

- **License:** Professional Engineer: West Virginia, Pennsylvania

AFFILIATIONS

- WV Society of Professional Engineers
- National Society of Professional Engineers
- Chi Epsilon; Member
- American Concrete Institute; Member

Research Experience

- Cold Formed Steel Deck Research
 - ✓ Fastener Failures
 - ✓ Edge conditions/failures
 - ✓ Buttoned overlap shear failures
- Composite Cold Formed Steel and Concrete Deck Research
 - ✓ Line load behavior/failures
 - ✓ Concentrated load behavior/failures
 - ✓ Web crippling
 - ✓ Punch failures

think  **Alpha** first.com

Contact

Charles B. Luttrell

304.296.8216

800.640.8216

charlie.luttrell@thinkalphafirst.com



ALPHA RESUMES

Rebecca Key, AIA, LEED-AP | Architect, Associate

SUMMARY

Ms. Key has worked in the architectural field for over 35 years. She serves as Project Architect/Project Manager for numerous architectural designs at Alpha Associates, Incorporated. Ms. Key is involved from the programmatic stages and schematic designs all the way through construction documents to construction administration. Having been with Alpha since 2000, Ms. Key has provided design services on numerous projects that have contributed to the ever-growing skyline of Morgantown, Charleston, Bridgeport, and other areas around the state.

PROFILE

Broad-based responsibilities in the following areas:

- Architectural Design
- Interior Design and Space Planning
- Feasibility Studies
- Water Infiltration Analysis
- Interior Space Planning
- Historic Renovation
- Project Management

PROFESSIONAL HIGHLIGHTS

Education

- Ridgedale Elementary; Morgantown, WV
- Mountaineer Middle School; Morgantown, WV
- Pineville Elementary; Pineville, WV
- Huff Consolidated School; Hanover, WV

Historic Renovations

- Cass Scenic Railroad - Clubhouse Renovation; Cass, WV
- Berkeley Springs Bathhouse; Berkeley Springs, WV
- Hawks Nest State Park Picnic Pavilion; Anstead, WV
- Hawks Nest State Park CCC Museum; Anstead, WV

Recreation

- Ruby McQuain Amphitheater; Morgantown, WV
- North Fork Hughes River State Park; Ritchie County, WV

Dormitory and Multi-Family

- Fairmont State University Prichard Hall Renovation; Fairmont, WV
- WVU Boreman Hall; Morgantown, WV
- Augusta Apartment Building; Morgantown, WV
- Grand Central Apartment

Municipal & State Government

- WV State Office Building; Clarksburg, WV
- Mon County Family Court Renovation; Morgantown, WV
- Mon County Sheriff's Department; Morgantown, WV
- White Hall Municipal Building; White Hall, WV
- WV State Office Building; Parkersburg, WV





ALPHA RESUMES

Rebecca Key, AIA, LEED-AP

Architect, Associate



EMPLOYMENT HISTORY

2000 – Current	Alpha Associates, Incorporated
1983-1999	Alexander Key and Associates
1978-1983	Webster Clothes; Director of Store Planning

EDUCATION

University of Maryland
 Bachelor of Architecture; 1977
 Maryland Institute College of Art
 Coursework in Furniture Design; 1986-1987

QUALIFICATIONS

- **License:** Registered Architect: West Virginia, Maryland, Washington DC, New York, Virginia, Pennsylvania
- NCIDQ Certified (Interior Design)
- Leadership In Energy and Environmental Design Accredited Professional
- Meet Standards of Secretary of the Interior for historic architecture

AFFILIATIONS

- American Institute of Architects
- West Virginia Society of Architects
- Fairmont, WV ICC Board of Appeal; Board Member
- U.S. Green Building Council
- AIA Liveable Communities
- Marion County Chamber of Commerce
- Leadership Kanawha Valley Class of 2014



think **Alpha** first.com

Contact

Rebecca Key

304.296.8216

800.640.8216

rebecca.key@thinkalphafirst.com

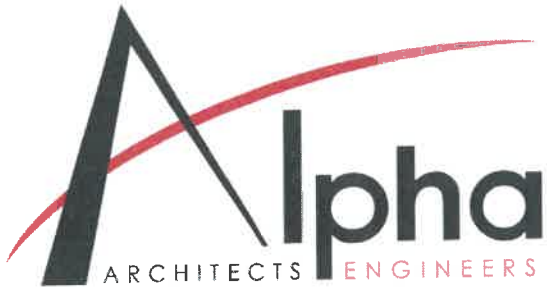

ALPHA RESUMES

Bradley Casdorff, PE, PS | Civil Engineer

SUMMARY

Mr. Casdorff joined the Alpha Associates, Incorporated team in 2004 and currently works as a project engineer in the Morgantown office. He has 36 years of professional experience with roadway design, storm sewer design, airport airside renovation and design, storm water management including conveyance and detention, environmental permitting, project administration supervision and inspection, as well as boundary and construction surveying.



PROFILE

Broad-based responsibilities in the following areas:

- Airport Planning and Design
- Highway Design
- Hydraulic and Hydrology Studies
- Site Plan Development
- Land Surveying

PROFESSIONAL HIGHLIGHTS

Civil Engineering:

- Platinum Properties - Waterfront Conference Center; Morgantown, WV
- Hart Field - Runway Safety Area; Morgantown, WV
- Hart Field - Ramp Renovation and Deicing Facility; Morgantown, WV
- Hart Field - Signage and Lighting; Morgantown, WV
- Hart Field - Airport Certification Manual; Morgantown, WV
- Hart Field - Air Rescue and Fire Fighting Vehicle Procurement, WV
- WVU - Lot 81 Parking Area Improvements; Morgantown, WV
- WVU Animal Facilities Annex, Engineering Retrofit; Morgantown, WV
- McKee Crossing - 120 Acre Subdivision; Martinsburg, WV
- Morgantown Municipal Airport Access Road; Morgantown, WV
- Davisson Estates - 60 Acre Subdivision; Morgantown, WV
- Mon General Hospital - East Parking Area; Morgantown, WV
- Applebee's Restaurant, Site Plan; Morgantown, WV
- WVU CPASS/Student Health; Morgantown, WV
- WVU Research Park- 100 Acre ALTA/ACSM Survey; Morgantown, WV
- WVU Museum; Morgantown, WV



ALPHA RESUMES

Bradley Casdorph, PE, PS | Civil Engineer

EMPLOYMENT HISTORY

2004 – Current Alpha Associates, Incorporated
1979-2004 Triad Engineering, Incorporated

EDUCATION

West Virginia University
Masters - Soil Conditions and Foundation Design; 1982
Bachelor - Civil Engineering; 1979

QUALIFICATIONS

- **License:** Professional Engineer: West Virginia
Professional Surveyor: West Virginia
Certified Private Pilot

AFFILIATIONS

- WV Society of Professional Engineers
- National Society of Professional Engineers
- WVSPS - Mountain Regional Chapter; President
- Aircraft Owners and Pilots Association; Member

Contact

Bradley Casdorph

304.296.8216

800.640.8216

brad.casdorph@thinkalphafirst.com

think  **Alpha** first.com



ALPHA RESUMES

Matthew T. Echard, PE | Structural Engineer, Associate

SUMMARY

Mr. Echard joined Alpha Associates, Inc. in early 2016 with a strong belief that his clients deserve intelligent, performance-based and value-oriented solutions. Drawing on experience working across the United States, Europe, and the Middle East, Mr. Echard returned to West Virginia to provide world-class service in a historically underserved region while making positive contributions to the future growth of his home state. Mr. Echard places a large value on the collaborative work process, believing that a building's form and function are derived from many contexts. Mr. Echard's office is located in the corporate office in Morgantown, WV.

PROFILE

Broad-based responsibilities in the following areas:

- Structural Engineering
- Structural Forensics
- Project Management

PROFESSIONAL HIGHLIGHTS

Structural Engineering:

- Grant County Bank; Petersburg, WV
- WVDOH Arnettsville Bridge Replacement; Monongalia County, WV
- WVDOH Deckers Creek Pedestrian Bridge; Morgantown, WV
- Jane Lew Truck Stop; Jane Lew, WV
- Queen Street Underpass; Martinsburg, WV
- Westover Goodwill Structural Design; Morgantown, WV
- Weyerhaeuser Roof Evaluation; Heaters, WV
- Weyerhaeuser OSB Facilities Alterations; Heaters, WV
- Weyerhaeuser Hazardous Material Transfer Encloser; Heaters, WV
- Mapletown High School Elevator; Mapletown, PA
- Knauf Insulation Melter Line Structural Supports ; Inwood, WV
- Knauf Insulation Cooling Tower & Heat Exchanger Structure & Foundations; Inwood, WV
- 57 Middleway Pike Commercial Building; Inwood, WV
- GrafTech Furnace Structural Assessment; Grafton, WV
- FedEx Distribution Facility Structural Damage Assessment; Morgantown, WV
- Los Mariachis UTC; Morgantown, WV



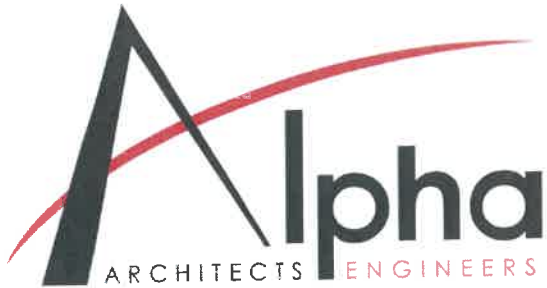

ALPHA RESUMES

Matthew T. Echard, PE | Structural Engineer

EMPLOYMENT HISTORY

2016-Current	Alpha Associates, Incorporated
2010-2015	Echard ingenieurBüro
2006-2009	Buro Happold Consulting Engineers
2003-2006	RISA Technologies, Inc.
2000-2003	Zaldastani Associates, Inc.

EDUCATION

Massachusetts Institute of Technology
Masters - Engineering & Environmental Mechanics 2002
West Virginia University
Bachelors of Science - Civil Engineering 2000

QUALIFICATIONS

- **License:** Professional Engineer: West Virginia, California
- California OES SAP Evaluator

AFFILIATIONS

American Concrete Institute (ACI)
American Institute of Steel Construction (AISC)
American Society of Civil Engineers (ASCE)
American Wood Council (AWC)

Publications

- Echard, M. and Tonis, D. Convergent Design Methodology for Bio-Science Labs: Architectonic and Performative Structural Considerations Using the Geilinger Composite Column Solution. Proceedings of ICSEA2010 - First International Conference on Structures and Architecture Guimarães, Portugal, July 2010, Taylor & Francis.
- Echard, M. Structural Analysis and Design Within a BIM Framework. EASEC 10 - East Asia Structural Conference, Bangkok, Thailand, August 2006.

Contact

Matthew T. Echard

304.296.8216

800.640.8216

matthew.echard@thinkalphafirst.com



B. Craig Miller, PE

Craig founded Miller Engineering in 2003, and serves as President and Principal Engineer. He has more than 20 years experience in design, specification, operations and project management. During his employment with WVU, Craig was directly involved with approximately \$130 million in new capital construction. His experience with a wide range of projects including HVAC, electrical, plumbing, infrastructure upgrades, building automation, energy efficiency and maintenance/renovation, among others, allows him to serve in multiple capacities within a given project. Craig will serve as the “Relationship

Manager” for Miller Engineering as the main communication interface between the Owner, the design team, contractors and end users.

Project Role: Relationship Manager - Primary Point of Contact

- Engineer in Responsible Charge
- Design and Project Management of Mechanical, Electrical, Plumbing Projects
- Concept and Construction Design
- Business Operations and Financial Management Oversight
- Quality Assurance and Control

Professional Project Highlights

- WVU Recreation Center Indoor Pool – Owner’s Engineer
- WVU Life Sciences Building and Student Recreation Center – Owner’s Engineer
- Camp Virgil Tate
- Mapletown High School HVAC Replacement
- Advanced Surgical Hospital
- Holly River State Park Primary Electric Service Replacements Phase I & II
- Beech Fork State Park – MEP New Construction Design
- WVU Willowdale Walkway

Professional History

2003- Present	Miller Engineering, Inc.	President, Relationship Manager
2002-2003	Casto Technical Services	Existing Building Services Staff Engineer
2001-2002	Uniontown Hospital	Supervisor of Engineering
1995-2001	West Virginia University	Staff Engineer
1990-1995	BOPARC	Caretaker – Krepps Park
1983-1988	University of Charleston	Electrician/HVAC Mechanic

Education

1995	West Virginia University	BS- Mechanical Engineering
1988	University of Charleston	BA- Mass Communications

Licenses and Certifications

- Professional Engineer (West Virginia, Pennsylvania, Maryland, and Ohio)
- Licensed Master Plumber
- LEED-AP Certified



Travis Taylor, PE

Experience in project management facilitates Travis's ability to create and design constructible projects. Prior to joining the Miller Engineering team he was directly responsible for managing \$10 million in electrical construction budgets. His experiences encompass both new construction and renovation. Travis maintains professional competencies by attending seminars and continuing education classes. As lead engineer he provides HVAC, mechanical, plumbing and electrical design solutions and services for our clients. In addition, he is part of our team's complete assessment process in both

planning and MEP design through construction administration.

Project Role: Lead MEP Engineer

- *Design of Mechanical, Electrical, and Plumbing Systems*
- *Constructible Materials Evaluation*
- *Site Evaluation and Mechanical System Review*
- *Submittal and RFP Review*
- *RFI Coordination, Review, and Response*
- *Construction Observation*

Professional Project Highlights

- Krepps Park ADA Upgrades
- Holly River State Park Primary Electric Service Replacements Phase I & II
- Beech Fork State Park Lodge Design Development
- Pipestem Lodge McKeever Lodge HVAC Piping Replacement
- WV Veterans Memorial Restoration
- Bobtown Elementary School HVAC Upgrades

Professional History

2011-Present	Miller Engineering, Inc.	Staff Engineer
2006-2011	Tri-County Electric, Co.	Project Manager
2006-2006	Schlumberger	Field Engineer Trainee - MWD

Education

2006 West Virginia University, BS – Mechanical Engineering

Licenses and Certifications

- Professional Engineer - State of West Virginia
- OSHA 10-hour Course: Construction Safety & Health



Jack Jamison

Jack brings 15 years as an electrical/building inspector and over 25 years of experience in the commercial electrical construction industry. His knowledge and experience are valuable resources to Miller's complete assessment process.

Project Role: Code and Construction Specialist

- *Facility Review, Code Research, and Project Evaluation*
- *Field Observations and Issue Resolutions*

Professional Project Highlights

- Board Member of the WV Code Officials
- Founder and Secretary of the West Virginia Division of the International Association of Electrical Inspectors
- IAEI Ohio Chapter – Membership Chair

Professional History

2010- Present	Miller Engineering, Inc.	Code and Construction Specialist
1999-2010	Megco Inspections	Chief Inspector
1972-1998	Jamison Electrical Construction	Master Electrician

Education

1971 Fairmont State College, BS-Engineering Technology-Electronics

Licenses and Certifications

- Master Code Professional, IAEI Master Electrical Inspector, Class C Electrical Inspector – WV, PA, MD, & OH
- ICC Commercial Building, Building Plans, Commercial Plumbing, Residential Energy, and Accessibility Inspector/Examiner
- WV Master Electricians License
- NCPCCI-2B, 2C, 4B, 4C: Electrical & Mechanical General/Plan Review
- OSHA 30 Hour Course: General Industry
- NFPA Code Making Panel 14 – NEC 2014 Edition



ALPHA EXPERIENCE

Interior Design | Office Space

Case Study-Office Spaces

Monongalia County Sheriff Office; WV State Office Building-Clarksburg

Office space conjures a series of offices, each with a door and desk and a chair. Sometimes, all that is required is space. Well thought out interior design allows the space to become user friendly. Beyond finishes and textures; the space; and how people use it and move through the area is further defined by the furnishings in place. In the modern office building, most are familiar with the terms; cube farm, open office, open concept, etc. In these open areas, acoustical privacy can be enhanced by the fabric textured panels that are part of the open office furnishings. (See lower left)

Office space also demands places for groups; large and small; to meet, discuss, argue and decide important matters of the day. Those spaces become conference rooms, class rooms, huddle spaces, etc. Those spaces function best when the furnishings are mobile. Tables and chairs can be rearranged for a formal conference setting, classroom lecture setting, etc. The conference room shown on the left side is furnished with chairs and tables that both are stackable and mobile with wheels.

Some office spaces demand custom creations from milled casework. The photo upper right shows, custom counters adapted to the configuration of the space, wrapping around a column, and providing an overhead hutch that accommodates the various forms, and books, etc. needed for the specific space.

Working with open office furnishings (see upper left) specific requirements; (in this case; providing a semi-private "report" space for local deputies) can be met; that would also allow future growth in the activity.

Interior designers involved with the furnishings and the finish selection, along with the architect can achieve a well-designed space that is coordinated with color, finish and texture, as well as be designed for the end user's needs.





ALPHA EXPERIENCE

U.S. Coast Guard Operations Center | Various

Engineering Case Study

**U.S. Coast Guard Operations
Systems Center**
Martinsburg, WV

Working with DMJM Architects, Alpha Associates, Incorporated provided site and civil engineering services for this 75,000-square foot building.

Services included parking lot design, site grading, site mapping, surveying, drainage design, sewer and water connections and storm water management. Alpha's staff also provided all necessary paperwork for the County's Planned Unit Development process.

Alpha also provided drawings for the following:

- Site Plan for Generator #2 and #3
- Conversion of existing Generator Room to Electrical Room

Project Contact:

Mr. Ken Lowe
Panhandle Venture II
233 Lowe Drive
Shepherdstown, WV 25443
304-870-7001

At a Glance

CLIENT: U.S. Coast Guard Operations Systems
LOCATION: Martinsburg, WV
COMPLETION DATE: Various
SIZE: 75,000 sq. ft.
CONSTRUCTION COST: Multiple Projects



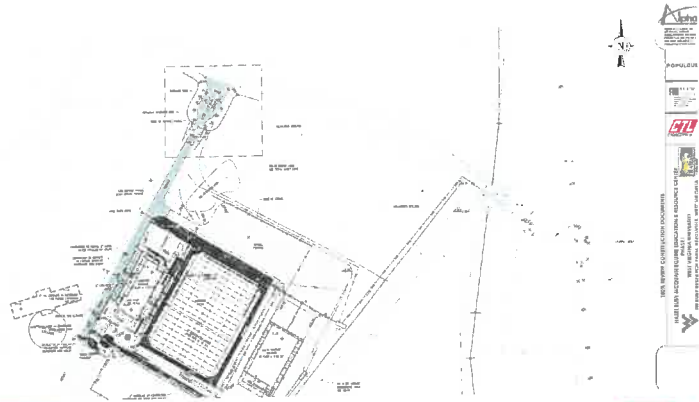

ALPHA EXPERIENCE

Hazel Ruby McQuain Equine Education & Research Center est. 2017

Engineering Case Study

WVU Reedsville Farm Redevelopment
Reedsville, WV

The West Virginia University Reedsville Farm is operated by the WVU Davis College partnered with WVU Extension Services and is home to the Extension Service Equine Arena. Alpha is the lead architect and project engineer for this project, partnering with POPULOUS, world-renowned in equine facilities to assist with design.

The goal of this project was to redevelop the farm as the Hazel Ruby McQuain Equine Education & Research Center with state-of-the-art facilities to increase student and stakeholder opportunities, enabling the equine studies program to flourish.

The project included:

- Design of a new gateway to improve appearance and identity along main road
- Addressing site and infrastructure issues
- Elevate and improve existing outdoor arena
- Design a new 11,500 sq. ft. Multipurpose Building
- Design a new 8,200 sq ft. Education & Research Center with dormitory rooms and facilities', offices, and classrooms
- Construct new Welcome/Honor/Gathering Plaza with vertical tower element incorporating donor plaques
- Master Planning which includes future horse barn, expanded multipurpose building, pasture improvements, RV Hookups, maintenance facilities, and further renovation of existing facilities

Project Contact:

Scott Owen
179 Rawley Lane
PO Box 6572
Morgantown, WV 26506
304-290-6613

At a Glance

CLIENT: WVU
LOCATION: Morgantown, WV
COMPLETION DATE: 2017
SIZE: 8.5 acres
CONSTRUCTION COST: \$6.5 Million





ALPHA EXPERIENCE

Alumni Center Parking Lots | 2008

Engineering Case Study

West Virginia University Alumni Center Parking Lots / Demolition Morgantown, WV

Alpha Associates provided surveying, civil engineering, and construction administration services for the West Virginia University Alumni Center Parking Lots Project. This project provided 200 controlled access, paved parking spaces adjacent to the new WVU Alumni Center, lighting, storm water controls, and other related appurtenances.

Alpha's civil engineering components included: building demolition, site grading, storm water management, utility design, and storm drain design. Alpha coordinated the project with the Morgantown Utility Board, the City of Morgantown, and all local utility companies.

Also included in this construction package was the demolition of two existing apartment buildings. Alpha provided engineering for the removal of the buildings and coordination of environmental remediation services.

Project Contact:
Paul Hanko
PO Box 4269
Morgantown, WV 26504
304-293-4731

At a Glance

CLIENT: WV Alumni Association
LOCATION: Morgantown, WV
COMPLETION DATE: 2008
SIZE: 200 spaces
CONSTRUCTION COST: \$997,000





ALPHA EXPERIENCE

R.E. Michel Building | 2006

Architectural Case Study

R.E. Michel Building
Morgantown, WV

Alpha Associates, Incorporated provided Civil/Site Design, Structural Design, Surveying, and Stormwater Management for the new R.E. Michel Building to replace the building vacated in the Research Park Construction. Alpha also completed architectural drawings to be submitted for permit approval. This 11,000 square foot metal building was completed in 2006.



Project Contact:

WVU Research Corporation
888 Chestnut Ridge Road
Morgantown, WV 26506
304-293-3449

At a Glance

CLIENT: WVU Research Center
LOCATION: Morgantown, WV
COMPLETION DATE: 2006
SIZE: 11,000 sq. ft.
CONSTRUCTION COST: \$1 Million



Project Experience: HVAC Upgrade

**West Virginia State
Building 36 (1 Davis Sq.)**
Charleston, WV

Services Provided:

- HVAC System Replacement
- Mechanical Piping
- Electric
- Construction Administration

Estimated Budget: \$2.1M

Facility Area: 58,400 ft²

**Owner: State of West Virginia –
General Services Division**



The 30-plus year old chiller serving Building 36 failed in the spring of 2016. MEI was retained to design the installation of a temporary rental chiller, which remains in service at this time. MEI was then retained to design a full HVAC retrofit to the building due to the condition of the air handlers, ductwork, VAV boxes, and associated systems. The building presented unique challenges as it was originally two buildings in which the common space was later in filled to create one building. The deck to deck heights in some areas are very limited, resulting in the need for accurate evaluation, design, and detailing in the construction documents. MEI designed a phased approach to accomplish the project. The phasing was developed directly with the owner to minimize the impact on the building occupants; who had to relocate to swing space phase by phase. Instead of just replacing the existing system in-kind, MEI designed a system utilizing three rooftop units ducted vertically through the building, which eliminates the sole source failures that have plagued the system for several years. The project is ready for bid at this time.

Project Contact:
*David Parsons, Operations and
Maintenance Manager
State Capitol, Room E-119
(304) 957-7122*



STATE BOARD OF REGISTRATION FOR PROFESSIONAL ENGINEERS

To all to whom these presents shall come, Greeting

Know Ye That The State Board of Registration for Professional Engineers, of the State of West Virginia, reposing special confidence in the Intelligence, Integrity and Discretion of

Charles B. Branch

Does, IN PURSUANCE OF AUTHORITY VESTED IN IT

by law, hereby certify that he, having submitted satisfactory evidence of his ability and experience, is a

REGISTERED PROFESSIONAL ENGINEER

Registration Number [Redacted]

To hold and use such title in the practice of his profession, subject to the conditions prescribed by law.



Given under the hand and the Seal of the Board at the Capitol in the City of Charleston, this 18th day of February in the year of our Lord 2002 and of the State the One Hundred Thirty-Eighth

STATE BOARD OF REGISTRATION FOR PROFESSIONAL ENGINEERS

[Signature]

By Frank D. Goddy

[Signature]

[Signature]

[Signature]



STATE BOARD OF REGISTRATION FOR PROFESSIONAL ENGINEERS

To all to whom these presents shall come Greeting
"Know Ye" That The State Board of Registration for Professional Engineers
of the State of West Virginia, reposing special confidence in
the Intelligence, Integrity and Discretion of

Bradley H. Casdorff

DOES IN PURSUANCE OF AUTHORITY VESTED IN IT

by law hereby certify that he having submitted
satisfactory evidence of his ability and experience is a

REGISTERED PROFESSIONAL ENGINEER

Registration Number [REDACTED]

"To Hold" and use such title in the practice of his profession,
subject to the conditions prescribed by law.



Given under the hand of the
Seal of the Board at the Capitol in the
City of Charleston,
This 29th day of December
in the year of our Lord 2005
and of the State
the One Hundred Forty-Second

Members of the Board

James D. Thomas, Jr. *Richard E. Dlyna*

Blair S. Salje *William E. Viersen* _____



STATE BOARD OF REGISTRATION FOR PROFESSIONAL ENGINEERS

To all to whom these presents shall come, Greeting

Know Ye That The State Board of Registration for Professional Engineers, of the State of West Virginia, reposing special confidence in the Intelligence, Integrity, and Discretion, of

Richard A. Colebank

DOES, IN PURSUANCE OF AUTHORITY VESTED IN IT

by law, hereby certify that he, having submitted satisfactory evidence of his ability and experience, is a

REGISTERED PROFESSIONAL ENGINEER

Registration Number [REDACTED]

To hold and use such title in the practice of his profession, subject to the conditions prescribed by law.



Given under the hand and the Seal of the Board, at the Capitol in the City of Charleston this 25th day of Feb. in the year of our Lord One Thousand Nine Hundred and Eighty Eight and of the State the One Hundred Twenty-Fourth.

STATE BOARD OF REGISTRATION FOR PROFESSIONAL ENGINEERS

Frank Gaddy

Secretary
Kenneth H. Means

By
Maud P. Jickson President
Robert Scott



STATE BOARD OF REGISTRATION FOR PROFESSIONAL ENGINEERS

To all to whom these presents shall come Greeting
"Know Ye" That The State Board of Registration for Professional Engineers
of the State of West Virginia, reposing special confidence in
the Intelligence, Integrity and Discretion of

Matthew T. Echard

DOES IN PURSUANCE OF AUTHORITY VESTED IN IT

by law hereby certify that he having submitted
satisfactory evidence of his ability and experience is a

REGISTERED PROFESSIONAL ENGINEER

Registration Number [REDACTED]

"To Hold" and use such title in the practice of his profession,
subject to the conditions prescribed by law.



Given under the hand of the
Seal of the Board at the Capitol in the
City of Charleston,
This 17th day of August
in the year of our Lord 2012
and of the State
the One Hundred Forty-Ninth

Members of the Board

James D. Thomas, Jr. Richard Edlyne

Bhajan S. Singh William E. Jensen

The Board of Architects



of West Virginia.

No. [REDACTED]

This Certifies that Rebecca Jean Key of Baltimore
in the State of Maryland, having successfully passed an examination
before the Board of Architects of the State of West Virginia, and being
otherwise qualified, is hereby authorized to practice Architecture in all its
branches in the State of West Virginia.



Witness the signatures of the President and Secretary of the Board of
Architects of West Virginia and the seal of said Board, this 26th
day of September 1994

Will. E. Johnson President.
F. J. Smith Secretary.



STATE BOARD OF REGISTRATION FOR PROFESSIONAL ENGINEERS

To all to whom these presents shall come, Greeting

Know Ye That The State Board of Registration for Professional Engineers, of the State of West Virginia, reposing special confidence in the Intelligence, Integrity, and Discretion, of

Charles B. Luttrell

DOES, IN PURSUANCE OF AUTHORITY VESTED IN IT

by law, hereby certify that he, having submitted satisfactory evidence of his ability and experience, is a

REGISTERED PROFESSIONAL ENGINEER

Registration Number [REDACTED]

to hold and use such title in the practice of his profession, subject to the conditions prescribed by law.



Given under the hand and the Seal of the Board at the Capitol in the City of Charleston this 28th day of July in the year of our Lord One Thousand Nine Hundred and Ninety-nine and of the State the One Hundred Thirty-sixth.

STATE BOARD OF REGISTRATION FOR PROFESSIONAL ENGINEERS

Handwritten signatures: G. R. Kelly, Frank A. Kelly, and W. B. Faulkner.

CERTIFICATE OF *Authorization*

STATE BOARD OF REGISTRATION FOR PROFESSIONAL ENGINEERS

*The West Virginia State Board of Registration for Professional Engineers
having verified the person in responsible charge is registered in
West Virginia as a professional engineer for the noted firm, hereby certifies*

ALPHA ASSOCIATES, INC.

C00012-00

Engineer in Responsible Charge: RICHARD A COLEBANK - WV PE 010346

*has complied with section §30-13-17 of the West Virginia Code governing
the issuance of a Certificate of Authorization. The Board hereby notifies you of its
certification with issuance of this Certification of Authorization for the period of:*

January 1, 2018 - December 31, 2019

providing for the practice of engineering services in the State of West Virginia.

IF YOU ARE REQUIRED TO REGISTER WITH THE SECRETARY OF STATE'S OFFICE
PLEASE SUBMIT THIS CERTIFICATE WITH YOUR APPLICATION.



IN TESTIMONY WHEREOF, THE WEST VIRGINIA STATE BOARD OF
REGISTRATION FOR PROFESSIONAL ENGINEERS HAS ISSUED THIS COA
UNDER ITS SEAL, AND SIGNED BY THE PRESIDENT OF SAID BOARD.

BOARD PRESIDENT

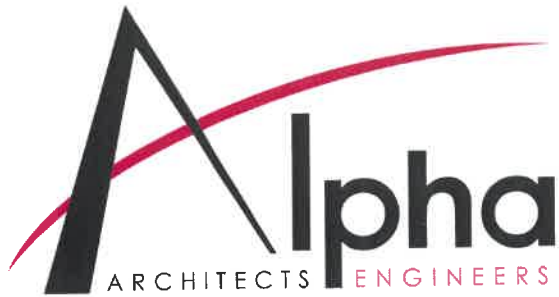

Jim King
WV Higher Education Policy Council
1018 Kanawha Boulevard, East, Suite 700
Charleston, WV 25301-2800
304-558-0281 ext. 206

Bill Clark, Executive Director
Region 9 Planning and Development Council
400 West Stephen Street Suite 301
Martinsburg, West Virginia 25401
304-263-1743

David Hildreth
State of West Virginia
1409 Greenbrier Street
Charleston, WV 25305
304-558-0510

Dirar Ahmad
West Virginia Division of Highways
Building 5
1900 Kanawha Blvd., East
Charleston, WV 25305-0430
304-558-2830

Damien Davis, City Engineer
City of Morgantown
389 Spruce Street
Morgantown, WV 26505
304-284-7412

REFERENCES

"Alpha Associates have a proven record of customer satisfaction and successful client delivery with our organization. We would be confident in our recommendation in support of Alpha."

J. Paul Walden
West Virginia University

Every aspect and detail of your planning, coordination, and completed projects have been exceptional and outstanding in every regard.

Robert Hammel, Former Director
Morgantown Municipal Airport