

Expression of Interest Renovations and Upgrades for Various Projects

CEOI DPS1600000001

West Virginia State Police



WilliamsonShriverArchitects

05/05/16 11:53:13
WV Purchasing Division

STATE OF WEST VIRGINIA
Purchasing Division

PURCHASING AFFIDAVIT

MANDATE: Under W. Va. Code §5A-3-10a, no contract or renewal of any contract may be awarded by the state or any of its political subdivisions to any vendor or prospective vendor when the vendor or prospective vendor or a related party to the vendor or prospective vendor is a debtor and: (1) the debt owed is an amount greater than one thousand dollars in the aggregate; or (2) the debtor is in employer default.

EXCEPTION: The prohibition listed above does not apply where a vendor has contested any tax administered pursuant to chapter eleven of the W. Va. Code, workers' compensation premium, permit fee or environmental fee or assessment and the matter has not become final or where the vendor has entered into a payment plan or agreement and the vendor is not in default of any of the provisions of such plan or agreement.

DEFINITIONS:

"Debt" means any assessment, premium, penalty, fine, tax or other amount of money owed to the state or any of its political subdivisions because of a judgment, fine, permit violation, license assessment, defaulted workers' compensation premium, penalty or other assessment presently delinquent or due and required to be paid to the state or any of its political subdivisions, including any interest or additional penalties accrued thereon.

"Employer default" means having an outstanding balance or liability to the old fund or to the uninsured employers' fund or being in policy default, as defined in W. Va. Code § 23-2c-2, failure to maintain mandatory workers' compensation coverage, or failure to fully meet its obligations as a workers' compensation self-insured employer. An employer is not in employer default if it has entered into a repayment agreement with the Insurance Commissioner and remains in compliance with the obligations under the repayment agreement.

"Related party" means a party, whether an individual, corporation, partnership, association, limited liability company or any other form or business association or other entity whatsoever, related to any vendor by blood, marriage, ownership or contract through which the party has a relationship of ownership or other interest with the vendor so that the party will actually or by effect receive or control a portion of the benefit, profit or other consideration from performance of a vendor contract with the party receiving an amount that meets or exceeds five percent of the total contract amount.

AFFIRMATION: By signing this form, the vendor's authorized signer affirms and acknowledges under penalty of law for false swearing (W. Va. Code §61-5-3) that neither vendor nor any related party owe a debt as defined above and that neither vendor nor any related party are in employer default as defined above, unless the debt or employer default is permitted under the exception above.

WITNESS THE FOLLOWING SIGNATURE:

Vendor's Name: WILLIAMSON SHRIVER ARCHITECTS, INC.

Authorized Signature: [Signature] Date: 4/21/2016

State of West Virginia

County of Kanawha, to-wit:

Taken, subscribed, and sworn to before me this 21 day of April, 2016.

My Commission expires September 17, 2018.

AFFIX SEAL HERE

NOTARY PUBLIC

[Signature: Lori A. Phillips]
Purchasing Affidavit (Revised 07/01/2012)

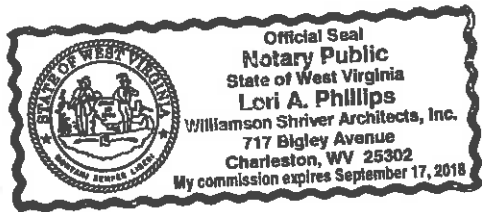

CERTIFICATION AND SIGNATURE PAGE

By signing below, or submitting documentation through wvOASIS, I certify that I have reviewed this Solicitation in its entirety; that I understand the requirements, terms and conditions, and other information contained herein; that this bid, offer or proposal constitutes an offer to the State that cannot be unilaterally withdrawn; that the product or service proposed meets the mandatory requirements contained in the Solicitation for that product or service, unless otherwise stated herein; that the Vendor accepts the terms and conditions contained in the Solicitation, unless otherwise stated herein; that I am submitting this bid, offer or proposal for review and consideration; that I am authorized by the vendor to execute and submit this bid, offer, or proposal, or any documents related thereto on vendor's behalf; that I am authorized to bind the vendor in a contractual relationship; and that to the best of my knowledge, the vendor has properly registered with any State agency that may require registration.

WILLIAMSON SHRIVER ARCHITECTS
(Company)

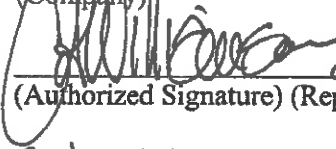
 GREGORY A. WILLIAMSON, PRESIDENT
(Authorized Signature) (Representative Name, Title)

304.345.1060 304.345.3693 4/21/2016
(Phone Number) (Fax Number) (Date)

ADDENDUM ACKNOWLEDGEMENT FORM
SOLICITATION NO.: CEOI DPS160000001

Instructions: Please acknowledge receipt of all addenda issued with this solicitation by completing this addendum acknowledgment form. Check the box next to each addendum received and sign below. Failure to acknowledge addenda may result in bid disqualification.

Acknowledgment: I hereby acknowledge receipt of the following addenda and have made the necessary revisions to my proposal, plans and/or specification, etc.

Addendum Numbers Received:

(Check the box next to each addendum received)

- | | |
|--|--|
| <input checked="" type="checkbox"/> Addendum No. 1 | <input type="checkbox"/> Addendum No. 6 |
| <input checked="" type="checkbox"/> Addendum No. 2 | <input type="checkbox"/> Addendum No. 7 |
| <input type="checkbox"/> Addendum No. 3 | <input type="checkbox"/> Addendum No. 8 |
| <input type="checkbox"/> Addendum No. 4 | <input type="checkbox"/> Addendum No. 9 |
| <input type="checkbox"/> Addendum No. 5 | <input type="checkbox"/> Addendum No. 10 |

I understand that failure to confirm the receipt of addenda may be cause for rejection of this bid. I further understand that that any verbal representation made or assumed to be made during any oral discussion held between Vendor's representatives and any state personnel is not binding. Only the information issued in writing and added to the specifications by an official addendum is binding.

WILLIAMSON SHRIVER ARCHITECTS

Company

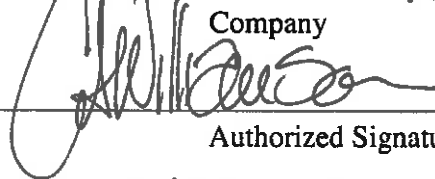

Authorized Signature

5/5/2016

Date

NOTE: This addendum acknowledgment should be submitted with the bid to expedite document processing.



April 21, 2016

Project Manager
West Virginia State Police
725 Jefferson Road
South Charleston, WV 25309

RE: Architectural and Engineering Services Statement of Qualifications
Renovations and Updates at Various Facilities

Greetings!

Williamson Shriver Architects, Inc. was excited to learn of the West Virginia State Police's current Request for Statement of Qualifications for Architectural and Engineering services for design and construction administration for the above referenced project. We are pleased to have an opportunity to submit our team's experience and credentials for your consideration.

Williamson Shriver Architects' six person staff combines for over 120 years of experience on architectural design projects located throughout West Virginia. Our firm, along with our selected team members, have established practices in place to ensure that your project is completed successfully – on time and within budget. Our knowledge, skills, and talents have been proven over and over throughout our firm's history. Our portfolio includes project of all sizes and scopes of work, from roofing replacement to door and window replacement, and from renovations to new buildings. We are confident that you will find our team more than qualified to provide design services for each of your proposed projects.

Please accept this letter as our team's Expression of Interest in serving as your design team for this exciting project. Our proposed project team will include the following:

- **Williamson Shriver Architects**, Charleston, WV - Architectural and structural design
- **Harper Engineering**, St. Albans, WV – HVAC, electrical, and plumbing design
- **Terradon Corporation**, Nitro, WV – Site, civil, and utility engineering

Our team has worked together on many past projects. We jointly have a strong understanding of costs, constructability, materials availability, and the economy of construction in the different regions of West Virginia, as well as project document preparation across a shared Revit software platform. Our workload is, at this time, such that we can easily accommodate your complete list of proposed projects.

In conclusion, please find enclosed our Statement of Qualifications outlining our history, experience, and qualifications for all team members to assist you in your evaluation. We are eager to be selected to work with the WV State Police in designing this project and look forward to a personal interview with your selection team during which we can present our credentials in greater detail.

RFP for A/E Services
WV State Police
April 21, 2016

Page 2

Sincerely,

WILLIAMSON SHRIVER ARCHITECTS, INC.

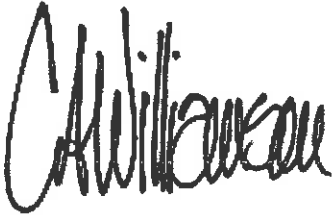
A handwritten signature in black ink, appearing to read "G. Williamson". The signature is stylized and cursive.

Gregory A. Williamson AIA • LEED AP
President / Architect

Contents

General information Introduction of our team & services we provide	Tab A
Project approach Our team's philosophy, culture, & process	Tab B
Personnel Backgrounds of the individuals on our team	Tab C
Design Experience Our team's extensive design background	Tab D
References Contact information for current & past clients	Tab E
Harper Engineering Mechanical and Electrical Engineering	Tab F
Terradon Corporation Site, civil, and utility design	Tab G

Tab A

General Information



Williamson Shriver Architects

General Information

Firm Overview

Williamson Shriver Architects Inc. is an award-winning, multi-disciplinary design firm with business roots back to 1967. While specializing in educational and commercial planning and design, we provide design services to a diverse client base throughout West Virginia. With construction values exceeding one billion dollars over our history, the size and scale of our projects have ranged from detailed designs for small interior

renovations to large multi-million dollar new facilities. Large or small, simple or complex, every project has our commitment to diligent, thoughtful design. Our functional and distinctive buildings reflect the vision of our clients and the spirit of our communities.

Experienced, capable, and responsive, we have a long tradition of excellence and client commitment. Simply put ... we listen ... and combine what we learn from

listening with a clear understanding of technology, sustainability, and a wealth of experience. Every Williamson Shriver Architects design is a collaboration with the end user. Our finished projects work for people because they start with people. Through focus groups, individual interviews, and public meetings, we ask our clients to stretch their imagination and anticipate how they will

use each space. The result of this process ... flexible design solutions that respond to people and

make the most of budgets.

Commitment to quality, dedication to project and client, and a nearly fifty year tradition of innovation and architectural excellence... that's Williamson Shriver Architects. No matter what the program, site, or budget, we've been there and we have the experience and vision to shape your project into a success.

At Williamson Shriver Architects, we're listening.

THE VISION OF
OUR CLIENTS AND
THE SPIRIT OF OUR
COMMUNITIES.



In House Services

- Pre-Design & Planning
- Architecture
- Structural Engineering
- Interior Design
- Construction Procurement / Administration
- Cost Estimating
- Sustainable Design

Services through Partners

- Site and Civil Engineering
- Landscape Design
- Historic Review and Preservation
- Mechanical Engineering
- Electrical Engineering
- Lighting Design
- Technology and Security Design
- Audio / Visual Design
- Acoustical Design



Tab B

Project Approach



WilliamsonShriver**Architects**

Project Approach & Understanding

Design Management

Williamson Shriver Architects is a mid-sized firm but with a small-firm attitude of personal service to our clients. Partners Greg Williamson and Ted Shriver, are actively involved in all aspects of all the firm's projects from concept to completion. To ensure consistency of quality design, all planning and design concepts originate under the direct supervision of the partners.

On this WV State Police project, architect Greg Williamson will be the Partner-in-Charge and will directly oversee all design activities as well as be the main point of contact with the Owner. Directly under Mr. Williamson's leadership, Greg Martin will serve as Project Manager, and will be assigned with the responsibility to produce documents and specifications based upon the design as well as to coordinate all team member activities and contributions to the project.

For site/civil and mechanical/electrical engineering services on this project, Williamson Shriver Architects will team with two consulting firms specifically selected to provide the most comprehensive, highest quality specialty services relating to this project.

• Terradon Corporation, of Nitro WV, specializing in site / civil engineering and utilities design consulting services.

• Harper Engineering, a St. Albans, WV consulting engineering firm who will provide HVAC, electrical, plumbing and fire protection design services.

We have worked with these two firms for many years on numerous projects throughout the state, and we have established common workflow processes in place to ensure that these services are seamless from the Owner's point of view.

Interactive Design / Programming Process

We believe that good design comes from good listening. We continually stress the importance of involving the building users throughout the design process and facilitating their input into the final program and design. This starts with the schematic "big picture" design concepts and continues all the way through the process to interior design and furniture selection. This is accomplished through a variety of methods tailored to the scope of

work and includes presentations, design charrettes, interior and exterior 3D concept modeling, and general discussions and feedback. We believe that our track record of highly successful renovation projects is directly attributable to this inclusive and interactive process.

For this project with the WV State Police, we will meet numerous times with the project manager(s) for each project to determine the complete scope, initially at the site of the existing facilities. We will also meet with other appropriate individuals as needed to understand the facility, operations, and/or maintenance issues and concerns. We will request existing drawings of the buildings, if available, in order to gain an understanding of the existing conditions and construction types for each facility. All of the information gained from these meetings will be summarized in a written program defining the scope of the work and provided to the Owner's representatives for verification.

At right: Exterior view of Williamson Shriver Architects office which was an adaptive re-use and complete renovation of an empty, non-descript commercial structure on Charleston's West Side completed in 2001.



As part of this process, we will develop cost estimates using our knowledge of the WV bidding climate and market conditions. Supporting our costing efforts, if requested by the Owner, we will retain a local cost consultant (Winfield Strock, former owner of Kenhill Construction in Charleston WV) when warranted based upon project complexity or when extensive or complicated phasing is involved. This will provide greater assurance to the Owner of certainty of the cost of the proposed project scope prior to bidding.

Design Schedule

Upon meeting with the owner's team to discuss the goals of the various projects, a master project schedule will be prepared to reflect all of the work tasks for the project organized by design phase and showing timelines and milestone dates for all tasks including construction and completion timeframes. We will also show the organization/individual responsible for the task. It will be organized as a horizontal bar chart. The schedule will be tested at critical intervals and measures taken to assure the schedule is maintained. Work efforts are tested against progress so that potential conflicts and delays can be detected quickly and appropriate action taken immediately to preserve scheduled milestones.

Project Approach & Understanding

Continued

Quality Control

Cost Control

It is vitally important that the project budget, program and outcome expectations are compatible from the outset. Once the initial project budget and project scope is established and agreed upon, all future cost estimates and design decisions will be measured against that budget and program. As indicated herein, further cost evaluation will be performed at the completion of schematic and design devel-

WE CONTINUALLY
STRESS THE IMPORTANCE
OF INVOLVING THE
BUILDING USERS IN THE
DESIGN PROCESS AND
FACILITATING THEIR
INPUT.

opment drawings, and at 75% completion of contract drawings. Between formal estimates, the design team is constantly evaluating design and materials/specification alternatives in an on-going effort to achieve the project goals in a cost effective manner and to maximize the value of the funds available for the project.

Design Technology

All of our major consultants use Autodesk Revit, a Building Information Modeling (BIM) software product. As a result, BIM will be utilized throughout the design process. Well beyond tradi-

tional drafting software, BIM is a more holistic approach to building design and culminates in an electronic 3-dimensional model of the building and contains 'intelligent' components. This product is not only a valuable production tool for the design team, but also offers several benefits to the Owner. For example, it's 'clash detection' capabilities offer better technical control of the coordination between work of multiple disciplines, reducing the number of potential change orders during construction. The software also allows for enhanced clarity of contract documents, and provides a potential facilities management benefit for clients through the manipulation of the intelligent components contained within the model. Williamson Shriver Architects was among the first architectural firms in West Virginia to routinely utilize BIM software on our projects.

Quality Management

Williamson Shriver Architects is proud of our success rate for meeting tight project budgets with a low incidence of construction change orders. We believe that this success stems largely from the retention rate of our long-term staff and selection of consultants that are highly specialized in the type of project being designed.

We have several peer review steps in place to review Con-

Project Approach & Understanding

Continued

struction Documents prior to letting them out for bidding. These include a design partner coordination review, review by the Construction Administrator who has jobsite experience, and involvement of nearly all of our production staff in the preparation of technical specifications ... whether or not they are otherwise working on the project ... to assure that the documents are reviewed by a "fresh set of eyes". All of these steps taken together, eliminate most design errors before they make it out of our office.

As products and product applications are constantly changing, our staff and consultants are continually updated on new materials and methods of construction through both internal and outside seminars and programs.

Lastly, we utilize Building Information Modeling (BIM) software in our document production, which greatly reduces the potential for design errors.

Sustainable Design

Multiple members of Williamson Shriver Architects team are LEED Accredited Professionals with experience in a number of LEED Certified facilities, including Spring Mills Primary School, West Virginia's first newly constructed LEED Gold Building. Eastwood Elementary School has also received LEED Gold certification with a third LEED candidate school currently under

construction. However, whether or not LEED Certification is being sought, we believe that architects, engineers, designers have a duty to provide services in a sustainable manner - selecting materials and systems with respect to their impact upon environment as well as to minimize energy usage costs for our clients. Our team commits to bring this attitude to all aspects of this project.



Tab C

Personnel



WilliamsonShriver**Architects**

Project Staffing

	Name /Title /Years with Firm	Role in Project
	Greg Williamson AIA / LEED AP President / Architect 33 Years	Partner-in-charge/Design
	Ted Shriver AIA / LEED AP / REFP Vice-President / Architect 32 Years	Partner-in-charge/Quality Control / Business Manager
	Don Beyer PE Engineer / Production Manager 26 Years	Structural Design/Quality Control
	Greg Martin AIA Project Architect 7 Years	Design / Document Production / Consultant Coordination
	Andrew Crawford AIA Assoc. Intern Architect 6 Years	Document Production / Building Information Modelling Manager
	Lori Phillips Project Administrator 16 Years	Document Assembly / Submittals Manager / Project Administration

Resumes for these individuals can be found on the following pages.

Gregory A. Williamson

AIA / LEED AP / CEFP
Architect / Partner



Greg Williamson attended the University of Tennessee, where he received his bachelor of architecture degree in 1981. His professional career began at Sverdrup and Parcel and later with Donald L. Moses Associates, both in Charleston. In 1983 he joined Gandee Thomas and Sprouse as an architect and project designer and obtained his West Virginia registration as an architect in 1985.

commissions in Charleston, the United States Federal Court-house with architect SOM of New York City, and the Clay Center for the Arts and Sciences with KSK Architects of Philadelphia.

Mr. Williamson is a former member of the WV Board of Architects, appointed by Governor Underwood in 1999. He has active registrations in five states and is a holder of an NCARB certificate. Mr. Williamson is active in the WV Chapter of the American Institute of Architects and serves on several standing committees including the Scholarship Committee, the Architect/Contractors Task Force, and the WV Foundation for Architecture.

In his spare time, Mr. Williamson is a musician and songwriter and enjoys recording his original music in his home studio.

In 1994, along with Ted Shriver, Mr. Williamson acquired the firm from founder Kent Gandee. As design partner, Mr. Williamson has designed such prominent and well-received projects as the LEED Gold Spring Mills Primary School, Caperton Center for Applied Technology at WVU-Parkersburg, and the Lodge and Conference Center at Chief Logan State Park. Additionally, he represented Williamson Shriver Architects in their role as associated architect on two prominent

Education:

University of Tennessee, 1981
B. Architecture
West Virginia State College, 1978
Winfield (WV) High School 1976

Registration:

Architect, WV (██████████),
Architect, KY (██████████),
Architect, MD (██████████),
Architect, VA (██████████),
Architect, OH (██████████),
NCARB Certified (██████████)
Green Building Certification Institute
LEED Accredited Professional (AP)

Affiliations:

West Virginia Board of Architects 1999-2015
American Institute of Architects
AIA - WV Chapter
President 1994 & 1995
WV Foundation for Architecture
Trustee / Secretary 2007-present
Contractors Association of WV
Architects/Contractors Task Force
Assoc. for Learning Environments
Member
Certified Educational Facility
Professional (CEFP)
Putnam Co. Bd. of Zoning Appeals
Member - 1997 to 2001
US Green Building Council
Member

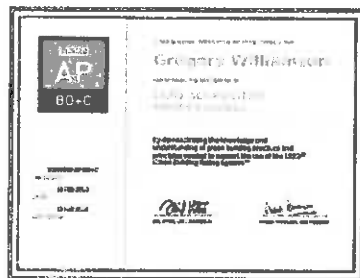
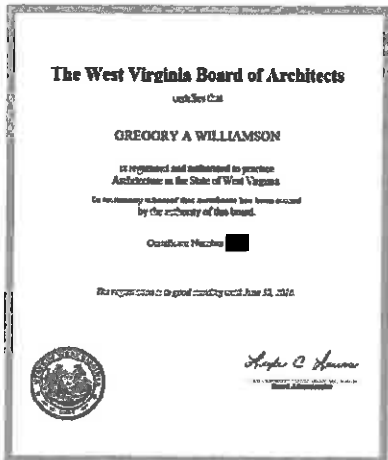

Ted A. Shriver
 AIA / LEED AP BD+C / CEFPI
 Architect / Partner



Ted Shriver is a registered architect and Vice-President of Williamson Shriver Architects. In addition to his role as firm partner, he is additionally responsible for the office-wide coordination and production of contract documents. He brings to the firm 30 plus years of architectural experience, and his primary responsibilities include assurance that appropriate production and support resources are applied to each project.

Mr. Shriver's career began in 1979 with other local firms, but he has been with the firm since 1984 with partner Greg Williamson.

Office management, marketing and construction administration on smaller scope projects add to his daily responsibilities. He

also oversees the firm's computer system, including evaluation and installation of new technology. He has extended this computer expertise to an understanding of the utilization and implementation of technology in school facilities and attends the Council of Educational Facility Planners' Technology Conferences. Since 2005, Mr. Shriver has focused on establishing guidelines for our designs on implementing safe schools and monitoring systems.

Mr. Shriver is active in the Council of Educational Facility Planners International especially in the Southeast Region. In 2003, he was one of the founding members of the West Virginia Chapter and served as their President from 2004-2007. He has also served as the Southeast Director since 2002.

Education:

Fairmont State College, 1979
 A.S. Architectural Technology
 South Charleston High School 1977

Registration:

Architect, WV (██████)
 Architect OH (██████)
 Architect MD (██████)
 Green Building Certification Institute
 LEED Accredited Professional
 (AP BD+C)

Affiliations:

West Virginia State Fire Commission
 2009-Present
 Code / Regulatory Committee, Chair
 2009-Present
 American Institute of Architects
 WV Chapter
 Executive Committee 2008-2013
 Treasurer 2008-2013
 Boone Career and Technical Center
 Advisory Council
 Council of Educational Facility Planners
 Int.
 Southeast Region
 Alternate Director 2002-2003
 Region Director 2003-Present
 Recognized Educational Facility
 Professional Certification (REFP)
 Contractors Association of WV
 Kanawha Valley Builders Association
 International Code Council
 National Fire Protection Association
 South Charleston Board of Health
 United States Green Building Council
 Building Codes Plan Examiner
 2015 - Present

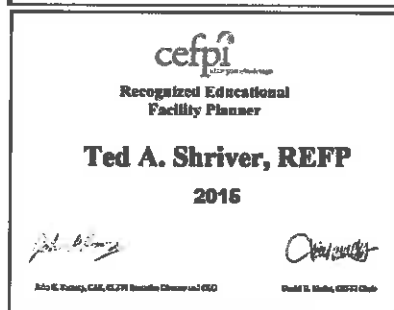
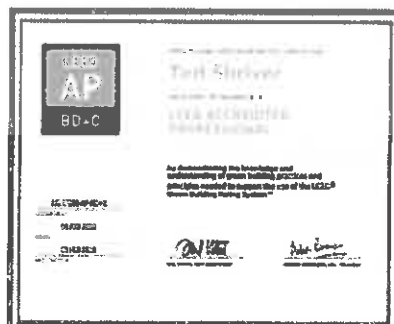
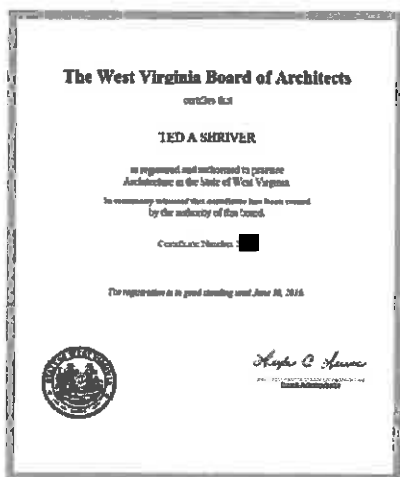

Donald W. Beyer

PE. / AIA Affiliate
Professional Engineer



With over twenty five years of tenure at Williamson Shriver Architects, Mr. Beyer is responsible for the coordination of structural design for all of the firm's projects, and personally designs the structural systems for most projects. He coordinates and integrates his design work with our in-house architectural designs as well as with mechanical and electrical engineering design performed by our consultants. He is also involved with the production of details and specifications for a project's structural systems and materials. Mr. Beyer's close involvement with the project architect provides for the smooth integration of the structural system into the project while maintaining the aesthetics of the

architect's design. His availability for immediate consultation is an asset to the design team. Mr. Beyer draws from his years of experience as a structural steel detailer, a structural draftsman, and engineering technician within the Charleston area.

In addition to his structural responsibilities, Mr. Beyer also serves as production coordinator for all project disciplines, ensuring that appropriate staff is in place to assure on-time completion of design work.

Mr. Beyer is an avid whitewater paddler, and currently sits on the WV Whitewater Commission, appointed by Governor Wise in 2005

Education:

WV Institute of Technology 1997
B. S. Civil Engineering
WV Institute of Technology 1978
A. S. Drafting & Design Eng. Tech.

Registration:

Professional Engineer, WV (██████)
Professional Engineer, PA (██████)
Professional Engineer, OH (██████)

Previous Employment:

Kelley, Gidley, Blair and Wolfe Engineers
1986 - 1990
W. C. Haworth, Structural Engineers
1984 - 1986
Union Carbide Corporation
1979 - 1983
West Virginia Steel Corporation
1978 - 1979

Affiliations:

American Society of Civil Engineers
American Institute of Architects
American Institute of Architects WV Chapter
Professional Affiliate Member

Certifications:

American Canoe Association
Swiftwater Rescue Instructor

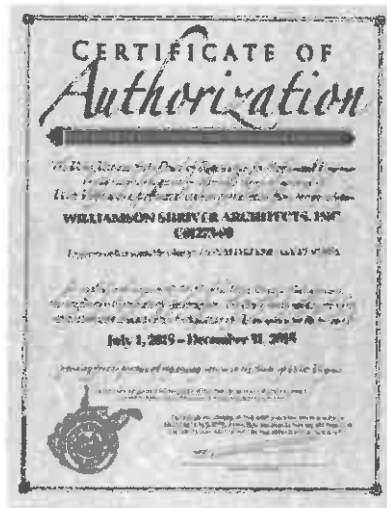
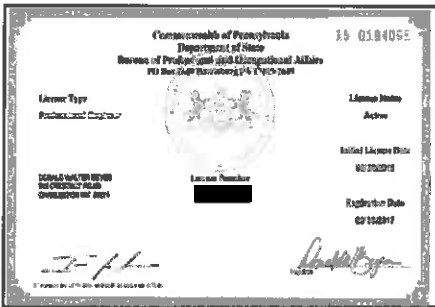

Gregory I. Martin

AIA

Project Architect

Greg Martin received his Masters of Architecture Degree from Virginia Polytechnic Institute and State University in 2008 after graduating from Fairmont State University in 2005. He began his professional career with Marks-Thomas Architects in Baltimore MD, and came to Williamson Shriver Architects in October of 2008. In early 2016, he successfully concluded his Architectural Registration Examination and became licensed to practice architecture in WV.

As Project Architect, he specializes in building design and

production / coordination of construction documents for projects of all types and sizes. His project portfolio with Williamson Shriver Architects includes Poca Elementary/Middle School, Leading Creek Elementary School, the Ronald McDonald House in Charleston, Little Creek Golf Course Clubhouse, and the LEED candidate Gilmer Elementary School which is currently under construction in Glenville.

In addition to his professional career, Mr. Martin is an accomplished craftsman, model maker, and sculptor in wood and other media.



Education:

Virginia Polytechnic Inst. & State Univ.
Master of Architecture - 2008
Fairmont State University
B. S. - Architectural Eng Tech - 2005

Registration:

Architect, WV (TBD),
NCARB Certified (TBD)

Previous Employment:

Marks-Thomas Architects
2008
Thomas Koontz Architect, P.C.
2006 (Summer Intern)
WYK Associates, Inc.
2003-2005

Affiliations:

American Institute of Architects
AIA Member
American Institute of Architects WV
Chapter

Andrew Crawford

AIA Associate

Intern Architect / Project Manager

Originally from St. Albans, WV, Andrew Crawford attended the University of Tennessee School of Architecture, completing his Bachelors of Architecture Degree in 2007. After graduating, he relocated to Nashville, Tennessee where he interned at Davis Stokes Collaborative.

Since joining Williamson Shriver Architects in 2010, Andrew has specialized in building design and production / coordination of construction documents for

projects of all types and sizes. He has served as project manager on many successfully completed projects included Teays River Station Office Building, East Hardy High School, Analabs Addition and Renovation and the Robert C. Byrd Health Science Center Renovation on the campus of Charleston Memorial Hospital.

In addition to his professional career, Andrew is an avid powerlifter.



Education:

University of Tennessee - Knoxville
B. Architecture - 2007

Previous Employment:

Davis Stokes Collaborative
Nashville TN 2008-2009

Studio Four Design
Knoxville, TN 2007-2008

Lori Phillips

Administrative Assistant / Submittals Manager

Lori Phillips has served as an administrative assistant for Williamson Shriver Architects for over sixteen years. Her project based responsibilities include, but are not limited to, development of contracts / agreements, project manual assembly, specifications, assistance with the bidding process, processing of bonds and insurance, construction cost monitoring, construction phase submittals, applications for payment processing and project closeout documentation.

As construction phase submittals manager, she maintains the electronic submittals log, assuring that action by staff and consultants is taken as expeditiously as possible.

In addition to these project based responsibilities, she also plays an essential primary role in preparation of educational planning documents such as annual updates and ten-year plans for numerous county school systems.



Education:

Fairmont State University
B. S. - Criminal Justice - 1992
(minor in Psychology)

Previous Employment:

Avis Rent A Car - Fleet manager
Wilmington NC 1998-1999

Federal Bureau of Investigation
Information Services Division
Fingerprint Examiner
Clarksburg WV 1997-1998

Tab D

Design Experience



WilliamsonShriver**Architects**

Civic Design



South Charleston Fire Station #1

Owner:
City Council of the
City of South Charleston
The Honorable Frank Mullins, Mayor
(304) 744-5300

Services provided in-house:
Architectural design
Structural design
Interior design

Services provided by consultants:
Site/Civil Design - Terradon Corp.
MEP Design - Harper Engineering

Constuction commence: 2015*
Year completed: 20016

Other data:
Size: 10,119 SF
Construction Cost: \$2.8 Million
Cost/SF: \$276.70 / SF



Description of Project:

This project is a replacement fire station facility for the City of South Charleston. For this station, the city requested a design in keeping with the high-tech chemical manufacturing facilities located nearby.

The design of this building includes three drive-thru apparatus bays, plus storage and maintenance spaces for firefighting operations. This area also includes a multi-story training space for learning vertical movement and

rescue.

The living quarters includes six sleeping berths, toilet / showers for male and female firefighters, shift commander's quarters and office, captain's quarters and office, and spaces for kitchen, dining, living, meeting/computer room, and laundry.

The building exterior features a sweeping curved metal roof, tri-color brick, and both smooth and corrugated metal wall panels.



Floor Plan Legend

1	Lobby	10	Bedroom
2	Living Room	11	Janitor
3	Office	12	Wash Station
4	Kitchen	13	Training Room
5	Meeting Room	14	Locker Room
6	Garage	15	Apparatus Bay
7	Reception	16	Office
8	S&S Commander	17	Garage
9	Captain's Quarters	18	Mechanical

Floor Plan
South Charleston
Fire Station #1

Below and right: Construction phase images of the South Charleston Fire Station taken in early February of 2016.



Business and Commercial Design



Carpenter's Training Center South Charleston, WV

Owner:
WV Carpenter's Local #1207

Services provided in-house:
Architectural design
Structural design
Interior design

Services provided by consultants:
MEP Design - Tower Engineering

Year completed: 2002

Other data:
Size: 7,500 SF
Cost: \$650,000



Description of Project:

Located adjacent to interstate 64 in South Charleston, this project was a new facility for the owner to train union members in current carpentry and building construction techniques.

Programmatic spaces within the building include a 4000 SF carpentry laboratory complete with appropriate equipment and a

partial plywood floor for anchoring projects, a large classroom, facility office / library, and storage and support spaces.

Business and Commercial Design



Beech Ridge Wind Farm Operations & Maintenance Facility

Greenbrier County, WV

Owner:
Invenergy, LLC

Services provided in-house:
Architectural design
Structural design
Interior design

Services provided by consultants:
MEP Design - Tower Engineering

Year completed: 2010

Other data:
Size: 6,120 SF
Cost: Withheld by Owner

Description of Project:

This newly constructed project, remotely located in Greenbrier County, consists of administrative offices, training space, control and technology spaces, and a maintenance bay for vehicles and wind turbine components.

The building is constructed of concrete walls using an insulated Concrete Form (ICF) construction system.

This project was a design-build project delivery approach jointly completed with contractor Agsten Construction of Charleston.

Business and Commercial Design



Teays River Station

Hurricane, WV

Owner:
Teays River Station LLC
Brian Prim
Managing Partner
Prim Law Firm, PLLC
(304) 201-2425

Services provided in-house:
Architectural design
Structural design
Interior design

Services provided by consultants:
MEP Design - Harper Engineering

Year completed: 2015

Other data:
Size: 6,500 SF
Cost: Withheld by Owner



The design concept for this multi-building development was to draw design features from the farmhouse vernacular and traditions of the historically agrarian Teays Valley, West Virginia community in which it resides.

Exterior features include a partial stone veneer and a striking complementary green wood veneer. These are set off by the traditional grey-silver metal roofing often found on farm buildings.

This initial building is a two

story office structure housing the development owner's law firm on the second floor with a tenant cardiac medical office on the ground level. Building two of this development is currently in design, and will feature a similarly detailed but larger office building placed perpendicularly on the site.

Williamson Shriver Architects was assisted by team members Triad Engineering (site / civil), Harper Engineering (MEP) and Laura Davis Interiors on this project.

Business and Commercial Design



International Coal Group / Arch Coal Office Building

Scott Depot, WV

Design-Builder:
G&G Builders, Inc.
Mike Davis, Project Manager
(304) 757-9196

Services provided in-house:
Architectural design
Structural design

Year completed: 2007

Other data:
Size: 52,000 SF
Cost: Withheld by Owner

Constructed originally for the International Coal Group's national headquarters, this three story office building was purchased by Arch Coal in 2014. The three story building included spaces for all departments of both companies including executive administration, legal, finance, information technology, and field operations such as mapping and land management.

Due to an extensive collection of paper records, the center structural bay framing members for the building were oversized to support large moving paper file storage systems.

The exterior of the building was designed to utilize large ribbon windows maximizing daylight within the perimeter office spaces. The building design incorporated two brick colors to reduce the building's apparent mass from the adjacent interstate highway and business park in which it resides.

Business and Commercial Design

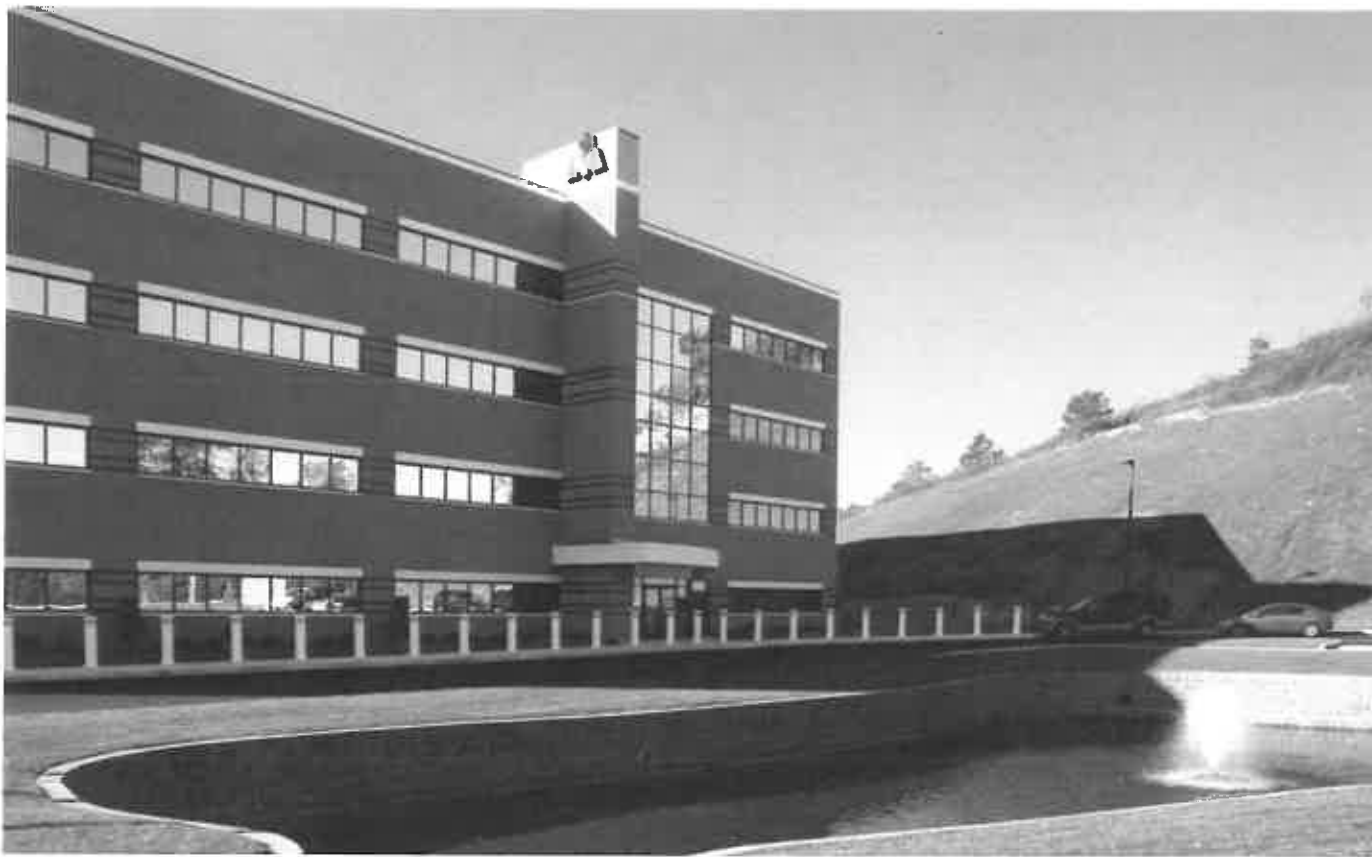

Massey Energy Office Building

Julian, WV

Design-Builder:
G&G Builders, Inc.
Mike Davis, Project Manager
(304) 757-9196

Services provided in-house:
Architectural design
Structural design

Year completed: 2008

Other data:
Size: 70,000 SF
Cost: \$13.2 million

Constructed originally for the Massey Energy's national headquarters, this three story office building was later occupied by Alpha Natural Resources following its acquisition of Massey. This four story building included spaces for all departments of both companies including executive administration, legal, finance, information technology, and field operations such as mapping and land management. Additionally the building includes a full commercial kitchen and glass-roofed garden dining space for employees.

In addition to the main headquarters building, the project also included construction of a new helipad and support facilities.

The exterior of the building was designed to utilize large ribbon windows maximizing daylight within the perimeter office spaces. The building design incorporated multiple brick colors in horizontal stripes reflecting underground coal strata.

Business and Commercial Design



Agsten Construction Company Office Building Charleston, WV



Design-Builder:
Agsten Construction, Inc.
Carl Agsten, Owner
(304) 343-5400

Services provided in-house:
Architectural design
Structural design

Year completed: 2006

Other data:
Size: 13,800 SF
Cost: Withheld by Owner

Located on Charleston's growing West Side, this project plays a vital role in the transition of this area from a residential neighborhood into a community of small and mid-sized businesses.

When Agsten Construction decided to vacate their longstanding leased second floor office space, they expressed a strong desire that the design for their new headquarters be expressive of their forward looking attitude, and sense of style held by the architecturally trained head of the construction company.

The site for this project originally contained two small, single story residential structures and a large abandoned commercial garage. The owner expressed interest in incorporating as much of the garage as possible in the new facility, renovating it into a warehouse as well as office space to supplement the new addition. This was accomplished by keeping the existing masonry walls, removing and replacing the existing roof structure, and spanning the new addition over the garage.

Business and Commercial Design

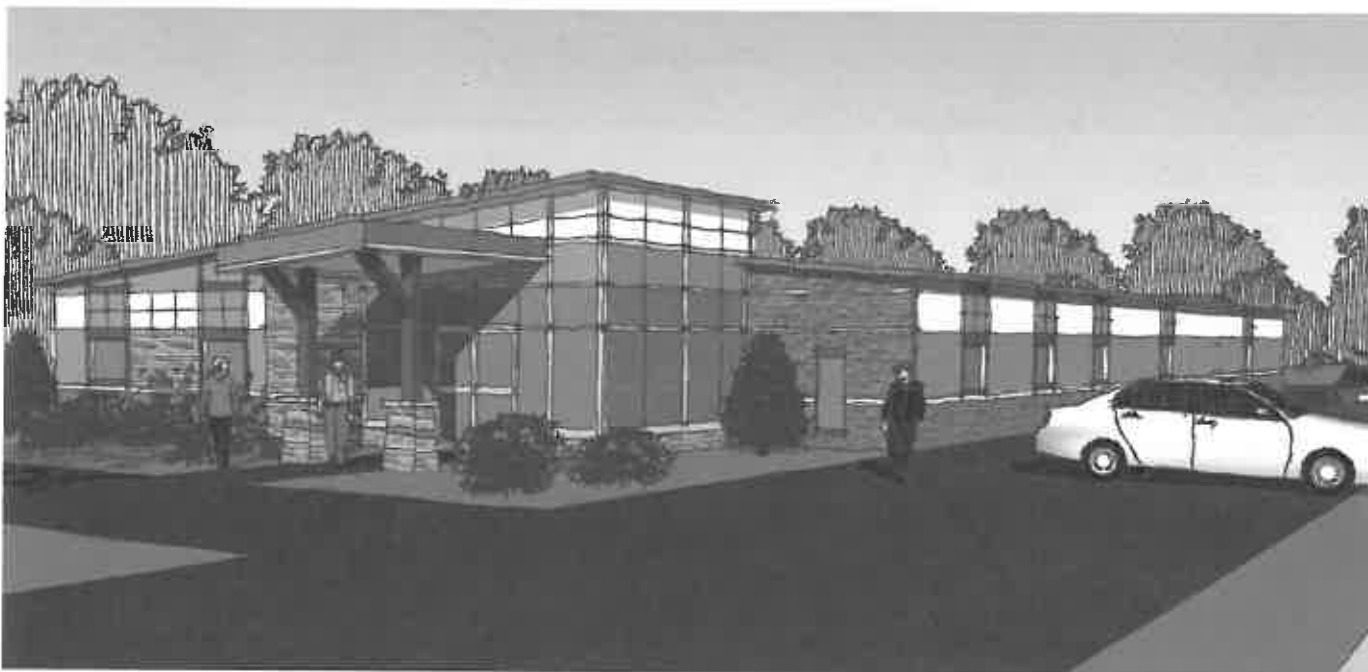

Analabs Office Building Addition Beckley, WV

Owner:
Analabs, Inc.
Kelli Harrison, Owner
(304) 255-4821

Services provided in-house:
Architectural design
Structural design
Interior Design

Services provided by Consultants:
Site Design - Terradon
MEP Design - Harper Engineering

Year completed: 2014

Other data:
Size: 6,000 SF
Cost: \$1.6 million

Analabs is a Crab Orchard, WV based company which provides drug testing of individuals as well as natural resource testing for the energy industry. The scope of the Analabs expansion project was to nearly double the existing facility size with an addition which included additional laboratory / testing spaces, as well as a training room, kitchen, offices, and a work area for field employees.

The existing building was a non-descript pre-engineered structure built in the 1980s. Due to the constricted site, the addition was located at the rear of the existing

building, requiring earthwork to fill a small ravine. Site enhancements included additional on-site staff parking and visitor parking.

The addition included two specialized lab and testing spaces, one for organic testing and one for non-organic testing. Each lab required a specialized HVAC system as well as custom casework and fittings.

An alternate front expansion, including a new entry lobby and offices for the owners was designed, but ultimately not constructed.

PK-12 Educational Design



Mingo Central Comprehensive High School

Owner:
Mingo County Board of Education
Randy Keathley, Former Supt.
Rob Bobbera, Superintendent
(304)235-3333

Services provided in-house:
Architectural design
Structural design
Interior design
Furnishings and equipment design

Services provided by consultants:
Site/Civil Design - Terradon Corp.
MEP Design - Tower Engineering

Construction Manager:
MCS Construction

Constuction commence: 2009
Year completed: 2011

Other data:
Size: 176,260 SF
Capacity: 850 students 9-12
Cost: \$34.9 million



Description of Project:

Mingo Central's floor plan took its form through the desire to separate the school into zones based upon usage. The academic zone is oriented around a central court which provides natural light to nearly all of the teaching spaces. The comprehensive career and technology zone is located on the opposing side of the centrally located common spaces.

The plan emphasizes the ability to share utilize large portions of

the building for after hours use. The dining room, media center, gymnasium, and auditorium are centrally located in the plan with convenient access to parking.

Both gyms as well as the locker rooms were placed one level down from the main level of the building. This allowed the building to conform with the slope of the site. Additionally, this reduced the apparent mass of these large building elements from the nearby King Coal Highway.

PK-12 Educational Design

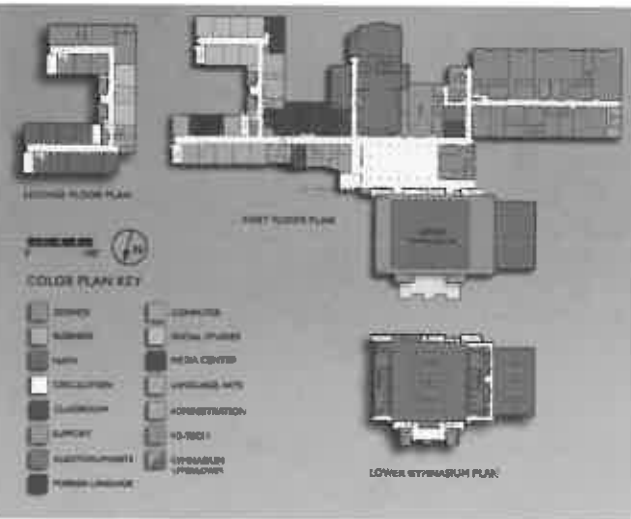

Clockwise from Top Left: Main entrance canopy and administrative office facade provide a striking first impression; Site plan showing current facilities as well as future development; Dining room with pro-start cafe seating in distance; Floor plans showing building layout; Main entry lobby with floor and ceiling emphasizing the exterior curved massing; Auditorium with 500 seats and complete theatrical lighting and curtain package.

A closer look at...
**Mingo Central
 Comprehensive
 High School**

Hospitality



Ronald McDonald House

Charleston, WV

Owner:
Ronald McDonald House Charities
of Southern West Virginia
Dewayne Dickens
Executive Director
304-346-0279

Services provided in-house:
Architectural design
Structural design

Services provided by Consultants:
MEP Design - Harper Engineering

Construction commenced: 2015
Year completed: 2016

Other data:
Size: 18,900 SF
Cost: \$3.5 million

Williamson Shriver Architects was retained in 2010 to provide planning services for a new Ronald McDonald House to be located near CAMC Womens and Childrens Hospital in Charleston, WV. After several years of planning and fundraising, the new facility is under construction with completion scheduled in 2016.

As Ronald McDonald Houses offer free housing to families of hospitalized children, a primary goal is to offer guests a feeling of emotional comfort and security in a home-like atmosphere. This was accomplished in part through breaking the building into three distinct zones: public spaces, guest suites, and administrative offices. There are 14 guest suites divided amongst two floors and many public areas including a communal kitchen, dining room, food pantry, laundry room, kids play room, a den, great room, and an outdoor patio. These spaces are intended to give each resident the comfort of home while providing opportunities for

interaction between guests and staff. A welcome station is located in the entry lobby and will be staffed 24 hours a day. The main entrance includes a secure vestibule, which allows staff to maintain visual control of the building entry point during all hours.

The design intent of the exterior was to create an inviting and intriguing facade with the use of vibrant colors, tall vertical masses, and large areas of fenestration.

By accomplishing these considerations in the design, the site now has an eye catching building that is unique to the area.



Hospitality



LaQuinta Inn & Suites Renovations

Elkview, WV

Owner:
Plaza Management, LLC

Services provided in-house:
Architectural design
Structural design

Year completed: 2014

Services provided by Owner:
Interior Design - Supreme Hospital-
ity - Atlanta, GA

This project was undertaken as a conversion of an existing Country Inn and Suites property. The owner sought Williamson Shriver Architect's assistance in designing substantial renovations to meet current LaQuinta brand design standards.

Exterior renovations included revisions to the roof form, new EIFS finish system, and renovations to the main entrance canopy. On the interior, renovations centered on a complete updating of the first floor public spaces including the lobby, meeting rooms, and fitness center.



Tab E

References



WilliamsonShriver**Architects**

References

The following are a list of current clients serving as references for Williamson Shriver Architects. Please feel free to contact them at your convenience.

Chairman Michael Albert
Chairman, Public Service Commission of WV
Public Service Commission of WV
Charleston, WV
(304) 340-0356

Mr. Frank Devono
Superintendent
Monongalia County Schools
Morgantown, WV
(304) 291-9210

Mr. Dewayne Dickens
Executive Director
Ronald McDonald House Charities of Southern WV
Charleston, WV
(304) 346-0279

The Honorable Mayor Frank Mullens
City of South Charleston
South Charleston, WV
(304) 744-5301

Mr. Gary Phillips
Manager of Building Services
Robert C. Byrd Health Science Center
Charleston, WV
(304) 347-1303

The Honorable Governor Earl Ray Tomblin
Office of the Governor of West Virginia
Charleston, WV
(304) 558-2000

Tab F

Harper Engineering

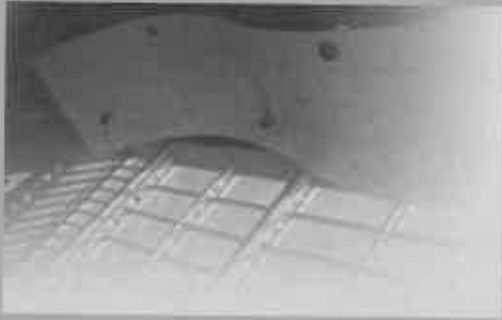

WilliamsonShriverArchitects

Harper Engineering, pllc

52 B Street
St. Albans, WV 25177
Office: 304.722.3602 Fax: 304.722.3603

Harper Engineering, pllc was founded in 2008 to provide innovative engineering design services to architects, owners and contractors throughout the state. We are a unique combination of eager young talent and proven experience fused together to serve all of your building systems design needs including HVAC, Plumbing, Lighting, Electrical, Fire Alarm and Sprinkler Suppression systems. Our goal is to design optimized systems that meet all of our client's performance, energy use, and budgetary needs.

Harper Engineering, pllc has worked with Williamson Shriver Architects, Inc. since 2008. We have amassed over 60 projects together. *indicates more than one project at that location.

Analabs Office Building
Arnoldsburg Elementary School
Burch PK-8 School
Burnsville Elementary School
Braxton County High School
Braxton County Middle School
Braxton County Schools Warehouse
Bruceton School*
Calhoun Gilmer Career Center
Davis Elementary School
Fellowsville Elementary School
Flatwoods Elementary School
Flinn Elementary School
Frametown Elementary School*
Fred Eberle Technical Center*
Geary Elementary School
Gilbert Elementary School
Gilbert High School
Gilmer County High School*
Glenville Elementary School
Hampshire County Career Tech Center
Hampton Inn Buckhannon
Holden Elementary School
Hodgesville Elementary School
Hurricane High School
Little Birch Elementary School
Little Creek Golf Course Conference Center
Marsh Fork Elementary School
Matewan Elementary School

Moorefield Primary School
Northeast Natural Energy Office
Oakwood Baptist Church
Pleasant Hill Elementary School
Preston County High School*
Ravenswood High School
Ripley High School
Roane Jackson Technical Center
South Charleston Fire Station #1
Step toe and Johnson Office Building*
Sutton Elementary School
Terra Alta East Preston School*
Tudors/Gino's Various Locations*
Tunnelton Denver Elementary School
Union Elementary School
Upshur County Schools*
West Chapman Elementary School
West Virginia State Capitol Building
Williamstown Army National Guard
Wirt County Schools



Harper Engineering,pllc

52 B Street
St. Albans, WV 25177
Office: 304.722.3602 Fax: 304.722.3603



Jason E. Harper, PE
(304)-541-1390
jason@harperengwv.com

Education

West Virginia University Institute of Technology
Montgomery, WV
Bachelor of Science-Mechanical Engineering

Registrations/Professional Affiliations

Licensed Professional Engineer – WV
ASHRAE
NFPA

Experience

Jason E. Harper, PE brings 11 years design experience to our firm. He has experience with HVAC, Electrical, plumbing, and fire alarm system design. His projects include educational facilities (including colleges and universities), health care facilities, office buildings, banks, emergency services facilities, postal facilities, and government buildings.

Projects

Addition and Renovation to Geary School
Baileysville Elem. HVAC Renovations
W. Kent Carper Justice and Public Safety Complex
Dominion Gas Office Building
Renovations to Glenville ES
Addition to Shady Spring Middle School
Addition and Renovations to Flinn Elementary
Renovations to Park Middle School



Harper Engineering,pllc

52 B Street
St. Albans, WV 25177
Office: 304.722.3602 Fax: 304.722.3603



Kevin Mark King, PE
mark@harperengwv.com

Education

West Virginia University Institute of
Technology Montgomery, WV
Bachelor of Science-Electrical Engineering

Bluefield State College
Bluefield, WV
Bachelor of Science-Computer Science

Registrations/Professional Affiliations

Licensed Professional Engineer – WV, KY, PA, OH, VA
WV licensed Master Electrician
NFPA

Experience

Kevin Mark King, PE brings 10 years of electrical design experience and over 11 years of electrical construction/maintenance experience to our firm. His projects include educational facilities (including colleges and universities), health care facilities, office buildings, emergency services facilities, government buildings and industrial projects.

Projects

Fayette Co. 911 Center
Wayne County 911 Center
Pulmonary Associates

Huff PK-8 School
Oakvale Elementary School
Pineville Elementary School



Harper Engineering,pllc

52 B Street
St. Albans, WV 25177
Office: 304.722.3602 Fax: 304.722.3603



Scott D. Phillips
(304)-722-3602
Scott@harperengwv.com

Registrations/Professional Affiliations

American Society of Plumbing Engineers

Experience

Scott D. Phillips brings 30 years design experience to our firm. He has experience with mechanical, electrical, plumbing and fire suppression system design. His projects include educational facilities (including colleges and universities), health care facilities, office buildings, banks, emergency services facilities, postal facilities, and government buildings.

Projects

W. Kent Carper Justice and Public Safety Complex
Renovations to Burnsville Elementary School
Pioneer Community Bank
Bible Center Recreation and Ministry Building
Pulmonary Associates Office Building
Additions and Renovations to Little Birch Elementary School
Moses Factory Outlet- Teays Valley
Dominion Gas Office Building
Fairmount State University WV Folk Life Center
South Preston Pre K-8 School
Rahall Technology and Business Center Community Based Outpatient Clinic
Renovations to Davis Elementary School

HE Harper Engineering

P O B o x 8 7 4
S t. A l b a n s , W V 2 5 1 7 7
O f f i c e : 3 0 4 . 7 2 2 . 3 6 0 2 F a x : 3 0 4 . 7 2 2 . 3 6 0 3



Richard M. Standish
(304)-722-3206
Rick@harperengwv.com

Registrations/Professional Affiliations

ASHRAE

Experience

Richard M. Standish brings 36 years design experience to our firm. He has experience with HVAC, plumbing, and electrical design. His specialty is the electrical design of water treatment and wastewater treatment plants. Rick's projects include treatment plants, educational facilities (including colleges and universities), health care facilities, office buildings, banks, emergency services facilities, postal facilities, and government buildings.

Projects

Brooke County High School
University of Charleston Dorm
Tri-State Gaming Center
Mylan Pharmaceuticals Expansion
Mason Co. 911 Center
Oak Hill Police Station
Kenova WTP
Boone County WWTP
Salt Rock PSD
Eleanor Maintenance Facility

Wyoming West High School
WVU- Boreman Hall
Greenbank Observatory
Robert Byrd Health Science Center
WV DEP Consolidated Offices
Flatwoods-Canoe Run PSD
Union PSD
City of St Mary's WWTP
St. Albans WTP
Dominion Gas Office Building

Tab G

Terradon Corporation



WilliamsonShriverArchitects

TERRADON Land Development Services Overview



Land Development covers a broad swath of TERRADON's service offerings and sees a large percentage of its annual revenue from repeat clients or referrals. The group is composed mainly of Landscape Architects and CAD designers who frequently team with every other department within the company.

TERRADON's Land Development department collaborates with public and private entities and has a strong presence in the recreation, public/civil, educational and commercial development sectors. TERRADON is recognized as a leader in providing site design and land planning services. The firm's professional engineers work closely with the client from the project's initial phase through a schematic design, construction documents and project delivery. TERRADON's Landscape Development Group remains on the forefront of sustainable design, providing LEED Accredited Professionals to clients. Projects utilizing sustainable design best practices aid clients in significantly reducing energy costs on projects.

TERRADON's Land Development Group works in a variety of markets including: Parks/Recreation, Commercial/Industrial, Civic/Public, K-12 Education, Higher Education and Medical.

Projects include: Master planning, recreational planning, funding agencies assistance, economic development planning, surveying, engineering, architecture, historical preservation construction administration and inspection.

LAND DEVELOPMENT SERVICES

- Master Planning
- Presentation Drawings/Renderings
- Site Feasibility Studies
- Schematic Design
- Layout Plans
- Grading Plans
- Stormwater Management Plans
- Erosion Control Plans
- Planting Plans
- Construction Observation

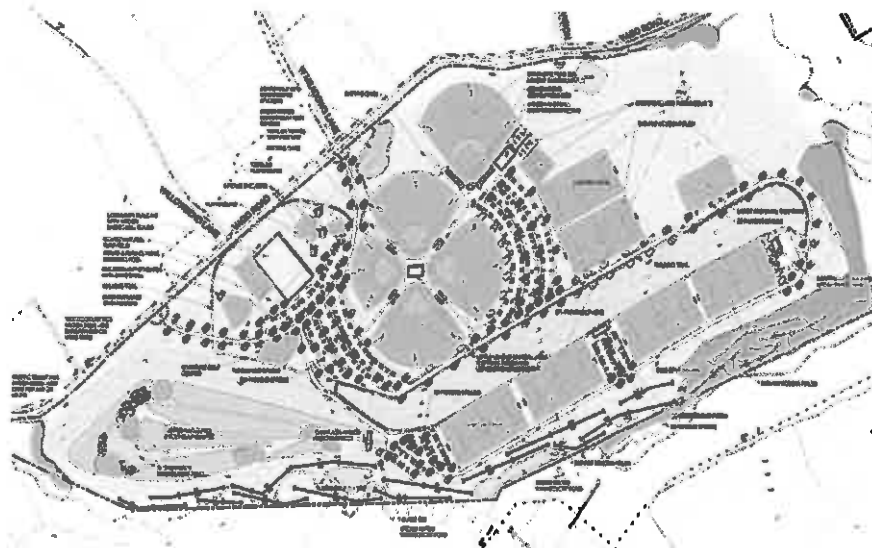

RESUMES OF PROJECT TEAM MEMBERS - TERRADON

Greg Fox, ASLA, LEED AP VP Land Development

Greg Fox has overseen TERRADON's Land Development Department since its inception in 2000. He offers more than 25 years of industry experience, providing design services to a variety of markets. During his tenure, the Land Development Group has completed more than one hundred K-12 Educational projects and dozens of Higher Education projects.

Under his guidance, the group has been the recipient of Engineering Excellence awards from the West Virginia Association of Consulting Engineers, and the Gold Award for Engineering Excellence from the American Council of Engineering Companies. Additionally, the Land Development Group has been recognized numerous times for Merit Awards by the West Virginia Chapter of American Society of Landscape Architects. Fox is a registered Landscape Architect in West Virginia, Ohio, North Carolina, South Carolina, Pennsylvania and Virginia. He is an active member of the American Society of Landscape Architects. Fox received degrees in Landscape Architecture and Planning from West Virginia University.

Peter J. Williams, ASLA Landscape Architect

Pete Williams is a graduate of West Virginia University with a Bachelor of Science in Landscape Architecture. His responsibilities include landscape architectural design, grading and storm water drainage design, the design of pedestrian circulation systems and related amenities, roadway design, site planning, and quality control. Mr. Williams is registered as a professional Landscape Architect in West Virginia with more than 13 years of experience at TERRADON and more than 22 years of overall experience.

Jim Nagy, PE Utility Infrastructure

Jim Nagy performs Civil Engineering related to water and waste water projects at TERRADON. He specializes in the design of water treatment and distribution systems. He has more than 25 years of on-hand experience providing engineering for the largest private water company in West Virginia. He earned a B.S. in Civil Engineering from West Virginia University. His primary focus is on management of water and wastewater projects. He also performs design work related to water distribution systems and sewage collection systems.

Robert Thaw, PS VP Survey and Mapping

Robert Thaw, Vice President of Survey and Mapping, oversees all TERRADON Survey services. TERRADON's survey group serves a diverse range of projects in support of TERRADON's service groups in addition to managing survey-specific clients. Thaw manages a staff of Professional Surveyors and Computer Aided Drafting (CAD) designers who provide mapping, construction layout, ALTA survey, topographic survey and boundary survey services. Thaw's leadership has been instrumental in TERRADON's prioritization of the use of modern technology, ensuring clients the most efficient and accurate results. Additionally, he is responsible for in-house design of commercial property sites, parking and utility easements, and review of project plans and base mapping creation. Thaw's group also provides as-built surveys, utility identification surveys and deformation monitoring of design features such as retaining walls and dams.

Bill Hunt, PG, LRS VP Geo-Environmental, Materials Testing and Inspection

Bill Hunt serves as Vice President of Geo-Environmental at TERRADON Corporation. He will oversee any environmental needs, permitting and direct work for geotechnical tasks and testing and inspection required of the project. Hunt offers relevant experience in environmental documentation, investigations, and coordination with federal, state, and local agencies. He prepares Environmental Impact Statements, Environmental Assessments, Section 4(f) Evaluations, and other environmental technical documents. He supervises and participates in work plan development, field surveys, on-site monitoring, data collection, impact analysis, subconsultant management, public meeting organization and group presentations.

John James, PE Geotechnical Engineer

John James is a Senior Geotechnical Engineer for civil engineering projects. Mr. James specializes in innovative and cost-saving concepts for his projects. James' project experience includes: roads; highways and bridges; earth and rockfill dams; numerous foundation investigations; studies and designs for landfills and environmental facilities; surface and ground water studies and remediation; foundation investigations and designs ranging in size from houses to major industrial complexes; storm drainage facilities; airport facilities; landslide analysis and correction; and forensic engineering.



WilliamsonShriverArchitects

Williamson Shriver Architects, Inc.
717 Bigley Ave
Charleston, WV 25302
304-345-1060 voice
304-345-3693 fax
www.wsgarch.com