

WEST VIRGINIA STATE POLICE



CEOI 0612 DPS1600000001

Architectural/Engineering Design Services for Various Projects



05/04/16 09:30:04
WV Purchasing Division



McKINLEY & ASSOCIATES
ARCHITECTS • ENGINEERS • INTERIOR DESIGN

in association with:

TRIAD
TRIAD ENGINEERING, INC.

**STAFFORD
CONSULTANTS
INCORPORATED**
Engineering Design and Consulting



2 May 2016

Tara Lyle
Department of Administration, Purchasing Division
2019 Washington Street East
Charleston, WV 25305-0130

Dear Ms. Lyle and Member of the Selection Committee;

McKinley & Associates is **honored** to have been **partnered with the West Virginia State Police** for nearly **20 years**, we have completed facilities **master plans**, worked on **dozens of WVSP facilities** – from new buildings to renovations, and we wish to continue our service with you on these various projects as well. We are confident that the enclosed materials demonstrate that our team is exceptionally qualified to provide the best service to you.

For these various projects for DPS1600000001, McKinley & Associates have teamed up with Triad Engineering and Stafford Consultants (McKinley/Triad/Stafford Team), and are pleased to provide you with our Expression of Interest to provide professional architectural/engineering services for various projects across West Virginia. As you review this submission, we emphasize the following strengths of the McKinley/Triad/Stafford Team with respect to your projects:

McKinley & Associates is an **Architectural/Engineering** firm that has been providing design services since 1981. By virtue of our multiple-office locations, including both **northern (Wheeling, WV and Washington, PA)** and **southern (Charleston, WV)** offices, we can respond to your statewide projects expeditiously. We have licensed West Virginia **Architects** located in every office. In addition to **Architects**, McKinley & Associates also supports a professional staff that includes mechanical, electrical, plumbing / fire protection Engineers (**MEP Engineers**); Construction Administrators; LEED Accredited Professionals specializing in Building Design and Construction (LEED AP BD+C); a Qualified Commissioning Process Provider (QCxP); a certified Interior Designer (NCIDQ); and more. In addition, we recently became a 100% ESOP Company (Employee Stock Ownership Plan), so our employees now own 100% of our corporation!

McKinley & Associates offers you an added benefit of having the capabilities of **handling multiple projects simultaneously**. Our Team has successfully worked together on numerous projects. McKinley & Associates has designed several projects that are **similar to your various projects**, including roof repairs, roll-up doors, large garages with multiple bays, hangars, various sized storage buildings, renovations to State Police office buildings, electrical engineering to design back-up generators to WVSP facilities, and much more. You will find a few examples of similar project experience we have designed within the project sheets.

Our Firm as a whole has experience with a vast array of **similar contracts** that involve multiple buildings projects, including various on-call agreements (such as Open-Ended contracts, Indefinite Delivery/Indefinite Quantity contracts, etc). This includes the **West Virginia State Police**, where we have had 3 multi-year open-ended A/E Services contracts together. We also currently have 2 multiple year open-ended IDIQ agreements with the United States Postal Service [in the Appalachian Area (West Virginia & Virginia) and in the Erie/Pittsburg Area of PA], open-ended A/E contract with West Virginia University, and more. From all of this experience, we have gained the knowledge to realize the multi-purpose nature of governmental facilities; such as sensitivity to the people using the buildings, safety and security, cost and energy efficiency, flexible environments, and much more. We are able to respond to their needs, and we are certain that we are able to respond to all of your needs, again, as well.

Triad Engineering is a full service **geotechnical engineering** corporation specializing in the areas of **subsurface exploration, surveying, environmental assessment and remediation**, construction monitoring and inspection, laboratory testing, drilling and landscape architecture, among other earth science disciplines. They were founded in 1975, and are an employee-owned firm of engineers and scientists. Triad Engineering has offices in both northern and southern West Virginia (Morgantown and St. Albans), as well as 5 offices in Maryland, Ohio, Pennsylvania, and Virginia, which all are within a close geographical location to other parts of the State (for example, their MD and VA offices strategically surround the Eastern Panhandle). McKinley & Associates has worked with Triad on dozens of projects over the years, including a few State Police projects.

Stafford Consultants is our **structural and site civil engineering** consultant. Stafford was formed in 1985, and currently employs a total staff of eighteen, including five registered professional engineers. Stafford's clients include State and local agencies such as the Division of Highways, the Department of Environmental Protection, the municipal market (Cities, Town, and Public Service Districts), Boards of Education, and private entities such as subdivision or commercial developers. McKinley & Associates has utilized Stafford Consultants on dozens of projects across the State, and in multiple sectors of business; these projects range from new construction to additions and renovations.

In Closing, with Triad and Stafford on our Team, we will provide you with all the services needed to make these projects successful. For your convenience, we have ordered and answered our Expression of Interest by following your criteria listed in SECTION THREE: PROJECT SPECIFICATIONS – “Part 3. Qualifications and Experience” and “Part 4. Project and Goals.”

We are ready to begin **immediately** and will meet all your Goals and Objectives. Each of the projects we have listed in our proposal will show you we can accomplish your goals. Thank you for reviewing our submission and considering the McKinley/Triad/Stafford Team for your projects. If you have any questions, please do not hesitate to call at any time.

Personal Regards,

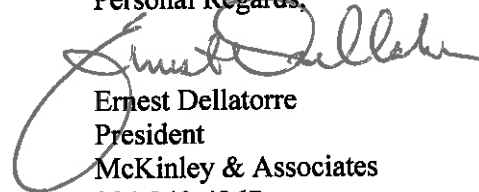

Ernest Dellatorre
President

McKinley & Associates

304-340-4267

edellatorre@mckinleyassoc.com



McKINLEY & ASSOCIATES
ARCHITECTS • ENGINEERS • INTERIOR DESIGN

"Vendors will provide information regarding its employees, such as staff qualifications and experience in completing similar projects ...

First and foremost, the McKinley/Triad/Stafford Team can state that our large professional staffs will devote whatever time is necessary to provide the West Virginia State Police with successful projects.

Since you are Headquartered in South Charleston, we have assigned *Thomas R. Worlledge, AIA, LEED AP BD+C, REFP*, McKinley & Associates' Charleston Office Manager, whom is an Architect and a **LEED Accredited Professional specializing in Building Design and Construction**, as your "Relationship Manager." Thom is a skilled Architect with 32 years experience (11 years with McKinley & Associates) who has received State-wide design awards, National design awards and recognitions, and placed in National design competitions. Mr. Worlledge is a former voting member of the ASHRAE 90.1 Standards committee that forms the basis of the International Energy Code and was the president of the State chapter of the AIA. As a LEED AP and a recognized sustainable design expert, he has **2 LEED Certified Projects**, multiple **LEED Registered** projects, has had articles published in State and National trade publications, and was also a featured speaker at multiple State and National conferences. He also teaches other design professionals in the art of High Performance design, as a professional trainer for the Sustainable Building Industries Council. Unlike many architects who are new to green building and alternate energy, Thom started his career designing and building alternate energy systems, and was the **first LEED Accredited Professional in the State of West Virginia!** He believe energy efficient design is simply good design practice. In fact, he wrote portions of the 2007 International Energy Code which is used by other architects as a guide for energy efficient design. He is also a Founder & Chairman of the Board for the US Green Building Council's West Virginia Chapter. Thom won a 2013 Placemaker Award for "Leadership, Inspiration, Stewardship" from West Virginia GreenWorks. Some of Thom's relevant and/or notable projects are:

- **West Virginia State Police - New Logan Detachment**
- **West Virginia State Police Academy - campus-wide projects:**
 - **Building A renovations (2-story dormitory with classrooms)**
 - **Building B renovations (2-story dormitory with classrooms)**
 - **Building C renovations (2-story dormitory with classrooms and cafeteria)**
 - **New Building D (shooting range and control center)**
 - **New Physical Training Facility / Multi-Purpose Building**
- **West Virginia University - University Police Building fit-out renovations**
- **Building 55: West Virginia State Office Building Complex in Logan (LEED Certified)**
- **West Virginia Department of Health & Human Resources' new Ohio County office fit-out**
- **SMART Office fit-out in Williamson, WV (LEED Registered / 2013 Placemaker Award)**
- **McKinley & Associates Charleston Area Office fit-out (2009 WV AIA Design Award winner / energy efficient "green" design)**
- **N&D - Natural Energy Design Office Building (energy efficient / 2013 Placemaker Award)**
- **Fairmont State University - Student Housing College Apartments (\$30 million)**
- **Marshall County Schools - Hilltop Elementary School (West Virginia's 1st LEED Certified School / multiple State and National awards & recognitions)**

** more information on Thom, along with the other Key members of your design team, are found on their resumes, in the upcoming pages.*



If the **McKinley/Triad/Stafford Team** is chosen for these projects; **we are available to start immediately upon our being selected, and will provide the necessary hours to complete your various projects on time.** In addition to those key team members whose resumes are on the upcoming pages; **we can also attribute more professionals from our various trades.** The technical **depth** of our professional staff indicates that these projects can be accomplished without overloading our group or computer graphics systems.

McKinley/Triad/Stafford all have multiple licensed Professional Engineers (PEs), who are licensed in West Virginia:

- **McKinley & Associates** is an A/E firm that employs a staff of over 25, including registered **Professional Engineers** and engineering designers in the MEP fields. McKinley & Associates also has **multiple Architects** licensed in West Virginia, and they are located in both the northern part of the State [Wheeling, WV (or Washington, PA)], or the southern part of the State (Charleston, WV), and the work will be performed out of all offices, depending on the location of the project. We also have architectural designers in all offices.
- **Triad Engineers** includes a staff of nearly 200, which includes **multiple Professional Engineers**. Their personnel include environmental, geotechnical, chemical, civil, and mining engineers, as well as surveyors, geologists and hydro geologists, biologists, chemists, environmental scientists, planners, landscape architects, natural resource specialists, regulatory compliance specialists, permitting engineers, risk assessors and health/safety specialists.
- **Stafford Consultants** employs a total staff of 25, including 6 registered **Professional Engineers**. They provides services in Civil, Site, Structural, Highway, Bridge, Airport, Environmental, and Sanitary Engineering.

McKinley & Associates is now a 100% ESOP Company (Employee Stock Ownership Plan); from this, our employees now own 100% of our corporation! Therefore, we believe our strength lies in the quality of the people we employ. Our seasoned staff has an unsurpassed knowledge of the business and the dedication it takes to make each project a success. And we're structured for efficiency; our Engineers, Architects, and technicians are all in-house, creating optimum communication and collaboration, which results in outstanding service to our clients. All of our project managers, Architects and Engineers, write their own specifications for a project. By doing so, the specifications are written for - and pertinent to - only your project.

Our portfolio includes multiple relevant projects; examples of which you will see later in our proposal. No project is too large or small; we have designed projects ranging from a few thousand dollars to multi-million dollar projects.

You will see that our employees have worked on various **West Virginia State Police facilities** (detachments, dormitories, shooting ranges and control centers, multi-purpose buildings, etc.), including new construction, additions, and renovations.

The McKinley/Triad/Stafford Team have collectively also worked on roof repairs; roll up doors for large vehicles; worked at hangars; garages; storage facilities; completed renovations to office buildings; back-up generators; topographical and other field surveys; test bores and other sub-surface investigations; energy efficiency; etc.

Thomas R. Worlledge, AIA, LEED AP BD+C, REFP

Architect / LEED Accredited Professional

Southern WV - Area Manager



EDUCATION:

Virginia Polytechnic Institute & State University
Master of Architecture - 1992

Fairmont State College, School of Technology
B.S. Architectural Eng. Tech. - 1983

PROFESSIONAL AFFILIATIONS AND REGISTRATIONS:

Registered Architect in:

West Virginia
Ohio
Pennsylvania
Tennessee
Virginia

National Board Certification:

NCARB # [REDACTED]

President:

West Virginia Society of Architects

Member:

The American Institute of Architects (AIA)
US Green Building Council (LEED AP BD+C)
Sustainable Building Industries Council
Recognized Educational Facility Professional (REFP)

Founder & Chairman of the Board:

US Green Building Council's West Virginia Chapter

Former voting member:

ASHRAE 90.1 Int'l Energy Code Committee

PROFESSIONAL EMPLOYMENT:

McKinley & Associates
Manager, Charleston Office
Charleston, WV (2005 to present)

Proactive Architecture Inc.
President
Charleston, WV (1999-2005)

Silling Associates Inc.
Vice President
Charleston, WV (1992-1999)

TAG Architects
Charleston, WV (1985-1990)

Alpha Associates Inc.
Morgantown, WV (1983-1985)

SUMMARY OF EXPERIENCE:

As mentioned before, your "Relationship Manager" and main point of contact will be Thom Worlledge. He is a skilled **Architect (AIA)**, a **LEED Accredited Professional** with a **specialization in commercial building design and construction (LEED AP BD+C)**, and a **Recognized Educational Facility Professional (REFP)**. He is a registered architect in 5 states, including West Virginia. Mr. Worlledge is a former voting member of the ASHRAE 90.1 Standards committee that forms the basis of the International Energy Code. He was also the president of the state chapter of the AIA. Mr. Worlledge has been involved in design of projects ranging from a small home additions (one of which was featured on HGTV's New Spaces Show) to multimillion dollar projects such as the \$20 million Parkersburg High School renovation/addition and historic preservation project, the fast-tracked \$6 million WVU IOT Maclin Hall renovation project, the **LEED Certified Building 55: West Virginia State Office Complex** in Logan, and he led the State-wide 2003 Courthouse Conditions Report for the West Virginia Courthouse Facilities Improvement Authority to name a few. Many projects have **similar scope** to your projects, such as roof repairs, overhead roll-up doors for various-sized vehicles, emergency back-up generators, etc. Thom won a 2013 Placemaker Award for "Leadership, Inspiration, Stewardship" from West Virginia GreenWorks, at The Building Conference in Morgantown; moreover, 3 of his projects (N&D Natural Energy Design Building, Hilltop Elementary School, and Williamson SMART Office) all won Placemaker Awards. The **LEED Certified Hilltop Elementary School** won multiple State and National awards and recognitions.

NOTABLE PROFESSIONAL ACHIEVEMENTS:

West Virginia State Police - multiple projects at the WVSP Academy, and new Logan Detachment

West Virginia University - University Police Building fit-out

Building 55: WV State Office Complex in Logan (**LEED Certified**)

United States Postal Service - multiple projects across WV

WVDHHR's new Ohio County (Wheeling) office renovation

West Virginia Plaster and Cement Masons Building

West Virginia School Building Authority - State-Wide School Safety/Vulnerability Assessments. Renovations for multiple WV County School Districts, including Boone, Hancock, Marshall, & Wood County Schools

Marshall County Schools - Hilltop Elementary School (**LEED Certified - won multiple WV and National Awards & Recognitions**)

Nicholas County Courthouse SF study

1601-1605 Washington Street, West roof repair

Bellann in Oakhill, WV (**LEED Registered**)

Veterans Affairs Medical Centers - multiple VAMCs around WV and PA

Big Sandy Arena & Convention Center

WVSU - Gus R. Douglass Economic Development Center renovations

SWVCTC - Williamson roof & HVAC and Wyoming/McDowell HVAC



McKINLEY & ASSOCIATES
ARCHITECTS • ENGINEERS • INTERIOR DESIGN

Gregg P. Dorfner, AIA, NCARB

Architect

Director of Architectural Services

EDUCATION:

Fairmont State College
Associate of Science, Architectural Engineering
Technology - 1974

Fairmont State College, School of Technology
Regents Bachelor of Arts - 2000

PROFESSIONAL AFFILIATIONS AND REGISTRATIONS:

Registered Architect in:

Maryland
Ohio
Pennsylvania
West Virginia

National Board Certification:

NCARB [REDACTED]

Professional Associations:

The American Institute of Architects
AIA West Virginia

Former Arbitrator:

Panel of Construction Neutrals,
American Arbitration Association

Former Instructor:

Architectural Technology, Fairmont State College

Former Member:

Chairman, Building Code Board of Appeals,
Fairmont, WV
National AIA 1997 General Conditions Committee,
Task Group C
The Council of Educational Facility Planners

PROFESSIONAL EXPERIENCE:

McKinley & Associates
Wheeling, WV (2001 to present)

Alpha Associates
Morgantown, WV (1996-2001)

Self-Employed Consulting Architect
Fairmont, WV (1995-1996)

Blackwood Associates
Fairmont, WV (1974-1995)

SUMMARY OF PROFESSIONAL EXPERIENCE:

Mr. Dorfner's 40+ years of experience in the planning and design of facilities is broad-based in scope, having worked in 23 of West Virginia's 55 counties. His experience in the commercial, institutional, and educational markets range in scope from warehouses to office buildings to convenience stores to psychiatric hospitals. He has acquired an extensive knowledge and understanding of state building and fire codes, building industry standards, as well as governmental guidelines and regulations. This expertise has helped him develop effective and economical design solutions to many complex code-related issues. Mr. Dorfner has been our Project Architect for multiple projects ranging from a few hundred thousand to multi-million dollars in construction value.

SELECTED PROFESSIONAL ACHIEVEMENTS:

Coordination Architect

Hancock Co. Schools - District-Wide Construction Program (\$56M)
Wood Co. Schools - District-Wide Construction Program (\$63M)

Project Architect / Lead Designer

Jefferson County Courthouse Annex Demo
PetSmart Distribution Center
United States Postal Service - multiple projects
Wagner Building
Building 34: West Virginia State Office Complex
Wm. R. Sharpe Hospital, WV Division of Health / Weston, WV*
Fairmont State University - College Apartments
WVU - Student Leader Housing Facilities*
Oak Glen Middle School, Hancock County (85,000 SF)
Chapmanville Regional High School, Logan County (138,500 SF)
John Marshall Fieldhouse, Marshall County
Cameron Middle/High School, Marshall County (127,000 SF)
Weirton Elementary School, Hancock County (105,000 SF)
North Marion High School, Marion County*
Marion County Vocational Center, Marion County*
Musselman Secondary School, Berkeley County*
Tomahawk Elementary School, Berkeley County*
Preston County High School, Preston County*
Aurora Elementary School, Preston County*

Bond Planning Services

11 counties between 1981 and 2010; Berkeley County (1981), Grant County (2000), Hancock County (2005), Hancock County (2010), Marion County (1977), Marshall County (2006), Monongalia County (2000), Ohio County (1985), Preston County (1992), Taylor County (2000), & Wood County Schools (2004)

Comprehensive Educational Facilities Plans

20 counties for the 2000-2010 and the 2010-2020 plans

** previous work experience with a firm other than McKinley & Associates*

Christina Schessler, AIA, LEED AP BD+C

Architect / LEED Accredited Professional / Historic Preservationist



EDUCATION:

The Pennsylvania State University
Bachelor of Architecture - 1988

Savannah College of Art & Design (SCAD)
Masters Degree in Historic Preservation - 2012

PROFESSIONAL AFFILIATIONS AND REGISTRATIONS:

Registered Architect in:

Ohio
Pennsylvania
Virginia
West Virginia

NCARB Certificate - 2005

LEED® Accredited Professional

Member:

American Institute of Architects
City of Wheeling - Building Codes Board
of Appeals
Preservation Alliance of West Virginia
The Association for Preservation Technology
International

Former Member, Board of Director, & Treasurer:

The Midwife Center for Birth & Women's
Health / Pittsburgh, PA

PROFESSIONAL EMPLOYMENT:

McKinley & Associates
Wheeling, WV (2004 to present)

MacLachlan, Cornelius & Filoni Architects
Pittsburgh, PA (1999-2004)

Perfido Welskopf Architects
Pittsburgh, PA (1996-1999)

T.L. Cox & Associates
Beaver, PA (1990-1996)

Valentour English Bodnar Architects
Mt. Lebanon, PA (1989-1990)

Kenny Williams & Williams Building Diagnostics
Maple Glen, PA (1988)

SUMMARY OF EXPERIENCE:

Christina Schessler, AIA, LEED AP BD+C is an **Architect** and a **LEED Accredited Professional specializing in Building Design & Construction** with over 25 years of experience. In addition, she recently completed her Masters in **Historic Preservation**, and has a passion for renovation, restoration, and modernization projects. Ms. Schessler is adept at developing space and utilization programs with Clients who are unfamiliar with the architectural design process. As a volunteer and as a professional, Ms. Schessler has developed several projects for non-profit agencies on limited budgets. She has had the opportunity to participate in the design of a few uncommon building types, such as fire fighting training centers, fire stations, funeral homes, and animal research facilities to name a few. As a LEED AP, Christina will also be able to provide direction to your projects to develop a design that includes energy efficiency. She was the project architect on award-winning projects, such as Bennett Square business center renovations, and for the WVDCH on the West Virginia Independence Hall historic preservation / renovation project, which both won a Heritage Tourism Award from the Preservation Alliance of West Virginia. She has also won other design awards for WV and PA projects.

NOTABLE PROFESSIONAL EXPERIENCES:

WVU Fire Training Academy / Jackson's Mill, WV (multiple roll up doors for various sized vehicles - part of Open-End A/E contract)

Panhandle Cleaning & Restoration office building renovations and warehouse addition (multiple roll up doors for various sized vehicles)

Wheeling Island Fire Station adaptive reuse / renovation (multiple roll up doors for various sized vehicles)

United States Postal Service - 2 Open-End IDIQ contracts / multiple projects across WV and PA

West Virginia Division of Rehabilitation Services Wheeling District's new office space fit-out in the historic Fort Henry Building

Ohio Valley Towers roof repair, HVAC, building envelope, and more

Wheeling Island Hotel•Casino•Racetrack multiple renovation projects

Bennett Square Office Building - 3 Phases

Wagner Building - Multiple Office fit-out projects

West Virginia Independence Hall historic preservation / renovations

Fairmont State University addition at Braxton County High School

Washington & Jefferson College - Old Main Building roof replacement

City of Steubenville, OH historic façades & roofs rehabilitation program

Lincoln National Bank historic preservation / renovations

Harrison County Courthouse, OH historic preservation, roof repair

The Linsly School 200th Anniversary Campaign

Grant County Schools - multiple projects

Hampshire County Schools - Animal Vet Science Center

Hancock County Schools - multiple projects



McKINLEY & ASSOCIATES
ARCHITECTS • ENGINEERS • INTERIOR DESIGN

Patrick J. Rymer, AIA, ALEP (CEFP)

Architect

EDUCATION:

University of Tennessee
Bachelor of Architecture - 1999

Memphis Center for Design - 1998

PROFESSIONAL AFFILIATIONS AND REGISTRATIONS:

Registered Architect in:
West Virginia

Member:
The American Institute of Architects (AIA)
Accredited Learning Environment Planner (ALEP)
- [formerly known as Certified Educational
Facility Professional (CEFP)]

NCARB

IDP

ArchNet

PROFESSIONAL EMPLOYMENT:

McKinley & Associates
Wheeling, WV (2005 to present)

Capitol Engineering
Charleston, WV (2003-2005)

United Brotherhood of Carpenters & Joiners
(2000-2003)

SUMMARY OF EXPERIENCE:

Mr. Rymer brings over 15 years experience in the building design and construction industry, which includes governmental such as multiple West Virginia State Police and West Virginia Army National Guard projects involving Project Management, Project Design & Construction Administration. He is in the inaugural class of Accredited Learning Environment Planners (ALEP) [formerly known as Certified Educational Facility Professional (CEFP)] as designated by the Association for Learning Environments (formerly CEFPI). His recent relevant experience includes the project management of several projects, as well as the lead design and construction administration of various Federal, State, County Government and private projects. Bringing a diverse background from the hands on experience of an apprenticeship in the construction trades to project management of multi-million dollar facilities, Mr. Rymer has an intimate understanding of building and design on a holistic level.

NOTABLE PROFESSIONAL EXPERIENCES:

West Virginia State Police - multiple projects State-wide from our Open-Ended A/E Services contract, including Jackson County / Ripley Detachment renovations, Kanawha County Troop 4 Headquarters renovations, and Berkeley County Detachment renovations

West Virginia Army National Guard - Camp Dawson/Fueling Canopies*, Parkersburg Army Aviation Support Facility / Taxiway Repair*, Glen Jean WVANG-AFRC-MEPS Facility*, Parkersburg AASF Apron Rehabilitation*, Williamson Armory, WVANG Wash Pad & Military Parking*, Summersville Readiness Center*, Lewisburg Readiness Center*

Ohio County Commission - Cabela's Phase II expansion

Wellsburg City Hall Building renovations

Regional Economic Development Office, Wheeling - Site Improvements for Orrick's Global Operations Center, & Adaptive Reuse Warehouse Study

Comprehensive Educational Facilities Plans for Brooke, Hancock, Ohio, Ritchie, Tyler, & Wetzel Counties

Brooke County Schools - NEW Brooke County Middle School

Hancock County Schools - Oak Glen Middle addition, Oak Glen High Multi-Sports Complex, & Weir High Multi-Sports Complex, and more

Marshall County Schools - NEW Cameron Middle/High (LEED Registered), Cameron Elementary addition/renovations, Cameron Fieldhouse, Center McMechen Elementary renovation, and more

Tyler County Schools - Board of Education Administrative Office renovation, Bus Maintenance Garage, & County-Wide Security / School Access Safety Project

Wetzel County Schools - Magnolia High renovations, New Martinsville renovations, Wetzel County Center for Children and Families renovations, Bus Wash addition, County-Wide Window Replacement Project

** previous WVARNG work experience with a firm other than McKinley & Associates*



McKINLEY & ASSOCIATES
ARCHITECTS • ENGINEERS • INTERIOR DESIGN

Ray Winovich, RA

Architect

EDUCATION:

Carnegie-Mellon University
Bachelor of Architecture - 1979

PROFESSIONAL AFFILIATIONS AND REGISTRATIONS:

Registered Architect in:

Pennsylvania (1984)
Washington (1997)
Michigan (2000)
Indiana (2000)
New York (2003)
Massachusetts (2003)
West Virginia (2005)
Ohio (2007)

NCARB Certificate - 2003

PROFESSIONAL EMPLOYMENT:

McKinley & Associates
Wheeling, WV (2005 to present)

Industrial Design Corp.
Pittsburgh, PA (2000-2005)

SSOE, Inc
Bellevue, WA and Toledo, OH (1997-2000)

R.T. Patterson Co. Engineers
Pittsburgh, PA (1994-1997)

Self employed (1993-1994)

Industrial Design Corp.
Pittsburgh, PA (1990-1992)

SUMMARY OF EXPERIENCE:

Mr. Winovich is a Registered Architect who has extensive experience in renovation and upgrade projects of various sizes and use groups. This includes governmental, commercial, municipal, financial, educational, medical, industrial laboratory operations, as well as larger high-technology micro-electronics cleanroom retrofits for clients such as Micron, Intel and IBM. In addition, he has vast experience with new building construction. He is an award-winning architect; most recently he has completed the \$10 million J.B. Chambers Performing Arts Center at Wheeling Park High School in Wheeling, WV, which was just selected as an Outstanding Design by the American School & University Magazine's 2013 Architectural Portfolio; the premier showcase celebrating the best in education design! He even has experience internationally, such as being the lead architect of a 150,000 SF, Class-10 clean-room lab for Intel in Leixlip, Ireland.

NOTABLE PROFESSIONAL EXPERIENCES:

United States Postal Service - multiple projects from our open-end IDIQ contract, including Kane Main Post Office, Corry, and more

Cabela's Eastern Distribution Center - Phase II

Carenbauer Wholesale Corporation distribution and warehouse addition & office renovations

Washington & Jefferson College - Old Main Building roof replacement and masonry repairs, Commons Building renovations (including generator), Thompson Hall renovations (including generator), & Facilities Building renovations

Silgan Warehouse expansion at the Highlands

Silver Companies storage building

Bayer Heritage FCU Warehouse & Office Building, New Martinsville

Bayer Heritage Federal Credit Union, Moundsville Branch

Holiday Inn Express & Suites - Highlands / Triadelphia WV, Parkersburg WV, Cambridge OH, Cumberland MD, & Washington PA

Candlewood Suites Hotel, Morgantown, WV

Follansbee City Building renovations

Brooke County Schools - Follansbee Middle School windows

Hancock County Schools - Oak Glen High School renovations & Weir High School renovations

Ohio County Schools - New 1,200-seat J.B. Chambers Performing Arts Center at Wheeling Park High School / \$10 million

Wood County Schools - 270,000 SF overall campus renovation of Parkersburg South High School / \$23 Million

Shenango Valley YMCA Wellness Center and Indoors Sports Complex

Dr Ganzer Medical Office Building renovation and expansion

Reynolds Memorial Hospital Rapid Care Center renovations & Emergency Room renovations

Tim E. Mizer, PE, RA, QCxP

Architectural Engineer / Architect / Qualified Commissioning Process Provider

Director of Operations

EDUCATION:

Kansas State University
B.S. Architectural Engineering - 1983

University of Cincinnati
Architecture

PROFESSIONAL AFFILIATIONS AND REGISTRATIONS:

Registered Engineering in:
West Virginia
Ohio

Registered Architect in:
Ohio

Qualified Commissioning Process Provider

PROFESSIONAL EMPLOYMENT:

McKinley & Associates
Director of Operations
Architect / Engineer / Commissioning
Wheeling, WV (1995 to present)

M.C.C. Engineering
Director of Design
Columbus, Ohio (1988-1995)

Schooley Caldwell and Associates
Electrical & Mechanical Design
Columbus, Ohio (1986-1988)

Mizer Design
Free Lance Architectural Engineering Design
Columbus, Ohio (1985-1986)

Envirotek, Inc.
Drafting and Electrical & Mechanical Design
Raleigh, NC (1984-1985)

SUMMARY OF EXPERIENCE:

The engineering will be led by Tim E. Mizer, PE, RA, QCxP, our **Director of Operations** who is an **Architectural Engineer**, an **Architect**, and a **Qualified Commissioning Process Provider**. He joined McKinley & Associates in 1995, and has over 30 years of experience. Mizer's background as both an Architect and Engineer has provided him with a total understanding of the engineering components and the process necessary for integrating architectural design and building systems. Furthermore, as a **qualified commissioning process provider**, he has been formally trained to fully understand how integrated HVAC systems function and how systems interface with others to run your building efficiently. As the Director of Operations, Mr. Mizer's presence is a key to the design procedures required to coordinate the functionality of the engineering systems into the aesthetics of a building space. He has worked on many relevant projects, such as building assessments, office buildings, tenant fit-outs, energy efficient projects, and more.

NOTABLE PROFESSIONAL EXPERIENCES:

West Virginia State Police - worked on multiple projects from our 3 consecutive Open-Ended A/E Services contracts, including renovations and new detachments. Also surveyed, reviewed, projected, budgeted, and documented 72 police facilities State-Wide.

United States Postal Service - multiple post offices in WV and PA, from our 2 IDIQ contracts. Also designed over 100 Post Offices throughout West Virginia for ADA compliance.

West Virginia Army National Guard - multiple projects, including AASF#1 Hangar renovations, statewide SPCC Certifications, new Mountaineer Challenge Academy, and new Multi-Purpose Building at Camp Dawson

Building 55: WV State Office Building Complex in Logan (LEED Certified)

Building 34: West Virginia State Office Complex in Weirton

Wheeling Island Hotel•Casino•Racetrack multiple projects

WVU State Fire Training Academy

Wheeling Island Fire Station

WVDHHR's new Ohio County office fit-out

Orrick's Global Operations Center office building fit-out

Maxwell Centre office building fit-outs

Bennett Square office building fit-outs

Wagner Building office building fit-outs

Marshall County Schools - Hilltop Elementary (LEED Certified)

Cabela's Eastern Distribution Center (\$40 million / 1.2 million SF)

The Silver Companies' Moss Neck Farm Storage Building

West Virginia School Building Authority - dozens of school renovations and new construction projects across the State

Parkview Vehicle Storage and Maintenance Garage



McKINLEY & ASSOCIATES
ARCHITECTS • ENGINEERS • INTERIOR DESIGN

Darren S. Duskey, PE

Electrical Engineer

Director of Engineering

EDUCATION:

The Ohio State University
B.S. Electrical Engineer - 1993

Marshall University
Graduate courses in Engineering

PROFESSIONAL AFFILIATIONS AND REGISTRATIONS:

Registered Professional Engineer in:
West Virginia
Ohio
Pennsylvania

PROFESSIONAL EMPLOYMENT:

McKinley & Associates
Wheeling, WV (2002 to present)

Pickering Associates
Parkersburg, WV (1997-2002)

Magnetic Specialty, Inc.
Marietta, OH (1995-1997)

Inland Products, Inc.
Columbus, OH (1993-1995)

SUMMARY OF EXPERIENCE:

The electrical design will be completed by Darren S. Duskey, PE, an **Electrical Engineer** who has over 20 years of experience in commercial, industrial, institutional, and educational markets with projects ranging from electrical design of **State Police detachments**, commercial properties, higher educational projects, PK-12 schools, health care facilities, large and small industrial projects, and more. He has extensive knowledge with the National Electrical Code, state building codes, building industry standards and practices, and has demonstrated the ability to design qualitative and economic solutions to a myriad of challenges. He has designed the electrical on many relevant projects, including experience with a wide array of **generators** and emergency power systems projects, from a small 20 kW propane generator for a volunteer fire department building, to a 500 kW diesel generator for a large distribution warehouse's life safety system and computer server rooms.

NOTABLE PROFESSIONAL EXPERIENCES:

West Virginia State Police - multiple projects across West Virginia, including backup generator and uninterruptible power supply (UPS) for the main server room at the West Virginia State Police headquarters, and designing entire building power backup generator systems for multiple West Virginia State Police detachments, including a 911 center.

Cabela's Eastern Distribution Center (\$40 million / 1.2 million SF), including 500 kW emergency backup generator

West Virginia University - Colson Hall office fit-out, including generator backup for life safety and critical systems

WVU State Fire Training Academy, including generator backup

Washington & Jefferson College - The Commons and Thompson Hall 2 major emergency power generation projects

United States Postal Service - multiple projects across WV

West Virginia Army National Guard - multiple projects

Building 55: WV State Office Building Complex in Logan (LEED Certified)

Building 34: West Virginia State Office Complex in Weirton

WVDRS Wheeling District's new office space fit-out

WVDHHR's new Ohio County office fit-out

Bennett Square multiple office fit-outs

Wagner Building multiple office fit-outs

Panhandle Cleaning & Restoration office building and warehouse

Ohio Valley Towers renovations

The Silver Companies' Moss Neck Farm Storage Building

Wheeling Island Hotel•Casino•Racetrack multiple renovation projects

Marshall County Schools - Hilltop Elementary (LEED Certified)

Marshall County Schools - Cameron High (\$32 million / LEED Registered)

Fairmont State University - College Apartments

Michael A. Heath

Mechanical/HVAC & Fire Protection Engineering Designer

EDUCATION:

ITT Technical Institute
Associate Degree in Specialized Technology:
Computer-Aided Drafting Technology - 2000

PROFESSIONAL EMPLOYMENT:

McKinley & Associates
Mechanical & Fire Protection Designer
Wheeling, WV (2007 to present)

Janus, Inc.
AutoCAD Designer / Project Manager
Pittsburgh, PA (2002-2007)

Comunale Automatic Sprinkler
Fire Protection Designer
Pittsburgh, PA (July 05 - Oct 05)

S.A. Comunale Inc.
Fire Protection Designer
Pittsburgh, PA (2000-2002)

SUMMARY OF EXPERIENCE:

Mr. Heath brings a cross-trained design background to your project, and has vast knowledge in a diverse range of disciplines. He was trained by the National Fire Protection Association (NFPA) in Dallas, Texas, and has used these skills to work on projects from multiple business sectors and with various sizes, such as the 4 story, 1,500,000 square foot David L. Lawrence Convention Center in Pittsburgh, Pennsylvania. He has vast expertise in designing and calculating fire protection systems, standpipes, dry and wet systems, hydraulics, and water cannons; stock listing materials for systems; as well as surveying job sites and frequent business trips to coordinate jobs.

NOTABLE PROFESSIONAL EXPERIENCES:

Building 55: WV State Office Complex in Logan (LEED Certified)

United States Postal Service - multiple projects

Wheeling Island Hotel•Casino•Racetrack - various projects

Cabela's Eastern Distribution Center

For 14 West Virginia counties; provided Mechanical and Fire Protection assessments at every school (160+ schools), for their 10-year Comprehensive Educational Facilities Plan (CEFP 2010-2020)

Big Sandy Arena & Convention Center

WVU Institute of Technology - Conley Hall

Southern WV Community and Technical College - Wyoming Campus

West Virginia Army National Guard - AASF#1 hangar renovations

West Virginia Army National Guard - Multipurpose Building at Camp Dawson

Silver Company - Moss Neck Storage Building

Bennett Square business center

WVDRS Wheeling District's new office space fit-out

WVDHHR's new Ohio County office building fit-out

PWP Industries

Carenbauer Wholesale Corp. office renovations / new warehouse

Panhandle Cleaning & Restoration warehouse & office building

Boone County Schools - multiple projects

Marshall County Schools - multiple projects

Ohio County Schools - multiple projects

Hancock County Schools - multiple projects

Ritchie County Middle/High School

Summers County Schools - Summers Middle School

Tyler County Schools - 3 HVAC projects

Wetzel County Schools - Long Drain Elementary



Scott D. Kain

Plumbing & Electrical Engineering Designer

EDUCATION:

Technology Education College /
Ohio State University
Associates in Mechanical Design - 1996

PROFESSIONAL EMPLOYMENT:

McKinley & Associates
Engineering Designer
Wheeling, WV (2001 to present)

HAWA Inc.
Mechanical Designer
Columbus, OH (1998-2001)

Autotool Inc.
Engineer
Columbus, OH (1995-1998)

SUMMARY OF EXPERIENCE:

Mr. Kain is an accomplished engineering designer who has performed in all the engineering trades we provide; specializing in electrical, plumbing, and fire protection. He has been utilized for various McKinley & Associates' projects that needed additional mechanical, structural, and architectural manpower. In addition, Mr. Kain has also provided 3D renderings, to aid in business development, during his long tenure at McKinley & Associates.

NOTABLE PROFESSIONAL EXPERIENCES:

West Virginia State Police - multiple projects / new & renovations
United States Postal Service - multiple projects / new & renovations
West Virginia University - multiple projects / new & renovations
WV Army National Guard - multiple projects / new & renovations
Building 55: WV State Office Complex in Logan (LEED Certified)
Building 34: WV State Office Complex in Weirton
Wheeling Island Hotel•Casino•Racetrack multiple projects
Cabela's Eastern Distribution Center (\$40 million)
West Virginia Department of Health & Human Resources' Ohio County office building renovation
Orrick's Global Operations Center
Millennium Centre Technology Park
Panhandle Cleaning & Restoration warehouse and office building
VAMC Beckley
WLU Student Union - bookstore/gift shop, concessions, lounge
Glenville State College - Robert F. Kidd Library
The Linsly School - Coudon Ogden Library
Bishop Bernard Schmitt Catholic Heritage Center
West Virginia Northern Community College - B. & O. Building
Maxwell Centre multi-use building
Bennett Square multi-use building
Wagner Building multi-use building
2000 Main Street Multi-Use Complex
Charleston Enterprise Center renovations (2009 WV AIA Design Award)
Big Sandy Arena & Convention Center
WVU Institute of Technology - Maclin Hall
Hilltop Elementary School (LEED Certified)
Cameron High School (\$32 million / LEED Registered)
Chapmanville Regional High School (\$21 million)
J.B. Chambers Performing Arts Center



Michael J. Clark Sr.

Electrical Engineering Designer

EDUCATION:

Eastern Gateway Community College
A-ATS Electro-Mechanical Engineering - 2012

Jefferson Community College
A-ATS Electrical Trade Technology - 2003

PROFESSIONAL AFFILIATIONS AND REGISTRATIONS:

Certified in SMAW Weld Process & Basic
Welding and Applications 2002

West Virginia Journeyman License

Ohio Fire Alarm License

OSHA 30 Certified

PROFESSIONAL EMPLOYMENT:

McKinley & Associates
Electrical Engineering Designer
Wheeling, WV (2012 to present)

Arcelor Mittal
Maintenance Technician Electrician
Weirton, WV (2012)

M.J. Electric
Journeyman Electrician
Iron Mountain, MI (2010-2012)

Erb Electric Company
Journeyman Electrician
Bridgeport, OH (2009-2010)

Bechtel Group Inc.
Journeyman Electrician
Glendale, AZ (2009)

Cattrell Companies, Inc
Journeyman Electrician
Toronto, OH (1998-2009)

SUMMARY OF EXPERIENCE:

Mr. Clark is an Electrical Engineering Designer and a Certified Journeyman Electrician with over 20 years of industrial, commercial and residential experience. He is knowledgeable in all areas of the national electrical code and excels in analyzing and solving problems with various electrical controls and systems. Mr. Clark brings a cross-trained background to our projects, being skilled in both the design and the construction ends which gives him a unique ability to understand all aspects of a project. He is also adept in performing electrical and mechanical installations, maintenance and repairs in plant facilities. Furthermore, he is seasoned as an Electrical Foreman and Superintendent on both commercial and industrial job sites. His key skills include Electrical Systems & Controls, Installations & Maintenance, Electromechanical Repairs, Blueprints & Schematics, Generators & Transformers, Switches & Circuit Breakers, Electrical Code, Safety & QA, Wiring Diagrams, Troubleshooting, Testing Instruments, Motors & Conduit, CAD-2D/3D, Welding, & Residential construction.

NOTABLE PROFESSIONAL EXPERIENCES:

Building 55: WV State Office Complex in Logan (LEED Certified)
United States Postal Service - multiple renovations
Wheeling Island Hotel•Casino•Racetrack - multiple projects
Carenbauer Wholesale Corporation warehouse addition/renovations
Mattern Tire Service Center Maintenance Garage
Silver Company - Moss Neck Storage Building
Jefferson County Courthouse renovations
Ft. Henry Building build-out
Follansbee City Building
Wellsburg City Building
Bennett Square renovations
Holiday Inn Express Hotel & Suites / Washington, PA
Holiday Inn Express Hotel & Suites / Cambridge, OH
Grave Creek Mound Museum renovations
Union Bank renovations
West Liberty University - Football Field Lighting
Grant County Schools - Maysville renovations
Hampshire County Schools - Animal Vet Science Center
Hancock County Schools - Weirton Elementary
Hancock County Schools - Oak Glen High renovations
Hancock County Schools - Weir High renovations
Marshall County Schools - Cameron High
The Linsly School addition/renovations
City of Steubenville - Parks Lighting



Deb Blakeman, NCIDQ #015070

Interior Designer / Architectural Designer



EDUCATION:

University of Charleston
Bachelor of Arts, Interior Design - 1992

PROFESSIONAL AFFILIATIONS AND REGISTRATIONS:

National Council for Interior
Design Qualification:
NCIDQ [REDACTED]

Associate Member:

The American Institute of Architects

PROFESSIONAL EMPLOYMENT:

McKinley & Associates
Charleston, WV (2004 to present)

HDMR Group Inc
Charleston, WV (2000-2004)

Custom Office Furniture
Charleston, WV (1994-2000)

University of Charleston
Teacher
Charleston, WV (1997-2000)

Interior Design
Charleston, WV (1992-1994)

Freeland Furniture Company
Charleston, WV (1981-1987)

Interior Reflections
Logan, WV (1980-1981)

SUMMARY OF EXPERIENCE:

Deb Blakeman has over 30 combined years of experience in the interior design field including corporate facilities, educational, residential, banks, health care projects, and more. She has knowledge and experience with application of ADA regulations, ergonomic standards, state building code and industrial standards as they apply to interior furnishings, space planning and finishes. Ms. Blakeman has spent a lot of time researching LEED-approved furnishings, finishes, etc. to make the interior energy conservation aspect a success in multiple sustainable projects. As a professional designer, Deb Blakeman believes it is important to find the right balance between organizational and individual needs to increase productivity. Improving comforts through lighting and ergonomically sound furnishings will increase employer performance, and efficient spaces will organize work flow, decreasing communication barriers.

NOTABLE PROFESSIONAL EXPERIENCES:

West Virginia State Police - new Logan Detachment

West Virginia State Police Academy renovations

Building 55: West Virginia State Office Complex (LEED Certified)

United States Postal Service - multiple projects

Charleston Enterprise Center renovation (2009 WV AIA Design Award)

WVSU's Gus R. Douglass Economic Development Center / DigISO

West Virginia Department of Health and Human Resources' Ohio
County Office Building

Wheeling Island Hotel•Casino•Racetrack - multiple projects

Hilltop Elementary School (LEED Certified)

Cameron High School (LEED Registered)

Bennett Square office fit-out

Panhandle Cleaning & Restoration office & warehouse

Mythology Marketing office fit-out

West Virginia University - Colson Hall renovation

West Virginia University - new State Fire Training Academy

WVU Institute of Technology - Maclin Hall renovation in Montgomery

Braxton County High School - Fairmont State addition/renovations

WV Northern Community College - B. & O. Building renovations

WV Northern Community College - Education Center renovations

The Linsly School - Banes Hall & Coudon Ogden Library renovations

Fairmont State University - Student Housing Apartments Complex

Sisters of St. Joseph - Convent / Assisted Living renovation

Braxton County Senior Center renovation

Michael L. Price

Construction Administrator

EDUCATION:

Belmont Technical College
Certified Surveyor

Licensed E.I.F.S. Technician

PROFESSIONAL AFFILIATIONS AND REGISTRATIONS:

Board Member:

West Virginia Capitol Building Commission

Member:

Wheeling Central Catholic Boosters
Our Lady of Peace Church
O.L.P. Basketball Coach

Vice President:

Circus Saints & Sinners

Former President:

Mt. Olivet Baseball Association

PROFESSIONAL EMPLOYMENT:

McKinley & Associates
Project Coordinator
Wheeling, WV (2009 to present)

Wheeling Hospital
Project Administration Carpentry Dept.
Wheeling, WV (2006-2009)

Main Street Bank
Foreclosure Property Inspector
Wheeling, WV (2003-2009)

Michael Price Construction, LLC
Owner
Wheeling, WV (2004-2007)

J.D. Fletcher Construction
Foreman, Supervisor and Estimator
St. Clairsville, OH (1989-2004)

National Road Utility Company
Sales, Product Inventory and Delivery
(1987-1989)

Real Contracting and Drywall
Framer, Finisher
(1985-1987)

SUMMARY OF EXPERIENCE:

Mr. Price has over 30 years of experience in the construction industry, especially in the commercial, residential, health care, and education construction, and his previous job was a Project Administration for the Carpentry Department at Wheeling Hospital. From his background he will bring vast insight to your project with his thorough understanding of building construction, codes, standards, and regulations. In addition, he has close work with architects and engineers in print takeoff and design. He joined McKinley & Associates in 2009 as a Construction Administrator; observing the construction progress of multiple notable projects, such as the award-winning West Virginia Independence Hall historic preservation project, the Capitol Theatre rehabilitation, and the award-winning J.B. Chambers Performing Arts Center at Wheeling Park High School among others. Mr. Price was recently appointed by Governor Earl Ray Tomblin to the Capitol Building Commission.

NOTABLE PROFESSIONAL EXPERIENCES:

Wheeling Island Hotel•Casino•Racetrack multiple projects

United States Postal Service - multiple projects across West Virginia and Pennsylvania

Carenbauer Wholesale Corporation warehouse addition and office renovations

Bennett Square business center renovations / historic

WVDHHR Ohio County Office Building renovation build-out

Ft. Henry Building office build-out renovations / historic

Holiday Inn Express & Suites - Triadelphia, WV

Holiday Inn Express & Suites - Cambridge, OH

Holiday Inn Express & Suites - Washington, PA

Holiday Inn Express & Suites - Cumberland, MD

Candlewood Suites Hotel - Morgantown, WV

West Virginia Independence Hall renovations / historic

Capitol Theatre renovations / historic

Ohio County Schools - J.B. Chambers Performing Arts Center

Ohio County Schools - Madison Elementary renovations / historic

Grave Creek Mound Museum renovations

Main Street Bank, multiple locations

Bayer Heritage Federal Credit Union

West Liberty University - Football Stadium Lighting

Hampshire County Schools - Animal Vet Science Center

Ritchie County Middle/High School renovations

Tyler County Schools - multiple renovations

Wetzel County Schools - multiple renovations

Robert E. Smith

Construction Administrator

EDUCATION:

University of Pittsburgh
M.S. Industrial Engineering - 1989

United States Air Force Academy
B.S. Behavioral Science /
Human Factors Engineering - 1983

PROFESSIONAL AFFILIATIONS AND REGISTRATIONS:

Board Member:
Indian Creek School District (elected in 2009)

Instructor:
Mechanical Engineering, Eastern Gateway
Community College

President:
Mingo Business Association (2007 to present)

Commander:
American Legion Post 351 (2008 to present)

PROFESSIONAL EMPLOYMENT:

McKinley & Associates
Construction Administrator
Wheeling, WV (2009 to present)

Jefferson County Regional Planning Commission
Regional Planner
Steubenville, OH (2008-2009)

Edison Local School District
Director of Operation (1999-2008)
Transportation Supervisor (1998-1999)
Hammondsville, OH

MILITARY SERVICE:

Wright Patterson Air Force Base - Dayton, OH
Chief B-2, Block 20 Field Retrofit, \$300 million
B-2 Systems Program Office (1994-1996)
Team Leader, Process Improvement Technology
Armstrong Laboratory (1989-1994)

Randolph Air Force Base - San Antonio, TX
Chief, Test Construction Section
Occupational Measurement Center (1987-1988)
Quality Control Psychologist
Occupational Measurement Center (1985-1987)
Supervisor of Test Construction Team
Occupational Measurement Center (1983-1985)

SUMMARY OF EXPERIENCE:

Mr. Smith is a self confident, articulate and highly motivated individual with superior interpersonal and teamwork skills. He has a plethora of experience in mid to upper level personnel management, advanced information systems integration, training, acquisition, contract management, transportation and maintenance, and quality control. He has 23 years of direct supervisory experience, as well as 13 years of documented success as an Air Force Officer. He is currently a member of the Board of Education for the Indian Creek School District in Jefferson County, Ohio. He is also an Adjunct Professor at Eastern Gateway Community College in Steubenville, Ohio, where he is teaching Mechanical Engineering.

NOTABLE PROFESSIONAL EXPERIENCES:

WV Army National Guard - Multipurpose Building

USPS Clarksburg Financial Office renovations

USPS Parkersburg Carrier Annex & Hub renovations

Jefferson County Commission - Ohio Valley Towers renovations (main roof, mezzanine roof, building envelope, HVAC, office build-out, etc.)

Steel Valley Regional Transit Authority roof

Cameron American Legion exterior renovations

Jefferson County Jobs & Family Services roof

Harrison County Courthouse roof

Follansbee City Building renovations

Cabela's Eastern Distribution Center

Lincoln National Bank Building

Fairmont State University's College Apartments Housing Complex

Brooke County Schools - Follansbee Middle renovations

Grant Co. Schools - Maysville Elementary renovations

Grant Co. Schools - Union Educational Complex renovations

Hampshire County Schools - Animal Vet Science Center

Hancock Co. Schools - Senator John D. Rockefeller IV Career Center renovations

Hancock Co. Schools - New Manchester Elementary renovations

Hancock Co. Schools - Oak Glen High renovations

Hancock Co. Schools - Weirton Elementary (\$26.5 million)

Marshall Co. Schools - Cameron High (\$32 million / LEED Registered)

Marshall Co. Schools - Hilltop Elementary (LEED Certified)

Tyler Co. Schools - 3 HVAC renovation projects

The Linsly School - Banes Hall & Coudon Ogden Library

The Linsly School - Behrens Gym

**Education**

West Virginia University
BS, Civil Engineering
MS, Civil Engineering
(Geotechnical)

Professional Experience

37 years.

Registrations

- P.E. Pennsylvania
- P.E. Virginia
- P.E. Maryland
- P.E. West Virginia
- P.E. Ohio
- P.E. Illinois
- P.E. North Carolina
- NCEES Record

Skills Highlights

- Geotechnical Analysis & Reporting
- Construction Materials Testing & Inspections
- Rock-socketed Caisson Design
- Groundwater & Seepage
- Earth and Rock Dams
- Landfills

Highlights of Experience

Mr. Moulton is a Principal Engineer for Triad Engineering, Inc., and in this capacity, Mr. Moulton is responsible for corporate contract administration, risk management and overall quality control and technical quality assurance of projects undertaken by the company. Specific technical activities include preparation of geotechnical proposals, review and/or preparation of subsurface exploration programs, evaluation of geotechnical data and review and preparation of detailed geotechnical reports. Mr. Moulton has also been responsible for managing design of corrective measures at three sanitary landfills under the Landfill Corrective Action Program (LCAP) in West Virginia and characterization and design of remedial measures for an old landfill in Virginia.

Relevant Project Experience**Mary Babb Randolph Cancer Center, Morgantown, WV**

Senior Engineer for geotechnical investigation of a multi-story cancer research and treatment facility located immediately adjacent to West Virginia University Hospital and Medical Center. Evaluations included deep excavations for construction of two levels underground and making use of moderate capacity spread footings constructed on weathered rock.

Chestnut Ridge Psychiatric Care Facility, Morgantown, WV

Senior Engineer for geotechnical investigation of a site for a two-story psychiatric care facility. Special considerations included treatment of excavation of basement level into pyritic shale. Recommended use of bituminous waterproofing of exposed shale to limit movement of water and air and compressible material behind basement walls to accommodate some swell and limit lateral displacement associated with these swelling shales.

National Research Center for Coal and Energy, Morgantown, WV

Senior Engineer for geotechnical investigation of a site for construction of this new multi-story research facility underlain by expansive (pyritic) shale. These materials caused severe damage to the older adjacent engineering sciences building. Accordingly, innovative foundation design approach was required to reduce the potential for heave and associated structural distress. Final foundations consisted of drilled piers (caissons) with post-tensioned rock anchors stressed to apply a foundation pressure roughly twice the anticipated maximum heave pressure

Winchester Medical Center, Winchester, VA

As Principal Engineer, responsible for preparation and/or review of numerous proposals and detailed reports for geotechnical investigations at this growing regional hospital. Activities involve meeting with facilities design and construction management personnel, interaction with architectural firm and construction management firm, review of all technical data and evaluation of foundation construction alternatives. The new hospital was completed in 1990, and new facilities which have been added since then, including an imaging center, a same day surgi-center, an additional day care center, two 3-story medical office buildings, several operating rooms, an expanded emergency department and a 4-story parking garage. Worked closely with the structural engineer on the parking garage project to develop reinforced strip footings designed using modulus of subgrade reaction in lieu of drilled piers, saving over \$100,000 in foundation construction costs.

Stafford County Public Schools (SCPS), Stafford County, VA

Since 1993, served as Contract Manager and Principal Engineer for numerous new schools under three different open-ended contracts negotiated using the Qualifications Based Selection (QBS) process. Responsibilities have included preparation of task order proposals and fee estimates, development of subsurface exploration programs, review of field and laboratory data, preparation and review of geotechnical reports and general quality assurance supervision for construction monitoring and testing projects involving new schools and additions to existing schools.

**Education**

University of Maryland
MS, Geotechnical
Engineering

Virginia Polytechnic
Institute and State
University
BS, Civil Engineering

Professional Experience
24 years

Registrations

- P.E. [REDACTED]
(Virginia)

Skills Highlights

- Geotechnical
Analysis & Reporting
- Special Inspections
- Ground Improvement
- Slope Stability
- Shrink-Swell Soils
- In Situ Testing

Highlights of Experience

Mr. Sawyers is the Regional Manager who oversees operations in the DC Metro area. He is responsible for the overall management and leadership of both the Ashburn and Winchester, Virginia offices. Over the course of his 24-year career, Mr. Sawyers has gained experience in scoping and performing Geotechnical evaluations for many different types of structures and situations, and has overseen QA/QC and Special Inspections programs on many notable projects in Northern Virginia. Having spent the majority of his career in the Mid-Atlantic Region, he has had the opportunity to work in several uniquely challenging geologic settings, and has repeated experience utilizing many different types of foundation systems.

Relevant Project Experience:***Virginia State Police Department of Forensic Science Project (GMU), Manassas, VA***

Principal Engineer responsible for coordinating and overseeing the Special Inspections and construction materials testing and observation for the Commonwealth's Northern Forensics Laboratory, near the Prince William Campus of George Mason University. The building was completed in 2009 and is certified LEED Silver.

Fairfax County Judicial Center Parking Garage

Project and Principal Geotechnical Engineer responsible for scoping and overseeing the subsurface exploration, soils laboratory testing program, geotechnical recommendations and construction materials testing and observation for the six-story parking garage. The geotechnical study included deep borings and in situ pressuremeter testing to evaluate a deep foundation system for support of the heavy structure. Drilled shafts were chosen as the most cost effective system capable of meeting the structural performance requirements for the precast concrete structure.

WMATA Metro Parking Garages

Vienna South, Vienna, VA

West Falls Church, Falls Church, VA

Franconia-Springfield, Springfield, VA

Project Geotechnical Engineer responsible for scoping, coordinating and overseeing the subsurface exploration, soils laboratory testing program, geotechnical recommendations and construction materials testing and observation for two new, six-level, precast concrete parking garages and one expansion to an existing five-level garage. The Menard Pressuremeter was used to provide in situ strength parameters for optimizing design of the drilled shaft foundations for support of the six-level garages at Vienna and West Falls Church. In order to reduce the standby time associated with obtaining down-hole SPT data in drilled shaft excavations, and provide the drilling contractor better planning information, a construction-phase test boring program was developed in order to perform SPTs at each shaft location prior to drilling at the West Falls Church garage. Foundation soils at Franconia-Springfield allowed the use of spread footings for support of the garage; however, a design was provided to the contractor for a geogrid-reinforced access road for support of the 500-ton crane.

Loudoun Courts Expansion, Leesburg, VA

Project Geotechnical Engineer responsible for scoping and overseeing the subsurface exploration, soils laboratory testing program, geotechnical recommendations and construction materials testing and observation for the two-story courts expansion which includes below-grade levels of parking garage. The geotechnical study included microgravity and electrical resistivity geophysical surveys to aide in the characterization and detection of karst features. Spread footings on a high-strength, geogrid-reinforced, aggregate mat comprised the majority of the foundation for the new building and grouted micropiles were used for support of columns near the existing buildings and in areas where solution features were confirmed during soil borings.



Education

Fairmont State College
WV BS. Civil Engineering

Professional Experience
11 Years

Registrations & Licenses

- Registered Professional Engineer, WV

Skills

- Geotechnical Evaluations
- Energy Sector
- Environmental Assessments
- Permitting
- Construction Materials Testing and Inspections

Highlights of Experience

Mr. Lipscomb is currently a Department Manager for Geotechnical Engineering Section and Senior Engineer at the St. Albans branch of TRIAD. In this capacity, he has been involved in development and management of subsurface exploration projects and development of geotechnical engineering reports providing recommendations based on field observations and laboratory results for bearing capacity, earthwork operations, earthen dam embankments, slope stability, flexible and rigid pavement design, lateral earth pressures, sinkhole remediation, geophysics (electrical resistivity and ground penetrating radar), and rock excavation. These projects have included freshwater dams, shopping centers, roadway/bridges, buildings, retaining walls, residential communities, water storage tanks, waste water treatment facilities, and structures for coal mining facilities. Duties included assignment of laboratory testing, visual inspection of soil/rock specimens, geophysics, and earthen embankment evaluation. Mr. Lipscomb has additional experience in areas relating to civil site design, hydrologic and hydraulic design, grading plans, water line plans, sewer line plans, hydraulic calculations, storage tank sizing, booster station design, roadway layout and design, storm water management plans, technical specifications, environmental and regulatory permitting, blast monitoring, and construction quality control.

Relevant Project Experience

Subsurface and Foundation Explorations (WV, VA, MD, KY, and OH)

Mr. Lipscomb has performed subsurface and foundation explorations for various private business and industrial firms. The projects consisted of performing subsurface explorations and analysis and recommending appropriate foundation types based on the results of the subsurface exploration. The projects also involved estimating potential settlement, delineating potential subsurface problems, and providing related recommendations regarding the geotechnical aspects of the projects. A geotechnical report was prepared and provided to the client for each project. Mr. Lipscomb has also designed foundation systems for buildings and other structures.

Dominion Transmission, Inc. (Chelyan, West Virginia)

As project engineer, Mr. Lipscomb processed information gathered during drilling activities and developed a report of subsurface exploration to aid in the design of a horizontal directional drilling project under the Kanawha River in Kanawha County, West Virginia. This included providing rock core unconfined compression test results, and performing a review of rock core samples to observe their Mohs Scale of Mineral Hardness values. Regional geologic information was also given to aid in the project's design.

United Coal Company (Crab Orchard, West Virginia)

As project engineer, Mr. Lipscomb performed geotechnical analysis of the site subsurface conditions and provided foundation recommendations for new coal preparation plant components planned to improve an existing facility. New coal preparation plant components included in the project consisted of a main coal preparation plant building, a raw coal reclaim tunnel, raw and clean coal stock piles (including stacker tubes), a loadout unit, and a refuse bin. Mr. Lipscomb recommended the use of cast-in-place concrete caissons for the majority of the proposed components due to underlying fill of unknown origin and variable content. Cast-in-place concrete caisson design parameters were provided for each of the proposed components, and spread foundation design parameters were provided for the refuse bin as an alternative to cast-in-place concrete caissons.

Civil/Site Design Projects (West Virginia, and Virginia)

Mr. Lipscomb has civil/site design experience related to the development of grading plans, cut/fill analysis, utility design/layout, hydrological analysis, hydraulic evaluations of open channel flow systems, storm sewer design, stormwater retention/detention design, sediment control structure design, preparation of permit applications, and consulting with clients, architects, regulatory agencies, and municipalities.

Water Distribution System Upgrades (Boone, Wayne, Berkeley, Lincoln, and Logan Counties, West Virginia)

Mr. Lipscomb has served as the project engineer for the detailed design of over 30 miles of water line extensions and associated appurtenances, including the preparation of construction drawings, water storage tank sizing and design, booster station design, hydraulic calculations, technical specifications, cost estimates, contractor's bid documents, review and recommendation of contractor's bids, and review of shop drawings.



Education

BS, Environmental
Science, Marshall
University, WV

Professional Experience

15 Years

**Registrations &
Licenses**

- Licensed Remediation Specialist, No. [REDACTED] West Virginia
- Monitoring Well Driller Certification, No. [REDACTED] West Virginia
- OSHA HAZWOPER 40 Hour Training/8 Hour Update (current)
- OSHA 8 Hour Supervisor Certification

Skills

- Due Diligence
- CERCLA
- Hazard Ranking System (HRS)
- Environmental Assessments
- Permitting

Highlights of Experience

Ms. Metz is currently the Environmental Services Manager and Senior Environmental Scientist at the Scott Depot office of Triad. Ms. Metz is responsible for the personnel management of the Environmental Services Group as well as the technical quality and management control of all Environmental projects in the southwest region. Additionally, Ms. Metz is a Licensed Remediation Specialist (LRS) and performs a variety of tasks for sites in the West Virginia Voluntary Remediation Program (VRP).

Relevant Project Experience

West Virginia Division of Highways, multiple locations, WV

As Program Manager and LRS, responsible for field activities and report preparation for WVDOH properties in the LUST, WV VRP, and UECA programs of WVDEP. Site characterization tasks have included subsurface investigations to determine the extent of contamination, multi-media sampling, groundwater monitoring well and recovery well installation. Prepares and/or provides oversight during data evaluation, prepares remedial action work plans and final reports. Responsible for project personnel selection, overall project and technical quality, budget and schedule management.

West Virginia Department of Environmental Protection, multiple locations, WV

As Program Manager, responsible for performing various assessment tasks at USEPA Superfund sites in West Virginia. Tasks have included performing Preliminary Assessments, Site Inspections, Combined Preliminary Assessment/Site Inspections, Expanded Site Inspection, and Site Inspection Reassessments under CERCLA. Specific tasks have included performing regulatory file reviews, site reconnaissance's, Hazard Ranking System (HRS) site scoring using USEPA software, USEPA Contract Laboratory Program (CLP) data management using USEPA software, providing electronic laboratory data deliverables for the WVDEP in EQUIS® data management format, Sampling and Analysis Plan (SAP) and Quality Assurance Project Plan (QAPP) generation, field sampling, and report preparation. These tasks have been performed at over 50 Superfund sites throughout WV.

West Virginia Department of Environmental Protection, Charleston, WV

As Program Manager, implemented the WVDEP Statewide Hazardous Brownfield Assessment Grant program. Tasks include preparing site assessment work plans, acting as liaison between WVDEP and USEPA, conducting Phase I ESAs, conducting Phase II ESAs, preparing reports, reporting status to WVDEP and USEPA, monitoring budgets, managing field activities, and managing community outreach.

City of Huntington, Huntington, WV

As Project Manager, implementing the City of Huntington Hazardous Brownfields Assessment Grant program. Tasks include completing an inventory of candidate sites, preparing site assessment work plans, acting as liaison between The City and USEPA, conducting Phase I ESAs, conducting Phase II ESAs, preparing reports, reporting status to The City and USEPA, monitoring budgets, managing field activities, and managing community outreach efforts.

Fayette County Commission, Fayetteville, WV

As Project Manager, implemented the County-Wide Hazardous Brownfields Assessment Grant program. Performed oversight for Phase I ESAs and asbestos inspections at 50 properties located throughout the County. Negotiated right of access agreements, monitored budgets and managed field activities.

Marshall University, Joan C. Edwards School of Medicine, Huntington, WV

As Project Manager and Environmental Scientist, performed various tasks under the WV VRP. Responsibilities included preparation of the Sampling and Analysis Plan, performing subsurface soil and groundwater investigations, data analysis, and report preparation. In addition, researched, designed, and implemented a soil gas vapor field investigation to investigate potential migration of VOCs, methane, and hydrogen sulfide from an abandoned, former MSW landfill underlying a portion of the site.



Professional Experience
26 years

Registrations

- Licensed Professional Surveyor-WV & NC
- FEMA Certified Flood Plain Surveyor

Skills Highlights

- Construction Layout
- Right of Way Plans
- Photogrammetric and Topographic Surveying
- Mine Surveying

Highlights of Experience

Mr. Kirk is currently the Survey Supervisor for the St. Albans office of TRIAD. In this capacity, he is responsible for the supervision of the survey crews, overseeing the field work through drafting to the finished product delivered to the client, meeting with clients, and performing field work on large and complex projects. Mr. Kirk is experienced in, construction layout, boundary and road work surveying, photogrammetric and topographic surveying. He has supervised and/or performed survey work on various types of work including surface mine surveying for coal mine facilities, site surveys and construction layout for landfill facilities, site surveys and right of way plans for WVDOH and NCDOT highway projects, and site surveys and construction layout for site development projects. Mr. Kirk has been involved in survey projects in several states including West Virginia, South Carolina and North Carolina.

In his supervisory capacity, he is responsible for schedules, project budgets, and the overall coordination of all survey projects. He works with all levels of engineering staff, the overall project team, and the project owner to produce a quality work product which satisfies all project requirements.

Relevant Project Experience

North Carolina Army National Guard-Morrisville, North Carolina

Professional Services 2005 / Construction Completed

Surveyor of Record / Field Supervisor providing construction staking and layout of Crash, Fire and Rescue (CFR) Facilities Building supporting the 1st of 130th Aviation Battalion (AH-64 Apache Helicopter unit) based at Raleigh Durham International Airport. Operations were conducted in close coordination with Federal Aviation Administration and NC National Guard personnel to provide layout services for the construction of an approximately \$1.3 million facility.

City of Raleigh-Raleigh, North Carolina

Buffalo Road Sanitary Sewer Collector Easement Acquisition Survey

As Surveyor-of-Record, provided direct supervision of various field crews and conducted field surveys for right-of-way acquisition, topographic location, and wetlands delineation surveys for an approximately 6000 LF sanitary sewer line. Project consisted of field work necessary to compile and prepare recordable plats of survey for easement acquisition by the City of Raleigh. Topographic mapping for design purposes, and the preparation of Wetlands Delineation Maps to secure 404(c) permits through the US Army Corps of Engineers (Wilmington District).

North Carolina Department of Transportation-Warren County, North Carolina

State Route 1608 – Will Cheek Road

State Route 1620 – Sherriff Davis Road

As Surveyor-of-Record / Data Analyst contracted to NCDOT, provided direct supervision of various field crews and conducted field surveys for right-of-way acquisition and topographic location surveys for roadway improvements. Project consisted of field surveys conducted per Federal Highway Administration High Risk Rural Roads specifications for approximately 3.5 miles of local rural roads in Warren County NC including deliverable plan sets prepared per NCDOT/NC MAPS specifications. Final field work consisted of setting Right-of-Way monumentation and staking of best-fit centerline of road alignment.



Affiliations

- Second V.P. of the Virginia Association of Surveyors (VAS)
- West VA Society of Professional Surveyors (WVSPS)
- Top of VA Builder's Association – Executive Committee & VP of Associates

Professional Experience

34 years – Surveying,
Planning, Engineering

Registrations

- Professional Land Surveyor VA/WV
- ASFPM Member, Certified Floodplain Manager

Skills Highlights

- Boundary Surveys
- Zoning Requirements
- Easement Plat Preparation
- As-Built Surveys
- Construction Stakeout and Layout
- ALTA/NSPS Surveys

Education

Graduate of the
Surveyor's Apprenticeship
Program (5 Year Course)

Highlights of Experience

Mr. Shreiner is the Surveying Manager for Triad's Ashburn and Winchester Offices. Mr. Shreiner has over 34 years of experience in the land development engineering industry working on projects located throughout Virginia and West Virginia. He is responsible for the management and coordination of Triad's survey operations in the Washington Metro Region. Specific experience includes boundary computations, numerous ALTA/NSPS surveys, subdivision computations, topographic maps, plat preparation, writing legal descriptions, deed research, plan and perform quality control on GPS surveys and responsible for survey equipment purchases. He is licensed as a professional land surveyor in Virginia & West Virginia, and is also a CFM (Certified Floodplain Manager).

Colonial Village West Apartments, Arlington, VA

Mr. Shreiner was the lead surveyor for the Affordable Housing Corporation (AHC) of Greater Baltimore with the preparation of an ALTA/ACSM Land Title Survey for the property. This site is located in Arlington County and listed on the National Register of Historic Places. The site is approximately 2.7 acres and is located within Arlington County, Virginia. The survey was prepared in accordance with "Minimum Standard Detail Requirements for ALTA/ACSM Land Title Surveys" effective February 23, 2011 including a comprehensive boundary survey of the property with a closed traverse exceeding the required relative positional precision of 0.07' + 50 parts per million as required by ALTA/ACSM standards. Analysis of a 400 page Title Report including location and recordation of all easements and encumbrances on the property. Field locations of all physical improvements including buildings, utilities, street improvements, sidewalks, trails, power lines, parking areas, fences, etc., and preparation of a plat signed by a professional land surveyor showing all site details, improvements, notes and pertinent data.

Loudoun County Landfill Sequence IV Cap System and Old Fill Cap Repair and Remediation Construction

Responsible surveyor in charge of landfill project field survey work and preparation of as-built drawings. Certified the plan sets which were submitted and accepted by DEQ. Project involved a cap system and old fill cap repair and remediation. Oversight of all field work which employed GPS and conventional field surveys. Review and checking of data and project management oversight.

VDOT Project #0029-023-132 – B616/C-501, Culpeper County

Responsible Surveyor in charge of the bridge and roadway stakeout for the overpass at Route 29 and Route 666 in Culpeper County, VA. Oversee, sign and seal all cutsheets, bridge stakeout plats and approximately 50 storm sewer cutsheets. This also included the oversight of all other components of stakeout such as clearing limits, edge of pavement, curb & gutter, stockpile areas, bridge abutments, ditches, etc.

Tysons Corner Hotel, Fairfax County, VA

Mr. Shreiner served as Survey Project Manager for construction stakeout of a multi-story hotel next to the Tysons Corner Mall. Work included stakeout and location of numerous columns, caissons, slabs, anchor bolts and underground garage levels. Tasks also included the monitoring of each floor as constructed and setting intricate control for stakeout of sheeting & shoring.



Education

BS, Geology, Morehead
State, KY

Professional Experience

25 Years

Registrations & Licenses

- Licensed Remediation Specialist No. [REDACTED]
- Monitoring Well Driller Certification No. [REDACTED] West Virginia
- Monitoring Well Driller Certification No. [REDACTED] Kentucky
- OSHA HAZWOPER 40 Hour Training
- OSHA HAZWOPER 8 Hour Update (Current)
- West Virginia UST Worker Class B
- West Virginia UST Class A/B Operator Training

Highlights of Experience

Mr. Wright is currently a Project Geologist-Licensed Remediation Specialist with Triad's Scott Depot, West Virginia office. In this capacity, he is responsible for designing and implementing technical investigations, which include Phase I and II, Brownfields, Voluntary Remediation Program (VRP), Uniform Environmental Covenants Act (UECA), Leaking Underground Storage Tank (LUST), and Superfund environmental site assessments. Assessment activities include installation of direct-push technology and auger drill rig borings and monitoring wells, as well as collection of soil, groundwater, soil vapor, surface water, and sediment samples. In addition, Mr. Wright develops sampling and analysis plans, evaluates environmental data, and prepares reports and documents. Skills: Designing and Implementing Technical Investigations, Underground Storage Tanks, Installation Direct Push Technology, Sampling and Analysis Plans

Relevant Project Experience

Dow Chemical Corporation, Charleston, West Virginia

As a direct push technology rig operator, collected soil, groundwater and soil vapor samples during performance of environmental site assessments at production facilities, landfills and decommissioned facilities.

West Virginia Division of Highways, Mineral Wells, WV

As a LRS, prepared the LUST/UECA Application, Agreement and Sampling and Analysis Plan. Conducted the site assessment which included monitoring well installation, soil, groundwater, sediment and soil vapor sampling. Prepared the Site Characterization Report. Conducted oversight of contaminated soil removal.

West Virginia Division of Highways, Various Sites throughout WV

As a LRS, prepared Site Characterization Reports, Remedial Action Work Plans, Final Reports, Land Use Covenants for petroleum contaminated VRP sites.

West Virginia Division of Highways, Various Sites throughout WV

As a Project Geologist, conducted oversight of UST removals and prepared closure assessment reports.

West Virginia Department of Environmental Protection, South Charleston, WV

As a direct push technology rig operator collected soil and sediment samples during performance of an environmental site assessment at an abandoned landfill.

Ashland Branded Marketing, Inc., Ohio, Kentucky and West Virginia

As Project Manager, supervised underground storage tank (UST) system removals and closure activities at 10-20 sites. Removed and cleaned USTs at each site. Excavated and disposed of any contaminated soils and completed site restoration activities. Installed groundwater monitoring wells, collected soil and groundwater samples and prepared site assessment reports.

American Electric Power, Cabin Creek Substation, WV

As Project Geologist, performed quarterly sampling of groundwater monitoring wells as part of the ongoing remediation of the property. As the LRS, prepared the LUST/UECA Application, Agreement and Sampling and Analysis Plan.

Columbia Gas Transmission Corp., Various States

Project Manager on a natural gas transmission project that characterized and remediated several sites contaminated by PCBs, and/or pipeline liquids. Also served as field activities coordinator and characterization team member. Additional duties included client relations, field cost accounting, field equipment/supplies management, site health and safety and QA/QC of final reports. As a direct push technology rig operator, collected soil and groundwater samples during performance of environmental site assessments at compressor stations, production facilities, and decommissioned facilities.

**Education**

West Virginia Institute of
Technology
B.S., Civil Engineering

West Virginia Institute of
Technology
BS, Mechanical
Engineering

Professional Experience
25 years

Registrations

- Registered Professional Engineer (WV)
- Certified Monitoring Well Installer (WV)

Skills Highlights

- Drilling Inspection
- Design of Subsurface Explorations
- Approval of Design Drawings
- Geotechnical Engineering Cost Proposals
- Geotechnical Analysis & Reporting

Highlights of Experience

Mr. Haynes serves as the Senior Drilling Manager for Triad's drilling operations when he manages all drilling and sampling activities conducted by the firm's regional offices. Mr. Haynes previously served as a Project Geotechnical Engineer. Mr. Haynes' duties include design and implementation of the subsurface investigations, assignment of laboratory testing, approval of design drawings, development of technical specifications, and preparation of drilling and geotechnical engineering cost proposals and reports.

Relevant Project Experience**Western Juvenile Detention Center, Barboursville, WV**

As a Project Engineer, Mr. Haynes developed and implemented the subsurface investigation for this detention facility. His responsibilities included coordination with our in-house survey department, determination of access for drill rig and equipment, and supervision of all field work.

Corridor H Drilling-Kerens to Parsons, Randolph, Tucker Counties, WV

The project consists of the geotechnical Drilling for a 5.62 mile section of a 4 lane Expressway which extends from Interstate 79 near Weston, WV east to the Virginia state line near Wardensville, WV. Mr. Haynes was the project manager for this project which consisted of 272 Borings for a total drilling footage of 15,757 feet. This project was extremely difficult due to the extremely steep terrain and strict environmental requirements.

Morris Impoundment, Doddridge County, WV

The project consists of the construction of an impoundment for the construction of a secondary containment system for a centralized water storage tank in Doddridge County, WV to be used in development of natural gas wells. Mr. Haynes provided drilling supervision and oversight during the subsurface investigation portion of the project. The subsurface investigation consisted of drilling 7 test borings to depths ranging from 16.5 to 45 ft. beneath the existing ground surface. Standard Penetration Testing was performed at each location and rock coring was performed at select borings.

Appalachian Corridor "H", Tucker and Grant Counties, WV

As a Staff Geotechnical Engineer, Mr. Haynes worked closely with the field inspectors during the subsurface investigation phase by helping make decisions concerning boring locations, depths, and subsurface descriptions. He entered boring logs, assigned laboratory testing, and prepared geological stick bar borings to be placed on the project cross sections. Mr. Haynes also designed cut and fill slopes, performed slope stability analysis on critical embankment fills, estimated shrink/swell factors for excavated materials, and tabulated probable sources of select embankment for these sections of the Corridor. He compiled all information into a final geotechnical roadway report, including the three bridges in this section. Bridge reports provided foundation recommendations and bearing capacity computations for each of the bridge abutments and piers.

Pleasants County PSD Water Storage Tanks, Pleasants County, WV

Mr. Haynes escorted Triad drillers to this project site and worked with the drill crew during the subsurface investigation. Following the subsurface investigation, Mr. Haynes developed computerized boring logs, assigned laboratory testing, and prepared a geotechnical report including foundation recommendations, allowable bearing capacities, and estimated settlements.

St. Mary's Hospital, Huntington, WV

Mr. Haynes escorted Triad's drillers to this project site and staked the test borings utilizing measurements from existing site features. Following the subsurface investigation, Mr. Haynes then prepared a geotechnical report including foundation recommendations, allowable bearing capacities, and estimated settlements.



Education

Pennsylvania State
University
BS, Agricultural and
Biological Engineering

University of Colorado
Structural Engineering
(Continuing Education)

Professional Experience
9 years

Registrations

- P.E. [REDACTED]
(Pennsylvania)
- P.E. [REDACTED]
(Virginia)
- PennDot Drilling
Inspector [REDACTED]

Skills Highlights

- Geotechnical
Investigations
- Landslide repairs
- Bridge replacements
- Roadway
improvements
- Structural design
- Drilling Inspection
- Infiltration Testing
- Soils Classification
- Construction
Materials Testing &
Inspections

Highlights of Experience

Mr. Fultz is the Geotechnical/Construction QC Services Team Manager in Triad's Ashburn, Virginia office. He is responsible for the management and oversight of both the Geotechnical Engineering and the Construction QC Departments operating in the Washington DC metro area. Mr. Fultz has 9 years of professional experience providing a wide variety of engineering services including geotechnical investigation and evaluation, structural design and engineered drawings, construction inspection, management, and technical documentation for various public and private sector clients.

Relevant Project Experience

Ft. Evans Plaza II Storage Facility, Leesburg, VA

Geotechnical Engineer providing management and oversight for subsurface investigation for a three-story storage facility with an approximate gross building footprint of 26,000 square feet supported by spread foundations. Mr. Fultz was also responsible for report preparation, foundation design and geotechnical recommendations.

Sterling Park – Lot 8 & 9, Sterling, VA

Special Inspection Engineer of Record for a three-story, blast proof General Services Administration (GSA) facility involving concrete tilt-up panel construction. Mr. Fultz provides management and oversight of QC technicians as well as on-site geotechnical consulting as needed to keep site work operations moving forward. Mr. Fultz also completed design calculations for support of the crane access road which will be utilized during tilt-up operations. Inspection services include earthwork, concrete, reinforcing steel, masonry, structural steel, water intrusion testing of window and door panels, etc.

NSA Cooling Towers (P-131), Walter Reed National Military Medical Center, Bethesda, MD

Geotechnical Engineer providing management and oversight for subsurface investigation for utility upgrades including construction of a new electrical manhole, a new substation and a relocated support building. Mr. Fultz was also responsible for report preparation to include recommendations for the design of slabs and spread foundations, excavations, site preparation, fill placement, etc.

ABC Parcel (Storage Facility), Arlington, VA

Geotechnical Engineer providing management and oversight for subsurface investigation for a six-story storage facility with an approximate gross building footprint of 25,000 square feet supported by spread foundations. Mr. Fultz was also responsible for report preparation, foundation design and geotechnical recommendations. Due to challenging site conditions, Mr. Fultz coordinated with specialty contractors to provide recommendations for ground improvements in order to stabilize existing subgrades.

Fairfax Rod & Gun Club, Manassas, VA

Geotechnical Engineer providing management and oversight for subsurface investigation for the construction of an earth dam (berm) to accommodate dredge disposal from an existing lake located on the property. Berm construction will involve the excavation of on-site material from high points on the property and using as structural material for the berm. Mr. Fultz was responsible for report and plan preparation, slope stability calculations and geotechnical recommendations. Mr. Fultz also made recommendations on the use of sheet drainage and phase construction which will save the Owner considerable cost and result in a higher quality end product.

Friendship Public Charter School – Athletic Field Renovation, Washington D.C.

Geotechnical Engineer providing management and oversight for subsurface auger probe investigation and in-situ infiltration testing information for the design of new turf athletic fields at Friendship Public Charter School/Collegiate Academy.



KENNETH R. CROWE, P.E.
VICE PRESIDENT

EDUCATION:

West Virginia Institute of Technology
Bachelor of Science, Civil Engineering (1976)

REGISTRATIONS/AFFILIATIONS:

Registered Professional Engineer in
West Virginia (1980) and Virginia (1981)

EXPERIENCE:

Stafford Consultants Incorporated (1985 to present)
Gates Engineering Company (1981 to 1985)
Westmoreland Coal Company (1976 to 1981)

PROJECT MANAGER AND LEAD DESIGN ENGINEER:

- Cameron High School, Marshall County – site work
- Weirton Elementary School, Hancock County – site work
- Hilltop Elementary School, Marshall County – site work
- Williamstown High School renovations, Wood County – site work
- Bayer Federal Credit Union, Ohio County – site work
- Oak Glen High School “Field of Dreams”, Hancock County – site work
- Oak Glen High School Multi-use Stadium, Hancock County – site work
- Weir High School Multi-use Stadium, Hancock County – site work
- Parkersburg High School, Wood County – site work
- Mercer County Health Center in Green Valley, WV – structural and site work
- Oakvale Elementary School in Oakvale, WV – structural and site work
- North Central Advanced Technology Center in Marion County, WV – structural work
- Merriman Athletic Facilities building at Virginia Tech – structural and site work
- 25 projects for the WVDoH including Cass Arch Bridge (*WVDoH Small Bridge Engineering Excellence Award Winner*), Mineral Wells I-77 Interchange Overpass Bridge (*WVDoH Small Bridge Engineering Achievement Award Finalist*), Camden Avenue I-77 Bridge, Grapevine Creek Bridge (*WVDoH Small Roadway Engineering Excellence Award Winner*), North Lewisburg Road Widening (*WVDoH Small Roadway Engineering Achievement Award Finalist*), and Mullens Overhead Bridge.
- 21 mine reclamation projects for the WVDEP, including Williamson Nursing Home Slide, Milburn Red Dog Pile, Mill Branch Refuse Piles, Canebrake Complex, and Matoaka Refuse Pile.



STACY A. FOWLER, P.E.
PROJECT MANAGER

EDUCATION:

Bluefield State College
BS, Civil Engineering Technology (1995)
University of Central Florida
Master of Science, Civil Engineering (2007)

REGISTRATIONS/AFFILIATIONS:

Registered Professional Engineer in West Virginia (2002),
Georgia (2003), and Florida (2007)

EXPERIENCE:

Stafford Consultants Incorporated (2009 to present)
Engineering Design and Construction, Inc. (2004-2009)
Port St. Lucie, FL Utility Systems Dept. (2001 to 2004)
Velcon Group, Incorporated (1998 to 2001)

Pentree, Inc. (1998)
Computects, Incorporated (1997-1998)
Visualizations, Incorporated (1995-1997)
Pentree, Inc. (1995)

PROJECT MANAGER AND DESIGNER:

- Meadow Bridge Sewer Improvements Project for the Town of Meadow Bridge, WV
- Mercer/Summers Phase IV-A Waterline Extension for Oakvale Road PSD – 8 miles of water main, storage tank and pressure reducing stations near Oakvale, WV
- Town of Rainelle Water System Expansion Project in Greenbrier County, WV
- Renovations to the Welch Water Treatment Plant for the City of Welch, WV
- Southern Grove Master Drainage Model for 3,600 acre development in Port St. Lucie, FL
- Tradition Operable Structures within the Tradition Development in Port St. Lucie, FL
- Tradition Master Control Structure spanning 50' wide drainage canal for 1,500 acre land development project in Port St. Lucie, FL
- Western Grove Master Drainage Model for 1,550 acre development in Port St. Lucie, FL
- Peacock Canal Relocation and Maintenance – included stream restoration and relocation for 3,000 acre land development in Port St. Lucie, FL
- Chester Brook Academy – paving, grading, and drainage plans along with permitting for 10,000 sq.ft. day care facility in Port St. Lucie, FL
- Port Consolidated – paving, grading, and drainage plans along with permitting for a 2 acre fueling station in Fort Pierce, FL
- B-Shaped Lake – construction plans, permitting, and contract administration for 2 acre, 80' deep lake for stormwater system in Port St. Lucie, FL



KEVIN G. SMITH
DESIGNER/CADD TECHNICIAN

EDUCATION:

Raleigh County Vocational Ed. Center (1979)

REGISTRATIONS/AFFILIATIONS:

Civil I and Civil II Certificates

EXPERIENCE:

Stafford Consultants Incorporated (1998 to present)
Computects and DBD Professional Group (1998)
G. A. Tice Incorporated (1992 to 1997)
ESP Associates (1986 to 1992)
G. O. Bledsoe Incorporated (1981 to 1986)
Holly, Kenny, Shott (1980 to 1981)

DESIGNER AND CADD TECHNICIAN:

Assists with all phases of project development, from initial site survey to preparation of base mapping, project layout (roadways, parking, water, and sewer), geometric layout, erosion & sediment control plans, profiles, structural plans, and detail sheets. Projects include:

- 12 projects for the WVDoH including Coalfields Expressway, Grapevine Creek Bridge, Hutchinson Branch Bridge, Cass Arch Bridge, Mullens Bridge, North Lewisburg Roadway Widening, Bellepoint Road Widening, West Webster Road Intersection, and Craigsville Intersection.
- Chapmanville Regional High School in Chapmanville, Logan County (site layout)
- Parkersburg South High School in Parkersburg, Wood County (site layout)
- Bayer Federal Credit Union in Moundsville, Marshall County (site layout)
- Hilltop Elementary School in Sherrard, Marshall County (site layout)
- Cameron High School in Cameron, Marshall County (site layout)
- Weir High School Stadium in Weirton, Hancock County (site layout)
- Oak Glen High School Stadium in New Manchester, Hancock County (site layout)
- Weirton Elementary School in Weirton, Hancock County (site layout)
- Oakvale Elementary School in Oakvale, Mercer County (site layout and structural)
- Mercer County Health Center in Green Valley, Mercer County (site layout and structural)
- North Central Advanced Technology Center in Fairmont, Marion County (structural)
- Brooke County Middle School in Wellsburg, Brooke County (site layout and Revit structural model)

... references ...

We feel that the best way to demonstrate our strengths and leadership in design is by referring to our past and present clients. McKinley & Associates have an ever-growing list of repeat clients, which include having multiple open-end contracts; many of these are in the governmental sector. We have multiple open-ended contracts with organizations such as the United States Postal Service in the Appalachian Area (West Virginia and Virginia), the United States Postal Service in the Erie/Pittsburgh District in Pennsylvania, and West Virginia University to name a few. We are able to respond to their needs, and we are certain that we are able to respond to all of your needs as well. So that you don't only have to take our word for it; here is a list of references that we encourage you to call (*more references are included on every project sheet*):



WEST VIRGINIA STATE POLICE
(*Open-End A/E Services Contract*)
Colonel C. R. "Jay" Smithers
Superintendent
725 Jefferson Road
South Charleston, WV 25309
304 / 746-2115

STATE OF WEST VIRGINIA
(*West Virginia State Office Complexes*)
Mr. Gregory L. Melton
Director
WV Department of Administration
General Services Division
1900 Kanawha Boulevard East
Charleston, WV 25305
304 / 558-1808

UNITED STATES POSTAL SERVICE
(*Open-Ended IDIQ Contracts*)
Mr. Don L. Mackey
Architect/Engineer Contracting Officer
Facilities Service Office
27497 Albert Pick Road
Greensboro, NC 27498
336 / 665-2894

WEST VIRGINIA ARMY NATIONAL GUARD
(*Multiple Projects*)
Major Melvin "Rocky" Hodges
Plans and Programming Branch Chief
1703 Coonskin Drive
Charleston, WV 25311
304 / 561-6353



LOUDOUN COUNTY
(*Moorefield Fire and Rescue Station*)
Ms. Sharon Hodges
211 Gibson St. NW
Leesburg, VA 20176
540 / 422-8353

CITY OF HUNTINGTON
(*Multiple Projects*)
Ms. Hessie Crislip
City of Huntington
800 Fifth Avenue
Huntington, WV 25701
304 / 696-4435



OAKVALE ROAD PSD
(*Multiple Projects, \$50M*)
Lyle Huntington
P.O. Box 1061
Princeton, WV 24740
304 / 487-2750

GREENBRIER COUNTY AIRPORT AUTHORITY
(*Multiple Projects*)
Mr. Jerry O'Sullivan
P.O. Box 329
Lewisburg WV 24901
304 / 645-3961

... copies of any staff certifications or degrees applicable to this project ...

Copies of McKinley & Associates' various licenses and certifications are found on the following pages. In addition, copies of every Architects' Registration & Authorization Certificate to provide Architectural Services in West Virginia, as well as copies of our Engineers' West Virginia State Board of Registration for Professional Engineers, are also included. Furthermore, the degrees and additional certifications these professionals have earned are listed on their resumes. We can also provide copies of certifications/licenses of our consultants if you wish to see them.

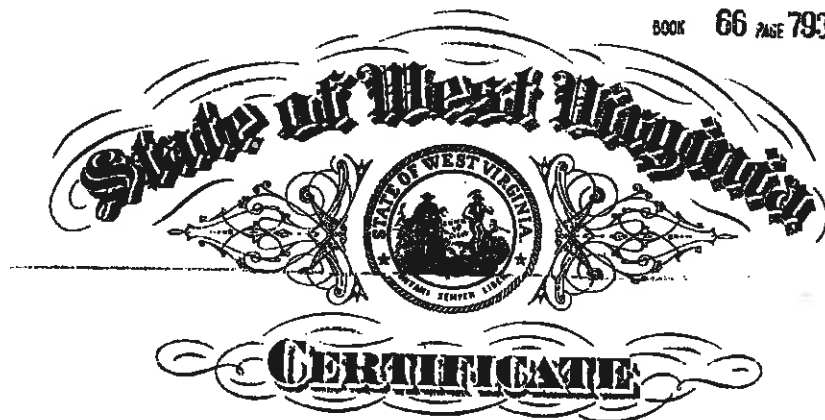

*I, Ken Hechler, Secretary of State of the
State of West Virginia, hereby certify that*

by the provisions of Chapter 31, Article 1, Sections 27 and 28 of the West Virginia
Code, the Articles of Incorporation of

McKINLEY & ASSOCIATES, INC.

conform to law and are filed in my office. I therefore declare the organization to
be a Corporation for the purposes set forth in its Articles, with the right of perpetual
existence, and I issue this

CERTIFICATE OF INCORPORATION

to which I have attached a duplicate original of the Articles of Incorporation.

*Given under my hand and the
Great Seal of the State of
West Virginia, on this*

FIFTEENTH day of
DECEMBER 19 89

Ken Hechler

Secretary of State



McKINLEY & ASSOCIATES
ARCHITECTS • ENGINEERS • INTERIOR DESIGN



**STAFFORD
CONSULTANTS
INCORPORATED**

State of West Virginia



Certificate

*I, Natalie E. Tennant, Secretary of State of the
State of West Virginia, hereby certify that*

MCKINLEY & ASSOCIATES, INC.

was incorporated under the laws of West Virginia and a Certificate of Incorporation was issued by the West Virginia Secretary of State's Office on December 15, 1989.

I further certify that the corporation has not been revoked by the State of West Virginia nor has the West Virginia Secretary of State issued a Certificate of Dissolution to the corporation.

Accordingly, I hereby issue this

CERTIFICATE OF EXISTENCE

Validation ID:0WV3W_CQTDH



*Given under my hand and the
Great Seal of the State of
West Virginia on this day of
October 27, 2015*

Natalie E. Tennant

Secretary of State

Notice: A certificate issued electronically from the West Virginia Secretary of State's Web site is fully and immediately valid and effective. However, as an option, the issuance and validity of a certificate obtained electronically may be established by visiting the Certificate Validation Page of the Secretary of State's Web site, <https://apps.wv.gov/sos/businessentitysearch/validate.aspx> entering the validation ID displayed on the certificate, and following the instructions displayed. Confirming the issuance of a certificate is merely optional and is not necessary to the valid and effective issuance of a certificate.

**WEST VIRGINIA
STATE TAX DEPARTMENT
BUSINESS REGISTRATION
CERTIFICATE**

ISSUED TO:
**MCKINLEY & ASSOCIATES INC
32 20TH ST
WHEELING, WV 26003-3750**

BUSINESS REGISTRATION ACCOUNT NUMBER: **1040-9524**

This certificate is issued on: **06/28/2011**

*This certificate is issued by
the West Virginia State Tax Commissioner
in accordance with Chapter 11, Article 12, of the West Virginia Code*

*The person or organization identified on this certificate is registered
to conduct business in the State of West Virginia at the location above.*

**This certificate is not transferrable and must be displayed at the location for which issued.
This certificate shall be permanent until cessation of the business for which the certificate of registration
was granted or until it is suspended, revoked or cancelled by the Tax Commissioner.**

**Change in name or change of location shall be considered a cessation of the business and a new
certificate shall be required.**

**TRAVELING/STREET VENDORS: Must carry a copy of this certificate in every vehicle operated by them.
CONTRACTORS, DRILLING OPERATORS, TIMBER/LOGGING OPERATIONS: Must have a copy of
this certificate displayed at every job site within West Virginia.**

atl.006 v.4
L0539442304



MCKINLEY & ASSOCIATES
ARCHITECTS • ENGINEERS • INTERIOR DESIGN

CERTIFICATE OF *Authorization*

STATE BOARD OF REGISTRATION FOR PROFESSIONAL ENGINEERS

*The West Virginia State Board of Registration for Professional Engineers
having verified the person in responsible charge is registered in
West Virginia as a professional engineer for the noted firm, hereby certifies*

MCKINLEY & ASSOCIATES, INC.

C00366-00

Engineer in Responsible Charge: TIM E MIZER - WV PE 013169

*has complied with section §30-13-17 of the West Virginia Code governing
the issuance of a Certificate of Authorization. The Board hereby notifies you of its
certification with issuance of this Certification of Authorization for the period of:*

January 1, 2015 - December 31, 2017

providing for the practice of engineering services in the State of West Virginia.



IF YOU ARE REQUIRED TO REGISTER WITH THE SECRETARY OF STATE'S OFFICE,
PLEASE SUBMIT THIS CERTIFICATE WITH YOUR APPLICATION.

IN TESTIMONY WHEREOF, THE WEST VIRGINIA STATE BOARD OF
REGISTRATION FOR PROFESSIONAL ENGINEERS HAS ISSUED THIS COA
UNDER ITS SEAL AND SIGNED BY THE PRESIDENT OF SAID BOARD.

BOARD PRESIDENT

The West Virginia Board of Architects

certifies that

THOMAS R. WORLLEDGE

is registered and authorized to practice
Architecture in the State of West Virginia.

In testimony whereof this certificate has been issued
by the authority of this board.

Certificate Number [REDACTED]

The registration is in good standing until June 30, 2016.



Lepa C. Lewis

Board Administrator

The West Virginia Board of Architects

certifies that

GREGG P DORFNER

is registered and authorized to practice
Architecture in the State of West Virginia.

In testimony whereof this certificate has been issued
by the authority of this board.

Certificate Number [REDACTED]

The registration is in good standing until June 30, 2016.



Lepa C. Lewis

Board Administrator



McKINLEY & ASSOCIATES
ARCHITECTS • ENGINEERS • INTERIOR DESIGN

The West Virginia Board of Architects

certifies that

CHRISTINA ANN SCHESSLER

is registered and authorized to practice
Architecture in the State of West Virginia.

In testimony whereof this certificate has been issued
by the authority of this board.

Certificate Number [REDACTED]

The registration is in good standing until June 30, 2016.



Lepa C. Lewis

Board Administrator

The West Virginia Board of Architects

certifies that

PATRICK JASON RYMER

is registered and authorized to practice
Architecture in the State of West Virginia.

In testimony whereof this certificate has been issued
by the authority of this board.

Certificate Number [REDACTED]

The registration is in good standing until June 30, 2016.



Lepa C. Lewis

Board Administrator



McKINLEY & ASSOCIATES
ARCHITECTS • ENGINEERS • INTERIOR DESIGN

The West Virginia Board of Architects

certifies that

RAYMOND S. WINOVICH

is registered and authorized to practice
Architecture in the State of West Virginia.

In testimony whereof this certificate has been issued
by the authority of this board.

Certificate Number [REDACTED]

The registration is in good standing until June 30, 2016.



Lepa C. Lewis

Board Administrator



West Virginia State Board of Registration for Professional Engineers

TIM E. MIZER
WV PE [REDACTED]

This is to certify that the above named PROFESSIONAL ENGINEER has met the
requirements of the law, is duly registered and is entitled to practice engineering
in the State of West Virginia.

EXPIRES December 31, 2016



West Virginia State Board of Registration for Professional Engineers

DARREN S. DUSKEY
WV PE [REDACTED]

This is to certify that the above named PROFESSIONAL ENGINEER has met the
requirements of the law, is duly registered and is entitled to practice engineering
in the State of West Virginia.

EXPIRES December 31, 2016



McKINLEY & ASSOCIATES
ARCHITECTS • ENGINEERS • INTERIOR DESIGN

... proposed staffing plan ...

The work to be performed by your design team is very clear; **to evaluate, prioritize and design within budget and schedule to meet the needs of the West Virginia State Police.** We know the **McKinley/Triad/Stafford Team** possesses the required expertise to address **all facets of your included projects**; such as architectural services; civil, structural, electrical, and mechanical engineering services; construction administration services; roof repairs; roll up doors for large vehicles; work at hangars; garages; storage facilities; renovations to office buildings; back-up generators; topographical and other field surveys; test bores and other sub-surface investigations; energy efficiency; etc.

In the past 35 years, McKinley & Associates have had extensive experience with similar projects. With our "in-house" registered professional architects and engineers, we have the ability to make your projects a success. The technical depth of our professional staff indicates that these projects can be accomplished without overloading our group or computer graphics systems. Also, by having both architects and engineers in-house, you can be reassured of smooth project delivery and sensitivity to all relevant guidelines in our state.

Since we have multiple similar contracts various projects, and with this experience, we found it advantageous to assign a **"Relationship Manager"** to be the **main point of contact** between our firms; the West Virginia State Police will have direct contact with Thomas R. Worlledge, AIA, LEED AP BD+C, REFP to talk about your various projects to assign the project manager. Since there are **multiple types of projects** involved within this contract, there will be different ways we will manage our technical team from one project to the next, based on the needs of the WVSP:

- **For example, the renovations of the old Logan State Police office** is an architectural project, and will probably be led by your actual Relationship Manager, Thom Worlledge, whom is an Architect located in Charleston.
- **For another example, if a building needs electrical engineering services** to install military surplus generators to provide backup power to various detachments and facilities, Thom will assign those projects to be **managed by Darren S. Duskey, PE, our electrical engineer.** Those projects will have support from other engineers, architects, and designers.

Our Team members have worked together on numerous projects for multiple Governmental Agencies where we followed this system, and the projects have turned out successful.

We are available to start **immediately** upon our being selected, and the McKinley/Triad/Stafford Team is available to dedicate the necessary personnel, effort, and hours to complete your projects on time.

The most important element of the entire process becomes **communication** from you to our designers. We use and welcome your input throughout the project. We continually achieve success in projects by maintaining **time and cost management, quality control and excellent communication** amongst the client, consultants, and contractors. We can and will perform for you on time and within your budget. In addition, we will help with cost estimating throughout the design phases. The way that we have historically achieved success with ANY construction project is by understanding fully the needs pertinent to the project by reviewing with the building Owner as early on as possible. Initial meetings with the users and staff will incorporate references to the standard with the object goal of determining budget, design and logistical priorities for the various projects.





Relationship Manager / Main Point of Contact

■■■ Thomas R. Worledge, AIA, LEED AP BD+C, REFP

Architectural Team

■■■ Thomas R. Worledge, AIA, LEED AP BD+C, REFP
Charleston Office Manager / Architect / LEED Attributes

■■■ Christina Schessler, AIA, LEED AP BD+C
Architect / LEED Attributes / Historic Preservationist

■■■ Ray Winovich, RA
Architect

■■■ Brandi Hinson
BIM Specialist / Architectural Designer

■■■ Gregg P. Dorfner, AIA, NCARB
Director of Architecture / Architect

■■■ Patrick J. Rymer, AIA, ALEP (CEFP)
Architect

■■■ Deb Blakeman, NCIDQ #015070
Interior Designer / Architectural Designer

■■■ Rich Halbrook
Architectural Designer

Engineering Team

■■■ Tim E. Mizer, PE, RA, QCxP
Director of Operations / Architectural Engineer / Architect / Commissioning Provider

■■■ Darren S. Duskey, PE
Electrical Engineer

■■■ Michael A. Heath
Mechanical / HVAC & Fire Protection Engineering Designer

■■■ Scott D. Kain
Plumbing & Electrical Engineering Designer

■■■ Michael J. Clark
Electrical Engineering Designer

⚡ Kenneth R. Crow, PE
Stafford Vice President / Site Civil Engineer / Structural Engineer

⚡ Stacy A. Fowler, PE
Civil Engineer / Water and Wastewater

⚡ Kevin G. Smith
Civil Site Structural Engineering Designer

TRIAD Randy L. Moulton, PE
Triad Principal Engineer / Geotechnical Engineer

TRIAD J. Michael Sawyers, PE
Triad Regional Manager / Geotechnical Engineer

TRIAD Danny Lipscomb, PE
Geotechnical Engineer Project Manager

TRIAD Heather Metz, LRS
Environmental Services Manager / Senior Environmental Scientist

TRIAD Lloyd Kirk, PS
Surveyor Supervisor

TRIAD Kevin D. Shreiner, LS, PS, CFM
Survey Manager

TRIAD Matthew Wright, LRS
Project Geologist

TRIAD John Haynes, PE
Senior Drilling Manager

TRIAD Zebulon D. Fultz, PE
Construction QC Services Team Manager

Construction Administration

■■■ Michael L. Price

■■■ Robert E. Smith

We hold weekly meetings to discuss your project, the budget, schedule and quality assurance. We provide Documented Minutes of all of our meetings and encourage the Owner to participate in as many of these meetings as possible.

Our Quality Assurance Program starts with a peer review where a registered professional not involved in the design becomes reviewer of the project before going to bid. Additionally, at our regularly scheduled project meetings the entire design team is constantly reviewing the process.

Peer Review



We are confident we can meet your program requirements. We have worked with owners in many different sectors of business and have been able to comply with their various requirements and standards, including **State Agencies** such as the **West Virginia State Police**, WVARNG, DHHR, DRS, DOE, DOC, DOJS, DOT, West Virginia University, Marshall University, West Virginia School Building Authority, and the Division of Culture & History among others,

and also Federal Agencies such as the USPS, NPS, EPA, NASA, MSHA, VA, DOD, FAA, and HUD to name a few. We are able to respond to their needs, and we are certain that we are able to respond to all of your needs as well.

You appropriately recognize how **codes**, and **state / federal regulations** are important to a successful project. Our professional's design within these codes daily, as our practice is and remains a West Virginia practice and we are dedicated more than ever to the state in which we live. All documents will be prepared with the current WV State Building Code and WV State Fire Code as well as all State and Federal Codes, Regulations, and Ordinances. We are members of many organizations, and follow their standards, such as NFPA, CEFPI, AWI, WVEDC, AIA, NCARB, ASCE, ASPE, BOCA, ASHRAE, and ACI International.

Our Eleven Month Walk-Through is a process where our professionals return to your facility eleven months after the project is completed. At that time they review all the work that was completed and check all warranties. We are making sure all of the covered work is in order and that the warranties do not expire with equipment or product not working properly. We have been doing this for 18 years which has now been adopted as an AIA 101 Standard. We also routinely conduct Post Occupancy Evaluations with the Owner to find out how well we matched the Owners' needs on all of our projects

With our previous experience on multiple relevant projects as shown on the upcoming pages; our vast experience with codes; and our great working relationship with various state agencies; we are confident that we have the talent and technology needed to make these projects successful.



McKINLEY & ASSOCIATES
ARCHITECTS • ENGINEERS • INTERIOR DESIGN



**STAFFORD
CONSULTANTS
INCORPORATED**

Being from West Virginia, we have vast experience with our local conditions and unique landscape. McKinley & Associates has enjoyed success throughout West Virginia, the Tri-State region, and the mid-Atlantic states because of our unique understanding of the region's architecture. The buildings complement their surroundings and work to create an unparalleled atmosphere for the clients. Also, by having **both northern and southern offices, we have a close **proximity to all parts of West Virginia**, so we can provide project services in an **economical, effective and efficient manner**.**

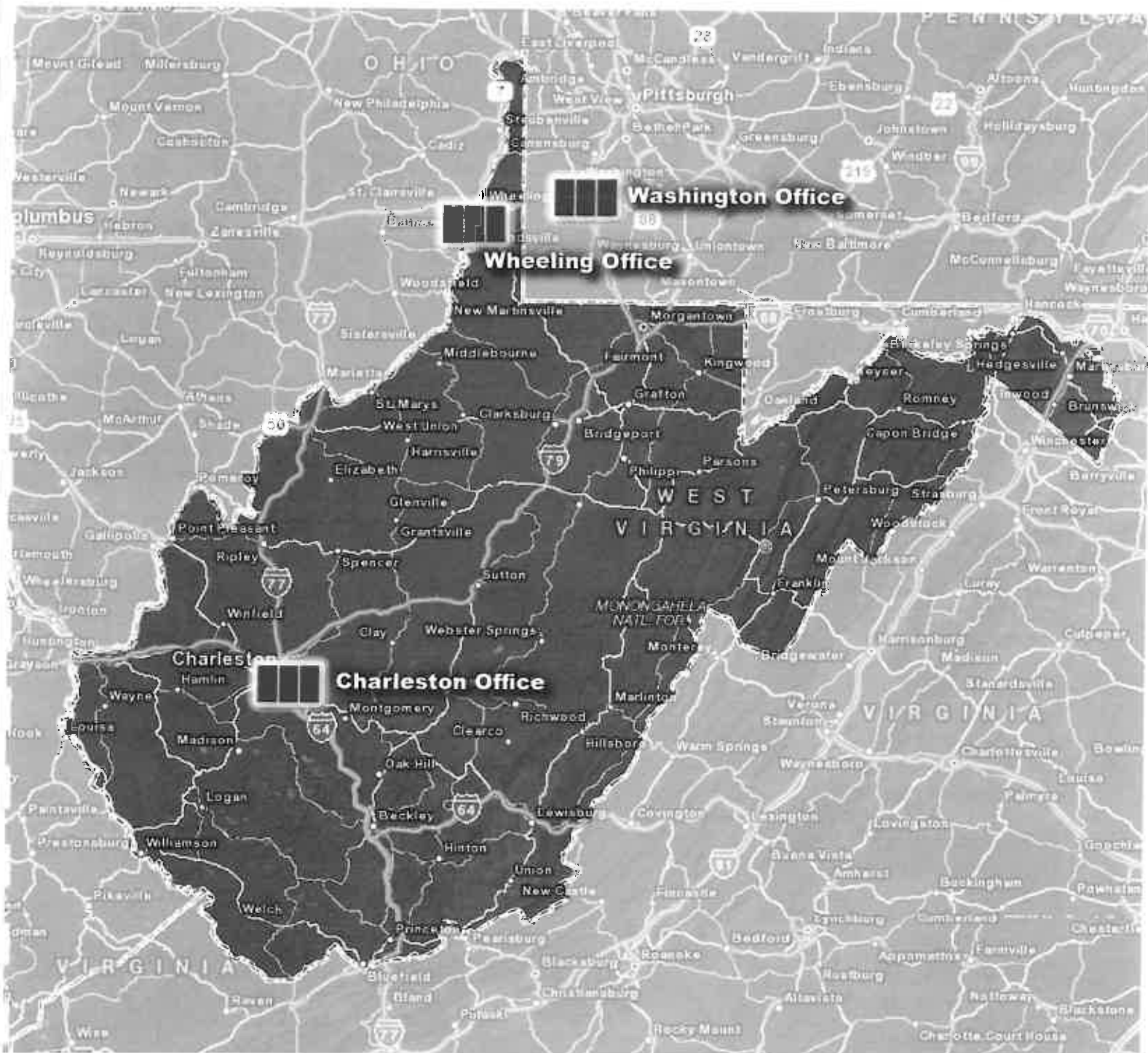

As seen on the following page, Triad Engineering also has multiple office locations:

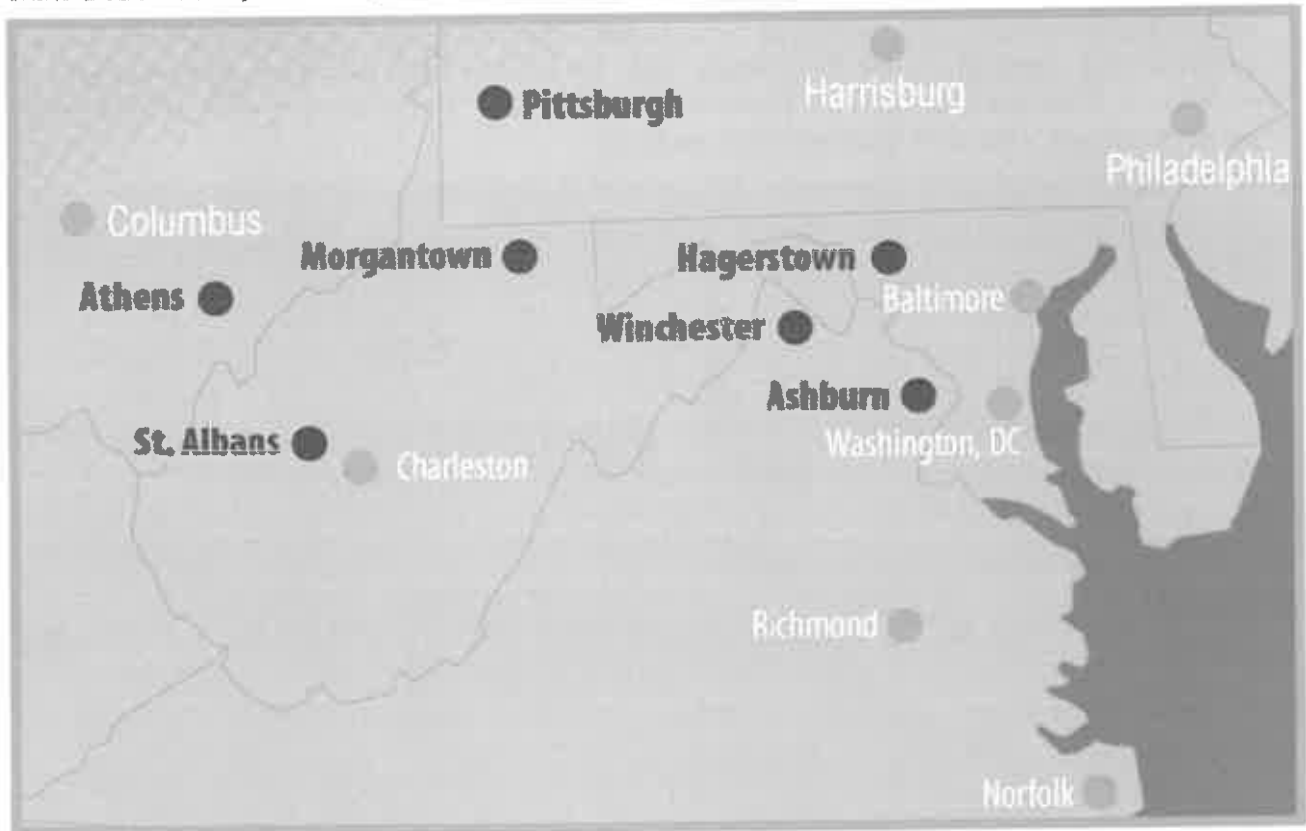

St. Albans

10541 Teays Valley Road
Scott Depot, WV 25560
304-755-0721 Phone
304-755-1880 Fax

Morgantown

1097 Chaplin Road
Morgantown, WV 26501
304-296-2562 Phone
304-296-8739 Fax

Northern Virginia

21641 Beaumeade Circle
Suite 300
Ashburn, VA 20147
703-729-3456 Phone
703-729-3459 Fax

Athens

1005 East State Street
Athens, Ohio 45701
740-249-4304 Phone
740-249-4305 Fax

Winchester

200 Aviation Drive
P.O. Box 2397
Winchester, VA 22604
540-667-9300 Phone
540-667-2260 Fax

Pittsburgh

500 Bursca Drive, Suite 504
Bridgeville, PA 15017
412-257-1325 Phone
412-257-1329 Fax

Hagerstown

1075-D Sherman Avenue
Hagerstown, MD 21740
301-797-6400 Phone
301-797-2424 Fax

... Descriptions of past projects completed entailing the location of the project, project manager name and contact information, type of project, and what the project goals and objectives where and how they were met.

West Virginia State Police Open-End Contracts (and Facilities Master Plan)

Location: State-Wide, West Virginia

Contact: Colonel C. R. "Jay" Smithers

West Virginia State Police

725 Jefferson Road

South Charleston, WV 25309

304 / 746-2115



Type of Project: Governmental - Full A/E Services - Multiple Projects

Project Description, Goals, and Objectives: For over the past 18 years, McKinley & Associates has been honored to have been selected for 3 consecutive West Virginia State Police open-ended contracts for all architectural and engineering services throughout West Virginia. We have completed numerous renovations/repairs as well as additions on police detachments throughout WV, such as in Clarksburg, Franklin, Lewisburg, Martinsburg, and Romney to name a few. The upgrades have included roofs, generators, doors, windows, interior finishes, furniture, HVAC, building skin/facades, floor tile to replace asbestos tile, fire alarm and sprinkler systems, electrical, site lighting, ADA compliance, and security systems, to name a few. Moreover, we also have completed design services on multiple new detachments in Berkeley, Logan, Morgantown, Rainelle, and Wheeling to name a few. Various buildings include garages for their various-sized vehicles (some have multiple bays), many have living/sleeping quarters, some detachments have E911 Centers. Our projects are built with energy efficiency in mind with the use of natural daylighting (such as daylight clearstories and self-supporting translucent skylights), occupancy sensors, photo sensors, kalwalls, and much more. Projects include building safety and security, compliance with codes, as well as force, bullet, and blast protection, and much more. We are proud to showcase continuous work for the WVSP throughout our State.

For one of our many projects, McKinley & Associates was tasked by the WVSP to create a Facilities Master Plan, where we surveyed, reviewed, projected, budgeted, and documented all 72 police facilities throughout the State of West Virginia. Previously, other than cosmetic, in-house studies, the WVSP has never had a master plan in effect to construct new facilities or maintain their current buildings. Also, most of their prior building repairs had been a result of emergency measures that could not be postponed; these types of upgrades have been very limited due to the lack of funding. Therefore, a strategic document was necessary to plan for future needs and goals.

A site visit to every building location was performed by a licensed architect and engineer to

determine the adequacy of the buildings and grounds. We completed our site evaluations in 49 days. A worksheet was developed prior to the site visit phase of this report so that each facility was evaluated by the same criteria. We examined the ages of the buildings, created floor plans, completed an analysis of needs, gas/electric cost comparisons to see how effectively the buildings are operating, ADA compliance, energy efficiency, meeting the future needs of the Department, growth in services and operations, projected staffing requirements and much more. The master plan not only was a comprehensive report of the current conditions of all of the properties utilized by the WVSP, it also determined whether to construct new facilities or maintain their current buildings, and budgets were also developed for furnishings and equipment for the facilities. The proposed work was extensive but was necessary. The West Virginia State Police has implemented dozens of our recommendations over the years.



West Virginia State Police Headquarters

Location: South Charleston, West Virginia

Contact: Colonel C. R. "Jay" Smithers

West Virginia State Police

725 Jefferson Road

South Charleston, WV 25309

304/746-2115

Type of Project: Governmental - A/E Services - Renovations

Project Description, Goals, and Objectives: For one project example from our open-ended contracts, we completed upgrades on the **State Police's main Data Center**, located at their **WVSP Headquarters** in South Charleston, which included **new service with a new generator and a new Uninterruptible Power Supply (UPS) for their main server room.**

Since the facility is the central hub of all police activity within the State, it must remain in operation 24/7; therefore, this emergency electric backup project was a **priority project.** This \$350,000 project included supplementing the existing 1600A, 208/120V service with a 480/277V feeder from a new service in the WVSP Headquarter's adjacent garage. The new 480/277V service has a generator which powers a panel in the main building's server room, which in turn feeds a UPS for the server, as well as a subpanel in the records room adjacent to the server room. The new emergency backup generator is a Cummins Model 400 DFEH series electric generating set rated for continuous standby service at 400 kW, 500 kVA Standby, at 0.8 PF, 277/480 volts 3 Phase 4 Wire, 60-Hz.

Before

and After



In addition, construction was recently completed on the new **Logan Detachment**, which is the **Back-Up Data Center** for this **WVSP Headquarters**; therefore, it needed much of the same emergency and power distribution systems. *More information is found on the following page.*

Furthermore, additional projects that were designed as E911 Centers for the State Police include their facilities in Berkeley, Doddridge, Mason and Pendleton Counties as well as the Morgantown Facility in Monongalia County. **Each of these facilities included secured entrances, raised access floors, UPS, and emergency backup generators.** They also included typical spaces such as Dispatch, Operations, Mapping and Data Entry, Office and Conference Rooms. The Romney Detachment included a 1000 SF 911 Center as part of the design. Although it was smaller than a normal 911 Center, it still included many of the same features mentioned above.



McKINLEY & ASSOCIATES
ARCHITECTS • ENGINEERS • INTERIOR DESIGN

West Virginia State Police's New Logan Detachment

Location: Logan, West Virginia

Contact: Colonel C. R. "Jay" Smithers
West Virginia State Police
725 Jefferson Road
South Charleston, WV 25309
304/746-2115

Type of Project: Governmental - Full A/E Services - New Construction

Project Description, Goals, and Objectives: As mentioned on the previous page, construction was completed in November of 2011 on the new \$4.5 million Logan Detachment for the West Virginia State Police, which is the Back-Up Data Center for that WVSP Headquarters facility in South Charleston. For this Logan facility, we designed a 350 kW backup generator for the entire building, as well as an Uninterruptible Power Supply (UPS) room, raised access floors, secured entrances, and more.

In addition, this 13,000 SF detachment also includes a Dispatch Center, multiple offices, squad bay for 25 Troopers w/workstations, evidence room, processing room, witness interview room, two-bay garage, and much more. This Dispatch Center includes a dispatch room, radio room, and a computer rooms with raised access floors. There are multiple **energy-efficient** and **sustainable design** aspects to the building. The Detachment uses a **daylight clearstory** to let **natural daylight** into the internal squad and conference rooms (*seen in middle picture*). This is the first time Insulated Concrete Forms have been used for State Police Buildings; which are **energy efficient** and **secure**. The **HVAC System** included the installation of 2 high efficiency condensing boilers, pumps with variable speed drive control, custom air handling unit with dx (remote condensing unit) and hot water coils, variable air volume boxes with hot water heating coils, computer room units with remote condensing units, and direct digital controls.



West Virginia State Police Academy - campus-wide projects

Location: Dunbar, West Virginia

Contact: Colonel C. R. "Jay" Smithers
West Virginia State Police
725 Jefferson Road
South Charleston, WV 25309
304/746-2115



Type of Project: Governmental - Full A/E Services - Renovations and New Construction

Project Description, Goals, and Objectives:

The \$4.5 million campus-wide improvement projects included 5 buildings: the renovation of 3 existing buildings (*seen below*), the demo of a shooting range and replacing that building with a brand new upgraded shooting range and control center, and the new training & assembly multi-purpose building. This project was completed in phases, on a building-by-building basis. The 27,708 SF **Building A** is a 2-story dormitory (for 160 cadets) with classrooms that was built in 1968. This renovation project included interior finishes, new built-in furniture, building skin/facade, windows & doors, elevator, floor tile to replace asbestos tile, upgraded HVAC, new boiler & chiller, replacing the WVSP shield at the entry, repairing the sauna and steam room, new fire alarm and sprinkler system, security system, network computers, electrical, site lighting, signage, ADA compliance and more. The 8,985 SF **Building B** is a 2-story dorm (for 10 female cadets) with classroom (for 100+ cadets) that was built in 1949. This renovation project included interior finishes, building skin/facade, windows & doors, flooring, walls, ceiling tile, ADA compliance and more. The 21,966 SF **Building C** is a 2-story dormitory (for 48 cadets) with classroom (for 100 cadets) and cafeteria that was built in the 1970s. This renovation project included interior finishes, HVAC, building skin, windows & doors, vestibule, security system, elevator, ADA compliance, fire alarm, floors, sprinkler system, lighting, data, signage, sidewalks and more. There was complete removal of **Building D** (shooting range), and replacement with a new 3,098 SF shooting range with a tower at the center. The staging area is enclosed with a glass wall toward the range, with space for 50 cadets with tables for gun cleaning and check. There is an armament room, target room, office area, three standing work benches with power, restrooms, and more. In addition, the bunker is a controlled environment with alarm system, that has storage for ammunition. Finally, the new Multi-Purpose Building (also known as the Physical Training Facility) is a 12,544 SF training and assembly building. Included in the building is a 5,500 SF gymnasium with a large storage room, an 1,100 SF strength training / weight room, an 1,100 SF cardio training room, a 784 SF "Force on Force" physical training room, locker rooms, office, and more. Everything was designed to be functional; for example, there are various interior windows throughout so an instructor could have cadets doing weights, cardio, and be in the gym - utilizing all portions of the building at the same time - and the instructor could still simultaneously supervise all three groups. There were some special considerations we had to design; for example, we had to know the equipment

being used beforehand to calculate heat loads for the HVAC. This was built with energy efficiency in mind, with the use of natural daylighting [2 self-supporting 46' x 8' translucent "skyroof" skylights (*seen above*), kalwalls, and more], occupancy sensors in every room, as well as skylight photo sensors in the gymnasium; these save an average of 30-40% on energy costs. These new projects also involved site grading and storm sewer plans, parking lot storm sewer plans, stormwater pollution prevention plans, and more. This involves exterior drainage systems of the buildings and the foundations, and tie-ins to the existing storm drain systems.



McKINLEY & ASSOCIATES
ARCHITECTS • ENGINEERS • INTERIOR DESIGN

WV Department of Health & Human Resources' new Ohio County office fit-out project

Location: Wheeling, West Virginia

Contact: State Representative:

Mr. David J. Hildreth
WV Department of Administration
1409 Greenbrier Street
Charleston, WV 25311
304/558-1295

Contact: Developer:

Mr. Michael D. Ferns, Sr.
Michael D. Ferns, Inc.
100 Marshall Street
Benwood, WV 26303
304/280-4048

Type of Project: Office Building

Project Description, Goals, and Objectives: We were asked by our client to **renovate a car showroom and service area into an office building** (now called the Mary Margaret Laipple Professional Building). The first fit-out includes space for the **Department of Health and Human Resources (DHHR)**. The 56,783 SF building was concrete and designed for cars; not people. The first challenge was to remove a large ramp that connected two floors of the building and level the concrete floors. **We worked with our client to fit the DHHR's program into the space and maximize the use of the space.** We had to work around the existing structural walls and columns and provide fire escapes at the different floor levels of the floor structure.

The **initial \$2 million fit-out project** was built in **three phases**: the exterior was completed first (including new skin, doors, windows, etc.), next the interior, and then the parking lot so the project could be fast tracked to meet the Owner's 2013 move-in requirements. We worked with the local and state code officials to bring the building into compliance with the current building and fire codes and provide access to all of the occupied areas of the building. **We worked with the owner of the building to allow a separate entrance for future tenants of the upper two floors and to keep the renovation cost to a minimum while providing a state of the art facility for the DHHR's use.**

The showroom windows were mostly in-filled because of the sensitive nature of the materials in the DHHR's office, but windows high on the wall provide natural daylight in the space. **The fit-out was divided into three distinct spaces: secure office space, Client space, and training areas.** The Office space is secured from the client area by an access control system. The training space was designed to be stand alone for use by other State staff training.



Cabela's Eastern Distribution Center

Location: Triadelphia, West Virginia

Contact: Mr. Rick Bocchetti

Cabela's

1 Cabela's Drive

Sidney, Nebraska 69160

860/290-6251



Type of Project: Commercial Warehouse - Full A/E Services - New Construction

Project Description, Goals, and Objectives: Located at The Highlands off of Interstate 70 is a **\$40 million** commercial warehouse/distribution center that was built in 2 fast-tracked phases. The building measures **1,200,000 square feet (600,000 SF for each of Phase I and Phase II)**, making it one of the largest buildings in West Virginia! Phase I included 32,000 SF of administrative offices and a large employee lunch room. Phase 2 included a **15,000 SF storage/maintenance shop** and battery charging room. The warehouse features **30-FT high-bay ceilings** to accommodate large automated storage/retrieval mezzanines and high-tech racking; the building's floor was designed to withstand continuous fork lift traffic. In order to facilitate construction during winter climate, a precast concrete wall panel system was designed for the building shell, and erected onto steel framing. The project was developed on a deep-fill, greenfield site with massive retaining walls, and new utilities. We worked closely with the site engineers to coordinate exterior vehicle circulation and fire protection systems. This included particular attention to building and dock access for the 90 dock positions. The project also included a large parking and shipping area around the facility; 300 trailer parking spaces and 750 employee parking spaces. Security lighting was designed for these areas, with careful attention paid to illumination levels to permit camera operation in the parking lot areas.

This **1.2 million square foot** facility is a key link in Cabela's retail expansion plans, serving as their primary distribution center for the East Coast.

In addition to keeping their retail stores fully stocked, it also benefits their direct business by reducing delivery times and lowering transportation costs to their catalog and Internet customers in the eastern United States. From this, certain areas of the facility need to be in operation 24/7; therefore, **Darren S. Duskey, PE**, our electrical engineer, designed an emergency backup generator and uninterruptible power supply (UPS) for the main data server room and for life safety systems. The generator is 500 kW; while the UPS is 65 kVA. This generator powers emergency lights, computer equipment, MIS power, MIS A/C, security and fire pump. Power is a key element in ensuring a fire pump works in an emergency situation; the fire pump is electric with standby power source connection to emergency generator.

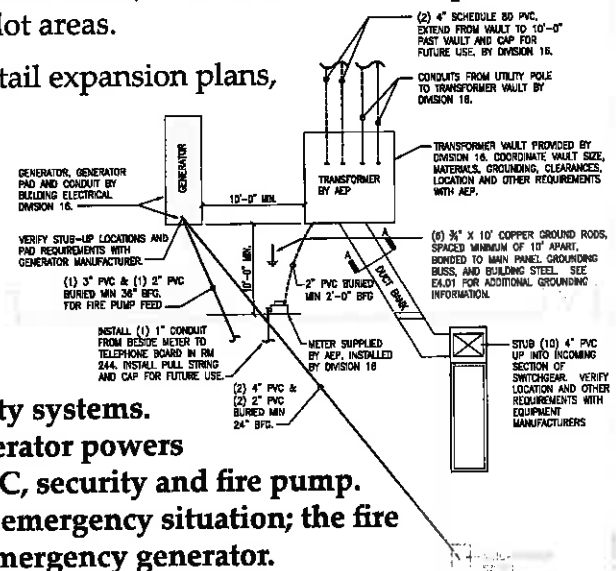

Building 55: West Virginia State Office Complex

Location: Logan, West Virginia

Contact: Mr. Robert P. Krause, PE, AIA

State of West Virginia, General Services Division

1900 Kanawha Boulevard East

Charleston, WV 25305

304/558-9018

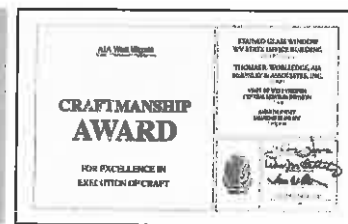

Type of Project: Governmental Office Building - Full A/E Services - New Construction

Project Description, Goals, and Objectives: City leaders were searching for a catalyst to stimulate community efforts to revitalize downtown Logan, West Virginia. This recently completed office building - dedicated on August 16, 2013 - has become that inspiration. **In March 2014, this project became LEED Certified.** The building is designed to reflect the history and culture of the area while incorporating **current technology and safety elements**, thus empowering the community leaders to create a vibrant connected urban core. This new 5-story building underscores its major role in the development and revitalization of downtown Logan by uniting office space for 127 employees for 6 state agencies under one roof, whom were once scattered throughout the city. **The 53,200 SF building provides current technology, flexibility for future growth, and security features for existing and future tenants.** At the request of the Owner, the building was designed to be **energy efficient "green" and meet sustainable design goals.** To help achieve this, a tight building envelope was created with **closed cell foam insulation and thermal efficient windows.** One of the unique features of the building is the **natural daylight system** where we added **"light louvers"** which redirect daylight to the ceiling and diffuse natural light throughout the space. The open offices were placed around the exterior of the building and the enclosed offices along the interior wall so more of the tenants receive quality light. In addition, interior windows allow the daylight to pass to the center offices. The **HVAC system** included the installation of 2 **high efficiency** condensing boilers, packaged rooftop **energy recovery ventilator**, and much more. For another feature, the plaza uses **recycled brick pavers** from the demolished street; the patterns intersect at a quilt star, a symbol of West Virginia heritage that is carried into the building's main entry. It is interesting to point out a stained glass window feature in this entry, which won a **2013 AIA Craftsmanship Award.** It is custom designed to reflect the culture and history of the area, and use as much glass from West Virginia Manufacturers as possible.

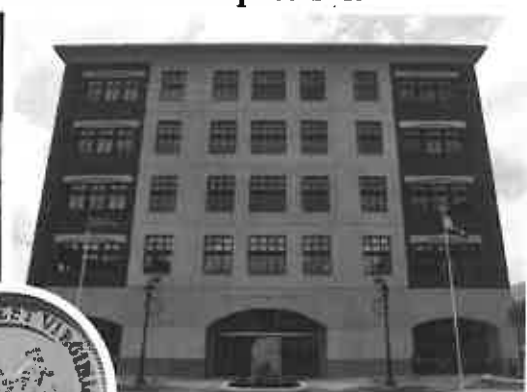

W&J - Old Main roof repair, The Commons generator, & Thompson Hall generator

Location: Washington, Pennsylvania

Contact: Mr. Ed Chavern, LEED AP

Washington & Jefferson College

60 South Lincoln Street

Washington, PA 15301

724/223-6534

Type of Project: Higher Education - Full A/E Services - Renovations and New Construction

Project Description, Goals, and Objectives: McKinley & Associates recently worked with Washington & Jefferson College on **multiple projects at 4 buildings** around their campus, between 2012-14. We designed a **roof replacement** and masonry repair project on the **Old Main Building**, a **roof solar panel installation** on their Facilities Building, a **major emergency generator installation project** with an elevated structural steel platform at their **Commons building**, and another **emergency generator installation project** at their administration building **Thompson Hall**.

The main intent of Old Main is to **repair and/or replace the existing flat roofed areas, flashing, skylights, and slate mansard roof**. There were many locations on the roof that had missing, damaged, or loose slate. There was significant evidence of water damage on the interior of the building. Similarly, the flashings, ornamental trim, box gutter, and downspout system were pitted, rusting and damaged, and needed to be replaced. Even the smallest pinhole in the metal can allow significant water infiltration. In addition, in some areas of the roof, the substrate sheathing was exposed. Since this is a historic structure; careful attention was used to identify and preserve the original, unique roof designs. **The replaced roof system included about 12,000 SF of new flat EPDM roofing, and spot repair of a large slate mansard that wraps around the entire perimeter.** The new EPDM was installed with 3" rigid insulation, and new wood perimeter blocking. The work included downspout and partial gutter replacement, as well. There was also removal of large skylight and reconstruction of roof at south wing.

The 2 natural gas emergency power generators will both provide backup power for egress lighting, life safety systems, and other mission critical processes. These required electrical, mechanical and civil engineering services, and responsibilities included researching current/projected loads and make recommendations for proper generator sizing, preparing an order of magnitude budget at various phases of design, developing a pre-purchase specification for the direct purchase of generators by the College (to reduce cost and lead time), making recommendations for generator placement giving consideration to cost benefit and reducing overall impact to the campus

environment, being responsible for utility coordination and the procurement of applicable permits, providing drawings, construction administration services, quality control and closeout. **Generator #1** will serve the **32,613 SF Commons** which serves as the main kitchen and dining hall for the College, has a radio station, coffee shop, student organizational space, and meeting spaces, and also includes some critical network equipment. It is the intent of the college that this space be used to provide food and shelter in the event an emergency. The 500 kW generator was designed to serve as backup power necessary to maintain food stores, prepare and serve food, provide heat for shelter, and, finally, serve as a campus operations center should one become necessary. Project included new transfer switches, panels, feeds, and lighting. In addition, the project included demo and excavation, as well as the addition of a concrete pad and retaining wall. **Generator #2** will serve the 14,530 SF Thompson Hall which houses offices for Business and Finance, Academic Affairs, and the Registrar, and is also the location of critical network switching equipment and a datacenter. The generator was designed to serve as backup power for the network equipment and ancillary HVAC housed there.

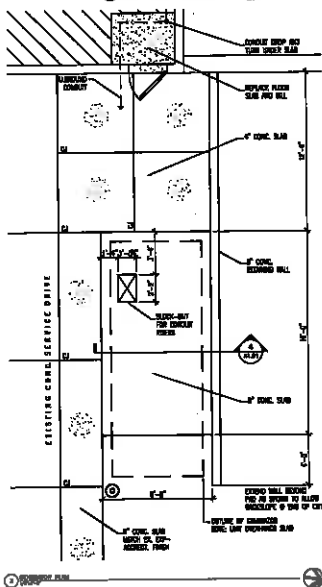

Panhandle Cleaning & Restoration - Storage Warehouse, Garages, & Office Building

Location: Triadelphia, West Virginia

Contact: Mr. Bob Contraguerro, Jr.

Panhandle Cleaning and Restoration

42 38th Street

Wheeling, WV 26003

304/232-2321

Type of Project: Warehouse / Office Building

Project Description, Goals, and Objectives: Panhandle Cleaning & Restoration invested \$3.5 million in new prefabricated metal buildings. The **Storage Warehouse** and Contents Processing Facility's exterior measures 130'x200', which includes a 6,400 SF 2-story mezzanine within the structure, providing 32,000 total warehouse square feet. **There are multiple bays and loading docks around this structure; the garages fit vehicles of various sizes.** The exterior walls are finished with masonry infill and metal siding. Interior space varies between 20' - 30' clear of the metal structure. The free-standing masonry area with a conventionally framed platform above it provides an additional storage area enabling the Owner to take advantage of the 2 ½ story clear height along one end of the warehouse. **An additional prefabricated 8,600 SF, 2-story office building is attached to the warehouse along the high side of the warehouse.** The office building also includes custom furnishings and finishes. Panhandle provides **24-hour emergency disaster clean-up services** and therefore required some **special electric, data, plumbing, and mechanical systems.** The first floor of the mezzanine is the "Contents Processing Facility," is broken into multiple rooms, and many have **specialized components and considerations** we had to design, such as casework, workbenches, and specialty electric to name a few.

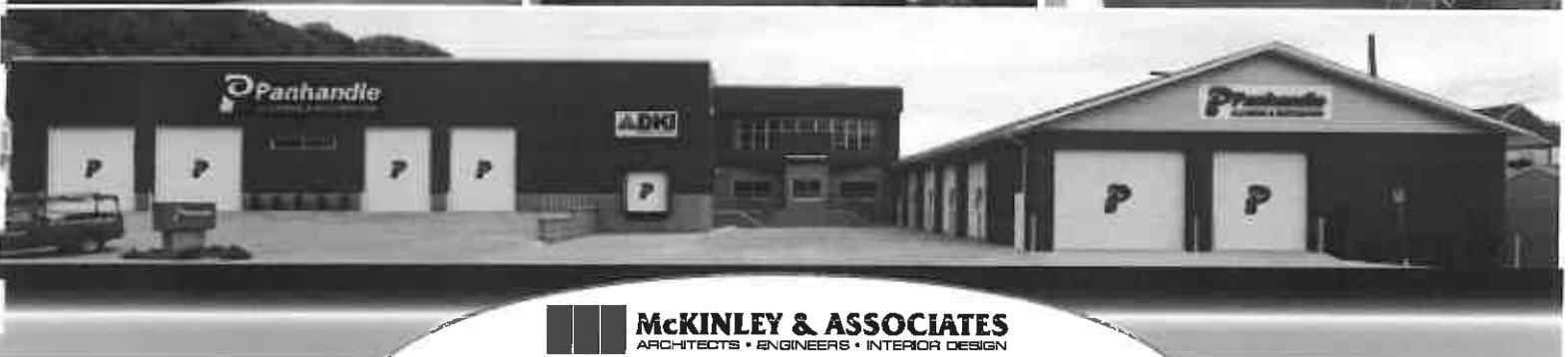

Overview

Constructed near the Intersection of the Dulles Greenway (Rte. 267) and Ryan Road in Loudoun County, Virginia, the station is within the Moorefield community and was proffered to the County as part of Moorefield Station, a multi-use, high-density housing development, near the planned final stop of the Silver Line Metrorail extension into Loudoun County.

The 13,000 SF facility serves as a combined fire-rescue station and law enforcement satellite office. The station houses an engine company, a basic life support ambulance, an advance life support ambulance and Battalion Chief.

The facility features three apparatus bays with mezzanine above, training room, volunteer office, staff porch with terrace, exercise room, and public entry with porch. It also includes bunkrooms, kitchen and dining areas, decontamination and laundry facilities, an on-site air compressor for breathing apparatus, office workspaces, repair shop, and office space for the Loudoun County Sheriff's Department.



Triad Engineering conducted a detailed geotechnical investigation, including soil test borings, auger probes, laboratory testing and preparation of a detailed report with design and construction recommendations. Infiltration testing was conducted at proposed stormwater detention pond locations and results were included in the geotechnical report. Triad also performed pavement analysis for both

flexible and rigid pavement areas, including parking areas, drive lanes and interior apparatus bays.

Challenges and Solutions

The subsurface exploration conducted as part of Triad's detailed geotechnical study confirmed the two mapped soil units indicated by the Loudoun County soils survey map, both of which are classified as Class IV soils, the most problematic when it comes to general development. The soils encountered in the test borings were of very low strength and laboratory tests indicated some highly plastic soils in some areas. The potential for highly plastic soils to shrink, swell, and undergo significant volume changes during fluctuations in moisture content was a significant concern in these Class IV soils that are poorly drained and subject to prolonged perched water tables. Recognizing this concern, Triad worked with the design team to develop geotechnical engineering recommendations aimed at mitigating these problematic soils.

Triad also conducted laboratory CBR testing in order to estimate soil subgrade strength under saturated conditions and provided both rigid and flexible pavement designs tailored to these low-strength soil properties. The site-specific solutions recommended by Triad for this project allowed for the construction of a safe, reliable structure in a challenging soil profile.



Project Type:
Public Safety

Year Completed:
2011

Client:
Loudoun County Office of
Capital Construction

Client Contact:
Ms. Sharon Hodges
211 Gibson St. NW
Leesburg, VA 20176

Project Cost:
\$3,500,000

Triad Services:

- Geotechnical Investigation
- Soil Borings
- Laboratory Testing
- Infiltration Testing
- Pavement Analysis
- Foundation Design Recommendations

Key Project Personnel:

Randy L. Moulton, PE
Senior Geotechnical
Engineer

R.J. Strother, PE
Geotechnical Engineer

4. Project and Goals:

4.1 Develop drawings and specifications for renovating/updating various projects, for the purpose of advertising and awarding construction contracts.

4.2. Provide full design services that may include civil, structural, electrical and mechanical disciplines to assist with the design and construction of fully functional facilities within the proposed budget.

4.3. Preparation of the definitive design including preparation of all preliminary and final working drawings, specifications, detailed cost estimates, bidding and construction schedules and assistance in surveying, analyzing and evaluating bids or proposals for construction.

4.4. Perform construction supervision and inspection services to include daily on-site owner representation and review and approval of samples and/or shop drawings, preparation of change orders and detailed cost estimates, evaluation of suppliers change order proposals and recommendations for negotiation, and preparation of record drawings (reproducible) showing construction work as actually accomplished (as-built drawings). These services also include presiding over the required construction meetings and preparing construction progress and forecast reports.

4.5. Development of preliminary design including the necessary topographical and any other field survey, test bores and other sub-surface investigations; preparations of preliminary studies, sketches, layout plans and outline specifications and preparation of reports including cost estimates of the proposed project and of all structures, utilities and appurtenances thereto: and design and construction schedules.

The McKinley/Triad/Stafford Team will meet all your goals and objectives!

The McKinley/Triad/Stafford Team will **develop drawings and specifications** for renovating/updating various projects, for the purpose of advertising and awarding construction contracts:

Each of the various projects begins with not only an existing plan review, but we will begin with initial team meetings to open up a dialogue. The Professionals sit down with the West Virginia State Police parties assigned to the project to establish a scope of work, schedule, budget and program. Site investigation, testing, surveys and research usually occur before the design phases start. Once clearly defined, a project moves into design. McKinley's Project Manager and support staff document discussions and design decisions. The Project Manager coordinates project related tasks and Consultant progress, code reviews or product demonstrations. McKinley can encourage project participants in the directions necessary for meeting schedule, budget and program goals established. Often the steps and phases over-lap or can be deleted depending on the scope of work, the timing of the project, or the needs of the Client. Establishing that a particular step is not needed keeps the project moving and on budget too.

During the design phases all needed personnel become fully versed in the Client's program, project requirements and design standards. The design team is responsible for identifying for the Client any potential conflicts between program criteria and design standards and resolving those conflicts to the client's satisfaction.

As the schematic/concept plans are developed, your Project Manager for each project will present the plans for review and comments to a plan group depending on the nature of the work; e.g. architects critiquing the architecture and engineers commenting on the engineering. Once a consensus is reached, the plans advance in the process.



Prior to the completion of each phase, a set of project documents is issued to each discipline for coordination, cross-checking and review. The following items are checked at that time: Drawings and specifications for program compliance; Drawings and specifications for internal coordination; Cost effectiveness of the design; Drawing accuracy; and Compliance with appropriate codes and client standards.

After coordination check corrections are completed, the Project Manager will review the documents and compare the completed documents with check prints to verify that corrections have been made in accordance with the project design criteria.

During the subsequent phases of design, all items are checked by persons other than those performing the daily design work in order to provide fresh insight. Prior to the final release of the documents, revisions are checked by the Project Manager and appropriately referenced on the drawings. Copies of the final documents will be distributed to you for final review and approval. All comments will then be incorporated into the documents prior to issuance for **advertising**, bidding and construction.

At this point, McKinley & Associates will submit these final approved construction documents to all of the pertaining code review agencies for their approval and permitting of the construction project. This drawing submission code review will not be the first time communicating with these code officials, as it is our common practice to engage these personnel with any questions we may have during the design process. We have found over the years that this early communication (during design stage) is a lot more cost and time effective while any needed changes can occur on paper not reconstruction.

After all reviews are completed and permits retained, the bid documents are issued after a final check to verify that all bid packages have current revisions included and are appropriately identified. Bid sets are numbered and registered to bidders so that each bidder may be kept informed of clarifications and addenda. Finally, we will assist with reviewing the bid and **awarding the construction contracts**.

The McKinley/Triad/Stafford Team will provide **full design services** that will include **all** civil, structural, electrical and mechanical disciplines (*and more*) to assist with the design and construction of fully functional facilities within the proposed budget:

This may include architectural services and structural engineering for the roof repair/design at Troop 3 Headquarters, Kearneysville (Jefferson Co), WV.

This may include architectural services, electrical engineering and structural engineering design services for the installation of new roll up doors to facilitate parking large vehicles at the WV State Police Academy hangar facility located in Dunbar (Kanawha Co) WV.

This may include architectural services, surveying, as well as civil, structural, geotechnical, electrical and mechanical engineering design services to design plans for a garage facility at Troop 3 Headquarters located in Beverly (Randolph Co), WV.

This may include architectural services, surveying, as well as civil, structural, geotechnical, electrical and mechanical engineering design services to design plans for a storage facility at the Procurement Division located in South Charleston (Kanawha Co) WV to replace the building on the back of the parking lot.

This may include architectural services, structural, electrical, mechanical, plumbing and fire protection engineering design services for the renovations to the old Logan State Police office, Logan (Logan Co) WV.

This may include electrical engineering services to install military surplus generators to provide backup power to various detachments and facilities. This will probably include architectural and mechanical engineering to install the systems. This might also include civil or structural engineering services for elevated structural steel platforms, concrete pads, retaining wall, etc.

Furthermore, to design within **budget**, our Quality Assurance Program starts with a peer review where a registered professional not involved in the design becomes reviewer of the project before going to bid. Additionally, at our regularly scheduled weekly project meetings the entire design team is constantly reviewing the process to discuss your project, the **budget**, schedule and quality assurance. We provide Documented Minutes of all of our meetings; moreover, so that we meet your objectives and requirements, we encourage the WVSP to participate in these meetings. Moreover, during the actual construction of the projects, the primary objective of our CA services is to ensure completion of work the way the client wants it - as scheduled and as **budgeted**.

The McKinley/Triad/Stafford Team will prepare the **definitive designs** including preparation of all preliminary and final working drawings, specifications, detailed cost estimates, bidding and construction schedules and assistance in surveying, analyzing and evaluating bids or proposals for construction.

Throughout the years we have worked on many relevant projects, achieving **success of design** and schedule by maintaining time and cost management, quality control and excellent communication amongst the client, consultants, and contractors. This is a **constant process** which **begins with the initial project activity and continues through document submissions, construction and owner occupancy**. The longevity and sizes of the McKinley/Triad/Stafford firms and our histories of success completing complex and innovative projects is founded upon our commitment to this process.

For cost control, we feel we have been able to accomplish our project successes by focusing on these finer points: First, understanding the West Virginia State Police's needs of their facilities through good communications up-front with the owners representatives to **ensure the project scope is understood from the beginning** planning stages. Second, utilizing our vast design experience and knowledge of the needed systems inherent to a WVSP facility project and helping the owner understand the importance of these items. Next, McKinley & Associates **tracks the budget through all phases**, all of the programming and design phase documents, and ensure that the total building scopes continue to stay within the budgeted amount. Lastly, we feel that **close project observations** during the construction phase is of the greatest importance. Our Construction Administrators maintain a great working relationship with the Contractors of your project; they ensure that you are receiving the intended design on the construction of your project.

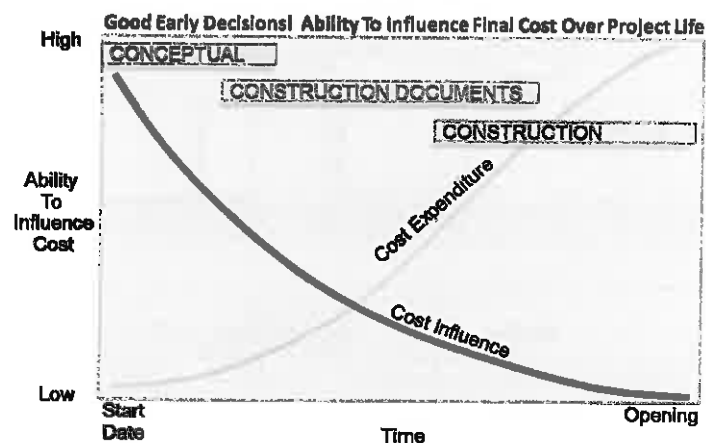

The McKinley/Triad/Stafford Team will perform **construction supervision and inspection services** to include daily (*if this is what the WVSP requires - please see the following paragraph*) on-site owner representation and review and approval of samples and/or shop drawings, preparation of change orders and detailed cost estimates, evaluation of suppliers change order proposals and recommendations for negotiation, and preparation of record drawings (reproducible) showing construction work as actually accomplished (as-built drawings). These services also include presiding over the required construction meetings and preparing construction progress and forecast reports.

Our **Construction Administrators (CA)** have an extra responsibility than what most firms' CAs have; our CAs are a part of the design process from Day 1 (they are not thrown into the project only when construction starts; they are involved from the beginning), so they know the ins-and-outs of the project. Your CAs have an important role as being the liaison between the Owner, Contractor, and Architect/Engineer. The primary objective of this service is to ensure completion of work the way the client wants it - as scheduled and as budgeted. The CA will evaluate the quality of the work to verify that it meets the level required by clients; in addition, they will monitor the contractor's progress to ensure that they are following the Construction Documents. The CAs will observe the construction progress, is responsible for all construction meetings and minutes, and will verify pay application and change orders. The Construction Administrator is **typically** on-site once every week or two weeks, but we can provide additional on-site representation if requested. **If you require a daily on-site owner representation; we will provide you with that service.**

During the construction, the processing of shop drawings and submittals will be controlled and monitored by your Project Managers. The standard turnaround for the receipt, logging, review and return of submittals is 10 working days while urgent items can often be expedited to satisfy the construction schedule. The Project Manager coordinates project-related tasks and consultant progress, performs code reviews and writes the project specifications. We will utilize our various documents we have created, such as our Project Phase Responsibility Matrix, RFI Log (*seen below*), Submittal Log (*seen below*), and Project QA/QC Checklist documents.

For all of our Clients we require a set of Operation & Maintenance Manuals be submitted from manufacturers as Closeout Documents. Equipment specific Maintenance Agreements can be incorporated into the construction documents if the Owner believes staff availability might be sporadic. The Eleven-Month Walk-thru is specified to follow-up on the status of the completed work and to make it possible to review product performance and final installation standards have been met before the warranties expire.

The project completion time frame expectation for Project Closeout is defined in the front end of the Project Manual in the Specifications so that the contractors are aware of the requirements before submitting a bid. Our Construction Administrators monitor progress during the project and verify that closeout documents are submitted in a timely manner upon Substantial Completion, and they can specify tools and goals (such as deadlines or monetary values) to encourage compliance.

Submittal Log										Project:			
										Contractor:			
										Project No.:			
Ref #	Specs	Description/Title	Contractor/Manufacturer/Supplier	Received	To	Date Rec'd	Date Ret'd	Approved	Amount As Noted	Revised/Revised	Rejected	Date Ret'd	Closeout To

RFI Log										Project: (NAME)			
										Contractor: (NAME)			
										Project No. (NUMBER)			
RFI #	RFP	Description/Title	Drawing Reference	To	Date Sent to Consultant	Date Returned from Consultant	Date Sent	Date Ret'd	Sketch #	Cost/Time Issue \$	S/Days	Change Order #	

The McKinley/Triad/Stafford Team will **develop preliminary design** including the necessary topographical and any other field survey, test bores and other sub-surface investigations; preparations of preliminary studies, sketches, layout plans and outline specifications and preparation of reports including cost estimates of the proposed project and of all structures, utilities and appurtenances thereto: and design and construction schedules.

As mentioned before, McKinley & Associates have teamed up with Triad Engineering and Stafford Consultants to provide you with all necessary professional architectural/engineering services for your various projects across West Virginia.

Your **new structures**, the garage facility (Beverly) and storage facility (South Charleston), will need preliminary field surveys and investigations, and the McKinley/Triad/Stafford Team have the ability to complete all the surveying, as well as civil, environmental, and geotechnical engineering services you require to complete the preliminary reports and plans. We will look at all the structures, utilities and appurtenances.

For the **existing structures** (Kearneysville, Dunbar, Logan, etc.) our staffs will re-assess your existing Architectural and MEPS plans and specifications to determine best option for the entities. Not only will we research cost effective options for renovations and repairs, we can also research energy efficient options. **We know the technology and we know how to apply it effectively.** Our **Philosophy** is to provide our clients with experienced leadership as well as state-of-the-art and innovative design expertise to accomplish the goals of your projects. We also believe that enhancement of the physical environment in which each individual lives and works should add significantly to the enjoyment of life. Our Team has dedicated our professional skills to attain your **goals and objectives**.

For some additional information of our firms:

McKinley & Associates is on the forefront of **innovative design**. **Sustainable Design** (whether it is LEED or any other type of **Energy Efficient "Green" Building**) is a fastly growing and supported philosophy. **Buildings designed today will need to meet the demands of the future;** McKinley & Associates identifies the changes necessary in the design of today and to meet these demands. **This approach helps to retain the buildings' long-term profitability and value, which achieves the buildings' sustainability.** We approach ecological design from a business perspective, offering proactive solutions to complex problems such as **indoor air quality, energy efficiency, resource depletion, and water quality.** Our architectural/engineering staff has had special opportunities and experience related to various typical and atypical building types. We designed the first Chilled Beam HVAC System in the State of West Virginia, one of the first Variable Refrigerant Volume / Air-Cooled DX Multizone System in the State, and one of the first buildings designed for all LED interior and exterior lighting - and the bids came in for the same cost as conventional florescent lighting. **Function, economics and versatility**, in addition to the development of **strong aesthetic appeal**, are crucial elements in our design process. **With commercial and institutional project experience**, the McKinley Team can provide sustainable design and construction guidance to your project. It is with this experience that we are able to bring insight to the design to retain and improve your long term value.



The LEED® (Leadership in Energy and Environmental Design) Green Building Rating System™ developed by the U.S. Green Building Council (USGBC) is the nationally accepted standard for the design, construction, and operation of high performance green buildings (www.usgbc.org). In January 2001, our firm was the first organization in West Virginia to join the USGBC. No other WV firm joined until nearly 2 years later! Our LEED Accredited Professionals, along with our skilled architectural/engineering team, can and will efficiently and cost effectively develop Energy Efficient goals specific to your projects.

We have 2 LEED Accredited Professionals with a Building Design and Construction specialty (LEED AP BD+C) on staff (Thomas R. Worlledge, AIA, LEED AP BD+C, REFP and Christina Schessler, AIA, LEED AP BD+C). Both Thom's and Christina's LEED AP Specialty Logo signifies advanced knowledge in green building practices and specialization in commercial design and construction. As mentioned before, Thom is the "Relationship Manager" and main point of contact for your proposed projects. Thom was the first LEED AP in West Virginia! He has 2 LEED Certified Projects: Building 55: West Virginia State Office Complex in Logan, WV (LEED NC 2.2), and Hilltop Elementary School in Sherrard, WV (LEED for Schools 2.0) which is the 1st LEED Certified School in the state of West Virginia!

All of our current LEED Registered Projects are either under construction or in design with potential LEED Platinum Certification or potential LEED Silver Certification. Our LEED Registered Projects are (LEED Rating System in parentheses): Cameron Middle School/High School in Cameron, WV (LEED for Schools 2.0), Bellann in Oakhill, WV (LEED EB O&M), and SMART Office in Williamson, WV (LEED CI).

In addition, we also have an Interior Design department. Basic interior services begin with a strategy session designed to determine the owner's project requirements, timetable and budget. The interviews will include analyzing space requirements, operating procedures, communication relationships and future needs. Inventory of existing conditions are used to develop accurate drawings and plans. Application of current ADA and building codes will be applied to the developed plans for way finding (signage, directories, fire escape plan), furnishings and finishes. Attention to budget and maintenance is given in relationship to owner needs. Construction documents required to detail the project include schedules, elevations, plans, presentation boards and specifications.

As previously stated, our approach to design requires an ongoing dialog with all parties including in this case building owners and the end users of the facility. Throughout the design process, we typically hold design workshops at the discretion of the owner to obtain the critical information needed to achieve a through design that not only meets the tenants needs but also your budget as the owner.

McKinley & Associates has a great working relationship with our State Fire Marshal and we commonly design to the State Fire and Life Safety Codes. We have worked with owners and tenants in many different sectors of business and have been able to comply with all of their various requirements and standards, including all Federal and State Agencies. We are able to respond to their needs, and we are certain that we are able to respond to your needs as well.

We would love to continue our relationship with the West Virginia State Police!

Triad Engineering, Incorporated (Triad) is an **employee owned**, regional consulting firm based in West Virginia that provides professional services in the areas of civil, environmental, geotechnical engineering; site assessment; planning and landscape architecture; geology and hydrogeology; surveying and mapping; construction inspection; and related services. Our firm has provided services on many thousands of projects of varying size and complexity since its founding in Morgantown, West Virginia in 1975.

Through our 40 years of service in West Virginia and surrounding states, both the number and complexity of these projects have grown. Our clients include Federal and State governmental agencies, mining and industrial corporations, contractors, architects, engineers, attorneys, developers, and commercial organizations.

Facilities and equipment available to support our staff have continued to evolve through the years to adapt to the changing needs of the market. Each of our offices contains computer facilities that are utilized for hydrogeological evaluations, risk assessment, stability analyses, survey data



reduction, mapping and site design. Our computer based drafting and reproduction facilities are used to develop detailed site plans, construction details, and other graphic documentation as required for our projects. Our Utilities Group possess all the necessary equipment to perform a thorough and comprehensive Sanitary Sewer Evaluation Study including Closed Circuit Television Camera Systems (remote control and cable driven), flow meters and smoke testing equipment.

Triad currently includes a staff of nearly 200 personnel located in seven offices: Hagerstown, Maryland; Pittsburgh, Pennsylvania; Ashburn and Winchester, Virginia; Athens, Ohio; and Morgantown and St. Albans (Scott Depot), West Virginia. Our personnel include chemical, civil, environmental, geotechnical and mining engineers, as well as geologists and hydro geologists, biologists, chemists, environmental scientists, planners, landscape architects, natural resource specialists, regulatory compliance specialists, permitting engineers, risk assessors and health and safety specialists.

ENVIRONMENTAL SERVICES

Triad provides a broad, comprehensive range of environmental consulting services to a variety of clients through the expertise of our diverse staff of environmental scientists, engineers, geologists, biologists, chemists and licensed remediation specialists. Our clients include federal and state regulatory agencies, county development offices, property owners, developers, banks, hospitals, and private industries.

We are proud of our relationships with state and federal environmental agencies, built over time through integrity and sound scientific work. Our staff is experienced and knowledgeable in current environmental regulatory requirements and has a proven track record of successfully completing projects for our diverse clients.

Our Environmental Services Include:

Environmental Site Assessments

- Due Diligence Evaluations, including Transaction Screen Assessments and Phase I and Phase II ESAs
- Vapor Intrusion Assessments
- Remediation Design & Oversight
- Human Health and Ecological Risk Assessments
- Waste Characterization

Brownfield/Voluntary Cleanup

- WV Voluntary Remediation
- PA Act 2 Projects
- Community-wide Brownfield Assessments
- Targeted Brownfield Assessments

Underground Storage Tanks

- UST Closure
- Site Characterization and Corrective Action Plans
- Groundwater and Soil Remediation

Data Validation and Data Quality Services

Indoor Air Quality/Industrial Hygiene Assessments

- Asbestos Inspections
- Indoor Air Quality Assessments
- Radon and Mold Assessments
- Lead-Based Paint Assessments

Oil and Gas Related Environmental Services

Mining Related Environmental Services

Ecological Services

- Wetland Delineation Studies and Permitting
- Wetland and Stream Mitigation
- Forest Compliance Delineation Studies
- Rare, Threatened and Endangered Species Evaluation

Groundwater Studies

- Source Water Assessments
- Hydrogeologic Investigations
- Fate and Transport Modeling
- Natural Attenuation Modeling

Permitting/Regulatory Compliance

- NPDES Permits
- Storm Water Pollution Prevention Plans (SWPPP)
- SPCC Plans
- Clean Air Act
- NEPA Evaluations

Grant Application Assistance



Please contact Triad to ask about other services which may not be listed

www.triadeng.com

◆ GEOTECHNICAL ENGINEERING SERVICES

Triad was originally formed in 1975 as a geotechnical engineering firm, and our expertise in this discipline is superior. Many of Triad's engineers have advanced degrees in geotechnical engineering. The combined education and professional experience of our staff provides our clients with cost-effective and practical solutions for the most difficult soil, rock and groundwater problems. Our clients include industrial and mining companies, governmental agencies, contractors, architects, engineers, developers, owners and commercial organizations. Geotechnical projects have included investigations for hospitals, churches, hotels, schools, shopping centers, communication towers, wind turbines, water and petroleum product storage tanks, coal and mineral processing facilities, landslides, bridges and highways, parks and recreation facilities, river docks, and impoundments of all types. Let Triad's experience and capabilities in geotechnical engineering help bring your project to a successful conclusion.

Our Geotechnical Engineering Services Include:

- ▼ **Shallow and Deep Foundation Evaluations and Recommendations**
- ▼ **Landslide/Slope Stability Analysis and Remedial Design**
- ▼ **Earth and Earth/Rock Dam and Embankment Design**
- ▼ **Retaining Wall Evaluation and Design**
- ▼ **Mine Subsidence Investigations**
- ▼ **Flexible and Rigid Pavement Evaluations and Design**
- ▼ **Groundwater and Seepage Analysis and Design**
- ▼ **Shored and/or Braced Excavation Evaluations**
- ▼ **Foundation Underpinning Recommendations**
- ▼ **Forensic Investigations and Expert Witness Testimony**
- ▼ **Hydrogeologic Studies**
- ▼ **Fracture Trace Analysis**
- ▼ **Karst Investigations**
- ▼ **Geophysical Investigations**
 - 2-Dimensional Electrical Resistivity Imaging
 - Ground Penetrating Radar (GPR) Testing
- ▼ **Laterally Loaded Pile Analysis**
- ▼ **Pile Driveability Studies**
- ▼ **Seismic Site Classifications**



❖ SURVEYING AND MAPPING SERVICES

Triad provides complete professional surveying and mapping services for clients in construction, mining and land development. All surveys are completed under the supervision of a licensed land surveyor experienced in the particular type of survey required. Triad utilizes GPS, robotic and conventional total stations with electronic data collectors. All surveys and mapping meet National Map Accuracy Standards or other appropriate quality standards. Triad routinely provides MSHA- and OSHA-trained survey crews, depending upon the site-specific requirements.

Our Surveying and Mapping Services Include:

- ▶ ALTA/ACSM Land Title Surveys
- ▶ Boundary and Subdivision Surveys
- ▶ Topographic and Planimetric Surveys
- ▶ Ground Control for Aerial Mapping
- ▶ Construction Layout and As-Built Surveys
- ▶ FEMA Flood Elevation Certificates
- ▶ Hazardous Material Site Surveys
(requires OSHA 40-Hour Certification)
- ▶ Hydrographic Surveys
- ▶ Support for Mining and Quarrying
Industries (requires MSHA certification)
- ▶ Quantity Determination Surveys
(Stockpiles, Mass Excavation)
- ▶ Streambed and Lake Soundings
- ▶ Well Plot Surveys for Oil and Gas Industry
- ▶ Settlement Monitoring and
Structural Deviation Surveys
- ▶ Locations of Delineated Wetlands



Please contact Triad to ask about other services which may not be listed

www.triadeng.com

Stafford Consultants, Inc. Profile

Stafford Consultants Inc. was formed in 1985 from a core group of employees of Gates Engineering Company. After many successful years of operation, Gates Engineering Company was bought by a large design / build firm that later decided to divest the consulting engineering firm. Two original partners and five other employees remain with the firm since its inception.

Currently, Stafford Consultants employs a total staff of twenty-five, including six registered professional engineers. Our high ratio of professional to total employees is indicative of the importance we place on providing professional service to our clients. Mr. C. Dean Upton, P.E. now serves as president of the firm. Mr. Upton is a past president of the West Virginia Society of Professional Engineers, having served in 1998-99.

Our firm is a full service Engineering firm that provides services in Civil, Structural, Highway, Bridge, Airport, Environmental, and Sanitary Engineering. We have been providing engineering services for water, sewer and general civil projects for more than twenty five years. Although our main emphasis is toward the municipal utility market, our firm is highly qualified and capable of completing varied civil and structural projects. The football stadiums at West Virginia and Marshall University, buildings at Virginia Tech, sidewalks for the City of Princeton, artificial turf for the Princeton Senior High School football field, and master planning of athletic facilities at Virginia Tech and Marshall are prime examples.

Stafford has provided site civil and structural engineering design services in association with architectural firms since the firm was founded. Representative projects include Chapmanville High School, Parkersburg High School, Parkersburg South High School, Williamstown High School, Hilltop Elementary School, Wheeling Park High School, Cameron High School, the Chuck Mathena Center for Performing Arts in Princeton, and the Merriman Athletic Facilities Building at Virginia Tech.

All structural projects and site civil projects at Stafford are managed by Kenneth R. Crowe, P.E. Kenneth has over thirty years of structural, transportation and site civil engineering experience. He is assisted in this work by Kevin Smith, engineering technician, and Don Parsons, CADD technician. Kevin is experienced and particularly adept at site grading, pavement, drainage, and water and sewer layout. Don has worked closely with Kenneth for more than fifteen years on drafting of structural projects.



The Merriman Athletic Facilities Building at Virginia Tech and the tennis court at Williamstown High School are representative of Stafford's structural and site development capabilities.



Water

Summersville Water Plant



- Over 30 storage tanks ranging from 30,000 to 750,000 gallons
- Surface water treatment plants from 50 to 2,000 gallons per minute
- Transmission and distribution systems ranging in costs from \$100,000 to over \$30,000,000
- Pumping stations designed with the needs and desires of the client in mind



Alderson Water Storage Tanks

Site Development



Glade Springs Village

Stafford Consultants provides engineering services to public and private clients such as:

- grading
- site utilities
- stormwater permitting
- structural analysis
- construction monitoring
- expert witness

Typical projects like Chapmanville, Williams-town, Parkersburg and Parkersburg South High Schools included:

- site grading
- utilities
- stormwater



Parkersburg South High School

Wastewater

Princeton Wastewater Treatment Plant



Athens Wastewater Treatment Plant



Stafford projects include:

- treatment systems from 10,000 gallons per day to 5 million gallons per day
- conventional activated sludge, extended aeration, "orbal" oxidation ditch and sequencing batch reactor treatment systems
- conventional sewer systems and innovative systems such as pressure systems, vacuum systems, septic tank effluent systems and constructed wetlands

Some of Stafford's Satisfied Clients

Town of Alderson, West Virginia
Alleghany County, Virginia
Town of Ansted, West Virginia
Town of Athens, West Virginia
Big Bend P.S.D., Talcott, West Virginia
Town of Blacksburg, Virginia
City of Bluefield, West Virginia
Bluefield Sanitary Board, Bluefield, Virginia
Town of Bramwell, West Virginia
Bramwell P.S.D., Bramwell, West Virginia
Cooper Land Development, Inc., Beaver, WV
City of Gary, West Virginia
Greenbrier Valley Airport, Lewisburg, WV
City of Hinton, West Virginia
City of Lewisburg, West Virginia
Logan County PSD, Logan, West Virginia
Marshall University, Huntington, West Virginia
McDowell County PSD, Coalwood, West Virginia
Mercer County Commission, Princeton, WV
New Haven PSD, Fayetteville, WV
Nicholas County Commission, Summersville, WV
Oakvale Road PSD, Princeton, West Virginia
City of Princeton, West Virginia
Princeton Sanitary Board, Princeton, West Virginia
City of Welch, West Virginia
WV Division of Highways, Charleston, WV
WV Department of Environmental Protection, WV
White Oak PSD, Scarbro, West Virginia
Wilderness PSD, Mt. Nebo, West Virginia

Lyle Huntington, Manager of Oakvale Road PSD says: "Oakvale Road has done service with Stafford Consultants since 1989. They have handled over \$50,000,000 worth of water and sewer projects. Stafford Consultants does exceptional work. You will not be disappointed if you should choose Stafford Consultants. I will continue to use them for future projects."

Transportation

Devil's Backbone Bridge



- 19 bridge design projects for WV Division of Highways
- 5 roadway design projects for WV Division of Highways
- 3 Engineering Achievement Awards for Bridge and Roadway Designs



Mullens Bridge

A Client-Caring and Serving Company

STAFFORD CONSULTANTS INCORPORATED



Whether your needs are for utilities, transportation, athletic facilities, structures or site development, you can trust the **EXPERIENCED Engineers at STAFFORD CONSULTANTS**.

Engineering, Design and Consulting

C. Dean Upton, P.E., President
1105 Mercer Street
Post Office Box 5849
Princeton, West Virginia 24740
Phone: (304) 425-9555
Fax: (304) 425-9557
E-Mail: staffordconsultants@frontiernet.net

Per your request in "General Terms and Conditions" Part 8, here you will find copies of our various Insurance Coverages, including Commercial General Liability, Automobile Liability, and WV Statutory Requirements including WV Code 23-4-2 (Mandolidis) found on this page, as well as Professional Liability found on the following page.

ACORD		CERTIFICATE OF LIABILITY INSURANCE		DATE (MM/DD/YYYY) 05/02/2016																						
<p>THIS CERTIFICATE IS ISSUED AS A MATTER OF INFORMATION ONLY AND CONFERS NO RIGHTS UPON THE CERTIFICATE HOLDER. THIS CERTIFICATE DOES NOT AFFIRMATIVELY OR NEGATIVELY AMEND, EXTEND OR ALTER THE COVERAGE AFFORDED BY THE POLICIES BELOW. THIS CERTIFICATE OF INSURANCE DOES NOT CONSTITUTE A CONTRACT BETWEEN THE ISSUING INSURER(S), AUTHORIZED REPRESENTATIVE OR PRODUCER, AND THE CERTIFICATE HOLDER.</p> <p>IMPORTANT: If the certificate holder is an ADDITIONAL INSURED, the policy(ies) must be endorsed. If SUBROGATION IS WAIVED, subject to the terms and conditions of the policy, certain policies may require an endorsement. A statement on this certificate does not confer rights to the certificate holder in lieu of such endorsement(s).</p>																										
PRODUCER Pauli Associates 1311 Chapline Street P. O. Box 990 Wheeling, WV 26003-0123			CONTACT NAME: III, Lee Pauli PHONE (A/C, No. Ext.): 304.233.3303 FAX (A/C, No.): 304.233.3333 E-MAIL ADDRESS: PRODUCER CUSTOMER ID #:																							
INSURED McKinley & Associates, Inc. The Maxwell Centre 32-20th Street Wheeling, WV 26003			<table border="1" style="width: 100%; border-collapse: collapse;"> <thead> <tr> <th colspan="2">INSURER(S) AFFORDING COVERAGE</th> <th>NAICS</th> </tr> </thead> <tbody> <tr> <td>INSURER A:</td> <td>Cincinnati Insurance Co.</td> <td>10677</td> </tr> <tr> <td>INSURER B:</td> <td>Brickstreet Ins</td> <td>Brick</td> </tr> <tr> <td>INSURER C:</td> <td></td> <td></td> </tr> <tr> <td>INSURER D:</td> <td></td> <td></td> </tr> <tr> <td>INSURER E:</td> <td></td> <td></td> </tr> <tr> <td>INSURER F:</td> <td></td> <td></td> </tr> </tbody> </table>			INSURER(S) AFFORDING COVERAGE		NAICS	INSURER A:	Cincinnati Insurance Co.	10677	INSURER B:	Brickstreet Ins	Brick	INSURER C:			INSURER D:			INSURER E:			INSURER F:		
INSURER(S) AFFORDING COVERAGE		NAICS																								
INSURER A:	Cincinnati Insurance Co.	10677																								
INSURER B:	Brickstreet Ins	Brick																								
INSURER C:																										
INSURER D:																										
INSURER E:																										
INSURER F:																										
COVERAGES CERTIFICATE NUMBER: 15/18 Liab w/workers comp REVISION NUMBER:																										
<p>THIS IS TO CERTIFY THAT THE POLICIES OF INSURANCE LISTED BELOW HAVE BEEN ISSUED TO THE INSURED NAMED ABOVE FOR THE POLICY PERIOD INDICATED. NOTWITHSTANDING ANY REQUIREMENT, TERM OR CONDITION OF ANY CONTRACT OR OTHER DOCUMENT WITH RESPECT TO WHICH THIS CERTIFICATE MAY BE ISSUED OR MAY PERTAIN, THE INSURANCE AFFORDED BY THE POLICIES DESCRIBED HEREIN IS SUBJECT TO ALL THE TERMS, EXCLUSIONS AND CONDITIONS OF SUCH POLICIES. LIMITS SHOWN MAY HAVE BEEN REDUCED BY PAID CLAIMS.</p>																										
LINE	TYPE OF INSURANCE	POLICY NUMBER	POLICY EFF. DATE (MM/DD/YYYY)	POLICY EXP. DATE (MM/DD/YYYY)	LIMITS																					
A	GENERAL LIABILITY	EPP0146335	06/15/2015	06/15/2018	EACH OCCURRENCE \$ 1,000,000																					
	<input checked="" type="checkbox"/> COMMERCIAL GENERAL LIABILITY				DAMAGE TO RENTED PREMISES (Ea occurrence) \$ 500,000																					
	<input type="checkbox"/> CLAIMS-MADE <input checked="" type="checkbox"/> OCCUR				MED EXP (Any one person) \$ 10,000																					
					PERSONAL & ADV INJURY \$ 1,000,000																					
	GEN'L AGGREGATE LIMIT APPLIES PER:				GENERAL AGGREGATE \$ 2,000,000																					
	<input type="checkbox"/> POLICY <input type="checkbox"/> PROJECT <input type="checkbox"/> LOC				PRODUCTS - COMPROP AGG \$ 2,000,000																					
A	AUTOMOBILE LIABILITY	EPP0146335	08/15/2016	08/15/2018	COMBINED SINGLE LIMIT (Ea accident) \$ 1,000,000																					
	<input type="checkbox"/> ANY AUTO				BODILY INJURY (Per person) \$																					
	<input type="checkbox"/> ALL OWNED AUTOS				BODILY INJURY (Per accident) \$																					
	<input type="checkbox"/> SCHEDULED AUTOS				PROPERTY DAMAGE (Per accident) \$																					
	<input checked="" type="checkbox"/> HIRED AUTOS				\$																					
	<input checked="" type="checkbox"/> NON-OWNED AUTOS				\$																					
A	UMBRELLA LIAB	EPP0146335	08/15/2015	08/15/2018	EACH OCCURRENCE \$ 1,000,000																					
	<input checked="" type="checkbox"/> EXCESS LIAB				AGGREGATE \$ 1,000,000																					
	<input type="checkbox"/> DEDUCTIBLE				\$																					
	<input type="checkbox"/> RETENTION \$				\$																					
B	WORKERS COMPENSATION AND EMPLOYERS' LIABILITY	WCB1018014	12/30/2015	12/30/2016	WC STATUTORY LIMITS																					
	ANY PROPRIETOR/PARTNER/EXECUTIVE OFFICER/ MEMBER EXCLUDED? (Mandatory in NH)				OTH-ER																					
	<input type="checkbox"/> Y/N				E.L. EACH ACCIDENT \$ 1,000,000																					
	If yes, describe under DESCRIPTION OF OPERATIONS below				E.L. DISEASE - EA EMPLOYEE \$ 1,000,000																					
					E.L. DISEASE - POLICY LIMIT \$ 1,000,000																					
<p>DESCRIPTION OF OPERATIONS / LOCATIONS / VEHICLES (Attach ACORD 101, Additional Remarks Schedule, if more space is required) Specimen copy to be held by McKinley and Associates.</p>																										
CERTIFICATE HOLDER Specimen			CANCELLATION SHOULD ANY OF THE ABOVE DESCRIBED POLICIES BE CANCELLED BEFORE THE EXPIRATION DATE THEREOF, NOTICE WILL BE DELIVERED IN ACCORDANCE WITH THE POLICY PROVISIONS. AUTHORIZED REPRESENTATIVE Lee C Pauli III 5/2/2016																							

ACORD 25 (2008/08)

The ACORD name and logo are registered marks of ACORD

© 1988-2009 ACORD CORPORATION. All rights reserved.



CERTIFICATE OF LIABILITY INSURANCE

DATE (MM/DD/YYYY)

10/9/2015

THIS CERTIFICATE IS ISSUED AS A MATTER OF INFORMATION ONLY AND CONFERS NO RIGHTS UPON THE CERTIFICATE HOLDER. THIS CERTIFICATE DOES NOT AFFIRMATIVELY OR NEGATIVELY AMEND, EXTEND OR ALTER THE COVERAGE AFFORDED BY THE POLICIES BELOW. THIS CERTIFICATE OF INSURANCE DOES NOT CONSTITUTE A CONTRACT BETWEEN THE ISSUING INSURER(S), AUTHORIZED REPRESENTATIVE OR PRODUCER, AND THE CERTIFICATE HOLDER.

IMPORTANT: If the certificate holder is an ADDITIONAL INSURED, the policy(ies) must be endorsed. If SUBROGATION IS WAIVED, subject to the terms and conditions of the policy, certain policies may require an endorsement. A statement on this certificate does not confer rights to the certificate holder in lieu of such endorsement(s).

PRODUCER The James B. Oswald Company 1100 Superior Avenue, Suite 1500 Cleveland OH 44114		CONTACT NAME: Patricia Cholewa PHONE (A/C, No, Ext): 216-839-2807 FAX (A/C, No): E-MAIL: PCholewa@oswaldcompanies.com ADDRESS: PCholewa@oswaldcompanies.com	
INSURED McKinley & Associates, Inc. 32 20th Street #100 Wheeling WV 26003		INSURER(S) AFFORDING COVERAGE INSURER A: Continental Casualty Co. NAIC #: 18313 INSURER B: INSURER C: INSURER D: INSURER E: INSURER F:	

COVERAGES

CERTIFICATE NUMBER: 149514368

REVISION NUMBER:

THIS IS TO CERTIFY THAT THE POLICIES OF INSURANCE LISTED BELOW HAVE BEEN ISSUED TO THE INSURED NAMED ABOVE FOR THE POLICY PERIOD INDICATED. NOTWITHSTANDING ANY REQUIREMENT, TERM OR CONDITION OF ANY CONTRACT OR OTHER DOCUMENT WITH RESPECT TO WHICH THIS CERTIFICATE MAY BE ISSUED OR MAY PERTAIN, THE INSURANCE AFFORDED BY THE POLICIES DESCRIBED HEREIN IS SUBJECT TO ALL THE TERMS, EXCLUSIONS AND CONDITIONS OF SUCH POLICIES. LIMITS SHOWN MAY HAVE BEEN REDUCED BY PAID CLAIMS.

INSR LTR	TYPE OF INSURANCE	ADDL SUBR INSR	WVD	POLICY NUMBER	POLICY EFF (MM/DD/YYYY)	POLICY EXP (MM/DD/YYYY)	LIMITS
	GENERAL LIABILITY <input type="checkbox"/> COMMERCIAL GENERAL LIABILITY <input type="checkbox"/> CLAIMS-MADE <input type="checkbox"/> OCCUR GEN'L AGGREGATE LIMIT APPLIES PER: <input type="checkbox"/> POLICY <input type="checkbox"/> PRO-JECT <input type="checkbox"/> LOC						EACH OCCURRENCE \$ DAMAGE TO RENTED PREMISES (Ea occurrence) \$ MED EXP (Any one person) \$ PERSONAL & ADV INJURY \$ GENERAL AGGREGATE \$ PRODUCTS - COMP/OP AGG \$ \$
	AUTOMOBILE LIABILITY <input type="checkbox"/> ANY AUTO <input type="checkbox"/> ALL OWNED AUTOS <input type="checkbox"/> HIRED AUTOS <input type="checkbox"/> SCHEDULED AUTOS <input type="checkbox"/> NON-OWNED AUTOS						COMBINED SINGLE LIMIT (Ea accident) \$ BODILY INJURY (Per person) \$ BODILY INJURY (Per accident) \$ PROPERTY DAMAGE (Per accident) \$ \$
	UMBRELLA LIAB <input type="checkbox"/> OCCUR EXCESS LIAB <input type="checkbox"/> CLAIMS-MADE DED <input type="checkbox"/> RETENTION \$						EACH OCCURRENCE \$ AGGREGATE \$ \$
	WORKERS COMPENSATION AND EMPLOYERS' LIABILITY ANY PROPRIETOR/PARTNER/EXECUTIVE OFFICER/MEMBER EXCLUDED? (Mandatory in NH) If yes, describe under DESCRIPTION OF OPERATIONS below Y/N <input type="checkbox"/> N/A						WC STATUTORY LIMITS <input type="checkbox"/> OTH-ER <input type="checkbox"/> E.L. EACH ACCIDENT \$ E.L. DISEASE - EA EMPLOYEE \$ E.L. DISEASE - POLICY LIMIT \$
A	Professional Liability Claims Made Retro Date: 9/10/1981	N	Y	AEH591893924	10/10/2015	10/10/2016	Each Claim \$1,000,000 Aggregate \$1,000,000

DESCRIPTION OF OPERATIONS / LOCATIONS / VEHICLES (Attach ACORD 101, Additional Remarks Schedule, if more space is required)

Waiver of Subrogation as designated above is provided when required of the Named Insured by written contract or agreement.

CERTIFICATE HOLDERSpecimen
For Purposes of Evidencing
Coverage Only WV 26003**CANCELLATION**

SHOULD ANY OF THE ABOVE DESCRIBED POLICIES BE CANCELLED BEFORE THE EXPIRATION DATE THEREOF, NOTICE WILL BE DELIVERED IN ACCORDANCE WITH THE POLICY PROVISIONS.

AUTHORIZED REPRESENTATIVE

Patricia A Cholewa

© 1988-2010 ACORD CORPORATION. All rights reserved.

ACORD 25 (2010/05)

The ACORD name and logo are registered marks of ACORD

**McKINLEY & ASSOCIATES**
ARCHITECTS • ENGINEERS • INTERIOR DESIGN



Purchasing Division
2019 Washington Street East
Post Office Box 50130
Charleston, WV 25305-0130

State of West Virginia
Centralized Expression of Interest
02 — Architect/Engr

Proc Folder: 198605

Doc Description: Architectural/Eng. design services for various projects

Proc Type: Central Purchase Order

Date Issued	Solicitation Closes	Solicitation No	Version
2016-03-29	2016-04-21 13:30:00	CEOI 0612 DPS1600000001	1

BID RECEIVING LOCATION

BID CLERK

DEPARTMENT OF ADMINISTRATION

PURCHASING DIVISION

2019 WASHINGTON ST E

CHARLESTON

WV 25305

US

VENDOR

Vendor Name, Address and Telephone Number:

*000000206862

McKinley & Associates, Inc.

1116 Smith Street - Suite 406

Charleston, WV 25301

304 / 340-4267

FOR INFORMATION CONTACT THE BUYER

Tara Lyle

(304) 558-2544

tara.l.lyle@wv.gov

Signature X

FEIN # 55-0696478

DATE 2 May 2016

All offers subject to all terms and conditions contained in this solicitation

CERTIFICATION AND SIGNATURE PAGE

By signing below, or submitting documentation through wvOASIS, I certify that I have reviewed this Solicitation in its entirety; that I understand the requirements, terms and conditions, and other information contained herein; that this bid, offer or proposal constitutes an offer to the State that cannot be unilaterally withdrawn; that the product or service proposed meets the mandatory requirements contained in the Solicitation for that product or service, unless otherwise stated herein; that the Vendor accepts the terms and conditions contained in the Solicitation, unless otherwise stated herein; that I am submitting this bid, offer or proposal for review and consideration; that I am authorized by the vendor to execute and submit this bid, offer, or proposal, or any documents related thereto on vendor's behalf; that I am authorized to bind the vendor in a contractual relationship; and that to the best of my knowledge, the vendor has properly registered with any State agency that may require registration.

McKinley & Associates

(Company)

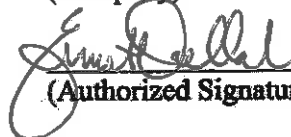
 Ernest Dellatorre, President
(Authorized Signature) (Representative Name, Title)

304-340-4267 | 304-340-4269 | 2016-5-2
(Phone Number) (Fax Number) (Date)

STATE OF WEST VIRGINIA
Purchasing Division**PURCHASING AFFIDAVIT**

MANDATE: Under W. Va. Code §5A-3-10a, no contract or renewal of any contract may be awarded by the state or any of its political subdivisions to any vendor or prospective vendor when the vendor or prospective vendor or a related party to the vendor or prospective vendor is a debtor and: (1) the debt owed is an amount greater than one thousand dollars in the aggregate; or (2) the debtor is in employer default.

EXCEPTION: The prohibition listed above does not apply where a vendor has contested any tax administered pursuant to chapter eleven of the W. Va. Code, workers' compensation premium, permit fee or environmental fee or assessment and the matter has not become final or where the vendor has entered into a payment plan or agreement and the vendor is not in default of any of the provisions of such plan or agreement.

DEFINITIONS:

"Debt" means any assessment, premium, penalty, fine, tax or other amount of money owed to the state or any of its political subdivisions because of a judgment, fine, permit violation, license assessment, defaulted workers' compensation premium, penalty or other assessment presently delinquent or due and required to be paid to the state or any of its political subdivisions, including any interest or additional penalties accrued thereon.

"Employer default" means having an outstanding balance or liability to the old fund or to the uninsured employers' fund or being in policy default, as defined in W. Va. Code § 23-2c-2, failure to maintain mandatory workers' compensation coverage, or failure to fully meet its obligations as a workers' compensation self-insured employer. An employer is not in employer default if it has entered into a repayment agreement with the Insurance Commissioner and remains in compliance with the obligations under the repayment agreement.

"Related party" means a party, whether an individual, corporation, partnership, association, limited liability company or any other form or business association or other entity whatsoever, related to any vendor by blood, marriage, ownership or contract through which the party has a relationship of ownership or other interest with the vendor so that the party will actually or by effect receive or control a portion of the benefit, profit or other consideration from performance of a vendor contract with the party receiving an amount that meets or exceeds five percent of the total contract amount.

AFFIRMATION: By signing this form, the vendor's authorized signer affirms and acknowledges under penalty of law for false swearing (W. Va. Code §61-5-3) that neither vendor nor any related party owe a debt as defined above and that neither vendor nor any related party are in employer default as defined above, unless the debt or employer default is permitted under the exception above.

WITNESS THE FOLLOWING SIGNATURE:Vendor's Name: McKinley & AssociatesAuthorized Signature:  Date: 2 May 2016State of West VirginiaCounty of Ohio, to-wit:Taken, subscribed, and sworn to before me this 2 day of May, 2016.My Commission expires 26 June, 2024.

AFFIX SEAL HERE

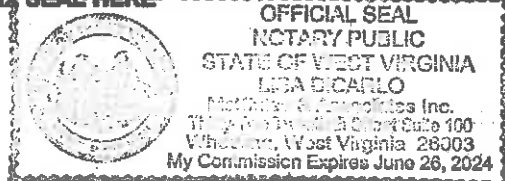
NOTARY PUBLIC 

Purchasing Affidavit (Revised 07/01/2012)



Purchasing Division
2019 Washington Street East
Post Office Box 50130
Charleston, WV 25305-0130

State of West Virginia
Centralized Expression of Interest
02 — Architect/Engr

Proc Folder: 198605

Doc Description: Addendum No. 1 - A/E design services for various projects

Proc Type: Central Purchase Order

Date Issued	Solicitation Closes	Solicitation No	Version
2016-04-20	2016-05-05 13:30:00	CEOI 0612 DPS1600000001	2

BID RECEIVING LOCATION

BID CLERK

DEPARTMENT OF ADMINISTRATION

PURCHASING DIVISION

2019 WASHINGTON ST E

CHARLESTON

WV

25305

US

VENDOR

Vendor Name, Address and Telephone Number:

*000000206862

McKinley & Associates, Inc.

1116 Smith Street - Suite 406

Charleston, WV 25301

304 / 340-4267

FOR INFORMATION CONTACT THE BUYER

Tara Lyle

(304) 558-2544

tara.l.lyle@wv.gov

Signature X

FEIN # 55-0696478

DATE 2 May 2016

All offers subject to all terms and conditions contained in this solicitation



Purchasing Division
2019 Washington Street East
Post Office Box 50130
Charleston, WV 25305-0130

State of West Virginia
Centralized Expression of Interest
02 — Architect/Engr

Proc Folder: 198605

Doc Description: Addendum No. 2 - A/E design services for various projects

Proc Type: Central Purchase Order

Date Issued	Solicitation Closes	Solicitation No	Version
2016-04-26	2016-05-05 13:30:00	CEOI 0612 DPS1600000001	3

BID RECEIVING LOCATION

BID CLERK

DEPARTMENT OF ADMINISTRATION

PURCHASING DIVISION

2019 WASHINGTON ST E

CHARLESTON

WV 25305

US

VENDOR

Vendor Name, Address and Telephone Number:

*000000206862

McKinley & Associates, Inc.

1116 Smith Street - Suite 406

Charleston, WV 25301

304 / 340-4267

FOR INFORMATION CONTACT THE BUYER

Tara Lyle

(304) 558-2544

tara.l.lyle@wv.gov

Signature X

FEIN # 55-0696478

DATE 2 May 2016

All offers subject to all terms and conditions contained in this solicitation

ADDENDUM ACKNOWLEDGEMENT FORM
SOLICITATION NO.: CEOI DPS1600000001

Instructions: Please acknowledge receipt of all addenda issued with this solicitation by completing this addendum acknowledgment form. Check the box next to each addendum received and sign below. Failure to acknowledge addenda may result in bid disqualification.

Acknowledgment: I hereby acknowledge receipt of the following addenda and have made the necessary revisions to my proposal, plans and/or specification, etc.

Addendum Numbers Received:

(Check the box next to each addendum received)

<input checked="" type="checkbox"/> Addendum No. 1	<input type="checkbox"/> Addendum No. 6
<input checked="" type="checkbox"/> Addendum No. 2	<input type="checkbox"/> Addendum No. 7
<input type="checkbox"/> Addendum No. 3	<input type="checkbox"/> Addendum No. 8
<input type="checkbox"/> Addendum No. 4	<input type="checkbox"/> Addendum No. 9
<input type="checkbox"/> Addendum No. 5	<input type="checkbox"/> Addendum No. 10

I understand that failure to confirm the receipt of addenda may be cause for rejection of this bid. I further understand that that any verbal representation made or assumed to be made during any oral discussion held between Vendor's representatives and any state personnel is not binding. Only the information issued in writing and added to the specifications by an official addendum is binding.

McKinley & Associates, Inc.

Company



Authorized Signature

2 May 2016

Date

NOTE: This addendum acknowledgement should be submitted with the bid to expedite document processing.