



BRIDGEPORT EQUIPMENT AND TOOL
1504 OAKHURST DRIVE
CHARLESTON, WV 25314
PHONE NUMBER: 304-659-2917

DATE: AUGUST 20, 2015

TO: WEST VIRGINIA PURCHASING

SEALED BID:

BUYER: CRYSTAL RINK

SOLICITATION NUMBER: CRFQ ADJ1600000003

BID OPENING DATE: AUGUST 20, 2015

BID OPENING TIME: 1:30 PM EST

FAX NUMBER: 304-588-3970

08/20/15 12:19:07
WV Purchasing Division

08/20/15 12:19:24
WV Purchasing Division



Purchasing Division
2019 Washington Street East
Post Office Box 50130
Charleston, WV 25305-0130

State of West Virginia
Request for Quotation
13 - Equipment

Proc Folder: 126501

Doc Description: ADDENDUM # 2 UTILITY FARM TRACTORS AND ATTACHMENTS

Proc Type: Central Purchase Order

| Date Issued | Solicitation Closes | Solicitation No | Version |
|-------------|------------------------|-------------------------|---------|
| 2015-08-14 | 2015-08-20 13:30:00 | CRFQ 0603 ADJ1600000003 | 3 |

BID CLERK

DEPARTMENT OF ADMINISTRATION

PURCHASING DIVISION

2019 WASHINGTON ST E

CHARLESTON

WV

25305

US

Vendor Name, Address and Telephone Number:

BRIDGEPORT EQUIPMENT AND TOOL
1504 OAKHURST DRIVE
CHARLESTON, WV 25314
304-659-2917

FOR INFORMATION CONTACT THE BUYER

Crystal Rink
(304) 558-2402
crystal.g.rink@wv.gov

Signature X *Ronald D. Gardner* FEIN #

34-1800484

DATE 8/19/2015

All offers subject to all terms and conditions contained in this solicitation

RECEIVED TIME AUG. 20. 12:10PM

| | | | |
|---|--------------|---|----------|
| STATE FINANCE ADJUTANT GENERALS OFFICE 1703 COONSKIN DR | | DIVISION ENGINEERING & FACILITIES ADJUTANT GENERALS OFFICE 1707 COONSKIN DR | |
| CHARLESTON | WV25311-1085 | CHARLESTON | WV 25311 |
| US | | US | |

| Line | Comm Ln Desc | Qty | Unit Issue | Unit Price | Total Price |
|------|--|---------|------------|-------------|-------------|
| 1 | Utility Farm Tractor P7040CPS or Equal (Brushfork Armory) | 1.00000 | EA | \$57,997.00 | \$57,997.00 |

| Comm Code | Manufacturer | Specification | Model # |
|-----------|--------------|----------------------|---------|
| 25101901 | JOHN DEERE | AS PER SPECIFICATION | 6105E |

Extended Description :
Utility Farm Tractor with Cab LS- Model P7040CPS or equal

| | | | |
|---|--------------|---|----------|
| STATE FINANCE ADJUTANT GENERALS OFFICE 1703 COONSKIN DR | | DIVISION ENGINEERING & FACILITIES ADJUTANT GENERALS OFFICE 1707 COONSKIN DR | |
| CHARLESTON | WV25311-1085 | CHARLESTON | WV 25311 |
| US | | US | |

| Line | Comm Ln Desc | Qty | Unit Issue | Unit Price | Total Price |
|------|--|---------|------------|-------------|-------------|
| 2 | Utility Farm Tractor P7040CPS or Equal (for Buckhannon AFRC) | 1.00000 | EA | \$57,997.00 | \$57,997.00 |

| Comm Code | Manufacturer | Specification | Model # |
|-----------|--------------|----------------------|---------|
| 25101901 | JOHN DEERE | AS PER SPECIFICATION | 6105E |

Extended Description :
Utility Farm Tractor with Cab LS- Model P7040CPS or equal

| | | | |
|---|--------------|---|----------|
| STATE FINANCE ADJUTANT GENERALS OFFICE 1703 COONSKIN DR | | DIVISION ENGINEERING & FACILITIES ADJUTANT GENERALS OFFICE 1707 COONSKIN DR | |
| CHARLESTON | WV25311-1085 | CHARLESTON | WV 25311 |
| US | | US | |

| Line | Comm Ln Desc | Qty | Unit Issue | Unit Price | Total Price |
|------|---|---------|------------|-------------|-------------|
| 3 | Utility Farm Tractor P7040CPS or Equal (for Logan/Mingo RC) | 1.00000 | EA | \$57,997.00 | \$57,997.00 |

| Comm Code | Manufacturer | Specification | Model # |
|-----------|--------------|----------------------|---------|
| 25101901 | JOHN DEERE | AS PER SPECIFICATION | 6105E |

Extended Description :

Utility Farm Tractor with Cab LS- Model P7040CPS or equal

| | | | |
|---|--------------|---|----------|
| STATE FINANCE ADJUTANT GENERALS OFFICE 1703 COONSKIN DR CHARLESTON US | WV25311-1085 | DIVISION ENGINEERING & FACILITIES ADJUTANT GENERALS OFFICE 1707 COONSKIN DR CHARLESTON US | WV 25311 |
|---|--------------|---|----------|

| Line | Comm Ln Desc | Qty | Unit Issue | Unit Price | Total Price |
|------|--|---------|------------|------------|-------------|
| 4 | Loader Bucket Attachment LL7101 or Equal (Brushfork Armory) | 1.00000 | EA | \$5,479.00 | \$5,479.00 |

| Comm Code | Manufacturer | Specification | Model # |
|-----------|--------------|----------------------|---------|
| 25101901 | JOHN DEERE | AS PER SPECIFICATION | H260 |

Extended Description :

Loader Bucket Attachment LS-Model LL7101 with 78" Bucket or equal

| | | | |
|---|--------------|---|----------|
| STATE FINANCE ADJUTANT GENERALS OFFICE 1703 COONSKIN DR CHARLESTON US | WV25311-1085 | DIVISION ENGINEERING & FACILITIES ADJUTANT GENERALS OFFICE 1707 COONSKIN DR CHARLESTON US | WV 25311 |
|---|--------------|---|----------|

| Line | Comm Ln Desc | Qty | Unit Issue | Unit Price | Total Price |
|------|---|---------|------------|------------|-------------|
| 5 | Loader Bucket Attachment LL7101 or Equal (Buckhannon AFRC) | 1.00000 | EA | \$5,479.00 | \$5,479.00 |

| Comm Code | Manufacturer | Specification | Model # |
|-----------|--------------|----------------------|---------|
| 25101901 | JOHN DEERE | AS PER SPECIFICATION | H260 |

Extended Description :

Loader Bucket Attachment LS-Model LL7101 with 78" Bucket or equal

| | |
|---|---|
| STATE FINANCE ADJUTANT GENERALS OFFICE 1703 COONSKIN DR | DIVISION ENGINEERING & FACILITIES ADJUTANT GENERALS OFFICE 1707 COONSKIN DR |
| CHARLESTON WV25311-1085 | CHARLESTON WV 25311 |
| US | US |

| Line | Comm Ln Desc | Qty | Unit Issue | Unit Price | Total Price |
|------|--|---------|------------|------------|-------------|
| 6 | Loader Bucket Attachment LL7101 or Equal (for Logan/MingoRC) | 1.00000 | EA | \$5,479.00 | \$5,479.00 |

| Comm Code | Manufacturer | Specification | Model # |
|-----------|--------------|----------------------|---------|
| 25101901 | JOHN DEERE | AS PER SPECIFICATION | H260 |

Extended Description :
Loader Bucket Attachment LS-Model LL7101 with 78" Bucket or equal

| | |
|---|---|
| STATE FINANCE ADJUTANT GENERALS OFFICE 1703 COONSKIN DR | DIVISION ENGINEERING & FACILITIES ADJUTANT GENERALS OFFICE 1707 COONSKIN DR |
| CHARLESTON WV25311-1085 | CHARLESTON WV 25311 |
| US | US |

| Line | Comm Ln Desc | Qty | Unit Issue | Unit Price | Total Price |
|------|--|---------|------------|------------|-------------|
| 7 | Snow Blade Attachment W9027S or Equal (Brushfork Armory) | 1.00000 | EA | \$2,699.00 | \$2,699.00 |

| Comm Code | Manufacturer | Specification | Model # |
|-----------|--------------|----------------------|---------|
| 22101710 | FRONTIER | AS PER SPECIFICATION | AF11G |

Extended Description :
Front Mounted, Front Snow Blade, Allied Model W9027S or equal

| | |
|---|---|
| STATE FINANCE ADJUTANT GENERALS OFFICE 1703 COONSKIN DR | DIVISION ENGINEERING & FACILITIES ADJUTANT GENERALS OFFICE 1707 COONSKIN DR |
| CHARLESTON WV25311-1085 | CHARLESTON WV 25311 |
| US | US |

| Line | Comm Ln Desc | Qty | Unit Issue | Unit Price | Total Price |
|------|---|---------|------------|------------|-------------|
| 8 | Snow Blade Attachment W9027S or Equal (for Buckhannon AFRC) | 1.00000 | EA | \$2,699.00 | \$2,699.00 |

| Comm Code | Manufacturer | Specification | Model # |
|-----------|--------------|----------------------|---------|
| 22101710 | FRONTIER | AS PER SPECIFICATION | AF11G |

Extended Description :

Front Mounted, Front Snow Blade, Allied Model W9027S or equal

| | | | |
|---|--------------|---|----------|
| STATE FINANCE ADJUTANT GENERALS OFFICE 1703 COONSKIN DR | | DIVISION ENGINEERING & FACILITIES ADJUTANT GENERALS OFFICE 1707 COONSKIN DR | |
| CHARLESTON | WV25311-1085 | CHARLESTON | WV 25311 |
| US | | US | |

| Line | Comm Ln Desc | Qty | Unit Issue | Unit Price | Total Price |
|------|--|---------|------------|------------|-------------|
| 9 | Snow Blade Attachment W9027S or Equal (for Logan/Mingo RC) | 1.00000 | EA | \$2,699.00 | \$2,699.00 |

| Comm Code | Manufacturer | Specification | Model # |
|-----------|--------------|----------------------|---------|
| 22101710 | FRONTIER | AS PER SPECIFICATION | AF11G |

Extended Description :

Front Mounted, Front Snow Blade, Allied Model W9027S or equal

| | | | |
|---|--------------|---|----------|
| STATE FINANCE ADJUTANT GENERALS OFFICE 1703 COONSKIN DR | | DIVISION ENGINEERING & FACILITIES ADJUTANT GENERALS OFFICE 1707 COONSKIN DR | |
| CHARLESTON | WV25311-1085 | CHARLESTON | WV 25311 |
| US | | US | |

| Line | Comm Ln Desc | Qty | Unit Issue | Unit Price | Total Price |
|------|--|---------|------------|------------|-------------|
| 10 | Snow Blade Attachment W9027S or Equal (for CSMS Eleanor) | 1.00000 | EA | \$2,699.00 | \$2,699.00 |

| Comm Code | Manufacturer | Specification | Model # |
|-----------|--------------|----------------------|---------|
| 22101710 | FRONTIER | AS PER SPECIFICATION | AF11G |

Extended Description :

Front Mounted, Front Snow Blade, Allied Model W9027S or equal

| | | | |
|---|--------------|---|----------|
| STATE FINANCE ADJUTANT GENERALS OFFICE 1703 COONSKIN DR | | DIVISION ENGINEERING & FACILITIES ADJUTANT GENERALS OFFICE 1707 COONSKIN DR | |
| CHARLESTON | WV25311-1085 | CHARLESTON | WV 25311 |
| US | | US | |

| Line | Comm Ln Desc | Qty | Unit Issue | Unit Price | Total Price |
|------|--|---------|------------|------------|-------------|
| 11 | Snow Blade Attachment W9027S or Equal (TriState AFRC Kenov) | 1.00000 | EA | \$2,699.00 | \$2,699.00 |

| Comm Code | Manufacturer | Specification | Model # |
|-----------|--------------|----------------------|---------|
| 22101710 | FRONTIER | AS PER SPECIFICATION | AF11G |

Extended Description :
Front Mounted, Front Snow Blade, Allied Model W9027S or equal

| | | | |
|---|--------------|---|----------|
| STATE FINANCE ADJUTANT GENERALS OFFICE 1703 COONSKIN DR | | DIVISION ENGINEERING & FACILITIES ADJUTANT GENERALS OFFICE 1707 COONSKIN DR | |
| CHARLESTON | WV25311-1085 | CHARLESTON | WV 25311 |
| US | | US | |

| Line | Comm Ln Desc | Qty | Unit Issue | Unit Price | Total Price |
|------|--|---------|------------|-------------|-------------|
| 12 | Utility Farm Tractor XU5065CPS or Equal (for CSMS Eleanor) | 1.00000 | EA | \$49,939.00 | \$49,939.00 |

| Comm Code | Manufacturer | Specification | Model # |
|-----------|--------------|----------------------|---------|
| 25101901 | JOHN DEERE | AS PER SPECIFICATION | 5075M |

Extended Description :
Utility Farm Tractor with Cab LS- Model XU5065CPS or equal

| | | | |
|---|--------------|---|----------|
| STATE FINANCE ADJUTANT GENERALS OFFICE 1703 COONSKIN DR | | DIVISION ENGINEERING & FACILITIES ADJUTANT GENERALS OFFICE 1707 COONSKIN DR | |
| CHARLESTON | WV25311-1085 | CHARLESTON | WV 25311 |
| US | | US | |

| Line | Comm Ln Desc | Qty | Unit Issue | Unit Price | Total Price |
|------|--|---------|------------|-------------|-------------|
| 13 | Utility Farm Tractor XU5065CPS or Equal (for Tri-State AFRC) | 1.00000 | EA | \$49,939.00 | \$49,939.00 |

| Comm Code | Manufacturer | Specification | Model # |
|-----------|--------------|----------------------|---------|
| 25101901 | JOHN DEERE | AS PER SPECIFICATION | 5075M |

Extended Description :

Utility Farm Tractor with Cab LS- Model XU5065CPS or equal

| | | | |
|---|--------------|---|----------|
| STATE FINANCE ADJUTANT GENERALS OFFICE 1703 COONSKIN DR | | DIVISION ENGINEERING & FACILITIES ADJUTANT GENERALS OFFICE 1707 COONSKIN DR | |
| CHARLESTON | WV25311-1085 | CHARLESTON | WV 25311 |
| US | | US | |

| Line | Comm Ln Desc | Qty | Unit Issue | Unit Price | Total Price |
|------|---|---------|------------|------------|-------------|
| 14 | Loader Bucket Attachment LL5103 or Equal (for CSMS Eleanor) | 1.00000 | EA | \$5,479.00 | \$5,479.00 |

| Comm Code | Manufacturer | Specification | Model # |
|-----------|--------------|----------------------|---------|
| 25101901 | JOHN DEERE | AS PER SPECIFICATION | H260 |

Extended Description :

Loader Bucket Attachment LS-Model LL5103 or equal

| | | | |
|---|--------------|---|----------|
| STATE FINANCE ADJUTANT GENERALS OFFICE 1703 COONSKIN DR | | DIVISION ENGINEERING & FACILITIES ADJUTANT GENERALS OFFICE 1707 COONSKIN DR | |
| CHARLESTON | WV25311-1085 | CHARLESTON | WV 25311 |
| US | | US | |

| Line | Comm Ln Desc | Qty | Unit Issue | Unit Price | Total Price |
|------|--|---------|------------|------------|-------------|
| 15 | Loader Bucket Attachment LL5103 or Equal (TriState AFRC) | 1.00000 | EA | \$5,479.00 | \$5,479.00 |

| Comm Code | Manufacturer | Specification | Model # |
|-----------|--------------|----------------------|---------|
| 25101901 | JOHN DEERE | AS PER SPECIFICATION | H260 |

Extended Description :

Loader Bucket Attachment LS-Model LL5103 or equal

| | | | |
|---|--------------|---|----------|
| STATE FINANCE ADJUTANT GENERALS OFFICE 1703 COONSKIN DR | | DIVISION ENGINEERING & FACILITIES ADJUTANT GENERALS OFFICE 1707 COONSKIN DR | |
| CHARLESTON | WV25311-1085 | CHARLESTON | WV 25311 |
| US | | US | |

| Line | Comm Ln Desc | Qty | Unit Issue | Unit Price | Total Price |
|------|---|---------|------------|------------|-------------|
| 16 | Mower Attachment RD990-X or Equal (for Brushfork Armory) | 1.00000 | EA | \$4,259.00 | \$4,259.00 |

| Comm Code | Manufacturer | Specification | Model # |
|-----------|--------------|----------------------|---------|
| 21101701 | WOODS | AS PER SPECIFICATION | RD990-x |

Extended Description :

Finish Mower Attachment, Rear Mount, Woods Model RD990-X or equal

| | | | |
|---|--------------|---|----------|
| STATE FINANCE ADJUTANT GENERALS OFFICE 1703 COONSKIN DR | | DIVISION ENGINEERING & FACILITIES ADJUTANT GENERALS OFFICE 1707 COONSKIN DR | |
| CHARLESTON | WV25311-1085 | CHARLESTON | WV 25311 |
| US | | US | |

| Line | Comm Ln Desc | Qty | Unit Issue | Unit Price | Total Price |
|------|--|---------|------------|------------|-------------|
| 17 | Mower Attachment RD990-X or Equal (for Buckhannon AFRC) | 1.00000 | EA | \$4,259.00 | \$4,259.00 |

| Comm Code | Manufacturer | Specification | Model # |
|-----------|--------------|----------------------|---------|
| 21101701 | WOODS | AS PER SPECIFICATION | RD990-X |

Extended Description :

Finish Mower Attachment, Rear Mount, Woods Model RD990-X or equal

| | | | |
|---|--------------|---|----------|
| STATE FINANCE ADJUTANT GENERALS OFFICE 1703 COONSKIN DR | | DIVISION ENGINEERING & FACILITIES ADJUTANT GENERALS OFFICE 1707 COONSKIN DR | |
| CHARLESTON | WV25311-1085 | CHARLESTON | WV 25311 |
| US | | US | |

| Line | Comm Ln Desc | Qty | Unit Issue | Unit Price | Total Price |
|------|---|---------|------------|------------|-------------|
| 18 | Polyethylene Spreader S-400-P or Equal (Brushfork Armory) | 1.00000 | EA | \$579.00 | \$579.00 |

| Comm Code | Manufacturer | Specification | Model # |
|-----------|--------------|----------------------|---------|
| 21101804 | FRONTIER | AS PER SPECIFICATION | SS3067B |

Extended Description :

Polyethylene Fertilizer Spreader, King Kutter Model S-400-P or equal

| | | | |
|---|--------------|---|----------|
| STATE FINANCE ADJUTANT GENERALS OFFICE 1703 COONSKIN DR CHARLESTON US | WV25311-1086 | DIVISION ENGINEERING & FACILITIES ADJUTANT GENERALS OFFICE 1707 COONSKIN DR CHARLESTON US | WV 25311 |
|---|--------------|---|----------|

| Line | Comm Ln Desc | Qty | Unit Issue | Unit Price | Total Price |
|------|--|---------|------------|------------|-------------|
| 19 | Polyethylene Spreader S-400-P or Equal (for Buckhannon AFRC) | 1.00000 | EA | \$579.00 | \$579.00 |

| Comm Code | Manufacturer | Specification | Model # |
|-----------|--------------|----------------------|---------|
| 21101804 | FRONTIER | AS PER SPECIFICATION | SS3067B |

Extended Description :

Polyethylene Fertilizer Spreader, King Kutter Model S-400-P or equal

| | | | |
|---|--------------|---|----------|
| STATE FINANCE ADJUTANT GENERALS OFFICE 1703 COONSKIN DR CHARLESTON US | WV25311-1086 | DIVISION ENGINEERING & FACILITIES ADJUTANT GENERALS OFFICE 1707 COONSKIN DR CHARLESTON US | WV 25311 |
|---|--------------|---|----------|

| Line | Comm Ln Desc | Qty | Unit Issue | Unit Price | Total Price |
|------|---|---------|------------|------------|-------------|
| 20 | Polyethylene Spreader S-400-P or Equal (for Logan/Mingo RC) | 1.00000 | EA | \$579.00 | \$579.00 |

| Comm Code | Manufacturer | Specification | Model # |
|-----------|--------------|----------------------|---------|
| 21101804 | FRONTIER | AS PER SPECIFICATION | SS3067B |

Extended Description :

Polyethylene Fertilizer Spreader, King Kutter Model S-400-P or equal

| | | | |
|---|--------------|---|----------|
| STATE FINANCE ADJUTANT GENERALS OFFICE 1703 COONSKIN DR | | DIVISION ENGINEERING & FACILITIES ADJUTANT GENERALS OFFICE 1707 COONSKIN DR | |
| CHARLESTON | WV25311-1085 | CHARLESTON | WV 25311 |
| US | | US | |

| Line | Comm Ln Desc | Qty | Unit Issue | Unit Price | Total Price |
|------|---|---------|------------|------------|-------------|
| 21 | Polyethylene Spreader S-400-P or Equal (for CSMS Eleanor) | 1.00000 | EA | \$579.00 | \$579.00 |

| Comm Code | Manufacturer | Specification | Model # |
|-----------|--------------|----------------------|---------|
| 21101804 | FRONTIER | AS PER SPECIFICATION | SS3067B |

Extended Description :

Polyethylene Fertilizer Spreader, King Kutter Model S-400-P or equal.

| | | | |
|---|--------------|---|----------|
| STATE FINANCE ADJUTANT GENERALS OFFICE 1703 COONSKIN DR | | DIVISION ENGINEERING & FACILITIES ADJUTANT GENERALS OFFICE 1707 COONSKIN DR | |
| CHARLESTON | WV25311-1085 | CHARLESTON | WV 25311 |
| US | | US | |

| Line | Comm Ln Desc | Qty | Unit Issue | Unit Price | Total Price |
|------|--|---------|------------|------------|-------------|
| 22 | Polyethylene Spreader S-400-P or Equal (TriState AFRC Kenov) | 1.00000 | EA | \$579.00 | \$579.00 |

| Comm Code | Manufacturer | Specification | Model # |
|-----------|--------------|---------------------|---------|
| 21101804 | FRONTIER | AS PER SPECIFICATIO | SS3067B |

Extended Description :

Polyethylene Fertilizer Spreader, King Kutter Model S-400-P or equal

| | Document Phase | Document Description | Page |
|---------------|-----------------------|---|-------------|
| ADJ1600000003 | Final | ADDENDUM #2 UTILITY FARM TRAC TORS AND ATTACHMENTS | 11 of 11 |

ADDITIONAL TERMS AND CONDITIONS

See attached document(s) for additional Terms and Conditions

CERTIFICATION AND SIGNATURE PAGE

By signing below, or submitting documentation through wvOASIS, I certify that I have reviewed this Solicitation in its entirety; understand the requirements, terms and conditions, and other information contained herein; that I am submitting this bid, offer or proposal for review and consideration; that I am authorized by the vendor to execute and submit this bid, offer, or proposal, or any documents related thereto on vendor's behalf; that I am authorized to bind the vendor in a contractual relationship; and that to the best of my knowledge, the vendor has properly registered with any State agency that may require registration.

BRIDGEPORT EQUIPMENT AND TOOL

(Company)

RONALD A. GARDNER SALES

(Authorized Signature) (Representative Name, Title)

304-659-2917 304-659-3276 8/19/2015
(Phone Number) (Fax Number) (Date)

Revised 05/20/2015

RECEIVED TIME AUG, 20. 12:10PM

ADDENDUM ACKNOWLEDGEMENT FORM
SOLICITATION NO.: CRFQ ADJ160000003

Instructions: Please acknowledge receipt of all addenda issued with this solicitation by completing this addendum acknowledgment form. Check the box next to each addendum received and sign below. Failure to acknowledge addenda may result in bid disqualification.

Acknowledgment: I hereby acknowledge receipt of the following addenda and have made the necessary revisions to my proposal, plans and/or specification, etc.

Addendum Numbers Received:
(Check the box next to each addendum received)

- | | |
|--|--|
| <input checked="" type="checkbox"/> Addendum No. 1 | <input type="checkbox"/> Addendum No. 6 |
| <input checked="" type="checkbox"/> Addendum No. 2 | <input type="checkbox"/> Addendum No. 7 |
| <input type="checkbox"/> Addendum No. 3 | <input type="checkbox"/> Addendum No. 8 |
| <input type="checkbox"/> Addendum No. 4 | <input type="checkbox"/> Addendum No. 9 |
| <input type="checkbox"/> Addendum No. 5 | <input type="checkbox"/> Addendum No. 10 |

I understand that failure to confirm the receipt of addenda may be cause for rejection of this bid. I further understand that any verbal representation made or assumed to be made during any oral discussion held between Vendor's representatives and any state personnel is not binding. Only the information issued in writing and added to the specifications by an official addendum is binding.

BRIDGEPORT EQUIPMENT AND TOOL

Company

Ronald A. Gardner

Authorized Signature

8/19/2015

Date

NOTE: This addendum acknowledgement should be submitted with the bid to expedite document processing.

Revised 05/20/2015

RECEIVED TIME AUG. 20. 12:10PM

**Vendor Questions for CRFQ 0603 ADJ1600000003
Heavy-Duty Utility Farm Tractors & Accessories**

1. On solicitation # CRFQAD J1600000003 which is for farm tractors and attachments for the WV Army National Guard Division of Engineering and Facilities- Can we bid the individual pieces or do we bid the whole RFQ as a package? Some pieces of this we can provide easily and some we don't have currently available. Please let us know.

Answer) This contract award will not be split in any way, or awarded to multiple vendors, all items listed in the solicitation are to be bid, so vendors must bid the whole solicitation as a package, and only one contract will be awarded.

2. Contract item #1 LS-Model P7030CPS is no longer available. Can this be revised to a LS-Model P7040CPS? The major differences are maximum 97 HP Diesel Engine and Weight 7143 lbs maximum.

Answer) Sections 3.1.1 and 3.1.1.1 of the specifications for Contract Item #1 have been revised to require a LS-Model P7040CPS utility tractor, or equal.

3. Contract item #2 LS-Model LL7100 is not compatible with the LS-Model P7040CPS. Can this be revised to a LS-Model LL7101? The major difference is maximum lift height 136.4.

Answer) Section 3.1.2 of the specifications has been revised to require an LS-Model LL7101 loader bucket attachment with 78" bucket or equal.

4. 3.1.1.1 The HP listed is not defined as Engine or PTO.

Answer) The 97HP (minimum) listed in Section 3.1.1.1 is for the engine, the PTO HP is listed in Section 3.1.1.2

5. 3.1.1.16 Rear RPM's: The 540/750/1000 request is not offered by John Deere.

Answer) Section 3.1.1.16 has been removed in its entirety.

6. 3.1.1.18 Weight of 6,724# maximum: John Deere's projected offering is heavier.

Answer) Section 3.1.1.18 has been removed in its entirety.

7. 3.1.4.17 Weight: Again John Deere's offering will be heavier.

Answer) Section 3.1.4.17 has been removed in its entirety.

SOLICITATION NUMBER: CRFQ ADJ1600000003
Addendum Number:

The purpose of this addendum is to modify the solicitation identified as ("Solicitation") to reflect the change(s) identified and described below.

Applicable Addendum Category:

- Modify bid opening date and time
- Modify specifications of product or service being sought
- Attachment of vendor questions and responses
- Attachment of pre-bid sign-in sheet
- Correction of error
- Other

Description of Modification to Solicitation:

- (1) To provide updated version of specifications
- (2) To provide updated version of pricing page
- (3) Answer vendor questions

Bid opening shall remain 08/20/2015 at 1:30 PM EST

Additional Documentation: Documentation related to this Addendum (if any) has been included herewith as Attachment A and is specifically incorporated herein by reference.

Terms and Conditions:

1. All provisions of the Solicitation and other addenda not modified herein shall remain in full force and effect.
2. Vendor should acknowledge receipt of all addenda issued for this Solicitation by completing an Addendum Acknowledgment, a copy of which is included herewith. Failure to acknowledge addenda may result in bid disqualification. The addendum acknowledgement should be submitted with the bid to expedite document processing.

Revised 6/8/2012

RECEIVED TIME AUG. 20. 12:10PM

SOLICITATION NUMBER: ADJ160000003
Addendum Number: 2

The purpose of this addendum is to modify the solicitation identified as ("Solicitation") to reflect the change(s) identified and described below.

Applicable Addendum Category:

- Modify bid opening date and time
- Modify specifications of product or service being sought
- Attachment of vendor questions and responses
- Attachment of pre-bid sign-in sheet
- Correction of error
- Other

Description of Modification to Solicitation:

1. To correct Commodity Line # 7 in Oasis electronic version of the solicitation only, the specifications and the Pricing Page are correct.
2. To provide Addendum Acknowledgment form.

Bid opening date will remain 08/20/2015 at 1:30 PM EST

Additional Documentation: Documentation related to this Addendum (if any) has been included herewith as Attachment A and is specifically incorporated herein by reference.

Terms and Conditions:

1. All provisions of the Solicitation and other addenda not modified herein shall remain in full force and effect.
2. Vendor should acknowledge receipt of all addenda issued for this Solicitation by completing an Addendum Acknowledgment, a copy of which is included herewith. Failure to acknowledge addenda may result in bid disqualification. The addendum acknowledgement should be submitted with the bid to expedite document processing.

Revised 6/8/2012

RECEIVED TIME AUG. 20. 12:10PM

ATTACHMENT A

Revised 6/8/2012

RECEIVED TIME AUG. 20. 12:10PM

SOLICITATION NUMBER: ADJ160000003**Addendum Number: 2**

The purpose of this addendum is to modify the solicitation identified as ("Solicitation") to reflect the change(s) identified and described below.

Applicable Addendum Category:

- Modify bid opening date and time
- Modify specifications of product or service being sought
- Attachment of vendor questions and responses
- Attachment of pre-bid sign-in sheet
- Correction of error
- Other

Description of Modification to Solicitation:

1. To correct Commodity Line # 7 in Oasis electronic version of the solicitation only, the specifications and the Pricing Page are correct.

2. To provide Addendum Acknowledgment form.

Bid opening date will remain 08/20/2015 at 1:30 PM EST

Additional Documentation: Documentation related to this Addendum (if any) has been included herewith as Attachment A and is specifically incorporated herein by reference.

Terms and Conditions:

1. All provisions of the Solicitation and other addenda not modified herein shall remain in full force and effect.
2. Vendor should acknowledge receipt of all addenda issued for this Solicitation by completing an Addendum Acknowledgment, a copy of which is included herewith. Failure to acknowledge addenda may result in bid disqualification. The addendum acknowledgement should be submitted with the bid to expedite document processing.

Revised 6/8/2012

RECEIVED TIME AUG. 20. 12:10PM

EXHIBIT A

Utility Farm Tractors & Accessories
PRICING PAGE

| CONTRACT ITEM NO. 1 | DESCRIPTION | QTY | UNIT PRICE | TOTAL |
|---------------------|--|-----|--------------|--------------|
| Item No. 3.1.1 | Utility Farm Tractor with Cab LS-Model P7040CPS or equal | 1 | \$ 57,997.00 | \$ 57,997.00 |
| | Manufacturer Bid: JOHN DEERE | | | |
| | Model No. Bid: 6105E | | | |
| Item No. 3.1.1 | Utility Farm Tractor with Cab LS-Model P7040CPS or equal | 1 | \$ 57,997.00 | \$ 57,997.00 |
| | Manufacturer Bid: JOHN DEERE | | | |
| | Model No. Bid: 6105E | | | |
| Item No. 3.1.1 | Utility Farm Tractor with Cab LS-Model P7040CPS or equal | 1 | \$ 57,997.00 | \$ 57,997.00 |
| | Manufacturer Bid: JOHN DEERE | | | |
| | Model No. Bid: 6105E | | | |

RECEIVED TIME AUG. 20. 12:10PM.

EXHIBIT A

Utility Farm Tractors & Accessories

PRICING PAGE

| CONTRACT ITEM NO. 2 | DESCRIPTION | QTY | UNIT PRICE | TOTAL |
|------------------------|---|-----|---------------|-------------|
| Item No. 3.1.2 | Loader Bucket Attachment LS-Model LL7101 w/78"Bucket or equal | 1 | \$ 5,479.00 | \$ 5,479.00 |
| | Manufacturer Bid: JOHN DEERE | | | |
| | Model No. Bid: H260 | | | |
| Item No. 3.1.2 | Loader Bucket Attachment LS-Model LL7101 w/78"Bucket or equal | 1 | \$ 5,479.00 | \$ 5,479.00 |
| | Manufacturer Bid: JOHN DEERE | | | |
| | Model No. Bid: H260 | | | |
| Item No. 3.1.2 | Loader Bucket Attachment LS-Model LL7101 w/78"Bucket or equal | 1 | \$ 5,479.00 | \$ 5,479.00 |
| | Manufacturer Bid: JOHN DEERE | | | |
| | Model No. Bid: H260 | | | |

EXHIBIT A

Utility Farm Tractors & Accessories

PRICING PAGE

| CONTRACT ITEM NO. 3 | DESCRIPTION | QTY | UNIT PRICE | TOTAL |
|------------------------|---|-----|---------------|-------------|
| Item No. 3.1.3 | Front Mounted Front Snow Blade, Allied Model W9027S or equal Manufacturer Bid: FRONTIER Model No. Bid: AF11G | 1 | \$ 2,699.00 | \$ 2,699.00 |
| Item No. 3.1.3 | Front Mounted Front Snow Blade, Allied Model W9027S or equal Manufacturer Bid: FRONTIER Model No. Bid: AF11G | 1 | \$ 2,699.00 | \$ 2,699.00 |
| Item No. 3.1.3 | Front Mounted Front Snow Blade, Allied Model W9027S or equal Manufacturer Bid: FRONTIER Model No. Bid: AF11G | 1 | \$ 2,699.00 | \$ 2,699.00 |

RECEIVED TIME AUG. 20. 12:10PM

RECEIVED TIME AUG. 20. 12:10PM

| | | | | |
|--------------------------------|--|------------|-----------------------|--------------|
| Item No. 3.1.3 | Front Mounted Front Snow Blade, Allied Model W9027S or equal | 1 | \$ 2,699.00 | \$ 2,699.00 |
| | Manufacturer Bid: FRONTIER | | | |
| | Model No. Bid: AF11G | | | |
| Item No. 3.1.3 | Front Mounted Front Snow Blade, Allied Model W9027S or equal | 1 | \$ 2,699.00 | \$ 2,699.00 |
| | Manufacturer Bid: FRONTIER | | | |
| | Model No. Bid: AF11G | | | |
| CONTRACT ITEM NO. 4 | DESCRIPTION | QTY | UNIT PRICE | TOTAL |
| Item No. 3.1.4 | Utility Farm Tractor with Cab LS-Model XU5065CPS or equal | 1 | \$ 49,939.00 | \$ 49,939.00 |
| | Manufacturer Bid: JOHN DEERE | | | |
| | Model No. Bid: 5075M | | | |
| Item No. 3.1.4 | Utility Farm Tractor with Cab LS-Model XU5065CPS or equal | 1 | \$ 49,939.00 | \$ 49,939.00 |
| | Manufacturer Bid: JOHN DEERE | | | |
| | Model No. Bid: 5075M | | | |

EXHIBIT A

Utility Farm Tractors & Accessories

PRICING PAGE

| CONTRACT ITEM NO. 5 | DESCRIPTION | QTY | UNIT PRICE | TOTAL |
|---------------------|--|-----|-------------|-------------|
| Item No. 3.1.5 | Front End Loader w/Bucket LS-Model LL5103 or equal | 1 | \$ 5,479.00 | \$ 5,479.00 |
| | Manufacturer Bid: JOHN DEERE | | | |
| | Model No. Bid: H260 | | | |
| Item No. 3.1.5 | Front End Loader w/Bucket LS-Model LL5103 or equal | 1 | \$ 5,479.00 | \$ 5,479.00 |
| | Manufacturer Bid: JOHN DEERE | | | |
| | Model No. Bid: H260 | | | |
| CONTRACT ITEM NO. 6 | DESCRIPTION | QTY | UNIT PRICE | TOTAL |
| Item No. 3.1.6 | Woods Model RD990-X Finish Mower Rear Mount or equal | 1 | \$ 4,259.00 | \$ 4,259.00 |
| | Manufacturer Bid: WOODS | | | |
| | Model No. Bid: RD990-X | | | |
| Item No. 3.1.6 | Woods Model RD990-X Finish Mower Rear Mount or equal | 1 | \$ 4,259.00 | \$ 4,259.00 |
| | Manufacturer Bid: WOODS | | | |
| | Model No. Bid: RD990-X | | | |

RECEIVED TIME AUG. 20. 12:10PM

EXHIBIT A

Utility Farm Tractors & Accessories

PRICING PAGE

| CONTRACT ITEM NO. 7 | DESCRIPTION | QTY | UNIT PRICE | TOTAL |
|------------------------|--|-----|---------------|-----------|
| Item No. 3.1.7 | Polyethylene Fertilizer Spreader, King Kutter Model S-400-P or equal | 1 | \$ 579.00 | \$ 579.00 |
| | Manufacturer Bid: FRONTIER | | | |
| | Model No. Bid: SS3067B | | | |
| Item No. 3.1.7 | Polyethylene Fertilizer Spreader, King Kutter Model S-400-P or equal | 1 | \$ 579.00 | \$ 579.00 |
| | Manufacturer Bid: FRONTIER | | | |
| | Model No. Bid: SS3067B | | | |
| Item No. 3.1.7 | Polyethylene Fertilizer Spreader, King Kutter Model S-400-P or equal | 1 | \$ 579.00 | \$ 579.00 |
| | Manufacturer Bid: FRONTIER | | | |
| | Model No. Bid: SS3067B | | | |
| Item No. 3.1.7 | Polyethylene Fertilizer Spreader, King Kutter Model S-400-P or equal | 1 | \$ 579.00 | \$ 579.00 |
| | Manufacturer Bid: FRONTIER | | | |
| | Model No. Bid: SS3067B | | | |
| | | | | |
| | | | | |

RECEIVED TIME AUG. 20. 12:10PM

| | | | | |
|----------------|--|---|-----------|---------------|
| Item No. 3.1.7 | Polyethylene Fertilizer Spreader, King Kutter Model S-400-P or equal | 1 | \$ 579.00 | \$ 579.00 |
| | Manufacturer Bid: FRONTIER | | | |
| | Model No. Bid: SS3067B | | | |
| | | | | |
| | Unit prices to be inclusive of all freight/delivery costs | | | |
| | Failure to use this form may result in disqualification | | | \$ 326,172.00 |
| | Bidder / Vendor Information: | | | |
| | Name: BRIDGEPORT EQUIPMENT AND TOOL | | | |
| | Address: 1504 OAKHURST DRIVE | | | |
| | CHARLESTON, WV 25314 | | | |
| | Phone: 304-659-2917 | | | |
| | Fax: 304-659-3276 | | | |
| | E-mail Address: rgardner@bridgeportequip.com | | | |
| | Authorized Signature: | | Date: | |
| | <i>Ronald A. Gardner</i> | | 8/19/2015 | |

EXCEPTIONS TO BID SPECIFICATION TAKEN

3.1.1.6 NUMBER OF SPEEDS – 40 FORWARD/40 REVERSE

JOHN DEERE 6105E – 24 FORWARD/12 REVERSE

3.1.4.7 DIFFERENTIAL LOCK: STANDARD MECHANICAL (PEDAL)

JOHN DEERE – 5075M - ELECTROHYDRAULIC

Print Specifications

| | |
|--|---|
| Manufacturer | John Deere |
| MODEL | 6105E Tractor FT4 |
| SERIAL NUMBERS | --- |
| Official Test | |
| Nebraska Test number | Yet to be tested |
| Engine | |
| Manufacturer | John Deere PowerTech™ |
| Engine family | PWL (B20 Diesel Compatible) |
| Aspiration | --- |
| Cylinders/Displacement, cu. in. (L) | Wastegate turbocharger with air-to-air aftercooling and cooled exhaust gas recirculation |
| Cylinder Liners | 4.5 L 275 cu in. |
| Fuel tank capacity, US Gal. (L) (Open; Cab) | Wet |
| Standard | --- |
| Optional | 168 L 44.4 U.S. gal. |
| Underhood muffler | --- |
| Performance | |
| Advertised PTO hp (kW) @ Rated rpm | 66 @ 2100 rpm kW 89 @ 2100 rpm PTO hp |
| Official PTO hp (kW) @ Rated rpm | --- |
| @ Standard PTO @ Eng rpm | --- |
| Maximum @ Eng rpm | --- |
| Advertised Engine hp (kW) @ Rated speed | 77 @ 2200 kW 105 @ 2200 engine hp |
| Max Unballast Drwbr hp (kW) @ Eng rpm | --- |
| Maximum Torque (PTO) @ rpm, lb-ft (Nm) | --- |
| Max Torque Rise (80% rtd spd) @ Eng rpm | 25% @ 1500 rpm |
| Maximum Torque Rise % (PTO) @ Eng rpm | 30% |
| Fuel Use, U.S. gal./hr & hp hr/gal. at: | |
| PTO @ Rated Eng rpm | --- |
| Standard PTO Speed @ Eng speed | --- |
| Maximum PTO Power @ Eng rpm | --- |
| Maximum Engine Power @ Eng rpm | --- |
| Max Unballasted Drawbar Power @ Eng rpm | --- |
| 75% Load, Full Engine rpm (Unballasted) | --- |
| 75% Load @ Reduced rpm (Unballasted) | --- |
| Transmission | |
| Std. Transmission; Forward/Reverse | 12F/12R PowrReverser Transmission (30) km/h 12F/12R PowrReverser Transmission (19) mph |
| Opt. Transmission; Forward/Reverse | 24F/12R PowrReverser Transmission (40) km/h 24F/12R PowrReverser Transmission (25) mph |
| Reverser | Base LH |
| On-the-Go Shifting (Yes/No/Partial) | Yes |
| Clutch; Wet/Dry | Wet |
| Creep | No |
| Power Take-Off (PTO) | |
| Standard | Independent 540/1000 |
| Optional | --- |
| PTO Speeds @ Engine rpm | 540 @ 2085 or 1000 @ 2067 rpm |
| PTO Actuation | Electronic |
| Hydraulics | |
| Type | Open-center |
| Pump Rated Output, GPM (L/min.) | |

PLEASE NOTE:

BID UNIT PLACED IS A 6105E
TRACTOR WITH A 24x12

POWRREVERSER TRANSMISSON.

PLEASE SEE ENCLOSED LITERATURE.

Print Specifications

| | |
|--|---|
| Front Axle Clearance, in. (mm) | 597 mm 23.5 in. |
| Turning Radius w/Brakes, ft (m) | 2.1 m @ 64.4 in. tread setting 7 ft. @ 64.4 in. tread setting |
| Turning Radius w/o Brakes, ft (m) | 2.9 m @ 64.4 in. tread setting 9.5 ft @ 64.4 in. tread setting |
| Unballasted Operating Weight, lb (kg) | --- |
| Approx. Ship Wgt, lb (kg) Open; Cab | 3960 ; 4064 kg 8480 ; 9780 lb |
| MFWD Dimensions | |
| Wheelbase, in. (mm) | 2450 mm 96.5 in. |
| Front Tread Range, in. (mm) | 1523-2033 mm 60.0-80.0 in. |
| Front Axle Clearance, in. (mm) | 457 mm 18 in. |
| Turning Radius w/Brakes, ft (m) | --- |
| Turning Radius w/o Brakes, ft (m) | --- |
| Limited Slip Differential | Yes |
| Unballasted Operating Weight, lb (kg) | --- |
| Approx. Ship Wgt, lb (kg) Open; Cab | 4268; 4645 kg 9410; 10,240 lb |
| 4WD Dimensions | |
| Wheelbase, in. (mm) | 2450 mm 96.5 in. |
| Wheel Tread, Min. to Max. in. (mm) | --- |
| Turning Radius w/o Brakes, ft (m) | --- |
| Nebraska Test Unballasted w/Duals, lb (kg) | --- |
| Unballasted Weight, lb (kg) | --- |
| Standard Tires | |
| 2WD | |
| Front | 10.00-16 in. 8PR F2 Bias |
| Rear | 460/85R38 in. 8PR R1W Radial |
| MFWD | |
| Front | 380/85R24 in. 8PR R1W Radial |
| Rear | 460/85R38 in. 8PR R1W Radial |
| 4WD | |
| Track widths | --- |
| Miscellaneous | |
| Country of Manufacture | Saltillo, Mexico |
| Ballasting Restrictions, lb (kg) | Refer to operator's manual |
| *Notes | Updated - 1 August 2015 |

Tire combinations; two-wheel-drive (2WD), mechanical front-wheel drive (MFWD) and rear axle – radial tires Page 1 of 1

Tire combinations; two-wheel-drive (2WD), mechanical front-wheel drive (MFWD) and rear axle – radial tires

Print

Overview

Front and rear radial tire offerings are available on all models, except for the front tires on the open-operator station (OOS) configurations.

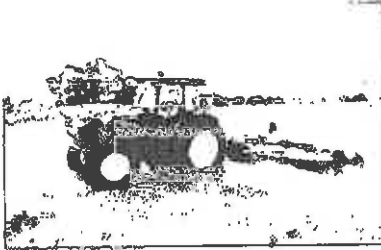

GE with radial tire offering

Benefits:

- Better ride quality
- Better wear characteristics
- Less compaction
- More efficient converting more power to the ground

Tire combinations by model

| Codes | | 610SE | 6125E | 6135E |
|-------|--|----------|----------|----------|
| | Two-wheel drive (2WD) front | | | |
| 6151 | 10.00-16 In. 8PR F2 Bias | In base | In base | N/A |
| | 2WD rear | | | |
| 5234 | 460/85R38 In. 8PR R1W Radial | In base | In base | N/A |
| 5212 | 460/85R34 In. 8PR R1W Radial | Optional | Optional | N/A |
| 5221 | 420/85/R38 In. 8PR R1W Radial | Optional | Optional | N/A |
| | Mechanical front-wheel drive (MFWD) front | | | |
| 6220 | 380/85R24 In. 8PR R1W Radial | In base | In base | In base |
| 6210 | 340/85R24 In. 8PR R1W Radial | Optional | Optional | Optional |
| | MFWD rear | | | |
| 5234 | 460/85R38 In. 8PR R1W Radial | In base | In base | In base |
| 5212 | 460/85R34 In. 8PR R1W Radial | Optional | Optional | Optional |
| 5221 | 420/85/R38 In. 8PR R1W Radial | Optional | Optional | Optional |

Provide feedback about this page

Last Updated : 11-Aug-2015

Product features are based on published information at the time of publication and are subject to change without notice. All trademarked terms, including John Deere, the leaping deer symbol and the colors green and yellow used herein are the property of Deere & Company, unless otherwise noted. Availability of products, product features, and other content on this site may vary by model and geographic region.

Engine horsepower and torque information for non-Deere engines are provided by the engine manufacturer for comparison purposes only. Actual operating horsepower and torque will be less. Refer to the engine manufacturer's Web site for additional information.

Copyright © 2015 Deere & Company All Rights Reserved

12 forward/12 reverse (12F/12R) and 24F/12R, PowrReverser™ transmission

Page 1 of 2

12 forward/12 reverse (12F/12R) and 24F/12R, PowrReverser™ transmission

Print

Overview:

The 6E Series PowrReverser transmissions deliver unmatched performance. This transmission is ideal for working in tight areas where forward to reverse shifting is a primary occurrence such as in barns, feedlots and loader applications.

Customers who are operating power take-off (PTO) implements like a rotary cutter or baler will appreciate the additional working speeds with the 24F/12R speeds PowrReverser transmission. High and low buttons are used to make fine adjustments in speed without the need to use the clutch delivering improved productivity.

The PowrReverser transmission is base equipment providing 12F/12R speeds. Six well-spaced ground speeds place the operator in the important haying or rotary cutter range of 8 km/h to 20.9 km/h (5 mph to 13 mph). With this transmission, the operator can reach a top speed of 31.5 km/h (19.6 mph). The optional PowrReverser transmission 24F/12R will deliver 11 well-spaced ground speeds to match the correct speed for a haying or rotary cutter application with a top speed of 40 km/h (25 mph).

A dash-mounted PowrReverser modulation kit (LV825727) is available to set the aggressiveness of the forward and reverse shuttle modulation that best fits the application or the operator's comfort level.

Operator controls

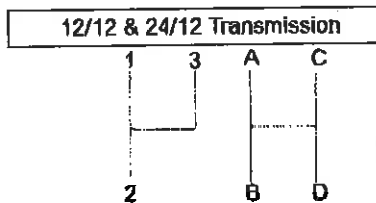

24F/12R high/low buttons



24F/12R high/low buttons



Gear and range levers in cab

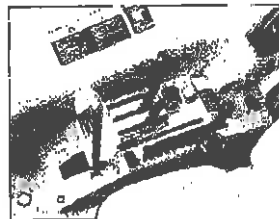

Gear lever in open operator station (OOS)

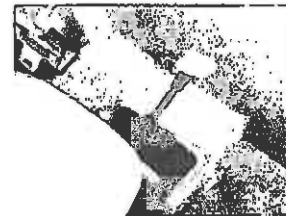

Range lever in OOS

Two levers, one for speed and one for range, with the addition of an electrohydraulic left-hand reverser, provide operators optimum control and maneuverability.

1. Range lever (right-hand side (cab), left-hand side (OOS)) selects four ranges (A, B, C, D).
2. Gear selection (right-hand side) selects speeds (1, 2, or 3) in the forward or reverse direction.
3. Electrohydraulic left-hand reverser allows for quick and convenient shuttle shifting between forward and reverse at any speed.
4. High and low buttons are located on the gear shifter for the 24F/12R PowrReverser transmission.

Benefits:

Forward and reverse speeds

All speed gears (1, 2, 3) are fully synchronized for shifting-on-the-go capabilities, putting less wear on the operator and saving time in the field. In the 12F/12R PowrReverser transmission, gears are synchronized for low shifting effort while the operator is doing field or loader work and during transport.

The high and low speeds on the 24F/12R PowrReverser transmission can be shifted without clutching while the tractor is under load. This makes for quick speed changes when operating a rotary cutter or baler.

To further enhance awareness of reverse tractor motion, a back-up alarm can be field-installed (BSJ10026).

The ranges (A, B) are not synchronized. This means the tractor must be stopped for the operator to select the range. However, with operator input, the speeds have been well spaced out to minimize the need to change ranges within applications. The ranges (B to C, C to D, and D to C) are synchronized. That allows the operator to shift ranges on the go in transport and high speed applications like operating a mower-conditioner.

http://dlrdoc.deere.com/sales/salesmanual/en_NA/tractors/2016/feature/transmissions/6e/2... 8/20/2015

Print Specifications

| | |
|--|--|
| Standard | 20.0 Advertised gpm 75.7 Advertised L/min |
| Optional | --- |
| Rated Flow @ One SCV, GPM (L/min.) | 20.0 gpm 75.7 L/min |
| Max Output @ SCV Couplers, GPM (L/min.) | --- |
| Maximum Operating Pressure, psi (kPa) | 19,500 kPa 2828 psi |
| Maximum Hydraulic Power, hp (kW) | --- |
| Hitch Draft Control Load Sense Type | Lower-link |
| Remote Control Valves Available | 2 std., 3 opt. With deluxe coupler |
| Hitch Category (SAE Designation) | Category II |
| Hitch Lift Cap. lb (kg) @24 in. Bhnd Lift Pt. | --- |
| OECD | --- |
| Standard | 2500 kg Advertised with 2 x 70 mm lift cylinders 5500 lb Advertised with 2 x 70 mm lift cylinders |
| Optional | 3318 kg Advertised with 2 x 80 mm lift cylinders 7300 lb Advertised with 2 x 80 mm lift cylinders |
| Hitch Lift Cap. lb (kg) @24 in. Bhnd Lift Pt. (SAE) | --- |
| Standard | --- |
| Optional | --- |
| Hitch Lift Cap. lb (kg) @24 in. Bhnd Lift Pt. (ASAE) | --- |
| Standard | --- |
| Optional | --- |
| Sensing type | Mechanical |
| Joystick SCV control | Mid mount, opt. |
| Final Drive | |
| Type | Inboard planetary |
| Differential controls | Mechanical |
| Availability | --- |
| Front | --- |
| Front & Rear | --- |
| Engage On-the-Go Rear Differential Lock | Yes |
| Axle Type | Flanged |
| Brakes, Type and Control | Mechanically actuated wet disk |
| Operator Station | |
| Rollover Protective Structure, OOS | Yes |
| Rigid - Foldable - Telescopic | Foldable |
| Platform - Flat/Straddle | Flat |
| Gearshift Location - Console/Floor | Floor |
| Cab | --- |
| Doors | 2 |
| Platform - Flat/Straddle | Flat |
| dB(A) Rating | 75 |
| Seat Suspension System | Mechanical, Air opt. |
| 2WD Dimensions | |
| Wheelbase, in. (mm) | 2456 mm 96.7 in. |
| Front Tread Range, in. (mm) | 1523-2033 mm 60.0-80.0 in. |
| Rear Tread Range, in. (mm) | 1512-2012 mm 59.5-79.2 in. |
| Minimum Rear Tread Setting, in. (mm) | 1523 mm 60.0 in. |

EPA Final Tier 4 (FT4) compliant engines with maximum fluid efficiency

**Placeholder
Image**

The DPF

Diesel exhaust fluid (DEF)

DEF is an ISO 22241 standard aqueous urea solution consisting of 32.5 percent urea and has a freezing point of -11°C (12°F). A heated DEF tank keeps the customer in the field longer even when the temperatures drop below freezing. The DEF tank header is integrated with a temperature sensor, and plumbed engine coolant lines are used to promote thawing and prevent freezing in the tank during operation.

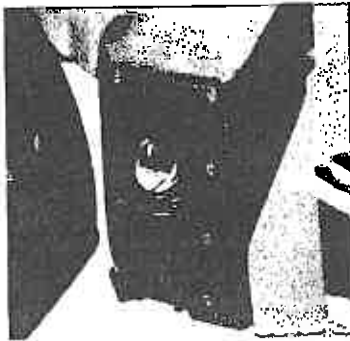

DEF tank

Mounted near the DEF tank, the electronic control unit (ECU)-controlled supply module draws diesel exhaust fluid from the storage tank and provides a pressurized flow to the dosing module. When the ignition key is off, the supply module pump will reverse direction to return any accumulated fluid back to the tank. The supply module is also fitted with a replaceable filter to prevent contaminants from entering the dosing lines. Both the supply module and dosing lines are electrically heated and controlled by the ECU to determine when DEF dosing can begin.

The dosing module is cooled by engine coolant and used to inject DEF at a pressure of 130 psi (900 kPa, 9 bar) into the decomposition tube. A harness is connected to the dosing valve that relays the needed DEF to inject based upon the amount of NOx exiting the DOC measured from the NOx tube sensor.

The decomposition tube is the internal mixing device used to circulate DEF with engine exhaust prior to entering the SCR/AOC after-treatment device.

SCR

The decomposition tube is the internal mixing device used to circulate DEF with engine exhaust prior to entering the selective catalytic reduction (SCR) / ammonia oxidation catalyst (AOC) after-treatment device.



SCR location on the 6E Tractor

Exhaust gas recirculation (EGR)

EGR reduces the high temperatures where these compounds are formed in the engine cylinders by replacing excess oxygen with a prescribed amount of cooled exhaust

http://dlrdoc.deere.com/sales/salesmanual/en_NA/tractors/2016/feature/engine/6e/filter_cle... 8/20/2015

EPA Final Tier 4 (FT4) compliant engines with maximum fluid efficiency

Page 3 of 3

gas.

Exhaust gases contain more carbon dioxide than oxygen. The EGR valve, in conjunction with the venturi tube and engine control unit (ECU), allows a controlled amount of exhaust gas to enter the intake manifold to mix with the incoming fresh air. Replacing excess oxygen with cooled exhaust gas leads to lower combustion temperatures, creating less NOx.

In addition, EGR allows for:

- Advanced timing
- Optimal engine performance
- Maximum fuel economy

For added performance and efficiency, the engine passes the exhaust gases through an EGR cooler before it enters the engine. Exhaust airflow enters into the EGR cooler from the exhaust manifold near the turbocharger. Based on engine load, air temperatures and rpm, the ECU opens or closes the EGR valve, allowing a measured percentage of exhaust gas to enter the intake manifold. The gases mix with the rest of the incoming air from the turbocharger and aftercooler before entering the cylinders.

Turbocharger

The PowerTech™ PWS and PWS 4.5L utilizes one turbocharger — a fixed geometry turbocharger. Fresh air is first drawn into the low-pressure fixed geometry turbocharger and compressed to a higher pressure. The compressed air is then routed to the charge air cooler and then to the intake manifold.

Benefits of air-to-air aftercooling:

- Lowers the intake manifold air temperature
- Provides more efficient cooling while reducing temperatures for greater engine reliability
- Higher volume of air flows into the cylinders
- Engine is capable of meeting the increasing horsepower demands

Combustion process with externally cooled EGR

According to engine operating conditions, the recirculated exhaust gases reduce the oxygen portion in the intake air to approximately 20 percent. Without any increase of the charge air pressure, the oxygen rate is not high enough to ensure a complete combustion of the fuel injected at high engine loads.

Therefore, fuel-efficient combustion is achieved, due to sufficient oxygen being provided. By dampening the typical hot combustion process generated by an oxygen surplus, a restrained, cooler combustion is realized by the inert gases and the NOx emissions are reduced.

For more information regarding EPA regulations and the technology behind John Deere integrated emissions control systems, please visit the following link: http://www.deere.com/wps/wcm/connect_US/campaigns/eg_turf/emissions/final_tier_4_page

Provide feedback about this page

Last Updated : 11-Aug-2015

[Home](#) | [Feedback](#) | [Help](#) Copyright © 2015 Deere & Company All Rights Reserved

[Privacy & Data](#) | [Legal](#)

Product features are based on published information at the time of publication and are subject to change without notice. All trademarked terms, including John Deere, the leaping deer symbol and the colors green and yellow used herein are the property of Deere & Company, unless otherwise noted. Availability of products, product features, and other content on this site may vary by model and geographic region.

Engine horsepower and torque information for non-Deere engines are provided by the engine manufacturer for comparison purposes only. Actual operating horsepower and torque will be less. Refer to the engine manufacturer's Web site for additional information.

Copyright © 2015 Deere & Company All Rights Reserved

EPA Final Tier 4 (FT4) compliant engines with maximum fluid efficiency

EPA Final Tier 4 (FT4) compliant engines with maximum fluid efficiency

Print

The U.S. Environmental Protection Agency (EPA) and Environment Canada require all off-road diesel engines with 25 hp or more to meet stringent FT4 emissions regulations. John Deere uses the most efficient and cost-effective solution for the tractor package to meet emissions requirements at each horsepower level. The 6E delivers a hassle-free emissions solution that allows faster work and operation with ease with two different engine offerings, the John Deere PowerTech™ PWL (6105E and 6120E) and PWS (6135E).

The engine powering the 6E is EPA certified Tier Level 4. This is achieved through a combination of a diesel oxidation catalyst (DOC) and selective catalytic reduction (SCR) using diesel exhaust fluid (DEF, or urea) with the PWL engine. In addition to the components that the PWL has, the PWS also has a diesel particulate filter (DPF).

Several defining features on the 6E maximize the performance and reliability of the emissions package. A completely shielded DOC/SCR not only protects essential components from damage, it also keeps out dirt and debris. The well-packaged and tightly organized circulation system means there is more room to work around the tractor.

PowerTech PWL Final Tier 4 technology

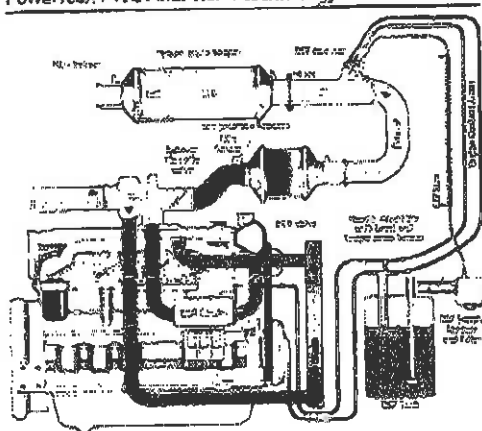

PowerTech PWL FT4 technology (Engine model: 4045HP73)

PowerTech PWS Final Tier 4 technology

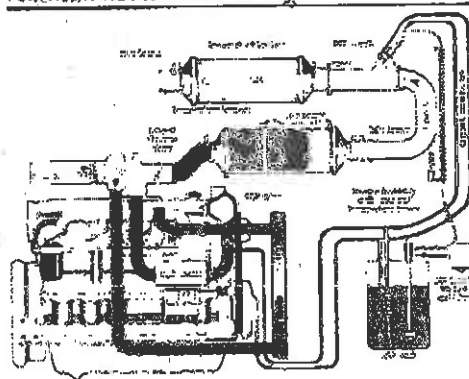

PowerTech PWS FT4 technology (Engine model: 4045HP74)

Key components of the emissions system include:

Diesel oxidation catalyst (DOC)

John Deere has chosen to utilize an exhaust filter to reduce particulate material so the engine can operate at a level which produces less NOx. With less NOx created, less DEF is required to treat. The result is improved total fluid economy (diesel and DEF).

The engine is programmed to aggressively respond to changes in power needs, which can temporarily increase particulate matter. Since the exhaust filter removes particulate matter instead of the engine, the engine is left free to do what it is designed to do – deliver all of the power, torque, plus transient response needed.

Diesel particulate filter (DPF)

The DPF (only in the PWS engine which is used in the 6135E) is constructed of ceramic porous channel walls, trapping and holding any remaining particulate matter.

Depending on the load the tractor is under, as well as ambient temperature, humidity and engine speed, the DPF may build up with particulate matter, thus requiring cleaning. This after-treatment cleaning process is an automatic process determined by one of three factors:

- A prescribed time-based estimation of needed cleaning
- DOC/DPF pressure sensors
- A particulate matter buildup estimation based on load conditions

Once one of the three parameters has been met, cleaning occurs.

There are three different types of cleaning processes:

- Passive cleaning
- Active cleaning
- Parked cleaning

Tire combinations; two-wheel-drive (2WD), mechanical front-wheel drive (MFWD) and rear axle – radial tires

Print

Overview

Front and rear radial tire offerings are available on all models, except for the front tires on the open-operator station (OOS) configurations.

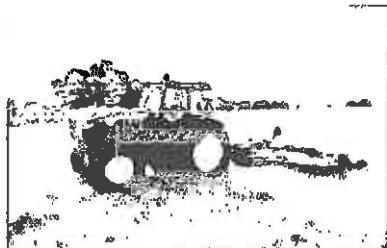

6E with radial tire offering

Benefits:

- Better ride quality
- Better wear characteristics
- Less compaction
- More efficient converting more power to the ground

Tire combinations by model

| Codes | | 6105E | 6125E | 6135E |
|-------|--|----------|----------|----------|
| | Two-wheel drive (2WD) front | | | |
| 6151 | 10.00-16 In. 8PR F2 Bias | In base | In base | N/A |
| | 2WD rear | | | |
| 5234 | 460/85R38 In. 8PR R1W Radial | In base | In base | N/A |
| 5212 | 460/85R34 In. 8PR R1W Radial | Optional | Optional | N/A |
| 5221 | 420/85/R38 In. 8PR R1W Radial | Optional | Optional | N/A |
| | Mechanical front-wheel drive (MFWD) front | | | |
| 6220 | 380/85R24 In. 8PR R1W Radial | In base | In base | In base |
| 6210 | 340/85R24 In. 8PR R1W Radial | Optional | Optional | Optional |
| | MFWD rear | | | |
| 5234 | 460/85R38 In. 8PR R1W Radial | In base | In base | In base |
| 5212 | 460/85R34 In. 8PR R1W Radial | Optional | Optional | Optional |
| 5221 | 420/85/R38 In. 8PR R1W Radial | Optional | Optional | Optional |

Provide feedback about this page

Last Updated : 11-Aug-2015

Product features are based on published information at the time of publication and are subject to change without notice. All trademarked terms, including John Deere, the leaping deer symbol and the colors green and yellow used herein are the property of Deere & Company, unless otherwise noted. Availability of products, product features, and other content on this site may vary by model and geographic region.

Engine horsepower and torque information for non-Deere engines are provided by the engine manufacturer for comparison purposes only. Actual operating horsepower and torque will be less. Refer to the engine manufacturer's Web site for additional information.

Copyright © 2015 Deere & Company All Rights Reserved

Differential, mechanically actuated rear differential lock

Page 1 of 1

Differential, mechanically actuated rear differential lock

Print



Differential lock

Overview:

For operators who work in slippery or muddy conditions, a mechanically actuated rear differential lock included as base equipment is a necessity.

When engaged, the differential lock applies power equally to both rear wheels for better traction and the ability to maintain control. To engage, depress the push-down lever located on the floor in front of the operator's seat. The differential lock can be engaged on the go when an operator needs extra traction.

Unequal traction will keep the lock engaged. When traction equalizes, the lock will disengage itself by spring action. If lock does not disengage, depress one brake pedal and then the other.

[Provide feedback about this page](#)

Last Updated : 03-Aug-2015

[Home](#) | [Feedback](#) | [Help](#) Copyright © 2015 Deere & Company All Rights Reserved.

[Privacy & Data](#) | [Legal](#)

Product features are based on published information at the time of publication and are subject to change without notice. All trademarked terms, including John Deere, the leaping deer symbol and the colors green and yellow used herein are the property of Deere & Company, unless otherwise noted. Availability of products, product features, and other content on this site may vary by model and geographic region.

Engine horsepower and torque information for non-Deere engines are provided by the engine manufacturer for comparison purposes only. Actual operating horsepower and torque will be less. Refer to the engine manufacturer's Web site for additional information.

Copyright © 2015 Deere & Company All Rights Reserved

Print Specifications

Page 1 of 3

| | |
|--|---|
| Manufacturer | John Deere |
| MODEL | 5075M (MY2015) |
| SERIAL NUMBERS | --- |
| Official Test | --- |
| Nebraska Test number | Factory observed |
| Engine | |
| Manufacturer | John Deere PowerTech |
| Engine family | 3029 |
| Aspiration | E3D XL03.0208 |
| Cylinders/Displacement, cu. in. (L) | Turbocharged and Air-to-Air Aftercooled |
| Cylinder Liners | 179 cu in. |
| Fuel tank capacity, US Gal. (L) (Open; Cab) | In-Line, 3 / 2.9 L |
| | --- |
| Standard | 113; 136 L |
| | 30; 36 gal. |
| Optional | 177 (with optional mid tank) L |
| | 47 (with optional mid tank) gal. |
| Underhood muffler | Yes |
| Performance | |
| Advertised PTO hp (kW) @ Rated rpm | 43.0 @ 2100 per SAE kW |
| | 57.7 PTO hp |
| Official PTO hp (kW) @ Rated rpm | --- |
| @ Standard PTO @ Eng rpm | --- |
| Maximum @ Eng rpm | --- |
| Advertised Engine hp (kW) @ Rated speed | 55.0 @ 2200 rpm per ISO |
| | 97/68/EC kW |
| | 73.8 @ 2200 rpm per ISO |
| | 97/68/EC engine hp |
| Max Unballast Drwbr hp (kW) @ Eng rpm | --- |
| Maximum Torque (PTO) @ rpm, lb-ft (Nm) | 300 @ 1400 |
| Max Torque Rise (80% rtd spd) @ Eng rpm | --- |
| Maximum Torque Rise % (PTO) @ Eng rpm | 26 @ 1400 |
| Fuel Use, U.S. gal./hr & hp hr/gal. at: | |
| PTO @ Rated Eng rpm | --- |
| Standard PTO Speed @ Eng speed | --- |
| Maximum PTO Power @ Eng rpm | --- |
| Maximum Engine Power @ Eng rpm | --- |
| Max Unballasted Drawbar Power @ Eng rpm | --- |
| 75% Load, Full Engine rpm (Unballasted) | --- |
| 75% Load @ Reduced rpm (Unballasted) | --- |
| Transmission | |
| Std. Transmission; Forward/Reverse | 16F/16R PowrReverser |
| Opt. Transmission; Forward/Reverse | 12F/4R SyncShuttle Plus, 32F/16R PowrReverser Plus |
| Reverser | Left Hand, Mechanical |
| On-the-Go Shifting (Yes/No/Partial) | Partial |
| Clutch; Wet/Dry | Wet |
| Creeper | 16F/16R PowrReverser |
| Power Take-Off (PTO) | |
| Standard | Independent 540/540 Economy |
| Optional | 540/540E/1000 |
| PTO Speeds @ Engine rpm | 1000 @ 2100 rpm rpm |
| PTO Actuation | Electrohydraulic |
| Hydraulics | |
| Type | Gear |
| Pump Rated Output, GPM (L/min.) | --- |
| Standard | 69.6 L/min |
| | 18.4 gpm |

Print Specifications

Page 2 of 3

| | |
|--|-----------------------------------|
| Optional | --- |
| Rated Flow @ One SCV, GPM (L/min.) | 14.6 gpm 55.4 L/min |
| Max Output @ SCV Couplers, GPM (L/min.) | --- |
| Maximum Operating Pressure, psi (kPa) | 2900 psi 20000 kPa |
| Maximum Hydraulic Power, hp (kW) | 22.3 hp 16.6 kW |
| Hitch Draft Control Load Sense Type | Mechanical or Electrohydraulic |
| Remote Control Valves Available | up to 3 |
| Hitch Category (SAE Designation) | 2; convertible to 1 |
| Hitch Lift Cap. lb (kg) @24 in. Bhnd Lift Pt. | --- |
| OECD | --- |
| Standard | 4793 lb 2174 kg |
| Optional | 5935 lb 2692 kg |
| Hitch Lift Cap. lb (kg) @24 in. Bhnd Lift Pt. (SAE) | --- |
| Standard | --- |
| Optional | --- |
| Hitch Lift Cap. lb (kg) @24 in. Bhnd Lift Pt. (ASAE) | --- |
| Standard | --- |
| Optional | --- |
| Sensing type | Lower Link |
| Joystick SCV control | Optional |
| Final Drive | |
| Type | Inboard Planetary |
| Differential controls | Electrohydraulic |
| Availability | --- |
| Front | No |
| Front & Rear | No |
| Engage On-the-Go Rear Differential Lock | Yes |
| Axle Type | Flanged |
| Brakes, Type and Control | Hydraulic Wet Disc |
| Operator Station | |
| Rollover Protective Structure, OOS | --- |
| Rigid - Foldable - Telescopic | Foldable, 2-Post |
| Platform - Flat/Straddle | Flat |
| Gearshift Location - Console/Floor | Floor |
| Cab | --- |
| Doors | 2 |
| Platform - Flat/Straddle | Flat |
| dB(A) Rating | 80 |
| Seat Suspension System | Mechanical (opt. Air Ride) |
| 2WD Dimensions | |
| Wheelbase, in. (mm) | 2301.24 mm 90.6 in. |
| Front Tread Range, in. (mm) | 1463 - 2098 mm 57.6 - 82.6 in. |
| Rear Tread Range, in. (mm) | 1348 - 2054 mm 53.1 - 80.9 in. |
| Minimum Rear Tread Setting, in. (mm) | 1348 mm 53.1 in. |
| Front Axle Clearance, in. (mm) | 477.5 mm 18.8 in. |
| Turning Radius w/Brakes, ft (m) | 3.51 m 11.2 ft |
| Turning Radius w/o Brakes, ft (m) | 3.90 m 12.8 ft |
| Unballasted Operating Weight, lb (kg) | --- |
| Approx. Ship Wgt, lb (kg) Open; Cab | --- |

Print Specifications

3357; 3765 kg
7400; 8300 lb

MFWD Dimensions

Wheelbase, in. (mm) 2301.24 mm
90.6 in.

Front Tread Range, in. (mm) 1340 - 1904 mm
52.8 - 75.0 in.

Front Axle Clearance, in. (mm) 401.3 mm
15.8 in.

Turning Radius w/Brakes, ft (m) 3.9 m
12.8 ft

Turning Radius w/o Brakes, ft (m) 4.4 m
14.4 ft

Limited Slip Differential Yes

Unballasted Operating Weight, lb (kg) ---

Approx. Ship Wgt, lb (kg) Open; Cab 3583; 3992 kg
6400; 7800 lb

4WD Dimensions

Wheelbase, in. (mm) ---

Wheel Tread, Min. to Max. In. (mm) ---

Turning Radius w/o Brakes, ft (m) ---

Nebraska Test Unballasted w/Duals, lb (kg) ---

Unballasted Weight, lb (kg) ---

Standard Tires

2WD

Front 11LL-15 In. 8PR F3 (Truck
Type) Bias (Firestone)

Rear 16.9-30 In. 6PR R1 Bias
(Firestone)

MFWD

Front 12.4R24 (320/85R24)
R1W Radial (Michelin) or
R1 Radial (Goodyear)

Rear 18.4R30 (460/65R30) R1
Radial (Goodyear)

4WD

Track widths ---

Miscellaneous

Country of Manufacture Augusta, GA

Ballasting Restrictions, lb (kg) ---

*Notes Updated 11/6/2014

Print Specifications

Page 1 of 2

| | |
|--|-----------------------------|
| Manufacturer | John Deere |
| MODEL | M260 NSL |
| --- | |
| Technical drawing | |
| Technical drawing | View diagram |
| Tractor | |
| Model | 6105i |
| Front tire | |
| Rear tire | |
| Front axle configuration | MFWD |
| Wheelbase | 2380 mm 93.7 in. |
| Pump capacity, gpm | 75.7 L/min 20 gpm |
| Rated pressure, psi | 195 bar 2828 psi |
| Loader | |
| Leveling configuration | Non-Self Leveling (NSL) |
| Bucket used | 1850 mm Materials 73 in. |
| Bucket weight, lb (kg) | 228 kg 503 lb |
| Lift capacity at full height, lb (kg) | --- |
| Measured at pivot (U) | 1643 kg 3622 lb |
| Measured at 500 mm ahead of pivot (V) | --- |
| Measured at 800 mm ahead of pivot (V) | 1139 kg 2511 lb |
| Lift capacity at 59 in. (1500 mm), lb (kg) | --- |
| Measured at pivot (W) | 2346 kg 5172 lb |
| Measured at 500 mm ahead of pivot (X) | --- |
| Measured at 800 mm ahead of pivot (X) | 1788 kg 3942 lb |
| Boom breakout force, lbf (kgf) | --- |
| Measured at pivot (Y) | 3111 6859 |
| Measured at 500 mm ahead of pivot (Z) | --- |
| Measured at 800 mm ahead of pivot (Z) | 2243 kg 4945 lb |
| Bucket rollback force capacity, lbf (kgf) | --- |
| At maximum height (VV) | 1579 kgf 3481 lbf |
| At 59-in. (1500-mm) lift height (XX) | 2884 kgf 6358 lbf |
| At ground-level line (ZZ) | 3051 kgf 6726 lbf |
| Dimensions | |
| Maximum lift height, in. (mm) (A) | 3562 mm 140.2 in. |
| Clearance | --- |
| At full height - bucket level, in. (mm) (B) | 3368 mm 132.6 in. |
| At full height - bucket dumped, in. (mm) (C) | 2521 mm 99.3 in. |
| Overall length (I+F), ft (m) | 2.4 m 7.8 ft |
| Overall height in carry position, ft (m) (J) | --- |
| Digging depth, in. (mm) (H) | 69 mm 2.7 in. |
| Reach | |

<http://www.deere.com/specsapp/DealerSpecificationServlet?userAction=PRINTSPEC&pci...> 8/20/2015

RECEIVED TIME AUG. 20. 12:10PM

Print Specifications

| | |
|--|---------------------|
| At maximum height, in. (mm) (D) | 1028 mm 40.5 in. |
| At ground level - bucket level, in. (mm) (F) | 2428 mm 95.6 in. |
| Bucket angle | |
| Dump angle, degrees (E) | -75 degree (angle) |
| Rollback angle, degrees (G) | 42 degree (angle) |
| Dump angle, ground | -157 degree (angle) |
| Cycle times | |
| Loader raise, seconds | 3.9 seconds |
| Loader lower, seconds | 3 seconds |
| Bucket dump, seconds | 3.1 seconds |
| Bucket rollback, seconds | 2.1 seconds |
| Date collected | --- |

16F/16R PowrReverser™ transmission

Page 1 of 2

16F/16R PowrReverser™ transmission

Print

The PowrReverser transmission provides 16 forward speeds and 16 reverse (16R/16R) speeds and can be equipped with the factory-installed creeper. This transmission comes standard with a dual speed 540/540 economy power take-off (E-PTO), and is ideal for applications requiring frequent directional changes.

Hydraulic wet forward and reverse clutches maximize durability and outlast the life of any dry clutch. When tractors are run by multiple operators with a variety of experience levels, a wet clutch is the best way to maintain transmission integrity and performance while decreasing clutch replacement costs.

Two platform-mounted levers offer easy and comfortable shifting for a pleasant operator experience. The gear-shift lever is easy to reach and the less-used range lever is now shorter. Unique knobs make it easy to distinguish between the two.

The forward lever selects one of four speeds, all synchronized shifts for on-the-go shifting with the use of the clutch. The rear lever selects collar-shift A, B, C, D, and creeper ranges.



Gear and range shift levers

Maximum productivity is achieved with clutchless hydraulic shifting between forward and reverse and is ideal for rear blading and any applications that require frequent directional switches in tight spaces. An electrohydraulic fingertip directional lever control allows the operator to effortlessly switch directions with a small finger motion. The control is located on the left side of the instrument console and selects forward, reverse, and neutral positions. It also allows the operator to steer and shift direction with the left hand, freeing the right hand to operate other tractor controls, such as the loader, rear implements, or hand throttle. The PowrReverser has a built-in engagement override valve for additional safety. This valve requires the clutch pedal to be depressed one time after each engine start before the transmission will begin to operate normally, giving the operator another opportunity to put all focus on the tractor.

A neutral start switch requires the directional lever be in the neutral position to start the engine.

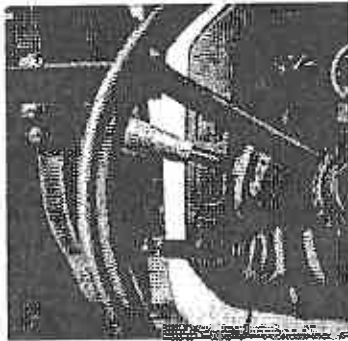

Left-hand reverser - cab

The speed of directional changes can be adjusted to the operator's preference or application demands with the field-installed infinitely variable control kit.

16F/16R transmission includes:

- Wet clutch
- Platform-mounted shift levers (4 gears, 4 ranges)
- Left-hand reverser
- Constant-mesh helical-cut gears
- Pressure-lubricated top shaft
- Positive park pawl
- Neutral start switch

All tractors have E-PTO (a fuel saving feature) that allows customers to operate rear implements at 540 PTO rpm but at lower engine rpm. The result is lower engine vibration, reduced noise, less wear and tear on the engine, reduced fuel consumption and increased operator comfort.

See PTO Functional area for more information on EPTO.

Dealer Use Only:

Twice the durability and work life, reversible cutting edges

Twice the durability and work life, reversible cutting edges

Print

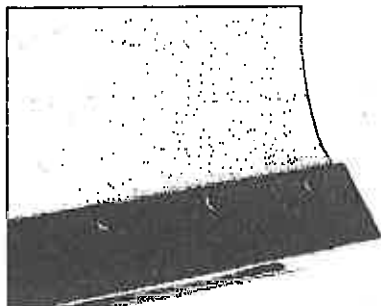

AF11 and AF12 Series cutting edge

The heat-treated steel cutting edge on the Frontier AF11 and AF12 Series Front Blades are reversible for twice the durability and work life.

[Provide feedback about this page](#)

Last Updated : 25-Jun-2015

[Home](#) | [Feedback](#) | [Help](#) Copyright © 2015 Deere & Company All Rights Reserved

[Privacy & Data](#) | [Legal](#)

Product features are based on published information at the time of publication and are subject to change without notice. All trademarked terms, including John Deere, the leaping deer symbol and the colors green and yellow used herein are the property of Deere & Company, unless otherwise noted. Availability of products, product features, and other content on this site may vary by model and geographic region.

Engine horsepower and torque information for non-Deere engines are provided by the engine manufacturer for comparison purposes only. Actual operating horsepower and torque will be less. Refer to the engine manufacturer's Web site for additional information.

Copyright © 2015 Deere & Company All Rights Reserved

Frame is heavy-duty for long, dependable implement life

Frame is heavy-duty for long, dependable implement life

[Print](#)

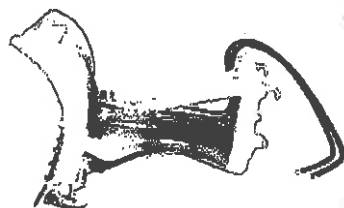

AF11 and AF12 Series Front Blades are built strong

The loader-mounted front blade is made of heavy-duty steel to resist bending and provide longer wear capability on the Frontier AF11 and AF12 Series Front Blades.

[Provide feedback about this page](#)

Last Updated : 25-Jun-2015

[Home](#) | [Feedback](#) | [Help](#) Copyright © 2015 Deere & Company All Rights Reserved

[Privacy & Data](#) | [Legal](#)

Product features are based on published information at the time of publication and are subject to change without notice. All trademarked terms, including John Deere, the leaping deer symbol and the colors green and yellow used herein are the property of Deere & Company, unless otherwise noted. Availability of products, product features, and other content on this site may vary by model and geographic region.

Engine horsepower and torque information for non-Deere engines are provided by the engine manufacturer for comparison purposes only. Actual operating horsepower and torque will be less. Refer to the engine manufacturer's Web site for additional information.

Copyright © 2015 Deere & Company All Rights Reserved

Hydraulic angle adjustment for hard-to-reach places

Page 1 of 1

Hydraulic angle adjustment for hard-to-reach places

Print



For AF11 Series and AF12 Series Front Blades

The hydraulically controlled angle can be adjusted 30 degrees to each side to overcome the toughest spots. This feature saves time and creates professional-grade results. A loader third-function hydraulic line is required.

NOTE: AF11E models have an optional hydraulic angle adjustment available.

Provide feedback about this page

Last Updated : 25-Jun-2015

[Home](#) | [Feedback](#) | [Help](#) Copyright © 2015 Deere & Company All Rights Reserved

[Privacy & Data](#) | [Legal](#)

Product features are based on published information at the time of publication and are subject to change without notice. All trademarked terms, including John Deere, the leaping deer symbol and the colors green and yellow used herein are the property of Deere & Company, unless otherwise noted. Availability of products, product features, and other content on this site may vary by model and geographic region.

Engine horsepower and torque information for non-Deere engines are provided by the engine manufacturer for comparison purposes only. Actual operating horsepower and torque will be less. Refer to the engine manufacturer's Web site for additional information.

Copyright © 2015 Deere & Company All Rights Reserved

Quick-Tatch™ for quick and easy attachment

Page 1 of 1

Quick-Tatch™ for quick and easy attachment

Print

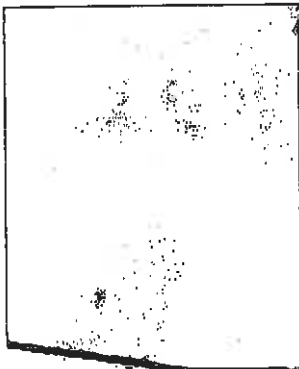

AF11 and AF12 Series view one

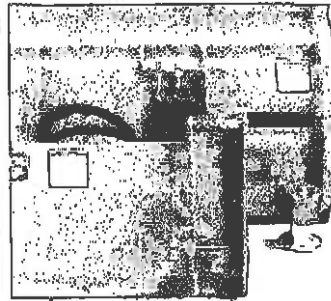

AF11 and AF12 Series view two

Attaching the Frontier AF11 and AF12 Series Front Blades to a John Deere loader is easy with the Quick-Tatch feature. Just line up the loader's connecting points to the attachment frame; then lock the frame in place.

[Provide feedback about this page](#)

Last Updated : 25-Jun-2015

[Home](#) | [Feedback](#) | [Help](#) Copyright © 2015 Deere & Company All Rights Reserved

[Privacy & Data](#) | [Legal](#)

Product features are based on published information at the time of publication and are subject to change without notice. All trademarked terms, including John Deere, the leaping deer symbol and the colors green and yellow used herein are the property of Deere & Company, unless otherwise noted. Availability of products, product features and other content on this site may vary by model and geographic region.

Engine horsepower and torque information for non-Deere engines are provided by the engine manufacturer for comparison purposes only. Actual operating horsepower and torque will be less. Refer to the engine manufacturer's Web site for additional information.

Copyright © 2015 Deere & Company All Rights Reserved

PTO-driven broadcast spreader

PTO-driven broadcast spreader

[Print](#)

Broadcast spreaders are PTO driven

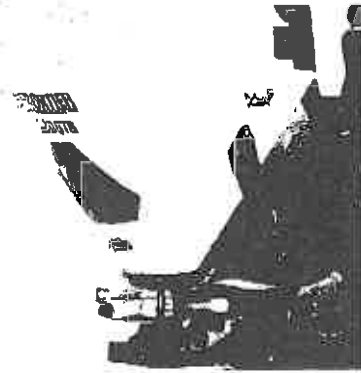

Close-up view

The SS30B Series Broadcast Spreader is power take-off (PTO) driven:

- Compatible with tractors ranging from 20 hp to 60 hp
- Equipped with 540-rpm PTO

[Provide feedback about this page](#)

Last Updated : 25-Jun-2015

Product features are based on published information at the time of publication and are subject to change without notice. All trademarked terms, including John Deere, the leaping deer symbol and the colors green and yellow used herein are the property of Deere & Company, unless otherwise noted. Availability of products, product features, and other content on this site may vary by model and geographic region.

Engine horsepower and torque information for non-Deere engines are provided by the engine manufacturer for comparison purposes only. Actual operating horsepower and torque will be less. Refer to the engine manufacturer's Web site for additional information.

Copyright © 2015 Deere & Company. All Rights Reserved

Hopper-enhanced technology provides long wear life

Page 1 of 1

Hopper-enhanced technology provides long wear life

Print

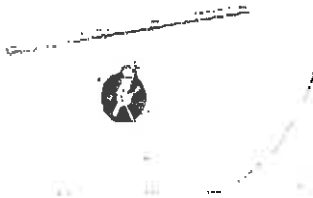

Hopper

Durability is a major component of the SS30B Broadcast Spreader hopper's polyethylene material. The hopper resists moisture and chemicals, allowing longer wear life even under the harshest weather conditions.

The standard fixed agitator and the seamless, conical hopper produces a quick, easy flow.

[Provide feedback about this page](#)

Last Updated : 25-Jun-2015

[Home](#) | [feedback](#) | [Help](#) Copyright © 2015 Deere & Company. All Rights Reserved

[Privacy & Data](#) | [Legal](#)

Product features are based on published information at the time of publication and are subject to change without notice. All trademarked terms, including John Deere, the leaping deer symbol and the colors green and yellow used herein are the property of Deere & Company, unless otherwise noted. Availability of products, product features, and other content on this site may vary by model and geographic region.

Engine horsepower and torque information for non-Deere engines are provided by the engine manufacturer for comparison purposes only. Actual operating horsepower and torque will be less. Refer to the engine manufacturer's Web site for additional information.

Copyright © 2015 Deere & Company. All Rights Reserved

Print Specifications

Page 1 of 1

| | |
|--|--------------------------------------|
| Manufacturer | Frontier |
| MODEL | SS3067B |
| SERIAL NUMBERS | --- |
| Dimension | |
| Hopper width, in. (cm) | 106.7 cm 42 in. |
| Hopper loading height, in. (cm) | 106.7 cm 42 in. |
| Weight | |
| Hopper capacity, lb (kg) | 390 kg 860 lb |
| Machine, lb (kg) | 58 kg 128 lb |
| Shipping (per pair), lb (kg) | 136 kg 300 lb |
| Hopper | |
| Volume capacity, cu. ft. (m ³) | 0.28 m ³ 10 cu ft |
| Material | Polyethylene |
| PTO | |
| rpm | 540 rpm |
| Tractor hp range | 14.9-45 kW 20-60 hp |
| Shaft category | 1 (Heavy-duty shielded 1.375 in.) |
| Range | |
| Swath spread, ft (m) | 15 m 49 ft |
| Mitch | |
| Type | 3-point, Cat., 1 |
| iMatch TM compatible | --- |
| Set-up time | |
| Labor hours | 0.2 hours |
| Warranty | |
| Time period | One year |

Rev. 04/14

State of West Virginia VENDOR PREFERENCE CERTIFICATE

Certification and application* is hereby made for Preference in accordance with **West Virginia Code, §5A-3-37**. (Does not apply to construction contracts). **West Virginia Code, §5A-3-37**, provides an opportunity for qualifying vendors to request (at the time of bid) preference for their residency status. Such preference is an evaluation method only and will be applied only to the cost bid in accordance with the **West Virginia Code**. This certificate for application is to be used to request such preference. The Purchasing Division will make the determination of the Vendor Preference, if applicable.

1. **Application is made for 2.5% vendor preference for the reason checked:**
 Bidder is an individual resident vendor and has resided continuously in West Virginia for four (4) years immediately preceding the date of this certification; or,
 Bidder is a partnership, association or corporation resident vendor and has maintained its headquarters or principal place of business continuously in West Virginia for four (4) years immediately preceding the date of this certification; or 80% of the ownership interest of Bidder is held by another individual, partnership, association or corporation resident vendor who has maintained its headquarters or principal place of business continuously in West Virginia for four (4) years immediately preceding the date of this certification; or,
 Bidder is a nonresident vendor which has an affiliate or subsidiary which employs a minimum of one hundred state residents and which has maintained its headquarters or principal place of business within West Virginia continuously for the four (4) years immediately preceding the date of this certification; or,
2. **Application is made for 2.5% vendor preference for the reason checked:**
 Bidder is a resident vendor who certifies that, during the life of the contract, on average at least 75% of the employees working on the project being bid are residents of West Virginia who have resided in the state continuously for the two years immediately preceding submission of this bid; or,
3. **Application is made for 2.5% vendor preference for the reason checked:**
 Bidder is a nonresident vendor employing a minimum of one hundred state residents or is a nonresident vendor with an affiliate or subsidiary which maintains its headquarters or principal place of business within West Virginia employing a minimum of one hundred state residents who certifies that, during the life of the contract, on average at least 75% of the employees or Bidder's affiliate's or subsidiary's employees are residents of West Virginia who have resided in the state continuously for the two years immediately preceding submission of this bid; or,
4. **Application is made for 5% vendor preference for the reason checked:**
 Bidder meets either the requirement of both subdivisions (1) and (2) or subdivision (1) and (3) as stated above; or,
5. **Application is made for 3.5% vendor preference who is a veteran for the reason checked:**
 Bidder is an individual resident vendor who is a veteran of the United States armed forces, the reserves or the National Guard and has resided in West Virginia continuously for the four years immediately preceding the date on which the bid is submitted; or,
6. **Application is made for 3.5% vendor preference who is a veteran for the reason checked:**
 Bidder is a resident vendor who is a veteran of the United States armed forces, the reserves or the National Guard, if, for purposes of producing or distributing the commodities or completing the project which is the subject of the vendor's bid and continuously over the entire term of the project, on average at least seventy-five percent of the vendor's employees are residents of West Virginia who have resided in the state continuously for the two immediately preceding years.
7. **Application is made for preference as a non-resident small, women- and minority-owned business, in accordance with West Virginia Code §5A-3-59 and West Virginia Code of State Rules.**
 Bidder has been or expects to be approved prior to contract award by the Purchasing Division as a certified small, women- and minority-owned business.

Bidder understands if the Secretary of Revenue determines that a Bidder receiving preference has failed to continue to meet the requirements for such preference, the Secretary may order the Director of Purchasing to: (a) reject the bid; or (b) assess a penalty against such Bidder in an amount not to exceed 5% of the bid amount and that such penalty will be paid to the contracting agency or deducted from any unpaid balance on the contract or purchase order.

By submission of this certificate, Bidder agrees to disclose any reasonably requested information to the Purchasing Division and authorizes the Department of Revenue to disclose to the Director of Purchasing appropriate information verifying that Bidder has paid the required business taxes, provided that such information does not contain the amounts of taxes paid nor any other information deemed by the Tax Commissioner to be confidential.

Under penalty of law for false swearing (West Virginia Code, §61-5-3), Bidder hereby certifies that this certificate is true and accurate in all respects; and that if a contract is issued to Bidder and if anything contained within this certificate changes during the term of the contract, Bidder will notify the Purchasing Division in writing immediately.

Bidder: BRIDGEPORT EQUIPMENT AND TOOL
Date: 8/19/2015

Signed: *Donald A. Gardner*
Title: SALES

RECEIVED TIME AUG. 20. 12:10PM

RFQ No. 0603 ADJ1600000003

STATE OF WEST VIRGINIA
Purchasing Division

PURCHASING AFFIDAVIT

MANDATE: Under W. Va. Code §5A-3-10a, no contract or renewal of any contract may be awarded by the state or any of its political subdivisions to any vendor or prospective vendor when the vendor or prospective vendor or a related party to the vendor or prospective vendor is a debtor and: (1) the debt owed is an amount greater than one thousand dollars in the aggregate; or (2) the debtor is in employer default.

EXCEPTION: The prohibition listed above does not apply where a vendor has contested any tax administered pursuant to chapter eleven of the W. Va. Code, workers' compensation premium, permit fee or environmental fee or assessment and the matter has not become final or where the vendor has entered into a payment plan or agreement and the vendor is not in default of any of the provisions of such plan or agreement.

DEFINITIONS:

"Debt" means any assessment, premium, penalty, fine, tax or other amount of money owed to the state or any of its political subdivisions because of a judgment, fine, permit violation, license assessment, defaulted workers' compensation premium, penalty or other assessment presently delinquent or due and required to be paid to the state or any of its political subdivisions, including any interest or additional penalties accrued thereon.

"Employer default" means having an outstanding balance or liability to the old fund or to the uninsured employers' fund or being in policy default, as defined in W. Va. Code § 23-2c-2, failure to maintain mandatory workers' compensation coverage, or failure to fully meet its obligations as a workers' compensation self-insured employer. An employer is not in employer default if it has entered into a repayment agreement with the Insurance Commissioner and remains in compliance with the obligations under the repayment agreement.

"Related party" means a party, whether an individual, corporation, partnership, association, limited liability company or any other form or business association or other entity whatsoever, related to any vendor by blood, marriage, ownership or contract through which the party has a relationship of ownership or other interest with the vendor so that the party will actually or by effect receive or control a portion of the benefit, profit or other consideration from performance of a vendor contract with the party receiving an amount that meets or exceeds five percent of the total contract amount.

AFFIRMATION: By signing this form, the vendor's authorized signer affirms and acknowledges under penalty of law for false swearing (W. Va. Code §61-5-3) that neither vendor nor any related party owe a debt as defined above and that neither vendor nor any related party are in employer default as defined above, unless the debt or employer default is permitted under the exception above.

WITNESS THE FOLLOWING SIGNATURE:

Vendor's Name: BRIDGEPORT EQUIPMENT AND TOOL

Authorized Signature: *Ronald A. Gardner* Date: 8/19/2015

State of WV

County of Kitchie, to-wit:

Taken, subscribed, and sworn to before me this 19 day of Aug., 2015

My Commission expires March 10, 2019.

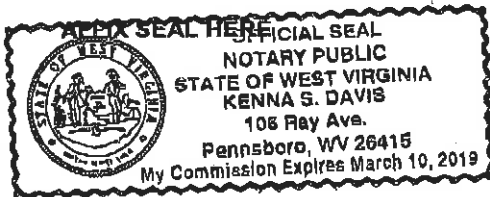

NOTARY PUBLIC *Kenna S. Davis*
Purchasing Affidavit (Revised 07/01/2012)

RECEIVED TIME AUG. 20. 12:10PM