



State of West Virginia
 Department of Administration
 Purchasing Division
 2019 Washington Street East
 Post Office Box 50130
 Charleston, WV 25305-0130

Solicitation

NUMBER
DEFK13010

PAGE
1

ADDRESS CORRESPONDENCE TO ATTENTION OF:
TARA LYLE 304-558-2544

VENDOR

RFQ COPY
 TYPE NAME/ADDRESS HERE
E.T. Boggess, Architect, Inc.
101 Rockledge Avenue
Princeton, WV 24740

SHIP TO

DIV ENGINEERING & FACILITIES
 ARMORY BOARD SECTION
 1707 COONSKIN DRIVE
 CHARLESTON, WV
 25311-1099 304-341-6368

DATE PRINTED
05/01/2013

BID OPENING DATE: 05/30/2013

BID OPENING TIME 01:30PM

LINE	QUANTITY	UOP	CAT NO.	ITEM NUMBER	UNIT PRICE	AMOUNT
0001	1	JB		906-00-00-001		
SION SERVICES EXPRESSION OF INTEREST (EOI) THE WEST VIRGINIA PURCHASING DIVISION, FOR THE AGENCY, DIVISION OF ENGINEERING & FACILITIES, WV ARMY NATIONAL GUARD, IS SOLICITING EXPRESSIONS OF INTEREST FOR PROFESSIONAL DESIGN SERVICES FOR A MEDICAL COMMAND FACILITY, TROOP MEDICAL CLINIC LOCATED IN CHARLESTON, WV, PER THE FOLLOWING BID REQUIREMENTS AND ATTACHED SPECIFICATIONS. ATTACHMENTS INCLUDE: DEFK13010 EXPRESSION OF INTEREST INSTRUCTIONS TO VENDORS SUBMITTING BIDS GENERAL TERMS AND CONDITIONS CERTIFICATION AND SIGNATURE PAGE PURCHASING AFFIDAVIT ***** THIS IS THE END OF RFQ DEFK13010 ***** TOTAL: _____ 05/30/13 10:09:46 AM West Virginia Purchasing Division						

SIGNATURE		TELEPHONE	304-425-4491	DATE	May 29, 2013
TITLE	President	FEIN	55-0515917	ADDRESS CHANGES TO BE NOTED ABOVE	

WHEN RESPONDING TO SOLICITATION, INSERT NAME AND ADDRESS IN SPACE ABOVE LABELED 'VENDOR'



State of West Virginia
 Department of Administration
 Purchasing Division
 2019 Washington Street East
 Post Office Box 50130
 Charleston, WV 25305-0130

Solicitation

NUMBER
DEFK13010

PAGE
1

ADDRESS CORRESPONDENCE TO ATTENTION OF:
 TARA LYLE
 304-558-2544

RFQ COPY
 TYPE NAME/ADDRESS HERE
E.T. Boggess, Architect, Inc.
101 Rockledge Avenue
Princeton, WV 24740

DIV ENGINEERING & FACILITIES
ARMORY BOARD SECTION
 1707 COONSKIN DRIVE
 CHARLESTON, WV
 25311-1099 304-341-6368

DATE PRINTED
 05/22/2013

BID OPENING DATE: 05/30/2013 BID OPENING TIME 1:30PM

LINE	QUANTITY	UOP	CAT. NO.	ITEM NUMBER	UNIT PRICE	AMOUNT
				ADDENDUM NO. 1		
				SEE ATTACHED PAGES -- TO CLARIFY BID OPENING DATE.		
				END OF ADDENDUM NO. 1		
0001	1	JB		906-00-00-001		
				SION SERVICES		
***** THIS IS THE END OF RFQ DEFK13010 ***** TOTAL:						

SIGNATURE *E.T. Boggess* TELEPHONE 304-425-4491 DATE May 29, 2013
 TITLE President FEIN 55-0515917 ADDRESS CHANGES TO BE NOTED ABOVE

WHEN RESPONDING TO SOLICITATION, INSERT NAME AND ADDRESS IN SPACE ABOVE LABELED 'VENDOR'



Tara Lyle
Purchasing Division
2019 Washington Street, East
PO Box 50130
Charleston, WV 25305-0130

May 29, 2013

Re: RFQ # DEFK13010 - West Virginia National Guard

Dear Ms Lyle:

In response to your qualifications request for the professional Architectural and Engineering Design services, E. T. Boggess, Architect, Inc. (ETB) is pleased to submit information regarding our experience and expertise. Our team is comprised of highly qualified firms versed in Architectural Design Services including Planning and Programming and Mechanical/Electrical/Plumbing Engineering.

I will be your architect and will be responsible for all aspects of the project. ETB will also be coordinating the activities of our MEP consultant, CMA Engineering. Our team is familiar with your project, your area, and your needs. As the project progresses, we will identify any additional consultants who may be required, specifically structural. We understand and appreciate the challenges that this project entails and believe we offer the service, knowledge and experience you will need to successfully accomplish this worthwhile project for the WVARNG.

The ETB Team stresses a focus on client issues and mutually defined project objectives. Through this focus, we can assure your agency that needs and project issues will be clearly identified and addressed through an engaged, interactive programming, design, and construction process. Our design process will be conducted with an attention to detail, creative problem solving and passion towards project success. We value this opportunity to serve you and look forward to personally presenting our credentials.

Sincerely,

A handwritten signature in black ink, appearing to read 'Todd Boggess', is written over a light gray background.

Todd Boggess, AIA, NCARB, Architect
President

TABLE of CONTENTS

Cover letter

**1 - Qualifications &
Technical Expertise**

2 - Firm Profiles

3 - Project Information

4 - Approach

5 - Resumes

6 - WV Purchasing Affidavit & Forms

SECTION ONE

Qualifications & Technical Expertise

Qualifications & Technical Expertise

E.T. Boggess, Architect, Inc.

MEDCOM Facility

The E.T. Boggess, Architect, Inc., team understands the challenges facing the WVARNG as you work to renovate an existing facility in order to serve as the Troop Medical Clinic and Medical Command Center. Addressing the needs of our service men and women is a responsibility that we owe to them - they deserve easy access to medical services. ETB has a great deal of experience with government facilities, both new and renovations, as well as medical and health related centers. We understand the unique requirements associated with the delivery of medical services having provided professional services for the following types of facilities:

- ✓ Dental offices
- ✓ Doctor's offices
- ✓ Medical Clinics
- ✓ Health Centers
- ✓ Rehabilitation Centers
- ✓ Health & Fitness Centers
- ✓ Primary Care Hospital Planning & Renovation

The Mercer County Health Center we designed is currently under construction and we are designing the Summers County Health Center which will be approximately 5,000 sf. We also recently re-designed a 10,300 sf commercial building to satisfy the needs of the Welch Family Health Care Center.



Mercer Health Center, Green Valley, WV

Our team includes CMA Engineering, a well-respected MEP consultant whose main office is located in Charleston. CMA has worked with us on numerous projects throughout the state for governmental and health care clients. Their experience and understanding of the local area, as well as our excellent relationship with them, will be vital to the success of this project.

Our team includes professionals who understand the WVARNG, its needs, its services, and its dedication. We have a history of successful projects and our involvement with a variety of governmental and healthcare projects uniquely qualifies us for this project. We would welcome the opportunity to assist the WVARNG and your efforts to improve the lives of your members.

Philosophy

Communication, collaboration, and consensus are the three elements we feel are essential to the planning, design and building process. The architect is responsible for the finished product, but the design process must include guidance and review by you and representatives from the various agencies. Our goal is to develop a "*partnership*" with our clients - a relationship that includes a long-term commitment, trust, and shared vision.

ETB believes architectural design should be an *interactive process*. We work closely with you to identify and define all your project goals, objectives, functions, responsibilities, and relationships. This interactive approach enables us to re-design facilities that meet your requirements, as well as being aesthetically distinctive. A renovation design must be developed from scratch with the unique attributes of each individual project in mind. Our approach is not about us and our ideas . . . it is about *you and your ideas*. We strive to help you realize your dreams.

Qualifications & Technical Expertise

E.T. Boggess, Architect, Inc.

Methods

The Integrated Design Process is our process of design in which the users, owners, and the ETB team (architects and engineers) and project participants are all integral team members. This integrated process and the implementation of high performance design requires both efficiency and innovation. Active participation of users, code officials, cost consultants, civil, mechanical, and electrical engineers, and representatives from the appropriate agencies.

In our role with this team as the design leader and project organizer, ETB will be responsible for coordinating and orchestrating the work of the many disciplines and users involved throughout the design, documentation, and administrative functions of the project. Utilizing the interactive design approach will best serve the needs of the WVARNG by allowing us to better identify your objectives and produce long-term solutions. Your project will be completed by emphasizing the following activities:

- **Understanding goals.** We develop objectives, organization and explore the impact this project can have on the guard.
- **Brainstorming ideas.** We investigate opportunities for greater service through value engineering, strategic partnering, or alternative delivery methods.
- **Assuring timelines.** We generate a management plan to fulfill deliverables and meet milestones on schedule.
- **Maintaining client contact.** We are accessible, convenient, and committed to success from the beginning through the design process, and after completion.

- **Inviting performance feedback.** We involve all team members and clients in project evaluation at closeout and determine how well time, cost, and design goals were met.

Project Management - Our project managers provide extraordinary leadership managing the team dynamics, budget, schedule, and the flow of information. The project manager's role also includes assisting the client with the management of services and consultants that may not be a part of this contract, but still may have an impact on workflow and infrastructure coordination.

The effective implementation of your goals and objectives will be realized thru early and consistent collaboration among all the design disciplines. This will result in opportunities and challenges being discussed and addressed as we proceed thru the design process.

Cost Management - We believe that the management of cost and/or risk begins with the development of fully vetted alternatives which enable you to make informed choices about the proposed renovations. We search for simple and effective solutions which support the different services you will be offering. The existing building and quality of existing space will provide a positive base to build upon.

We also believe that the evaluation of cost must extend beyond the cost of renovations, and consider the costs of operations, human resources, energy and sustainability. Design alternatives must be evaluated and consider the cost of operations as well as the cost of construction.

Qualifications & Technical Expertise

E.T. Boggess, Architect, Inc.

Project Schedule Management - Completing projects on time requires effective schedule management and a commitment of the entire project team including the Council on Aging and the design team. The process begins with the development of the project schedule with input from each stakeholder engaged in the process. Accelerated schedules require even more dedication to benchmarks and deadlines, identifying production problems early and making the necessary adjustments before issues become too great to be effectively managed.

Contract Administration - The services we provide during construction is yet another way of ensuring you receive the quality you desire. We review shop drawings and product submittals and conduct site visits on a regular basis. We want to ensure the construction is in compliance with the design intent. While we seek to control the quality of construction, we are always open to new ideas and products that will have a positive effect on the project, its longevity and how well it functions.

Technical Expertise - Information Management

As mentioned previously, project coordination is ETB's responsibility. A very effective tool we utilize in this process is a standard format dedicated website. The website, created in-house, is a key communication component for sharing all types of project information. The owner has immediate access to everything from design plans, imagery, and construction documents to submittals, submittal logs, field reports, and meeting minutes. The following pages outline the information that can be included and gives an example of a current website.

Qualifications & Technical Expertise

E.T. Boggess, Architect, Inc.

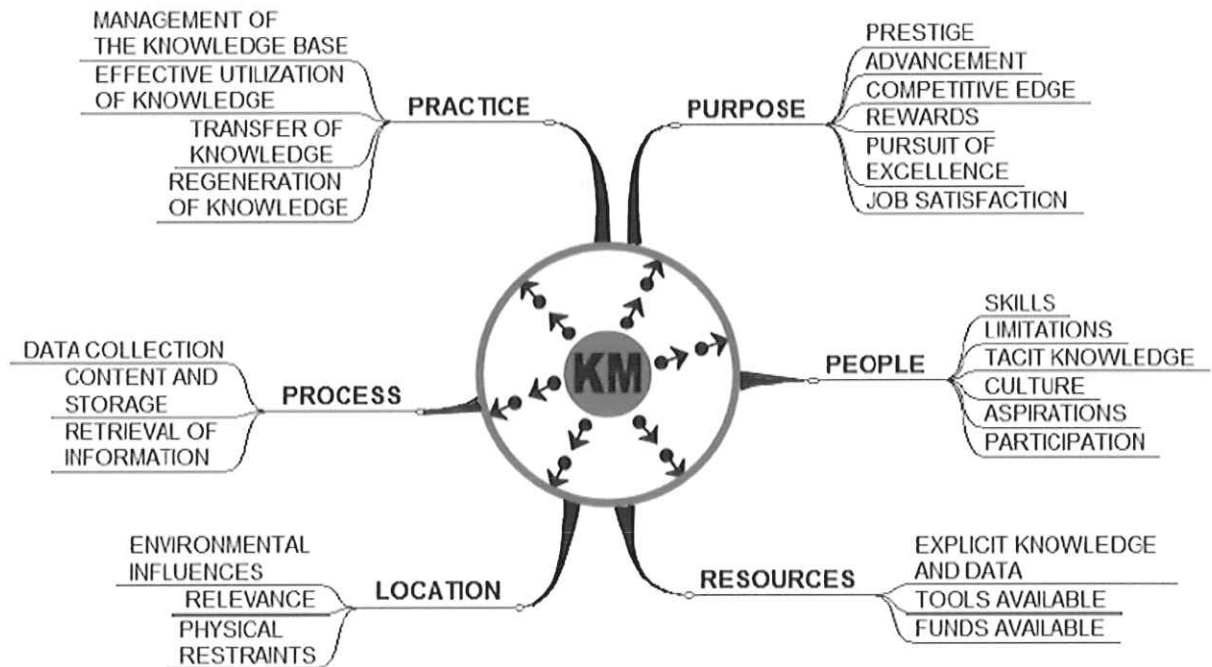

CRITICAL ELEMENTS OF KNOWLEDGE MANAGEMENT

Source: 'A Model for Knowledge Management' by Roy Morum

PROPOSED PROJECT WEBSITE

As a service to the client and for the sake of efficiency, ETB creates an online (secured and password protected) website for each project which functions as a project management tool. The site gives the project team direct access to project information and we consider that effective Knowledge Management is the key to the success of the project. This method has proved most successful on our projects - keeping the client and the team members well informed and insuring that the latest information is always readily available.

We maintain the site after the project is complete and this can provide the client with a valuable resource for ongoing Facilities Management.

The site has the following main information areas which may be expanded or adapted to meet the particular needs of the project:

Qualifications & Technical Expertise

E.T. Boggess, Architect, Inc.

Home Page

General information such as project description site location and site information.

Navigation Map

An outline of the Site Navigation structure.

Administration

All the latest administration documentation will be kept here, such as:

- Site Minutes
- Status Reports
- Field Inspection Reports
- Change Orders

Documents-Drawings

This is the working area of the Web-Site and will include an interface for Transfer of documents via FTP. The sections include:

- Drawings Index & Revisions. (The latest revisions are always shown on this index.
- Specifications & Keynotes.
- LEED Documentation,
- Drawings.(In CAD and PDF format)

Graphics

The Graphics page will provide an interface to view to Concept Models etc.

- Concept Graphics.
- Site Images.
- Job Camera
- Rendered Images.

Project Schedule

The latest version of the following will be kept here:

- Project Schedule
- Project Milestones
- Project Meetings/ Calendar
- Current Site Weather conditions

Qualifications & Technical Expertise

E.T. Boggess, Architect, Inc.

Communication

This page provides all the latest contact details of the parties involved in this Project. The sub-sections include:

- Contact List
- Communications
- Discussion Group
- E-mail interface

Help Documents

This page provides assistance on any issue related to the Project and the Web-Site. Software required for the use of this site (such as drawing viewers) can also be downloaded here.

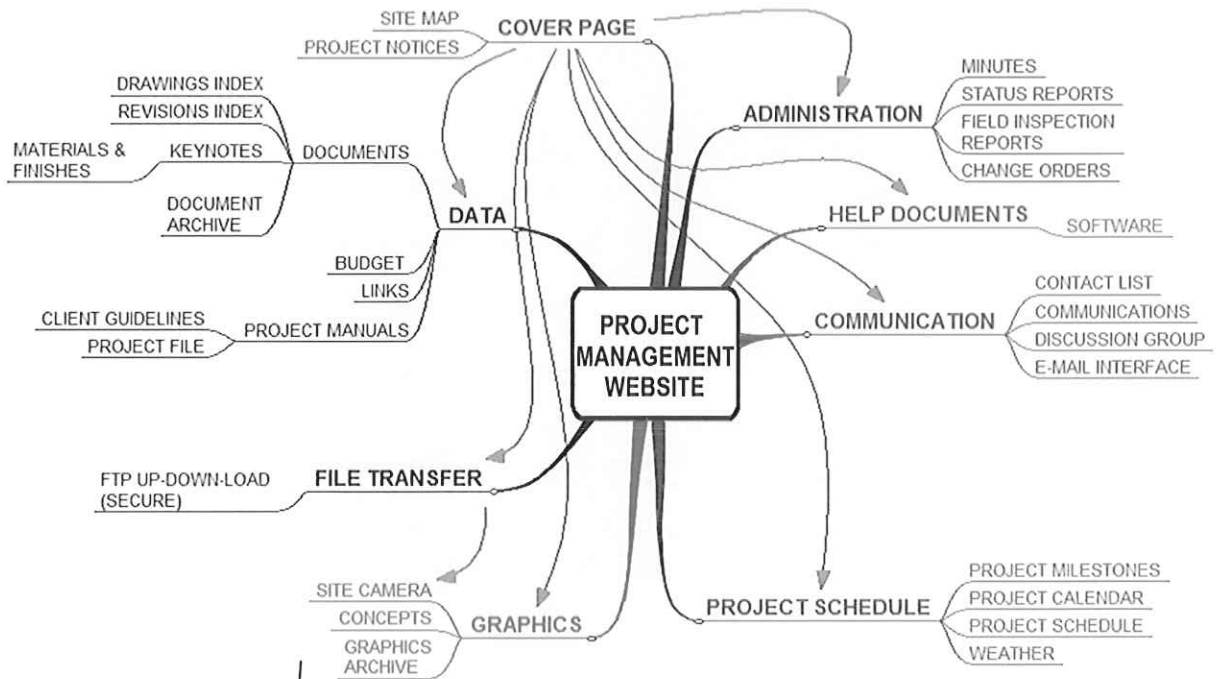

WEBSITE MAP - As developed and managed by ETB architects

Qualifications & Technical Expertise

E.T. Boggess, Architect, Inc.

E. T. BOGCESS ARCHITECT INC
200 West 121st Building Ave. Princeton WV 24740-0707
25.334.432 FAX 254.432.2028
<http://www.etbarchitect.com>

West Virginia Army National Guard / U. S. Army Reserve
ARMED FORCES RESERVE CENTER (AFRC)
Randolph County, Elkins, West Virginia

PROJECT ADMINISTRATION
MANAGEMENT HOME PAGE

WORKING PROJECT WEBSITE FOR CONSTRUCTION PHASE. AUTHORIZED ACCESS ONLY ALLOWED

DISCLAIMER: This website is maintained for convenience, and ease of communication only. No indication, communication, or other document contained herein will be considered valid in terms of the contract. All data & information must be verified against the contents of the original authorized document. Information contained herein will not relieve the contractor of the responsibility for maintaining proper documentation and administration in other duty within the contractual obligations.

[CONTACTS](#) | [CONSTR ADMIN](#) | [KEYNOTES](#) | [DWG INDEX](#) | [DWG FILES](#) | [PROCEDURES & DATA](#)

PROJECT NOTICES	PROJECT DESCRIPTION
<p>Preliminary bid dates proposed Elkins AFRC - Utility Extension Contract</p> <p>ADVERTISEMENT PRE-BID MEETING ACCESSION #1 LAST DAY FOR QUESTIONS ACCESSION #2 BID OPENING REVISED DATES TO BE SUBMITTED</p> <p>See Fire Marshall Reports</p> <p>MEETINGS Meetings are generally to be held every two weeks on Thursdays at 10am.</p> <p>Conference Call Information: Road-Access Number: 8005032099 7-Digit Access Code: 7836660</p>	<p>The Elkins Armed Forces Reserve Center (AFRC) consists of the primary facility, military equipment parking (MPE), and privately owned vehicle (POV) parking. The primary facility will be housed in an 84,200 square-foot, single-story building with a skill hall.</p> <p>The site is located approximately 8 miles west of Elkins, West Virginia and borders on U.S. Route 33 (Condon Rd), a four-lane highway with limited access control. A near to-face access road will be required up the hill to the usable area of the property.</p> <p>The site is approximately 112 acres and site occupies a hill in a large band of the Tygart Valley River, with a large, mostly sloping hillside and moderately steep - to steep slopes down to the river. Approximately 50 of the 112 acres are wooded with another 22 acres of undeveloped strip mine covered by pine trees and grasses. The site drains directly into the Tygart Valley River. A drainage channel will be required to convey the stormwater from the proposed facility down the steep hillside to the river. Email: land@etb.com</p> <p>MEETING SCHEDULE - 2010 (Thursdays) 06-23-2010 / 06-17-2010 07-01-2010 / 07-15-2010 / 07-20-2010 08-10-2010 / 08-28-2010 08-28-2010 / 09-23-2010 10-27-2010 / 10-21-2010 11-04-2010 / 11-18-2010 12-02-2010 / 12-16-2010 / 12-30-2010</p> <p>MEETING SCHEDULE - 2011 (Thursdays) TBD</p>
<p>CONSTRUCTION ADMINISTRATION Click on this heading to go to the Construction Administration page. This area is for the management and storage of Contract Documentation and the coordination of Drawings, RFIs etc.</p>	<p>PROCEDURES & DATA Click on this heading to go to this page - to document project data and specific procedures established as the project progresses</p> <p>CONTACTS Click on this heading to go to Contact names and addresses of the Client / Consultant / Contractor project team.</p>
<p>DRAWING INDEX Click on this heading to go to a list of all current drawings issued</p>	<p>DRAWING FILES PDFs and CAD files may be downloaded here. PROJECT KEYNOTE TAGS keynote tags are as referenced on the drawings. This schedule includes color references for materials - all for final verification by submittal.</p>
<p>WEBSITE MAP SEE CONSTRUCTION ADMINISTRATION PAGE</p>	<p>POWERED BY Google Maps</p> <p>View Larger Map</p>
<p>ETP SITE ACCESS</p> <p>Click here to contact Web Administrator for access details.</p>	

[CONTACTS](#) | [CONSTR ADMIN](#) | [KEYNOTES](#) | [DWG INDEX](#) | [DWG FILES](#) | [PROCEDURES & DATA](#)

Elkins, WV
Scattered Clouds
Humidity 55%
Visibility 6 miles
Wind Cam

54°F
Updated 11:05 AM
USA for WEBCAST

RULES OF COPYRIGHT APPLY STRICTLY TO THE FULL CONTENT OF THIS WEB SITE
[Contact Webmaster](#) | [Email Feedback](#)

[CONTACTS](#) | [CONSTR ADMIN](#) | [KEYNOTES](#) | [DWG INDEX](#) | [DWG FILES](#) | [PROCEDURES & DATA](#)

E. T. BOGCESS ARCHITECT INC
200 West 121st Building Ave. Princeton WV 24740-0707
25.334.432 FAX 254.432.2028
<http://www.etbarchitect.com>

West Virginia Army National Guard / U. S. Army Reserve
ARMED FORCES RESERVE CENTER (AFRC)
Randolph County, Elkins, West Virginia

PROJECT ADMINISTRATION
MANAGEMENT HOME PAGE

WORKING PROJECT WEBSITE FOR CONSTRUCTION PHASE. AUTHORIZED ACCESS ONLY ALLOWED

DISCLAIMER: This website is maintained for convenience, and ease of communication only. No indication, communication, or other document contained herein will be considered valid in terms of the contract. All data & information must be verified against the contents of the original authorized document. Information contained herein will not relieve the contractor of the responsibility for maintaining proper documentation and administration in other duty within the contractual obligations.

[CONTACTS](#) | [CONSTR ADMIN](#) | [KEYNOTES](#) | [DWG INDEX](#) | [DWG FILES](#) | [PROCEDURES & DATA](#)

GROUP	CHECK	COMMENT
INFO	A-DATA	GENERAL INFORMATION
	<input type="checkbox"/> A-GENERAL POSTS APPROVAL <input type="checkbox"/> AIF-Forms <input type="checkbox"/> AIF-Code Books One-Click <input type="checkbox"/> CHANGE/REVISIONAL FORMS ARE AVAILABLE TO THE AIR-Force USER WITH THE FILED WILL BE CHARGED TO THE CONTRACTOR'S ACCOUNT	
	<input type="checkbox"/> A-ADMINISTRATIVE CHECKS <input type="checkbox"/> A-ADMINISTRATIVE CONTRACTS <input type="checkbox"/> A-ADMINISTRATIVE SUBMITTALS	
	<input type="checkbox"/> AIF-EDIT HOLD THE APPROVAL FOR CONTRACTOR'S CHECKS (BASED ON THE CONTRACTOR'S)	
P&C	<input type="checkbox"/> P&C-BIDDING <input type="checkbox"/> P&C-BIDDING CHECKS <input type="checkbox"/> P&C-BIDDING CHECKS <input type="checkbox"/> P&C-BIDDING CHECKS <input type="checkbox"/> P&C-BIDDING CHECKS	P&C-BIDDING CHECKS (BASED ON THE CONTRACTOR'S)
	<input type="checkbox"/> P&C-BIDDING CHECKS <input type="checkbox"/> P&C-BIDDING CHECKS <input type="checkbox"/> P&C-BIDDING CHECKS <input type="checkbox"/> P&C-BIDDING CHECKS	
	<input type="checkbox"/> P&C-BIDDING CHECKS <input type="checkbox"/> P&C-BIDDING CHECKS <input type="checkbox"/> P&C-BIDDING CHECKS <input type="checkbox"/> P&C-BIDDING CHECKS	
INFO	BASINS	RESOURCES/FILES
	<input type="checkbox"/> B-GENERAL INFORMATION <input type="checkbox"/> B-GENERAL INFORMATION	
INFO	CONSTR ADMIN	RECORDS OF CONSTRUCTION ADMINISTRATION DOCUMENTATION OFFICE
	<input type="checkbox"/> C1-GENERAL CONSTRUCTION CHECKS <input type="checkbox"/> C2-Asst-Comp-Plan <input type="checkbox"/> C3-Asst-Plan-Permit <input type="checkbox"/> C4-Comp-Cont <input type="checkbox"/> C5-Comp-Cont <input type="checkbox"/> C6-Comp-Cont <input type="checkbox"/> C7-Comp-Cont <input type="checkbox"/> C8-Comp-Cont <input type="checkbox"/> C9-Comp-Cont	
	<input type="checkbox"/> C10-CONTRACTOR <input type="checkbox"/> C11-Comp-Appr <input type="checkbox"/> C12-Comp-Submittal <input type="checkbox"/> C13-Submittal <input type="checkbox"/> C14-Submittal <input type="checkbox"/> C15-Submittal	
	<input type="checkbox"/> C16-CONTRACTOR <input type="checkbox"/> C17-Comp-Appr <input type="checkbox"/> C18-Comp-Submittal <input type="checkbox"/> C19-Submittal <input type="checkbox"/> C20-Submittal	
	<input type="checkbox"/> C21-CONTRACTOR <input type="checkbox"/> C22-Comp-Appr <input type="checkbox"/> C23-Comp-Submittal <input type="checkbox"/> C24-Submittal <input type="checkbox"/> C25-Submittal	
	<input type="checkbox"/> C26-CONTRACTOR <input type="checkbox"/> C27-Comp-Appr <input type="checkbox"/> C28-Comp-Submittal <input type="checkbox"/> C29-Submittal <input type="checkbox"/> C30-Submittal	
	<input type="checkbox"/> C31-CONTRACTOR <input type="checkbox"/> C32-Comp-Appr <input type="checkbox"/> C33-Comp-Submittal <input type="checkbox"/> C34-Submittal <input type="checkbox"/> C35-Submittal	
	<input type="checkbox"/> C36-CONTRACTOR <input type="checkbox"/> C37-Comp-Appr <input type="checkbox"/> C38-Comp-Submittal <input type="checkbox"/> C39-Submittal <input type="checkbox"/> C40-Submittal	
	<input type="checkbox"/> C41-CONTRACTOR <input type="checkbox"/> C42-Comp-Appr <input type="checkbox"/> C43-Comp-Submittal <input type="checkbox"/> C44-Submittal <input type="checkbox"/> C45-Submittal	
	<input type="checkbox"/> C46-CONTRACTOR <input type="checkbox"/> C47-Comp-Appr <input type="checkbox"/> C48-Comp-Submittal <input type="checkbox"/> C49-Submittal <input type="checkbox"/> C50-Submittal	

[CONTACTS](#) | [CONSTR ADMIN](#) | [KEYNOTES](#) | [DWG INDEX](#) | [DWG FILES](#) | [PROCEDURES & DATA](#)

TYPICAL PROJECT WEBSITE -by ETB architects



SECTION TWO

Firm Profiles

Firm Profile

E.T. Boggess, Architect, Inc.

History

E. T. Boggess, Architect, Inc., is a 14 person architectural firm located in Princeton, West Virginia. Our firm was established in 1966 by Ted Boggess and has been successful because of a team approach and partnership-type attitude with all involved in the design and construction process. Having grown up in the practice and with a life-long love of architecture, Todd became a full time presence with the firm in 1988 after receiving a Masters in Architecture from Clemson University. Their unique relationship as father/son/mentor/ apprentice and, now, partners is both exciting and rewarding as the practice continues to flourish and evolve.

Location

Our firm's location in southern West Virginia is in close proximity to Charleston. Although the majority of our current projects are located in WV, we have satisfied clients from Michigan to Florida. ETB has a reputation for quality service to our clients regardless of the project site, scale, or scope. The location of our firm and knowledge of our state, people, construction materials and contractors, as well as its regional climatological characteristics, are all important considerations for the success of your project.

During the administration phase, our proximity to the project site will allow us to observe the work in a very efficient and cost effective manner. This will help minimize problems and allow for timely solutions whenever our presence is required. We are currently providing construction administration services in Charleston for the Advantage Valley ATC project at the Dow Technology Park, as well as the District 1 Office Building for the DOH in downtown Charleston.

Reputation

Our firm lives or dies by its reputation. We work for "Pride in Product" and are confirmed by the amount of repeat business we can truthfully claim.

The architects at ETB are well-respected for their high ethical standards, as well as professional and civic activities. They are frequently asked to serve as expert witnesses and arbitrators in legal disputes. They have also been selected to serve on various local, state and national committees. These committees cover areas from determining local zoning ordinances to reviewing and developing educational requirements for future architects, to preserving West Virginia's historic architecture.

Attitude

Bigger is not always better. ETB has purposely controlled size in order to maintain personal involvement and quality control. We feel that it is important to maintain close client contact and availability to respond to your needs and address any situations that may arise. Your project will not get lost in the shuffle.

We are, however, of sufficient size and capabilities to accommodate the needs of your project, as well as ensuring the successful completion of our current workload. The depth of our personnel is such that we can assign individuals to the appropriate task during each phase to ensure all your project's needs are satisfied.

Firm Profile

E.T. Boggess, Architect, Inc.

Experience

Over the past 47 years, ETB has accomplished many different types of buildings in 12 different states and 1 foreign country. We have not limited ourselves by focusing on one particular type of project or a single location. Instead, we choose to maintain a diverse practice which allows us to begin each project with renewed enthusiasm. Our strength is in the delivery of appropriate and analytical solutions for complex buildings and doing so within restricted budgets and time constraints.

Almost 30 years ago, ETB was one of the first architectural firms in the state to implement the use of computer-aided design and drafting into the everyday practice of architecture. Our firm also has experience with Revit and we have been looking at new opportunities associated with BIM. Today we continue to lead the industry as we utilize photorealistic imagery through computer modeling and digital photography. The building 3-D model and associated imagery can be developed early in the design process for your presentations. The vast opportunities associated with virtual reality allow us to provide you with a "tour" of your finished building long before the foundation has been laid.

We are also utilizing a dedicated ftp website for many of our recent projects. A variety of information can be shared on the website and available for immediate review. The WVARNG will benefit from our experience, combined with ongoing technological research and innovations.

Projects

ETB has been very fortunate over the past ten years to be involved with various state and local government agencies on projects of varying scope and budgets. The majority of our work during the past decade has been public-use projects, with only about 25% representing financial institutions, residential, religious, recreational, and health & fitness for private organizations.

The scope of our work for the state has included office spaces, maintenance/garage facilities, multi-purpose areas, classrooms, conference space, distance learning, laboratories, workshops, judicial courtrooms, and conference rooms. Specifically, we have provided new designs for the following state agencies:

- WV Army National Guard
 - Elkins Readiness Center
- WV DOT/Dept. of Highways
 - District Ten HQ Complex
 - District Six HQ Complex
 - District Nine Office Building
 - District One Office Building
- WV Higher Education Policy Commission
 - Planning & Programming for \$108 mil bond for the Community & Technical College System
- WV Community and Technical College System
 - Advantage Valley Advanced Technology Center
 - North Central Advanced Technology Center
 - New River C&TC Raleigh County Headquarters
 - Allied Health Building

Firm Profile

E.T. Boggess, Architect, Inc.

- WV School Building Authority
 - PikeView Middle School
 - Panther/laeger Elementary School
 - Greenbrier West High School Addition
 - Oakvale Elementary Addition
- WV Supreme Court of Appeals
 - Mercer County Courthouse Annex

Additional work for local governmental agencies during the past ten years includes:

- Mercer County Commission
 - Mercer County Courthouse Annex
 - Mercer County Health Center
 - Mercer County Courthouse (Energy Improvements)
 - Mercer County War Memorial Building Renovations
 - Mercer County 911 Center Programming for new facility (also designed the original building)
- City of Princeton
 - City Hall (Adaptive Reuse)
 - Railroad Museum
 - Library (Adaptive Reuse)
 - East Mercer Streetscape
- City of Bluefield
 - Streetscape
 - Chicory Square
- Concord University
 - Rahall Technology Center

ETB has also worked with the GSA on several projects including Social Security Offices for Welch and Williamson and renovations to accommodate the needs of the IRS in Downtown Beckley.

Many of our projects, especially in recent years, have involved state-of-the-art technology and security/communication systems, as well as focusing on energy efficient, sustainable designs.

Section 3 contains more information regarding some of these projects, along with project information provided by our team members.



Princeton Public Library - Adaptive Reuse of Historic former USPO

C O R P O R A T E P R O F I L E



Clingenpeel/McBrayer & Associates, Inc.

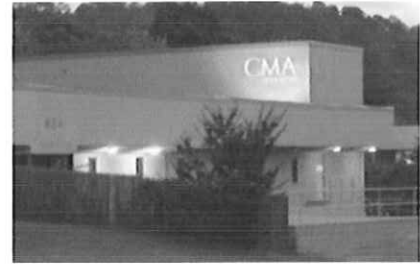

Services

CMA Engineering is a West Virginia based small business firm, providing services in the areas of HVAC, plumbing, fire protection and electrical engineering. CMA's founders have long believed in the philosophy that a successful project requires a comprehensive approach. This includes all traditional facets of project planning, starting with master planning, working closely with the client, developing the completed construction documents, bidding the project and contract administration. However, our depth of expertise goes far beyond the traditional services, From developing design criteria for owners to designing the mechanical and electrical systems for the West Virginia DEP Consolidated Office Building, the first LEED certified building in the state, CMA is a proven leader in providing engineering services in the design-build delivery method. As we have been involved in LEED Certification and other "LEED-Oriented" ventures for several years, we attempt to incorporate the most efficient and sustainable "green" designs in all of our projects.

History

Since 1986, CMA Engineering has provided services on numerous projects of varying size and complexity. Clients include architects, industrial companies, governmental agencies, contractors, engineers, developers and private organizations. With offices strategically located in Charleston and Morgantown, our professional staff can provide clients with exceptional hands-on engineering services and construction administration without effecting the project's budget.

Commitment

CMA Engineering's submittal is based on your needs and our experience. Our firm has the experience, service and quality work to create a successful project. We are committing senior design professionals in order to assure you receive top priority. We have extensive experience with projects of this nature. Examples of projects for which we were the Engineer are listed in this proposal.

In 1987, computer aided drafting stations were added to provide the best quality and engineering services for our clients. We are currently operating AutoCad 2011. Our firm is constantly monitoring the latest technology, the cost effects and the end results to the final project.

Present staffing allows CMA to complete work in a timely manner without limiting our ability to perform our on-going work. The staff of CMA Engineering is large enough to handle any size project, yet small enough for direct input and supervision by key personnel.



Clingenpeel/McBrayer & Associates, Inc.

Daniel L. Ellars, P.E.

Timothy L. Cox, P.E.

824 Cross Lanes Drive

5 Riddle Court

Charleston, WV 25313

Morgantown, WV 26505

(304) 343-0316 tel

(304) 598-2558 tel

(304) 343-5146 fax

(304) 598-2472 fax

Professional Affiliations



Leadership in Energy &
Environmental Design



U.S. Green Building
Council



American Society of
Heating, Refrigerating and
Air Conditioning Engineers,



American Institute of
Architects— WV Chapter
Affiliate Member



National Fire
Protection Association

ASPE

American Society Of
Plumbing Engineers



MasterSpec
Specifications



The
LIGHTING
AUTHORITY

Illuminating
Engineering Society



WV Society of
Healthcare Engineers



International Code Council (ICC)



Business Partner

CMA
ENGINEERING

SECTION THREE

Project Information

Project Information

E.T. Boggess, Architect, Inc.

Project	Type	Goals	Size	Cost	Comp.
WVARNG Readiness Center Location: Elkins Project Manager for the WVARNG: Dan Clevenger - 304-561-6451	New	Provide offices, classrooms, kitchens, showers for local armed forces to train & prepare. Serve as base of operations in emergency.	56,000 sf	\$15.5 mil	2012
WVDOH District 9 Office Building Location: Lewisburg Project Manager for the WVDOH: Greg Hylton - 304-647-7450	New	Provide centralized office and meeting room for DOH district operations.	28,000 sf	\$3.5 mil	2011
WVDOH District 1 Office Building Location: Charleston Project Manager for the WVDOH: Brian Tackman - 304-356-3820	New	Provide centralized office and meeting room for DOH district operations.			Under Con.
Advantage Valley Advanced Tech Center Location: So. Charleston	New	Three educational facilities with similar objectives - address needs of WV C&TCS program. Provide classrooms, labs, offices, and high-tech learning environment for secondary education programs that can be modified easily to satisfy market/demand.	50,000 sf	\$15 mil	Under Con.
North Central Adv Tech Center/Allied Health Location: Fairmont	New		60,000 sf	\$17.4 mil	Bid - 2012
New River Headquarters & Allied Health Location: Beckley Project Manager - Chancellor of the WVC&TCS James Skidmore - 304-558-0265	New		72,500 sf	\$15 mil	Under Con.
Greenbrier West High School Addition Location: Charmco	Add.	Provide new gym, auditorium, upgrade systems.	150,000 sf	\$20 mil	2012
Lewisburg Elementary School Location: Lewisburg	New	Provide new classrooms, kitchen, offices and gym for elementary students.	76,000 sf	\$12 mil	2012
Rainelle Elementary School Location: Rainelle Proj Mgr: Dave McClure - 304-647-6460	New	Provide new classrooms, kitchen, offices and gym for elementary students.	50,000 sf	\$9 mil	2012



WV Army National Guard Readiness Center

ETB designed and provided construction administration services for the 50,000 sf, single-story facility to serve the Elkins units of the Army Reserve and National Guard.



The Readiness Center has two main entrances; the front into the lobby and the rear into the assembly hall. The circular central core of the entrance leads to the administrative wing (east) and classroom wing (west). The facility also contains a learning center, library, storage areas, locker rooms, kitchen, break-room, and Telcon spaces. Areas within the lobby will be used for recruiting, family support and distance learning.



The project included the design and construction of a separate structure for secure storage & maintenance/workshop/office structure.



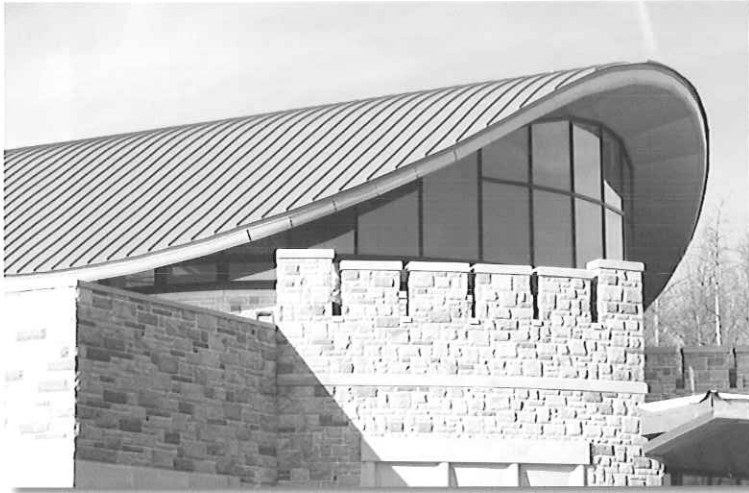

WV Army National Guard Readiness Center



Secure Storage and
Maintenance Building





Merger County Health Center and Report

The 2007 Health Facility Building Viability Report that was used to obtain the funding needed for a new facility was prepared by ETB.



ETB idesigned the new 18,000 SF facility which is currently under construction on the same site as the previous health center.

The new facility will be more energy efficient and provide the health services needed by the residents of Mercer County.

Areas include the following . . .

- Clinics
- Exam Rooms
- Labs
- Pharmacy
- Offices
- Storage
- Community Room

E.T. Boggess, Architect, Inc.



Mercer County Health Center and Report

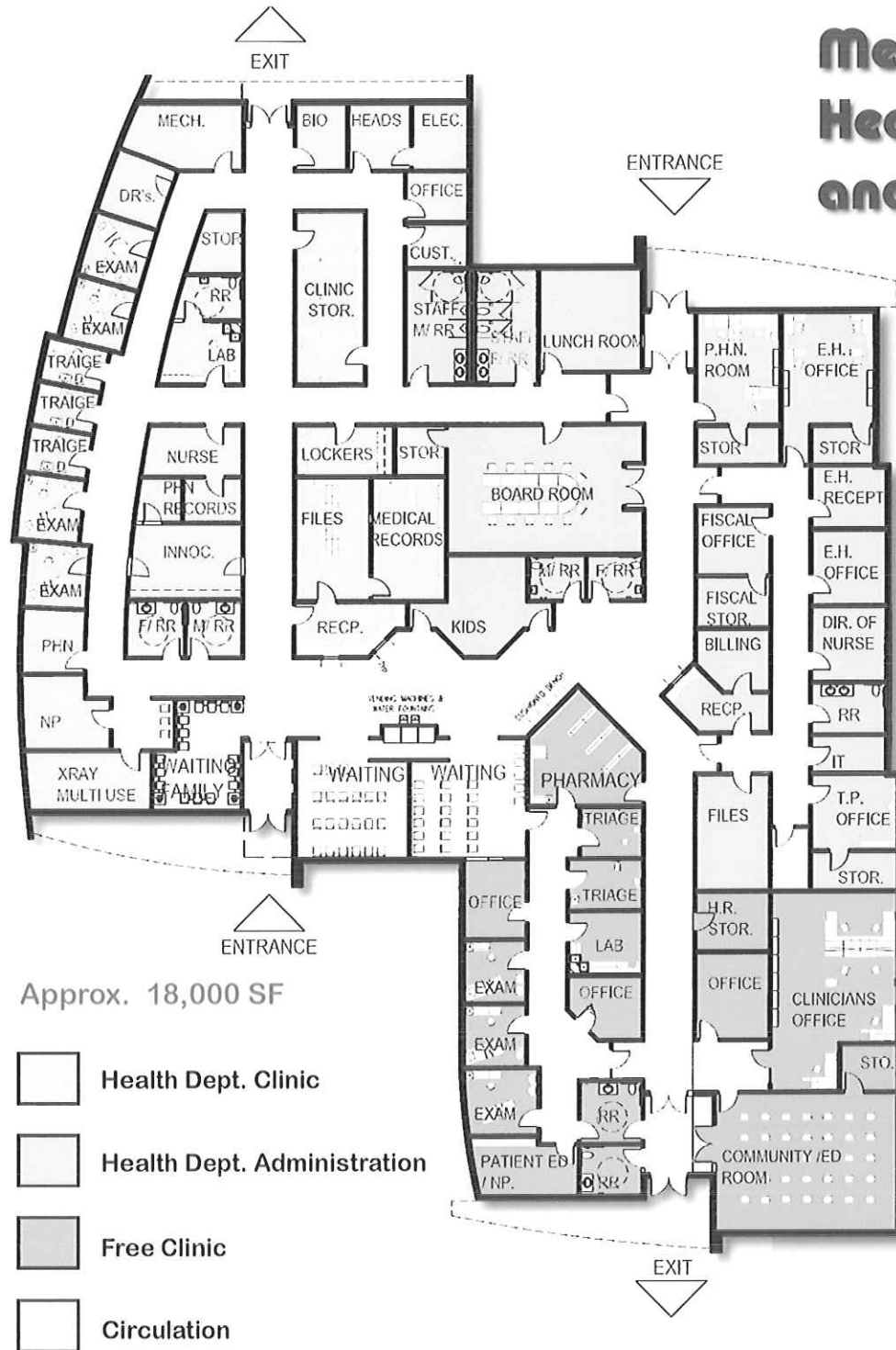

ETB prepared the Health Facility Building Viability Report in 2007. The report showed multiple conditions/issues that needed to be addressed thru a comprehensive renovation or demo and construction of a new building. The report was then used to obtain the funding needed for a new facility which ETB is also currently designing.

A new 18,000 sf facility will be built on the site after the existing structure is demoed. The Health Department Offices/Services have been relocated during this process.

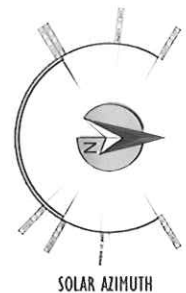



New River C&TC Headquarters & Allied Health

Raleigh County

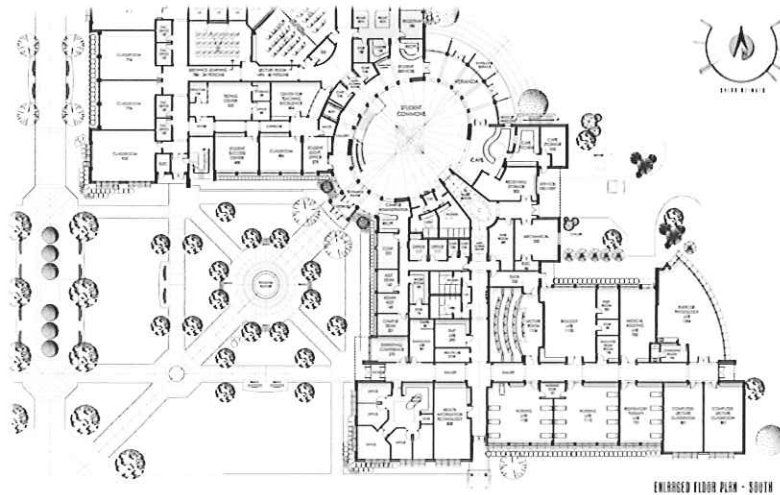

The ETB team worked with both New River C&TC and the CTCS of WV to design a new building that will accommodate both of their needs. One side of the building will be the Beckley Headquarters for New River and the other side will serve the Allied Health programs for the CTCS of WV.

Construction on this project began in spring 2013.



E.T. Boggess, Architect, Inc.



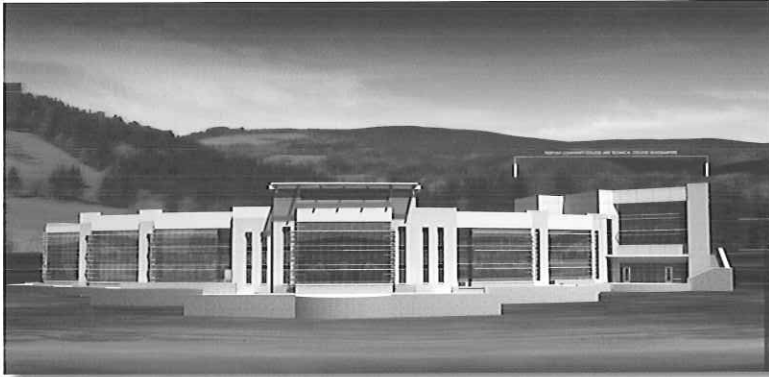

Advanced Technology Center

North Central



The design of the North Central ATC is almost complete. The project includes an Allied Health program, multiple specialty labs, classrooms and offices. The building will be located in the WV High Technology Park off I-79 in Marion County.



E.T. Boggess, Architect, Inc.





Advanced Technology Center

Advantage Valley

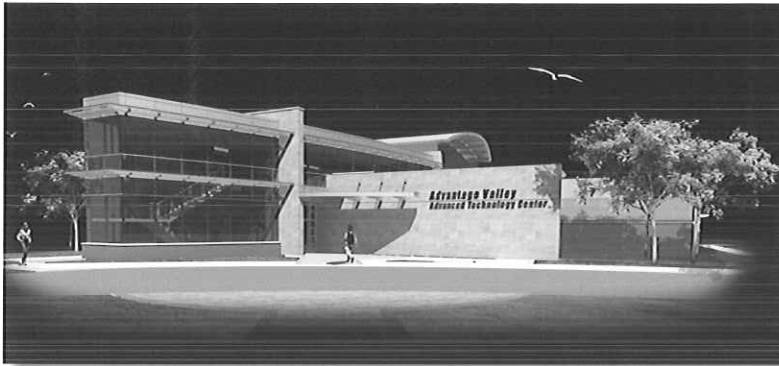

The ETB team designed this new Advanced Technology Center for the C&TCS of WV. The imagery shown here represents the Advantage Valley ATC that is currently under construction in Kanawha County. Multiple specialty lab uses, systems and equipment are all part of these unique projects.

Projected cost for this ATC is \$15 mil.

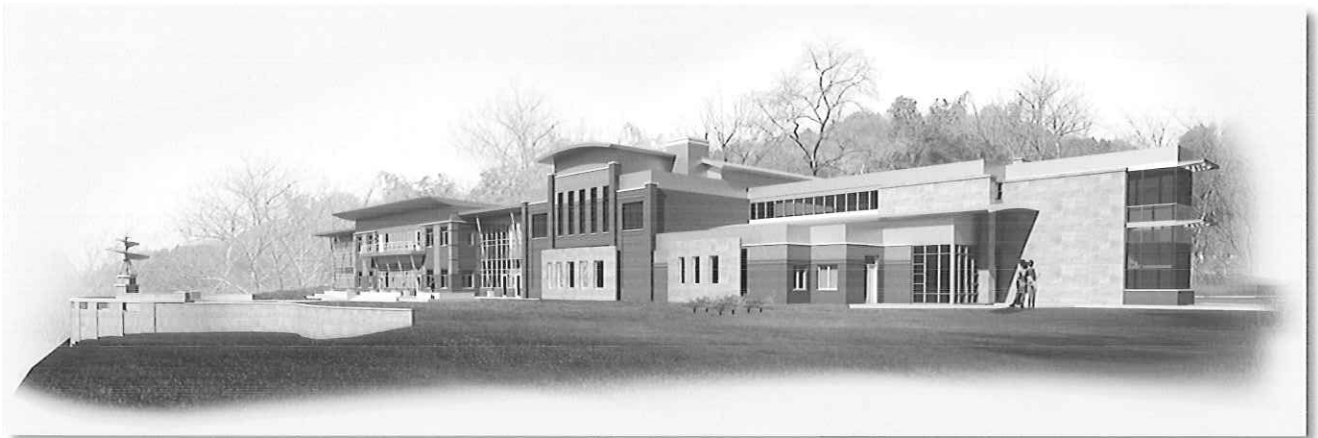

E.T. Boggess, Architect, Inc.



Projects

E.T. Boggess, Architect Inc.

GOVERNMENTAL - New:

- WV Army National Guard Readiness Center, Elkins, WV
- Mercer County Courthouse Annex, Princeton, WV
- Mercer County Health Center, Green Valley, WV
- WV Tourist Information Center, Princeton, WV
- WVDOH District 10 HQ Complex Gardner, WV
 - Office Building
 - Maintenance Building
 - Bridge/Sign Shop
 - Lab Building
- WVDOH District 6 HQ Complex, Moundsville, WV
 - Office Building
 - Maintenance Building
 - Bridge/Sign Shop
 - Lab Building
- WVDOH District 9 Office Building, Lewisburg, WV
- WVDOH District 1 Office Building, Charleston, WV
- Mercer County EOS/911 Emergency Response Center, Green Valley, WV
- Mercer County Civil Air Patrol Hanger and Headquarters, Bluefield, WV
- U.S. Social Security Offices for the GSA
 - Welch, WV
 - Williamson, WV
- Princeton Railroad Museum (*Historical Re-creation*)
- Bramwell Coal Interpretive Museum (*Historical Re-creation*)

GOVERNMENTAL - Renovations:

- Princeton Public Library, (*Adaptive Re-use*), Princeton, WV
- Pipestem State Park Conference Center (*Renovations + Addition*), Pipestem, WV
- Greenbrier County Convention and Visitors Center, Lewisburg, WV
- Princeton City Hall (*Adaptive Re-use*), Princeton, WV
- Mercer County Courthouse Energy Improvements, Princeton, WV
- U.S. Social Security Offices for the GSA, Bluefield, WV
- Mercer County War Memorial Building, Princeton, WV
- Summers County Health Center, Hinton, WV
- Department of Health & Human Resources, Welch, WV
- Division of Motor Vehicles, Welch, WV
- Welch City Hall/Library (*Renovations & Floodproofing*), Welch, WV
- Nicholas County Judicial Annex, Summersville, WV
- Beckley Financial Center - IRS Offices for the GSA (*Adaptive Re-use*), Beckley, WV
- Hatfield/McCoy Regional Recreational Authority Offices, Lyburn, WV

Projects

E.T. Boggess, Architect Inc.

HOSPITALS - CLINICS - OFFICES

New Construction:

- Mercer County Health Center, Green Valley, WV
- Schwartz Dental Offices, Bluefield, WV
- Westwood Doctor's Offices (multiple), Bluefield, VA
- Schwartz Dental Offices, Bluefield, WV
- Doctor's Office, Princeton, WV
- Summers County Health Center (current), Hinton, WV
- Total Life Family Practice Clinic, Princeton, WV
- Princeton Radiation Oncology Center, Princeton, WV
- Quail Valley Medical Center, Princeton, WV
- County Health Centers for the Southern WV Regional Health Council
 - Fayette County
 - Monroe County
 - Raleigh County
 - Hinton, WV
 - Pineville, WV
- Grundy Health Center for the Tri-District Community Health County, Grundy, VA

Renovations & Additions:

- HealthSouth's Southern Hills Rehabilitation Hospital, Princeton, WV
- HealthSouth's Southern Hills Outpatient Center, Mercer Mall, Bluefield, WV

- Princeton Community Hospital - Phase 1 & 2 Renovations (current), Princeton, WV
- Family Health Care (current), Welch, WV
- Orthopedic Center of the Virginias (current), Princeton, WV
- Dermatology Clinics of SW Virginia, Bluefield, VA
- Total Life Family Practice Clinic, Princeton, WV (1996 Addition)
- Medical Arts Building, Princeton, WV
- Quantum Medical Services, Bluefield, WV
- Mercer Medical Group Building, Princeton, WV
- Bluestone Medical Clinic, Matoaka, WV

Projects designed/not built:

- Mountain Haven Spa & Bluefield Women's Center, Bluefield, WV (*construction documents*)
- Princeton Community Hospital Behavioral Medicine Center, Princeton, WV (*construction documents*)
- Rural Acute Care Hospital (*schematic design*)
- Check-Ups Kiosks for malls, various locations (*schematic design*)

Design of mechanical, electrical, plumbing, fire protection and communication systems, including emergency power generators.



WVANG Elkins Readiness Center

CMA Engineering provided design of HVAC, plumbing, fire sprinkler and fire alarm systems, and electrical systems for new 54,500sf readiness center. All systems were designed utilizing LEED criteria.



Moorefield Readiness Center

CMA Engineering is currently providing mechanical, electrical and plumbing design services for the new 57,100sf readiness center which will include a 911 Center, a distance learning center and classrooms. MEP systems are being designed to obtain LEED Silver Certification .



Gassaway Armory

CMA Engineering provided mechanical, electrical and plumbing, design services for the renovation of 24,170sf of a single story structure including a 10,900sf drill hall and the addition of a new 4,810sf single story facility to house lockers, storage space, a lobby, corridors and office space.



St. Albans Armory

CMA Engineering provided mechanical, electrical and plumbing design services for the renovation of 16,407sf of a single story facility and a single story addition of 13,940sf composed primarily of office space, storage space, a lobby and corridors.

Project Profiles

WVANG

Design of mechanical, electrical, plumbing, fire protection and communication systems, including emergency power generators.



WVANG Eleanor Maintenance Center

CMA Engineering provided mechanical, electrical and plumbing design services for a 132,000sf maintenance facility to house combined support maintenance shop and Class IX USPFO warehouse. CMA has continued to provide engineering services for the addition of the paint booth, entrance guard house, MCOFT pad, and covered storage.



WVANG Eleanor Readiness Center

CMA Engineering provided engineering services for the design of mechanical, electrical and plumbing systems for the new 80,000sf readiness center, including a 16,000sf section that is utilized by the United States Navy.



WVANG Summersville Readiness Center

CMA Engineering provided engineering services for the design of mechanical, electrical and plumbing systems for the 42,000sf readiness center. This facility also features areas for use by the City of Summersville for events



WVANG Lewisburg Readiness Center

CMA Engineering provided mechanical, electrical and plumbing design services for a 37,000sf readiness center that includes a vehicle maintenance bay.

Project Profiles

New Construction 911 Centers

Design of mechanical, electrical, plumbing, fire protection and communication systems.



New Randolph County 911 Center

CMA provided design services for HVAC, plumbing, fire alarm, fire sprinkler, electrical and communications systems for the new 12,000sf facility.

New Putnam County 911 Center

CMA is currently providing design services for the HVAC, plumbing, fire alarm, fire sprinkler, electrical and communications systems for the new single story 911 Facility(11,700sf) and new two story maintenance garage(5,000sf) with six maintenance bays on lower level and storage area (1,500sf) on second level.



New Raleigh County 911 Center

CMA provided design services for HVAC, plumbing, fire sprinkler/alarm systems, data and communication and electrical power for the new Emergency Operation Center in Raleigh County.

New Wetzel County 911 Center

CMA is currently providing design services for the HVAC, plumbing, fire alarm, fire sprinkler, electrical and communications systems for the new 3,100sf facility.



Harrison County 911 Center

CMA Engineering provided mechanical, electrical, plumbing, fire alarm, fire sprinkler and communication systems design services.

Project Profiles

New Construction Emergency Response Facilities

Design of mechanical, electrical, plumbing, fire protection and communication systems



Orchard Manor Fire Station, Charleston, WV
CMA Engineering provided design of HVAC, plumbing, fire sprinkler and fire alarm, electrical and communications systems and site utilities for new 9,000sf fire station .



Northview Fire Station, Clarksburg, WV
CMA Engineering provided design of HVAC, plumbing, fire sprinkler and fire alarm systems, communication systems, lighting and electrical power for renovations to 7,000sf existing office facility and new connected garage facility of 7,300sf.



White Sulfur Springs Fire Station
CMA Engineering provided design of HVAC, plumbing, fire sprinkler and fire alarm systems, communication systems, lighting and electrical power for new 7,800sf facility.

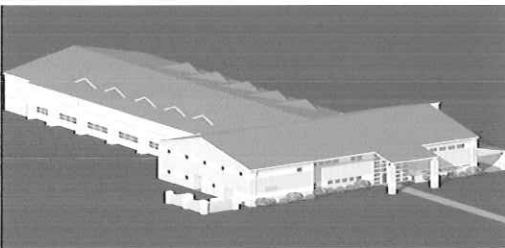

WVANG-Fire Station
CMA Engineering is provided design services for the HVAC, plumbing, fire alarm, fire sprinkler, communications systems, lighting and electrical power for the design/build of the new approximately 21,000sf fire/crash/ rescue station in Charleston, WV.

SECTION FOUR

Approach

Approach

E.T. Boggess, Architect, Inc.

Typically, ETB renovation projects involve 4 phases:

- Investigation, evaluation and report preparation for existing roof systems and structure.
- Preparation of Preliminary Design Documentation and Preliminary Estimate of Probable Construction Costs.
- Preparation of Construction Documents and Final Estimate of Probable Construction Costs.
- Bidding and Construction Administration Services.

Investigation and Evaluation Phase:

- Upon receipt of Notice to Proceed, ETB will review all available original plans, specifications and other relevant data documenting existing systems and structures.
- Interview WVARNG staff to gain an understanding of how services are currently being provided and how to improve function and work-flow.
- Perform an on-site, non-destructive, visual inspection and survey of all systems and record/document any deviations from the existing as-built plans.
- Perform test cuts where necessary to determine existing roof system as-built assembly/thickness and subsurface conditions. Submit test cuts for lab testing where presence of asbestos or other hazardous material is suspected.

- Perform engineering analysis to establish roof system design criteria including structural loading/uplift capacities, fire resistance ratings, thermal resistance ratings, drainage capacities and other relevant data.
- Prepare narrative summary evaluation of each system's compatibility/conformance with applicable codes and standards for repair or replacement.
- Meet with WVARNG staff to review system summary evaluations. Discuss systems and product options, including installation, performance/compliance alternatives. Establish project schedule milestones for Design & Construction phases.

Preliminary Design Phase:

- Prepare preliminary design drawings including plans and typical sections and details.
- Prepare Outline Specifications and Preliminary Estimate of Probable Construction Cost.
- Meet with WVARNG staff to review preliminary design drawings, proposed scope of work, proposed system product selections and alternatives, and Preliminary Estimate of Probable Construction Cost. Review/establish budget and contingency for each facility and establish Final Construction Phase Schedule (bidding and award) for project.

Approach

E.T. Boggess, Architect, Inc.

Construction Document Phase:

- Prepare Construction Documents including detailed drawings and specifications commensurate with established scope of work.
 - Prepare Final Estimate of Probable Construction Costs.
 - Assist WVARNG staff with coordination/preparation of non-technical provisions of the contract documents. (Bid Advertisement, safety/security compliance, temporary facilities, utility access, etc.)
 - Meet with WVARNG staff as necessary to review progress, discuss proposed design and budget refinements, value engineering proposals and other general coordination issues. (est.2-3 meetings)
 - Assist WVARNG staff with review, selection and pre-approval of Contractors.
- Review/response to RFI and construction change order requests
 - Regular on-site Construction observation and reporting
 - Assistance/coordination with governmental/regulatory agencies
 - Preparation of project punch list and sign-off
 - Review of project close-out documents/ compliance

Bidding and Construction Phase:

ETB will provide general administrative assistance to WVARNG staff and the Contractor(s) during the Bidding and Construction Phases including:

- Reproduction and distribution of Construction Documents
- Attendance at pre-bid meeting
- Preparation of addenda
- Review of bids
- Review of contractor submittals

SECTION FIVE

Resumes

Todd Boggess, AIA, NCARB, Architect

President

E.T. Boggess, Architect Inc.



EDUCATION:

- Master of Architecture, Clemson University School of Architecture
- International Studies, Clemson University Daniel Center for Urban Design & Building Studies, Genoa, Italy
- Bachelor of Arts Degree in Design, Clemson University School of Architecture

RESPONSIBILITIES:

Todd joined ETB as a project architect and office manager in 1988 after graduating from Clemson University. In January, 2001, he assumed the office of President.

Todd is responsible for . . .

- architectural design and development
- project management and coordination
- computer aided design and visualization
- interior design
- site planning

Your project will receive his complete attention, from the interview and project meetings, through the construction process.

As the president of the firm, you are putting your trust in him and he takes that commitment very seriously. He wants to make sure you are satisfied with our service, performance, and design.

PROJECTS:

Todd's design for the WVARNG Readiness Center in Elkins included the main 50,000 sf single-story facility to serve the Army Reserve and National Guard, along with a separate structure for secure storage, maintenance/workshop and office space. The needs of the WVARNG were reflected in the design, which includes the following areas:

- assembly hall
- lobby
- administrative wing
- classroom wing
- learning center
- library
- storage areas
- locker rooms
- kitchen/break-room
- Telecon spaces



WVARNG Readiness Center - Elkins

PROJECTS – Public Buildings:

- WVARNG Readiness Center, Elkins, WV
- Mercer County Courthouse Annex, Princeton, WV
- WVDOH District 10 Headquarters Complex
 - Office Building*
 - Maintenance Building*
 - Bridge/Sign Shop*
 - Lab Building*
- WVDOH District 6 Headquarters Complex
 - Office Building*
 - Maintenance Building*
 - Bridge/Sign Shop*
- WVDOH District 9 Headquarters Complex
 - Office Building*
 - (under construction)*
- Rahall Technology Center at Concord University, Athens, WV
- Advantage Valley Advanced Technology Center for the WV Council for the Community & Technical College System
- North Central Advanced Technology Center and Allied Health Building for the WV Council for the Community & Technical College System
- Allied Health Building, Beckley, WV for the WV Council for the Community & Technical College System
- New River Community & Technical College – Beckley Headquarters Building, Beckley, WV
- Mercer County Health Center, Green Valley, WV

PROJECTS – Public Renovations:

- Princeton Public Library, Princeton, WV
- Princeton Municipal Building, Princeton, WV
- Greenbrier County Convention and Visitors Center, Lewisburg, WV
- U.S. Social Security Offices for the GSA, Bluefield, WV
- Pipestem State Park Conference Center Addition, Pipestem, WV
- New River Community and Technical College Renovations for Fine Arts Building, Lewisburg, WV
- Dermatology Clinic of SW Virginia, Bluefield, VA
- Family Healthcare Center, Welch, WV

AWARDS:

- WVAIA “Honor Award” for Renovation Design of the Princeton Public Library – April 2012
- Princeton/Mercer County Chamber of Commerce “Excel Award” – January, 2011
- *West Virginia Executive Magazine’s* “Young Guns” – Fall, 2003
- Princeton/Mercer County Chamber of Commerce “Citizen of the Year – 2000”
- Princeton Elks Club “Citizen of the Year – 2000”

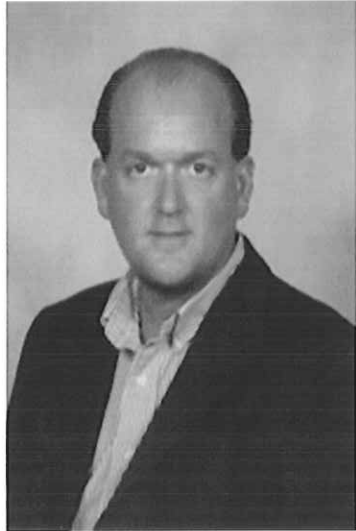

EDUCATION:

Bachelor of Science Design
Clemson University

Master of Architecture
Clemson University

RESPONSIBILITIES:

With over 26 years of experience in all phases of design and construction, Mr. Mackey brings strong design, management and leadership skills to the firm. His significant experience has enabled him to successfully oversee the design and construction of a number of large government projects. Specific project responsibilities include:

- code review and analysis
- program development
- master plan development
- conceptual design
- design visualization
- project management
- project coordination
- construction specifications

PROJECTS:

Mr. Mackey rejoined ETB Architects in 2009 after serving as Executive Vice President for two Florida Architectural firms. During his absence, Mr. Mackey served as project manager on several large school projects in the state of Florida. In addition to his design and project management responsibilities, Mr Mackey also directed the day to day operations and management of the firm.

PROJECTS - Educational:

- Advantage Valley Advanced Technology Center for the WV C&TCS, Kanawha County, WV
- North Central Advanced Technology Center for the WV C&TCS and Allied Health, Fairmont, WV
- New River Community and Technical College Headquarters and Allied Health Building, Beckley, WV
- Mercer County Health Center, Green Valley, WV
- Greenbrier County Schools
 - Greenbrier West High (*Renovations*)
 - Lewisburg Elementary (*New*)
 - Rainelle Elementary (*New*)



Advantage Valley ATC, South Charleston

Roy Morum, LEED G. A. Project Manager

E.T. Boggess, Architect, Inc.



EDUCATION:

Bachelor of Architecture
University of the Orange Free
State, South Africa

Master of Design Management
UNITEC
Auckland, New Zealand

RESPONSIBILITIES:

Roy joined ETB in 2004 as a project architect. His area of expertise is in design, documentation, and information management. He will be responsible for the ftp site that we will create to share project information. Before joining ETB, Roy completed major works in South Africa and New Zealand. His work in the USA includes government facilities for the West Virginia Army National Guard and other public buildings.

Roy's Master's Dissertation, "*A Model for Knowledge Management in an Architectural Enterprise*" deals with effective communication and creative project / information / data management.

He has developed processes and skills in this field that contribute much to the successful outcome of a project – and the continued facilities maintenance of a building.

Roy is responsible for . . .

- planning/programming
- construction documentation
- coordination of other disciplines
- ftp site design and implementation
- information management
- responding to contractor's requests for information
- reviewing submittals and shop drawings
- site visits/construction administration
- overall project management

PROJECTS:

Roy's expertise in project management and communication is reflected in his use of technology to enhance the delivery process via the internet and FTP. His mastery of information management systems will ensure that team members, contractors, and your representatives will be able to share ideas efficiently and cost effectively.

PROJECTS – Public Buildings:

- WVARNG Readiness Center, Elkins, WV
- The Summit Bechtel Reserve Boy Scout Shower Houses, Fayette County, WV
- Four Seasons YMCA, Tazewell, VA
- Chuck Mathena Center, Princeton, WV

Nathan S. Turner, LEED Green Associate

Project Manager

E.T. Boggess, Architect, Inc.



EDUCATION:

Bachelor of Science, Eng. - Arch.
Fairmont State University

Master of Architecture (May, 2009)
Boston Architectural College

RESPONSIBILITIES:

Mr. Turner joined ETB in 2009 and brought with him a wealth of experience in architectural design, as well as construction methods and practices. His prior experience with educational facilities has already proven extremely valuable as we have several elementary, middle, and high school projects at various stages of completion. Nathan obtained LEED certification last year and will assist in our efforts to provide a "green" approach to as many projects as possible.

Specific project responsibilities include:

- architectural programming
- construction documentation
- design visualization
- project management

- project coordination
- construction specifications
- construction administration

PROJECTS - Public Buildings:

- Advantage Valley Advanced Technology Center for the WV C&TCS, Kanawha County, WV
- North Central Advanced Technology Center for the WV C&TCS and Allied Health, Fairmont, WV
- New River Community and Technical College Headquarters & Allied Health Building, Beckley, WV
- WV Council for Community and Technical College Education - Facility Programming
- Oakvale Elementary School Addition for Mercer County
- Rainelle Elementary School for Greenbrier County
- Lewisburg Elementary School for Greenbrier County
- PikeView Middle School for Mercer County



New River C&TC HQ/Allied Health, Beckley, WV

Chris Canterbury, Associate AIA

Construction Admin. Manager

E.T. Boggess, Architect, Inc.



EDUCATION:

Bachelor of Science Engineering
Technology/Architecture
Fairmont State University

RESPONSIBILITIES:

Chris joined ETB in 2000 as a CADD Technician. His focus in recent years has been project administration and his current position of Construction Administration Manager reflects that area of expertise. Your project will benefit from his superb organizational skills. He attends meetings and keeps track of your needs and wishes through notes and minutes. His timely response to submittals will ensure that your project stays on its construction schedule.

Chris is responsible for . . .

- construction documentation
- organizing and attending meetings
- distribution of minutes and progress reports
- contacting material suppliers
- responding to contractor's requests for information

- reviewing submittals and shop drawings
- construction administration
- site visits/observations

PROJECTS - Public Buildings:

During the construction of the Mercer County Courthouse Annex, Chris monitored the budget very closely. He distributed updated amounts at the monthly meetings with the building commission and was instrumental in keeping the project under-budget.

- Mercer County Courthouse Annex, Princeton, WV
- Mercer County Health Center, Green Valley, WV
- WVDOH District 9 Office Building, Lewisburg, WV
- WVDOH District 1 Office Building, Charleston, WV
- Princeton Public Library (Adaptive Re-use), Princeton, WV
- Princeton City Hall (Adaptive Re-use), Princeton, WV
- Greenbrier County Schools
 - Greenbrier West High (*Renovations*)
 - Lewisburg Elementary (*New*)
 - Rainelle Elementary (*New*)



Merger County Health Center

P R O F I L E

Timothy Cox, P.E.,
NCEES.

President

Mechanical Engineer

(304) 598-2558

tcox@cmawv.com

EDUCATION

University of Colorado
Boulder, Colorado
Degree: Mechanical Engineering B.S.

REGISTRATIONS/PROFESSIONAL AFFILIATIONS

Association of Energy Engineers-CBCP

Registered Professional Engineer in WV, VA, MD, KY

CPD (Certified in Plumbing Engineering)

Member of ASHRAE

American Society of Plumbing Engineers

National Association of Fire Protection Engineers

WV Society of Healthcare Engineers

EXPERIENCE

Mr. Timothy Cox, President and Senior Mechanical Engineer of CMA Engineering brings 26 years of mechanical design experience to our clients. Mr. Cox has been project manager and project engineer for a variety of

PROJECTS

West Virginia University-Open End Contract since 1999
Mountain Lair Plaza Renovations
Boreman HVAC/Plumbing/Fire Sprinkler Upgrades
Soccer Stadium
Coliseum Life/Safety Renovations
Coliseum Locker Room Suites
Engineering Science Building Addition/Renovations
Arnold Hall Fire Alarm/ Fire Sprinkler Upgrades
Wrestling Training Facility

WVU Health Sciences Center

Electrical and Mechanical Utility Extensions for
BioMedical Research Facility

West Virginia University Hospitals

WV Eye Institute-MEP systems design for new
facility
Cheat Clinic-MEP design for new clinical addition
WVUH Emergency Department-HVAC, electrical,
fire and communication systems design for new
addition
Chestnut Ridge Hospital-various MEP renovations
Healthworks Rehab and Fitness -MEP systems
design for new facility

Mylan Pharmaceuticals, Morgantown, WV

Various projects including HVAC, plumbing, fire
Sprinkler and controls for new office building, fluid
bed addition, north plant expansion, parking garage
and weighing and packaging.

CMA
ENGINEERING

Clingenpeel/McBrayer & Associates, Inc.

824 Cross Lanes Drive

Charleston, West Virginia 25313

(304) 343-0316 tel

(304) 343-5146 fax

5 Riddle Court

Morgantown, West Virginia

(304) 598-2558 tel

(304) 598-2472

P R O F I L E

Daniel Lee Ellars, P.E.
LEED AP

NCEES

Principal

(304) 343-0316

dellars@cmawv.com

EDUCATION

West Virginia University Institute of Technology
Montgomery, West Virginia.
Bachelors of Science in Electrical Engineering

West Virginia State University
Institute, West Virginia
Bachelors of Science in Business Administration

REGISTRATIONS/PROFESSIONAL AFFILIATIONS

Registered Professional Engineer in West Virginia

National Fire Protection Association (NFPA)

Institute of Electrical and Electronics Engineers (IEEE)

American Society of Heating, Refrigerating and Air-Conditioning
Engineers (ASHRAE)

EXPERIENCE

Mr. Daniel L. Ellars, Electrical Engineer for Clingenpeel/McBrayer & Associates, Inc. brings 21 years of electrical design experience to our clients. Mr. Ellars has been a project manager and project engineer for a variety of projects including commercial and industrial facilities as well as for both power and tele-communications utilities.

PROJECTS

Military Experience

West Virginia Army National Guard
Elkins Readiness Center—Electrical systems design for new facility
Eleanor (WV) Maintenance Center—Electrical systems design for new facility
Moorefield Readiness Center—Electrical systems for new facility
Gassaway Armory—Electrical design for renovations
St. Albans Armory—Electrical design for renovations to existing facility and new addition

Hospital Experience

West Virginia University / Ruby Memorial Hospitals
West Virginia Eye Institute—Electrical systems design for new facility.
Thomas Memorial Hospital—Electrical systems survey, upgrades and documentation. Standby emergency power engine/generator replacement.

Correctional Experience

St. Mary's Correctional Center—Multiple emergency power engine/generator systems with combined control and monitoring.

Industrial Experience

Mylan Pharmaceuticals
Mylan Office & Lab Buildings—various electrical systems designs for new, existing and expanded facilities including new 23kV/12kV switchyard and grounding plain layout.



Clingenpeel/McBrayer & Associates, Inc.

824 Cross Lanes Drive
Charleston, West Virginia 25313
(304) 343-0316 tel
(304) 343-5146 fax

5 Riddle Court
Morgantown, West Virginia .
(304) 598-2558 tel
(304) 598-2472

P R O F I L E

James A. Kerns

Mechanical/Electrical Designer

(304) 343-0316

jkerns@cmawv.com

EDUCATION

West Virginia State College
Institute, West Virginia
Degree: Bachelor of Science in Industrial Technology/
Building Construction

REGISTRATIONS/PROFESSIONAL AFFILIATIONS

Member of ASHRAE

EXPERIENCE

Mr. James A. Kerns has over 33 years experience in Mechanical and Electrical engineering design. He has been responsible for design projects in the educational, commercial, and health care fields.

Mr. Kerns has been a great asset to Clingenpeel/McBrayer & Associates. His knowledge and experience enables him to complete project designs in a clear and concise manner and in a timely fashion.

PROJECTS

Kanawha County Schools

George Washington High School-HVAC Renovations
George Washington High School-Classroom Additions
Horace Mann Middle School-HVAC Renovations
Elkview Middle School-Classroom Additions
Elkview Middle School-Fire Alarm System
Ruffner Elementary School-Classroom Additions
Point Harmony Elementary School-Activity Building

Concord College

Athens, West Virginia — various renovation projects throughout the campus, which include Twin Towers Fire Alarm, Twin Towers Elevator Renovation, and Alexander Arts Center Chiller Replacement.

U.S. Postal Service

Open End Contract Since 1993, which encompasses numerous Post Office Renovations, new Post Offices, and new Postal Maintenance Facilities. Mr. Kerns has been Project Manager for over 65 projects for the U.S. Postal Service.

Yeager Airport

New Parking Garage
New Emergency Generator
Electrical Upgrades
Fire Alarm System Upgrade
Security Upgrade
Fire Sprinkler Renovations



Clingenpeel/McBrayer & Associates, Inc.

824 Cross Lanes Drive
Charleston, West Virginia 25313
(304) 343-0316 tel
(304) 343-5146 fax

5 Riddle Court
Morgantown, West Virginia
(304) 598-2558 tel
(304) 598-2472

P R O F I L E

Matt Corathers, E.I.
Mechanical Designer

(304) 598-2558

mcorathers@cmawv.com

EDUCATION

West Virginia University
Bachelor of Science -Mechanical Engineering

PROFESSIONAL DEVELOPMENT

Successfully passed Fundamentals of Engineering Exam

EXPERIENCE

Mr. Corathers joined our professional staff in 2008, having previously worked for Whitman, Requardt and Associates in Baltimore, MD.

PROJECTS

West Virginia University
Mechanical design for new two-story child care facility

University High School, Morgantown, WV
Mechanical design for renovations/ upgrades to the HVAC systems

Randolph County Building
Mechanical design for completion of two story addition and modifications of the existing second floor to be used by the Family Court

Monongalia County Family Court
Mechanical design for renovations to 4,850sf in existing court facility

Veterans Hospital, Clarksburg, WV
Mechanical design for renovations to Dental Lab

Monongalia General Hospital
Evaluation of kitchen gas systems
Mechanical design for renovations to IT workroom cooling



Clingenpeel/McBrayer & Associates, Inc.

824 Cross Lanes Drive
Charleston, West Virginia 25313
(304) 343-0316 tel
(304) 343-5146 fax

5 Riddle Court
Morgantown, West Virginia
(304) 598-2558 tel
(304) 598-2472

P R O F I L E

Larry Weese

Mechanical/Plumbing Designer

(304) 343-0316

lweese@cmaavv.com

EDUCATION

West Virginia University
Morgantown, West Virginia
Degree: Division of Forestry BS,MS

PROJECTS

Emergency Response Facilities

Randolph County 911-New Facility
Mason County 911-New Facility
Raleigh County 911-New Facility
Orchard Manor Fire Station-New Facility

Military Facilities

Elkins Readiness Center-New Facility
Gassaway Armory-Renovations and Addition
St. Albans Armory-Renovations and Addition
Moorefield Readiness Center-New Facility

Medical Facilities Experience

Charleston Area Medical Center
Women & Children's Hospital- Renovations to
Emergency Room
Hess Medical Office Building-New Facility
Pinewood Medical Office Building-Renovations
Southern West Virginia Hospice-New Facility
NorthGate Doctor's Office Building-New Facility

WV Department of Health and Human Resources

Office of Chief Medical Examiner, Charleston
New Facility Mingo County

Industrial Experience

Standard Laboratories-Laboratory Addition
Dow Process Control-New Facility
Diamond Electric-Expansion

PROFESSIONAL DEVELOPMENT

Various seminars and technical sessions

EXPERIENCE

Mr. Larry Weese, Mechanical Designer for Clingenpeel/McBrayer & Associates, Inc. brings 20 years of mechanical design and project management experience to our clients.



Clingenpeel/McBrayer & Associates, Inc.

824 Cross Lanes Drive
Charleston, West Virginia 25313
(304) 343-0316 tel
(304) 343-5146 fax

5 Riddle Court
Morgantown, West Virginia
(304) 598-2558 tel
(304) 598-2472

CERTIFICATION AND SIGNATURE PAGE

By signing below, I certify that I have reviewed this Solicitation in its entirety; understand the requirements, terms and conditions, and other information contained herein; that I am submitting this bid or proposal for review and consideration; that I am authorized by the bidder to execute this bid or any documents related thereto on bidder's behalf; that I am authorized to bind the bidder in a contractual relationship; and that to the best of my knowledge, the bidder has properly registered with any State agency that may require registration.

E.T. Boggess, Architect, Inc.

(Company)

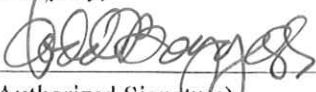

(Authorized Signature)

Todd Boggess, President

(Representative Name, Title)

304-425-4491 / 304-425-2028

(Phone Number)

(Fax Number)

May 29, 2013

(Date)

ADDENDUM ACKNOWLEDGEMENT FORM
SOLICITATION NO.: DEFK13010

Instructions: Please acknowledge receipt of all addenda issued with this solicitation by completing this addendum acknowledgment form. Check the box next to each addendum received and sign below. Failure to acknowledge addenda may result in bid disqualification.

Acknowledgment: I hereby acknowledge receipt of the following addenda and have made the necessary revisions to my proposal, plans and/or specification, etc.

Addendum Numbers Received:

(Check the box next to each addendum received)

- | | |
|--|--|
| <input checked="" type="checkbox"/> Addendum No. 1 | <input type="checkbox"/> Addendum No. 6 |
| <input type="checkbox"/> Addendum No. 2 | <input type="checkbox"/> Addendum No. 7 |
| <input type="checkbox"/> Addendum No. 3 | <input type="checkbox"/> Addendum No. 8 |
| <input type="checkbox"/> Addendum No. 4 | <input type="checkbox"/> Addendum No. 9 |
| <input type="checkbox"/> Addendum No. 5 | <input type="checkbox"/> Addendum No. 10 |

I understand that failure to confirm the receipt of addenda may be cause for rejection of this bid. I further understand that that any verbal representation made or assumed to be made during any oral discussion held between Vendor's representatives and any state personnel is not binding. Only the information issued in writing and added to the specifications by an official addendum is binding.

E.T. Boggess, Architect, Inc.

Company



Authorized Signature

May 29, 2013

Date

NOTE: This addendum acknowledgment should be submitted with the bid to expedite document processing.

STATE OF WEST VIRGINIA
Purchasing Division

PURCHASING AFFIDAVIT

MANDATE: Under W. Va. Code §5A-3-10a, no contract or renewal of any contract may be awarded by the state or any of its political subdivisions to any vendor or prospective vendor when the vendor or prospective vendor or a related party to the vendor or prospective vendor is a debtor and: (1) the debt owed is an amount greater than one thousand dollars in the aggregate; or (2) the debtor is in employer default.

EXCEPTION: The prohibition listed above does not apply where a vendor has contested any tax administered pursuant to chapter eleven of the W. Va. Code, workers' compensation premium, permit fee or environmental fee or assessment and the matter has not become final or where the vendor has entered into a payment plan or agreement and the vendor is not in default of any of the provisions of such plan or agreement.

DEFINITIONS:

"Debt" means any assessment, premium, penalty, fine, tax or other amount of money owed to the state or any of its political subdivisions because of a judgment, fine, permit violation, license assessment, defaulted workers' compensation premium, penalty or other assessment presently delinquent or due and required to be paid to the state or any of its political subdivisions, including any interest or additional penalties accrued thereon.

"Employer default" means having an outstanding balance or liability to the old fund or to the uninsured employers' fund or being in policy default, as defined in W. Va. Code § 23-2c-2, failure to maintain mandatory workers' compensation coverage, or failure to fully meet its obligations as a workers' compensation self-insured employer. An employer is not in employer default if it has entered into a repayment agreement with the Insurance Commissioner and remains in compliance with the obligations under the repayment agreement.

"Related party" means a party, whether an individual, corporation, partnership, association, limited liability company or any other form or business association or other entity whatsoever, related to any vendor by blood, marriage, ownership or contract through which the party has a relationship of ownership or other interest with the vendor so that the party will actually or by effect receive or control a portion of the benefit, profit or other consideration from performance of a vendor contract with the party receiving an amount that meets or exceeds five percent of the total contract amount.

AFFIRMATION: By signing this form, the vendor's authorized signer affirms and acknowledges under penalty of law for false swearing (W. Va. Code §61-5-3) that neither vendor nor any related party owe a debt as defined above and that neither vendor nor any related party are in employer default as defined above, unless the debt or employer default is permitted under the exception above.

WITNESS THE FOLLOWING SIGNATURE:

Vendor's Name: E.T. Boggess, Architect, Inc.

Authorized Signature: *E.T. Boggess* Date: May 29, 2013

State of West Virginia

County of Mercer, to-wit:

Taken, subscribed, and sworn to before me this 29 day of May, 2013.

My Commission expires March 11, 2018.

AFFIX SEAL HERE

NOTARY PUBLIC *Donna R. East*

Purchasing Affidavit (Revised 07/01/2012)

