



State of West Virginia
 Department of Administration
 Purchasing Division
 2019 Washington Street East
 Post Office Box 50130
 Charleston, WV 25305-0130

Request for Quotation

RFQ NUMBER
7011EC06

PAGE
1

ADDRESS CORRESPONDENCE TO ATTENTION OF:
**BUYER 33
 304-558-2402**

ROBERT RODERY

RFQ COPY # 709034551
 TYPE NAME/ADDRESS HERE
**RISH EQUIPMENT COMPANY
 P.O. Box 906
 BRIDGEPORT, WV 26330**

SHIP TO

**DIVISION OF HIGHWAYS
 EQUIPMENT DIVISION
 ROUTE 33
 BRUSHY FORK ROAD
 BUCKHANNON, WV
 26201 304-472-1750**

DATE PRINTED	TERMS OF SALE	SHIP VIA	F.O.B.	FREIGHT TERMS
09/29/2010				

BID OPENING DATE: **11/10/2010** BID OPENING TIME **01:30PM**

LINE	QUANTITY	UOP	CAT NO	ITEM NUMBER	UNIT PRICE	AMOUNT
0001	1	EA		760-06	\$103,872.⁰⁰	\$103,872.⁰⁰
				75 HORSEPOWER TRACTOR/DOZER WITH WINCH AND BLADE		
				OPEN END CONTRACT		
				TO PROVIDE 75 HORSEPOWER TRACTOR/DOZER WITH WINCH AND BLADE FOR THE WEST VIRGINIA DIVISION OF HIGHWAYS. PER THE ATTACHED SPECIFICATIONS.		
				MANDATORY PRE-BID		
				A MANDATORY PRE-BID WILL BE HELD ON THURSDAY, 10/28 AT 11AM, 2019 WASHINGTON ST E., CHARLESTON WV 25305. ALL INTERESTED PARTIES ARE REQUIRED TO ATTEND THIS MEETING FAILURE TO ATTEND THE MANDATORY PRE-BID SHALL RESULT IN DISQUALIFICATION OF THE BID. NO ONE PERSON MAY REPRESENT MORE THAN ONE BIDDER.		
				AN ATTENDANCE SHEET WILL BE MADE AVAILABLE FOR ALL POTENTIAL BIDDERS TO COMPLETE. THIS WILL SERVE AS THE OFFICIAL DOCUMENT VERIFYING ATTENDANCE AT THE MANDATORY PRE-BID. FAILURE TO PROVIDE YOUR COMPANY AND REPRESENTATIVE NAME ON THE ATTENDANCE SHEET WILL RESULT IN DISQUALIFICATION OF THE BID. THE STATE WILL NOT ACCEPT ANY OTHER DOCUMENTATION TO VERIFY ATTENDANCE. THE BIDDER IS RESPONSIBLE FOR ENSURING THEY HAVE COMPLETED THE INFORMATION REQUIRED ON THE ATTENDANCE SHEET. THE PURCHASING DIVISION AND THE STATE AGENCY WILL NOT ASSUME ANY RESPONSIBILITY FOR A BIDDER-S FAILURE TO COMPLETE THE PRE-BID ATTENDANCE SHEET. IN ADDITION, WE REQUEST THAT ALL POTENTIAL BIDDERS INCLUDE THEIR E-MAIL ADDRESS AND FAX NUMBER.		

RECEIVED
 2010 NOV 24 P 12:25
 PURCHASING DIVISION
 STATE OF WV

SEE REVERSE SIDE FOR TERMS AND CONDITIONS

SIGNATURE Paul Cabnet	TELEPHONE 304-842-3511	DATE 11/24/10
FEIN 54-139-01008-004	ADDRESS CHANGES TO BE NOTED ABOVE	

WHEN RESPONDING TO RFQ, INSERT NAME AND ADDRESS IN SPACE ABOVE LABELED 'VENDOR'



State of West Virginia
 Department of Administration
 Purchasing Division
 2019 Washington Street East
 Post Office Box 50130
 Charleston, WV 25305-0130

Request for Quotation

RFQ NUMBER
7011EC06

PAGE
2

ADDRESS CORRESPONDENCE TO ATTENTION OF
BUYER 33 304-558-2402

VENDOR

*709034551 304-327-5124
 RISH EQUIPMENT COMPANY
 PO BOX 330
 BLUEFIELD WV 24701

SHIP TO

DIVISION OF HIGHWAYS
 EQUIPMENT DIVISION
 ROUTE 33
 BRUSHY FORK ROAD
 BUCKHANNON, WV
 26201 304-472-1750

DATE PRINTED	TERMS OF SALE	SHIP VIA	F.O.B	FREIGHT TERMS
09/29/2010				

BID OPENING DATE: 11/10/2010 BID OPENING TIME 01:30PM

LINE	QUANTITY	UOP	CAT NO	ITEM NUMBER	UNIT PRICE	AMOUNT
<p>ALL POTENTIAL BIDDERS ARE REQUESTED TO ARRIVE PRIOR TO THE STARTING TIME FOR THE PRE-BID. BIDDERS WHO ARRIVE LATE, BUT PRIOR TO THE DISMISSAL OF THE TECHNICAL PORTION OF THE PRE-BID WILL BE PERMITTED TO SIGN IN. BIDDERS WHO ARRIVE AFTER CONCLUSION OF THE TECHNICAL PORTION OF THE PRE-BID, BUT DURING ANY SUBSEQUENT PART OF THE PRE-BID WILL NOT BE PERMITTED TO SIGN THE ATTENDANCE SHEET.</p> <p>QUESTIONS: WRITTEN QUESTIONS WILL BE ACCEPTED THROUGH CLOSE OF BUSINESS (5:00 PM, EST) ON THURSDAY, 10/21/10.</p> <p>SEND QUESTIONS TO: PURCHASING DIVISION ATTENTION SHERI SLONE/CHUCK BOWMAN 2019 WASHINGTON STREET EAST CHARLESTON, WV 25305</p> <p>QUESTIONS MAY BE SENT VIA FAX, E-MAIL, OR REGULAR MAIL. E-MAIL: SHERI.D.SLONE@WV.GOV FAX: 304-558-4115</p> <p>IT IS THE VENDOR'S RESPONSIBILITY TO VERIFY THAT THEIR QUESTIONS HAVE BEEN RECEIVED BY CALLING 304-558-2402.</p> <p>EXHIBIT 2</p> <p>LIFE OF CONTRACT: THIS CONTRACT BECOMES EFFECTIVE ON AND EXTENDS FOR A PERIOD OF ONE (1) YEAR OR UNTIL SUCH "REASONABLE TIME" THEREAFTER AS IS NECESSARY TO OBTAIN A NEW CONTRACT OR RENEW THE ORIGINAL CONTRACT. THE "REASONABLE TIME" PERIOD SHALL NOT EXCEED TWELVE (12) MONTHS. DURING THIS "REASONABLE TIME" THE VENDOR MAY TERMINATE THIS CONTRACT FOR</p>						

SEE REVERSE SIDE FOR TERMS AND CONDITIONS

SIGNATURE	TELEPHONE	DATE
<i>Paul Calvert</i>	304-842-3511	11/24/10
TITLE	FEIN	ADDRESS CHANGES TO BE NOTED ABOVE
GENERAL MANAGER	54-139-0608-004	

WHEN RESPONDING TO RFQ, INSERT NAME AND ADDRESS IN SPACE ABOVE LABELED 'VENDOR'



State of West Virginia
 Department of Administration
 Purchasing Division
 2019 Washington Street East
 Post Office Box 50130
 Charleston, WV 25305-0130

Request for Quotation

RFQ NUMBER
7011EC06

PAGE
3

ADDRESS CORRESPONDENCE TO ATTENTION OF
BUYER 33 304-558-2402

VENDOR

*709034551 304-327-5124
 RISH EQUIPMENT COMPANY
 PO BOX 330
 BLUEFIELD WV 24701

SHIP TO

DIVISION OF HIGHWAYS
 EQUIPMENT DIVISION
 ROUTE 33
 BRUSHY FORK ROAD
 BUCKHANNON, WV
 26201 304-472-1750

DATE PRINTED	TERMS OF SALE	SHIP VIA	F.O.B	FREIGHT TERMS
09/29/2010				

BID OPENING DATE: 11/10/2010 BID OPENING TIME 01:30PM

LINE	QUANTITY	UOP	CAT NO.	ITEM NUMBER	UNIT PRICE	AMOUNT
<p>ANY REASON UPON GIVING THE DIRECTOR OF PURCHASING THIRTY (30) DAYS WRITTEN NOTICE.</p> <p>UNLESS SPECIFIC PROVISIONS ARE STIPULATED IN THIS CONTRACT DOCUMENT, THE TERMS, CONDITIONS, AND PRICING SET HEREIN ARE FIRM FOR THE LIFE OF THE CONTRACT.</p> <p>RENEWAL: THIS CONTRACT MAY BE RENEWED UPON THE MUTUAL WRITTEN CONSENT OF THE SPENDING UNIT AND VENDOR, SUBMITTED TO THE DIRECTOR OF PURCHASING THIRTY (30) DAYS PRIOR TO THE EXPIRATION DATE. SUCH RENEWAL SHALL BE IN ACCORDANCE WITH THE TERMS AND CONDITIONS OF THE ORIGINAL CONTRACT AND SHALL BE LIMITED TO TWO (2) ONE (1) YEAR PERIODS.</p> <p>CANCELLATION: THE DIRECTOR OF PURCHASING RESERVES THE RIGHT TO CANCEL THIS CONTRACT IMMEDIATELY UPON WRITTEN NOTICE TO THE VENDOR IF THE COMMODITIES AND/OR SERVICE SUPPLIED ARE OF AN INFERIOR QUALITY OR DO NOT CONFORM WITH THE SPECIFICATIONS OF THE BID AND CONTRACT HEREIN.</p> <p>OPEN MARKET CLAUSE: THE DIRECTOR OF PURCHASING MAY AUTHORIZE A SPENDING UNIT TO PURCHASE ON THE OPEN MARKET, WITHOUT THE FILING OF A REQUISITION OR COST ESTIMATE, ITEMS SPECIFIED ON THIS CONTRACT FOR IMMEDIATE DELIVERY IN EMERGENCIES DUE TO UNFORESEEN CAUSES (INCLUDING BUT NOT LIMITED TO DELAYS IN TRANSPORTATION OR AN UNANTICIPATED INCREASE IN THE VOLUME OF WORK).</p> <p>QUANTITIES: QUANTITIES LISTED IN THE REQUISITION ARE APPROXIMATIONS ONLY, BASED ON ESTIMATES SUPPLIES BY THE STATE SPENDING UNIT. IT IS UNDERSTOOD AND AGREED THAT THE CONTRACT SHALL COVER THE QUANTITIES ACTUALLY ORDERED FOR DELIVERY DURING THE TERM OF CONTRACT, WHETHER MORE OR LESS THAN THE QUANTITIES SHOWN.</p>						

SEE REVERSE SIDE FOR TERMS AND CONDITIONS

SIGNATURE <i>Paul Calvert</i>	TELEPHONE 304-842-3511	DATE 11/24/10
TITLE GENERAL MANAGER	FEIN 54-139-0608-004	ADDRESS CHANGES TO BE NOTED ABOVE

WHEN RESPONDING TO RFQ, INSERT NAME AND ADDRESS IN SPACE ABOVE LABELED 'VENDOR'



State of West Virginia
 Department of Administration
 Purchasing Division
 2019 Washington Street East
 Post Office Box 50130
 Charleston, WV 25305-0130

Request for Quotation

RFQ NUMBER
7011EC06

PAGE
4

ADDRESS CORRESPONDENCE TO ATTENTION OF
**BUYER 33
 304-558-2402**

VENDOR

*709034551 304-327-5124
RISH EQUIPMENT COMPANY
PO BOX 330

BLUEFIELD WV 24701

SHIP TO

**DIVISION OF HIGHWAYS
 EQUIPMENT DIVISION
 ROUTE 33
 BRUSHY FORK ROAD
 BUCKHANNON, WV
 26201 304-472-1750**

DATE PRINTED 09/29/2010	TERMS OF SALE	SHIP VIA	F.O.B.	FREIGHT TERMS
BID OPENING DATE: 11/10/2010		BID OPENING TIME 01:30PM		

LINE	QUANTITY	UOP	CAT NO	ITEM NUMBER	UNIT PRICE	AMOUNT
<p>ORDERING PROCEDURE: SPENDING UNIT(S) SHALL ISSUE A WRITTEN EQUIPMENT CONTRACT ORDER (FORM NUMBER WV-35) FOR COMMODITIES COVERED BY THIS CONTRACT. THE ORIGINAL WV-35 MUST BE SENT TO THE PURCHASING DIVISION OF THE DEPARTMENT OF ADMINISTRATION. AFTER APPROVAL AND ENCUMBRANCE, ONE COPY OF THE PURCHASE ORDER WILL BE RETURNED TO THE SPENDING UNIT AND ONE COPY FORWARDED TO THE VENDOR AS AUTHORIZATION FOR SHIPMENT. NO ORDER IS VALID UNLESS APPROVED AND ENCUMBERED BY THE PURCHASING DIVISION.</p> <p>BANKRUPTCY: IN THE EVENT THE VENDOR/CONTRACTOR FILES FOR BANKRUPTCY PROTECTION, THE STATE MAY DEEM THE CONTRACT NULL AND VOID, AND TERMINATE SUCH CONTRACT WITHOUT FUTHER ORDER.</p> <p>REV. 5/2009</p> <p>EXHIBIT 10</p> <p style="text-align: right;">REQUISITION NO.: 7011EC06</p> <p>ADDENDUM ACKNOWLEDGEMENT</p> <p>I HEREBY ACKNOWLEDGE RECEIPT OF THE FOLLOWING CHECKED ADDENDUM(S) AND HAVE MADE THE NECESSARY REVISIONS TO MY PROPOSAL, PLANS AND/OR SPECIFICATION, ETC.</p> <p>ADDENDUM NO. AS:</p> <p>NO. 1 ABS</p> <p>NO. 2 ABS</p> <p>NO. 3 ABS</p>						

SEE REVERSE SIDE FOR TERMS AND CONDITIONS

SIGNATURE <i>Paul Cabot</i>	TELEPHONE 304-842-3511	DATE 11/24/10
TITLE GENERAL MANAGER	FEIN 54-139-0608-004	ADDRESS CHANGES TO BE NOTED ABOVE



State of West Virginia
 Department of Administration
 Purchasing Division
 2019 Washington Street East
 Post Office Box 50130
 Charleston, WV 25305-0130

Request for Quotation

RFQ NUMBER
7011EC06

PAGE
5

ADDRESS CORRESPONDENCE TO ATTENTION OF
**BUYER 33
 304-558-2402**

***709034551 304-327-5124**
RISH EQUIPMENT COMPANY
PO BOX 330
BLUEFIELD WV 24701

DIVISION OF HIGHWAYS
EQUIPMENT DIVISION
ROUTE 33
BRUSHY FORK ROAD
BUCKHANNON, WV
26201 304-472-1750

DATE PRINTED 09/29/2010	TERMS OF SALE	SHIP VIA	F.O.B.	FREIGHT TERMS
-----------------------------------	---------------	----------	--------	---------------

BID OPENING DATE: **11/10/2010** BID OPENING TIME **01:30PM**

LINE	QUANTITY	UOP	CAT NO	ITEM NUMBER	UNIT PRICE	AMOUNT
NO. 4	<i>ABS</i>					
NO. 5					
<p>I UNDERSTAND THAT FAILURE TO CONFIRM THE RECEIPT OF TH ADDENDUM(S) MAY BE CAUSE FOR REJECTION OF BIDS.</p> <p>VENDOR MUST CLEARLY UNDERSTAND THAT ANY VERBAL REPRESENTATION MADE OR ASSUMED TO BE MADE DURING ANY ORAL DISCUSSION HELD BETWEEN VENDOR'S REPRESENTATIVES AND ANY STATE PERSONNEL IS NOT BINDING. ONLY THE INFORMATION ISSUED IN WRITING AND ADDED TO THE SPECIFICATIONS BY AN OFFICIAL ADDENDUM IS BINDING.</p> <p style="text-align: center;"> <i>Paul Cabunt</i> SIGNATURE RISH EQUIPMENT COMPANY COMPANY ..NOVEMBER 24, 2010..... DATE </p> <p>NOTE: THIS ADDENDUM ACKNOWLEDGEMENT SHOULD BE SUBMITTED WITH THE BID.</p> <p>REV. 09/21/2009</p> <p>EXHIBIT 4</p> <p>LOCAL GOVERNMENT BODIES: UNLESS THE VENDOR INDICATES IN THE BID HIS REFUSAL TO EXTEND THE PRICES, TERMS, AND CONDITIONS OF THE BID TO COUNTY, SCHOOL, MUNICIPAL</p>						

SEE REVERSE SIDE FOR TERMS AND CONDITIONS

SIGNATURE <i>Paul Cabunt</i>	TELEPHONE 304-842-3511	DATE 11/24/10
TITLE GENERAL MANAGER	FEIN 54-139-0608-004	ADDRESS CHANGES TO BE NOTED ABOVE

WHEN RESPONDING TO RFQ, INSERT NAME AND ADDRESS IN SPACE ABOVE LABELED 'VENDOR'



State of West Virginia
 Department of Administration
 Purchasing Division
 2019 Washington Street East
 Post Office Box 50130
 Charleston, WV 25305-0130

Request for Quotation

RFQ NUMBER
7011EC06

PAGE
6

ADDRESS CORRESPONDENCE TO ATTENTION OF
BUYER 33 304-558-2402

VENDOR	*709034551 304-327-5124
	RISH EQUIPMENT COMPANY
	PO BOX 330
	BLUEFIELD WV 24701

SHIP TO	DIVISION OF HIGHWAYS
	EQUIPMENT DIVISION
	ROUTE 33
	BRUSHY FORK ROAD
	BUCKHANNON, WV 26201
	304-472-1750

DATE PRINTED	TERMS OF SALE	SHIP VIA	F.O.B.	FREIGHT TERMS
09/29/2010				
BID OPENING DATE: 11/10/2010		BID OPENING TIME 01:30PM		

LINE	QUANTITY	UOP	CAT NO	ITEM NUMBER	UNIT PRICE	AMOUNT
<p>AND OTHER LOCAL GOVERNMENT BODIES, THE BID SHALL EXTEND TO POLITICAL SUBDIVISIONS OF THE STATE OF WEST VIRGINIA. IF THE VENDOR DOES NOT WISH TO EXTEND THE PRICES, TERMS, AND CONDITIONS OF THE BID TO ALL POLITICAL SUBDIVISIONS OF THE STATE, THE VENDOR MUST CLEARLY INDICATE SUCH REFUSAL IN HIS BID. SUCH REFUSAL SHALL NOT PREJUDICE THE AWARD OF THIS CONTRACT IN ANY MANNER.</p> <p>REV. 3/88</p> <p style="text-align: center;">NOTICE</p> <p>A SIGNED BID MUST BE SUBMITTED TO:</p> <p style="text-align: center;">DEPARTMENT OF ADMINISTRATION PURCHASING DIVISION BUILDING 15 2019 WASHINGTON STREET, EAST CHARLESTON, WV 25305-0130</p> <p>THE BID SHOULD CONTAIN THIS INFORMATION ON THE FACE OF THE ENVELOPE OR THE BID MAY NOT BE CONSIDERED:</p> <p>SEALED BID</p> <p>BUYER: 33</p> <p>RFQ. NO.: 7011EC06</p> <p>BID OPENING DATE: 11/10/2010</p>						

SEE REVERSE SIDE FOR TERMS AND CONDITIONS			
SIGNATURE	TELEPHONE	DATE	
<i>Paul Calvert</i>	304-842-3511	11/24/10	
TITLE	FEIN	ADDRESS CHANGES TO BE NOTED ABOVE	
GENERAL MANAGER	54-139-0608		

WHEN RESPONDING TO RFQ, INSERT NAME AND ADDRESS IN SPACE ABOVE LABELED 'VENDOR'



State of West Virginia
 Department of Administration
 Purchasing Division
 2019 Washington Street East
 Post Office Box 50130
 Charleston, WV 25305-0130

Request for Quotation

RFQ NUMBER
7011EC06

PAGE
7

ADDRESS CORRESPONDENCE TO ATTENTION OF
**BUYER 33
 304-558-2402**

***709034551 304-327-5124**
RISH EQUIPMENT COMPANY
PO BOX 330
BLUEFIELD WV 24701

DIVISION OF HIGHWAYS
EQUIPMENT DIVISION
ROUTE 33
BRUSHY FORK ROAD
BUCKHANNON, WV
26201 304-472-1750

DATE PRINTED 09/29/2010	TERMS OF SALE	SHIP VIA	F.O.B.	FREIGHT TERMS
-----------------------------------	---------------	----------	--------	---------------

BID OPENING DATE: **11/10/2010** BID OPENING TIME **01:30PM**

LINE	QUANTITY	UOP	CAT NO.	ITEM NUMBER	UNIT PRICE	AMOUNT
BID OPENING TIME:				1:30 PM		
PLEASE PROVIDE A FAX NUMBER IN CASE IT IS NECESSARY TO CONTACT YOU REGARDING YOUR BID:						
----- (304) 842-6126 -----						
CONTACT PERSON (PLEASE PRINT CLEARLY):						
----- ANTONIO B. SELARFO -----						
***** THIS IS THE END OF RFQ 7011EC06 ***** TOTAL:						\$ 103,872.⁰⁰

SEE REVERSE SIDE FOR TERMS AND CONDITIONS

SIGNATURE **Paul Cabnet** TELEPHONE **304-842-3511** DATE **11/24/10**

TITLE **GENERAL MANAGER** FEIN **54-139-0608-004** ADDRESS CHANGES TO BE NOTED ABOVE

WHEN RESPONDING TO RFQ, INSERT NAME AND ADDRESS IN SPACE ABOVE LABELED 'VENDOR'



State of West Virginia
 Department of Administration
 Purchasing Division
 2019 Washington Street East
 Post Office Box 50130
 Charleston, WV 25305-0130

Request for Quotation

RFQ NUMBER
7011EC06

PAGE
1

ADDRESS CORRESPONDENCE TO ATTENTION OF
BUYER 33 304-558-2402

RFQ COPY

TYPE NAME/ADDRESS HERE

SHIP TO

DIVISION OF HIGHWAYS
 EQUIPMENT DIVISION
 ROUTE 33
 BRUSHY FORK ROAD
 BUCKHANNON, WV
 26201 304-472-1750

DATE PRINTED	TERMS OF SALE	SHIP VIA	FOB	FREIGHT TERMS
10/15/2010				

BID OPENING DATE: 11/17/2010 BID OPENING TIME: 01:30PM

LINE	QUANTITY	UOP	CAT NO	ITEM NUMBER	UNIT PRICE	AMOUNT
ADDENDUM NO. 1						
THIS ADDENDUM IS ISSUED TO:						
1.) TO CHANGE THE DATE AND TIME FOR THE MANDATORY PRE-BID MEETING,						
MANDATORY PRE-BID DATE: 11/03/2010						
MANDATORY PRE-BID TIME: 9:00 AM						
PRE-BID WILL BE HELD AT:						
WV STATE PURCHASING DIVISION						
2019 WASHINGTON STREET, EAST						
CHARLESTON, WV 25305						
(BUILDING #15)						
2.) TO EXTEND THE DEADLINE FOR TECHNICAL QUESTIONS,						
DEADLINE FOR TECHNICAL QUESTIONS: 10/28/2010 AT THE CLOSE OF BUSINESS (5:00 PM)						
3.) EXTEND THE BID OPENING DATE						
BID OPENING DATE IS EXTENDED TO: 11/17/2010						
BID OPENING TIME REMAINS: 1:30 PM						
***** END ADDENDUM NO. 1 *****						

SEE REVERSE SIDE FOR TERMS AND CONDITIONS

SIGNATURE	TELEPHONE	DATE
<i>Paul Cabot</i>	304-842-3511	11/24/10
TITLE	FEIN	ADDRESS CHANGES TO BE NOTED ABOVE
GENERAL MANAGER	54-139-0608-004	

WHEN RESPONDING TO RFQ, INSERT NAME AND ADDRESS IN SPACE ABOVE LABELED 'VENDOR'



State of West Virginia
 Department of Administration
 Purchasing Division
 2019 Washington Street East
 Post Office Box 50130
 Charleston, WV 25305-0130

Request for Quotation

RFQ NUMBER
 7011EC06

PAGE
 1

ADDRESS CORRESPONDENCE TO ATTENTION OF
 BUYER 33
 304-558-2402

RFQ COPY 709034551
 TYPE NAME/ADDRESS HERE
RISH EQUIPMENT COMPANY
 P.O. Box 906
 Bridgeport, W 26330

DIVISION OF HIGHWAYS
 EQUIPMENT DIVISION
 ROUTE 33
 BRUSHY FORK ROAD
 BUCKHANNON, WV
 26201 304-472-1750

DATE PRINTED	TERMS OF SALE	SHIP VIA	FOB	FREIGHT TERMS
11/16/2010				
BID OPENING DATE: 11/17/2010		BID OPENING TIME 01:30PM		

LINE	QUANTITY	UOP	CAT NO	ITEM NUMBER	UNIT PRICE	AMOUNT
ADDENDUM NO. 2						
THIS ADDENDUM IS ISSUED TO ADDRESS SPECIFICATION CHANGES AS DISCUSSED AND AGREED UPON DURING MANDATORY PRE-BID MEETING PER ATTACHED.						
BID OPENING DATE REMAINS: 11/17/2010						
BID OPENING TIME REMAINS: 1:30 PM						
*****.END ADDENDUM NO. 2 *****						
0001	1	EA		760-06	\$103,872.00	\$103,872.00
75 HORSEPOWER TRACTOR/DOZER WITH WINCH AND BLADE						
***** THIS IS THE END OF RFQ 7011EC06 ***** TOTAL:						\$103,872.00

SEE REVERSE SIDE FOR TERMS AND CONDITIONS

SIGNATURE <i>Paul Calant</i>	TELEPHONE 304-842-3511	DATE 11/24/10
TITLE GENERAL MANAGER	FEIN 54-139-0608-004	ADDRESS CHANGES TO BE NOTED ABOVE

WHEN RESPONDING TO RFQ. INSERT NAME AND ADDRESS IN SPACE ABOVE LABELED 'VENDOR'

PREBID ADDENDUM #2
70-11-EC06

OPEN END CONTRACT
75 HORSEPOWER TRACTOR/DOZER WITH WINCH AND BLADE

CHANGES TO SPECIFICATIONS:

FROM:

4.2 DELIVERY – 2nd Paragraph – 2nd Sentence
Delivery is preferred within 120 days after receipt of purchase agreement.

TO:

4.2 DELIVERY – 2nd Paragraph – 2nd Sentence
Delivery is preferred within 180 days after receipt of purchase agreement.

FROM:

4.2 DELIVERY – 3rd Paragraph
A completed pilot model for inspection must be provided within 90 calendar days after receipt of the purchase agreement by the successful vendor.

TO:

4.2 DELIVERY – 3rd Paragraph
A completed pilot model for inspection must be provided within 120 calendar days after receipt of the purchase agreement by the successful vendor.

FROM:

7.5.2 Drum capacity should be about 257 feet.

TO:

7.5.2 Drum capacity should be about 257 feet. **However we will spool only 150 feet.**

FROM:

7.5.2.1 **Winch rope diameter shall be a minimum of 5/8 inches and maximum 3/4 inches with tail chain and hook. (Must comply with winch specifications.)**

TO:

7.5.2.1 **Winch rope diameter shall be a minimum of 5/8 inch cable with tail chain and hook. (Must comply with winch specifications.)**

Prebid Addendum
7011EC06

FROM:

7.5.3 **Minimum line pull (full drum) 25,000 lbs./11340kg.**

TO:

7.5.3 **Minimum line pull (full drum) 22,000 lbs.**

FROM:

7.5.4 **Maximum line speed (full drum) 207 feet/min/63m/min.**

TO:

7.5.4 **Minimum line speed (full drum) 100 ft. per minute**

DELETE: (Duplicate)

7.11 Preventive Maintenance and Operators Orientation/Training:

7.11.1 **The Manufacturer or dealer shall provide preventive maintenance/operator orientation seminar to be conducted at the Equipment Division, Buckhannon.** All training aids i.e. videos, charts, manuals, etc. to be furnished by successful vendor.

PREBID ADDENDUM #2
70-11-EC06

OPEN END CONTRACT
75 HORSEPOWER TRACTOR/DOZER WITH WINCH AND BLADE

CHANGES TO BIDDER'S EVALUATION REPORT:

NO CHANGE REQUIRED:

X4.2 DELIVERY:

X4.2.1 Delivery date of completed representative unit: 120 Calendar Days After
Receipt of Purchase Agreement

X4.2.2 Delivery date of balance of completed units: 180 Calendar Days After Receipt of
Purchase Agreement

FROM:

X7.5.2 Drum Capacity: feet

TO:

X7.5.2 Drum Capacity: 277 feet How many feet spooled: 150 feet

FROM:

X7.5.2.1 Winch rope diameter inches with tail chain and hook YES NO
Does it comply with winch specifications YES NO

TO:

X7.5.2.1 Winch rope diameter 5/8 inch cable with tail chain and hook X YES NO
Does it comply with winch specifications X YES NO

FROM:

X7.5.3 Minimum line pull (full drum): lbs./ kg.

TO:

X7.5.3 Minimum line pull (full drum) 22,000 lbs.

7011EC06
Bidder's Evaluation

FROM:

X7.5.4 Maximum line speed (full drum): _____ feet/min _____ m/min.

TO:

X7.5.4 Minimum line speed (full drum): 80 ft. per minute

DELETE: (Duplicate)

X7.11 Preventive Maintenance and Operators Orientation/Training:

X7.11.1 Will manufacturer or dealer conduct seminar at Buckhannon YES ___ NO

X7.11.2 Will you furnish all training aids YES ___ NO



State of West Virginia
 Department of Administration
 Purchasing Division
 2019 Washington Street East
 Post Office Box 50130
 Charleston, WV 25305-0130

Request for Quotation

RFQ NUMBER
 7011EC06

PAGE
 1

ADDRESS CORRESPONDENCE TO ATTENTION OF
 BUYER 33
 304-558-2402

VENDOR

RFQ COPY # 709034551
 TYPE NAME/ADDRESS HERE
RISH EQUIPMENT COMPANY
 P.O. Box 906
 Bridgeport, WV 26330

DIVISION OF HIGHWAYS
 EQUIPMENT DIVISION
 ROUTE 33
 BRUSHY FORK ROAD
 BUCKHANNON, WV
 26201 304-472-1750

DATE PRINTED	TERMS OF SALE	SHIP VIA	F.O.B.	FREIGHT TERMS		
11/16/2010						
BID OPENING DATE	11/24/2010	BID OPENING TIME	01:30 PM			
LINE	QUANTITY	UOP	CAT. NO.	ITEM NUMBER	UNIT PRICE	AMOUNT
				ADDENDUM NO. 3		
				THIS ADDENDUM IS ISSUED TO:		
				EXTEND BID OPENING DATE: 11/24/2010		
				EXTEND BID OPENING TIME: 1:30 PM		
				*****END ADDENDUM NO 3*****		
0001	1	EA		750-06	\$103,872.00	\$103,872.00
				75 HORSEPOWER TRACTOR/DOZER WITH WINCH AND BLADE		
				***** THIS IS THE END OF RFQ 7011EC06 *****		TOTAL: \$103,872.00

SEE REVERSE SIDE FOR TERMS AND CONDITIONS

SIGNATURE Paul Calvert TELEPHONE 304-842-3511 DATE 11/24/10

TITLE GENERAL MANAGER FEIN 54-139-0608-004 ADDRESS CHANGES TO BE NOTED ABOVE

WHEN RESPONDING TO RFQ INSERT NAME AND ADDRESS IN SPACE ABOVE LABELED 'VENDOR'



State of West Virginia
 Department of Administration
 Purchasing Division
 2019 Washington Street East
 Post Office Box 50130
 Charleston, WV 25305-0130

Request for Quotation

RFQ NUMBER
 7011EC06

PAGE
 1

ADDRESS CORRESPONDENCE TO ATTENTION OF:
 BUYER 33
 304-558-2402

RFQ COPY # 709034551
 TYPE NAME/ADDRESS HERE
RSH EQUIPMENT COMPANY
 P.O. Box 90e
 Bridgeport, WV 26330

DIVISION OF HIGHWAYS
 EQUIPMENT DIVISION
 ROUTE 33
 BRUSHY FORK ROAD
 BUCKHANNON, WV
 26201 304-472-1750

DATE PRINTED	TERMS OF SALE	SHIP VIA	F.O.B.	FREIGHT TERMS
11/22/2010				

BID OPENING DATE: 11/24/2010 BID OPENING TIME 01:30PM

LINE	QUANTITY	UOP	CAT NO	ITEM NUMBER	UNIT PRICE	AMOUNT
ADDENDUM NO 4 THIS ADDENDUM IS ISSUED TO ADDRESS CORRECTION TO ITEM 7.5.4 OF SPECIFICATION, PER ATTACHED. *****END ADDENDUM NO 4*****						
0001	1	EA		750-06	\$103,872. ⁰⁰	\$103,872.00
				75 HORSEPOWER TRACTOR/DOZER WITH WINCH AND BLADE		
***** THIS IS THE END OF RFQ 7011EC06 ***** TOTAL:						\$103,872. ⁰⁰

SEE REVERSE SIDE FOR TERMS AND CONDITIONS

SIGNATURE: Paul Calvert TELEPHONE: 304-842-3511 DATE: 11/24/10

TITLE: GENERAL MANAGER FEIN: 54-139-0608-004 ADDRESS CHANGES TO BE NOTED ABOVE

WHEN RESPONDING TO RFQ, INSERT NAME AND ADDRESS IN SPACE ABOVE LABELED 'VENDOR'

PREBID ADDENDUM #4
70-11-EC06

OPEN END CONTRACT
75 HORSEPOWER TRACTOR/DOZER WITH WINCH AND BLADE

CHANGES TO SPECIFICATIONS:

FROM PREBID ADDENDUM #2

7.5.4 Minimum line speed (full drum) 100 ft. per minute

TO:

7.5.4 Minimum line speed (full drum) 80 ft. per minute

WEST VIRGINIA DEPARTMENT OF TRANSPORTATION
DIVISION OF HIGHWAYS
EQUIPMENT DIVISION

BIDDER'S EVALUATION REPORT

PROCUREMENT SPECIFICATIONS FOR OPEN END CONTRACT
NO. 300-2-D

OPEN END CONTRACT
75 HORSEPOWER TRACTOR/DOZER WITH WINCH AND BLADE

NOTE TO BIDDER: Procurement Specification No. 300-2-D, Paragraph 2.0 recommends the completion and submittal of this Report with your bid. Purpose of this Report is to enable the West Virginia Division of Highways Evaluation Committee to make full and fair evaluation of the bid. Addendums in order, along with a summary of exception as a separate attachment, should be with Bidder's Evaluation Report.
FAILURE TO SUBMIT THIS REPORT, COMPLETE IN ITS ENTIRETY, MAY SUBJECT THE BIDDER TO DISQUALIFICATION.

Reference Requisition No.: 7011EC06

Bidder's Name: Rish Equipment Company

Address: P.O. Box 906 Bridgeport, WV 26330

Telephone Number: (304) 842-3511

Years Bidder has been registered to do business with the State of West Virginia: 76 YRS.

Years Company has been an authorized dealer for proposed unit: 26 YRS.

X3.2 Have you complied with all mandatory specifications? YES NO

X4.2 DELIVERY:

X4.2.1 Delivery date of completed representative unit: 120 Calendar Days After
Receipt of Purchase Agreement

X4.2.2 Delivery date of balance of completed units: 180 Calendar Days After Receipt of
Purchase Agreement

X5.0 AWARD CRITERIA;

X5.1 Price per unit: _____ \$103,872.00 _____ per unit

X6.0 SPECIFICATIONS - GENERAL

X6.1 Manufacturer, model, series, and date of manufacture of proposed unit:

KOMATSU D31EX-22 CRAWLER TRACTOR WITH 6-WAY BLADE AND WINCH - 2011 _____
Is descriptive literature, fully describing proposed unit attached to your bid? YES NO

If not, why? _____

X6.2 Will the required number of service manuals, and complete parts list be delivered to the Equipment Division at Buckhannon upon completion of delivery of total units?
 YES NO

Will the required Equipment Preventive Maintenance Form (Section X6.2 of Bidders Evaluation Report) be provided upon inspection of the pilot unit?
 YES NO

X6.3 TRAINING:

Will training seminar be conducted on Preventive Maintenance, Operator and Mechanic Training YES NO

Will you conduct training with each purchase order against this open end contract? YES NO

Will training be conducted within 2 working days from the delivery of the pilot unit on the individual purchase order? YES NO

If NO, explain time frame _____

Will an Operator's Manual be furnished directly to Training Academy prior to the delivery of the pilot? YES NO

X6.4 If you are the successful vendor, will you furnish all training aids, i.e., videos, projectors, required in conducting the training? YES NO

X6.4.1 Will all manuals, booklets, etc. explaining preventive maintenance, operator procedures, and service schedule be delivered with each unit? YES NO

If NO, explain _____

X6.5 WARRANTY AND SERVICE POLICY

Will the warranty and service you provide comply with all areas as stated in Section 6.5 of specifications YES NO

Is warranty literature attached? YES NO

Is a minimum two (2) year bumper to bumper basic parts and labor warranty excluding abuse and normal wear items included? YES NO

Describe:

SEE ATTACHED _____

X6.5 WARRANTY AND SERVICE POLICY QUESTIONNAIRE
THIS FORM MUST BE COMPLETED IN ITS ENTIRETY AND SUBMITTED WITH YOUR BID.

(If additional lines are needed, make copies of form.)

1. Define the terms of the standard warranty. If not offered, so state. (Attach copy)
STANDARD FACTORY FULL MACHINE WARRANTY WILL APPLY FOR 2 YEARS.

2. Define warranty service to be performed at DOH facilities and warranty service to be performed at manufacturer's representative facility. List name and location of manufacturer's representative.

ALL WARRANTY SERVICE TO BE PERFORMED AT MANUFACTURER'S REPRESENTATIVE FACILITY UNLESS PRIOR ARRANGEMENTS HAVE BEEN MADE.

3. List locations for parts inventories that are within the State of West Virginia. Also, list availability levels, if known.
BRIDGEPORT, WV - BLUEFIELD, WV - BECKLEY, WV - LOGAN, WV - ST. ALBANS, WV.

4. During the term of warranty, list the guarantee discount to manufacturer's published list price for parts that bidder will sell the parts to owner.

A.	Terms: Net 30	Manufacturer's published list price less: <u>0</u> % discount
B.	Terms: Net 60	Manufacturer's published list price less: <u>0</u> % discount
C.	Terms: Net 90	Manufacturer's published list price less: <u>0</u> % discount

5. During the term of warranty, will all manufacturers or engineering improvements be submitted to Division of Highways? X YES NO

6. During the term of warranty, list the guaranteed rates charged for repair to the unit.

A.	Shop Rate	\$ <u>75.00</u> per mechanic hour
B.	Travel Time Charge (Specify if one-way)	\$ <u>75.00</u> per mechanic hour _____ ; port to port _____
C.	Mileage Charge (Specify if one-way)	\$ <u>3.00</u> per vehicle mile _____ ; port to port _____
D.	Field Mechanic Rate	\$ <u>80.00</u> per mechanic hour

E. Specify period of time that prices are in effect: 1 YEAR

F. Surcharge for miscellaneous items: 4% OF LABOR %

X6.6 EVALUATION COMMITTEE REQUIREMENTS

Is all component specifications, product literature, component models provided for Evaluation Committee bid determination? YES NO

X6.7 Will all parts, equipment, accessories, material, design and performance characteristics not specified herein, but which are necessary to provide a complete unit, be furnished with the unit and conform in strength, quality of material, and quality of workmanship to those which are advertised and provided to the market in general by the unit industry? YES NO

X6.7.1 Are all parts and accessories adequate and regularly supplied as standard to be included except those which may be duplications of specifications herein, and except these by specification are not to be furnished? YES NO

X6.7.2 Are all standard safety features that are required by Federal and State statutes of law included? YES NO

X7.0 SPECIFICATIONS OF THE QUOTED UNIT:

The bidder should complete the following schedule in order for the Division to compare the actual bid unit to the specifications. Should the bidder except a requirement, then such exception may be only on the basis that such feature is not offered by the manufacturer. The Division will have the sole discretion as to whether the bidder's substitution meets the requirements of the specification.

Manufacturer: KOMATSU **Model:** D31EX-22

X7.1 Engine:

X7.1.1 Is engine diesel YES NO

X7.1.2 Engine horsepower: 78

X7.1.3 Engine flywheel power: 71 HP

X7.2 Weight:

X7.2.1 Operating weight: 18,056 lbs.

X7.3 Transmission:

X7.3.1 Travel speed forward: 0 - 5.3 MPH/ 0 - 8.5 KM/h

X7.3.2 Travel speed reverse: 0 - 5.3 MPH/ 0 - 8.5 KM/h

X7.4 Cab/ROPS/FOPS:

XD7.4.1 Does unit have fully enclosed cab with air conditioning, ROPS, FOPS, and rear screen X YES NO

X7.4.1.1 Does ROPS meet SAE J397-Oct. 95, SAFJ1040 May 94, ISO3471-94 ISO 3164-95 Standards X YES NO

X7.4.1.2 Does FOPS meet SAEJ231-Jan.81, ISO 3449 Standards X YES NO

X7.5 Winch:

X7.5.1 Is winch hydrostatic with variable control X YES NO

X7.5.2 Drum Capacity: 277 feet

X7.5.2.1 Winch rope diameter 5/8 inches with tail chain and hook X YES NO

Does it comply with winch specifications X YES NO

X7.5.3 Minimum line pull (full drum): 22,000 lbs./ kg

X7.5.4 Maximum line speed (full drum): 80 feet/min m/min

X7.5.5 Does winch meet or exceed all OSHA safety requirements X YES NO

X7.6 Undercarriage:

X7.6.1 Shoe width: 16.0 inches/ mm

X7.6.2 Does unit have standard rock guards on each end X YES NO

X7.7 Blade:

X7.7.1 Does unit have a 6 way blade X YES NO

X7.8 Paint (Describe proposed method of painting and color):

MANUFACTURE'S STANDARD PAINT _____

X7.9 Does unit comply with OSHA requirements **YES** **NO**

X7.10 Does unit comply with advertising guidelines **YES** **NO**

X7.11 Preventive Maintenance and Operators Orientation/Training:

X7.11.1 Will manufacturer or dealer conduct seminar at Buckhannon
 YES **NO**

X7.11.2 Will you furnish all training aids **YES** **NO**

RFQ No. 7011EC06

STATE OF WEST VIRGINIA
Purchasing Division

PURCHASING AFFIDAVIT

West Virginia Code §5A-3-10a states: No contract or renewal of any contract may be awarded by the state or any of its political subdivisions to any vendor or prospective vendor when the vendor or prospective vendor or a related party to the vendor or prospective vendor is a debtor and the debt owned is an amount greater than one thousand dollars in the aggregate

DEFINITIONS:

"Debt" means any assessment, premium, penalty, fine, tax or other amount of money owed to the state or any of its political subdivisions because of a judgment, fine, permit violation, license assessment, defaulted workers' compensation premium, penalty or other assessment presently delinquent or due and required to be paid to the state or any of its political subdivisions, including any interest or additional penalties accrued thereon.

"Debtor" means any individual, corporation, partnership, association, Limited Liability Company or any other form or business association owing a debt to the state or any of its political subdivisions. "Political subdivision" means any county commission; municipality; county board of education; any instrumentality established by a county or municipality; any separate corporation or instrumentality established by one or more counties or municipalities, as permitted by law; or any public body charged by law with the performance of a government function or whose jurisdiction is coextensive with one or more counties or municipalities. "Related party" means a party, whether an individual, corporation, partnership, association, limited liability company or any other form or business association or other entity whatsoever, related to any vendor by blood, marriage, ownership or contract through which the party has a relationship of ownership or other interest with the vendor so that the party will actually or by effect receive or control a portion of the benefit, profit or other consideration from performance of a vendor contract with the party receiving an amount that meets or exceeds five percent of the total contract amount.

EXCEPTION: The prohibition of this section does not apply where a vendor has contested any tax administered pursuant to chapter eleven of this code, workers' compensation premium, permit fee or environmental fee or assessment and the matter has not become final or where the vendor has entered into a payment plan or agreement and the vendor is not in default of any of the provisions of such plan or agreement.

Under penalty of law for false swearing (*West Virginia Code §61-5-3*), it is hereby certified that the vendor affirms and acknowledges the information in this affidavit and is in compliance with the requirements as stated.

WITNESS THE FOLLOWING SIGNATURE

Vendor's Name: RISH EQUIPMENT COMPANY

Authorized Signature: Paul Cabot Date: NOVEMBER 24, 2010

State of West Virginia

County of Harrison, to-wit:

Taken, subscribed, and sworn to before me this 23RD day of NOVEMBER, 20 10.

My Commission expires May 27TH, 20 11.

AFFIX SEAL HERE

NOTARY PUBLIC

Debra Sue Erickson

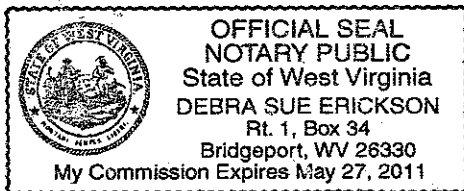

Rev. 09/08

State of West Virginia
VENDOR PREFERENCE CERTIFICATE

Certification and application* is hereby made for Preference in accordance with *West Virginia Code*, §5A-3-37. (Does not apply to construction contracts). *West Virginia Code*, §5A-3-37, provides an opportunity for qualifying vendors to request (at the time of bid) preference for their residency status. Such preference is an evaluation method only and will be applied only to the cost bid in accordance with the *West Virginia Code*. This certificate for application is to be used to request such preference. The Purchasing Division will make the determination of the Resident Vendor Preference, if applicable.

1. Application is made for 2.5% resident vendor preference for the reason checked:
 _____ Bidder is an individual resident vendor and has resided continuously in West Virginia for four (4) years immediately preceding the date of this certification; or,
 _____ Bidder is a partnership, association or corporation resident vendor and has maintained its headquarters or principal place of business continuously in West Virginia for four (4) years immediately preceding the date of this certification; or 80% of the ownership interest of Bidder is held by another individual, partnership, association or corporation resident vendor who has maintained its headquarters or principal place of business continuously in West Virginia for four (4) years immediately preceding the date of this certification; or,
 _____ Bidder is a nonresident vendor which has an affiliate or subsidiary which employs a minimum of one hundred state residents and which has maintained its headquarters or principal place of business within West Virginia continuously for the four (4) years immediately preceding the date of this certification; or,
2. Application is made for 2.5% resident vendor preference for the reason checked:
 Bidder is a resident vendor who certifies that, during the life of the contract, on average at least 75% of the employees working on the project being bid are residents of West Virginia who have resided in the state continuously for the two years immediately preceding submission of this bid; or,
3. Application is made for 2.5% resident vendor preference for the reason checked:
 _____ Bidder is a nonresident vendor employing a minimum of one hundred state residents or is a nonresident vendor with an affiliate or subsidiary which maintains its headquarters or principal place of business within West Virginia employing a minimum of one hundred state residents who certifies that, during the life of the contract, on average at least 75% of the employees or Bidder's affiliate's or subsidiary's employees are residents of West Virginia who have resided in the state continuously for the two years immediately preceding submission of this bid; or,
4. Application is made for 5% resident vendor preference for the reason checked:
 _____ Bidder meets either the requirement of both subdivisions (1) and (2) or subdivision (1) and (3) as stated above; or,
5. Application is made for 3.5% resident vendor preference who is a veteran for the reason checked:
 _____ Bidder is an individual resident vendor who is a veteran of the United States armed forces, the reserves or the National Guard and has resided in West Virginia continuously for the four years immediately preceding the date on which the bid is submitted; or,
6. Application is made for 3.5% resident vendor preference who is a veteran for the reason checked:
 _____ Bidder is a resident vendor who is a veteran of the United States armed forces, the reserves or the National Guard, if, for purposes of producing or distributing the commodities or completing the project which is the subject of the vendor's bid and continuously over the entire term of the project, on average at least seventy-five percent of the vendor's employees are residents of West Virginia who have resided in the state continuously for the two immediately preceding years.

Bidder understands if the Secretary of Revenue determines that a Bidder receiving preference has failed to continue to meet the requirements for such preference, the Secretary may order the Director of Purchasing to: (a) reject the bid; or (b) assess a penalty against such Bidder in an amount not to exceed 5% of the bid amount and that such penalty will be paid to the contracting agency or deducted from any unpaid balance on the contract or purchase order.

By submission of this certificate, Bidder agrees to disclose any reasonably requested information to the Purchasing Division and authorizes the Department of Revenue to disclose to the Director of Purchasing appropriate information verifying that Bidder has paid the required business taxes, provided that such information does not contain the amounts of taxes paid nor any other information deemed by the Tax Commissioner to be confidential.

Under penalty of law for false swearing (*West Virginia Code*, §61-5-3), Bidder hereby certifies that this certificate is true and accurate in all respects; and that if a contract is issued to Bidder and if anything contained within this certificate changes during the term of the contract, Bidder will notify the Purchasing Division in writing immediately.

Bidder: RISH EQUIPMENT COMPANY Signed: Paul Calvert
 Date: NOVEMBER 24, 2010 Title: GENERAL MANAGER

*Check any combination of preference consideration(s) indicated above, which you are entitled to receive.

- a) Other coverage (Power train, Hydraulic, etc.) requires sampling for the components covered.
- 4) The Customer must notify the Distributor promptly of any machine abnormalities in order to limit potential failure damage.
- 5) The Customer agrees to use only genuine parts of the Applicable Manufacturer (KAC) in the normal maintenance and repair of the machine for the term of this extended coverage.
- 6) All transportation costs and other related expenses are the Customer's responsibility.
- 7) The Customer must make the machine available for repairs, under the coverage, during normal working hours.
- 8) This coverage will expire on the date of sale or transfer of the machine unless the remaining coverage is transferred to the new owner within 15 days of the transfer and otherwise meets the required conditions, including approval by the Company and Distributor. Contact your Distributor for details.

C) ITEMS NOT COVERED

- 1) Travel Labor.
- 2) Charges related to transporting the product to and from the place at which coverage work is performed.
- 3) Freight charges related to transporting repair parts to or from the place at which coverage work is performed.
- 4) Premiums charged for overtime labor requested by the customer.
- 5) Any incidental costs such as, but not limited to: tolls, lodging, meals, etc.
- 6) All used goods of any kind.
- 7) Consumable parts such as, but not limited to: tires, tubes, wiper blades, V-belts, filters, cables, bulbs, condensers, spark plugs, fuses or carbon brushes.
- 8) Components such as, but not limited to: alternators, starters, batteries, wires, connectors, hoses, hose flange O-rings, etc.
- 9) Ground engaging tools such as, but not limited to: bucket and bucket teeth, ripper teeth and cutting edges.
- 10) Undercarriage pieces such as track with shoes, front idlers, top rollers, bottom rollers, sprockets, rock guards and deflectors.
- 11) Non-Komatsu attachments or components of any kind.
- 12) Damage to a covered component that is caused by a non-covered component.
- 13) Any damage as a result of maintenance or repairs performed by a non-Komatsu distributor

D) LIMITATIONS

- 1) This extended coverage applies only to mechanical breakdown or failures found during the coverage period due to a defect in material or workmanship. The Company shall not have any obligation under this coverage for:
 - a) **Replacement or rebuild of parts and/or components required because they have exceeded their expected life, or due to normal wear and tear, does not constitute a defect in material or workmanship. Therefore, such repairs are not covered under this coverage.**
 - b) Any defects caused by misuse, misappropriation, negligence, accident, unauthorized alterations or failure to maintain, repair or use in accordance with the most current operating instructions;
 - c) Defects or failures caused by any attachments or parts not manufactured by or approved by the Company and Machines which are not configured to published specifications (unless approved for warranty coverage through the Sales Engineering Support Team, SEST);
 - d) Failure to conduct normal maintenance and operating services, including and without limitation to, providing lubricants, coolant, fuel, tune-ups, inspections or adjustments;
 - e) Failure to maintain the KOWA oil sample schedule may void the extended coverage;

Additionally, note the following other limitations with respect to this coverage:

- 2) An authorized Distributor must carry out all repairs.
- 3) The distributor may not be reimbursed more than the actual claim amount. This total includes any combination of sources (customer, insurance, warranty coverage, etc)
- 4) This extended coverage is valid only for the machines and components of the Applicable Manufacturer in the USA, and Dressta and Galion machines in Canada.

E) OTHER CUSTOMER OR DISTRIBUTOR REQUIREMENTS

- 1) **Inspections**

F) SPECIAL CONDITIONS

- 1)

Remedies under this optional extended coverage are strictly limited to provision of replacement parts and repairs specifically provided. Except for such repairs and replacements, the Company and any Distributor shall in no event be liable for any other losses, damages, costs or expenses claimed by you, including but not limited to loss from failure of the machine to operate for any period of time, property damage and all other direct, indirect, special incidental, or consequential damages whether arising under contract, warranty, negligence, strict liability or any other legal theory whatsoever. The standard warranty and this optional extended coverage of workmanship and material are in lieu of all other warranties by the Company and Distributor whether expressed or implied by law. WITHOUT LIMITING THE GENERALITY OF THE FOREGOING, THE COMPANY AND DISTRIBUTOR MAKE NO WARRANTY OF MERCHANTABILITY OR FITNESS OF ANY PRODUCT FOR ANY PARTICULAR PURPOSE.

I have read the above terms and conditions and agree to abide by them for the period of coverage.

Customer's Signature

Distributor Signature

Customer's Name

Distributor Representative Name

Business Name

Distributor Name

Address

Address

City, State, Zip

City, State, Zip

Machine Brand

Machine Model

Today's Date

Serial No., Product Identification No.

Beginning Date

Engine, Model & Serial No.

Expiration Date Expiration SMR Hours

STRUCTURAL – FRAME AND BOOM & ARM INSPECTION INTERVALS	At 2500 hours	At 5000 hours	At 7500 hours	At 10,000 hours	Every 12 months or every 1000 hours* (after 10,000 total hours)	Every 12 months or every 2000 hours* (after 10,000 total hours)
Excavators larger than PC95 and smaller than PC600		X	X	X		X
Excavators PC600 and larger		X	X	X	X	
All Hydraulic Forestry	X	X	X	X	X	
Wheel Loaders larger than WA95 and smaller than WA700		X	X	X		X
Wheel Loaders WA700 and larger		X	X	X	X	
Crawler Loader		X	X	X		X
Crawler Carrier		X	X	X		X
Dozers larger than D21 and smaller than D275		X	X	X		X
Dozers D275 and larger		X	X	X		X
Wheel Dozer		X	X	X		X
All Trucks		X	X	X		X
Motor Grader		X	X	X		X
Crusher		X	X	X		X
Backhoe Loader		X	X	X		X
Skid Steer		X	X	X		X
Crane		X	X	X	X	
WA95 and smaller		X	X	X		X
Excavators: PC95 and smaller		X	X	X		X
Dozers D21 and smaller		X	X	X		X
* = Whichever occurs first						

WALK-AROUND

The D31-22 is the next addition to an all new HST dozer line based on the D51-22 design concepts. Some of these concepts include Super-slant nose, large mid-mount cab, and durable construction.

All-around Visibility

- Super-slant nose design
- Cab-forward design
- Integrated ROPS/FOPS (Level 2)

Increased Productivity

- Highest HP in its class
- Electronically-controlled hydraulically-driven fan
- Rigid track frame with in-shoe final drive
- High capacity Power Angle Tilt dozer blade
- Adjustable blade pitch

Easy Operation/Increased Operator Comfort

- Hydrostatic Transmission (HST) with electronic control
- Palm Command Control System (PCCS)
- New cab damper mounting system
- Large and quiet pressurized cab (optional)

Improved Durability

- Increased bushing diameter
- Heavy-plate steel used throughout
- Dozer frame with steel casting
- Strong modular design
- New heavy duty HST components

Easy Maintenance

- Electronic monitor panel with on-board diagnostics
- Rear-mount radiator with swing-up electronically-controlled hydraulically-driven fan
- Ground-level daily service checks
- KOMTRAX®

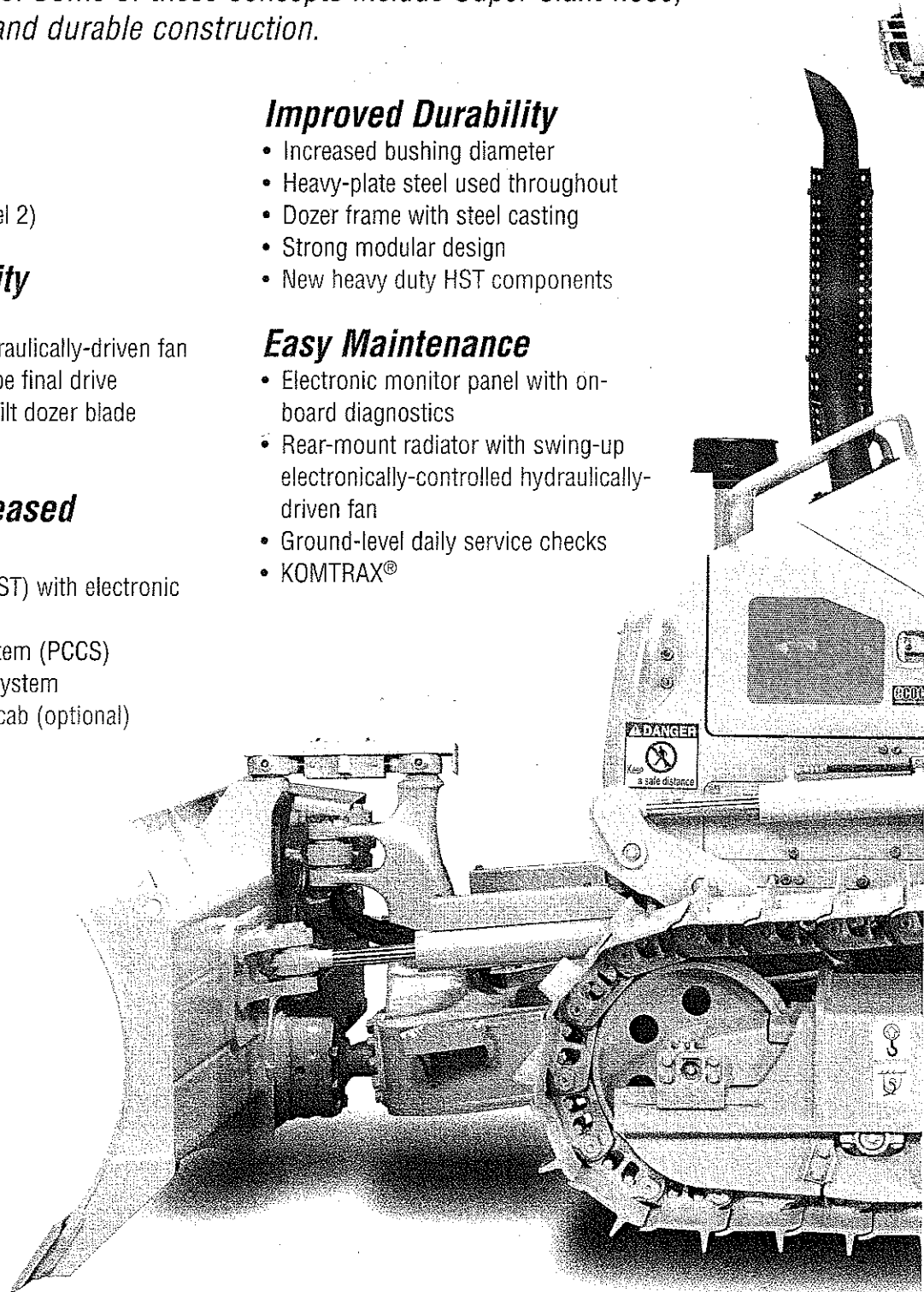

KOMTRAX

KOMTRAX equipped machines can send location, SMR and operation maps to a secure website utilizing wireless technology. Machines also relay error codes, cautions, maintenance items, fuel levels, and much more.



Great visibility r

Unrivalled blade visibility

Just like the D51EX/PX-22, the D31EX/PX-22 incorporates Komatsu's **super-slant nose** design. Komatsu's innovative design provides excellent blade visibility for improved machine control and increased efficiency and productivity.

OPERATOR COMFORT

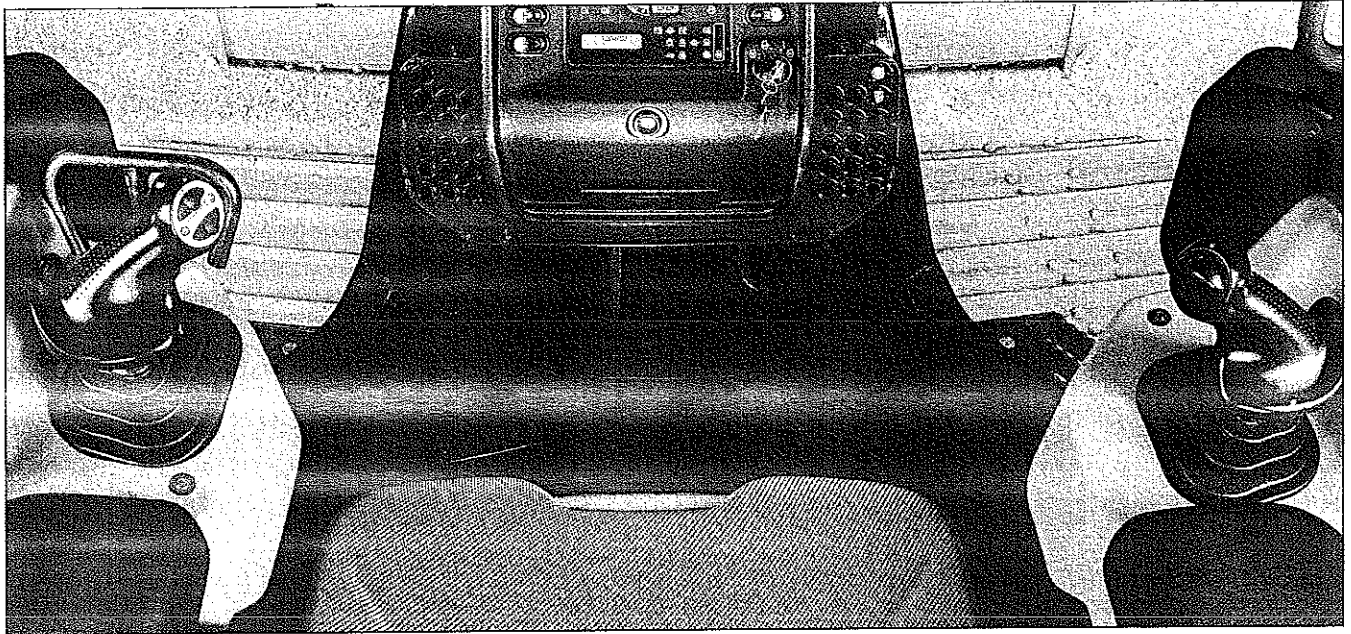

Hydrostatic Transmission (HST) with electronic control

The D31 is equipped with a Komatsu-designed Hydrostatic Transmission (HST), similar to the D51, that allows for Quick-Shift (3 speed) or variable (20 speed) selection. The HST consists of dual-path closed-circuits with two variable displacement piston pumps and two variable displacement travel motors. Hydrostatic steering eliminates steering clutches and brakes, providing smooth powerful turns. Fully electronic control provides automatic shifting and enables smooth operation. Engine speed is controlled using an electronic fuel control dial.

Comfortable ride with cab damper mounting

The D31 shares the same roomy cab as the D51 using a cab damper system that provides excellent shock and vibration absorption which conventional mounting systems are unable to match. The silicon oil filled cab damper mount helps to isolate the cab from the machine body, suppressing vibration and providing a quiet, comfortable operating environment.

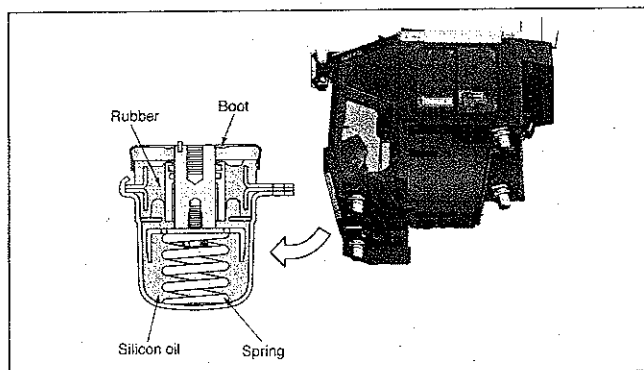

Palm command Proportional Pressure Control (PPC)

PPC-controlled palm command joystick provides blade control. Combined with the highly reliable Komatsu hydraulic system, precise control is the result.

Closed-center Load Sensing System (CLSS) hydraulic system

With CLSS hydraulics, blade lever stroke is directly proportional to blade speed, regardless of the load and travel speed. This results in superb fine controllability.

Palm Command Control System (PCCS)

The low-effort, ergonomic PCCS joystick controls all directional movements including machine travel speed as well as counter-rotation.

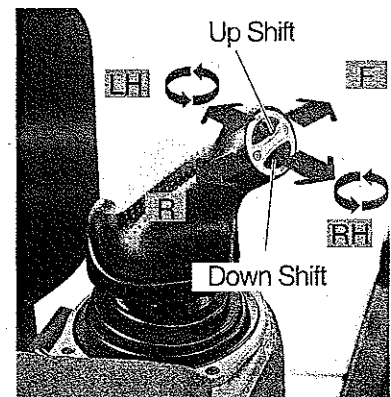

DURABILITY FEATURES

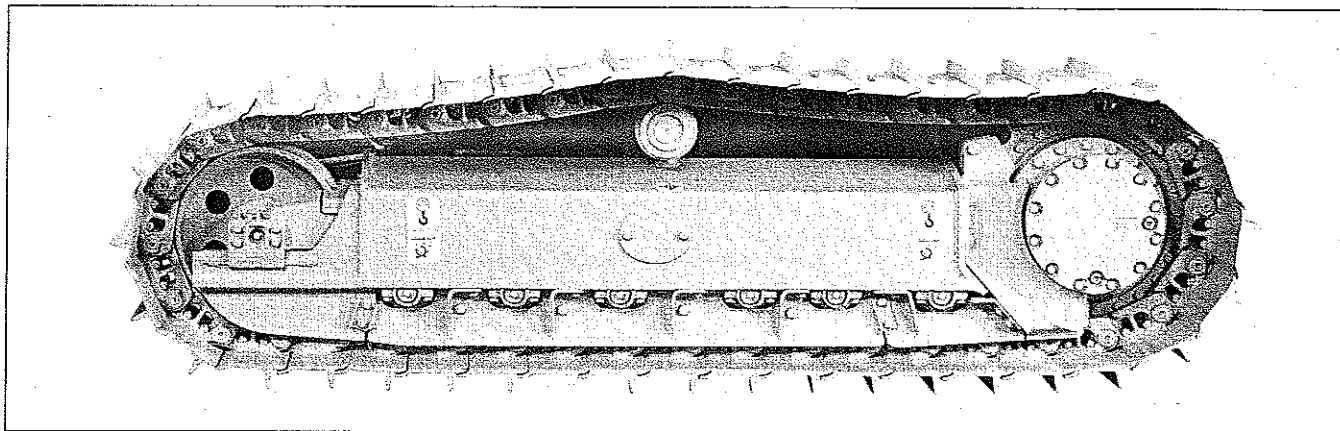

Heavy-duty undercarriage

Large links, large bushing diameters, and wide sprocket teeth extend undercarriage life.

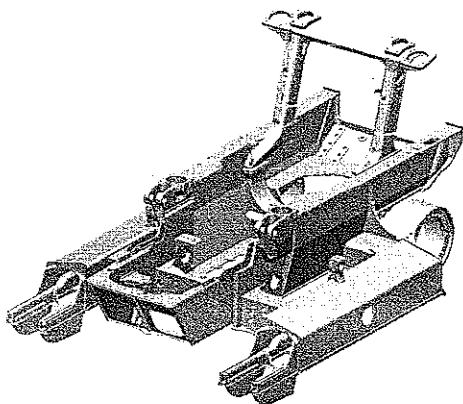

Durable and reliable main frame

Komatsu welds the track frames to the main frame with large connecting bars and weldments, providing the ideal stiffness required in a finish crawler dozer. The track frame is made of a solid one-piece design, reducing maintenance costs compared to designs that use multiple pieces and bolt-on covers.

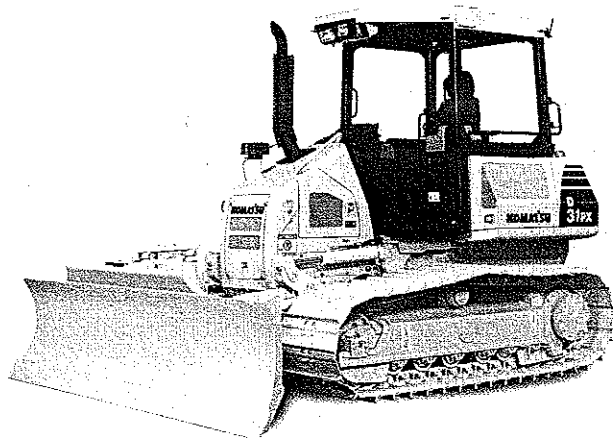

Modular design

Just like the D51, one of the design goals behind the creation of the D31 was to manufacture a more durable machine. This was achieved by reducing component complexity and using a strong modular design for increased serviceability and durability.

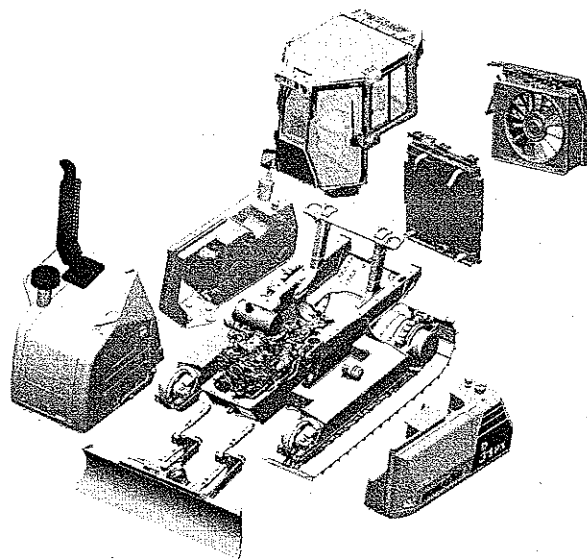

One-piece nose guard

Simplified high-rigidity structure with thicker plates reduces vibration and noise.

Strong and reliable drive train

Internal components of the HST pump have been increased in size for improved durability. This provides a strong and durable drive train that is designed to last. This system utilizes a new high efficiency filter and hydraulic tank cap. The cap now has a separate breather to minimize contaminants in the system.

PRODUCTIVITY FEATURES

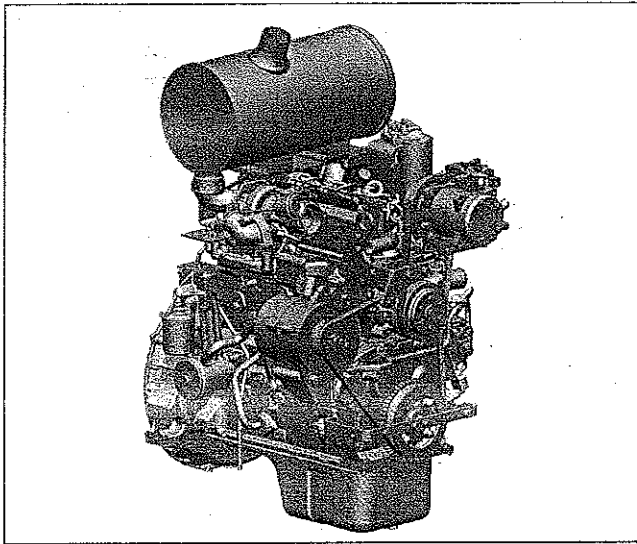

Long track-on-ground and rigid track frame

Long track-on-ground, rigid track frame improves machine final grading performance.

Adjustable pitch PAT blade

Blade pitch angle can be easily adjusted by changing the length of the pitch rod on the top of the blade. This enables maximum job efficiency in various material and ground conditions.

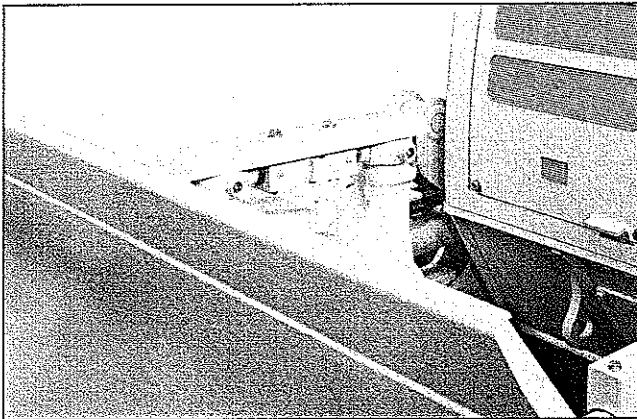

ecot3

ecology & economy - technology 3

This engine is EPA Tier 3 and EU Stage 3A emissions certified; "ecot3" - ecology and economy combine with Komatsu

technology to create a high performance engine without sacrificing power or productivity.

Fuel efficient electronic controlled engine

The Komatsu SAA4D95LE-5 engine delivers a net output of 58 kW **78 HP** at 2200 rpm*. The powerful Komatsu engine incorporated into the D31-22 makes this dozer fuel efficient and the logical choice in both grading and dozing operations. The engine is turbocharged and features direct fuel injection and air-to-air aftercooling to maximize power, fuel efficiency, and emission compliance. To minimize noise and vibration, the engine is iso-mounted to the main frame.

* ISO 9249/SAE J1349

Hydrostatic Transmission (HST) control system

The HST controller monitors engine output and work equipment/travel load. It controls HST pump and motor displacement to provide the optimum speed and drawbar pull. Power to both tracks during turns and counter-rotation makes the D31 extremely maneuverable.

Hydraulically-driven cooling fan

The engine cooling fan rotation speed and direction is electronically controlled. The fan rotation speed depends on engine coolant and hydraulic oil temperatures; the higher the temperature, the higher the fan speed. This system increases fuel efficiency, reduces operating noise levels, and requires less horsepower than a belt-driven fan. Additionally, cool ambient air is pulled in through perforations in the rear access doors adding to its cooling efficiency.

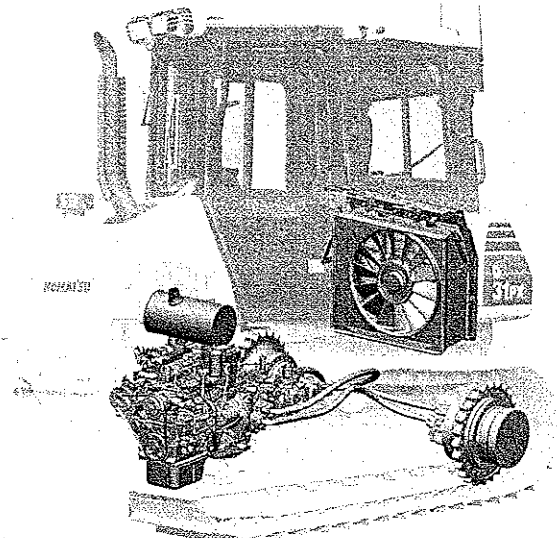

MAINTENANCE FEATURES

Hydraulically-driven swing-up fan

The D31-22 utilizes a swing-up fan with a gas strut-assisted lift locking system to provide easy access to the (side-by-side) radiator, oil cooler, and charge air cooler. The swing-up feature makes it easier to access cooling cores. The hydraulic fan has a "cleaning" mode. The fan rotates in the reverse direction and helps to clear off objects in front of the cooling areas. The fan is protected by thick steel louvers and an additional fan screen for added durability.

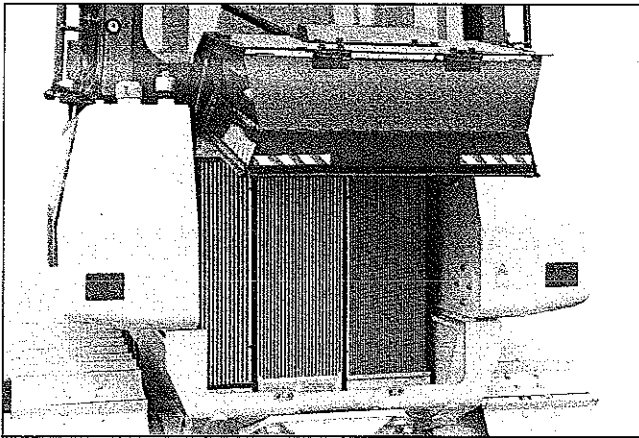

New monitor with self-diagnostic function

The monitor system provides critical information about the machine. It provides operating condition status and notifies the operator with a lamp and buzzer when an abnormality occurs. In addition, fault codes are indicated to aid troubleshooting and help reduce machine downtime. Service reminders for fluids and filters are also indicated. KOMTRAX adds a valuable dimension to troubleshooting and maintenance.

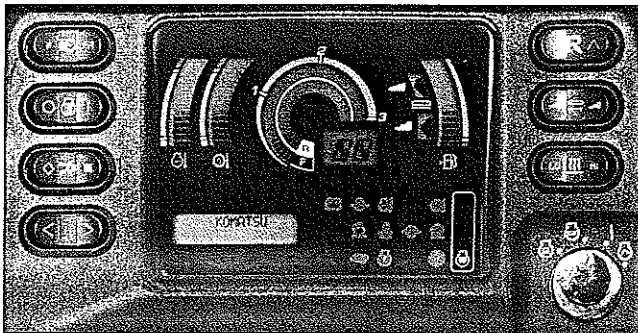

Daily checks

All daily checks can be performed efficiently at ground level from the left side of the machine.

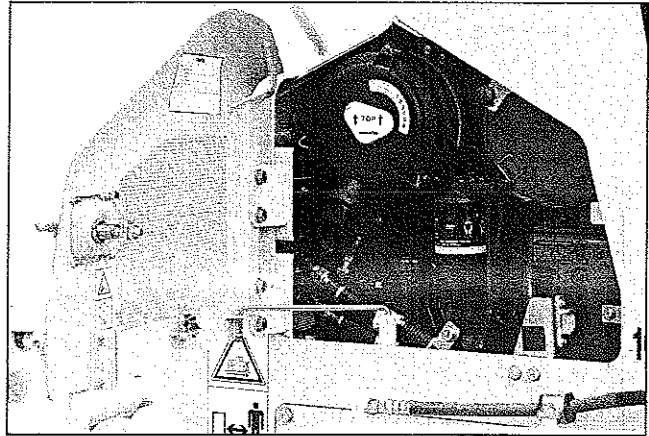

Adjustment-free parking disc brake

An adjustment-free spring-applied hydraulic-release wet parking brake is located in each final drive. Dynamic HST braking is used until the machine stops moving, then the parking brake engages, minimizing wear.

Easy engine oil drain

Changing the engine oil is easy with a strategically mounted access cover. There is no need to crawl under the machine to drain the engine oil.

Towing hitch

The optional hitch extends past the track to allow maximum angle when towing.

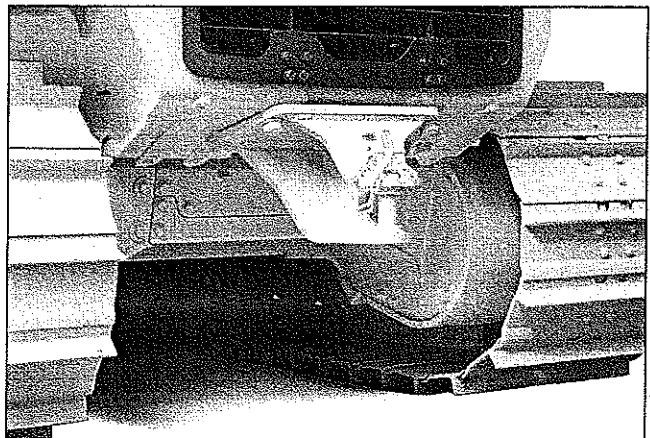

D31-22 CRAWLER DOZER

SPECIFICATIONS



ENGINE

Model Komatsu SAA4D95LE-5*
 Type 4-cycle, water-cooled, direct injection
 Aspiration Turbocharged, air-to-air aftercooled
 Number of cylinders 4
 Bore x stroke 95 mm x 115 mm **3.74" x 4.53"**
 Piston displacement 3.26 ltr **199 in³**
 Governor All-speed, electronic
 Horsepower
 SAE J1995 Gross 60 kW **80 HP**
 ISO 9249 / SAE J1349 Net 58 kW **78 HP**
 Hydraulic fan at maximum speed Net 53 kW **71 HP**
 Rated rpm 2200 rpm
 Fan drive type Hydraulic (reversible for cleaning)
 Lubrication system
 Method Gear pump, force lubrication
 Filter Full-flow

*EPA Tier 3 emissions certified



HYDROSTATIC TRANSMISSION

Dual-path, hydrostatic transmission provides infinite speed changes up to 8.5 km/h **5.3 mph**. The variable capacity travel motors allow the operator to select the optimum speed to match specific jobs. Travel control lock lever and neutral switch.

Travel speed (quick shift mode)	Forward	Reverse
1st	0-3.4 km/h 0-2.1 mph	0-4.1 km/h 0-2.5 mph
2nd	0-5.6 km/h 0-3.5 mph	0-6.5 km/h 0-4.0 mph
3rd	0-8.5 km/h 0-5.3 mph	0-8.5 km/h 0-5.3 mph

Travel speed (variable mode)	Forward	Reverse
	0-8.5 km/h 0-5.3 mph	0-8.5 km/h 0-5.3 mph

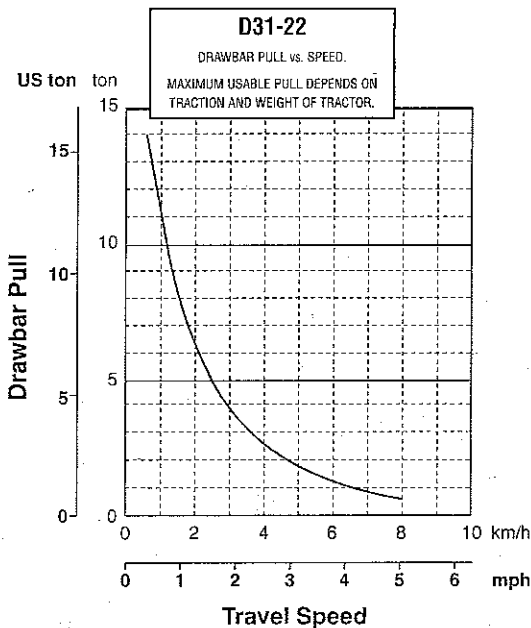

FINAL DRIVE

Two-stage planetary gear integrated into axial piston travel motors. Compact in-shoe mount reduces risk of damage by debris.



STEERING

Palm Command Control System (PCCS) joystick control for all directional movements. Pushing the joystick forward results in forward machine travel, while pulling it rearward reverses the machine. Simply tilt the joystick to the left or right to make a turn. Tilting the joystick fully to the left or right activates counter-rotation. Hydrostatic Transmission (HST) eliminates steering clutches and brakes, providing smooth powerful turns. Fully electronic control enables smooth control. The PCCS utilizes shift buttons to increase and decrease speed.

Minimum turning radius:
 D31EX-22 2.0 m **6'8"**
 D31PX-22 2.2 m **7'3"**

As measured by track marks on the ground at pivot turn.



UNDERCARRIAGE

Suspension Rigid track frame
 Track roller frame Solid one-piece, thick steel, durable construction
 Rollers and idlers Lubricated track rollers

Lubricated tracks

Unique seals minimize the entry of foreign abrasive material into pin to bushing clearances to provide extended service life. Track tension is easily adjusted with a grease gun.

	D31EX-22	D31PX-22
Number of track rollers (each side)	6	6
Type of shoes (standard)	Single grouser	Single grouser
Number of shoes (each side)	40	40
Grouser height	47 mm 1.9"	47 mm 1.9"
Shoe width (standard)	400 mm 16"	600 mm 24"
Ground contact area	17500 cm ² 2,713 in²	26200 cm ² 4,061 in²
Ground pressure (with dozer, ROPS cab)	46.1 kPa 0.47 kgf/cm ² 6.68 psi	32.3 kPa 0.33 kgf/cm ² 4.69 psi
Track gauge	1510 mm 4'11"	1650 mm 5'5"
Length of track on ground	2185 mm 7'2"	2185 mm 7'2"



COOLANT AND LUBRICANT CAPACITY (REFILLING)

Coolant 18 ltr **4.8 U.S. gal**
 Fuel tank 195 ltr **51.5 U.S. gal**
 Engine oil 11 ltr **2.9 U.S. gal**
 Hydraulic tank 60 ltr **15.9 U.S. gal**
 Final drive (each side) 3.5 ltr **0.9 U.S. gal**



OPERATING WEIGHT (APPROXIMATE)

Tractor weight:

Including ROPS canopy or cab, rated capacity of lubricant, coolant, full fuel tank, operator, and standard equipment.

D31EX-22 (ROPS canopy) 6570 kg **14,484 lb**
 D31PX-22 (ROPS canopy) 6910 kg **15,234 lb**
 D31EX-22 (ROPS cab) 7040 kg **15,521 lb**
 D31PX-22 (ROPS cab) 7320 kg **16,138 lb**

Operating weight:

Including PAT dozer, ROPS canopy or cab, operator, standard equipment, rated capacity of lubricant, coolant, and full fuel tank.

D31EX-22 (ROPS canopy) 7720 kg **17,020 lb**
 D31PX-22 (ROPS canopy) 8130 kg **17,924 lb**
 D31EX-22 (ROPS cab) 8190 kg **18,056 lb**
 D31PX-22 (ROPS cab) 8540 kg **18,827 lb**



DIMENSIONS

	D31EX-22		D31PX-22	
A	1280 mm	4'2"	1280 mm	4'2"
B	2550 mm	8'4"	3250 mm	10'8"
B*	—	—	2875 mm	9'5"
C	350 mm	1'2"	445 mm	1'5"
C*	—	—	390 mm	1'3"
D	2635 mm	8'8"	2635 mm	8'8"
E	870 mm	2'10"	860 mm	2'10"
F	390 mm	1'3"	380 mm	1'3"
G	2185 mm	7'2"	2185 mm	7'2"
H	4175 mm	13'8"	4155 mm	13'8"
I	2245 mm	7'4"	2245 mm	7'4"
I**	1785 mm	5'10"	1785 mm	5'10"
J	2945 mm	9'8"	2945 mm	9'8"
J**	2775 mm	9'1"	2775 mm	9'1"
K	2760 mm	9'1"	2760 mm	9'1"
L	47 mm	1.9"	47 mm	1.9"
M	1510 mm	4'11"	1650 mm	5'5"
N	400 mm	16"	600 mm	24"
O	1910 mm	6'3"	2250 mm	7'5"
P	2350 mm	7'9"	2980 mm	9'9"
P*	—	—	2640 mm	8'8"

* Narrow blade for D31PX-22
 ** For ROPS Canopy

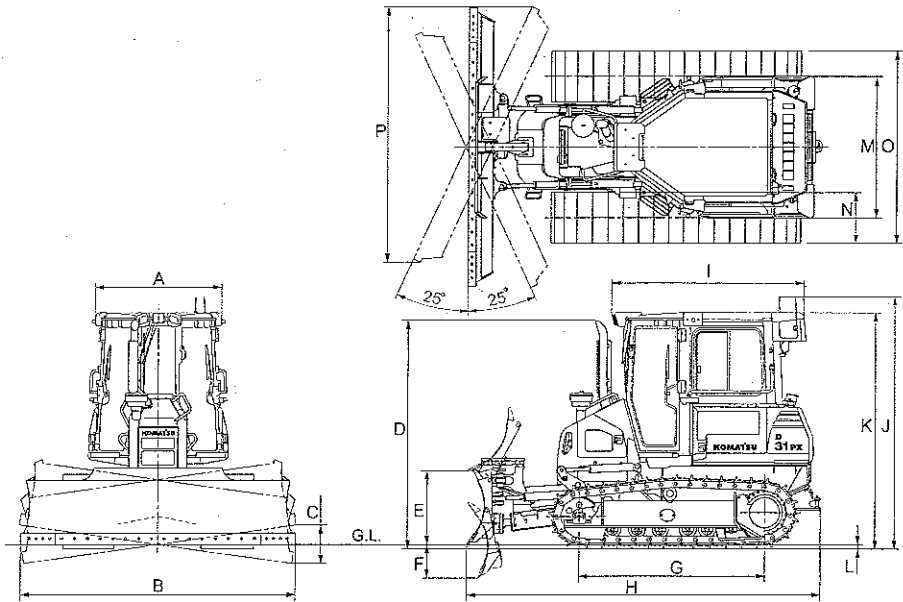

Ground clearance:
 D31EX-22 315 mm 12.4"
 D31PX-22 315 mm 12.4"



HYDRAULIC SYSTEM

Closed-center Load Sensing System (CLSS) designed for precise and responsive control and for efficient simultaneous operation.

Hydraulic control unit:

All spool control valves externally mounted remote to the hydraulic tank. Piston-type hydraulic pump with capacity (discharge flow) of 99 ltr/min **26.2 U.S. gal/min** at rated engine rpm.

Relief valve setting 27.4 MPa, 280 kg/cm² **3,983 psi**

Hydraulic cylinders Double-acting, piston type

	Number of cylinders	Bore
Blade lift	2	75 mm 2.95"
Blade tilt	1	90 mm 3.54"
Blade angle	2	80 mm 3.15"
Blade pitch	1 adjustable linkage	

Hydraulic oil capacity (refilling):

Power angle tilt dozer 60 ltr 15.9 U.S. gal

Control valves:

3-spool control valve for power angle tilt dozer.

Positions:

- Blade lift Raise, hold, lower, and float
- Blade tilt Right, hold, and left
- Blade angle Right, hold, and left

Note: Includes one additional spool for fan control.

Additional control valve required for ripper.

Positions:

- Ripper lift Raise, hold and lower



DOZER EQUIPMENT

Use of high tensile strength steel in moldboard for strengthened blade construction.

	Overall Length With Dozer*	Blade Capacity (SAE)	Blade Width x Height	Maximum Lift Above Ground	Maximum Drop Below Ground	Maximum Tilt Adjustment	Blade Angle
D31EX-22 PAT Standard Blade	4175 mm 13'8"	1.61 m ³ 2.11 yd ³	2550 mm x 840 mm 8'4" x 2'9"	870 mm 2'10"	390 mm 1'3"	350 mm 1'2"	25°
D31PX-22 PAT Standard Blade	4155 mm 13'8"	1.61 m ³ 2.11 yd ³	3250 mm x 750 mm 10'8" x 2'6"	870 mm 2'10"	390 mm 1'3"	445 mm 1'5"	25°
D31PX-22 PAT Narrow Blade	4155 mm 13'8"	1.60 m ³ 2.09 yd ³	2875 mm x 790 mm 9'5" x 2'7"	870 mm 2'10"	390 mm 1'3"	390 mm 1'3"	25°

* Including hitch



STANDARD EQUIPMENT FOR BASE MACHINE

ENGINE AND RELATED ITEMS

- Air cleaner, dry, double element type with caution lamp on monitor
- Decelerator pedal
- Engine, KOMATSU SAA4D95LE-5, net output of 58 kW 78 HP direct injection, turbocharged, air-to-air aftercooler, EPA Tier 3 emissions certified
- Fan, hydraulic driven, electronic control, reversible for cleaning
- Fuel pre-filter (10 micron) and fuel filter (2 micron)
- Grid heater
- Intake pipe with precleaner
- Radiator mask grid
- Radiator reserve tank
- Water separator

ELECTRIC SYSTEM

- Alternator, 35 amp (24 V)
- Back-up alarm
- Batteries, large capacity 92 Ah
- Starting motor, 4.5 kW

POWER TRAIN AND CONTROLS

- Brake pedal
- Counter rotation
- Electronically controlled Hydrostatic Transmission (HST) with Quick-shift and variable speed settings
- Palm Command Control System (PCCS) with electronic control for travel control
- Reverse speed presets

UNDERCARRIAGE

- Idler
- Sprockets, bolt-on, solid type
- Track roller guards, end sections
- Track shoe assembly w/sealed and lubricated link assembly:
 - D31EX-22: 400 mm 16" single grouser shoes
 - D31PX-22: 600 mm 24" single grouser shoes

GUARDS AND COVERS

- Crankcase guard and underguard
- Engine hood and side panels
- ROPS/FOPS*
- Sprocket inner guard

OPERATOR ENVIRONMENT

- Electronic monitor panel with on-board diagnostics
- Foot rests, high mounted
- Horn
- Rearview mirror
- Seat, suspension type
- Seat belt, 76 mm 3" wide retractable

HYDRAULICS AND CONTROLS

- Hydraulics for PAT dozer
- Palm Command Control System (PCCS) with Proportional Pressure Control (PPC) for blade control
 - Accumulator for Proportional Pressure Control (PPC)

VANDALISM PROTECTION

- Filler cap locks and cover locks
- Instrument panel lock and cover (canopy only)

OTHER STANDARD EQUIPMENT

- Grease gun holder
- High altitude arrangement (no fuel adjustment up to 2300 m 7,546 ft)
- KOMTRAX® function Level 2+
- Lighting package - (3 front, 1 rear cab/canopy)
- Marks and plates, English
- Pullhook, front

* ROPS cab or ROPS canopy must be ordered for all machines. Cab and canopy FOPS Level 2. ROPS/FOPS meets all OSHA/MSHA standards and regulations criteria.

Dozer assembly and rear-mounted equipment are not included in base machine price.



OPTIONAL EQUIPMENT

TRACK SHOE ASSEMBLY WITH SEALED AND LUBRICATED LINK ASSEMBLY

- D31EX-22
 - 460 mm 18" single grouser
- D31PX-22
 - 600 mm 24" swamp grouser

DOZER ASSEMBLY

- Variable pitch, power angle tilt dozer assembly, inside arms
 - EX: 2550 mm 8' 4" width blade
 - PX: 2875 mm 9' 5" width narrow blade
 - PX: 3250 mm 10' 8" width blade

TRACK ROLLER GUARDS

- Track roller guards, full length

HITCH

- Standard type

ELECTRIC SYSTEM

- Alternator, 60 amp (24 V)

REAR EQUIPMENT AND HYDRAULICS

- Ripper, multi-shank (D31EX-22 only)
- Rear hydraulics
- Winch

ROPS CANOPY

- ROPS canopy
- Lower heater
- Lunchbox holder
- Seat, suspension type, vinyl

ROPS CAB

- ROPS cab (includes air conditioner with heater, defroster, pressurizer, cup holder, lunchbox holder, radio, AM/FM, cassette, cigarette lighter (24 V), 12 amp (12 V) power port)
- Seat, suspension type, vinyl
- Seat, suspension type, fabric
- Seat, air suspension type, fabric

OPERATOR ENVIRONMENT

- Forestry guards for cab and canopy

AESS767-01

©2010 Komatsu America Corp.

Printed in USA

D01(1.5M)C

01/10 (EV-1)

KOMATSU®

