



The following documentation is an electronically-submitted vendor response to an advertised solicitation from the *West Virginia Purchasing Bulletin* within the Vendor Self-Service portal at ***wvOASIS.gov***. As part of the State of West Virginia's procurement process, and to maintain the transparency of the bid-opening process, this documentation submitted online is publicly posted by the West Virginia Purchasing Division at ***WVPurchasing.gov*** with any other vendor responses to this solicitation submitted to the Purchasing Division in hard copy format.

Header @ 1

General Information

Contact

Default Values

Discount

Document Information

Clarification Request

Procurement Folder: 1552053

Procurement Type: Central Purchase Order

Vendor ID: 000000201753

Legal Name: ALPHA ASSOCIATES INC

Alias/DBA:

Total Bid: \$0.00

Response Date: 11/20/2024

Response Time: 11:07

Responded By User ID: Diann.Clark

First Name: Heather

Last Name: Fox

Email: heather.fox@thinkalphafirst.c

Phone: 304-296-8216

SO Doc Code: CEOI

SO Dept: 0310

SO Doc ID: DNR2500000001

Published Date: 11/1/24

Close Date: 11/20/24

Close Time: 13:30

Status: Closed

Solicitation Description: A&E - Greenbrier River Public Access Sites

Total of Header Attachments: 1

Total of All Attachments: 1



Department of Administration
Purchasing Division
2019 Washington Street East
Post Office Box 50130
Charleston, WV 25305-0130

State of West Virginia
Solicitation Response

Proc Folder: 1552053
Solicitation Description: A&E - Greenbrier River Public Access Sites
Proc Type: Central Purchase Order

Solicitation Closes	Solicitation Response	Version
2024-11-20 13:30	SR 0310 ESR11202400000003590	1

VENDOR
000000201753
ALPHA ASSOCIATES INC

Solicitation Number: CEOI 0310 DNR2500000001
Total Bid: 0
Response Date: 2024-11-20
Response Time: 11:07:56
Comments:

FOR INFORMATION CONTACT THE BUYER
Joseph E Hager III
(304) 558-2306
joseph.e.hageriii@wv.gov

Vendor Signature X FEIN# DATE

All offers subject to all terms and conditions contained in this solicitation

Line	Comm Ln Desc	Qty	Unit Issue	Unit Price	Ln Total Or Contract Amount
1	Civil engineering				0.00

Comm Code	Manufacturer	Specification	Model #
81101500			

Commodity Line Comments:

Extended Description:

Design and Contract Administration of Greenbrier River Boat Launch Facilities New Construction.



Department of Administration
Purchasing Division
2019 Washington Street East
Post Office Box 50130
Charleston, WV 25305-0130

State of West Virginia
Centralized Expression of Interest
Architect/Engr

Proc Folder: 1552053

Doc Description: A&E - Greenbrier River Public Access Sites

Reason for Modification:

Proc Type: Central Purchase Order

Date Issued	Solicitation Closes	Solicitation No	Version
2024-11-01	2024-11-20 13:30	CEOI 0310 DNR2500000001	1

BID RECEIVING LOCATION

BID CLERK
DEPARTMENT OF ADMINISTRATION
PURCHASING DIVISION
2019 WASHINGTON ST E
CHARLESTON WV 25305
US

VENDOR

Vendor Customer Code:

Vendor Name : **Alpha Associates, Incorporated**

Address : **209 Prairie Avenue**

Street : **209 Prairie Avenue**

City : **Morgantown**

State : **WV**

Country : **US**

Zip : **26501**

Principal Contact : **Richard A. Colebank, PE, PS; President & COO**

Vendor Contact Phone: **(304) 296-8216**

Extension: **102**

FOR INFORMATION CONTACT THE BUYER

Joseph E Hager III
(304) 558-2306
joseph.e.hageriii@wv.gov

Vendor
Signature X

FEIN#

550516286

DATE **20 November 2024**

All offers subject to all terms and conditions contained in this solicitation



Division of Natural Resources

Architectural & Engineering Services

Greenbrier River Public Access Site

November 20, 2024



Alpha Associates, Inc.

Morgantown, WV 26501 | Martinsburg, WV 25401

Richard Colebank, PE, PS; President & COO

304.296.8216 ext. 102

rick.colebank@thinkalphafirst.com

<http://thinkalphafirst.com>

TABLE OF CONTENTS.

SECTION A

General Information	01-05
A. 1 Letter of Interest	1-2
A. 2 Firm Overview	3-4
A. 3 Statement of Qualifications	05

SECTION B

Technical Expertise	06-11
B. 1 Schedule & Budget.....	06
B. 2 Capacity & Software	07
B. 3 Funding Experience	08
B. 4 Cost & Budget.....	09
B. 5 Alpha's LEED/Sustainability	10
B. 6 Meet the Alpha Team.....	11

SECTION C

Management and Staffing Capabilities	12-21
C. 1 Key Personnel & Project Role	12-13
C. 2 Alpha Personnel Resumes & Certificates	14-21

SECTION D

Project Experience	22-33
D. 1 Ongoing & Completed WVDNR Projects	22-27
D. 2 Relevant Project Experience Projects	28-33

APPENDIX

E. 1 References	34
E. 2 Firm COA, COE & Insurance Certifications	35-37
E. 3 Mandatory WVOASIS Documents	38-39

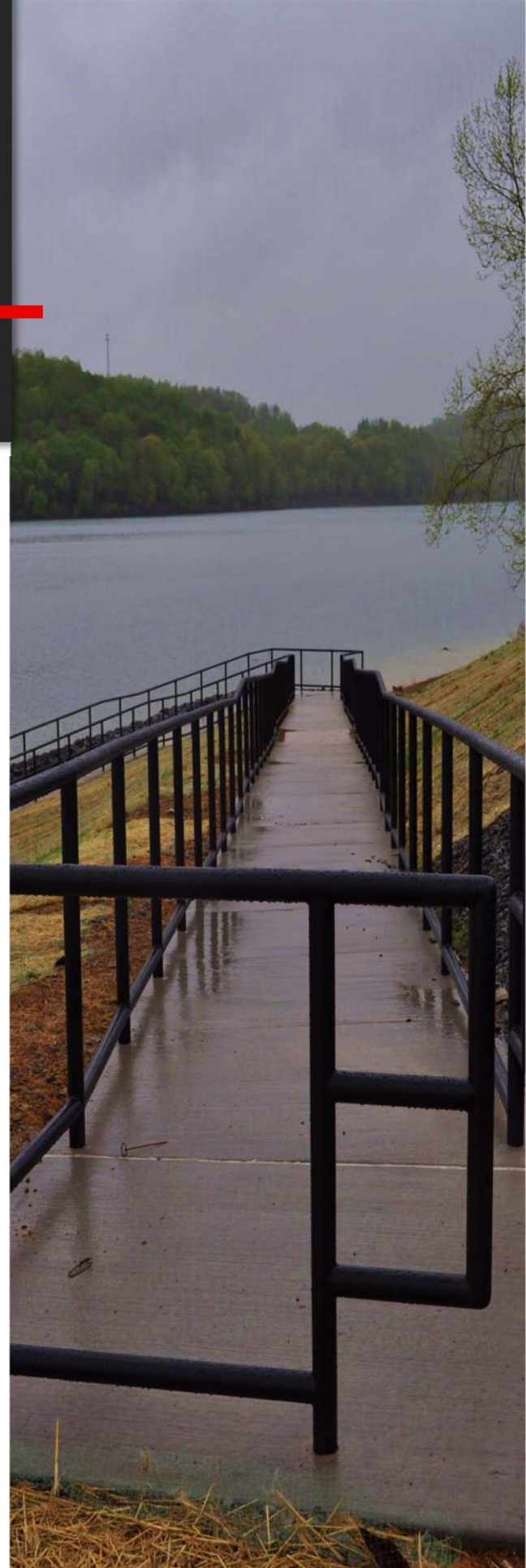



November 20, 2024

Department of Administration
Purchasing Division
2019 Washington Street East
Charleston, WV 25305

Attn: Joseph Hager III,

RE: A&E – Greenbrier River Public Access Sites

Dear Mr. Hager,

Alpha Associates, Incorporated, is pleased to submit our Expression of Interest to provide engineering services to the West Virginia Department of Natural Resources (WVDNR) for the renovation/construction of a new boat ramps and related facilities on the Greenbrier River in Hinton and Renick WV., including making the facilities ADA Accessible. In addition to the new boating ramp, Alpha would design the significant addition of required parking spots allotted for boating trailers and automobiles at the location. This project is very similar to the work we completed at Tygart Lake in the past couple of years.

Project Understanding

The Division of Natural Resources operates facilities on the Greenbrier River in Hinton and Renick WV. and wishes to construct a new boat ramp and related facilities. This project will include making the facilities ADA Accessible. Specific improvements considered presently can be described as the construction of a new boat ramp, and the addition of required parking spots for town vehicles and trailers and depending on the evaluation results there may be related and connected improvements. Any required Health Department, DEP permitting and USCOE Permitting will be handled by Alpha.

Design Team

Alpha is proud to promote that we are a wild and wonderful West Virginia owned and operated engineering/architectural firm with 54+ years history carried throughout the State. Our 21-person strong professional staff include architecture, civil and structural engineers, surveyors, cost estimators, construction representatives, landscape designers, interior designers, and technicians. Talk about quite the house blend of skills. The personnel assigned to your project are dedicated and highly qualified professionals with support and technical expertise to meet and surpass your expectations.

Project Familiarity

Alpha has completed numerous boat ramps, ADA compliant ramps and parking area projects over our more than 54 years of providing professional engineering services. Many of these projects included parking and maneuvering for trucks and vehicles with trailers. Alpha's staff includes Professional Engineers, as well as additional engineering technicians, surveyors, and landscape designers who are available to assist with all your project needs. The WVDNR has engaged with Alpha on numerous projects, including boat ramp renovations and parking lot expansions at Tygart Lake State Park for

improved recreational opportunity, a recent structural assessment of the iconic overlook pedestrian bridge at Coopers Rock State Forest, and the ongoing new aerial tramway system projects at both Hawks Nest State Park and Pipestem Resort State Park.

Summary

Alpha Associates, Incorporated, is excited for the opportunity to work with the WVDNR on another project. Our dedicated team of professionals will make **YOUR PROJECTS A PRIORITY**. We appreciate your time and consideration of Alpha for these upgrades. Please contact me at (304) 296-8216 ext. 102 if you have any questions or require additional information.

Sincerely,

Alpha Associates, Incorporated

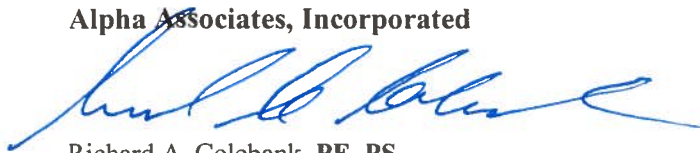

Richard A. Colebank, PE, PS

President and COO

rick.colebank@thinkalphafirst.com

(304) 296.8216 ext. 102



Two West Virginia Owned and Operated offices in Morgantown and Martinsburg which offer multiple in-house services. Everyone at Alpha Associates, Inc. shares the same goal of exceeding expectations and successfully accomplishing projects.

Architecture

Commercial

Public

Private

Residential

Civil/Structural Engineering

Enhance

Conservational

Leadership

Surveying

Accurate

Clearly Communicated

State-of-the-Art

Alpha's clients are served by a local, unique combination of professionals who provide top-notch architectural design, civil engineering and structural engineering. The Alpha design experience begins with the design staff listening, interpreting, reviewing and designing what you, the client, wants. The conclusion of the design process is not the end of Alpha's involvement in your project. Alpha's staff will stay involved until your project is constructed.

"The engineer always has been, and is, a maker of history."

- James Kip Fitch

Throughout Alpha's decades of practice, our architects and engineers work closely, making history every day. With support from the Alpha Team, one can truly create a sense of place and a proper environment for the built atmosphere.

The firm mantra has always been to "*do good work*" and that philosophy is carried on today.



*Tygart Lake State Park -
Boating Facilities Improvements*

***"Creating client-focused,
innovation designs with
quality and value that
are sustainable and
cost-effective"***

LOCATIONS:

209 Prairie Avenue
Morgantown, WV 26501
304.296.8216

535 West King Street
Martinsburg, WV 25401
304.264.0051

WEBSITE:

<https://thinkalphafirst.com/>

EMPLOYEES:

21

Webster's dictionary defines Alpha as "the first, the beginning". In the case of Alpha, the beginning was 1969 and the location was Morgantown, West Virginia. Since 1969, Alpha has earned a reputation for producing exceptional architectural and engineering designs for high profile organizations. By 1995, Alpha's client base had grown, demanding the need for a second location. The Eastern Panhandle of West Virginia was selected and the planning began.

The Eastern Regional Office is located in Historic Downtown Martinsburg and is conveniently located to serve clients in West Virginia, Maryland, Virginia and Pennsylvania. We continue to raise the bar with a design studio of cross-disciplined professionals that embrace technology and innovation while treating you, the client, with respect and dignity.

As you travel through the region, you will find Alpha's influence on the built environment, especially in West Virginia. Alpha's local project success reflects an architectural studio which encourages creativity and flexibility. Continuing the focus of success, Alpha's architectural and engineering teams are experts with the planning of solutions for complex issues even before facing them head-on. Alpha's team consists of industry leaders, consistently being called upon for advice and guidance for the future. Alpha Associates, Inc. will surpass all expectations while maximizing the client's, your, vision.

With our client-first mission, we design spaces for now and the future.

Think Alpha First!

STATEMENT OF QUALIFICATIONS.

Alpha Associates, Incorporated is a local, West Virginia based Architectural/Engineering design firm that provides services in the areas of architectural design, interior design, construction administration, civil engineering, structural engineering, landscape design, project management and surveying. Our clients benefit from our unique combination of extensive design and construction experience, advanced technological tools, dedicated principals and highly skilled staff members. Alpha's work is diverse and includes clients in commercial, educational and government facilities, developers and private organizations.

Since 1969, Alpha's team provided architectural/engineering design services throughout the State and surrounding areas. For over 54+ years, we have worked with numerous local, state, and federal government entities on multiple projects of varying sizes and types. No project is too big or too small for us. Our team of licensed architects and engineers have recent, relevant experience with land assessment, civil/site planning, schematic and design layout, document preparation, and construction/bid administration to complete projects seamlessly.

Alpha's philosophy has always been to provide exemplary services for fair fees. We have always believed that the best way to succeed as a business is to go above and beyond the basic requirements of our contracts and take every step necessary to successfully complete and surpass a given project. We act in the client's best interest.

Everyone at Alpha, no matter the given role, all work towards the same goal of achieving success for not the project but the client too. Our principals are involved with all projects from the earliest stages through to the final completion and even beyond. They will consistently update you on your projects by using effective communication tools to manage the projects and all involved parties. Our skilled staff of architects, engineers, surveyors and administrative personnel at Alpha are professionals dedicated to providing superior services to the State of West Virginia and surrounding areas. While our staff is large enough to handle any size project, our firm is also capable of being small enough to give each and every one of our projects the individual attention to details it deserves. Alpha's local and unique approach to projects ensures success for all our clientele.



SCHEDULE & BUDGET.

Project Track Record

Alpha Associates, Incorporated has an excellent track record of producing projects on time and within the Owner's budget. Many A/E firms can claim the same successes; however, the determining factor is the tools a firm utilizes to achieve the budgets, in regards to funds at that time. Alpha utilizes a number of both traditional & modern tools to exceed our client's expectations.

A project schedule is a dynamic, ever-changing entity. Your project schedule depends on many factors including:

- α Preferred construction method
- α Changes to project scope
- α Unique construction elements

Successful Project Management/Schedule

Successful project management depends on consensus regarding work efforts, milestones and goals. Our team has found the development of detailed work plans, which delineate tasks and deliverables for each project phase, in consort with the client and full project team, is the most effective approach with establishing expectations of efforts required by the respective disciplines. In addition to guiding the efforts of the design team, the work plan sets forth specific time frames and decision points for the Owner and user reviews, comments and/or approvals.

Developing an overall project schedule is a critical task that must take account of many factors: building type, owner's desired occupancy, scope of work & level of documentation, whether contract(s) is bid or negotiable, available fee, and experiences on similar projects. Once the design process begins, a comprehensive, realistic project schedule can be developed and communicated to all involved.

In a world where "time is money", the schedule of a project is as important as controlling the cost. Alpha works diligently to control the budget of a project and avoid the "scope creep" which can occur.

Alpha's Unique In-House Features

Alpha's in-house cost estimators combined with our excellent relationships with contractors throughout the State provides the client with the most accurate estimates early in the design process. The Alpha estimators begin at the schematic design phase of the project and develop a line-item estimate of probable construction costs which can be carried through each of the project phases. At each phase, the estimate is updated to include a more detailed evaluation for enhanced accuracy. When updating estimates, specific increases or decreases can be identified allowing the owner to make informed decisions on important budget issues for the project.

Many projects use alternatives to control the budget through obtaining actual contractor pricing during the bid process. This allows flexibility in the owner's determining costs of portions for the project which may be optional and/or critical for budget control.

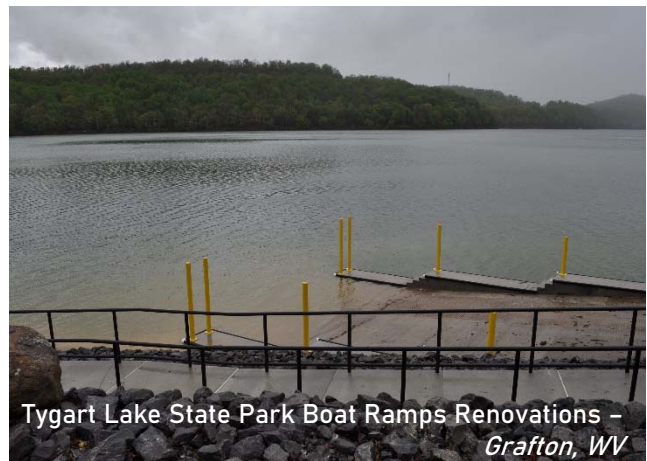

Tygart Lake State Park Boat Ramps Renovations -
Grafton, WV

CAPACITY & SOFTWARE

OUR CAPABILITIES

Alpha Associates, Incorporated is prepared to commit staff and resources to your project. Alpha has the qualified and experienced personnel, administrative support, along with the production equipment and resources, to ensure the successful completion of this project. We are confident in our ability to provide you with a committed and dependable design team. Our multidisciplinary design team is prepared to meet and exceed the expectations for your project by committing any resources necessary to meet the project schedule.

USING THE LATEST SOFTWARE

The project team incorporates the latest computer and software capabilities required to complete the working drawings and specifications of this project. Our cost accounting system is top-of-the-line and we have the ability to differentiate fees according to task. We have secure e-mail and internet capability to allow efficient transfer of information between Alpha and the client. We currently have the latest editions of the following software:

- α AutoCAD24
- α REVIT
- α Civil 3D
- α RISA 3D
- α RISA Foundation
- α MathCAD Prime
- α DJI Phantom 4 RTK Drone
- α Office 365
- α Autodesk Civil 3D
- α Autodesk Suite
- α Autodesk Revit
- α Bentley Open Bridge Modeler & Designer
- α Enercalc
- α AutoTURN
- α TopCON GR5 GPS System
- α TopCON Total Station with Reflector-less Capabilities
- α Carlson Surveyor & Data Collector



FUNDING EXPERIENCE

Throughout our 54 years of business, Alpha Associates, Incorporated has worked with multiple funding agencies on projects, including State and Federal dollars. Our funding experience includes:

- State and Federal ARRA Funds
- West Virginia Infrastructure Loan Program
- HUD Grants and Loans
- West Virginia Economic Development Grants and Loans
- Transportation Enhancement Grants
- West Virginia State Historic Preservation Office Funds
- Small Cities Block Grants
- Tax Increment Financing
- BIG Grant (Boating Infrastructure Grant)
- USDA Rural Development/Rural Utility Service- Grants and Loans
- ARC
- School Building Authority of West Virginia
- WV DEP Revolving Loan Fund
- WV Bureau of Health Clean Water Loan Fund
- Private Bond Sales

CZnu Žy& , u

Alpha Associates, Incorporated has an excellent record of budget control. Our in-house estimators, combined with an excellent relationship with contractors throughout the area allow us to develop accurate estimates early in the design process. The Alpha estimators begin at the schematic design phase of the project and develop a line item estimate of probable construction costs that can be carried through each of the project phases. At each phase, the project estimate is updated to include a more detailed estimate so that accuracy can be enhanced. During these updated estimates, specific increases or decreases can be identified allowing the owner to make informed decisions moving forward on the important budget issues for the project.

Many projects employ the use of alternatives to control the budget through obtaining actual contractor pricing during the bid process. This allows flexibility for the owner in determining the costs of portions of the project that may be optional and critical for budget control.

Below you will find several examples where Alpha was able to execute projects successfully within a reasonable budget.

Jefferson County Emergency Services Agency

Estimate:	\$ 1,230,651. 26
Bid Amount:	\$ 1,219,000. 00
Change Order:	\$ 4,354. 52
Final Budget:	\$ 1,223,354.52



Berkeley County Emergency Ambulance Authority

Estimate:	\$ 345,463.30
Bid Amount:	\$ 399,400.00
Change Order:	\$ 23,859. 91
Final Budget:	\$ 423,259. 91



Clear Mountain Bank – Oakland, MD

Estimate:	\$ 1,922,615. 80
Bid Amount:	\$ 1,925,948.00
Change Order:	-\$ 37,405.00
Final Budget:	\$ 1,888,543.00





LEED/SUSTAINABILITY

As the intellectual landscape of the new century becomes more and more environmentally conscious, there is increasing demand to see this attitude reflected in the “built environment” with which we surround ourselves. The measure of a project’s success is increasingly dependent on its environmental, as well as economic and social innovation. A truly holistic approach to sustainable design must recognize the impacts of every design choice on natural and cultural resources. Aside from being attractive and enjoyable for humans, sustainable projects promote biological diversity, contribute to the quality of the air and water and reduce the impacts of construction and human use to help preserve the planet for future generations.

Alpha Associates, Incorporated understands the importance of sustaining the environment for future generations. Alpha works closely with the client to determine the level of environmental impact that the project will have. For example, Alpha works very hard to preserve and reuse equipment and building materials where necessary. Projects that have been designed include reuse of elements from stained glass windows to commercial cafeteria equipment.

Our Design Team will make sure your facility is designed with cost effective, energy conserving features. Where appropriate, we provide the ability to obtain any level of LEED Certification that you may desire, or we can simply utilize the principals of sustainable design to benefit your project.



The firm currently has three professional staff members who are LEED Accredited Professionals. We have two projects that are LEED registered; The FBOP Hazelton Facility and the new State Office Building in Clarksburg, WV.

MEET THE ALPHA TEAM.

MANAGERS

Richard A. Colebank
PE, PS
 President & COO

ARCHITECTURE

Rebecca Key
AIA-LEED-AP
 Director of Architecture

Todd Lewis
AIA Associate
 Architectural Technician

Alex Hail
 Construction
 Administration

CIVIL ENGINEERING

Charles Branch
PE, Senior Principal
 Senior Civil Engineer

Bradley Casdorff
PE, PS
 Civil Engineer

Richard W. Klein
PE, PS
 Director of Surveying

Julie Frazee
 Engineering
 Technician

Kevin McClung
 Engineering
 Technician

Barbara Kerns
 Survey Crew

Nick Perry
 Survey Crew

STRUCTURAL ENGINEERING

Charles Luttrell
PE, Senior Principal
 Senior Structural Engineer

Matthew Echard
PE, Principal
 Structural Engineer

Cody Antoon
 Engineering
 Technician

OFFICE ADMINISTRATION

Heather Fox
 Business Manager

Mia Larkin
 Marketing Coordinator

Kim Coomler
 Administrative

KEY PERSONNEL.

TO BE ASSIGNED TO YOUR PROJECT

All work performed for the WVDNR will be managed out of Alpha's Morgantown office. In addition to your dedicated project team, Alpha's staff of 21 includes engineers, architects, architectural designers, technicians and support staff that are available to assist you with any potential project need. Rick Colebank will serve as the project's Principal-in-Charge and Chuck Branch will serve as the day-to-day contact for the Project Team.



Richard "Rick" Colebank
PE, PS, President & COO
Principal in Charge



Charles "Chuck" Branch
PE, Senior Principal
Civil Engineer



Bradley Casdorff
PE, PS
Civil Engineer



Charlie Luttrell
PE, Senior Principal
Lead Structural Engineer

EXPERIENCE OF KEY PERSONNEL

Key Personnel <i>Role</i>	Description of Role	Licensed Architect/Engineer	Construction Administrator	Work w/ Similar Project/Scope	Experienced with BIM
Richard “Rick” Colebank, PE, PS <i>Managing Principal</i> Alpha Associates, Inc.	Mr. Colebank is responsible for overall management of the project and the coordination of partners and consultants. He is the spokesman for the team and will be involved from inception to completion of the project, bringing his 40 years of experience for benefit of the project.	X		X	
Charles “Chuck” Branch, PE <i>Co-Project Manager, Civil Engineer</i> Alpha Associates, Inc.	Mr. Branch will work hand-in-hand with Mr. Colebank to successfully direct the day-to-day operations of the project team including the Owner, Partners and consultants. He will also provide civil engineering services.	X		X	
Bradley Casdorff, PE, PS <i>Civil Engineer</i> Alpha Associates, Inc.	Mr. Casdorff is bringing his 41 years of professional experience to this project with services including conveyance and detention, environmental permitting, project administration supervision and inspection, as well as boundary and construction surveying.	X		X	
Charles “Charlie” Luttrell, PE <i>Lead Structural Engineer</i> Alpha Associates, Inc.	Mr. Luttrell will provide lead the structural team directing major decisions regarding the design and construction of the structural systems and will ensure QA/QC procedures are maintained.	X		X	
Alex Haill, Associate AIA <i>Construction Administrator</i> Alpha Associates, Inc.	Alex will be the primary direct contact for information flow during construction of the project including receipt, distribution, returns of RFI's, Shop Drawings, and other submittals. He will periodically inspect the project and file reports on the progress and concerns during the construction. He will lead the construction administration team.		X	X	



Richard Colebank PE, PS

PRESIDENT & COO

SUMMARY

Mr. Colebank is President and Chief Operating Officer at Alpha. He has been with Alpha Associates, Inc. since 1985. He began his career with Alpha as a staff engineer and progressed through the ranks from Project Manager to his current position. Mr. Colebank has worked with diverse clients such as WVU, City of Morgantown, WVDOH, WVU Foundation, and the Morgantown Municipal Airport, as well as numerous other public and private clients. Since 1988, Mr. Colebank has been the Principal-In-Charge of the Civil Engineering projects developed by Alpha. In his current capacity, Mr. Colebank provides financial and administrative guidance for the day-to-day operations of the company while managing projects.

PROFILE

Broad-based responsibilities in the following areas:

- Project Management
- Business Operations & Financial Management
- Quality Assurance/Quality Control
- Civil Engineering Project Management and Design
- New Business Development
- Expert Testimony and Investigation

PROFESSIONAL HIGHLIGHTS

Project Principal

Morgantown Municipal Airport Access Rd; Morgantown, WV
 Mon General Access Rd; Morgantown, WV
 WVU Reedsville Farm Redevelopment; Reedsville, WV
 Monongalia General Hospital Access Road; Morgantown, WV
 DOH Martinsburg Train Station Corridor Streetscape; Martinsburg, WV
 WV State Office Building; Parkersburg, WV
 College of Physical Activity & Sports Science; Morgantown, WV
 WVDOH Open End Engineering Contract; WV
 WVDOH Deckers Creek Pedestrian Bridge; Morgantown, WV
 Clarksburg State Office Building; Clarksburg, WV
 Jane Lew Truck Stop; Jane Lew, WV
 Grant County Bank Addition & Renovation; Petersburg, WV
 South Berkeley Fire Station; Inwood, WV

EMPLOYMENT HISTORY

1985-Current | Alpha Associates, Inc.
 1983-1985 | Charles Townes & Assoc. P.C.
 1983 | US Army Corps of Engineers

EDUCATION

MA Business Administration | 1999
 BA Civil Engineering | 1982

QUALIFICATIONS

- License: Professional Engineer: West Virginia, Maryland, Pennsylvania, and Virginia
- Professional Surveyor: West Virginia
- Certified Private Pilot

AFFILIATIONS

- Former NSPE/PEPP Governor of WV
- American Red Cross - State Board
- University High School Foundation; Charter Member; President
- Morgantown Area Chamber of Commerce; Past Chairman
- WVU College of Civil & Environmental Engineering Visiting Committee
- WVU College of Business & Economics MBA Advisory Committee
- WVU 2023 Academy of Civil Engineers



STATE BOARD OF REGISTRATION FOR PROFESSIONAL ENGINEERS

To all to whom these presents shall come, Greeting.

Know Ye That The State Board of Registration for Professional Engineers, of the State of West Virginia, reposing special confidence in the Intelligence, Integrity and Discretion of

Richard A. Colebank

DOES, IN PURSUANCE OF AUTHORITY VESTED IN IT
by law, hereby certify that he, having submitted satisfactory evidence of his ability and experience, is a
REGISTERED PROFESSIONAL ENGINEER

Registration Number 10346

To Hold and use such title in the practice of his profession, subject to the conditions prescribed by law.



Given under the hand and the Seal of the Board at the Capitol in the City of Charleston, this 23rd day of Feb. in the year of our Lord One Thousand Nine Hundred and Eighty-Eight and of the State the One Hundred Twenty-Fourth.

STATE BOARD OF REGISTRATION FOR PROFESSIONAL ENGINEERS

Frank L. Gaddy
 Frank L. Gaddy

Secretary *Monroe P. Jickles* *President*
 Kenneth H. Means Robert B. Scott



Charles Branch PE

SENIOR PRINCIPAL & CIVIL ENGINEER

SUMMARY

As Chief Engineer for site development and planning projects, Mr. Branch is a vital part of the design process at Alpha. His involvement spans from solely civil engineering projects to the design of large-scale educational projects and medical facilities. Mr. Branch acts as peer review for young engineers in the firm on issues ranging from storm water management to site design. Mr. Branch is also involved in commercial and residential development design, roadway and bridge design and utilities layout.

PROFILE

Broad-based responsibilities in the following areas:

- Highway Design
- Municipal Engineering
- Wastewater Collection
- Storm Sewer System Design
- Storm Water Management
- Site Engineering
- Project Management

PROFESSIONAL HIGHLIGHTS

Civil Engineer/Project Manager:

Jane Lew Truck Stop; Jane Lew, WV
 Clarksburg State Office Building; Clarksburg, WV
 WVU Reedsville Farm Redevelopment; Morgantown, WV
 Freedom Automotive Group Dealerships; Morgantown, WV
 Freedom Kia; Clarksburg, WV
 WVU Parking Lot 81 Renovations; Morgantown, WV
 WVU Doll's Run Burn Room; Morgantown, WV
 WVU Alumni Center Parking Lot; Morgantown, WV
 WVU Alumni Center Storm Water Management; Morgantown, WV
 WVU Health Sciences Center Eastern Division; Martinsburg, WV
 WVDOH Martinsburg Train Station Corridor Streetscape; Martinsburg, WV
 WVDOH I-77 Welcome Center; Williamstown, WV
 WV Medal of Honor Recipients Plaza; Hazleton, WV
 Lewis County High School Bridge; Weston, WV
 Wyoming County Route 10 Relocation; Wyoming County, WV
 Fairmont Federal Credit Union; Bridgeport, WV
 Queen St Underpass; Martinsburg, WV
 Martinsburg Little League Fields; Martinsburg, WV

EMPLOYMENT HISTORY

1992-Current | Alpha Associates, Inc.
 1988-1992 | Reimer, Muegge & Assoc., Inc.

EDUCATION

MA Civil Engineering | 2000
 BA Architectural Engineering
 Technology | 1988

QUALIFICATIONS

- License: Professional Engineer: West Virginia

AFFILIATIONS

- WV Society of Professional Engineers
- National Society of Professional Engineers



STATE BOARD OF REGISTRATION FOR PROFESSIONAL ENGINEERS

To all to whom these presents shall come, Greeting.

Know Ye That The State Board of Registration for Professional Engineers, of the State of West Virginia, reposing special confidence in the Intelligence, Integrity and Discretion of

Charles B. Branch

DOES, IN PURSUANCE OF AUTHORITY VESTED IN IT
by law, hereby certify that he, having submitted satisfactory evidence of his ability and experience, is a
REGISTERED PROFESSIONAL ENGINEER

Registration Number 15056

(To Hold) and use such title in the practice of his profession, subject to the conditions prescribed by law.



Given under the hand and the Seal of the Board at the Capitol in the City of Charleston,
 this 13th day of February in the year of our Lord 2002
 and of the State the One Hundred Thirty-Eighth

STATE BOARD OF REGISTRATION FOR PROFESSIONAL ENGINEERS

Ed Rieckhoff

By

Frank D. Goddy

L. J. Burns, Jr.

[Signature]

[Signature]



Bradley Casdorph PE, PS

CIVIL ENGINEER

SUMMARY

Mr. Casdorph joined the Alpha Associates, Inc. team in 2004 and currently works as a project engineer in the Morgantown office. He has 36 years of professional experience with roadway design, storm sewer design, airport airside renovation and design, storm water management including conveyance and detention, environmental permitting, project administration supervision and inspection, as well as boundary and construction surveying.

PROFILE

Broad-based responsibilities in the following areas:

- Airport Planning & Design
- Highway Design
- Hydraulic & Hydrology Studies
- Site Plan Development
- Land Surveying, including use of Aerial Drone Technology

PROFESSIONAL HIGHLIGHTS

Civil Engineering:

WVDOH Arnettsville Bridge Replacement; Monongalia County, WV
 WV DOH Open Engineering Open End Contract; WV
 WVDOH Deckers Creek Pedestrian Bridge; Morgantown, WV
 Freedom Automotive Three Dealerships; Morgantown, WV
 Freedom Kia Clarksburg; Clarksburg, WV
 Morgantown Municipal Airport Access Road; Morgantown, WV
 Mon General Hospital Access Road; Morgantown, WV
 WVU - Lot 81 Parking Area Improvements; Morgantown, WV
 McKee Crossing - 120 Acre Subdivision; Martinsburg, WV
 WVU Reedsville Farm Redevelopment; Reedsville, WV
 Mon General Hospital - East Parking Area; Morgantown, WV
 Jane Lew Truck Stop; Jane Lew, WV
 Point Marion Borough; Point Marion, PA
 Clarksburg State Office Building; Clarksburg, WV
 WVU College of Physical Activity & Sports Sciences; Morgantown, WV
 VA Parking Lot SWM; Shepherdstown, WV
 Arcland RV Parking Lot SWM; Charles Town, WV

Surveying:

WVDOH Arnettsville Bridge Replacement; Monongalia County, WV
 Morgantown Municipal Airport Access Road; Morgantown, WV
 Mon General Hospital Access Road; Morgantown, WV
 Freedom Automotive Three Dealerships; Morgantown, WV
 Freedom Kia Clarksburg; Clarksburg, WV

EMPLOYMENT HISTORY

2004-Current | Alpha Associates, Inc.
 1979-2004 | Triad Engineering, Inc.

EDUCATION

MA Soil Conditions & Foundation Design | 1982
 BA Civil Engineering | 1979

QUALIFICATIONS

- License: Professional Engineer: West Virginia
- Professional Surveyor: West Virginia
- Certified Private Pilot
- Certified FAA Part 107 Remote Pilot

AFFILIATIONS

- WV Society of Professional Engineers
- National Society of Professional Engineers
- WVSPS Mountain Regional Chapter; President
- Aircraft Owners and Pilots Association; Member



STATE BOARD OF REGISTRATION FOR PROFESSIONAL ENGINEERS

To all to whom these presents shall come Greeting

*"Know Ye" That The State Board of Registration for Professional Engineers
of the State of West Virginia, reposing special confidence in
the Intelligence, Integrity and Discretion of*

Bradley H. Casdorph

DOES IN PURSUANCE OF AUTHORITY VESTED IN IT

*by law hereby certify that he having submitted
satisfactory evidence of his ability and experience is a*

REGISTERED PROFESSIONAL ENGINEER

Registration Number 16618

*(To Hold) and use such title in the practice of his profession,
subject to the conditions prescribed by law.*



*Given under the hand of the
Seal of the Board at the Capitol in the
City of Charleston,
This 29th day of December
in the year of our Lord 2005
and of the State
the One Hundred Forty-Second*

Members of the Board

Leonard D. Timms, Jr.

Richard E. Dlynas

Blayne S. Shufa

William E. Viers

[Signature]



Charles Luttrell PE

SENIOR PRINCIPAL & STRUCTURAL ENGINEER

SUMMARY

Mr. Luttrell has worked with Alpha Associates, Inc. since 1996. He is the chief structural engineer on all projects at Alpha. Before coming to Alpha, Mr. Luttrell's graduate work resulted in several contributions to the cold-formed steel deck industry. His new method of analysis for non-uniform loads on composite concrete and cold formed steel decks has been made a permanent part of the Steel Deck Institute's design manual. Mr. Luttrell also worked on projects that involved pre-stressed timber bridge research with WVU Constructed Facilities Center. Since coming to Alpha, Mr. Luttrell has had significant involvement in the effort to begin utilizing modern composite materials in practical bridge applications.

PROFILE

Broad-based responsibilities in the following areas:

- Project Mangement
- Business Operations & Financial Management
- Quality Assurance/Quality Control
- Civil Engineering Project Management and Design
- New Business Development
- Expert Testimony and Investigation

PROFESSIONAL HIGHLIGHTS

Structural Engineer:

Freedom Automotive Group 3 Dealerships; Morgantown, WV
 Hazel Ruby McQuain Equine Education & Resource Center; WVU
 WVDOT Arnettsville Replacement Bridge; Morgantown, WV
 Clarksburg State Office Building; Clarksburg, WV
 Grant County Bank Addition & Renovation; Petersburg, WV
 South Berkeley Fire Station; Inwood, WV
 Alumni Center Structural Framing and Foundation; WVU
 Engineering Science Building, East Wing Addition; WVU
 Hazel Ruby McQuain Amphitheater Roof; Morgantown, WV
 Shepherd University Pedestrian Underpass; Shepherdstown, WV
 Washington High School; Charles Town, WV
 WVU Coliseum Structural Inspection; Morgantown, WV
 Alderson Broaddus College, Rex Pyles Arena Deck; Phillipi, WV
 Monongalia County Sheriff's Building; Morgantown, WV
 South High Street Bridge; Morgantown, WV
 Ices Ferry Bridge; Morgantown, WV
 Matthews Foundry Structural Evaluation; Martinsburg, WV
 Martinsburg Little League Fields; Martinsburg, WV
 Martinsburg WWTP; Martinsburg, WV
 Queen St. Underpass; Martinsburg, WV
 Winchester & Western RR Rt. 11 Bridge; Martinsburg, WV

EMPLOYMENT HISTORY

1996-Current | Alpha Associates, Inc.
 1995-1996 | Larry D. Luttrell, PE, PhD
 1991-1994 | West Virginia University
 1990-1991 | WVU Constructed Facilities Center

EDUCATION

MA Structural Engineering | 1995
 BA Civil Engineering | 1993

QUALIFICATIONS

- License: Professional Engineer: West Virginia, Pennsylvania

AFFILIATIONS

- WV Society of Professional Engineers
- National Society of Professional Engineers
- Chi Epsilon; Member
- American Concrete Institute; Member

RESEARCH EXPERIENCE

Cold Formed Steel Deck Research:

- Fastener Failures
- Edge Conditions/Failures
- Buttoned Overlap Shear Failures

Composite Cold Formed Steel & Concrete Deck

- Line Load Behavior/Failures
- Concentrated Load Behavior/Failures
- Web Crippling
- Punch Failures



STATE BOARD OF REGISTRATION FOR PROFESSIONAL ENGINEERS

To all to whom these presents shall come, Greeting.

Know Ye That The State Board of Registration for Professional Engineers, of the State of West Virginia, reposing special confidence in the Intelligence, Integrity and Discretion of

Charles B. Luttrell

DOES, IN PURSUANCE OF AUTHORITY VESTED IN IT

by law, hereby certify that he, having submitted satisfactory evidence of his ability and experience, is a

REGISTERED PROFESSIONAL ENGINEER

Registration Number 14172

To Hold and use such title in the practice of his profession, subject to the conditions prescribed by law.



Given under the hand and the Seal of the Board at the Capitol in the City of Charleston, this 28th day of July in the year of our Lord One Thousand Nine Hundred and Ninety-nine and of the State the One Hundred Thirty-sixth.

STATE BOARD OF REGISTRATION FOR PROFESSIONAL ENGINEERS

Ed. Rickley

Frank H. Naddy

Leade L. H. H. H.

Wm. J. H. H.

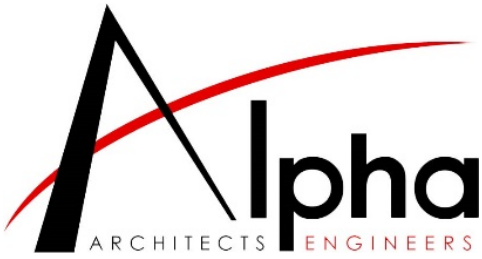

Alpha Experience

Ongoing & Completed Projects with the WVDNR

Hawks Nest State Park & Pipestem Resort State Park – New Aerial Tramways

Ansted, WV | Pipestem, WV

Alpha Associates, Incorporated is currently engaged with the WVDNR as engineer of record to provide a more both Hawks Nest State Park and Pipestem Resort with a more accommodating aerial tramway system for guests. Alpha is providing full services with plans to tie the new development into the existing lodge buildings and create ADA compliant access to the new terminals.

Alpha's designs of the new aerial tramways feature significant improvements over the original, including larger six-person gondolas and a freight car to transport larger objects such as kayaks and bicycles.

Project Contact:

Brad Leslie, Project Engineer

WVDNR

brad.s.leslie@wv.gov

304.389.7663





Coopers Rock State Forest – Pedestrian Overlook Bridge Renovations Morgantown, WV

The WVDNR engaged Alpha to perform a structural assessment of the overlook pedestrian bridge at Cooper Rock State Forest. Over several years, Alpha has consulted with WVDNR/PEM to develop a design befitting to the iconic state park while making immediate repairs to keep visitors safe.

Project Contact:

Brad Leslie, Project Engineer
WVDNR
brad.s.leslie@wv.gov
304.389.7663



Canaan Valley Resort Buildings 1, 4 & 5 – Demolition Project

Davis, WV

Alpha Associates, Incorporated provided demolition plans for the existing buildings 1, 4 and 5 at Canaan Valley Resort. The reclamation plans included creating two (2) levels of grassed, accessible, open spaces that can be used for outdoor activities.



Project Contact:

Guy Nisbet, Assistant Dir. of Business & Technical Services
National Association of State Procurement Officials (NASPO)
guy.l.nisbet@wv.gov
304.558.2596



Coopers Rock State Forest – Portable Water Supply & Distribution System Morgantown, WV

Alpha designed a new portable water supply and distribution system for Coopers Rock State Forest. The current well, storage tank, and pump systems were deficient and in need of replacement. The upgraded system serves as the Forest Superintendent's residence, the Assistant Superintendent's residence, as well as the Forest Office Building.



Project Contact:

Brad Leslie, Project Engineer
WVDNR
brad.s.leslie@wv.gov
304.389.7663

Watters Smith Memorial State Park

Jane Lew, WV

Alpha Associates, Incorporated prepared demolition plans for the existing pool at Watters Smith Memorial State Park. As part of the reclamation, Alpha completed the architectural and site design for a large pavilion that the park will rent to the public for use of gatherings such as wedding receptions, family reunions, and company picnics.



Alpha also developed a structural engineering plan to straighten and stabilize the historic Farm Barn located within the Historical Restoration and Interpretive Area of the park.

Project Contact:

Carolyn Mansberger, Retired Project Manager
WVDNR
Lost Creek, WV
304.745.3081



Cacapon State Park – Old Lodge Renovation

Berkeley Springs, WV

Alpha Associates, Incorporated was tasked by the WVDNR and Cacapon State Park to rehabilitate the Old Inn (also known as the Old Lodge). The project upgraded the HVAC and allowed for the removal of temporary window AC units from the rooms. The windows, sashes, and shutters were restored using stored parts or in-kind parts. HVAC furnaces were installed in the partial basement and outdoor condensers were installed on the west-end of the building with refrigerant linesets groups and run up the exterior face of the building to the attic. Two (2) fireplaces were converted from wood to gas fire units and one wood burning fireplace was upgraded with an electronic draft controller.



Interior wall work included removal of ca. 1970 panels and painted panels to reveal the original rustic log appearance. The modifications applied to the bathroom layouts in the three (3) bedrooms include the removal of existing hall entrances and the relocation and/or construction of new walls and doors. Lighting fixtures were replaced to be a more period appropriated fixture, and, to the south of the building, Alpha provided an installation of a buried propane tanks and associated pipework.

The Old Inn at Cacapon State Park is eligible for the National Register of Historic Places by the West Virginia Division of Culture and History and it was determined that the renovations made did adversely affect the historic characteristics of the building.

Project Contact:

Brad Leslie, Project Engineer
WVDNR
brad.s.leslie@wv.gov
304.389.7663



Bald Knob Overlook Evaluation

Cass, WV

At the request of Matt Yeager, Deputy Chief of Planning, Engineering and Construction for WV State Parks, and Marshall Markely, Superintendent of Cass Scenic Railroad State Park, Alpha visited the Bald Knob Observation Deck in 2023. The purpose of the site visit was to perform the site work for a limited structural evaluation of the deck.



It was determined that the observation deck at Bald Knob has exceeded its structural life span and is now seriously dangerous to continue to use. There were no repair options and/or short-term solutions given; however, Alpha provided some good options for a new observation area at this location. The front of the hill could be terraced with low retaining walls and hardscape. This solution would be economical and very durable. A new observation deck could be built. If it was set back a little from the current one it could be built at the same deck elevation without having such tall columns. If it was set in the same location but built slightly lower than the current deck, the approach section could be launched from grade and provide handicapped accessible access

Project Contact:

Brad Leslie, Project Engineer

WVDNR

brad.s.leslie@wv.gov

304.389.7663



Canaan Valley Resort Tubing Conveyor

Davis, WV

The Canaan Valley Tube Park is situated on the eastern side of State Route 32 and north of Slope Road within the southeastern portion of Canaan Valley State Park. Planned improvements to the park included excavation of on-site material at the crest of the run and placement of fill to create a berm on the northeastern side of the tube run, resulting in a more well-defined run area.



Project Contact:

Sam England, General Manager
Canaan Valley Resort
englands@canaanrestort.com
304.866.4121

TYGART LAKE STATE PARK – BOAT RAMP(S) RENOVATIONS

WV DNR



Location:

Grafton, WV

The project at Tygart Lake was designed to greatly improve the existing boating facilities. The two existing ramps were widened and lengthened to better access the lake and extend the boating season.

Parking lot circulation was expanded to allow better access and the small existing gravel lot was enlarged to accommodate 110 parked vehicles and trailers.

Overall, the project has greatly improved the recreational opportunities for the public and provided an efficient, effective boating facility.



PROJECT INFORMATION:

- ★ Services Provided:
Engineering Design
- ★ Size:
7.5 Acres
- ★ Completion Date:
2019
- ★ Cost:
\$ 2 Million
- ★ Reference:
Brad Leslie
324 4th Avenue
South Charleston, WV 25303
304.558.2764

WEST VIRGINIA UNIVERSITY – LOT 81 PARKING LOT

West Virginia University

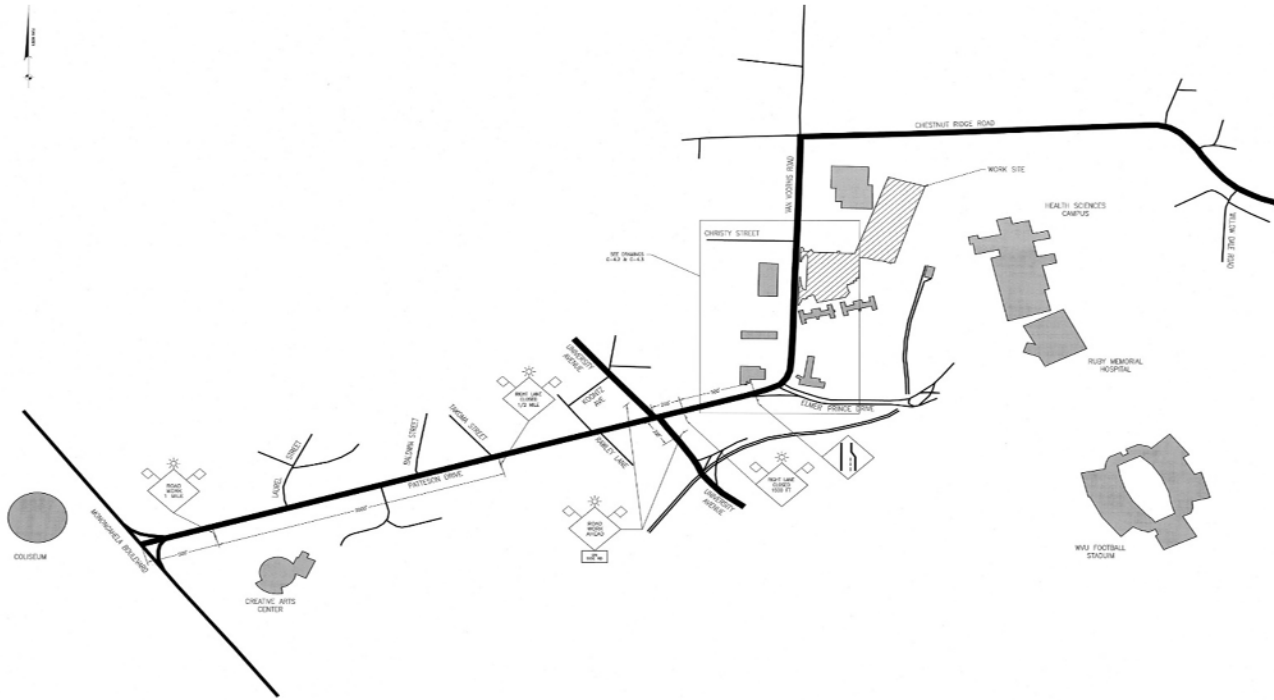

ALPHA
ARCHITECTS, INCORPORATED
1000 N. MARKET STREET
MORGANTOWN, WV 26506
TEL: 304.293.4731
FAX: 304.293.4732
WWW.ALPHA-ARCHITECTS.COM

Alpha Engineering Inc.
Professional Engineer
No. 10000000000000000000
MORGANTOWN, WV

TEMPORARY TRAFFIC CONTROL PLAN
SCALE: AS NOTED

**WEST VIRGINIA UNIVERSITY
AREA 81 – INTERMODAL PARKING
PARKING AREA IMPROVEMENTS
PHASE 1**
MORGANTOWN, WEST VIRGINIA

Location:

Morgantown, WV

Alpha Associates, Incorporated provided surveying, civil engineering, and construction administration services for West Virginia Park Lot 81 Project. This project was the renovation of a parking lot of approximately 1000 spaces. Phase 1 provided revised entrances and additional handicap parking. Phase 2 provided additional asphalt and storm water management controls as well as new lighting.

Alpha's civil engineering components included: site grading, storm water management, utility design, and storm drain design. Alpha coordinated the project with Morgantown Utility Board, the City of Morgantown, and all local utility companies.



PROJECT INFORMATION:

- ⊛ Services Provided:
Engineering, Surveying & Construction Administration
- ⊛ Size:
N/A
- ⊛ Completion Date:
2011
- ⊛ Cost:
\$ 1.3 Million
- ⊛ Reference:
Kevin Kilinsky
Morgantown, WV 26506
304.293.4731

WEST VIRGINIA UNIVERSITY – ALUMNI CENTER PARKING

West Virginia University Alumni Association



Location:

Morgantown, WV

Alpha Associates provided surveying, civil engineering and construction administration services for the West Virginia University Alumni Center Parking Lots Project. This project provided 200 controlled access, paved parking spaces adjacent to the new WVU Alumni Center, lighting, storm water controls, and other related appurtenances.

Alpha's civil engineering components included: building demolition, site grading, storm water management, utility design, and storm drain design. Alpha coordinated the project with the Morgantown Utility Board, the City of Morgantown, and all local utility companies.

Also included in this construction package was the demolition of two existing apartment buildings. Alpha provided engineering for the removal of the buildings and coordination of environmental remediation services.



PROJECT INFORMATION:

- ⊛ Services Provided:
Engineering Services
- ⊛ Size:
200 Spaces
- ⊛ Completion Date:
2008
- ⊛ Cost:
\$ 997,000
- ⊛ Reference:
Paul Hanco
Morgantown, WV 26504
304.293.4731

NORTH FORK HUGHES RIVER RECREATIONAL DESIGN

USDA



Location:

Ritchie County, WV

Alpha Associates, Incorporated provided architectural design, engineering and landscape design for the implantation of a \$12 million Master Plan for the USDA.

The camping area included:

- α Deluxe bath houses & restrooms
- α Amphitheatre
- α Trails
- α Parking areas
- α Check-in building
- α Water transmission & distributor
- α Navigational aids
- α Camping areas
- α Picnic areas
- α Sports fields
- α Roadways
- α Maintenance building
- α Sewage collection & treatment



PROJECT INFORMATION:

- ★ Services Provided:
Architectural, Engineering & Surveying
- ★ Size:
23,089 sq. ft.
- ★ Completion Date:
2009
- ★ Cost:
\$ 12 Million
- ★ Reference:
Sam Ware
Parkersburg, WV
304.422.9072

WV MEDAL OF HONOR RECIPIENTS MEMORIAL PLAZA

WV Division of Highways



Location:

Hazelton, WV

This project required a separate sewage treatment plant and major utility extensions due to the remote location of the site. The building is designed using native West Virginian materials as a central design theme. The design has steeply sloped, metal-clad roofs evocative of West Virginia's hills. Exposed heavy timber framing, native ledge rock stonework and rough-cut cedar siding are used both inside and outside of the building as a symbolic reminder of the beauty and ruggedness of the State's rustic environment.

The Welcome Center is a single-story building of approx. 7,700 square feet. It has separate spaces for public restrooms, vending, landscaped sitting "mall", arts and crafts display and offices. A state of the art, multiple-monitor, computerized theater having multi-media presentation capabilities is also included, as well as interactive computer kiosks bringing the latest updates on regional and state-wide information) to residents and visitors alike. This design utilizes large glass view areas within the Welcome Center to take advantage of the mountainous vista at this site.



PROJECT INFORMATION:

- ★ Services Provided:
Architectural and Engineering
- ★ Size:
7,700 sq. ft.
- ★ Completion Date:
2002
- ★ Cost:
\$ 2 Million
- ★ Reference:
Dirar Ahmad
State Capital Complex, Bldg. 5, Room 317
Charleston, WV 25301
304.558.9721

TOWN OF GLENVILLE – CITY SQUARE

Gilmer County Family Resource Network



Location:

Glenville, WV

Alpha Associates, Incorporated provided architectural and civil engineering design services for the park in downtown Glenville. The park includes 2200 square feet of pavilion, a 20' diameter gazebo, lighting, clock, sidewalk and landscaping.

Civil engineering design services included site design, hardscapes, ADA access to the gazebo, stormwater management, and landscape design and planting plan.

Design was influenced by the anticipated use of the space as a City Park and a potential location for the Annual West Virginia State Folk Festival held in Glenville.



PROJECT INFORMATION:

- ★ Services Provided:
Architectural & Engineering
- ★ Size:
120' x 120'
- ★ Completion Date:
2011
- ★ Cost:
\$ 510,000
- ★ Reference:
Donna Waddell
Glenville, WV 26351
304.462.7545

ALPHA ASSOCIATES, INC.

209 Prairie Ave
Morgantown, WV 26501
304.296.8216

REFERENCES

Elizabeth Williams
WV Division of Highways
Elkins Coal & Coke Restroom Facility
1900 Kanawha Boulevard, East
Charleston, WV 25305
304.285.3209

Conrad Slanina, City Engineer
City of Wheeling – East Sports
Complex
1500 Chapline Street
Wheeling, WV 26003
304.234.3830

Brad Leslie
Tygart Lake State Park
324 4th Avenue
South Charleston, WV 25305
304.558.2764

Ella Belling, Executive Director
Monongahela River Trails
Conservancy
268 High Street
Morgantown, WV 26505
304.692.6782

Sam England
Canaan Valley Resort State Park
230 Main Lodge Road
Davis, WV 26260
304.866.4121

CERTIFICATE OF *Authorization*

STATE BOARD OF REGISTRATION FOR PROFESSIONAL ENGINEERS

*The West Virginia State Board of Registration for Professional Engineers
having verified the person in responsible charge is registered in
West Virginia as a professional engineer for the noted firm, hereby certifies*

*has complied with section §30-13-17 of the West Virginia Code governing
the issuance of a Certificate of Authorization. The Board hereby notifies you of its
certification with issuance of this Certification of Authorization for the period of:*

providing for the practice of engineering services in the State of West Virginia.

IF YOU ARE REQUIRED TO REGISTER WITH THE SECRETARY OF STATE'S OFFICE,
PLEASE SUBMIT THIS CERTIFICATE WITH YOUR APPLICATION.



IN TESTIMONY WHEREOF, THE WEST VIRGINIA STATE BOARD OF
REGISTRATION FOR PROFESSIONAL ENGINEERS HAS ISSUED THIS COA
UNDER ITS SEAL, AND SIGNED BY THE PRESIDENT OF SAID BOARD.

Scott E. Thomas Jr.

BOARD PRESIDENT

State of West Virginia



Certificate

I, Mac Warner, Secretary of State of the State of West Virginia, hereby certify that

ALPHA ASSOCIATES, INCORPORATED

was incorporated under the laws of West Virginia and a Certificate of Incorporation was issued by the West Virginia Secretary of State's Office on June 23, 1969.

I further certify that the corporation has not been revoked or administratively dissolved by the State of West Virginia nor has the West Virginia Secretary of State issued a Certificate of Dissolution to the corporation.

Accordingly, I hereby issue this Certificate of Existence

CERTIFICATE OF EXISTENCE

Validation ID:1WV25_3J5W7



*Given under my hand and the
Great Seal of the State of
West Virginia on this day of
January 26, 2024*

Mac Warner

Secretary of State



CERTIFICATE OF LIABILITY INSURANCE

DATE (MM/DD/YY) **37**
02/29/2024

THIS CERTIFICATE IS ISSUED AS A MATTER OF INFORMATION ONLY AND CONFERS NO RIGHTS UPON THE CERTIFICATE HOLDER. THIS CERTIFICATE DOES NOT AFFIRMATIVELY OR NEGATIVELY AMEND, EXTEND OR ALTER THE COVERAGE AFFORDED BY THE POLICIES BELOW. THIS CERTIFICATE OF INSURANCE DOES NOT CONSTITUTE A CONTRACT BETWEEN THE ISSUING INSURER(S), AUTHORIZED REPRESENTATIVE OR PRODUCER, AND THE CERTIFICATE HOLDER.

IMPORTANT: If the certificate holder is an **ADDITIONAL INSURED**, the policy(ies) must have **ADDITIONAL INSURED** provisions or be endorsed. If **SUBROGATION IS WAIVED**, subject to the terms and conditions of the policy, certain policies may require an endorsement. A statement on this certificate does not confer rights to the certificate holder in lieu of such endorsement(s).

PRODUCER MEDALLION INSURANCE SERVICES PO Box 79089 Charlotte NC 28271		CONTACT NAME: Phyllis Constantino PHONE (A/C, No, Ext): (704) 256-6000 E-MAIL ADDRESS: phyllis@medallioninsurance.com FAX (A/C, No): (704) 256-6001	
INSURED Alpha Associates, Incorporated 209 Prairie Ave Ste 209 Morgantown WV 26501		INSURER(S) AFFORDING COVERAGE INSURER A: Kinsale Insurance Company INSURER B: INSURER C: INSURER D: INSURER E: INSURER F:	
		NAIC # 38920	

COVERAGES **CERTIFICATE NUMBER:** CL2422110349 **REVISION NUMBER:**

THIS IS TO CERTIFY THAT THE POLICIES OF INSURANCE LISTED BELOW HAVE BEEN ISSUED TO THE INSURED NAMED ABOVE FOR THE POLICY PERIOD INDICATED. NOTWITHSTANDING ANY REQUIREMENT, TERM OR CONDITION OF ANY CONTRACT OR OTHER DOCUMENT WITH RESPECT TO WHICH THIS CERTIFICATE MAY BE ISSUED OR MAY PERTAIN, THE INSURANCE AFFORDED BY THE POLICIES DESCRIBED HEREIN IS SUBJECT TO ALL THE TERMS, EXCLUSIONS AND CONDITIONS OF SUCH POLICIES. LIMITS SHOWN MAY HAVE BEEN REDUCED BY PAID CLAIMS.

INSR LTR	TYPE OF INSURANCE	ADDL INSD	SUBR WVD	POLICY NUMBER	POLICY EFF (MM/DD/YYYY)	POLICY EXP (MM/DD/YYYY)	LIMITS
	COMMERCIAL GENERAL LIABILITY <input type="checkbox"/> CLAIMS-MADE <input type="checkbox"/> OCCUR GEN'L AGGREGATE LIMIT APPLIES PER: <input type="checkbox"/> POLICY <input type="checkbox"/> PRO-JECT <input type="checkbox"/> LOC <input type="checkbox"/> OTHER:						EACH OCCURRENCE DAMAGE TO RENTED PREMISES (Ea occurrence) MED EXP (Any one person) PERSONAL & ADV INJURY GENERAL AGGREGATE PRODUCTS - COMP/OP AGG \$ \$ \$ \$ \$ \$
	AUTOMOBILE LIABILITY <input type="checkbox"/> ANY AUTO <input type="checkbox"/> OWNED AUTOS ONLY <input type="checkbox"/> HIRED AUTOS ONLY <input type="checkbox"/> SCHEDULED AUTOS <input type="checkbox"/> NON-OWNED AUTOS ONLY						COMBINED SINGLE LIMIT (Ea accident) BODILY INJURY (Per person) BODILY INJURY (Per accident) PROPERTY DAMAGE (Per accident) \$ \$ \$ \$
	UMBRELLA LIAB EXCESS LIAB <input type="checkbox"/> OCCUR <input type="checkbox"/> CLAIMS-MADE <input type="checkbox"/> DED <input type="checkbox"/> RETENTION \$						EACH OCCURRENCE AGGREGATE \$ \$ \$
	WORKERS COMPENSATION AND EMPLOYERS' LIABILITY ANY PROPRIETOR/PARTNER/EXECUTIVE OFFICER/MEMBER EXCLUDED? (Mandatory in NH) If yes, describe under DESCRIPTION OF OPERATIONS below <input type="checkbox"/> Y / <input type="checkbox"/> N		N / A				PER STATUTE OTH-ER E.L. EACH ACCIDENT E.L. DISEASE - EA EMPLOYEE E.L. DISEASE - POLICY LIMIT \$ \$ \$
A	PROFESSIONAL LIABILITY CLAIMS-MADE			0100225819-1	02/12/2024	02/12/2025	EACH CLAIM AGGREGATE \$3,000,000 \$3,000,000

DESCRIPTION OF OPERATIONS / LOCATIONS / VEHICLES (ACORD 101, Additional Remarks Schedule, may be attached if more space is required)

CERTIFICATE HOLDER

CANCELLATION

Information Purposes

SHOULD ANY OF THE ABOVE DESCRIBED POLICIES BE CANCELLED BEFORE THE EXPIRATION DATE THEREOF, NOTICE WILL BE DELIVERED IN ACCORDANCE WITH THE POLICY PROVISIONS.

AUTHORIZED REPRESENTATIVE

© 1988-2015 ACORD CORPORATION. All rights reserved.

DESIGNATED CONTACT: Vendor appoints the individual identified in this Section as the Contract Administrator and the initial point of contact for matters relating to this Contract.

(Printed Name and Title) Richard Colebank, PE, PS, President & COO

(Address) 209 Prairie Avenue, Morgantown, WV 26501

(Phone Number) / (Fax Number) (304) 296-8216 / (304) 296-8245

(email address) rick.colebank@thinkalphafirst.com

CERTIFICATION AND SIGNATURE: By signing below, or submitting documentation through wvOASIS, I certify that: I have reviewed this Solicitation/Contract in its entirety; that I understand the requirements, terms and conditions, and other information contained herein; that this bid, offer or proposal constitutes an offer to the State that cannot be unilaterally withdrawn; that the product or service proposed meets the mandatory requirements contained in the Solicitation/Contract for that product or service, unless otherwise stated herein; that the Vendor accepts the terms and conditions contained in the Solicitation, unless otherwise stated herein; that I am submitting this bid, offer or proposal for review and consideration; that this bid or offer was made without prior understanding, agreement, or connection with any entity submitting a bid or offer for the same material, supplies, equipment or services; that this bid or offer is in all respects fair and without collusion or fraud; that this Contract is accepted or entered into without any prior understanding, agreement, or connection to any other entity that could be considered a violation of law; that I am authorized by the Vendor to execute and submit this bid, offer, or proposal, or any documents related thereto on Vendor's behalf; that I am authorized to bind the vendor in a contractual relationship; and that to the best of my knowledge, the vendor has properly registered with any State agency that may require registration.

By signing below, I further certify that I understand this Contract is subject to the provisions of West Virginia Code § 5A-3-62, which automatically voids certain contract clauses that violate State law; and that pursuant to W. Va. Code 5A-3-63, the entity entering into this contract is prohibited from engaging in a boycott against Israel.

Alpha Associates, Incorporated

(Company)

(Signature of Authorized Representative)

Richard Colebank, PE, PS, President & COO

(Printed Name and Title of Authorized Representative) (Date)

(304) 296-8216 / (304) 296-8245

(Phone Number) (Fax Number)

rick.colebank@thinkalphafirst.com

(Email Address)